



**CITY OF MILWAUKEE
OFFICE OF THE CITY CLERK**

Wednesday, October 09, 2024

COMMITTEE MEETING NOTICE

AD 06

JAISWAL, Punit, Agent
NORTH & H INC.
2110 W Woodbury Ln
Glendale, WI 53209

You are requested to attend a hearing which is to be held in Room 301-B, Third Floor, City Hall or you may attend virtually using the link below.

Tuesday, October 22, 2024 at 01:25 PM

The access code is <https://meet.goto.com/366619901>. Please see the enclosed best practices document for further instructions.

Regarding: Your Extended Hours Establishments, Filling Station, Food Dealer and Weights & Measures Licenses Application Requesting To Open From 5AM to 2AM  agent for "NORTH & H INC." for "Holton Gas & Food" at 2237 N HOLTON St.

There is a possibility that your application may be denied for one or more of the following reasons: The recommendation of the committee regarding the application shall be based on evidence presented at the hearing. Per MCO 85-2.7-4, probative evidence concerning whether or not a new license should be granted may be presented on the following subjects: whether or not the applicant meets the municipal requirements, the appropriateness of the location and premises where the licensed premises is to be located and whether use of the premises for the purposes or activities permitted by the license would tend to facilitate a public or private nuisance or create undesirable neighborhood problems such as disorderly patrons, unreasonably loud noise, litter, and excessive traffic and parking congestion. Probative evidence relating to these matters may be taken from the plan of operation submitted with the license application, if any, but shall not include the content of any music. Evidence regarding the fitness of the location of the premises to be maintained as the principal place of business, including but not limited to whether there is an overconcentration of businesses of the type for which the license is sought; whether the proposal is consistent with any pertinent neighborhood business or development plans, or the location's proximity to areas where children are typically present. The applicant's record in operating similarly licensed premises; and whether or not the applicant has been charged with or convicted of any felony, misdemeanor, municipal offense or other offense, the circumstances of which substantially relate to the activity to be permitted by the license being applied for or any other factor which reasonably relates to the public health, safety or welfare may also be considered. See attached police report or correspondence.

**Notice for applicants with
warrants or unpaid fines:**

Proof of warrant satisfaction or payment of fines must be submitted at the hearing on the above date and time. Failure to comply with this requirement may result in a delay of the granting/denial of your application.

Failure to appear at this meeting may result in the denial of your license. Individual applicants must appear only in person or by an attorney. Corporate or Limited Liability applicants must appear only by the agent designated on the application or by an attorney. Partnership applicants must appear by a partner listed on the application or by an attorney. If you wish to do so and at your own expense, you may be accompanied by an attorney of your choosing to represent you at this hearing.

You will be given an opportunity to speak on behalf of the application and to respond and challenge any charges or reasons given for the denial. No petitions can be accepted by the committee, unless the people who signed the petition are present at the committee hearing and willing to testify. You may present witnesses under oath and you may also confront and cross-examine opposing witnesses under oath. If you have difficulty with the English language, you should bring an interpreter with you, at your expense, so that you can answer questions and participate in your hearing.

You may examine the application file at this office during regular business hours prior to the hearing date. Inquiries regarding this matter may be directed to the person whose signature appears below.

Limited parking for persons attending meetings during normal business hours is available at reduced rates (5 hour limit) at the Milwaukee Center on the southwest corner of Kilbourn Avenue and Water Street. You must present a copy of the meeting notice to the parking cashier.

PLEASE NOTE: Upon reasonable notice, efforts will be made to accommodate the needs of disabled individuals through sign language interpreters or other auxiliary aids. For additional information or to request this service, contact the Council Services Division ADA Coordinator at (414) 286-2998, Fax - (414) 286-3456, TDD - (414) 286-2025.

JIM OWCZARSKI, CITY CLERK



BY: _____

Jim Cooney
License Division Manager

If you have questions regarding this notice, please contact the License Division at (414) 286-2238.

200 E. Wells Street, Room 105, City Hall, Milwaukee, WI 53202. www.milwaukee.gov/license
Phone: (414) 286-2238 Fax: (414) 286-3057 Email Address: License@milwaukee.gov



Wednesday, October 09, 2024



Notice of Public Hearing

Blank Notice

JAISWAL, Punit, Agent
Holton Gas & Food at 2237 N HOLTON St
Extended Hours Establishments, Filling Station, Food Dealer and Weights & Measures Licenses
Application Requesting To Open From 5AM to 2AM

Tuesday, October 22, 2024 at 1:25 PM

To whom it may concern:

The above application has been made by the above named applicant(s). This requires approval from the Licenses Committee and the Common Council of the City of Milwaukee. The hearing before the Licenses Committee will take place on 10/22/2024 at 1:25 PM in Room 301-B, Third Floor, City Hall. This is a public hearing. Those wishing to view the proceeding are able to do so via the City Channel – Channel 25 on Spectrum Cable. – or on the Internet at <http://city.milwaukee.gov/citychannel>. Those wishing to provide oral testimony via internet are asked to contact the staff assistant, Yadira Melendez at (414) 286-2775 or stasst5@milwaukee.gov for necessary information. Please make such requests no later than one business day prior to the start of the meeting. You are not required to attend the hearing, but please see the information below if you would like to provide testimony. Once the Licenses Committee makes its recommendation, this recommendation is forwarded to the full Common Council for approval at its next regularly scheduled hearing.

Important details for those wishing to provide information for the Licenses Committee to consider when making its recommendation:

1. The license application is scheduled to be heard at the above time. Due to other hearings running longer than scheduled, you may have to wait some time to provide your testimony.
2. You must appear in person and testify as to matters that you have personally experienced or seen. (You cannot provide testimony for your neighbor, parent or anyone else; this is considered hearsay and cannot be considered by the committee.)
3. No letters or petitions can be accepted by the committee (unless the person who wrote the letter or the persons who signed the petition are present at the committee hearing and willing to testify).
4. Persons opposed to the license application are given the opportunity to testify first; supporters may testify after the opponents have finished.
5. When you are called to testify, you will be sworn in and asked to give your name, and address. (If your first and/or last names are uncommon please spell them.)
6. You may then provide testimony.
 - a. Include only information relating to the above license application.
 - b. Include only information you have personally witnessed or seen.
 - c. Provide concise and relevant information detailing how this business has affected or may affect the peaceful enjoyment of your neighborhood.
 - d. If by the time you have the opportunity to testify, the information you wish to share has already been provided to the committee, you may state that you agree with the previous testimony. Redundant or repetitive testimony will not assist the committee in making its recommendation.
7. After giving your testimony, the members of the Licenses Committee and the licensee may ask questions regarding the testimony you have given or other factors relating to the license application.
8. Business Competition is not a valid basis for denial or non-renewal of a license.
Please Note: If you have submitted an objection to the above application your objection cannot be considered by the committee unless you personally testify at the hearing.

OCCUPANT	MAIL ADDRESS	CITY STATE ZIP
CURRENT OCCUPANT	2211 N BOOTH ST	MILWAUKEE, WI 53212-3407
CURRENT OCCUPANT	2211A N BOOTH ST	MILWAUKEE, WI 53212-3407
CURRENT OCCUPANT	2212 N HOLTON ST	MILWAUKEE, WI 53212-3338
CURRENT OCCUPANT	2213 N HOLTON ST# 1	MILWAUKEE, WI 53212-3337
CURRENT OCCUPANT	2213 N HOLTON ST# 2	MILWAUKEE, WI 53212-3337
CURRENT OCCUPANT	2214 N HOLTON ST	MILWAUKEE, WI 53212-3338
CURRENT OCCUPANT	2216 N BUFFUM ST	MILWAUKEE, WI 53212-3328
CURRENT OCCUPANT	2216 N HOLTON ST	MILWAUKEE, WI 53212-3338
CURRENT OCCUPANT	2216A N BUFFUM ST	MILWAUKEE, WI 53212-3328
CURRENT OCCUPANT	2216A N HOLTON ST	MILWAUKEE, WI 53212-3338
CURRENT OCCUPANT	2218 N BUFFUM ST	MILWAUKEE, WI 53212-3328
CURRENT OCCUPANT	2220 N BUFFUM ST	MILWAUKEE, WI 53212-3328
CURRENT OCCUPANT	2220 N HOLTON ST	MILWAUKEE, WI 53212-3338
CURRENT OCCUPANT	2221 N BOOTH ST	MILWAUKEE, WI 53212-3407
CURRENT OCCUPANT	2221 N HOLTON ST	MILWAUKEE, WI 53212-3337
CURRENT OCCUPANT	2221 N HOLTON ST# A	MILWAUKEE, WI 53212-3337
CURRENT OCCUPANT	2222 N HOLTON ST	MILWAUKEE, WI 53212-3338
CURRENT OCCUPANT	2223 N BOOTH ST	MILWAUKEE, WI 53212-3407
CURRENT OCCUPANT	2224 N BUFFUM ST	MILWAUKEE, WI 53212-3328
CURRENT OCCUPANT	2224 N HOLTON ST	MILWAUKEE, WI 53212-3338
CURRENT OCCUPANT	2224A N BUFFUM ST	MILWAUKEE, WI 53212-3328
CURRENT OCCUPANT	2226 N HOLTON ST	MILWAUKEE, WI 53212-3338
CURRENT OCCUPANT	2228 N BUFFUM ST	MILWAUKEE, WI 53212-3328
CURRENT OCCUPANT	2230 N HOLTON ST	MILWAUKEE, WI 53212-3338
CURRENT OCCUPANT	2231 N BOOTH ST	MILWAUKEE, WI 53212-3407
CURRENT OCCUPANT	2232 N BUFFUM ST	MILWAUKEE, WI 53212-3328
CURRENT OCCUPANT	2232 N HOLTON ST	MILWAUKEE, WI 53212-3338
CURRENT OCCUPANT	2236 N HOLTON ST	MILWAUKEE, WI 53212-3338
CURRENT OCCUPANT	2238 N HOLTON ST	MILWAUKEE, WI 53212-3338
CURRENT OCCUPANT	2244 N BUFFUM ST	MILWAUKEE, WI 53212-3328
CURRENT OCCUPANT	2303 N HOLTON ST# 1	MILWAUKEE, WI 53212-3300
CURRENT OCCUPANT	2303 N HOLTON ST# 2	MILWAUKEE, WI 53212-3300
CURRENT OCCUPANT	2303 N HOLTON ST# 3	MILWAUKEE, WI 53212-3300
CURRENT OCCUPANT	2303 N HOLTON ST# 4	MILWAUKEE, WI 53212-3300
CURRENT OCCUPANT	2303 N HOLTON ST# 5	MILWAUKEE, WI 53212-3300
CURRENT OCCUPANT	2303 N HOLTON ST# 6	MILWAUKEE, WI 53212-3300
CURRENT OCCUPANT	2308 N BUFFUM ST	MILWAUKEE, WI 53212-3306
CURRENT OCCUPANT	2313 N HOLTON ST	MILWAUKEE, WI 53212-3355
CURRENT OCCUPANT	2313A N HOLTON ST	MILWAUKEE, WI 53212-3355
CURRENT OCCUPANT	2313B N HOLTON ST	MILWAUKEE, WI 53212-3355
CURRENT OCCUPANT	2316 N HOLTON ST	MILWAUKEE, WI 53212-3356
CURRENT OCCUPANT	2316A N HOLTON ST	MILWAUKEE, WI 53212-3356
CURRENT OCCUPANT	2320 N BUFFUM ST	MILWAUKEE, WI 53212-3306
CURRENT OCCUPANT	2320 N HOLTON ST	MILWAUKEE, WI 53212-3356
CURRENT OCCUPANT	2320A N BUFFUM ST	MILWAUKEE, WI 53212-3306
CURRENT OCCUPANT	2320A N HOLTON ST	MILWAUKEE, WI 53212-3356

CURRENT OCCUPANT	2322 N BUFFUM ST	MILWAUKEE, WI 53212-3306
CURRENT OCCUPANT	2322 N HOLTON ST	MILWAUKEE, WI 53212-3356
CURRENT OCCUPANT	2323 N HOLTON ST	MILWAUKEE, WI 53212-3355
CURRENT OCCUPANT	400 E GARFIELD AVE	MILWAUKEE, WI 53212-3332
CURRENT OCCUPANT	402 E GARFIELD AVE	MILWAUKEE, WI 53212-3332
CURRENT OCCUPANT	406 E GARFIELD AVE	MILWAUKEE, WI 53212-3332
CURRENT OCCUPANT	408 E GARFIELD AVE	MILWAUKEE, WI 53212-3332
CURRENT OCCUPANT	410 E GARFIELD AVE	MILWAUKEE, WI 53212-3332
CURRENT OCCUPANT	412 E GARFIELD AVE	MILWAUKEE, WI 53212-3332
CURRENT OCCUPANT	418 E GARFIELD AVE	MILWAUKEE, WI 53212-3332
CURRENT OCCUPANT	420 E GARFIELD AVE	MILWAUKEE, WI 53212-3332
CURRENT OCCUPANT	424 E GARFIELD AVE	MILWAUKEE, WI 53212-3332
CURRENT OCCUPANT	434 E GARFIELD AVE	MILWAUKEE, WI 53212-3332
CURRENT OCCUPANT	436 E GARFIELD AVE	MILWAUKEE, WI 53212-3332
CURRENT OCCUPANT	510 E GARFIELD AVE	MILWAUKEE, WI 53212-3410
CURRENT OCCUPANT	512 E NORTH AVE	MILWAUKEE, WI 53212-3421
CURRENT OCCUPANT	514 E GARFIELD AVE	MILWAUKEE, WI 53212-3480
CURRENT OCCUPANT	514 E GARFIELD AVE# 1	MILWAUKEE, WI 53212-3480
CURRENT OCCUPANT	514 E GARFIELD AVE# 2	MILWAUKEE, WI 53212-3480
CURRENT OCCUPANT	514 E GARFIELD AVE# 3	MILWAUKEE, WI 53212-3480
CURRENT OCCUPANT	514 E NORTH AVE	MILWAUKEE, WI 53212-3421
CURRENT OCCUPANT	517 E NORTH AVE	MILWAUKEE, WI 53212-3420
CURRENT OCCUPANT	519 E NORTH AVE	MILWAUKEE, WI 53212-3420
CURRENT OCCUPANT	520 E NORTH AVE	MILWAUKEE, WI 53212-3421
CURRENT OCCUPANT	521 E NORTH AVE	MILWAUKEE, WI 53212-3420
CURRENT OCCUPANT	522 E NORTH AVE	MILWAUKEE, WI 53212-3421

Blank Notice

Total Records: 72

Radius 250 feet and Center of the Circle: 2237 N Holton St



APPLICATION AMENDMENT

Office of the City Clerk License Division

200 E. Wells Street, Room 105, Milwaukee, WI 53202 (414) 286-2238

Date: 9-20-24

To the License Division of the City of Milwaukee:

I, PUNIR JAISWAL, wish to amend my answer(s) on the application for a

(full legal name)

Filling Station Food license at 2237 N. Holton St Milwaukee - 53212
 (type of license) extended (premises address, if applicable)

by adding or amending the following information (complete only those sections being amended):

1. Answer to Question(s) # _____ should be: _____
2. Agent should be (full legal name): _____ Also complete 3, 4, 5 & 6
3. Date of birth should be: _____
4. Home address should be (include city/state/zip): _____
5. Phone number should be (include area code): _____
6. Driver's License Number/State ID Number should be: _____
7. Corporation/LLC name should be (full legal name): _____
8. Business name should be: _____
9. Premises address should be (include city/state/zip): _____
10. Business phone number should be (include area code): _____
11. Mailing address should be (include city/state/zip): _____
12. Email address should be: _____
13. Recycling/Salvaging/Towing: Location where vehicle will be parked should be (include city/state/zip): _____
14. Class B Tavern: Age Distinction should be: _____
15. Other: Changing hour of operation on all the license to be
5 AM - 00 AM not 24 hours

(Check with the License Division before submitting "Other" amendments using this form.)

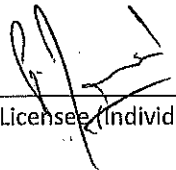
 Signature of Licensee (Individual, Partner, or Agent of Corp/LLC)
Office Use Only: Application #: 368 322 Date: 9/20/24 Initials: AD To LC: _____LC Email: ☐MPD ☐NS ☐HD Initials: _____



BUSINESS LICENSE PLAN OF OPERATION

ccl-busplan 5/12/2020

Office of the City Clerk License Division
200 E. Wells St. Room 105, Milwaukee, WI 53202
(414) 286-2238 www.milwaukee.gov/license e-mail address: license@milwaukee.gov

1. Type of Business

Applying for: ☒ Extended Hours (12AM to 5AM) - If a food establishment, check all that apply: ☐ Delivery ☐ Drive Thru ☐ Dining Room
☐ Self Service Laundry ☐ Massage Establishment ☐ Filling Station
☐ Other (supplemental application for specific license also required)

Provide a detailed description of the type of business you plan on operating: GAS STATION & CONVENIENCE STORE

Do you have any experience operating this type of business? ☐ No ☒ Yes If yes, explain: 5401 N. Lovers Lane Rd, Milwaukee

2. Business Operations

- a. Proposed Opening Date: 08/01/2024
- b. Is this premise under construction? ☒ No ☐ Yes If yes, list estimated completion date: _____
- c. Is this a franchise? ☒ No ☐ Yes
- d. Is this premises currently licensed? ☐ No ☒ Yes If yes, list type of license: FOOD, CIG, WEIGHT, FILL IN, EXTENDED
- e. Is the current licensee operating? ☐ No ☒ Yes If no, list date closed: _____
- f. Do you have future plans for other businesses, licenses or permits at this location? ☒ No ☐ Yes
If yes, explain: _____
- g. Have you previously held an Extended Hours License in Milwaukee? ☐ No ☒ Yes
If yes, list address(es): 5401 N LOVERS LANE RD, MILWAUKEE, WI
- h. Are other businesses operating in the same building? ☒ No ☐ Yes If yes, describe: _____

3. Litter & Noise

- a. How are grounds kept clean? ☒ Sweep ☒ Pressure Wash ☒ Pick Up Litter ☐ Other: _____
- b. How often will grounds be cleaned? ☒ Daily ☐ Weekly ☐ As Needed ☐ Monthly ☐ Other: _____
- c. Grounds cleaned by: ☒ Licensee ☒ Building Owner ☒ Employees ☒ Hired Maintenance ☐ Other: _____
- d. How are noise issues prevented and/or addressed? ☐ Security ☒ Manager approaches customer(s) ☐ Call Police
☒ Signs Posted ☒ Other: CAMERA INSTALLED
- e. Will a sound amplification system be used? ☒ No ☐ Yes If yes, describe: _____

4. Smoking & Sanitation

- a. Are there designated outdoor smoking areas? ☒ No ☐ Yes If yes, describe: _____
- b. Number of Garbage Cans: Inside: 3 Locations: 1 by cashier, 1 in restroom, 1 by cooler
Outside: 5 Locations: 1 main entrance, 4 by each pump
- c. Is a crowd control barrier used? ☒ No ☐ Yes If yes, describe: _____
- d. How many restrooms are on the premises? 1
- e. Name of solid waste contractor: ☒ Advanced Disposal ☐ Waste Management ☐ Other: _____

5. Security

- a. Are there onsite parking spaces? ☐ No ☒ Yes If yes, how many? 8 and describe the parking security plan: Security Cameras are installed
- b. Is there a loading zone? ☒ No ☐ Yes If yes, describe the loading area security plan: _____
- c. Will you have licensed security on premise? ☒ No ☐ Yes If yes, how many? _____ and answer the following:
What are their responsibilities? _____
Describe equipment used _____
List their License Number (s) _____
- d. Will there be security cameras? ☐ No ☒ Yes If yes, how many? 16 and list locations: 8 inside
8 outside
- e. Will searches/identification checks be done upon entry? ☒ No ☐ Yes If yes, describe _____

6. Percentage of Sales (must total 100%)

Alcohol _____%	Food <u>30</u> % Cigarettes, Electronic Vape Devices, Tobacco Products <u>5</u> %	Secondhand Merchandise _____%	Precious Metals & Gems _____%
Entertainment _____%			
Pawnbroker Activity _____%	Salvaged Materials _____% (such as scrap metal)	Personal Services (such as tattoo, body piercing, salon, tailor, tanning, etc.) _____%	Other <u>65</u> % Describe: <u>Gas and lottery</u>

7. Businesses/Licenses on the Premises (check all that apply):

Type 1

- | | | | |
|--|---|---|--|
| <input type="checkbox"/> Full Service Restaurant | <input type="checkbox"/> Cafe/Coffee Shop | <input type="checkbox"/> Deli or Fast Food Restaurant | <input type="checkbox"/> Private/Fraternal/Veterans Club |
| <input type="checkbox"/> Night Club | <input type="checkbox"/> Tavern | <input type="checkbox"/> Cocktail Lounge | <input type="checkbox"/> Teen Club |
| <input type="checkbox"/> Banquet Hall | <input type="checkbox"/> Sports Facility | <input type="checkbox"/> Bowling Alley | |
| <input type="checkbox"/> Hotel/Motel : Number of Floors: _____
Number of Rooms: _____ | <input type="checkbox"/> Rooming House: Number of Floors: _____
Number of Rooms: _____ | | |

Type 2

- | | | | |
|---|--|--------------------------------------|---|
| <input type="checkbox"/> Liquor Store | <input type="checkbox"/> Corner Store | <input type="checkbox"/> Supermarket | <input checked="" type="checkbox"/> Convenience Store |
| <input checked="" type="checkbox"/> Gas Station | <input type="checkbox"/> Amusement/Phonograph Distributor | | <input type="checkbox"/> Recycling, Salvage or Towing |
| <input type="checkbox"/> Used Car Dealer | <input type="checkbox"/> Personal Service Establishment
(such as tattoo business, hair salon, tailor, etc.) | | <input type="checkbox"/> Recording Studio |

What other licenses/permits will you hold at this location? (check all that apply)

- | | | | | | |
|--|---|---|--|---|--|
| <input checked="" type="checkbox"/> Occupancy Permit | <input checked="" type="checkbox"/> Cigarette, Tobacco,
Electronic Vape Products | <input checked="" type="checkbox"/> Gas Station | <input checked="" type="checkbox"/> Extended Hours | <input type="checkbox"/> Class "B" Tavern | <input checked="" type="checkbox"/> Weights & Measures |
| <input type="checkbox"/> Secondhand Dealer | <input type="checkbox"/> Precious Metal & Gem | <input type="checkbox"/> Other: _____ | | | |

8. Legal Capacity (only if a Type 1 premises in #7 above)

Capacity _____ (Call the Milwaukee Development Center at 414-286-8211 if you have questions.)

9. Premises Description

- a. Identify all area(s) of the premises that will be used in operating this business (include areas used only for storage):
☒ 1st Floor ☐ 2nd Floor ☐ Basement Storage ☐ Patio ☐ Beer Garden ☐ Sidewalk Café ☐ Deck ☐ Rooftop
☐ Other: Describe: _____
- b. Describe Location: ☒ Major Thoroughfare ☐ Secondary Street ☐ Other: _____
- c. Nearest Major Cross Street: North Ave
- d. Describe Building: ☒ Free Standing Building ☐ Strip Mall ☐ Other: _____
- e. Describe Premises Structure: ☒ Single Story ☐ Multi-Story - # of Stories _____ ☐ Other: _____
- f. Describe Surrounding Area: ☐ Commercial ☒ Residential ☐ Industrial ☐ Other: _____
- g. Building Owner Name: Jasjit Singh Phone Number: 414-350-6241
 Building Owner Address: 2237 N. Milton Ave, Milwaukee

10. Hours of Operation & Customers

Will customers be entering the premises? ☐ No ☒ Yes

Day of the Week	Proposed Hours of Operation		Estimated Number of Customers expected each day	Potential Age Range of Customers	Class B Tavern Applicant Only: Age Restriction (If none, write None)
	Open Time (include a.m. or p.m.)	Close Time (include a.m. or p.m.)			
Sunday	12 am	12 am	300	All	
Monday	12 am	12 am	300	All	
Tuesday	12 am	12 am	300	All	
Wednesday	12 am	12 am	300	All	
Thursday	12 am	12 am	300	All	
Friday	12 am	12 am	300	All	
Saturday	12 am	12 am	300	All	

An Extended Hours Establishment License is required for any convenience store, filling station, personal service establishment (such as tattoo, body piercing, salon, tailor, tanning, etc.), recording studio or restaurant which is open between the hours of 12:00 a.m. and 5:00 a.m.

Alcohol Establishments Class A: 8:00 am to 9:00 pm Sunday thru Saturday
 Permitted Hours of Operation: Class B: 6:00 am to 2:00 am Sunday thru Thursday, 6:00 am to 2:30 am Friday & Saturday

Entertainment Outdoor Closing Hours: 10:00pm Sunday-Thursday; 12:00am Friday & Saturday; unless a different time, either earlier or later, is established by the Common Council in its approval of the licensee's plan of operation.

11. Signature(s)

Signature of Sole Proprietor, Partner, or 20% or more Shareholder
 (If there are no 20% or more shareholders,
 Corporate Officer-print name/title and sign)

Signature of additional partner or 20% or more shareholder

See Application Information for a complete list of all required application forms.

**FOOD DEALER LICENSE PLAN OF OPERATION**

OFFICE OF THE CITY CLERK, LICENSE DIVISION
CITY HALL, 200 E. WELLS ST, ROOM 105, MILWAUKEE, WI 53202
(414) 286-2238 • license@milwaukee.gov • www.milwaukee.gov/license

Legal Entity Name: **NORTH & H INC.**Premises Address: **2237 N HOLTON ST, MILWAUKEE, WI-53212****SECTION 1 TYPE OF BUSINESS**

What will be the majority of your food sales? (check one)

☐ Restaurant Items (meals):

MEALS include, but are not limited to, chicken, ribs, sandwiches, roasted corn, baked potatoes, hot dogs, brats, tacos, nachos w/ cheese and meat, French fries, cooked or deep fried vegetables/fruit, cooked cheese curds, corn dogs, egg rolls, salads.

☒ Retail Items (snacks and beverages):

RETAIL items include, but are not limited to, ice cream/soft serve, lemonade, snow cones, coffee, espresso, cappuccino, tea, fruit juice, smoothies, candy, dispensed soda, fruit cups, bakery, cookies, kettle corn, cotton candy, funnel cakes, fritters, tortilla chips w/ cheese.

Will it be a convenience store? ☒ Yes ☐ No

A convenience store contains less than 5,000 square feet of retail space and has, as its primary business, the sale of basic food items and in addition, sells household products or is a filling station that sells basic food items and household products.

☐ Bed & Breakfast☐ Micro Market

All Applicants: Submit a menu or a list of food items that will be sold.

Will any wholesale business be done? ☒ No ☐ Yes If yes, what percentage of food sales will be wholesale?☐ Less than 25%☐ 25% or More AND:☐ Restaurant items (meals) will be sold – Complete this application and also contact DATCP.☐ NO restaurant items (meals) will be sold - Do NOT complete this application. Contact DATCP only.**SECTION 2 FOOD PROCESSING**Will any food processing be done? ☒ No ☐ Yes

Processing is defined as assembling, grinding, cutting, mixing, baking, coating, stuffing, packing, bottling, grilling, canning, extracting, fermenting, distilling, pickling, freezing, drying, smoking, or packaging.

SECTION 3 FOOD REQUIRING TEMPERATURE CONTROLWill any food that requires temperature control be sold? ☐ No ☒ Yes

(includes dairy products such as milk, cheese, and ice cream, fish, shellfish, meat, poultry)

If yes, list the types of food items: **ICE CREAM, MILK, MEAT, EGGS, FROZEN**

SECTION 4 DETAILS OF OPERATION

- Will you have seating on site for dining? ☒ No ☐ Yes
- Will you be doing any catering? ☒ No ☐ Yes
- Will you be doing any delivery? ☒ No ☐ Yes
- Will you have outdoor activities? ☒ No ☐ Yes - Check all that apply: ☐ Bar ☐ Cooking/Grilling ☐ Dining
- Will you have a drive thru window? ☒ No ☐ Yes - Are hours different from inside? ☐ No ☐ Yes
If Yes, provide drive thru hours: _____
- Will scales or barcode scanners be used? ☒ No ☐ Yes - You must also apply for a Weights & Measures License.

SECTION 5 ADDITIONAL SITES

Where will food be prepared and/or sold?

- ☒ At a single site ☐ At multiple sites: How many? _____ (for example, a hotel with several dining rooms or bars)

If multiple sites, attach a Food Dealer Additional Site Addendum (ccl-foodadd) for each additional site.

SECTION 6 CONSTRUCTION OR CHANGES

Are you planning any construction, remodeling or equipment changes?

- ☒ No If No, SKIP to Section 7
- ☐ Yes If Yes, check all that apply: ☐ New construction of a building ☐ Renovation or remodeling
☐ Construction changes to existing building ☐ Equipment changes only

Provide a brief description of the changes: _____

Start date: _____

Name, Address & Phone Number of Architect: _____

Name, Address & Phone Number of Contractor: _____

SECTION 7 ALCOHOL BEVERAGES

Are you applying for an alcohol beverage license?

- ☒ No If No, SKIP to Section 8
- ☐ Yes If YES, if your food license is approved prior to the alcohol license, when do you want the food license issued?
☐ Immediately ☐ At the same time as the alcohol license

SECTION 8 ACKNOWLEDGEMENTS & SIGNATURE

You must initial each item confirming your understanding:

- ls* I understand the Health Department must conduct an inspection and advise the License Division of their approval before the license may be issued.
- ls* I understand I must obtain an occupancy permit from the Department of Neighborhood Services and an inspection may be required. Neighborhood Services must advise the License Division of their approval before the license may be issued.
- ls* I understand the district alderperson will review and either support or object to my application. If he/she objects, I may appeal and be scheduled to appear before the Licenses Committee. The Licenses Committee will then make a recommendation to the Common Council. The Common Council must grant the license before it may be issued.
- ls* I understand proof of payment for all license fees must be on file in the License Division before the license may be issued and the license must be issued and posted in my establishment prior to opening for business.
- ls* I will not operate my food business until the license has been issued and posted in the establishment.

Signature of Sole Proprietor, Partner, or 20% Shareholder: _____

Signature of Additional Partner: _____



FILLING STATION LICENSE AND WEIGHTS & MEASURES (RETAIL PETROLEUM METERS) LICENSE SUPPLEMENTAL APPLICATION

OFFICE OF THE CITY CLERK, LICENSE DIVISION
 CITY HALL, 200 E. WELLS ST, ROOM 105, MILWAUKEE, WI 53202
 (414) 286-2238 • license@milwaukee.gov • www.milwaukee.gov/license

Legal Entity Name: **NORTH & H INC.**

Premise Address: **2237 N HOLTON ST, MILWAUKEE, WI-53212**

Filling Station License Fee \$ 275

Weights & Measures License Fee

Number of Retail Petroleum Meters* 7 x \$60 per meter = \$ 420

*For each nozzle, count the number of grades (not including midgrade if mixed in the pump), add the number of all grades together and that is your number of retail petroleum meters.

Will electronic scanners be used to determine/record the price of items?

☒ No ☐ Yes

Will scales be used to price items based on their weight?

☒ No ☐ Yes

If yes to either or both questions, a separate Weights & Measures License Application must be submitted for these devices.

Acknowledgements and Signature

I confirm that all information is true and correct. I understand any changes to the information in this application must be reported to the City Clerk License Division within 10 days. I have knowledge of the City of Milwaukee ordinances currently regulating the licenses applied for and understand that the licenses may be subject to suspension, non-renewal, or revocation if I violate these regulations.

 Signature of Sole Proprietor, Partner, or 20% or more Shareholder
 (If no 20% or more Shareholder, Corporate Officer must sign and provide title)

 Signature of Additional Partner or 20% or more Shareholder

Submit this form with the following:

- Business License Application
- Business Plan of Operation
- Floor plan
- License fees

Forms can be obtained online at www.milwaukee.gov/licenses

Office Use Only:

App#	_____	Filed	_____	Initials	_____
Paid	_____	MPD	_____	CC	_____
HD	_____	DNS	_____	Lic #	_____

80'

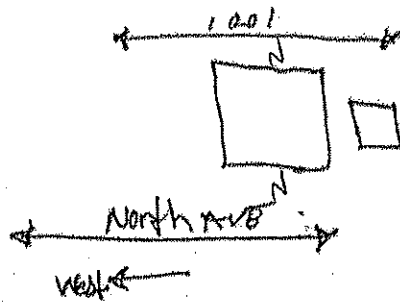
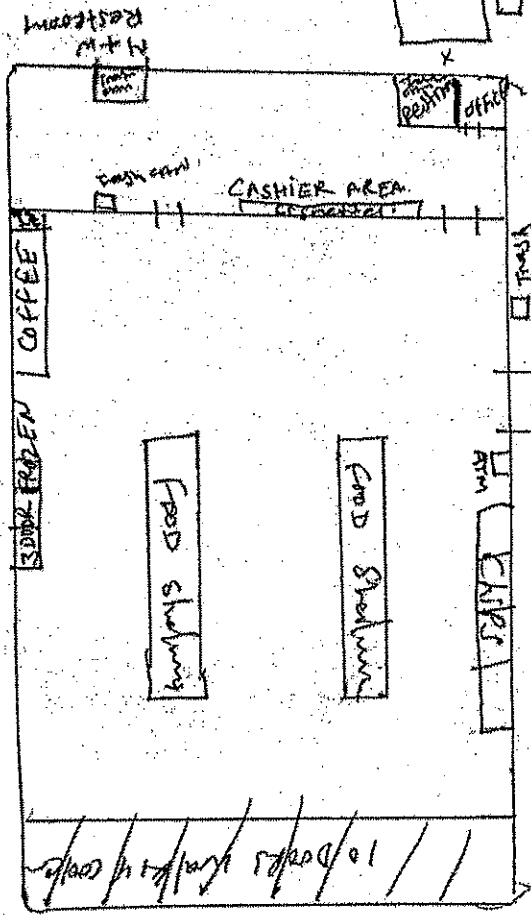

TOTAL 7 Pumps
4 TRASH CAN

N = Nozzle
TOTAL 59 feet
2000'

60'

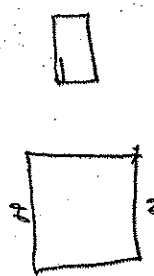
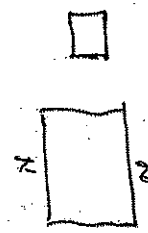

HOLTON STREET
→ North

50'

West

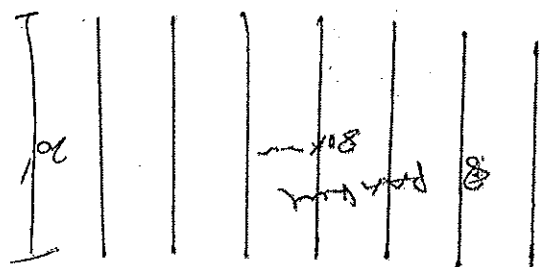

DATE 06/19/2014
Punit Jais WAL
Agent For North & W. Inc.
2237 N HOLTON STREET
MILWAUKEE WI 53212
PDA - Holton Gas & Food