



Certificate of Appropriateness

Milwaukee Historic Preservation Commission/841 N Broadway/Milwaukee, WI 53202/phone 414-286-5722

Property Description of work

1842 N. 2nd Street, Brewers Hill Historic District

Replace an existing wood fence with new dog ear white cedar privacy fence per the plan and scope of work below.

Date issued 8/20/2024

In accordance with the provisions of Section 320-21 (11) and (12) of the Milwaukee Code of Ordinances, the Milwaukee Historic Preservation Commission has issued a certificate of appropriateness for the work listed above. The work was found to be consistent with preservation guidelines. The following conditions apply to this certificate of appropriateness:

All wood must be smooth and equivalent to #1 grade cedar or better for use in rear and side yards. Sections of fence forward of or in line with the primary building's front setback must be clear grain. Wood fences must be painted or stained upon completion. Note: when new, bare wood is left exposed to the exterior elements for a period of only a week or two, the life of the finish subsequently applied to it will be decreased.

All work must be done in a craftsman-like manner. Staff must approve any changes or additions to this certificate before work begins. Work that is not completed in accordance with this certificate may be subject to correction orders or citations. If you require technical assistance, please contact Historic Preservation staff as follows: Phone: (414) 286-5722 E-mail: hpc@milwaukee.gov.

Permits and timeline

You are responsible for determining if permits are required and obtaining them prior to commencing work. Consult the Development Center on the web or by telephone for details: www.milwaukee.gov/lms - (414) 286-8210. If permits are not required, work must be completed within one year of the date this certificate was issued. If permits are required, permits must be obtained within one year of the date this certificate was issued.

City of Milwaukee Historic Preservation

Copies to: Development Center, Ald. Coggs

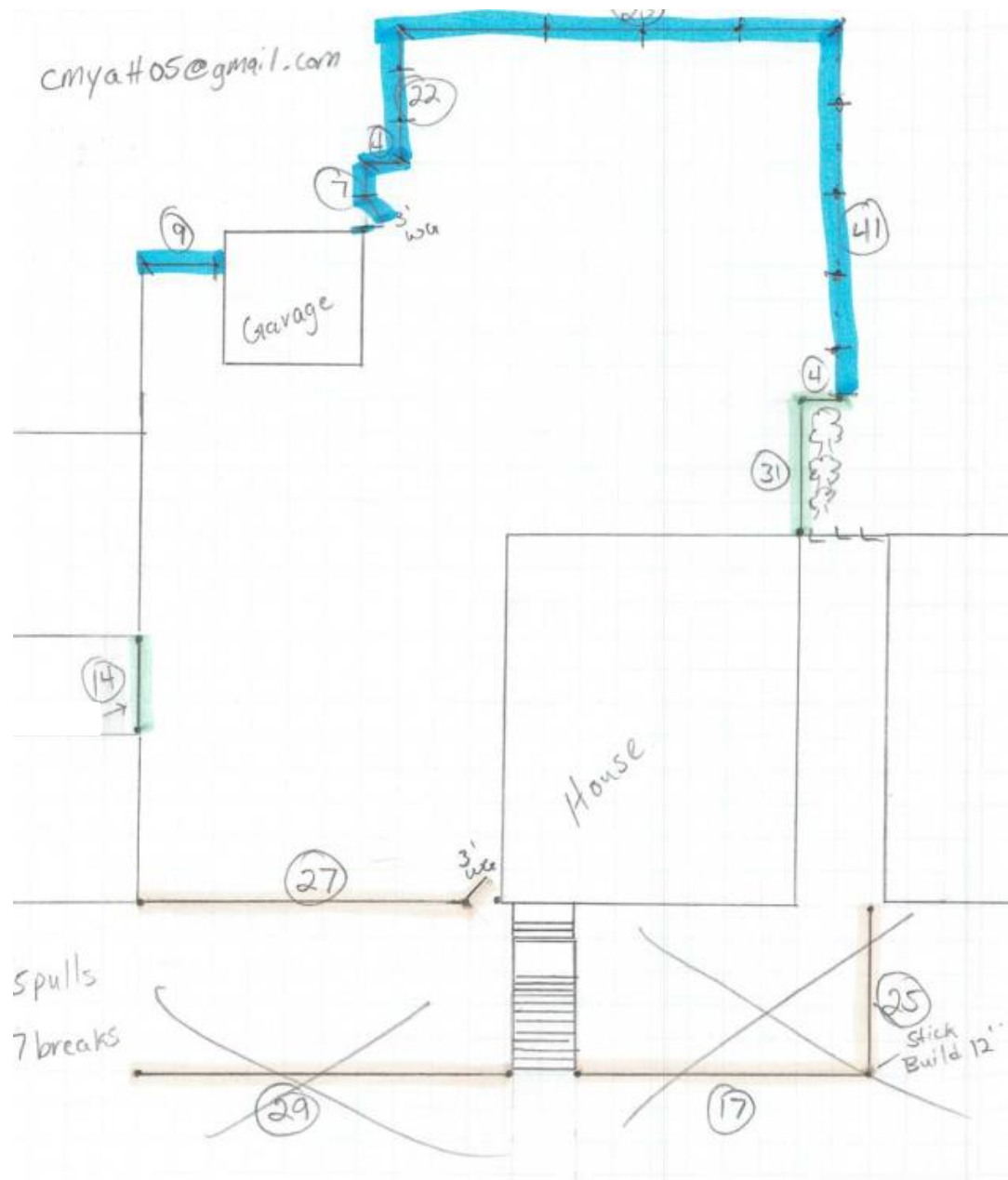

- Installation of:
- (108') 6' High White Cedar Dog Ear Privacy
 - (1) 3' Wide, 6' High Walk Gate.
 - (76) 4' High White Cedar Picket
 - (1) 3' Wide, 4' High Picket Walk Gate.
- Fence removal and disposal.

Plan and scope of work for new white cedar dog ear privacy fence.