

DCO # 2578

MILWAUKEE COUNTY CERTIFIED SURVEY MAP NO. _____

BEING A DIVISION OF LOTS 26, 27 AND 28 IN BLOCK 32 OF REEVE AND ROE'S SUBDIVISION LOCATED IN THE SOUTHEAST 1/4 OF THE NORTHEAST 1/4 OF SECTION 19, TOWN 7 NORTH, RANGE 22 EAST IN THE CITY OF MILWAUKEE, MILWAUKEE COUNTY, WISCONSIN.

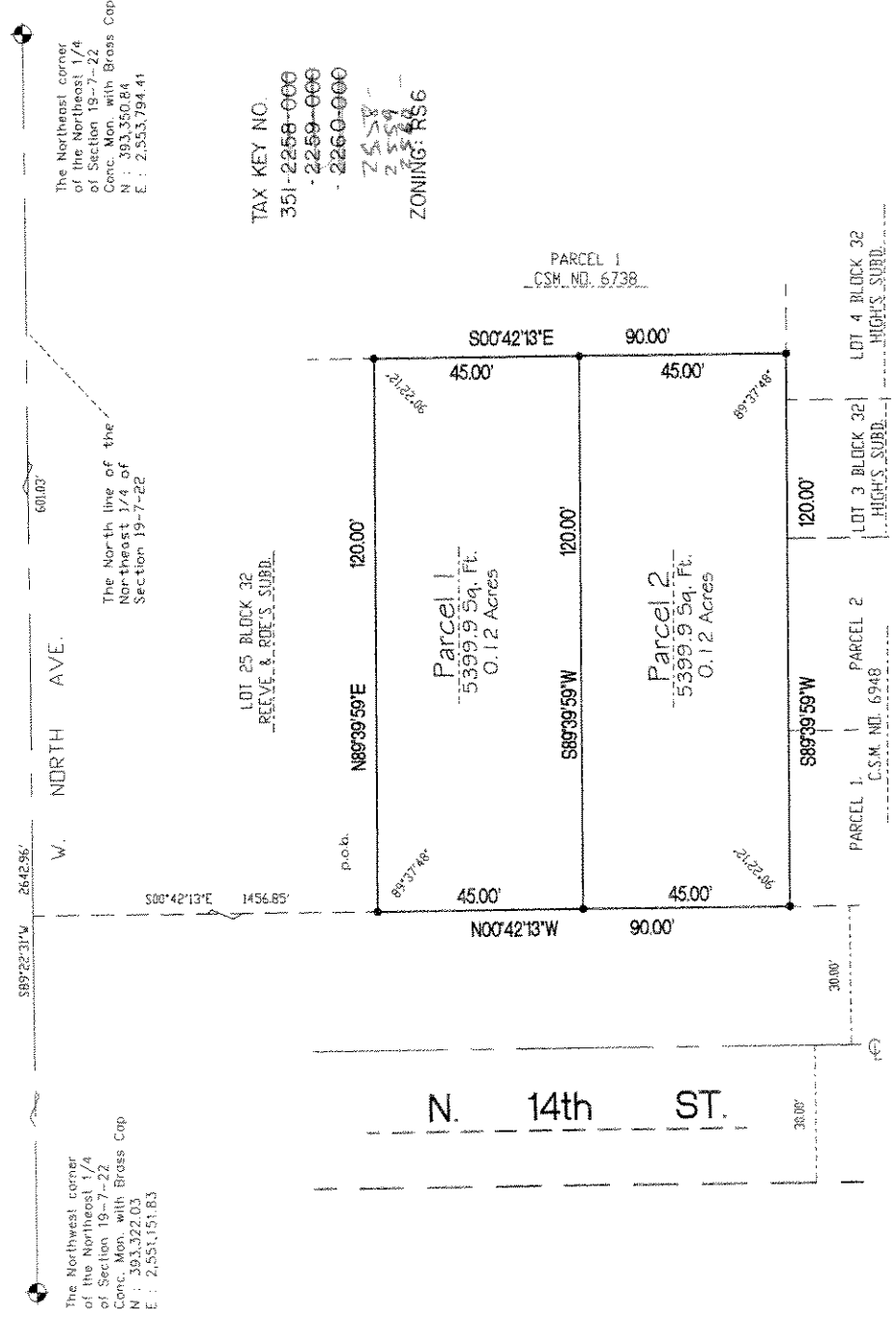

The Northwest corner
of the Northeast 1/4
of Section 19-7-22
Cont. Mon. with Brass Cap
N : 393.322.03
E : 2,551,151.83

The Northeast corner
of the Northeast 1/4
of Section 19-7-22
Cont. Mon. with Brass Cap
N : 393.350.84
E : 2,553,794.41

TAX KEY NO.
351-2258-0000
- 2259-0000
- 2260-0000
7558
7559
7560
ZONING: RS 6

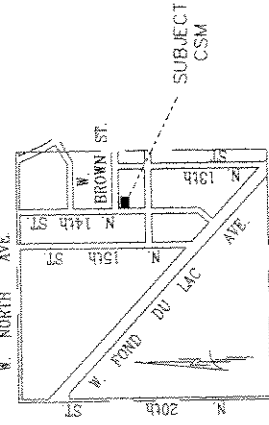

LOCATION SKETCH
NORTHEAST 1/4 SECTION 19-7-22
1" = 2000'



2554 N. 100th STREET
WAUWATOSA, WI. 53226
PHN 414-257-2212
FAX 414-257-2443

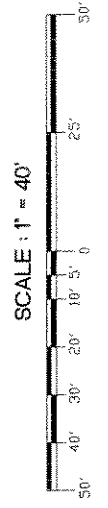

SCALE : 1" = 40'

• - DENOTES SET 3/4" X 18" LONG
IRON REBAR WEIGHING 15 LBS.
PER LINEAL FOOT.

ALL BEARINGS ARE REFERENCED TO
THE NORTH LINE OF THE NORTHEAST
1/4 OF SECTION 19-7-22, WHICH IS
ASSUMED TO BEAR S 89°22'31" W,
STATE PLANE COORDINATE SYSTEM
SOUTH ZONE JAN. 2005 DATUM.

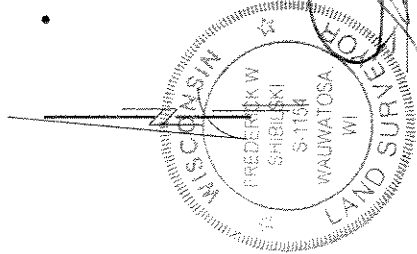

FREDERICK W. SHIBILSKI S - 1154

INFRASTRUCTURE
SERVICES DIVISION
Marcia Lindholm 9/11/06
CENTRAL DRAFTING & RECORDS MANAGER
ENGR. IN CHARGE ENVIRON. ENGR.
for *Timothy Dora* 9/8/06
W. Schmitt 9/12/06
CORRECT
CITY ENGINEER APPROVED

Doc# 2578

MILWAUKEE COUNTY CERTIFIED SURVEY MAP NO. _____

BEING A DIVISION OF LOTS 26, 27 AND 28 IN BLOCK 32 OF REEVE AND ROE'S SUBDIVISION LOCATED IN THE SOUTHEAST ¼ OF THE NORTHEAST ¼ OF SECTION 19, TOWN 7 NORTH, RANGE 22 EAST IN THE CITY OF MILWAUKEE, MILWAUKEE COUNTY, WISCONSIN.

SURVEYOR'S CERTIFICATE
STATE OF WISCONSIN)
MILWAUKEE COUNTY)SS

I, Frederick W. Shibilski, a registered land surveyor do hereby certify:

That I have surveyed, divided and mapped Lots 26, 27 and 28 in Block 32 of Reeve and Roe's Subdivision located in the Southeast ¼ of the Northeast ¼ of Section 19, Town 7 North, Range 22 East in the City of Milwaukee, Milwaukee County, Wisconsin, bounded and described as follows: Commencing at the Northeast corner of the Northeast ¼ of Section 19; thence South 89° 22' 31" West, along the North line of said ¼ Section, 601.03 feet; thence South 00° 42' 13" East, 1456.85 feet to the Northwest corner of Lot 26 and the point of beginning of the land to be described; thence North 89° 39' 59" East, 120.00 feet to the Northeast corner of Lot 26; thence South 00° 42' 13" East, 90.00 feet to the Southeast corner of Lot 28; thence South 89° 39' 59" West, 120.00 feet to the Southwest corner of Lot 28; thence North 00° 42' 13" West, 90.00 feet to the point of beginning.

That I have made such survey, land division and map by the direction of the City of Milwaukee, owner of said land.

That this map is a correct representation of all exterior boundaries of land surveyed and the land division thereof made.

That I have fully complied with the provisions of Chapter 236 of the Wisconsin Statutes and Chapter 119 of the Milwaukee Code in surveying, dividing and mapping the same.

Dated this 8th day of June 2006.

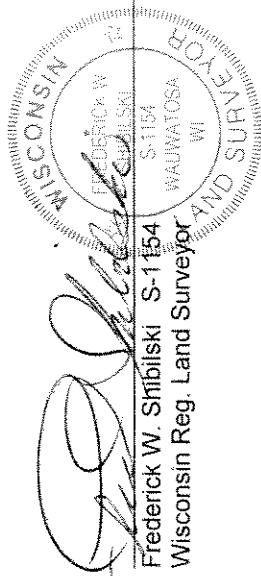

CORPORATE OWNERS CERTIFICATE:

The City of Milwaukee, a corporation duly organized and existing under and by virtue of the laws of the State of Wisconsin as owner, does hereby certify that said corporation caused the land described on this map to be surveyed, divided and mapped as represented on this map in accordance with the requirements of Chapter 119 of the Milwaukee Code of Ordinances.

In consideration of the approval of this map by the Common Council, and in accordance with Chapter 119 of the Milwaukee Code of Ordinances, the undersigned agrees:

- a. That all utility lines to provide electric power and telephone services and cable television or communications systems lines or cables to all parcels in the certified survey map shall be installed underground in easements provided therefor, where feasible.

This agreement shall be binding on the undersigned and assigns.

IN WITNESS WHEREOF, the said City of Milwaukee has caused these presents to be signed by Thomas Barrett, its Mayor and countersigned by Ronald D. Leonhardt, its City Clerk, at Milwaukee, Wisconsin, on this _____ day of _____, 2006.

In the Presence of:

William J. Karpen
Kathleen H. Mollica

The City of Milwaukee

Thomas Barrett
Thomas Barrett, Mayor
Ronald D. Leonhardt
Ronald D. Leonhardt, City Clerk

DCD#2578

MILWAUKEE COUNTY CERTIFIED SURVEY MAP NO. _____

BEING A DIVISION OF LOTS 26, 27 AND 28 IN BLOCK 32 OF REEVE AND ROE'S SUBDIVISION LOCATED IN THE SOUTHEAST ¼ OF THE NORTHEAST ¼ OF SECTION 19, TOWN 7 NORTH, RANGE 22 EAST IN THE CITY OF MILWAUKEE, MILWAUKEE COUNTY, WISCONSIN.

CORPORATE OWNERS CERTIFICATE (CONTINUED):

STATE OF WISCONSIN)
MILWAUKEE COUNTY)SS

Personally came before me this 20th day of October, 2006, the above named Thomas Barrett, Mayor of the above named Corporation, to me known to be the person who executed the foregoing instrument and to me known to be such Mayor of said Corporation and acknowledged that he executed the foregoing instrument as such officer as the deed of said Corporation by its authority.

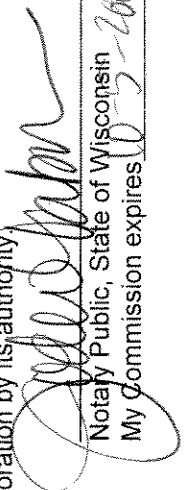

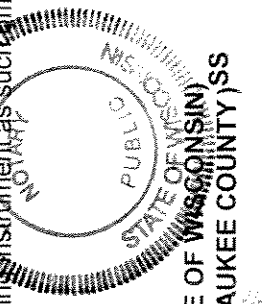
Notary Public, State of Wisconsin
My Commission expires 10-3-2008



STATE OF WISCONSIN)
MILWAUKEE COUNTY)SS

Personally came before me this 31st day of October, 2006, the above named Ronald D. Leonhardt, City Clerk, of the above named Corporation, to me known to be the person who executed the foregoing instrument and to me known to be such City Clerk of said Corporation and acknowledged that he executed the foregoing instrument as such officer as the deed of said Corporation by its authority.

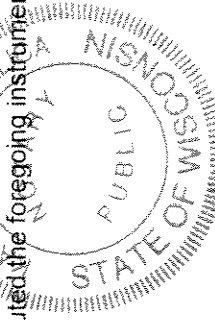
Notary Public, State of Wisconsin
My Commission expires 2-10-08



CERTIFICATE OF CITY TREASURER
STATE OF WISCONSIN)
MILWAUKEE COUNTY)SS

I, Wayne F. Whitlow, being the duly elected, qualified and acting City Treasurer of the City of Milwaukee, certify that in accordance with the records in the Office of the City Treasurer of the City of Milwaukee there are no unpaid taxes or unpaid special assessments on the land included in this Certified Survey Map.

Date: 10-16-06

Wayne F. Whitlow, City Treasurer

COMMON COUNCIL CERTIFICATE OF APPROVAL

I certify that this Certified Survey Map was approved under Resolution File No. 060821, adopted by the Common Council of the City of Milwaukee on October 24, 2006.

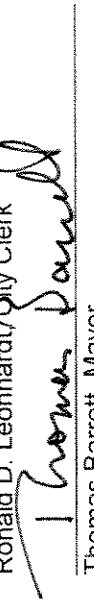
Ronald D. Leonhardt, City Clerk

Thomas Barrett, Mayor

