

06/18/22

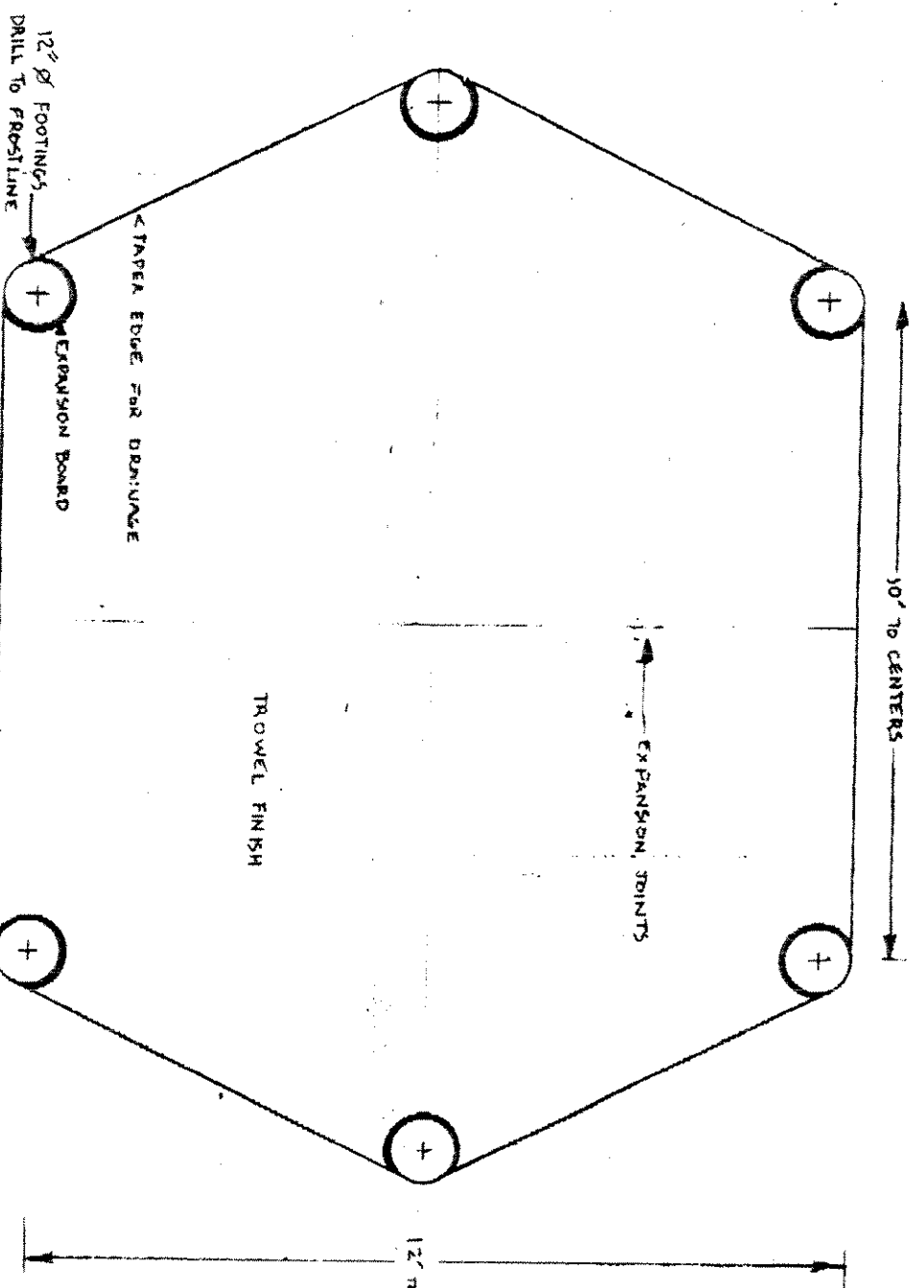

NOTE: FINISH SOIL FOR POSITIVE DRAINAGE

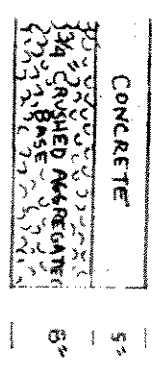

NOTE: REINFORCE W/ REBAR

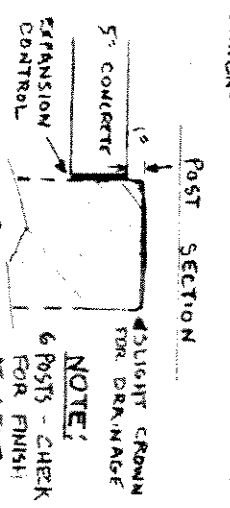

*P. Flannery*

### 8 BOULDERS AND A PAVILION FOR MERRILL PARK

Peter Flannery  
 21123 State Road 23  
 Mineral Point, WI 53565  
 PH & FX: 608 987 4601

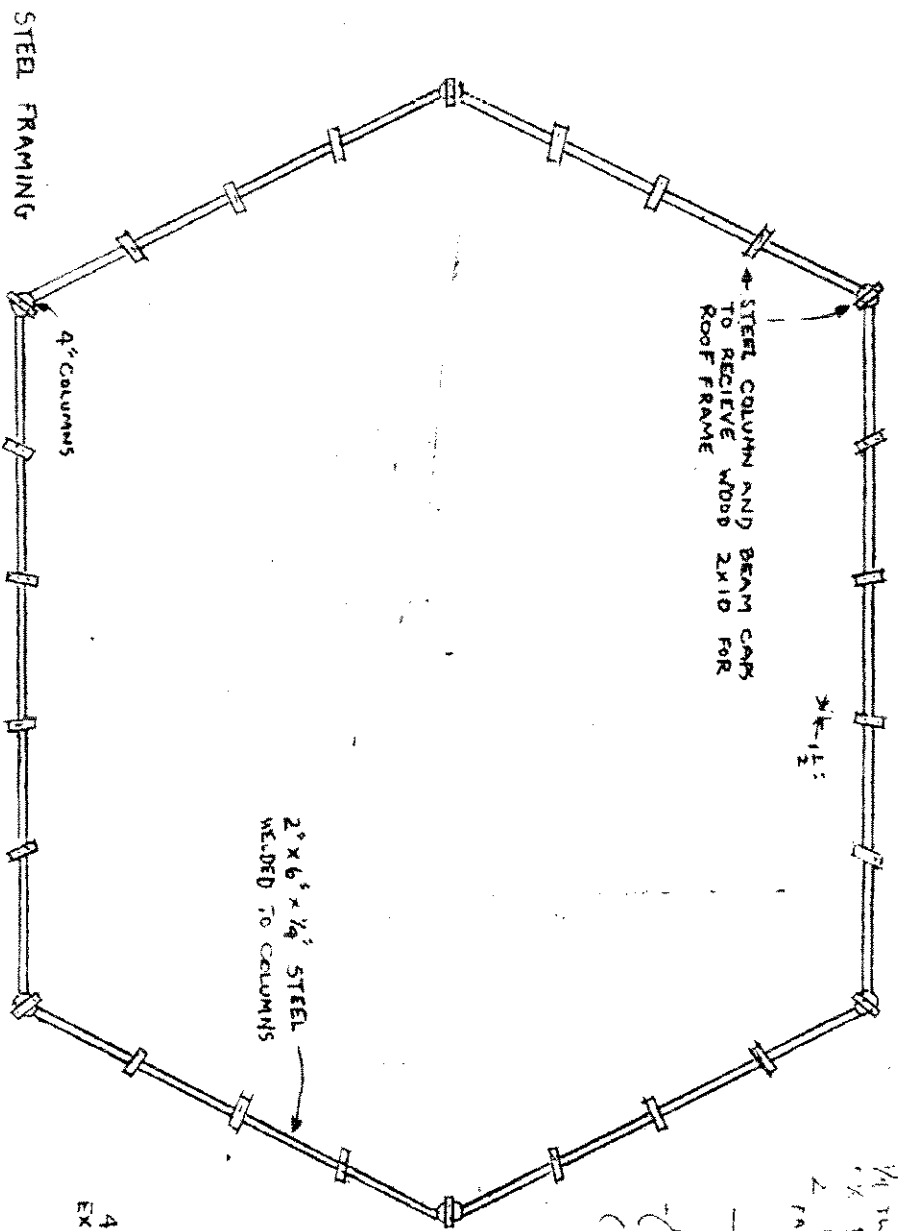

- BEAM + COLUMN CAPS ARE CONSTRUCTED OF 1/4" THICK STEEL X 1/2" DEPTH, 2 1/2" CHANNEL BEAMS FASTEN TO COLUMN

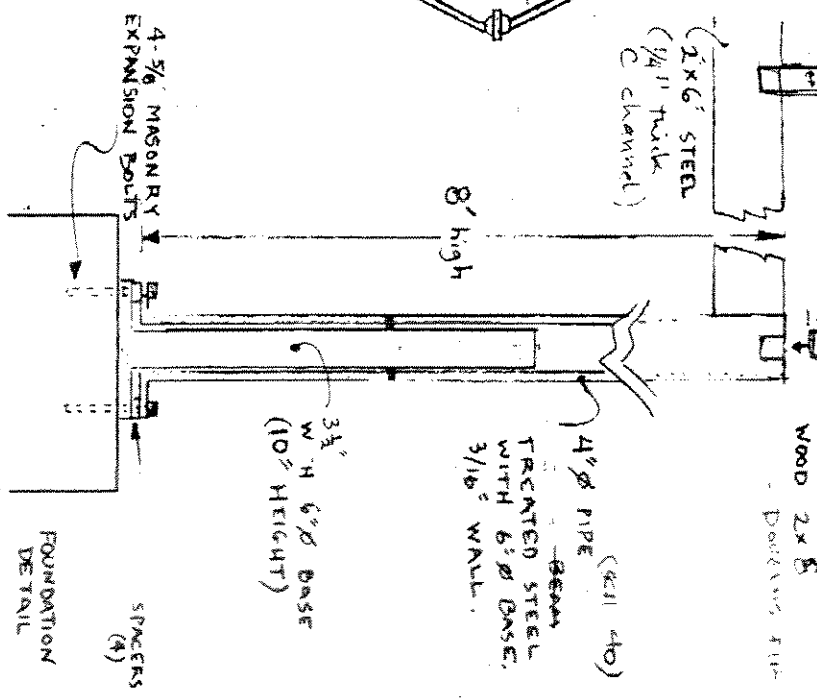

- BEAM CAP. WELD TO COLUMN ANGLE TO 1/10 ROOF SLOPE  
- DRILL FOR FASTENING WOOD 2x8  
- DOCKING FIT

BEAM TREATED STEEL WITH 60# BASE, 3/16" WALL.

3 1/2" x 6" BASE (10" HEIGHT)

*PF Drawing*

8 BOULDERS AND A PAVILION FOR MERRILL PARK

Peter Rankov  
21123 Stone Road 23  
Mineral Point, WI 53566  
Ph & FX: 608 987 4601

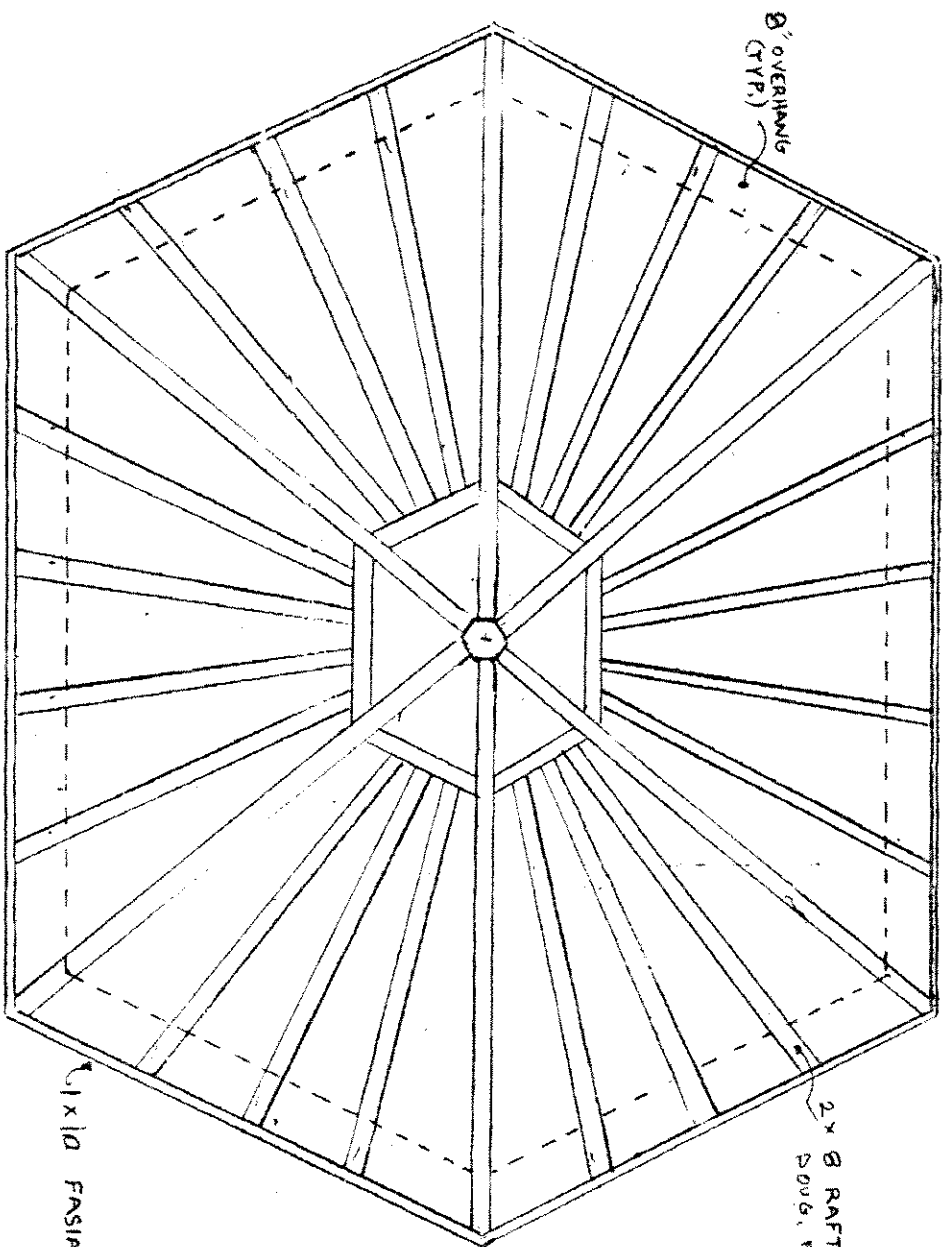

8 BOULDERS AND A PAVILION FOR MERRILL PARK

PFLANNERY

- NOTE: TEMPORARY SUPPORT OF KINGPIN IS NECESSARY UNTIL RAFTERS ARE PLACED.
- 1/2" ROOF SLOPE
  - ~ 265 SQ. FOOT OF SHINGLES AND PLYWOOD SHEETING.
  - ALL RAFTERS ARE 2" O.C. OR LESS.
  - COPPER SHINGLES

Peter Flannery  
 21123 State Road 23  
 Mineral Point, WI 53565  
 Ph 8. FX. 608 987 4601

Peter Flanary  
21123 State Road 23  
Mineral Point, WI 53565

Ph & FX: 608 987 4601

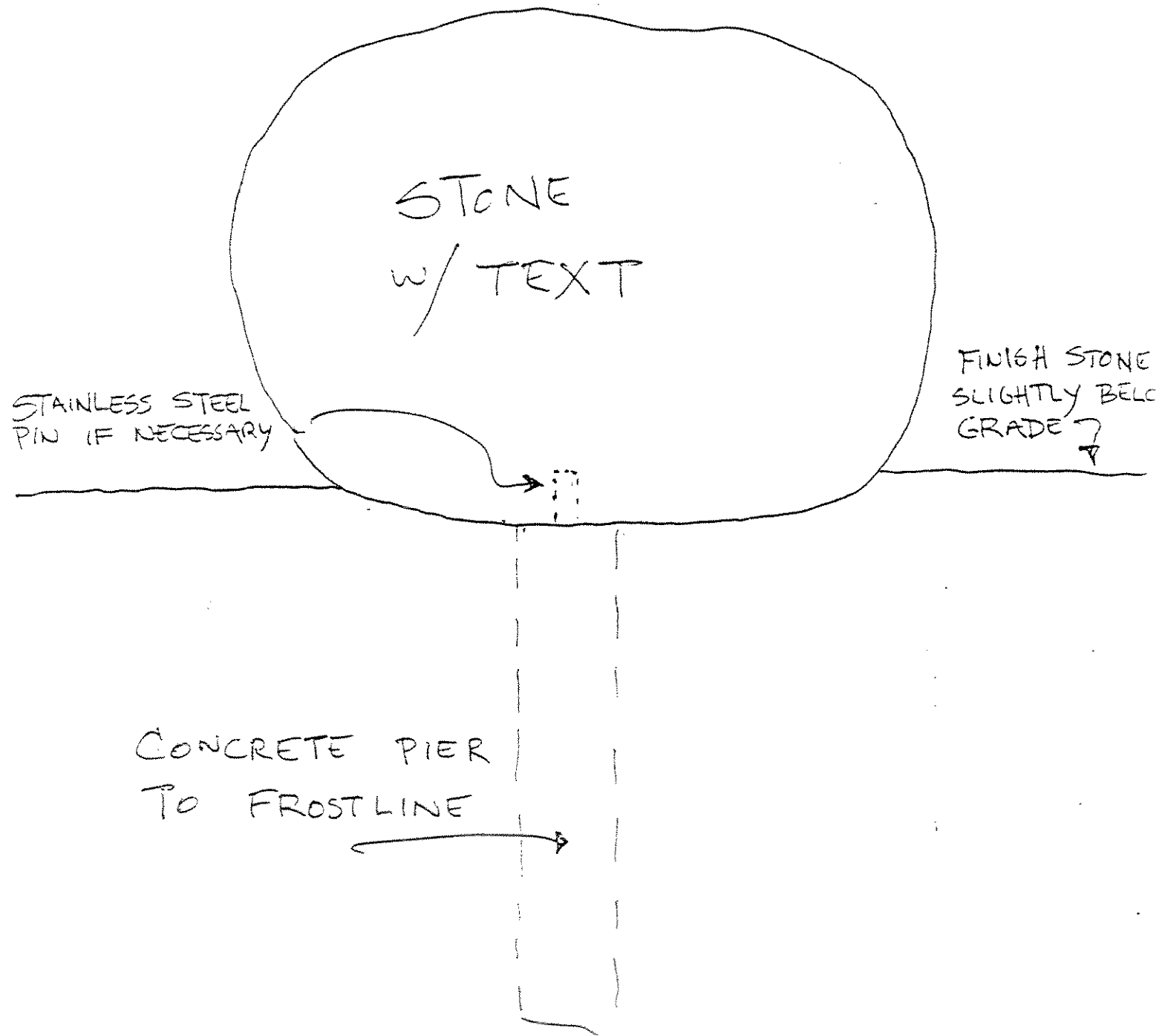

← BOULDERS AND A PAVILLION FOR  
MERRILL PARK

PFLANARY

