

CODE INFO:
 OCCUPANCY CLASS: ASSEMBLY A-2
 OCCUPANCY SEPARATION:
 - BETWEEN A-2 & B = 2 HR
 - BETWEEN A-2 & R = 2 HR
 FLOOR AREA: 2,904 SF
 MAX FLOOR AREA PER OCCUPANT: 15 NET
 (UNCONCENTRATED - TABLE & CHAIRS)
 MAX OCCUPANTS: 193

W. NORTH AVENUE

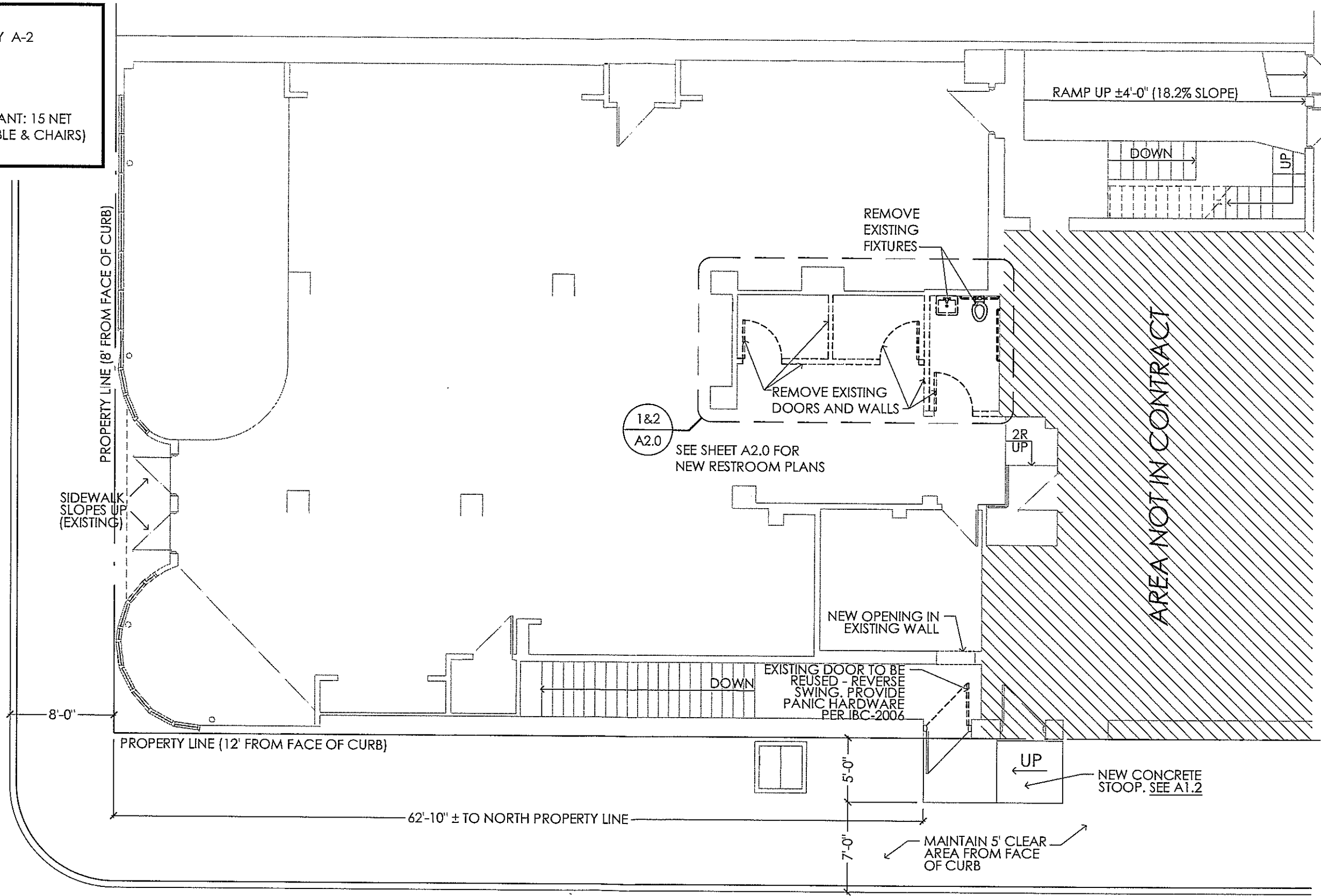

N. 39TH STREET

FLOOR PLAN - NEW CONSTRUCTION
 A1.1 SCALE: 1/8"=1'-0"

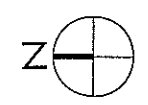

GENERAL NOTES:
 CONTRACTOR SHALL FIELD-VERIFY ALL DIMENSIONS AND CONDITIONS PRIOR TO CONSTRUCTION.
 PATCH AND REPAIR ALL WALLS, FLOORS, CONCRETE WALKS, CEILINGS AND OTHER SURFACES AS REQUIRED.

EMERALD HALL
 3829 west north avenue
 milwaukee wisconsin 53208

DATE: 09.02.2010
 REVISED: 09.24.2010
 SCALE: 1/8"=1'-0"

FLOOR PLAN - NEW CONSTRUCTION

A1.1

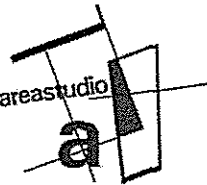

ARCHITECTURE
SPACE PLANNING
CONSTRUCTION MANAGEMENT
GRAPHIC DESIGN
RENDERINGS

PHONE: 414.628.4409
info@areastudio.biz
www.areastudio.biz

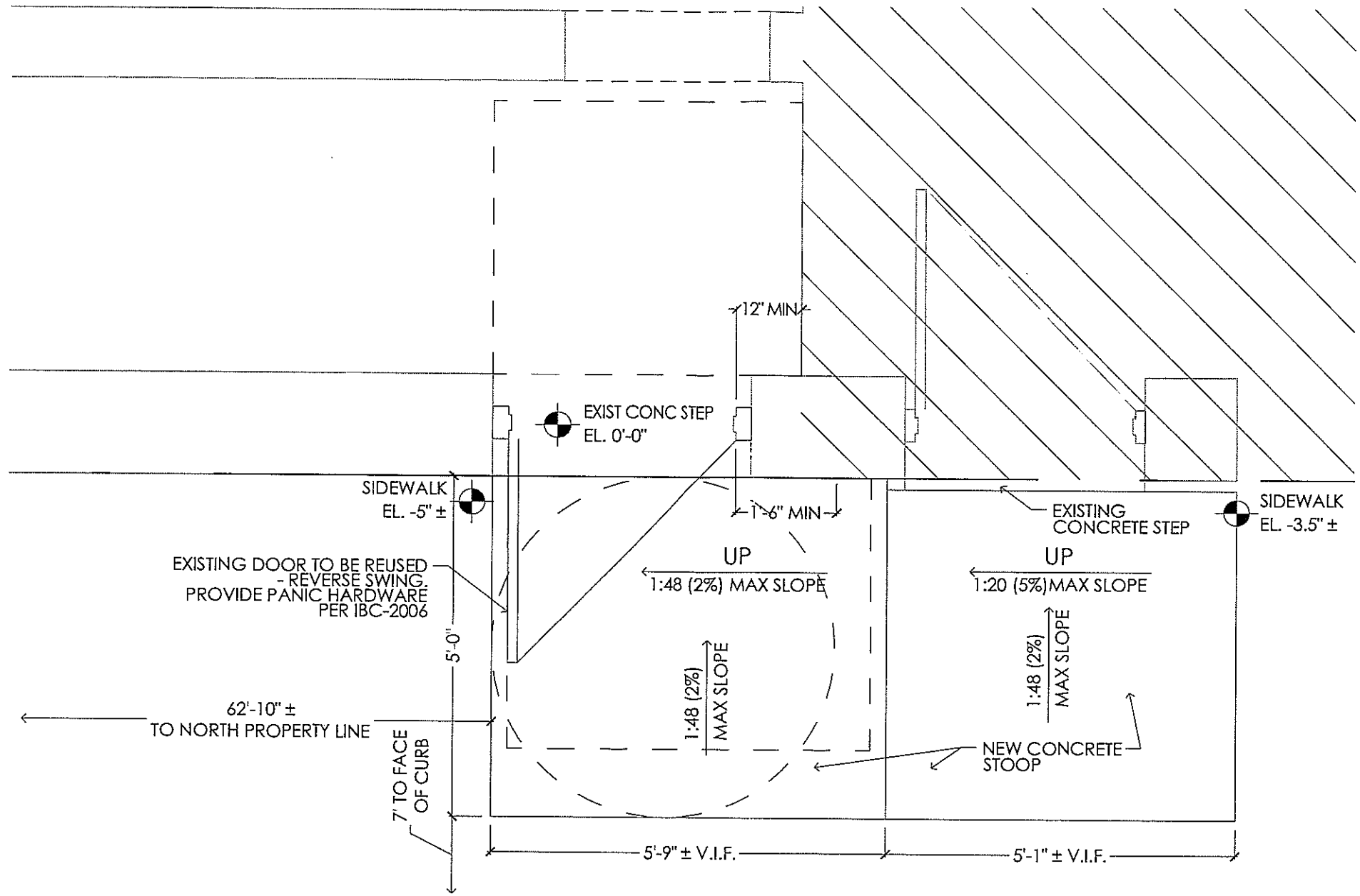

1
A1.2 **NEW STOOP - ENLARGED PLAN**
SCALE: 1/2"=1'-0"

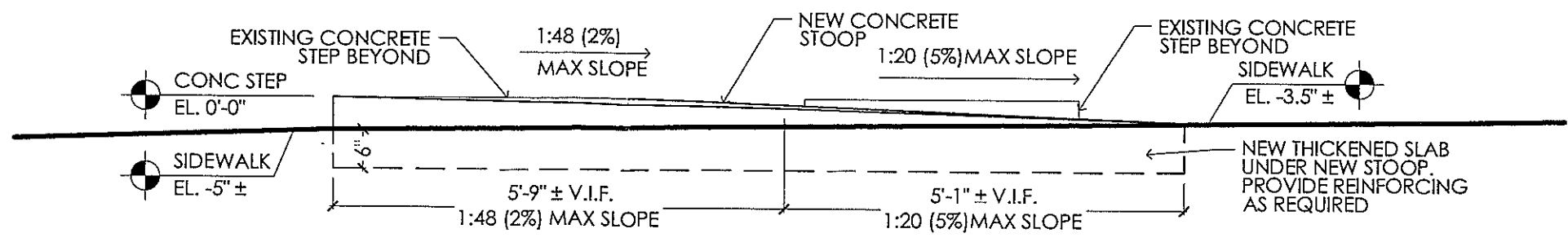

2
A1.2 **NEW STOOP - DIAGRAM**
SCALE: 1/2"=1'-0"

GENERAL NOTES:
CONTRACTOR SHALL FIELD-VERIFY ALL DIMENSIONS AND CONDITIONS PRIOR TO CONSTRUCTION.
PATCH AND REPAIR ALL WALLS, FLOORS, CONCRETE WALKS, CEILINGS AND OTHER SURFACES AS REQUIRED.
CONCRETE WALK ELEVATIONS ARE APPROXIMATE ONLY. CONTRACTOR TO FIELD VERIFY CONCRETE WALK ELEVATIONS AS REQUIRED FOR CONSTRUCTION
STOOP DESIGN, DIMENSIONS AND CONSTRUCTION TO COMPLY WITH ANSI A117.1 - 2003

EMERALD HALL
3829 west north avenue
milwaukee wisconsin 53208

DATE: 09.02.2010
REVISED: 09.24.2010
SCALE: 1/8" = 1'-0"

ENLARGED STOOP
PLAN AND DIAGRAM

A1 2

