

W. WISCONSIN AVENUE

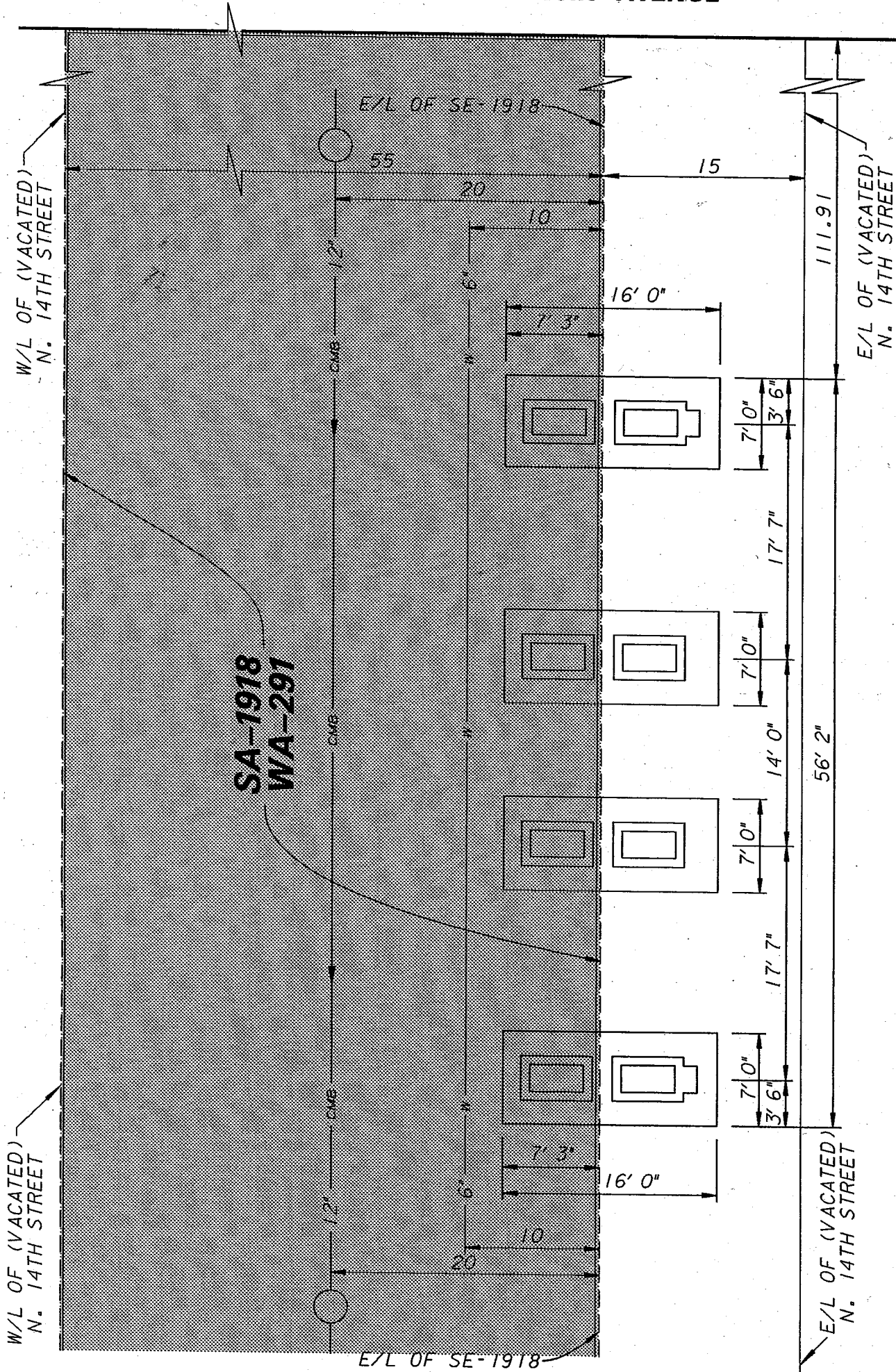

**SA-1918
WA-291**

ENVIRONMENTAL ENGINEERING SECTION		
INFRASTRUCTURE SERVICES DIVISION		
DEPARTMENT OF PUBLIC WORKS		
MILWAUKEE, WISCONSIN		
PLAN OF SEWER EASEMENT		
AREA IN	S.E. 1/4 SEC. 30, T. 7 N., R. 22 E.	
	(VACATED) N. 14TH STREET FROM W. CLYBOURN STREET	
	TO W. WISCONSIN AVENUE	
SCALE 1" = 100'	ATLAS PAGE NO. 399	EASE. NO. SA-1918 & WA-291
DRAWN BY KELLER	CHK'D. BY	W.O. NO.
APPROVED	<i>Matthew Legurski</i>	DATE 10/19/01
APPROVED		FILE NO. 151-4-63A