



CITY OF MILWAUKEE
OFFICE OF THE CITY CLERK

Thursday, September 02, 2021

COMMITTEE MEETING NOTICE

AD 04

KASHEVAROF, Robbin V, Agent
Valentine Coffee Roasters Third Ward LLC
5918 W Vliet St

Milwaukee, WI 53208

You are requested to attend a virtual hearing to be held on:

Monday, September 20, 2021 at 10:45 AM

Regarding: Your Class B Tavern, Food Dealer, and Sidewalk Dining License Applications as agent for "Valentine Coffee Roasters Third Ward LLC" for "Valentine Coffee" at 1815  Milwaukee St.

This meeting will be held via GoToMeeting. Please see the enclosed best practices document for further instructions. The access code is <https://global.gotomeeting.com/join/733111181>. If you wish to call in, please call +1 (646) 749-3122 and use Access Code: 733-111-181.

There is a possibility that your application may be denied for one or more of the following reasons: The recommendation of the committee regarding the application shall be based on evidence presented at the hearing. Per MCO 85-2.7-4, probative evidence concerning whether or not a new license should be granted may be presented on the following subjects: whether or not the applicant meets the municipal requirements, the appropriateness of the location and premises where the licensed premises is to be located and whether use of the premises for the purposes or activities permitted by the license would tend to facilitate a public or private nuisance or create undesirable neighborhood problems such as disorderly patrons, unreasonably loud noise, litter, and excessive traffic and parking congestion. Probative evidence relating to these matters may be taken from the plan of operation submitted with the license application, if any, but shall not include the content of any music. Evidence regarding the fitness of the location of the premises to be maintained as the principal place of business, including but not limited to whether there is an overconcentration of businesses of the type for which the license is sought; whether the proposal is consistent with any pertinent neighborhood business or development plans, or the location's proximity to areas where children are typically present. The applicant's record in operating similarly licensed premises; and whether or not the applicant has been charged with or convicted of any felony, misdemeanor, municipal offense or other offense, the circumstances of which substantially relate to the activity to be permitted by the license being applied for or any other factor which reasonably relates to the public health, safety or welfare may also be considered. See attached police report or correspondence.

Notice for applicants with warrants or unpaid fines: Proof of warrant satisfaction or payment of fines must be submitted at the hearing on the above date and time. Failure to comply with this requirement may result in a delay of the granting/denial of your application.

Failure to attend this meeting may result in the denial of your license. Individual applicants and partnership applicants must attend or attend by an attorney. The agent or attorney for corporate or limited liability applicants must attend. If you wish to do so and at your own expense, you may be accompanied by an attorney of your choosing to represent you at this hearing.

You will be given an opportunity to speak on behalf of the application and to respond and challenge any charges or reasons given for the denial. No petitions can be accepted by the committee, unless the people who signed the petition attend the virtual hearing and are willing to testify. You may present witnesses under oath and you may also confront and cross-examine opposing witnesses under oath. If you have difficulty with the English language, you should request an interpreter attend the meeting with you, at your expense, so that you can answer questions and participate in your hearing.

PLEASE NOTE: Upon reasonable notice, efforts will be made to accommodate the needs of disabled individuals through sign language interpreters or other auxiliary aids. For additional information or to request this service, contact the Council Services Division ADA Coordinator at (414) 286-2998, Fax - (414) 286-3456, TDD - (414) 286-2025.

JIM OWCZARSKI, CITY CLERK

BY: _____

Jim Cooney

License Division Manager

If you have questions regarding this meeting, please contact the staff assistant, Molly Kuether-Steele at (414) 286-2775 or molly.kuether-steele@milwaukee.gov.

200 E. Wells Street, Room 105, City Hall, Milwaukee, WI 53202. www.milwaukee.gov/license
Phone: (414) 286-2238 Fax: (414) 286-3057 Email Address: License@milwaukee.gov



CITY OF MILWAUKEE
OFFICE OF THE CITY CLERK

Thursday, September 02, 2021

COMMITTEE MEETING NOTICE

AD 04

KASHEVAROF, Robbin V, Agent
Valentine Coffee Roasters Third Ward LLC
244 Four Winds Court

Hartland, WI 53029

You are requested to attend a virtual hearing to be held on:

Monday, September 20, 2021 at 10:45 AM

Regarding: Your Class B Tavern, Food Dealer, and Sidewalk Dining License Applications as agent for "Valentine Coffee Roasters Third Ward LLC" for "Valentine Coffee" at 189 N Milwaukee St.

This meeting will be held via GoToMeeting. Please see the enclosed best practices document for further instructions. The access code is <https://global.gotomeeting.com/join/733111181>. If you wish to call in, please call +1 (646) 749-3122 and use Access Code: 733-111-181.

There is a possibility that your application may be denied for one or more of the following reasons: The recommendation of the committee regarding the application shall be based on evidence presented at the hearing. Per MCO 85-2.7-4, probative evidence concerning whether or not a new license should be granted may be presented on the following subjects: whether or not the applicant meets the municipal requirements, the appropriateness of the location and premises where the licensed premises is to be located and whether use of the premises for the purposes or activities permitted by the license would tend to facilitate a public or private nuisance or create undesirable neighborhood problems such as disorderly patrons, unreasonably loud noise, litter, and excessive traffic and parking congestion. Probative evidence relating to these matters may be taken from the plan of operation submitted with the license application, if any, but shall not include the content of any music. Evidence regarding the fitness of the location of the premises to be maintained as the principal place of business, including but not limited to whether there is an overconcentration of businesses of the type for which the license is sought; whether the proposal is consistent with any pertinent neighborhood business or development plans, or the location's proximity to areas where children are typically present. The applicant's record in operating similarly licensed premises; and whether or not the applicant has been charged with or convicted of any felony, misdemeanor, municipal offense or other offense, the circumstances of which substantially relate to the activity to be permitted by the license being applied for or any other factor which reasonably relates to the public health, safety or welfare may also be considered. See attached police report or correspondence.

Notice for applicants with warrants or unpaid fines:

Proof of warrant satisfaction or payment of fines must be submitted at the hearing on the above date and time. Failure to comply with this requirement may result in a delay of the granting/denial of your application.

Failure to attend this meeting may result in the denial of your license. Individual applicants and partnership applicants must attend or attend by an attorney. The agent or attorney for corporate or limited liability applicants must attend. If you wish to do so and at your own expense, you may be accompanied by an attorney of your choosing to represent you at this hearing.

You will be given an opportunity to speak on behalf of the application and to respond and challenge any charges or reasons given for the denial. No petitions can be accepted by the committee, unless the people who signed the petition attend the virtual hearing and are willing to testify. You may present witnesses under oath and you may also confront and cross-examine opposing witnesses under oath. If you have difficulty with the English language, you should request an interpreter attend the meeting with you, at your expense, so that you can answer questions and participate in your hearing.

PLEASE NOTE: Upon reasonable notice, efforts will be made to accommodate the needs of disabled individuals through sign language interpreters or other auxiliary aids. For additional information or to request this service, contact the Council Services Division ADA Coordinator at (414) 286-2998, Fax - (414) 286-3456, TDD - (414) 286-2025.

JIM OWCZARSKI, CITY CLERK

BY: _____

Jim Cooney

License Division Manager

If you have questions regarding this meeting, please contact the staff assistant, Molly Kuether-Steele at (414) 286-2775 or molly.kuether-steele@milwaukee.gov.

200 E. Wells Street, Room 105, City Hall, Milwaukee, WI 53202. www.milwaukee.gov/license
Phone: (414) 286-2238 Fax: (414) 286-3057 Email Address: License@milwaukee.gov

Date: 07/16/21
Officer: Xavier Benitez

City of Milwaukee Police Department
90-5-1.5 Crime Prevention Survey
Tavern Inspection

Name of Premise: Valentine Coffee Roasters
Address: 189 N. Milwaukee St
Phone:

Owner: Kashevarof, Robbin V.
Owner address: 244 Four Winds Ct.
City State Zip: Hartland WI 53029
Owner Phone: 414 732-6860
Owner email: robb@valentinecoffeeco.com

Licensee/Agent: Same
Home Address:
City State Zip:
Phone:
Email:

Preferred contact: by phone

Location currently open: YES NO

Projected open date: Fall 2021

Day's open: S M T W Th F SA ALL

Hours of Operation: Sun: 6am-10pm 24 hours Y N
Mon: 6am-10pm
Tue: 6am-10pm
Wed: 6am-10pm
Thu: 6am-10pm
Fri: 6am-10pm
Sat: 6am-10pm

Premise Type: Tavern/Bar
 Restaurant
 Other: Café/ Coffee Shop

Licenses currently held:

Alcohol: Yes No Class: #:
 Tobacco: Yes No #:
 Food: Yes No #:
 Extended Hours: Yes No #:
 Secondhand Dealer: Yes No Type: #:
 Other: Yes No Type: #:
 Other: Yes No Type: #:

Exterior Survey:

1. Is the area around the location clean? Yes No
2. What surrounds the location? (Check all the apply)
 - a. Park
 - b. School
 - c. Youth Center
 - d. Church
 - e. Tavern(s) If so, how many
 - f. Residential
 - g. Other businesses
 - h. Other:
3. Can you see from the outside of the location into the interior Yes No
4. Can you see the employees inside of the location from the outside Yes No
5. Are exterior windows free of signage Yes No
6. Is there a parking lot Yes No
7. Is the parking lot clean? Yes No
8. Off-Street parking Yes No
9. Is the parking lot well lit? Yes No
10. Valet Parking Yes No
 - a. Will this lot have a guard? Yes No
 - b. Will this lot have cameras? Yes No
11. Are there areas where a person could conceal themselves Yes No
12. Is there exterior lighting? Yes No. Does it appears to be adequate Yes No
13. Exterior Payphone? Yes No
14. Are there No Loitering Signs posted? Yes No
15. Are there exterior security cameras Yes No How Many:
16. Are the address numbers prominently displayed and easy to see Yes No

Camera Survey:

17. Does this location have security cameras? Yes No
18. Are they in working order? Yes No
19. What format are the cameras?
 - a. Color Yes No
 - b. Digital Yes No
 - c. Recorded Yes No
20. How long is footage stored for later viewing: 30 Days
21. Are there exterior cameras Yes No How many: 2
22. Are there interior cameras Yes No How many: 5
23. Do all employees know how to retrieve recorded digital images/footage? Yes No

24. Cameras located in parking lot Yes No How many

Interior Survey:

25. What is the planned capacity 49
26. What is the minimum number of employees That will be on premise 2
27. Is the storeowner willing to be a standing complainant regarding loitering? Yes No
a. If yes have them fill out the standing complaint form and give them two of the commercial signs Yes No
28. Is the interior of the location neat and clean? Yes No
29. Does an interior camera face the entrance/exit? Yes No
30. Is there a lockable area that separates employees from customers? Yes No
31. Are emergency and non-emergency numbers posted near the phone? Yes No
32. Does the owner know how to contact their police district directly? Yes No
a. Did you provide a district contact guide to the owner? Yes No

Security

33. How many security personnel are going to be employed: N/A
34. How ill they be deployed: Interior Exterior
35. What days will they be deployed Mon Tue Wed Thu Fri Sat Sun
36. Will the security be managed by business or contracted
37. Will they be armed Yes No
38. What type of security measures to be used:
Wanding/metal detector
ID Scanner
Dress Code
Cover Charge
Age restriction
Other

ADDITIONAL COMMENTS/RECOMMENDATIONS:

The location is a café/coffee shop that is in the process of being remolded. The agent stated that the business will have 5 cameras in the interior of the building. The building itself does have exterior cameras that the property owner maintains. The location will not be being using security personal in its daily operations.



City Concentration Map - 189 N Milwaukee St

Area of Interest (AOI) Information

Area : 21,862,585.72 ft²

Jul 8 2021 16:31:00 Central Daylight Time

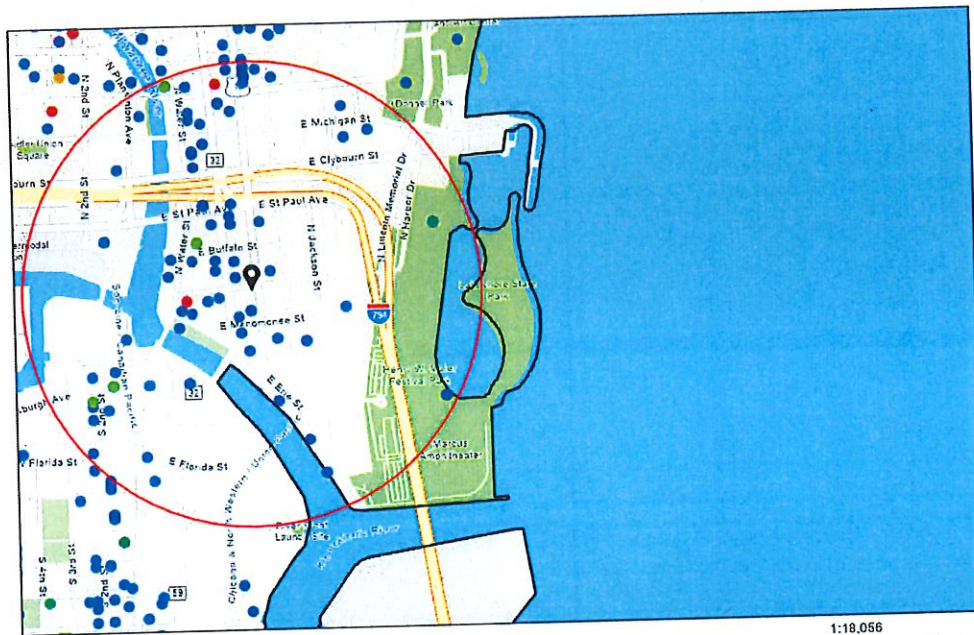

- Alcohol Licenses
 - Class A Fermented Malt Beverage
 - Class A Liquor and Malt
 - Class B Fermented Malt Beverage
 - Class B Tavern
 - Class C Wine Retailer
- City Limits

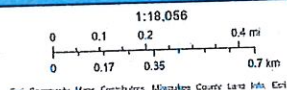

Summary

Name	Count	Area(ft ²)	Length(mi)
Alcohol Licenses	95		

Alcohol Licenses

#	Legal Entity	Trade Name	Licensee	Address	License Type Name	Total Capacity	Expiration Date	Count
1	JING'S CORPORATION	JING'S	JING WANG, Agt	207 E BUFFALO ST 168	Class B Fermented Malt Beverage Retailer's License	45	7/29/2021, 7:00 PM	1
2	DICK'S PIZZA, LLC	DICK'S	ADAM D KIRCHNER, Agt	730 N MILWAUKEE ST	Class B Tavern License	330	7/28/2021, 7:00 PM	1
3	MARCUS HOTELS HOSPITALITY, LLC	Pfister Hotel & Tower	Michael L Swasey, Agt	424 E WISCONSIN AV	Class B Tavern License	419	7/29/2021, 7:00 PM	1
4	HTWA - Catalano Square	HTWA - Catalano Square	MICHAEL GARDNER, Agt	138 N Broadway	Class B Tavern License		7/28/2021, 7:00 PM	1
5	DOS BONITAS, LLC	CUBANITAS	MARTA C BIANCHINI, Agt	728 N MILWAUKEE ST	Class B Tavern License	50	7/13/2021, 7:00 PM	1
6	Dan Dan LLC	Dan Dan	Daniel P Jacobs, Agt	360 E ERIE ST	Class B Tavern License	165	7/18/2021, 7:00 PM	1
7	JING'S CORPORATION	JING'S	JING WANG, Agt	207 E BUFFALO ST 168	Class C Wine Retailer's License	45	7/29/2021, 7:00 PM	1
8	Black Tuna LLC	Lucky Ginger	Soukvilay Sayavongsa, Agt	221 N Water ST	Class B Tavern License		8/15/2021, 7:00 PM	1
9	INDULGE WINE ROOMS, LLC	INDULGE	MARC R BIANCHINI, Agt	708 N MILWAUKEE ST	Class B Tavern License	60	8/12/2021, 7:00 PM	1
10	Grand Royale LLC	Fauntleroy	Daniel P Jacobs, Agt	316 N MILWAUKEE ST	Class B Tavern License		7/15/2021, 7:00 PM	1
11	Merriment Social LLC	Merriment Social	Andrew H Miller, Agt	240 E Pittsburgh AV	Class B Tavern License		7/30/2021, 7:00 PM	1
12	Indulgence Chocolatiers LLC	Indulgence Chocolatiers	Julie A Waterman, Agt	211 S 2nd ST	Class B Tavern License		9/22/2021, 7:00 PM	1
13	Woori Corp	Kanpai	Jongsoo Kim, Agt	408 E Chicago ST	Class B Tavern License	99	9/3/2021, 7:00 PM	1
14	Red Elephant LLC	Nicole's Third Ward Social	JACOB E DEHNE, Agt	333 N Broadway	Class B Tavern License		9/8/2021, 7:00 PM	1
15	BARTOLOTTA CATERING - PIER WI LLC	BARTOLOTTA CATERING - PIER WI	JOHN M WISE, Agt	500 N HARBOR DR	Class B Tavern License	250	9/21/2021, 7:00 PM	1
16	BARTOLOTTA CATERING - GRAIN EXCHANGE LLC	BARTOLOTTA CATERING - GRAIN EXCHANGE LLC	JOHN M WISE, Agt	225 E MICHIGAN ST	Class B Tavern License	299	9/21/2021, 7:00 PM	1
17	BRG 777 E Wisconsin LLC	Downtown Kitchen	JOHN M WISE, Agt	777 E WISCONSIN AV	Class B Tavern License	483	9/21/2021, 7:00 PM	1

18	BRG ICC LLC	Bartolotta Catering & Events at the Italian Community Center	JOHN M WISE, Agt	631 E Chicago ST	Class B Tavern License	598	9/21/2021, 7:00 PM	1
19	SRW ACQUISITION, LLC	HARBOR HOUSE	JOHN M WISE, Agt	550 N HARBOR DR	Class B Tavern License	250	9/21/2021, 7:00 PM	1
20	SINCERESWAN, LLC	SWINGIN DOOR EXCHANGE	MICHELLE M SINCERE, Agt	219 E MICHIGAN ST	Class B Tavern License	80	10/10/2021, 7:00 PM	1
21	Sweet Diner LLC	Sweet Diner	George S Prassas, Agt	239 E Chicago ST 103	Class B Tavern License		10/14/2021, 7:00 PM	1
22	Drury Hotels Company, LLC	Drury Plaza Hotel - Milwaukee Downtown	Chris Palid, Agt	700 N Water ST	Class B Tavern License		10/2/2021, 7:00 PM	1
23	Rosko Thomas Enterprises, LLC	Press Au Marche	Aaron Rosko, Agt	207 E Buffalo ST 104	Class B Tavern License		10/9/2021, 7:00 PM	1
24	The Explorium Brewpub Third Ward LLC	The Explorium Brewpub	Michael P Doble, Agt	143 W ST PAUL AV	Class B Tavern License		9/20/2021, 7:00 PM	1
25	ST. PAUL SEAFOOD, LLC	ST. PAUL FISH CO.	TIMOTHY G COLLINS, Agt	400 N WATER ST	Class B Tavern License		9/20/2021, 7:00 PM	1
26	GROOM FOR MEN, INC	Groom for Men / Groom Lounge	Terri J DeJoode, Agt	330 E ST PAUL AV	Class B Tavern License		11/1/2021, 7:00 PM	1
27	Shake Shack Wisconsin LLC	Shake Shack	ARI B DOMNITZ, Agt	220 E Buffalo ST 110	Class B Fermented Malt Beverage Retailer's License		11/26/2021, 6:00 PM	1
28	CSM Milwaukee Downtown LLC	Residence Inn - Milwaukee	Dustin A Woyak, Agt	101 W Wisconsin AV 3	Class B Tavern License		11/2/2021, 7:00 PM	1
29	Button Block Holdings LLC	Homewood Suites Hotel	Tammy L.C. Fraley, Agt	500 N Water ST	Class B Tavern License		11/18/2021, 6:00 PM	1
30	The Brownstone LLC	The Brownstone	COREY L SMITH, Agt	524 N Water ST	Class B Tavern License		11/27/2021, 6:00 PM	1
31	Shake Shack Wisconsin LLC	Shake Shack	ARI B DOMNITZ, Agt	220 E Buffalo ST 110	Class C Wine Retailer's License		11/26/2021, 6:00 PM	1
32	Integrated Plankinton Milwaukee LLC	Cambria Milwaukee Downtown	Tara-L Wurtz, Agt	503 N Plankinton AV	Class B Tavern License		11/2/2021, 7:00 PM	1
33	CIRCLE K LLC	CIRCLE K PANTRY	ZIAD W KAID, Agt	130 N WATER ST	Class A Malt & Class A Liquor License		12/9/2021, 6:00 PM	1
34	Full of Beans LLC	Full of Beans Cafe	JoAnn R Hausknecht, Agt	184 S 2nd ST	Class B Fermented Malt Beverage Retailer's License		12/16/2021, 6:00 PM	1

35	TwoBirds LLC	Filament	Tyler T Curran, Agt	131 W SEEBOTH ST	Class B Tavern License		12/15/2021, 6:00 PM	1
36	CARNAL LLC	CLUB CHARLIES	CRAIG M BLOOMFIELD, Agt	320 E MENOMONEE ST	Class B Tavern License	128	12/14/2021, 6:00 PM	1
37	VINO THIRD WARD, LLC	VINO THIRD WARD	Julle L Peck, Agt	102C N WATER ST	Class B Tavern License	41	11/22/2021, 6:00 PM	1
38	MKE Water Street LLC	ELMNT Lounge	HABIB MANJEE, Agt	618 N WATER ST	Class B Tavern License		12/17/2021, 6:00 PM	1
39	The Xenia Group, LLC	Tied House	Ralph A Weber, Agt	124 N Water ST	Class B Tavern License		12/17/2021, 6:00 PM	1
40	Full of Beans LLC	Full of Beans Cafe	JoAnn R Hausknecht, Agt	184 S 2nd ST	Class C Wine Retailer's License		12/16/2021, 6:00 PM	1
41	NACAR LLC	Riverfront Pizzeria Bar & Grill	ARTURO NAPOLES CARRERA, Agt	509 E ERIE ST	Class B Tavern License	300	12/15/2021, 6:00 PM	1
42	Tua Pasta LLC	Tua Pasta	Alvaro Nino de Guzman Ramirez, Agt	100 E WISCONSIN AV LL101	Class B Fermented Malt Beverage Retailer's License		12/28/2021, 6:00 PM	1
43	Bowls LLC	Bowls	Andrew C Larson, Agt	207 W Freshwater WA	Class B Fermented Malt Beverage Retailer's License		12/3/2021, 6:00 PM	1
44	3CP LLC	Third Coast Provisions	Andrew H Miller, Agt	724 N Milwaukee ST	Class B Tavern License		1/19/2022, 6:00 PM	1
45	Carnivoras Inc	Carnevor	Joseph McLean, Agt	718 N Milwaukee ST	Class B Tavern License	99	1/25/2022, 6:00 PM	1
46	ALEM ETHIOPIAN RESTAURANT, LLC	ALEM ETHIOPIAN VILLAGE	MULU H HABTESILAS SIE, Agt	307 E WISCONSIN AV	Class B Tavern License	98	12/24/2021, 6:00 PM	1
47	COMPROV, INC	COMEDY SPORTZ	JOSHUA M LEFEVRE, Agt	420 S 1ST ST	Class B Tavern License	320	1/15/2022, 6:00 PM	1
48	Tua Pasta LLC	Tua Pasta	Alvaro Nino de Guzman Ramirez, Agt	100 E WISCONSIN AV LL101	Class C Wine Retailer's License		12/28/2021, 6:00 PM	1
49	Bowls LLC	Bowls	Andrew C Larson, Agt	207 W Freshwater WA	Class C Wine Retailer's License		12/3/2021, 6:00 PM	1
50	APARTMENT 720, LLC	APARTMENT 720	Tony T Skoufis, Agt	720 N MILWAUKEE ST	Class B Tavern License	299	1/24/2022, 6:00 PM	1
51	Joy DB LLC	DryBar	Joy N Vertz, Agt	241 N BROADWAY	Class B Tavern License	60	1/30/2022, 6:00 PM	1
52	ANACORP LLC	Cavas	Ana C Docta, Agt	401 E ERIE ST	Class B Tavern License		1/22/2022, 6:00 PM	1

53	Smoke Shack Mke, LLC	Smoke Shack	David J Marcus, Agt	332 N Milwaukee ST	Class B Tavern License	91	2/6/2022, 6:00 PM	1
54	Onesto MKE, LLC	Onesto	David J Marcus, Agt	221-223 N Broadway	Class B Tavern License	288	2/6/2022, 6:00 PM	1
55	Blue Bat Kitchen MKE, LLC	Blue Bat Kitchen	David J Marcus, Agt	249 N WATER ST	Class B Tavern License	240	2/6/2022, 6:00 PM	1
56	Camp Bar Inc	Campsite 131	Paul C Hackbarth, Agt	131 N Jackson ST	Class B Tavern License		2/9/2022, 6:00 PM	1
57	Indulge Wine Rooms LLC	Indulge Wine Room	MARC R BIANCHINI, Agt	158 N Broadway	Class B Tavern License	156	1/16/2022, 6:00 PM	1
58	THE WICKED HOP, LLC	THE WICKED HOP	MILES E O'NEIL, Agt	343-45 N BROADWAY	Class B Tavern License	160	2/28/2022, 6:00 PM	1
59	Foot Paw LLC	Amilinda	Gregory R Leon, Agt	315 E Wisconsin AV	Class B Tavern License		3/2/2022, 6:00 PM	1
60	Camp Bar Inc	Camp Bar	Paul C Hackbarth, Agt	525 E Menomonee ST	Class B Tavern License		3/27/2022, 7:00 PM	1
61	S&S Hospitality Concepts, LLC	Black Sheep	MICHAEL R SORGE, Agt	216 S 2nd ST	Class B Tavern License	160	1/19/2022, 6:00 PM	1
62	Gordo's Water Street, LLC	Toast	Gordon Goggin, Agt	231 S 2nd ST	Class B Tavern License	99	2/28/2022, 6:00 PM	1
63	CIELITO LINDO, LLC	CIELITO LINDO	LORENZO R LOPEZ, Agt	733-39 S 2ND ST	Class B Tavern License	198	3/3/2022, 6:00 PM	1
64	Charro Latino, LLC	The Garden/Lucid	SEAN A PLISS, Agt	725-729 N Milwaukee ST	Class B Tavern License	490	3/21/2022, 7:00 PM	1
65	Saz's Festival LLC	Saz's Dockside BBQ	Stephanie L Sazama-Schneck, Agt	200 N HARBOR DR	Class B Tavern License		4/4/2022, 7:00 PM	1
66	MWF, LLC	SUMMERFEST	MICHAEL H WHITE, Agt	100 N HARBOR DR	Class B Tavern License		4/11/2022, 7:00 PM	1
67	BRUNCH MKE LLC	BRUNCH	Morgan K Schnabl, Agt	714 N MILWAUKEE ST	Class B Tavern License	160	4/15/2022, 7:00 PM	1
68	Steakhouse Milwaukee LLC	Rare Steakhouse	Mark D Burish, Agt	833 E MICHIGAN ST	Class B Tavern License		4/16/2022, 7:00 PM	1
69	SBB of Milwaukee Inc.	Stack'D Burger Bar	TREVOR M DANIELSEN, Agt	170 S 1st ST	Class B Tavern License		3/30/2022, 7:00 PM	1
70	Higbee's MKE LLC	District IV	PATSY SMITH-JAMES, Agt	628 N Water ST	Class B Tavern License	225	4/13/2022, 7:00 PM	1
71	Jay Squared LLC	The Box	Jamie A Berger, Agt	311 E Wisconsin AV	Class B Tavern License	270	4/11/2022, 7:00 PM	1
72	goRI Food Entertainment Inc	Char'd	Jongsoo Kim, Agt	222 E Erie ST 100	Class B Tavern License		5/9/2022, 7:00 PM	1

73	Hungry Sailor, Inc	Milwaukee Sail Loft	JEFFREY G REINBOLD, Agt	649 E Erie ST	Class B Tavern License	300	4/11/2022, 7:00 PM	1
74	Kipper LLC	Fore Milwaukee	Timothy M Grogan, Agt	530 N Water ST	Class B Tavern License		4/11/2022, 7:00 PM	1
75	Olive Tree LLC	Convenience +	Jamal T Shawar, Agt	308 E Wisconsin AV	Class A Malt & Class A Liquor License		5/19/2022, 7:00 PM	1
76	Mader's German Restaurant, Inc	Klement's Sausage Garden	DANIEL J HAZARD, Agt	200 N Harbor DR	Class B Fermented Malt Beverage Retailer's License		5/13/2022, 7:00 PM	1
77	The North/South Club, Inc	North South Club	Marla R Poytinger, Agt	175 S Water ST	Class B Tavern License	299	5/30/2022, 7:00 PM	1
78	HY-VEE, INC.	Wahlburgers	Ross Grunwald, Agt	322 N BROADWAY 100	Class B Tavern License		5/2/2022, 7:00 PM	1
79	Memento LLC	Bavette	Karen E Bell, Agt	330 E Menomonee ST	Class B Tavern License		5/19/2022, 7:00 PM	1
80	Milwaukee Artist Resource Network Inc	Milwaukee Artist Resource Network	Malaquias E Montoya, Agt	191 N Broadway 102	Class B Tavern License	150	5/15/2022, 7:00 PM	1
81	Pritzlaff Events LLC	Pritzlaff / Aperitivo	Kendall G Breuntig, Agt	311-333 N Plankinton AV	Class B Tavern License	915	5/20/2022, 7:00 PM	1
82	JSWD Wisconsin Venture I LLC	The Westin Milwaukee	Keith A Filipak, Agt	550 N Van Buren ST	Class B Tavern License		5/22/2022, 7:00 PM	1
83	Saz's Festival LLC	Summerfest - Corkscrew	Stephanie L Sazama-Schneck, Agt	200 N HARBOR DR Area F	Class B Tavern License		6/18/2022, 7:00 PM	1
84	Saz's Festival LLC	Summerfest - Corkscrew	Stephanie L Sazama-Schneck, Agt	200 N HARBOR DR Area G	Class B Tavern License		6/18/2022, 7:00 PM	1
85	MC ZAR'S, LLC	O'Lydia's Bar & Grill	Linda M Sackett, Agt	338 S 1ST ST	Class B Tavern License	150	6/4/2022, 7:00 PM	1
86	Foltz Family Market, Inc	Foltz Family Market	Casey C Foltz, Agt	400 N WATER ST 6	Class B Tavern License		5/29/2022, 7:00 PM	1
87	HTWA MARKET PROJECT, LLC	MILWAUKEE PUBLIC MARKET	MICHAEL GARDNER, Agt	400 N WATER ST	Class B Tavern License	320	5/28/2022, 7:00 PM	1
88	Kimpton Hotel & Restaurant Group LLC	Journeyman Hotel	Patrick J Gaskin, Agt	310 E Chicago ST	Class B Tavern License		6/15/2022, 7:00 PM	1
89	Wisconsin & Milwaukee Hotel, LLC	Milwaukee Marriott Downtown/Starbucks	Keith A Fillpak, Agt	323 E Wisconsin AV	Class B Tavern License	312	5/23/2022, 7:00 PM	1
90	THE MILWAUKEE CLUB	THE MILWAUKEE CLUB	Molly J Schick, Agt	706 N JEFFERSON ST	Class B Tavern License	180	6/29/2022, 7:00 PM	1

7/8/2021

91	THIEF WINE, LLC	THIEF WINE SHOP & BAR	PHILIP M BILODEAU, Agt	400 N WATER ST	Class B Tavern License	42	6/29/2022, 7:00 PM	1
92	Benelux Third Ward, LLC	Cafe Benelux	ERIC G WAGNER, Agt	346 N Broadway	Class B Tavern License	455	5/1/2022, 7:00 PM	1
93	SCREAMING TUNA RESTAURANT, LLC	SCREAMING TUNA	Jeff T Bronstad, Agt	106 W SEEBOTH ST 102	Class B Tavern License	174	6/13/2022, 7:00 PM	1
94	First MKD, LLC	Hilton Garden Inn	Sarah I Frost, Agt	611 N BROADWAY	Class B Tavern License		6/15/2022, 7:00 PM	1
95	THE SALOON, LTD	JUST ART'S SALOON	ARTHUR R GUENTHER, Agt	181 S 2ND ST	Class B Tavern License	70	6/29/2022, 7:00 PM	1

Establishments within a 0.5 miles radius centered on area of interest.



Thursday, September 02, 2021

Licenses Committee Notice of Hearing

MONARCH PARTNERS LLC
333 E CHICAGO St
MILWAUKEE, WI 53202

The Licenses Committee will consider the following license application:

Class B Tavern, Food Dealer, and Sidewalk Dining License Applications
KASHEVAROF, Robbin V, Agent
Valentine Coffee at 189 N Milwaukee St

Date: 9/20/2021

Time: 10:45 AM

Location: The hearing before the Licenses Committee will take place virtually on Monday, September 20, 2021. This is a public hearing. Those wishing to view the proceeding are able to do so via the City Channel – Channel 25 on Spectrum Cable – or on the Internet at <http://city.milwaukee.gov/citychannel>. Those wishing to provide oral testimony will be asked to do so by phone or internet and are asked to contact the staff assistant, Molly Kuether-Steele at (414) 286-2775 or molly.kuether-steele@milwaukee.gov for necessary information. Please make such requests no later than one business day prior to the start of the meeting. You are not required to attend the hearing, but please see the information below if you would like to provide testimony

Please note this application may be recommended for denial based on fitness of the location due to concentration of alcohol beverage outlets in the area. If the application is denied for this reason, no other application for an alcohol beverage license for this location shall be recommended for approval by the Licenses Committee within three years of the date of denial unless the applicant has demonstrated a change of circumstances since the prior denial.





Thursday, September 02, 2021



Notice of Public Hearing

blank
notice

KASHEVAROF, Robbin V, Agent
Valentine Coffee at 189 N Milwaukee St
Class B Tavern, Food Dealer, and Sidewalk Dining License Applications

Monday, September 20, 2021 at 10:45 AM

To whom it may concern:

The above application has been made by the above named applicant(s). This requires approval from the Licenses Committee and the Common Council of the City of Milwaukee. The hearing before the Licenses Committee will take place virtually on 9/20/2021 at 10:45 AM. This is a public hearing. Those wishing to view the proceeding are able to do so via the City Channel – Channel 25 on Spectrum Cable – or on the Internet at <http://city.milwaukee.gov/citychannel>. Those wishing to provide oral testimony will be asked to do so by phone or internet and are asked to contact the staff assistant, Molly Kuether-Steele at (414) 286-2775 or molly.kuether-steele@milwaukee.gov for necessary information. Please make such requests no later than one business day prior to the start of the meeting. You are not required to attend the hearing, but please see the information below if you would like to provide testimony. Once the Licenses Committee makes its recommendation, this recommendation is forwarded to the full Common Council for approval at its next regularly scheduled hearing.

Important details for those wishing to provide information for the Licenses Committee to consider when making its recommendation:

1. The license application is scheduled to be heard at the above time. Due to other hearings running longer than scheduled, you may have to wait some time to provide your testimony.
2. You must testify as to matters that you have personally experienced or seen. (You cannot provide testimony for your neighbor, parent or anyone else; this is considered hearsay and cannot be considered by the committee.)
3. No letters or petitions can be accepted by the committee (unless the person who wrote the letter or the persons who signed the petition are willing to testify).
4. Persons opposed to the license application are given the opportunity to testify first; supporters may testify after the opponents have finished.
5. When you are called to testify, you will be sworn in and asked to give your name, and address. (If your first and/or last names are uncommon please spell them.)
6. You may then provide testimony.
 - a. Include only information relating to the above license application.
 - b. Include only information you have personally witnessed or seen.
 - c. Provide concise and relevant information detailing how this business has affected or may affect the peaceful enjoyment of your neighborhood.
 - d. If by the time you have the opportunity to testify, the information you wish to share has already been provided to the committee, you may state that you agree with the previous testimony. Redundant or repetitive testimony will not assist the committee in making its recommendation.
7. After giving your testimony, the members of the Licenses Committee and the licensee may ask questions regarding the testimony you have given or other factors relating to the license application.
8. Business Competition is not a valid basis for denial or non-renewal of a license.

Please Note: If you have submitted an objection to the above application your objection cannot be considered by the committee unless you personally testify at the hearing.

CURRENT OCCUPANT	234 N BROADWAY, 609	MILWAUKEE, WI 53202-5806
CURRENT OCCUPANT	234 N BROADWAY, 610	MILWAUKEE, WI 53202-5806
CURRENT OCCUPANT	234 N BROADWAY, 611	MILWAUKEE, WI 53202-5806
CURRENT OCCUPANT	234 N BROADWAY, 612	MILWAUKEE, WI 53202-5806
CURRENT OCCUPANT	234 N BROADWAY, 613	MILWAUKEE, WI 53202-5806
CURRENT OCCUPANT	234 N BROADWAY, 614	MILWAUKEE, WI 53202-5806
CURRENT OCCUPANT	234 N BROADWAY, 615	MILWAUKEE, WI 53202-5806
CURRENT OCCUPANT	234 N BROADWAY, 616	MILWAUKEE, WI 53202-5806
CURRENT OCCUPANT	234 N BROADWAY, 617	MILWAUKEE, WI 53202-5806
CURRENT OCCUPANT	234 N BROADWAY, 618	MILWAUKEE, WI 53202-5806
CURRENT OCCUPANT	318 E CHICAGO ST, 4A	MILWAUKEE, WI 53202-5810
CURRENT OCCUPANT	318 E CHICAGO ST, 4B	MILWAUKEE, WI 53202-5810
CURRENT OCCUPANT	318 E CHICAGO ST, 5	MILWAUKEE, WI 53202-5810
CURRENT OCCUPANT	318 E CHICAGO ST, 6	MILWAUKEE, WI 53202-5810
blank	notice	

Total Records: 107

Radius: 250.0 feet and Center of Circle: 189 N Milwaukee St



BUSINESS LICENSE PLAN OF OPERATION

ccl-busplan 5/12/2020

Office of the City Clerk License Division
200 E. Wells St. Room 105, Milwaukee, WI 53202
(414) 286-2238 www.milwaukee.gov/license e-mail address: license@milwaukee.gov

1. Type of Business

Applying for: Extended Hours (12AM to 5AM) - If a food establishment, check all that apply: Delivery Drive Thru Dining Room
 Self Service Laundry Massage Establishment Filling Station
 Other (supplemental application for specific license also required)

Provide a detailed description of the type of business you plan on operating: Coffee shop

Do you have any experience operating this type of business? No Yes If yes, explain: Operate two other coffee shops in SE WI

2. Business Operations

- a. Proposed Opening Date: 07/01/21
- b. Is this premise under construction? No Yes If yes, list estimated completion date: 05/15/21
- c. Is this a franchise? No Yes
- d. Is this premises currently licensed? No Yes If yes, list type of license: _____
- e. Is the current licensee operating? No Yes If no, list date closed: N/A
- f. Do you have future plans for other businesses, licenses or permits at this location? No Yes
If yes, explain: Class "B" Tavern License
- g. Have you previously held an Extended Hours License in Milwaukee? No Yes
If yes, list address(es): _____
- h. Are other businesses operating in the same building? No Yes If yes, describe: Metro Eye, EUA Architects

3. Litter & Noise

- a. How are grounds kept clean? Sweep Pressure Wash Pick Up Litter Other: _____
- b. How often will grounds be cleaned? Daily Weekly As Needed Monthly Other: _____
- c. Grounds cleaned by: Licensee Building Owner Employees Hired Maintenance Other: _____
- d. How are noise issues prevented and/or addressed? Security Manager approaches customer(s) Call Police
 Signs Posted Other: _____
- e. Will a sound amplification system be used? No Yes If yes, describe: _____

4. Smoking & Sanitation

- a. Are there designated outdoor smoking areas? No Yes If yes, describe: _____
- b. Number of Garbage Cans: Inside: 9 Locations: 2 - bathroom, 2 - cafe, 4 - bar, 1 - office
Outside: 1 Locations: on the dining patio
- c. Is a crowd control barrier used? No Yes If yes, describe: _____
- d. How many restrooms are on the premises? 2
- e. Name of solid waste contractor: Advanced Disposal Waste Management Other: _____

5. Security

- a. Are there onsite parking spaces? No Yes If yes, how many? _____ and describe the parking security plan: _____
- b. Is there a loading zone? No Yes If yes, describe the loading area security plan: _____ visually monitored
- c. Will you have security personnel on premise? No Yes If yes, how many? _____ and answer the following:
 What are their responsibilities? _____
 Is security equipment used? No Yes If yes, describe _____
 List their licensing, certification, or training credentials _____
- d. Will there be security cameras? No Yes If yes, how many? 3 and list locations: inside cafe
- e. Will searches/identification checks be done upon entry? No Yes If yes, describe _____

6. Percentage of Sales (must total 100%)

Alcohol <u>10</u> %	Food <u>90</u> %	Secondhand Merchandise _____ %	Precious Metals & Gems _____ %
Entertainment _____ %	Cigarettes _____ %	Personal Services (such as tattoo, body piercing, salon, tailor, tanning, etc.) _____ %	Other _____ % Describe: _____
Pawnbroker Activity _____ %	Salvaged Materials _____ % (such as scrap metal)		

7. Businesses/Licenses on the Premises (check all that apply):

Type 1

- Full Service Restaurant Cafe/Coffee Shop Deli or Fast Food Restaurant Private/Fraternal/Veterans Club
- Night Club Tavern Cocktail Lounge Teen Club
- Banquet Hall Sports Facility Bowling Alley
- Hotel/Motel: Number of Floors: _____ Number of Rooms: _____
 Rooming House: Number of Floors: _____ Number of Rooms: _____

Type 2

- Liquor Store Corner Store Supermarket Convenience Store
- Gas Station Amusement/Phonograph Distributor Recycling, Salvage or Towing
- Used Car Dealer Personal Service Establishment (such as tattoo business, hair salon, tailor, etc.) Recording Studio

What other licenses/permits will you hold at this location? (check all that apply)

- Occupancy Permit Cigarette & Tobacco Gas Station Extended Hours Class "B" Tavern Weights & Measures
- Secondhand Dealer Precious Metal & Gem Other: _____

8. Legal Capacity (only if a Type 1 premises in #7 above)

Capacity 49 (Call the Milwaukee Development Center at 414-286-8211 if you have questions.)

9. Premises Description

- a. Identify all area(s) of the premises that will be used in operating this business (include areas used only for storage):
 1st Floor 2nd Floor Basement Storage Patio Beer Garden Sidewalk Café Deck Rooftop
 Other: Describe: _____
- b. Describe Location: Major Thoroughfare Secondary Street Other: _____
- c. Nearest Major Cross Street: Chicago Street & Milwaukee Street
- d. Describe Building: Free Standing Building Strip Mall Other: _____
- e. Describe Premises Structure: Single Story Multi-Story - # of Stories 5 Other: _____
- f. Describe Surrounding Area: Commercial Residential Industrial Other: _____
- g. Building Owner Name: Greg Uhen Phone Number: 414-271-5350
 Building Owner Address: 333 East Chicago Street, Milwaukee, WI 53202

10. Hours of Operation & Customers

Will customers be entering the premises? No Yes

Day of the Week	Proposed Hours of Operation:		Estimated Number of Customers expected each day	Potential Age Range of Customers	Class B Tavern Applicant Only: Age Restriction (If none, write 'None')
	Open Time (include a.m. or p.m.)	Close Time (include a.m. or p.m.)			
Sunday	7:00 a.m.	10:00 p.m.	200	16-100	None
Monday	7:00 a.m.	10:00 p.m.	300	16-100	None
Tuesday	7:00 a.m.	10:00 p.m.	300	16-100	None
Wednesday	7:00 a.m.	10:00 p.m.	300	16-100	None
Thursday	7:00 a.m.	10:00 p.m.	300	16-100	None
Friday	7:00 a.m.	10:00 p.m.	300	16-100	None
Saturday	7:00 a.m.	10:00 p.m.	200	16-100	None

An Extended Hours Establishment License is required for any convenience store, filling station, personal service establishment (such as tattoo, body piercing, salon, tailor, tanning, etc.), recording studio or restaurant which is open between the hours of 12:00 a.m. and 5:00 a.m.

Alcohol Establishments Permitted Hours of Operation: Class A: 8:00 am to 9:00 pm Sunday thru Saturday
 Class B: 6:00 am to 2:00 am Sunday thru Thursday, 6:00 am to 2:30 am Friday & Saturday

Entertainment Outdoor Closing Hours: 10:00pm Sunday-Thursday; 12:00am Friday & Saturday; unless a different time, either earlier or later, is established by the Common Council in its approval of the licensee's plan of operation.

11. Signature(s)

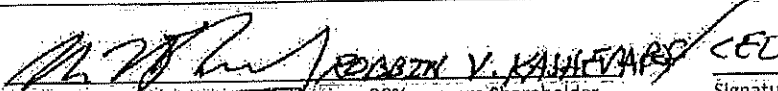
 Signature of Sole Promoter, Partner, or 20% or more Shareholder
 (If there are no 20% or more shareholders, Corporate Officer-print name/title and sign)

Signature of additional partner or 20% or more shareholder

See Application Information for a complete list of all required application forms.



ALCOHOL BEVERAGE & PUBLIC ENTERTAINMENT PREMISES SUPPLEMENTAL APPLICATION

Office of the City Clerk License Division
200 E. Wells St. Room 105, Milwaukee, WI 53202
(414) 286-2238 e-mail address: license@milwaukee.gov www.milwaukee.gov/license

Legal Entity Name: Valentine Coffee Roasters Third Ward LLC

Premise Address: 189 North Milwaukee Street, Milwaukee, WI 53202

Proximity of Premises to Church, School, Daycare Center or Hospital

Is the building within 300 feet of any church, school, daycare center or hospital? No Yes

"Service Bar Only" Designation

If applying for Class B or C license, are you applying for "Service Bar Only"? No Yes

Service Bar Only means customers cannot sit at the bar. Alcohol is served to employees who serve patrons seated at tables. No stools, chairs or other articles of furniture shall be placed at the service bar for patrons to sit upon.

Business Information

a) Are you taking out this application for anyone that may not be eligible for a license? No Yes

If yes, list their name and address: _____

b) Will the agent, a partner or the individual licensee be conducting the day-to-day operations of the business? No Yes
If no, list the name and address of the person(s) who will: _____

Class B Applicants: If the agent, a partner or the individual licensee will not be conducting the day-to-day operations of the business, the person(s) listed above must obtain a Class B Managers license.

c) Does anyone else have money invested or any other interest in this business? No Yes

If yes, explain: _____

d) Have you made an agreement with anyone to repay any loan or any other payments based upon income from the business?
 No Yes If yes, list name and address: _____

Property Information (New & Transfer Applicants Only)

a) Do you own or lease the building? Own Lease

b) Who owns the fixtures (for example, coolers, etc.)? Valentine Coffee Roasters Third Ward LLC

c) Are you purchasing the stock and/or fixtures? No Yes If yes, amount paid \$ _____

d) Total amount paid for business \$ N/A

e) Total amount paid for goodwill of the business \$ N/A

Goodwill comprises the reputation and customer relationships of an existing business. If the price you pay for the business exceeds the fair market value of all of the rest of the assets of the business, the excess may be considered goodwill.

f) Have you made arrangements with the seller for payment of personal property taxes? No Yes

Lease Information (New & Transfer Applicants who are leasing the premises only)

a) Date lease begins 6/1/21 Ends 12/31/26

b) Monthly rental \$ 1,500

c) Do you have an option to renew the lease? No Yes

d) Does your lease allow for assignment to another party without the consent of the owner? No Yes

e) For what length of time have you been guaranteed occupancy (number of years)? 5

Lease Information (Continued)

- f) In addition to paying the monthly rental, will you have to pay anything additional to the owner of the building to guarantee performance of the lease? No Yes If yes, explain electricity, heating and cooling
- g) Does the present owner or occupancy object to the granting of your license? No Yes
If yes, explain _____

Change of Agent Applicants Only

Have there been any changes to the floor plan since the last application was submitted? No Yes
If no, a new floor plan is not required. If yes, submit a new floor plan and explain the change(s):

Signature

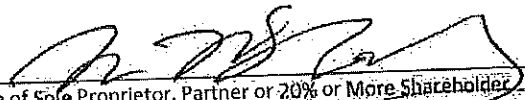
Signature of Sole Proprietor, Partner or 20% or More Shareholder
(If no 20% or more Shareholder, Corporate Officer - print name/title and sign)

Note: All information contained in this application is subject to approval by the Common Council.
Deviating from approved plan of operation will subject licensee to citations, and/or suspension or non-renewal of the license.
Contact the License Division for information on how to request changes.

New and transfer of premises applicants must submit the following:

- Detailed floor plan
- If a restaurant, copy of the menu



FOOD DEALER LICENSE PLAN OF OPERATION

ccl-foodplan 2/28/19

OFFICE OF THE CITY CLERK, LICENSE DIVISION
CITY HALL, 200 E. WELLS ST, ROOM 105, MILWAUKEE, WI 53202
(414) 286-2238 • license@milwaukee.gov • www.milwaukee.gov/license

Legal Entity Name: **Valentine Coffee Roasters Third Ward LLC**

Premises Address: **189 North Milwaukee Street, Milwaukee, WI 53202**

SECTION 1 TYPE OF BUSINESS

What will be the majority of your food sales? (check one)

Restaurant Items (meals):

MEALS include, but are not limited to, chicken, ribs, sandwiches, roasted corn, baked potatoes, hot dogs, brats, tacos, nachos w/ cheese and meat, French fries, cooked or deep fried vegetables/fruit, cooked cheese curds, corn dogs, egg rolls, salads.

Retail Items (snacks and beverages):

RETAIL items include, but are not limited to, ice cream/soft serve, lemonade, snow cones, coffee, espresso, cappuccino, tea, fruit juice, smoothies, candy, dispensed soda, fruit cups, bakery, cookies, kettle corn, cotton candy, funnel cakes, fritters, tortilla chips w/ cheese.

Will it be a convenience store? Yes No

A convenience store contains less than 5,000 square feet of retail space and has, as its primary business, the sale of basic food items and in addition, sells household products or is a filling station that sells basic food items and household products.

Bed & Breakfast

Micro Market

All Applicants: Submit a menu or a list of food items that will be sold.

Will any wholesale business be done? No Yes If yes, what percentage of food sales will be wholesale?

Less than 25%

25% or More AND:

Restaurant Items (meals) will be sold – Complete this application and also contact DATCP.

NO restaurant items (meals) will be sold - Do NOT complete this application. Contact DATCP only.

SECTION 2 FOOD PROCESSING

Will any food processing be done? No Yes

Processing is defined as assembling, grinding, cutting, mixing, baking, coating, stuffing, packing, bottling, grilling, canning, extracting, fermenting, distilling, pickling, freezing, drying, smoking, or packaging.

SECTION 3 FOOD REQUIRING TEMPERATURE CONTROL

Will any food that requires temperature control be sold? No Yes
(includes dairy products such as milk, cheese, and ice cream, fish, shellfish, meat, poultry)

If yes, list the types of food items: Salads, to-go beverages, yogurt parfaits, milk

SECTION 4 DETAILS OF OPERATION

Will you have seating on site for dining? No Yes

Will you be doing any catering? No Yes

Will you be doing any delivery? No Yes

Will you have outdoor activities? No Yes - Check all that apply: Bar Cooking/Grilling Dining

Will you have a drive thru window? No Yes - Are hours different from inside? No Yes
 If Yes, provide drive thru hours: _____

Will scales or barcode scanners be used? No Yes - You must also apply for a Weights & Measures License.

SECTION 5 ADDITIONAL SITES

Where will food be prepared and/or sold?
 At a single site At multiple sites: How many? _____ (for example, a hotel with several dining rooms or bars)
 If multiple sites, attach a Food Dealer Additional Site Addendum (ccl-foodadd) for each additional site.

SECTION 6 CONSTRUCTION OR CHANGES

Are you planning any construction, remodeling or equipment changes?
 No If No, SKIP to Section 8
 Yes If Yes, check all that apply: New construction of a building Renovation or remodeling
 Construction changes to existing building Equipment changes only

Provide a brief description of the changes: Cosmetic updating to FFE

Start date: 4-15-2021

Name, Address & Phone Number of Architect: Eppstein Uhen Architects (414)-271-5350
333 East Chicago Street, Milwaukee, WI 53202

Name, Address & Phone Number of Contractor: Pure Mechanical (414) 897-8012
N8W22275 Johnson Dr., Waukesha WI 53186

SECTION 7 ALCOHOL BEVERAGES

Are you applying for an alcohol beverage license?
 No If No, SKIP to Section 8
 Yes If YES, if your food license is approved prior to the alcohol license, when do you want the food license issued?
 Immediately At the same time as the alcohol license

SECTION 8 ACKNOWLEDGEMENTS & SIGNATURE

You must initial each item confirming your understanding:

RK I understand the Health Department must conduct an inspection and advise the License Division of their approval before the license may be issued.

RK I understand I must obtain an occupancy permit from the Department of Neighborhood Services and an inspection may be required. Neighborhood Services must advise the License Division of their approval before the license may be issued.

EX I understand the district alderperson will review and either support or object to my application. If he/she objects, I may appeal and be scheduled to appear before the Licenses Committee. The Licenses Committee will then make a recommendation to the Common Council. The Common Council must grant the license before the license may be issued.

AK I understand proof of payment for all license fees must be on file in the License Division before the license may be issued and the license must be issued and posted in my establishment prior to opening for business.

AK I will not operate my food business until the license has been issued and posted in the establishment.

Signature of Sole Proprietor, Partner, or 20% Shareholder: [Signature]

Signature of Additional Partner: _____



Sidewalk Dining Facility Supplemental Application

ccl-side1 2/21/18

Office of the City Clerk License Division
200 E. Wells St. Room 105, Milwaukee, WI 53202
(414) 286-2238 www.milwaukee.gov/license e-mail address: license@milwaukee.gov

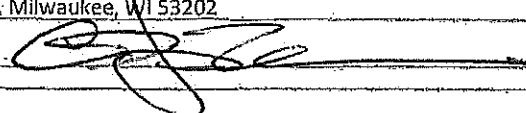
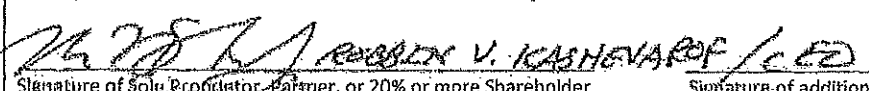
Business Name: Valentine Coffee Roasters Third Ward LLC		Aldermanic District # 4
Premises Address: 189 N. Milwaukee St., Milwaukee, WI 53202		
Business Operations		
Check one: <input checked="" type="checkbox"/> I/we are also applying for Food/Alcohol license(s) at this time.		
<input type="checkbox"/> I/we currently hold Food/Alcohol license(s) AND		
<input type="checkbox"/> confirm that the Business Plan of Operation on file which was previously submitted with the Food and/or Alcohol application has not changed, except for the addition of this sidewalk dining facility.		
<input type="checkbox"/> have included a new Business Plan of Operation reflecting requested changes.		
Sidewalk Dining Facility will operate from: Start Date: <u>April 1</u> to End Date: <u>October 31</u>		
Will any food preparation be done outdoors? <input checked="" type="checkbox"/> No <input type="checkbox"/> Yes		
If yes, describe: _____		
Will any sidewalk dining facility improvements be physically attached to public structures? <input checked="" type="checkbox"/> No <input type="checkbox"/> Yes		
If yes, describe: _____		
Property Owner		
Check one: <input type="checkbox"/> Applicant owns the property		
<input checked="" type="checkbox"/> Property owner's information/signature provided below (REQUIRED):		
Name: <u>Greg Uhen</u>		Phone # <u>414-271-5350</u>
Address: <u>333 East Chicago Street, Milwaukee, WI 53202</u>		
Property Owner's Signature: 		
Signature(s)		
		
Signature of Sole Proprietor, Partner, or 20% or more Shareholder (If there are no 20% or more shareholders, Corporate Officer-print name/title and sign)		Signature of additional partner or 20% or more shareholder

Office Use Only:

Initials _____ Filed _____ App # _____

Processing LS: Queue to: HD DNS CC Email To: DPW Primary LS

Also: holds is applying for: Food Alcohol Perm Ext

Valentine

OAK CREEK • CAFÉ & WINE BAR

ORDER ONLINE!

Visit: ValentineCoffeeCo.com

Full Menu Served Daily 7 am - 4 pm

V Vegetarian **DF** Dairy Free **GF** Gluten Free

Breakfast

Breakfast Sandwich \$4.5

Build your own starting with a Bagel, English Muffin or Croissant and egg.

Add Cheese \$1 : Cheddar, Swiss or Pepper Jack

Add Meat \$2 : Bacon, Breakfast Sausage or Canadian Bacon

Bagel & Lox \$8

Nova Lox with dill cream cheese, capers and red onions on a toasted bagel.

Mushroom Burrito \$7 **V**

Scrambled eggs with mushrooms, spinach and feta.

Chorizo Burrito \$7

Scrambled eggs with chorizo, roasted poblano, queso and salsa verde.

Yogurt Parfait \$6 **V**

Vanilla yogurt layered with mixed berry compote topped with house made pistachio and dried cranberry granola.

Belgian Liège Waffle

Brioche-based dough made locally by hand.

Original : powdered sugar \$6

Sweet : seasonal fruit compote \$7

Savory : ham, Gruyère, and arugula \$8

Bob's Red Mill

Oatmeal Cups \$4 **GF**

Hash Brown Patty \$1.5 **GF**

Soup & Salad

Add Chicken \$5 | Add Steak \$6.5 | House-made Dressings: Ranch, Caesar, Green Goddess, Balsamic Vinaigrette, Poppy seed, Gremolata Vinaigrette

Caesar Salad \$8

Romaine lettuce with Pecorino Romano and garlic croutons tossed in caesar dressing.

Chopped Bibb \$8

Bibb lettuce with bacon, tomato, red onion, hard boiled eggs and croutons tossed in a goat cheese - green goddess dressing.

Fattoush \$9 **V**

Mixed greens with cilantro, mint, cucumber, tomato, radish, red onion, feta and pita chips tossed in gremolata vinaigrette.

House Salad \$9 **V GF**

Baby spinach with apples, dried cranberries, walnuts, red onions and buttermilk blue cheese tossed in poppy seed dressing.

Side Salad \$4 **DF**

Mixed greens with carrot, tomato, red onion and cucumber with choice of dressing.

Valentine Chili \$4 | \$6

Hearty & Seasonal. Add cheese, onion, or sour cream, \$0.50 each

Soup of the day \$4 | \$6

Cup or Bowl. Bowl served with bread.

Sandwiches

Served with kettle chips, side salad or hash brown patty. Substitute soup for an additional \$1.5
Gluten Free bread available upon request for an additional charge

BLT \$12

Thick-cut bacon with arugula, herbed cheese spread and spicy tomato jam on grilled bread.

Egg Salad \$8 **V**

Chopped eggs with celery, red onion, capers, dill and bibb lettuce on toasted sourdough.

Roast Beef \$10

Deli-style roast beef and sliced cheddar with bibb lettuce and spicy brown mustard on sourdough.

Ham and Cheese \$11

Grilled city ham with gruyere and honey mustard on sourdough bread.

Turkey \$9

Black pepper turkey breast with smoked gouda, romaine and garlic-rosemary mayonnaise on toasted multigrain bread.

*Steak Sandwich \$12

Grilled steak with caramelized onion, arugula, Gruyère and horseradish sauce on a toasted baguette.

Buffalo Ranch Chicken Wrap \$9

Chicken breast with romaine, tomato, red onion and buttermilk blue cheese in a flour tortilla with sriracha buffalo and ranch dressing.

Grilled Cheese \$9 **V**

Provolone, Fontinella and Pecorino cheeses on grilled sourdough. Add grilled tomato, sriracha mayo, or basil walnut pesto, \$0.50 each.

Menu items and prices subject to change without notice. Jan | 2020 *Eating raw or undercooked meat, poultry, eggs, or seafood poses a health risk to everyone, but especially to the elderly, young children under age 4, pregnant women and other highly susceptible individuals with compromised immune systems. The cooking of such animal foods reduces the risk of illness.

Valentine

OAK CREEK • CAFÉ & WINE BAR

Daily Happy Hour

3pm - 5pm

Featured \$3
Beer & Wine Pours

All Drafts \$1 Off
Beer & Wine

Beverages

Fresh Brewed Coffee

Cold Brew • Espresso

Macchiato • Cortado

Americano • Cappuccino

London Fog • Hot Chocolate

Steamer • Rishi Tea

Lattes Original, Vanilla Bean,
Mocha, Miel, Chai, Seasonal,
Dulce de Leche

Bottled Water Nicolet 500 ml

Izze Clementine or Blackberry

Juice Orange or Apple

San Pellegrino 250 ml

Milk Whole, 2%, Skim, Chocolate,
Almond, Soy, Coconut

Soda Coke, Diet Coke, Sprite

Tap Wine

+ Available by the growler to-go

Sparkling

	Glass	Full Bottle
Carra Prosecco, Treviso DOC, Veneto, Italy	\$6	\$24

White

+ Gazerra Pinot Grigio, Sicily IGT, Italy	\$6	\$24
+ Matchbook "Old Head" Chardonnay, Dunnigan Hills, California	\$6	\$24

Rosé

+ Schneider & Bieler "Empire" Rose, New York	\$6	\$24
--	-----	------

Red

+ Broadside Cabernet Sauvignon, Paso Robles, California	\$8	\$28
+ Roots "Klee" Pinot Noir, Willamette Valley, Oregon	\$8	\$28

Ask about our retail wine
& beer offerings

Beer

* Indicates Valentine Coffee collaboration!

Draught

	12 oz Glass	16 oz Pint	64 oz To-Go
Enlightened Milwaukee, WI Seasonal Selection	\$5	\$6	\$18
Good City Milwaukee, WI "Risk" India Pale Ale	\$5	\$6	\$18
Lakefront Milwaukee, WI "Riverwest Stein" Amber Lager	\$5	\$6	\$18
Miller Milwaukee, WI "Lite" Pilsner	\$4	\$5	\$16
Third Space Milwaukee, WI Seasonal Selection	\$5	\$6	\$18

Bottle/Can

* Epic Denver, CO "Son of a Baptist" Coffee Stout	\$6 12 oz can
Guinness Dublin, Ireland "Draught" Stout	\$6 14.9 oz can
Heineken Amsterdam, Netherlands "Premium" Lager	\$5 16 oz can
Miller Milwaukee, WI "High Life" Lager	\$3 16 oz can
White Claw Chicago, IL Hard Seltzers: Mango or Raspberry	\$4 12 oz can

VALENTINE COFFEE ROASTERS THAKU WARD LLC
 189 N. MILWAUKEE ST.
 MILWAUKEE, WI 53202
 6 JULY 2021

Back/over storage
24x36 @ 150lb
24x36 @ 150lb
Back/over storage

Hand storage / display

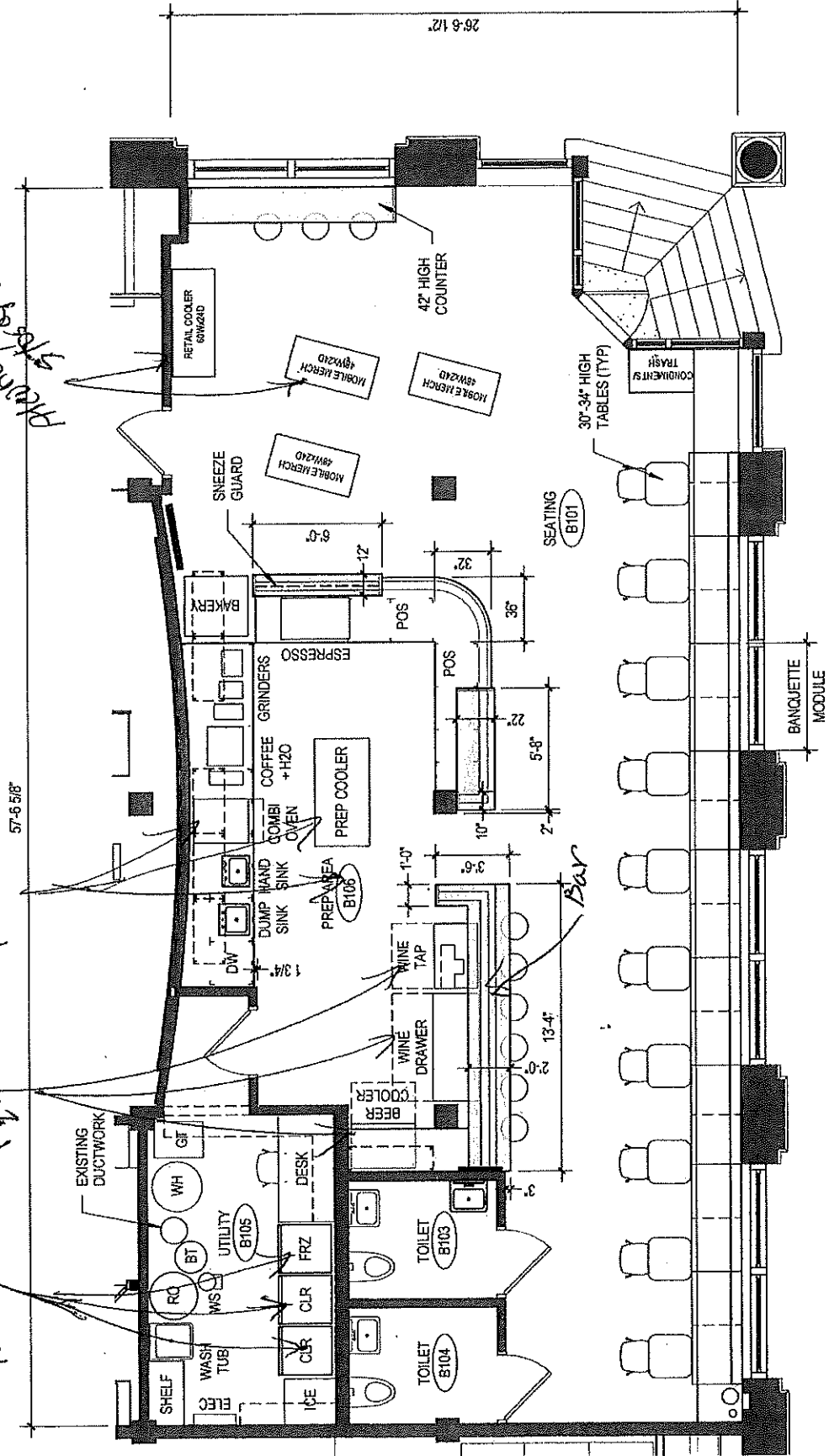

TOTAL SQUARE FEET: 1500SF

Chicago Street



Milwaukee Street

ROBB KASHEVAROFF (414) 732-6860 robb@valentinecoffee.com

189 N. MILWAUKEE ST.
MILWAUKEE, WI 53202
6 JULY 2021

Handwritten notes:
 Add Bar
 Add Storage
 24" x 36" cooler
 Bar
 Add prep/storage
 Add prep/storage
 Add prep/storage
 Add Storage
 19 chairs
 4 1/2" x 30" x 30" tables
 SEATING STATION
 SEATING AREA 115SF
 SEATING AREA 81SF
 SEATING AREA 300SF
 SEATING AREA 300SF

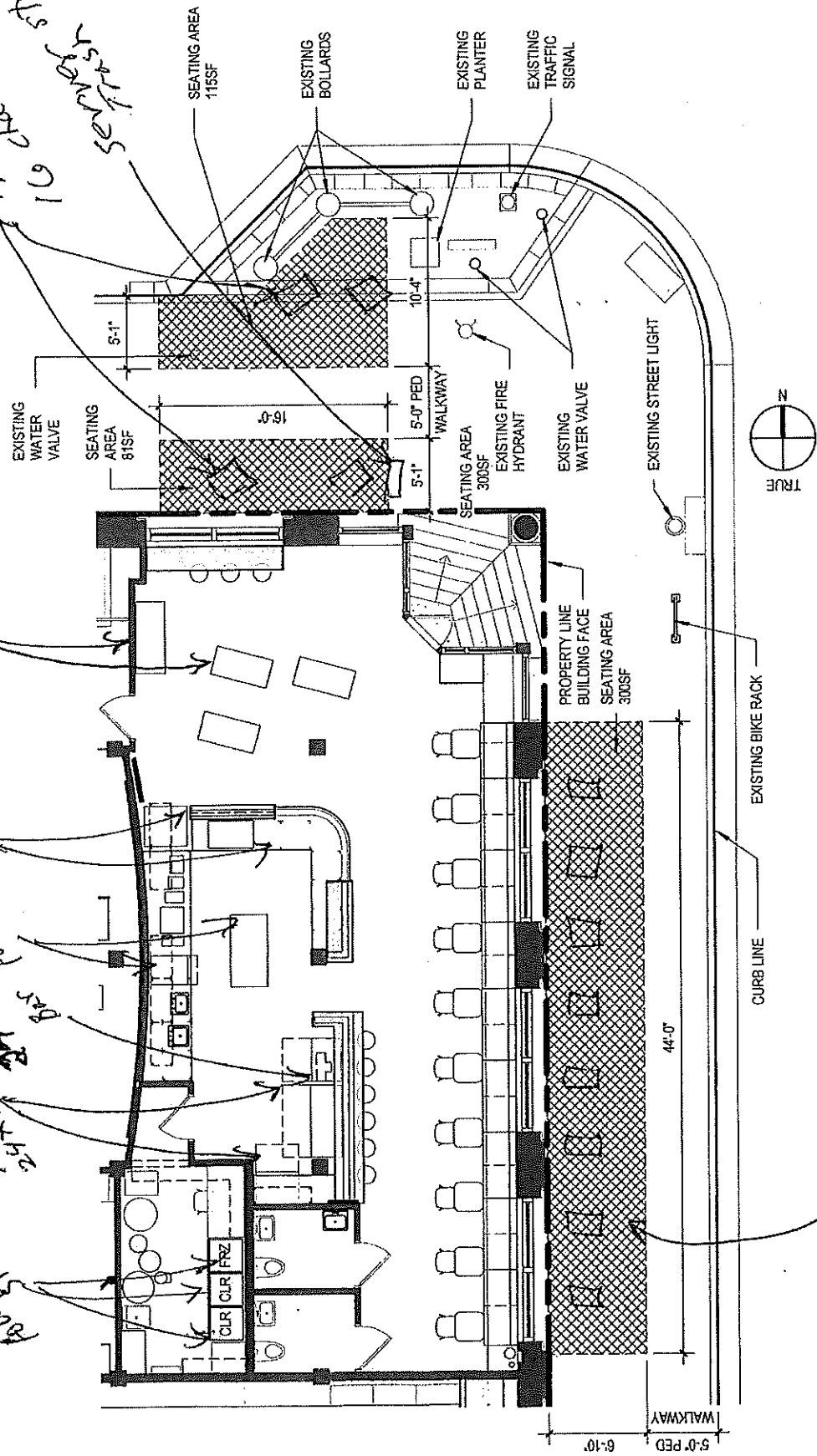

8, 24" x 30" tables
16 chairs

ROBB KASHEVAROF (414) 732-6860
rob@valentinescoffee.com
VALENTINE COFFEE ROASTERS THIRD WARD LLC.