



**CITY OF MILWAUKEE  
OFFICE OF THE CITY CLERK**

Thursday, November 19, 2020

**COMMITTEE MEETING NOTICE**

AD 07

AL-GHROUZ, Mahmoud A, Agent  
Jordan Convenience LLC  
4704 W BURLEIGH St

Milwaukee, WI 53210

You are requested to attend a virtual hearing to be held on:

**Tuesday, December 01, 2020 at 11:25 AM**

**Regarding:** Your Food Dealer License Application as agent for "Jordan Convenience LLC" for "Jordan Food and Tobacco" at 4704 W BURLEIGH St.

This meeting will be held via GoToMeeting. Please see the enclosed best practices document for further instructions. The access code is <https://global.gotomeeting.com/join/907185773>. If you wish to call in, please call +1 (786) 535-3211 and use Access Code: 907-185-773.

There is a possibility that your application may be denied for one or more of the following reasons: The recommendation of the committee regarding the application shall be based on evidence presented at the hearing. Per MCO 85-2.7-4, probative evidence concerning whether or not a new license should be granted may be presented on the following subjects: whether or not the applicant meets the municipal requirements, the appropriateness of the location and premises where the licensed premises is to be located and whether use of the premises for the purposes or activities permitted by the license would tend to facilitate a public or private nuisance or create undesirable neighborhood problems such as disorderly patrons, unreasonably loud noise, litter, and excessive traffic and parking congestion. Probative evidence relating to these matters may be taken from the plan of operation submitted with the license application, if any, but shall not include the content of any music. Evidence regarding the fitness of the location of the premises to be maintained as the principal place of business, including but not limited to whether there is an overconcentration of businesses of the type for which the license is sought; whether the proposal is consistent with any pertinent neighborhood business or development plans, or the location's proximity to areas where children are typically present. The applicant's record in operating similarly licensed premises; and whether or not the applicant has been charged with or convicted of any felony, misdemeanor, municipal offense or other offense, the circumstances of which substantially relate to the activity to be permitted by the license being applied for or any other factor which reasonably relates to the public health, safety or welfare may also be considered. See attached police report or correspondence.

**Notice for applicants with warrants or unpaid fines:**

Proof of warrant satisfaction or payment of fines must be submitted at the hearing on the above date and time. Failure to comply with this requirement may result in a delay of the granting/denial of your application.

Failure to attend this meeting may result in the denial of your license. Individual applicants and partnership applicants must attend or attend by an attorney. The agent or attorney for corporate or limited liability applicants must attend. If you wish to do so and at your own expense, you may be accompanied by an attorney of your choosing to represent you at this hearing.

You will be given an opportunity to speak on behalf of the application and to respond and challenge any charges or reasons given for the denial. No petitions can be accepted by the committee, unless the people who signed the petition attend the virtual hearing and are willing to testify. You may present witnesses under oath and you may also confront and cross-examine opposing witnesses under oath. If you have difficulty with the English language, you should request an interpreter attend the meeting with you, at your expense, so that you can answer questions and participate in your hearing.

PLEASE NOTE: Upon reasonable notice, efforts will be made to accommodate the needs of disabled individuals through sign language interpreters or other auxiliary aids. For additional information or to request this service, contact the Council Services Division ADA Coordinator at (414) 286-2998, Fax - (414) 286-3456, TDD - (414) 286-2025.

JIM OW CZARSKI, CITY CLERK

BY: \_\_\_\_\_

Jessica Celella  
License Division Manager

**If you have questions regarding this meeting, please contact the staff assistant, Molly Kuether-Steele at (414) 286-2775 or [molly.kuether-steele@milwaukee.gov](mailto:molly.kuether-steele@milwaukee.gov).**

200 E. Wells Street, Room 105, City Hall, Milwaukee, WI 53202. [www.milwaukee.gov/license](http://www.milwaukee.gov/license)  
Phone: (414) 286-2238 Fax: (414) 286-3057 Email Address: [License@milwaukee.gov](mailto:License@milwaukee.gov)



CITY OF MILWAUKEE  
OFFICE OF THE CITY CLERK

Thursday, November 19, 2020

COMMITTEE MEETING NOTICE

AD 07

AL-GHROUZ, Mahmoud A, Agent  
Jordan Convenience LLC  
5240 S 13th St

Milwaukee, WI 53221

You are requested to attend a virtual hearing to be held on:

**Tuesday, December 01, 2020 at 11:25 AM**

**Regarding:** Your Food Dealer License Application as agent for "Jordan Convenience LLC" for "Jordan Food and Tobacco" at 4704 W BURLEIGH St.

This meeting will be held via GoToMeeting. Please see the enclosed best practices document for further instructions. The access code is <https://global.gotomeeting.com/join/907185773>. If you wish to call in, please call +1 (786) 535-3211 and use Access Code: 907-185-773.

There is a possibility that your application may be denied for one or more of the following reasons: The recommendation of the committee regarding the application shall be based on evidence presented at the hearing. Per MCO 85-2.7-4, probative evidence concerning whether or not a new license should be granted may be presented on the following subjects: whether or not the applicant meets the municipal requirements, the appropriateness of the location and premises where the licensed premises is to be located and whether use of the premises for the purposes or activities permitted by the license would tend to facilitate a public or private nuisance or create undesirable neighborhood problems such as disorderly patrons, unreasonably loud noise, litter, and excessive traffic and parking congestion. Probative evidence relating to these matters may be taken from the plan of operation submitted with the license application, if any, but shall not include the content of any music. Evidence regarding the fitness of the location of the premises to be maintained as the principal place of business, including but not limited to whether there is an overconcentration of businesses of the type for which the license is sought; whether the proposal is consistent with any pertinent neighborhood business or development plans, or the location's proximity to areas where children are typically present. The applicant's record in operating similarly licensed premises; and whether or not the applicant has been charged with or convicted of any felony, misdemeanor, municipal offense or other offense, the circumstances of which substantially relate to the activity to be permitted by the license being applied for or any other factor which reasonably relates to the public health, safety or welfare may also be considered. See attached police report or correspondence.

**Notice for applicants with warrants or unpaid fines:**

Proof of warrant satisfaction or payment of fines must be submitted at the hearing on the above date and time. Failure to comply with this requirement may result in a delay of the granting/denial of your application.

Failure to attend this meeting may result in the denial of your license. Individual applicants and partnership applicants must attend or attend by an attorney. The agent or attorney for corporate or limited liability applicants must attend. If you wish to do so and at your own expense, you may be accompanied by an attorney of your choosing to represent you at this hearing.

You will be given an opportunity to speak on behalf of the application and to respond and challenge any charges or reasons given for the denial. No petitions can be accepted by the committee, unless the people who signed the petition attend the virtual hearing and are willing to testify. You may present witnesses under oath and you may also confront and cross-examine opposing witnesses under oath. If you have difficulty with the English language, you should request an interpreter attend the meeting with you, at your expense, so that you can answer questions and participate in your hearing.

PLEASE NOTE: Upon reasonable notice, efforts will be made to accommodate the needs of disabled individuals through sign language interpreters or other auxiliary aids. For additional information or to request this service, contact the Council Services Division ADA Coordinator at (414) 286-2998, Fax - (414) 286-3456, TDD - (414) 286-2025.

JIM OWCZARSKI, CITY CLERK

BY: \_\_\_\_\_

Jessica Ceella  
License Division Manager

If you have questions regarding this meeting, please contact the staff assistant, Molly Kuether-Steele at (414) 286-2775 or [molly.kuether-steele@milwaukee.gov](mailto:molly.kuether-steele@milwaukee.gov).

200 E. Wells Street, Room 105, City Hall, Milwaukee, WI 53202. [www.milwaukee.gov/license](http://www.milwaukee.gov/license)  
Phone: (414) 286-2238 Fax: (414) 286-3057 Email Address: [License@milwaukee.gov](mailto:License@milwaukee.gov)



# Concentration Map

## Area of Interest (AOI) Information

4704 W Burleigh St

Nov 19 2020 15:04:30 Central Standard Time

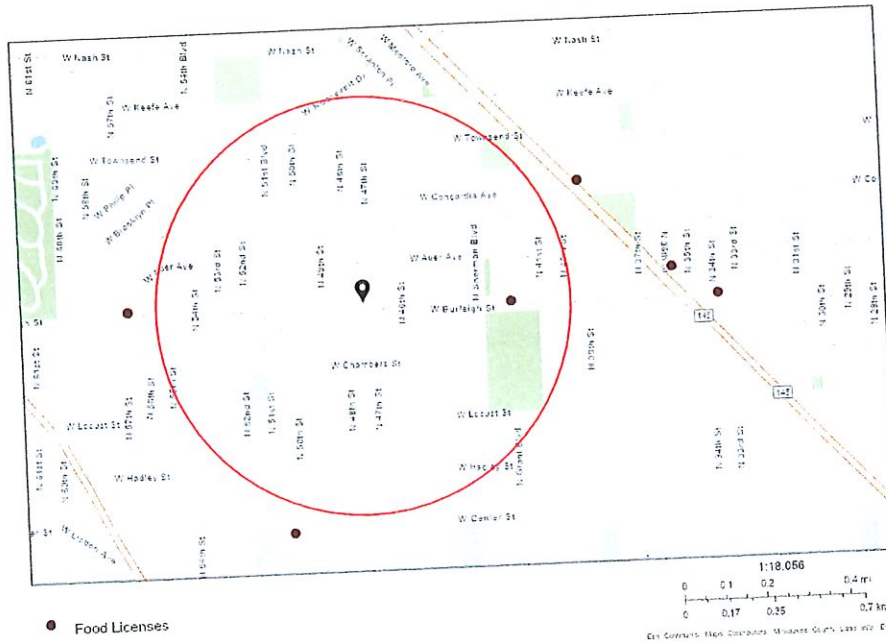

Summary

Name	Count	Area(ft²)	Length(mi)
Food Licenses	1		

Food Licenses

#	Legal entity	Trade name	Licensee	Address	License type name	Total capacity	Expiration date	Count
1	SRJEWELL ENTERTAINMENT LLC	42nd Street Bar & Grill	SHERLISE A JEWELL, Agt	4200 W BURLEIGH ST	Public Entertainment Premises License		9/14/2021, 7:00 PM	1

Establishments within a 0.5 miles radius centered on area of interest.

**To: The City of Milwaukee**

**License Committee of the Common Council  
License Division**

**Date: 10/08/2020**

**Appeal**

**I am writing to appeal your decision of the alderman's objection to grant my business the required Food Dealer Retail License dated on 10/05/2020 and received on 10/08/2020.**

**The objection was based on concentration which is totally a non-understandable step**

**First the business is located in a residential and commercial area that serves the community around 47<sup>th</sup> and Burleigh St. No stores close to the address 4704 W Burleigh St are licensed to sell food items. Further, I am not requesting any beer or liquor license to be issued to the business. The customers of various ages will approach us mainly for food items.**

**The community around my store will benefit greatly from a nearby convenience store that is located within a walking distance from their houses and that offers fresh fruits on a daily basis.**

**The business was never issued any violations and was in full compliance with rules and city codes. The store is licensed to sell tobacco products since 2017.**

**I don't see any valid reason to hold this license and I think the city planners should review the fact that businesses are suffering because of the lack of licenses.**

**I definitely will address any concerns of the city's officials as soon as they arise.**

**The decision is impacting my business negatively and will finally drive the lack of business and the probability of shutting down the whole business.**

**Your help in reconsideration of this decision is highly needed.**



**Mahmoud A. Al-Ghrouz**

**Jordan Convenience LLC  
4707 W Burleigh St, Milwaukee, WI 53210**



Thursday, November 19, 2020



# Notice of Public Hearing

blank  
notice

---

AL-GHROUZ, Mahmoud A, Agent  
Jordan Food and Tobacco at 4704 W BURLEIGH St  
Food Dealer License Application

**Tuesday, December 1, 2020 at 11:25 AM**

To whom it may concern:

The above application has been made by the above named applicant(s). This requires approval from the Licenses Committee and the Common Council of the City of Milwaukee. The hearing before the Licenses Committee will take place virtually on 12/1/2020 at 11:25 AM. This is a public hearing. Those wishing to view the proceeding are able to do so via the City Channel – Channel 25 on Spectrum Cable – or on the Internet at <http://city.milwaukee.gov/citychannel>. Those wishing to provide oral testimony will be asked to do so by phone or internet and are asked to contact the staff assistant, Molly Kuether-Steele at (414) 286-2775 or [molly.kuether-steele@milwaukee.gov](mailto:molly.kuether-steele@milwaukee.gov) for necessary information. Please make such requests no later than one business day prior to the start of the meeting. You are not required to attend the hearing, but please see the information below if you would like to provide testimony. Once the Licenses Committee makes its recommendation, this recommendation is forwarded to the full Common Council for approval at its next regularly scheduled hearing.

---

## Important details for those wishing to provide information for the Licenses Committee to consider when making its recommendation:

1. The license application is scheduled to be heard at the above time. Due to other hearings running longer than scheduled, you may have to wait some time to provide your testimony.
2. You must testify as to matters that you have personally experienced or seen. (You cannot provide testimony for your neighbor, parent or anyone else; this is considered hearsay and cannot be considered by the committee.)
3. No letters or petitions can be accepted by the committee (unless the person who wrote the letter or the persons who signed the petition are willing to testify).
4. Persons opposed to the license application are given the opportunity to testify first; supporters may testify after the opponents have finished.
5. When you are called to testify, you will be sworn in and asked to give your name, and address. (If your first and/or last names are uncommon please spell them.)
6. You may then provide testimony.
  - a. Include only information relating to the above license application.
  - b. Include only information you have personally witnessed or seen.
  - c. Provide concise and relevant information detailing how this business has affected or may affect the peaceful enjoyment of your neighborhood.
  - d. If by the time you have the opportunity to testify, the information you wish to share has already been provided to the committee, you may state that you agree with the previous testimony. Redundant or repetitive testimony will not assist the committee in making its recommendation.
7. After giving your testimony, the members of the Licenses Committee and the licensee may ask questions regarding the testimony you have given or other factors relating to the license application.
8. Business Competition is not a valid basis for denial or non-renewal of a license.

**Please Note: If you have submitted an objection to the above application your objection cannot be considered by the committee unless you personally testify at the hearing.**

OCCUPANT	MAIL ADDRESS	CITY, STATE ZIP
CURRENT OCCUPANT	4720 W BURLEIGH ST 6	MILWAUKEE, WI 53210
CURRENT OCCUPANT	3136A N 48TH ST	MILWAUKEE, WI 53216
CURRENT OCCUPANT	3142 N 48TH ST	MILWAUKEE, WI 53216
CURRENT OCCUPANT	3107 N 48TH ST 4	MILWAUKEE, WI 53216
CURRENT OCCUPANT	3107 N 48TH ST 5	MILWAUKEE, WI 53216
CURRENT OCCUPANT	3107 N 48TH ST 3	MILWAUKEE, WI 53216
CURRENT OCCUPANT	3133 N 48TH ST	MILWAUKEE, WI 53216
CURRENT OCCUPANT	3131 N 48TH ST	MILWAUKEE, WI 53216
CURRENT OCCUPANT	4705 W BURLEIGH ST 7	MILWAUKEE, WI 53210
CURRENT OCCUPANT	4713 W BURLEIGH ST 22	MILWAUKEE, WI 53210
CURRENT OCCUPANT	4720 W BURLEIGH ST 1	MILWAUKEE, WI 53210
CURRENT OCCUPANT	3132 N 48TH ST	MILWAUKEE, WI 53216
CURRENT OCCUPANT	3057 N 47TH ST	MILWAUKEE, WI 53210
CURRENT OCCUPANT	3107 N 48TH ST 1	MILWAUKEE, WI 53216
CURRENT OCCUPANT	3107 N 48TH ST 2	MILWAUKEE, WI 53216
CURRENT OCCUPANT	4713 W BURLEIGH ST 16	MILWAUKEE, WI 53210
CURRENT OCCUPANT	4716 W BURLEIGH ST	MILWAUKEE, WI 53210
CURRENT OCCUPANT	3144 N 47TH ST	MILWAUKEE, WI 53216
CURRENT OCCUPANT	4705 W BURLEIGH ST 8	MILWAUKEE, WI 53210
CURRENT OCCUPANT	4720 W BURLEIGH ST 7	MILWAUKEE, WI 53210
CURRENT OCCUPANT	4720 W BURLEIGH ST 4	MILWAUKEE, WI 53210
CURRENT OCCUPANT	3119 N 47TH ST	MILWAUKEE, WI 53216
CURRENT OCCUPANT	3120 N 47TH ST	MILWAUKEE, WI 53216
CURRENT OCCUPANT	4631 W CARTER PL	MILWAUKEE, WI 53216
CURRENT OCCUPANT	3127 N 47TH ST	MILWAUKEE, WI 53216
CURRENT OCCUPANT	3126 N 47TH ST	MILWAUKEE, WI 53216
CURRENT OCCUPANT	3139 N 47TH ST	MILWAUKEE, WI 53216
CURRENT OCCUPANT	3107 N 48TH ST 6	MILWAUKEE, WI 53216
CURRENT OCCUPANT	3122 N 48TH ST	MILWAUKEE, WI 53216
CURRENT OCCUPANT	3137 N 47TH ST	MILWAUKEE, WI 53216
CURRENT OCCUPANT	3146 N 47TH ST	MILWAUKEE, WI 53216
CURRENT OCCUPANT	3148 N 48TH ST	MILWAUKEE, WI 53216
CURRENT OCCUPANT	3149 N 47TH ST	MILWAUKEE, WI 53216
CURRENT OCCUPANT	3056 N 48TH ST	MILWAUKEE, WI 53210
CURRENT OCCUPANT	3125 N 48TH ST	MILWAUKEE, WI 53216
CURRENT OCCUPANT	3121 N 48TH ST	MILWAUKEE, WI 53216
CURRENT OCCUPANT	4719 W BURLEIGH ST 17	MILWAUKEE, WI 53210
CURRENT OCCUPANT	4720 W BURLEIGH ST 2	MILWAUKEE, WI 53210
CURRENT OCCUPANT	3132 N 47TH ST	MILWAUKEE, WI 53216
CURRENT OCCUPANT	3143 N 47TH ST	MILWAUKEE, WI 53216
CURRENT OCCUPANT	3127 N 48TH ST	MILWAUKEE, WI 53216
CURRENT OCCUPANT	4720 W BURLEIGH ST 3	MILWAUKEE, WI 53210
CURRENT OCCUPANT	3131 N 47TH ST	MILWAUKEE, WI 53216
CURRENT OCCUPANT	3133 N 47TH ST	MILWAUKEE, WI 53216
CURRENT OCCUPANT	4705 W BURLEIGH ST 10	MILWAUKEE, WI 53210
CURRENT OCCUPANT	4713 W BURLEIGH ST 21	MILWAUKEE, WI 53210

CURRENT OCCUPANT	4720 W BURLEIGH ST 5	MILWAUKEE, WI 53210
CURRENT OCCUPANT	3126 N 48TH ST	MILWAUKEE, WI 53216
CURRENT OCCUPANT	3136 N 48TH ST	MILWAUKEE, WI 53216
CURRENT OCCUPANT	3145 N 47TH ST	MILWAUKEE, WI 53216
CURRENT OCCUPANT	4627 W CARTER PL	MILWAUKEE, WI 53216
CURRENT OCCUPANT	4627A W CARTER PL	MILWAUKEE, WI 53216
blank	notice	

Total Records: 52

Radius: 250.0 feet and Center of Circle: 4704 W Burleigh St





# BUSINESS LICENSE PLAN OF OPERATION

ccl-busplan 5/12/2020

Office of the City Clerk License Division  
200 E. Wells St. Room 105, Milwaukee, WI 53202  
(414) 286-2238 www.milwaukee.gov/license e-mail address: license@milwaukee.gov

## 1. Type of Business

Applying for:  Extended Hours (12AM to 5AM) - If a food establishment, check all that apply:  Delivery  Drive Thru  Dining Room  
 Self Service Laundry  Massage Establishment  Filling Station  
 Other (supplemental application for specific license also required)

Provide a detailed description of the type of business you plan on operating: GROCERY STORE

Do you have any experience operating this type of business?  No  Yes If yes, explain: RAN THE SAME BUSINESS FOR 5 YEARS

## 2. Business Operations

- a. Proposed Opening Date. 11/11/2018
- b. Is this premise under construction?  No  Yes If yes, list estimated completion date: \_\_\_\_\_
- c. Is this a franchise?  No  Yes
- d. Is this premises currently licensed?  No  Yes If yes, list type of license: OCCUPANCY
- e. Is the current licensee operating?  No  Yes If no, list date closed: \_\_\_\_\_
- f. Do you have future plans for other businesses, licenses or permits at this location?  No  Yes  
If yes, explain: \_\_\_\_\_
- g. Have you previously held an Extended Hours License in Milwaukee?  No  Yes  
If yes, list address(es): \_\_\_\_\_
- h. Are other businesses operating in the same building?  No  Yes If yes, describe: \_\_\_\_\_

## 3. Litter & Noise

- a. How are grounds kept clean?  Sweep  Pressure Wash  Pick Up Litter  Other: \_\_\_\_\_
- b. How often will grounds be cleaned?  Daily  Weekly  As Needed  Monthly  Other: \_\_\_\_\_
- c. Grounds cleaned by:  Licensee  Building Owner  Employees  Hired Maintenance  Other: \_\_\_\_\_
- d. How are noise issues prevented and/or addressed?  Security  Manager approaches customer(s)  Call Police  
 Signs Posted  Other: \_\_\_\_\_
- e. Will a sound amplification system be used?  No  Yes If yes, describe: \_\_\_\_\_

## 4. Smoking & Sanitation

- a. Are there designated outdoor smoking areas?  No  Yes If yes, describe: \_\_\_\_\_
- b. Number of Garbage Cans: Inside: 1 Locations: BY THE MAIN COUNTER  
Outside: 2 Locations: BY THE BOTH SIDES OF ENTRANCE
- c. Is a crowd control barrier used?  No  Yes If yes, describe: \_\_\_\_\_
- d. How many restrooms are on the premises? 1
- e. Name of solid waste contractor:  Advanced Disposal  Waste Management  Other: \_\_\_\_\_

### 5. Security

- a. Are there onsite parking spaces?  No  Yes If yes, how many? 8 and describe the parking security plan: ENTRANCE AND EXITS ARE WELL MARKED , PARKING SPOTS DESIGNATED
- b. Is there a loading zone?  No  Yes If yes, describe the loading area security plan: \_\_\_\_\_
- c. Will you have security personnel on premise?  No  Yes If yes, how many? \_\_\_\_\_ and answer the following:  
 What are their responsibilities? \_\_\_\_\_  
 Is security equipment used?  No  Yes If yes, describe \_\_\_\_\_  
 List their licensing, certification, or training credentials \_\_\_\_\_
- d. Will there be security cameras?  No  Yes If yes, how many? 14 and list locations: EVERY SIDE OF STORE IS COVERED
- e. Will searches/identification checks be done upon entry?  No  Yes If yes, describe \_\_\_\_\_

### 6. Percentage of Sales (must total 100%)

Alcohol <u>0</u> %	Food <u>75</u> %	Secondhand Merchandise <u>0</u> %	Precious Metals & Gems <u>0</u> %
Entertainment <u>00</u> %	Cigarettes <u>25</u> %	Personal Services (such as tattoo, body piercing, salon, tailor, tanning, etc.) <u>0</u> %	Other <u>0</u> % Describe: <u>0</u>
Pawnbroker Activity <u>00</u> %	Salvaged Materials _____ % (such as scrap metal)		

### 7. Businesses/Licenses on the Premises (check all that apply):

#### Type 1

- Full Service Restaurant     Cafe/Coffee Shop     Deli or Fast Food Restaurant     Private/Fraternal/Veterans Club
- Night Club     Tavern     Cocktail Lounge     Teen Club
- Banquet Hall     Sports Facility     Bowling Alley
- Hotel/Motel : Number of Floors: \_\_\_\_\_     Rooming House: Number of Floors: \_\_\_\_\_  
 Number of Rooms: \_\_\_\_\_    Number of Rooms: \_\_\_\_\_

#### Type 2

- Liquor Store     Corner Store     Supermarket     Convenience Store
- Gas Station     Amusement/Phonograph Distributor     Recycling, Salvage or Towing
- Used Car Dealer     Personal Service Establishment  
(such as tattoo business, hair salon, tailor, etc.)     Recording Studio

What other licenses/permits will you hold at this location? (check all that apply)

- Occupancy Permit     Cigarette & Tobacco     Gas Station     Extended Hours     Class "B" Tavern     Weights & Measures
- Secondhand Dealer     Precious Metal & Gem     Other: \_\_\_\_\_

### 8. Legal Capacity (only if a Type 1 premises in #7 above)

Capacity \_\_\_\_\_ (Call the Milwaukee Development Center at 414-286-8211 if you have questions.)

## 9. Premises Description

a. Identify all area(s) of the premises that will be used in operating this business (include areas used only for storage):

1<sup>st</sup> Floor  2<sup>nd</sup> Floor  Basement Storage  Patio  Beer Garden  Sidewalk Café  Deck  Rooftop

Other: Describe: \_\_\_\_\_

b. Describe Location:  Major Thoroughfare  Secondary Street  Other: \_\_\_\_\_

c. Nearest Major Cross Street: 47TH ST AND BURLEIGH

d. Describe Building:  Free Standing Building  Strip Mall  Other: \_\_\_\_\_

e. Describe Premises Structure:  Single Story  Multi-Story - # of Stories \_\_\_\_\_  Other: \_\_\_\_\_

f. Describe Surrounding Area:  Commercial  Residential  Industrial  Other: \_\_\_\_\_

g. Building Owner Name: MAHMOUD AL-GHROUZ Phone Number: 714-487-1647

Building Owner Address: 4704 W BURLEIGH ST, MILWAUKEE, WI 53210

## 10. Hours of Operation & Customers

Will customers be entering the premises?  No  Yes

Day of the Week	Proposed Hours of Operation:		Estimated Number of Customers expected each day	Potential Age Range of Customers	Class B Tavern Applicant Only: Age Restriction (If none, write 'None')
	Open Time (Include a.m. or p.m.)	Close Time (Include a.m. or p.m.)			
Sunday	9:00 AM	9:00 PM	40	VARIES	NONE
Monday	=	=	55	=	NONE
Tuesday	=	=	55	=	NONE
Wednesday	=	=	55	=	NONE
Thursday	=	=	55	=	NONE
Friday	=	=	60	=	NONE
Saturday	=	=	45	=	NONE

An Extended Hours Establishment License is required for any convenience store, filling station, personal service establishment (such as tattoo, body piercing, salon, tanning, etc.), recording studio or restaurant which is open between the hours of 12:00 a.m. and 5:00 a.m.

Alcohol Establishments Permitted Hours of Operation: Class A: 8:00 am to 9:00 pm Sunday thru Saturday  
Class B: 6:00 am to 2:00 am Sunday thru Thursday, 6:00 am to 2:30 am Friday & Saturday

Entertainment Outdoor Closing Hours: 10:00pm Sunday-Thursday; 12:00am Friday & Saturday; unless a different time, either earlier or later, is established by the Common Council in its approval of the licensee's plan of operation.

## 11. Signature(s)

Signature of Sole Proprietor, Partner, or 20% or more Shareholder  
(If there are no 20% or more shareholders, Corporate Officer-print name/title and sign)

Signature of additional partner or 20% or more shareholder

See Application Information for a complete list of all required application forms.



# FOOD DEALER LICENSE PLAN OF OPERATION

ccl-foodplan 2/28/19

OFFICE OF THE CITY CLERK, LICENSE DIVISION  
CITY HALL, 200 E. WELLS ST, ROOM 105, MILWAUKEE, WI 53202  
(414) 286-2238 • [license@milwaukee.gov](mailto:license@milwaukee.gov) • [www.milwaukee.gov/license](http://www.milwaukee.gov/license)

Legal Entity Name: Jordan Convenience LLC  
Premises Address: 4704 W Burleigh St. Milwaukee, WI 53210

## SECTION 1 TYPE OF BUSINESS

What will be the majority of your food sales? (check one)

- Restaurant Items (meals):  
MEALS include, but are not limited to, chicken, ribs, sandwiches, roasted corn, baked potatoes, hot dogs, brats, tacos, nachos w/ cheese and meat, French fries, cooked or deep fried vegetables/fruit, cooked cheese curds, corn dogs, egg rolls, salads.
- Retail Items (snacks and beverages):  
RETAIL items include, but are not limited to, ice cream/soft serve, lemonade, snow cones, coffee, espresso, cappuccino, tea, fruit juice, smoothies, candy, dispensed soda, fruit cups, bakery, cookies, kettle corn, cotton candy, funnel cakes, fritters, tortilla chips w/ cheese.

Will it be a convenience store?  Yes  No

A convenience store contains less than 5,000 square feet of retail space and has, as its primary business, the sale of basic food items and in addition, sells household products or is a filling station that sells basic food items and household products.

- Bed & Breakfast
- Micro Market

All Applicants: Submit a menu or a list of food items that will be sold.

Will any wholesale business be done?  No  Yes If yes, what percentage of food sales will be wholesale?

Less than 25%

25% or More AND:

Restaurant items (meals) will be sold – Complete this application and also contact DATCP.

NO restaurant items (meals) will be sold - Do NOT complete this application. Contact DATCP only.

## SECTION 2 FOOD PROCESSING

Will any food processing be done?  No  Yes

Processing is defined as assembling, grinding, cutting, mixing, baking, coating, stuffing, packing, bottling, grilling, canning, extracting, fermenting, distilling, pickling, freezing, drying, smoking, or packaging.

## SECTION 3 FOOD REQUIRING TEMPERATURE CONTROL

Will any food that requires temperature control be sold?  No  Yes  
(includes dairy products such as milk, cheese, and ice cream, fish, shellfish, meat, poultry)

If yes, list the types of food items: Milk - eggs - meat - frozen food

**SECTION 4 DETAILS OF OPERATION**

Will you have seating on site for dining?  No  Yes  
 Will you be doing any catering?  No  Yes  
 Will you be doing any delivery?  No  Yes  
 Will you have outdoor activities?  No  Yes - Check all that apply:  Bar  Cooking/Grilling  Dining  
 Will you have a drive thru window?  No  Yes - Are hours different from inside?  No  Yes  
 If Yes, provide drive thru hours: \_\_\_\_\_  
 Will scales or barcode scanners be used?  No  Yes - You must also apply for a Weights & Measures License.

**SECTION 5 ADDITIONAL SITES**

Where will food be prepared and/or sold?  
 At a single site  At multiple sites: How many? \_\_\_\_\_ (for example, a hotel with several dining rooms or bars)  
 If multiple sites, attach a Food Dealer Additional Site Addendum (ccl-foodadd) for each additional site.

**SECTION 6 CONSTRUCTION OR CHANGES**

Are you planning any construction, remodeling or equipment changes?  
 No If No, SKIP to Section 8  
 Yes If Yes, check all that apply:  New construction of a building  Renovation or remodeling  
 Construction changes to existing building  Equipment changes only  
 Provide a brief description of the changes: \_\_\_\_\_  
 Start date: \_\_\_\_\_  
 Name, Address & Phone Number of Architect: \_\_\_\_\_  
 \_\_\_\_\_  
 Name, Address & Phone Number of Contractor: \_\_\_\_\_  
 \_\_\_\_\_

**SECTION 7 ALCOHOL BEVERAGES**

Are you applying for an alcohol beverage license?  
 No If No, SKIP to Section 8  
 Yes If YES, if your food license is approved prior to the alcohol license, when do you want the food license issued?  
 Immediately  At the same time as the alcohol license

**SECTION 8 ACKNOWLEDGEMENTS & SIGNATURE**

You must initial each item confirming your understanding:  
MA I understand the Health Department must conduct an inspection and advise the License Division of their approval before the license may be issued.  
MA I understand I must obtain an occupancy permit from the Department of Neighborhood Services and an inspection may be required. Neighborhood Services must advise the License Division of their approval before the license may be issued.  
MA I understand the district alderperson will review and either support or object to my application. If he/she objects, I may appeal and be scheduled to appear before the Licenses Committee. The Licenses Committee will then make a recommendation to the Common Council. The Common Council must grant the license before it may be issued.  
MA I understand proof of payment for all license fees must be on file in the License Division before the license may be issued and the license must be issued and posted in my establishment prior to opening for business.  
MA I will not operate my food business until the license has been issued and posted in the establishment.

Signature of Sole Proprietor, Partner, or 20% Shareholder: \_\_\_\_\_  
 Signature of Additional Partner: \_\_\_\_\_



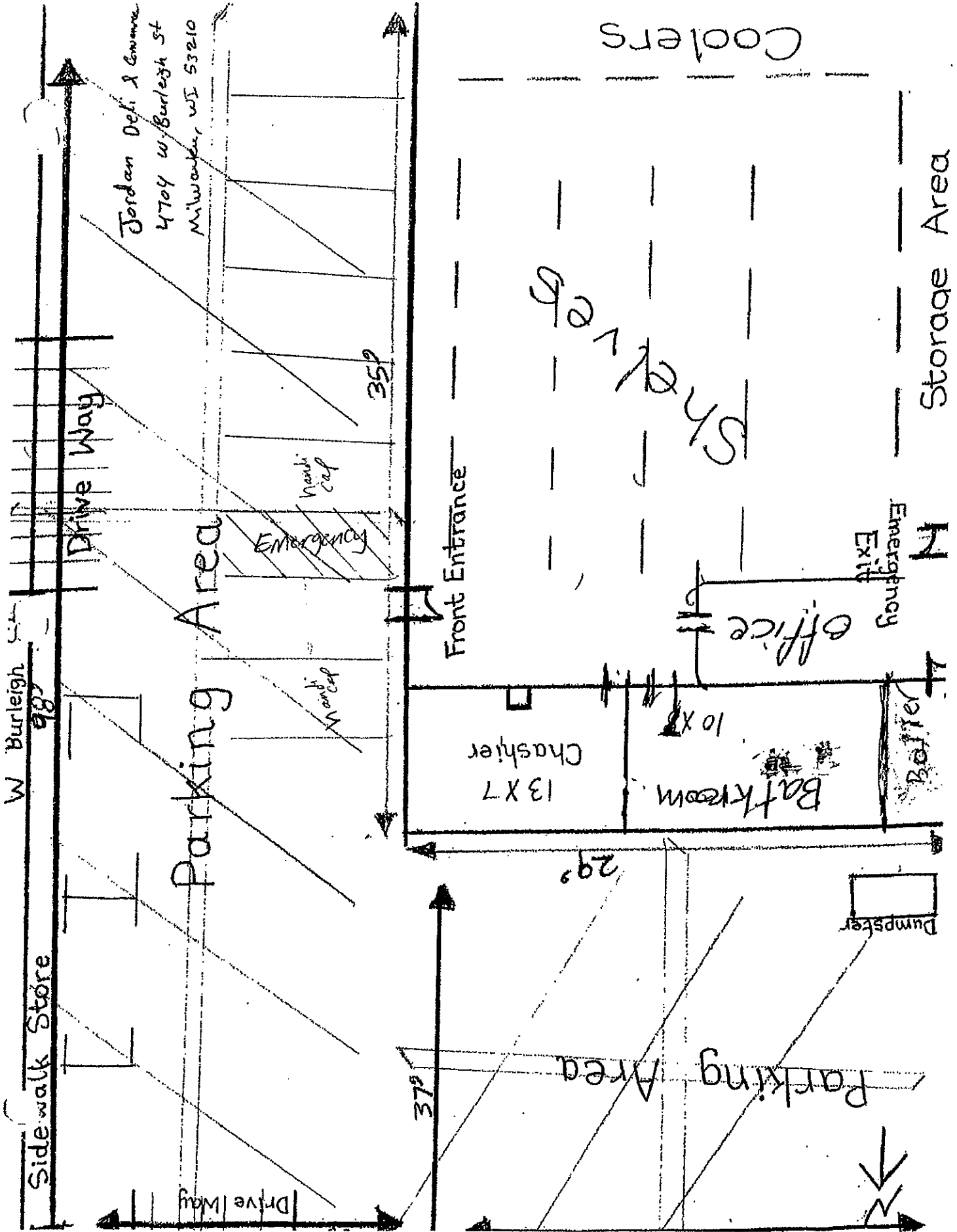

W Burleigh St

Side walk Store

Drive Way

Jordan Deli & Grocery  
4704 W Burleigh St  
Milwaukee, WI 53210

Parking Area

Drive Way

Wash Cap

Emergency

Wash Cap

35°

37°

Front Entrance

Chashier  
13 X 7

Bathroom  
10 X 8

Office

Shower

Dumpster

Emergency Exit

Storage Area

Coolers



July 16, 2020

Mr. Hani Ahmad  
4704 W. Burleigh Street  
Milwaukee, WI 53216

**Re: Vapor Assessment Results Related to Former One Hour Fabricare Drycleaner / Gas Station  
4704 W. Burleigh Street, Milwaukee, WI BRRTS # 02-41-548391  
Responsible Party: Mr. Tom McKay, Thiensville, WI, 414 273-9054**

**Subject: Results of Vapor Testing from the Site Property at 4704 W. Burleigh Street, Milwaukee, WI**

Dear Mr. Ahmad,

Sand Creek Consultants, W5877 Pheasant Lane, Plymouth, Wisconsin was hired by One Hour Fabricare (Mr. Tom McKay), to complete additional environmental investigation and remediation activities at the former drycleaner and gas station property that is currently a store that you operate. I believe you are in the process of purchasing the property from Mr. McKay.

Sand Creek is the environmental consultant for the project. On June 10 and 11, 2020, we obtained one sub-slab vapor sample and one indoor air sample from the western portion of the building. One ambient air sample was also obtained from the building roof. The samples were obtained from the location of the former drycleaning machine. Samples were retained per WDNR requirements and methods, and analyzed by Pace Analytical Laboratory, Minneapolis, MN. Testing was conducted to evaluate the concentration of drycleaning chemicals and select components of gasoline, as there has been a documented release of drycleaning solvent and petroleum on the property. The ten tested substances are listed on the attached table that shows the results.

The subslab sample was obtained from a 5/8" diameter hole drilled into the basement floor, and the indoor air sample was obtained from a height of about four feet above grade at the locations shown on the attached sample location map. The subslab hole was patched immediately after sample collection using cement.

The laboratory analytical report from the test results is attached, as is a table that compares your results to the current WDNR standards for each type of sample (subslab and indoor air vapor).

The results indicate for the indoor air sample that none of the analyzed compounds exceed the indoor air standards for a small commercial building. The ambient air sample also did not indicate any significant detections of the tested compounds in the typical outside air.

The subslab sample contains a concentration of the drycleaning chemical, tetrachloroethene (PCE) at a level above what the WDNR considers elevated for a subslab commercial building.

The WDNR has indicated further testing should be completed to verify and assess the significant of these findings. While the concentrations are above standards, the levels are still quite low, and have only been detected in the subslab, and not in the indoor air. Venting of the subslab air will likely be necessary, but should be discussed with the WDNR prior to taking further steps.



If you have further questions, please feel free to contact me at [ken.ebbott@sand-creek.com](mailto:ken.ebbott@sand-creek.com) or at 920 918-9024.

You can also contact the WDNR Project Manager for the One Hour Fabricare Site, Ms. Linda Michalets. She can be reached at [linda.michalets@wisconsin.gov](mailto:linda.michalets@wisconsin.gov) or by phone at (414) 263-8757.

Thank you for your cooperation on this matter, and we will be in contact regarding scheduling.

Sincerely,



Ken Ebbott, P.G.  
Project Manager

Attachments: Table of Findings  
Pace Laboratory Analytical Results 4704 W. Burleigh Street, Milwaukee, WI  
Figure 1: Sample Locations

Cc: Ms. Linda Michalets, WDNR, via email only with Attachments  
Mr. Tom McKay, via Email Only with Attachments

**Table 1: Vapor Chemistry Results**  
**Former One Hour Fabricare, 4704 W. Burleigh, Milwaukee, WI**

Sample ID	Location	Date	Benzene	cis-1,2-Dichloro-ethene	Ethyl benzene	Naphthalene	Tetrachloro-ethene (PCE)	Toluene	Trichloro-ethene (TCE)	Vinyl Chloride	m & p-Xylene separately	o-Xylenes	CONCLUSIONS
<b>Indoor Air Vapor Action Levels<sup>1</sup></b>													
<b>Small Commercial Standards</b>			16	--	49	3.6	180	22000	8.8	28	440	440	
Ambient (8-hour)	Former Drycleaner Roof 4704 W. Burleigh	6/10/2020	<0.19	<0.17	0.24 J	<1.9	<0.40	3.1	<0.33	<0.14	0.87 J	0.35 J	Ambient Air has no Drycleaning Chemicals
Indoor Air 4704 W. Burleigh (8-hour)	At Former Drycleaning Machine, 3.5' height	6/10/2020	2.6	<0.17	1.8	<1.9	4.9	9.5	<0.33	<0.14	6.5	2.1	Indoor Air of Former Drycleaner meets Standards

**Sub-Slab Vapor Samples ( $\mu\text{g}/\text{m}^3$ )**

Sample ID	Location	Date	Benzene	cis-1,2-Dichloro-ethene	Ethyl benzene	Naphthalene	Tetrachloro-ethene (PCE)	Toluene	Trichloro-ethene (TCE)	Vinyl Chloride	n, m, o-Xylene separately	Xylenes mix	CONCLUSIONS
<b>Sub-Slab Vapor Screening Levels<sup>2</sup></b>													
<b>Small Commercial Standards</b>			530	--	1600	120	6,000	730,000	290	930	15,000	15,000	
Subslab Drycleaner 4704 W Burleigh (30 min. grab)	Subslab at Former Dry Cleaning Machine	6/11/2020	4.0	3.1	3.7	<2.3	8,460	74.3	104	<0.17	11.0	3.9	Subslab Air at Former Dryclean Machine has elevated PCE, But Indoor Air is below Standards

**Notes:**

<sup>1</sup> Wisconsin Vapor Quick Look-UP Table Indoor Air Vapor Action Levels based on **November 2017 USEPA Regional Screening Levels** (<http://dnr.wi.gov/topic/Brownfields/documents/vapor/vapor-quick.pdf>).

<sup>2</sup> Screening level for Residential/Small Commercial Buildings (attenuation factor of 0.03).

$\mu\text{g}/\text{m}^3$ : micrograms per cubic meter.

-- = Substance not detected above indicated detection limit.

**Bold** indicate concentration exceeds associated Vapor Action Level for Setting.

J = Analyte was detected but is below the reporting limit. The concentration is estimated.

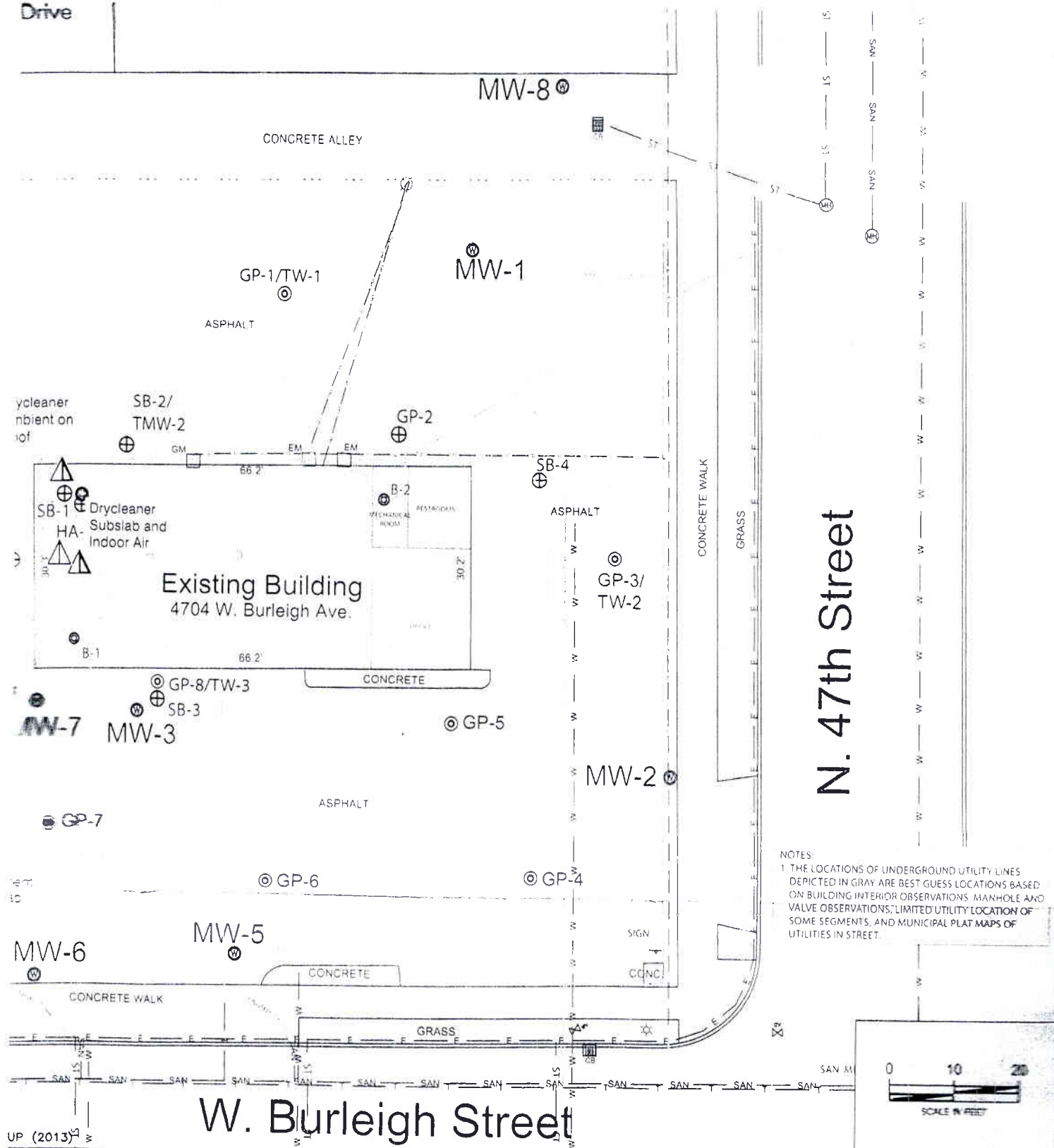

NOTES:  
 1. THE LOCATIONS OF UNDERGROUND UTILITY LINES DEPICTED IN GRAY ARE BEST GUESS LOCATIONS BASED ON BUILDING INTERIOR OBSERVATIONS, MANHOLE AND VALVE OBSERVATIONS, LIMITED UTILITY LOCATION OF SOME SEGMENTS, AND MUNICIPAL PLAT MAPS OF UTILITIES IN STREET.

W. Burleigh Street

N. 47th Street

**VAPOR SAMPLE LOCATIONS  
 JUNE 10 AND 11, 2020**

**FORMER ONE HOUR FABRICARE  
 4704 WEST BURLEIGH STREET  
 MILWAUKEE, WISCONSIN**

DATE:	JUNE 2020	DRAWN BY:	ASR
SCALE:	AS NOTED	APPROVED BY:	XX
		<b>FIGURE 1</b>	

June 18, 2020

Ken Ebbott  
Sand Creek Consultants  
W5877 Pheasant Lane  
Plymouth, WI 53073

RE: Project: ONE HOUR FABRICARE  
Pace Project No.: 10521568

Dear Ken Ebbott:

Enclosed are the analytical results for sample(s) received by the laboratory on June 15, 2020. The results relate only to the samples included in this report. Results reported herein conform to the applicable TNI/NELAC Standards and the laboratory's Quality Manual, where applicable, unless otherwise noted in the body of the report.

The test results provided in this final report were generated by each of the following laboratories within the Pace Network:

- Pace Analytical Services - Minneapolis

If you have any questions concerning this report, please feel free to contact me.

Sincerely,

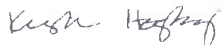

Kirsten Hogberg  
kirsten.hogberg@pacelabs.com  
(612)607-1700  
Project Manager

Enclosures



## REPORT OF LABORATORY ANALYSIS

This report shall not be reproduced, except in full,  
without the written consent of Pace Analytical Services, LLC.

## CERTIFICATIONS

Project: ONE HOUR FABRICARE  
Pace Project No.: 10521568

---

### Pace Analytical Services Minneapolis

A2LA Certification #: 2926.01  
Alabama Certification #: 40770  
Alaska Contaminated Sites Certification #: 17-009  
Alaska DW Certification #: MN00064  
Arizona Certification #: AZ0014  
Arkansas DW Certification #: MN00064  
Arkansas WW Certification #: 88-0680  
California Certification #: 2929  
CNMI Saipan Certification #: MP0003  
Colorado Certification #: MN00064  
Connecticut Certification #: PH-0256  
EPA Region 8+Wyoming DW Certification #: via MN 027-053-137  
Florida Certification #: E87605  
Georgia Certification #: 959  
Guam EPA Certification #: MN00064  
Hawaii Certification #: MN00064  
Idaho Certification #: MN00064  
Illinois Certification #: 200011  
Indiana Certification #: C-MN-01  
Iowa Certification #: 368  
Kansas Certification #: E-10167  
Kentucky DW Certification #: 90062  
Kentucky WW Certification #: 90062  
Louisiana DEQ Certification #: 03086  
Louisiana DW Certification #: MN00064  
Maine Certification #: MN00064  
Maryland Certification #: 322  
Massachusetts DWP Certification #: via MN 027-053-137  
Michigan Certification #: 9909  
Minnesota Certification #: 027-053-137  
Minnesota Dept of Ag Certification #: via MN 027-053-137

Minnesota Petrofund Certification #: 1240  
Mississippi Certification #: MN00064  
Missouri Certification #: 10100  
Montana Certification #: CERT0092  
Nebraska Certification #: NE-OS-18-06  
Nevada Certification #: MN00064  
New Hampshire Certification #: 2081  
New Jersey Certification #: MN002  
New York Certification #: 11647  
North Carolina DW Certification #: 27700  
North Carolina WW Certification #: 530  
North Dakota Certification #: R-036  
Ohio DW Certification #: 41244  
Ohio VAP Certification #: CL101  
Oklahoma Certification #: 9507  
Oregon Primary Certification #: MN300001  
Oregon Secondary Certification #: MN200001  
Pennsylvania Certification #: 68-00563  
Puerto Rico Certification #: MN00064  
South Carolina Certification #: 74003001  
Tennessee Certification #: TN02818  
Texas Certification #: T104704192  
Utah Certification #: MN00064  
Vermont Certification #: VT-027053137  
Virginia Certification #: 460163  
Washington Certification #: C486  
West Virginia DEP Certification #: 382  
West Virginia DW Certification #: 9952 C  
Wisconsin Certification #: 999407970  
Wyoming UST Certification #: via A2LA 2926.01

## REPORT OF LABORATORY ANALYSIS

This report shall not be reproduced, except in full,  
without the written consent of Pace Analytical Services, LLC

## PROJECT NARRATIVE

Project: ONE HOUR FABRICARE

Pace Project No.: 10521568

---

**Method:** TO-15

**Description:** TO15 MSV AIR

**Client:** Sand Creek Consultants

**Date:** June 18, 2020

**General Information:**

7 samples were analyzed for TO-15 by Pace Analytical Services Minneapolis. All samples were received in acceptable condition with any exceptions noted below or on the chain-of custody and/or the sample condition upon receipt form (SCUR) attached at the end of this report.

**Hold Time:**

The samples were analyzed within the method required hold times with any exceptions noted below.

**Initial Calibrations (including MS Tune as applicable):**

All criteria were within method requirements with any exceptions noted below.

**Continuing Calibration:**

All criteria were within method requirements with any exceptions noted below.

**Internal Standards:**

All internal standards were within QC limits with any exceptions noted below.

**Method Blank:**

All analytes were below the report limit in the method blank, where applicable, with any exceptions noted below.

**Laboratory Control Spike:**

All laboratory control spike compounds were within QC limits with any exceptions noted below.

**Duplicate Sample:**

All duplicate sample results were within method acceptance criteria with any exceptions noted below.

**Additional Comments:**

This data package has been reviewed for quality and completeness and is approved for release.

## REPORT OF LABORATORY ANALYSIS

This report shall not be reproduced, except in full,  
without the written consent of Pace Analytical Services, LLC.

### ANALYTICAL RESULTS

Project: ONE HOUR FABRICARE  
Pace Project No.: 10521568

Sample: **AMBIENT AIR** Lab ID: **10521568001** Collected: 06/10/20 16:31 Received: 06/15/20 11:10 Matrix: Air  
**DRYCLEANER ROOF**

Parameters	Results	Units	LOQ	LOD	DF	Prepared	Analyzed	CAS No.	Qual
Analytical Method: TO-15 Pace Analytical Services - Minneapolis									
TO15 MSV AIR							06/16/20 16:49	71-43-2	
Benzene	<0.19	ug/m3	0.48	0.19	1.49		06/16/20 16:49	156-59-2	
cis-1,2-Dichloroethene	<0.17	ug/m3	1.2	0.17	1.49		06/16/20 16:49	100-41-4	
Ethylbenzene	0.24J	ug/m3	1.3	0.21	1.49		06/16/20 16:49	91-20-3	
Naphthalene	<1.9	ug/m3	4.0	1.9	1.49		06/16/20 16:49	127-18-4	
Tetrachloroethene	<0.40	ug/m3	1.0	0.40	1.49		06/16/20 16:49	108-88-3	
Toluene	3.1	ug/m3	1.1	0.25	1.49		06/16/20 16:49	79-01-6	
Trichloroethene	<0.33	ug/m3	0.81	0.33	1.49		06/16/20 16:49	75-01-4	
Vinyl chloride	<0.14	ug/m3	0.77	0.14	1.49		06/16/20 16:49	179601-23-1	
m&p-Xylene	0.87J	ug/m3	2.6	0.50	1.49		06/16/20 16:49	95-47-6	
o-Xylene	0.35J	ug/m3	1.3	0.22	1.49				

Sample: **INDOOR DRYCLEANER** Lab ID: **10521568002** Collected: 06/10/20 16:35 Received: 06/15/20 11:10 Matrix: Air

Parameters	Results	Units	LOQ	LOD	DF	Prepared	Analyzed	CAS No.	Qual
Analytical Method: TO-15 Pace Analytical Services - Minneapolis									
TO15 MSV AIR							06/16/20 17:45	71-43-2	
Benzene	2.6	ug/m3	0.48	0.19	1.49		06/16/20 17:45	156-59-2	
cis-1,2-Dichloroethene	<0.17	ug/m3	1.2	0.17	1.49		06/16/20 17:45	100-41-4	
Ethylbenzene	1.8	ug/m3	1.3	0.21	1.49		06/16/20 17:45	91-20-3	
Naphthalene	<1.9	ug/m3	4.0	1.9	1.49		06/16/20 17:45	127-18-4	
Tetrachloroethene	4.9	ug/m3	1.0	0.40	1.49		06/16/20 17:45	108-88-3	
Toluene	9.5	ug/m3	1.1	0.25	1.49		06/16/20 17:45	79-01-6	
Trichloroethene	<0.33	ug/m3	0.81	0.33	1.49		06/16/20 17:45	75-01-4	
Vinyl chloride	<0.14	ug/m3	0.77	0.14	1.49		06/16/20 17:45	179601-23-1	
m&p-Xylene	6.5	ug/m3	2.6	0.50	1.49		06/16/20 17:45	95-47-6	
o-Xylene	2.1	ug/m3	1.3	0.22	1.49				

### REPORT OF LABORATORY ANALYSIS

This report shall not be reproduced, except in full,  
without the written consent of Pace Analytical Services, LLC.

### ANALYTICAL RESULTS

Project: ONE HOUR FABRICARE  
Pace Project No.: 10521568

Sample: DRYCLEANER SUBSLAM Lab ID: 10521568006 Collected: 06/11/20 12:47 Received: 06/15/20 11:10 Matrix: Air  
DCM

Parameters	Results	Units	LOQ	LOD	DF	Prepared	Analyzed	CAS No.	Qual
<b>TO15 MSV AIR</b>		Analytical Method: TO-15 Pace Analytical Services - Minneapolis							
Benzene	4.0	ug/m3	0.58	0.23	1.79		06/16/20 20:05	71-43-2	
cis-1,2-Dichloroethene	3.1	ug/m3	1.4	0.21	1.79		06/16/20 20:05	156-59-2	
Ethylbenzene	3.7	ug/m3	1.6	0.25	1.79		06/16/20 20:05	100-41-4	
Naphthalene	<2.3	ug/m3	4.8	2.3	1.79		06/16/20 20:05	91-20-3	
Tetrachloroethene	8460	ug/m3	296	115	429.6		06/17/20 11:30	127-18-4	
Toluene	74.3	ug/m3	1.4	0.31	1.79		06/16/20 20:05	108-88-3	
Trichloroethene	104	ug/m3	0.98	0.40	1.79		06/16/20 20:05	79-01-6	
Vinyl chloride	<0.17	ug/m3	0.93	0.17	1.79		06/16/20 20:05	75-01-4	
m&p-Xylene	11.0	ug/m3	3.2	0.61	1.79		06/16/20 20:05	179601-23-1	
o-Xylene	3.9	ug/m3	1.6	0.26	1.79		06/16/20 20:05	95-47-6	

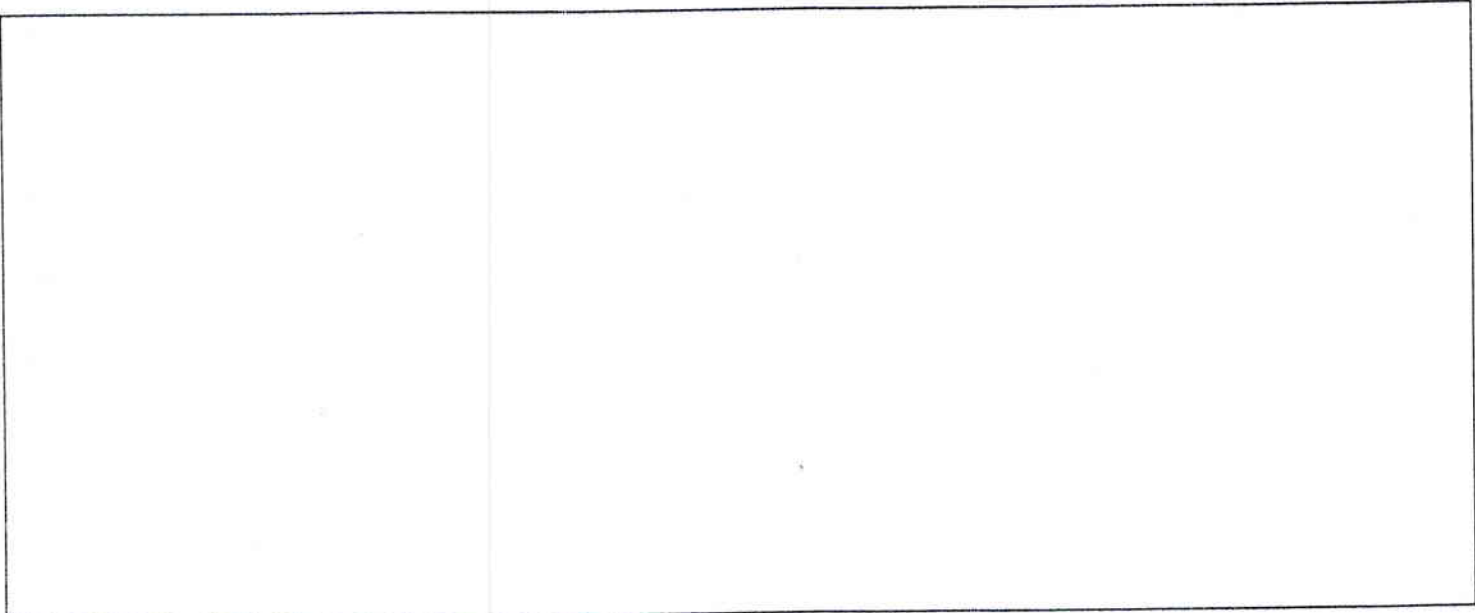

### REPORT OF LABORATORY ANALYSIS

This report shall not be reproduced, except in full,  
without the written consent of Pace Analytical Services, LLC.





**QUALITY CONTROL DATA**

Project: ONE HOUR FABRICARE  
 Pace Project No.: 10521568

QC Batch: 681428 Analysis Method: TO-15  
 QC Batch Method: TO-15 Analysis Description: TO15 MSV AIR Low Level  
 Laboratory: Pace Analytical Services - Minneapolis  
 Associated Lab Samples: 10521568001, 10521568002, 10521568003, 10521568004, 10521568005, 10521568006, 10521568007

METHOD BLANK: 3646261 Matrix: Air  
 Associated Lab Samples: 10521568001, 10521568002, 10521568003, 10521568004, 10521568005, 10521568006, 10521568007

Parameter	Units	Blank Result	Reporting Limit	Analyzed	Qualifiers
Benzene	ug/m3	<0.065	0.16	06/16/20 11:03	
cis-1,2-Dichloroethene	ug/m3	<0.058	0.40	06/16/20 11:03	
Ethylbenzene	ug/m3	<0.069	0.44	06/16/20 11:03	
m&p-Xylene	ug/m3	<0.17	0.88	06/16/20 11:03	
Naphthalene	ug/m3	<0.64	1.3	06/16/20 11:03	
o-Xylene	ug/m3	<0.074	0.44	06/16/20 11:03	
Tetrachloroethene	ug/m3	<0.13	0.34	06/16/20 11:03	
Toluene	ug/m3	<0.086	0.38	06/16/20 11:03	
Trichloroethene	ug/m3	<0.11	0.27	06/16/20 11:03	
Vinyl chloride	ug/m3	<0.048	0.26	06/16/20 11:03	MN

LABORATORY CONTROL SAMPLE: 3646262

Parameter	Units	Spike Conc.	LCS Result	LCS % Rec	% Rec Limits	Qualifiers
Benzene	ug/m3	33.5	35.3	105	70-133	
cis-1,2-Dichloroethene	ug/m3	41.6	39.2	94	70-132	
Ethylbenzene	ug/m3	45.6	41.0	90	70-142	
m&p-Xylene	ug/m3	91.2	80.6	88	70-141	
Naphthalene	ug/m3	57.7	55.7	97	63-130	
o-Xylene	ug/m3	45.5	39.8	87	70-135	
Tetrachloroethene	ug/m3	71	74.4	105	70-136	
Toluene	ug/m3	39.5	38.1	96	70-136	
Trichloroethene	ug/m3	56.3	60.1	107	70-132	
Vinyl chloride	ug/m3	26.7	22.0	82	68-141	

SAMPLE DUPLICATE: 3647419

Parameter	Units	10521568001 Result	Dup Result	RPD	Max RPD	Qualifiers
Benzene	ug/m3	<0.19	<0.19			25
cis-1,2-Dichloroethene	ug/m3	<0.17	<0.17			25
Ethylbenzene	ug/m3	0.24J	0.24J			25
m&p-Xylene	ug/m3	0.87J	0.91J			25
Naphthalene	ug/m3	<1.9	<1.9			25
o-Xylene	ug/m3	0.35J	0.34J			25
Tetrachloroethene	ug/m3	<0.40	<0.40			25
Toluene	ug/m3	3.1	3.3		7	25
Trichloroethene	ug/m3	<0.33	<0.33			25

Results presented on this page are in the units indicated by the "Units" column except where an alternate unit is presented to the right of the result.

**REPORT OF LABORATORY ANALYSIS**

This report shall not be reproduced, except in full,  
 without the written consent of Pace Analytical Services, LLC.

### QUALITY CONTROL DATA

Project: ONE HOUR FABRICARE

Pace Project No.: 10521568

SAMPLE DUPLICATE: 3647419

Parameter	Units	10521568001 Result	Dup Result	RPD	Max RPD	Qualifiers
Vinyl chloride	ug/m3	<0.14	<0.14		25	

SAMPLE DUPLICATE: 3647420

Parameter	Units	10521568002 Result	Dup Result	RPD	Max RPD	Qualifiers
Benzene	ug/m3	2.6	2.7	4	25	
cis-1,2-Dichloroethene	ug/m3	<0.17	<0.17		25	
Ethylbenzene	ug/m3	1.8	1.7	4	25	
m&p-Xylene	ug/m3	6.5	6.8	4	25	
Naphthalene	ug/m3	<1.9	<1.9		25	
o-Xylene	ug/m3	2.1	2.1	1	25	
Tetrachloroethene	ug/m3	4.9	5.5	11	25	
Toluene	ug/m3	9.5	10.2	7	25	
Trichloroethene	ug/m3	<0.33	<0.33		25	
Vinyl chloride	ug/m3	<0.14	<0.14		25	

Results presented on this page are in the units indicated by the "Units" column except where an alternate unit is presented to the right of the result.

### REPORT OF LABORATORY ANALYSIS

This report shall not be reproduced, except in full,  
without the written consent of Pace Analytical Services, LLC.

## QUALIFIERS

Project: ONE HOUR FABRICARE  
Pace Project No.: 10521568

---

### DEFINITIONS

DF - Dilution Factor, if reported, represents the factor applied to the reported data due to dilution of the sample aliquot.

ND - Not Detected at or above LOD.

J - Estimated concentration at or above the LOD and below the LOQ.

LOD - Limit of Detection adjusted for dilution factor, percent moisture, initial weight and final volume.

LOQ - Limit of Quantitation adjusted for dilution factor, percent moisture, initial weight and final volume.

S - Surrogate

1,2-Diphenylhydrazine decomposes to and cannot be separated from Azobenzene using Method 8270. The result for each analyte is a combined concentration.

Consistent with EPA guidelines, unrounded data are displayed and have been used to calculate % recovery and RPD values.

LCS(D) - Laboratory Control Sample (Duplicate)

MS(D) - Matrix Spike (Duplicate)

DUP - Sample Duplicate

RPD - Relative Percent Difference

NC - Not Calculable.

SG - Silica Gel - Clean-Up

U - Indicates the compound was analyzed for, but not detected at or above the adjusted LOD.

N-Nitrosodiphenylamine decomposes and cannot be separated from Diphenylamine using Method 8270. The result reported for each analyte is a combined concentration.

Pace Analytical is TNI accredited. Contact your Pace PM for the current list of accredited analytes.

TNI - The NELAC Institute.

### ANALYTE QUALIFIERS

MN The reporting limit has been raised in accordance with Minnesota Statutes 4740.2100 Subpart 8, C, D. Reporting Limit Evaluation Rule.

## REPORT OF LABORATORY ANALYSIS

This report shall not be reproduced, except in full,  
without the written consent of Pace Analytical Services, LLC.

**QUALITY CONTROL DATA CROSS REFERENCE TABLE**

Project: ONE HOUR FABRICARE

Pace Project No.: 10521568

Lab ID	Sample ID	QC Batch Method	QC Batch	Analytical Method	Analytical Batch
10521568001	AMBIENT AIR DRYCLEANER ROOF	TO-15	681428		
10521568002	INDOOR DRYCLEANER	TO-15	681428		
10521568003	4714 BURLEIGH SUBSLAB VP-N	TO-15	681428		
10521568004	4714 BURLEIGH SUBSLAB VP-S	TO-15	681428		
10521568005	3119 N 47TH CRAWL SPACE	TO-15	681428		
10521568006	DRYCLEANER SUBSLAM DCM	TO-15	681428		
10521568007	3119 N 47TH SUBSLAB CRAWL SPACE	TO-15	681428		

**REPORT OF LABORATORY ANALYSIS**

This report shall not be reproduced, except in full,  
without the written consent of Pace Analytical Services, LLC.

WO#: 10521568



Pace Analytical  
www.paceanalytical.com

**AIR: CHAIN-OF-CUSTODY / Analytical Request Document**

The Chain-of-Custody is a LEGAL DOCUMENT. All relevant fields must be completed accurately.

<b>Section A</b> Required Client Information: Company: <b>SAND CREEK</b> Address: <b>W 5877 Pleasant Lane</b> City: <b>Lyndoth WI 53073</b> Email To: <b>Ken.Ebbott@Sand-Creek.com</b> Phone: <b>920 9024</b> Fax: <b>---</b> Requested Due Date/TAT: <b>---</b>		<b>Section B</b> Required Project Information: Report To: <b>SAND</b> Copy To: <b>---</b> Purchase Order No.: <b>---</b> Project Name: <b>ONE HOUR FABRICARE</b> Project Number: <b>---</b>		<b>Section C</b> Invoicing Information: Attention: <b>TOM MCKAY</b> Company Name: <b>ONE HOUR FABRICARE</b> 53092 Address: <b>601 OAKWOOD DRIVE THIONSVILLE WI</b> Pace Quote Reference: <b>ANNUAL - \$200/sample w/ regulator</b> Pace Project Manager/Sales Rep: <b>---</b> Pace Profile #: <b>41110</b>		<b>Section D</b> Required Client Information <b>AIR SAMPLE ID</b> Sample IDs MUST BE UNIQUE	
Valid Media Codes: MEDIA 1 Litter Bag 1 Liter Summa Can 6 Liter Summa Can Low Volume Puff High Volume Puff Other		<b>COLLECTED</b> MEDIA CODE PID Reading (Client only)		Canister Pressure (Initial Field - In Hg) Canister Pressure (Final Field - In Hg)		Summa Can Number Flow Control Number	
Method: PM10 3C - Fixed Gas (%) TO-3 BTEX TO-3M (Methane) TO-14 TO-15 Full List VOCs TO-15 Short List BTEX TO-15 Short List Chlormethane TO-15 Short List (Other)		DATE TIME COMPOSITE START DATE TIME COMPOSITE STOP DATE TIME		DATE TIME ACCEPTED BY / AFFILIATION		DATE TIME SAMPLE CONDITIONS	
Report Level: II. III. IV. Other:		Report Level: II. III. IV. Other:		Report Level: II. III. IV. Other:		Report Level: II. III. IV. Other:	
Location of Sampling by State: <b>WI</b> Reporting Units: <input checked="" type="checkbox"/> mg/m <sup>3</sup> <input checked="" type="checkbox"/> engine* <input type="checkbox"/> PPMV <input type="checkbox"/> Other		Location of Sampling by State: <b>WI</b> Reporting Units: <input checked="" type="checkbox"/> mg/m <sup>3</sup> <input checked="" type="checkbox"/> engine* <input type="checkbox"/> PPMV <input type="checkbox"/> Other		Location of Sampling by State: <b>WI</b> Reporting Units: <input checked="" type="checkbox"/> mg/m <sup>3</sup> <input checked="" type="checkbox"/> engine* <input type="checkbox"/> PPMV <input type="checkbox"/> Other		Location of Sampling by State: <b>WI</b> Reporting Units: <input checked="" type="checkbox"/> mg/m <sup>3</sup> <input checked="" type="checkbox"/> engine* <input type="checkbox"/> PPMV <input type="checkbox"/> Other	
Program: <b>OCRF</b> <input type="checkbox"/> UST <input type="checkbox"/> Superfund <input type="checkbox"/> Emissions <input type="checkbox"/> Clean Air Act <input checked="" type="checkbox"/> Voluntary Clean Up <input checked="" type="checkbox"/> Dry Clean <input type="checkbox"/> RCRA <input type="checkbox"/> Other		Program: <b>OCRF</b> <input type="checkbox"/> UST <input type="checkbox"/> Superfund <input type="checkbox"/> Emissions <input type="checkbox"/> Clean Air Act <input checked="" type="checkbox"/> Voluntary Clean Up <input checked="" type="checkbox"/> Dry Clean <input type="checkbox"/> RCRA <input type="checkbox"/> Other		Program: <b>OCRF</b> <input type="checkbox"/> UST <input type="checkbox"/> Superfund <input type="checkbox"/> Emissions <input type="checkbox"/> Clean Air Act <input checked="" type="checkbox"/> Voluntary Clean Up <input checked="" type="checkbox"/> Dry Clean <input type="checkbox"/> RCRA <input type="checkbox"/> Other		Program: <b>OCRF</b> <input type="checkbox"/> UST <input type="checkbox"/> Superfund <input type="checkbox"/> Emissions <input type="checkbox"/> Clean Air Act <input checked="" type="checkbox"/> Voluntary Clean Up <input checked="" type="checkbox"/> Dry Clean <input type="checkbox"/> RCRA <input type="checkbox"/> Other	
Page: 1 of 1		Page: 1 of 1		Page: 1 of 1		Page: 1 of 1	

Comments:  
 Run All for:  
 PCE, TCE, DCE, VC  
 B, E, T, X, and  
 Naphthalene

SAMPLER NAME AND SIGNATURE  
 PRINT Name of SAMPLER: **KEN EBBOTT**  
 SIGNATURE OF SAMPLER: *Ken Ebbott*  
 DATE: **6/17/20**

ORIGINAL