



CITY OF MILWAUKEE
OFFICE OF THE CITY CLERK

Wednesday, January 10, 2018

COMMITTEE MEETING NOTICE

AD 01

KHEHRA, Amardeep S, Agent
PRINCE PETROLEUM, LLC
4811 N TEUTONIA Av

MILWAUKEE, WI 53209

You are requested to attend a hearing which is to be held in Room 301-B, Third Floor, City Hall on:

Tuesday, January 23, 2018 at 09:30 AM

Regarding: Your Extended Hours Establishments, Food Dealer, Filling Station, and Weights & Measures License Renewal Applications as agent for "PRINCE PETROLEUM LLC" for "Prince Petroleum" at 4811 N TEUTONIA Av.

There is a possibility that your application may be denied for one or more of the following reasons: The recommendation of the committee regarding the application shall be based on evidence presented at the hearing. Per MCO 85-4-4, unless otherwise specified in the code, probative evidence concerning non-renewal, suspension or revocation may include evidence of the following: failure of the applicant to meet municipal qualifications, pending charges against or the conviction of any felony, misdemeanor, municipal offense or other offense, the circumstances of which substantially relate to the circumstances of the particular licensed or permitted activity, by the applicant or by any employee or other agent of the applicant. If the activities of the applicant involve a licensed premises, whether the premises tends to facilitate a public or private nuisance or has been the source of congregations of persons which have resulted in any of the following: disturbance of the peace; illegal drug activity; public drunkenness; drinking in public; harassment of passers-by; gambling; prostitution; sale of stolen goods; public urination; theft; assaults; battery; acts of vandalism including graffiti, excessive littering, loitering, illegal parking, loud noise at times when the licensed premise is open for business; traffic violations; curfew violations; lewd conduct; display of materials harmful to minors, pursuant to s. 106-9.6; or any other factor which reasonably relates to the public health, safety and welfare, or failure to comply with the approved plan of operation. See attached police report or correspondence.

Notice for applicants with warrants or unpaid fines: Proof of warrant satisfaction or payment of fines must be submitted at the hearing on the above date and time. Failure to comply with this requirement may result in a delay of the granting/denial of your application.

Failure to appear at this meeting may result in the denial of your license. Individual applicants must appear only in person or by an attorney. Corporate or Limited Liability applicants must appear only by the agent designated on the application or by an attorney. Partnership applicants must appear by a partner listed on the application or by an attorney. If you wish to do so and at your own expense, you may be accompanied by an attorney of your choosing to represent you at this hearing.

You will be given an opportunity to speak on behalf of the application and to respond and challenge any charges or reasons given for the denial. No petitions can be accepted by the committee, unless the people who signed the petition are present at the committee hearing and willing to testify. You may present witnesses under oath and you may also confront and cross-examine opposing witnesses under oath. If you have difficulty with the English language, you should bring an interpreter with you, at your expense, so that you can answer questions and participate in your hearing.

You may examine the application file at this office during regular business hours prior to the hearing date. Inquiries regarding this matter may be directed to the person whose signature appears below.

Limited parking for persons attending meetings in City Hall is available at reduced rates (5 hour limit) at the Milwaukee Center on the southwest corner of East Kilbourn and North Water Street. Parking tickets must be validated in the first floor information booth in City Hall.

PLEASE NOTE: Upon reasonable notice, efforts will be made to accommodate the needs of disabled individuals through sign language interpreters or other auxiliary aids. For additional information or to request this service, contact the Council Services Division ADA Coordinator at (414) 286-2998, Fax - (414) 286-3456, TDD - (414) 286-2025.

JIM OWCZARSKI, CITY CLERK

BY: _____
Jessica Celella
License Division Manager

If you have questions regarding this notice, please contact the License Division at (414) 286-2238.
200 E. Wells Street, Room 105, City Hall, Milwaukee, WI 53202. www.milwaukee.gov/license
Phone: (414) 286-2238 Fax: (414) 286-3057 Email Address: License@milwaukee.gov

**MILWAUKEE POLICE DEPARTMENT
LICENSE INVESTIGATION UNIT**

**CRIMINAL RECORD/ORDINANCE VIOLATION/INCIDENTS
SYNOPSIS**

DATE:01/09/18

LICENSE TYPE: 24 HRR

NEW:

RENEWAL: X

No. 266451

Application Date: 11/27/2017

Expiration Date:

License Location: 4811 N. Teutonia Av.

Aldermanic District:

Business Name: Prince Petroleum

Licensee/Applicant: Khehra, Amardeep S.

(Last Name, First Name, MI)

Date of Birth: 12/12/1985

Home Address: 4811 N. Teutonia Ave.

City: Milwaukee

State: WI

Zip Code: 53209

Home Phone:

This report is written by Police Officer Corstan D. COURT, assigned to the License Investigation Unit, Days.

The Milwaukee Police Department's investigation regarding this application revealed the following:

1. On 04/10/2007 the applicant was cited in the City of Milwaukee for Sell Cigarette in Package/Container Without Stamp.

Charge: Sell Cigarette in Package/Container Without Stamp
Finding: Guilty
Sentence: \$70.00 fine
Date: 08/02/2007
Case: 07045874

2. On 08/22/2007 the applicant was cited in the City of Milwaukee for Sale of Cigarette to Minor/Underage.

Charge: Sale of Cigarette to Minor/Underage
Finding: Guilty
Sentence: \$160.00 fine
Date: 10/11/2207
Case: 07099864

3. On 11/26/2016 a 16 year old, working in conjunction with Milwaukee police, was able to purchase a 2 pack of cigarillos from the cashier at 4811 North Teutonia Avenue (Prince Petroleum). The business did enroll in the M.A.R.T.S. program, but it failed and a citation was mailed.

Charge: Sale of Cigarettes to Minor/Underage
Finding: Guilty
Sentence: \$181.00
Date: 12/12/17
Case: 17057094

4. On 05/30/2017 a Milwaukee police officer reviewed reports related to a homicide that occurred at 4811 N. Teutonia Avenue (Prince Petroleum) on 05/28/2017. Preliminary information indicates two individuals were involved in an argument in the parking lot of the gas station. During the altercation the suspect shot the victim who died from the gunshot wound. A casing was recovered from the gas station parking lot. Milwaukee police incident report #171480133 filed.

PA-33E Narrative

This report is submitted by P.O. Joshua Post assigned to District One, Early-Power shift. On Saturday, November 26th, 2016, I was assigned to work the Wisconsin WINS Youth Tobacco Initiative, which checks area vendors for age compliance tobacco purchases. I was assigned in this capacity as Squad 1269 and dressed in full police uniform.

Assisting in this assignment was Destiny K. Yarbrough (B/F, 04-02-00, 1938 N. 28th St., ph#414-553-7667). Yarbrough is sixteen years old and not of legal age to purchase tobacco. A photo of Yarbrough was taken at the beginning of the assignment for identification purposes.

At approximately 11:11AM, Yarbrough entered Prince Petroleum, located at 4811 N. Teutonia Av., and purchased a Swisher Sweets brand 2 for 99 cents pack of grape flavored cigarillos. Yarbrough left the store with her purchase and provided me with a description of the cashier that sold her the tobacco.

I entered the store and spoke with the cashier that matched the description. The subject was identified as Rajesh Paswan (W/M, 02-01-77). I could not communicate with Paswan due to a language barrier. However, the owner of the store was on scene and identified himself as Amardeep S. Khehra (W/M, 12-12-85). I explained the official purpose of my presence in the store and he related that information to Paswan. Khehra informed me that Paswan was the cashier at the time of this incident. However, Khehra informed me that Paswan related to him that, while it was possible he made the sale, he did not remember the transaction. Khehra was advised an enrollment letter for the M.A.R.T.S. program would be mailed to him. Khehra did enroll in the M.A.R.T.S. program. The goal of the program is to ensure that going forward the business verifies the age of each individual it sells tobacco to. To hold the business accountable, over a six month period from the date of enrollment into the program, mystery shoppers are sent in to purchase tobacco and determine whether or not the business is verifying their age.

Successful completion of this program would absolve Khehra of the citation for the sale of tobacco to Yarbrough. However, subsequent to Khehra enrolling his business, it failed the program on May 24th, 2017 and July 14th, 2017. As such, on 10-12-17, Khehra was cited for the underlying violation.

MILWAUKEE POLICE DEPARTMENT
REPORT OF INCIDENTS INVOLVING LICENSED PERSONS OR PREMISES

TO: Captain Boris TURCINOVIC

Business Name: Prince Petroleum (Citgo)

Address of Licensed Premises: 4811 N Teutonia Av

District: 7

Business Phone:

Type of License: Gas Station (Cigarette and Tobacco License)

Violation / Incident # 17-148-0133

Date of Incident: 5/28/17

Licensee or Manager on premises at time of violation / Incident? Yes No Unknown

Licensee cooperative? Yes No (If no, explain in narrative section)

Licensee Notified by Officer: P.O. Brian LaROQUE

Date: 5/30/17 Time: 7:50pm

Licensee or Agent's Name: Amardeep S KHEHRA

Date of Birth: 12/12/85

Home Address: 4811 N Teutonia Av

Home Phone: 414-422-3217

Co-Licensee Name:

Date of Birth:

Home Address:

Home Phone:

Class S License Number:

Bartender Name:

Date of Birth:

Home Address:

Home Phone:

Class D License Number:

Licensed Person / Public Pass. Vehicle, etc.:

Date of Birth:

Home Address:

Home Phone:

Class D License Number:

VIOLATION/INCIDENT - DESCRIBE FACTS AND CIRCUMSTANCES IN NARRATIVE SECTION

Name of Person Cited:

Citation Number:

Violation & Ord. / Statue No.:

Date of Birth:

Court Date:

Name of Person Cited:

Citation Number:

Violation & Ord. / Statue No.:

Date of Birth:

Court Date:

Name of Person Cited:

Citation Number:

Violation & Ord. / Statue No.:

Date of Birth:

Court Date:

Name of Person Cited:

Citation Number:

Violation & Ord. / Statue No.:

Date of Birth:

Court Date:

Name of Person Cited:

Citation Number:

Violation & Ord. / Statue No.:

Date of Birth:

Court Date:

Investigating Officer: P.O. Brian LaROQUE

District / Bureau: 74

Date: 5/30/17

Capt. Boris Turcinovic TURCINOVIC

05/30/17

Commanding Officer

Date

DISPOSITION - FOR LICENSING ONLY

Table with 5 columns: Citation No., Case Number, Disposition, Judge, Date. Includes text: LICENSE INVESTIGATION UNIT, Received 5-31-17, Referred, By [Signature]

Gas Station: Prince Petroleum (Citgo)

Date: 5/30/17

Type of Incident: Homicide

Investigating Officer: P.O. Brian LaROQUE

This report was written by P.O. Brian LaROQUE, assigned to District Seven, Late Power Shift. On 5/30/17 I reviewed reports regarding a homicide that occurred at 4811 N Teutonia Av (Prince Petroleum) on 5/28/17.

According to the preliminary reports two individuals were possibly in some kind of verbal altercation when the suspect shot the victim causing her death. We now understand that the victim and suspect in this incident are known to each other and that jealousy may be a motivating factor in this incident.

According to the preliminary reports there is video of the incident from the tavern and the video was provided to the investigating detectives. According to the preliminary report the video did capture the incident and it does show the suspect extending her arm towards the victim prior to the victim fleeing the area.

I attempted to speak with Amardeep S KHEHRA (U/M, 12/12/85) on 5/30/17 regarding the incident. KHEHRA did not answer my phone call and a voice mail was left for him. KHEHRA is listed as the agent for the gas station.

The gas station has current licenses and was operating within the scope of their license at the time of the incident.

It should be noted that according to the preliminary information a casing was recovered inside of the gas station parking lot and this is where the original shooting had occurred. The victim drove her vehicle 4-5 blocks west of the gas station before coming to a stop. Life saving measures were attempted by MPD and MFD without success.

This investigation is ongoing and the information above is preliminary information regarding the incident.

For additional information please refer to IR 17-148-0133

Gas Station: Prince Petroleum (Citgo)
Date: 5/30/17
Type of Incident: Homicide
Investigating Officer: P.O. Brian LaROQUE



Wednesday, January 10, 2018



Notice of Public Hearing

KHEHRA, Amardeep S, Agent
Prince Petroleum at 4811 N TEUTONIA Av
Extended Hours Establishments, Food Dealer, Filling Station, and Weights & Measures License
Renewal Applications

Tuesday, January 23, 2018 at 9:30 AM

To whom it may concern:

The above application has been made by the above named applicant(s). This requires approval from the Licenses Committee and the Common Council of the City of Milwaukee. The hearing before the Licenses Committee will take place on 1/23/2018 at 9:30 AM, in Room 301-B, Third Floor, City Hall. If you wish, you may provide testimony at the hearing regarding the request; see below for further information. You are not required to attend the hearing. Once the Licenses Committee makes its recommendation, this recommendation is forwarded to the full Common Council for approval at its next regularly scheduled hearing. Please review the information below and if you have further questions regarding this process, please contact the License Division at (414) 286-2238.

Important details for those wishing to provide information for the Licenses Committee to consider when making its recommendation:

1. The license application is scheduled to be heard at the above time. Due to other hearings running longer than scheduled, you may have to wait some time to provide your testimony.
2. You must appear in person and testify as to matters that you have personally experienced or seen. (You cannot provide testimony for your neighbor, parent or anyone else; this is considered hearsay and cannot be considered by the committee.)
3. No letters or petitions can be accepted by the committee (unless the person who wrote the letter or the persons who signed the petition are present at the committee hearing and willing to testify).
4. Persons opposed to the license application are given the opportunity to testify first; supporters may testify after the opponents have finished.
5. When you are called to testify, you will be sworn in and asked to give your name, and address. (If your first and/or last names are uncommon please spell them.)
6. You may then provide testimony.
 - a. Include only information relating to the above license application.
 - b. Include only information you have personally witnessed or seen.
 - c. Provide concise and relevant information detailing how this business has affected or may affect the peaceful enjoyment of your neighborhood.
 - d. If by the time you have the opportunity to testify, the information you wish to share has already been provided to the committee, you may state that you agree with the previous testimony. Redundant or repetitive testimony will not assist the committee in making its recommendation.
7. After giving your testimony, the members of the Licenses Committee and the licensee may ask questions regarding the testimony you have given or other factors relating to the license application.
8. Business Competition is not a valid basis for denial or non-renewal of a license.
Please Note: If you have submitted an objection to the above application your objection cannot be considered by the committee unless you personally testify at the hearing.

| OCCUPANT | MAIL ADDRESS | CITY, STATE ZIP |
|------------------|------------------|---------------------|
| CURRENT OCCUPANT | 2627 W LINWAL LN | MILWAUKEE, WI 53209 |
| CURRENT OCCUPANT | 2619 W LINWAL LN | MILWAUKEE, WI 53209 |
| CURRENT OCCUPANT | 2623 W LINWAL LN | MILWAUKEE, WI 53209 |

Total Records: 3

Radius: 250.0 feet and Center of Circle: 4811 N Teutonia Av



BUSINESS LICENSE RENEWAL PLAN OF OPERATION

Office of the City Clerk License Division
200 E. Wells St. Room 105, Milwaukee, WI 53202

| Licenses to be Renewed | Renewal Fee(s) | |
|---|-------------------|--|
| Food Dealer - FOOD 7552 | \$1,325.00 | Expiration Date: 2/10/2018 File By Date: 12/7/2017 Date Late Fee Begins: 12/8/2017 Late Fee Amount: \$75.00 |
| Extended Hours - 24HRS 198222 | \$225.00 | |
| Filing Station - FILL 583 | \$250.00 | |
| Cigarette & Tobacco - CIG 1026215 | \$100.00 | |
| Weights & Measures - W&M 3187 21 RPM | \$1,260.00 | |
| Sidewalk Dining - | | |
| TOTAL DUE | \$3,160.00 | |

Legal Entity Name: PRINCE PETROLEUM, LLC

Premises Address: 4811 N TEUTONIA AV

Changes Since Last Application?

Are there any changes in your plans to address litter, noise, and/or security?
 No Yes If yes, describe: _____

Are there any changes to your floor plan and/or capacity?
 No Yes If yes, describe: _____ and submit a new floor plan

Are there any changes to the hours of operation (as listed on your current license)?
 No Yes If yes, describe: _____

Weights & Measures Licensees Only

Number/Type of Devices:
Retail Petroleum Meters = 21
Are there any changes to the number or types of devices? No Yes If yes, contact our office for further instructions.

Food Dealer Licensees Only

Your current food license includes the following business operations: Convenience Store, Filling Station, ALIGNMENT REQUEST PENDING
Are there any changes to your plan of operation (for example, adding processing, changing sales amount or complexity, etc.)? No Yes
If yes, you must complete a "Request to Modify Food Establishment/Food Operation Plan" which can be obtained at www.milwaukee.gov/licenses under "Forms and Related Information" or by contacting our office.

All Applicants: Signature(s)

Ay GJ KHP
Sole Proprietor, Partner, Agent or 20% or more Shareholder

Signature of additional partner or 20% or more Shareholder



CITY OF MILWAUKEE
OFFICE OF THE CITY CLERK

Wednesday, January 10, 2018

COMMITTEE MEETING NOTICE

AD 02

PATEL, Pushpak, Agent
Mitra Midwest Operations LLC
18900 Dallas Parkway #125

Dallas, TX 75287

You are requested to attend a hearing which is to be held in Room 301-B, Third Floor, City Hall on:

Tuesday, January 23, 2018 at 09:30 AM

Regarding: Your Extended Hours Establishments and Food Dealer License Applications as agent for "Mitra Midwest Operations LLC" for "Kentucky Fried Chicken" at 4  N 60th St.

There is a possibility that your application may be denied for one or more of the following reasons: The recommendation of the committee regarding the application shall be based on evidence presented at the hearing. Per MCO 85-4-4, unless otherwise specified in the code, probative evidence concerning non-renewal, suspension or revocation may include evidence of the following: failure of the applicant to meet municipal qualifications, pending charges against or the conviction of any felony, misdemeanor, municipal offense or other offense, the circumstances of which substantially relate to the circumstances of the particular licensed or permitted activity, by the applicant or by any employee or other agent of the applicant. If the activities of the applicant involve a licensed premises, whether the premises tends to facilitate a public or private nuisance or has been the source of congregations of persons which have resulted in any of the following: disturbance of the peace; illegal drug activity; public drunkenness; drinking in public; harassment of passers-by; gambling; prostitution; sale of stolen goods; public urination; theft; assaults; battery; acts of vandalism including graffiti, excessive littering, loitering, illegal parking, loud noise at times when the licensed premise is open for business; traffic violations; curfew violations; lewd conduct; display of materials harmful to minors, pursuant to s. 106-9.6; or any other factor which reasonably relates to the public health, safety and welfare, or failure to comply with the approved plan of operation. See attached police report or correspondence.

Notice for applicants with warrants or unpaid fines:

Proof of warrant satisfaction or payment of fines must be submitted at the hearing on the above date and time. Failure to comply with this requirement may result in a delay of the granting/denial of your application.

Failure to appear at this meeting may result in the denial of your license. Individual applicants must appear only in person or by an attorney. Corporate or Limited Liability applicants must appear only by the agent designated on the application or by an attorney. Partnership applicants must appear by a partner listed on the application or by an attorney. If you wish to do so and at your own expense, you may be accompanied by an attorney of your choosing to represent you at this hearing.

You will be given an opportunity to speak on behalf of the application and to respond and challenge any charges or reasons given for the denial. No petitions can be accepted by the committee, unless the people who signed the petition are present at the committee hearing and willing to testify. You may present witnesses under oath and you may also confront and cross-examine opposing witnesses under oath. If you have difficulty with the English language, you should bring an interpreter with you, at your expense, so that you can answer questions and participate in your hearing.

You may examine the application file at this office during regular business hours prior to the hearing date. Inquiries regarding this matter may be directed to the person whose signature appears below.

Limited parking for persons attending meetings in City Hall is available at reduced rates (5 hour limit) at the Milwaukee Center on the southwest corner of East Kilbourn and North Water Street. Parking tickets must be validated in the first floor information booth in City Hall.

PLEASE NOTE: Upon reasonable notice, efforts will be made to accommodate the needs of disabled individuals through sign language interpreters or other auxiliary aids. For additional information or to request this service, contact the Council Services Division ADA Coordinator at (414) 286-2998, Fax - (414) 286-3456, TDD - (414) 286-2025.

JIM OWCZARSKI, CITY CLERK

BY: _____

Jessica Celella
License Division Manager

If you have questions regarding this notice, please contact the License Division at (414) 286-2238.



CITY OF MILWAUKEE
OFFICE OF THE CITY CLERK

Wednesday, January 10, 2018

COMMITTEE MEETING NOTICE

AD 02

PATEL, Pushpak, Agent
Mitra Midwest Operations LLC
3812 Saddle Trail

Parker, TX 75002

You are requested to attend a hearing which is to be held in Room 301-B, Third Floor, City Hall on:

Tuesday, January 23, 2018 at 09:30 AM

Regarding: Your Extended Hours Establishments and Food Dealer License Applications as agent for "Mitra Midwest Operations LLC" for "Kentucky Fried Chicken" at 4400 N 60th St.

There is a possibility that your application may be denied for one or more of the following reasons: The recommendation of the committee regarding the application shall be based on evidence presented at the hearing. Per MCO 85-4-4, unless otherwise specified in the code, probative evidence concerning non-renewal, suspension or revocation may include evidence of the following: failure of the applicant to meet municipal qualifications, pending charges against or the conviction of any felony, misdemeanor, municipal offense or other offense, the circumstances of which substantially relate to the circumstances of the particular licensed or permitted activity, by the applicant or by any employee or other agent of the applicant. If the activities of the applicant involve a licensed premises, whether the premises tends to facilitate a public or private nuisance or has been the source of congregations of persons which have resulted in any of the following: disturbance of the peace; illegal drug activity; public drunkenness; drinking in public; harassment of passers-by; gambling; prostitution; sale of stolen goods; public urination; theft; assaults; battery; acts of vandalism including graffiti, excessive littering, loitering, illegal parking, loud noise at times when the licensed premise is open for business; traffic violations; curfew violations; lewd conduct; display of materials harmful to minors, pursuant to s. 106-9.6; or any other factor which reasonably relates to the public health, safety and welfare, or failure to comply with the approved plan of operation. See attached police report or correspondence.

Notice for applicants with warrants or unpaid fines: Proof of warrant satisfaction or payment of fines must be submitted at the hearing on the above date and time. Failure to comply with this requirement may result in a delay of the granting/denial of your application.

Failure to appear at this meeting may result in the denial of your license. Individual applicants must appear only in person or by an attorney. Corporate or Limited Liability applicants must appear only by the agent designated on the application or by an attorney. Partnership applicants must appear by a partner listed on the application or by an attorney. If you wish to do so and at your own expense, you may be accompanied by an attorney of your choosing to represent you at this hearing.

You will be given an opportunity to speak on behalf of the application and to respond and challenge any charges or reasons given for the denial. No petitions can be accepted by the committee, unless the people who signed the petition are present at the committee hearing and willing to testify. You may present witnesses under oath and you may also confront and cross-examine opposing witnesses under oath. If you have difficulty with the English language, you should bring an interpreter with you, at your expense, so that you can answer questions and participate in your hearing.

You may examine the application file at this office during regular business hours prior to the hearing date. Inquiries regarding this matter may be directed to the person whose signature appears below.

Limited parking for persons attending meetings in City Hall is available at reduced rates (5 hour limit) at the Milwaukee Center on the southwest corner of East Kilbourn and North Water Street. Parking tickets must be validated in the first floor information booth in City Hall.

PLEASE NOTE: Upon reasonable notice, efforts will be made to accommodate the needs of disabled individuals through sign language interpreters or other auxiliary aids. For additional information or to request this service, contact the Council Services Division ADA Coordinator at (414) 286-2998, Fax - (414) 286-3456, TDD - (414) 286-2025.

JIM OWCZARSKI, CITY CLERK

BY:

Jessica Ceella
License Division Manager

If you have questions regarding this notice, please contact the License Division at (414) 286-2238.

200 E. Wells Street, Room 105, City Hall, Milwaukee, WI 53202. www.milwaukee.gov/license
Phone: (414) 286-2238 Fax: (414) 286-3057 Email Address: License@milwaukee.gov



Wednesday, January 10, 2018



Notice of Public Hearing

PATEL, Pushpak, Agent
Kentucky Fried Chicken at 4400 N 60th St
Extended Hours Establishments and Food Dealer License Applications

Tuesday, January 23, 2018 at 9:30 AM

To whom it may concern:

The above application has been made by the above named applicant(s). This requires approval from the Licenses Committee and the Common Council of the City of Milwaukee. The hearing before the Licenses Committee will take place on 1/23/2018 at 9:30 AM, in Room 301-B, Third Floor, City Hall. If you wish, you may provide testimony at the hearing regarding the request; see below for further information. You are not required to attend the hearing. Once the Licenses Committee makes its recommendation, this recommendation is forwarded to the full Common Council for approval at its next regularly scheduled hearing. Please review the information below and if you have further questions regarding this process, please contact the License Division at (414) 286-2238.

Important details for those wishing to provide information for the Licenses Committee to consider when making its recommendation:

1. The license application is scheduled to be heard at the above time. Due to other hearings running longer than scheduled, you may have to wait some time to provide your testimony.
2. You must appear in person and testify as to matters that you have personally experienced or seen. (You cannot provide testimony for your neighbor, parent or anyone else; this is considered hearsay and cannot be considered by the committee.)
3. No letters or petitions can be accepted by the committee (unless the person who wrote the letter or the persons who signed the petition are present at the committee hearing and willing to testify).
4. Persons opposed to the license application are given the opportunity to testify first; supporters may testify after the opponents have finished.
5. When you are called to testify, you will be sworn in and asked to give your name, and address. (If your first and/or last names are uncommon please spell them.)
6. You may then provide testimony.
 - a. Include only information relating to the above license application.
 - b. Include only information you have personally witnessed or seen.
 - c. Provide concise and relevant information detailing how this business has affected or may affect the peaceful enjoyment of your neighborhood.
 - d. If by the time you have the opportunity to testify, the information you wish to share has already been provided to the committee, you may state that you agree with the previous testimony. Redundant or repetitive testimony will not assist the committee in making its recommendation.
7. After giving your testimony, the members of the Licenses Committee and the licensee may ask questions regarding the testimony you have given or other factors relating to the license application.
8. Business Competition is not a valid basis for denial or non-renewal of a license.
Please Note: If you have submitted an objection to the above application your objection cannot be considered by the committee unless you personally testify at the hearing.

| OCCUPANT | MAIL ADDRESS | CITY, STATE ZIP |
|------------------|--------------------|---------------------|
| CURRENT OCCUPANT | 4411A N 60TH ST | MILWAUKEE, WI 53218 |
| CURRENT OCCUPANT | 4418 N 58TH ST | MILWAUKEE, WI 53218 |
| CURRENT OCCUPANT | 6010 W MEDFORD AVE | MILWAUKEE, WI 53218 |
| CURRENT OCCUPANT | 4406 N 58TH ST | MILWAUKEE, WI 53218 |
| CURRENT OCCUPANT | 4400 N 58TH ST | MILWAUKEE, WI 53218 |
| CURRENT OCCUPANT | 4343A N 60TH ST | MILWAUKEE, WI 53216 |
| CURRENT OCCUPANT | 4412 N 58TH ST | MILWAUKEE, WI 53218 |
| CURRENT OCCUPANT | 6014 W MEDFORD AVE | MILWAUKEE, WI 53218 |

Total Records: 8

Radius: 250.0 feet and Center of Circle: 4400 N 60th St

1197



BUSINESS LICENSE PLAN OF OPERATION

ccl-busplan 9/26/16

Office of the City Clerk License Division
200 E. Wells St. Room 105, Milwaukee, WI 53202
(414) 286-2238 www.milwaukee.gov/license e-mail address: license@milwaukee.gov

1. Type of Business

Applying for: Extended Hours (12AM to 5AM) - If a food establishment, check all that apply: Delivery Drive Thru Dining Room
 Self Service Laundry Massage Establishment Filling Station
 Other (supplemental application for specific license also required)

Provide a detailed description of the type of business you plan on operating:

fast food restaurant

Do you have any experience operating this type of business? No Yes If yes, explain: We own 47 franchises

2. Business Operations

- a. Proposed Opening Date: 10/27/2017
- b. Is this premise under construction? No Yes If yes, list estimated completion date: _____
- c. Is this a franchise? No Yes
- d. Is this premises currently licensed? No Yes If yes, list type of license: Food,
- e. Is the current licensee operating? No Yes If no, list date closed: _____
- f. Do you have future plans for other businesses, licenses or permits at this location? No Yes
If yes, explain: _____
- g. Have you previously held an Extended Hours License in Milwaukee? No Yes
If yes, list address(es): _____
- h. Are other businesses operating in the same building? No Yes If yes, describe: _____

CITY OF MILWAUKEE
LICENSE DIVISION
2017 DEC 12 P 12:32

3. Litter & Noise

- a. How are grounds kept clean? Sweep Pressure Wash Pick Up Litter Other: _____
- b. How often will grounds be cleaned? Daily Weekly As Needed Monthly Other: _____
- c. Grounds cleaned by: Licensee Building Owner Employees Hired Maintenance Other: _____
- d. How are noise issues prevented and/or addressed? Security Manager approaches customer(s) Call Police
 Signs Posted Other: _____
- e. Will a sound amplification system be used? No Yes If yes, describe: AMBULANCE

4. Smoking & Sanitation

- a. Are there designated outdoor smoking areas? No Yes If yes, describe: _____
- b. Number of Garbage Cans: Inside: 12 Locations: Kitchen, lobby, packing RR2
Outside: 1 Locations: dumpsters NE corner of lot
- c. Is a crowd control barrier used? No Yes If yes, describe: _____
- d. How many restrooms are on the premises? 2
- e. Name of solid waste contractor: Advanced Disposal Waste Management Other: _____

5. Security

- a. Are there onsite parking spaces? No Yes If yes, indicate how many? 26 and describe the parking security plan: _____
- b. Is there a loading zone? No Yes If yes, describe the loading area security plan: South of building
- c. Will you have security personnel on premise? No Yes If yes, how many? _____ and answer the following:
 What are their responsibilities? _____
 Is security equipment used? No Yes If yes, describe _____
 List their licensing, certification, or training credentials _____
- d. Will there be security cameras? No Yes If yes, where? outside, inside
- e. Will searches/identification checks be done upon entry? No Yes If yes, describe _____

6. Percentage of Sales (must total 100%)

| | | | |
|----------------------------|---|--|-------------------------------|
| Alcohol _____% | Food <u>100</u> % | Secondhand Merchandise _____% | Precious Metals & Gems _____% |
| Entertainment _____% | Cigarettes _____% | Personal Services (such as tattoo, body piercing, salon, tailor, tanning, etc.) _____% | Other _____% |
| Pawnbroker Activity _____% | Salvaged Materials _____% (such as scrap metal) | | Describe: _____ |

7. Businesses/Licenses on the Premises (check all that apply):

Type 1

- Full Service Restaurant Cafe/Coffee Shop Deli or Fast Food Restaurant Private/Fraternal/Veterans Club
- Night Club Tavern Cocktail Lounge Teen Club
- Banquet Hall Sports Facility Bowling Alley
- Hotel/Motel : Number of Floors: _____ Rooming House: Number of Floors: _____
 Number of Rooms: _____ Number of Rooms: _____

Type 2

- Liquor Store Corner Store Supermarket Convenience Store
- Gas Station Amusement/Phonograph Distributor Recycling, Salvage or Towing
- Used Car Dealer Personal Service Establishment (such as tattoo business, hair salon, tailor, etc.) Recording Studio

What other licenses/permits will you hold at this location? (check all that apply)

- Occupancy Permit Cigarette & Tobacco Gas Station Extended Hours Class "B" Tavern Weights & Measures
- Secondhand Dealer Precious Metal & Gem Other: _____

8. Legal Capacity (only if a Type 1 premises in #7 above)

Capacity 40 (Call the Milwaukee Development Center at 414-286-8211 if you have questions.)

9. Premises Description

a. Identify all area(s) of the premises that will be used in operating this business (include areas used only for storage):

1st Floor 2nd Floor Basement Storage Patio Beer Garden Sidewalk Café Deck Rooftop

Other: Describe: _____

b. Describe Location: Major Thoroughfare Secondary Street Other: _____

c. Nearest Major Cross Street: Congress

d. Describe Building: Free Standing Building Strip Mall Other: _____

e. Describe Premises Structure: Single Story Multi-Story - # of Stories _____ Other: _____

f. Describe Surrounding Area: Commercial Residential Industrial Other: _____

g. Building Owner Name: ARC/Verit Phone Number: 800-606-3610

Business Owner Address: 2325 East Camelback Rd, #1100 Phoenix, AZ 85016

10. Hours of Operation & Customers

Will customers be entering the premises? No Yes

| Day of the Week | Proposed Hours of Operation: | | Estimated Number of Customers expected each day | Potential Age Range of Customers | Class B Tavern Applicant Only: Age Restriction (If none, write 'None') |
|-----------------|----------------------------------|-----------------------------------|---|----------------------------------|--|
| | Open Time (include a.m. or p.m.) | Close Time (include a.m. or p.m.) | | | |
| Sunday | 10:30 am | 2am | 380 | 18-90 | |
| Monday | 10:30 am | 2am | 380 | 18-90 | |
| Tuesday | 10:30 am | 2am | 380 | 18-90 | |
| Wednesday | 10:30 am | 2am | 400 | 18-90 | |
| Thursday | 10:30 am | 2am | 400 | 18-90 | |
| Friday | 10:30 am | 3am | 425 | 18-90 | |
| Saturday | 10:30 am | 3am | 425 | 18-90 | |

An Extended Hours Establishment License is required for any convenience store, filling station, personal service establishment (such as tattoo, body piercing, salon, tailor, tanning, etc.), recording studio or restaurant which is open between the hours of 12:00 a.m. and 5:00 a.m.

Alcohol Establishments Class A: 8:00 am to 9:00 pm Sunday thru Saturday
 Permitted Hours of Operation: Class B: 6:00 am to 2:00 am Sunday thru Thursday, 6:00 am to 2:30 am Friday & Saturday

Entertainment Closing Hours: Indoors: Alcohol beverage establishments: Same as alcohol license hours
 Non-alcohol establishments: 1:00 am Sunday thru Thursday, 1:30 am Friday & Saturday
 Outdoors: All establishments: 10:00 pm Sunday thru Thursday, 12:00 am Friday & Saturday
 (unless otherwise approved by the Common Council in licensee's plan of operation)

11. Signature(s)

 Sole Proprietor, Partner, Agent, or 20% or more Shareholder

 Signature of additional partner or 20% or more Shareholder

See Application Information for a complete list of all required application forms.



FOOD DEALER LICENSE PLAN OF OPERATION

cci-foodplan 8/1/17

OFFICE OF THE CITY CLERK, LICENSE DIVISION
CITY HALL, 200 E. WELLS ST, ROOM 105, MILWAUKEE, WI 53202
(414) 286-2238 • license@milwaukee.gov • www.milwaukee.gov/license

Legal Entity Name: MITRA MLOWEST OPERATIONS, LLC (KFC)
Premises Address: 4400 N. GO TH ST MILWAUKEE WI 53218

SECTION 1 TYPE OF BUSINESS

Type of application (check one): taking over a currently operating business starting a new business
Anticipated opening date? 10/27/2017

Check the type that best describes your business (check only one):
See Food Dealer License Information sheet for definitions.
 Restaurant Bed & Breakfast
 Retail Establishment Base for Food Peddler
If retail, will it be a convenience store? Yes No Base for Temporary/Seasonal Food Stand
(Convenience Stores have less than 5,000 sq ft of retail space, primary business is the sale of basic food items, and in addition sells household products)
In addition, will any wholesale business be done? Yes No
If yes, what percentage of the business will be wholesale? Less than 25% 25% or More (Contact DATCP)*
Will retail items be sold? No Yes If Yes, indicate percentage of food sales _____ %
Will restaurant items be sold? No* Yes If Yes, indicate percentage of food sales _____ %
** If you checked "25% or More" of the business will be wholesale and answered "No" to restaurant items being sold, do not continue completing this application. A City of Milwaukee License is not required. Contact DATCP only.*

2017 NOV - 9 P 5: 35
CITY OF MILWAUKEE
LICENSE DIVISION

SECTION 2 FOOD PROCESSING

Will any food processing be done? No Yes
Processing is defined as assembling, grinding, cutting, mixing, baking, coating, stuffing, packing, bottling, grilling, canning, extracting, fermenting, distilling, pickling, freezing, drying, smoking, or packaging.
If Yes, check the types of food items:
 SNACKS & BEVERAGES
includes, but is not limited to, ice cream/soft serve, lemonade, snow cones, coffee, espresso, cappuccino, tea, fruit juice, smoothies, candy, dispensed soda, fruit cups, bakery, cookies, popcorn, kettle corn, cotton candy, funnel cakes, fritters, tortilla chips w/ cheese
 MEALS
includes, but is not limited to, chicken, ribs, sandwiches, roasted corn, baked potatoes, hot dogs, brats, tacos, nachos w/ cheese and meat, French fries, cooked or deep fried vegetables/fruit, cooked cheese curds, corn dogs, egg rolls, salads

SECTION 3 FOOD REQUIRING TEMPERATURE CONTROL

Will any food that requires temperature control be sold? No Yes
(includes dairy products such as milk, cheese, and ice cream, fish, shellfish, meat, poultry)
If yes, list the types of food items: Chicken

SECTION 4 SHARED KITCHEN

Will you be sharing kitchen space with another operator?

- No If No, SKIP to Section 5
- Yes If Yes, check one:
- I will rent space from another operator ("Shared Kitchen Agreement" is required)
 - I will rent space to another operator (peddler/caterer)

SECTION 5 DETAILS OF OPERATION

Answer the following questions:

- Will you have seating on site for dining? No Yes
- Will you be doing any catering? No Yes
- Will you be doing any delivery? No Yes
- Will you have outdoor activities? No Yes
- If Yes to outdoor activities, check all that apply: Bar Cooking/Grilling Dining
- Will you have a drive thru window? No Yes
- If Yes to drive thru, are hours different from inside? No Yes
- If Yes, provide drive thru hours: _____
- Will any scales or barcode scanners be used? No Yes
- If Yes, a Weights & Measures application must be completed and a license obtained.

SECTION 6 ADDITIONAL SITES

Where will food be prepared and/or sold?

- At a single site
- At multiple sites (for example, a hotel with several dining rooms or bars) How many? _____
- If multiple sites, attach a Food Dealer Additional Site Addendum (ccl-foodadd) for each additional site.

SECTION 7 CONSTRUCTION OR CHANGES

Are you planning any construction, remodeling or equipment changes?

- No If No, SKIP to Section 8
- Yes If Yes, check all that apply:
- New construction of a building
 - Construction changes to an existing building
 - Renovation or remodeling
 - Equipment changes only (installation or replacement)

Provide a brief description of the changes: _____

Start date: _____

Name, Address & Phone Number of Architect: _____

Name, Address & Phone Number of Contractor: _____







SECTION 8 ALCOHOL BEVERAGES

Are you applying for an alcohol beverage license?

- No If No, SKIP to Section 9
- Yes If YES, if your food license is approved prior to the alcohol beverage license, when do you want the food license issued? Immediately At the same time as the alcohol license

SECTION 9 ACKNOWLEDGEMENTS & SIGNATURE

You must initial each item confirming your understanding:

-  I understand the Health Department must conduct an inspection and advise the License Division of their approval before the license may be issued.
-  I understand I must obtain an occupancy permit from the Department of Neighborhood Services and an inspection may be required. Neighborhood Services must advise the License Division of their approval before the license may be issued.
-  I understand the district alderperson will review and either approve or deny my application. If denied, I may appeal and be scheduled to appear before the Licenses Committee. The Licenses Committee will then make a recommendation to the Common Council. The Common Council must grant the license before it may be issued.
-  I understand proof of payment for all license fees must be on file in the License Division before the license may be issued.
-  I understand the license must be issued and posted in my establishment prior to opening for business.
-  I will not operate my food business until the license has been issued and posted in the establishment.

Signature of sole proprietor, partner, agent or 20% shareholder: 

Signature of additional partner(s): _____

| D | SIZE | PRICE |
|---|------|-------|
|---|------|-------|

Combos

Includes Individual Side & Medium Drink

| | | |
|------------------------------|--|--------|
| 2 Pc. Chicken - Combo | | \$6.29 |
| Doublicious Sandwich - Combo | | \$6.29 |
| Popcorn Nuggets - Combo | | \$5.76 |
| 2 Chicken Littles - Combo | | \$5.55 |
| Go Large Combo | | \$1.58 |

Nashville Hot Chicken

| | | |
|--|--|---------|
| 1 Pc. Basket (Chicken Breast, Coleslaw & Biscuit) | | \$5.76 |
| 2 Pc. Basket (Drumstick & Thigh, Coleslaw & Biscuit) | | \$5.76 |
| 8 Pc. Meal (8 Pc. Chicken, Large Mashed Potatoes & Gravy, Large Coleslaw & 4 Biscuits) | | \$23.09 |

Nashville Hot Tenders

| | | |
|--|--|---------|
| 3 Pc. Basket (3 Tenders, Coleslaw & Biscuit) | | \$5.76 |
| 12 Pc. Meal (12 Tenders, Large Mashed Potatoes & Gravy, Large Coleslaw & 4 Biscuits) | | \$23.09 |
| 24 Pc. Tailgate Meal (24 Tenders) | | \$31.49 |

Tenders & Popcorn Nuggets

Combo Includes Individual Side & Medium Drink

| | | |
|-------------------------|--------|---------|
| Chicken Tenders | 3 Pc. | \$4.19 |
| Chicken Tenders | 6 Pc. | \$7.34 |
| Chicken Tenders | 12 Pc. | \$13.64 |
| Chicken Tenders - Combo | 3 Pc. | \$6.29 |
| Popcorn Nuggets | Large | \$4.19 |

Kid's Meal

| | | |
|--|--|--------|
| Drumstick, 1 Chicken Little, 1 Tender, or Popcorn Nuggets, and Individual Side, and Applesauce, or Small Drink | | \$4.19 |
|--|--|--------|

| D | SIZE | PRICE |
|---|------|-------|
|---|------|-------|

Family Meals

| | | |
|---|--|---------|
| 8 Pc. Meal with 2 Large Sides & 4 Biscuits | | \$23.09 |
| 8 Pc. Chicken Only | | \$15.74 |
| 12 Pc. Meal with 3 Large Sides & 6 Biscuits | | \$31.49 |
| 12 Pc. Chicken Only | | \$21.51 |
| 16 Pc. Meal with 4 Large Sides & 8 Biscuits | | \$38.84 |
| 16 Pc. Chicken Only | | \$26.24 |
| Tenders & Wedges for 2 (6 Pc. Tenders, Large Wedges & 2 Sauces) | | \$10.49 |
| Tenders Meal (12 Pc. Tenders, 2 Large Sides, 4 Biscuits & 6 Sauces) | | \$20.99 |

Homestyle Sides

| | | |
|-------------------|------------|--------|
| Mashed Potatoes | Individual | \$2.09 |
| Mashed Potatoes | Large | \$3.98 |
| Potato Wedges | Individual | \$2.09 |
| Potato Wedges | Large | \$3.98 |
| Baked Beans | Individual | \$2.09 |
| Baked Beans | Large | \$3.98 |
| Cole Slaw | Individual | \$2.09 |
| Cole Slaw | Large | \$3.98 |
| Sweet Kernel Corn | Individual | \$2.09 |
| Sweet Kernel Corn | Large | \$3.98 |
| Green Beans | Individual | \$2.09 |
| Green Beans | Large | \$3.98 |
| Mac & Cheese | Individual | \$2.09 |
| Mac & Cheese | Large | \$3.98 |
| 2 Biscuits | | \$1.56 |

| D | SIZE | PRICE |
|---|------|-------|
|---|------|-------|

Colonel's Value

| | | |
|-----------------------------------|--|--------|
| 3 Hot Wings | | \$2.40 |
| 1 Chicken Little | | \$1.56 |
| Go Cup - Popcorn Nuggets & Wedges | | \$2.93 |
| Go Cup - Chicken Little & Wedges | | \$2.93 |
| Go Cup - 2 Tenders & Wedges | | \$2.93 |
| Go Cup - 3 Hot Wings & Wedges | | \$2.93 |

Drinks

| | | |
|---------------------|---------------|--------|
| Soft Drink | Medium | \$1.77 |
| Soft Drink | Large | \$2.09 |
| Aquafina Water | Bottle | \$1.77 |
| Iced Tea | 1/2 Gallon | \$2.61 |
| Lemonade | Medium | \$2.09 |
| Lemonade | 1/2 Gallon | \$3.66 |
| Strawberry Lemonade | Medium | \$2.40 |
| Strawberry Lemonade | 1/2 Gallon | \$4.19 |

\$20 Family Fill Up

Limited Time

| | |
|--|---------|
| Family Meal - 8 Pc. Chicken, 2 Large Mashed Potatoes, Large Gravy, Large Coleslaw & 4 Biscuits | \$21.00 |
|--|---------|

\$5 Fill Ups

| | |
|---|--------|
| 2 Pc. Drum & Thigh, Mashed Potatoes with Gravy, Biscuit, Medium Drink & Chocolate Chip Cookie | \$5.25 |
| 3 Pc. Tenders, Mashed Potatoes with Gravy, Biscuit, Medium Drink & Chocolate Chip Cookie | \$5.25 |

| D | SIZE | PRICE |
|---|------|--------|
| Chicken Breast, Mashed Potatoes with Gravy, Biscuit, Medium Drink & Chocolate Chip Cookie | | \$5.25 |
| Famous Bowl, Medium Drink & Chocolate Chip Cookie | | \$5.25 |
| Pot Pie, Medium Drink & Chocolate Chip Cookie | | \$5.25 |

Big Box Meals

Includes Individual Mashed Potatoes with Gravy, Coleslaw, Biscuit & Medium Drink

| | | |
|-----------------------------|--|--------|
| 3 Pc. Chicken Box | | \$8.39 |
| 2 Pc. Chicken & Popcorn Box | | \$8.39 |
| 3 Tenders & Popcorn Box | | \$8.39 |

Desserts

| | | |
|---------------------|--------|--------|
| Chocolate Chip Cake | | \$4.19 |
| Cookies | 3 Pc. | \$1.35 |
| Cookies | 12 Pc. | \$4.71 |

KFC was founded in 1930 in North Corbin, Kentucky, by the man who would become the face of the company, Harland Sanders. He became a huge hit in a few short years and was given the highest title of honor in Kentucky — Kentucky colonel. Since then he always known as Colonel Sanders.

Today, KFC is headquartered in Louisville, Kentucky, and it has nearly 19,000 locations in over 120 countries worldwide. It is the second largest fast food restaurant in sales after McDonalds. Although KFC prices are above the industry average, it has expanded its menu to include value items such as the Chicken Little sandwiches.



CITY OF MILWAUKEE
OFFICE OF THE CITY CLERK

Friday, January 19, 2018

COMMITTEE MEETING NOTICE

AD 02

WALTON, Shawntel, Agent
Runway Lounge LLC
8131 W Congress St #2
Milwaukee, WI 53218

You are requested to attend a hearing which is to be held in Room 301-B, Third Floor, City Hall on:

Tuesday, January 23, 2018 at 09:30 AM

Regarding: Your Class B Tavern and Public Entertainment Premises License Applications Requesting Disc Jockey, Poetry Readings, Comedy Acts, and 1 Pool Table as agent for "Runway Lounge LLC" for "Runway Lounge" at 9316 W APPLETON Av. 

There is a possibility that your application may be denied for one or more of the following reasons: The recommendation of the committee regarding the application shall be based on evidence presented at the hearing. Per MCO 85-2.7-4, probative evidence concerning whether or not a new license should be granted may be presented on the following subjects: whether or not the applicant meets the municipal requirements, the appropriateness of the location and premises where the licensed premises is to be located and whether use of the premises for the purposes or activities permitted by the license would tend to facilitate a public or private nuisance or create undesirable neighborhood problems such as disorderly patrons, unreasonably loud noise, litter, and excessive traffic and parking congestion. Probative evidence relating to these matters may be taken from the plan of operation submitted with the license application, if any, but shall not include the content of any music. Evidence regarding the fitness of the location of the premises to be maintained as the principal place of business, including but not limited to whether there is an overconcentration of businesses of the type for which the license is sought; whether the proposal is consistent with any pertinent neighborhood business or development plans, or the location's proximity to areas where children are typically present. The applicant's record in operating similarly licensed premises; and whether or not the applicant has been charged with or convicted of any felony, misdemeanor, municipal offense or other offense, the circumstances of which substantially relate to the activity to be permitted by the license being applied for or any other factor which reasonably relates to the public health, safety or welfare may also be considered. See attached police report or correspondence.

Notice for applicants with warrants or unpaid fines:

Proof of warrant satisfaction or payment of fines must be submitted at the hearing on the above date and time. Failure to comply with this requirement may result in a delay of the granting/denial of your application.

Failure to appear at this meeting may result in the denial of your license. Individual applicants must appear only in person or by an attorney. Corporate or Limited Liability applicants must appear only by the agent designated on the application or by an attorney. Partnership applicants must appear by a partner listed on the application or by an attorney. If you wish to do so and at your own expense, you may be accompanied by an attorney of your choosing to represent you at this hearing.

You will be given an opportunity to speak on behalf of the application and to respond and challenge any charges or reasons given for the denial. No petitions can be accepted by the committee, unless the people who signed the petition are present at the committee hearing and willing to testify. You may present witnesses under oath and you may also confront and cross-examine opposing witnesses under oath. If you have difficulty with the English language, you should bring an interpreter with you, at your expense, so that you can answer questions and participate in your hearing.

You may examine the application file at this office during regular business hours prior to the hearing date. Inquiries regarding this matter may be directed to the person whose signature appears below.

Limited parking for persons attending meetings in City Hall is available at reduced rates (5 hour limit) at the Milwaukee Center on the southwest corner of East Kilbourn and North Water Street. Parking tickets must be validated in the first floor information booth in City Hall.

PLEASE NOTE: Upon reasonable notice, efforts will be made to accommodate the needs of disabled individuals through sign language interpreters or other auxiliary aids. For additional information or to request this service, contact the Council Services Division ADA Coordinator at (414) 286-2998, Fax - (414) 286-3456, TDD - (414) 286-2025.

JIM OWCZARSKI, CITY CLERK

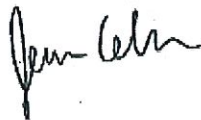

BY: _____

Jessica Celella

License Division Manager

If you have questions regarding this notice, please contact the License Division at (414) 286-2238.

Date: 11-22-17
Officer: Tracey Geniesse

City of Milwaukee Police Department
90-5-1.5 Crime Prevention Survey
Tavern Inspection

Name of Premise: Runway Lounge
Address: 9316 W Appleton Ave
Phone: None

Owner:
Owner address:
City State Zip:
Owner Phone:
Owner email:

Licensee/Agent: Shawntel R Walton
Home Address: 8131 W Congress Ave #2
City State Zip: Milwaukee, WI 53218
Phone: 414-215-8108
Email: shawntelrw@gmail.com

Preferred contact: Shawntel Walton

Location currently open: YES NO

Projected open date: 12/15/17

Day's open: S M T W Th F SA ALL

Hours of Operation: Sun: 11a-2a 24 hours Y N
Mon: 11a-2a
Tue: 11a-2a
Wed: 11a-2a
Thu: 11a-2a
Fri: 11a-230a
Sat: 11a-230a

Premise Type: Tavern/Bar
 Restaurant
 Other:

Licenses currently held:

Alcohol: Yes No Class: #:
Tobacco: Yes No #:
Food: Yes No #:
Occupancy: Yes No #:
Other: Yes No Type: #:
Other: Yes No Type: #:

Exterior Survey:

1. Is the area around the location clean? Yes No
2. What surrounds the location? (Check all the apply)
 - a. Park
 - b. School
 - c. Youth Center
 - d. Church
 - e. Tavern(s) If so, how many
 - f. Residential
 - g. Other businesses
 - h. Other: Teen Challenge alcohol/drug treatment center
3. Can you see from the outside of the location into the interior Yes No
4. Can you see the employees inside of the location from the outside Yes No
5. Are exterior windows free of signage Yes No
6. Is there a bus stop? Yes No
7. Is there a bus shelter? Yes No N/A
8. Street parking Yes No
9. Is there a parking lot Yes No
10. Is the parking lot clean? Yes No N/A
11. Is the parking lot well lit? Yes No N/A
12. Valet Parking Yes No
 - a. Will this lot have a guard? Yes No N/A
 - b. Will this lot have cameras? Yes No N/A
13. Are there areas where a person could conceal themselves Yes No
14. Is there exterior lighting? Yes No. Does it appears to be adequate Yes No
15. Exterior Payphone? Yes No
16. Are there No Loitering Signs posted? Yes No
17. Are there exterior security cameras Yes No How Many: 4
18. Are the address numbers prominently displayed and easy to see Yes No

Exterior Comments:

Camera Survey:

19. Does this location have security cameras? Yes No
20. Are they in working order? Yes No
21. What format are the cameras?
 - a. Color Yes No
 - b. Digital Yes No
 - c. VCR Yes No

d. Recorded Yes No

22. How long is footage stored for later viewing: 60 days

23. Are there exterior cameras Yes No How many: 4

24. Are there interior cameras Yes No How many: 8

25. Do all employees know how to retrieve recorded digital images/footage? Yes No

26. Cameras located in parking lot Yes No N/A How many

Camera Survey Comments: was not able to log onto the system at this time

Interior Survey:

27. What is the planned/posted capacity 144

28. What is the minimum number of employees that will be on premise 3

29. Is the storeowner willing to be a standing complainant regarding loitering? Yes No

a. If yes have them fill out the standing complaint form and give them two of the commercial signs Yes No

30. Is the interior of the location neat and clean? Yes No

31. Does an interior camera face the entrance/exit? Yes No

32. Are emergency and non-emergency numbers posted near the phone? Yes No

33. Does the owner know how to contact their police district directly? Yes No

a. Did you provide a district contact guide to the owner? Yes No

Interior Comments:

Security

34. How many security personnel are going to be employed: N/A

35. How will they be deployed: Interior 2 Exterior1 N/A

36. What days will they be deployed Mon Tue Wed Thu Fri Sat Sun ALL

37. Will the security be managed by business or contracted

38. Will they be armed Yes No N/A

39. What type of security measures will be used: N/A

Wanding/metal detector

ID Scanner

Dress Code

Cover Charge special events

Age restriction if recommended by city

Other

40. When at capacity, how will the overflow crowd be managed?

41. Will a guard monitor the overflow crowd at all times? Yes No

Security Comments: They were not sure what days and hours security will be deployed and if they will be armed or unarmed

ADDITIONAL COMMENTS/RECOMMENDATIONS:

MPD made the following recommendations: Contact District Four CLO'S with a calendar of events, and to keep an open line of communication. Be sure to use a counter, not to go over capacity. Will change music 30-45 min prior to closing. If they are wanding, be sure to wand consistently and wand everyone.

Date: 11-22-17
Officer: Tracey Geniesse

City of Milwaukee Police Department
90-5-1.5 Crime Prevention Survey
Tavern Inspection

Name of Premise: Runway Lounge
Address: 9316 W Appleton Ave
Phone: None

Owner:
Owner address:
City State Zip:
Owner Phone:
Owner email:

Licensee/Agent: Shawntel R Walton
Home Address: 8131 W Congress Ave #2
City State Zip: Milwaukee, WI 53218
Phone: 414-215-8108
Email: shawntelrw@gmail.com

Preferred contact: Shawntel Walton

Location currently open: YES NO

Projected open date: 12/15/17

Day's open: S M T W Th F SA ALL

Hours of Operation: Sun: 11a-2a 24 hours Y N
Mon: 11a-2a
Tue: 11a-2a
Wed: 11a-2a
Thu: 11a-2a
Fri: 11a-230a
Sat: 11a-230a

Premise Type: Tavern/Bar
 Restaurant
 Other:

Licenses currently held:

Alcohol: Yes No Class: #:
Tobacco: Yes No #:
Food: Yes No #:
Occupancy: Yes No #:
Other: Yes No Type: #:
Other: Yes No Type: #:

Exterior Survey:

1. Is the area around the location clean? Yes No
2. What surrounds the location? (Check all the apply)
 - a. Park
 - b. School
 - c. Youth Center
 - d. Church
 - e. Tavern(s) If so, how many
 - f. Residential
 - g. Other businesses
 - h. Other: Teen Challenge alcohol/drug treatment center
3. Can you see from the outside of the location into the interior Yes No
4. Can you see the employees inside of the location from the outside Yes No
5. Are exterior windows free of signage Yes No
6. Is there a bus stop? Yes No
7. Is there a bus shelter? Yes No N/A
8. Street parking Yes No
9. Is there a parking lot Yes No
10. Is the parking lot clean? Yes No N/A
11. Is the parking lot well lit? Yes No N/A
12. Valet Parking Yes No
 - a. Will this lot have a guard? Yes No N/A
 - b. Will this lot have cameras? Yes No N/A
13. Are there areas where a person could conceal themselves Yes No
14. Is there exterior lighting? Yes No. Does it appears to be adequate Yes No
15. Exterior Payphone? Yes No
16. Are there No Loitering Signs posted? Yes No
17. Are there exterior security cameras Yes No How Many: 4
18. Are the address numbers prominently displayed and easy to see Yes No

Exterior Comments:

Camera Survey:

19. Does this location have security cameras? Yes No
20. Are they in working order? Yes No
21. What format are the cameras?
 - a. Color Yes No
 - b. Digital Yes No
 - c. VCR Yes No

d. Recorded Yes No

22. How long is footage stored for later viewing: 60 days

23. Are there exterior cameras Yes No How many: 4

24. Are there interior cameras Yes No How many: 8

25. Do all employees know how to retrieve recorded digital images/footage? Yes No

26. Cameras located in parking lot Yes No N/A How many

Camera Survey Comments: was not able to log onto the system at this time

Interior Survey:

27. What is the planned/posted capacity 144

28. What is the minimum number of employees that will be on premise 3

29. Is the storeowner willing to be a standing complainant regarding loitering? Yes No

a. If yes have them fill out the standing complaint form and give them two of the commercial signs Yes No

30. Is the interior of the location neat and clean? Yes No

31. Does an interior camera face the entrance/exit? Yes No

32. Are emergency and non-emergency numbers posted near the phone? Yes No

33. Does the owner know how to contact their police district directly? Yes No

a. Did you provide a district contact guide to the owner? Yes No

Interior Comments:

Security

34. How many security personnel are going to be employed: N/A

35. How will they be deployed: Interior 2 Exterior1 N/A

36. What days will they be deployed Mon Tue Wed Thu Fri Sat Sun ALL

37. Will the security be managed by business or contracted

38. Will they be armed Yes No N/A

39. What type of security measures will be used: N/A

Wandering/metal detector

ID Scanner

Dress Code

Cover Charge special events

Age restriction if recommended by city

Other

40. When at capacity, how will the overflow crowd be managed?

41. Will a guard monitor the overflow crowd at all times? Yes No

Security Comments: They were not sure what days and hours security will be deployed and if they will be armed or unarmed

ADDITIONAL COMMENTS/RECOMMENDATIONS:

MPD made the following recommendations: Contact District Four CLO"S with a calendar of events, and to keep an open line of communication. Be sure to use a counter, not to go over capacity. Will change music 30-45 min prior to closing. If they are wandering, be sure to wand consistently and wand everyone.

Alcohol concentration for 9316 W Appleton Av.

City of Milwaukee, Wisconsin

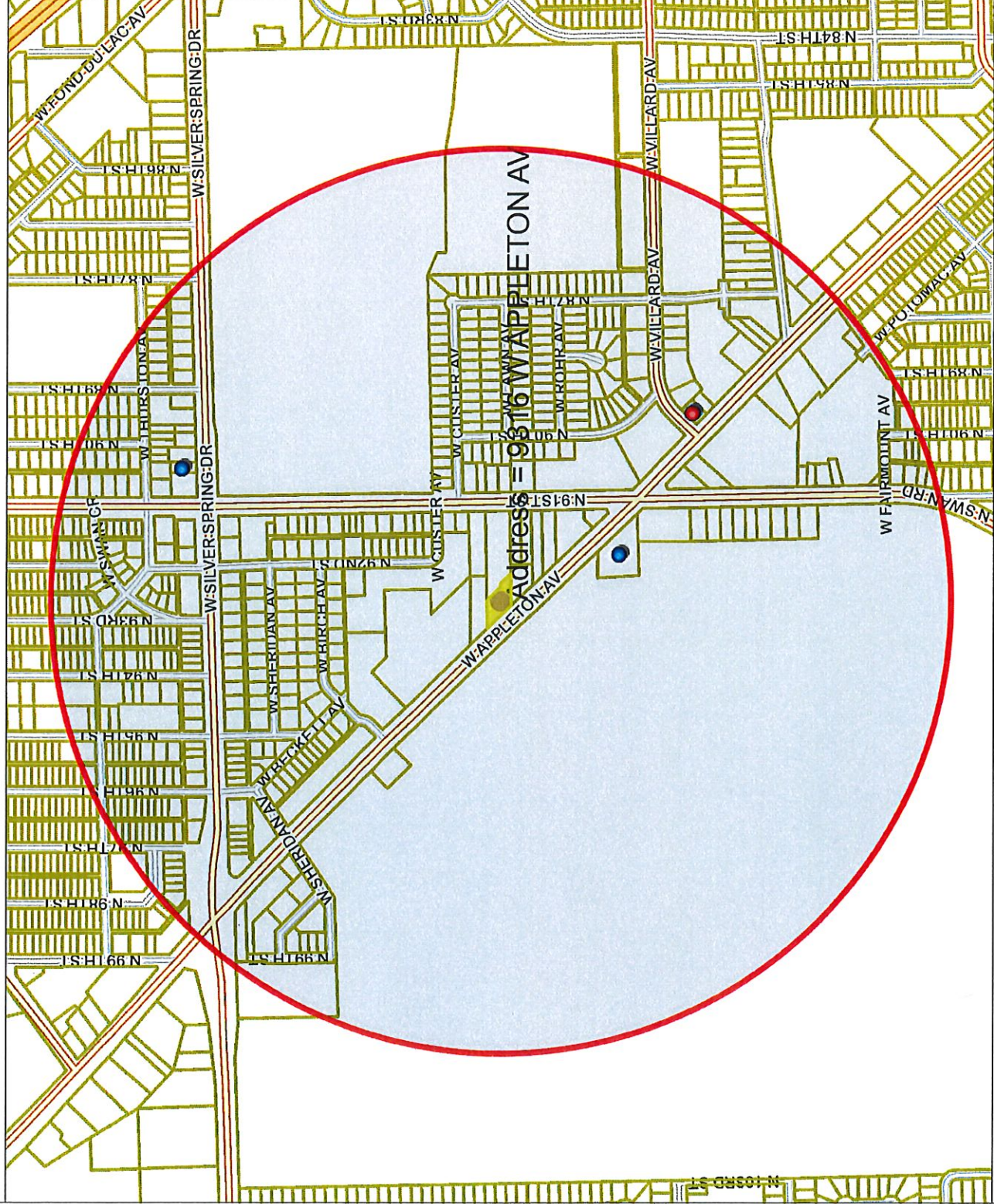

Address = 9316 W APPLETON AV

- Legend -

- Milwaukee parcels
- Street names 10,000
- City limits
- Freeways 15,000
- Freeways
- Exit ramps
- Entry ramps
- Ramps
- Major streets 10,000
- Streets 10,000
- Street names 10,000
- Alcohol licenses**
 - Class A intoxicating liquor
 - Class A fermented malt beverage
 - Class A liquor and malt
 - Class B fermented malt beverage
 - Class B tavern
 - Class C wine retailer

- Notes -

Licensed alcohol beverage establishments within a .5 mile radius centered on 9316 W Appleton Av, November 14, 2017.



Department of Administration - ITMD



Map Scale: 1: 10,000

Disclaimer
11/14/2017

© City of Milwaukee, Wisconsin
Map Milwaukee: Property Information

| Licensed alcohol beverage establishments within a .5 mile radius centered on 9316 W Appleton Av, November 14, 2017. | | | | | | | | | |
|---|-----------------------|------------------------|---------------------------------------|--------------------|----------------|-------------------------|------------------|-------------|-------|
| License Summary | | | | | | | | | Total |
| Class A Malt & Class A Liquor License | | | | | | | | | 1 |
| Class B Tavern License | | | | | | | | | 2 |
| | | | | | | | | Grand Total | 3 |
| Legal entity | Trade name | Licensor | Licensor name | Licensor type name | Total capacity | Address | Expiration date | | |
| WESTSIDE LIQUOR | WESTSIDE LIQUOR | ZUHEIR N ABDALLAH, SP | Class A Malt & Class A Liquor License | | | 8948 W APPLETON AV | 2/7/2018 18:00 | | |
| Goodson Ventures LLC | Courtside Bar & Grill | ERNESTINE GOODSON, Agt | Class B Tavern License | | | 9012 W Silver Spring DR | 10/15/2018 19:00 | | |
| EL GRECO, INC | EL GRECO RESTAURANT | GUS GUATIS, Agt | Class B Tavern License | | 300 | 9143 W APPLETON AV | 2/7/2018 18:00 | | |



Friday, January 19, 2018

Licenses Committee Notice of Hearing

Universal Estates
25502 Hickory Valley Ln
Spring, TX 77373

Date: 1/23/2018
Time: 09:30 AM
Location: Room 301-B, Third Floor, City Hall

The Licenses Committee will consider the following license application:

Class B Tavern and Public Entertainment Premises License Applications
Requesting Disc Jockey, Poetry Readings, Comedy Acts, and 1 Pool Table
WALTON, Shawntel, Agent
Runway Lounge at 9316 W APPLETON Av

Please note this application may be recommended for denial based on fitness of the location due to concentration of alcohol beverage outlets in the area. If the application is denied for this reason, no other application for an alcohol beverage license for this location shall be recommended for approval by the Licenses Committee within three years of the date of denial unless the applicant has demonstrated a change of circumstances since the prior denial.

If you have any questions, please call (414) 286-2238.





Friday, January 19, 2018

Licenses Committee Notice of Hearing

Mario Kimbrough
6425 Westheimer Rd, #218
Houston, TX 77057

Date: 1/23/2018
Time: 09:30 AM
Location: Room 301-B, Third Floor, City Hall

The Licenses Committee will consider the following license application:

Class B Tavern and Public Entertainment Premises License Applications
Requesting Disc Jockey, Poetry Readings, Comedy Acts, and 1 Pool Table
WALTON, Shawntel, Agent
Runway Lounge at 9316 W APPLETON Av

Please note this application may be recommended for denial based on fitness of the location due to concentration of alcohol beverage outlets in the area. If the application is denied for this reason, no other application for an alcohol beverage license for this location shall be recommended for approval by the Licenses Committee within three years of the date of denial unless the applicant has demonstrated a change of circumstances since the prior denial.

If you have any questions, please call (414) 286-2238.





Friday, January 19, 2018



Notice of Public Hearing

WALTON, Shawntel, Agent

Runway Lounge at 9316 W APPLETON Av

Class B Tavern and Public Entertainment Premises License Applications Requesting Disc Jockey,
Poetry Readings, Comedy Acts, and 1 Pool Table

Tuesday, January 23, 2018 at 9:30 AM

To whom it may concern:

The above application has been made by the above named applicant(s). This requires approval from the Licenses Committee and the Common Council of the City of Milwaukee. The hearing before the Licenses Committee will take place on 1/23/2018 at 9:30 AM, in Room 301-B, Third Floor, City Hall. If you wish, you may provide testimony at the hearing regarding the request; see below for further information. You are not required to attend the hearing. Once the Licenses Committee makes its recommendation, this recommendation is forwarded to the full Common Council for approval at its next regularly scheduled hearing. Please review the information below and if you have further questions regarding this process, please contact the License Division at (414) 286-2238.

Important details for those wishing to provide information for the Licenses Committee to consider when making its recommendation:

1. The license application is scheduled to be heard at the above time. Due to other hearings running longer than scheduled, you may have to wait some time to provide your testimony.
2. You must appear in person and testify as to matters that you have personally experienced or seen. (You cannot provide testimony for your neighbor, parent or anyone else; this is considered hearsay and cannot be considered by the committee.)
3. No letters or petitions can be accepted by the committee (unless the person who wrote the letter or the persons who signed the petition are present at the committee hearing and willing to testify).
4. Persons opposed to the license application are given the opportunity to testify first; supporters may testify after the opponents have finished.
5. When you are called to testify, you will be sworn in and asked to give your name, and address. (If your first and/or last names are uncommon please spell them.)
6. You may then provide testimony.
 - a. Include only information relating to the above license application.
 - b. Include only information you have personally witnessed or seen.
 - c. Provide concise and relevant information detailing how this business has affected or may affect the peaceful enjoyment of your neighborhood.
 - d. If by the time you have the opportunity to testify, the information you wish to share has already been provided to the committee, you may state that you agree with the previous testimony. Redundant or repetitive testimony will not assist the committee in making its recommendation.
7. After giving your testimony, the members of the Licenses Committee and the licensee may ask questions regarding the testimony you have given or other factors relating to the license application.
8. Business Competition is not a valid basis for denial or non-renewal of a license.
Please Note: If you have submitted an objection to the above application your objection cannot be considered by the committee unless you personally testify at the hearing.

| OCCUPANT | MAIL ADDRESS | CITY, STATE ZIP |
|------------------|---------------------|---------------------|
| CURRENT OCCUPANT | 5443 N 92ND ST A | MILWAUKEE, WI 53225 |
| CURRENT OCCUPANT | 9137 W CUSTER AVE | MILWAUKEE, WI 53225 |
| CURRENT OCCUPANT | 9145 W CUSTER AVE | MILWAUKEE, WI 53225 |
| CURRENT OCCUPANT | 9149 W CUSTER AVE 1 | MILWAUKEE, WI 53225 |
| CURRENT OCCUPANT | 9151 W CUSTER AVE 7 | MILWAUKEE, WI 53225 |
| CURRENT OCCUPANT | 5407 N 92ND ST | MILWAUKEE, WI 53225 |
| CURRENT OCCUPANT | 5435 N 92ND ST F | MILWAUKEE, WI 53225 |
| CURRENT OCCUPANT | 5443 N 92ND ST B | MILWAUKEE, WI 53225 |
| CURRENT OCCUPANT | 5351 N 91ST ST 102 | MILWAUKEE, WI 53225 |
| CURRENT OCCUPANT | 5351 N 91ST ST 201 | MILWAUKEE, WI 53225 |
| CURRENT OCCUPANT | 5351 N 91ST ST 203 | MILWAUKEE, WI 53225 |
| CURRENT OCCUPANT | 5321 N 91ST ST 3 | MILWAUKEE, WI 53225 |
| CURRENT OCCUPANT | 5401 N 92ND ST C | MILWAUKEE, WI 53225 |
| CURRENT OCCUPANT | 9143 W CUSTER AVE | MILWAUKEE, WI 53225 |
| CURRENT OCCUPANT | 9151 W CUSTER AVE 6 | MILWAUKEE, WI 53225 |
| CURRENT OCCUPANT | 5423 N 92ND ST F | MILWAUKEE, WI 53225 |
| CURRENT OCCUPANT | 5429 N 92ND ST B | MILWAUKEE, WI 53225 |
| CURRENT OCCUPANT | 5349 N 91ST ST 202 | MILWAUKEE, WI 53225 |
| CURRENT OCCUPANT | 5349 N 91ST ST 102 | MILWAUKEE, WI 53225 |
| CURRENT OCCUPANT | 5321 N 91ST ST 2 | MILWAUKEE, WI 53225 |
| CURRENT OCCUPANT | 5417 N 92ND ST A | MILWAUKEE, WI 53223 |
| CURRENT OCCUPANT | 9127 W CUSTER AVE | MILWAUKEE, WI 53225 |
| CURRENT OCCUPANT | 9139 W CUSTER AVE | MILWAUKEE, WI 53225 |
| CURRENT OCCUPANT | 9149 W CUSTER AVE 6 | MILWAUKEE, WI 53225 |
| CURRENT OCCUPANT | 9151 W CUSTER AVE 8 | MILWAUKEE, WI 53225 |
| CURRENT OCCUPANT | 5401 N 92ND ST B | MILWAUKEE, WI 53225 |
| CURRENT OCCUPANT | 5413 N 92ND ST | MILWAUKEE, WI 53225 |
| CURRENT OCCUPANT | 5429 N 92ND ST E | MILWAUKEE, WI 53225 |
| CURRENT OCCUPANT | 9316 W APPLETON AVE | MILWAUKEE, WI 53225 |
| CURRENT OCCUPANT | 5351 N 91ST ST 104 | MILWAUKEE, WI 53225 |
| CURRENT OCCUPANT | 5351 N 91ST ST 204 | MILWAUKEE, WI 53225 |
| CURRENT OCCUPANT | 5319 N 91ST ST 2 | MILWAUKEE, WI 53225 |
| CURRENT OCCUPANT | 9151 W CUSTER AVE 4 | MILWAUKEE, WI 53225 |
| CURRENT OCCUPANT | 5415 N 92ND ST | MILWAUKEE, WI 53225 |
| CURRENT OCCUPANT | 5435 N 92ND ST C | MILWAUKEE, WI 53225 |
| CURRENT OCCUPANT | 9129 W CUSTER AVE | MILWAUKEE, WI 53225 |
| CURRENT OCCUPANT | 9131 W CUSTER AVE | MILWAUKEE, WI 53225 |
| CURRENT OCCUPANT | 9141 W CUSTER AVE | MILWAUKEE, WI 53225 |
| CURRENT OCCUPANT | 9149 W CUSTER AVE 2 | MILWAUKEE, WI 53225 |
| CURRENT OCCUPANT | 9151 W CUSTER AVE 1 | MILWAUKEE, WI 53225 |
| CURRENT OCCUPANT | 9151 W CUSTER AVE 5 | MILWAUKEE, WI 53225 |
| CURRENT OCCUPANT | 5401 N 92ND ST | MILWAUKEE, WI 53225 |
| CURRENT OCCUPANT | 5403 N 92ND ST | MILWAUKEE, WI 53225 |
| CURRENT OCCUPANT | 5411 N 92ND ST | MILWAUKEE, WI 53225 |
| CURRENT OCCUPANT | 5423 N 92ND ST G | MILWAUKEE, WI 53225 |
| CURRENT OCCUPANT | 5423 N 92ND ST C | MILWAUKEE, WI 53225 |

| | | |
|------------------|---------------------|---------------------|
| CURRENT OCCUPANT | 5435 N 92ND ST E | MILWAUKEE, WI 53225 |
| CURRENT OCCUPANT | 5349 N 91ST ST 204 | MILWAUKEE, WI 53225 |
| CURRENT OCCUPANT | 5349 N 91ST ST 104 | MILWAUKEE, WI 53225 |
| CURRENT OCCUPANT | 5321 N 91ST ST 4 | MILWAUKEE, WI 53225 |
| CURRENT OCCUPANT | 9121 W CUSTER AVE | MILWAUKEE, WI 53225 |
| CURRENT OCCUPANT | 5445 N 92ND ST | MILWAUKEE, WI 53225 |
| CURRENT OCCUPANT | 9147 W CUSTER AVE | MILWAUKEE, WI 53225 |
| CURRENT OCCUPANT | 9149 W CUSTER AVE 5 | MILWAUKEE, WI 53225 |
| CURRENT OCCUPANT | 5405 N 92ND ST | MILWAUKEE, WI 53225 |
| CURRENT OCCUPANT | 5409 N 92ND ST | MILWAUKEE, WI 53225 |
| CURRENT OCCUPANT | 5429 N 92ND ST C | MILWAUKEE, WI 53225 |
| CURRENT OCCUPANT | 5435 N 92ND ST D | MILWAUKEE, WI 53225 |
| CURRENT OCCUPANT | 5443 N 92ND ST D | MILWAUKEE, WI 53225 |
| CURRENT OCCUPANT | 5349 N 91ST ST 201 | MILWAUKEE, WI 53225 |
| CURRENT OCCUPANT | 5351 N 91ST ST 101 | MILWAUKEE, WI 53225 |
| CURRENT OCCUPANT | 9135 W CUSTER AVE | MILWAUKEE, WI 53225 |
| CURRENT OCCUPANT | 5401 N 92ND ST A | MILWAUKEE, WI 53225 |
| CURRENT OCCUPANT | 9149 W CUSTER AVE 8 | MILWAUKEE, WI 53225 |
| CURRENT OCCUPANT | 5429 N 92ND ST A | MILWAUKEE, WI 53225 |
| CURRENT OCCUPANT | 5443 N 92ND ST C | MILWAUKEE, WI 53225 |
| CURRENT OCCUPANT | 5349 N 91ST ST 101 | MILWAUKEE, WI 53225 |
| CURRENT OCCUPANT | 5319 N 91ST ST 4 | MILWAUKEE, WI 53225 |
| CURRENT OCCUPANT | 5319 N 91ST ST 3 | MILWAUKEE, WI 53225 |
| CURRENT OCCUPANT | 9149 W CUSTER AVE 7 | MILWAUKEE, WI 53225 |
| CURRENT OCCUPANT | 5423 N 92ND ST D | MILWAUKEE, WI 53225 |
| CURRENT OCCUPANT | 5435 N 92ND ST B | MILWAUKEE, WI 53225 |
| CURRENT OCCUPANT | 9133 W CUSTER AVE | MILWAUKEE, WI 53225 |
| CURRENT OCCUPANT | 9149 W CUSTER AVE 3 | MILWAUKEE, WI 53225 |
| CURRENT OCCUPANT | 9151 W CUSTER AVE 2 | MILWAUKEE, WI 53225 |
| CURRENT OCCUPANT | 9151 W CUSTER AVE 3 | MILWAUKEE, WI 53225 |
| CURRENT OCCUPANT | 5417 N 92ND ST B | MILWAUKEE, WI 53223 |
| CURRENT OCCUPANT | 5417 N 92ND ST | MILWAUKEE, WI 53223 |
| CURRENT OCCUPANT | 5423 N 92ND ST A | MILWAUKEE, WI 53225 |
| CURRENT OCCUPANT | 5423 N 92ND ST E | MILWAUKEE, WI 53225 |
| CURRENT OCCUPANT | 5435 N 92ND ST A | MILWAUKEE, WI 53225 |
| CURRENT OCCUPANT | 5435 N 92ND ST G | MILWAUKEE, WI 53225 |
| CURRENT OCCUPANT | 5349 N 91ST ST 203 | MILWAUKEE, WI 53225 |
| CURRENT OCCUPANT | 5349 N 91ST ST 103 | MILWAUKEE, WI 53225 |
| CURRENT OCCUPANT | 5321 N 91ST ST 1 | MILWAUKEE, WI 53225 |
| CURRENT OCCUPANT | 9123 W CUSTER AVE | MILWAUKEE, WI 53225 |
| CURRENT OCCUPANT | 9125 W CUSTER AVE | MILWAUKEE, WI 53225 |
| CURRENT OCCUPANT | 9149 W CUSTER AVE 4 | MILWAUKEE, WI 53225 |
| CURRENT OCCUPANT | 5417 N 92ND ST C | MILWAUKEE, WI 53223 |
| CURRENT OCCUPANT | 5423 N 92ND ST B | MILWAUKEE, WI 53225 |
| CURRENT OCCUPANT | 5429 N 92ND ST D | MILWAUKEE, WI 53225 |
| CURRENT OCCUPANT | 5443 N 92ND ST E | MILWAUKEE, WI 53225 |
| CURRENT OCCUPANT | 5351 N 91ST ST 202 | MILWAUKEE, WI 53225 |

| | | |
|------------------|--------------------|---------------------|
| CURRENT OCCUPANT | 5351 N 91ST ST 103 | MILWAUKEE, WI 53225 |
| CURRENT OCCUPANT | 5319 N 91ST ST 1 | MILWAUKEE, WI 53225 |

Total Records: 95

Radius: 250.0 feet and Center of Circle: 9316 W Appleton Ave



BUSINESS LICENSE PLAN OF OPERATION

ccl-busplan 9/26/16

Office of the City Clerk License Division
200 E. Wells St. Room 105, Milwaukee, WI 53202
(414) 286-2238 www.milwaukee.gov/license e-mail address: license@milwaukee.gov

1. Type of Business

Applying for: Extended Hours (12AM to 5AM) - If a food establishment, check all that apply: Delivery Drive Thru Dining Room
 Self Service Laundry Massage Establishment Filling Station
 Other (supplemental application for specific license also required) bar / lounge

Provide a detailed description of the type of business you plan on operating:

bar / lounge

Do you have any experience operating this type of business? No Yes If yes, explain:

2. Business Operations

- a. Proposed Opening Date: December 22nd
- b. Is this premise under construction? No Yes If yes, list estimated completion date: _____
- c. Is this a franchise? No Yes
- d. Is this premises currently licensed? No Yes If yes, list type of license: _____
- e. Is the current licensee operating? No Yes If no, list date closed: 7/2017
- f. Do you have future plans for other businesses, licenses or permits at this location? No Yes
If yes, explain: _____
- g. Have you previously held an Extended Hours License in Milwaukee? No Yes
If yes, list address(es): _____
- h. Are other businesses operating in the same building? No Yes If yes, describe: _____

3. Litter & Noise

- a. How are grounds kept clean? Sweep Pressure Wash Pick Up Litter Other: _____
- b. How often will grounds be cleaned? Daily Weekly As Needed Monthly Other: _____
- c. Grounds cleaned by: Licensee Building Owner Employees Hired Maintenance Other: _____
- d. How are noise issues prevented and/or addressed? Security Manager approaches customer(s) Call Police
 Signs Posted Other: _____
- e. Will a sound amplification system be used? No Yes If yes, describe: _____

4. Smoking & Sanitation

- a. Are there designated outdoor smoking areas? No Yes If yes, describe: Patio In front
- b. Number of Garbage Cans: Inside: 8 Locations: Restrooms, behind Bar, 4 corners
Outside: 3 Locations: parking Lot
- c. Is a crowd control barrier used? No Yes If yes, describe: _____
- d. How many restrooms are on the premises? 2
- e. Name of solid waste contractor: Advanced Disposal Waste Management Other: _____

5. Security

- a. Are there onsite parking spaces? No Yes If yes, indicate how many? 50 spaces and describe the parking security plan: lot security patrol
- b. Is there a loading zone? No Yes If yes, describe the loading area security plan: _____
- c. Will you have security personnel on premise? No Yes If yes, how many: 1-3 and answer the following:
 What are their responsibilities? Id check, ~~patrol~~ searches, lot patrol
 Is security equipment used? No Yes If yes, describe Id scanner, metal detector
 List their licensing, certification, or training credentials _____
- d. Will there be security cameras? No Yes If yes, where? 4 cameras outside 12 inside
- e. Will searches/identification checks be done upon entry? No Yes If yes, describe If needed

6. Percentage of Sales (must total 100%)

| | | | |
|-----------------------------|--|---|----------------------------------|
| Alcohol <u>100</u> % | Food _____ % | Secondhand Merchandise _____ % | Precious Metals & Gems _____ % |
| Entertainment _____ % | Cigarettes _____ % | Personal Services (such as tattoo, body piercing, salon, tailor, tanning, etc.) _____ % | Other _____ % Describe: _____ |
| Pawnbroker Activity _____ % | Salvaged Materials (such as scrap metal) _____ % | | |

7. Businesses/Licenses on the Premises (check all that apply):

Type 1

- Full Service Restaurant Cafe/Coffee Shop Deli or Fast Food Restaurant Private/Fraternal/Veterans Club
- Night Club Tavern Cocktail Lounge Teen Club
- Banquet Hall Sports Facility Bowling Alley
- Hotel/Motel: Number of Floors: _____ Rooming House: Number of Floors: _____
 Number of Rooms: _____ Number of Rooms: _____

Type 2

- Liquor Store Corner Store Supermarket Convenience Store
- Gas Station Amusement/Phonograph Distributor Recycling, Salvage or Towing
- Used Car Dealer Personal Service Establishment (such as tattoo business, hair salon, tailor, etc.) Recording Studio

What other licenses/permits will you hold at this location? (check all that apply)

- Occupancy Permit Cigarette & Tobacco Gas Station Extended Hours Class "B" Tavern Weights & Measures
- Secondhand Dealer Precious Metal & Gem Other: _____

8. Legal Capacity (only if a Type 1 premises in #7 above)

Capacity 144 (Call the Milwaukee Development Center at 414-286-8211 if you have questions.)

9. Premises Description

- a. Identify all area(s) of the premises that will be used in operating this business (include areas used only for storage):
 1st Floor 2nd Floor Basement Storage Patio Beer Garden Sidewalk Café Deck Rooftop
 Other: Describe: _____
- b. Describe Location: Major Thoroughfare Secondary Street Other: _____
- c. Nearest Major Cross Street: 91st
- d. Describe Building: Free Standing Building Strip Mall Other: _____
- e. Describe Premises Structure: Single Story Multi-Story - # of Stories _____ Other: _____
- f. Describe Surrounding Area: Commercial Residential Industrial Other: _____
- g. Building Owner Name: Mario Phone Number: _____
 Business Owner Address: 6425 Westheimer rd. #218

10. Hours of Operation & Customers

Will customers be entering the premises? No Yes

| Day of the Week | Proposed Hours of Operation: | | Estimated Number of Customers expected each day | Potential Age Range of Customers | Class B Tavern Applicant Only: Age Restriction (If none, write 'None') |
|-----------------|----------------------------------|-----------------------------------|---|----------------------------------|--|
| | Open Time (include a.m. or p.m.) | Close Time (include a.m. or p.m.) | | | |
| Sunday | 11am | 2am | 100 | Open | Open |
| Monday | 11am | 2am | 100 | ↓ | ↓ |
| Tuesday | 11am | 2am | 100 | | |
| Wednesday | 11am | 2am | 100 | | |
| Thursday | 11am | 2am | 100 | | |
| Friday | 11am | 2:30am | 200 | | |
| Saturday | 11am | 2:30am | 200 | | |

An Extended Hours Establishment License is required for any convenience store, filling station, personal service establishment (such as tattoo, body piercing, salon, tailor, tanning, etc.), recording studio or restaurant which is open between the hours of 12:00 a.m. and 5:00 a.m.

Alcohol Establishments Permitted Hours of Operation: Class A: 8:00 am to 9:00 pm Sunday thru Saturday
 Class B: 6:00 am to 2:00 am Sunday thru Thursday, 6:00 am to 2:30 am Friday & Saturday

Entertainment Closing Hours: Indoors: Alcohol beverage establishments: Same as alcohol license hours
 Non-alcohol establishments: 1:00 am Sunday thru Thursday, 1:30 am Friday & Saturday
 Outdoors: All establishments: 10:00 pm Sunday thru Thursday, 12:00 am Friday & Saturday
 (unless otherwise approved by the Common Council in licensee's plan of operation)

11. Signature(s)

Shawn D. Warden
 Sole Proprietor, Partner, Agent, or 20% or more Shareholder

 Signature of additional partner or 20% or more Shareholder

See Application Information for a complete list of all required application forms.



ALCOHOL BEVERAGE & PUBLIC ENTERTAINMENT PREMISES SUPPLEMENTAL PLAN OF OPERATION

Office of the City Clerk License Division

200 E. Wells St. Room 105, Milwaukee, WI 53202

(414) 286-2238 e-mail address: license@milwaukee.gov www.milwaukee.gov/licenseLegal Entity Name: Runway LoungePremise Address: 9316 W. Appleton Ave

Proximity of Premises to Church, School, Daycare Center or Hospital

Is there at least 300 feet between the building and any church, school, daycare center or hospital? Yes No

"Service Bar Only" Designation

If applying for Class B or C license, are you applying for "Service Bar Only"? No Yes

Service Bar Only means customers cannot sit at the bar. Alcohol is served to patrons seated at tables. No stools, chairs or other articles of furniture shall be placed at the service bar for patrons to sit upon.

Business Information

a) Are you taking out this application for anyone that may not be eligible for a license? No Yes

If yes, list name and address: _____

b) Will the agent, a partner or the individual licensee be conducting the day-to-day operations of the business? No Yes

If no, list the name and address of the person(s) who will: _____

Class B Applicants: If the agent, a partner or the individual licensee will not be conducting the day-to-day operations of the business, the person(s) listed above must obtain a Class B Managers license.

c) Does anyone else have money invested or any other interest in this business? No Yes

If yes, explain: _____

d) Have you made an agreement with anyone to repay any loan or any other payments based upon income from the business?

 No Yes If yes, list name and address: _____

Proof of Ownership, Lease, or Offer to Purchase (new & transfer applicants only)

Submit proof of ownership, lease, or offer to purchase the building with this application.

A lease or offer to purchase must:

- Be in the same legal entity name as that apply for the license
- Reflect the same address as the premises address on this application
- Reflect current dates and
- Be signed by the lessor/seller and lessee/buyer

Property Information (new & transfer applicants only)

a) Do you own or lease the building? Own Leaseb) Who owns the fixtures (for example, coolers, etc.)? ownerc) Are you purchasing the stock and/or fixtures? No Yes If yes, amount paid \$ _____d) Total amount paid for business \$ 8000.00e) Total amount paid for goodwill of the business \$ 0

Goodwill comprises the reputation and customer relationships of an existing business. If the price you pay for the business exceeds the fair market value of all of the rest of the assets of the business, the excess may be considered goodwill.

f) Have you made arrangements with the seller for payment of personal property taxes? No Yes

See Application Information for a list of all required application forms.

Lease Information (new & transfer applicants who are leasing the premises only)

- a) Date lease begins 11/1/17 Ends 11/1/20
- b) Monthly rental \$ 4000
- c) Do you have an option to renew the lease? No Yes
- d) Does your lease allow for assignment to another party without the consent of the owner? No Yes
- e) For what length of time have you been guaranteed occupancy (number of years)? 3
- f) In addition to paying the monthly rental, will you have to pay anything additional to the owner of the building to guarantee performance of the lease? No Yes If yes, explain _____
- g) Does the present owner or occupancy object to the granting of your license? No Yes
If yes, explain _____

Change of Agent Applicants Only

- Have there been any changes to the floor plan since the last application was submitted? No Yes
If no, a new floor plan is not required. If yes, submit a new floor plan and explain the change(s): _____

Notarized Signatures of Applicants

SUBSCRIBED AND SWORN TO BEFORE ME

This 14th day of November

(Clerk/Notary Public)

My Commission Expires 12/2/18
*Notary Seal must be affixed.

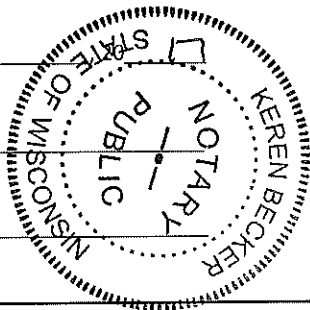

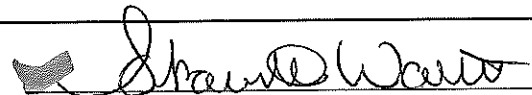

Sole Proprietor, Partner, 20% or more Shareholder, or
Agent – only if there are no 20% or more shareholders

Additional partner or 20% or more shareholder

Note: All information contained in this application is subject to approval by the Common Council.
Deviating from approved plan of operation will subject licensee to citations, and/or suspension or non-renewal of the license.
Contact the License Division for information on how to request changes.

New and transfer of premise applicants must submit the following:

- Proof of ownership, lease or offer to purchase the building Detailed floor plan If a restaurant, copy of the menu



PUBLIC ENTERTAINMENT PREMISES LICENSE SUPPLEMENTAL APPLICATION

Office of the City Clerk License Division
200 E. Wells St. Room 105, Milwaukee, WI 53202
(414) 286-2238 www.milwaukee.gov/license e-mail address: license@milwaukee.gov

TYPES OF ENTERTAINMENT (CHECK ALL THAT APPLY)

| | | | |
|---|--|--|---|
| <input type="checkbox"/> Instrumental Musicians | <input type="checkbox"/> Bands | <input type="checkbox"/> Battle of the Bands | <input checked="" type="checkbox"/> Comedy Acts |
| <input checked="" type="checkbox"/> Disc Jockey | <input type="checkbox"/> Magic Shows | <input checked="" type="checkbox"/> Poetry Readings | <input type="checkbox"/> Dancing by Performers |
| <input type="checkbox"/> Jukebox | <input type="checkbox"/> Wrestling | <input type="checkbox"/> Patron Contests | <input type="checkbox"/> Patrons Dancing |
| <input type="checkbox"/> Adult Entertainment/ Strippers/Erotic Dance | <input type="checkbox"/> Karaoke | <input type="checkbox"/> Bowling Alley How many? _____ | <input checked="" type="checkbox"/> Pool Tables How many? <u>1</u> |
| <input type="checkbox"/> Motion Pictures on Projection Screens – How many? _____ | <input type="checkbox"/> Amusement Machines – How many? _____ | <input type="checkbox"/> Concerts Approx. # per year? _____ | <input type="checkbox"/> Theatrical Performances Approx. # per year? _____ |
| <input type="checkbox"/> Other: _____ | | | |

Entertainment Indoor Hours: Alcohol beverage establishment: same as alcohol license hours.
Non-alcohol establishment: 10:30am to 1:00am Sun to Thurs; 1:30am Fri-Sat

Entertainment Outdoor Closing Hours: 10:00pm Sunday-Thurs; 12:00am Friday & Saturday; unless otherwise approved by Common Council.

PROMOTERS/SOUND AMPLIFICATION

Will promoters ever be used for any of the entertainment? No Yes If Yes, Describe:

At any time will sound amplification be used? No Yes If Yes, Describe: Amp & speakers

LEGAL CAPACITY OF PREMISES

1400 (Call the Development Center at 414-286-8211 with questions.) Legal capacity determines the fee for your Public Entertainment Premises License. If you would like to request the license be approved with a lower capacity than that listed above, indicate the lower capacity here: _____. If approved, this lower capacity will print on your license and override the capacity listed on your Occupancy Permit.

NOTARIZED SIGNATURES

I understand that after the license has been issued, a change to the plan of operation will require a written request to change and approval from the Common Council.

I agree to inform the City Clerk within 10 days of any substantial changes in the information supplied in this application.

I understand that I shall not willfully refuse to provide the services offered under this license, or add charges or require deposits not required of the general public because of race, color, sex, religion, national origin or ancestry, age, handicap, lawful source of income, marital status, sexual orientation, gender identity or expression, familial status or the fact that a person is now or has been a member of the military service, whether dressed in uniform or not; and shall not seek such information as a condition of employment, or penalize any employee or discriminate in the selection of personnel for training or promotion on the basis of such information.

I have knowledge of the City Ordinances currently regulating public entertainment, and understand that the license may be subject to suspension, non-renewal or revocation, if I violate any rule, law or regulation of the city of Milwaukee and State of Wisconsin.

SUBSCRIBED AND SWORN TO BEFORE ME

This 14th day of November, 2014

[Signature]
Sole Proprietor/Agent/20% or More Shareholder/Partner

[Signature]
Additional 20% or More Shareholder/Partner

(Clerk/Notary Public)
My Commission Expires 10/2/18

*Notary Seal must be affixed.

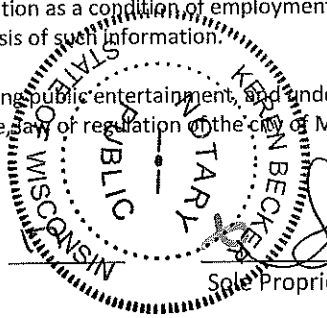

Office Use Only: Initials: _____ Filed: _____ App: _____

Check if only PEP (must be heard w/in 60 days) Granted _____ License # _____

11/13/2011

Runway Lounge LLC

Runway Lounge

Shawntel Watson

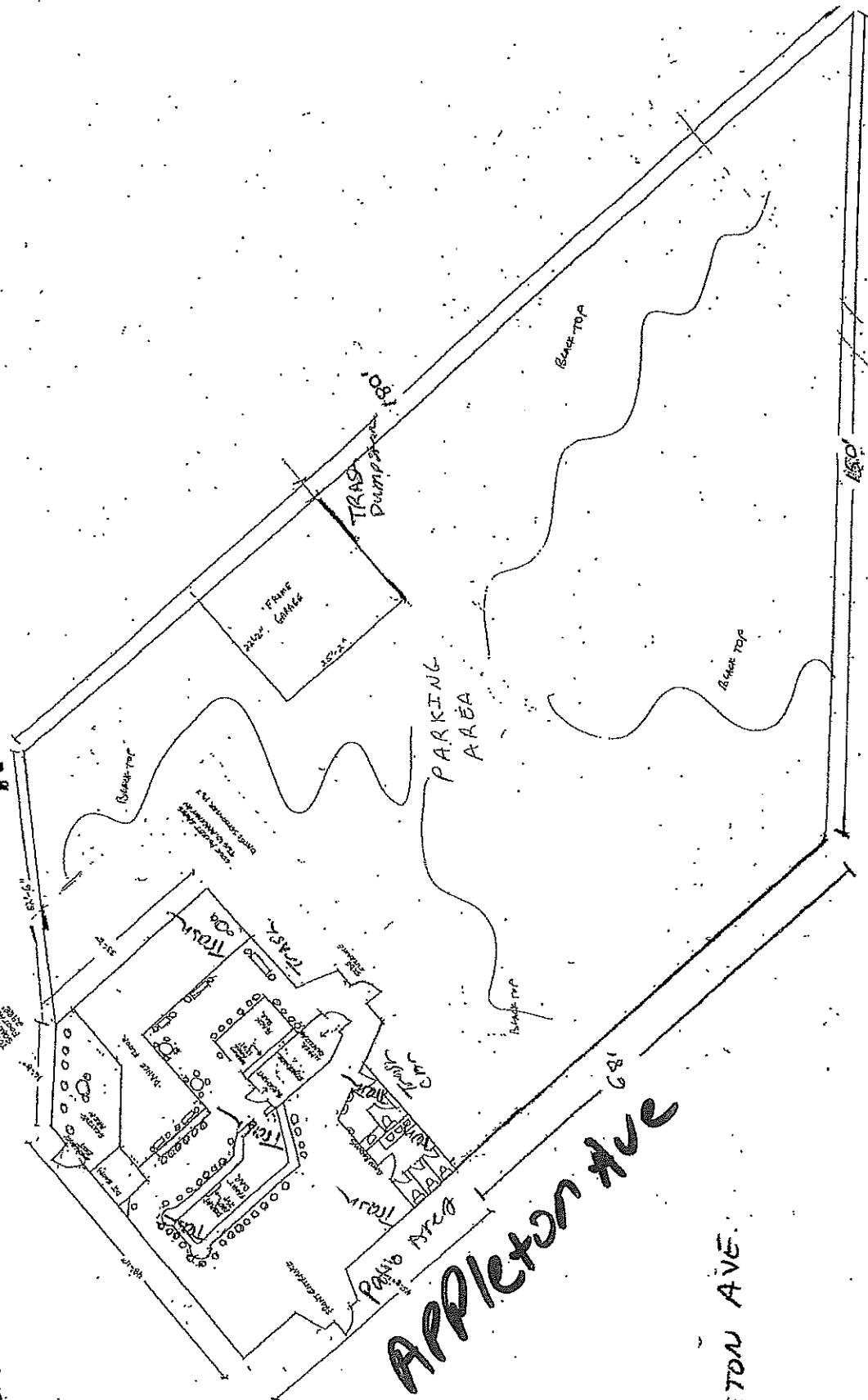
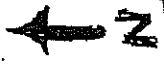

APPLETON AVE

9316 W. APPLETON AVE.

Date:

12901
SUNBELT FOODS

11/13/2017
Runway Lounge
LLC

Runway Lounge
Agent: Shawnel Winton

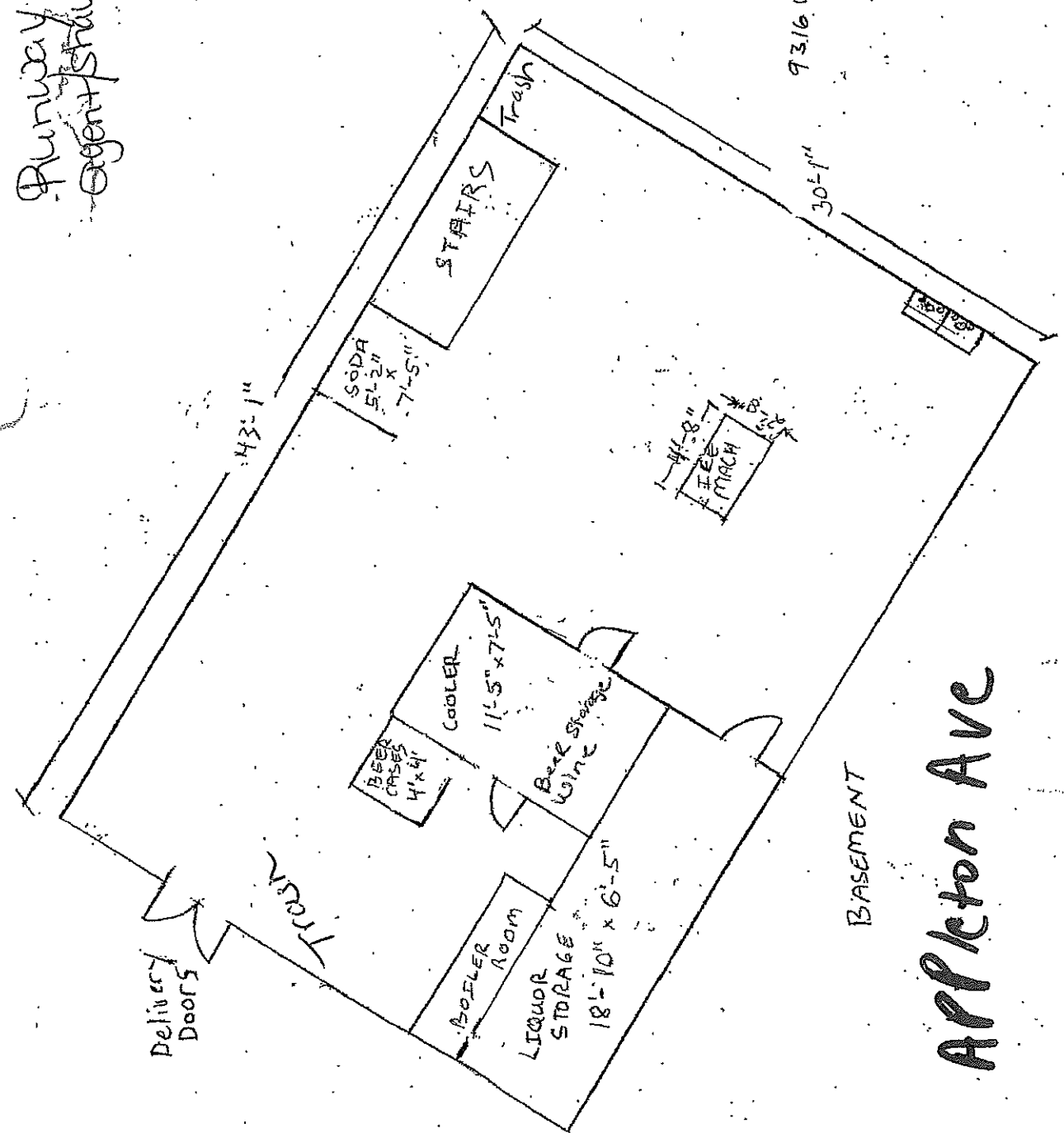
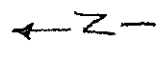

9316 W. APPLETON AVE.

30'-1"

BASEMENT

Appleton Ave