

REVISED Demolition Conditions

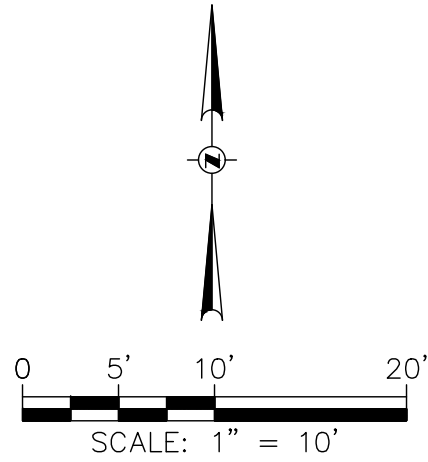

LEGEND

- CONCRETE SIDEWALK REMOVAL
- SAWCUT
- TREE AND BOLLARD REMOVAL
- INLET PROTECTION
- CURB REMOVAL

GENERAL NOTES

- SEE SHEET C900.1 FOR GENERAL NOTES.

REMOVAL NOTES

- SEE SHEET C900.1 FOR REMOVAL NOTES.

EROSION CONTROL NOTES

- SEE SHEET C900.1 FOR EROSION CONTROL NOTES.

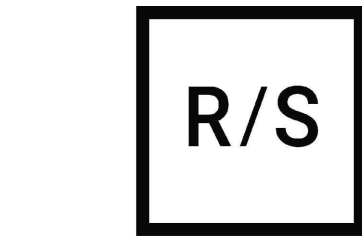

RAMLOW / STEIN  
ARCHITECTURE + INTERIORS

322 East Michigan Street  
Milwaukee, WI 53202  
414.271.8999  
www.ramlowstein.com



© RAMLOW/STEIN, INC.  
ALL RIGHTS RESERVED  
OWNERSHIP OF DOCUMENTS

This document, and the ideas and designs incorporated herein, as an instrument of professional service, is the sole property of Ramlow/Stein, Inc., and is not to be used in whole or in part for any other project or purpose without the expressed written authorization of Ramlow/Stein, Inc.

REVISIONS

No.	Date:	Description:
A	04/11/2025	Phase 1 Bid Documents
B	04/25/2025	Phase 1 ADD01
C	05/14/2025	Phase 1 ADD03

PROJECT  
MSOE EIC - CAMPUS CENTER RENOVATIONS

SHEET  
DEMOLITION  
AND EROSION  
CONTROL PLAN

DATE  
04/11/2025

PROJECT NO.  
22-129

SHEET NO.

C200.1

NOTICE:  
In accordance with Wisconsin statute 182.0175, damage to transmission facilities, excavator shall be solely responsible to provide advance notice to the designated "ONE CALL SYSTEM" not less than three working days prior to commencement of any excavation required to perform work contained on this drawing, and further, excavator shall comply with all other requirements of this statute relative to excavator's work.

DISCLAIMER:  
The underground utilities shown have been located from field survey information and existing drawings. GRAEF makes no guarantees that the underground utilities shown comprise all such utilities in the area, either in service or abandoned. GRAEF further does not warrant that the underground utilities shown are in the exact location indicated. GRAEF has not physically located the underground utilities.

14 May 2025 2:16:31 PM X:\ML\2024\20240296\Design\Civil\00 Campus Center\Demo & EC Plan\_0296.dwg



REVISED Proposed Conditions

14 May 2025 3:57:43 PM X:\ML\2024\20240296\Design\Civil\00 Campus Center\Layout & Grading Plan\_0296.dwg

NOTICE:  
In accordance with Wisconsin statute 182.0175, damage to transmission facilities, excavator shall be solely responsible to provide advance notice to the designated "ONE CALL SYSTEM" not less than three working days prior to commencement of any excavation required to perform work contained on this drawing, and further, excavator shall comply with all other requirements of this statute relative to excavator's work.

DISCLAIMER:  
The underground utilities shown have been located from field survey information and existing drawings. GRAEF makes no guarantees that the underground utilities shown comprise all such utilities in the area, either in service or abandoned. GRAEF further does not warrant that the underground utilities shown are in the exact location indicated. GRAEF has not physically located the underground utilities.

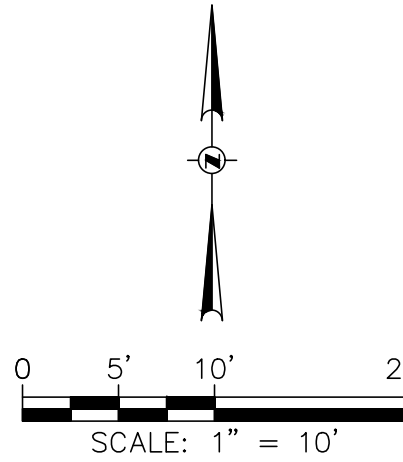
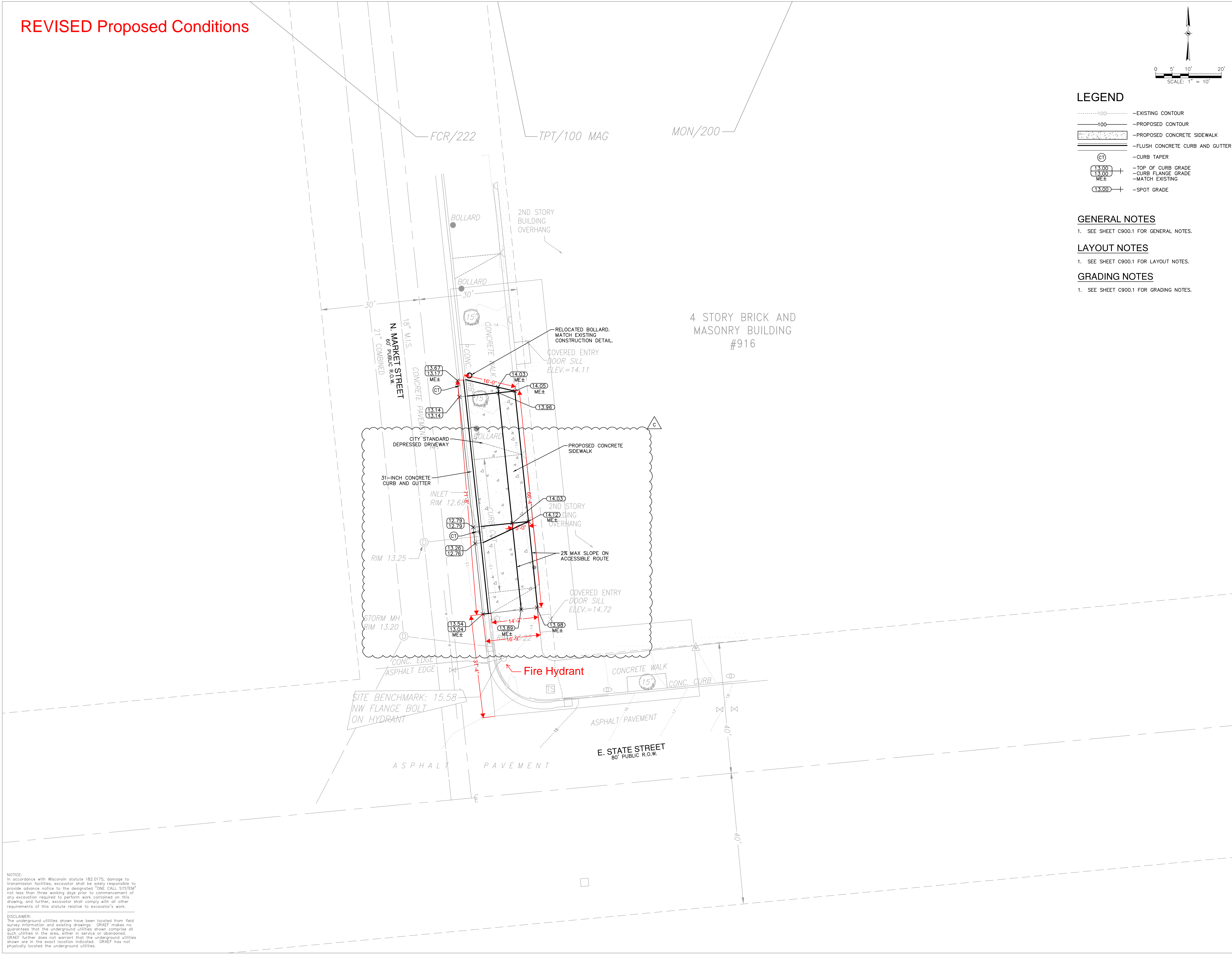

LEGEND

- 100----- -EXISTING CONTOUR
- 100———— -PROPOSED CONTOUR
- [Pattern] -PROPOSED CONCRETE SIDEWALK
- [Pattern] -FLUSH CONCRETE CURB AND GUTTER
- (CT) -CURB TAPER
- [Elev] + -TOP OF CURB GRADE
- [Elev] + -CURB FLANGE GRADE
- [Elev] + -MATCH EXISTING
- [Elev] + -SPOT GRADE

GENERAL NOTES

- SEE SHEET C900.1 FOR GENERAL NOTES.

LAYOUT NOTES

- SEE SHEET C900.1 FOR LAYOUT NOTES.

GRADING NOTES

- SEE SHEET C900.1 FOR GRADING NOTES.

R/S

**RAMLOW / STEIN**  
ARCHITECTURE + INTERIORS  
322 East Michigan Street  
Milwaukee, WI 53202  
414.271.8899  
www.ramlowstein.com

**GRAEF**

© RAMLOW/STEIN, INC.  
ALL RIGHTS RESERVED  
OWNERSHIP OF DOCUMENTS  
This document, and the ideas and designs incorporated herein, as an instrument of professional service, is the sole property of Ramlow/Stein, Inc., and is not to be used in whole or in part for any other project or purpose without the expressed written authorization of Ramlow/Stein, Inc.

REVISIONS

No.	Date:	Description:
A	04/11/2025	Phase 1 Bid Documents
B	04/25/2025	Phase 1 ADD01
C	05/14/2025	Phase 1 ADD03

PROJECT

**MSOE EIC - CAMPUS CENTER RENOVATIONS**

MILWAUKEE SCHOOL OF ENGINEERING

SHEET

**LAYOUT AND GRADING PLAN**

DATE

04/11/2025

PROJECT NO.

22-129

SHEET NO.

C300.1



Mechanical Engineering Department  
Student Project Laboratory

Area of Work

N. Market Street





