

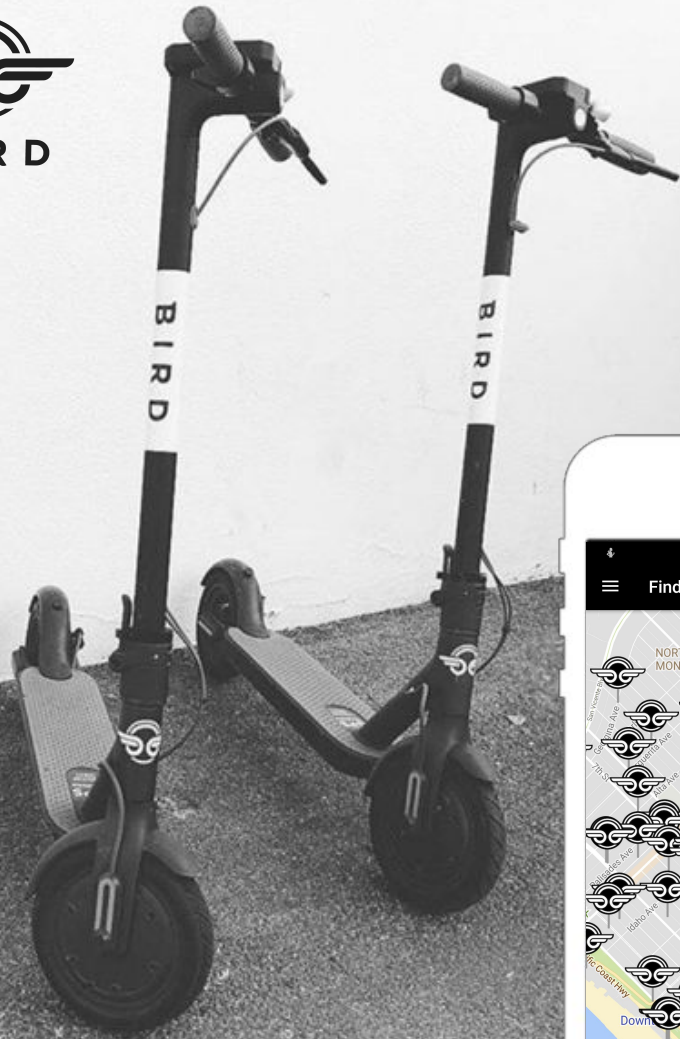

**BIRD**



# How It Works

Bird is Easy - Just Find a Bird, Scan, and Go!

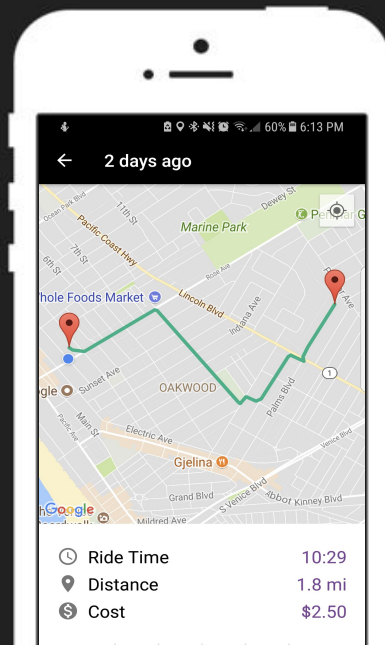
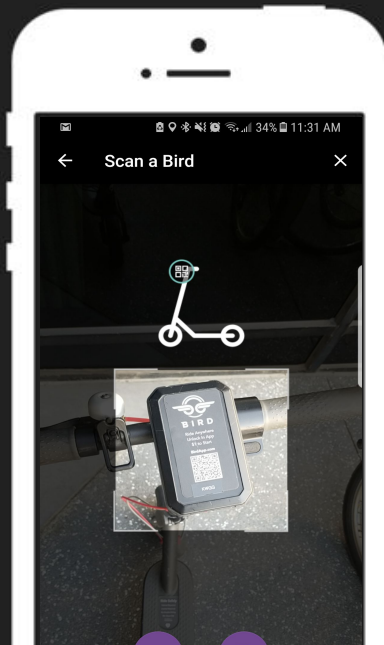
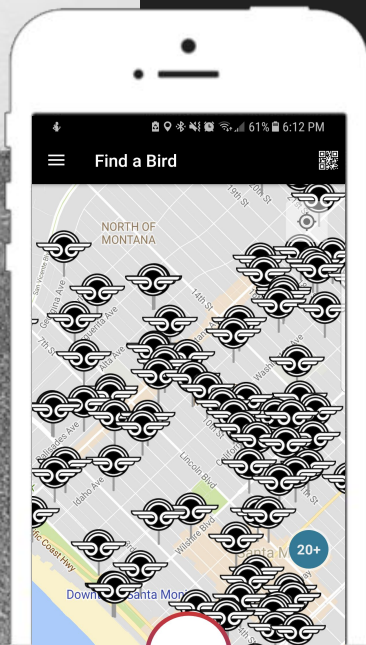

# The Bird Difference

## Smart Scaling

Demand determines supply

## Active Bird Management

We pull every Bird off the road every night

## Small Footprint

Less clutter and easy to move

## Charger Program

Supplemental income for your community

## Bird Nests

In partnership with local businesses



# Safety First

Always Wear a Helmet

15 MPH Max Speed

Drivers License Scan

Must be 18+

One Rider per Bird

Always Follow Traffic Laws

Park Your Bird Safely





**B I R D**

**Matt Shaw**

Director Government Relations

[matt@bird.co](mailto:matt@bird.co)

**Carl Hansen**

Director Government Relations

[carl@bird.co](mailto:carl@bird.co)