



CITY OF MILWAUKEE  
OFFICE OF THE CITY CLERK

Thursday, January 14, 2021

COMMITTEE MEETING NOTICE

AD 04

VAILLANCOURT, Erica E, Agent  
Interstate Parking Company LLC  
710 N PLANKINTON Av #700

Milwaukee, WI 53203

You are requested to attend a virtual hearing to be held on:

**Tuesday, January 26, 2021 at 10:35 AM**

**Regarding:** Your Parking Lot or Place and Weights & Measures License Applications as agent for "Interstate Parking Company LLC" for "Interstate Parking Company LLC" at 822 N Old World Third St.

This meeting will be held via GoToMeeting. Please see the enclosed best practices document for further instructions. The access code is <https://global.gotomeeting.com/join/778000629>. If you wish to call in, please call +1 (669) 224-3412 and use Access Code: 778-000-629.

There is a possibility that your application may be denied for one or more of the following reasons: The recommendation of the committee regarding the application shall be based on evidence presented at the hearing. Per MCO 85-2.7-4, probative evidence concerning whether or not a new license should be granted may be presented on the following subjects: whether or not the applicant meets the municipal requirements, the appropriateness of the location and premises where the licensed premises is to be located and whether use of the premises for the purposes or activities permitted by the license would tend to facilitate a public or private nuisance or create undesirable neighborhood problems such as disorderly patrons, unreasonably loud noise, litter, and excessive traffic and parking congestion. Probative evidence relating to these matters may be taken from the plan of operation submitted with the license application, if any, but shall not include the content of any music. Evidence regarding the fitness of the location of the premises to be maintained as the principal place of business, including but not limited to whether there is an overconcentration of businesses of the type for which the license is sought; whether the proposal is consistent with any pertinent neighborhood business or development plans, or the location's proximity to areas where children are typically present. The applicant's record in operating similarly licensed premises; and whether or not the applicant has been charged with or convicted of any felony, misdemeanor, municipal offense or other offense, the circumstances of which substantially relate to the activity to be permitted by the license being applied for or any other factor which reasonably relates to the public health, safety or welfare may also be considered. See attached police report or correspondence.

**Notice for applicants with warrants or unpaid fines:**

Proof of warrant satisfaction or payment of fines must be submitted at the hearing on the above date and time. Failure to comply with this requirement may result in a delay of the granting/denial of your application.

Failure to attend this meeting may result in the denial of your license. Individual applicants and partnership applicants must attend or attend by an attorney. The agent or attorney for corporate or limited liability applicants must attend. If you wish to do so and at your own expense, you may be accompanied by an attorney of your choosing to represent you at this hearing.

You will be given an opportunity to speak on behalf of the application and to respond and challenge any charges or reasons given for the denial. No petitions can be accepted by the committee, unless the people who signed the petition attend the virtual hearing and are willing to testify. You may present witnesses under oath and you may also confront and cross-examine opposing witnesses under oath. If you have difficulty with the English language, you should request an interpreter attend the meeting with you, at your expense, so that you can answer questions and participate in your hearing.

PLEASE NOTE: Upon reasonable notice, efforts will be made to accommodate the needs of disabled individuals through sign language interpreters or other auxiliary aids. For additional information or to request this service, contact the Council Services Division ADA Coordinator at (414) 286-2998, Fax - (414) 286-3456, TDD - (414) 286-2025.

JIM OWCZARSKI, CITY CLERK

BY: \_\_\_\_\_

Jessica Celella  
License Division Manager

If you have questions regarding this meeting, please contact the staff assistant, Molly Kuether-Steele at (414) 286-2775 or [molly.kuether-steele@milwaukee.gov](mailto:molly.kuether-steele@milwaukee.gov).

200 E. Wells Street, Room 105, City Hall, Milwaukee, WI 53202. [www.milwaukee.gov/license](http://www.milwaukee.gov/license)  
Phone: (414) 286-2238 Fax: (414) 286-3057 Email Address: [License@milwaukee.gov](mailto:License@milwaukee.gov)



CITY OF MILWAUKEE  
OFFICE OF THE CITY CLERK

Thursday, January 14, 2021

COMMITTEE MEETING NOTICE

AD 04

VAILLANCOURT, Erica E, Agent  
Interstate Parking Company LLC  
5329 S Mary Knoll Dr

New Berlin, WI 53151

You are requested to attend a virtual hearing to be held on:

**Tuesday, January 26, 2021 at 10:35 AM**

**Regarding:** Your Parking Lot or Place and Weights & Measures License Applications as agent for "Interstate Parking Company LLC" for "Interstate Parking Company LLC" at 822 N Old World Third St.

This meeting will be held via GoToMeeting. Please see the enclosed best practices document for further instructions. The access code is <https://global.gotomeeting.com/join/778000629>. If you wish to call in, please call +1 (669) 224-3412 and use Access Code: 778-000-629.

There is a possibility that your application may be denied for one or more of the following reasons: The recommendation of the committee regarding the application shall be based on evidence presented at the hearing. Per MCO 85-2.7-4, probative evidence concerning whether or not a new license should be granted may be presented on the following subjects: whether or not the applicant meets the municipal requirements, the appropriateness of the location and premises where the licensed premises is to be located and whether use of the premises for the purposes or activities permitted by the license would tend to facilitate a public or private nuisance or create undesirable neighborhood problems such as disorderly patrons, unreasonably loud noise, litter, and excessive traffic and parking congestion. Probative evidence relating to these matters may be taken from the plan of operation submitted with the license application, if any, but shall not include the content of any music. Evidence regarding the fitness of the location of the premises to be maintained as the principal place of business, including but not limited to whether there is an overconcentration of businesses of the type for which the license is sought; whether the proposal is consistent with any pertinent neighborhood business or development plans, or the location's proximity to areas where children are typically present. The applicant's record in operating similarly licensed premises; and whether or not the applicant has been charged with or convicted of any felony, misdemeanor, municipal offense or other offense, the circumstances of which substantially relate to the activity to be permitted by the license being applied for or any other factor which reasonably relates to the public health, safety or welfare may also be considered. See attached police report or correspondence.

**Notice for applicants with warrants or unpaid fines:**

Proof of warrant satisfaction or payment of fines must be submitted at the hearing on the above date and time. Failure to comply with this requirement may result in a delay of the granting/denial of your application.

Failure to attend this meeting may result in the denial of your license. Individual applicants and partnership applicants must attend or attend by an attorney. The agent or attorney for corporate or limited liability applicants must attend. If you wish to do so and at your own expense, you may be accompanied by an attorney of your choosing to represent you at this hearing.

You will be given an opportunity to speak on behalf of the application and to respond and challenge any charges or reasons given for the denial. No petitions can be accepted by the committee, unless the people who signed the petition attend the virtual hearing and are willing to testify. You may present witnesses under oath and you may also confront and cross-examine opposing witnesses under oath. If you have difficulty with the English language, you should request an interpreter attend the meeting with you, at your expense, so that you can answer questions and participate in your hearing.

PLEASE NOTE: Upon reasonable notice, efforts will be made to accommodate the needs of disabled individuals through sign language interpreters or other auxiliary aids. For additional information or to request this service, contact the Council Services Division ADA Coordinator at (414) 286-2998, Fax - (414) 286-3456, TDD - (414) 286-2025.

JIM OWCZARSKI, CITY CLERK

BY: \_\_\_\_\_

Jessica Celella

License Division Manager

If you have questions regarding this meeting, please contact the staff assistant, Molly Kuether-Steele at (414) 286-2775 or [molly.kuether-steele@milwaukee.gov](mailto:molly.kuether-steele@milwaukee.gov).

200 E. Wells Street, Room 105, City Hall, Milwaukee, WI 53202. [www.milwaukee.gov/license](http://www.milwaukee.gov/license)  
Phone: (414) 286-2238 Fax: (414) 286-3057 Email Address: [License@milwaukee.gov](mailto:License@milwaukee.gov)

Date: 12/16/20  
Officer: Monreal

City of Milwaukee Police Department  
90-5-1.5 Crime Prevention Survey  
Parking Lot Inspection

Name of Premise: Interstate Parking  
Address: 822 N Old World Third.  
Phone: 414-431-6555

Owner: Vaillancourt, Erica E.  
Owner address: 5329 S. Mary Knoll Dr.  
City State Zip: New Berlin, WI 53151  
Owner Phone: 414-909-7914  
Owner email: evaillaincourt@interstateparking.com

Manager: Same  
Home Address:  
City State Zip:  
Phone:  
Email:

Preferred contact: Same

Location currently open:  YES  NO

Projected open date: Currently Open

Day's open: S M T W Th F SA ALL

Number of Parking Spots: 53

Hours of Operation: Sun: 24 hours Y N  
Mon:  
Tue:  
Wed:  
Thu:  
Fri:  
Sat:

Premise Type:  Parking Lot  
 Other:

**Exterior Survey:**

1. Is the area around the location clean?  Yes  No
2. What surrounds the location? (Check all the apply)
  - a.  Park
  - b.  School
  - c.  Youth Center
  - d.  Church
  - e.  Tavern(s) If so, how many
  - f.  Residential
  - g.  Other businesses
  - h.  Other:
3. Is the parking lot well lit?  Yes  No Does it appears to be adequate  Yes  No
4. Is the lighting in uniformity?  Yes  No
5. Are there areas where a person could conceal themselves  Yes  No
6. Are there No Loitering Signs posted?  Yes  No
7. Are the address numbers prominently displayed and easy to see  Yes  No

**Camera Survey:**

8. Does this location have security cameras?  Yes  No
9. Signs posted stating property monitored by security cameras?  Yes  No
10. Are they in working order?  Yes  No
11. What format are the cameras?
  - a. Color  Yes  No
  - b. Digital  Yes  No
  - c. VCR  Yes  No
  - d. Recorded  Yes  No
12. How long is footage stored for later viewing:
13. Are the security cameras monitored?  Yes  No
14. How many cameras:
15. Do all employees know how to retrieve recorded digital images/footage?  Yes  No
16. Does this lot have a gate at the entrance/exit?  Yes  No
17. Does this lot have an on-site attendant?  Yes  No

Hours of attendant: Sun:  24 hours  Y  N  
Mon:  
Tue:  
Wed:  
Thu:  
Fri:  
Sat:

18. Does this lot have onsite security officers?  Yes  No

Hours of security: Sun:  24 hours  Y  N  
Mon:  
Tue:  
Wed:  
Thu:  
Fri:  
Sat:

**Interior Survey:**

- 19. Does this lot have stair towers?  Yes  No  N/A
- 20. Can you see inside the stair towers from the outside?  Yes  No  N/A
- 21. Does this lot have an elevator?  Yes  No  N/A
- 22. Can you see inside the elevator from the outside?  Yes  No  N/A
- 23. What color are the interior walls? Is that color light?  Yes  No  N/A
- 24. Does this lot have restrooms?  Yes  No  N/A 24 hours  Y  N
- 25. Are safety signs posted reminding citizens not to leave valuables in their cars?  Y  N
- 26. Does this lot have an emergency phone?  Y  N
- 27. Does this lot contract spaces to a valet company?  Y  N
- 28. Are exit signs posted and illuminated at all exits?  Y  N

**ADDITIONAL COMMENTS/RECOMMENDATIONS:**

Interstate Provides roving security. Plans are being discussed to add security cameras



Thursday, January 14, 2021



# Notice of Public Hearing

blank  
notice

---

VAILLANCOURT, Erica E, Agent  
Interstate Parking Company LLC at 822 N Old World Third St  
Parking Lot or Place and Weights & Measures License Applications

**Tuesday, January 26, 2021 at 10:35 AM**

To whom it may concern:

The above application has been made by the above named applicant(s). This requires approval from the Licenses Committee and the Common Council of the City of Milwaukee. The hearing before the Licenses Committee will take place virtually on 1/26/2021 at 10:35 AM. This is a public hearing. Those wishing to view the proceeding are able to do so via the City Channel – Channel 25 on Spectrum Cable – or on the Internet at <http://city.milwaukee.gov/citychannel>. Those wishing to provide oral testimony will be asked to do so by phone or internet and are asked to contact the staff assistant, Molly Kuether-Steele at (414) 286-2775 or [molly.kuether-steele@milwaukee.gov](mailto:molly.kuether-steele@milwaukee.gov) for necessary information. Please make such requests no later than one business day prior to the start of the meeting. You are not required to attend the hearing, but please see the information below if you would like to provide testimony. Once the Licenses Committee makes its recommendation, this recommendation is forwarded to the full Common Council for approval at its next regularly scheduled hearing.

---

## Important details for those wishing to provide information for the Licenses Committee to consider when making its recommendation:

1. The license application is scheduled to be heard at the above time. Due to other hearings running longer than scheduled, you may have to wait some time to provide your testimony.
2. You must testify as to matters that you have personally experienced or seen. (You cannot provide testimony for your neighbor, parent or anyone else; this is considered hearsay and cannot be considered by the committee.)
3. No letters or petitions can be accepted by the committee (unless the person who wrote the letter or the persons who signed the petition are willing to testify).
4. Persons opposed to the license application are given the opportunity to testify first; supporters may testify after the opponents have finished.
5. When you are called to testify, you will be sworn in and asked to give your name, and address. (If your first and/or last names are uncommon please spell them.)
6. You may then provide testimony.
  - a. Include only information relating to the above license application.
  - b. Include only information you have personally witnessed or seen.
  - c. Provide concise and relevant information detailing how this business has affected or may affect the peaceful enjoyment of your neighborhood.
  - d. If by the time you have the opportunity to testify, the information you wish to share has already been provided to the committee, you may state that you agree with the previous testimony. Redundant or repetitive testimony will not assist the committee in making its recommendation.
7. After giving your testimony, the members of the Licenses Committee and the licensee may ask questions regarding the testimony you have given or other factors relating to the license application.
8. Business Competition is not a valid basis for denial or non-renewal of a license.

**Please Note: If you have submitted an objection to the above application your objection cannot be considered by the committee unless you personally testify at the hearing.**

OCCUPANT	MAIL ADDRESS	CITY, STATE ZIP
CURRENT OCCUPANT	808 N OLD WORLD THIRD ST 403	MILWAUKEE, WI 53203
CURRENT OCCUPANT	808 N OLD WORLD THIRD ST 501	MILWAUKEE, WI 53203
CURRENT OCCUPANT	808 N OLD WORLD THIRD ST 507	MILWAUKEE, WI 53203
CURRENT OCCUPANT	808 N OLD WORLD THIRD ST 508	MILWAUKEE, WI 53203
CURRENT OCCUPANT	808 N OLD WORLD THIRD ST 601	MILWAUKEE, WI 53203
CURRENT OCCUPANT	808 N OLD WORLD THIRD ST 604	MILWAUKEE, WI 53203
CURRENT OCCUPANT	808 N OLD WORLD THIRD ST 302	MILWAUKEE, WI 53203
CURRENT OCCUPANT	823 N 2ND ST 811	MILWAUKEE, WI 53203
CURRENT OCCUPANT	823 N 2ND ST 812	MILWAUKEE, WI 53203
CURRENT OCCUPANT	823 N 2ND ST 905	MILWAUKEE, WI 53203
CURRENT OCCUPANT	823 N 2ND ST 406	MILWAUKEE, WI 53203
CURRENT OCCUPANT	823 N 2ND ST 501	MILWAUKEE, WI 53203
CURRENT OCCUPANT	823 N 2ND ST 513	MILWAUKEE, WI 53203
CURRENT OCCUPANT	823 N 2ND ST 604	MILWAUKEE, WI 53203
CURRENT OCCUPANT	823 N 2ND ST 703	MILWAUKEE, WI 53203
CURRENT OCCUPANT	823 N 2ND ST 707	MILWAUKEE, WI 53203
CURRENT OCCUPANT	830 N OLD WORLD THIRD ST	MILWAUKEE, WI 53203
CURRENT OCCUPANT	808 N OLD WORLD THIRD ST 410	MILWAUKEE, WI 53203
CURRENT OCCUPANT	808 N OLD WORLD THIRD ST 503	MILWAUKEE, WI 53203
CURRENT OCCUPANT	808 N OLD WORLD THIRD ST 609	MILWAUKEE, WI 53203
CURRENT OCCUPANT	823 N 2ND ST 714	MILWAUKEE, WI 53203
CURRENT OCCUPANT	823 N 2ND ST 802	MILWAUKEE, WI 53203
CURRENT OCCUPANT	823 N 2ND ST 809	MILWAUKEE, WI 53203
CURRENT OCCUPANT	823 N 2ND ST 810	MILWAUKEE, WI 53203
CURRENT OCCUPANT	823 N 2ND ST 902	MILWAUKEE, WI 53203
CURRENT OCCUPANT	823 N 2ND ST 904	MILWAUKEE, WI 53203
CURRENT OCCUPANT	823 N 2ND ST 207	MILWAUKEE, WI 53203
CURRENT OCCUPANT	823 N 2ND ST 312	MILWAUKEE, WI 53203
CURRENT OCCUPANT	823 N 2ND ST 410	MILWAUKEE, WI 53203
CURRENT OCCUPANT	823 N 2ND ST 502	MILWAUKEE, WI 53203
CURRENT OCCUPANT	823 N 2ND ST 506	MILWAUKEE, WI 53203
CURRENT OCCUPANT	823 N 2ND ST 614	MILWAUKEE, WI 53203
CURRENT OCCUPANT	823 N 2ND ST 704	MILWAUKEE, WI 53203
CURRENT OCCUPANT	823 N 2ND ST 708	MILWAUKEE, WI 53203
CURRENT OCCUPANT	823 N 2ND ST 213	MILWAUKEE, WI 53203
CURRENT OCCUPANT	808 N OLD WORLD THIRD ST 402	MILWAUKEE, WI 53203
CURRENT OCCUPANT	808 N OLD WORLD THIRD ST 408	MILWAUKEE, WI 53203
CURRENT OCCUPANT	808 N OLD WORLD THIRD ST 509	MILWAUKEE, WI 53203
CURRENT OCCUPANT	808 N OLD WORLD THIRD ST 603	MILWAUKEE, WI 53203
CURRENT OCCUPANT	808 N OLD WORLD THIRD ST 306	MILWAUKEE, WI 53203
CURRENT OCCUPANT	808 N OLD WORLD THIRD ST 401	MILWAUKEE, WI 53203
CURRENT OCCUPANT	823 N 2ND ST 712	MILWAUKEE, WI 53203
CURRENT OCCUPANT	823 N 2ND ST 203	MILWAUKEE, WI 53203
CURRENT OCCUPANT	823 N 2ND ST 205	MILWAUKEE, WI 53203
CURRENT OCCUPANT	823 N 2ND ST 310	MILWAUKEE, WI 53203
CURRENT OCCUPANT	823 N 2ND ST 314	MILWAUKEE, WI 53203

CURRENT OCCUPANT	823 N 2ND ST 403	MILWAUKEE, WI 53203
CURRENT OCCUPANT	823 N 2ND ST 409	MILWAUKEE, WI 53203
CURRENT OCCUPANT	823 N 2ND ST 505	MILWAUKEE, WI 53203
CURRENT OCCUPANT	823 N 2ND ST 605	MILWAUKEE, WI 53203
CURRENT OCCUPANT	808 N OLD WORLD THIRD ST 411	MILWAUKEE, WI 53203
CURRENT OCCUPANT	808 N OLD WORLD THIRD ST 511	MILWAUKEE, WI 53203
CURRENT OCCUPANT	808 N OLD WORLD THIRD ST 605	MILWAUKEE, WI 53203
CURRENT OCCUPANT	808 N OLD WORLD THIRD ST 607	MILWAUKEE, WI 53203
CURRENT OCCUPANT	808 N OLD WORLD THIRD ST 608	MILWAUKEE, WI 53203
CURRENT OCCUPANT	808 N OLD WORLD THIRD ST 303	MILWAUKEE, WI 53203
CURRENT OCCUPANT	808 N OLD WORLD THIRD ST 308	MILWAUKEE, WI 53203
CURRENT OCCUPANT	823 N 2ND ST 709	MILWAUKEE, WI 53203
CURRENT OCCUPANT	823 N 2ND ST 801	MILWAUKEE, WI 53203
CURRENT OCCUPANT	823 N 2ND ST 813	MILWAUKEE, WI 53203
CURRENT OCCUPANT	823 N 2ND ST 903	MILWAUKEE, WI 53203
CURRENT OCCUPANT	823 N 2ND ST 210	MILWAUKEE, WI 53203
CURRENT OCCUPANT	823 N 2ND ST 211	MILWAUKEE, WI 53203
CURRENT OCCUPANT	823 N 2ND ST 212	MILWAUKEE, WI 53203
CURRENT OCCUPANT	823 N 2ND ST 401	MILWAUKEE, WI 53203
CURRENT OCCUPANT	823 N 2ND ST 412	MILWAUKEE, WI 53203
CURRENT OCCUPANT	823 N 2ND ST 509	MILWAUKEE, WI 53203
CURRENT OCCUPANT	823 N 2ND ST 602	MILWAUKEE, WI 53203
CURRENT OCCUPANT	823 N 2ND ST 609	MILWAUKEE, WI 53203
CURRENT OCCUPANT	823 N 2ND ST 201	MILWAUKEE, WI 53203
CURRENT OCCUPANT	808 N OLD WORLD THIRD ST 404	MILWAUKEE, WI 53203
CURRENT OCCUPANT	808 N OLD WORLD THIRD ST 405	MILWAUKEE, WI 53203
CURRENT OCCUPANT	808 N OLD WORLD THIRD ST 502	MILWAUKEE, WI 53203
CURRENT OCCUPANT	808 N OLD WORLD THIRD ST 504	MILWAUKEE, WI 53203
CURRENT OCCUPANT	808 N OLD WORLD THIRD ST 510	MILWAUKEE, WI 53203
CURRENT OCCUPANT	808 N OLD WORLD THIRD ST 602	MILWAUKEE, WI 53203
CURRENT OCCUPANT	808 N OLD WORLD THIRD ST 606	MILWAUKEE, WI 53203
CURRENT OCCUPANT	808 N OLD WORLD THIRD ST 610	MILWAUKEE, WI 53203
CURRENT OCCUPANT	808 N OLD WORLD THIRD ST 304	MILWAUKEE, WI 53203
CURRENT OCCUPANT	808 N OLD WORLD THIRD ST 305	MILWAUKEE, WI 53203
CURRENT OCCUPANT	808 N OLD WORLD THIRD ST 310	MILWAUKEE, WI 53203
CURRENT OCCUPANT	823 N 2ND ST 711	MILWAUKEE, WI 53203
CURRENT OCCUPANT	823 N 2ND ST 805	MILWAUKEE, WI 53203
CURRENT OCCUPANT	823 N 2ND ST 901	MILWAUKEE, WI 53203
CURRENT OCCUPANT	823 N 2ND ST 906	MILWAUKEE, WI 53203
CURRENT OCCUPANT	823 N 2ND ST 302	MILWAUKEE, WI 53203
CURRENT OCCUPANT	823 N 2ND ST 303	MILWAUKEE, WI 53203
CURRENT OCCUPANT	823 N 2ND ST 309	MILWAUKEE, WI 53203
CURRENT OCCUPANT	823 N 2ND ST 311	MILWAUKEE, WI 53203
CURRENT OCCUPANT	823 N 2ND ST 405	MILWAUKEE, WI 53203
CURRENT OCCUPANT	823 N 2ND ST 511	MILWAUKEE, WI 53203
CURRENT OCCUPANT	823 N 2ND ST 514	MILWAUKEE, WI 53203
CURRENT OCCUPANT	823 N 2ND ST 607	MILWAUKEE, WI 53203



CURRENT OCCUPANT	823 N 2ND ST 702	MILWAUKEE, WI 53203
CURRENT OCCUPANT	808 N OLD WORLD THIRD ST 406	MILWAUKEE, WI 53203
CURRENT OCCUPANT	808 N OLD WORLD THIRD ST 409	MILWAUKEE, WI 53203
CURRENT OCCUPANT	808 N OLD WORLD THIRD ST 505	MILWAUKEE, WI 53203
CURRENT OCCUPANT	808 N OLD WORLD THIRD ST 301	MILWAUKEE, WI 53203
CURRENT OCCUPANT	808 N OLD WORLD THIRD ST 309	MILWAUKEE, WI 53203
CURRENT OCCUPANT	808 N OLD WORLD THIRD ST 311	MILWAUKEE, WI 53203
CURRENT OCCUPANT	823 N 2ND ST 713	MILWAUKEE, WI 53203
CURRENT OCCUPANT	823 N 2ND ST 804	MILWAUKEE, WI 53203
CURRENT OCCUPANT	823 N 2ND ST 806	MILWAUKEE, WI 53203
CURRENT OCCUPANT	823 N 2ND ST 814	MILWAUKEE, WI 53203
CURRENT OCCUPANT	823 N 2ND ST 911	MILWAUKEE, WI 53203
CURRENT OCCUPANT	823 N 2ND ST 913	MILWAUKEE, WI 53203
CURRENT OCCUPANT	823 N 2ND ST 208	MILWAUKEE, WI 53203
CURRENT OCCUPANT	823 N 2ND ST 308	MILWAUKEE, WI 53203
CURRENT OCCUPANT	823 N 2ND ST 407	MILWAUKEE, WI 53203
CURRENT OCCUPANT	823 N 2ND ST 508	MILWAUKEE, WI 53203
CURRENT OCCUPANT	823 N 2ND ST 606	MILWAUKEE, WI 53203
CURRENT OCCUPANT	823 N 2ND ST 610	MILWAUKEE, WI 53203
CURRENT OCCUPANT	823 N 2ND ST 611	MILWAUKEE, WI 53203
CURRENT OCCUPANT	823 N 2ND ST 613	MILWAUKEE, WI 53203
CURRENT OCCUPANT	823 N 2ND ST 705	MILWAUKEE, WI 53203
CURRENT OCCUPANT	823 N 2ND ST 214	MILWAUKEE, WI 53203
CURRENT OCCUPANT	808 N OLD WORLD THIRD ST 407	MILWAUKEE, WI 53203
CURRENT OCCUPANT	808 N OLD WORLD THIRD ST 506	MILWAUKEE, WI 53203
CURRENT OCCUPANT	808 N OLD WORLD THIRD ST 307	MILWAUKEE, WI 53203
CURRENT OCCUPANT	823 N 2ND ST 908	MILWAUKEE, WI 53203
CURRENT OCCUPANT	823 N 2ND ST 914	MILWAUKEE, WI 53203
CURRENT OCCUPANT	823 N 2ND ST 204	MILWAUKEE, WI 53203
CURRENT OCCUPANT	823 N 2ND ST 304	MILWAUKEE, WI 53203
CURRENT OCCUPANT	823 N 2ND ST 305	MILWAUKEE, WI 53203
CURRENT OCCUPANT	823 N 2ND ST 307	MILWAUKEE, WI 53203
CURRENT OCCUPANT	823 N 2ND ST 402	MILWAUKEE, WI 53203
CURRENT OCCUPANT	823 N 2ND ST 503	MILWAUKEE, WI 53203
CURRENT OCCUPANT	808 N OLD WORLD THIRD ST 611	MILWAUKEE, WI 53203
CURRENT OCCUPANT	823 N 2ND ST 803	MILWAUKEE, WI 53203
CURRENT OCCUPANT	823 N 2ND ST 807	MILWAUKEE, WI 53203
CURRENT OCCUPANT	823 N 2ND ST 907	MILWAUKEE, WI 53203
CURRENT OCCUPANT	823 N 2ND ST 909	MILWAUKEE, WI 53203
CURRENT OCCUPANT	823 N 2ND ST 912	MILWAUKEE, WI 53203
CURRENT OCCUPANT	823 N 2ND ST 202	MILWAUKEE, WI 53203
CURRENT OCCUPANT	823 N 2ND ST 301	MILWAUKEE, WI 53203
CURRENT OCCUPANT	823 N 2ND ST 408	MILWAUKEE, WI 53203
CURRENT OCCUPANT	823 N 2ND ST 411	MILWAUKEE, WI 53203
CURRENT OCCUPANT	823 N 2ND ST 414	MILWAUKEE, WI 53203
CURRENT OCCUPANT	823 N 2ND ST 504	MILWAUKEE, WI 53203
CURRENT OCCUPANT	823 N 2ND ST 601	MILWAUKEE, WI 53203

CURRENT OCCUPANT	823 N 2ND ST 612	MILWAUKEE, WI 53203
CURRENT OCCUPANT	823 N 2ND ST 701	MILWAUKEE, WI 53203
CURRENT OCCUPANT	823 N 2ND ST 206	MILWAUKEE, WI 53203
blank	notice	

Total Records: 143

Radius: 250.0 feet and Center of Circle: 822 N Old World Third St



**BUSINESS LICENSE PLAN OF OPERATION**

ccl-busplan 3/15/18

Office of the City Clerk License Division  
200 E. Wells St. Room 105, Milwaukee, WI 53202  
(414) 286-2238 www.milwaukee.gov/license e-mail address: [license@milwaukee.gov](mailto:license@milwaukee.gov)

**1. Type of Business**

Applying for:  Extended Hours (12AM to 5AM) - If a food establishment, check all that apply:  Delivery  Drive Thru  Dining Room  
 Self Service Laundry  Massage Establishment  Filling Station  
 Other (supplemental application for specific license also required) Parking Lot

Provide a detailed description of the type of business you plan on operating: Parking Lot

Do you have any experience operating this type of business?  No  Yes If yes, explain: Interstate Parking was founded in 2009 and operate nearly 50 locations in Milwaukee and several in several other cities

**2. Business Operations**

- a. Proposed Opening Date: Already Open
- b. Is this premise under construction?  No  Yes If yes, list estimated completion date: \_\_\_\_\_
- c. Is this a franchise?  No  Yes
- d. Is this premises currently licensed?  No  Yes If yes, list type of license: \_\_\_\_\_
- e. Is the current licensee operating?  No  Yes If no, list date closed: \_\_\_\_\_
- f. Do you have future plans for other businesses, licenses or permits at this location?  No  Yes  
If yes, explain: \_\_\_\_\_
- g. Have you previously held an Extended Hours License in Milwaukee?  No  Yes  
If yes, list address(es): \_\_\_\_\_
- h. Are other businesses operating in the same building?  No  Yes If yes, describe: \_\_\_\_\_

**3. Litter & Noise**

- a. How are grounds kept clean?  Sweep  Pressure Wash  Pick Up Litter  Other: \_\_\_\_\_
- b. How often will grounds be cleaned?  Daily  Weekly  As Needed  Monthly  Other: \_\_\_\_\_
- c. Grounds cleaned by:  Licensee  Building Owner  Employees  Hired Maintenance  Other: \_\_\_\_\_
- d. How are noise issues prevented and/or addressed?  Security  Manager approaches customer(s)  Call Police  
 Signs Posted  Other: \_\_\_\_\_
- e. Will a sound amplification system be used?  No  Yes If yes, describe: \_\_\_\_\_

**4. Smoking & Sanitation**

- a. Are there designated outdoor smoking areas?  No  Yes If yes, describe: \_\_\_\_\_
- b. Number of Garbage Cans: Inside: \_\_\_\_\_ Locations: \_\_\_\_\_  
Outside: 1 Locations: Near the paystation
- c. Is a crowd control barrier used?  No  Yes If yes, describe: \_\_\_\_\_
- d. How many restrooms are on the premises? 0
- e. Name of solid waste contractor:  Advanced Disposal  Waste Management  Other: \_\_\_\_\_

### 5. Security

- a. Are there onsite parking spaces?  No  Yes If yes, how many? 53 and describe the parking security plan: \_\_\_\_\_
- b. Is there a loading zone?  No  Yes If yes, describe the loading area security plan: \_\_\_\_\_
- c. Will you have security personnel on premise?  No  Yes If yes, how many? \_\_\_\_\_ and answer the following:  
 What are their responsibilities? \_\_\_\_\_  
 Is security equipment used?  No  Yes If yes, describe \_\_\_\_\_  
 List their licensing, certification, or training credentials \_\_\_\_\_
- d. Will there be security cameras?  No  Yes If yes, how many? \_\_\_\_\_ and list locations: Discussing plans to install
- e. Will searches/identification checks be done upon entry?  No  Yes If yes, describe \_\_\_\_\_

### 6. Percentage of Sales (must total 100%)

Alcohol _____%	Food _____%	Secondhand Merchandise _____%	Precious Metals & Gems _____%
Entertainment _____%	Cigarettes _____%		
Pawnbroker Activity _____%	Salvaged Materials _____% (such as scrap metal)	Personal Services (such as tattoo, body piercing, salon, tailor, tanning, etc.) _____%	Other <u>100</u> % Describe: <u>Parking revenue</u>

### 7. Businesses/Licenses on the Premises (check all that apply):

#### Type 1

- Full Service Restaurant       Cafe/Coffee Shop       Deli or Fast Food Restaurant       Private/Fraternal/Veterans Club
- Night Club       Tavern       Cocktail Lounge       Teen Club
- Banquet Hall       Sports Facility       Bowling Alley
- Hotel/Motel: Number of Floors: \_\_\_\_\_       Rooming House: Number of Floors: \_\_\_\_\_  
 Number of Rooms: \_\_\_\_\_      Number of Rooms: \_\_\_\_\_

#### Type 2

- Liquor Store       Corner Store       Supermarket       Convenience Store
- Gas Station       Amusement/Phonograph Distributor       Recycling, Salvage or Towing
- Used Car Dealer       Personal Service Establishment  
 (such as tattoo business, hair salon, tailor, etc.)       Recording Studio

What other licenses/permits will you hold at this location? (check all that apply)

- Occupancy Permit     Cigarette & Tobacco     Gas Station     Extended Hours     Class "B" Tavern     Weights & Measures
- Secondhand Dealer     Precious Metal & Gem     Other: \_\_\_\_\_

### 8. Legal Capacity (only if a Type 1 premises in #7 above)

Capacity \_\_\_\_\_ (Call the Milwaukee Development Center at 414-286-8211 if you have questions.)

## 9. Premises Description

- a. Identify all area(s) of the premises that will be used in operating this business (include areas used only for storage):  
 1<sup>st</sup> Floor  2<sup>nd</sup> Floor  Basement Storage  Patio  Beer Garden  Sidewalk Café  Deck  Rooftop  
 Other: Describe: The entire parking lot
- b. Describe Location:  Major Thoroughfare  Secondary Street  Other: Old World third & Wells
- c. Nearest Major Cross Street: Wells St
- d. Describe Building:  Free Standing Building  Strip Mall  Other: Parking lot
- e. Describe Premises Structure:  Single Story  Multi-Story - # of Stories \_\_\_\_\_  Other: Surface lot
- f. Describe Surrounding Area:  Commercial  Residential  Industrial  Other: \_\_\_\_\_
- g. Building Owner Name: The Parking Reit - Dan Huberty Phone Number: dhuberty@theparkingreit.com  
 Business Owner Address: 9130 W Post Road #200, Las Vegas NV 89148

## 10. Hours of Operation & Customers

Will customers be entering the premises?  No  Yes

Day of the Week	Proposed Hours of Operation:		Estimated Number of Customers expected each day	Potential Age Range of Customers	Class B Tavern Applicant Only: Age Restriction (If none, write 'None')
	Open Time (include a.m. or p.m.)	Close Time (include a.m. or p.m.)			
Sunday	24 hours	24 hours	50	18-80	
Monday	24 hours	24 hours	50	18-80	
Tuesday	24 hours	24 hours	50	18-80	
Wednesday	24 hours	24 hours	50	18-80	
Thursday	24 hours	24 hours	50	18-80	
Friday	24 hours	24 hours	50	18-80	
Saturday	24 hours	24 hours	50	18-80	

An Extended Hours Establishment License is required for any convenience store, filling station, personal service establishment (such as tattoo, body piercing, salon, tailor, tanning, etc.), recording studio or restaurant which is open between the hours of 12:00 a.m. and 5:00 a.m.

Alcohol Establishments Class A: 8:00 am to 9:00 pm Sunday thru Saturday  
 Permitted Hours of Operation: Class B: 6:00 am to 2:00 am Sunday thru Thursday, 6:00 am to 2:30 am Friday & Saturday

Entertainment Outdoor Closing Hours: 10:00pm Sunday-Thursday; 12:00am Friday & Saturday; unless a different time, either earlier or later, is established by the Common Council in its approval of the licensee's plan of operation.

## 11. Signature(s)

Signature of Sole Proprietor, Partner, or 20% or more Shareholder  
 (If there are no 20% or more shareholders,  
 Corporate Officer-print name/title and sign)

Signature of additional partner or 20% or more shareholder

See Application Information for a complete list of all required application forms.



# PARKING LOT LICENSE AND WEIGHTS & MEASURES (TIMING DEVICE) LICENSE SUPPLEMENTAL PLAN OF OPERATION

OFFICE OF THE CITY CLERK LICENSE DIVISION  
200 E. WELLS ST. ROOM 105, MILWAUKEE, WI 53202  
(414) 286-2238 [license@milwaukee.gov](mailto:license@milwaukee.gov) [www.milwaukee.gov/license](http://www.milwaukee.gov/license)

Legal Entity Name:	Interstate Parking Company LLC
Parking Lot Address:	822 N Old World Third St, Milwaukee WI 53203
Number of Parking Spaces:	53
<b>Security Plan</b>	
Describe in detail the security measures that will be taken to protect patrons from harm: The lot is well lit at night and we are proposing to the owner to install icloud based cameras facing the lot. Lot patrollers, Managers and Maintenance will frequent the lot during the day.	
Describe in detail the security measures that will be taken to protect vehicles and property inside vehicles from theft, vandalism or other damage: The lot is well lit at night and we are proposing to the owner to install icloud based cameras facing the lot. Lot patrollers, Managers and Maintenance will frequent the lot during the day.	
Describe in detail plans to comply with City Ordinance which states a person must be available at all times parking service is offered with a response time of no greater than 30 minutes: Interstate Parking has three 24 hour on call Managers.	
<b>Weights &amp; Measures License</b>	
Will timing devices be used to establish parking charges? <input type="checkbox"/> No <input checked="" type="checkbox"/> Yes If yes, how many? <u>1</u> x \$30 per device	
<b>Signature of Property Owner</b>	
Print Name of Property Owner:	MVP MILWAUKEE OLD WORLD LLC
Signature of Property Owner:	<i>[Signature]</i> DIRECTOR OF ASSET MGMT
<b>Signature of Applicant</b>	
I understand and will comply with all requirements as stated in the Milwaukee Code of Ordinances.	
Sole Proprietor, Partner, or 20% or more Shareholder (if no 20% or more shareholders, corporate officer must print name and sign)	Signature of additional partner or 20% or more shareholder

Old World 3rd St

N →

Entry/Exit  
15 ft.

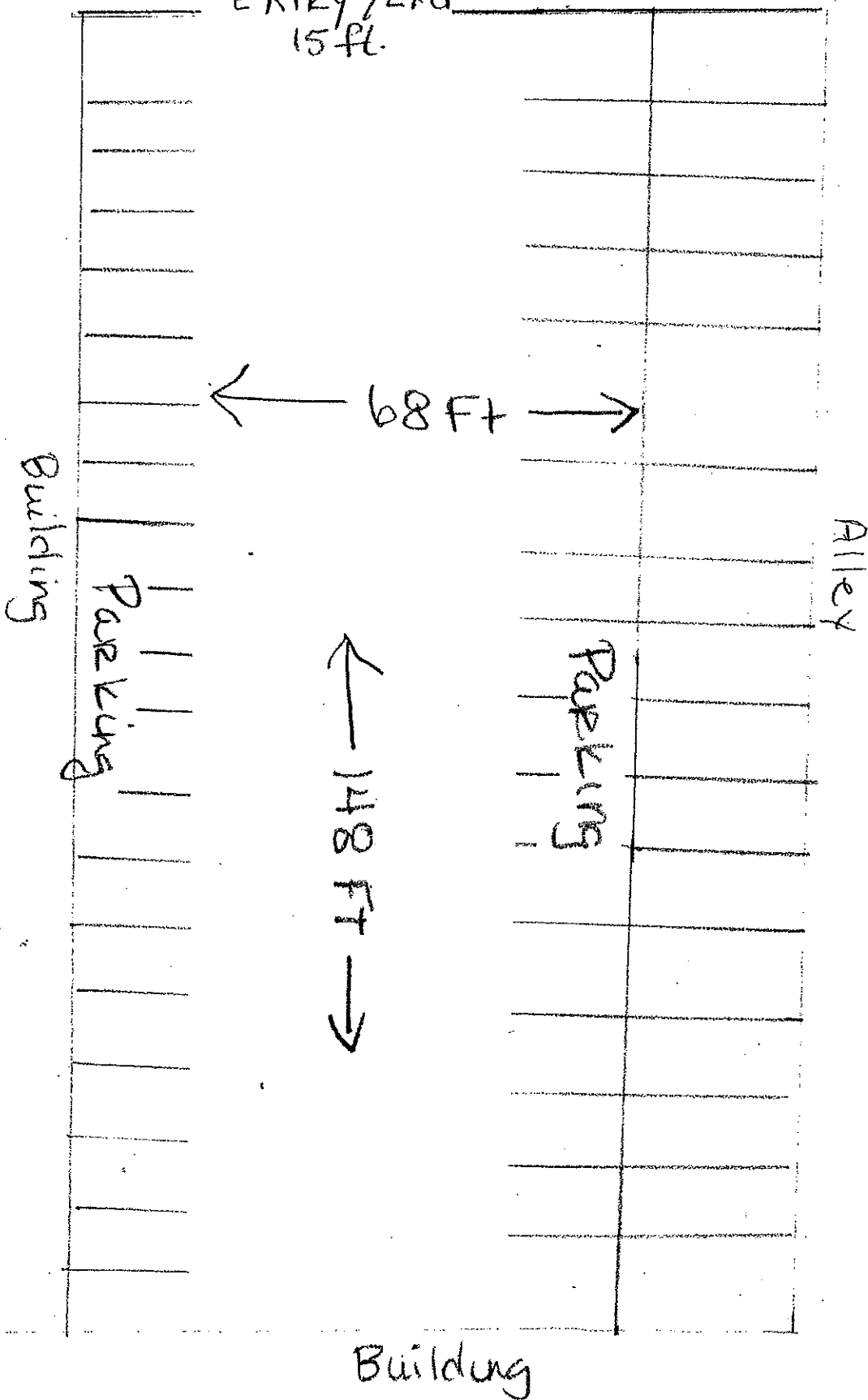

Building

Alley

Parking

← 148 ft →

Building

Interstate Parking Company LLC  
 Interstate Parking Company LLC  
 Erica Malloncourt - GM  
 829 N. Old World 3rd St

WORLD  
PARKING

P

Parking

822 North Old  
World 3rd Street