

Present Day Site

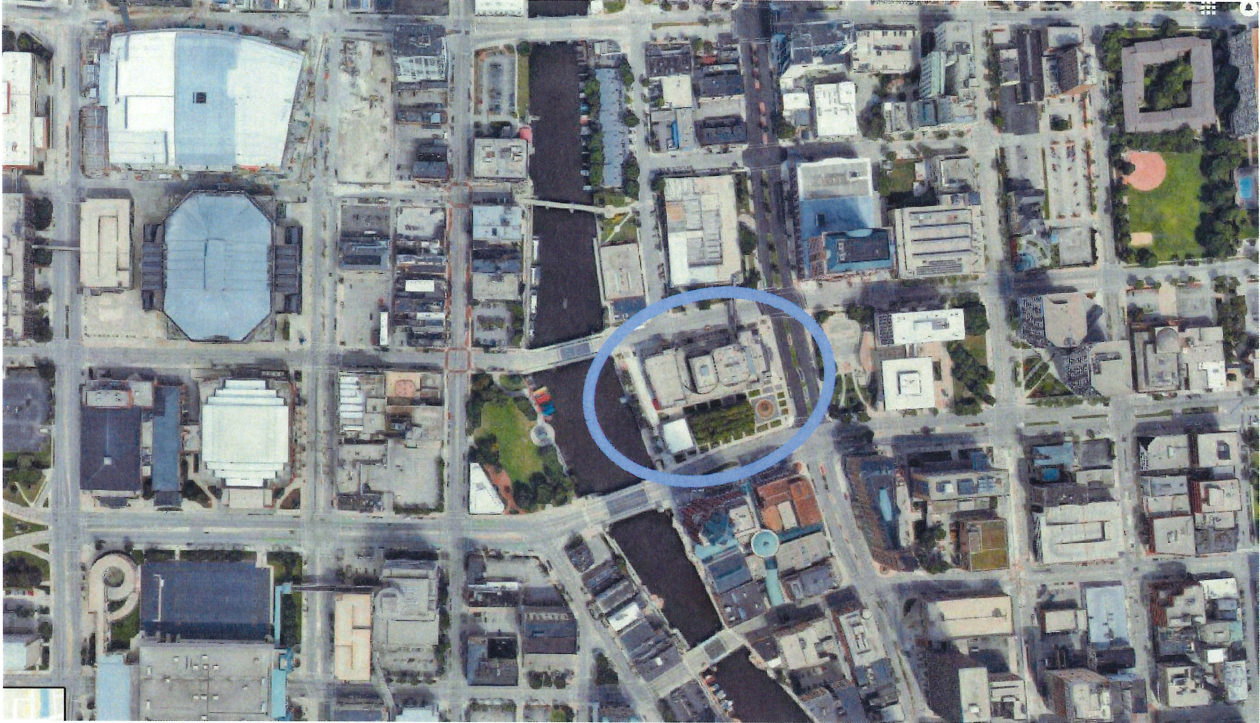

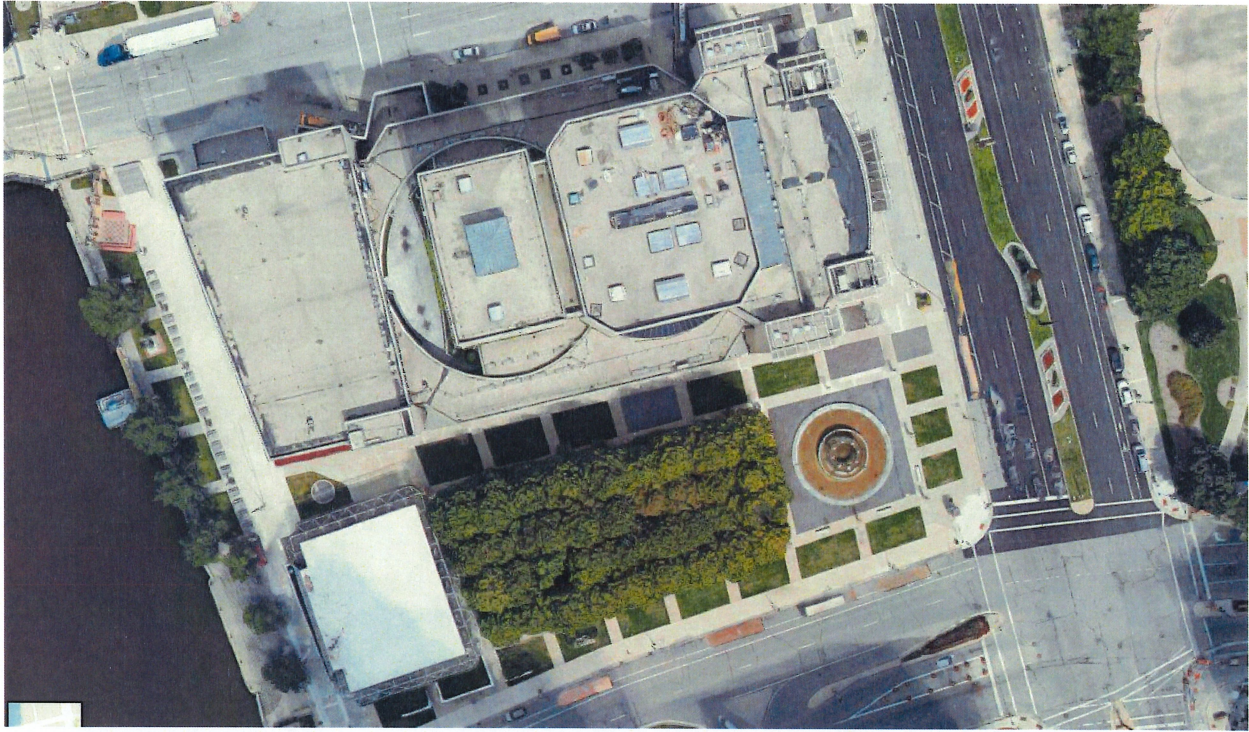

Historic Plans and Images

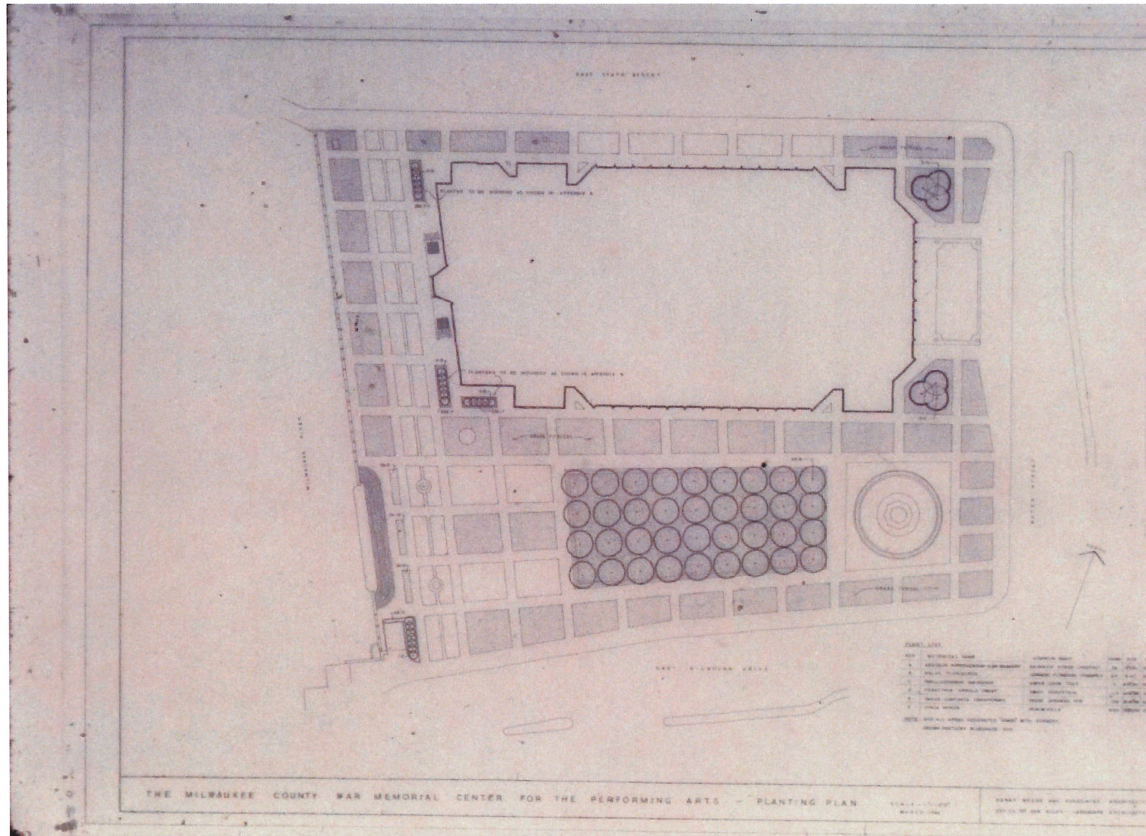

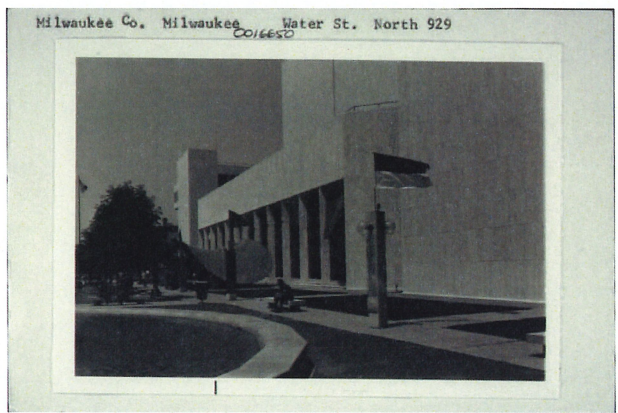
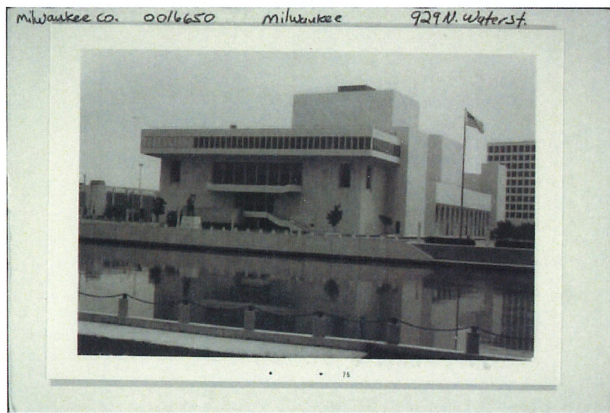

The following images are from the archive published by the Milwaukee Journal Sentinel on December 7, 2018.

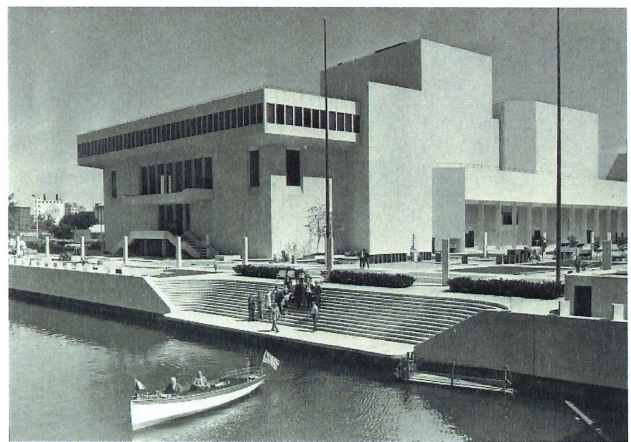

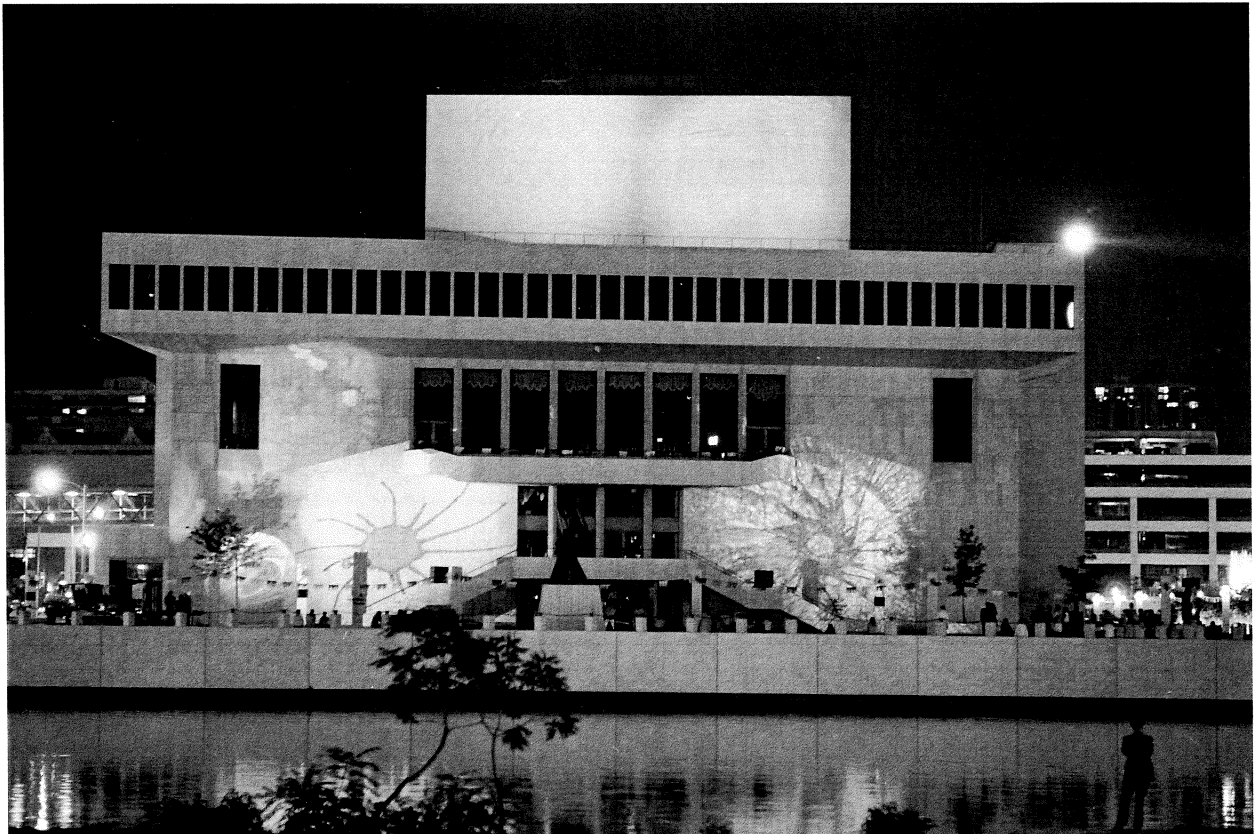

Milwaukee County Land Information Parcel Report

TAXKEY: 3921172111

Report generated 11/1/2017 10:11:55 AM

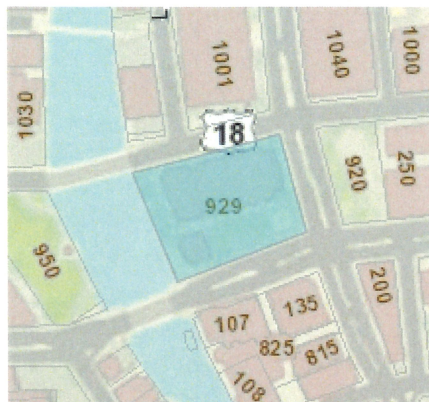

Parcel location within Milwaukee County

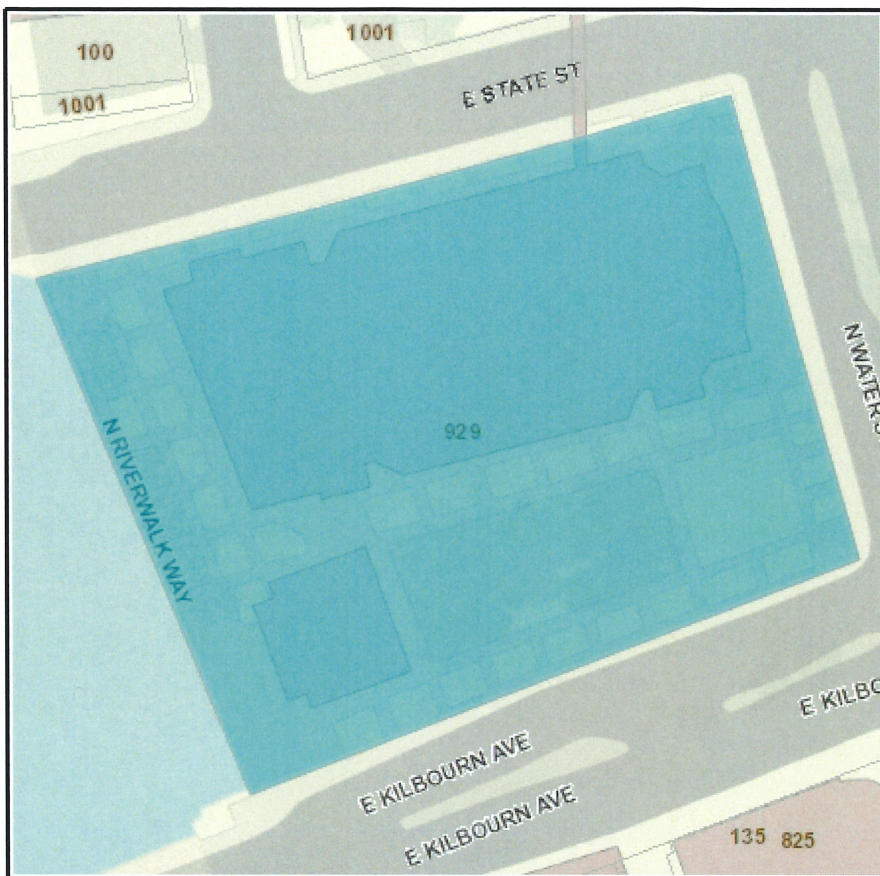

Selected parcel highlighted

Parcel Information

TAXKEY: 3921172111
Record Date: 06/07/1968
Owner(s): MILWAUKEE COUNTY
%BUSINESS MANAGER
PERFORMING ARTS CENTER

Address:	929 N WATER ST	Assessed Value:	\$16,215,000
Municipality:	Milwaukee	Land Value:	\$915,000
Acres:	3.65	Improvement Value:	\$15,300,000

Parcel Description: COUNTY
Zoning Description: C9D(A), Central Business - Civic Activity
Legal Description: PLAT OF MILWAUKEE IN SECS (28-29-33)-7-22 PART (BLOCKS 48-49-53-VAC STRS & ALLEY & LOTS 1 TO 5 INCL FISCHER'S SUBD) LYING BETW E STATE ST-E KILBOURN-MILWAUKEE RIVER & N WATER ST BID #21

School District: MILWAUKEE SCHOOL DISTRICT

This map is a user generated static output from an Internet mapping site and is for reference only. Data layers that appear on this map may or may not be accurate, current, or otherwise reliable.



CONTACT US

ROWSE

SEARCH

EVENTS

STORE

PROPERTY RECORD 929 N WATER ST

Architecture and History Inventory

[PRINT](#) [EMAIL A FRIEND](#) [FACEBOOK](#) [TWITTER](#) [MORE...](#)



NAMES

Historic Name: **Performing Arts Center**
Other Name: **Marcus Center for the Performing Arts**
Contributing:
Reference Number: **16650**

PROPERTY LOCATION

Location (Address): **929 N WATER ST**
County: **Milwaukee**
City: **Milwaukee**
Township/Village:
Unincorporated Community:
Town:
Range:
Direction:
Section:
Quarter Section:
Quarter/Quarter Section:

PROPERTY FEATURES

Year Built: **1969**
Additions: **1992**
Survey Date: **1984**
Historic Use: **auditorium**
Architectural Style: **Contemporary**
Structural System:
Wall Material: **Marble**
Architect: **HARRY WEESE AND ASSOCIATES** Daniel Urban Kiley-gardens
Other Buildings On Site:
Demolished?: **No**
Demolished Date:

DESIGNATIONS

National/State Register Listing Name:
National Register Listing Date:
State Register Listing Date:
National Register Multiple Property Name:

RESOURCE DESCRIPTIONS

About the National Register and State Register of Historic Places

All Wisconsin National Register of Historic Places listings are searchable on our website.

About Our Wisconsin Architecture and History Inventory (AHI)

Search digital records on more than 140,000 historic buildings, structures and objects throughout Wisconsin.

RELATED ARTICLES

Is Your Property Eligible for the National Register or State Register of Historic Places?

Eligible properties must retain the essential physical appearance of the period in which they were important, and meet one of four criteria.

Related products from our Online Store:

[Forward 1848 Sweatshirt](#)



Price: \$42.95

[Wisconsin Wool Pillow](#)



NOTES ▶

Additional Information:

Bibliographic References: MILWAUKEE HISTORIC BUILDINGS TOUR: JUNEAU TOWN, CITY OF MILWAUKEE DEPARTMENT OF CITY DEVELOPMENT 1994.

RECORD LOCATION ▶

Wisconsin Architecture and History Inventory, Division of Historic Preservation, Wisconsin Historical Society, Madison, Wisconsin

Have Questions?

If you didn't find the record you were looking for, or have other questions about historic preservation, please email us and we can help:

joe.derose@wisconsinhistory.org

If you have an update, correction, or addition to a record, please include this in your message:

- AHI number
- Information to be added or changed
- Source information

Note: When providing a historical fact, such as the story of a historic event or the name of an architect, be sure to list your sources. We will only create or update a property record if we can verify a submission is factual and accurate.

How to Cite

For the purposes of a bibliography entry or footnote, follow this model:

Wisconsin Architecture and History Inventory Citation

Wisconsin Historical Society, Wisconsin Architecture and History Inventory, "Historic Name", "Town", "County", "State", "Reference Number".

CONTACT US

DIVISIONS

Library-Archives
Museums and Historic Sites
Historic Preservation
Office of Programs and Outreach
Administrative Services

GENERAL INFORMATION

About the Society
Media Room
Hours
Staff Directory
Employment
Volunteer
Privacy Policy

SELECTED PROGRAMS

National History Day
Wisconsin Historical Images
Office of School Services
Wisconsin Historical Society Press
State Historic Preservation Officer (SHPO)
State Archives & Gov. Publications
Speakers Bureau

SERVICES FOR

Educators
Government Agencies
Journalists
Legislators
Local Historians

CONNECT WITH US

Facebook
Flickr
Twitter
ENewsletters
YouTube
Tumblr
Pinterest

Price: \$45.00

2018 Wisconsin State Capitol Ornament



Price: \$20.00

Hunting Camp 52: Tales from a North Woods Deer Camp

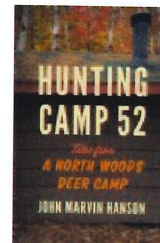

Price: \$18.95

The Misunderstood Mission of Jean Nicolet: Uncovering the Story of the 1634 Journey

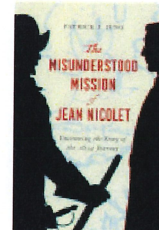

Price: \$28.95

Beer Cap Map



Price: \$34.95