



CITY OF MILWAUKEE
OFFICE OF THE CITY CLERK

Sunday, March 29, 2015

COMMITTEE MEETING NOTICE

AD 12

GARCIA GARCIA, Rafael, Agent
Taqueria y Pollos al Carbon El Parian LLC
1631 W MITCHELL St

Milwaukee, WI 53204

You are requested to attend a hearing which is to be held in Room 301-B, Third Floor, City Hall on:

Monday, April 06, 2015 at 11:00 AM

Regarding: Your Public Entertainment Premises License Application Requesting Dancing by Performers, Disc Jockey, Instrumental Musicians, Karaoke, and Magic Shows as agent for "Taqueria y Pollos al Carbon El Parian LLC" for "Parian" at 1631 W MITCHELL St.

There is a possibility that your application may be denied for one or more of the following reasons: The recommendation of the committee regarding the application shall be based on evidence presented at the hearing. Per MCO 85-2.7-4, probative evidence concerning whether or not a new license should be granted may be presented on the following subjects: whether or not the applicant meets the municipal requirements, the appropriateness of the location and premises where the licensed premises is to be located and whether use of the premises for the purposes or activities permitted by the license would tend to facilitate a public or private nuisance or create undesirable neighborhood problems such as disorderly patrons, unreasonably loud noise, litter, and excessive traffic and parking congestion. Probative evidence relating to these matters may be taken from the plan of operation submitted with the license application, if any, but shall not include the content of any music. Evidence regarding the fitness of the location of the premises to be maintained as the principal place of business, including but not limited to whether there is an overconcentration of businesses of the type for which the license is sought; whether the proposal is consistent with any pertinent neighborhood business or development plans, or the location's proximity to areas where children are typically present. The applicant's record in operating similarly licensed premises; and whether or not the applicant has been charged with or convicted of any felony, misdemeanor, municipal offense or other offense, the circumstances of which substantially relate to the activity to be permitted by the license being applied for or any other factor which reasonably relates to the public health, safety or welfare may also be considered. See attached police report or correspondence.

Notice for applicants with warrants or unpaid fines:

Proof of warrant satisfaction or payment of fines must be submitted at the hearing on the above date and time. Failure to comply with this requirement may result in a delay of the granting/denial of your application.

Failure to appear at this meeting may result in the denial of your license. Individual applicants must appear only in person or by an attorney. Corporate or Limited Liability applicants must appear only by the agent designated on the application or by an attorney. Partnership applicants must appear by a partner listed on the application or by an attorney. If you wish to do so and at your own expense, you may be accompanied by an attorney of your choosing to represent you at this hearing.

You will be given an opportunity to speak on behalf of the application and to respond and challenge any charges or reasons given for the denial. No petitions can be accepted by the committee, unless the people who signed the petition are present at the committee hearing and willing to testify. You may present witnesses under oath and you may also confront and cross-examine opposing witnesses under oath. If you have difficulty with the English language, you should bring an interpreter with you, at your expense, so that you can answer questions and participate in your hearing.

You may examine the application file at this office during regular business hours prior to the hearing date. Inquiries regarding this matter may be directed to the person whose signature appears below.

Limited parking for persons attending meetings in City Hall is available at reduced rates (5 hour limit) at the Milwaukee Center on the southwest corner of East Kilbourn and North Water Street. Parking tickets must be validated in the first floor information booth in City Hall.

PLEASE NOTE: Upon reasonable notice, efforts will be made to accommodate the needs of disabled individuals through sign language interpreters or other auxiliary aids. For additional information or to request this service, contact the Council Services Division ADA Coordinator at (414) 286-2998, Fax - (414) 286-3456, TDD - (414) 286-2025.

JIM OW CZARSKI, CITY CLERK

BY:

Jason Schunk

License Division Manager

If you have questions regarding this notice, please contact the License Division at (414) 286-2238.

200 E. Wells Street, Room 105, City Hall, Milwaukee, WI 53202. www.milwaukee.gov/license
Phone: (414) 286-2238 Fax: (414) 286-3057 Email Address: License@milwaukee.gov

MILWAUKEE POLICE DEPARTMENT

LICENSING

CRIMINAL RECORD/ORDINANCE VIOLATION/INCIDENTS SYNOPSIS

DATE: 00/27/2015
LICENSE TYPE: PEP
NEW:
RENEWAL:

No. 205386
Application Date: 02/25/2015

License Location: 1631 W. Mitchell St
Business Name: Taqueria v Pollos al Carbon El Parian

Licensee/Applicant: Garcia Garcia, Rafael
(Last Name, First Name, MI)

Date of Birth: 02/23/1972

Home Address: 4227 South 91st Place
City: Greenfield State: WI Zip Code: 53228
Home Phone:

This report is written by Police Officer David NOVAK, assigned to the License Investigation Unit, Days.

The Milwaukee Police Department's investigation regarding this application revealed the following:

1. On 10/07/2008 Rogelio Mercado Sanchez was cited in the City of Milwaukee at 2123 S. 5th Pl for Building Code Violations. Rogelio Mercado Sanchez is listed on the application as 50% shareholder.

Charge: Building Code Violations
Finding: Guilty
Sentence: Fined \$230.00
Date: 12/17/2009
Case: 09128051

2. On 02/18/2010 Rogelio Mercado Sanchez was cited in the City of Milwaukee at 1727 S. 5th St for Building Code Violations. Rogelio Mercado Sanchez is listed on the application as 50% shareholder.

Charge: Building Code Violations
Finding: Guilty
Sentence: Fined \$230.00
Date: 10/07/2010
Case: 10085974

3. On 10/20/2010 Rogelio Mercado Sanchez was cited in the City of Milwaukee at 1631 W. Mitchell St for Prerecorded Music Machine License. Rogelio Mercado Sanchez is listed on the application as 50% shareholder.

Charge: Prerecorded Music Machine License
Finding: Guilty
Sentence: Fined \$368.00
Date: 03/11/2011
Case: 10126657

4. On 02/14/2015 Officers conducted a license premises check on El Parian at 1631 W. Mitchell St based on information a radio advertisement stating the bar was having a live band that day. The officers did not find a band or a stage. The co-owner, Rogelio MERCADO-SANCHEZ, stated he was not having a band and had no plans for a band. He stated he knows he needs a PEP and had an appointment to obtain that license.

MILWAUKEE POLICE DEPARTMENT

REPORT OF INCIDENTS INVOLVING LICENSED PERSONS OR PREMISES

TO: Captain Alfonso MORALES

Business Name: Taqueria y Pollos al Carbon El Parian
Address of Licensed Premises: 1631 W Mitchell St Milwaukee, WI 53204
Business Phone: _____ Type of License: B & Food Dealer

ORIGINAL

District: 2

Violation / Incident # _____ Date of Incident: _____

Licensee or Manager on premises at time of violation / Incident? Yes No

Licensee cooperative? Yes No (if no, explain in narrative section)

Licensee Notified by Officer: P.O. VODICKA Date: 02/14/15 Time: 1:36 pm

Licensee or Agent's Name: GARCIA-GARCIA, Rafael Date of Birth: 02/23/72
Home Address: 4227 S 91st Pl Greenfield, WI 53228 Home Phone: _____

Co-Licensee Name: MERCADO-SANCHEZ, Rogelio Date of Birth: 07/08/70
Home Address: 1631 W Mitchell St Milwaukee, WI 53204 Home Phone: 414-975-7205
Class S License Number: _____

Bartender Name: _____ Date of Birth: _____
Home Address: _____ Home Phone: _____
Class D License Number: _____

Licensed Person / Public Pass. Vehicle, etc.: _____ Date of Birth: _____
Home Address: _____ Home Phone: _____
Class D License Number: _____

VIOLATION/INCIDENT - DESCRIBE FACTS AND CIRCUMSTANCES IN NARRATIVE SECTION

Name of Person Cited: _____ Date of Birth: _____
Citation Number: _____ Violation & Ord. / Statue No.: _____ Court Date: _____

Name of Person Cited: _____ Date of Birth: _____
Citation Number: _____ Violation & Ord. / Statue No.: _____ Court Date: _____

Name of Person Cited: _____ Date of Birth: _____
Citation Number: _____ Violation & Ord. / Statue No.: _____ Court Date: _____

Name of Person Cited: _____ Date of Birth: _____
Citation Number: _____ Violation & Ord. / Statue No.: _____ Court Date: _____

Name of Person Cited: _____ Date of Birth: _____
Citation Number: _____ Violation & Ord. / Statue No.: _____ Court Date: _____

Investigating Officer: P.O. Kevin VODICKA District / Bureau: 22 Date: 02/15/15

Kevin Vodicka

Commanding Officer Date

DISPOSITION - FOR LICENSING ONLY

Citation No.	Case Number	Disposition	Judge	Date

LICENSE INVESTIGATION UNIT

Received 2-19-15

Referred _____

By *[Signature]*

PA-33E Narrative

This report is written by P.O. Kevin VODICKA, assigned to District Two Early Shift. On Saturday, February 14, 201, at 1:36 pm, Squads 2264 (P.O. Jesus GLORIA) and 2268 (P.O. VODICKA) conducted a license premises check at "Taqueria y Pollos al Carbon el Parian" or "El Parian", located at 1631 W. Mitchell St., after receiving information from P.O. Efrain CORNEJO that he had heard a radio advertisement for the premises that mentioned the premises having a live band on today's date.

Officers entered the premises did not observe a band or a stage for a band. Officers then spoke with the co-owner of the premises, Rogelio MERCADO-SANCHEZ (M/W 07/08/70), who stated he did not have a band playing and had no plans for a band to play at the premises. MERCADO-SANCHEZ was cooperative and stated that he was aware that he needed a "PEP" license in order to have live music at the location. MERCADO-SANCHEZ further stated that he had an appointment with his alderman during the coming week to discuss obtaining such a license.



PUBLIC ENTERTAINMENT PREMISES LICENSE SUPPLEMENTAL APPLICATION

Office of the City Clerk License Division
200 E. Wells St. Room 105, Milwaukee, WI 53202
(414) 286-2238 www.milwaukee.gov/license e-mail address: license@milwaukee.gov

TYPES OF ENTERTAINMENT (CHECK ALL THAT APPLY)

<input checked="" type="checkbox"/> Instrumental Musicians	<input type="checkbox"/> Bands	<input type="checkbox"/> Battle of the Bands	<input type="checkbox"/> Comedy Acts
<input checked="" type="checkbox"/> Disc Jockey	<input checked="" type="checkbox"/> Magic Shows	<input type="checkbox"/> Poetry Readings	<input checked="" type="checkbox"/> Dancing by Performers
<input type="checkbox"/> Adult Entertainment/ Strippers/Erotic Dance	<input type="checkbox"/> Wrestling	<input type="checkbox"/> Patron Contests	<input type="checkbox"/> Patrons Dancing
<input type="checkbox"/> Jukebox	<input checked="" type="checkbox"/> Karaoke	<input type="checkbox"/> Bowling Alley	<input type="checkbox"/> Pool Tables
<input type="checkbox"/> Motion Pictures	<input type="checkbox"/> Amusement Machines –	<input type="checkbox"/> Concerts	<input type="checkbox"/> Theatrical Performances
How many? _____	How many? _____	Approx. # per year? _____	Approx. # per year? _____
<input type="checkbox"/> Other: _____			

WILL PROMOTERS EVER BE USED FOR ANY OF THE ENTERTAINMENT?

No Yes, describe: _____

LEGAL CAPACITY OF PREMISES

99 (Call the Development Center at 414-286-8211 with questions.) Legal capacity determines the fee for your Public Entertainment Premises License. If you would like to request the license be approved with a lower capacity than that listed above, indicate the lower capacity here: _____. If approved, this lower capacity will print on your license and override the capacity listed on your Occupancy Permit.

WILL SOUND AMPLIFICATION EVER BE USED?

No Yes, describe: Stereo

DECLARATIONS, ACKNOWLEDGEMENTS, & DISCLOSURES

Read And Initial Each Item Confirming Your Understanding:

1. Ry I understand that after the license has been issued, a change to the plan of operation will require a written request to change and approval from the Common Council.
2. Ry I agree to inform the City Clerk within 10 days of any substantial changes in the information supplied in this application.
3. Ry I understand that I shall not willfully refuse to provide the services offered under this license, or add charges or require deposits not required of the general public because of race, color, sex, religion, national origin or ancestry, age, handicap, lawful source of income, marital status, sexual orientation, gender identity or expression, familial status or the fact that a person is now or has been a member of the military service, whether dressed in uniform or not; and shall not seek such information as a condition of employment, or penalize any employee or discriminate in the selection of personnel for training or promotion on the basis of such information.
4. Ry I have knowledge of the City Ordinances currently regulating public entertainment, and understand that the license may be subject to suspension, non-renewal or revocation, if I violate any rule, law or regulation of the city of Milwaukee and State of Wisconsin.

NOTARIZED SIGNATURES OF APPLICANTS

SUBSCRIBED AND SWORN TO BEFORE ME

This 25th day of FEBRUARY, 2015

[Signature]
(Clerk/Notary Public)
My Commission Expires 3/6/16

[Signature]
Agent/Owner/Partner

Additional Owner/Partner

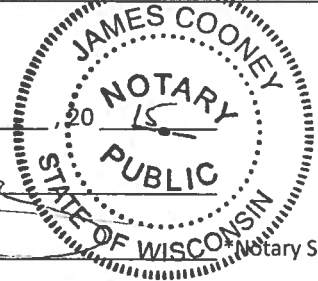

Notary Seal must be affixed.

Office Use Only: Initials: _____ Filed: _____ App: _____

Check if only PEP (must be heard w/in 60 days) Granted _____ License # _____



PLAN OF OPERATION CONFIRMATION STATEMENT

Office of the City Clerk License Division
200 E. Wells St. Room 105, Milwaukee, WI 53202
(414) 286-2238 license@milwaukee.gov

Date: 2-25-2015

License(s) Being Applied For: P.e.p

I confirm that the plan of operation on file which was previously submitted with my BTAVN 202426
(type of license)
application has not changed, except for the addition of this business being operated.

I understand any changes to the plan of operation on file must be reported to the City Clerk License
Division within 10 days of the change.

Rafael Garcia
Print name of individual, partner, agent or 20% or more shareholder

[Signature]
Signature



CITY OF MILWAUKEE
OFFICE OF THE CITY CLERK

Thursday, March 26, 2015

COMMITTEE MEETING NOTICE

AD 12

GHAZAI, Mustafa N, Agent
Diamond Auto Sales LLC
1801 W FOREST HOME Av

Milwaukee, WI 53204

You are requested to attend a hearing which is to be held in Room 301-B, Third Floor, City Hall on:

Monday, April 06, 2015 at 11:00 AM

Regarding: Your Secondhand Motor Vehicle Dealer's License Application as agent for "Diamond Auto Sales LLC" for "Diamond Auto Sales" at 1801 W FOREST HOME Av.

There is a possibility that your application may be denied for one or more of the following reasons: The recommendation of the committee regarding the application shall be based on evidence presented at the hearing. Per MCO 85-2.7-4, probative evidence concerning whether or not a new license should be granted may be presented on the following subjects: whether or not the applicant meets the municipal requirements, the appropriateness of the location and premises where the licensed premises is to be located and whether use of the premises for the purposes or activities permitted by the license would tend to facilitate a public or private nuisance or create undesirable neighborhood problems such as disorderly patrons, unreasonably loud noise, litter, and excessive traffic and parking congestion. Probative evidence relating to these matters may be taken from the plan of operation submitted with the license application, if any, but shall not include the content of any music. Evidence regarding the fitness of the location of the premises to be maintained as the principal place of business, including but not limited to whether there is an overconcentration of businesses of the type for which the license is sought; whether the proposal is consistent with any pertinent neighborhood business or development plans, or the location's proximity to areas where children are typically present. The applicant's record in operating similarly licensed premises; and whether or not the applicant has been charged with or convicted of any felony, misdemeanor, municipal offense or other offense, the circumstances of which substantially relate to the activity to be permitted by the license being applied for or any other factor which reasonably relates to the public health, safety or welfare may also be considered. See attached police report or correspondence.

Notice for applicants with warrants or unpaid fines:

Proof of warrant satisfaction or payment of fines must be submitted at the hearing on the above date and time. Failure to comply with this requirement may result in a delay of the granting/denial of your application.

Failure to appear at this meeting may result in the denial of your license. Individual applicants must appear only in person or by an attorney. Corporate or Limited Liability applicants must appear only by the agent designated on the application or by an attorney. Partnership applicants must appear by a partner listed on the application or by an attorney. If you wish to do so and at your own expense, you may be accompanied by an attorney of your choosing to represent you at this hearing.

You will be given an opportunity to speak on behalf of the application and to respond and challenge any charges or reasons given for the denial. No petitions can be accepted by the committee, unless the people who signed the petition are present at the committee hearing and willing to testify. You may present witnesses under oath and you may also confront and cross-examine opposing witnesses under oath. If you have difficulty with the English language, you should bring an interpreter with you, at your expense, so that you can answer questions and participate in your hearing.

You may examine the application file at this office during regular business hours prior to the hearing date. Inquiries regarding this matter may be directed to the person whose signature appears below.

Limited parking for persons attending meetings in City Hall is available at reduced rates (5 hour limit) at the Milwaukee Center on the southwest corner of East Kilbourn and North Water Street. Parking tickets must be validated in the first floor information booth in City Hall.

PLEASE NOTE: Upon reasonable notice, efforts will be made to accommodate the needs of disabled individuals through sign language interpreters or other auxiliary aids. For additional information or to request this service, contact the Council Services Division ADA Coordinator at (414) 286-2998, Fax - (414) 286-3456, TDD - (414) 286-2025.

JIM OWCZARSKI, CITY CLERK

BY: _____

Jason Schunk
License Division Manager

If you have questions regarding this notice, please contact the License Division at (414) 286-2238.

200 E. Wells Street, Room 105, City Hall, Milwaukee, WI 53202. www.milwaukee.gov/license
Phone: (414) 286-2238 Fax: (414) 286-3057 Email Address: License@milwaukee.gov



CITY OF MILWAUKEE
OFFICE OF THE CITY CLERK

Thursday, March 26, 2015

COMMITTEE MEETING NOTICE

AD 12

GHAZAI, Mustafa N, Agent
Diamond Auto Sales LLC
5480 W Abbott Ave

Greenfield, WI 53220

You are requested to attend a hearing which is to be held in Room 301-B, Third Floor, City Hall on:

Monday, April 06, 2015 at 11:00 AM

Regarding: Your Secondhand Motor Vehicle Dealer's License Application as agent for "Diamond Auto Sales LLC" for "Diamond Auto Sales" at 1801 W FOREST HOME Av.

There is a possibility that your application may be denied for one or more of the following reasons: The recommendation of the committee regarding the application shall be based on evidence presented at the hearing. Per MCO 85-2.7-4, probative evidence concerning whether or not a new license should be granted may be presented on the following subjects: whether or not the applicant meets the municipal requirements, the appropriateness of the location and premises where the licensed premises is to be located and whether use of the premises for the purposes or activities permitted by the license would tend to facilitate a public or private nuisance or create undesirable neighborhood problems such as disorderly patrons, unreasonably loud noise, litter, and excessive traffic and parking congestion. Probative evidence relating to these matters may be taken from the plan of operation submitted with the license application, if any, but shall not include the content of any music. Evidence regarding the fitness of the location of the premises to be maintained as the principal place of business, including but not limited to whether there is an overconcentration of businesses of the type for which the license is sought; whether the proposal is consistent with any pertinent neighborhood business or development plans, or the location's proximity to areas where children are typically present. The applicant's record in operating similarly licensed premises; and whether or not the applicant has been charged with or convicted of any felony, misdemeanor, municipal offense or other offense, the circumstances of which substantially relate to the activity to be permitted by the license being applied for or any other factor which reasonably relates to the public health, safety or welfare may also be considered. See attached police report or correspondence.

Notice for applicants with warrants or unpaid fines:

Proof of warrant satisfaction or payment of fines must be submitted at the hearing on the above date and time. Failure to comply with this requirement may result in a delay of the granting/denial of your application.

Failure to appear at this meeting may result in the denial of your license. Individual applicants must appear only in person or by an attorney. Corporate or Limited Liability applicants must appear only by the agent designated on the application or by an attorney. Partnership applicants must appear by a partner listed on the application or by an attorney. If you wish to do so and at your own expense, you may be accompanied by an attorney of your choosing to represent you at this hearing.

You will be given an opportunity to speak on behalf of the application and to respond and challenge any charges or reasons given for the denial. No petitions can be accepted by the committee, unless the people who signed the petition are present at the committee hearing and willing to testify. You may present witnesses under oath and you may also confront and cross-examine opposing witnesses under oath. If you have difficulty with the English language, you should bring an interpreter with you, at your expense, so that you can answer questions and participate in your hearing.

You may examine the application file at this office during regular business hours prior to the hearing date. Inquiries regarding this matter may be directed to the person whose signature appears below.

Limited parking for persons attending meetings in City Hall is available at reduced rates (5 hour limit) at the Milwaukee Center on the southwest corner of East Kilbourn and North Water Street. Parking tickets must be validated in the first floor information booth in City Hall.

PLEASE NOTE: Upon reasonable notice, efforts will be made to accommodate the needs of disabled individuals through sign language interpreters or other auxiliary aids. For additional information or to request this service, contact the Council Services Division ADA Coordinator at (414) 286-2998, Fax - (414) 286-3456, TDD - (414) 286-2025.

JIM OW CZARSKI, CITY CLERK

BY: _____

Jason Schunk
License Division Manager

If you have questions regarding this notice, please contact the License Division at (414) 286-2238.

200 E. Wells Street, Room 105, City Hall, Milwaukee, WI 53202. www.milwaukee.gov/license
Phone: (414) 286-2238 Fax: (414) 286-3057 Email Address: License@milwaukee.gov



Thursday, March 26, 2015



Notice of Public Hearing

GHAZAI, Mustafa N, Agent
Diamond Auto Sales at 1801 W FOREST HOME Av
Secondhand Motor Vehicle Dealer's License Application

Monday, April 06, 2015 at 11:00 AM

To whom it may concern:

The above application has been made by the above named applicant(s). This requires approval from the Licenses Committee and the Common Council of the City of Milwaukee. The hearing before the Licenses Committee will take place on 4/6/2015 at 11:00 AM, in Room 301-B, Third Floor, City Hall. If you wish, you may provide testimony at the hearing regarding the request; see below for further information. You are not required to attend the hearing. Once the Licenses Committee makes its recommendation, this recommendation is forwarded to the full Common Council for approval at its next regularly scheduled hearing. Please review the information below and if you have further questions regarding this process, please contact the License Division at (414) 286-2238.

Important details for those wishing to provide information for the Licenses Committee to consider when making its recommendation:

1. The license application is scheduled to be heard at the above time. Due to other hearings running longer than scheduled, you may have to wait some time to provide your testimony.
2. You must appear in person and testify as to matters that you have personally experienced or seen. (You cannot provide testimony for your neighbor, parent or anyone else; this is considered hearsay and cannot be considered by the committee.)
3. No letters or petitions can be accepted by the committee (unless the person who wrote the letter or the persons who signed the petition are present at the committee hearing and willing to testify).
4. Persons opposed to the license application are given the opportunity to testify first; supporters may testify after the opponents have finished.
5. When you are called to testify, you will be sworn in and asked to give your name, and address. (If your first and/or last names are uncommon please spell them.)
6. You may then provide testimony.
 - a. Include only information relating to the above license application.
 - b. Include only information you have personally witnessed or seen.
 - c. Provide concise and relevant information detailing how this business has affected or may affect the peaceful enjoyment of your neighborhood.
 - d. If by the time you have the opportunity to testify, the information you wish to share has already been provided to the committee, you may state that you agree with the previous testimony. Redundant or repetitive testimony will not assist the committee in making its recommendation.
7. After giving your testimony, the members of the Licenses Committee and the licensee may ask questions regarding the testimony you have given or other factors relating to the license application.
8. Business Competition is not a valid basis for denial or non-renewal of a license.
Please Note: If you have submitted an objection to the above application your objection cannot be considered by the committee unless you personally testify at the hearing.

CURRENT RESIDENT	1836 W BECHER ST	MILWAUKEE, WI 53215-2610
CURRENT RESIDENT	1838 W BECHER ST	MILWAUKEE, WI 53215-2610
CURRENT RESIDENT	2004 S 19TH ST 1	MILWAUKEE, WI 53204-3730
CURRENT RESIDENT	2004 S 19TH ST 2	MILWAUKEE, WI 53204-3730
CURRENT RESIDENT	2004 S 19TH ST 3	MILWAUKEE, WI 53204-3730
CURRENT RESIDENT	2004 S 19TH ST 4	MILWAUKEE, WI 53204-3730
CURRENT RESIDENT	2017 S 17TH ST	MILWAUKEE, WI 53204-3723
CURRENT RESIDENT	2021 S 17TH ST	MILWAUKEE, WI 53204-3723
CURRENT RESIDENT	2024 S 18TH ST	MILWAUKEE, WI 53204-3724
CURRENT RESIDENT	2025 S 17TH ST	MILWAUKEE, WI 53204-3723
CURRENT RESIDENT	2026 S 18TH ST	MILWAUKEE, WI 53204-3724
CURRENT RESIDENT	2029 S 17TH ST	MILWAUKEE, WI 53204-3723
CURRENT RESIDENT	2029A S 17TH ST	MILWAUKEE, WI 53204-3723
CURRENT RESIDENT	2030 S 18TH ST	MILWAUKEE, WI 53204-3724
CURRENT RESIDENT	2032 S 18TH ST	MILWAUKEE, WI 53204-3724
CURRENT RESIDENT	2032 S 18TH ST A	MILWAUKEE, WI 53204-3724
CURRENT RESIDENT	2033 S 17TH ST	MILWAUKEE, WI 53204-3723
CURRENT RESIDENT	2033A S 17TH ST	MILWAUKEE, WI 53204-3723
CURRENT RESIDENT	2035 S 17TH ST	MILWAUKEE, WI 53204-3723
CURRENT RESIDENT	2036 S 18TH ST	MILWAUKEE, WI 53204-3724
CURRENT RESIDENT	2036A S 18TH ST	MILWAUKEE, WI 53204-3724
CURRENT RESIDENT	2037 S 17TH ST	MILWAUKEE, WI 53204-3723
CURRENT RESIDENT	2040 S 18TH ST	MILWAUKEE, WI 53204-3724
CURRENT RESIDENT	2040A S 18TH ST	MILWAUKEE, WI 53204-3724
CURRENT RESIDENT	2044 S 18TH ST	MILWAUKEE, WI 53204-3724
CURRENT RESIDENT	2047 S 17TH ST	MILWAUKEE, WI 53204-3723
CURRENT RESIDENT	2049 S 17TH ST	MILWAUKEE, WI 53204-3723
CURRENT RESIDENT	2050 S 18TH ST	MILWAUKEE, WI 53204-3724
CURRENT RESIDENT	2050A S 18TH ST	MILWAUKEE, WI 53204-3724
CURRENT RESIDENT	2054 S 18TH ST	MILWAUKEE, WI 53204-3724
CURRENT RESIDENT	2057 S 17TH ST	MILWAUKEE, WI 53204-3723
CURRENT RESIDENT	2059 S 17TH ST	MILWAUKEE, WI 53204-3723
CURRENT RESIDENT	2060 S 18TH ST	MILWAUKEE, WI 53204-3724
CURRENT RESIDENT	2061 S 17TH ST	MILWAUKEE, WI 53204-3723
CURRENT RESIDENT	2061A S 17TH ST	MILWAUKEE, WI 53204-3723
CURRENT RESIDENT	2066 S 19TH ST	MILWAUKEE, WI 53204-3732
CURRENT RESIDENT	2068 S 19TH ST	MILWAUKEE, WI 53204-3732

Total Records: 261

Radius: 250.0 feet and Center of Circle: 1801 W Forest Home AV



**SECONDHAND MOTOR VEHICLE DEALER,
USED MOTOR VEHICLE DEALER-PARTS ONLY &
USED BIKE, TIRE & BATTERY LICENSE
SUPPLEMENTAL PLAN OF OPERATION**

Office of the City Clerk License Division
200 E. Wells St. Room 105, Milwaukee, WI 53202
(414) 286-2238 e-mail address: license@milwaukee.gov www.milwaukee.gov/license

Legal Entity Name: Diamond Auto Sales LLC

Premise Address: 1801 W Forest Home Ave, Milwaukee, WI, 53204

Type of License applied for (check one):

- Secondhand Motor Vehicle Retail Dealer
- Secondhand Motor Vehicle Wholesale Dealer
- Used Motor Vehicle Retail Dealer – Parts Only
- Used Motor Vehicle Wholesale Dealer – Parts Only
- Used Bike, Tire & Battery Retail Dealer
- Used Bike, Tire & Battery Wholesale Dealer

RETAIL DEALERS ONLY

Total Number of Parking Spaces (including customer/employee parking) 30

Number of Parking Spaces that will be used for Display/Storage of Secondhand Motor Vehicles 20

STORAGE, MAINTENANCE & REPAIR

Do you understand that all vehicles associated with the business must be stored on the licensed premise? Yes No

List your plans to ensure this requirement is met: The Manager and the Owner will be in charge to meet this requirement.

Do you understand all maintenance/repair work to these vehicles must be confined to the licensed premise? Yes No

List your plans to ensure this requirement is met: The Manager and the Owner will be in charge to meet this requirement.

DISCLOSURE

Has the applicant ever had a license relating to the activities licensed in Milwaukee Code of Ordinances Chapter 93 denied, not renewed, suspended, or revoked? No Yes

If yes, provide the circumstances and jurisdiction in which the event occurred (including a record of any actions from the State Department of Transportation and Financial Institutions relating to suspensions, revocations, forfeitures and warnings imposed by these departments relating to the operation of any automotive sales business by the applicant:

REQUIRED SIGNATURE(S)

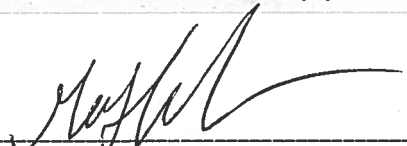

Sole Proprietor, Partner, 20% or more Shareholder,
or the Agent - only if there are no 20% or more shareholders



Signature of additional partner or 20% or more shareholder

**SUBMIT THIS FORM ALONG WITH THE
BUSINESS LICENSE APPLICATION & BUSINESS LICENSE PLAN OF OPERATION**

Office Use Only:

Initials _____ Filed _____ App# _____



BUSINESS LICENSE PLAN OF OPERATION

ccl-busplan 12/8/14

Office of the City Clerk License Division
200 E. Wells St. Room 105, Milwaukee, WI 53202
(414) 286-2238 www.milwaukee.gov/license e-mail address: license@milwaukee.gov

1. Type of Business

Is this application for an Extended Hours Establishment License? No Yes

Provide a detailed description of the type of business you plan on operating:

Car wash and Car Sales

Do you have any experience operating this type of business? No Yes

If yes, explain: *Worked in selling and buying cars*

2. Business Operations

a) Proposed Opening Date: *02/01/2015*

b) Is this premise under construction? No Yes If yes, list estimated completion date: _____

c) Is this a franchise? No Yes

d) Is this premises currently licensed? No Yes If yes, list type of license: _____

e) Is the current licensee operating? No Yes If no, list date closed: _____

f) What other types of licenses/permits will you hold at this location? (check all that apply)

Occupancy Permit Cigarette & Tobacco Gas Station Extended Hours Class "B" Tavern Weights & Measures

Secondhand Dealer Precious Metal & Gem Other: _____

g) Do you have future plans for other businesses, licenses or permits at this location? No Yes

If yes, explain: _____

h) Have you previously held an Extended Hours License in Milwaukee? No Yes

If yes, list address(es): _____

i) Are other businesses operating in the same building? No Yes If yes, describe: _____

3. Premises Description

a) Identify all area(s) of the premises that will be used in operating this business (include areas used only for storage):

1st Floor 2nd Floor Basement Storage Patio Beer Garden Sidewalk Café Deck Rooftop

Other: Describe: _____

b) Describe Location: Major Thoroughfare Secondary Street Other: _____

c) Nearest Major Cross Street: *18th st and Forest Home Ave*

d) Describe Building: Free Standing Building Strip Mall Other: _____

e) Describe Premises Structure: Single Story Multi-Story - # of Stories _____ Other: _____

f) Describe Surrounding Area: Commercial Residential Industrial Other: _____

g) Are there off-street parking places? No Yes If yes, how many? _____

h) Property Owner's Name: *Purpose USA LLC* Phone Number: _____

Address: _____

- b. Will there be security cameras? No Yes If yes, where? office, and 3 others around the building
- c. Will searches or identification checks be conducted upon entry? No Yes If yes, describe _____

9. Customers

- a. Will customers be entering the premises? No Yes
- b. Are there designated outdoor smoking areas? No Yes If yes, describe: _____
- c. Is a crowd control barrier used? No Yes If yes, describe: _____

10. Hours of Operation

Day of the Week	Proposed Hours of Operation:		Number of Customers expected each day	Potential Age Range of Customers	Class B Applicants: Age Restriction (If none, write 'None')
	Open (include a.m. or p.m.)	Close (include a.m. or p.m.)			
Sunday	—	—	—	—	—
Monday	9:00 am	7:00 pm	12	20-45	None
Tuesday	9:00 am	7:00 pm	12	20-45	None
Wednesday	9:00 am	7:00 pm	12	20-45	None
Thursday	9:00 am	7:00 pm	12	20-45	None
Friday	9:00 am	7:00 pm	12	20-45	None
Saturday	9:00 am	7:00 pm	12	20-45	None

Entertainment Indoor Closing Hours - If alcohol beverage establishment, same as alcohol license hours.
If non-alcohol establishment 1:00 am Sunday to Thursday; 1:30 am Friday and Saturday.

Entertainment Outdoor Closing Hours - 10:00 pm Sunday – Thursday; 12:00 am Friday and Saturday,
unless otherwise approved by Common Council in licensee's plan of operation.

11. Required Signature(s)

Sole Proprietor, Partner, 20% or more Shareholder, or Agent - only if there are no 20% or more shareholders

Signature of additional partner or 20% or more shareholder

See Application Information for a list of all required application forms.

4. Businesses On The Premises (check all that apply):

Type 1

- | | | | |
|--|---|---|--|
| <input type="checkbox"/> Full Service Restaurant | <input type="checkbox"/> Cafe/Coffee Shop | <input type="checkbox"/> Deli or Fast Food Restaurant | <input type="checkbox"/> Private/Fraternal/Veterans Club |
| <input type="checkbox"/> Night Club | <input type="checkbox"/> Tavern | <input type="checkbox"/> Cocktail Lounge | <input type="checkbox"/> Teen Club |
| <input type="checkbox"/> Bowling Alley | <input type="checkbox"/> Hotel | <input type="checkbox"/> Banquet Hall | <input type="checkbox"/> Sports Facility |

Type 2

- | | | | |
|---|---|---|--|
| <input type="checkbox"/> Liquor Store | <input type="checkbox"/> Corner Store | <input type="checkbox"/> Supermarket | <input type="checkbox"/> Convenience Store |
| <input type="checkbox"/> Gas Station | <input type="checkbox"/> Amusement/Phonograph Distributor | <input type="checkbox"/> Auto Wrecker | |
| <input checked="" type="checkbox"/> Used Car Dealer | <input type="checkbox"/> Used Auto Parts | <input type="checkbox"/> Personal Service Establishment | <input type="checkbox"/> Recording Studio |

5. Legal Capacity (only if a Type 1 premises in #4 above)

Capacity _____ (Call the Milwaukee Development Center at 414-286-8211 if you have questions.)

6. Percentage of Sales (must total 100%)

Alcohol _____%	Cigarettes _____%	Secondhand Merchandise _____%	Precious Metals & Gems _____%
Food _____%	Entertainment _____%		
Pawnbroker Activity _____%	Salvaged Materials _____% (such as scrap metal)	Other <u>100</u> % Describe: <u>Cars Sales and wash</u>	

7. Litter and Noise Control

- How are grounds kept clean? Sweep Pressure Wash Pick Up Litter Other: _____
- How often will grounds be cleaned? Daily Weekly Other: _____
- Grounds cleaned by: Licensee Building Owner Employees Hired Maintenance Other: _____
- Number of Garbage Cans: Inside: 2 Locations: in the office / in the car wash waiting area
Outside: 1 Locations: Southwest side of the building
- Describe sanitation facilities (restrooms): _____
- Name of solid waste contractor: Waste Management
- How are noise issues prevented and/or addressed? Security Manager approaches customer(s) Call Police
 Signs Posted Other: _____
- Will a sound amplification system be used? No Yes If yes, describe: _____

8. Security

- Will you have security personnel on premise? No Yes If yes, how many? _____
What are their responsibilities? _____
Is security equipment used? No Yes If yes, describe _____
List their licensing, certification, or training credentials _____



CITY OF MILWAUKEE
OFFICE OF THE CITY CLERK

Thursday, March 26, 2015

COMMITTEE MEETING NOTICE

AD 12

ANGEL GUTIERREZ GARNICA

2431 S 9TH St

MILWAUKEE, WI 53215

You are requested to attend a hearing which is to be held in Room 301-B, Third Floor, City Hall on:

Monday, April 06, 2015 at 11:00 AM

Regarding: Your Extended Hours Establishments Application Requesting to Close at 4 AM Sun-Thurs and 5 AM Fri-Sat for "TAQUERIA EL JALAPENO" at 2222 S 13TH St.

There is a possibility that your application may be denied for one or more of the following reasons: The recommendation of the committee regarding the application shall be based on evidence presented at the hearing. Per MCO 85-2.7-4, probative evidence concerning whether or not a new license should be granted may be presented on the following subjects: whether or not the applicant meets the municipal requirements, the appropriateness of the location and premises where the licensed premises is to be located and whether use of the premises for the purposes or activities permitted by the license would tend to facilitate a public or private nuisance or create undesirable neighborhood problems such as disorderly patrons, unreasonably loud noise, litter, and excessive traffic and parking congestion. Probative evidence relating to these matters may be taken from the plan of operation submitted with the license application, if any, but shall not include the content of any music. Evidence regarding the fitness of the location of the premises to be maintained as the principal place of business, including but not limited to whether there is an overconcentration of businesses of the type for which the license is sought; whether the proposal is consistent with any pertinent neighborhood business or development plans, or the location's proximity to areas where children are typically present. The applicant's record in operating similarly licensed premises; and whether or not the applicant has been charged with or convicted of any felony, misdemeanor, municipal offense or other offense, the circumstances of which substantially relate to the activity to be permitted by the license being applied for or any other factor which reasonably relates to the public health, safety or welfare may also be considered. See attached police report or correspondence.

Notice for applicants with warrants or unpaid fines:

Proof of warrant satisfaction or payment of fines must be submitted at the hearing on the above date and time. Failure to comply with this requirement may result in a delay of the granting/denial of your application.

Failure to appear at this meeting may result in the denial of your license. Individual applicants must appear only in person or by an attorney. Corporate or Limited Liability applicants must appear only by the agent designated on the application or by an attorney. Partnership applicants must appear by a partner listed on the application or by an attorney. If you wish to do so and at your own expense, you may be accompanied by an attorney of your choosing to represent you at this hearing.

You will be given an opportunity to speak on behalf of the application and to respond and challenge any charges or reasons given for the denial. No petitions can be accepted by the committee, unless the people who signed the petition are present at the committee hearing and willing to testify. You may present witnesses under oath and you may also confront and cross-examine opposing witnesses under oath. If you have difficulty with the English language, you should bring an interpreter with you, at your expense, so that you can answer questions and participate in your hearing.

You may examine the application file at this office during regular business hours prior to the hearing date. Inquiries regarding this matter may be directed to the person whose signature appears below.

Limited parking for persons attending meetings in City Hall is available at reduced rates (5 hour limit) at the Milwaukee Center on the southwest corner of East Kilbourn and North Water Street. Parking tickets must be validated in the first floor information booth in City Hall.

PLEASE NOTE: Upon reasonable notice, efforts will be made to accommodate the needs of disabled individuals through sign language interpreters or other auxiliary aids. For additional information or to request this service, contact the Council Services Division ADA Coordinator at (414) 286-2998, Fax - (414) 286-3456, TDD - (414) 286-2025.

JIM OW CZARSKI, CITY CLERK

BY:

Jason Schunk
License Division Manager

If you have questions regarding this notice, please contact the License Division at (414) 286-2238.

200 E. Wells Street, Room 105, City Hall, Milwaukee, WI 53202. www.milwaukee.gov/license
Phone: (414) 286-2238 Fax: (414) 286-3057 Email Address: License@milwaukee.gov

MILWAUKEE POLICE DEPARTMENT

LICENSING

CRIMINAL RECORD/ORDINANCE VIOLATION/INCIDENTS SYNOPSIS

DATE: 02/20/2015

LICENSE TYPE: Extended Hour Establishment

NEW:

RENEWAL:

No. 205079

Application Date: 02/19/2015

License Location: 2222 S 13th St

Business Name: Taqueria El Jalapeno

Licensee/Applicant: GUTIERREZ-GARNICA, Angel
(Last Name, First Name, MI)

Date of Birth: 06/28/1971

Home Address: 2431 S 9th St

City: Milwaukee

State: WI Zip Code: 53215

Home Phone:

This report is written by Police Officer David NOVAK, assigned to the License Investigation Unit, Days.

The Milwaukee Police Department's investigation regarding this application revealed the following:

1. On 05/23/2010 the applicant was cited in the City of Milwaukee at 2106 W. National Av for Class B Premises Allow Patron After Hours and Exceeding posted Occupancy Limit

Charge: Class B Premises Allow Patron After Hours
2: Exceeding Occupancy Limit
Finding: Guilty both charges
Sentence: Fined \$368.00 each charge
Date: 07/12/2010
Case: 1072856, 10073489

2. On 06/25/2010 the applicant was cited in the City of Milwaukee at 2222 S 13th St for License Required if Establishment Open 12am-5am.

Charge: License Required if Establishment Open 12am-5am
Finding: Guilty
Sentence: Fined \$368.00
Date: 10/25/2010
Case: 10111487

3. On 09/27/2011 the applicant was cited in the City of Milwaukee at 1428 W. Lincoln Av for Building Code Violations.

Charge: Building Code Violations
Finding: Guilty
Sentence: Fined \$380.00
Date: 06/13/2012
Case: 12031258

4. On 03/02/2012 the applicant was cited in the City of Milwaukee at 1428 W. Lincoln Av for Building Code Violations.

Charge: Building Code Violations
Finding: Guilty
Sentence: Fined \$380.00
Date: 10/10/2012
Case: 12088662

5. On 06/01/2014 the applicant was cited in the City of Milwaukee at 2106 W. National Av for Responsible Person on Premises Required.

Charge: Responsible Person on Premises Required
Finding: Guilty
Sentence: Fined \$378.00
Date: 11/05/2014
Case: 14042042



Thursday, March 26, 2015



Notice of Public Hearing

GUTIERREZ GARNICA, Angel
TAQUERIA EL JALAPENO at 2222 S 13TH St
Extended Hours Establishments Application Requesting to Close at 4 AM Sun-Thurs and 5 AM
Fri-Sat

Monday, April 06, 2015 at 11:00 AM

To whom it may concern:

The above application has been made by the above named applicant(s). This requires approval from the Licenses Committee and the Common Council of the City of Milwaukee. The hearing before the Licenses Committee will take place on 4/6/2015 at 11:00 AM, in Room 301-B, Third Floor, City Hall. If you wish, you may provide testimony at the hearing regarding the request; see below for further information. You are not required to attend the hearing. Once the Licenses Committee makes its recommendation, this recommendation is forwarded to the full Common Council for approval at its next regularly scheduled hearing. Please review the information below and if you have further questions regarding this process, please contact the License Division at (414) 286-2238.

Important details for those wishing to provide information for the Licenses Committee to consider when making its recommendation:

1. The license application is scheduled to be heard at the above time. Due to other hearings running longer than scheduled, you may have to wait some time to provide your testimony.
2. You must appear in person and testify as to matters that you have personally experienced or seen. (You cannot provide testimony for your neighbor, parent or anyone else; this is considered hearsay and cannot be considered by the committee.)
3. No letters or petitions can be accepted by the committee (unless the person who wrote the letter or the persons who signed the petition are present at the committee hearing and willing to testify).
4. Persons opposed to the license application are given the opportunity to testify first; supporters may testify after the opponents have finished.
5. When you are called to testify, you will be sworn in and asked to give your name, and address. (If your first and/or last names are uncommon please spell them.)
6. You may then provide testimony.
 - a. Include only information relating to the above license application.
 - b. Include only information you have personally witnessed or seen.
 - c. Provide concise and relevant information detailing how this business has affected or may affect the peaceful enjoyment of your neighborhood.
 - d. If by the time you have the opportunity to testify, the information you wish to share has already been provided to the committee, you may state that you agree with the previous testimony. Redundant or repetitive testimony will not assist the committee in making its recommendation.
7. After giving your testimony, the members of the Licenses Committee and the licensee may ask questions regarding the testimony you have given or other factors relating to the license application.
8. Business Competition is not a valid basis for denial or non-renewal of a license.
Please Note: If you have submitted an objection to the above application your objection cannot be considered by the committee unless you personally testify at the hearing.

RESIDENT	MAIL ADDRESS	CITY AND ZIP CODE
CURRENT RESIDENT	1136 W LINCOLN AVE	MILWAUKEE, WI 53215-3103
CURRENT RESIDENT	1206 W LINCOLN AVE 1	MILWAUKEE, WI 53215-3125
CURRENT RESIDENT	1206 W LINCOLN AVE 2	MILWAUKEE, WI 53215-3125
CURRENT RESIDENT	1206 W LINCOLN AVE 3	MILWAUKEE, WI 53215-3125
CURRENT RESIDENT	1206 W LINCOLN AVE 4	MILWAUKEE, WI 53215-3125
CURRENT RESIDENT	1206 W LINCOLN AVE 5	MILWAUKEE, WI 53215-3125
CURRENT RESIDENT	1206 W LINCOLN AVE 6	MILWAUKEE, WI 53215-3125
CURRENT RESIDENT	1206 W LINCOLN AVE 7	MILWAUKEE, WI 53215-3125
CURRENT RESIDENT	1206 W LINCOLN AVE 8	MILWAUKEE, WI 53215-3125
CURRENT RESIDENT	1206 W LINCOLN AVE 9	MILWAUKEE, WI 53215-3125
CURRENT RESIDENT	1209 W GRANT ST	MILWAUKEE, WI 53215-2731
CURRENT RESIDENT	1210 W GRANT ST	MILWAUKEE, WI 53215-2732
CURRENT RESIDENT	1210 W LINCOLN AVE	MILWAUKEE, WI 53215-3125
CURRENT RESIDENT	1231 W WINDLAKE AVE	MILWAUKEE, WI 53215-2736
CURRENT RESIDENT	1233 W WINDLAKE AVE	MILWAUKEE, WI 53215-2736
CURRENT RESIDENT	1241 W WINDLAKE AVE	MILWAUKEE, WI 53215-2736
CURRENT RESIDENT	1243 W WINDLAKE AVE	MILWAUKEE, WI 53215-2736
CURRENT RESIDENT	1243 W WINDLAKE AVE A	MILWAUKEE, WI 53215-2736
CURRENT RESIDENT	1243 W WINDLAKE AVE B	MILWAUKEE, WI 53215-2736
CURRENT RESIDENT	1245 W WINDLAKE AVE	MILWAUKEE, WI 53215-2736
CURRENT RESIDENT	1308 W WINDLAKE AVE	MILWAUKEE, WI 53215-2739
CURRENT RESIDENT	1308A W WINDLAKE AVE	MILWAUKEE, WI 53215-2739
CURRENT RESIDENT	1310 W WINDLAKE AVE	MILWAUKEE, WI 53215-2739
CURRENT RESIDENT	1312 W WINDLAKE AVE	MILWAUKEE, WI 53215-2739
CURRENT RESIDENT	1314 W GRANT ST	MILWAUKEE, WI 53215-2734
CURRENT RESIDENT	1314 W GRANT ST A	MILWAUKEE, WI 53215-2734
CURRENT RESIDENT	1314 W GRANT ST B	MILWAUKEE, WI 53215-2734
CURRENT RESIDENT	1318 W WINDLAKE AVE	MILWAUKEE, WI 53215-2739
CURRENT RESIDENT	1318A W WINDLAKE AVE	MILWAUKEE, WI 53215-2739
CURRENT RESIDENT	1322 W WINDLAKE AVE	MILWAUKEE, WI 53215-2739
CURRENT RESIDENT	1324 W WINDLAKE AVE	MILWAUKEE, WI 53215-2739
CURRENT RESIDENT	1328 W WINDLAKE AVE	MILWAUKEE, WI 53215-2739
CURRENT RESIDENT	1332 W WINDLAKE AVE	MILWAUKEE, WI 53215-2739
CURRENT RESIDENT	1334 W WINDLAKE AVE	MILWAUKEE, WI 53215-2739
CURRENT RESIDENT	1337 W WINDLAKE AVE	MILWAUKEE, WI 53215-2738
CURRENT RESIDENT	1338 W WINDLAKE AVE	MILWAUKEE, WI 53215-2739
CURRENT RESIDENT	1338A W WINDLAKE AVE	MILWAUKEE, WI 53215-2739
CURRENT RESIDENT	1339 W WINDLAKE AVE	MILWAUKEE, WI 53215-2738
CURRENT RESIDENT	1341 W WINDLAKE AVE	MILWAUKEE, WI 53215-2738
CURRENT RESIDENT	1347 W WINDLAKE AVE	MILWAUKEE, WI 53215-2738
CURRENT RESIDENT	1349 W WINDLAKE AVE	MILWAUKEE, WI 53215-2738
CURRENT RESIDENT	1353 W WINDLAKE AVE	MILWAUKEE, WI 53215-2738
CURRENT RESIDENT	1353A W WINDLAKE AVE	MILWAUKEE, WI 53215-2738
CURRENT RESIDENT	1353B W WINDLAKE AVE	MILWAUKEE, WI 53215-2738
CURRENT RESIDENT	1357 W WINDLAKE AVE	MILWAUKEE, WI 53215-2738
CURRENT RESIDENT	1357A W WINDLAKE AVE	MILWAUKEE, WI 53215-2738
CURRENT RESIDENT	2150 S 13TH ST 101	MILWAUKEE, WI 53215-2786
CURRENT RESIDENT	2150 S 13TH ST 102	MILWAUKEE, WI 53215-2786
CURRENT RESIDENT	2150 S 13TH ST 103	MILWAUKEE, WI 53215-2786
CURRENT RESIDENT	2150 S 13TH ST 104	MILWAUKEE, WI 53215-2786
CURRENT RESIDENT	2150 S 13TH ST 105	MILWAUKEE, WI 53215-2786
CURRENT RESIDENT	2150 S 13TH ST 106	MILWAUKEE, WI 53215-2786
CURRENT RESIDENT	2150 S 13TH ST 107	MILWAUKEE, WI 53215-2786
CURRENT RESIDENT	2150 S 13TH ST 108	MILWAUKEE, WI 53215-2786
CURRENT RESIDENT	2150 S 13TH ST 109	MILWAUKEE, WI 53215-2786

CURRENT RESIDENT	2234A S 12TH ST	MILWAUKEE, WI 53215-2712
CURRENT RESIDENT	2238 S 12TH ST	MILWAUKEE, WI 53215-2712
CURRENT RESIDENT	2238A S 12TH ST	MILWAUKEE, WI 53215-2712
CURRENT RESIDENT	2242 S 12TH ST	MILWAUKEE, WI 53215-2712
CURRENT RESIDENT	2246 S 12TH ST	MILWAUKEE, WI 53215-2712
CURRENT RESIDENT	2246A S 12TH ST	MILWAUKEE, WI 53215-2712
CURRENT RESIDENT	2250 S 12TH ST	MILWAUKEE, WI 53215-2712
CURRENT RESIDENT	2254 S 12TH ST	MILWAUKEE, WI 53215-2712
CURRENT RESIDENT	2256 S 12TH ST	MILWAUKEE, WI 53215-2712
CURRENT RESIDENT	2258 S 12TH ST	MILWAUKEE, WI 53215-2712
CURRENT RESIDENT	2270 S 12TH ST	MILWAUKEE, WI 53215-2712

Total Records: 179

Radius: 250.0 feet and Center of Circle: 2222 S 13th ST



BUSINESS LICENSE PLAN OF OPERATION

ccl-busplan 12/8/14

Office of the City Clerk License Division
200 E. Wells St. Room 105, Milwaukee, WI 53202
(414) 286-2238 www.milwaukee.gov/license e-mail address: license@milwaukee.gov

1. Type of Business

Is this application for an Extended Hours Establishment License? No Yes

Provide a detailed description of the type of business you plan on operating:

full service restaurant

Do you have any experience operating this type of business? No Yes

If yes, explain: I have this restaurant for 8 years.

2. Business Operations

a) Proposed Opening Date: _____

b) Is this premise under construction? No Yes If yes, list estimated completion date: _____

c) Is this a franchise? No Yes

d) Is this premises currently licensed? No Yes If yes, list type of license: Beer + Alcohol & Food

e) Is the current licensee operating? No Yes If no, list date closed: _____

f) What other types of licenses/permits will you hold at this location? (check all that apply)

Occupancy Permit Cigarette & Tobacco Gas Station Extended Hours Class "B" Tavern Weights & Measures
 Secondhand Dealer Precious Metal & Gem Other: _____

g) Do you have future plans for other businesses, licenses or permits at this location? No Yes

If yes, explain: _____

h) Have you previously held an Extended Hours License in Milwaukee? No Yes

If yes, list address(es): 2106 W. National Ave. Milwaukee, WI 53204

i) Are other businesses operating in the same building? No Yes If yes, describe: _____

3. Premises Description

a) Identify all area(s) of the premises that will be used in operating this business (include areas used only for storage):

1st Floor 2nd Floor Basement Storage Patio Beer Garden Sidewalk Café Deck Rooftop
 Other: Describe: _____

b) Describe Location: Major Thoroughfare Secondary Street Other: _____

c) Nearest Major Cross Street: 13 + Lincoln Ave

d) Describe Building: Free Standing Building Strip Mall Other: _____

e) Describe Premises Structure: Single Story Multi-Story - # of Stories _____ Other: _____

f) Describe Surrounding Area: Commercial Residential Industrial Other: _____

g) Are there off-street parking places? No Yes If yes, how many? _____

h) Property Owner's Name: BLUE KANGAROO.LLC Phone Number: _____

Address: 300 W North Avenue Lombard, Illinois, 60148

4. Businesses On The Premises (check all that apply):

Type 1

- Full Service Restaurant
 Cafe/Coffee Shop
 Deli or Fast Food Restaurant
 Private/Fraternal/Veterans Club
 Night Club
 Tavern
 Cocktail Lounge
 Teen Club
 Bowling Alley
 Hotel
 Banquet Hall
 Sports Facility

Type 2

- Liquor Store
 Corner Store
 Supermarket
 Convenience Store
 Gas Station
 Amusement/Phonograph Distributor
 Auto Wrecker
 Used Car Dealer
 Used Auto Parts
 Personal Service Establishment
 Recording Studio

5. Legal Capacity (only if a Type 1 premises in #4 above)

Capacity 80 (Call the Milwaukee Development Center at 414-286-8211 if you have questions.)

6. Percentage of Sales (must total 100%)

Alcohol <u>5</u> %	Cigarettes _____ %	Secondhand Merchandise _____ %	Precious Metals & Gems _____ %
Food <u>95</u> %	Entertainment _____ %		
Pawnbroker Activity _____ %	Salvaged Materials _____ % (such as scrap metal)	Other _____ % Describe: _____	

7. Litter and Noise Control

- a. How are grounds kept clean? Sweep Pressure Wash Pick Up Litter Other: _____
- b. How often will grounds be cleaned? Daily Weekly Other: _____
- c. Grounds cleaned by: Licensee Building Owner Employees Hired Maintenance Other: _____
- d. Number of Garbage Cans: Inside: 5 Locations: restrooms, dining room, kitchen
 Outside: 1 Locations: side of Bldg in parking lot
- e. Describe sanitation facilities (restrooms): 1 mens room 1 womens room
- f. Name of solid waste contractor: Waste Management
- g. How are noise issues prevented and/or addressed? Security Manager approaches customer(s) Call Police
 Signs Posted Other: _____
- h. Will a sound amplification system be used? No Yes If yes, describe: _____

8. Security

- a. Will you have security personnel on premise? No Yes If yes, how many? 1
 What are their responsibilities? Keep clients in order, break up fights
 Is security equipment used? No Yes If yes, describe 1 outside by garbage can, 3 inside dining r
 List their licensing, certification, or training credentials: Private Detective Agency state of WI Security #16890-62

- b. Will there be security cameras? No Yes If yes, where? outside 3 in dining room
- c. Will searches or identification checks be conducted upon entry? No Yes If yes, describe _____

9. Customers

- a. Will customers be entering the premises? No Yes
- b. Are there designated outdoor smoking areas? No Yes If yes, describe: _____
- c. Is a crowd control barrier used? No Yes If yes, describe: _____

10. Hours of Operation

Day of the Week	Proposed Hours of Operation:		Number of Customers expected each day	Potential Age Range of Customers	Class B Applicants: Age Restriction (If none, write 'None')
	Open (include a.m. or p.m.)	Close (include a.m. or p.m.)			
Sunday	8:30 am	4am	80	18 yrsup	none
Monday	8:30 am	4am	50	18 yrsup	none
Tuesday	8:30 am	4am	50	18 yrsup	none
Wednesday	8:30 am	4am	50	18 yrsup	none
Thursday	8:30 am	4am	50	18 yrsup	none
Friday	8:30 am	5am	50	18 yrsup	none
Saturday	8:30 am	5am	80	18 yrsup	none

Entertainment Indoor Closing Hours - If alcohol beverage establishment, same as alcohol license hours.
If non-alcohol establishment 1:00 am Sunday to Thursday; 1:30 am Friday and Saturday.

Entertainment Outdoor Closing Hours - 10:00 pm Sunday – Thursday; 12:00 am Friday and Saturday, unless otherwise approved by Common Council in licensee's plan of operation.

11. Required Signature(s)

X *angel estes garza*
Sole Proprietor, Partner, 20% or more Shareholder, or Agent - only if there are no 20% or more shareholders

Signature of additional partner or 20% or more shareholder

See Application Information for a list of all required application forms.



CITY OF MILWAUKEE
OFFICE OF THE CITY CLERK

Friday, March 27, 2015

COMMITTEE MEETING NOTICE

AD 12

MORALES, Reyna G, Agent
Reyna's Events & Mexican Restaurant, LLC
1242 S Cesar E Chavez DR

Milwaukee, WI 53204

You are requested to attend a hearing which is to be held in Room 301-B, Third Floor, City Hall on:

Monday, April 06, 2015 at 11:00 AM

Regarding: Your Class B Tavern and Public Entertainment Premises License Applications Requesting Instrumental Musicians, Bands, Disc Jockey, Patrons Dancing, Jukebox, and Karaoke as agent for "Reyna's Events & Mexican Restaurant, LLC" for "Reyna's Events & Mexican Restaurant" at 611 W NATIONAL Av.

There is a possibility that your application may be denied for one or more of the following reasons: The recommendation of the committee regarding the application shall be based on evidence presented at the hearing. Per MCO 85-2.7-4, probative evidence concerning whether or not a new license should be granted may be presented on the following subjects: whether or not the applicant meets the municipal requirements, the appropriateness of the location and premises where the licensed premises is to be located and whether use of the premises for the purposes or activities permitted by the license would tend to facilitate a public or private nuisance or create undesirable neighborhood problems such as disorderly patrons, unreasonably loud noise, litter, and excessive traffic and parking congestion. Probative evidence relating to these matters may be taken from the plan of operation submitted with the license application, if any, but shall not include the content of any music. Evidence regarding the fitness of the location of the premises to be maintained as the principal place of business, including but not limited to whether there is an overconcentration of businesses of the type for which the license is sought; whether the proposal is consistent with any pertinent neighborhood business or development plans, or the location's proximity to areas where children are typically present. The applicant's record in operating similarly licensed premises; and whether or not the applicant has been charged with or convicted of any felony, misdemeanor, municipal offense or other offense, the circumstances of which substantially relate to the activity to be permitted by the license being applied for or any other factor which reasonably relates to the public health, safety or welfare may also be considered. See attached police report or correspondence.

Notice for applicants with warrants or unpaid fines:

Proof of warrant satisfaction or payment of fines must be submitted at the hearing on the above date and time. Failure to comply with this requirement may result in a delay of the granting/denial of your application.

Failure to appear at this meeting may result in the denial of your license. Individual applicants must appear only in person or by an attorney. Corporate or Limited Liability applicants must appear only by the agent designated on the application or by an attorney. Partnership applicants must appear by a partner listed on the application or by an attorney. If you wish to do so and at your own expense, you may be accompanied by an attorney of your choosing to represent you at this hearing.

You will be given an opportunity to speak on behalf of the application and to respond and challenge any charges or reasons given for the denial. No petitions can be accepted by the committee, unless the people who signed the petition are present at the committee hearing and willing to testify. You may present witnesses under oath and you may also confront and cross-examine opposing witnesses under oath. If you have difficulty with the English language, you should bring an interpreter with you, at your expense, so that you can answer questions and participate in your hearing.

You may examine the application file at this office during regular business hours prior to the hearing date. Inquiries regarding this matter may be directed to the person whose signature appears below.

Limited parking for persons attending meetings in City Hall is available at reduced rates (5 hour limit) at the Milwaukee Center on the southwest corner of East Kilbourn and North Water Street. Parking tickets must be validated in the first floor information booth in City Hall.

PLEASE NOTE: Upon reasonable notice, efforts will be made to accommodate the needs of disabled individuals through sign language interpreters or other auxiliary aids. For additional information or to request this service, contact the Council Services Division ADA Coordinator at (414) 286-2998, Fax - (414) 286-3456, TDD - (414) 286-2025.

JIM OWZARSKI, CITY CLERK

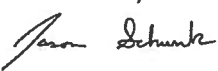
BY: 

Jason Schunk
License Division Manager

If you have questions regarding this notice, please contact the License Division at (414) 286-2238.

200 E. Wells Street, Room 105, City Hall, Milwaukee, WI 53202. www.milwaukee.gov/license
Phone: (414) 286-2238 Fax: (414) 286-3057 Email Address: License@milwaukee.gov



CITY OF MILWAUKEE
OFFICE OF THE CITY CLERK

Friday, March 27, 2015

COMMITTEE MEETING NOTICE

AD 12

MORALES, Reyna G, Agent
Reyna's Events & Mexican Restaurant, LLC
1701 S 5th St Upper

Milwaukee, WI 53204

You are requested to attend a hearing which is to be held in Room 301-B, Third Floor, City Hall on:

Monday, April 06, 2015 at 11:00 AM

Regarding: Your Class B Tavern and Public Entertainment Premises License Applications Requesting Instrumental Musicians, Bands, Disc Jockey, Patrons Dancing, Jukebox, and Karaoke as agent for "Reyna's Events & Mexican Restaurant, LLC" for "Reyna's Events & Mexican Restaurant" at 611 W NATIONAL Av.

There is a possibility that your application may be denied for one or more of the following reasons: The recommendation of the committee regarding the application shall be based on evidence presented at the hearing. Per MCO 85-2.7-4, probative evidence concerning whether or not a new license should be granted may be presented on the following subjects: whether or not the applicant meets the municipal requirements, the appropriateness of the location and premises where the licensed premises is to be located and whether use of the premises for the purposes or activities permitted by the license would tend to facilitate a public or private nuisance or create undesirable neighborhood problems such as disorderly patrons, unreasonably loud noise, litter, and excessive traffic and parking congestion. Probative evidence relating to these matters may be taken from the plan of operation submitted with the license application, if any, but shall not include the content of any music. Evidence regarding the fitness of the location of the premises to be maintained as the principal place of business, including but not limited to whether there is an overconcentration of businesses of the type for which the license is sought; whether the proposal is consistent with any pertinent neighborhood business or development plans, or the location's proximity to areas where children are typically present. The applicant's record in operating similarly licensed premises; and whether or not the applicant has been charged with or convicted of any felony, misdemeanor, municipal offense or other offense, the circumstances of which substantially relate to the activity to be permitted by the license being applied for or any other factor which reasonably relates to the public health, safety or welfare may also be considered. See attached police report or correspondence.

Notice for applicants with warrants or unpaid fines:

Proof of warrant satisfaction or payment of fines must be submitted at the hearing on the above date and time. Failure to comply with this requirement may result in a delay of the granting/denial of your application.

Failure to appear at this meeting may result in the denial of your license. Individual applicants must appear only in person or by an attorney. Corporate or Limited Liability applicants must appear only by the agent designated on the application or by an attorney. Partnership applicants must appear by a partner listed on the application or by an attorney. If you wish to do so and at your own expense, you may be accompanied by an attorney of your choosing to represent you at this hearing.

You will be given an opportunity to speak on behalf of the application and to respond and challenge any charges or reasons given for the denial. No petitions can be accepted by the committee, unless the people who signed the petition are present at the committee hearing and willing to testify. You may present witnesses under oath and you may also confront and cross-examine opposing witnesses under oath. If you have difficulty with the English language, you should bring an interpreter with you, at your expense, so that you can answer questions and participate in your hearing.

You may examine the application file at this office during regular business hours prior to the hearing date. Inquiries regarding this matter may be directed to the person whose signature appears below.

Limited parking for persons attending meetings in City Hall is available at reduced rates (5 hour limit) at the Milwaukee Center on the southwest corner of East Kilbourn and North Water Street. Parking tickets must be validated in the first floor information booth in City Hall.

PLEASE NOTE: Upon reasonable notice, efforts will be made to accommodate the needs of disabled individuals through sign language interpreters or other auxiliary aids. For additional information or to request this service, contact the Council Services Division ADA Coordinator at (414) 286-2998, Fax - (414) 286-3456, TDD - (414) 286-2025.

JIM OWZARSKI, CITY CLERK

BY: 

Jason Schunk
License Division Manager

If you have questions regarding this notice, please contact the License Division at (414) 286-2238.

200 E. Wells Street, Room 105, City Hall, Milwaukee, WI 53202. www.milwaukee.gov/license
Phone: (414) 286-2238 Fax: (414) 286-3057 Email Address: License@milwaukee.gov

MILWAUKEE POLICE DEPARTMENT

LICENSING

CRIMINAL RECORD/ORDINANCE VIOLATION/INCIDENTS SYNOPSIS

DATE: 09/10/214

LICENSE TYPE: Class B Tavern

No. 189341

NEW:

Application Date: 06/13/2014

RENEWAL:

License Location: 611 West National Ave.

Business Name: Reyna's Events & Mexican Restaurant

Licensee/Applicant: Morales, Reyna G.
(Last Name, First Name, MI)

Date of Birth: 09/30/1989

Home Address: 1701 South 5th Street

City: Milwaukee

State: WI **Zip Code:** 53204

Home Phone: (414) 306-2216

This report is written by Police Officer Gilbert Gwinn, assigned to the License Investigation Unit, Days.

The Milwaukee Police Department's investigation regarding this application revealed the following:

1. On 05/25/2012 the applicant was cited by the Greenfield Police Department for Disorderly Conduct.

Charge: Disorderly Conduct
Finding: Guilty
Sentence: Fine
Date: 10/31/2012
Case: Not indicated.

2. On 08/06/2014 a Milwaukee police officer was informed by a Department of Neighborhood Services Special Inspector that Reyna's Events and Mexican Restaurant (611 West National Avenue) was operating as a public entertainment premise prior to receiving the appropriate license. The applicant told officers that she had hosted a baptism with a DJ playing music on 08/02/2014. The applicant was cited.

Charge: Public Entertainment Premises-License Required
Finding: Due for pre-trial 10/24/2014 1:30pm branch 3
Sentence:
Date:
Case: 14058253

3. On 08/21/2014 Milwaukee police, along with Alderman Perez, Assistant City Attorney Nick DeSiato, Department of Neighborhood Services Supervisor Erica Lewandowski and a representative from the city of Milwaukee license division met with Alfonso Morales to discuss the status of pending licenses and a recent violation of pending licenses. During this meeting, Mr. Morales stated the business had hosted a baptism on 08/02/2014 and an additional event on 05/10/2014 and that another event had been planned for 09/13/2014. Mr. Morales was advised that the business was not to operate until the appropriate licenses were obtained.

This report is written by P.O. Kevin VODICKA assigned to District Two, Early Shift Community Prosecution Unit. On Wednesday, August 6, 2014, while assigned to Squad 2268 (P.O. Guadalupe VELASQUEZ and I) was informed by D.N.S. Special Inspector Lorie GALLUP that Reyna's Events & Mexican Restaurant (further referred to as "the premises"), located at 611 W. National Av. Milwaukee WI, was observed by D.N.S. Commercial Codes and Building supervisor Michael M. MANAN (M/W 03/19/74 841 N. Broadway Milwaukee, WI 53202 (414)286-3975) operating as a public entertainment premises without first obtaining a license to do so.

I did check the LIRA website (the License Information Reporting and Administration system for the City of Milwaukee, a database of individual and business licenses) and found that the premises had three pending licenses with the following statuses;

PEP 189364 Public Entertainment Premises – Pending Payment

FREST 187193 Food Dealer – Restaurant – Pending Aldermanic Approval

BTAVN 189341 Class B Tavern – Pending Committee Review

I did also receive a copy of an email from City Clerk, Jim OWCZARSKI (286-2998) to the licensee of the premises, Reyna G. MORALES (F/W 09/30/89 of 1701 S. 5th St Milwaukee, WI (414) 306-2216, dated 07/24/14, stating that a provisional license was being denied due to the fact that only renewal licenses are eligible for provisional licenses and that MORALES would have to wait until September 23, 2014, to have the license granted for the premises.

On Friday, August 8, 2014, at 2:22 pm, I spoke with MANAN by phone regarding his observations of the premises. MANAN stated that on Saturday, August 2, 2014, at 8:45 pm, he had stopped at a red traffic signal in the eastbound lane of the 600 block of W. National Av. And had observed that a party was taking place at the premises. MANAN further stated that he observed a D.J. booth and D.J. through the windows at the northeast corner of the building, which he knew to be "Reyna's". MANAN further stated that he observed "multi-colored dance lights", could hear disco/dance music, and observed the shadows of three or four subjects seated at tables which were decorated with balloons and ribbons. MANAN stated that he has been aware of and involved with the ongoing occupancy issues at 611 W. National Av. for the past year, particularly with the first floor restaurant space.

On Friday, August 08, 2014, at 4:40 pm, P.O. VELASQUEZ and I met with the licensee of the premises, Reyna MORALES, at District Two. I explained the concerns that I had that the premises had been offering public entertainment prior to being licensed to do so and that any and all activity would have to cease until the licenses were obtained. MORALES stated that she had hosted a baptism at the premises on the night of August 2nd, 2014, and acknowledged that there had been a D.J. playing music, but stated no one had been dancing, MORALES stated that the organizer of the event brought in food from a licensed caterer and that no alcohol had been served.

MORALES was issued a citation for Public Entertainment Premises-License Required and given a future court date.

This report is written by P.O. Kevin VODICKA assigned to District Two, Early Shift. On Thursday, August 21, 2014, at 10:00 am, Squad 2268 (P.O. Guadalupe VELASQUEZ and I) met with the licensee (Alfonso MORALES), Alderman Jose PEREZ, Assistant City Attorney Nick DeSIATO, Department of Neighborhood Services Special Enforcement Supervisor Erica LEWANDOWSKI, and a representative from the City of Milwaukee licensing department at City Hall to discuss the status of the license and a recent violation of the pending license at the premises.

Alfonso MORALES acknowledged that the business had hosted a baptism event on Saturday, August 2, 2014, that had been observed by D.N.S. Commercial Codes and Building supervisor Michael MANNAN. MORALES also acknowledged that a special permit for the event had been sought and denied due to the "pending" license status. MORALES further stated that an additional event had been scheduled at the premises for Saturday, September 13, 2014 and that the premises had hosted an additional event on Saturday, May 10, 2014 (no permit for the event was located). MORALES stated that he wished to operate a "sit down" restaurant Monday through Friday and to rent out the premises for "Special Events" on the weekends.

MORALES was advised by all parties present that the business was not to operate until all licenses were properly obtained. MORALES was further advised that to seek a change to the occupancy to include "Assembly Hall" if the premises was going to continue to host events in addition to operating as a restaurant. MORALES was also advised not to use any of the basement space or the common hallway/entryway to 611 W. National Av. for his business.

MILWAUKEE POLICE DEPARTMENT

LICENSING

CRIMINAL RECORD/ORDINANCE VIOLATION/INCIDENTS SYNOPSIS

DATE: 06/16/2014

LICENSE TYPE: Class B Tavern

NEW:

RENEWAL:

No. 189341

Application Date: 06/13/2014

License Location: 611 West National Ave.

Business Name: Reyna's Events & Mexican Restaurant

Licensee/Applicant: Morales, Reyna G.
(Last Name, First Name, MI)

Date of Birth: 09/30/1989

Home Address: 1701 South 5th Street

City: Milwaukee

State: WI **Zip Code:** 53204

Home Phone: (414) 306-2216

This report is written by Police Officer Gilbert Gwinn, assigned to the License Investigation Unit, Days.

The Milwaukee Police Department's investigation regarding this application revealed the following:

1. On 05/25/2012 the applicant was cited by the Greenfield Police Department for Disorderly Conduct.

Charge:	Disorderly Conduct
Finding:	Guilty
Sentence:	Fine
Date:	10/31/2012
Case:	Not indicated.

Date: 7-14-14
Officer: PO Matthew Diener

City of Milwaukee Police Department
90-5-1.5 Crime Prevention Survey
Tavern Inspection

Name of Premise: Reyna's Events & Mexican Restaurant
Address: 611 W National Av
Phone: 414-306-2216

Owner: Reyna G Morales-Villegas
Owner address: 1701 S 5th St
City State Zip: Milwaukee, WI 53204
Owner Phone: 414-306-2216
Owner email: reynamorales@ymail.com

Licensee/Agent: same as owner
Home Address:
City State Zip:
Phone:
Email:

Preferred contact: by phone

Location currently open: YES NO

Projected open date: 8-1-14

Day's open: S M T W Th F SA ALL

Hours of Operation: Sun: 8am-2am
Mon: 8am-2am
Tue: 8am-2am
Wed: 8am-2am
Thu: 8am-2am
Fri: 8am-2am
Sat: 8am-2am
24 hours Y N

Premise Type: Tavern/Bar
 Restaurant
 Other:

Licenses currently held:

- Alcohol: Yes No Class: #:
Tobacco: Yes No #:
Food: Yes No #:
Other: Yes No Type: #:
Other: Yes No Type: #:

Exterior Survey:

1. Is the area around the location clean? Yes No
2. What surrounds the location? (Check all the apply)
 - a. Park
 - b. School
 - c. Youth Center
 - d. Church
 - e. Tavern(s) If so, how many
 - f. Residential
 - g. Other businesses
 - h. Other:
3. Can you see from the outside of the location into the interior Yes No
4. Can you see the employees inside of the location from the outside Yes No
5. Are exterior windows free of signage Yes No
6. Street parking Yes No
7. Is there a parking lot Yes No
8. Is the parking lot clean? Yes No
9. Is the parking lot well lit? Yes No
10. Valet Parking Yes No
 - a. Will this lot have a guard? Yes No
 - b. Will this lot have cameras? Yes No
11. Are there areas where a person could conceal themselves Yes No
12. Is there exterior lighting? Yes No. Does it appears to be adequate Yes No
13. Exterior Payphone? Yes No
14. Are there No Loitering Signs posted? Yes No
15. Are there exterior security cameras Yes No How Many:
16. Are the address numbers prominently displayed and easy to see Yes No

Camera Survey:

17. Does this location have security cameras? Yes No
18. Are they in working order? Yes No
19. What format are the cameras?
 - a. Color Yes No
 - b. Digital Yes No
 - c. VCR Yes No
 - d. Recorded Yes No
20. How long is footage stored for later viewing: 30 days
21. Are there exterior cameras Yes No How many:
22. Are there interior cameras Yes No How many: 8

23. Do all employees know how to retrieve recorded digital images/footage? Yes No
24. Cameras located in parking lot Yes No How many

Interior Survey:

25. What is the planned/posted capacity 306
26. What is the minimum number of employees that will be on premise 5
27. Is the storeowner willing to be a standing complainant regarding loitering? Yes No
a. If yes have them fill out the standing complaint form and give them two of the commercial signs Yes No
28. Is the interior of the location neat and clean? Yes No
29. Does an interior camera face the entrance/exit? Yes No
30. Are emergency and non-emergency numbers posted near the phone? Yes No
31. Does the owner know how to contact their police district directly? Yes No
a. Did you provide a district contact guide to the owner? Yes No

Security

32. How many security personnel are going to be employed: 3
33. How will they be deployed: Interior 2 Exterior 1
34. What days will they be deployed Mon Tue Wed Thu Fri Sat Sun
35. Will the security be managed by business or contracted
36. Will they be armed Yes No
37. What type of security measures will be used:
Wanding/metal detector
ID Scanner
Dress Code
Cover Charge
Age restriction
Other
38. When at capacity, how will the overflow crowd be managed? Owner will rope off a line for waiting patrons
39. Will a guard monitor the overflow crowd at all times? Yes No

ADDITIONAL COMMENTS/RECOMMENDATIONS:

MILWAUKEE POLICE DEPARTMENT
LICENSE INVESTIGATION UNIT

CRIMINAL RECORD/ORDINANCE VIOLATION/INCIDENTS
SYNOPSIS

DATE: 10/20/2010
LICENSE TYPE: BTAVN
NEW: X
RENEWAL:

No. 17266
Application Date: 10/06/2010
Expiration Date:

License Location: 611 W. National Ave.
Business Name: Tainos Sportsbar Restaurant and Lounge

Aldermanic District: 12

Licensee/Applicant: Ortiz Gonzalez, Ana I
(Last Name, First Name, MI)

Date of Birth: 01/03/84

Male:

Female:

Home Address: 7729 W. Hicks St.
City: West Allis
Home Phone: (414) 397-3966

State: Wi Zip Code: 53218

This report is written by Police Officer Gilbert Gwinn, assigned to the License Investigation Unit, Days.

The Milwaukee Police Department's investigation regarding this application revealed the following:

1. On 11/10/09 at 10:07 pm, Milwaukee police conducted a License Premise Check at 2078 S 8th Street. Officers were unable to enter through the front or side doors to the bar and believed the doors to be locked even though the business was open. Officers found that it took a great deal of force to open the front door. Police spoke with the bartender Wanda Rosario-Quinones regarding and Rosairo stated the doors were not locked and that they should work fine. Also found were bottles of liquor with no caps on them. Eleven bottles of liquor contained bugs and were seized by police. One patron was found to have a VOP warrant and he was placed into custody. The licensee Ana Ortiz-Gonzalez, arrived on scene and officers advised her of the violations found. The applicant received a citation for Licensed Premises-Safe Egress Required at 2078 S 8th Street.

Charge: Licensed Premises-Safe Egress Required
Finding: Guilty
Sentence: Fined \$356.00
Date: 12/28/09
Case: 09151107

2. On 11/19/09 at 9:42 pm, Milwaukee Police conducted a License Premise check at 2078 S 8th Street regarding violations found the week before. Bottles were found to be capped and repairs to the entrance door were made. No violations were found during this check.

Page 2 Re: Ortiz Gonzalez, Ana I.

The applicant owes the following to the City of Milwaukee:

Charge:	Date:	Penalty:	Due Date:	Balance Due:	Case:
Operate Without License	12/18/2009	\$114.00	04/12/2010	\$114.00	10007285
Operate Vehicle With Suspended/Revoked/Cancelled Registration	12/18/2009	\$88.80	04/12/2010	\$88.80	10007284

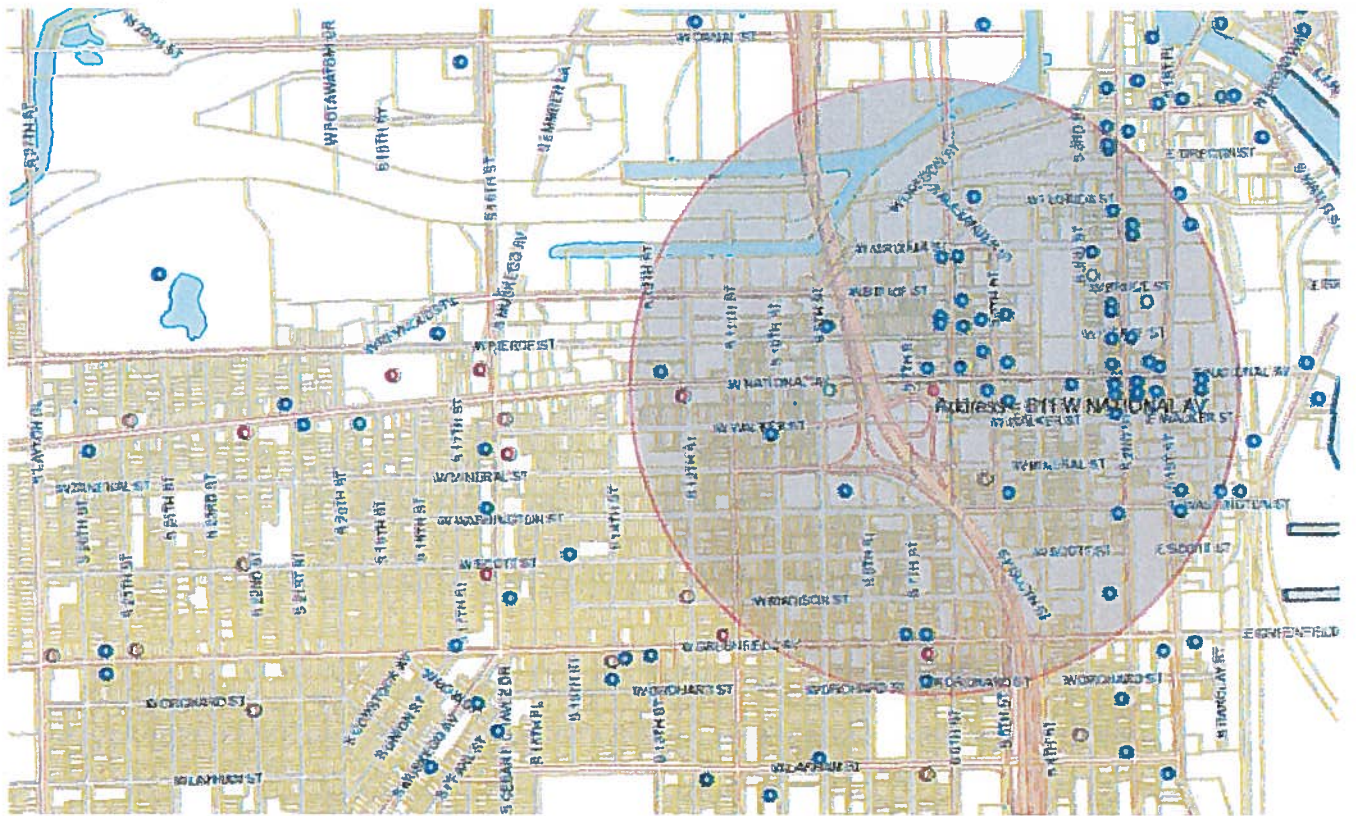

License Summary:									
Class A Fermented Malt Beverage Retailer's License									
Class A Malt & Class A Liquor License									
Class B Fermented Malt Beverage Retailer's License									
Class B Tavern License									
Class C Wine Retailer's License									
Total									
3									
3									
5									
50									
3									
Total									
3									
Room capacity									
Expiration date	Legal entity	Trade name	Licensee	Address	City	State	License type name	Total	Room capacity
2/15/2015	LA TROPICANA	LA TROPICANA	SALVA B TALEB, SP	1011 S	5TH	ST	Class A Fermented Malt Beverage Retailer's License		
4/13/2015	Campanino, LLC	Campanino Di Campanino	Pazzerelli Mayra, Act	695 W	GREENFIELD	AV	Class A Malt & Class A Liquor License		
1/6/2015	BAR LOS COPAS	BAR LOS COPAS	FRANCESCO	601 S	1ST	ST	Class A Malt & Class A Liquor License		
10/13/2014	TEXAS FOOD	TEXAS FOOD	HAKAM F ASSAD, Act	1201 W	NATIONAL	AV	Class A Malt & Class A Liquor License		
3/7/2015	Central Standard LLC	Central Standard Craft Distillery	William P MacChesney, Act	613 S	2ND	ST	Class B Fermented Malt Beverage Retailer's License		
9/13/2014	Club Corp	Analytica Coffee Roasting Co.	Matthew J MacChesney, Act	224 W	Bruce	ST	Class B Fermented Malt Beverage Retailer's License		
5/9/2015	KARAOOKAS INVESTMENTS INC	THE NATIONAL	HICK R KARAOOKAS, Act	402 S	2ND	ST	Class B Fermented Malt Beverage Retailer's License	78	
11/7/2014	THE NATIONAL, LLC	THE NATIONAL	Helen J Benton, Act	819 W	NATIONAL	AV	Class B Fermented Malt Beverage Retailer's License	25	
7/25/2014	TIMES SQUARE BISTRO & PIZZERIA INC.	TIMES SQUARE BISTRO & PIZZERIA	MAARE W BRULGEBER, Act	605 S	1ST	ST	Class B Fermented Malt Beverage Retailer's License	64	
11/20/2014	700 CLUB, LLC	SABBATIC	JAY K STANJATES, Act	700 S	2ND	ST	Class B Tavern License	20	
7/13/2015	AP, LLC	AP Bar & Bingham	ROBERT WAGSTER, Act	814 S	2nd	ST	Class B Tavern License		
7/25/2015	Arumark Corporation	Rockwell Automation	Held M Petrakis, Act	1201 S	2nd	ST	Class B Tavern License		
5/20/2015	Blue Jacket LLC	Blue Jacket	Tom H Van Halbeek, Act	135 E	NATIONAL	AV	Class B Tavern License	88	
11/28/2014	BOOM, LLC	BOOM	DAVID G PANEE, Act	613 S	2ND	ST	Class B Tavern License	271	
7/28/2015	BOTANAS RESTAURANT	BOTANAS RESTAURANT	MARTHA GONZALEZ, SP	818 S	5TH	ST	Class B Tavern License	533	122 plus 160 addition
9/15/2015	Becher Breweries, LLC	Becher Restaurant	David C Swanson, Act	1101 S	2nd	ST	Class B Tavern License	96	1st floor and basement storage
7/5/2015	Camacho's Bar, LLC	Camacho's Bar	JESUS M CAMACHO, Act	611 S	6TH	ST	Class B Tavern License	49	
11/17/2014	Charvelon Productions, LLC	Kona Molito Club	ANGEL M VELAZQUEZ, Act	626 S	5TH	ST	Class B Tavern License	159	
			SANTIBAGO S MERCADO, JR ALFREDO						
			MERCADO FRANCISCO / MERCADO JESUS S						
12/11/2014	Chives Bar	Chives Bar	MERCADO	644 S	9th	ST	Class B Tavern License	30	
3/1/2015	CHELITO LINDO, LLC	CHELITO LINDO	RODRIGO R LOPEZ, Act	731 S	2ND	ST	Class B Tavern License	198	
6/29/2014	CLUB ANYTHING	CLUB ANYTHING	TODD N HOWASSIC, SP	407 S	5TH	ST	Class B Tavern License	160	
11/12/2014	COMBROW, INC	COMBROW SPORTS	Josue Soto, Act	420 S	1ST	ST	Class B Tavern License	120	
6/30/2015	COMERTOS PLACE, INC	COMERTOS PLACE	THOMAS A MALLEB, Act	539 W	WINDING	ST	Class B Tavern License	144	
5/13/2015	CRAZY WATER	CRAZY WATER	PEGGY J HAGSTEB, SP	839 S	2ND	ST	Class B Tavern License	62	
11/2/2014	EL AS DE COPAS	EL AS DE COPAS	ROSTINA STEWART, SP	1246 W	NATIONAL	AV	Class B Tavern License	63	
1/4/2015	El Fand Bar, LLC	El Fand Bar	REVERLYN GONZALEZ DEL TORD, Act	636 S	6TH	ST	Class B Tavern License		
9/12/2015	El Puma V, LLC	Los Angeles City	Ama's, Esteban Ramirez, Act	1444 S	7th	ST	Class B Tavern License		
11/19/2015	EL SIETE DE COPAS	EL SIETE DE COPAS	ANTONIO U OCAMPO, SP	1339 S	7TH	ST	Class B Tavern License	75	
3/23/2015	FELIPE'S LATIN QUARTER	FELIPE'S LATIN QUARTER	LUIS M BELMONTES, SP	538 W	NATIONAL	AV	Class B Tavern License	80	
5/13/2015	FLUID, INC	FLUID	WILLIAM M MARSHLOW, Act	819 S	2ND	ST	Class B Tavern License	110	
9/23/2014	GUADALAJARA CORPORATION	GUADALAJARA RESTAURANT	GENOVEVA LOZADA, Act	901 S	10TH	ST	Class B Tavern License	50	
7/29/2014	IRON HORSE MILWAUKEE, LLC	THE IRON HORSE HOTEL	TIMOTHY J DIXON, Act	500 W	FLORIDA	ST	Class B Tavern License	550	
10/11/2014	JACQUES, LLC	JACQUES	JACQUES J CHALUMET, Act	1022 S	1ST	ST	Class B Tavern License	164	
6/23/2015	Juko, LLC	Juko	Justin H Chan, Act	605 W	WYOMING	ST	Class B Tavern License	99	
4/14/2015	Konak Enterprises, LLC	Konak Cafe	Douglas R Konak, Act	231 S	2nd	ST	Class B Tavern License	99	
12/12/2014	LA CAGE ENTERPRISES, LLC	LA CAGE	MICHAEL J JOST, Act	801 S	7ND	ST	Class B Tavern License	815	45
6/30/2014	LA FLUENTE LTD	LA FLUENTE RESTAURANT	JOSE G ZARATE, Act	825 S	5TH	ST	Class B Tavern License	328	
9/6/2014	LA GUADALUPEANA	LA GUADALUPEANA/CAFE EL SON	Josue Osorio, Act	1020 S	9TH	ST	Class B Tavern License	170	
11/13/2014	LA MERENDA, INC	LA MERENDA	AUGUSTO P SANDRONI, III, Act	125 E	NATIONAL	AV	Class B Tavern License	148	
10/17/2014	LA PERLA, LLC	LA PERLA RESTAURANT	JOANNE A ANTON, Act	730 S	1ST	ST	Class B Tavern License	112	
3/19/2015	LE CABARET, INC	SOLID GOLD	JOHN A URBAN, Act	811 S	5TH	ST	Class B Tavern License	300	
11/4/2014	LA Anagnostis, LLC	La Casa de Alberto	Luis A Anagnostis, Act	624 W	NATIONAL	AV	Class B Tavern License	48	
6/24/2015	LOLA'S, LLC	WALKERS PHIL	ELIZABETH A BOCHNING, Act	814 S	2ND	ST	Class B Tavern License	150	93 Inside, 57 out with 1 portable restroom
4/8/2015	LOUWING AROUND, INC	lyna Nightclub	SAMER L ASAD, Act	715 S	5TH	ST	Class B Tavern License	320	2nd floor = 80; 1st floor = 240
4/10/2015	Love Day Em, LLC	Love 1880	Thomas E Hunt, Act	1100 S	1st	ST	Class B Tavern License	99	
4/17/2015	Madison Bar LLC	Madison Bar	Daniel J De La Rosa, Act	675 S	6TH	ST	Class B Tavern License	75	
5/27/2015	POPPER, 2011 LLC	Studio 200	STEPHEN G LASZKOWSKI, Act	200 E	WASHINGTON	ST	Class B Tavern License	99	
7/29/2014	RDJH, INC	GINGER	ROSE A BRILANCIEY, Act	235 S	2ND	ST	Class B Tavern License	150	
10/13/2014	SHAKERS, INC	SHAKERS CIGAR BAR & WORLD CAFE	ROBERT G WITTS, Act	427 S	2ND	ST	Class B Tavern License	144	
11/12/2014	STEVENS, INC	STEVENS	BERNARD L STEHRUP, Act	800 S	2ND	ST	Class B Tavern License	150	
1/27/2015	STRENGTH HEAD, INC	CAROL'S	CAROL H FLURITSKY, Act	401 S	2ND	ST	Class B Tavern License	176	
9/19/2014	Tasqueria Los Altos de Jalisco, Inc.	Tasqueria Los Altos de Jalisco	Juan J Torrealba, Act	1334 S	7th	ST	Class B Tavern License	99	
4/21/2015	Terra Restaurant & Bar	Terra Restaurant & Bar	Terra Contreras, Act	600 S	6TH	ST	Class B Tavern License	99	
9/23/2014	The Chef's Table LLC	The Chef's Table	Daniel P Magagnoli, Act	500 S	3rd	ST	Class B Tavern License	49	
4/9/2015	The Red Arrow Bar, LLC	UTS Whiskey Bar	LUIS D GARCIA, Act	309 W	National	AV	Class B Tavern License	49	
10/22/2014	THE TRIPLE BGLT CORPORATION	D.J.K.	ELIZABETH J KUZAWA, Act	739 S	1ST	ST	Class B Tavern License	190	
4/16/2015	THE V BAR, LLC	The Tin Widow	MICHELLE R HOFF, Act	701 S	2ND	ST	Class B Tavern License	49	
3/20/2015	Theatre Unchained	Theatre Unchained	JAMES D DRAGONOVICH, SP	1074 S	5TH	ST	Class B Tavern License	99	
4/10/2015	Wanderlust Enterprises, LLC	Fat Daddy's	STEFANY JAMES, Act	120 W	National	AV	Class B Tavern License	220	92 - 1st floor, 128 - Beer Garden
2/23/2015	ZAD'S, INC	ZAD'S	TERRY M ZADRA, Act	454 S	2ND	ST	Class B Tavern License	160	
9/23/2014	Church Corp	Analytica Coffee Roasting Co.	Matthew J MacChesney, Act	224 W	Bruce	ST	Class C Wine Retailer's License		
11/1/2014	THE NATIONAL, LLC	THE NATIONAL	Helen J Benton, Act	819 W	NATIONAL	AV	Class C Wine Retailer's License		
7/29/2014	TIMES SQUARE BISTRO & PIZZERIA INC	TIMES SQUARE BISTRO & PIZZERIA	MAARE W BRULGEBER, Act	605 S	1ST	ST	Class C Wine Retailer's License	64	



Friday, March 27, 2015



Notice of Public Hearing

MORALES, Reyna G, Agent

Reyna's Events & Mexican Restaurant at 611 W NATIONAL Av

Class B Tavern and Public Entertainment Premises License Applications Requesting Instrumental Musicians, Bands, Disc Jockey, Patrons Dancing, Jukebox, and Karaoke

Monday, April 06, 2015 at 11:00 AM

To whom it may concern:

The above application has been made by the above named applicant(s). This requires approval from the Licenses Committee and the Common Council of the City of Milwaukee. The hearing before the Licenses Committee will take place on 4/6/2015 at 11:00 AM, in Room 301-B, Third Floor, City Hall. If you wish, you may provide testimony at the hearing regarding the request; see below for further information. You are not required to attend the hearing. Once the Licenses Committee makes its recommendation, this recommendation is forwarded to the full Common Council for approval at its next regularly scheduled hearing. Please review the information below and if you have further questions regarding this process, please contact the License Division at (414) 286-2238.

Important details for those wishing to provide information for the Licenses Committee to consider when making its recommendation:

1. The license application is scheduled to be heard at the above time. Due to other hearings running longer than scheduled, you may have to wait some time to provide your testimony.
2. You must appear in person and testify as to matters that you have personally experienced or seen. (You cannot provide testimony for your neighbor, parent or anyone else; this is considered hearsay and cannot be considered by the committee.)
3. No letters or petitions can be accepted by the committee (unless the person who wrote the letter or the persons who signed the petition are present at the committee hearing and willing to testify).
4. Persons opposed to the license application are given the opportunity to testify first; supporters may testify after the opponents have finished.
5. When you are called to testify, you will be sworn in and asked to give your name, and address. (If your first and/or last names are uncommon please spell them.)
6. You may then provide testimony.
 - a. Include only information relating to the above license application.
 - b. Include only information you have personally witnessed or seen.
 - c. Provide concise and relevant information detailing how this business has affected or may affect the peaceful enjoyment of your neighborhood.
 - d. If by the time you have the opportunity to testify, the information you wish to share has already been provided to the committee, you may state that you agree with the previous testimony. Redundant or repetitive testimony will not assist the committee in making its recommendation.
7. After giving your testimony, the members of the Licenses Committee and the licensee may ask questions regarding the testimony you have given or other factors relating to the license application.
8. Business Competition is not a valid basis for denial or non-renewal of a license.
Please Note: If you have submitted an objection to the above application your objection cannot be considered by the committee unless you personally testify at the hearing.

RESIDENT	MAIL ADDRESS	CITY AND ZIP CODE
CURRENT RESIDENT	518 W NATIONAL AVE	MILWAUKEE, WI 53204-1746
CURRENT RESIDENT	522 W NATIONAL AVE	MILWAUKEE, WI 53204-1746
CURRENT RESIDENT	522A W NATIONAL AVE	MILWAUKEE, WI 53204-1746
CURRENT RESIDENT	526 W NATIONAL AVE	MILWAUKEE, WI 53204-1746
CURRENT RESIDENT	532 W NATIONAL AVE	MILWAUKEE, WI 53204-1746
CURRENT RESIDENT	533 W WALKER ST	MILWAUKEE, WI 53204-1754
CURRENT RESIDENT	534 W NATIONAL AVE	MILWAUKEE, WI 53204-1746
CURRENT RESIDENT	624 W NATIONAL AVE A	MILWAUKEE, WI 53204-1712
CURRENT RESIDENT	624 W NATIONAL AVE B	MILWAUKEE, WI 53204-1712
CURRENT RESIDENT	624 W NATIONAL AVE C	MILWAUKEE, WI 53204-1712
CURRENT RESIDENT	639 W NATIONAL AVE	MILWAUKEE, WI 53204-1714
CURRENT RESIDENT	701A W NATIONAL AVE	MILWAUKEE, WI 53204-1716
CURRENT RESIDENT	718 S 7TH ST 1	MILWAUKEE, WI 53204-1709
CURRENT RESIDENT	718 S 7TH ST 2	MILWAUKEE, WI 53204-1709
CURRENT RESIDENT	718 S 7TH ST 3	MILWAUKEE, WI 53204-1709
CURRENT RESIDENT	720 S 6TH ST	MILWAUKEE, WI 53204-1707
CURRENT RESIDENT	720A S 6TH ST	MILWAUKEE, WI 53204-1707
CURRENT RESIDENT	722 S 7TH ST	MILWAUKEE, WI 53204-1709
CURRENT RESIDENT	722A S 7TH ST	MILWAUKEE, WI 53204-1709
CURRENT RESIDENT	724 S 7TH ST	MILWAUKEE, WI 53204-1709
CURRENT RESIDENT	724A S 7TH ST	MILWAUKEE, WI 53204-1709
CURRENT RESIDENT	813 S 5TH ST	MILWAUKEE, WI 53204-1730
CURRENT RESIDENT	819 S 5TH ST	MILWAUKEE, WI 53204-1730
CURRENT RESIDENT	900 S 6TH ST	MILWAUKEE, WI 53204-1736
CURRENT RESIDENT	902 S 6TH ST	MILWAUKEE, WI 53204-1736
CURRENT RESIDENT	902A S 6TH ST	MILWAUKEE, WI 53204-1736
CURRENT RESIDENT	902B S 6TH ST	MILWAUKEE, WI 53204-1736

Total Records: 28

Radius: 250.0 feet and Center of Circle: 611 W National AV



PLAN OF OPERATION

1. Premises Location
<input type="checkbox"/> Free Standing Building <input type="checkbox"/> Strip Mall <input checked="" type="checkbox"/> Other <u>FIRST FLOOR + BASEMENT OF COMMERCIAL BUILDING</u>
2. Describe Premises Structure
<input type="checkbox"/> Single Story <input checked="" type="checkbox"/> Multi-Story - # of Stories <u>4</u> <input type="checkbox"/> Other _____
3. Describe Surrounding Area
<input checked="" type="checkbox"/> Commercial <input type="checkbox"/> Residential <input type="checkbox"/> Industrial <input type="checkbox"/> Other _____
4. Premises Location
a) <input checked="" type="checkbox"/> Major Thoroughfare <input type="checkbox"/> Secondary Street <input type="checkbox"/> Other _____ b) Nearest Cross Street <u>S. 6th ST. + W. NATIONAL AVE.</u>
5. Proximity of Premises to Church, School, or Hospital
Is there at least 300 feet between the building and any church, school or hospital? <input checked="" type="checkbox"/> Yes <input type="checkbox"/> No
6. Miscellaneous Business Questions
a) Proposed Opening Date: <u>JUNE 2014</u> b) Is this premise under construction? <input type="checkbox"/> Yes <input checked="" type="checkbox"/> No If yes, list estimated completion date: _____ c) Is this a franchise? <input type="checkbox"/> Yes <input checked="" type="checkbox"/> No d) Is this premises currently licensed? <input type="checkbox"/> Yes <input checked="" type="checkbox"/> No If yes, list type of license: _____ e) Is the current licensee operating? <input type="checkbox"/> Yes <input checked="" type="checkbox"/> No If no, list date closed: _____ f) What other types of licenses/permits will you or do you hold at this location? (check all that apply) <input checked="" type="checkbox"/> Occupancy Permit <input type="checkbox"/> Cigarette & Tobacco <input type="checkbox"/> Gas Station <input type="checkbox"/> Extended Hours <input type="checkbox"/> Other: _____ g) Do you have future plans for other businesses, licenses or permits at this location? <input type="checkbox"/> Yes <input checked="" type="checkbox"/> No If yes, explain: _____
7. Food
Will food be served on the premises? <input type="checkbox"/> No <input checked="" type="checkbox"/> Yes If yes, a Food Dealer license is required. Check all that apply: <input checked="" type="checkbox"/> Prepackaged Food <input checked="" type="checkbox"/> Snacks <input checked="" type="checkbox"/> Appetizers <input checked="" type="checkbox"/> Catered Events <input checked="" type="checkbox"/> Full Meals - Hours of Food Service: From _____ To _____ A menu must be submitted with this Plan of Operation for all restaurants.
8. Type of Business
Briefly describe the type of business you plan to operate if granted a license (attach additional sheets as necessary.) <u>EVENT BUSINESS SPECIALIZING IN WEDDINGS, BIRTHDAYS,</u> <u>GRADUATIONS, ANNIVERSARIES + OTHER SPECIAL EVENTS.</u> <u>SERVING FOOD, BAKERY AND SOME ALCOHOLIC BEVERAGES</u>

9. Litter and Noise

How are the grounds kept clean? Sweep Pressure Wash Pick Up Litter Other: _____

How often will grounds be cleaned? Daily Weekly Other: _____

Grounds Cleaned By: Licensee Building Owner Employees Hired Maintenance Other: _____

How are noise issues prevented and/or addressed? Security Manager approaches customer(s) Call Police
 Signs Posted Other: _____

10. Smoking and Sanitation

Are there designated outdoor smoking areas? No Yes
 If yes, describe the area(s) and provide location(s): _____

Number of Garbage Cans: Inside: X Locations: GARBAGE REMOVED BY STAFF
 Outside: 0 Locations: around the building.

Is a Crowd Control Barrier used? No Yes If yes, describe: SECURITY

Describe sanitation facilities (restrooms): 5 WOMANS 3 MANS

Provide name of solid waste contractor: Eagle Disposal

11. Security

Are there parking spaces on the premises? No Yes If yes, number of spaces: 40 APPROX. and describe security provisions: _____

Are there designated loading areas? No Yes If yes, describe security provisions _____

Do you have security personnel on the premise? No Yes If yes, how many? AS NECESSARY

AND What are their responsibilities? MAINTAIN ORDER IN THE EVENT OF ANY PROBLEMS

What security equipment do they use? NOT ENGAGED - AT THIS TIME

List their licensing, certification or training credentials: _____

Are there security cameras? No Yes If yes, list all locations: THROUGHOUT THE PREMISES

Are searches and/or identification checks conducted upon entry? No Yes If yes, describe: I.D. EVERYONE

12. Percentage of Sales (must total 100%)

Alcohol 50 % Food Sales 50 % Entertainment _____ % Other _____ %

13. Businesses On The Premise (choose all that apply):

Type 1

- Full Service Restaurant
- Night Club
- Bowling Alley
- Cafe/Coffee Shop
- Tavern
- Hotel
- Deli or Fast Food Restaurant
- Cocktail Lounge
- Banquet Hall
- Private/Fraternal/Veterans Club
- Teen Club
- Sports Facility

Type 2

- Liquor Store
- Gas Station
- Corner Store
- Other _____
- Supermarket
- Convenience Store

14. Legal Capacity of Premises (Only premises identified as Type I in Question #13)

306 (Call the Milwaukee Development Center at 414-286-8211 if you have questions.)

15. Hours of Operation

Day of the Week	Proposed Hours of Operation:		Number of Customers expected each day	Potential Age Range of Customers	Class B Applicants: Age Restriction (If none, write 'None')
	Open	Close			
Sunday	10 ^{AM}	2 ^{AM}	20 to 200	21-75	MINORS ALLOWED
Monday	10 ^{AM}	2 ^{AM}	20 to 200	21-75	(IN WITH PARENTS)
Tuesday	10 ^{AM}	2 ^{AM}	20 to 200	21-75	FOR FAMILY EVENTS
Wednesday	10 ^{AM}	2 ^{AM}	20 to 200	21-75	
Thursday	10 ^{AM}	2 ^{AM}	20 to 200	21-75	
Friday	10 ^{AM}	2 ^{AM}	20 to 300	21-75	
Saturday	10 ^{AM}	2 ^{AM}	20 to 300	21-75	

Entertainment Indoor Closing Hours - If alcohol beverage establishment, same as alcohol license hours.
If non-alcohol establishment 1:00 am Sunday to Thursday; 1:30 am Friday and Saturday.

Entertainment Outdoor Closing Hours - 10:00 pm Sunday - Thursday; 12:00 am Friday and Saturday, unless otherwise approved by Common Council in licensee's plan of operation.

16. This Section to be Completed by Alcohol Applicants Only

a) Property Owners Name: ESPERANZA UNIDA Phone Number: 641-0251
Address: 611 W. NATIONAL AVE MILWAUKEE WI. 53204

b) Are you taking out this application for anyone that may not be eligible for a license? No Yes
If yes, list name and address: _____

c) Will the agent, a partner or the individual licensee be conducting the day-to-day operations of the business? No Yes
If no, list the name and address of the person(s) who will: _____

Class B Applicants: If the agent, a partner or the individual licensee will not be conducting the day-to-day operations of the business, the person(s) listed above must obtain a Class B Managers license.

d) Does anyone else have money invested or any other interest in this business? No Yes
If yes, explain: _____

e) Have you made an agreement with anyone to repay any loan or any other payments based upon income from the business?
 No Yes If yes, list name and address: _____

f) Will any of the following types of businesses be conducted at this location? (check all that apply)
 Bed & Breakfast Billiard/Pool Hall Comedy Club Indoor Golf Facility
 Video Game Center(6 or more games) Brew Pub Volleyball Court Theater Wine Tasting Room
 Department Store Pharmacy Gift Shop Museum Center for the Visual & Performing Arts

g) If applying for Class B or C license, are you applying for "Service Bar Only"? No Yes
Service Bar Only means customers cannot sit at the bar. Alcohol is served to patrons seated at tables. No stools, chairs or other articles of furniture shall be placed at the service bar for patrons to sit upon.

17. Proof of Ownership, Lease, or Offer to Purchase (new & transfer applicants only)

Submit proof of ownership, lease, or offer to purchase the building with this application.
A lease or office to purchase must:

- Be in the same legal entity name as that apply for the license
- Reflect the same address as the premises address on this application
- Reflect current dates and
- Be signed by the lessor/seller and lease/buyer

18. Property Information (new & transfer applicants only)

- a) Do you own or lease the building? Own Lease
 - b) Who owns the fixtures (for example, coolers, etc.)? LANDLORD
 - c) Are you purchasing the stock and/or fixtures? No Yes If yes, amount paid \$ _____
 - d) Total amount paid for business \$ 0
 - e) Total amount paid for goodwill of the business \$ 0
- Goodwill comprises the reputation and customer relationships of an existing business. If the price you pay for the business exceeds the fair market value of all of the rest of the assets of the business, the excess may be considered goodwill.
- f) Have you made arrangements with the seller for payment of personal property taxes? No Yes

19. Lease Information (new & transfer applicants who are leasing the premises only)

- a) Date lease begins MAY 2014 Ends MAY 2024
- b) Monthly rental \$ \$2,600⁰⁰
- c) Do you have an option to renew the lease? No Yes
- d) Does your lease allow for assignment to another party without the consent of the owner? No Yes
- e) For what length of time have you been guaranteed occupancy (number of years)? 10 years
- f) In addition to paying the monthly rental, will you have to pay anything additional to the owner of the building to guarantee performance of the lease? No Yes If yes, explain H.V.A.C. UPDATE
- g) Does the present owner or occupancy object to the granting of your license? No Yes
If yes, explain _____

20. Change of Agent Applicants Only

Have there been any changes to the floor plan since the last application was submitted? No Yes
If no, a new floor plan is not required. If yes, submit a new floor plan and explain the change(s): _____

21. Notarized Signatures of Applicants

SUBSCRIBED AND SWORN TO BEFORE ME

This 13th day of June, 2014
David Harris
(Clerk/Notary Public)

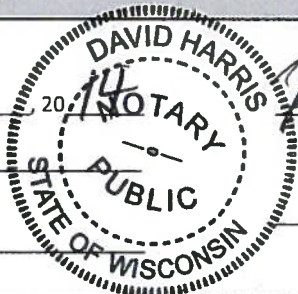

Reyna Morales
Agent/Owner/Partner

My Commission Expires 2/19/17
***Notary Seal must be affixed.**

[Signature]
Additional Owner/Partner

Note: All information contained in this application is subject to approval by the Common Council. Deviating from approved plan of operation will subject licensee to citations, and/or suspension or non-renewal of the license. Contact the License Division for information on how to request changes.

New and transfer of premise applicants must submit the following:

- Proof of ownership, lease or offer to purchase the building
- Detailed floor plan
- If a restaurant, copy of the menu

If you do not provide all required information, your application will be returned to you.



PUBLIC ENTERTAINMENT PREMISES SUPPLEMENTARY APPLICATION

Office of the City Clerk License Division
200 E. Wells St. Room 105, Milwaukee, WI 53202
(414) 286-2238 www.milwaukee.gov/license
e-mail address: license@milwaukee.gov

(1) TYPES OF ENTERTAINMENT (CHOOSE ALL THAT APPLY)

<input checked="" type="checkbox"/> Instrumental Musicians	<input checked="" type="checkbox"/> Bands	<input type="checkbox"/> Battle of the Bands	<input type="checkbox"/> Comedy Acts
<input checked="" type="checkbox"/> Disc Jockey	<input type="checkbox"/> Magic Shows	<input type="checkbox"/> Poetry Readings	<input type="checkbox"/> Dancing by Performers
<input type="checkbox"/> Adult Entertainment/ Strippers/Erotic Dance	<input type="checkbox"/> Wrestling	<input type="checkbox"/> Patron Contests	<input checked="" type="checkbox"/> Patrons Dancing
<input checked="" type="checkbox"/> Jukebox	<input checked="" type="checkbox"/> Karaoke	<input type="checkbox"/> Bowling Alley	<input type="checkbox"/> Pool Tables
<input type="checkbox"/> Motion Pictures	<input type="checkbox"/> Amusement Machines –	<input type="checkbox"/> Concerts	<input type="checkbox"/> Theatrical Performances
How many? _____	How many? _____	Approx. # per year? _____	Approx. # per year? _____
<input type="checkbox"/> Other: _____			

(2) WILL PROMOTERS EVER BE USED FOR ANY OF THE ENTERTAINMENT?

No Yes, describe: _____

(3) LEGAL CAPACITY OF PREMISES

306 (Call the Milwaukee Development Center at 414-286-8211 if you have questions.) Your legal capacity will determine the license fee for your Public Entertainment Premise License. If you would like to request that the license be approved with a lower capacity than that listed above, indicate lower capacity _____. If approved, this lower capacity will print on your license and override the capacity listed on your Occupancy Permit.

(4) IDENTIFY IF SOUND AMPLIFICATION IS USED

No Yes, describe: EXISTING SYSTEM

(5) DECLARATIONS, ACKNOWLEDGEMENTS, AND DISCLOSURES

1. The undersigned understands that after the license has been issued, a change to the plan of operation will require a written request to change and approval from the Common Council.
2. The undersigned agrees to inform the City Clerk within 10 days of any substantial changes in the information supplied in this application.
3. The undersigned understands that applicants shall not willfully refuse to provide the services offered under this license, or add charges or require deposits not required of the general public because of race, color, sex, religion, national origin or ancestry, age, handicap, lawful source of income, marital status, sexual orientation, gender identity or expression, familial status or the fact that a person is now or has been a member of the military service, whether dressed in uniform or not; and shall not seek such information as a condition of employment, or penalize any employee or discriminate in the selection of personnel for training or promotion on the basis of such information.
4. The undersigned has knowledge of the City Ordinances currently regulating the public entertainment, and understands that the license may be subject to suspension, non-renewal or revocation, if the applicant violates any rule, law or regulation of the city of Milwaukee and State of Wisconsin.

(6) NOTARIZED SIGNATURES OF APPLICANTS

SUBSCRIBED AND SWORN TO BEFORE ME
This 13th day of June, 2014

David Harris
(Clerk/Notary Public)
My Commission Expires 2/19/17
**Notary Seal must be affixed.*

Ryza Morales
Agent/Owner/Partner

Additional Owner/Partner

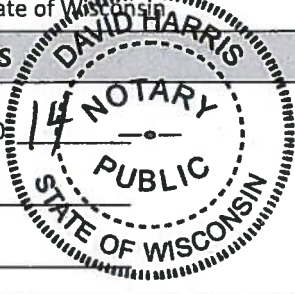

Office Use Only: Initials: _____ Filed: _____ App #: _____ Permit #: _____ Granted: _____ Issued: _____

TOTAL SQUARE FOOTAGE = 4,150.44

DT. 54.9'

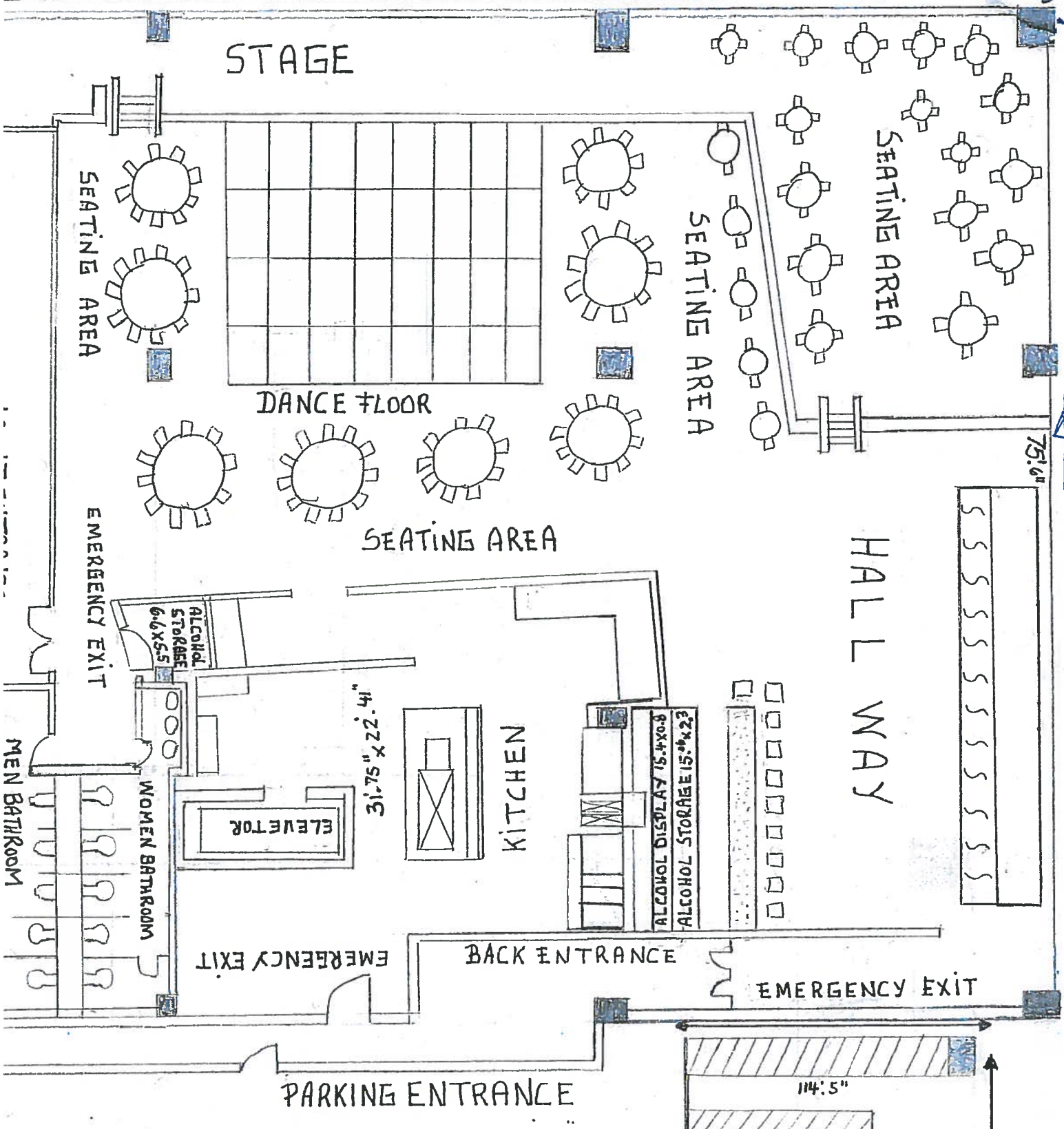

W NATIONAL AVE
TE: 08/02/2013

gnas Mexican Restaurant and events LLC
↑
N
gnas Mexican Restaurant and events.

PARKING AREA
114'5"
445'4"

Base + mant

