

DD#2500

# CERTIFIED SURVEY MAP NO. \_\_\_\_\_

A division of part of Lot 3 and all of Lots 2, 10 and 11 and the public alley adjoining said lots in Block 38 in the Plat of Milwaukee, part of the Northwest 1/4 and Southwest 1/4 of the Southwest 1/4 of Section 28, Town 7 North, Range 22 East, in the City of Milwaukee, Milwaukee County, Wisconsin.

NW COR. SW 1/4  
28-7--22  
NO POINT  
N. 395.514.95  
E. 2,559,200.07

ZONED: C9G  
TAX KEY NO.'S: 392-1012,  
1019-100, 1022, & PART  
OF 396-0132

- LEGEND**
- - SECTION CORNER
  - + - CHISELED CROSS AS NOTED
  - (R) - RECORD
  - ⊙ - DEDICATED TO THE CITY OF MILWAUKEE FOR PUBLIC ALLEY PURPOSES



## N. MILWAUKEE ST.

## E. ST. PAUL AVE.

## E. BUFFALO ST.

## N. BROADWAY

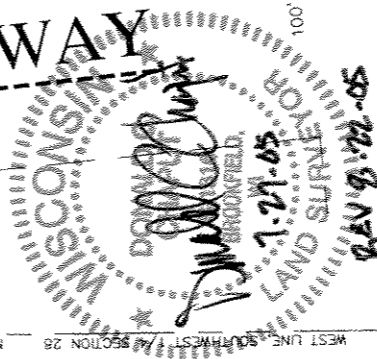

ANGLES  
A= 185°10'24"  
B= 174°53'19"

SW COR. SW 1/4  
28-7--22  
CONC MON  
W/BRASS CAP  
N. 392,877.36  
E. 2,559,245.79

BEARING BASIS  
ALL BEARINGS REFER TO THE WEST  
LINE OF THE SOUTHWEST 1/4 OF  
SECTION 28, WHICH HAS A  
WISCONSIN STATE PLANE  
COORDINATE SYSTEM (SOUTH ZONE)  
BEARING OF N 00°59'35" W, AS  
PUBLISHED BY SEWRPC, JAN. 2005.

GRAPHIC SCALE  
0 20 40 80  
( IN FEET )  
1 inch = 80 ft.

VICINITY SKETCH  
SW 1/4 28-7-22  
1"=2000'

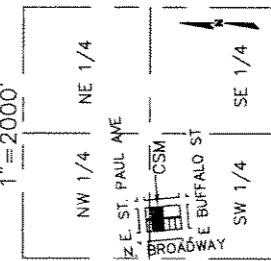

**National Survey & Engineering**  
262-781-1000  
Fax 262-797-7373  
16745 W. Bluestound Road  
Suite 200  
Brookfield, WI 53005-5938  
A Division of R.A. Smith & Associates, Inc.  
www.nrsac.com

Sheet 1 of 5

DEPARTMENT OF CITY DEVELOPMENT  
CITY OF MILWAUKEE

INFRASTRUCTURE SERVICES DIVISION  
CENTRAL DRAFTING & RECORDS MANAGER

Marcia Jankuba 1/17/06  
ENGR. IN CHARGE

Martin Legume 1/17/06  
CORRECT  
CITY ENGINEER

APPROVED

JUN 23 2005 1:41 PM

STAFF APPROVED

APPROVED

DP# 2570

CERTIFIED SURVEY MAP NO. \_\_\_\_\_

A division of part of Lot 3 and all of Lots 2, 10 and 11 and the public alley adjoining said lots in Block 38 in the Plat of Milwaukee, part of the Northwest 1/4 and Southwest 1/4 of the Southwest 1/4 of Section 28, Town 7 North, Range 22 East, in the City of Milwaukee, Milwaukee County, Wisconsin.

SURVEYOR'S CERTIFICATE

STATE OF WISCONSIN }  
WAUKESHA COUNTY } :SS }

I, DONALD C. CHAPUT, Registered Land Surveyor, do hereby certify:

THAT I have surveyed, divided and mapped a division of part of Lot 3 and all of Lots 2, 10 and 11 and the public alley adjoining said lots in Block 38 in the Plat of Milwaukee, part of the Northwest 1/4 and Southwest 1/4 of the Southwest 1/4 of Section 28, Town 7 North, Range 22 East, in the City of Milwaukee, Milwaukee County, Wisconsin, which is bounded and described as follows:

COMMENCING at the Southwest corner of said 1/4 Section; thence North 00°59'35" West along the West line of said 1/4 Section 1341.33 feet to a point; thence North 89°00'25" East, measured normal to said west line, 284.10 feet to a point at the Northwest corner of Lot 12, said Block 38; thence South 06°14'44" East along the West line of said Lot and the East line of North Broadway 59.96 feet to the Northwest corner of Lot 11 and the point of beginning of the lands to be described; thence North 83°42'14" East along the North line of said Lot 254.62 feet to the Northeast corner of said Lot 2; thence South 06°18'41" East along the East line of Lots 2 and 3 a distance of 118.82 feet to point; thence South 83°46'31" West 120.38 feet to a point; thence South 78°36'07" West 14.06 feet to a point; thence South 83°42'48" West 120.38 feet to the Southwest corner of Lot 10; thence North 06°14'44" West along the West line of said Lot and the East line of North Broadway 119.90 feet to the point of beginning. Excepting and dedicating therefrom the 14.00 foot public alley shown hereon. Containing 30,391 square feet or 0.698 acres.

THAT I have made this survey, land division and map by the direction THE MICHAEL J. GARDNER 1999 TRUST and MICHAEL J. GARDNER, owners.

THAT the map is a correct representation of all the exterior boundaries of the land surveyed and the land division thereof made.

THAT I have fully complied with Chapter 236 of the Wisconsin Statutes and Chapter 119 of the Milwaukee Code in surveying, dividing and mapping the same.

July 27, 2005  
DATE  
Rev August 22, 2005

*Donald C. Chaput*  
DONALD C. CHAPUT,  
REGISTERED LAND SURVEYOR S-1316

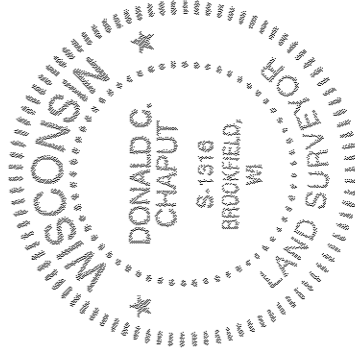

CERTIFIED SURVEY MAP NO. \_\_\_\_\_

A division of part of Lot 3 and all of Lots 2, 10 and 11 and the public alley adjoining said lots in Block 38 in the Plat of Milwaukee, part of the Northwest 1/4 and Southwest 1/4 of the Southwest 1/4 of Section 28, Town 7 North, Range 22 East, in the City of Milwaukee, Milwaukee County, Wisconsin.

OWNER'S CERTIFICATE

THE MICHAEL J. GARDNER 1999 TRUST, a Trust organized and existing under and by virtue of the laws of the State of Wisconsin, as owner, certifies that said Trust caused the land described on this map to be surveyed, divided, mapped and dedicated as represented on this map in accordance with the requirements of Chapter 119 of the Milwaukee Code of Ordinances.

IN consideration of the approval of the map by the Common Council of the City of Milwaukee and in accordance with Chapter 119 of the Milwaukee Code, the undersigned agrees:

- A. That all utility lines to provide electric power and telephone service and cable television or communications systems lines or cables to all lots in the Certified Survey Map shall be installed underground in easements provided therefore, where feasible.

THIS agreement shall be binding on the undersigned and assigns.

IN Witness Whereof THE MICHAEL J. GARDNER 1999 TRUST has caused these presents to be signed by Michael J. Gardner, Trustee, this 5 day of December, 2005.

THE MICHAEL J. GARDNER 1999 TRUST

  
MICHAEL J. GARDNER, TRUSTEE

STATE OF WISCONSIN }  
COUNTY OF Milwaukee } :SS

Be it known, that on this 5 day of December, 2005, before me, a Notary Public, in and for said County and State, personally came, MICHAEL J. GARDNER, who acknowledged himself to be the Trustee of THE MICHAEL J. GARDNER 1999 TRUST, to me personally known to be the person who executed the foregoing instrument, and acknowledged that he executed the same freely and voluntarily for the uses and purposes mentioned in it and as the free act and deed of the said Trust, by its authority.

IN WITNESS WHEREOF, I have hereunto set my hand and official seal.

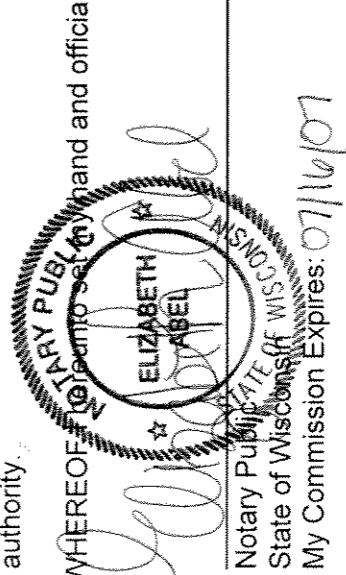
  
Notary Public  
State of Wisconsin  
My Commission Expires: 07/16/07

  
WISCONSIN  
PUBLIC  
ELIZABETH J. STABEL  
S-1316  
BROOKFIELD,  
1-27-05  
LAND SURVEYOR  
REV. 8-22-05

DD#2500

CERTIFIED SURVEY MAP NO. \_\_\_\_\_

A division of part of Lot 3 and all of Lots 2, 10 and 11 and the public alley adjoining said lots in Block 38 in the Plat of Milwaukee, part of the Northwest 1/4 and Southwest 1/4 of the Southwest 1/4 of Section 28, Town 7 North, Range 22 East, in the City of Milwaukee, Milwaukee County, Wisconsin.

OWNER'S CERTIFICATE

MICHAEL J. GARDNER, as owner, certifies that he caused the land described on this map to be surveyed, divided, mapped and dedicated as represented on this map in accordance with the requirements of Chapter 119 of the Milwaukee Code of Ordinances.

IN consideration of the approval of the map by the Common Council of the City of Milwaukee and in accordance with Chapter 119 of the Milwaukee Code, the undersigned agrees:

- A. That all utility lines to provide electric power and telephone service and cable television or communications systems lines or cables to all lots in the Certified Survey Map shall be installed underground in easements provided therefore, where feasible.

THIS agreement shall be binding on the undersigned and assigns.

WITNESS the hand of MICHAEL J. GARDNER this 5 day of December, 2005.

  
 MICHAEL J. GARDNER

STATE OF WISCONSIN }  
 COUNTY OF Milwaukee } :SS

Be it known, that on this 5<sup>th</sup> day of December, 2005, before me, a Notary Public, in and for said County and State, personally came, MICHAEL J. GARDNER, who acknowledged himself to be the person who executed the foregoing instrument, and acknowledged that he executed the same freely.

IN WITNESS WHEREOF I hereunto set my hand and official seal.

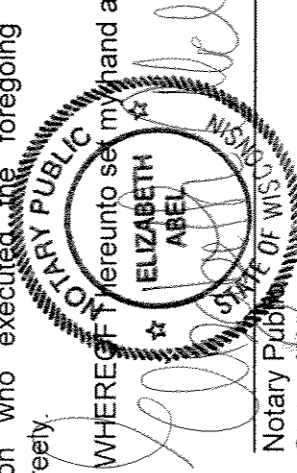

Notary Public  
 State of Wisconsin  
 My Commission Expires 07/16/07

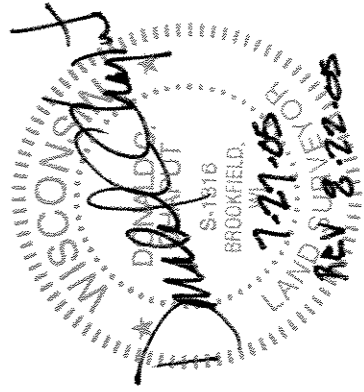

DLD # 2570

CERTIFIED SURVEY MAP NO. \_\_\_\_\_

A division of part of Lot 3 and all of Lots 2, 10 and 11 and the public alley adjoining said lots in Block 38 in the Plat of Milwaukee, part of the Northwest 1/4 and Southwest 1/4 of the Southwest 1/4 of Section 28, Town 7 North, Range 22 East, in the City of Milwaukee, Milwaukee County, Wisconsin.

CERTIFICATE OF CITY TREASURER

STATE OF WISCONSIN     }  
                                      } :SS  
MILWAUKEE COUNTY    }

I, WAYNE F. WHITTOW, being the duly elected, qualified and acting City Treasurer of the City of Milwaukee, certify that in accordance with the records in the office of the City Treasurer of the City of Milwaukee there are no unpaid taxes or unpaid special assessments on the land included in this Certified Survey Map.

\_\_\_\_\_  
WAYNE F. WHITTOW, CITY TREASURER

DATE \_\_\_\_\_

COMMON COUNCIL CERTIFICATE OF APPROVAL

I certify that this Certified Survey Map was approved under Resolution File No. OS1323 adopted by the Common Council of the City of Milwaukee on February 7, 2006.

\_\_\_\_\_  
RONALD D. LEONHARDT, CITY CLERK

\_\_\_\_\_  
TOM BARRETT, MAYOR

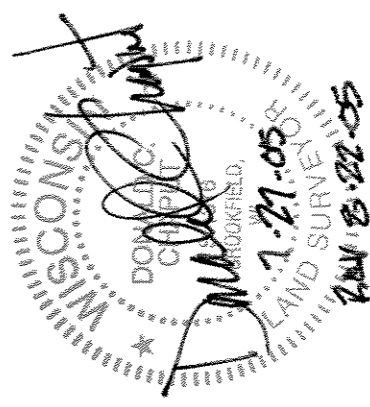

159686.CSM

This instrument was drafted by Donald C. Chaput  
Registered Land Surveyor S-1316