



CITY OF MILWAUKEE
OFFICE OF THE CITY CLERK

Wednesday, June 15, 2022

COMMITTEE MEETING NOTICE

AD 04

DAMIANO, Christian M, Agent
BRG Lotta Burger, LLC
520 W MC KINLEY Av
Milwaukee, WI 53212

You are requested to attend a virtual hearing to be held on:

Tuesday, June 28, 2022 at 11:25 AM

Regarding: Your Class B Tavern and Food Dealer License Applications as agent for "BRG Lotta Burger, LLC" for "Roundhouse" at 1750 N Lincoln Memorial DR. 

This meeting will be held via GoToMeeting. Please see the enclosed best practices document for further instructions. The access code is <https://meet.goto.com/834390325>. If you wish to call in, please call [+1 \(408\) 650-3123](tel:+14086503123) and use Access Code: 834-390-325.

There is a possibility that your application may be denied for one or more of the following reasons: The recommendation of the committee regarding the application shall be based on evidence presented at the hearing. Per MCO 85-2.7-4, probative evidence concerning whether or not a new license should be granted may be presented on the following subjects: whether or not the applicant meets the municipal requirements, the appropriateness of the location and premises where the licensed premises is to be located and whether use of the premises for the purposes or activities permitted by the license would tend to facilitate a public or private nuisance or create undesirable neighborhood problems such as disorderly patrons, unreasonably loud noise, litter, and excessive traffic and parking congestion. Probative evidence relating to these matters may be taken from the plan of operation submitted with the license application, if any, but shall not include the content of any music. Evidence regarding the fitness of the location of the premises to be maintained as the principal place of business, including but not limited to whether there is an overconcentration of businesses of the type for which the license is sought; whether the proposal is consistent with any pertinent neighborhood business or development plans, or the location's proximity to areas where children are typically present. The applicant's record in operating similarly licensed premises; and whether or not the applicant has been charged with or convicted of any felony, misdemeanor, municipal offense or other offense, the circumstances of which substantially relate to the activity to be permitted by the license being applied for or any other factor which reasonably relates to the public health, safety or welfare may also be considered. See attached police report or correspondence.

Notice for applicants with warrants or unpaid fines:

Proof of warrant satisfaction or payment of fines must be submitted at the hearing on the above date and time. Failure to comply with this requirement may result in a delay of the granting/denial of your application.

Failure to attend this meeting may result in the denial of your license. Individual applicants and partnership applicants must attend or attend by an attorney. The agent or attorney for corporate or limited liability applicants must attend. If you wish to do so and at your own expense, you may be accompanied by an attorney of your choosing to represent you at this hearing.

You will be given an opportunity to speak on behalf of the application and to respond and challenge any charges or reasons given for the denial. No petitions can be accepted by the committee, unless the people who signed the petition attend the virtual hearing and are willing to testify. You may present witnesses under oath and you may also confront and cross-examine opposing witnesses under oath. If you have difficulty with the English language, you should request an interpreter attend the meeting with you, at your expense, so that you can answer questions and participate in your hearing.

PLEASE NOTE: Upon reasonable notice, efforts will be made to accommodate the needs of disabled individuals through sign language interpreters or other auxiliary aids. For additional information or to request this service, contact the Council Services Division ADA Coordinator at (414) 286-2998, Fax - (414) 286-3456, TDD - (414) 286-2025.

JIM OWCZARSKI, CITY CLERK



BY: _____

Jim Cooney
License Division Manager

If you have questions regarding this meeting, please contact the staff assistant, Yadira Melendez at (414) 286-2775 or stas5@milwaukee.gov



CITY OF MILWAUKEE
OFFICE OF THE CITY CLERK

Wednesday, June 15, 2022

COMMITTEE MEETING NOTICE

AD 04

DAMIANO, Christian M, Agent
BRG Lotta Burger, LLC
W226 N7459 WOODLAND CREEK
SUSSEX, WI 53089

You are requested to attend a virtual hearing to be held on:

Tuesday, June 28, 2022 at 11:25 AM

Regarding: Your Class B Tavern and Food Dealer License Applications as agent for "BRG Lotta Burger, LLC" for "Roundhouse" at 1750 N Lincoln Memorial DR.

This meeting will be held via GoToMeeting. Please see the enclosed best practices document for further instructions. The access code is <https://meet.goto.com/834390325>. If you wish to call in, please call [+1 \(408\) 650-3123](tel:+14086503123) and use Access Code: 834-390-325.

There is a possibility that your application may be denied for one or more of the following reasons: The recommendation of the committee regarding the application shall be based on evidence presented at the hearing. Per MCO 85-2.7-4, probative evidence concerning whether or not a new license should be granted may be presented on the following subjects: whether or not the applicant meets the municipal requirements, the appropriateness of the location and premises where the licensed premises is to be located and whether use of the premises for the purposes or activities permitted by the license would tend to facilitate a public or private nuisance or create undesirable neighborhood problems such as disorderly patrons, unreasonably loud noise, litter, and excessive traffic and parking congestion. Probative evidence relating to these matters may be taken from the plan of operation submitted with the license application, if any, but shall not include the content of any music. Evidence regarding the fitness of the location of the premises to be maintained as the principal place of business, including but not limited to whether there is an overconcentration of businesses of the type for which the license is sought; whether the proposal is consistent with any pertinent neighborhood business or development plans, or the location's proximity to areas where children are typically present. The applicant's record in operating similarly licensed premises; and whether or not the applicant has been charged with or convicted of any felony, misdemeanor, municipal offense or other offense, the circumstances of which substantially relate to the activity to be permitted by the license being applied for or any other factor which reasonably relates to the public health, safety or welfare may also be considered. See attached police report or correspondence.

Notice for applicants with warrants or unpaid fines:

Proof of warrant satisfaction or payment of fines must be submitted at the hearing on the above date and time. Failure to comply with this requirement may result in a delay of the granting/denial of your application.

Failure to attend this meeting may result in the denial of your license. Individual applicants and partnership applicants must attend or attend by an attorney. The agent or attorney for corporate or limited liability applicants must attend. If you wish to do so and at your own expense, you may be accompanied by an attorney of your choosing to represent you at this hearing.

You will be given an opportunity to speak on behalf of the application and to respond and challenge any charges or reasons given for the denial. No petitions can be accepted by the committee, unless the people who signed the petition attend the virtual hearing and are willing to testify. You may present witnesses under oath and you may also confront and cross-examine opposing witnesses under oath. If you have difficulty with the English language, you should request an interpreter attend the meeting with you, at your expense, so that you can answer questions and participate in your hearing.

PLEASE NOTE: Upon reasonable notice, efforts will be made to accommodate the needs of disabled individuals through sign language interpreters or other auxiliary aids. For additional information or to request this service, contact the Council Services Division ADA Coordinator at (414) 286-2998, Fax - (414) 286-3456, TDD - (414) 286-2025.

JIM OWCZARSKI, CITY CLERK

BY: _____

Jim Cooney
License Division Manager

If you have questions regarding this meeting, please contact the staff assistant, Yadira Melendez at (414) 286-2775 or stas5@milwaukee.gov

Date: 5/18/2022
Officer: Plumley

City of Milwaukee Police Department
90-5-1.5 Crime Prevention Survey
Tavern Inspection

Name of Premise: Roundhouse
Address: 1750 N. Lincoln Memorial Drive
Phone: 414-935-5000

Owner: Christian DAMIANO
Owner address: W226 N7459 Woodland Creek Dr
City State Zip: Sussex WI 53089
Owner Phone: 414-405-3640
Owner email: cdamiano@wi.rr.com

Licensee/Agent: Christian DAMIANO
Home Address: W226 N7459 Woodland Creek Dr
City State Zip: Sussex WI 53089
Phone: 414-405-3640
Email: cdamiano@wi.rr.com

Preferred contact: Phone

Location currently open: YES NO

Projected open date: 6/1/2022

Day's open: S M T W Th F SA ALL

Hours of Operation: Sun: 11A-9P 24 hours Y N
Mon: 11A-9P
Tue: 11A-9P
Wed: 11A-9P
Thu: 11A-9P
Fri: 11A-9P
Sat: 11A-9P

Premise Type: Tavern/Bar
Restaurant
Other:

Licenses currently held:

Alcohol: Yes No Class: BTAVN #: 209617
 Tobacco: Yes No #:
 Food: Yes No #: 16555
 Extended Hours: Yes No #:
 Secondhand Dealer: Yes No Type: #:
 Other: Yes No Type: BART #: 223769
 Other: Yes No Type: PEP #: 7726

Exterior Survey:

1. Is the area around the location clean? Yes No
2. What surrounds the location? (Check all the apply)
 - a. Park
 - b. School
 - c. Youth Center
 - d. Church
 - e. Tavern(s) If so, how many
 - f. Residential
 - g. Other businesses
 - h. Other: McKinley Marina
3. Can you see from the outside of the location into the interior Yes No
4. Can you see the employees inside of the location from the outside Yes No
5. Are exterior windows free of signage Yes No
6. Is there a parking lot Yes No
7. Is the parking lot clean? Yes No
8. Off-Street parking Yes No
9. Is the parking lot well lit? Yes No
10. Valet Parking Yes No
 - a. Will this lot have a guard? Yes No
 - b. Will this lot have cameras? Yes No
11. Are there areas where a person could conceal themselves Yes No
12. Is there exterior lighting? Yes No. Does it appears to be adequate Yes No
13. Exterior Payphone? Yes No
14. Are there No Loitering Signs posted? Yes No
15. Are there exterior security cameras Yes No How Many:
16. Are the address numbers prominently displayed and easy to see Yes No

Camera Survey:

17. Does this location have security cameras? Yes No
18. Are they in working order? Yes No
19. What format are the cameras?
 - a. Color Yes No
 - b. Digital Yes No
 - c. Recorded Yes No
20. How long is footage stored for later viewing:
21. Are there exterior cameras Yes No How many:
22. Are there interior cameras Yes No How many:
23. Do all employees know how to retrieve recorded digital images/footage? Yes No

24. Cameras located in parking lot Yes No How many

Interior Survey:

25. What is the planned capacity 49
26. What is the minimum number of employees That will be on premise 2
27. Is the storeowner willing to be a standing complainant regarding loitering? Yes No
a. If yes have them fill out the standing complaint form and give them two of the commercial signs Yes No
28. Is the interior of the location neat and clean? Yes No
29. Does an interior camera face the entrance/exit? Yes No
30. Is there a lockable area that separates employees from customers? Yes No
31. Are emergency and non-emergency numbers posted near the phone? Yes No
32. Does the owner know how to contact their police district directly? Yes No
a. Did you provide a district contact guide to the owner? Yes No

Security

33. How many security personnel are going to be employed: 0
34. How ill they be deployed: Interior Exterior
35. What days will they be deployed MonTueWedThuFriSatSun
36. Will the security be managed by business or contracted
37. Will they be armed Yes No
38. What type of security measures to be used:
Wanding/metal detector
ID Scanner
Dress Code
Cover Charge
Age restriction
Other

ADDITIONAL COMMENTS/RECOMMENDATIONS:

This building is located in the parking lot of the McKinley Marina. Roundhouse will share the building with Milwaukee County Parks. Milwaukee County Parks own the security cameras on the building and have access to them. Roundhouse is planning on having their own cameras installed for the interior of the building.

#	Legal Entity	Trade Name	Licensee	Address	License Type Name	Total Capacity	Expiration Date	Count
1	Mari Corp	Merge	Karandeep S Randhawa, Agt	1932 E KENILWORTH PL	Class B Tavern License	99	11/13/2021, 6:00 PM	1
2	Charles Allis and Villa Terrace Museums, Inc.	Villa Terrace Decorative Arts Museum	John C Sterr, Agt	2220 N TERRACE AV	Class B Tavern License	85	11/29/2021, 6:00 PM	1
3	Stone Bowl Grill, LLC	Stone Bowl	Young B Kim, Agt	1958-62 N Farwell AV	Class B Tavern License	99	12/15/2021, 6:00 PM	1
4	El Grupo J & K, LLC	Judy's on North / El Grupo J & K	Kevin I Lopez, Agt	2207 E North AV	Class B Tavern License		2/3/2022, 6:00 PM	1
5	Saint John's Communities, Inc	Saint John's on the Lake	Renee E Anderson, Agt	1840 N PROSPECT AV	Class B Tavern License		2/3/2022, 6:00 PM	1
6	APOLLO CAFE	APOLLO CAFE	PETER A LIMBERATOS, VIVIAN ANTON-LIMBERATOS	1310 E BRADY ST	Class B Tavern License	100	12/19/2021, 6:00 PM	1
7	Lin & Chen Fushimi, LLC	Fushimi Sushi Seafood Buffet	Gui Lin, Agt	2116 N Farwell AV	Class B Tavern License		1/19/2022, 6:00 PM	1
8	ETHIOPIAN COTTAGE RESTAURANT, INC	ETHIOPIAN COTTAGE RESTAURANT	YITLETU DEBEBE, Agt	1824 N FARWELL AV	Class B Fermented Malt Beverage Retailer's License	75	1/14/2022, 6:00 PM	1
9	ETHIOPIAN COTTAGE RESTAURANT, INC	ETHIOPIAN COTTAGE RESTAURANT	YIGLETU DEBEBE, Agt	1824 N FARWELL AV	Class C Wine Retailer's License		1/14/2022, 6:00 PM	1
10	ZAFFIRO BROS, INC	ZAFFIRO'S PIZZA	MICHAEL J ZAFFIRO, Agt	1724 N FARWELL AV	Class B Tavern License	25	1/25/2022, 6:00 PM	1
11	Krikar LLC	Koppa's Fulbelli Deli	Karthik B Pothumachi, Agt	1940 N FARWELL AV	Class A Malt & Class A Liquor License		2/26/2022, 6:00 PM	1
12	Ian's Pizza Milwaukee, LLC	Ian's Pizza Milwaukee	Ryan W Donovan, Agt	2035 E NORTH AV	Class B Fermented Malt Beverage Retailer's License		3/1/2022, 6:00 PM	1
13	Ian's Pizza Milwaukee, LLC	Ian's Pizza Milwaukee	Ryan W Donovan, Agt	2035 E NORTH AV	Class C Wine Retailer's License		3/1/2022, 6:00 PM	1
14	Erth Wellness, LLC	Kind Oasis	Salem J Kashou, Agt	2169 N FARWELL AV	Class B Tavern License		2/7/2022, 6:00 PM	1
15	MILAP, INC	SMITH BEER & LIQUOR MART	AMARJIT S KALSEY, Agt	1413 E BRADY ST	Class A Malt & Class A Liquor License		3/21/2022, 7:00 PM	1
16	Colectivo Coffee Roasters Inc	Colectivo Coffee Roasters Inc	William D Suskey, Agt	1701 N LINCOLN MEMORIAL DR	Class B Fermented Malt Beverage Retailer's License		3/29/2022, 7:00 PM	1

17	SPTresto, LLC	Rice N Roll Bistro	Bundid Muangsiri, Agt	1952 N Farwell AV	Class B Fermented Malt Beverage Retailer's License		3/29/2022, 7:00 PM	1
18	PIZZA SHUTTLE, INC	PIZZA SHUTTLE	MARK H GOLD, Agt	1827 N Farwell AV	Class B Tavern License	150	3/6/2022, 6:00 PM	1
19	SPTresto, LLC	Rice N Roll Bistro	Bundid Muangsiri, Agt	1952 N Farwell AV	Class C Wine Retailer's License		3/29/2022, 7:00 PM	1
20	NOMADIC VENTURES, INC	NOMAD WORLD PUB	MICHAEL J EITEL, Agt	1401 E BRADY-1668 N WARREN ST	Class B Tavern License	99	3/8/2022, 6:00 PM	1
21	Saz's Catering Inc	Jan Serr Studio	Stephanie L Sazama-Schneck, Agt	2155 N Prospect AV	Class B Tavern License		4/4/2022, 7:00 PM	1
22	GPJ OF MILWAUKEE, INC	MA FISCHER'S	HEIDI A PANAGIOTOP OULOS, Agt	2214 N FARWELL AV	Class B Tavern License	240	4/11/2022, 7:00 PM	1
23	PROSPECTOR PARTNERSHIP LLC	VINTAGE	REBECCA E GODFREY, Agt	2203 N PROSPECT AV	Class B Tavern License	151	4/10/2022, 7:00 PM	1
24	LANDMARK BARS, INC	LANDMARK LANES	SLAVA TUZHILKOV, Agt	2220 N FARWELL AV	Class B Tavern License	240	4/11/2022, 7:00 PM	1
25	Crossroads Collective, LLC	Crossroads Collective	TIM B GOKHMAN, Agt	2238 N Farwell AV	Class B Tavern License		12/10/2021, 6:00 PM	1
26	JC CAPITAL SAINT BIBIANA LLC	St. Bibiana/St. Bibi	JENO J CATALDO, Agt	1327 E BRADY ST	Class B Tavern License		4/28/2022, 7:00 PM	1
27	Bharat Enterprise, Inc	Bharat Mart	RAVI SACHDEVA, Agt	1556 N Farwell AV	Class A Malt & Class A Liquor License		5/2/2022, 7:00 PM	1
28	Nine Below Inc	Nine Below	Marla R Poytinger, Agt	1905 E North AV	Class B Tavern License	270	5/30/2022, 7:00 PM	1
29	Splash Studio Inc.	Splash Studio Inc.	Marla R Poytinger, Agt	1815 E Kenilworth PL	Class B Tavern License		5/30/2022, 7:00 PM	1
30	Axe MKE, Inc	Axe MKE	Marla R Poytinger, Agt	1924 E KENILWORTH PL	Class B Tavern License		5/30/2022, 7:00 PM	1
31	Jack's American Pub, LLC	Jack's American Pub	SCOTT A SCHAEFER, Agt	1323 E Brady ST	Class B Tavern License	240	6/30/2022, 7:00 PM	1
32	HOOLIGAN'S SUPER IRISH DELI & BAR, INC	HOOLIGAN'S	MARK B BUESING, Agt	2017 E NORTH AV	Class B Tavern License	118	6/29/2022, 7:00 PM	1
33	Black Gate LLC	Von Trier	MARK A ZIERATH, Agt	2235 N Farwell AV	Class B Tavern License	153	6/13/2022, 7:00 PM	1
34	BENJAMIN'S FINE WINE & SPIRITS LLC	Waterford Wine Company	BENJAMIN T CHRISTIANS EN, Agt	2120 N FARWELL AV	Class B Tavern License		6/18/2022, 7:00 PM	1

35	Sip & Purr LLC	Sip & Purr Cat Cafe	Katherine E McHugh, Agt	2021 E Ivanhoe PL	Class B Tavern License		6/14/2022, 7:00 PM	1
36	IFM Farwell LLC	Oriental Theatre	Kristen C Heller, Agt	2230 N FARWELL AV	Class B Tavern License	1,834	7/23/2022, 7:00 PM	1
37	Good City Brewing LLC	Good City Brewing	David C Dupee, Agt	2108 N Farwell AV	Class C Wine Retailer's License		7/28/2022, 7:00 PM	1
38	BEANS & BARLEY, INC	BEANS & BARLEY	JAMES C NEUMEYER, Agt	1901 E NORTH AV	Class B Tavern License	180	6/29/2022, 7:00 PM	1
39	M P ON BRADY, INC	CLUB BRADY	MICHAEL D LEE, Agt	1339 E BRADY ST	Class B Tavern License	143	6/29/2022, 7:00 PM	1
40	MILWAUKEE YACHT CLUB	MILWAUKEE YACHT CLUB	Matthew F Michael, Agt	1700 N LINCOLN MEMORIAL DR	Class B Tavern License	180	7/5/2022, 7:00 PM	1
41	TKCS Brady LLC	The King Crab Shack	Tam Ngo, Agt	1330 E Brady ST	Class B Tavern License		7/5/2022, 7:00 PM	1
42	Dock Bradford, LLC	The Dock at Bradford Beach	BRIAN C RANDALL, Agt	2400 N Lincoln Memorial DR	Class B Tavern License		7/26/2022, 7:00 PM	1
43	J & S Malone, LLC	Malone's on Brady	JOSHUA L MALONE, Agt	1329 E BRADY ST	Class B Tavern License	80	7/21/2022, 7:00 PM	1
44	MOOSA BURGER, INC.	Moosa's	ALAA I MUSA, Agt	2272 N LINCOLN MEMORIAL DR	Class B Tavern License		7/28/2022, 7:00 PM	1
45	Hangout MKE Cafe & Lounge Co	Hangout MKE	Rebecca M Riddle, Agt	1819 N Farwell AV	Class B Tavern License	150	8/7/2022, 7:00 PM	1
46	La Masa LLC	La Masa	BRADLEY H TODD, Agt	1300 E Brady ST	Class B Tavern License	99	8/30/2022, 7:00 PM	1
47	SATGUR CORPORATION, INC	MAHARAJA RESTAURANT	BALBIR SINGH, Agt	1550 N FARWELL AV	Class B Tavern License	300	9/21/2022, 7:00 PM	1
48	BALZAC, INC	BALZAC WINE BAR	SCOTT M JOHNSON, Agt	1716 N ARLINGTON PL	Class B Tavern License	100	8/30/2022, 7:00 PM	1
49	Ardent Milwaukee, LLC	Ardent	Justin K Carlisle, Agt	1749-51 N Farwell AV	Class B Tavern License		10/13/2022, 7:00 PM	1
50	Colectivo Coffee Roasters Inc	Colectivo Coffee Roasters Inc	William D Suskey, Agt	2211 N Prospect AV	Class B Tavern License	299	10/17/2022, 7:00 PM	1
51	Charles Allis and Villa Terrace Museums, Inc.	Charles Allis Art Museum	Neil V Albrecht, Agt	1801 N PROSPECT AV	Class B Tavern License	99	11/29/2021, 6:00 PM	1
52	Charles Allis and Villa Terrace Museums, Inc.	Charles Allis Art Museum	Neil V Albrecht, Agt	1801 N PROSPECT AV	Class B Tavern License	99	11/29/2022, 6:00 PM	1
53	The National, LLC	The LaFayette Place	Amy R Plennes, Agt	1978 N Farwell AV	Class B Tavern License		11/3/2022, 7:00 PM	1

1750 N Lincoln Memorial DR

Summary

Name	Count	Area(ft ²)	Length(mi)
Alcohol Licenses	53		

Alcohol Licenses



Wednesday, June 15, 2022



Notice of Public Hearing

Blank Notice

DAMIANO, Christian M
Roundhouse at 1750 N Lincoln Memorial DR.
Class B Tavern and Food Dealer License Applications

Tuesday, June 28, 2022 at 11:25 AM

To whom it may concern:

The above application has been made by the above named applicant(s). This requires approval from the Licenses Committee and the Common Council of the City of Milwaukee. The hearing before the Licenses Committee will take place virtually on 06/28/2022 at 11:25 AM. This is a public hearing. Those wishing to view the proceeding are able to do so via the City Channel – Channel 25 on Spectrum Cable – or on the Internet at <http://city.milwaukee.gov/citychannel>. Those wishing to provide oral testimony will be asked to do so by phone or internet and are asked to contact the staff assistant, Yadira Melendez at (414) 286-2775 or stasst5@milwaukee.gov for necessary information. Please make such requests no later than one business day prior to the start of the meeting. You are not required to attend the hearing, but please see the information below if you would like to provide testimony. Once the Licenses Committee makes its recommendation, this recommendation is forwarded to the full Common Council for approval at its next regularly scheduled hearing.

Important details for those wishing to provide information for the Licenses Committee to consider when making its recommendation:

1. The license application is scheduled to be heard at the above time. Due to other hearings running longer than scheduled, you may have to wait some time to provide your testimony.
2. You must testify as to matters that you have personally experienced or seen. (You cannot provide testimony for your neighbor, parent or anyone else; this is considered hearsay and cannot be considered by the committee.)
3. No letters or petitions can be accepted by the committee (unless the person who wrote the letter or the persons who signed the petition are willing to testify).
4. Persons opposed to the license application are given the opportunity to testify first; supporters may testify after the opponents have finished.
5. When you are called to testify, you will be sworn in and asked to give your name, and address. (If your first and/or last names are uncommon please spell them.)
6. You may then provide testimony.
 - a. Include only information relating to the above license application.
 - b. Include only information you have personally witnessed or seen.
 - c. Provide concise and relevant information detailing how this business has affected or may affect the peaceful enjoyment of your neighborhood.
 - d. If by the time you have the opportunity to testify, the information you wish to share has already been provided to the committee, you may state that you agree with the previous testimony. Redundant or repetitive testimony will not assist the committee in making its recommendation.
7. After giving your testimony, the members of the Licenses Committee and the licensee may ask questions regarding the testimony you have given or other factors relating to the license application.
8. Business Competition is not a valid basis for denial or non-renewal of a license.

Please Note: If you have submitted an objection to the above application your objection cannot be considered by the committee unless you personally testify at the hearing.

CURRENT OCCUPANT	1983 N SUMMIT AVE, 24	MILWAUKEE, WI 53202-1365
CURRENT OCCUPANT	1983 N SUMMIT AVE, 30	MILWAUKEE, WI 53202-1365
CURRENT OCCUPANT	1983 N SUMMIT AVE, 31	MILWAUKEE, WI 53202-1365
CURRENT OCCUPANT	1983 N SUMMIT AVE, 33	MILWAUKEE, WI 53202-1365
CURRENT OCCUPANT	1983 N SUMMIT AVE, 34	MILWAUKEE, WI 53202-1365
CURRENT OCCUPANT	1983 N SUMMIT AVE, 40	MILWAUKEE, WI 53202-1365
CURRENT OCCUPANT	1983 N SUMMIT AVE, 41	MILWAUKEE, WI 53202-1365
CURRENT OCCUPANT	1983 N SUMMIT AVE, 43	MILWAUKEE, WI 53202-1365
CURRENT OCCUPANT	1983 N SUMMIT AVE, 44	MILWAUKEE, WI 53202-1365
CURRENT OCCUPANT	1983 N SUMMIT AVE, B1	MILWAUKEE, WI 53202-1313
CURRENT OCCUPANT	1983 N SUMMIT AVE, B2	MILWAUKEE, WI 53202-1313
CURRENT OCCUPANT	2000 N PROSPECT AVE	MILWAUKEE, WI 53202-1109
CURRENT OCCUPANT	2004 N PROSPECT AVE	MILWAUKEE, WI 53202-1109
CURRENT OCCUPANT	2006 E LAFAYETTE PL	MILWAUKEE, WI 53202-1370
CURRENT OCCUPANT	2007 E WINDSOR PL, N	MILWAUKEE, WI 53202-1340
CURRENT OCCUPANT	2007 E WINDSOR PL, S	MILWAUKEE, WI 53202-1340
CURRENT OCCUPANT	2008 N PROSPECT AVE	MILWAUKEE, WI 53202-1109
CURRENT OCCUPANT	2010 N LAKE DR	MILWAUKEE, WI 53202-1333
CURRENT OCCUPANT	2012 N PROSPECT AVE	MILWAUKEE, WI 53202-1109
CURRENT OCCUPANT	2014 E LAFAYETTE PL	MILWAUKEE, WI 53202-1370
CURRENT OCCUPANT	2014 E WINDSOR PL	MILWAUKEE, WI 53202-1341
CURRENT OCCUPANT	2014 E WINDSOR PL, A	MILWAUKEE, WI 53202-1341
CURRENT OCCUPANT	2015 N LAKE DR	MILWAUKEE, WI 53202-1372
CURRENT OCCUPANT	2016 E WINDSOR PL	MILWAUKEE, WI 53202-1341
CURRENT OCCUPANT	2016 N PROSPECT AVE	MILWAUKEE, WI 53202-1109
CURRENT OCCUPANT	2020 N PROSPECT AVE	MILWAUKEE, WI 53202-1109
CURRENT OCCUPANT	2022 E LAFAYETTE PL	MILWAUKEE, WI 53202-1370
CURRENT OCCUPANT	2024 E LAFAYETTE PL	MILWAUKEE, WI 53202-1370
CURRENT OCCUPANT	2024 N PROSPECT AVE	MILWAUKEE, WI 53202-1109
CURRENT OCCUPANT	2025 N LAKE DR	MILWAUKEE, WI 53202-1372
CURRENT OCCUPANT	2025A N LAKE DR	MILWAUKEE, WI 53202-1372
CURRENT OCCUPANT	2028 E LAFAYETTE PL	MILWAUKEE, WI 53202-1370
CURRENT OCCUPANT	2030 E LAFAYETTE PL	MILWAUKEE, WI 53202-1370
CURRENT OCCUPANT	2030 N LAKE DR	MILWAUKEE, WI 53202-1333
CURRENT OCCUPANT	2036 N LAKE DR	MILWAUKEE, WI 53202-1333
CURRENT OCCUPANT	2036 N PROSPECT AVE, 1001	MILWAUKEE, WI 53202-1266
CURRENT OCCUPANT	2036 N PROSPECT AVE, 1002	MILWAUKEE, WI 53202-1267
CURRENT OCCUPANT	2036 N PROSPECT AVE, 1003	MILWAUKEE, WI 53202-1268
CURRENT OCCUPANT	2036 N PROSPECT AVE, 1004	MILWAUKEE, WI 53202-1263
CURRENT OCCUPANT	2036 N PROSPECT AVE, 1005	MILWAUKEE, WI 53202-1263
CURRENT OCCUPANT	2036 N PROSPECT AVE, 1006	MILWAUKEE, WI 53202-1263
CURRENT OCCUPANT	2036 N PROSPECT AVE, 1007	MILWAUKEE, WI 53202-1263
CURRENT OCCUPANT	2036 N PROSPECT AVE, 1008	MILWAUKEE, WI 53202-1263
CURRENT OCCUPANT	2036 N PROSPECT AVE, 1101	MILWAUKEE, WI 53202-1263
CURRENT OCCUPANT	2036 N PROSPECT AVE, 1102	MILWAUKEE, WI 53202-1263
CURRENT OCCUPANT	2036 N PROSPECT AVE, 1103	MILWAUKEE, WI 53202-1263
CURRENT OCCUPANT	2036 N PROSPECT AVE, 1104	MILWAUKEE, WI 53202-1263

CURRENT OCCUPANT	2036 N PROSPECT AVE, 604	MILWAUKEE, WI 53202-1261
CURRENT OCCUPANT	2036 N PROSPECT AVE, 605	MILWAUKEE, WI 53202-1262
CURRENT OCCUPANT	2036 N PROSPECT AVE, 606	MILWAUKEE, WI 53202-1262
CURRENT OCCUPANT	2036 N PROSPECT AVE, 607	MILWAUKEE, WI 53202-1262
CURRENT OCCUPANT	2036 N PROSPECT AVE, 608	MILWAUKEE, WI 53202-1262
CURRENT OCCUPANT	2036 N PROSPECT AVE, 701	MILWAUKEE, WI 53202-1262
CURRENT OCCUPANT	2036 N PROSPECT AVE, 702	MILWAUKEE, WI 53202-1262
CURRENT OCCUPANT	2036 N PROSPECT AVE, 703	MILWAUKEE, WI 53202-1262
CURRENT OCCUPANT	2036 N PROSPECT AVE, 704	MILWAUKEE, WI 53202-1262
CURRENT OCCUPANT	2036 N PROSPECT AVE, 705	MILWAUKEE, WI 53202-1262
CURRENT OCCUPANT	2036 N PROSPECT AVE, 706	MILWAUKEE, WI 53202-1262
CURRENT OCCUPANT	2036 N PROSPECT AVE, 707	MILWAUKEE, WI 53202-1262
CURRENT OCCUPANT	2036 N PROSPECT AVE, 708	MILWAUKEE, WI 53202-1262
CURRENT OCCUPANT	2036 N PROSPECT AVE, 801	MILWAUKEE, WI 53202-1262
CURRENT OCCUPANT	2036 N PROSPECT AVE, 802	MILWAUKEE, WI 53202-1262
CURRENT OCCUPANT	2036 N PROSPECT AVE, 803	MILWAUKEE, WI 53202-1262
CURRENT OCCUPANT	2036 N PROSPECT AVE, 804	MILWAUKEE, WI 53202-1262
CURRENT OCCUPANT	2036 N PROSPECT AVE, 805	MILWAUKEE, WI 53202-1262
CURRENT OCCUPANT	2036 N PROSPECT AVE, 806	MILWAUKEE, WI 53202-1262
CURRENT OCCUPANT	2036 N PROSPECT AVE, 807	MILWAUKEE, WI 53202-1262
CURRENT OCCUPANT	2036 N PROSPECT AVE, 808	MILWAUKEE, WI 53202-1262
CURRENT OCCUPANT	2036 N PROSPECT AVE, 901	MILWAUKEE, WI 53202-1262
CURRENT OCCUPANT	2036 N PROSPECT AVE, 902	MILWAUKEE, WI 53202-1262
CURRENT OCCUPANT	2036 N PROSPECT AVE, 903	MILWAUKEE, WI 53202-1262
CURRENT OCCUPANT	2036 N PROSPECT AVE, 904	MILWAUKEE, WI 53202-1262
CURRENT OCCUPANT	2036 N PROSPECT AVE, 905	MILWAUKEE, WI 53202-1262
CURRENT OCCUPANT	2036 N PROSPECT AVE, 906	MILWAUKEE, WI 53202-1262
CURRENT OCCUPANT	2036 N PROSPECT AVE, 907	MILWAUKEE, WI 53202-1262
CURRENT OCCUPANT	2036 N PROSPECT AVE, 908	MILWAUKEE, WI 53202-1263
CURRENT OCCUPANT	2040 E LAFAYETTE PL	MILWAUKEE, WI 53202-1370
CURRENT OCCUPANT	2042 E LAFAYETTE PL	MILWAUKEE, WI 53202-1370
CURRENT OCCUPANT	2104 E LAFAYETTE PL	MILWAUKEE, WI 53202-1331
CURRENT OCCUPANT	2105 E LAFAYETTE PL	MILWAUKEE, WI 53202-1330
CURRENT OCCUPANT	2118 E LAFAYETTE PL	MILWAUKEE, WI 53202-1331
CURRENT OCCUPANT	2121 E LAFAYETTE PL	MILWAUKEE, WI 53202-1330
CURRENT OCCUPANT	2128 E LAFAYETTE PL	MILWAUKEE, WI 53202-1331

Blank Notice

Total Records: 741

Radius 250.0 feet and Center of Circle: 1750 N Lincoln Memorial Dr



BUSINESS LICENSE PLAN OF OPERATION

ccl-busplan 5/12/2020

Office of the City Clerk License Division
200 E. Wells St. Room 105, Milwaukee, WI 53202
(414) 286-2238 www.milwaukee.gov/license e-mail address: license@milwaukee.gov

1. Type of Business

Applying for: Extended Hours (12AM to 5AM) - If a food establishment, check all that apply: Delivery Drive Thru Dining Room
 Self Service Laundry Massage Establishment Filling Station
 Other (supplemental application for specific license also required)

Provide a detailed description of the type of business you plan on operating:

... serving beer, wine, cocktails with pickup counter service

Do you have any experience operating this type of business? No Yes If yes, explain: 25+ years of Milwaukee area Bartolotta Rest.

2. Business Operations

- a. Proposed Opening Date: 05/19/2022
- b. Is this premise under construction? No Yes If yes, list estimated completion date: _____
- c. Is this a franchise? No Yes
- d. Is this premises currently licensed? No Yes If yes, list type of license: _____
- e. Is the current licensee operating? No Yes If no, list date closed: Fall 2018
- f. Do you have future plans for other businesses, licenses or permits at this location? No Yes
If yes, explain: future plans include live entertainment
- g. Have you previously held an Extended Hours License in Milwaukee? No Yes
If yes, list address(es): _____
- h. Are other businesses operating in the same building? No Yes If yes, describe: _____

3. Litter & Noise

- a. How are grounds kept clean? Sweep Pressure Wash Pick Up Litter Other: _____
- b. How often will grounds be cleaned? Daily Weekly As Needed Monthly Other: _____
- c. Grounds cleaned by: Licensee Building Owner Employees Hired Maintenance Other: _____
- d. How are noise issues prevented and/or addressed? Security Manager approaches customer(s) Call Police
 Signs Posted Other: _____
- e. Will a sound amplification system be used? No Yes If yes, describe: streamed music through speakers

4. Smoking & Sanitation

- a. Are there designated outdoor smoking areas? No Yes If yes, describe: as governed by MKE county rules & regulations
- b. Number of Garbage Cans: Inside: 3 Locations: service counter and exits
Outside: 6 Locations: perimeter of building & outdoor service areas
Smoking allowed only outside
- c. Is a crowd control barrier used? No Yes If yes, describe: _____
- d. How many restrooms are on the premises? 2 total - (1 men, 1 women) public restrooms only
- e. Name of solid waste contractor: Advanced Disposal Waste Management Other: Eagle

5. Security

- a. Are there onsite parking spaces? No Yes If yes, how many? 80 (est) and describe the parking security plan: parking is the responsibility of the county
- b. Is there a loading zone? No Yes If yes, describe the loading area security plan: _____
- c. Will you have security personnel on premise? No Yes If yes, how many? _____ and answer the following:
 What are their responsibilities? _____
 Is security equipment used? No Yes If yes, describe _____
 List their licensing, certification, or training credentials _____
- d. Will there be security cameras? No Yes If yes, how many? 5 and list locations: *planned : 3 outside covering beverage service area, 2 inside
- e. Will searches/identification checks be done upon entry? No Yes If yes, describe _____

6. Percentage of Sales (must total 100%)

Alcohol <u>60</u> %	Food <u>30</u> %	Secondhand Merchandise _____ %	Precious Metals & Gems _____ %
Entertainment _____ %	Cigarettes _____ %	Personal Services (such as tattoo, body piercing, salon, tailor, tanning, etc.) _____ %	Other <u>10</u> % <i>- life jackets - other boating supplies items</i>
Pawnbroker Activity _____ %	Salvaged Materials _____ % (such as scrap metal)		Describe: <u>retail items</u>

7. Businesses/Licenses on the Premises (check all that apply):

Type 1

- Full Service Restaurant Cafe/Coffee Shop Deli or Fast Food Restaurant Private/Fraternal/Veterans Club
- Night Club Tavern Cocktail Lounge Teen Club
- Banquet Hall Sports Facility Bowling Alley
- Hotel/Motel : Number of Floors: _____ Rooming House: Number of Floors: _____
 Number of Rooms: _____ Number of Rooms: _____

Type 2

- Liquor Store Corner Store Supermarket Convenience Store
- Gas Station Amusement/Phonograph Distributor Recycling, Salvage or Towing
- Used Car Dealer Personal Service Establishment
(such as tattoo business, hair salon, tailor, etc.) Recording Studio

What other licenses/permits will you hold at this location? (check all that apply)

- Occupancy Permit Cigarette & Tobacco Gas Station Extended Hours Class "B" Tavern Weights & Measures
- Secondhand Dealer Precious Metal & Gem Other: _____

8. Legal Capacity (only if a Type 1 premises in #7 above)

Capacity 49 indoor (Call the Milwaukee Development Center at 414-286-8211 if you have questions.)
63 outdoor

9. Premises Description

- a. Identify all area(s) of the premises that will be used in operating this business (include areas used only for storage):
 1st Floor 2nd Floor Basement Storage Patio Beer Garden Sidewalk Café Deck Rooftop
 Other: Describe: _____
- b. Describe Location: Major Thoroughfare Secondary Street Other: Park Property
- c. Nearest Major Cross Street: Lafayette Hill Rd
- d. Describe Building: Free Standing Building Strip Mall Other: _____
- e. Describe Premises Structure: Single Story Multi-Story - # of Stories _____ Other: _____
- f. Describe Surrounding Area: Commercial Residential Industrial Other: Park
- g. Building Owner Name: Milwaukee County Parks Phone Number: 414-257-7275
 Building Owner Address: 9480 W Watertown Plank Rd. Wauwatosa, WI 53226

10. Hours of Operation & Customers

Will customers be entering the premises? No Yes

Day of the Week	Proposed Hours of Operation:		Estimated Number of Customers expected each day	Potential Age Range of Customers	Class B Tavern Applicant Only: Age Restriction (If none, write 'None')
	Open Time (include a.m. or p.m.)	Close Time (include a.m. or p.m.)			
Sunday	11 am	9 pm	<500	0-100	none
Monday	11 am	9 pm	<500	0-100	none
Tuesday	11 am	9 pm	<500	0-100	none
Wednesday	11 am	9 pm	<500	0-100	none
Thursday	11 am	9 pm	<500	0-100	none
Friday	11 am	9 pm	<500	0-100	none
Saturday	11 am	9 pm	<500	0-100	none

An Extended Hours Establishment License is required for any convenience store, filling station, personal service establishment (such as tattoo, body piercing, salon, tailor, tanning, etc.), recording studio or restaurant which is open between the hours of 12:00 a.m. and 5:00 a.m.

Alcohol Establishments Permitted Hours of Operation: Class A: 8:00 am to 9:00 pm Sunday thru Saturday
 Class B: 6:00 am to 2:00 am Sunday thru Thursday, 6:00 am to 2:30 am Friday & Saturday

Entertainment Outdoor Closing Hours: 10:00pm Sunday-Thursday; 12:00am Friday & Saturday; unless a different time, either earlier or later, is established by the Common Council in its approval of the licensee's plan of operation.

11. Signature(s)

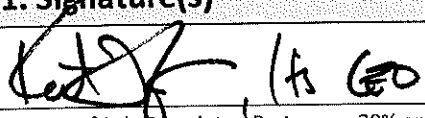
 (If there are no 20% or more shareholders, Corporate Officer-print name/title and sign)

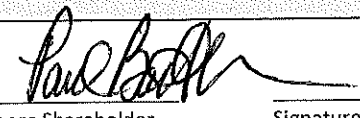
 Signature of additional partner or 20% or more shareholder

See Application Information for a complete list of all required application forms.



ALCOHOL BEVERAGE & PUBLIC ENTERTAINMENT PREMISES SUPPLEMENTAL APPLICATION

Office of the City Clerk License Division
200 E. Wells St. Room 105, Milwaukee, WI 53202
(414) 286-2238 e-mail address: license@milwaukee.gov www.milwaukee.gov/license

Legal Entity Name: BRG Lotta Burger, LLC

Premise Address: 1750 N Lincoln Memorial Drive, Milwaukee, WI 53202

Proximity of Premises to Church, School, Daycare Center or Hospital

Is the building within 300 feet of any church, school, daycare center or hospital? No Yes

"Service Bar Only" Designation

If applying for Class B or C license, are you applying for "Service Bar Only"? No Yes

Service Bar Only means customers cannot sit at the bar. Alcohol is served to employees who serve patrons seated at tables. No stools, chairs or other articles of furniture shall be placed at the service bar for patrons to sit upon.

Business Information

a) Are you taking out this application for anyone that may not be eligible for a license? No Yes

If yes, list their name and address: _____

b) Will the agent, a partner or the individual licensee be conducting the day-to-day operations of the business? No Yes

If no, list the name and address of the person(s) who will: _____

Class B Applicants: If the agent, a partner or the individual licensee will not be conducting the day-to-day operations of the business, the person(s) listed above must obtain a Class B Managers license.

c) Does anyone else have money invested or any other interest in this business? No Yes

If yes, explain: _____

d) Have you made an agreement with anyone to repay any loan or any other payments based upon income from the business?

No Yes If yes, list name and address: _____

Property Information (New & Transfer Applicants Only)

a) Do you own or lease the building? Own Lease

b) Who owns the fixtures (for example, coolers, etc.)? BRG Lotta Burger, LLC

c) Are you purchasing the stock and/or fixtures? No Yes if yes, amount paid \$ _____

d) Total amount paid for business \$ _____

e) Total amount paid for goodwill of the business \$ _____

Goodwill comprises the reputation and customer relationships of an existing business. If the price you pay for the business exceeds the fair market value of all of the rest of the assets of the business, the excess may be considered goodwill.

f) Have you made arrangements with the seller for payment of personal property taxes? No Yes

Lease Information (New & Transfer Applicants who are leasing the premises only)

a) Date lease begins June 2019 Ends June 2024

b) Monthly rental \$ percentage of sales

c) Do you have an option to renew the lease? No Yes

d) Does your lease allow for assignment to another party without the consent of the owner? No Yes

e) For what length of time have you been guaranteed occupancy (number of years)? 3

Lease Information (Continued)

- f) In addition to paying the monthly rental, will you have to pay anything additional to the owner of the building to guarantee performance of the lease? No Yes If yes, explain _____
- g) Does the present owner or occupancy object to the granting of your license? No Yes
If yes, explain _____

Change of Agent Applicants Only

Have there been any changes to the floor plan since the last application was submitted? No Yes
If no, a new floor plan is not required. If yes, submit a new floor plan and explain the change(s):

Signature

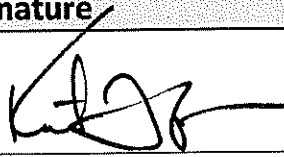

Keith Trank, Its CEO

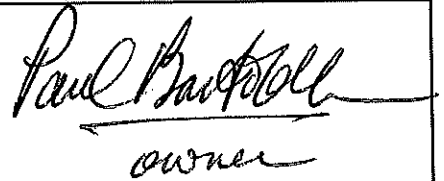
owner

Signature of Sole Proprietor, Partner or 20% or More Shareholder
(If no 20% or more Shareholder, Corporate Officer - print name/title and sign)

Note: All information contained in this application is subject to approval by the Common Council.
Deviating from approved plan of operation will subject licensee to citations, and/or suspension or non-renewal of the license.
Contact the License Division for information on how to request changes.

New and transfer of premises applicants must submit the following:

- Detailed floor plan
- If a restaurant, copy of the menu



FOOD DEALER LICENSE PLAN OF OPERATION

ccl-foodplan 2/28/19

OFFICE OF THE CITY CLERK, LICENSE DIVISION
CITY HALL, 200 E. WELLS ST, ROOM 105, MILWAUKEE, WI 53202
(414) 286-2238 • license@milwaukee.gov • www.milwaukee.gov/license

Legal Entity Name: **BRG Lotta Burger, LLC**

Premises Address: **1750 N Lincoln Memorial Drive Milwaukee, WI 53202**

SECTION 1 TYPE OF BUSINESS

What will be the majority of your food sales? (check one)

Restaurant Items (meals):

MEALS include, but are not limited to, chicken, ribs, sandwiches, roasted corn, baked potatoes, hot dogs, brats, tacos, nachos w/ cheese and meat, French fries, cooked or deep fried vegetables/fruit, cooked cheese curds, corn dogs, egg rolls, salads.

Retail Items (snacks and beverages):

RETAIL items include, but are not limited to, ice cream/soft serve, lemonade, snow cones, coffee, espresso, cappuccino, tea, fruit juice, smoothies, candy, dispensed soda, fruit cups, bakery, cookies, kettle corn, cotton candy, funnel cakes, fritters, tortilla chips w/ cheese.

Will it be a convenience store? Yes No

A convenience store contains less than 5,000 square feet of retail space and has, as its primary business, the sale of basic food items and in addition, sells household products or is a filling station that sells basic food items and household products.

Bed & Breakfast

Micro Market

All Applicants: Submit a menu or a list of food items that will be sold.

Will any wholesale business be done? No Yes If yes, what percentage of food sales will be wholesale?

Less than 25%

25% or More AND:

Restaurant items (meals) will be sold – Complete this application and also contact DATCP.

NO restaurant items (meals) will be sold - Do NOT complete this application. Contact DATCP only.

SECTION 2 FOOD PROCESSING

Will any food processing be done? No Yes

Processing is defined as assembling, grinding, cutting, mixing, baking, coating, stuffing, packing, bottling, grilling, canning, extracting, fermenting, distilling, pickling, freezing, drying, smoking, or packaging.

SECTION 3 FOOD REQUIRING TEMPERATURE CONTROL

Will any food that requires temperature control be sold? No Yes

(includes dairy products such as milk, cheese, and ice cream, fish, shellfish, meat, poultry)

If yes, list the types of food items: meat, poultry, produce, cheese, dairy, ice cream novel ties

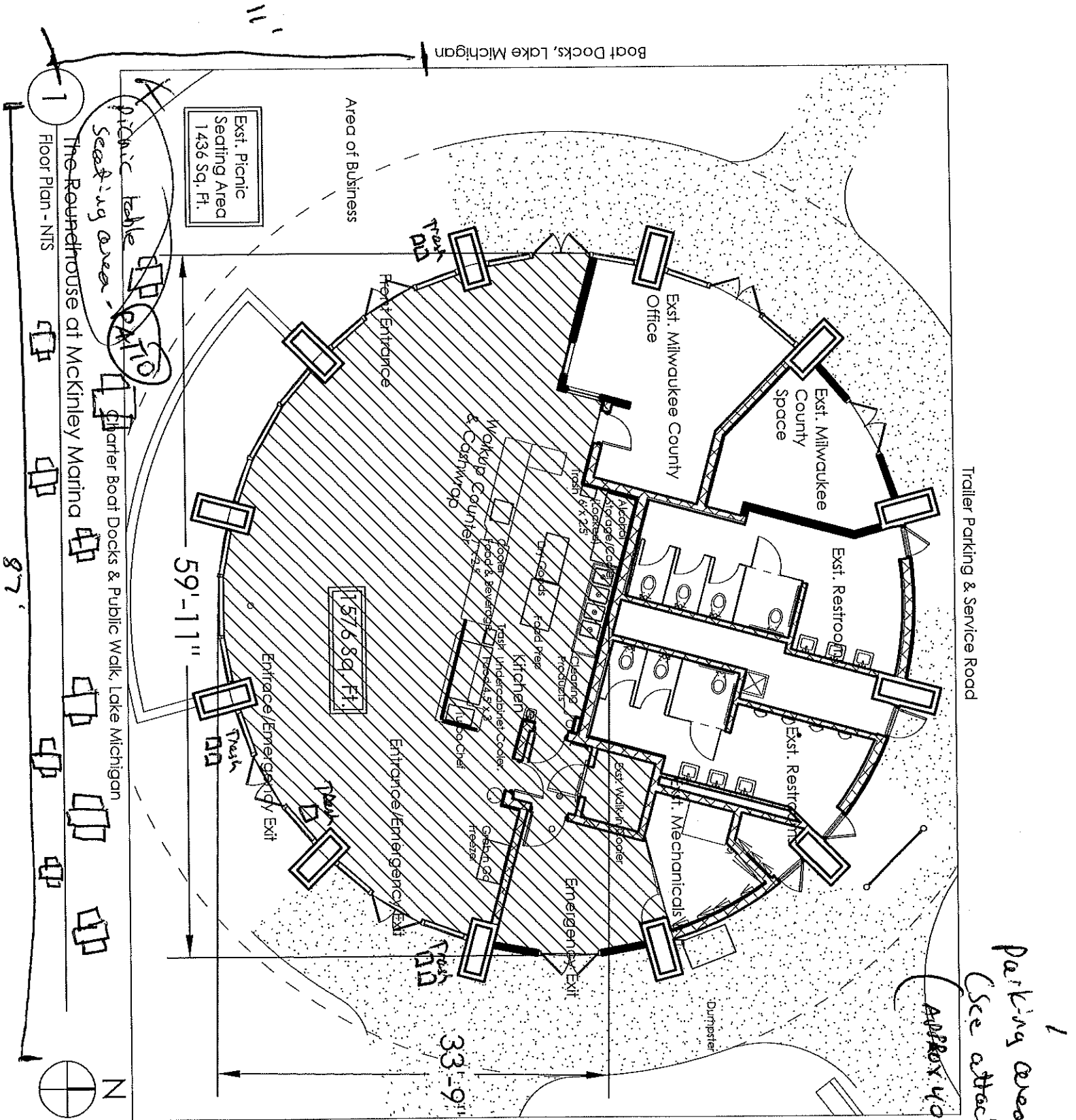

1
Floor Plan - NTS

Seating Area
Picnic table
PATIO
Charter Boat Docks & Public Walk, Lake Michigan

87'

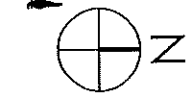

DRAWN BY:
CAK
4/20/2022

BRG Lotta Burger, LLC
1750 N Lincoln Memorial Dr., Milwaukee, WI 53202

Agent: Christian Damiano

1
Parking area
(See attached)
Approx 40 320 58 Ft

04/22/2022

Tentative Menu - Roundhouse

- Sandwiches
- warm pretzels
- prepackaged snacks
- mac n cheese (prepackaged)
- prepackaged fruits & vegetables