



CITY OF MILWAUKEE  
OFFICE OF THE CITY CLERK

Tuesday, June 14, 2022

COMMITTEE MEETING NOTICE

AD 14

HUHN, Heather R, Agent  
MARY JANE RESTAURANTS LLC  
541 E Erie St #514  
Milwaukee, WI 53202

You are requested to attend a virtual hearing to be held on:

**Tuesday, June 28, 2022 at 09:00 AM**

**Regarding:** Your Class B Tavern and Food Dealer License Applications as agent for "MARY JANE RESTAURANTS LLC" for "Cheba Hut" at 2202 S KINNICKINNIC A 

This meeting will be held via GoToMeeting. Please see the enclosed best practices document for further instructions. The access code is <https://meet.goto.com/834390325>. If you wish to call in, please call [+1 \(408\) 650-3123](tel:+14086503123) and use Access Code: 834-390-325.

There is a possibility that your application may be denied for one or more of the following reasons: The recommendation of the committee regarding the application shall be based on evidence presented at the hearing. Per MCO 85-2.7-4, probative evidence concerning whether or not a new license should be granted may be presented on the following subjects: whether or not the applicant meets the municipal requirements, the appropriateness of the location and premises where the licensed premises is to be located and whether use of the premises for the purposes or activities permitted by the license would tend to facilitate a public or private nuisance or create undesirable neighborhood problems such as disorderly patrons, unreasonably loud noise, litter, and excessive traffic and parking congestion. Probative evidence relating to these matters may be taken from the plan of operation submitted with the license application, if any, but shall not include the content of any music. Evidence regarding the fitness of the location of the premises to be maintained as the principal place of business, including but not limited to whether there is an overconcentration of businesses of the type for which the license is sought; whether the proposal is consistent with any pertinent neighborhood business or development plans, or the location's proximity to areas where children are typically present. The applicant's record in operating similarly licensed premises; and whether or not the applicant has been charged with or convicted of any felony, misdemeanor, municipal offense or other offense, the circumstances of which substantially relate to the activity to be permitted by the license being applied for or any other factor which reasonably relates to the public health, safety or welfare may also be considered. See attached police report or correspondence.

**Notice for applicants with warrants or unpaid fines:** Proof of warrant satisfaction or payment of fines must be submitted at the hearing on the above date and time. Failure to comply with this requirement may result in a delay of the granting/denial of your application.

Failure to attend this meeting may result in the denial of your license. Individual applicants and partnership applicants must attend or attend by an attorney. The agent or attorney for corporate or limited liability applicants must attend. If you wish to do so and at your own expense, you may be accompanied by an attorney of your choosing to represent you at this hearing.

You will be given an opportunity to speak on behalf of the application and to respond and challenge any charges or reasons given for the denial. No petitions can be accepted by the committee, unless the people who signed the petition attend the virtual hearing and are willing to testify. You may present witnesses under oath and you may also confront and cross-examine opposing witnesses under oath. If you have difficulty with the English language, you should request an interpreter attend the meeting with you, at your expense, so that you can answer questions and participate in your hearing.

PLEASE NOTE: Upon reasonable notice, efforts will be made to accommodate the needs of disabled individuals through sign language interpreters or other auxiliary aids. For additional information or to request this service, contact the Council Services Division ADA Coordinator at (414) 286-2998, Fax - (414) 286-3456, TDD - (414) 286-2025.

JIM OWCZARSKI, CITY CLERK

BY: \_\_\_\_\_

Jim Cooney  
License Division Manager

If you have questions regarding this meeting, please contact the staff assistant, Yadira Melendez at (414) 286-2775 or [stasst5@milwaukee.gov](mailto:stasst5@milwaukee.gov)

# MILWAUKEE POLICE DEPARTMENT LICENSING

## CRIMINAL RECORD/ORDINANCE VIOLATION/INCIDENTS SYNOPSIS

**DATE:** 07/12/2021

**LICENSE TYPE:** CLASS B AND CLASS C

**NEW:**

**RENEWAL:**

**No. 326687**

**Application Date:** 07/12/2021

**License Location:** 2202 S Kinnickinnic Av

**Business Name:** Red Brick Pizza

**Licensee/Applicant:** VERMEULEN, Jason M  
(Last Name, First Name, MI)

**Date of Birth:** 08/21/1976

**Home Address:** 3440 S Pennsylvania Av

**City:** Milwaukee

**State:** WI **Zip Code:** 53207

**Home Phone:**

This report is written by Police Officer David Novak, assigned to the License Investigation Unit, Days.

The Milwaukee Police Department's investigation regarding this application revealed the following:

1. On 12/05/2020 at 5:22pm officers were dispatched to a Trouble with Subject at 2202 S Kinnickinnic Av. The call was for an intoxicated subject refusing to leave. The employees of the restaurant were cooperative.

=====

**Previous Premise**

Date: 06/08/22  
Officer: P.O. Fabian Garcia

City of Milwaukee Police Department  
90-5-1.5 Crime Prevention Survey  
Tavern Inspection

Name of Premise: Cheba Hut  
Address: 2202 S. Kinnickinnic Avenue  
Phone:

Owner:  
Owner address:  
City State Zip:  
Owner Phone:  
Owner email:

Licensee/Agent: Heather r. Huhn  
Home Address: 541 E. Erie Street  
City State Zip: Milwaukee, WI 53202  
Phone: 414-617-9875  
Email: heather.huhn@icloud.com

Preferred contact: email/or District Manager (See comments)

Location currently open:  YES  NO

Projected open date:

Day's open: S M T W Th F SA ALL

Hours of Operation: Sun: 10am-12am  
Mon: 10am-12am  
Tue: 10am-12am  
Wed: 10am-12am  
Thu: 10am-12am  
Fri: 10am-2:30am  
Sat: 10am-2:30am

24 hours Y N

Premise Type: Tavern/Bar  
Restaurant  
Other:

Licenses currently held: Non at this location

- Alcohol:  Yes  No Class: #:  
Tobacco:  Yes  No #:  
Food:  Yes  No #:  
Extended Hours:  Yes  No #:  
Secondhand Dealer:  Yes  No Type: #:  
Other:  Yes  No Type: #:  
Other:  Yes  No Type: #:

**Exterior Survey:**

1. Is the area around the location clean?  Yes  No
2. What surrounds the location? (Check all the apply)
  - a.  Park
  - b.  School
  - c.  Youth Center
  - d.  Church
  - e.  Tavern(s) If so, how many 3
  - f.  Residential
  - g.  Other businesses
  - h.  Other:
3. Can you see from the outside of the location into the interior  Yes  No
4. Can you see the employees inside of the location from the outside  Yes  No
5. Are exterior windows free of signage  Yes  No
6. Is there a parking lot  Yes  No
7. Is the parking lot clean?  Yes  No N/A
8. Off-Street parking  Yes  No
9. Is the parking lot well lit?  Yes  No N/A
10. Valet Parking  Yes  No
  - a. Will this lot have a guard?  Yes  No N/A
  - b. Will this lot have cameras?  Yes  No N/A
11. Are there areas where a person could conceal themselves  Yes  No
12. Is there exterior lighting?  Yes  No. Does it appears to be adequate  Yes  No
13. Exterior Payphone?  Yes  No
14. Are there No Loitering Signs posted?  Yes  No Will add
15. Are there exterior security cameras  Yes  No How Many:
16. Are the address numbers prominently displayed and easy to see  Yes  No Will add

**Camera Survey:** No cameras at this time, under construction, will add (see comments).

17. Does this location have security cameras?  Yes  No
18. Are they in working order?  Yes  No
19. What format are the cameras?
  - a. Color  Yes  No
  - b. Digital  Yes  No
  - c. Recorded  Yes  No
20. How long is footage stored for later viewing: 5 days
21. Are there exterior cameras  Yes  No How many:
22. Are there interior cameras  Yes  No How many:

23. Do all employees know how to retrieve recorded digital images/footage?  Yes  No  
 24. Cameras located in parking lot  Yes  No How many N/A

**Interior Survey:**

25. What is the planned capacity under construction, to be determined  
 26. What is the minimum number of employees that will be on premise two employees  
 27. Is the storeowner willing to be a standing complainant regarding loitering?  Yes  No  
 a. If yes have them fill out the standing complaint form and give them two of the commercial signs  Yes  No  
 28. Is the interior of the location neat and clean?  Yes  No  
 29. Does an interior camera face the entrance/exit?  Yes  No will add  
 30. Is there a lockable area that separates employees from customers?  Yes  No will add  
 31. Are emergency and non-emergency numbers posted near the phone?  Yes  No will add  
 32. Does the owner know how to contact their police district directly?  Yes  No  
 a. Did you provide a district contact guide to the owner?  Yes  No

**Security** Not at this time, will add if necessary

33. How many security personnel are going to be employed:  
 34. How will they be deployed: Interior Exterior  
 35. What days will they be deployed  Mon  Tue  Wed  Thu  Fri  Sat  Sun  
 36. Will the security be managed by business  or contracted   
 37. Will they be armed  Yes  No  
 38. What type of security measures to be used:  
 Wanding/metal detector  
 ID Scanner  
 Dress Code  
 Cover Charge  
 Age restriction  
 Other

**ADDITIONAL COMMENTS/RECOMMENDATIONS:**

This report was written by Police Officer Fabian Garcia assigned to District 6-CLO/CPU.

On Wednesday, June 8, 2022, at 4:30 pm, my partner PO Michael Ward and I met with the licensee Heather R. Huhn and her District Manager Davis R. Kemppainen (2905 N. Newhall St #501, Milwaukee, WI 53211/262-844-8110/davis.kemppainen@chebahut.com). The location is still under construction and Huhn states they would like to open sometime in October if granted a license. Huhn stated that the business will be a restaurant but they will be adding a full service bar for their customers.

Huhn and Kemppainen plan on adding approximately 8 interior cameras. These cameras will face their main entrance and exit points, cash register areas, office area, and their storage/walk in cooler area. Huhn stated that the surveillance footage will be stored for 5 days and only shift leads and higher will have access to security footage.

The location has high windows across the front (west) and side (north) of the business which makes it easy to see inside and out of the location. Huhn stated that she plans on adding storage lockers for their employees as well.

Discussions were had regarding posting "No Loitering" signs and also placement of their address numbers. Huhn stated they do plan on adding "No Loitering" signs near the entry doors and will be placing the address numbers near their front entry door, which is located in the northwest corner of the property that faces both S. Kinnickinnic Avenue and E. Ward Street. Huhn and Kemppainen stated they do not plan on having security personnel at this time, but will add in the future if needed. Huhn stated that Kemppainen may be contacted as well if needed.



# Concentration Map 2202 S KINNICKINNIC AVE

## Area of Interest (AOI) Information

Area : 21,862,585.81 ft<sup>2</sup>

May 23 2022 11:42:52 Central Daylight Time

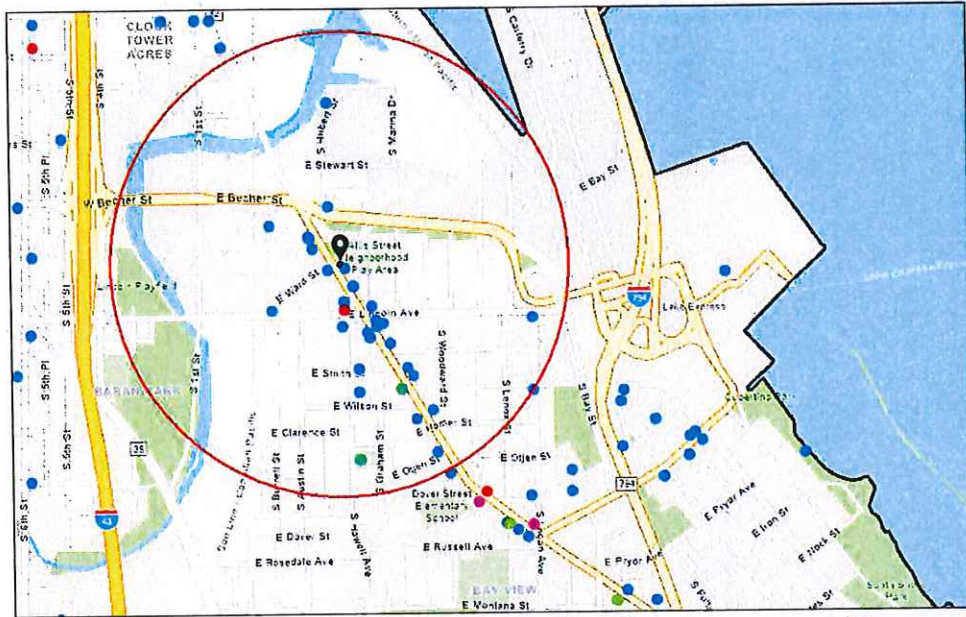

- Alcohol Licenses
- Class A Intoxicating Liquor
  - Class A Fermented Malt Beverage
  - Class A Liquor and Malt
  - Class B Fermented Malt Beverage
  - Class B Tavern
  - Class C Wine Retailer

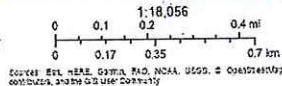

5/23/22, 11:43 AM

2202 S KINNICKINNIC AVE

### Summary

Name	Count	Area(ft <sup>2</sup> )	Length(mi)
Alcohol Licenses	33		

Alcohol Licenses



#	Legal Entity	Trade Name	Licensee	Address	License Type Name	Total Capacity	Expiration Date	Count
1	Morgan Kenwood, LTD	Avalon	JANE M SCHILZ, Agt	2473 S Kinnickinnic AV	Class B Tavern License		12/14/2021, 6:00 PM	1
2	ST AUGUSTINE CONGREGATION	ST AUGUSTINE CONGREGATION	Joseph A Laska, Agt	2530 S HOWELL AV	Class B Fermented Malt Beverage Retailer's License		12/30/2021, 6:00 PM	1
3	WHEEL & SPROCKET, INC	Wheel & Sprocket	Noel C Kegel, Agt	187 E BECHER ST	Class B Tavern License		12/20/2021, 6:00 PM	1
4	GW Mireles Inc	Cafe Corazon Bay View	GEORGE MIRELES, Agt	2394 S Kinnickinnic AV	Class B Tavern License	99	2/2/2022, 6:00 PM	1
5	Lazy Susan MKE Inc	Lazy Susan MKE	AMANDA J DIXON, Agt	2376-78 S Howell AV	Class B Tavern License	80	1/20/2022, 6:00 PM	1
6	RADBAT LLC	Odd Duck	ROSS M BACHHUBER, Agt	2352-54 S Kinnickinnic AV	Class B Tavern License	80	2/26/2022, 6:00 PM	1
7	Egg & Flour II LLC	Egg & Flour	Adam M Pawlak, Agt	2273 S HOWELL AV	Class B Tavern License		3/2/2022, 6:00 PM	1
8	NEVADA PRODUCTIONS LLC	THE TONIC TAVERN	PAUL U JONAS, Agt	2335 S KINNICKINNIC AV	Class B Tavern License	99	2/25/2022, 6:00 PM	1
9	Caviche, Inc.	C-Viche	KARLOS J SORIANO, Agt	2165 S Kinnickinnic AV	Class B Tavern License		3/21/2022, 7:00 PM	1
10	Lion's Tooth, LLC	Lion's Tooth	Michelle M McClone-Carriere, Agt	2421 S KINNICKINNIC AV	Class C Wine Retailer's License		3/22/2022, 7:00 PM	1
11	Lion's Tooth, LLC	Lion's Tooth	Michelle M McClone-Carriere, Agt	2421 S KINNICKINNIC AV	Class B Fermented Malt Beverage Retailer's License		3/22/2022, 7:00 PM	1
12	CIAO CUCINA, LLC	CAFE LULU	SARAH F JONAS, Agt	2261-65 S Howell AV	Class B Tavern License	189	4/8/2022, 7:00 PM	1
13	BAY STREET PUB, LLC	BAY STREET PUB	MARK R PASCHAL, Agt	338 E BAY ST	Class B Tavern License	70	4/13/2022, 7:00 PM	1
14	LANDLUBBERS, INC	BARNACLE BUD'S	GENE M MC KIERNAN, Agt	1955 S HILBERT ST	Class B Tavern License	50	3/14/2022, 7:00 PM	1
15	Lost Whale Enterprises LLC	Lost Whale	Richard W Duval, Agt	2151 S KINNICKINNIC AV	Class B Tavern License		6/18/2022, 7:00 PM	1
16	DRI 5 BAYVIEW LLC	Centraal Grand Cafe & Tappery	ERIC G WAGNER, Agt	2306 S KINNICKINNIC AV	Class B Tavern License	261	6/29/2022, 7:00 PM	1
17	MAPLE LEAF ENTERPRISES, LLC	SUGAR MAPLE	ADRIENNE M PIERLUISSI, Agt	441 E LINCOLN AV	Class B Tavern License	160	7/29/2022, 7:00 PM	1
18	Tota's LLC	Riviera Maya	FRANCISCO ARAIZA-QUINTANA, Agt	2321&2327 S Kinnickinnic AV	Class B Tavern License	90	7/5/2022, 7:00 PM	1

19	Guanajuato Mexican Restaurant, LLC	Guanajuato Mexican Restaurant	CAROLINA GAMINO, Agt	2317 S Howell AV	Class B Tavern License		7/29/2022, 7:00 PM	1
20	Three Sheets LLC	The Stone	SHAWN T LEET, Agt	2422 S Howell AV	Class B Tavern License	80	7/28/2022, 7:00 PM	1
21	HIGGSKI, INC	BAY VIEW BOWL	MICHAEL S KOSINSKI, Agt	2416 S KINNICKINNI C AV	Class B Tavern License	160	7/25/2022, 7:00 PM	1
22	SUMO, LLC	THE HIGHBURY PUB	JOSEPH R KATZ, Agt	2322 S KINNICKINNI C AV	Class B Tavern License	80	7/26/2022, 7:00 PM	1
23	KRS Hospitality Group LLC	Makk N Cheese	Marcos A Ramos-Garcia, Agt	2242 S Kinnickinnic AV	Class B Tavern License	60	8/9/2022, 7:00 PM	1
24	PKNJ, LLC	Sorella	Kyle C Toner, Agt	2535 S Kinnickinnic AV	Class B Tavern License		8/16/2022, 7:00 PM	1
25	U.C. Jonas Inc	Mothership	PAUL U JONAS, Agt	2301 S Logan AV	Class B Tavern License		7/25/2022, 7:00 PM	1
26	Rap Us Corp	Cafe India - Bar & Grill	RAKESH REHAN, Agt	2201 S Kinnickinnic AV	Class B Tavern License		9/14/2022, 7:00 PM	1
27	RSVR LLC	RSVR	Reid C Spiering, Agt	2210 S KINNICKINNI C AV	Class B Tavern License		10/10/2022, 7:00 PM	1
28	Vine Society LLC	Voyager Wine & Cocktail Bar	JORDAN A BURICH, Agt	422 E Lincoln AV	Class B Tavern License	49	10/17/2022, 7:00 PM	1
29	MPR CORPORATION	Bay View Supermarket	PARESH C PATEL, Agt	2277 S HOWELL AV	Class A Malt & Class A Liquor License		9/19/2022, 7:00 PM	1
30	Semolina MKE LLC	Semolina MKE	Petra L Orłowski, Agt	2474 S KINNICKINNI C AV	Class B Tavern License		10/16/2022, 7:00 PM	1
31	AA Entertainment, LLC	The Backyard	Sam J Leaf, Agt	2155 S KINNICKINNI C AV	Class B Tavern License	160	10/17/2022, 7:00 PM	1
32	BABY BOOMERS	BABY BOOMERS	WENDELL E BENNETT, SP	182 E LINCOLN AV	Class B Tavern License	80	11/4/2022, 7:00 PM	1
33	Revel Group Inc	Revel	Haley I Pollard, Agt	2246 S Kinnickinnic AV	Class B Tavern License	80	10/31/2022, 7:00 PM	1

Establishments within a 0.5 miles radius centered on area of interest.



Tuesday, June 14, 2022



# Notice of Public Hearing

Blank Notice

---

HUHN, Heather R  
Cheba Hut at 2202 S KINNICKINNIC Av.  
Class B Tavern and Food Dealer License Applications

**Tuesday, June 28, 2022 at 09:00 AM**

To whom it may concern:

The above application has been made by the above named applicant(s). This requires approval from the Licenses Committee and the Common Council of the City of Milwaukee. The hearing before the Licenses Committee will take place virtually on 06/28/2022 at 09:00 AM. This is a public hearing. Those wishing to view the proceeding are able to do so via the City Channel – Channel 25 on Spectrum Cable – or on the Internet at <http://city.milwaukee.gov/citychannel>. Those wishing to provide oral testimony will be asked to do so by phone or internet and are asked to contact the staff assistant, Yadira Melendez at (414) 286-2775 or [stasst5@milwaukee.gov](mailto:stasst5@milwaukee.gov) for necessary information. Please make such requests no later than one business day prior to the start of the meeting. You are not required to attend the hearing, but please see the information below if you would like to provide testimony. Once the Licenses Committee makes its recommendation, this recommendation is forwarded to the full Common Council for approval at its next regularly scheduled hearing.

---

## Important details for those wishing to provide information for the Licenses Committee to consider when making its recommendation:

1. The license application is scheduled to be heard at the above time. Due to other hearings running longer than scheduled, you may have to wait some time to provide your testimony.
2. You must testify as to matters that you have personally experienced or seen. (You cannot provide testimony for your neighbor, parent or anyone else; this is considered hearsay and cannot be considered by the committee.)
3. No letters or petitions can be accepted by the committee (unless the person who wrote the letter or the persons who signed the petition are willing to testify).
4. Persons opposed to the license application are given the opportunity to testify first; supporters may testify after the opponents have finished.
5. When you are called to testify, you will be sworn in and asked to give your name, and address. (If your first and/or last names are uncommon please spell them.)
6. You may then provide testimony.
  - a. Include only information relating to the above license application.
  - b. Include only information you have personally witnessed or seen.
  - c. Provide concise and relevant information detailing how this business has affected or may affect the peaceful enjoyment of your neighborhood.
  - d. If by the time you have the opportunity to testify, the information you wish to share has already been provided to the committee, you may state that you agree with the previous testimony. Redundant or repetitive testimony will not assist the committee in making its recommendation.
7. After giving your testimony, the members of the Licenses Committee and the licensee may ask questions regarding the testimony you have given or other factors relating to the license application.
8. Business Competition is not a valid basis for denial or non-renewal of a license.

**Please Note: If you have submitted an objection to the above application your objection cannot be considered by the committee unless you personally testify at the hearing.**













CURRENT OCCUPANT	2202 S KINNICKINNIC AVE, 512	MILWAUKEE, WI 53207-1308
CURRENT OCCUPANT	2202 S KINNICKINNIC AVE, 513	MILWAUKEE, WI 53207-1308
CURRENT OCCUPANT	2202 S KINNICKINNIC AVE, 514	MILWAUKEE, WI 53207-1308
CURRENT OCCUPANT	2202 S KINNICKINNIC AVE, 515	MILWAUKEE, WI 53207-1308
CURRENT OCCUPANT	2202 S KINNICKINNIC AVE, 517	MILWAUKEE, WI 53207-1308
CURRENT OCCUPANT	2202 S KINNICKINNIC AVE, 518	MILWAUKEE, WI 53207-1308
CURRENT OCCUPANT	2203 S KINNICKINNIC AVE	MILWAUKEE, WI 53207-1329
CURRENT OCCUPANT	2205 S ALLIS ST	MILWAUKEE, WI 53207-1320
CURRENT OCCUPANT	2205A S ALLIS ST	MILWAUKEE, WI 53207-1320
CURRENT OCCUPANT	2206 S ALLIS ST	MILWAUKEE, WI 53207-1321
CURRENT OCCUPANT	2207 S KINNICKINNIC AVE	MILWAUKEE, WI 53207-1329
CURRENT OCCUPANT	2207A S KINNICKINNIC AVE	MILWAUKEE, WI 53207-1329
CURRENT OCCUPANT	2208 S ALLIS ST	MILWAUKEE, WI 53207-1321
CURRENT OCCUPANT	2208 S KINNICKINNIC AVE	MILWAUKEE, WI 53207-1330
CURRENT OCCUPANT	2209 S ALLIS ST	MILWAUKEE, WI 53207-1320
CURRENT OCCUPANT	2210 S ALLIS ST	MILWAUKEE, WI 53207-1321
CURRENT OCCUPANT	2212 S KINNICKINNIC AVE	MILWAUKEE, WI 53207-1330
CURRENT OCCUPANT	2212 S ROBINSON AVE	MILWAUKEE, WI 53207-1338
CURRENT OCCUPANT	2213 S ALLIS ST	MILWAUKEE, WI 53207-1320
CURRENT OCCUPANT	2213 S KINNICKINNIC AVE	MILWAUKEE, WI 53207-1329
CURRENT OCCUPANT	2214 S ALLIS ST	MILWAUKEE, WI 53207-1321
CURRENT OCCUPANT	2214 S KINNICKINNIC AVE	MILWAUKEE, WI 53207-1330
CURRENT OCCUPANT	2215 S KINNICKINNIC AVE	MILWAUKEE, WI 53207-1329
CURRENT OCCUPANT	2216 S ALLIS ST	MILWAUKEE, WI 53207-1321
CURRENT OCCUPANT	2216 S KINNICKINNIC AVE	MILWAUKEE, WI 53207-1330
CURRENT OCCUPANT	2216 S ROBINSON AVE	MILWAUKEE, WI 53207-1338
CURRENT OCCUPANT	2217 S ALLIS ST	MILWAUKEE, WI 53207-1320
CURRENT OCCUPANT	2218 S ALLIS ST	MILWAUKEE, WI 53207-1321
CURRENT OCCUPANT	2218 S KINNICKINNIC AVE	MILWAUKEE, WI 53207-1330
CURRENT OCCUPANT	2219 S ALLIS ST	MILWAUKEE, WI 53207-1320
CURRENT OCCUPANT	2219 S KINNICKINNIC AVE	MILWAUKEE, WI 53207-1329
CURRENT OCCUPANT	2219 S KINNICKINNIC AVE, A	MILWAUKEE, WI 53207-1329
CURRENT OCCUPANT	2220 S KINNICKINNIC AVE	MILWAUKEE, WI 53207-1330
CURRENT OCCUPANT	2220 S ROBINSON AVE	MILWAUKEE, WI 53207-1338
CURRENT OCCUPANT	2221 S KINNICKINNIC AVE	MILWAUKEE, WI 53207-1329
CURRENT OCCUPANT	2222 S ALLIS ST	MILWAUKEE, WI 53207-1321
CURRENT OCCUPANT	2224 S ROBINSON AVE	MILWAUKEE, WI 53207-1338
CURRENT OCCUPANT	2225 S KINNICKINNIC AVE	MILWAUKEE, WI 53207-1329
CURRENT OCCUPANT	2226 S ALLIS ST	MILWAUKEE, WI 53207-1321
CURRENT OCCUPANT	2226 S KINNICKINNIC AVE	MILWAUKEE, WI 53207-1330
CURRENT OCCUPANT	2227 S KINNICKINNIC AVE	MILWAUKEE, WI 53207-1329
CURRENT OCCUPANT	2228 S ROBINSON AVE	MILWAUKEE, WI 53207-1338
CURRENT OCCUPANT	2230 S KINNICKINNIC AVE	MILWAUKEE, WI 53207-1330
CURRENT OCCUPANT	2231 S ALLIS ST	MILWAUKEE, WI 53207-1320
CURRENT OCCUPANT	2231 S KINNICKINNIC AVE	MILWAUKEE, WI 53207-1329
CURRENT OCCUPANT	2231A S ALLIS ST	MILWAUKEE, WI 53207-1320
CURRENT OCCUPANT	2234 S KINNICKINNIC AVE	MILWAUKEE, WI 53207-1330

CURRENT OCCUPANT	2235 S ALLIS ST	MILWAUKEE, WI 53207-1320
CURRENT OCCUPANT	2235 S KINNICKINNIC AVE, 1	MILWAUKEE, WI 53207-1329
CURRENT OCCUPANT	2235 S KINNICKINNIC AVE, 2	MILWAUKEE, WI 53207-1329
CURRENT OCCUPANT	2235 S KINNICKINNIC AVE, 5	MILWAUKEE, WI 53207-1329
CURRENT OCCUPANT	2235A S ALLIS ST	MILWAUKEE, WI 53207-1320
CURRENT OCCUPANT	2236 S KINNICKINNIC AVE	MILWAUKEE, WI 53207-1330
CURRENT OCCUPANT	2243 S KINNICKINNIC AVE	MILWAUKEE, WI 53207-1329
CURRENT OCCUPANT	2244 S KINNICKINNIC AVE, 1	MILWAUKEE, WI 53207-1330
CURRENT OCCUPANT	326 E ARCHER AVE	MILWAUKEE, WI 53207-1323
CURRENT OCCUPANT	326A E ARCHER AVE	MILWAUKEE, WI 53207-1323
CURRENT OCCUPANT	332 E ARCHER AVE	MILWAUKEE, WI 53207-1323
CURRENT OCCUPANT	336 E ARCHER AVE	MILWAUKEE, WI 53207-1323
CURRENT OCCUPANT	338 E WARD ST	MILWAUKEE, WI 53207-1348
CURRENT OCCUPANT	338A E WARD ST	MILWAUKEE, WI 53207-1348
CURRENT OCCUPANT	339 E BRUNKS LN	MILWAUKEE, WI 53207-1353
CURRENT OCCUPANT	340 E ARCHER AVE	MILWAUKEE, WI 53207-1323
CURRENT OCCUPANT	340A E ARCHER AVE	MILWAUKEE, WI 53207-1323
CURRENT OCCUPANT	348 E ARCHER AVE	MILWAUKEE, WI 53207-1323

Blank Notice

Total Records: 299

Radius 250.0 feet and Center of Circle: 2202 S Kinnickinnic Av



# BUSINESS LICENSE PLAN OF OPERATION

Office of the City Clerk License Division  
200 E. Wells St. Room 105, Milwaukee, WI 53202  
(414) 286-2238 www.milwaukee.gov/license e-mail address: [license@milwaukee.gov](mailto:license@milwaukee.gov)

ccl-busplan 5/12/2020

## 1. Type of Business

Applying for:  Extended Hours (12AM to 5AM) - If a food establishment, check all that apply:  Delivery  Drive Thru  Dining Room  
 Self Service Laundry  Massage Establishment  Filling Station  
 Other (supplemental application for specific license also required)

Provide a detailed description of the type of business you plan on operating:

We will be selling fast casual non-alcoholic & alcoholic drinks.

Do you have any experience operating this type of business?  No  Yes If yes, explain: Food: toasted subs, salads, & munchies

## 2. Business Operations

- a. Proposed Opening Date: 10/1/2022
- b. Is this premise under construction?  No  Yes If yes, list estimated completion date: \_\_\_\_\_
- c. Is this a franchise?  No  Yes
- d. Is this premises currently licensed?  No  Yes If yes, list type of license: \_\_\_\_\_
- e. Is the current licensee operating?  No  Yes if no, list date closed: 9/21/2021
- f. Do you have future plans for other businesses, licenses or permits at this location?  No  Yes  
If yes, explain: \_\_\_\_\_
- g. Have you previously held an Extended Hours License in Milwaukee?  No  Yes  
If yes, list address(es): \_\_\_\_\_
- h. Are other businesses operating in the same building?  No  Yes If yes, describe: Vue Apartments

## 3. Litter & Noise

- a. How are grounds kept clean?  Sweep  Pressure Wash  Pick Up Litter  Other: \_\_\_\_\_
- b. How often will grounds be cleaned?  Daily  Weekly  As Needed  Monthly  Other: \_\_\_\_\_
- c. Grounds cleaned by:  Licensee  Building Owner  Employees  Hired Maintenance  Other: \_\_\_\_\_
- d. How are noise issues prevented and/or addressed?  Security  Manager approaches customer(s)  Call Police  
 Signs Posted  Other: \_\_\_\_\_
- e. Will a sound amplification system be used?  No  Yes If yes, describe: speakers

## 4. Smoking & Sanitation

- a. Are there designated outdoor smoking areas?  No  Yes If yes, describe: \_\_\_\_\_
- b. Number of Garbage Cans: Inside: 2 Locations: By Beverage Station, By Seating Area near front door  
Outside: 2 Locations: one on each side of the entrance
- c. Is a crowd control barrier used?  No  Yes If yes, describe: \_\_\_\_\_
- d. How many restrooms are on the premises? 2
- e. Name of solid waste contractor:  Advanced Disposal  Waste Management  Other: TBD

## 5. Security

- a. Are there onsite parking spaces?  No  Yes If yes, how many? \_\_\_\_\_ and describe the parking security plan: \_\_\_\_\_
- b. Is there a loading zone?  No  Yes If yes, describe the loading area security plan: The driver will pull up put out cones. Wheel in product down a ramp into the back door
- c. Will you have security personnel on premise?  No  Yes If yes, how many? TBD and answer the following:  
 What are their responsibilities? to watch and assist in keeping the peace  
 Is security equipment used?  No  Yes If yes, describe alarm system  
 List their licensing, certification, or training credentials \_\_\_\_\_
- d. Will there be security cameras?  No  Yes If yes, how many? TBD and list locations: point of sale, bar,
- e. Will searches/identification checks be done upon entry?  No  Yes If yes, describe Bartender will card patrons only / point of sale for alcohol

## 6. Percentage of Sales (must total 100%)

Alcohol <u>10</u> %	Food <u>90</u> %	Secondhand Merchandise <u>0</u> %	Precious Metals & Gems <u>0</u> %
Entertainment _____ %	Cigarettes _____ %	Personal Services (such as tattoo, body piercing, salon, tailor, tanning, etc.) <u>0</u> %	Other _____ % Describe: _____
Pawnbroker Activity <u>0</u> %	Salvaged Materials <u>0</u> % (such as scrap metal)		

## 7. Businesses/Licenses on the Premises (check all that apply):

### Type 1

- Full Service Restaurant   
  Cafe/Coffee Shop   
  Deli or Fast Food Restaurant   
  Private/Fraternal/Veterans Club  
 Night Club   
  Tavern   
  Cocktail Lounge   
  Teen Club  
 Banquet Hall   
  Sports Facility   
  Bowling Alley  
 Hotel/Motel: Number of Floors: \_\_\_\_\_   
  Rooming House: Number of Floors: \_\_\_\_\_  
 Number of Rooms: \_\_\_\_\_   
 Number of Rooms: \_\_\_\_\_

### Type 2

- Liquor Store   
  Corner Store   
  Supermarket   
  Convenience Store  
 Gas Station   
  Amusement/Phonograph Distributor   
  Recycling, Salvage or Towing  
 Used Car Dealer   
  Personal Service Establishment  
 (such as tattoo business, hair salon, tailor, etc.)   
  Recording Studio

What other licenses/permits will you hold at this location? (check all that apply)

- Occupancy Permit   
  Cigarette & Tobacco   
  Gas Station   
  Extended Hours   
  Class "B" Tavern   
  Weights & Measures  
 Secondhand Dealer   
 Precious Metal & Gem   
 Other: \_\_\_\_\_

## 8. Legal Capacity (only if a Type 1 premises in #7 above)

Capacity TBD (Call the Milwaukee Development Center at 414-286-8211 if you have questions.)

## 9. Premises Description

a. Identify all area(s) of the premises that will be used in operating this business (include areas used only for storage):  
 1<sup>st</sup> Floor  2<sup>nd</sup> Floor  Basement Storage  Patio  Beer Garden  Sidewalk Café  Deck  Rooftop

Other: Describe: \_\_\_\_\_

b. Describe Location:  Major Thoroughfare  Secondary Street  Other: \_\_\_\_\_

c. Nearest Major Cross Street: East Ward St.

d. Describe Building:  Free Standing Building  Strip Mall  Other: Apartment & Condo

e. Describe Premises Structure:  Single Story  Multi-Story - # of Stories \_\_\_\_\_  Other: \_\_\_\_\_

f. Describe Surrounding Area:  Commercial  Residential  Industrial  Other: \_\_\_\_\_

g. Building Owner Name: Milwaukee Desmond LLC Phone Number: 414-690-2703

Building Owner Address: P.O. Box 400970, Las Vegas, NV 89140

## 10. Hours of Operation & Customers

Will customers be entering the premises?  No  Yes

Day of the Week	Proposed Hours of Operation:		Estimated Number of Customers expected each day	Potential Age Range of Customers	Class B Tavern Applicant Only: Age Restriction (If none, write 'None')
	Open Time (include a.m. or p.m.)	Close Time (include a.m. or p.m.)			
Sunday	10:00 AM	12:00 AM	450	N/A	none
Monday	10:00 AM	12:00 AM	450	N/A	none
Tuesday	10:00 AM	12:00 AM	450	N/A	none
Wednesday	10:00 AM	12:00 AM	450	N/A	none
Thursday	10:00 AM	2:00 AM	450	N/A	none
Friday	10:00 AM	2:30 AM	500	N/A	none
Saturday	10:00 AM	2:30 AM	500	N/A	none

An Extended Hours Establishment License is required for any convenience store, filling station, personal service establishment (such as tattoo, body piercing, salon, tailor, tanning, etc.), recording studio or restaurant which is open between the hours of 12:00 a.m. and 5:00 a.m.

Alcohol Establishments Permitted Hours of Operation: Class A: 8:00 am to 9:00 pm Sunday thru Saturday  
 Class B: 6:00 am to 2:00 am Sunday thru Thursday, 6:00 am to 2:30 am Friday & Saturday

Entertainment Outdoor Closing Hours: 10:00pm Sunday-Thursday; 12:00am Friday & Saturday; unless a different time, either earlier or later, is established by the Common Council in its approval of the licensee's plan of operation.

## 11. Signature(s)

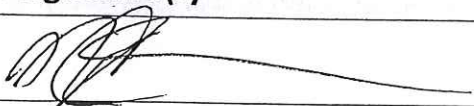
  
 Signature of Sole Proprietor, Partner, or 20% or more Shareholder  
 (If there are no 20% or more shareholders,  
 Corporate Officer-print name/title and sign)

\_\_\_\_\_  
 Signature of additional partner or 20% or more shareholder

See Application Information for a complete list of all required application forms.



# ALCOHOL BEVERAGE & PUBLIC ENTERTAINMENT PREMISES SUPPLEMENTAL APPLICATION

Office of the City Clerk License Division  
200 E. Wells St. Room 105, Milwaukee, WI 53202  
(414) 286-2238 e-mail address: license@milwaukee.gov [www.milwaukee.gov/license](http://www.milwaukee.gov/license)

Legal Entity Name: Mary Jane Restaurants LLC

Premise Address: 2202 S. Kinnickinnic Ave, Milwaukee, WI

53207

### Proximity of Premises to Church, School, Daycare Center or Hospital

Is the building within 300 feet of any church, school, daycare center or hospital?  No  Yes

### "Service Bar Only" Designation

If applying for Class B or C license, are you applying for "Service Bar Only"?  No  Yes  
Service Bar Only means customers cannot sit at the bar. Alcohol is served to employees who serve patrons seated at tables. No stools, chairs or other articles of furniture shall be placed at the service bar for patrons to sit upon.

### Business Information

a) Are you taking out this application for anyone that may not be eligible for a license?  No  Yes  
If yes, list their name and address: \_\_\_\_\_

b) Will the agent, a partner or the individual licensee be conducting the day-to-day operations of the business?  No  Yes  
If no, list the name and address of the person(s) who will: Michael R. Ruckelshaus

Class B Applicants: If the agent, a partner or the individual licensee will not be conducting the day-to-day operations of the business, the person(s) listed above must obtain a Class B Managers license.

c) Does anyone else have money invested or any other interest in this business?  No  Yes  
If yes, explain: \_\_\_\_\_

d) Have you made an agreement with anyone to repay any loan or any other payments based upon income from the business?  
 No  Yes If yes, list name and address: \_\_\_\_\_

### Property Information (New & Transfer Applicants Only)

a) Do you own or lease the building?  Own  Lease

b) Who owns the fixtures (for example, coolers, etc.)? Mary Jane Restaurants LLC

c) Are you purchasing the stock and/or fixtures?  No  Yes If yes, amount paid \$ 300,000

d) Total amount paid for business \$ 750,000

e) Total amount paid for goodwill of the business \$ 0

Goodwill comprises the reputation and customer relationships of an existing business. If the price you pay for the business exceeds the fair market value of all of the rest of the assets of the business, the excess may be considered goodwill.

f) Have you made arrangements with the seller for payment of personal property taxes?  No  Yes

### Lease Information (New & Transfer Applicants who are leasing the premises only)

a) Date lease begins: 4/15/2022 Ends 4/30/2027

b) Monthly rental \$ 4,300

c) Do you have an option to renew the lease?  No  Yes

d) Does your lease allow for assignment to another party without the consent of the owner?  No  Yes

e) For what length of time have you been guaranteed occupancy (number of years)? 5

**Lease Information (Continued)**

- f) In addition to paying the monthly rental, will you have to pay anything additional to the owner of the building to guarantee performance of the lease?  No  Yes If yes, explain \_\_\_\_\_
- g) Does the present owner or occupancy object to the granting of your license?  No  Yes  
If yes, explain \_\_\_\_\_

**Change of Agent Applicants Only**

Have there been any changes to the floor plan since the last application was submitted?  No  Yes  
If no, a new floor plan is not required. If yes, submit a new floor plan and explain the change(s):  
\_\_\_\_\_

**Signature**

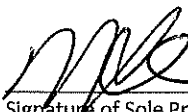
 Robert Huhn, Owner

Signature of Sole Proprietor, Partner or 20% or More Shareholder  
(If no 20% or more Shareholder, Corporate Officer - print name/title and sign)

Note: All information contained in this application is subject to approval by the Common Council.  
Deviating from approved plan of operation will subject licensee to citations, and/or suspension or non-renewal of the license.  
Contact the License Division for information on how to request changes.

**New and transfer of premises applicants must submit the following:**

- Detailed floor plan
- If a restaurant, copy of the menu



# FOOD DEALER LICENSE PLAN OF OPERATION

OFFICE OF THE CITY CLERK, LICENSE DIVISION  
 CITY HALL, 200 E. WELLS ST, ROOM 105, MILWAUKEE, WI 53202  
 (414) 286-2238 • [license@milwaukee.gov](mailto:license@milwaukee.gov) • [www.milwaukee.gov/license](http://www.milwaukee.gov/license)

Legal Entity Name: MARY JANE RESTAURANTS LLC

Premises Address: 2202S. Kinnickinnic Ave Milwaukee, WI 53207

## SECTION 1 TYPE OF BUSINESS

What will be the majority of your food sales? (check one)

Restaurant Items (meals):

MEALS include, but are not limited to, chicken, ribs, sandwiches, roasted corn, baked potatoes, hot dogs, brats, tacos, nachos w/ cheese and meat, French fries, cooked or deep fried vegetables/fruit, cooked cheese curds, corn dogs, egg rolls, salads.

Retail Items (snacks and beverages):

RETAIL items include, but are not limited to, ice cream/soft serve, lemonade, snow cones, coffee, espresso, cappuccino, tea, fruit juice, smoothies, candy, dispensed soda, fruit cups, bakery, cookies, kettle corn, cotton candy, funnel cakes, fritters, tortilla chips w/ cheese.

Will it be a convenience store?  Yes  No

A convenience store contains less than 5,000 square feet of retail space and has, as its primary business, the sale of basic food items and in addition, sells household products or is a filling station that sells basic food items and household products.

Bed & Breakfast

Micro Market

All Applicants: Submit a menu or a list of food items that will be sold.

Will any wholesale business be done?  No  Yes If yes, what percentage of food sales will be wholesale?

Less than 25%

25% or More AND:

Restaurant items (meals) will be sold – Complete this application and also contact DATCP.

NO restaurant items (meals) will be sold - Do NOT complete this application. Contact DATCP only.

## SECTION 2 FOOD PROCESSING

Will any food processing be done?  No  Yes

Processing is defined as assembling, grinding, cutting, mixing, baking, coating, stuffing, packing, bottling, grilling, canning, extracting, fermenting, distilling, pickling, freezing, drying, smoking, or packaging.

## SECTION 3 FOOD REQUIRING TEMPERATURE CONTROL

Will any food that requires temperature control be sold?  No  Yes  
 (includes dairy products such as milk, cheese, and ice cream, fish, shellfish, meat, poultry)

If yes, list the types of food items: Cheese, proteins, produce



**SECTION 4 DETAILS OF OPERATION**

Will you have seating on site for dining?  No  Yes

Will you be doing any catering?  No  Yes

Will you be doing any delivery?  No  Yes

Will you have outdoor activities?  No  Yes - Check all that apply:  Bar  Cooking/Grilling  Dining

Will you have a drive thru window?  No  Yes - Are hours different from inside?  No  Yes  
 If Yes, provide drive thru hours: \_\_\_\_\_

Will scales or barcode scanners be used?  No  Yes - You must also apply for a Weights & Measures License.

**SECTION 5 ADDITIONAL SITES**

Where will food be prepared and/or sold?  
 At a single site  At multiple sites: How many? \_\_\_\_\_ (for example, a hotel with several dining rooms or bars)  
 If multiple sites, attach a Food Dealer Additional Site Addendum (ccl-foodadd) for each additional site.

**SECTION 6 CONSTRUCTION OR CHANGES**

Are you planning any construction, remodeling or equipment changes?  
 No If No, SKIP to Section 8  
 Yes If Yes, check all that apply:  New construction of a building  Renovation or remodeling  
 Construction changes to existing building  Equipment changes only

Provide a brief description of the changes: Please see attached design layout

Start date: 01/1/22

Name, Address & Phone Number of Architect: JEFF BAKER DESIGN PARAMETERS  
(214) 784-5014

Name, Address & Phone Number of Contractor: TBD

**SECTION 7 ALCOHOL BEVERAGES**

Are you applying for an alcohol beverage license?  
 No If No, SKIP to Section 8  
 Yes IF YES, if your food license is approved prior to the alcohol license, when do you want the food license issued?  
 Immediately  At the same time as the alcohol license

**SECTION 8 ACKNOWLEDGEMENTS & SIGNATURE**

You must initial each item confirming your understanding:

RA I understand the Health Department must conduct an inspection and advise the License Division of their approval before the license may be issued.

RAH I understand I must obtain an occupancy permit from the Department of Neighborhood Services and an inspection may be required. Neighborhood Services must advise the License Division of their approval before the license may be issued.

RAH I understand the district alderperson will review and either support or object to my application. If he/she objects, I may appeal and be scheduled to appear before the Licenses Committee. The Licenses Committee will then make a recommendation to the Common Council. The Common Council must grant the license before it may be issued.

RA I understand proof of payment for all license fees must be on file in the License Division before the license may be issued and the license must be issued and posted in my establishment prior to opening for business.

RAH I will not operate my food business until the license has been issued and posted in the establishment.

Signature of Sole Proprietor, Partner, or 20% Shareholder: [Signature]

Signature of Additional Partner: \_\_\_\_\_

Agent Heather Hulam - Mary Jane Restaurants LLC  
 Trade: Cheba Hut  
 2202 S. Kinnickinnic Ave.  
 Milwaukee, WI 53207  
 5/23/22

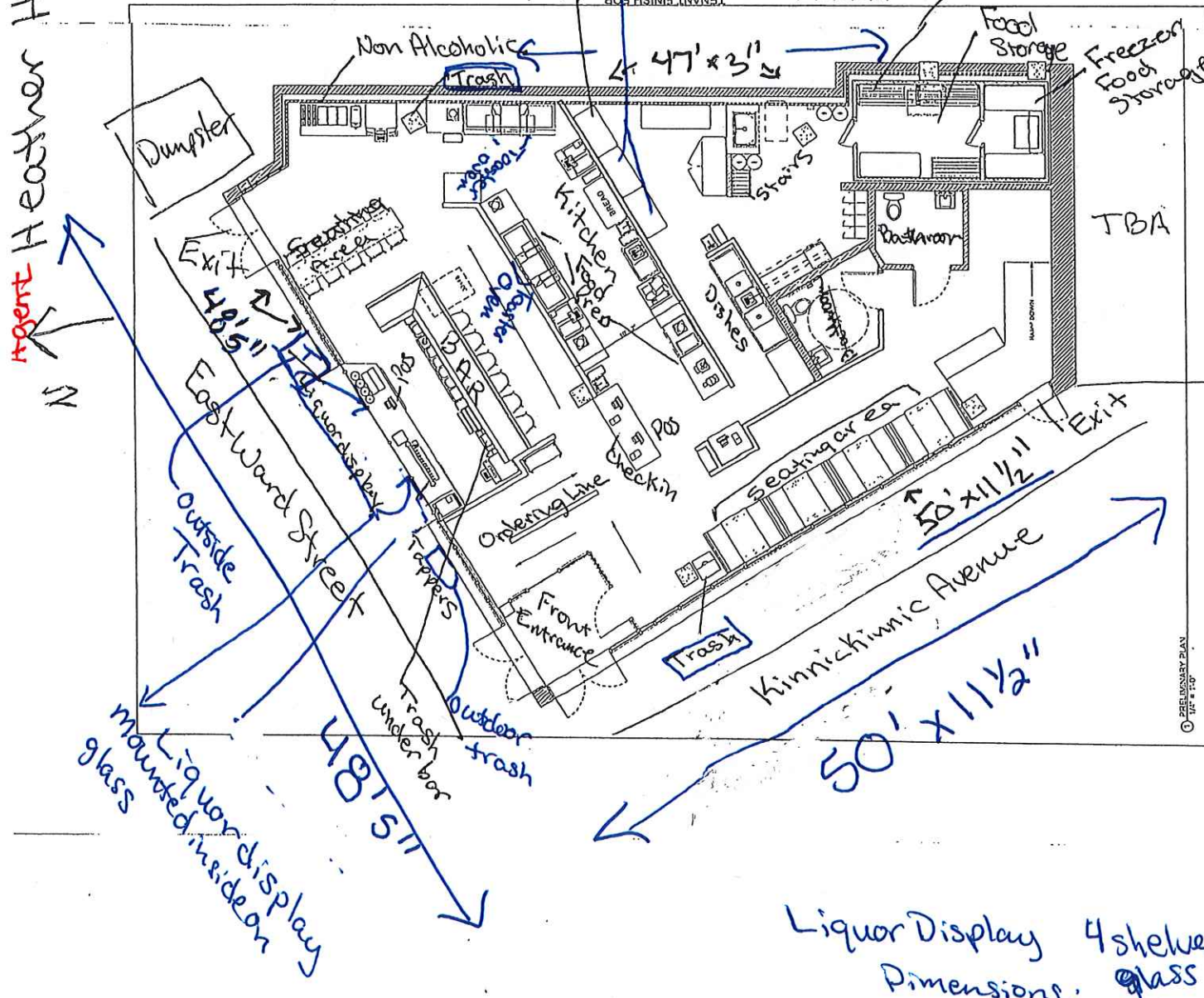

PROJECT NO.	CBH2021	
START DATE	05/16/2022	
DRAWN BY	CEB	
CHECKED BY	JMG	
NO.	DESCRIPTION	DATE

PRELIMINARY PLAN  
 PFP-1  
 copyright 2022

No parking

Total Sq. ft. - 2396 sq. ft.

Liquor Display 4 shelves on glass  
 Dimensions: 4 x 6

## SALADS

\$7.99

### GRILLED CHICKEN BACON SALAD

Grilled chicken breast, bacon, provolone, spring mix, tomatoes, cucumbers, green peppers, onions, pickle spear & handcrafted croutons (700)

\$7.99

### ANTIPASTO SALAD

Pepperoni, smoked ham rolls, provolone, black olives, spring mix, tomatoes, cucumbers, green peppers, onions, pickle spear & handcrafted croutons (720)

\$5.99

### GREEK SALAD

Kalamata olives, feta, banana peppers, spring mix, tomatoes, cucumbers, onions & handcrafted croutons (690)  
Add chicken +\$3.00 (700)

\$7.99

### TUNA SALAD

Tuna salad, spring mix, tomatoes, cucumbers, green peppers, onions, pickle spear & handcrafted croutons (450)

\$3.59

### GREEK SIDE SALAD

Kalamata olives, feta, banana peppers, spring mix, tomatoes, cucumbers, onions & handcrafted croutons (230)  
Add chicken +\$1.50 (340)

\$3.59

### HOUSE SIDE SALAD

Spring mix, tomatoes, cucumbers, green peppers, onions & handcrafted croutons (170)  
Add chicken +\$1.50 (280)

— Ranch, Honey Mustard, House, Greek —  
250 270 340 240

## MUNCHIES

\$1.79

### CHIPS (120-160)

\$2.79

### RICE KRISPIE BAR (430-510)

\$2.99

### 300 BALL

Rice Krispies, peanut butter, honey & cocoa (460)

\$2.79

### BROWNIES (450)

\$1.79

### COOKIES (370)

\$5.49

### BOWL O'BALLS

Handcrafted marinara or teriyaki or BBQ (450)

\$3.89

### RENCH ONION SOUP (220)

\$6.49

### HUMMUS PLATTER

House & jalapeño hummus, cucumber sticks, toasted atbread (970)

\$4.49

### LOADED NOT'CHOS

Melted cheddar cheese, jalapeños, red onion, black olives & hot sauce on a bed of Nacho Cheese Doritos with ranch drizzled on top! (620) (Add chicken +\$1.50) (730)

\$4.49

### PRETZEL NUGGETS

10 soft pretzels tossed in garlic butter & parmesan. Served with honey mustard (780)

\$4.29

### SARLIC CHEESE BREAD

Handcrafted marinara/ranch (700/970)

Chêba Hut is a "toasted" sub concept that has been curing munchies since its start in 1998. Founder Scott Jennings decided to showcase the harmony between great tasting food and...well, a very specific counter-culture.

We have the best BREAD in the business and nothing is fried at the Chêba Hut! Our motto is, "where the only thing fried is an occasional customer." The menu features over 25 signature sandwiches, as well as a variety of rice krispie treats, salads and munchies. Most locations also offer craft beer bars that feature beers from neighborhood breweries.

Our huts can be found in Arizona, Arkansas, Colorado, California, Florida, Oregon, New Mexico, Nevada, and Wisconsin. What really sets Chêba Hut apart, though, can only be experienced in our shops. We combine home grown food with real people in a relaxed environment.

# ESCAPE THE ESTABLISHED!

OG - Tempe, AZ 1998



# MENU



608-819-8485

453 Gilman St  
Madison, WI 53703

# 20 YEARS AND STILL ROLLING!

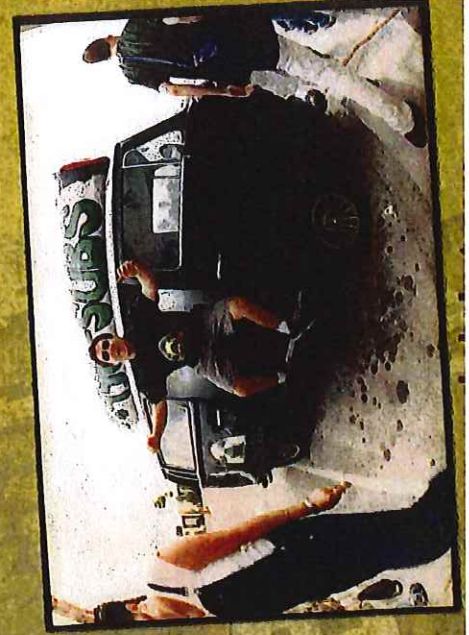



## WE HAVE THE BEST BREAD IN THE BUSINESS!

Our proprietary Parisian bread is hand-rolled, hand-scored, and baked by a bakery that has been in the business for over 50 years.

### SIGNATURE BREADS GARLIC HERB, WHITE, WHEAT

**NUG 4" PINNER 8" BLUNT 12"**



## ALL SUBS ARE HIT WITH OUR PROPRIETARY BLENDS!

\*House Dressing: Italian vinaigrette  
\*Chèba Shake: Proprietary blend of parmesan, herbs & spices

### OUR HANDCRAFTED SAUCES & DRESSINGS

Signature Ranch (250)	Teriyaki Sauce (70)	House Cream Cheese (210)
Toney Mustard (270)	Horseradish (250)	Jalapeno Cream Cheese (170)
Jamaican Red Hot Sauce (70)	House Dressing (340)	Hummus (140)
Chipotle Mayo (360)	Greek Dressing (240)	Handcrafted Marinara (60)   Jalapeno Hummus (130)
3BQ Sauce (90)		

ADDITIONAL NUTRITION INFO AVAILABLE UPON REQUEST

SANDWICH VALUES ARE ON WHEAT BREAD WITHOUT LOADED UP OPTION  
GARLIC AND HERB ADD: 10/30/50 CALORIES  
WHITE ADD: 20/40/60 CALORIES  
LOADED UP ADD: 15/30/50 CALORIES

2000 CALORIES A DAY IS USED FOR GENERAL NUTRITIONAL ADVICE,  
BUT CALORIE NEEDS VARY



## CHICKEN & TURKEY

**NUG \$5.89 • PINNER \$8.79 • BLUNT \$11.39**

### JAMAICAN RED (Spicy Chicken)

Spicy chicken breast, green peppers, jalapeños, black olives, cheddar, lettuce, tomato, onion, pickle, house dressing & Chèba Shake (380/750/1130)

### WHITE WIDOW (Chicken & Ranch)

Grilled chicken breast smothered in our signature ranch dressing, topped with 'shrooms, bacon, provolone, lettuce, tomato, onion, pickle, house dressing & Chèba Shake (480/960/1440)

### THAI STICK (Teriyaki Chicken)

Grilled chicken breast topped with our teriyaki sauce glaze, green pepper, pineapple, pepper jack, lettuce, tomato, onion, pickle, house dressing & Chèba Shake (350/700/1050)

### PANAMA RED (Chicken Marinara)

Grilled chicken breast topped with our handcrafted marinara, provolone & Chèba Shake (360/770/1160)

### ACAPULCO GOLD (BBQ Chicken)

Grilled chicken breast topped with BBQ sauce, Swiss, lettuce, tomato, onion, pickle, house dressing & Chèba Shake (320/630/950)

### APOLLO 13 (Greek Chicken)

Grilled chicken breast, garlic butter, kalamata olives, feta, spring mix, Greek dressing, tomato, onion, pickle & Chèba Shake (550/1100/1640)

### THE KIND (Turkey & Bacon)

Roasted turkey breast, layered with bacon, 'shrooms, Swiss, lettuce, tomato, pickle, house dressing & Chèba Shake (320/630/950)

### KALI MIST (California Club)

Roasted turkey breast, chipotle mayo, fresh jalapeños, bacon, pepper jack, avocado, lettuce, tomato, onion, pickle, house dressing & Chèba Shake (440/890/1330)

## VEGGIE

### HUMBOLDT (Guacamole & Veggie)

Provolone, guacamole, spring mix, onion, tomato, pickle, cucumber, 'shrooms, black olives, house dressing & Chèba Shake (290/580/870)

### GRIFFO (Cream Cheese & Veggie)

Pepper Jack, cream cheese, guacamole, spring mix, onion, tomato, pickle, cucumber, black olives, 'shrooms, house dressing & Chèba Shake (340/680/1200)

### SILVER HAZE (Hummus)

Swiss, hummus, banana peppers, spring mix, onion, tomato, pickle, cucumber, 'shrooms, black olives, house dressing & Chèba Shake (330/650/980)

### MAGIC MUSHROOM (Portobello)

Pepper jack, portobellos, teriyaki glaze, bell peppers, pineapple, spring mix, onion, tomato, pickle, cucumber, 'shrooms, black olives, house dressing & Chèba Shake (260/520/780)

### POWER PLANT (Guacamole & Hummus)

Guacamole, hummus, feta, spring mix, onion, tomato, pickle, cucumber, 'shrooms, black olives, house dressing & Chèba Shake (350/700/1050)



## MEAT

**NUG \$5.89 • PINNER \$8.79 • BLUNT \$11.39**

### LA CANNA (Italian)

Smoked ham, Genoa salami, prosciutto, black olives, provolone & lettuce, tomato, onion, pickle, house dressing & Chèba Shake (440/880/1330)

### 5-0 (ALL THE PIG, BABY)

Smoked ham, Genoa salami, prosciutto, pepperoni, bacon, giardiniera peppers, cheddar & lettuce, tomato, onion, pickle, house dressing & Chèba Shake (470/940/1410)

### PAKALOLO (Ham, Swiss & Pineapple)

Smoked ham, pineapple, honey mustard, Swiss, lettuce, onion, pickle, house dressing & Chèba Shake (440/870/1310)

### CHRONIC (BBQ Roast Beef)

Roast beef, BBQ sauce, green peppers, 'shrooms, Cheddar, lettuce, onion, pickle, house dressing & Chèba Shake (350/700/1050)

### KG8 (Roast Beef)

Roast beef, horseradish, green peppers, 'shrooms, Swiss, lettuce, tomato, onion, pickle, house dressing & Chèba Shake (350/700/1050)

### AK-47 (French Dip)

Roast Beef, portobellos, onions, provolone & Chèba Shake with a side of Au Jus (320/640/960)

### G-13 (Turkey & Roast Beef)

Roasted turkey breast, roast beef, chipotle mayo, bacon, provolone, lettuce, tomato, onion, pickle, house dressing & Chèba Shake (410/810/960)

### MIDWEST BEST (Club)

Roasted turkey breast, smoked ham, bacon, provolone, lettuce, tomato, onion, pickle, house dressing & Chèba Shake (320/640/960)

### KUSH (BLT)

Bacon, provolone, mayo, lettuce, extra tomatoes, house dressing & Chèba Shake (650/1290/1940)

### PACIFIC BLUE (Tuna Melt)

Our very own handcrafted tuna salad topped with cheddar, lettuce tomato, onion, pickle, house dressing & Chèba Shake (290/590/880)

### BOMB (Meatball)

Meatballs, marinara, green peppers, 'shrooms, provolone & Chèba Shake (530/1060/1580)

### DANK (Pizza Sub)

Salami, marinara, provolone, pepperonis & Chèba Shake (530/1060/1580)



CREW CONCOCTED SANDWICHES  
SEE STORE FOR DETAILS!

KICK IT OLD SCHOOL WITH THE  
STICKY ICKY (Peanut butter & jelly) (430/1350)

67 70 • 66 30 • 66 00