



Certificate of Appropriateness

Milwaukee Historic Preservation Commission/200 E. Wells Street/Milwaukee, WI 53202/phone 414-286-5712/fax 414-286-3004

Property 2670 N. GRANT BL.
Description of work Wooden fence per attached diagram. Heights to comply with zoning regulations. Shadow box fencing PROHIBITED. Please see attached fence design options and prohibitions.
Date issued 11/19/2021 PTS ID 115219 COA: wooden fence

In accordance with the provisions of Section 320-21 (11) and (12) of the Milwaukee Code of Ordinances, the Milwaukee Historic Preservation Commission has issued a certificate of appropriateness for the work listed above. The work was found to be consistent with preservation guidelines. The following conditions apply to this certificate of appropriateness:

All wood must be smooth and equivalent to #1 grade cedar or better for use in rear and side yards. Sections of fence forward of or in line with the primary building's front setback must be clear grain. Wood fences must be painted or stained with an opaque stain upon completion. Note: when new, bare wood is left exposed to the exterior elements for a period of only a week or two, the life of the paint job subsequently applied to it will be decreased.

All work must be done in a craftsman-like manner, and must be completed within one year of the date this certificate was issued. Staff must approve any changes or additions to this certificate before work begins. Work that is not completed in accordance with this certificate may be subject to correction orders or citations. If you require technical assistance, please contact hpc@milwaukee.gov.

If permits are required, you are responsible for obtaining them from the Milwaukee Development Center. If you have questions about permit requirements, please consult the Development Center's web site, www.milwaukee.gov/build, or call (414) 286-8210.

City of Milwaukee Historic Preservation Staff

Copies to: Development Center, Ald. Russell Stamper II

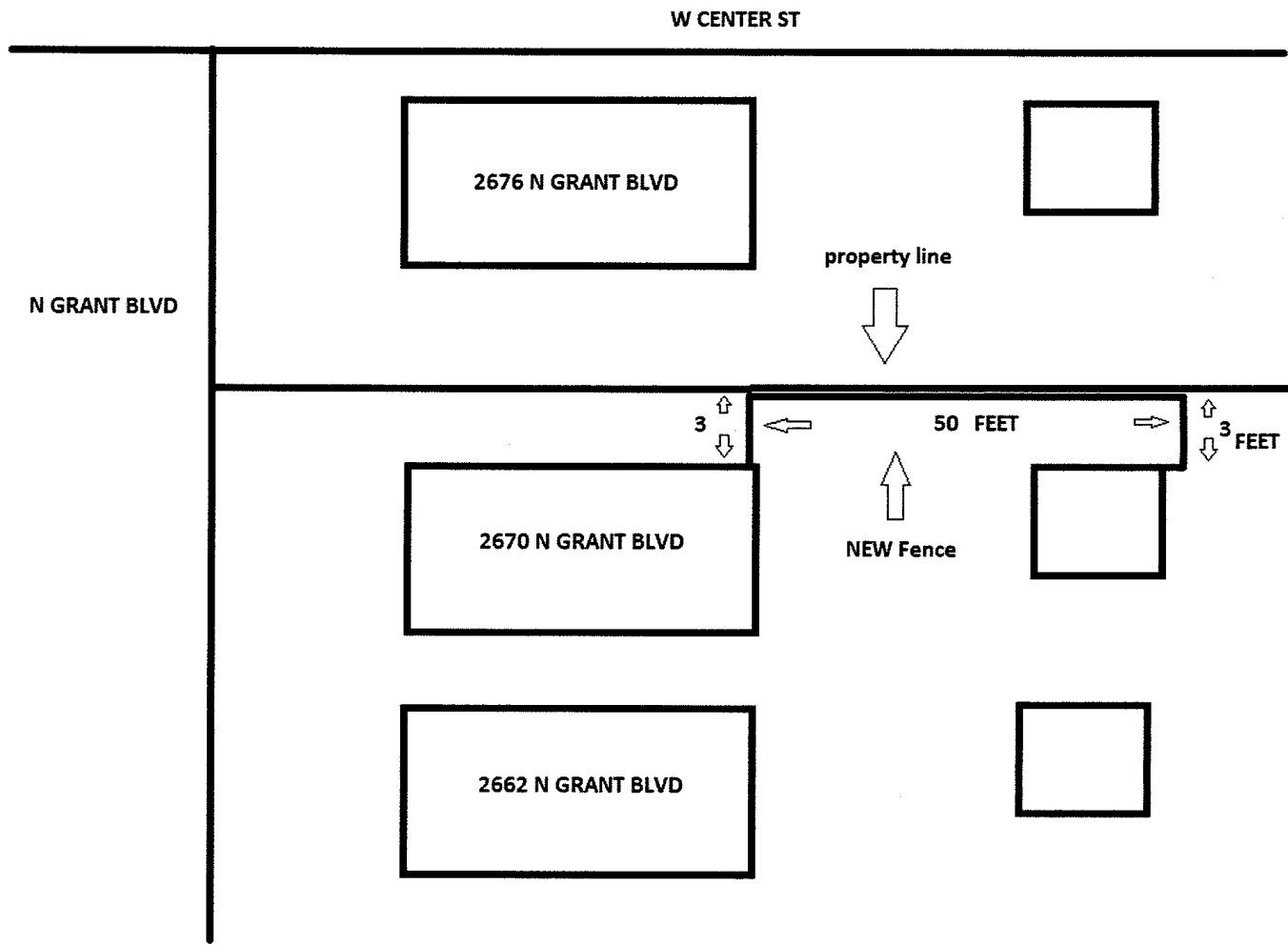

Site Plan

Fences



Fe

Common Privacy Fences

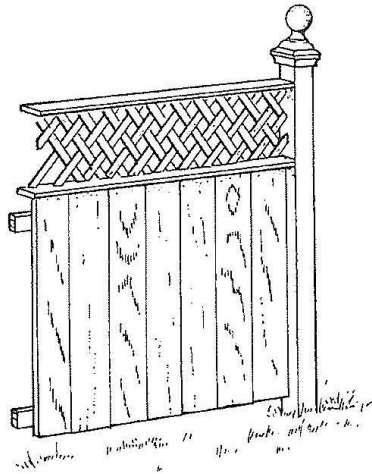

Board and lattice, also called a "treillage fence"

A privacy fence, which is intended to obstruct the view into a yard, should only be built in rear yards. The privacy fences on this page are compatible with most houses built before 1940. Most of these styles are available at building supply stores in ready-made sections or can be built from stock lumber. The finished side of a privacy fence must always face out to the public right-of-way or the neighboring property.

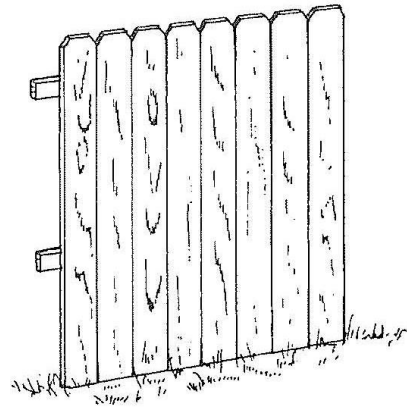

Dog Ear Vertical Board

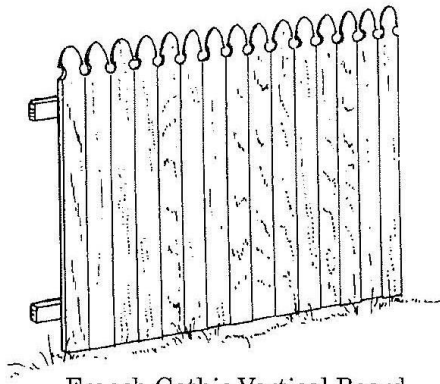

French Gothic Vertical Board

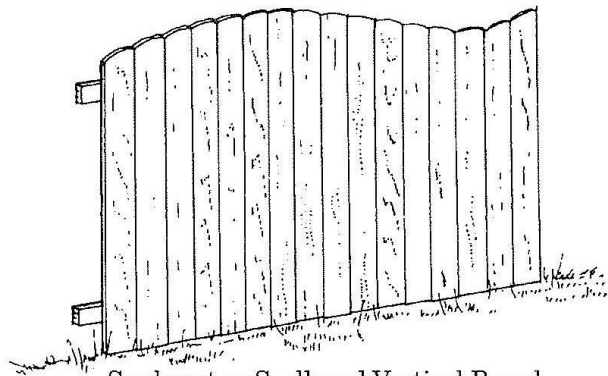

Sunburst or Scalloped Vertical Board

Victo:

Fences



Custom Privacy Fences

Building a custom privacy fence is not required by the preservation ordinance, but these designs are intended to show a few of the many alternatives to the standard, off-the-shelf, privacy fences usually built today. Years ago, fences were often individually designed to reflect the architecture of the house and this is still possible today.



Victorian/Arts and Crafts, 1870-1900

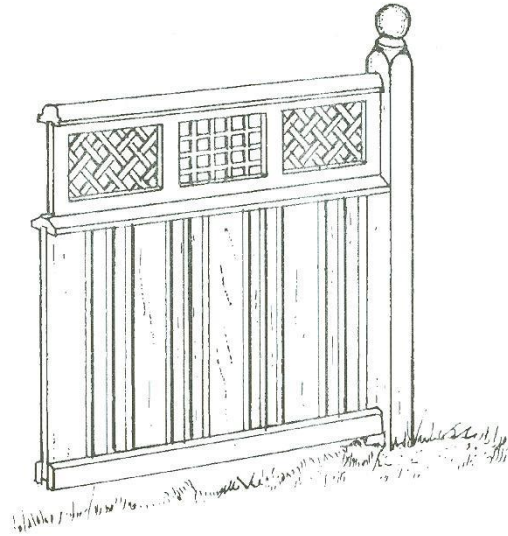

All Styles, 1870-1930

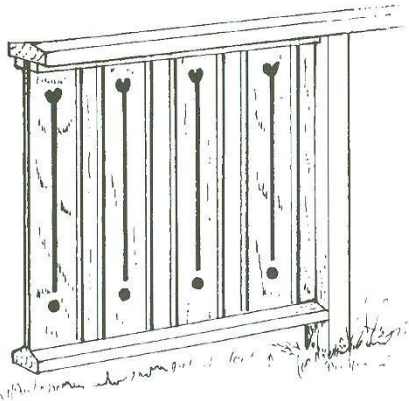

Craftsman/Bungalow, 1910-1935

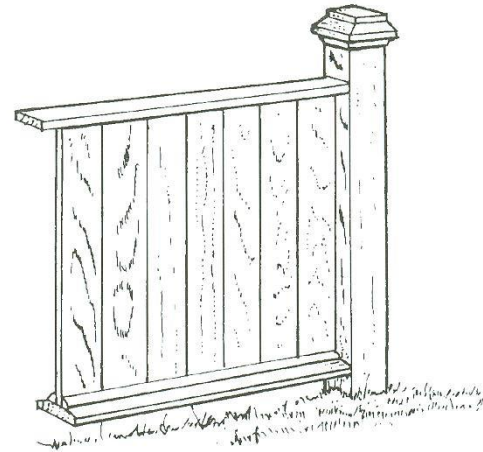

All Styles, 1860-1935

Fences



Fences that are incompatible with the style of the house

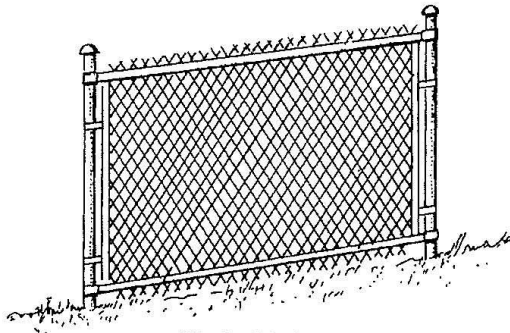

Chain Link

These fence styles are not compatible with the architecture of houses built before 1940 and are not permitted in residential historic districts.

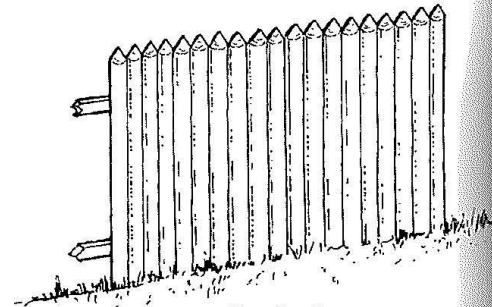

Stockade

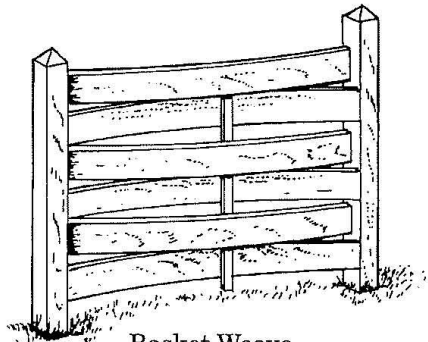

Basket Weave

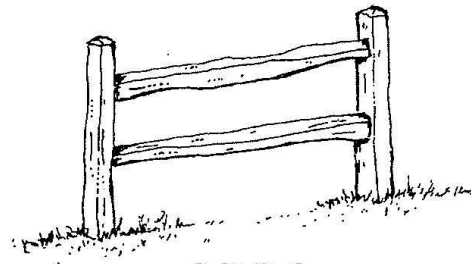

Split Rail

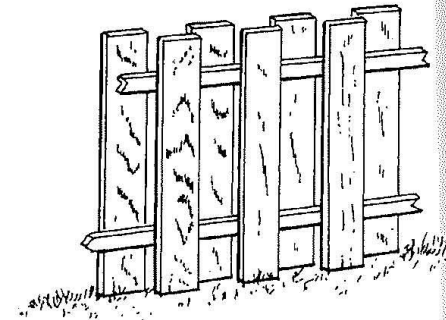

Board-on-Board