



CITY OF MILWAUKEE
OFFICE OF THE CITY CLERK

Wednesday, August 23, 2023

COMMITTEE MEETING NOTICE

AD 04

SKEETS, Pakeeta L, Agent
Rock & Roll Variety Shop LLC
4440 W OLIVE ST
Milwaukee, WI 53216

You are requested to attend a hearing which is to be held in Room 301-B, Third Floor, City Hall or you may attend virtually using the link below.

Wednesday, September 06, 2023 at 09:55 AM

The access code is <https://meet.goto.com/400885589>. If you wish to call in: +1 (872) 240-3212 and use Access Code: 400-885-589. Please see the enclosed best practices document for further instructions.

Regarding: Your Class A Malt & Class A Liquor and Food Dealer License Applications as agent for "Rock & Roll Variety Shop LLC" for "Rock & Roll Variety Shop" at 802 N 35TH St.

There is a possibility that your application may be denied for one or more of the following reasons: The recommendation of the committee regarding the application shall be based on evidence presented at the hearing. Per MCO 85-2.7-4, probative evidence concerning whether or not a new license should be granted may be presented on the following subjects: whether or not the applicant meets the municipal requirements, the appropriateness of the location and premises where the licensed premises is to be located and whether use of the premises for the purposes or activities permitted by the license would tend to facilitate a public or private nuisance or create undesirable neighborhood problems such as disorderly patrons, unreasonably loud noise, litter, and excessive traffic and parking congestion. Probative evidence relating to these matters may be taken from the plan of operation submitted with the license application, if any, but shall not include the content of any music. Evidence regarding the fitness of the location of the premises to be maintained as the principal place of business, including but not limited to whether there is an overconcentration of businesses of the type for which the license is sought; whether the proposal is consistent with any pertinent neighborhood business or development plans, or the location's proximity to areas where children are typically present. The applicant's record in operating similarly licensed premises; and whether or not the applicant has been charged with or convicted of any felony, misdemeanor, municipal offense or other offense, the circumstances of which substantially relate to the activity to be permitted by the license being applied for or any other factor which reasonably relates to the public health, safety or welfare may also be considered. See attached police report or correspondence.

Notice for applicants with warrants or unpaid fines:

Proof of warrant satisfaction or payment of fines must be submitted at the hearing on the above date and time. Failure to comply with this requirement may result in a delay of the granting/denial of your application.

Failure to appear at this meeting may result in the denial of your license. Individual applicants must appear only in person or by an attorney. Corporate or Limited Liability applicants must appear only by the agent designated on the application or by an attorney. Partnership applicants must appear by a partner listed on the application or by an attorney. If you wish to do so and at your own expense, you may be accompanied by an attorney of your choosing to represent you at this hearing. You will be given an opportunity to speak on behalf of the application and to respond and challenge any charges or reasons given for the denial. No petitions can be accepted by the committee, unless the people who signed the petition are present at the committee hearing and willing to testify. You may present witnesses under oath and you may also confront and cross-examine opposing witnesses under oath. If you have difficulty with the English language, you should bring an interpreter with you, at your expense, so that you can answer questions and participate in your hearing.

You may examine the application file at this office during regular business hours prior to the hearing date. Inquiries regarding this matter may be directed to the person whose signature appears below.

Limited parking for persons attending meetings during normal business hours is available at reduced rates (5 hour limit) at the Milwaukee Center on the southwest corner of Kilbourn Avenue and Water Street. You must present a copy of the meeting notice to the parking cashier.

PLEASE NOTE: Upon reasonable notice, efforts will be made to accommodate the needs of disabled individuals through sign language interpreters or other auxiliary aids. For additional information or to request this service, contact the Council Services Division ADA Coordinator at (414) 286-2998, Fax - (414) 286-3456, TDD - (414) 286-2025.

JIM OWCZARSKI, CITY CLERK

BY: _____
Jim Cooney
License Division Manager

If you have questions regarding this notice, please contact the License Division at (414) 286-2238.

200 E. Wells Street, Room 105, City Hall, Milwaukee, WI 53202. www.milwaukee.gov/license
Phone: (414) 286-2238 Fax: (414) 286-3057 Email Address: License@milwaukee.gov



Milwaukee Police Department Police
Administration Building 749 West State
Street Milwaukee, Wisconsin 53233
<http://www.milwaukee.gov/police>

Jeffrey Norman
Chief of Police

(414) 933-4444

Friday, September 9th, 2022

SADAQAT ALI,
1551 N 118TH ST
WAUWATOSA, WI 53226

RE: Notice of After Set Activity at 802 N 35th Street

Dear Sadaqat Ali:

This letter is notice to you that the Milwaukee Chief of Police, by the chief's designee, the district commander, has determined that a person associated with the premises located at 802 N 35th Street ("the premises") has engaged in after set activity pursuant to Milwaukee Code of Ordinances 80-11, After Sets.

The Milwaukee Police Department has responded to the following described after set activity at the premises:

1. On Friday August 26th, 2022 at 1:49am, officers were dispatched to 802 N 35th Street for a Subject with Gun complaint. The caller stated they observed multiple subjects with guns go into an abandon building for a possible party. Officers responded and spoke with the renter of the location who stated he started renting about a month ago and this was his first event hosted inside the location. The renter initially stated to officers he had proper licensing for the event but later redacted the statement. Officers conducted a check of the location and observed 10 individuals inside the location. Officer spoke with one female individual who stated she was there for a party. Officer heard loud music from inside their squad vehicle approximately 50 feet away. Officers observed colorful strobe lights inside location, hookah, stripper poles, food (buns, condiments, warming dishes), plywood bar with plastic cups, dance floor with mirrors and television on the wall, lounge area (with couch), an empty bottle of Hennessy. Officers noted there were no licenses for the location. Officers filed a report regarding this incident. This is a violation of s.108-5 of the code.
2. On Saturday September 3rd, 2022 at 7:01am, officers were dispatched to 802 N 35th Street for a Shooting complaint. Caller stated victim is shot in the leg. Caller stated they heard about 12 shots. Officers arrived on scene and located a victim shot. Upon arrival officers spoke with renter of location who stated the victim departed his after-set party with no problems. The renter stated approximately 30 seconds after the group left the party he heard 10 gunshots, looked outside of the location and observed the victim on the sidewalk bleeding. While officers were inside the location they observed a large gold

"stripper pole" in the middle of the room, a makeshift bar made out of 2x4 pieces of wood, and numerous plastic cups filled with a dark substance. Detectives spoke to a witness who stated she and a group of people were leaving the bar after close and went to the location for an after-set. The witness stated as they were leaving the after-set someone fired shots and ultimately struck the victim. The witness stated she recognized the suspect from the after-set party. Detectives described the inside of the location to be a night club. The renter stated to detectives he is in the process of updating the building with the intent to open a night club/bar. Officers and detectives filed reports regarding this incident. This is a violation of s.108-5 of the code.

The City of Milwaukee has determined that the unlicensed sale or distribution of alcohol beverages and the operation of public entertainment by individuals or entities that have not applied for or received, or are not eligible for, the appropriate licenses or permits as required by code, particularly when these activities take place on premises not zoned for commercial activities, constitute a public nuisance.

This letter is notice to you that the cost of future enforcement of any subsequent after set activity engaged in by a person associated with the premises, as defined by s. 80-11 of the code, at least fourteen days after the issuance of this notice may be assessed and collected as a special charge against the premises.

If you are billed for the costs of enforcement relating to 3 or more separate occurrences of after set activities within one year, you may be issued a citation of not less than \$1,000 nor more than \$5,000 after notification by the chief of police that the premises is a chronic after set premises due to your failure to abate the after set activities.

Thank you,

JEFFREY NORMAN
CHIEF OF POLICE



RAYMOND BRATCHETT
DISTRICT COMMANDER

c: Deputy Chief
District Alderperson
Department of Neighborhood Services
City Clerk, License Division
Milwaukee Police Department, License Investigation Unit
City Attorney's Office, Assistant City Attorney Heather Hechimovich Hough

Objecting
License

objector:

Milwaukee 53208

don't know of any such business

it's OK

REDACTED RECORD



NOTICE OF PUBLIC INTEREST

New License Application Filed

CURRENT OCCUPANT

MILWAUKEE, WI 53208-3307

REDACTED RECORD

Pursuant to Milwaukee Code of Ordinances, notice is hereby given that the following new retail establishment license application has been filed with the Office of the City Clerk-License Division:

License Type(s):	Class A Malt & Class A Liquor and Food Dealer- Retail Convenience
Applicant:	Pakeeta L. Skeets, Agt. Rock & Roll Variety Shop LLC
Business Name:	Rock & Roll Variety Shop
Premise Address:	802 N 35th St

This applicant is filing new Class A Malt & Class A Liquor and Food Dealer- Retail Convenience applications at this location.

A Class A Malt & Class A Liquor license allows for both intoxicating liquor and fermented malt beverages to be sold, bartered or given away in any quantity and in the original packages.

A Food Dealer- Retail Convenience Store license allows for at least one of the following (1) Has as its primary business the sale of basic food items and in addition sells household products. (2) A filling station that sells basic food items and in addition sells household products. (3) Contains less than 5,000 square feet of retail sales space.

For more information regarding licensing please visit www.milwaukee.gov/license.

HOW TO SUBMIT OBJECTIONS:

Written objections to the granting of the license based on the proposed operation of the license premises should be submitted immediately by any interested party to the Office of the City Clerk-License Division, City Hall, Room 105, 200 East Wells Street, Milwaukee, WI 53202, or via email to license@milwaukee.gov.

WHAT TO SUBMIT IN OBJECTIONS:

Written objections must include the following information:

1. Name of the person objecting.
2. Contact information for the objector. (Mailing or Email address)
3. Information personally known to the objector that may form a basis for denial of the license application. Such information should relate to the manner in which the operation of the proposed premises will have an adverse impact on the health, safety, and welfare of the public and the neighborhood.

Monday, March 13, 2023

CITY OF MILWAUKEE
 LICENSE DIVISION
 2023 MAR 21 P 2:56

MILWAUKEE POLICE DEPARTMENT LICENSING

CRIMINAL RECORD/ORDINANCE VIOLATION/INCIDENTS SYNOPSIS

DATE: 05/31/23

LICENSE TYPE: CLASS A

NEW:

RENEWAL:

No. 349082

Application Date:

License Location: 802 N. 35th St

Business Name: Rock & Roll Variety Shop

Licensee/Applicant: Skeets, Pakeeta L.
(Last Name, First Name, MI)

Date of Birth: 03/25/68

Home Address: 4440 W Olive St

City: Milwaukee

State: WI **Zip Code:** 53216

Home Phone:

This report is written by Police Officer Penny Monreal, assigned to the License Investigation Unit, Days.

The Milwaukee Police Department's investigation regarding this application revealed the following:

1. On 04/19/23, Milwaukee Police conducted a business check at Rock & Roll Variety Shot, located at 802 N. 35th St. On arrival officers observed a Neon Open sign illuminated in the window. Officers spoke to the manager on scene who stated they have been open for several weeks and identified the owner as the above listed agent. The officers observed shoes and clothes as well as tobacco products offered for sale. An officer checked with LIRA and it was determined there were no licenses or permits to operate. A Wisconsin Department of Revenue Agent confiscated several amounts of tobacco products.

Milwaukee Police Department

749 W. State Street Milwaukee, WI 53233

414-933-4444

Case #:231090092

OtherEvent #: 23-LP-1187

Incident

802 N 35TH ST MILWAUKEE, WISCONSIN 53208

Incident Date/Time:: 04/19/2023 12:39:00
CAD Number:: 231090715
District:: 3
Beat:: 350
Reporting Area:: 4506

Business Agent (2)

WATKINS, BOBBY J

Person Involvement: (Must choose Agent
AGENT from drop down):
DOB:: 08/18/1990
Sex:: MALE
Race:: BLACK/AFRICAN AMERICAN
Phone 1 Number:: (414)-763-4028
Phone 1 Type:: Phone
Address:: 4611 N 69TH ST
City:: MILWAUKEE
State:: WISCONSIN
Zip Code:: 53218

SKEETS, PAKEETA LAJOYCE

Person Involvement: (Must choose Agent
AGENT from drop down):
DOB:: 03/25/1968
Sex:: FEMALE
Race:: BLACK/AFRICAN AMERICAN
Phone 1 Number:: (414)-517-9037
Phone 1 Type:: Phone
Address:: 4440 W OLIVE ST
City:: MILWAUKEE
State:: WISCONSIN
Zip Code:: 53216

Milwaukee Police Department

749 W. State Street Milwaukee, WI 53233

414-933-4444

Case #:231090092

OtherEvent #: 23-LP-1187

Licensed Persons Involved (3)

MUNGON, OBRYAN MAURICE JR

Person Involvement:: Manager
DOB:: 12/18/2001
Sex:: MALE
Race:: BLACK/AFRICAN AMERICAN
Address:: 404 BAY HEIGHTS DR # F
City:: SOUTH MILWAUKEE
State:: WISCONSIN
Zip Code:: 53172

BLACKSHIRE, AZARIAH L

Person Involvement:: Employee
DOB:: 01/27/2002
Sex:: FEMALE
Race:: BLACK/AFRICAN AMERICAN
Address:: 6407 N 54TH ST
Apartment or Suite:: 2
City:: MILWAUKEE
State:: WISCONSIN
Zip Code:: 53223

HUGHES, ZAMUIRA RENEE

Person Involvement:: Employee
DOB:: 03/13/2001
Sex:: FEMALE
Race:: BLACK/AFRICAN AMERICAN
Address:: 5647 N 67TH ST
City:: MILWAUKEE
State:: WISCONSIN
Zip Code:: 53218

Licensed Premise Data (1)

ROCK & ROLL VARIETY SHOP LLC

Address:: 802 N 35TH ST
City:: MILWAUKEE
State:: WISCONSIN
Zip Code:: 53208
Licensee Notification Was Made:: No
Business Was Cited For Violation:: No
Licensee was cooperative: (If not explain in narrative): No
Licensee or Manager was on premises at time of violation/incident:: No

Milwaukee Police Department

749 W. State Street Milwaukee, WI 53233

414-933-4444

Case #:231090092

OtherEvent #: 23-LP-1187

Narrative (1)

LICENSED PREMISE REPORT

Cruz, Jonathan A 026041

04/23/2023

This report is being typed by Police Officer Jonathan CRUZ assigned to District Three Modified Early Shift.

On Wednesday April 19, 2023 I was assigned to Squad 3274, and conducted a business check of Rock N. Roll Variety Shop located at 802 N. 35th St.

Squad 3271, Police Officer Taylor CARLONI assisted me in a business check.

The business had a bright neon "Open" sign that was lit and activated in the front window of the business.

I spoke to the manager of the business identified as Obryan Maurice MUNGON (B/M 12-18-01) who stated that the business has been open for several weeks. MUNGON stated the business is opened from 10am-8pm all days of the week. MUNGON stated the owners of the business were identified as Bobby Jo WATKINS and PAKEETA L. SKEETS(B/F 03-25-68).

I observed shoes on the walls and clothes on the tables in the middle of the room. There was snacks, hookah pipes, tobacco products including but not limited to Black and Mild's, nicotine vape devices, cigarettes.

P.O. CARLONI checked the City of Milwaukee Website that revealed that there was no business license(S) listed to the address of the business 802 N. 35th St.

Squad 3264, Police Officer Ordlyn SANDERS and Squad 3272 Police Officer Demetrius HUDSON arrived on scene.

P.O. HUDSON spoke to Special Agent Ashley Schnering WI Department of Revenue Alcohol & Tobacco Enforcement

Employees on scene:

Azariah L. BLACKSHIRE
(B/F 01-27-02)
3251 S. 99th St.
Milwaukee WI, 53227
(414)499-8871
Sales associate

Zamaira R. HUGHES
(B/F 03-13-01)
5647 N. 67th St.
Milwaukee, WI 53218
(414)349-7555

Milwaukee Police Department

749 W. State Street Milwaukee, WI 53233

414-933-4444

Case #:231090092

OtherEvent #: 23-LP-1187

Sales associate

Special Agent Ashley Schnering WI Department of Revenue Alcohol & Tobacco arrived on scene and conducted a field report for illegal tobacco sales.

Special Agent Ashley Schnering confiscated several amounts of tobacco products and gave MUNGON a property receipt from the WI Department of Revenue Alcohol & Tobacco Enforcement.

End of report

Officer (2)		
-------------	--	--

Reporting Officer:	Cruz, Jonathan A (026041)	04/23/2023 18:44:00
Section: (Work Location):	32	
Approving Officer:	Byers, Gregory A (014713)	04/23/2023 18:53:34
Section: (Work Location):	32	

Date: 06/02/2023
Officer: Carloni

City of Milwaukee Police Department
90-5-1.5 Crime Prevention Survey
Convenience Store/Liquor Store Inspection

Name of Premise: Rock and Roll Variety Shop
Address: 802 N 35th Street
Phone: 414-212-8616

Owner: Pakeeta Skeets
Owner address: 4440 W Olive Street
City State Zip: Milwaukee, WI 53016
Owner Phone: 414-517-9039
Owner email: pakeetawatkins@gmail.com

Manager: Pakeeta Skeets
Home Address: 4440 W Olive Street
City State Zip: Milwaukee, WI 53016
Phone: 414-517-9039
Email: pakeetawatkins@gmail.com

Preferred contact: 414-517-9039

Location currently open: YES NO

Projected open date: N/A

Day's open: S M T W Th F SA ALL

Hours of Operation: Sun: Closed 24 hours Y N
Mon: 10:00am-7:00pm
Tue: 10:00am-7:00pm
Wed: 10:00am-7:00pm
Thu: 10:00am-7:00pm
Fri: 10:00am-7:00pm
Sat: 10:00am-7:00pm

Premise Type: Liquor Store
Convenience Store
Other:

Licenses currently held:

- Alcohol: Yes No Class: #:
Tobacco: Yes No #:
Food: Yes No #:
Extended Hours: Yes No #:
Secondhand Dealer: Yes No Type: #:
Other: Yes No Type: #:
Other: Yes No Type: #:

Exterior Survey:

1. Is the area around the location clean? Yes No
2. What surrounds the location? (Check all the apply)
 - a. Park
 - b. School
 - c. Youth Center
 - d. Church
 - e. Tavern(s) If so, how many
 - f. Residential
 - g. Other businesses
 - h. Other:
3. Can you see from the outside of the location into the interior Yes No
4. Can you see the employees inside of the location from the outside Yes No
5. Are exterior windows free of signage Yes No
6. Is there a parking lot Yes No
7. Is the parking lot clean? Yes No
8. Is the parking lot well lit? Yes No
9. Are there areas where a person could conceal themselves Yes No
10. Is there exterior lighting? Yes No. Does it appears to be adequate Yes No
11. Exterior Payphone? Yes No
12. Are there No Loitering Signs posted? Yes No
13. Are there exterior security cameras Yes No How Many: 2
14. Are the address numbers prominently displayed and easy to see Yes No

Camera Survey:

15. Does this location have security cameras? Yes No
16. Are they in working order? Yes No
17. What format are the cameras?
 - a. Color Yes No
 - b. Digital Yes No
 - c. VCR Yes No
 - d. Recorded Yes No
18. How long is footage stored for later viewing: Unknown
19. Are there exterior cameras Yes No How many: 3
20. Are there interior cameras Yes No How many: 2
21. Do all employees know how to retrieve recorded digital images/footage? Yes No

Interior Survey:

22. Is the storeowner willing to be a standing complainant regarding loitering? Yes No
a. If yes have them fill out the standing complaint form and give them two of the commercial signs Yes No
23. Is the interior of the location neat and clean? Yes No
24. Does an interior camera face the entrance/exit? Yes No
25. Is there a lockable area that separates employees from customers? Yes No
26. Does the store sell single chore boy? Yes No
27. Does the store sell blunt wraps? Yes No
28. Does the store sell scales? Yes No
29. Does the store sell items that may be used as crack pipes? Yes No
a. Describe item
30. Does the store have an over abundance of sandwich baggies: Yes No
31. Does the owner understand that these items are often used for drug use? Yes No
32. Do the products in the store appear to be new and rotated often? Yes No
33. Are emergency and non-emergency numbers posted near the phone? Yes No
34. Does the owner know how to contact their police district directly? Yes No
a. Did you provide a district contact guide to the owner? Yes No

Complete this section if alcohol establishment is a convenience store:

(** Read full ordinance for all details "68-4.3 Convenience Food Stores")

All convenience food stores not exempted under sub. 3 shall:

1. Is the cash register located in a manner so that at the time of a sales transaction, the employee and customer are both visible from the sidewalk? Yes No **
2. Are the glass entrance and exit doors clear of any signs or advertisements with the exception of a sign which states that the cash register contains \$50 or less and that the safe is no accessible to employees? Yes No
3. Does the store maintain one of the following on the licensed premise:
 - a. A safe that was in use at the convenience food store on August 17, 1994? Yes No
 - b. A drop-safe or time release safe that weighs at least 500 pounds or which is attached to or set into the floor in a manner approved by the police department? Yes No
4. Is lighting provided for the store's parking area during all hours of darkness when employees or customers are on the premises at a minimum average of 2-foot candles per square foot, unless the store is not open for business after sunset and before sunrise? Yes No N/A
5. Are at least two high-resolution surveillance security cameras installed? Yes No
6. Are the security cameras in working order? Yes No
7. Does one camera show an overall view of the counter and register area? Yes No
8. Does one camera show a clear, identifiable, full frame image of the face of each person entering and leaving the store? Yes No
9. Are the camera views obstructed by fixtures or displays? Yes No
10. Is the recorded footage stored for at least 30 days? Yes No
11. Do all store employees know how to record footage from the camera system to media capable of being transferred to police custody? Yes No

12. Are customer entrances/exits made of glass or other transparent material? Yes No
a. Exception: A store that does not have such doors on August 17, 1994 shall not be required to install such doors until the holder of the store's food dealer license changes.
13. Has the owner and their employees attended the Robbery Prevention Training within 120 days of ownership or employment? Yes No
a. Contact Community Outreach and Education at 935-7836 for schedule.

Sub 3. Exemptions. The requirements of this section do not apply to a convenience food store that conforms to either of the following descriptions:

- a-1. The store is located in an enclosed shopping structure, enclosed commercial building or hospital. A convenience food store is not in an enclosed structure or building if a customer can enter it directly from the outside.
Does store conform to a-1 Yes No
- a-2. The store physically separates employees from customers with a solid partition that bars a person from entering the employee area from the customer area, has a secure lock on the employee side of any door between the employee area and the customer, and conducts all transaction through a service window or similar arrangement.
Does store conform to a-2 Yes No
- a. At the commissioner's discretion, a convenience store may be exempted from any or all of the regulations specified in sub 2.
Does this location hold an exemption from the commissioner regarding any of the requirements of Sub 2? Yes No

ADDITIONAL COMMENTS/RECOMMENDATIONS:

- Did not know how to access the cameras or have the password for the system
- Received complaints about possible drug dealing at the store
- License Premise report filed for previous check (DOR responded and took tobacco products) case number 23-109-0092

Area of Interest (AOI) Information

Area : 21,862,585.39 ft²

Mar 13 2023 12:02:51 Central Daylight Time

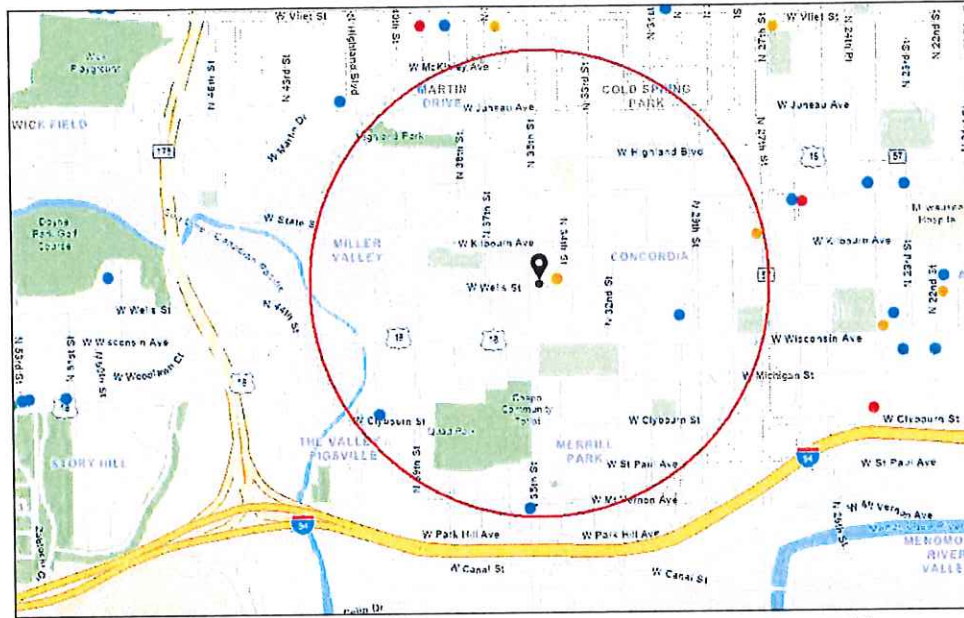

- Alcohol Licenses (active)
- Class A Fermented Malt Beverage
- Class B Fermented Malt Beverage
- Class A Liquor and Malt
- Class B Tavern
- Class C Wine Retailer
- ▭ City Limits

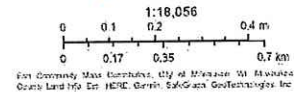

Summary

Name	Count	Area(ft ²)	Length(mi)
Alcohol Licenses	6		

Alcohol Licenses

#	Legal Entity	Trade Name	Licensee	Address	License Type Name	Total Capacity	Expiration Date	Count
1	MIDTOWN II	MIDTOWN II	NASSIF E MADI, SP	3420-24 W WELLS ST	Class A Fermented Malt Beverage Retailer's License		3/18/2023, 7:00 PM	1
2	TRIPOLI TEMPLE	TRIPOLI TEMPLE	Peter F Hennig, Agt	3000 W WISCONSIN AV	Class B Tavern License	1,089	5/25/2023, 7:00 PM	1
3	M N Supermarket Inc	Kilbourn Supermarket	DAVINDER SINGH, Agt	901 N 27th ST	Class A Fermented Malt Beverage Retailer's License		5/25/2023, 7:00 PM	1
4	JJH VALLEY INN, LLC	VALLEY INN	JAMES J HUTTERER, Agt	4000 W CLYBOURN ST	Class B Tavern License	72	9/23/2023, 7:00 PM	1
5	TJ'S ON 35TH ST	TJ'S ON 35TH ST	TOMMIE L JONES, SP	237 N 35TH ST	Class B Tavern License	50	10/17/2023, 7:00 PM	1
6	MIDTOWN II	MIDTOWN II	NASSIF E MADI, SP	3420-24 W WELLS ST	Class A Fermented Malt Beverage Retailer's License		3/18/2024, 7:00 PM	1

Establishments within a 0.5 miles radius centered on area of interest.



Wednesday, August 23, 2023



Notice of Public Hearing

Blank Notice

SKEETS, Pakeeta L, Agent
Rock & Roll Variety Shop at 802 N 35TH St
Class A Malt & Class A Liquor and Food Dealer License Applications

Wednesday, September 06, 2023 at 9:55 AM

To whom it may concern:

The above application has been made by the above named applicant(s). This requires approval from the Licenses Committee and the Common Council of the City of Milwaukee. The hearing before the Licenses Committee will take place on 9/6/2023 at 9:55 AM in Room 301-B, Third Floor, City Hall. This is a public hearing. Those wishing to view the proceeding are able to do so via the City Channel – Channel 25 on Spectrum Cable – or on the Internet at <http://city.milwaukee.gov/citychannel>. Those wishing to provide oral testimony via phone or internet are asked to contact the staff assistant, Yadira Melendez at (414) 286-2775 or stasst5@milwaukee.gov for necessary information. Please make such requests no later than one business day prior to the start of the meeting. You are not required to attend the hearing, but please see the information below if you would like to provide testimony. Once the Licenses Committee makes its recommendation, this recommendation is forwarded to the full Common Council for approval at its next regularly scheduled hearing.

Important details for those wishing to provide information for the Licenses Committee to consider when making its recommendation:

1. The license application is scheduled to be heard at the above time. Due to other hearings running longer than scheduled, you may have to wait some time to provide your testimony.
2. You must appear in person and testify as to matters that you have personally experienced or seen. (You cannot provide testimony for your neighbor, parent or anyone else; this is considered hearsay and cannot be considered by the committee.)
3. No letters or petitions can be accepted by the committee (unless the person who wrote the letter or the persons who signed the petition are present at the committee hearing and willing to testify).
4. Persons opposed to the license application are given the opportunity to testify first; supporters may testify after the opponents have finished.
5. When you are called to testify, you will be sworn in and asked to give your name, and address. (If your first and/or last names are uncommon please spell them.)
6. You may then provide testimony.
 - a. Include only information relating to the above license application.
 - b. Include only information you have personally witnessed or seen.
 - c. Provide concise and relevant information detailing how this business has affected or may affect the peaceful enjoyment of your neighborhood.
 - d. If by the time you have the opportunity to testify, the information you wish to share has already been provided to the committee, you may state that you agree with the previous testimony. Redundant or repetitive testimony will not assist the committee in making its recommendation.
7. After giving your testimony, the members of the Licenses Committee and the licensee may ask questions regarding the testimony you have given or other factors relating to the license application.
8. Business Competition is not a valid basis for denial or non-renewal of a license.

Please Note: If you have submitted an objection to the above application your objection cannot be considered by the committee unless you personally testify at the hearing.

CURRENT OCCUPANT	834 N 35TH ST# 302	MILWAUKEE, WI 53208-3307
CURRENT OCCUPANT	834 N 35TH ST# 303	MILWAUKEE, WI 53208-3307
CURRENT OCCUPANT	834 N 35TH ST# 304	MILWAUKEE, WI 53208-3307
CURRENT OCCUPANT	834 N 35TH ST# 305	MILWAUKEE, WI 53208-3307
CURRENT OCCUPANT	834 N 35TH ST# 306	MILWAUKEE, WI 53208-3307
CURRENT OCCUPANT	834 N 35TH ST# 307	MILWAUKEE, WI 53208-3307
CURRENT OCCUPANT	834 N 35TH ST# 308	MILWAUKEE, WI 53208-3307
CURRENT OCCUPANT	834 N 35TH ST# 309	MILWAUKEE, WI 53208-3307

Blank Notice

Total Records: 101

Radius 250.0 feet and Center of the Circle: 802 N 35th St



BUSINESS LICENSE PLAN OF OPERATION

ccl-busplan 5/12/2020

Office of the City Clerk License Division
200 E. Wells St. Room 105, Milwaukee, WI 53202
(414) 286-2238 www.milwaukee.gov/license e-mail address: license@milwaukee.gov

1. Type of Business

Applying for: Extended Hours (12AM to 5AM) - If a food establishment, check all that apply: Delivery Drive Thru Dining Room
 Self Service Laundry Massage Establishment Filling Station
 Other (supplemental application for specific license also required)

Provide a detailed description of the type of business you plan on operating: VARIETY STORE that sells CIGARETTES & TOYS, SNACKS, CANDY, TOYS ect...

Do you have any experience operating this type of business? No Yes If yes, explain: worked at a store before

2. Business Operations

- a. Proposed Opening Date: 3-25-2023
- b. Is this premise under construction? No Yes If yes, list estimated completion date: _____
- c. Is this a franchise? No Yes
- d. Is this premises currently licensed? No Yes If yes, list type of license: _____
- e. Is the current licensee operating? No Yes If no, list date closed: _____
- f. Do you have future plans for other businesses, licenses or permits at this location? No Yes
If yes, explain: Food sales grocery
- g. Have you previously held an Extended Hours License in Milwaukee? No Yes
If yes, list address(es): _____
- h. Are other businesses operating in the same building? No Yes If yes, describe: _____

3. Litter & Noise

- a. How are grounds kept clean? Sweep Pressure Wash Pick Up Litter Other: _____
- b. How often will grounds be cleaned? Daily Weekly As Needed Monthly Other: _____
- c. Grounds cleaned by: Licensee Building Owner Employees Hired Maintenance Other: _____
- d. How are noise issues prevented and/or addressed? Security Manager approaches customer(s) Call Police
 Signs Posted Other: _____
- e. Will a sound amplification system be used? No Yes If yes, describe: _____

4. Smoking & Sanitation

- a. Are there designated outdoor smoking areas? No Yes If yes, describe: _____
- b. Number of Garbage Cans: Inside: 1 Locations: by the front door
Outside: 1 Locations: the back of the building
- c. Is a crowd control barrier used? No Yes If yes, describe: _____
- d. How many restrooms are on the premises? 0
- e. Name of solid waste contractor: Advanced Disposal Waste Management Other: city of Milwaukee

5. Security

- a. Are there onsite parking spaces? No Yes If yes, how many? _____ and describe the parking security plan: _____
- b. Is there a loading zone? No Yes If yes, describe the loading area security plan: _____
- c. Will you have security personnel on premise? No Yes If yes, how many? _____ and answer the following:
 What are their responsibilities? _____
 Is security equipment used? No Yes If yes, describe cameras
 List their licensing, certification, or training credentials _____
- d. Will there be security cameras? No Yes If yes, how many? 8 and list locations: 4 outside
4 inside
- e. Will searches/identification checks be done upon entry? No Yes If yes, describe cop cigarettes or Alcohol

6. Percentage of Sales (must total 100%)

Alcohol <u>25</u> %	Food <u>50</u> %	Secondhand Merchandise <u>0</u> %	Precious Metals & Gems _____ %
Entertainment _____ %	Cigarettes <u>25</u> %	Personal Services (such as tattoo, body piercing, salon, tailor, tanning, etc.) _____ %	Other _____ % Describe: _____
Pawnbroker Activity _____ %	Salvaged Materials _____ % (such as scrap metal)		

7. Businesses/Licenses on the Premises (check all that apply):

Type 1

- Full Service Restaurant Cafe/Coffee Shop Deli or Fast Food Restaurant Private/Fraternal/Veterans Club
- Night Club Tavern Cocktail Lounge Teen Club
- Banquet Hall Sports Facility Bowling Alley
- Hotel/Motel : Number of Floors: _____ Rooming House: Number of Floors: _____
 Number of Rooms: _____ Number of Rooms: _____

Type 2

- Liquor Store Corner Store Supermarket Convenience Store
- Gas Station Amusement/Phonograph Distributor Recycling, Salvage or Towing
- Used Car Dealer Personal Service Establishment
(such as tattoo business, hair salon, tailor, etc.) Recording Studio

What other licenses/permits will you hold at this location? (check all that apply)

- Occupancy Permit Cigarette & Tobacco Gas Station Extended Hours Class "B" Tavern Weights & Measures
- Secondhand Dealer Precious Metal & Gem Other: Liquor

8. Legal Capacity (only if a Type 1 premises in #7 above)

Capacity _____ (Call the Milwaukee Development Center at 414-286-8211 if you have questions.)

9. Premises Description

- a. Identify all area(s) of the premises that will be used in operating this business (include areas used only for storage):
 1st Floor 2nd Floor Basement Storage Patio Beer Garden Sidewalk Café Deck Rooftop
 Other: Describe: _____
- b. Describe Location: Major Thoroughfare Secondary Street Other: 35th St.
- c. Nearest Major Cross Street: Wells
- d. Describe Building: Free Standing Building Strip Mall Other: _____
- e. Describe Premises Structure: Single Story Multi-Story - # of Stories _____ Other: _____
- f. Describe Surrounding Area: Commercial Residential Industrial Other: Mix Use
- g. Building Owner Name: McLcom (Manager) Phone Number: 262-298-2528
 Building Owner Address: _____

10. Hours of Operation & Customers

Will customers be entering the premises? No Yes

Day of the Week	Proposed Hours of Operation:		Estimated Number of Customers expected each day	Potential Age Range of Customers	Class B Tavern Applicant Only: Age Restriction (If none, write 'None')
	Open Time (include a.m. or p.m.)	Close Time (include a.m. or p.m.)			
Sunday	9 AM	9 PM	25-100	25-100	NONE
Monday	9 AM	9 PM	25-100	25-100	NONE
Tuesday	9 AM	9 PM	25-100	25-100	NONE
Wednesday	9 AM	9 PM	25-100	25-100	NONE
Thursday	9 AM	9 PM	25-100	25-100	NONE
Friday	9 AM	9 PM	25-100	25-100	NONE
Saturday	9 AM	9 PM	25-100	25-100	NONE

An Extended Hours Establishment License is required for any convenience store, filling station, personal service establishment (such as tattoo, body piercing, salon, tailor, tanning, etc.), recording studio or restaurant which is open between the hours of 12:00 a.m. and 5:00 a.m.

Alcohol Establishments Class A: 8:00 am to 9:00 pm Sunday thru Saturday
 Permitted Hours of Operation: Class B: 6:00 am to 2:00 am Sunday thru Thursday, 6:00 am to 2:30 am Friday & Saturday

Entertainment Outdoor Closing Hours: 10:00pm Sunday-Thursday; 12:00am Friday & Saturday; unless a different time, either earlier or later, is established by the Common Council in its approval of the licensee's plan of operation.

11. Signature(s)

Raketa Shuk
 Signature of Sole Proprietor, Partner, or 20% or more Shareholder
 (If there are no 20% or more shareholders,
 Corporate Officer-print name/title and sign)

 Signature of additional partner or 20% or more shareholder

See Application Information for a complete list of all required application forms.



ALCOHOL BEVERAGE & PUBLIC ENTERTAINMENT PREMISES SUPPLEMENTAL APPLICATION

Office of the City Clerk License Division
200 E. Wells St. Room 105, Milwaukee, WI 53202
(414) 286-2238 e-mail address: license@milwaukee.gov www.milwaukee.gov/license

Legal Entity Name: <u>Rock & Roll Valley Shop LLC</u>
Premise Address: <u>802 N 35th St, Milwaukee</u>
Proximity of Premises to Church, School, Daycare Center or Hospital
Is the building within 300 feet of any church, school, daycare center or hospital? <input checked="" type="checkbox"/> No <input type="checkbox"/> Yes
"Service Bar Only" Designation
If applying for Class B or C license, are you applying for "Service Bar Only"? <input checked="" type="checkbox"/> No <input type="checkbox"/> Yes Service Bar Only means customers cannot sit at the bar. Alcohol is served to employees who serve patrons seated at tables. No stools, chairs or other articles of furniture shall be placed at the service bar for patrons to sit upon.
Business Information
a) Are you taking out this application for anyone that may not be eligible for a license? <input checked="" type="checkbox"/> No <input type="checkbox"/> Yes If yes, list their name and address: _____
b) Will the agent, a partner or the individual licensee be conducting the day-to-day operations of the business? <input type="checkbox"/> No <input checked="" type="checkbox"/> Yes If no, list the name and address of the person(s) who will: _____
Class B Applicants: If the agent, a partner or the individual licensee will not be conducting the day-to-day operations of the business, the person(s) listed above must obtain a Class B Managers license.
c) Does anyone else have money invested or any other interest in this business? <input checked="" type="checkbox"/> No <input type="checkbox"/> Yes If yes, explain: _____
d) Have you made an agreement with anyone to repay any loan or any other payments based upon income from the business? <input checked="" type="checkbox"/> No <input type="checkbox"/> Yes If yes, list name and address: _____
Property Information (New & Transfer Applicants Only)
a) Do you own or lease the building? <input type="checkbox"/> Own <input checked="" type="checkbox"/> Lease
b) Who owns the fixtures (for example, coolers, etc.)? <u>LANDLORD</u>
c) Are you purchasing the stock and/or fixtures? <input type="checkbox"/> No <input checked="" type="checkbox"/> Yes If yes, amount paid \$ <u>15,000</u>
d) Total amount paid for business <u>\$0.00</u>
e) Total amount paid for goodwill of the business <u>\$0.00</u>
Goodwill comprises the reputation and customer relationships of an existing business. If the price you pay for the business exceeds the fair market value of all of the rest of the assets of the business, the excess may be considered goodwill.
f) Have you made arrangements with the seller for payment of personal property taxes? <input checked="" type="checkbox"/> No <input type="checkbox"/> Yes
Lease Information (New & Transfer Applicants who are leasing the premises only)
a) Date lease begins <u>02-1-2023</u> Ends <u>02-1-2024</u>
b) Monthly rental <u>\$900.00</u>
c) Do you have an option to renew the lease? <input type="checkbox"/> No <input checked="" type="checkbox"/> Yes
d) Does your lease allow for assignment to another party without the consent of the owner? <input checked="" type="checkbox"/> No <input type="checkbox"/> Yes
e) For what length of time have you been guaranteed occupancy (number of years)? <u>1</u>

Lease Information (Continued)

- f) In addition to paying the monthly rental, will you have to pay anything additional to the owner of the building to guarantee performance of the lease? No Yes If yes, explain _____
- g) Does the present owner or occupant object to the granting of your license? No Yes
If yes, explain _____

Change of Agent Applicants Only

Have there been any changes to the floor plan since the last application was submitted? No Yes
If no, a new floor plan is not required. If yes, submit a new floor plan and explain the change(s):

Signature

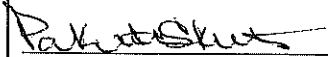

Signature of Sole Proprietor, Partner or 20% or More Shareholder
(If no 20% or more Shareholder, Corporate Officer - print name/title and sign)

Note: All information contained in this application is subject to approval by the Common Council.
Deviating from approved plan of operation will subject licensee to citations, and/or suspension or non-renewal of the license.
Contact the License Division for information on how to request changes.

New and transfer of premises applicants must submit the following:

- Detailed floor plan
 If a restaurant, copy of the menu



FOOD DEALER LICENSE PLAN OF OPERATION

cci-foodplan 2/28/19

OFFICE OF THE CITY CLERK, LICENSE DIVISION
CITY HALL, 200 E. WELLS ST, ROOM 105, MILWAUKEE, WI 53202
(414) 286-2238 • license@milwaukee.gov • www.milwaukee.gov/license

Legal Entity Name: Rock & Roll Variety Shop LLC

Premises Address: 802 N 35th St Milwaukee WI 53208

SECTION 1 TYPE OF BUSINESS

What will be the majority of your food sales? (check one)

Restaurant Items (meals):

MEALS include, but are not limited to, chicken, ribs, sandwiches, roasted corn, baked potatoes, hot dogs, brats, tacos, nachos w/ cheese and meat, French fries, cooked or deep fried vegetables/fruit, cooked cheese curds, corn dogs, egg rolls, salads.

Retail Items (snacks and beverages):

RETAIL items include, but are not limited to, ice cream/soft serve, lemonade, snow cones, coffee, espresso, cappuccino, tea, fruit juice, smoothies, candy, dispensed soda, fruit cups, bakery, cookies, kettle corn, cotton candy, funnel cakes, fritters, tortilla chips w/ cheese.

Will it be a convenience store? Yes No

A convenience store contains less than 5,000 square feet of retail space and has, as its primary business, the sale of basic food items and in addition, sells household products or is a filling station that sells basic food items and household products.

Bed & Breakfast

Micro Market

All Applicants: Submit a menu or a list of food items that will be sold.

Will any wholesale business be done? No Yes If yes, what percentage of food sales will be wholesale?

Less than 25%

25% or More AND:

Restaurant items (meals) will be sold – Complete this application and also contact DATCP.

NO restaurant items (meals) will be sold - Do NOT complete this application. Contact DATCP only.

SECTION 2 FOOD PROCESSING

Will any food processing be done? No Yes

Processing is defined as assembling, grinding, cutting, mixing, baking, coating, stuffing, packing, bottling, grilling, canning, extracting, fermenting, distilling, pickling, freezing, drying, smoking, or packaging.

SECTION 3 FOOD REQUIRING TEMPERATURE CONTROL

Will any food that requires temperature control be sold? No Yes
(includes dairy products such as milk, cheese, and ice cream, fish, shellfish, meat, poultry)

If yes, list the types of food items: Milk Ice Cream Freeze Pops & GAPP

SECTION 4 DETAILS OF OPERATION

Will you have seating on site for dining? No Yes

Will you be doing any catering? No Yes

Will you be doing any delivery? No Yes

Will you have outdoor activities? No Yes - Check all that apply: Bar Cooking/Grilling Dining

Will you have a drive thru window? No Yes - Are hours different from inside? No Yes
 If Yes, provide drive thru hours: _____

Will scales or barcode scanners be used? No Yes - You must also apply for a Weights & Measures License.

SECTION 5 ADDITIONAL SITES

Where will food be prepared and/or sold? 20

At a single site At multiple sites: How many? _____ (for example, a hotel with several dining rooms or bars)

If multiple sites, attach a Food Dealer Additional Site Addendum (ccl-foodadd) for each additional site.

SECTION 6 CONSTRUCTION OR CHANGES

Are you planning any construction, remodeling or equipment changes?

No If No, SKIP to Section 8

Yes If Yes, check all that apply: New construction of a building Renovation or remodeling
 Construction changes to existing building Equipment changes only

Provide a brief description of the changes: _____

Start date: _____

Name, Address & Phone Number of Architect: _____

Name, Address & Phone Number of Contractor: _____

SECTION 7 ALCOHOL BEVERAGES

Are you applying for an alcohol beverage license?

No If No, SKIP to Section 9

Yes If YES, if your food license is approved prior to the alcohol license, when do you want the food license issued?
 Immediately At the same time as the alcohol license

SECTION 8 ACKNOWLEDGEMENTS & SIGNATURE

You must initial each item confirming your understanding:

PS I understand the Health Department must conduct an inspection and advise the License Division of their approval before the license may be issued.

PS I understand I must obtain an occupancy permit from the Department of Neighborhood Services and an inspection may be required. Neighborhood Services must advise the License Division of their approval before the license may be issued.

PS I understand the district alderperson will review and either support or object to my application. If he/she objects, I may appeal and be scheduled to appear before the Licenses Committee. The Licenses Committee will then make a recommendation to the Common Council. The Common Council must grant the license before it may be issued.

PS I understand proof of payment for all license fees must be on file in the License Division before the license may be issued and the license must be issued and posted in my establishment prior to opening for business.

PS I will not operate my food business until the license has been issued and posted in the establishment.

Signature of Sole Proprietor, Partner, or 20% Shareholder Paketa Sheets

Signature of Additional Partner: _____

DUMPSTER

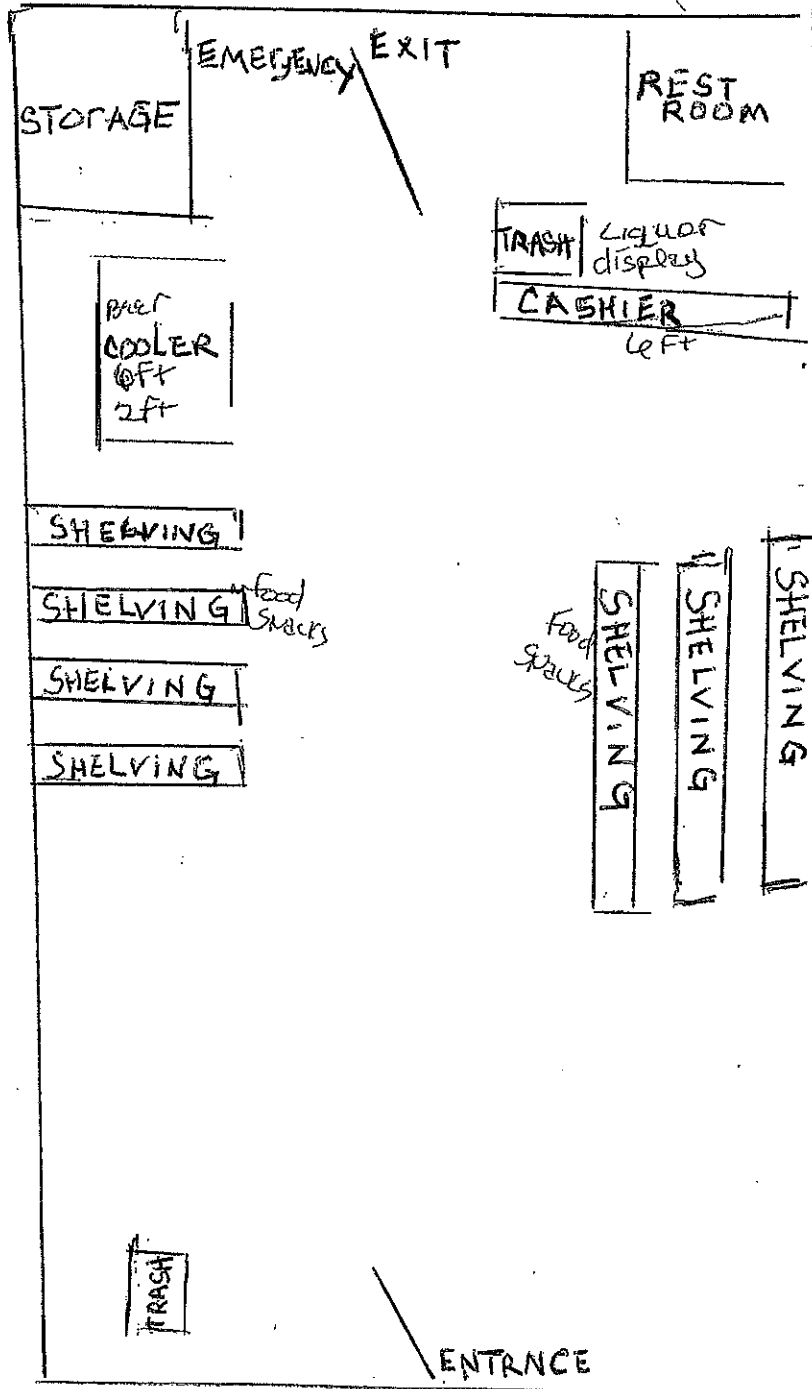

WEEDS
40x20

Rock & Roll Variety Shop LLC

Paketa Seests

ROCK & ROLL VARIETY SHOP
802 N. 35TH ST.
MILWAUKEE WI, 53200

~~20x40~~

35 ST.

800 SQ FT

03-13-2023