

DCO # 2390

CERTIFIED SURVEY MAP NO.

BEING A DIVISION OF LOTS 34, 35 AND 36, BLOCK 15, OGDEN'S SUBDIVISION, LOT 14, IN ASSESSMENT SUBDIVISION NO. 9 AND LANDS LOCATED IN THE SOUTHEAST 1/4 OF THE NORTHWEST 1/4 OF SECTION 19, TOWN 7 NORTH, RANGE 22 EAST IN THE CITY OF MILWAUKEE, MILWAUKEE COUNTY, WISCONSIN.

TAX KEY NO. 350-0023-100, -2513-100, -2513-120 & -2515-100

ZONING: RT 4

MEEHAN AND SOMER'S SUBDIVISION

OGDEN'S SUBDIVISION

DEDICATED TO THE CITY OF MILWAUKEE FOR PUBLIC ALLEY PURPOSES (831.3 Sq. Ft.)

PUBLIC ALLEY

(EAST REC.)

82.48'

52.61'

52.61'

107.63'

48.30'

48.30'

48.30'

30.00'

LOT 8, BLOCK 15 MEEHAN AND SOMER'S SUBDIVISION

N00°50'55"W 107.63'

N00°50'14"W 107.55'

N00°50'14"W 107.46'

S00°51'25"E 107.37'

N. 23rd ST. (60' WIDE PUBLIC R-O-W)

OUTLOT 1  
4,134.9 Sq. Ft.

PARCEL 1  
5,142.7 Sq. Ft.

PARCEL 2  
5,140.4 Sq. Ft.

PARCEL 2  
5,140.4 Sq. Ft.

38.47'

48.30'

48.30'

48.34'

30.00'

NORTH

NO DIRECT VEHICULAR ACCESS

BROWN ST.

(60' WIDE PUBLIC R-O-W)

THE SW CORN. OF THE NW 1/4 OF SECT. 19-7-22 conc. mon. w/ brass cap N: 390,630.35 E: 2,548,538.37

THE SOUTH LINE OF THE NORTHWEST 1/4 OF SECTION 19-7-22

N89°11'18"E 2,650.65'

S89°11'18"W 994.46'

THE SE CORN. OF THE NW 1/4 OF SECT. 19-7-22 conc. mon. w/ brass cap N: 390,667.90 E: 2,551,188.53

GRAPHIC SCALE



( IN FEET )  
1 inch = 40 ft.

SURVEYING ASSOCIATES, INC.

2554 N. 100th STREET  
WAUWATOSA, WI. 53226  
PHN 414-257-2212  
FAX 414-257-2443

INSTRUMENT DRAFTED BY: TRACI L. ZUPKE

JOB NO. 30118 CSM

SHEET 1 OF 3

INFRASTRUCTURE SERVICES DIVISION

*Marcia Lindholm* 9/15/04  
CENTRAL DRAFTING & RECORDS MANAGER

*Al Martin* 9/15/04  
ENGINEER IN CHARGE

*Traci L. Zupke* 9/16/04  
CITY ENGINEER

APPROVED

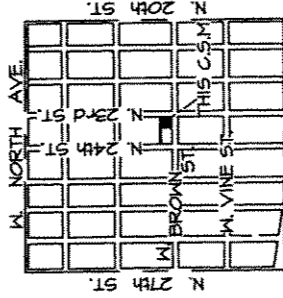

CERTIFIED SURVEY MAP NO. \_\_\_\_\_

BEING A DIVISION OF LOTS 34, 35 AND 36, BLOCK 15, OGDEN'S SUBDIVISION, LOT 14, IN ASSESSMENT SUBDIVISION NO. 9 AND LANDS LOCATED IN THE SOUTHEAST ¼ OF THE NORTHWEST ¼ OF SECTION 19, TOWN 7 NORTH, RANGE 22 EAST IN THE CITY OF MILWAUKEE, MILWAUKEE COUNTY, WISCONSIN.

**SURVEYOR'S CERTIFICATE**  
**STATE OF WISCONSIN)**  
**MILWAUKEE COUNTY)SS**

I, Frederick W. Shibilski, a registered land surveyor do hereby certify:

That I have surveyed, divided and mapped Lots 34, 35 and 36, Block 15, Ogden's Subdivision, Lot 14, in Assessment Subdivision No. 9 and lands located in the Southeast ¼ of the Northwest ¼ of Section 19, Town 7 North, Range 22 East in the City of Milwaukee, Milwaukee County, Wisconsin, bounded and described as follows: Commencing at the Southeast corner of the Northwest ¼ of Section 19; thence South 89° 11' 18" West along the South line of said ¼ Section 994.46 feet; thence North 00° 51' 25" West, 1,156.14 feet; thence South 89° 14' 18" West, 30.00 feet to the point of beginning of the land to be described; thence South 89° 14' 18" West, 135.11 feet; thence North 00° 50' 55" West, 107.63 feet to a point on the South line of a 15 foot wide public alley; thence North 89° 20' 44" East, along said South line 82.48 feet; thence North 00° 51' 25" West, 12.00 feet; thence North 89° 20' 44" East, 52.61 feet, to a point on the West right-of-way line of North 23<sup>rd</sup> Street; thence South 00° 51' 25" East, 119.37 feet to the point of beginning.

That I have made such survey, land division and map by the direction of the City of Milwaukee, owner of said land.

That this map is a correct representation of all exterior boundaries of land surveyed and the land division thereof made.

That I have fully complied with the provisions of Chapter 236 of the Wisconsin Statutes and Chapter 119 of the Milwaukee Code in surveying, dividing and mapping the same.

Dated this 11<sup>th</sup> day of May 2004.

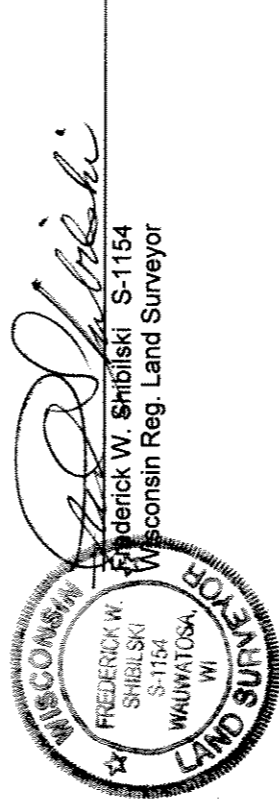

**CORPORATE OWNERS CERTIFICATE:**

The City of Milwaukee, a corporation duly organized and existing under and by virtue of the laws of the State of Wisconsin as owner, does hereby certify that said corporation caused the land described on this map to be surveyed, divided, mapped and dedicated as represented on this map in accordance with the requirements of Chapter 119 of the Milwaukee Code of Ordinances.

In consideration of the approval of this map by the Common Council, and in accordance with Chapter 119 of the Milwaukee Code of Ordinances, the undersigned agrees:

- a. That all utility lines to provide electric power and telephone services and cable television or communications systems lines or cables to all parcels in the certified survey map shall be installed underground in easements provided therefor, where feasible.
- b. That direct vehicular access from portions of Outlot 1 and Parcel 1, to West Brown Street, is prohibited as delineated on the attached map.

This agreement shall be binding on the undersigned and assigns.

IN WITNESS WHEREOF, the said City of Milwaukee has caused these presents to be signed by Tom Barrett, its Mayor and countersigned by Ronald D. Leonhardt, its City Clerk, at Milwaukee, Wisconsin, on this \_\_\_\_\_ day of \_\_\_\_\_, 2004.

In the Presence of:

Scott Ford  
\_\_\_\_\_  
\_\_\_\_\_

The City of Milwaukee

Tom Barrett  
Tom Barrett, Mayor  
Ronald D. Leonhardt  
Ronald D. Leonhardt, City Clerk

CERTIFIED SURVEY MAP NO. \_\_\_\_\_

BEING A DIVISION OF LOTS 34, 35 AND 36, BLOCK 15, OGDEN'S SUBDIVISION, LOT 14, IN ASSESSMENT SUBDIVISION NO. 9 AND LANDS LOCATED IN THE SOUTHEAST ¼ OF THE NORTHWEST ¼ OF SECTION 19, TOWN 7 NORTH, RANGE 22 EAST IN THE CITY OF MILWAUKEE, MILWAUKEE COUNTY, WISCONSIN.

CORPORATE OWNERS CERTIFICATE (CONTINUED):

STATE OF WISCONSIN)  
MILWAUKEE COUNTY)SS

Personally came before me this 27th day of October, 2004, the above named Tom Barrett, Mayor of the above named Corporation, to me known to be the person who executed the foregoing instrument and to me known to be such ~~Mayor~~ <sup>Mayor</sup> of said Corporation and acknowledged that he executed the foregoing instrument as such officer ~~and~~ <sup>of</sup> said Corporation by its authority.

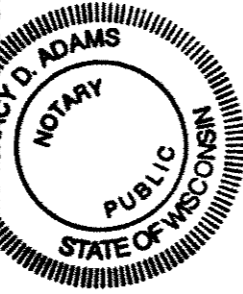

Traci P. Adams  
Notary Public, State of Wisconsin  
My Commission expires July 2, 2006

STATE OF WISCONSIN)  
MILWAUKEE COUNTY)SS

Personally came before me this \_\_\_\_\_ day of \_\_\_\_\_, 2004, the above named Ronald D. Leonhardt, City Clerk, of the above named Corporation, to me known to be the person who executed the foregoing instrument and to me known to be such City Clerk of said Corporation and acknowledged that he executed the foregoing instrument as such officer as the deed of said Corporation by its authority.

\_\_\_\_\_  
Notary Public, State of Wisconsin  
My Commission expires \_\_\_\_\_

CERTIFICATE OF CITY TREASURER  
STATE OF WISCONSIN)  
MILWAUKEE COUNTY)SS

I, Wayne F. Whittow, being the duly elected, qualified and acting City Treasurer of the City of Milwaukee, certify that in accordance with the records in the Office of the City Treasurer of the City of Milwaukee there are no unpaid taxes or unpaid special assessments on the land included in this Certified Survey Map.

Date: 9-22-04 \_\_\_\_\_  
Wayne F. Whittow, City Treasurer

COMMON COUNCIL CERTIFICATE OF APPROVAL

I certify that this Certified Survey Map was approved under Resolution File No. 040796, adopted by the Common Council of the City of Milwaukee on October 11, 2004.

Ronald D. Leonhardt  
Ronald D. Leonhardt, City Clerk  
Tom Barrett  
Tom Barrett, Mayor

