



CITY OF MILWAUKEE  
OFFICE OF THE CITY CLERK

Wednesday, October 28, 2020

COMMITTEE MEETING NOTICE

AD 08

ALMAADHEEDI, Khashea J, Agent  
KJ Food Mart LLC  
2039 W GREENFIELD AV

Milwaukee, WI 53204

You are requested to attend a virtual hearing to be held on:

**Tuesday, November 10, 2020 at 10:35 AM**

**Regarding:** Your Class A Malt License Application and Food Dealer License Renewal Application as agent for "KJ Food Mart LLC" for "Happy Face Food Mart" at 2039 W GREENFIELD Av.

This meeting will be held via GoToMeeting. Please see the enclosed best practices document for further instructions. The access code is <https://global.gotomeeting.com/join/560140757>. If you wish to call in, please call +1 (571) 317-3122 and use Access Code: 560-140-757.

There is a possibility that your application may be denied for one or more of the following reasons: The recommendation of the committee regarding the application shall be based on evidence presented at the hearing. Per MCO 85-2.7-4, probative evidence concerning whether or not a new license should be granted may be presented on the following subjects: whether or not the applicant meets the municipal requirements, the appropriateness of the location and premises where the licensed premises is to be located and whether use of the premises for the purposes or activities permitted by the license would tend to facilitate a public or private nuisance or create undesirable neighborhood problems such as disorderly patrons, unreasonably loud noise, litter, and excessive traffic and parking congestion. Probative evidence relating to these matters may be taken from the plan of operation submitted with the license application, if any, but shall not include the content of any music. Evidence regarding the fitness of the location of the premises to be maintained as the principal place of business, including but not limited to whether there is an overconcentration of businesses of the type for which the license is sought; whether the proposal is consistent with any pertinent neighborhood business or development plans, or the location's proximity to areas where children are typically present. The applicant's record in operating similarly licensed premises; and whether or not the applicant has been charged with or convicted of any felony, misdemeanor, municipal offense or other offense, the circumstances of which substantially relate to the activity to be permitted by the license being applied for or any other factor which reasonably relates to the public health, safety or welfare may also be considered. See attached police report or correspondence.

**Notice for applicants with warrants or unpaid fines:** Proof of warrant satisfaction or payment of fines must be submitted at the hearing on the above date and time. Failure to comply with this requirement may result in a delay of the granting/denial of your application.

Failure to attend this meeting may result in the denial of your license. Individual applicants and partnership applicants must attend or attend by an attorney. The agent or attorney for corporate or limited liability applicants must attend. If you wish to do so and at your own expense, you may be accompanied by an attorney of your choosing to represent you at this hearing.

You will be given an opportunity to speak on behalf of the application and to respond and challenge any charges or reasons given for the denial. No petitions can be accepted by the committee, unless the people who signed the petition attend the virtual hearing and are willing to testify. You may present witnesses under oath and you may also confront and cross-examine opposing witnesses under oath. If you have difficulty with the English language, you should request an interpreter attend the meeting with you, at your expense, so that you can answer questions and participate in your hearing.

PLEASE NOTE: Upon reasonable notice, efforts will be made to accommodate the needs of disabled individuals through sign language interpreters or other auxiliary aids. For additional information or to request this service, contact the Council Services Division ADA Coordinator at (414) 286-2998, Fax - (414) 286-3456, TDD - (414) 286-2025.

JIM OWCZARSKI, CITY CLERK

BY:

\_\_\_\_\_  
Jessica Celella  
License Division Manager

If you have questions regarding this meeting, please contact the staff assistant, Molly Kuether-Steele at (414) 286-2775 or [molly.kuether-steele@milwaukee.gov](mailto:molly.kuether-steele@milwaukee.gov).

200 E. Wells Street, Room 105, City Hall, Milwaukee, WI 53202. [www.milwaukee.gov/license](http://www.milwaukee.gov/license)  
Phone: (414) 286-2238 Fax: (414) 286-3057 Email Address: [License@milwaukee.gov](mailto:License@milwaukee.gov)



CITY OF MILWAUKEE  
OFFICE OF THE CITY CLERK

Wednesday, October 28, 2020

COMMITTEE MEETING NOTICE

AD 08

ALMAADHEEDI, Khashea J, Agent  
KJ Food Mart LLC  
8396 S Chicago Rd #115

Oak Creek, WI 53154

You are requested to attend a virtual hearing to be held on:

**Tuesday, November 10, 2020 at 10:35 AM**

**Regarding:** Your Class A Malt License Application and Food Dealer License Renewal Application as agent for "KJ Food Mart LLC" for "Happy Face Food Mart" at 2039 W GREENFIELD Av.

This meeting will be held via GoToMeeting. Please see the enclosed best practices document for further instructions. The access code is <https://global.gotomeeting.com/join/560140757>. If you wish to call in, please call +1 (571) 317-3122 and use Access Code: 560-140-757.

There is a possibility that your application may be denied for one or more of the following reasons: The recommendation of the committee regarding the application shall be based on evidence presented at the hearing. Per MCO 85-2.7-4, probative evidence concerning whether or not a new license should be granted may be presented on the following subjects: whether or not the applicant meets the municipal requirements, the appropriateness of the location and premises where the licensed premises is to be located and whether use of the premises for the purposes or activities permitted by the license would tend to facilitate a public or private nuisance or create undesirable neighborhood problems such as disorderly patrons, unreasonably loud noise, litter, and excessive traffic and parking congestion. Probative evidence relating to these matters may be taken from the plan of operation submitted with the license application, if any, but shall not include the content of any music. Evidence regarding the fitness of the location of the premises to be maintained as the principal place of business, including but not limited to whether there is an overconcentration of businesses of the type for which the license is sought; whether the proposal is consistent with any pertinent neighborhood business or development plans, or the location's proximity to areas where children are typically present. The applicant's record in operating similarly licensed premises; and whether or not the applicant has been charged with or convicted of any felony, misdemeanor, municipal offense or other offense, the circumstances of which substantially relate to the activity to be permitted by the license being applied for or any other factor which reasonably relates to the public health, safety or welfare may also be considered. See attached police report or correspondence.

**Notice for applicants with warrants or unpaid fines:**

Proof of warrant satisfaction or payment of fines must be submitted at the hearing on the above date and time. Failure to comply with this requirement may result in a delay of the granting/denial of your application.

Failure to attend this meeting may result in the denial of your license. Individual applicants and partnership applicants must attend or attend by an attorney. The agent or attorney for corporate or limited liability applicants must attend. If you wish to do so and at your own expense, you may be accompanied by an attorney of your choosing to represent you at this hearing.

You will be given an opportunity to speak on behalf of the application and to respond and challenge any charges or reasons given for the denial. No petitions can be accepted by the committee, unless the people who signed the petition attend the virtual hearing and are willing to testify. You may present witnesses under oath and you may also confront and cross-examine opposing witnesses under oath. If you have difficulty with the English language, you should request an interpreter attend the meeting with you, at your expense, so that you can answer questions and participate in your hearing.

PLEASE NOTE: Upon reasonable notice, efforts will be made to accommodate the needs of disabled individuals through sign language interpreters or other auxiliary aids. For additional information or to request this service, contact the Council Services Division ADA Coordinator at (414) 286-2998, Fax - (414) 286-3456, TDD - (414) 286-2025.

JIM OWCZARSKI, CITY CLERK

BY: \_\_\_\_\_

Jessica Celella  
License Division Manager

If you have questions regarding this meeting, please contact the staff assistant, Molly Kuether-Steele at (414) 286-2775 or [molly.kuether-steele@milwaukee.gov](mailto:molly.kuether-steele@milwaukee.gov).

200 E. Wells Street, Room 105, City Hall, Milwaukee, WI 53202. [www.milwaukee.gov/license](http://www.milwaukee.gov/license)  
Phone: (414) 286-2238 Fax: (414) 286-3057 Email Address: [License@milwaukee.gov](mailto:License@milwaukee.gov)

Date:10/15/20  
Officer: Vodicka

City of Milwaukee Police Department  
90-5-1.5 Crime Prevention Survey  
Convenience Store/Liquor Store Inspection

Name of Premise: KJ Food Mart  
Address: 2039 W Greenfield Av  
Phone: 414-334-8472

Owner: Khashea J Almaadheedi`  
Owner address: 814 Manitowoc Av  
City State Zip: South Milwaukee, WI 53172  
Owner Phone: 414-334-8472  
Owner email: khashaa94@gmail.com

Manager: Same  
Home Address:  
City State Zip:  
Phone:  
Email:

Preferred contact: Same

Location currently open:  YES  NO

Projected open date:

Day's open: S M T W Th F SA ALL

Hours of Operation: Sun: 10a-9p 24 hours Y N  
Mon: 9a-9p  
Tue: "  
Wed: "  
Thu: "  
Fri: "  
Sat: "

Premise Type: Liquor Store  
Convenience Store  
Other:

Licenses currently held:

- Alcohol:  Yes  No Class: #:  
Tobacco:  Yes  No #: 1028988  
Food:  Yes  No #: 10679  
Extended Hours:  Yes  No #:  
Secondhand Dealer:  Yes  No Type: #:  
Other:  Yes  No Type: #:  
Other:  Yes  No Type: #:

**Exterior Survey:**

1. Is the area around the location clean?  Yes  No
2. What surrounds the location? (Check all the apply)
  - a.  Park
  - b.  School
  - c.  Youth Center
  - d.  Church
  - e.  Tavern(s) If so, how many
  - f.  Residential
  - g.  Other businesses
  - h.  Other:
3. Can you see from the outside of the location into the interior  Yes  No
4. Can you see the employees inside of the location from the outside  Yes  No
5. Are exterior windows free of signage  Yes  No
6. Is there a parking lot  Yes  No
7. Is the parking lot clean?  Yes  No
8. Is the parking lot well lit?  Yes  No
9. Are there areas where a person could conceal themselves  Yes  No
10. Is there exterior lighting?  Yes  No. Does it appears to be adequate  Yes  No
11. Exterior Payphone?  Yes  No
12. Are there No Loitering Signs posted?  Yes  No
13. Are there exterior security cameras  Yes  No How Many: 3
14. Are the address numbers prominently displayed and easy to see  Yes  No

**Camera Survey:**

15. Does this location have security cameras?  Yes  No
16. Are they in working order?  Yes  No
17. What format are the cameras?
  - a. Color  Yes  No
  - b. Digital  Yes  No
  - c. VCR  Yes  No
  - d. Recorded  Yes  No
18. How long is footage stored for later viewing: 2 months
19. Are there exterior cameras  Yes  No How many: 3
20. Are there interior cameras  Yes  No How many: 7
21. Do all employees know how to retrieve recorded digital images/footage?  Yes  No

**Interior Survey:**

22. Is the storeowner willing to be a standing complainant regarding loitering?  Yes  No  
a. If yes have them fill out the standing complaint form and give them two of the commercial signs  Yes  No
23. Is the interior of the location neat and clean?  Yes  No
24. Does an interior camera face the entrance/exit?  Yes  No
25. Is there a lockable area that separates employees from customers?  Yes  No
26. Does the store sell single chore boy?  Yes  No
27. Does the store sell blunt wraps?  Yes  No
28. Does the store sell scales?  Yes  No
29. Does the store sell items that may be used as crack pipes?  Yes  No  
a. Describe item glass pipes
30. Does the store have an over abundance of sandwich baggies:  Yes  No
31. Does the owner understand that these items are often used for drug use?  Yes  No
32. Do the products in the store appear to be new and rotated often?  Yes  No
33. Are emergency and non-emergency numbers posted near the phone?  Yes  No
34. Does the owner know how to contact their police district directly?  Yes  No  
a. Did you provide a district contact guide to the owner?  Yes  No

**Complete this section if alcohol establishment is a convenience store:**

(\*\* Read full ordinance for all details "68-4.3 Convenience Food Stores")

All convenience food stores not exempted under sub. 3 shall:

1. Is the cash register located in a manner so that at the time of a sales transaction, the employee and customer are both visible from the sidewalk?  Yes  No \*\*
2. Are the glass entrance and exit doors clear of any signs or advertisements with the exception of a sign which states that the cash register contains \$50 or less and that the safe is no accessible to employees?  Yes  No
3. Does the store maintain one of the following on the licensed premise:
  - a. A safe that was in use at the convenience food store on August 17, 1994?  Yes  No
  - b. A drop-safe or time release safe that weighs at least 500 pounds or which is attached to or set into the floor in a manner approved by the police department?  Yes  No
4. Is lighting provided for the store's parking area during all hours of darkness when employees or customers are on the premises at a minimum average of 2-foot candles per square foot, unless the store is not open for business after sunset and before sunrise?  Yes  No  N/A
5. Are at least two high-resolution surveillance security cameras installed?  Yes  No
6. Are the security cameras in working order?  Yes  No
7. Does one camera show an overall view of the counter and register area?  Yes  No
8. Does one camera show a clear, identifiable, full frame image of the face of each person entering and leaving the store?  Yes  No
9. Are the camera views obstructed by fixtures or displays?  Yes  No
10. Is the recorded footage stored for at least 30 days?  Yes  No
11. Do all store employees know how to record footage from the camera system to media capable of being transferred to police custody?  Yes  No

12. Are customer entrances/exits made of glass or other transparent material?  Yes  No  
a. Exception: A store that does not have such doors on August 17, 1994 shall not be required to install such doors until the holder of the store's food dealer license changes.
13. Has the owner and their employees attended the Robbery Prevention Training within 120 days of ownership or employment?  Yes  No  
a. Contact Community Outreach and Education at 935-7836 for schedule.

**Sub 3. Exemptions.** The requirements of this section do not apply to a convenience food store that conforms to either of the following descriptions:

- a-1. The store is located in an enclosed shopping structure, enclosed commercial building or hospital. A convenience food store is not in an enclosed structure or building if a customer can enter it directly from the outside.  
Does store conform to a-1  Yes  No
- a-2. The store physically separates employees from customers with a solid partition that bars a person from entering the employee area from the customer area, has a secure lock on the employee side of any door between the employee area and the customer, and conducts all transactions through a service window or similar arrangement.  
Does store conform to a-2  Yes  No
- a. At the commissioner's discretion, a convenience store may be exempted from any or all of the regulations specified in sub 2.  
Does this location hold an exemption from the commissioner regarding any of the requirements of Sub 2?  Yes  No

**ADDITIONAL COMMENTS/RECOMMENDATIONS:**

Door is partially covered in COVID -19 signage



# Concentration Map

2039 W Greenfield Av

Area : 21,862,585.55 ft<sup>2</sup>

Sep 21 2020 13:02:02 Central Daylight Time

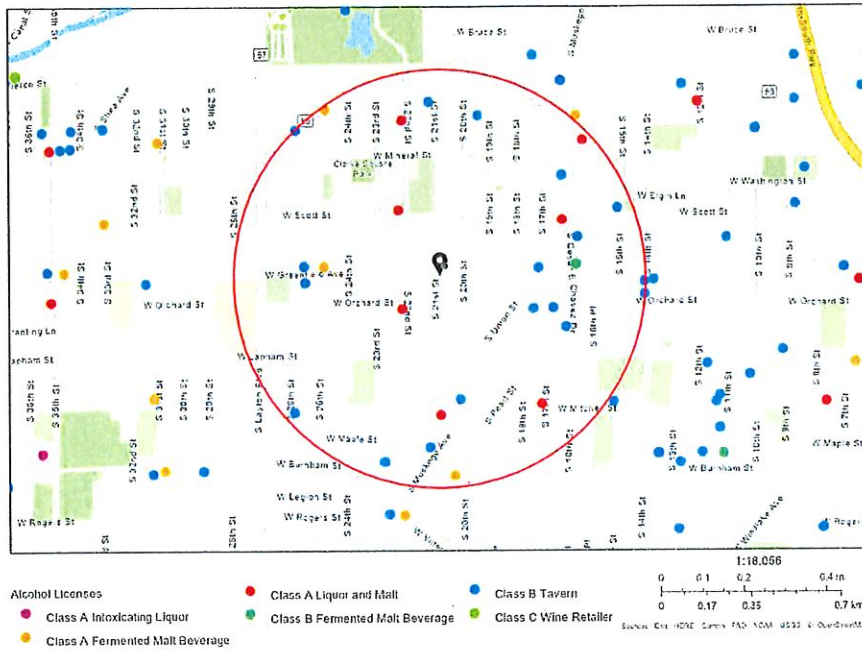

Summary

Name	Count	Area(ft <sup>2</sup> )	Length(mi)
Alcohol Licenses	29		

Alcohol Licenses



#	Legal Entity	Trade Name	Licensee	Address	License Type Name	Total Capacity	Expiration Date	Count
1	BETO'S PIZZA LLC	Beto's Pizza LLC	Jair A Varela-Caballero, Agt	1234 S CESAR E CHAVEZ DR	Class B Tavern License		3/1/2021, 6:00 PM	1
2	SCHULIST TAP	SCHULIST TAP	DAVID SCHULIST, SP	2539 W MITCHELL ST	Class B Tavern License	49	3/22/2021, 7:00 PM	1
3	EL Inferno LLC	EL Inferno	ANTONIO MARTINEZ, Agt	2000 W Mitchell ST	Class B Tavern License		11/24/2020, 6:00 PM	1
4	APPLE TWO, LLC	EL CHARRO LIQUOR STORE	VIKRAMJIT SINGH, Agt	1207 S CESAR E CHAVEZ DR	Class A Malt & Class A Liquor License		12/19/2020, 6:00 PM	1
5	La Caleta LLC	La Caleta Restaurant & Bar	Monica Hernandez-Gaspar, Agt	1801 S Muskego AV	Class B Tavern License		11/27/2020, 6:00 PM	1
6	Mann Family, LLC	Orchard Food Mart	Jatinder K Mann, Agt	2201 W ORCHARD ST	Class A Malt & Class A Liquor License		12/15/2020, 6:00 PM	1
7	VILLA'S RESTAURANT	VILLA'S RESTAURANT	ALFREDO O VILLA, SP	2522 W GREENFIELD AV	Class B Tavern License		9/26/2020, 7:00 PM	1
8	TAQUERIA EL JALAPENO	TAQUERIA EL JALAPENO	ANGEL GUTIERREZ GARNICA, SP	2106 W NATIONAL AV	Class B Tavern License	61	9/25/2020, 7:00 PM	1
9	El Barril	El Barril	JOSE L TERRONES, SP	1400 W ORCHARD ST	Class B Tavern License	59	6/13/2021, 7:00 PM	1
10	Cafe Playa, LLC	Cafe Playa	Edwin C Valentin, Agt	1330 S Cesar E Chavez DR	Class B Fermented Malt Beverage Retailer's License		6/13/2021, 7:00 PM	1
11	PHANS GARDEN, INC	PHAN'S GARDEN	HOI T TRAN, Agt	1923 W NATIONAL AV	Class B Tavern License	240	10/17/2020, 7:00 PM	1
12	CANTARITOS BAR, LLC	Passion Nightclub	FRANCISCO GOMEZ-ORTIZ, Agt	1566-1570 S MUSKEGO AV	Class B Tavern License	52	10/10/2020, 7:00 PM	1
13	ABC EMPIRE LLC	ABC Food and Liquor	Mohamad D Kattoum, Agt	1143 S 22nd ST	Class A Malt & Class A Liquor License		12/31/2020, 6:00 PM	1
14	VILLA'S PLACE	VILLA'S PLACE	ALFREDO O VILLA, SP	1700 W GREENFIELD AV	Class B Tavern License	25	2/4/2021, 6:00 PM	1
15	EL REY SPIRITS, INC	EL REY SPIRITS, INC	ERNESTO VILLARREAL, Agt	916 S CESAR E CHAVEZ DR	Class A Malt & Class A Liquor License		6/29/2021, 7:00 PM	1
16	MC Jimenez LLC	Candelas	Martin Jimenez Segura, Agt	2537 W National AV	Class B Tavern License	99	7/4/2021, 7:00 PM	1
17	Mi Pais LLC	Mi Pais	GRACIELA HERNANDEZ, Agt	1401 W GREENFIELD AV	Class B Tavern License		9/28/2020, 7:00 PM	1
18	TEQUILA NIGHT CLUB	TEQUILA NIGHT CLUB	GUSTAVO GUIZAR, JR, SP	1460 S MUSKEGO AV	Class B Tavern License	168	11/7/2020, 6:00 PM	1
19	Century Beverage Group LLC	Don Julio's	Maria J Ramirez, Agt	1537 S CESAR E CHAVEZ DR	Class B Tavern License	80	10/22/2020, 7:00 PM	1

20	TEDDY'S INCOME, INC	SHARI'S STILL	SHERYL L LARSON, Agt	1834 S 23RD ST	Class B Tavern License	49	1/20/2021, 6:00 PM	1
21	RICHARD'S GROCERY	RICHARD'S GROCERY	NADER A ASAD, SP	2438 W GREENFIELD AV	Class A Fermented Malt Beverage Retailer's License		3/3/2021, 6:00 PM	1
22	Gunny Food Mart Inc	Gunny Food Mart	MANPREET KAUR, Agt	2033 W Mitchell ST	Class A Malt & Class A Liquor License		2/26/2021, 6:00 PM	1
23	Swan Inc	Kwik Stop	Ishwor Ghimire, Agt	2434 W NATIONAL AV	Class A Fermented Malt Beverage Retailer's License		6/29/2021, 7:00 PM	1
24	Debbie Coops LLC	The Tool Box	Debra J Torres, Agt	1500 W Scott ST	Class B Tavern License		7/31/2021, 7:00 PM	1
25	Harjodh, Inc	Mi Pueblo	Harpreet S Chawla, Agt	1700 W MITCHELL ST	Class A Malt & Class A Liquor License		10/23/2020, 7:00 PM	1
26	GOODSPOT, LLC	GOODSPOT FOODS	MAZEN T MUSTAFA, Agt	2201 W NATIONAL AV	Class A Malt & Class A Liquor License		11/25/2020, 6:00 PM	1
27	JALISCO RESTAURANT, LLC	JALISCO RESTAURANT	CARLOS E CASERES, Agt	1035 S CESAR E CHAVEZ DR	Class B Tavern License	128	11/23/2020, 6:00 PM	1
28	Starlite Beer & Food, Inc.	Starlite Food	GURMUKH SINGH, Agt	2013 W Burnham ST	Class A Fermented Malt Beverage Retailer's License		4/20/2021, 7:00 PM	1
29	Patricia Herrera de Castro, LLC	La Fondita	Felipe Castro Pena, Agt	2523 W GREENFIELD AV	Class B Tavern License		9/4/2021, 7:00 PM	1

Establishments within a 0.5 miles radius centered on area of interest.

# MILWAUKEE POLICE DEPARTMENT LICENSING

## CRIMINAL RECORD/ORDINANCE VIOLATION/INCIDENTS SYNOPSIS

**DATE:** 10/19/2020  
**LICENSE TYPE:** FOOD  
**NEW:**   
**RENEWAL:**

**No. 315979**  
**Application Date:** 10/15/2020

**License Location:** 2039 W Greenfield Av  
**Business Name:** KJ Food Mart

**Licensee/Applicant:** ALMAADHEEDI, Khashea J  
(Last Name, First Name, MI)  
**Date of Birth:** 09/01/1995

**Home Address:** 814 Manitowac Av  
**City:** South Milwaukee **State:** WI **Zip Code:** 53172  
**Home Phone:**

This report is written by Police Officer David Novak, assigned to the License Investigation Unit, Days.

The Milwaukee Police Department's investigation regarding this application revealed the following:

1. On 10/01/2020 officers investigated a Strong Arm Robbery in the area of 1400 S 21<sup>st</sup>. The officer checked the business at 2039 W. Greenfield Av for cameras that may have captured the incident. The clerk at the business did not have the code for the system but stated he called the owner to come to the scene. The owner stated he would come after he was done shopping. The owner did provide the video but was afraid the people in the neighborhood would think he was a snitch.

# Milwaukee Police Department

749 W. State Street Milwaukee, WI 53233

414-933-4444

Case #:202750125

OtherEvent #: 20-LP-0951

## Incident

### 2039 W GREENFIELD AV MILWAUKEE, WISCONSIN 53204

Incident Date/Time:: 10/01/2020 17:29:00  
CAD Number:: 202751769  
District:: 2  
Beat:: 224  
Reporting Area:: 5443

## Business Agent (1)

### ALMAADHEEDI, KHASHEA JALAL

Person Involvement: (Must choose Agent  
AGENT from drop down):  
DOB:: 09/01/1995  
Sex:: MALE  
Race:: WHITE  
Phone 1 Number:: (414)-334-8472  
Address:: 8396 CHICAGO RD  
Apartment or Suite:: 115  
City:: OAK CREEK  
State:: WISCONSIN  
Zip Code:: 53154

## Licensed Persons Involved (1)

### WILLIAMS, NATHANIEL T JR

Person Involvement:: other  
DOB:: 12/16/1961  
Sex:: MALE  
Race:: BLACK/AFRICAN AMERICAN  
Address:: 2015 W GREENFIELD AV  
City:: MILWAUKEE  
State:: WISCONSIN  
Zip Code:: 53204

## Licensed Premise Data (1)

### Grocery Mercados LLC

Phone 1 Number:: (414)-736-4090  
Phone 1 Type:: Cell  
Address:: 2039 W GREENFIELD AV  
City:: MILWAUKEE  
State:: WISCONSIN  
Zip Code:: 53204  
License Type:: Food Dealer  
Licensee Notification Was Made:: No  
Licensee Notified Date/Time:: 10/01/2020 17:29:00  
Business Was Cited For Violation:: No

# Milwaukee Police Department

749 W. State Street Milwaukee, WI 53233

414-933-4444

Case #:202750125

OtherEvent #: 20-LP-0951

Licensee was cooperative: (If not explain in narrative): No

Licensee or Manager was on premises at time of violation/incident:: No

## Narrative (1)

### INITIAL INVESTIGATION

Elm, Dakota J 026043

10/01/2020

This report is written by Police Officer Dakota ELM, assigned to District Two, Early Shift, Squad 2224 with Police Officer Adam ROBAKOWSKI.

On Thursday, October 1st, 2020 at approximately 4:26PM, My partner and I responded to a Strong arm robbery and I located cameras at 2039 W. Greenfield Av. that picked up the incident. (This address is located in the City and County of Milwaukee)

Upon arrival I spoke to the Clerk identified as Nathaniel T. WILLIAMS (B/M, 12/16/1961) who showed me where the cameras were located and helped me get to the cameras that would have picked up the incident. When I was attempting to locate evidence regarding the robbery, I was prompted with a screen that requested a password. I asked WILLIAMS if he knew the password and he stated that he did not. WILLIAMS called the owner identified as "Mike". WILLIAMS stated that "Mike" was on his way and will allow me access to the cameras. This was roughly around 4:40PM. After about an hour or so I asked WILLIAMS to call again. WILLIAMS called and put the phone on speaker. Mike answered the phone and I asked what time he would be there. Mike responded with "What!" and I restated the same question. Mike is the owner of Grocery Mercados LLC. Mike stated that he would not give me the password and would not allow me to access this camera. Mike requested me to leave the store and stated that I was scaring his customers away. It must be noted that customers did not know I was in the store until they entered. Mike stated that he was shopping at Menards shopping and wasn't going to rush over. When Mike got on scene 20 Minutes later and showed me the video of the incident. Mike stated that people are going to think he's a snitch and he believed that his store was going to get robbed by the same subjects.

End of report

## Officer (2)

Reporting Officer: Elm, Dakota J (026043) 10/01/2020 18:46:00

Section: (Work Location): 22

Approving Officer: Raden, Chad M (010032) 10/07/2020 11:38:22

Section: (Work Location): 27



Wednesday, October 28, 2020

## Licenses Committee Notice of Hearing

DOLPHIN PROPERTIES LLC  
11065 CATHEDRAL Ct  
WAUWATOSA, WI 53226

The Licenses Committee will consider the following license application:

Class A Malt License Application and Food Dealer License Renewal Application  
ALMAADHEEDI, Khashea J, Agent  
Happy Face Food Mart at 2039 W GREENFIELD Av

Date: 11/10/2020

Time: 10:35 AM

Location: The hearing before the Licenses Committee will take place virtually on Tuesday, November 10, 2020. This is a public hearing. Those wishing to view the proceeding are able to do so via the City Channel – Channel 25 on Spectrum Cable – or on the Internet at <http://city.milwaukee.gov/citychannel>. Those wishing to provide oral testimony will be asked to do so by phone or internet and are asked to contact the staff assistant, Molly Kuether-Steele at (414) 286-2775 or [molly.kuether-steele@milwaukee.gov](mailto:molly.kuether-steele@milwaukee.gov) for necessary information. Please make such requests no later than one business day prior to the start of the meeting. You are not required to attend the hearing, but please see the information below if you would like to provide testimony.

Please note this application may be recommended for denial based on fitness of the location due to concentration of alcohol beverage outlets in the area. If the application is denied for this reason, no other application for an alcohol beverage license for this location shall be recommended for approval by the Licenses Committee within three years of the date of denial unless the applicant has demonstrated a change of circumstances since the prior denial.





Wednesday, October 28, 2020



# Notice of Public Hearing

blank  
notice

---

ALMAADHEEDI, Khashea J, Agent  
Happy Face Food Mart at 2039 W GREENFIELD Av  
Class A Malt License Application and Food Dealer License Renewal Application

**Tuesday, November 10, 2020 at 10:35 AM**

To whom it may concern:

The above application has been made by the above named applicant(s). This requires approval from the Licenses Committee and the Common Council of the City of Milwaukee. The hearing before the Licenses Committee will take place virtually on 11/10/2020 at 10:35 AM. This is a public hearing. Those wishing to view the proceeding are able to do so via the City Channel – Channel 25 on Spectrum Cable – or on the Internet at <http://city.milwaukee.gov/citychannel>. Those wishing to provide oral testimony will be asked to do so by phone or internet and are asked to contact the staff assistant, Molly Kuether-Steele at (414) 286-2775 or [molly.kuether-steele@milwaukee.gov](mailto:molly.kuether-steele@milwaukee.gov) for necessary information. Please make such requests no later than one business day prior to the start of the meeting. You are not required to attend the hearing, but please see the information below if you would like to provide testimony. Once the Licenses Committee makes its recommendation, this recommendation is forwarded to the full Common Council for approval at its next regularly scheduled hearing.

---

## Important details for those wishing to provide information for the Licenses Committee to consider when making its recommendation:

1. The license application is scheduled to be heard at the above time. Due to other hearings running longer than scheduled, you may have to wait some time to provide your testimony.
2. You must testify as to matters that you have personally experienced or seen. (You cannot provide testimony for your neighbor, parent or anyone else; this is considered hearsay and cannot be considered by the committee.)
3. No letters or petitions can be accepted by the committee (unless the person who wrote the letter or the persons who signed the petition are willing to testify).
4. Persons opposed to the license application are given the opportunity to testify first; supporters may testify after the opponents have finished.
5. When you are called to testify, you will be sworn in and asked to give your name, and address. (If your first and/or last names are uncommon please spell them.)
6. You may then provide testimony.
  - a. Include only information relating to the above license application.
  - b. Include only information you have personally witnessed or seen.
  - c. Provide concise and relevant information detailing how this business has affected or may affect the peaceful enjoyment of your neighborhood.
  - d. If by the time you have the opportunity to testify, the information you wish to share has already been provided to the committee, you may state that you agree with the previous testimony. Redundant or repetitive testimony will not assist the committee in making its recommendation.
7. After giving your testimony, the members of the Licenses Committee and the licensee may ask questions regarding the testimony you have given or other factors relating to the license application.
8. Business Competition is not a valid basis for denial or non-renewal of a license.

**Please Note: If you have submitted an objection to the above application your objection cannot be considered by the committee unless you personally testify at the hearing.**

OCCUPANT	MAIL ADDRESS	CITY, STATE ZIP
CURRENT OCCUPANT	2020A W ORCHARD ST	MILWAUKEE, WI 53204
CURRENT OCCUPANT	1423 S 20TH ST	MILWAUKEE, WI 53204
CURRENT OCCUPANT	2017 W GREENFIELD AVE	MILWAUKEE, WI 53204
CURRENT OCCUPANT	2005 W GREENFIELD AVE	MILWAUKEE, WI 53204
CURRENT OCCUPANT	2016 W GREENFIELD AVE A	MILWAUKEE, WI 53204
CURRENT OCCUPANT	2018 W GREENFIELD AVE	MILWAUKEE, WI 53204
CURRENT OCCUPANT	1323 S 20TH ST	MILWAUKEE, WI 53204
CURRENT OCCUPANT	2027 W ORCHARD ST	MILWAUKEE, WI 53204
CURRENT OCCUPANT	2116 W ORCHARD ST	MILWAUKEE, WI 53204
CURRENT OCCUPANT	2100 W ORCHARD ST	MILWAUKEE, WI 53204
CURRENT OCCUPANT	2114 W GREENFIELD AVE	MILWAUKEE, WI 53204
CURRENT OCCUPANT	1337 S 21ST ST	MILWAUKEE, WI 53204
CURRENT OCCUPANT	2008 W ORCHARD ST	MILWAUKEE, WI 53204
CURRENT OCCUPANT	1437 S 20TH ST	MILWAUKEE, WI 53204
CURRENT OCCUPANT	1433 S 20TH ST	MILWAUKEE, WI 53204
CURRENT OCCUPANT	2021 W GREENFIELD AVE	MILWAUKEE, WI 53204
CURRENT OCCUPANT	2019 W GREENFIELD AVE	MILWAUKEE, WI 53204
CURRENT OCCUPANT	2028A W GREENFIELD AVE	MILWAUKEE, WI 53204
CURRENT OCCUPANT	2030 W GREENFIELD AVE	MILWAUKEE, WI 53204
CURRENT OCCUPANT	2028B W GREENFIELD AVE	MILWAUKEE, WI 53204
CURRENT OCCUPANT	2016 W GREENFIELD AVE B	MILWAUKEE, WI 53204
CURRENT OCCUPANT	2004 W GREENFIELD AVE	MILWAUKEE, WI 53204
CURRENT OCCUPANT	1417 S 21ST ST	MILWAUKEE, WI 53204
CURRENT OCCUPANT	2112 W GREENFIELD AVE	MILWAUKEE, WI 53204
CURRENT OCCUPANT	1502 S 21ST ST	MILWAUKEE, WI 53204
CURRENT OCCUPANT	1504 S 21ST ST	MILWAUKEE, WI 53204
CURRENT OCCUPANT	1429 S 20TH ST	MILWAUKEE, WI 53204
CURRENT OCCUPANT	2011 W GREENFIELD AVE	MILWAUKEE, WI 53204
CURRENT OCCUPANT	2014 W GREENFIELD AVE	MILWAUKEE, WI 53204
CURRENT OCCUPANT	1324A S 21ST ST	MILWAUKEE, WI 53204
CURRENT OCCUPANT	2029 W ORCHARD ST	MILWAUKEE, WI 53204
CURRENT OCCUPANT	1335 S 21ST ST	MILWAUKEE, WI 53204
CURRENT OCCUPANT	2020 W ORCHARD ST	MILWAUKEE, WI 53204
CURRENT OCCUPANT	2007 W GREENFIELD AVE	MILWAUKEE, WI 53204
CURRENT OCCUPANT	2016 W GREENFIELD AVE	MILWAUKEE, WI 53204
CURRENT OCCUPANT	2103 W ORCHARD ST	MILWAUKEE, WI 53204
CURRENT OCCUPANT	2112 W ORCHARD ST	MILWAUKEE, WI 53204
CURRENT OCCUPANT	2113 W GREENFIELD AVE A	MILWAUKEE, WI 53204
CURRENT OCCUPANT	2110 W GREENFIELD AVE	MILWAUKEE, WI 53204
CURRENT OCCUPANT	1337A S 21ST ST	MILWAUKEE, WI 53204
CURRENT OCCUPANT	2028 W ORCHARD ST	MILWAUKEE, WI 53204
CURRENT OCCUPANT	2015A W GREENFIELD AVE	MILWAUKEE, WI 53204
CURRENT OCCUPANT	2009A W GREENFIELD AVE	MILWAUKEE, WI 53204
CURRENT OCCUPANT	2001 W GREENFIELD AVE	MILWAUKEE, WI 53204
CURRENT OCCUPANT	2008 W GREENFIELD AVE	MILWAUKEE, WI 53204
CURRENT OCCUPANT	2102 W ORCHARD ST	MILWAUKEE, WI 53204



CURRENT OCCUPANT	1409 S 21ST ST	MILWAUKEE, WI 53204
CURRENT OCCUPANT	1323 S 21ST ST	MILWAUKEE, WI 53204
CURRENT OCCUPANT	2037 W GREENFIELD AVE	MILWAUKEE, WI 53204
CURRENT OCCUPANT	2009 W GREENFIELD AVE	MILWAUKEE, WI 53204
CURRENT OCCUPANT	2026 W GREENFIELD AVE	MILWAUKEE, WI 53204
CURRENT OCCUPANT	1324 S 21ST ST	MILWAUKEE, WI 53204
CURRENT OCCUPANT	2110 W ORCHARD ST	MILWAUKEE, WI 53204
CURRENT OCCUPANT	2116 W GREENFIELD AVE	MILWAUKEE, WI 53204
CURRENT OCCUPANT	2104 W GREENFIELD AVE	MILWAUKEE, WI 53204
CURRENT OCCUPANT	1500A S 21ST ST	MILWAUKEE, WI 53204
CURRENT OCCUPANT	2038 W ORCHARD ST	MILWAUKEE, WI 53204
CURRENT OCCUPANT	2034 W ORCHARD ST	MILWAUKEE, WI 53204
CURRENT OCCUPANT	2020B W ORCHARD ST	MILWAUKEE, WI 53204
CURRENT OCCUPANT	2012 W ORCHARD ST	MILWAUKEE, WI 53204
CURRENT OCCUPANT	2015B W GREENFIELD AVE	MILWAUKEE, WI 53204
CURRENT OCCUPANT	2005A W GREENFIELD AVE	MILWAUKEE, WI 53204
CURRENT OCCUPANT	1407 S 20TH ST	MILWAUKEE, WI 53204
CURRENT OCCUPANT	2012 W GREENFIELD AVE B	MILWAUKEE, WI 53204
CURRENT OCCUPANT	2010 W GREENFIELD AVE	MILWAUKEE, WI 53204
CURRENT OCCUPANT	2008A W GREENFIELD AVE	MILWAUKEE, WI 53204
CURRENT OCCUPANT	1323A S 20TH ST	MILWAUKEE, WI 53204
CURRENT OCCUPANT	2029A W ORCHARD ST	MILWAUKEE, WI 53204
CURRENT OCCUPANT	2120 W ORCHARD ST	MILWAUKEE, WI 53204
CURRENT OCCUPANT	2116A W ORCHARD ST	MILWAUKEE, WI 53204
CURRENT OCCUPANT	2106 W ORCHARD ST	MILWAUKEE, WI 53204
CURRENT OCCUPANT	2113 W GREENFIELD AVE B	MILWAUKEE, WI 53204
CURRENT OCCUPANT	2113 W GREENFIELD AVE	MILWAUKEE, WI 53204
CURRENT OCCUPANT	1415 S 21ST ST	MILWAUKEE, WI 53204
CURRENT OCCUPANT	1342 S 22ND ST	MILWAUKEE, WI 53204
CURRENT OCCUPANT	1327 S 21ST ST	MILWAUKEE, WI 53204
CURRENT OCCUPANT	2024A W ORCHARD ST	MILWAUKEE, WI 53204
CURRENT OCCUPANT	2024 W ORCHARD ST	MILWAUKEE, WI 53204
CURRENT OCCUPANT	2016 W ORCHARD ST	MILWAUKEE, WI 53204
CURRENT OCCUPANT	2035 W GREENFIELD AVE	MILWAUKEE, WI 53204
CURRENT OCCUPANT	2023 W GREENFIELD AVE	MILWAUKEE, WI 53204
CURRENT OCCUPANT	2012 W GREENFIELD AVE A	MILWAUKEE, WI 53204
CURRENT OCCUPANT	2023 W ORCHARD ST	MILWAUKEE, WI 53204
CURRENT OCCUPANT	1411 S 21ST ST	MILWAUKEE, WI 53204
CURRENT OCCUPANT	1331 S 21ST ST	MILWAUKEE, WI 53204
blank	notice	

Total Records: 85

Radius: 250.0 feet and Center of Circle: 2039 W Greenfield Ave



# BUSINESS LICENSE RENEWAL PLAN OF OPERATION

Office of the City Clerk License Division  
200 E. Wells St. Room 105, Milwaukee, WI 53202

Licenses to be Renewed	Renewal Fee(s)	
Food Dealer - 10679	\$575.00	Expiration Date: 1/5/2021 File By Date: 10/15/2020 Date Late Fee Begins: 10/16/2020 Late Fee Amount: \$75.00
Extended Hours -		
Filling Station -		
Cigarette & Tobacco - 1028988	\$100.00	
Weights & Measures -		
Sidewalk Dining -		
<b>TOTAL DUE</b>	<b>\$675.00</b>	

Legal Entity Name: **KJ Food Mart LLC**

Premises Address: **2039 W GREENFIELD AV**

## Changes Since Last Application?

Are there any changes in your plans to address litter, noise, and/or security?  No  Yes If yes, describe: \_\_\_\_\_

Are there any changes to the hours of operation (as listed on your current license)?  No  Yes If yes, describe: \_\_\_\_\_

Are there any changes to your current plan of operation or floor plan\*?  No  Yes If yes, describe: \_\_\_\_\_

\*If there are changes to the floor plan, a new floor plan must be submitted with this renewal application. A sample plan can be found online at [www.milwaukee.gov/licenses](http://www.milwaukee.gov/licenses) under License Forms and Related Information.

Weights & Measures Licensees Only	Sidewalk Dining:
Number/Type of Devices:  Are there any changes to the number or types of devices? <input checked="" type="checkbox"/> No <input type="checkbox"/> Yes If yes, contact our office for further instructions.	Are there any changes to the sidewalk dining site plan?  <input checked="" type="checkbox"/> No <input type="checkbox"/> Yes If Yes, submit an updated site plan with this application.

## Food Dealer Licensees Only

Your current food license includes the following business operations: **Processing, Hazardous Foods, Sales \$20,001 - \$200,000**  
Are there any changes to your plan of operation (for example, adding processing, changing sales amount or complexity, etc.)?  No  Yes  
If yes, you must complete a "Request to Modify Food Establishment/Food Operation Plan" which can be obtained at [www.milwaukee.gov/licenses](http://www.milwaukee.gov/licenses) under "Forms and Related Information" or by contacting our office.

## All Applicants: Signature

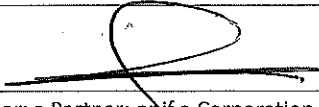
  
 \_\_\_\_\_  
 Signature of Sole Proprietor; a Partner; or if a Corporation or LLC, the Agent must sign



# BUSINESS LICENSE PLAN OF OPERATION

ccl-busplan 3/15/18

Office of the City Clerk License Division  
200 E. Wells St. Room 105, Milwaukee, WI 53202  
(414) 286-2238 www.milwaukee.gov/license e-mail address: license@milwaukee.gov

## 1. Type of Business

Applying for:  Extended Hours (12AM to 5AM) - If a food establishment, check all that apply:  Delivery  Drive Thru  Dining Room  
 Self Service Laundry  Massage Establishment  Filling Station  
 Other (supplemental application for specific license also required)

Provide a detailed description of the type of business you plan on operating:

*Beer License*

Do you have any experience operating this type of business?  No  Yes If yes, explain:

## 2. Business Operations

- a. Proposed Opening Date: 3/1/19
- b. Is this premise under construction?  No  Yes If yes, list estimated completion date: \_\_\_\_\_
- c. Is this a franchise?  No  Yes
- d. Is this premises currently licensed?  No  Yes If yes, list type of license: Food & Cigarettes
- e. Is the current licensee operating?  No  Yes If no, list date closed: \_\_\_\_\_
- f. Do you have future plans for other businesses, licenses or permits at this location?  No  Yes  
If yes, explain: \_\_\_\_\_
- g. Have you previously held an Extended Hours License in Milwaukee?  No  Yes  
If yes, list address(es): \_\_\_\_\_
- h. Are other businesses operating in the same building?  No  Yes If yes, describe: \_\_\_\_\_

## 3. Litter & Noise

- a. How are grounds kept clean?  Sweep  Pressure Wash  Pick Up Litter  Other: \_\_\_\_\_
- b. How often will grounds be cleaned?  Daily  Weekly  As Needed  Monthly  Other: \_\_\_\_\_
- c. Grounds cleaned by:  Licensee  Building Owner  Employees  Hired Maintenance  Other: \_\_\_\_\_
- d. How are noise issues prevented and/or addressed?  Security  Manager approaches customer(s)  Call Police  
 Signs Posted  Other: \_\_\_\_\_
- e. Will a sound amplification system be used?  No  Yes If yes, describe: \_\_\_\_\_

## 4. Smoking & Sanitation

- a. Are there designated outdoor smoking areas?  No  Yes If yes, describe: \_\_\_\_\_
- b. Number of Garbage Cans: Inside: 2 Locations: Main Entrance, Behind Counter  
Outside: 2 Locations: By the main door
- c. Is a crowd control barrier used?  No  Yes If yes, describe: \_\_\_\_\_
- d. How many restrooms are on the premises? 1
- e. Name of solid waste contractor:  Advanced Disposal  Waste Management  Other: \_\_\_\_\_

## 9. Premises Description

a. Identify all area(s) of the premises that will be used in operating this business (include areas used only for storage):

1<sup>st</sup> Floor  2<sup>nd</sup> Floor  Basement Storage  Patio  Beer Garden  Sidewalk Café  Deck  Rooftop

Other: Describe: \_\_\_\_\_

b. Describe Location:  Major Thoroughfare  Secondary Street  Other: \_\_\_\_\_

c. Nearest Major Cross Street: Greenfield Ave & 21st St

d. Describe Building:  Free Standing Building  Strip Mall  Other: \_\_\_\_\_

e. Describe Premises Structure:  Single Story  Multi-Story - # of Stories 2  Other: \_\_\_\_\_

f. Describe Surrounding Area:  Commercial  Residential  Industrial  Other: \_\_\_\_\_

g. Building Owner Name: Ali Hassan Phone Number: 4142589254

Business Owner Address: 11065 cathedral et, Wauwatosa, WI 53226

## 10. Hours of Operation & Customers

Will customers be entering the premises?  No  Yes

Day of the Week	Proposed Hours of Operation:		Estimated Number of Customers expected each day	Potential Age Range of Customers	Class B Tavern Applicant Only: Age Restriction (If none, write 'None')
	Open Time (include a.m. or p.m.)	Close Time (include a.m. or p.m.)			
Sunday	9 am	9 pm	50	18-45	
Monday	9 am	9 pm	50	18-45	
Tuesday	9 am	9 pm	50	18-45	
Wednesday	9 am	9 pm	50	18-45	
Thursday	9 am	9 pm	50	18-45	
Friday	9 am	9 pm	50	18-45	
Saturday	9 am	9 pm	50	18-45	

An Extended Hours Establishment License is required for any convenience store; filling station; personal service establishment (such as tattoo, body piercing, salon, tailor, tanning; etc.); recording studio or restaurant which is open between the hours of 12:00 a.m. and 5:00 a.m.

Alcohol Establishments: Class A: 8:00 am to 9:00 pm Sunday thru Saturday  
 Permitted Hours of Operation: Class B: 6:00 am to 2:00 am Sunday thru Thursday; 6:00 am to 2:30 am Friday & Saturday

Entertainment Outdoor Closing Hours: 10:00pm Sunday-Thursday; 12:00am Friday & Saturday; unless a different time, either earlier or later, is established by the Common Council in its approval of the licensee's plan of operation.

## 11. Signature(s)

  
 Signature of Sole Proprietor, Partner, or 20% or more Shareholder  
 (If there are no 20% or more shareholders,  
 Corporate Officer-print name/title and sign)

\_\_\_\_\_  
 Signature of additional partner or 20% or more shareholder

See Application Information for a complete list of all required application forms.



# ALCOHOL BEVERAGE & PUBLIC ENTERTAINMENT PREMISES SUPPLEMENTAL APPLICATION

Office of the City Clerk License Division  
200 E. Wells St. Room 105, Milwaukee, WI 53202  
(414) 286-2238 e-mail address: license@milwaukee.gov www.milwaukee.gov/license

Legal Entity Name: KJ Food Mart LLC

Premise Address: 2039 W Green Field Ave Milwaukee WI 53204

**Proximity of Premises to Church, School, Daycare Center or Hospital**

Is the building within 300 feet of any church, school, daycare center or hospital?  No  Yes

**"Service Bar Only" Designation**

If applying for Class B or C license, are you applying for "Service Bar Only"?  No  Yes

Service Bar Only means customers cannot sit at the bar. Alcohol is served to employees who serve patrons seated at tables. No stools, chairs or other articles of furniture shall be placed at the service bar for patrons to sit upon.

**Business Information**

a) Are you taking out this application for anyone that may not be eligible for a license?  No  Yes  
If yes, list their name and address: \_\_\_\_\_

b) Will the agent, a partner or the individual licensee be conducting the day-to-day operations of the business?  No  Yes  
If no, list the name and address of the person(s) who will: \_\_\_\_\_

Class B Applicants: If the agent, a partner or the individual licensee will not be conducting the day-to-day operations of the business, the person(s) listed above must obtain a Class B Managers license.

c) Does anyone else have money invested or any other interest in this business?  No  Yes  
If yes, explain: \_\_\_\_\_

d) Have you made an agreement with anyone to repay any loan or any other payments based upon income from the business?  
 No  Yes If yes, list name and address: \_\_\_\_\_

**Proof of Ownership, Lease, or Offer to Purchase (New & Transfer Applicants Only)**

Submit proof of ownership, lease, or offer to purchase the building with this application.  
A lease or offer to purchase must:

- Be in the same legal entity name as that apply for the license
- Reflect the same address as the premises address on this application
- Reflect current dates and
- Be signed by the lessor/seller and lessee/buyer

**Property Information (New & Transfer Applicants Only)**

a) Do you own or lease the building?  Own  Lease

b) Who owns the fixtures (for example, coolers, etc.)? KJ Food Mart LLC

c) Are you purchasing the stock and/or fixtures?  No  Yes If yes, amount paid \$ \_\_\_\_\_

d) Total amount paid for business \$ 25,000

e) Total amount paid for goodwill of the business \$ -

Goodwill comprises the reputation and customer relationships of an existing business. If the price you pay for the business exceeds the fair market value of all of the rest of the assets of the business, the excess may be considered goodwill.

f) Have you made arrangements with the seller for payment of personal property taxes?  No  Yes

See Application Information for a list of all required application forms.

### Lease Information (New & Transfer Applicants who are leasing the premises only)

- a) Date lease begins 10-23-18 Ends 12-31-2024
- b) Monthly rental \$ 925
- c) Do you have an option to renew the lease?  No  Yes
- d) Does your lease allow for assignment to another party without the consent of the owner?  No  Yes
- e) For what length of time have you been guaranteed occupancy (number of years)? 1
- f) In addition to paying the monthly rental, will you have to pay anything additional to the owner of the building to guarantee performance of the lease?  No  Yes If yes, explain Electricity
- g) Does the present owner or occupancy object to the granting of your license?  No  Yes  
If yes, explain \_\_\_\_\_

### Change of Agent Applicants Only

Have there been any changes to the floor plan since the last application was submitted?  No  Yes

If no, a new floor plan is not required. If yes, submit a new floor plan and explain the change(s): \_\_\_\_\_

### Signature

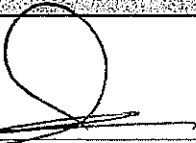
  
Signature of Sole Proprietor, Partner or 20% or More Shareholder  
(If no 20% or more Shareholder, Corporate Officer - print name/title and sign)

Note: All information contained in this application is subject to approval by the Common Council.  
Deviating from approved plan of operation will subject licensee to citations, and/or suspension or non-renewal of the license.  
Contact the License Division for information on how to request changes.

### New and transfer of premise applicants must submit the following:

- Proof of ownership, lease or offer to purchase the building
- Detailed floor plan
- If a restaurant, copy of the menu

21 Street



N →

Total 26 year  
Foot age  
1300

Garbage  
Back  
Yard

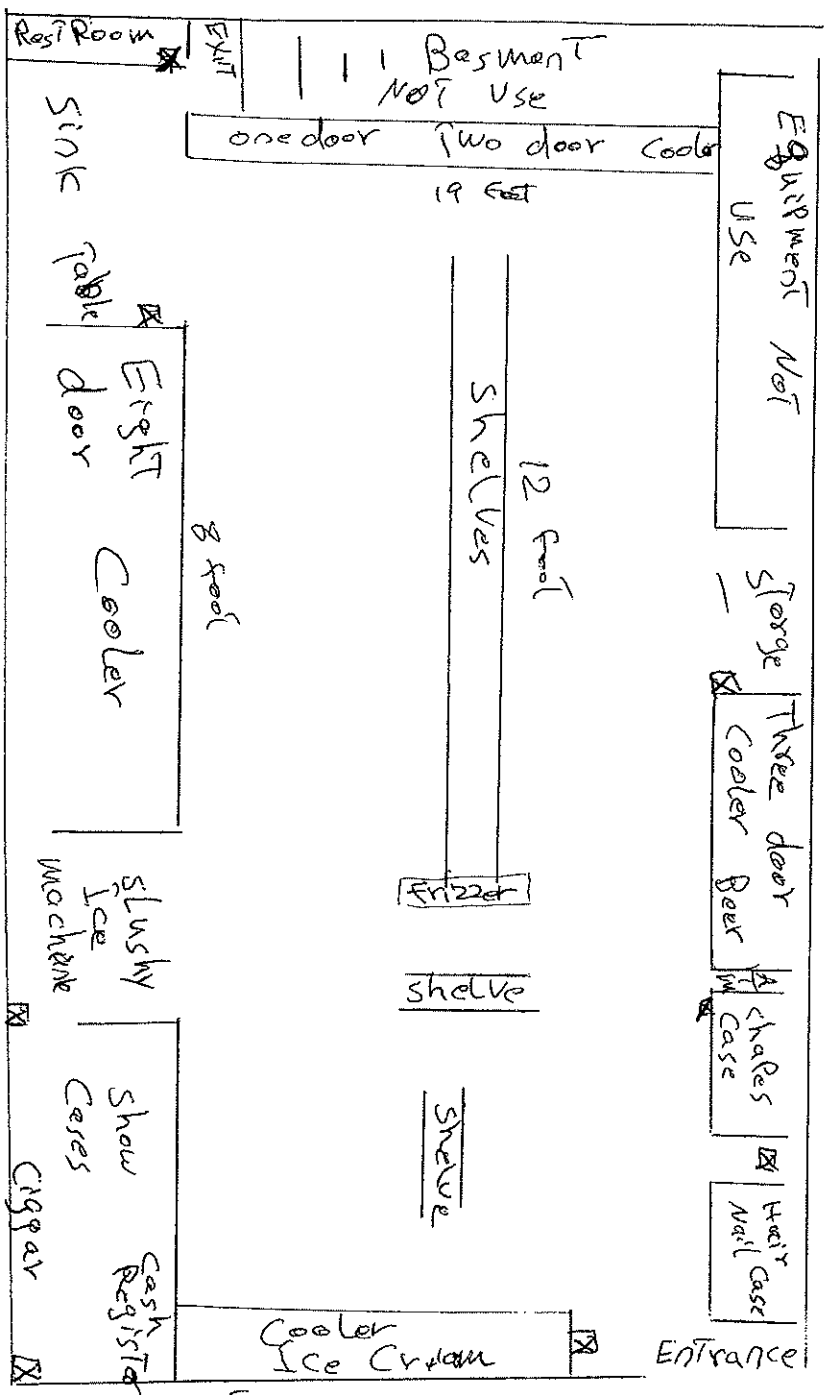

Kasha Almadheedi

KS Food Mart LLC

2039 W Greenfield Ave

Milwaukee WI 53204



8,29,2020

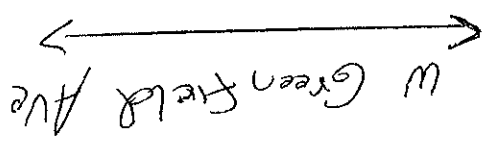

W Greenfield Ave