

DCO # 2539

CERTIFIED SURVEY MAP NO.

BEING A DIVISION OF A PORTION OF LAND IN THE SOUTHEAST 1/4 AND THE SOUTHWEST 1/4 OF THE SOUTHEAST 1/4 OF SECTION 17, TOWNSHIP 8 NORTH, RANGE 21 EAST, IN THE CITY OF MILWAUKEE, MILWAUKEE COUNTY, WISCONSIN.



INDICATES IRON PIPE FOUND
INDICATES 1 INCH DIA. IRON PIPE, 18 INCHES IN LENGTH, WEIGHING 1.13 LBS PER LINEAL FOOT. SET.
ALL DIMENSIONS SHOWN ARE MEASURED TO THE NEAREST HUNDREDTH OF A FOOT.
ALL BEARINGS SHOWN ARE REFERENCED TO THE SOUTH LINE OF THE SOUTHEAST 1/4 OF SECTION 17-8-21, WISCONSIN STATE PLANE COORDINATE SYSTEM GRID, SOUTH ZONE, AND ALL BEARINGS ARE REFERENCED TO GRID NORTH (APRIL 2001 DATUM).

TAX KEY NO.: 109--9994--110

WEST GREENWOOD TERRACE (30')

PARCEL 4
CSM #3717

ZONING: RS2 LOT 1 DATA: 688,073 SF 15.80 AC
LOT 2 DATA: 480,000 SF 11.02 AC

NORTH GRANVILLE ROAD (110')

LOT 1, BLOCK 4
WAXMAN'S MEADOWLARK ADDITION

LOT 10, BLOCK 4
WAXMAN'S MEADOWLARK ADDITION

LOT 11, BLOCK 4
WAXMAN'S MEADOWLARK ADDITION

LOT 18, BLOCK 4
WAXMAN'S MEADOWLARK ADDITION

LOT 19, BLOCK 4
WAXMAN'S MEADOWLARK ADDITION

LOT 1

LOT 2

N 87°30'14" E 1108.12'
(RECORDED AS S 89°44'56" W)

N 87°16'00" E 675.66'

S 25°20'42" E 323.02'

S 64°30'18" W 205.00'

90°00'00"

172°50'56"

234°54'28"

143.47'

890.85'

S 09°44'52" W 747.38'

N 00°29'26" E 281.00'

N 87°16'00" E 621.09'

S 87°16'00" W 621.09'

N 02°44'00" W 80.00'

S 87°16'00" W 897.44'

2651.55'

102°28'52"

80.00'

N 87°16'00" E 8716.00'

S 87°16'00" W 897.44'

E 2526.989.18

N 424,871.40

W/ALUMINUM CAP

CONCRETE MONUMENT

SECTION 17-8-21

SOUTHEAST CORNER OF THE SOUTHEAST 1/4

UNPLATTED LANDS

VICINITY MAP
1" = 2000'
W. CALUMET RD.

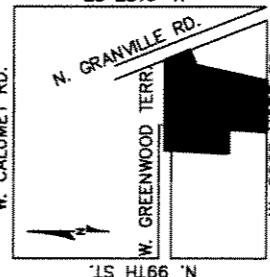

GRAPHIC SCALE
1 INCH = 200 FT.



SOUTH LINE OF THE SOUTHEAST 1/4 SECTION 17-8-21

SOUTH LINE OF THE SOUTHEAST 1/4 SECTION 17-8-21

WEST GOOD HOPE ROAD (160')

SERVICES DIVISION
CENTRAL DRAFTING & RECORDS MANAGER

Maxine Lindholm 3/13/06

Michael Berry 3/13/06
ATTEN: IN CHARGE EQUIPMENT ENGR.

Michael Berry 3/13/06
CORRECTED

Michael Berry 3/13/06
CITY ENGINEER APPROVED

THIS INSTRUMENT DRAFTED BY MICHAEL J. BERRY

CERTIFIED SURVEY MAP NO.

BEING A DIVISION OF A PORTION OF LAND IN THE SOUTHEAST 1/4 AND THE SOUTHWEST 1/4 OF THE SOUTHEAST 1/4 OF SECTION 17, TOWNSHIP 8 NORTH, RANGE 21 EAST, IN THE CITY OF MILWAUKEE, MILWAUKEE COUNTY, WISCONSIN.

SURVEYOR'S CERTIFICATE

STATE OF WISCONSIN) SS
MILWAUKEE COUNTY)

I, MICHAEL J. BERRY, A REGISTERED LAND SURVEYOR, HEREBY CERTIFY:
THAT I HAVE SURVEYED, DIVIDED AND MAPPED A PORTION OF LAND IN THE SOUTHEAST 1/4 AND THE SOUTHWEST 1/4 OF THE SOUTHEAST 1/4 OF SECTION 17, TOWNSHIP 8 NORTH, RANGE 21 EAST, IN THE CITY OF MILWAUKEE, MILWAUKEE COUNTY, WISCONSIN, BOUNDED AND DESCRIBED AS FOLLOWS:

COMMENCING AT THE SOUTHEAST CORNER OF THE SOUTHEAST 1/4 OF SECTION 17, TOWNSHIP 8 NORTH, RANGE 21 EAST; THENCE S 87°16'00" W, ALONG THE SOUTH LINE OF SAID 1/4 SECTION, 897.44 FEET; THENCE N 02°44'00" W, 80.00 FEET, TO THE POINT OF BEGINNING; THENCE S 87°16'00" W, ALONG THE NORTH RIGHT OF WAY LINE OF WEST GOOD HOPE ROAD, 621.09 FEET; THENCE N 00°29'26" E, 469.87 FEET ; THENCE S 87°16'00" W, 299.93 FEET ; THENCE N 00°29'26" E, (RECORDED AS S 00°29'26" E), 783.50 FEET; THENCE N 87°30'14" E, (RECORDED AS S 89°44'56" W), 1108.12 FEET; THENCE S 25°20'42" E, ALONG THE SOUTHWESTERLY RIGHT OF WAY LINE OF NORTH GRANVILLE ROAD, 323.02 FEET; THENCE S 64°39'18" W, 205.00 FEET; THENCE S 09°44'52" W, 890.85 FEET, TO THE POINT OF BEGINNING.

SAID LANDS CONTAINING 1,168,073 SF (26.82 AC) MORE OR LESS.

THAT I HAVE MADE SUCH SURVEY, LAND DIVISION AND MAP BY THE DIRECTION OF MT. ZION ASSEMBLY OF THE APOSTOLISTIC FAITH, INCORPORATED, OWNER OF SAID LAND.

THAT SUCH MAP IS A CORRECT REPRESENTATION OF ALL EXTERIOR BOUNDARIES OF THE LAND SURVEYED AND THE DIVISION THEREOF MADE.

THAT I HAVE FULLY COMPLIED WITH THE PROVISIONS OF CHAPTER 236.34 OF THE STATUTES OF THE STATE OF WISCONSIN AND CHAPTER 119 OF THE CITY OF MILWAUKEE CODE OF ORDINANCES IN SURVEYING, DIVIDING, AND MAPPING THE SAME.

DATED THIS 6TH DAY OF FEBRUARY, 2006.

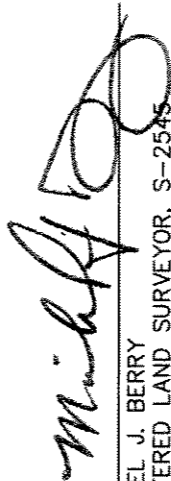
MICHAEL J. BERRY
REGISTERED LAND SURVEYOR, S-2545
STATE OF WISCONSIN

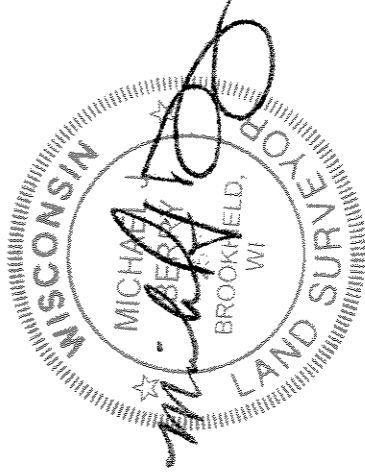

CERTIFIED SURVEY MAP NO.

BEING A DIVISION OF A PORTION OF LAND IN THE SOUTHEAST 1/4 AND THE SOUTHWEST 1/4 OF THE SOUTHEAST 1/4 OF SECTION 17, TOWNSHIP 8 NORTH, RANGE 21 EAST, IN THE CITY OF MILWAUKEE, MILWAUKEE COUNTY, WISCONSIN.

CORPORATE OWNERS CERTIFICATE

MT. ZION ASSEMBLY OF THE APOSTOLIC FAITH, INCORPORATED, A CORPORATION DULY ORGANIZED AND EXISTING UNDER AND BY VIRTUE OF THE LAWS OF THE STATE OF WISCONSIN, AS OWNER, CERTIFIES THAT SAID CORPORATION CAUSED THE LAND DESCRIBED ON THIS MAP TO BE SURVEYED, DIVIDED, MAPPED AND DEDICATED AS REPRESENTED ON THIS MAP IN ACCORDANCE WITH THE REQUIREMENTS OF CHAPTER 119 OF THE MILWAUKEE CODE OF ORDINANCES.

IN CONSIDERATION OF THE APPROVAL OF THE MAP BY COMMON COUNCIL AND IN ACCORDANCE WITH CHAPTER 119 OF THE MILWAUKEE CODE, THE UNDERSIGNED AGREES: THAT ALL UTILITY LINES TO PROVIDE ELECTRIC POWER AND TELEPHONE SERVICES AND CABLE TELEVISION OR COMMUNICATIONS SYSTEMS LINES OR CABLES TO ALL LOTS IN THE CERTIFIED SURVEY MAP SHALL BE INSTALLED UNDERGROUND IN EASEMENTS PROVIDED THEREFOR.

THIS AGREEMENT SHALL BE BINDING ON THE UNDERSIGNED AND ASSIGNS. IN WITNESS WHEREOF, MT. ZION ASSEMBLY OF THE APOSTOLIC FAITH, INCORPORATED HAS CAUSED THESE PRESENTS TO BE SIGNED BY DR. EARL PARCHIA, IT'S President AT Milwaukee, WISCONSIN, THIS 1st DAY OF March, 2006.

IN THE PRESENCE OF:

MT. ZION ASSEMBLY OF THE APOSTOLIC FAITH, INCORPORATED

Cheresa Brown
(WITNESS)

[Signature]
DR. EARL PARCHIA
MT. ZION ASSEMBLY OF THE APOSTOLIC FAITH, INC.

STATE OF WISCONSIN) SS
MILWAUKEE COUNTY)

PERSONALLY CAME BEFORE ME THIS 1st DAY OF March, 2006, DR. EARL PARCHIA, President OF THE ABOVE NAMED CORPORATION, TO ME KNOWN AS THE PERSON WHO EXECUTED THE FOREGOING INSTRUMENT, AND TO ME KNOWN TO BE THE President OF THE CORPORATION, AND ACKNOWLEDGED THAT THEY EXECUTED THE FOREGOING INSTRUMENT AS SUCH OFFICER AS THE DEED OF THE CORPORATION, BY IT'S AUTHORITY.

DATED THIS 1st DAY OF March, 2006.

[Signature]
NOTARY PUBLIC Renee A. Adrian
STATE OF WISCONSIN
MY COMMISSION EXPIRES: Aug 10, 2008

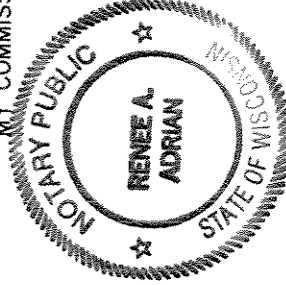
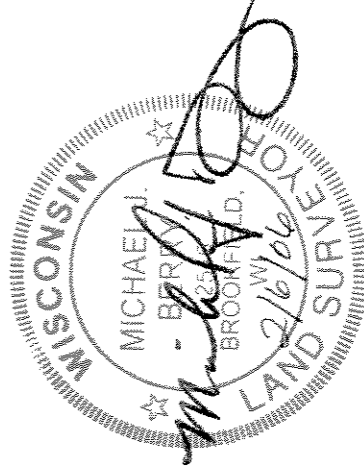

CERTIFIED SURVEY MAP NO.

BEING A DIVISION OF A PORTION OF LAND IN THE SOUTHEAST 1/4 AND THE SOUTHWEST 1/4 OF THE SOUTHEAST 1/4 OF SECTION 17, TOWNSHIP 8 NORTH, RANGE 21 EAST, IN THE CITY OF MILWAUKEE, MILWAUKEE COUNTY, WISCONSIN.

CERTIFICATE OF CITY TREASURER

STATE OF WISCONSIN) SS
MILWAUKEE COUNTY)

I, WAYNE F. WHITLOW, BEING THE DULY ELECTED, QUALIFIED AND ACTING CITY TREASURER OF THE CITY OF MILWAUKEE, CERTIFY THAT IN ACCORDANCE WITH THE RECORDS IN THE OFFICE OF THE CITY TREASURER OF THE CITY OF MILWAUKEE THERE ARE NO UNPAID TAXES OR UNPAID SPECIAL ASSESSMENTS ON THE LAND INCLUDED IN THIS CERTIFIED SURVEY MAP.

THIS 14th DAY OF MAY, 2006.

Wayne F. Whitlow
WAYNE F. WHITLOW, CITY TREASURER

COMMON COUNCIL CERTIFICATE OF APPROVAL

I CERTIFY THAT THIS CERTIFIED SURVEY MAP WAS APPROVED UNDER RESOLUTION NO. 051537 ADOPTED BY THE COMMON COUNCIL OF THE CITY OF MILWAUKEE ON THIS 23rd DAY OF March, 2006.

Ronald D. Leonhardt
RONALD D. LEONHARDT, CITY CLERK
Tom Barrett
TOM BARRETT, MAYOR

