



**CITY OF MILWAUKEE  
OFFICE OF THE CITY CLERK**

Tuesday, April 15, 2025

**COMMITTEE MEETING NOTICE**

AD 03

CHEKKALA, Ram Mohan Rao, Agent  
3 EYE LLC  
6581 N BETHMAUR LN  
Glendale, WI 53209

You are requested to attend a hearing which is to be held in Room 301-B, Third Floor, City Hall or you may attend virtually using the link below.

**Tuesday, April 29, 2025 at 01:35 PM**

The access code is <https://meet.goto.com/329456501>. Please see the enclosed best practices document for further instructions.

**Regarding:** Your Class A Malt & Class A Liquor, Food Dealer and Weights & Measures Licenses Application as agent for "3 EYE LLC" for "KOPPA'S FULBELI DELI" at 1940 N FARWELL

There is a possibility that your application may be denied for one or more of the following reasons: The recommendation of the committee regarding the application shall be based on evidence presented at the hearing. Per MCO 85-2.7-4, probative evidence concerning whether or not a new license should be granted may be presented on the following subjects: whether or not the applicant meets the municipal requirements, the appropriateness of the location and premises where the licensed premises is to be located and whether use of the premises for the purposes or activities permitted by the license would tend to facilitate a public or private nuisance or create undesirable neighborhood problems such as disorderly patrons, unreasonably loud noise, litter, and excessive traffic and parking congestion. Probative evidence relating to these matters may be taken from the plan of operation submitted with the license application, if any, but shall not include the content of any music. Evidence regarding the fitness of the location of the premises to be maintained as the principal place of business, including but not limited to whether there is an overconcentration of businesses of the type for which the license is sought; whether the proposal is consistent with any pertinent neighborhood business or development plans, or the location's proximity to areas where children are typically present. The applicant's record in operating similarly licensed premises; and whether or not the applicant has been charged with or convicted of any felony, misdemeanor, municipal offense or other offense, the circumstances of which substantially relate to the activity to be permitted by the license being applied for or any other factor which reasonably relates to the public health, safety or welfare may also be considered. See attached police report or correspondence.

**Notice for applicants with  
warrants or unpaid fines:**

Proof of warrant satisfaction or payment of fines must be submitted at the hearing on the above date and time. Failure to comply with this requirement may result in a delay of the granting/denial of your application.

Failure to appear at this meeting may result in the denial of your license. Individual applicants must appear only in person or by an attorney. Corporate or Limited Liability applicants must appear only by the agent designated on the application or by an attorney. Partnership applicants must appear by a partner listed on the application or by an attorney. If you wish to do so and at your own expense, you may be accompanied by an attorney of your choosing to represent you at this hearing. You will be given an opportunity to speak on behalf of the application and to respond and challenge any charges or reasons given for the denial. No petitions can be accepted by the committee, unless the people who signed the petition are present at the committee hearing and willing to testify. You may present witnesses under oath and you may also confront and cross-examine opposing witnesses under oath. If you have difficulty with the English language, you should bring an interpreter with you, at your expense, so that you can answer questions and participate in your hearing.

You may examine the application file at this office during regular business hours prior to the hearing date. Inquiries regarding this matter may be directed to the person whose signature appears below.

Limited parking for persons attending meetings during normal business hours is available at reduced rates (5 hour limit) at the Milwaukee Center on the southwest corner of Kilbourn Avenue and Water Street. You must present a copy of the meeting notice to the parking cashier.

PLEASE NOTE: Upon reasonable notice, efforts will be made to accommodate the needs of disabled individuals through sign language interpreters or other auxiliary aids. For additional information or to request this service, contact the Council Services Division ADA Coordinator at (414) 286-2998, Fax - (414) 286-3456, TDD - (414) 286-2025.

**JIM OWCZARSKI, CITY CLERK**

BY: \_\_\_\_\_

Jim Cooney  
License Division Manager

**If you have questions regarding this notice, please contact the License Division at (414) 286-2238.**

200 E. Wells Street, Room 105, City Hall, Milwaukee, WI 53202. [www.milwaukee.gov/license](http://www.milwaukee.gov/license)  
Phone: (414) 286-2238 Fax: (414) 286-3057 Email Address: [License@milwaukee.gov](mailto:License@milwaukee.gov)

Date: 02/24/2025  
Officer: MUSTAFA

City of Milwaukee Police Department  
90-5-1.5 Crime Prevention Survey  
Convenience Store/Liquor Store Inspection

Name of Premise: Koppa's Fulbeli Deli  
Address: 1940 N. Farwell Av.  
Phone: 414.273.1273  
Owner: Ram CHEKKALA  
Owner address: 6581 N. BETHMAUR LN  
City State Zip: Milwaukee, WI 53209  
Owner Phone: 414.865.1790  
Owner email: 3EYE.LLC3@GMAIL.COM

Manager:  
Home Address:  
City State Zip:  
Phone:  
Email:

Preferred contact: Ram CHEKKALA

Location currently open: ☒ YES ☐ NO

Projected open date: April 1, 2025

Day's open: ☐S ☐M ☐T ☐W ☐Th ☐F ☐SA ☒ALL

Hours of Operation: Sun: 8:00 AM-9:00 PM ☐24 hours ☐Y ☐N  
Mon: 8:00 AM-9:00 PM  
Tue: 8:00 AM-9:00 PM  
Wed: 8:00 AM-9:00 PM  
Thu: 8:00 AM-9:00 PM  
Fri: 8:00 AM-9:00 PM  
Sat: 8:00 AM-9:00 PM

Premise Type: ☒Liquor Store  
☒Convenience Store  
☐Other:

Licenses currently held:

Alcohol: ☐Yes ☐No Class: #: BTAVN- 375998  
Tobacco: ☐Yes ☐No #:

Food: ☐ Yes ☐ No #:   
 Extended Hours: ☐ Yes ☐ No #:   
 Secondhand Dealer: ☐ Yes ☐ No Type: #:   
 Other: ☐ Yes ☐ No Type: #:   
 Other: ☐ Yes ☐ No Type: #:

### **Exterior Survey:**

1. Is the area around the location clean? ☐ Yes ☐ No
2. What surrounds the location? (Check all the apply)
  - a. ☐ Park
  - b. ☐ School
  - c. ☐ Youth Center
  - d. ☐ Church
  - e. ☐ Tavern(s) If so, how many
  - f. ☒ Residential
  - g. ☒ Other businesses
  - h. ☐ Other:
3. Can you see from the outside of the location into the interior ☒ Yes ☐ No
4. Can you see the employees inside of the location from the outside ☒ Yes ☐ No
5. Are exterior windows free of signage ☐ Yes ☒ No
6. Is there a parking lot ☐ Yes ☒ No
7. Is the parking lot clean? ☐ Yes ☒ No
8. Is the parking lot well lit? ☐ Yes ☒ No
9. Are there areas where a person could conceal themselves ☒ Yes ☐ No
10. Is there exterior lighting? ☒ Yes ☐ No. Does it appears to be adequate ☐ Yes ☒ No
11. Exterior Payphone? ☐ Yes ☒ No
12. Are there No Loitering Signs posted? ☒ Yes ☐ No
13. Are there exterior security cameras ☒ Yes ☐ No How Many: 0
14. Are the address numbers prominently displayed and easy to see ☒ Yes ☐ No

### **Camera Survey:**

15. Does this location have security cameras? ☒ Yes ☐ No
16. Are they in working order? ☒ Yes ☐ No
17. What format are the cameras?
  - a. Color ☒ Yes ☐ No
  - b. Digital ☒ Yes ☐ No
  - c. VCR ☐ Yes ☐ No
  - d. Recorded ☒ Yes ☐ No
18. How long is footage stored for later viewing: 30 days
19. Are there exterior cameras ☐ Yes ☒ No How many: 0
20. Are there interior cameras ☒ Yes ☐ No How many: 9
21. Do all employees know how to retrieve recorded digital images/footage? ☐ Yes ☒ No

### **Interior Survey:**

22. Is the storeowner willing to be a standing complainant regarding loitering? ☒ Yes ☐ No

- a. If yes have them fill out the standing complaint form and give them two of the commercial signs ☒ Yes ☐ No
23. Is the interior of the location neat and clean? ☒ Yes ☐ No
24. Does an interior camera face the entrance/exit? ☐ Yes ☒ No
25. Is there a lockable area that separates employees from customers? ☒ Yes ☐ No
26. Does the store sell single chore boy? ☐ Yes ☒ No
27. Does the store sell blunt wraps? ☒ Yes ☐ No
28. Does the store sell scales? ☐ Yes ☒ No
29. Does the store sell items that may be used as crack pipes? ☐ Yes ☒ No
- a. Describe item
30. Does the store have an over abundance of sandwich baggies? ☒ Yes ☐ No
31. Does the owner understand that these items are often used for drug use? ☒ Yes ☐ No
32. Do the products in the store appear to be new and rotated often? ☒ Yes ☐ No
33. Are emergency and non-emergency numbers posted near the phone? ☒ Yes ☐ No
34. Does the owner know how to contact their police district directly? ☒ Yes ☐ No
- a. Did you provide a district contact guide to the owner? ☒ Yes ☐ No

**Complete this section if alcohol establishment is a convenience store:**

(\*\* Read full ordinance for all details "68-4.3 Convenience Food Stores")

All convenience food stores not exempted under sub. 3 shall:

1. Is the cash register located in a manner so that at the time of a sales transaction, the employee and customer are both visible from the sidewalk? ☒ Yes ☐ No \*\*
2. Are the glass entrance and exit doors clear of any signs or advertisements with the exception of a sign which states that the cash register contains \$50 or less and that the safe is no accessible to employees? ☐ Yes ☒ No
3. Does the store maintain one of the following on the licensed premise:
  - a. A safe that was in use at the convenience food store on August 17, 1994? ☒ Yes ☐ No
  - b. A drop-safe or time release safe that weighs at least 500 pounds or which is attached to or set into the floor in a manner approved by the police department? ☒ Yes ☐ No
4. Is lighting provided for the store's parking area during all hours of darkness when employees or customers are on the premises at a minimum average of 2-foot candles per square foot, unless the store is not open for business after sunset and before sunrise? ☐ Yes ☐ No ☒ N/A
5. Are at least two high-resolution surveillance security cameras installed? ☒ Yes ☐ No
6. Are the security cameras in working order? ☒ Yes ☐ No
7. Does one camera show an overall view of the counter and register area? ☒ Yes ☐ No
8. Does one camera show a clear, identifiable, full frame image of the face of each person entering and leaving the store? ☐ Yes ☒ No
9. Are the camera views obstructed by fixtures or displays? ☐ Yes ☒ No
10. Is the recorded footage stored for at least 30 days? ☒ Yes ☐ No
11. Do all store employees know how to record footage from the camera system to media capable of being transferred to police custody? ☐ Yes ☒ No
12. Are customer entrances/exits made of glass or other transparent material? ☒ Yes ☐ No
  - a. Exception: A store that does not have such doors on August 17, 1994 shall not be required to install such doors until the holder of the store's food dealer license changes.
13. Has the owner and their employees attended the Robbery Prevention Training with in 120 days of ownership or employment? ☐ Yes ☒ No
  - a. Contact Community Outreach and Education at 935-7836 for schedule.

**Sub 3. Exemptions.** The requirements of this section do not apply to a convenience food store that conforms to either of the following descriptions:

- a-1. The store is located in an enclosed shopping structure, enclosed commercial building or hospital. A convenience food store is not in an enclosed structure or building if a customer can enter it directly from the outside.

Does store conform to a-1 ☐ Yes ☒ No

- a-2 The store physically separates employees from customers with a solid partition that bars a person from entering the employee area from the customer area, has a secure lock on the employee side of any door between the employee area and the customer, and conducts all transaction through a service window or similar arrangement.

Does store conform to a-2 ☐ Yes ☒ No

- a. At the commissioner's discretion, a convenience store may be exempted from any or all of the regulations specified in sub 2.

Does this location hold an exemption from the commissioner regarding any of the requirements of Sub 2? ☐ Yes ☒ No

**ADDITIONAL COMMENTS/RECOMMENDATIONS:**



City of Milwaukee 1940 N Farwell Ave

## Area of Interest (AOI) Information

Area : 21,862,585.81 ft<sup>2</sup>

Jan 21 2025 15:27:00 Central Standard Time

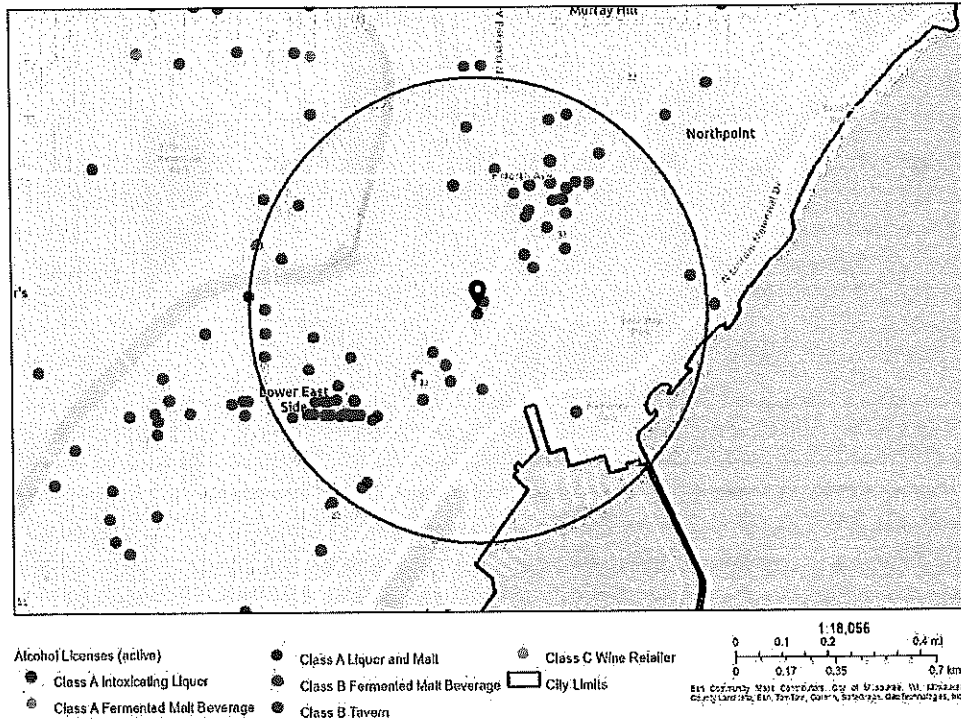

## Summary

Name	Count	Area(ft <sup>2</sup> )	Length(mi)
Alcohol Licenses	84		

## Alcohol Licenses

#	Legal Entity	Trade Name	Licensee	Address	License Type Name	Total Capacity	Expiration Date	Count
1	Mex Ave East LLC	Mex Avenue	Melissa G Escobar, Agt	2238 N FARWELL AV 6	Class B Tavern License		1/22/2025, 6:00 PM	1
2	Lazy Tiger Group LLC	Easy Tyger Restaurant	NONGLUK TRICK, Agt	1230 E Brady ST	Class B Tavern License		1/28/2025, 6:00 PM	1
3	Saint John's Communities, Inc	Saint John's on the Lake	Renee E Anderson, Agt	1840 N PROSPECT AV	Class B Tavern License		2/3/2025, 6:00 PM	1
4	Pomona Cider Company LLC	Pomona Cider Company	Thomas S Gabert, Agt	2163 N FARWELL AV	Class B Tavern License		2/5/2025, 6:00 PM	1
5	Izzy Hops LLC	Izzy Hops	MICHAEL J VITUCCI, Agt	2311 N Murray AV	Class B Tavern License		2/6/2025, 6:00 PM	1
6	PTG Live Events, LLC	The Vivarium	RICHARD J RYAN, Agt	1818 N FARWELL AV	Class B Tavern License	680	2/13/2025, 6:00 PM	1
7	Strange Town, LLC	Strange Town	Mia L LeTendre, Agt	2101-2103 N Prospect AV	Class B Tavern License	49	2/13/2025, 6:00 PM	1
8	Fink's of Milwaukee, Inc	Fink's	KRISTYNA A Eitel, Agt	1875 N Humboldt AV	Class B Tavern License	80	2/20/2025, 6:00 PM	1
9	Charles Allis and Villa Terrace Museums, Inc.	Villa Terrace Decorative Arts Museum	Jaymee Harvey Willms, Agt	2220 N TERRACE AV	Class B Tavern License	85	2/21/2025, 6:00 PM	1
10	Woori Wells Corp	Maru	Jongsoo Kim, Agt	2150 N Prospect AV	Class B Tavern License		2/25/2025, 6:00 PM	1
11	Charles Allis and Villa Terrace Museums, Inc.	Charles Allis Art Museum	Jaymee Harvey Willms, Agt	1801 N PROSPECT AV	Class B Tavern License	99	2/25/2025, 6:00 PM	1
12	Erth Wellness, LLC	Kind Oasis	Salem J Kashou, Agt	2169 N FARWELL AV	Class B Tavern License		2/25/2025, 6:00 PM	1
13	Krikar LLC	Koppa's Fulbeli Deli	Karthik B Pothumachi, Agt	1940 N FARWELL AV	Class A Malt & Class A Liquor License		2/26/2025, 6:00 PM	1
14	PADDY'S PET & PUB, LLC	PADDY'S PET & PUB	ORLEN G WOOD, Agt	2339-A N MURRAY AV	Class B Tavern License	179	3/1/2025, 6:00 PM	1
15	Ian's Pizza Milwaukee, LLC	Ian's Pizza Milwaukee	Ryan W Donovan, Agt	2035 E NORTH AV	Class B Fermented Malt Beverage Retailer's License		3/1/2025, 6:00 PM	1
16	Ian's Pizza Milwaukee, LLC	Ian's Pizza Milwaukee	Ryan W Donovan, Agt	2035 E NORTH AV	Class C Wine Retailer's License		3/1/2025, 6:00 PM	1
17	PIZZA SHUTTLE, INC	PIZZA SHUTTLE	Megan Marita, Agt	1827 N Farwell AV	Class B Tavern License	150	3/6/2025, 6:00 PM	1
18	ZUM ZEPPEL, LLC	Thurmans 15	Richard J Paul, Agt	1731 N Arlington PL	Class B Tavern License	80	3/9/2025, 7:00 PM	1



19	WI LJ INC	Back Street	Ying Li, Agt	2116 N FARWELL AV	Class B Fermented Malt Beverage Retailer's License		3/18/2025, 7:00 PM	1
20	MILAP, INC	SMITH BEER & LIQUOR MART	AMARJIT S KALSEY, Agt	1413 E BRADY ST	Class A Malt & Class A Liquor License		3/21/2025, 7:00 PM	1
21	Sorivilla Inc	Kompali Taqueria	JOSE F VILLAR, Agt	1205 E BRADY ST	Class B Tavern License	99	3/21/2025, 7:00 PM	1
22	JAMOHEAD, INC	JAMO'S	JAMISON H GOLL, Agt	1800 N ARLINGTON PL	Class B Tavern License	25	3/24/2025, 7:00 PM	1
23	SPTresto, LLC	Rice N Roll Bistro	Bundid Muangsiri, Agt	1952 N Farwell AV	Class C Wine Retailer's License		3/29/2025, 7:00 PM	1
24	SPTresto, LLC	Rice N Roll Bistro	Bundid Muangsiri, Agt	1952 N Farwell AV	Class B Fermented Malt Beverage Retailer's License		3/29/2025, 7:00 PM	1
25	Saz's Catering Inc	Jan Serr Studio	Stephanie L Sazama-Schneck, Agt	2155 N Prospect AV	Class B Tavern License		4/4/2025, 7:00 PM	1
26	Premier Closers LLC	Upper East Bar	Stephanie R Townsend, Agt	1732 E NORTH AV	Class B Tavern License		4/7/2025, 7:00 PM	1
27	INCONTRO GROUP LLC	L'INCONTRO	Paul J Piotrowski, Agt	2315 N MURRAY AV	Class B Tavern License		4/7/2025, 7:00 PM	1
28	PROSPECTOR PARTNERSHIP LLC	VINTAGE	REBECCA E GODFREY, Agt	2203 N PROSPECT AV	Class B Tavern License	151	4/10/2025, 7:00 PM	1
29	LANDMARK BARS, INC	LANDMARK LANES	SLAVA TUZHILKOV, Agt	2220 N FARWELL AV	Class B Tavern License	240	4/11/2025, 7:00 PM	1
30	GPJ OF MILWAUKEE, INC	MA FISCHER'S	HEIDI A PANAGIOTOPoulos, Agt	2214 N FARWELL AV	Class B Tavern License	240	4/11/2025, 7:00 PM	1
31	MEGA MARTS, LLC	PICK 'N SAVE #882	Stephanie Nowatzki, Agt	1100 E GARFIELD AV	Class A Malt & Class A Liquor License		4/17/2025, 7:00 PM	1
32	BUSSEN MARSHALL LLC	Pete's Pub	PETER R MARSHALL, Agt	1234 E BRADY ST	Class B Tavern License		4/20/2025, 7:00 PM	1
33	Plantivore LLC	Twisted Plants	Arielle M Hawthorne, Agt	1233 E Brady ST	Class B Fermented Malt Beverage Retailer's License		4/23/2025, 7:00 PM	1
34	Plantivore LLC	Twisted Plants	Arielle M Hawthorne, Agt	1233 E Brady ST	Class C Wine Retailer's License		4/23/2025, 7:00 PM	1
35	JC Capital Dorsia LLC	Dorsia	JENO J CATALDO, Agt	1301-07 E Brady ST	Class B Tavern License	199	4/24/2025, 7:00 PM	1
36	Bharat Enterprise, Inc	Bharat Mart	RAVI SACHDEVA, Agt	1556 N Farwell AV	Class A Malt & Class A Liquor License		5/2/2025, 7:00 PM	1

37	FRANKIES RESTAURANT AND CATERING, LLC	Frankies Restaurant and Catering	Donna D Afrifa, Agt	1815 E KENILWORTH PL	Class B Tavern License		5/10/2025, 7:00 PM	1
38	ZAFFIRO BROS, INC	ZAFFIRO'S PIZZA	MICHAEL J ZAFFIRO, Agt	1724 N FARWELL AV	Class B Tavern License	25	5/19/2025, 7:00 PM	1
39	Nine Below Inc	Nine Below	Marla R Poytinger, Agt	1905 E North AV	Class B Tavern License	270	5/30/2025, 7:00 PM	1
40	Axe MKE, Inc	Axe MKE	Marla R Poytinger, Agt	1924 E KENILWORTH PL	Class B Tavern License		5/30/2025, 7:00 PM	1
41	BENJAMIN'S FINE WINE & SPIRITS LLC	Waterford Wine Company	BENJAMIN T CHRISTIANS EN, Agt	2120 N FARWELL AV	Class B Tavern License		5/30/2025, 7:00 PM	1
42	Nashville North, LLC	Nashville North	Jeffrey Marsh, Agt	1216 E BRADY ST	Class B Tavern License	120	6/9/2025, 7:00 PM	1
43	ROCHAMBO, LTD	ROCHAMBO COFFEE & TEA HOUSE	LORENZO G CATALDO, Agt	1317 E BRADY ST	Class B Tavern License	110	6/13/2025, 7:00 PM	1
44	Black Gate LLC	Von Trier	MARK A ZIERATH, Agt	2235 N Farwell AV	Class B Tavern License	153	6/13/2025, 7:00 PM	1
45	WHOLE FOODS MARKET GROUP, INC	WHOLE FOODS MARKET	Brooke M Remitz, Agt	2305 N PROSPECT AV	Class B Tavern License		6/13/2025, 7:00 PM	1
46	Dairyland Retail Group LLC	7-Eleven #35852B	Daniel J Stachnik, Agt	1609 E NORTH AV	Class A Fermented Malt Beverage Retailer's License		6/14/2025, 7:00 PM	1
47	Dairyland Retail Group LLC	7-Eleven #35852B	Daniel J Stachnik, Agt	1609 E NORTH AV	Class A Retailer's Intoxicating Liquor License		6/14/2025, 7:00 PM	1
48	CHAMPION'S PUB, LLC	CHAMPION'S PUB	ROBERT R GREENYA, Agt	2417 N BARTLETT AV	Class B Tavern License	148	6/28/2025, 7:00 PM	1
49	THE HIDEOUT CORP OF MILWAUKEE	SCAFFIDI'S HIDEOUT	RICK SCAFFIDI, Agt	1837 N HUMBOLDT AV	Class B Tavern License	80	6/29/2025, 7:00 PM	1
50	HOOLIGAN'S SUPER IRISH DELI & BAR, INC	HOOLIGAN'S	MARK B BUESING, Agt	2017 E NORTH AV	Class B Tavern License	118	6/29/2025, 7:00 PM	1
51	OCTOPUS, LTD	WOLSKI'S TAVERN	DENNIS BONDAR, Agt	1836 N PULASKI ST	Class B Tavern License	80	6/29/2025, 7:00 PM	1
52	M P ON BRADY, INC	CLUB BRADY	MICHAEL D LEE, Agt	1339 E BRADY ST	Class B Tavern License	143	6/29/2025, 7:00 PM	1
53	JOEY C'S, INC	JO-CAT'S PUB	PATRICIA A CATALDO, Agt	1311 E BRADY ST	Class B Tavern License	220	6/30/2025, 7:00 PM	1
54	TKCS Brady LLC	The King Crab Shack	Tien Ngo, Agt	1330 E Brady ST	Class B Tavern License		7/5/2025, 7:00 PM	1

55	MILWAUKEE YACHT CLUB	MILWAUKEE YACHT CLUB	Dawn M Brooks, Agt	1700 N LINCOLN MEMORIAL DR	Class B Tavern License	180	7/5/2025, 7:00 PM	1
56	HOSED ON BRADY INC	HOSED ON BRADY	DONNA R OLSON, Agt	1689 N FRANKLIN PL	Class B Tavern License	80	7/7/2025, 7:00 PM	1
57	BRG Lotta Burger, LLC	Roundhouse	CHRISTIAN M DAMIANO, Agt	1750 N Lincoln Memorial DR	Class B Tavern License	112	7/10/2025, 7:00 PM	1
58	J & S Malone, LLC	Malone's on Brady	JOSHUA L MALONE, Agt	1329 E BRADY ST	Class B Tavern License	80	7/21/2025, 7:00 PM	1
59	CONCOCTIO NS LLC	CONCOCTIO NS	HYACINTH E NEMBHARDT, Agt	1316 E BRADY ST	Class B Tavern License		7/23/2025, 7:00 PM	1
60	JC CAPITAL SAINT BIBIANA LLC	St. Bibiana/St. Bibi	JENO J CATALDO, Agt	1327 E BRADY ST	Class B Tavern License		7/28/2025, 7:00 PM	1
61	Jack's American Pub, LLC	Jack's American Pub	SCOTT A SCHAEFER, Agt	1323 E Brady ST	Class B Tavern License	240	7/29/2025, 7:00 PM	1
62	KOALA DK LLC	Nomad World Pub	JEFFREY A KOVACOVICH, JR, Agt	1401 E Brady ST	Class B Tavern License		8/3/2025, 7:00 PM	1
63	El Grupo J & K, LLC	Judy's Cantina	Kevin I Lopez, Agt	2124 N FARWELL AV	Class B Tavern License		8/13/2025, 7:00 PM	1
64	1754 NFRANKLINB AR LLC	The Standard Tavern	STEPHEN G GILBERTSON, Agt	1754 N FRANKLIN PL	Class B Tavern License	78	8/13/2025, 7:00 PM	1
65	IFM Farwell LLC	Oriental Theatre	Kristen C Heller, Agt	2230 N FARWELL AV	Class B Tavern License	1,834	8/19/2025, 7:00 PM	1
66	COZUMEL III, LLC	Cozumel Mexican Restaurant	Miguel A Lopez Lopez, Agt	2060 N HUMBOLDT AV 200	Class B Tavern License		8/21/2025, 7:00 PM	1
67	La Masa LLC	La Masa	BRADLEY H TODD, Agt	1300 E Brady ST	Class B Tavern License	99	8/30/2025, 7:00 PM	1
68	BEANS & BARLEY, INC	BEANS & BARLEY	JAMES C NEUMEYER, Agt	1901 E NORTH AV	Class B Tavern License	180	8/30/2025, 7:00 PM	1
69	Kawa Ramen & Sushi Inc	Kawa	LinJin Xiao, Agt	2321-23 N Murray AV	Class B Tavern License		9/12/2025, 7:00 PM	1
70	SATGUR CORPORATIO N, INC	MAHARAJA RESTAURAN T	BALBIR SINGH, Agt	1550 N FARWELL AV	Class B Tavern License	300	9/21/2025, 7:00 PM	1
71	MJE, INC	HI HAT LOUNGE & GARAGE	KRISTYN A Eitel, Agt	1701-03 N ARLINGTON PL	Class B Tavern License	159	9/27/2025, 7:00 PM	1
72	WURSTBAR MKE LLC	WURST BAR	SCOTT A SCHAEFER, Agt	1239 E BRADY ST	Class B Tavern License		10/10/2025, 7:00 PM	1
73	7-ELEVEN, INC	7-ELEVEN # 35852J	Angela Schultz, Agt	1609 E NORTH AV	Class A Fermented Malt Beverage Retailer's License		10/23/2025, 7:00 PM	1

74	7-ELEVEN, INC	7-ELEVEN # 35852J	Angela Schultz, Agt	1609 E NORTH AV	Class A Retailer's Intoxicating Liquor License		10/23/2025, 7:00 PM	1
75	Ardent Milwaukee, LLC	Ardent	Justin K Carlisle, Agt	1749-51 N Farwell AV	Class B Tavern License		11/4/2025, 6:00 PM	1
76	FAMOUS CIGAR, LLC	FAMOUS CIGAR	JOHN PIETTE, Agt	1213 E BRADY ST	Class B Tavern License		11/5/2025, 6:00 PM	1
77	ETHIOPIAN COTTAGE RESTAURANT, INC	ETHIOPIAN COTTAGE RESTAURANT	YIGLETU DEBEBE, Agt	1824 N FARWELL AV	Class B Fermented Malt Beverage Retailer's License	75	11/19/2025, 6:00 PM	1
78	ETHIOPIAN COTTAGE RESTAURANT, INC	ETHIOPIAN COTTAGE RESTAURANT	YIGLETU DEBEBE, Agt	1824 N FARWELL AV	Class C Wine Retailer's License		11/19/2025, 6:00 PM	1
79	Pitch's Lounge & Restaurant	Pitch's Lounge & Restaurant	JAMES L PICCIURRO, SP	1801 N HUMBOLDT AV	Class B Tavern License		11/24/2025, 6:00 PM	1
80	Crossroads Collective, LLC	Crossroads Collective	TIM B GOKHMAN, Agt	2238 N Farwell AV	Class B Tavern License	231	12/10/2025, 6:00 PM	1
81	The Jazz Estate Inc	The Jazz Estate	JOHN M DYE, Agt	2423 N MURRAY AV	Class B Tavern License	62	12/14/2025, 6:00 PM	1
82	Stone Bowl Grill, LLC	Stone Bowl	Young B Kim, Agt	1958-62 N Farwell AV	Class B Tavern License	99	12/15/2025, 6:00 PM	1
83	Apollo Cafe, LLC	Apollo Cafe	NIKOLAOS A LIMBERATOS, Agt	1310 E BRADY ST	Class B Tavern License	100	12/19/2025, 6:00 PM	1
84	MAA VERAI, INC.	Murray Pantry	Sandipkumar M Patel, Agt	2430 N MURRAY AV	Class A Malt & Class A Liquor License		1/16/2026, 6:00 PM	1

Establishments within a 0.5 miles radius centered on area of interest.



Tuesday, April 15, 2025



# Notice of Public Hearing

Blank Notice

---

CHEKKALA, Ram mohan rao, Agent  
KOPPA'S FULBELI DELI at 1940 N FARWELL Av  
Class A Malt & Class A Liquor, Food Dealer and Weights & Measures Licenses Application

**Tuesday, April 29, 2025 at 1:35 PM**

To whom it may concern:

The above application has been made by the above named applicant(s). This requires approval from the Licenses Committee and the Common Council of the City of Milwaukee. The hearing before the Licenses Committee will take place on 4/29/2025 at 1:35 PM in Room 301-B, Third Floor, City Hall. This is a public hearing. Those wishing to view the proceeding are able to do so via the City Channel – Channel 25 on Spectrum Cable – or on the Internet at <http://city.milwaukee.gov/citychannel>. Those wishing to provide oral testimony via internet are asked to contact the staff assistant, Yadira Melendez at (414) 286-2775 or [stasst5@milwaukee.gov](mailto:stasst5@milwaukee.gov) for necessary information. Please make such requests no later than one business day prior to the start of the meeting. You are not required to attend the hearing, but please see the information below if you would like to provide testimony. Once the Licenses Committee makes its recommendation, this recommendation is forwarded to the full Common Council for approval at its next regularly scheduled hearing.

---

## Important details for those wishing to provide information for the Licenses Committee to consider when making its recommendation:

1. The license application is scheduled to be heard at the above time. Due to other hearings running longer than scheduled, you may have to wait some time to provide your testimony.
2. You must appear in person and testify as to matters that you have personally experienced or seen. (You cannot provide testimony for your neighbor, parent or anyone else; this is considered hearsay and cannot be considered by the committee.)
3. No letters or petitions can be accepted by the committee (unless the person who wrote the letter or the persons who signed the petition are present at the committee hearing and willing to testify).
4. Persons opposed to the license application are given the opportunity to testify first; supporters may testify after the opponents have finished.
5. When you are called to testify, you will be sworn in and asked to give your name, and address. (If your first and/or last names are uncommon please spell them.)
6. You may then provide testimony.
  - a. Include only information relating to the above license application.
  - b. Include only information you have personally witnessed or seen.
  - c. Provide concise and relevant information detailing how this business has affected or may affect the peaceful enjoyment of your neighborhood.
  - d. If by the time you have the opportunity to testify, the information you wish to share has already been provided to the committee, you may state that you agree with the previous testimony. Redundant or repetitive testimony will not assist the committee in making its recommendation.
7. After giving your testimony, the members of the Licenses Committee and the licensee may ask questions regarding the testimony you have given or other factors relating to the license application.
8. Business Competition is not a valid basis for denial or non-renewal of a license.  
**Please Note: If you have submitted an objection to the above application your objection cannot be considered by the committee unless you personally testify at the hearing.**

[illegible]

CURRENT OCCUPANT	1632 E IRVING PL# 26	MILWAUKEE, WI 53202-1416
CURRENT OCCUPANT	1632 E IRVING PL# 27	MILWAUKEE, WI 53202-1416
CURRENT OCCUPANT	1632 E IRVING PL# 28	MILWAUKEE, WI 53202-1416
CURRENT OCCUPANT	1632 E IRVING PL# 31	MILWAUKEE, WI 53202-1416
CURRENT OCCUPANT	1632 E IRVING PL# 32	MILWAUKEE, WI 53202-1416
CURRENT OCCUPANT	1632 E IRVING PL# 33	MILWAUKEE, WI 53202-1416
CURRENT OCCUPANT	1632 E IRVING PL# 34	MILWAUKEE, WI 53202-1416
CURRENT OCCUPANT	1632 E IRVING PL# 35	MILWAUKEE, WI 53202-1416
CURRENT OCCUPANT	1632 E IRVING PL# 36	MILWAUKEE, WI 53202-1416
CURRENT OCCUPANT	1632 E IRVING PL# 37	MILWAUKEE, WI 53202-1416
CURRENT OCCUPANT	1632 E IRVING PL# 38	MILWAUKEE, WI 53202-1416
CURRENT OCCUPANT	1632 E IRVING PL# 41	MILWAUKEE, WI 53202-1416
CURRENT OCCUPANT	1632 E IRVING PL# 42	MILWAUKEE, WI 53202-1416
CURRENT OCCUPANT	1632 E IRVING PL# 43	MILWAUKEE, WI 53202-1416
CURRENT OCCUPANT	1632 E IRVING PL# 44	MILWAUKEE, WI 53202-1416
CURRENT OCCUPANT	1632 E IRVING PL# 45	MILWAUKEE, WI 53202-1416
CURRENT OCCUPANT	1632 E IRVING PL# 46	MILWAUKEE, WI 53202-1416
CURRENT OCCUPANT	1632 E IRVING PL# 47	MILWAUKEE, WI 53202-1416
CURRENT OCCUPANT	1632 E IRVING PL# 48	MILWAUKEE, WI 53202-1416
CURRENT OCCUPANT	1704 E KANE PL# A	MILWAUKEE, WI 53202-1410
CURRENT OCCUPANT	1704 E KANE PL# B	MILWAUKEE, WI 53202-1714
CURRENT OCCUPANT	1704 E KANE PL# C	MILWAUKEE, WI 53202-1714
CURRENT OCCUPANT	1704 E KANE PL# D	MILWAUKEE, WI 53202-1714
CURRENT OCCUPANT	1704 E KANE PL# E	MILWAUKEE, WI 53202-1714
CURRENT OCCUPANT	1704 E KANE PL# F	MILWAUKEE, WI 53202-1714
CURRENT OCCUPANT	1705 E KANE PL# 3	MILWAUKEE, WI 53202-1713
CURRENT OCCUPANT	1705 E KANE PL# 4	MILWAUKEE, WI 53202-1713
CURRENT OCCUPANT	1714 E IRVING PL# 1	MILWAUKEE, WI 53202-1458
CURRENT OCCUPANT	1714 E IRVING PL# 2	MILWAUKEE, WI 53202-1458
CURRENT OCCUPANT	1714 E IRVING PL# 3	MILWAUKEE, WI 53202-1458
CURRENT OCCUPANT	1714 E IRVING PL# 4	MILWAUKEE, WI 53202-1458
CURRENT OCCUPANT	1714 E IRVING PL# 5	MILWAUKEE, WI 53202-1458
CURRENT OCCUPANT	1714 E IRVING PL# 6	MILWAUKEE, WI 53202-1458
CURRENT OCCUPANT	1714 E KANE PL# H	MILWAUKEE, WI 53202-1714
CURRENT OCCUPANT	1714 E KANE PL# I	MILWAUKEE, WI 53202-1714
CURRENT OCCUPANT	1714 E KANE PL# J	MILWAUKEE, WI 53202-1714
CURRENT OCCUPANT	1714 E KANE PL# K	MILWAUKEE, WI 53202-1714
CURRENT OCCUPANT	1714 E KANE PL# L	MILWAUKEE, WI 53202-1714
CURRENT OCCUPANT	1714 E KANE PL# M	MILWAUKEE, WI 53202-1714
CURRENT OCCUPANT	1715 E IRVING PL	MILWAUKEE, WI 53202-1457
CURRENT OCCUPANT	1811 E LAFAYETTE PL	MILWAUKEE, WI 53202-1160
CURRENT OCCUPANT	1817 E LAFAYETTE PL# 1	MILWAUKEE, WI 53202-1160
CURRENT OCCUPANT	1817 E LAFAYETTE PL# 2	MILWAUKEE, WI 53202-1160
CURRENT OCCUPANT	1817 E LAFAYETTE PL# 3	MILWAUKEE, WI 53202-1160
CURRENT OCCUPANT	1825 E LAFAYETTE PL# M	MILWAUKEE, WI 53202-1160
CURRENT OCCUPANT	1825 E LAFAYETTE PL# N	MILWAUKEE, WI 53202-1160
CURRENT OCCUPANT	1825 E LAFAYETTE PL# O	MILWAUKEE, WI 53202-1160

[illegible]



[illegible]

[illegible]

[illegible]

CURRENT OCCUPANT	1981 N PROSPECT AVE# 1	MILWAUKEE, WI 53202-1450
CURRENT OCCUPANT	1981 N PROSPECT AVE# 2	MILWAUKEE, WI 53202-1450
CURRENT OCCUPANT	1981 N PROSPECT AVE# 3	MILWAUKEE, WI 53202-1450
CURRENT OCCUPANT	1981 N PROSPECT AVE# 4	MILWAUKEE, WI 53202-1450
CURRENT OCCUPANT	1981 N PROSPECT AVE# 5	MILWAUKEE, WI 53202-1495
CURRENT OCCUPANT	1981 N PROSPECT AVE# 6	MILWAUKEE, WI 53202-1495
CURRENT OCCUPANT	1981 N PROSPECT AVE# 7	MILWAUKEE, WI 53202-1495
CURRENT OCCUPANT	1981 N PROSPECT AVE# 8	MILWAUKEE, WI 53202-1495

Blank Notice

Total Records: 289

Radius 250 feet and Center of the Circle: 1940 N Farwell Av



## BUSINESS LICENSE PLAN OF OPERATION

ccl-busplan 5/12/2020

Office of the City Clerk License Division

200 E. Wells St. Room 105, Milwaukee, WI 53202

(414) 286-2238 www.milwaukee.gov/license e-mail address: [license@milwaukee.gov](mailto:license@milwaukee.gov)

### 1. Type of Business

Applying for: ☐ Extended Hours (12AM to 5AM) - If a food establishment, check all that apply: ☐ Delivery ☐ Drive Thru ☐ Dining Room  
☐ Self Service Laundry ☐ Massage Establishment ☐ Filling Station  
☒ Other (supplemental application for specific license also required)

Provide a detailed description of the type of business you plan on operating:

Liquor, C-Store, Deli

Do you have any experience operating this type of business? ☒ No ☐ Yes If yes, explain:

### 2. Business Operations

- a. Proposed Opening Date: 03/01/2025
- b. Is this premise under construction? ☒ No ☐ Yes If yes, list estimated completion date: \_\_\_\_\_
- c. Is this a franchise? ☒ No ☐ Yes
- d. Is this premises currently licensed? ☐ No ☒ Yes If yes, list type of license: FOOD CLASS A LIQUOR, 9A, WEIGHT  
8 HOURS
- e. Is the current licensee operating? ☐ No ☒ Yes If no, list date closed: \_\_\_\_\_
- f. Do you have future plans for other businesses, licenses or permits at this location? ☒ No ☐ Yes  
If yes, explain: \_\_\_\_\_
- g. Have you previously held an Extended Hours License in Milwaukee? ☒ No ☐ Yes  
If yes, list address(es): \_\_\_\_\_
- h. Are other businesses operating in the same building? ☒ No ☐ Yes If yes, describe: \_\_\_\_\_

### 3. Litter & Noise

- a. How are grounds kept clean? ☒ Sweep ☐ Pressure Wash ☒ Pick Up Litter ☐ Other: \_\_\_\_\_
- b. How often will grounds be cleaned? ☒ Daily ☐ Weekly ☒ As Needed ☐ Monthly ☐ Other: \_\_\_\_\_
- c. Grounds cleaned by: ☒ Licensee ☐ Building Owner ☒ Employees ☐ Hired Maintenance ☐ Other: \_\_\_\_\_
- d. How are noise issues prevented and/or addressed? ☐ Security ☒ Manager approaches customer(s) ☐ Call Police  
☐ Signs Posted ☐ Other: \_\_\_\_\_
- e. Will a sound amplification system be used? ☒ No ☐ Yes If yes, describe: \_\_\_\_\_

### 4. Smoking & Sanitation

- a. Are there designated outdoor smoking areas? ☒ No ☐ Yes If yes, describe: 1 2 1
- b. Number of Garbage Cans: Inside: 6 Locations: BY FRONT DOOR, CASHIER, DELI, STORE  
Outside: 1 Locations: BY FRONT DOOR
- c. Is a crowd control barrier used? ☒ No ☐ Yes If yes, describe: \_\_\_\_\_
- d. How many restrooms are on the premises? 1
- e. Name of solid waste contractor: ☐ Advanced Disposal ☒ Waste Management ☐ Other: \_\_\_\_\_

## 5. Security

- a. Are there onsite parking spaces? ☒ No ☐ Yes If yes, how many? \_\_\_\_\_ and describe the parking security plan: \_\_\_\_\_
- b. Is there a loading zone? ☒ No ☐ Yes If yes, describe the loading area security plan: \_\_\_\_\_
- c. Will you have licensed security on premise? ☒ No ☐ Yes If yes, how many? \_\_\_\_\_ and answer the following:  
 What are their responsibilities? \_\_\_\_\_  
 Describe equipment used \_\_\_\_\_  
 List their License Number (s) \_\_\_\_\_
- d. Will there be security cameras? ☐ No ☒ Yes If yes, how many? 16 and list locations: MONITORS INSIDE & STORE SURROUNDINGS
- e. Will searches/identification checks be done upon entry? ☒ No ☐ Yes If yes, describe \_\_\_\_\_

## 6. Percentage of Sales (must total 100%)

Alcohol <u>60</u> %	Food <u>20</u> % Cigarettes, Electronic Vape Devices, Tobacco Products <u>20</u> %	Secondhand Merchandise <u>0</u> %	Precious Metals & Gems <u>0</u> %
Entertainment <u>0</u> %	Salvaged Materials <u>0</u> % (such as scrap metal)	Personal Services (such as tattoo, body piercing, salon, tailor, tanning, etc.) _____ %	Other <u>0</u> % Describe: <u>0</u>
Pawnbroker Activity <u>0</u> %			

## 7. Businesses/Licenses on the Premises (check all that apply):

### Type 1

- ☐ Full Service Restaurant ☐ Cafe/Coffee Shop ☒ Deli or Fast Food Restaurant ☐ Private/Fraternal/Veterans Club
- ☐ Night Club ☐ Tavern ☐ Cocktail Lounge ☐ Teen Club
- ☐ Banquet Hall ☐ Sports Facility ☐ Bowling Alley
- ☐ Hotel/Motel: Number of Floors: \_\_\_\_\_ Number of Rooms: \_\_\_\_\_  
 Rooming House: Number of Floors: \_\_\_\_\_ Number of Rooms: \_\_\_\_\_

### Type 2

- ☒ Liquor Store ☐ Corner Store ☐ Supermarket ☒ Convenience Store
- ☐ Gas Station ☐ Amusement/Phonograph Distributor ☐ Recycling, Salvage or Towing
- ☐ Used Car Dealer ☐ Personal Service Establishment (such as tattoo business, hair salon, tailor, etc.) ☐ Recording Studio

What other licenses/permits will you hold at this location? (check all that apply)

- ☐ Occupancy Permit ☐ Cigarette, Tobacco, Electronic Vape Products ☐ Gas Station ☐ Extended Hours ☐ Class "B" Tavern ☐ Weights & Measures
- ☐ Secondhand Dealer ☐ Precious Metal & Gem ☐ Other: \_\_\_\_\_

## 8. Legal Capacity (only if a Type 1 premises in #7 above)

Capacity \_\_\_\_\_ (Call the Milwaukee Development Center at 414-286-8211 if you have questions.)

— N/A —

## 9. Premises Description

a. Identify all area(s) of the premises that will be used in operating this business (include areas used only for storage):

☒ 1<sup>st</sup> Floor ☐ 2<sup>nd</sup> Floor ☐ Basement Storage ☐ Patio ☐ Beer Garden ☐ Sidewalk Café ☐ Deck ☐ Rooftop

☐ Other: Describe: \_\_\_\_\_

b. Describe Location: ☒ Major Thoroughfare ☐ Secondary Street ☐ Other: \_\_\_\_\_

c. Nearest Major Cross Street: N FARMER AVE & E IRVING PL

d. Describe Building: ☒ Free Standing Building ☐ Strip Mall ☐ Other: \_\_\_\_\_

e. Describe Premises Structure: ☒ Single Story ☐ Multi-Story - # of Stories \_\_\_\_\_ ☐ Other: \_\_\_\_\_

f. Describe Surrounding Area: ☒ Commercial ☒ Residential ☐ Industrial ☐ Other: \_\_\_\_\_

g. Building Owner Name: JEROME SHIMEK Phone Number: 414-828-3083

Building Owner Address: 1600 Indianwood DR, Brookfield, WI - 53005

## 10. Hours of Operation & Customers

Will customers be entering the premises? ☐ No ☒ Yes

Day of the Week	Proposed Hours of Operation:		Estimated Number of Customers expected each day	Potential Age Range of Customers	Class B Tavern Applicant Only: Age Restriction (If none, write 'None')
	Open Time (include a.m. or p.m.)	Close Time (include a.m. or p.m.)			
Sunday	8:00 AM	9:00 PM	150	ALL	NONE
Monday	8:00 AM	9:00 PM	150	ALL	NONE
Tuesday	8:00 AM	9:00 PM	150	ALL	NONE
Wednesday	8:00 AM	9:00 PM	150	ALL	NONE
Thursday	8:00 AM	9:00 PM	150	ALL	NONE
Friday	8:00 AM	9:00 PM	150	ALL	NONE
Saturday	8:00 AM	9:00 PM	150	ALL	NONE

An Extended Hours Establishment License is required for any convenience store, filling station, personal service establishment (such as tattoo, body piercing, salon, tailor, tanning, etc.), recording studio or restaurant which is open between the hours of 12:00 a.m. and 5:00 a.m.

Alcohol Establishments Class A: 8:00 am to 9:00 pm Sunday thru Saturday  
Permitted Hours of Operation: Class B: 6:00 am to 2:00 am Sunday thru Thursday, 6:00 am to 2:30 am Friday & Saturday

Entertainment Outdoor Closing Hours: 10:00pm Sunday-Thursday; 12:00am Friday & Saturday; unless a different time, either earlier or later, is established by the Common Council in its approval of the licensee's plan of operation.

## 11. Signature(s)

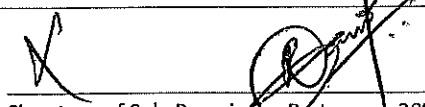
  
Signature of Sole Proprietor, Partner, or 20% or more Shareholder  
(If there are no 20% or more shareholders,  
Corporate Officer-print name/title and sign)

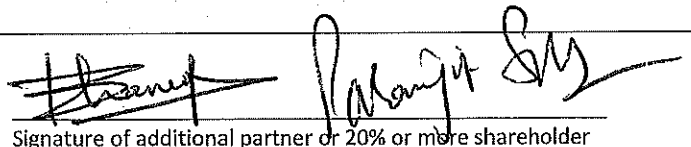
  
Signature of additional partner or 20% or more shareholder

See Application Information for a complete list of all required application forms.



# ALCOHOL BEVERAGE & PUBLIC ENTERTAINMENT PREMISES SUPPLEMENTAL APPLICATION

Office of the City Clerk License Division  
200 E. Wells St. Room 105, Milwaukee, WI 53202  
(414) 286-2238 e-mail address: license@milwaukee.gov [www.milwaukee.gov/license](http://www.milwaukee.gov/license)

Legal Entity Name: 3 EYE LLC.

Premise Address: 1940 N FARWELL AVE MILWAUKEE WI 53202

## Proximity of Premises to Church, School, Daycare Center or Hospital

Is the building within 300 feet of any church, school, daycare center or hospital? ☒ No ☐ Yes

## "Service Bar Only" Designation

If applying for Class B or C license, are you applying for "Service Bar Only"? ☒ No ☐ Yes

Service Bar Only means customers cannot sit at the bar. Alcohol is served to employees who serve patrons seated at tables. No stools, chairs or other articles of furniture shall be placed at the service bar for patrons to sit upon.

## Business Information

a) Are you taking out this application for anyone that may not be eligible for a license? ☒ No ☐ Yes

If yes, list their name and address: \_\_\_\_\_

b) Will the agent, a partner or the individual licensee be conducting the day-to-day operations of the business? ☐ No ☒ Yes

If no, list the name and address of the person(s) who will: \_\_\_\_\_

Class B Applicants: If the agent, a partner or the individual licensee will not be conducting the day-to-day operations of the business, the person(s) listed above must obtain a Class B Managers license.

c) Does anyone else have money invested or any other interest in this business? ☒ No ☐ Yes

If yes, explain: \_\_\_\_\_

d) Have you made an agreement with anyone to repay any loan or any other payments based upon income from the business?

☒ No ☐ Yes If yes, list name and address: \_\_\_\_\_

## Property Information (New & Transfer Applicants Only)

a) Do you own or lease the building? ☐ Own ☒ Lease

b) Who owns the fixtures (for example, coolers, etc.)? 3 EYE LLC

c) Are you purchasing the stock and/or fixtures? ☐ No ☒ Yes If yes, amount paid \$ 100,000 APPROX.

d) Total amount paid for business \$ 0.00

e) Total amount paid for goodwill of the business \$ 175,000

Goodwill comprises the reputation and customer relationships of an existing business. If the price you pay for the business exceeds the fair market value of all of the rest of the assets of the business, the excess may be considered goodwill.

f) Have you made arrangements with the seller for payment of personal property taxes? ☐ No ☒ Yes

## Lease Information (New & Transfer Applicants who are leasing the premises only)

a) Date lease begins 04/1/2025 Ends 03/31/2035

b) Monthly rental \$ 8500

c) Do you have an option to renew the lease? ☐ No ☒ Yes

d) Does your lease allow for assignment to another party without the consent of the owner? ☒ No ☐ Yes

e) For what length of time have you been guaranteed occupancy (number of years)? 10 years



## Lease Information (Continued)

- f) In addition to paying the monthly rental, will you have to pay anything additional to the owner of the building to guarantee performance of the lease? ☒ No ☐ Yes If yes, explain \_\_\_\_\_
- g) Does the present owner or occupant object to the granting of your license? ☒ No ☐ Yes  
If yes, explain \_\_\_\_\_

## Change of Agent Applicants Only

Have there been any changes to the floor plan since the last application was submitted? ☒ No ☐ Yes  
If no, a new floor plan is not required. If yes, submit a new floor plan and explain the change(s):  
\_\_\_\_\_

## Signature

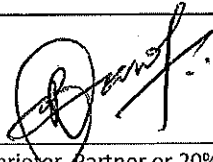

Signature of Sole Proprietor, Partner or 20% or More Shareholder  
(If no 20% or more Shareholder, Corporate Officer - print name/title and sign)

Note: All information contained in this application is subject to approval by the Common Council.  
Deviating from approved plan of operation will subject licensee to citations, and/or suspension or non-renewal of the license.  
Contact the License Division for information on how to request changes.

## New and transfer of premises applicants must submit the following:

- ☐ Detailed floor plan  
☐ If a restaurant, copy of the menu

**FOOD DEALER LICENSE PLAN OF OPERATION**

OFFICE OF THE CITY CLERK, LICENSE DIVISION  
CITY HALL, 200 E. WELLS ST, ROOM 105, MILWAUKEE, WI 53202  
(414) 286-2238 • [license@milwaukee.gov](mailto:license@milwaukee.gov) • [www.milwaukee.gov/license](http://www.milwaukee.gov/license)

Legal Entity Name:

3 BYE LLC

Premises Address:

1940 N FARWELL AVE MILWAUKEE WI 53202

**SECTION 1****TYPE OF BUSINESS**

What will be the majority of your food sales? (check one)

☐ Restaurant Items (meals):

MEALS include, but are not limited to, chicken, ribs, sandwiches, roasted corn, baked potatoes, hot dogs, brats, tacos, nachos w/ cheese and meat, French fries, cooked or deep fried vegetables/fruit, cooked cheese curds, corn dogs, egg rolls, salads.

☒ Retail Items (snacks and beverages):

RETAIL items include, but are not limited to, ice cream/soft serve, lemonade, snow cones, coffee, espresso, cappuccino, tea, fruit juice, smoothies, candy, dispensed soda, fruit cups, bakery, cookies, kettle corn, cotton candy, funnel cakes, fritters, tortilla chips w/ cheese.

Will it be a convenience store? ☒ Yes ☐ No

A convenience store contains less than 7,500 square feet of retail space and has, as its primary business, the sale of basic food items and in addition, sells household products or is a filling station that sells basic food items and household products.

☐ Bed & Breakfast☐ Micro Market

All Applicants: Submit a menu or a list of food items that will be sold.

Will any wholesale business be done? ☒ No ☐ Yes If yes, what percentage of food sales will be wholesale?☐ Less than 25%☐ 25% or More AND:☐ Restaurant items (meals) will be sold – Complete this application and also contact DATCP.☐ NO restaurant items (meals) will be sold - Do NOT complete this application. Contact DATCP only.**SECTION 2****FOOD PROCESSING**Will any food processing be done? ☐ No ☒ Yes

Processing is defined as assembling, grinding, cutting, mixing, baking, coating, stuffing, packing, bottling, grilling, canning, extracting, fermenting, distilling, pickling, freezing, drying, smoking, or packaging.

**SECTION 3****FOOD REQUIRING TEMPERATURE CONTROL**Will any food that requires temperature control be sold? ☐ No ☒ Yes

(includes dairy products such as milk, cheese, and ice cream, fish, shellfish, meat, poultry)

If yes, list the types of food items: MILK, CHEESE, ICE-CREAM, MEAT, POULTRY

**SECTION 4 DETAILS OF OPERATION**

- Will you have seating on site for dining? ☐ No ☒ Yes
- Will you be doing any catering? ☒ No ☐ Yes
- Will you be doing any delivery? ☒ No ☐ Yes
- Will you have outdoor activities? ☒ No ☐ Yes - Check all that apply: ☐ Bar ☐ Cooking/Grilling ☐ Dining
- Will you have a drive thru window? ☒ No ☐ Yes - Are hours different from inside? ☐ No ☐ Yes
- If Yes, provide drive thru hours: \_\_\_\_\_
- Will scales or barcode scanners be used? ☐ No ☒ Yes - You must also apply for a Weights & Measures License.

**SECTION 5 ADDITIONAL SITES**

Where will food be prepared and/or sold?

- ☒ At a single site ☐ At multiple sites: How many? \_\_\_\_\_ (for example, a hotel with several dining rooms or bars)

If multiple sites, attach a Food Dealer Additional Site Addendum (ccl-foodadd) for each additional site.

**SECTION 6 CONSTRUCTION OR CHANGES**

Are you planning any construction, remodeling or equipment changes?

- ☒ No If No, SKIP to Section 7
- ☐ Yes If Yes, check all that apply: ☐ New construction of a building ☐ Renovation or remodeling
- ☐ Construction changes to existing building ☐ Equipment changes only

Provide a brief description of the changes: \_\_\_\_\_

Start date: \_\_\_\_\_

Name, Address &amp; Phone Number of Architect: \_\_\_\_\_

Name, Address &amp; Phone Number of Contractor: \_\_\_\_\_

**SECTION 7 ALCOHOL BEVERAGES**

Are you applying for an alcohol beverage license?

- ☐ No If No, SKIP to Section 8
- ☒ Yes If YES, if your food license is approved prior to the alcohol license, when do you want the food license issued?
- ☐ Immediately ☒ At the same time as the alcohol license

**SECTION 8 ACKNOWLEDGEMENTS & SIGNATURE**

You must initial each item confirming your understanding:

RC

I understand the Health Department must conduct an inspection and advise the License Division of their approval before the license may be issued.

RC

I understand I must obtain an occupancy permit from the Department of Neighborhood Services and an inspection may be required. Neighborhood Services must advise the License Division of their approval before the license may be issued.

RC

I understand the district alderperson will review and either support or object to my application. If he/she objects, I may appeal and be scheduled to appear before the Licenses Committee. The Licenses Committee will then make a recommendation to the Common Council. The Common Council must grant the license before it may be issued.

RC

I understand proof of payment for all license fees must be on file in the License Division before the license may be issued and the license must be issued and posted in my establishment prior to opening for business.

RC

I will not operate my food business until the license has been issued and posted in the establishment.

Signature of Sole Proprietor, Partner, or 20% Shareholder: \_\_\_\_\_

Signature of Additional Partner: \_\_\_\_\_



## WEIGHTS & MEASURES PLAN OF OPERATION

ccl-wmpln 1/9/18

Office of the City Clerk License Division  
200 E. Wells St. Room 105, Milwaukee, WI 53202  
(414) 286-2238 [www.milwaukee.gov/license](http://www.milwaukee.gov/license) [license@milwaukee.gov](mailto:license@milwaukee.gov)

Legal Entity Name:

3 Eye LLC

Premise Address:

1940 N Farwell Ave

### Type of Business

Provide a brief description of the establishment/business:

LIQUOR STORE, C-STORE & Deli

Other licenses may be required depending on the type of business you are operating.

### Litter & Noise

- a. How are grounds kept clean? ☒ Sweep ☐ Pressure Wash ☒ Pick Up Litter ☐ Other: \_\_\_\_\_
- b. How often will grounds be cleaned? ☒ Daily ☐ Weekly ☒ As Needed ☐ Monthly ☐ Other: \_\_\_\_\_
- c. Grounds cleaned by: ☒ Licensee ☐ Building Owner ☒ Employees ☐ Hired Maintenance ☐ Other: \_\_\_\_\_
- d. How are noise issues prevented and/or addressed? ☐ Security ☒ Manager approaches customer(s) ☐ Call Police  
☐ Signs Posted ☐ Other: \_\_\_\_\_

### Signature

Signature of Sole Proprietor, Partner, or 20% or more Shareholder  
(If there are no 20% or more shareholders,  
Corporate Officer-print name/title and sign)

Signature of additional partner or 20% or more shareholder

This form must be submitted with the Business License Application, Weights & Measures License Supplemental Application, and appropriate fee. Forms can be obtained online at [www.milwaukee.gov/licenses](http://www.milwaukee.gov/licenses).



# WEIGHTS & MEASURES LICENSE SUPPLEMENTAL APPLICATION

OFFICE OF THE CITY CLERK, LICENSE DIVISION  
CITY HALL, 200 E. WELLS ST, ROOM 105, MILWAUKEE, WI 53202  
(414) 286-2238 • [license@milwaukee.gov](mailto:license@milwaukee.gov) • [www.milwaukee.gov/license](http://www.milwaukee.gov/license)

## Office Use Only:

App# \_\_\_\_\_  
Filed \_\_\_\_\_  
Initials \_\_\_\_\_  
Paid \_\_\_\_\_  
Lic # \_\_\_\_\_

Legal Entity Name: 3 EYE LLC

Premise Address: 1940 N FAIRVIEW AVE

### Device Type(s)

- Check all device types for which you need a license.
  - For each device type checked, indicate how many you have in the Number of Devices column (b).
  - Calculate the Total Fee Per Device Type by multiplying the Fee Per Device Type (a) by the Number of Devices (b).
  - Add all Total Fee Per Device Type amounts together and that will be your Total Fee Due.
- \* **Exception:** The Scanner fee is not per device. Check the box for the appropriate range.  
If you have 1-3 scanners, the total due is \$130. If you have 4 or more scanners, the total due is \$250.  
Check the Number of Devices (b).

Device Type	License Period	Fee Per Device Type (a)	Number of Devices (b)	Total Fee Per Device Type (a x b)
<b>Liquid Measuring Devices</b>				
<input type="checkbox"/> Retail Petroleum Meters	12 months	\$60		
<input type="checkbox"/> 0 to 30 gallons per minute	24 months	\$60		
<input type="checkbox"/> 31 to 200 gallons per minute	24 months	\$250		
<input type="checkbox"/> Over 200 gallons per minute	24 months	\$250		
<b>Scales</b>				
<input checked="" type="checkbox"/> Measuring any weight amount	24 months	\$55	<u>1</u>	
<b>Scanners</b>				
		Fee for scanners is by range	Check how many scanners you have	
<input checked="" type="checkbox"/> Up to 3 scanners	24 months	\$130 total*	<input checked="" type="checkbox"/> 1 <input type="checkbox"/> 2 <input type="checkbox"/> 3	
<input type="checkbox"/> Four or more scanners	24 months	\$250 total*	<input type="checkbox"/> 4 <input type="checkbox"/> Other _____	
<b>Other Devices</b>				
<input type="checkbox"/> Length Measuring Device	24 months	\$60		
<input type="checkbox"/> Timing Device	24 months	\$30		

**Total Fee Due**

### Signature

I hereby agree that I will comply with the applicable sections of the Wisconsin State Statutes, Administrative Code and the Milwaukee Code of Ordinances regarding the operation of weighing and measuring devices.

I understand that all devices must be operated within the specifications, tolerances and other technical requirements set forth in the National Institute of Standards and Technology Handbook 44. I understand that the license for which I am applying must be posted on the premises or in my vehicle prior to opening for business or operating the device.

I understand that these device licenses are not transferable (with the exception of scanners). If the device is replaced or needs to be resealed, I must apply for and receive a new license so that an inspection of the device can be performed prior to its use. I acknowledge that as a condition of being issued this license, I must allow the Health Department into the establishment to test the device to validate its specifications/tolerances. If my devices are found out of compliance, I may be charged inspection fees. I have read, understand, and will adhere to all the above acknowledgments.

Signature of Sole Proprietor, Partner, or 20% or more Shareholder  
(If there are no 20% or more shareholders, Corporate Officer-print name/title and sign)

Signature of additional partner or 20% or more shareholder

This form must be submitted with the Business License Application, Weights & Measures Plan of Operation, and appropriate fee. Forms can be obtained online at [www.milwaukee.gov/licenses](http://www.milwaukee.gov/licenses).

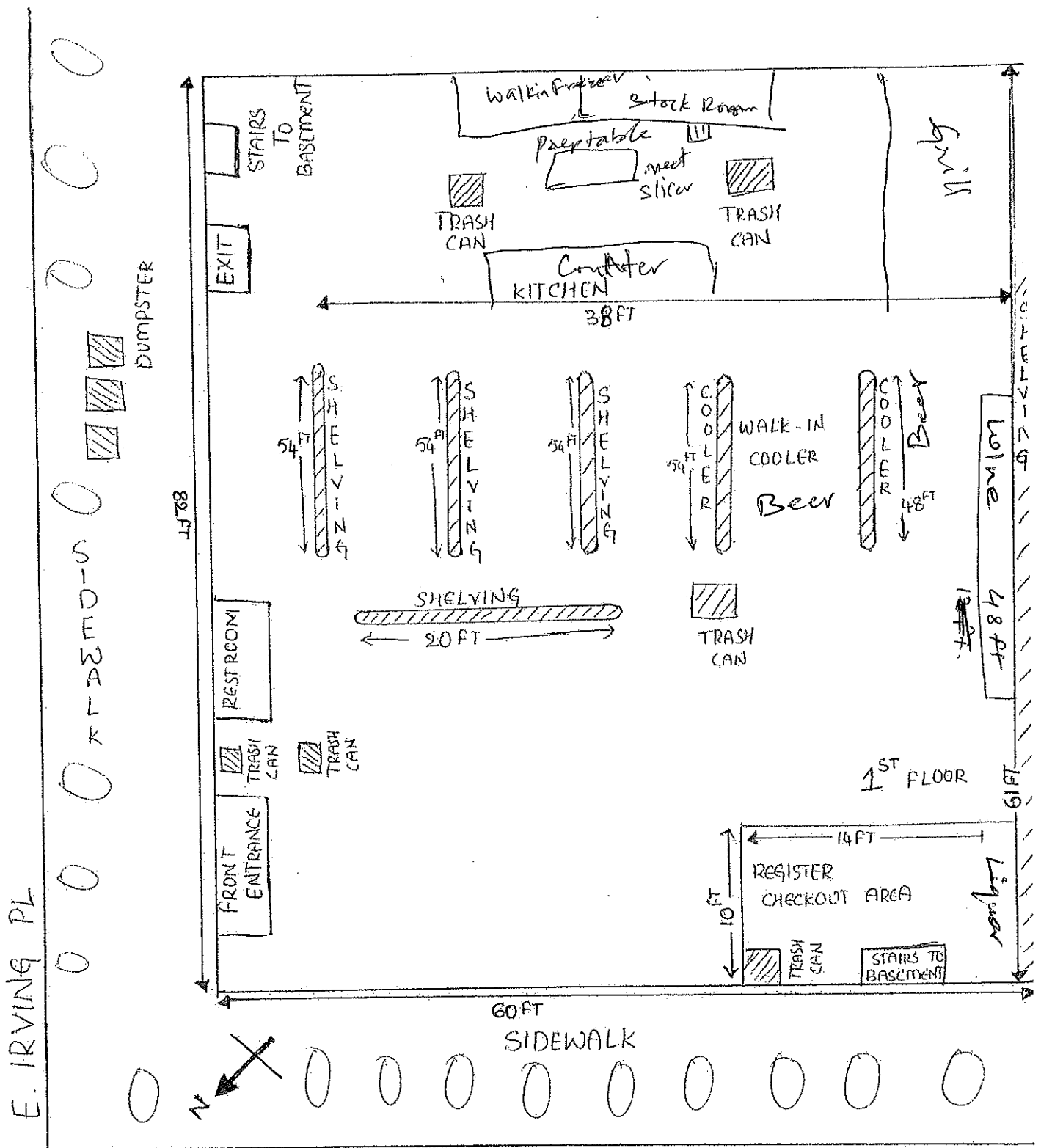

N. FAREWELL AVE

Chekkala, Ram Mohan Rao Agent for 3EYE LLC  
KOPPAS FULBELI DELI

1/15/2025  
1940 N. FAREWELL AVE  
MILWAUKEE, WI 53202

TOTAL SQUARE  
FOOTAGE = 5880

## VEGETARIAN

**Deli Lama** \$5.99  
Peanut butter, cheese, tomato, cucumber, red onion, sprouts, and a side of hummus on a sub roll.

**Atlantis** \$5.99  
Mozzarella and cheddar cheese, green pepper, tomato, cucumber, red onion, sprouts, and a side of hummus on a sub roll.

**Euphrata** \$5.99  
Grilled chicken, green pepper, tomato, cucumber, red onion, sprouts, and a side of hummus on a sub roll.

**Moon** \$4.99  
American cheese, tomato, cucumber, red onion, sprouts, and a side of hummus on a sub roll.

**Sun** \$4.99  
Sharp cheddar cheese, tomato, cucumber, red onion, sprouts, and a side of hummus on a sub roll.

**Elvis** \$4.99  
Peanut butter, cheese, tomato, cucumber, red onion, sprouts, and a side of hummus on a sub roll.

## GRILLED

**Frankwine** \$6.99  
Shaved turkey breast, tomato, cucumber, red onion, sprouts, and a side of hummus on a sub roll.

**Lunklunk** \$6.99  
Shaved ham, tomato, cucumber, red onion, sprouts, and a side of hummus on a sub roll.

**Oogle-Nogle** \$7.99  
Shaved ham, tomato, cucumber, red onion, sprouts, and a side of hummus on a sub roll.

**Saturn** \$6.99  
Shaved ham, tomato, cucumber, red onion, sprouts, and a side of hummus on a sub roll.

**Stralkowski** \$6.99  
Shaved ham, tomato, cucumber, red onion, sprouts, and a side of hummus on a sub roll.

**Uranus** \$7.99  
Shaved ham, tomato, cucumber, red onion, sprouts, and a side of hummus on a sub roll.

**Vellonecab** \$6.99  
Shaved ham, tomato, cucumber, red onion, sprouts, and a side of hummus on a sub roll.

**Satyr** \$6.99  
Shaved ham, tomato, cucumber, red onion, sprouts, and a side of hummus on a sub roll.

## SUBS

**Baron Rogers** \$8.99  
Shaved ham, tomato, cucumber, red onion, sprouts, and a side of hummus on a sub roll.

**Bread Favre** \$8.99  
Shaved ham, tomato, cucumber, red onion, sprouts, and a side of hummus on a sub roll.

**Jackalope** \$6.99  
Shaved ham, tomato, cucumber, red onion, sprouts, and a side of hummus on a sub roll.

**Nomesness** \$5.99  
Shaved ham, tomato, cucumber, red onion, sprouts, and a side of hummus on a sub roll.

**Jupiter** \$6.99  
Shaved ham, tomato, cucumber, red onion, sprouts, and a side of hummus on a sub roll.

**Mars** \$6.99  
Shaved ham, tomato, cucumber, red onion, sprouts, and a side of hummus on a sub roll.

**Yeti** \$6.99  
Shaved ham, tomato, cucumber, red onion, sprouts, and a side of hummus on a sub roll.

## PANINIS

**Nosslehouse** \$7.99  
Shaved ham, tomato, cucumber, red onion, sprouts, and a side of hummus on a sub roll.

**Merdlebock** \$7.99  
Shaved ham, tomato, cucumber, red onion, sprouts, and a side of hummus on a sub roll.

**Dirtleucus** \$8.99  
Shaved ham, tomato, cucumber, red onion, sprouts, and a side of hummus on a sub roll.

**Loopledum** \$7.99  
Shaved ham, tomato, cucumber, red onion, sprouts, and a side of hummus on a sub roll.

**Beetlegork** \$7.99  
Shaved ham, tomato, cucumber, red onion, sprouts, and a side of hummus on a sub roll.

**Jezzeidorf** \$7.99  
Shaved ham, tomato, cucumber, red onion, sprouts, and a side of hummus on a sub roll.

**Royce** \$7.99  
Shaved ham, tomato, cucumber, red onion, sprouts, and a side of hummus on a sub roll.

## HOMESTYLE

**Pluto** \$6.99  
Shaved ham, tomato, cucumber, red onion, sprouts, and a side of hummus on a sub roll.

**Rimpish** \$8.99  
Shaved ham, tomato, cucumber, red onion, sprouts, and a side of hummus on a sub roll.

**Venus** \$6.99  
Shaved ham, tomato, cucumber, red onion, sprouts, and a side of hummus on a sub roll.

**Neptune** \$4.99  
Shaved ham, tomato, cucumber, red onion, sprouts, and a side of hummus on a sub roll.

## UNDER \$5

**Moon** \$4.99  
American cheese, tomato, cucumber, red onion, sprouts, and a side of hummus on a sub roll.

**Sun** \$4.99  
Sharp cheddar cheese, tomato, cucumber, red onion, sprouts, and a side of hummus on a sub roll.

**Elvis** \$4.99  
Peanut butter, cheese, tomato, cucumber, red onion, sprouts, and a side of hummus on a sub roll.

**Neptune** \$4.99  
Shaved ham, tomato, cucumber, red onion, sprouts, and a side of hummus on a sub roll.

**BLT** \$4.99  
Bacon, lettuce, tomato, cucumber, red onion, sprouts, and a side of hummus on a sub roll.

**PB&J** \$3.99  
Peanut butter, cheese, tomato, cucumber, red onion, sprouts, and a side of hummus on a sub roll.

**KPPAS**  
World's Best Sandwiches  
MILWAUKEE, WISC.