



CITY OF MILWAUKEE
OFFICE OF THE CITY CLERK

Tuesday, June 18, 2019

COMMITTEE MEETING NOTICE

AD 06

ARIAS, Julio R, Agent
Jay's Towing MKE LLC
2010 N HOLTON St
Milwaukee, WI 53212

You are requested to attend a hearing which is to be held in Room 301-B, Third Floor, City Hall on:

Tuesday, June 25, 2019 at 02:30 PM

Regarding: Your Recycling, Salvaging, or Towing Premises License Application Requesting Non-Consensual Towing, Dealing, Storing, Transporting, Removing and/or Recycling Junk/Valuable Metal, and Dealing, Storing, and/or Transporting Salvaged Motor Vehicle Parts as agent for "Jay's Towing MKE LLC" for "Jay's Towing MKE LLC" at 3950 N HOLTON St #101DT.

There is a possibility that your application may be denied for one or more of the following reasons: The recommendation of the committee regarding the application shall be based on evidence presented at the hearing. Per MCO 85-2.7-4, probative evidence concerning whether or not a new license should be granted may be presented on the following subjects: whether or not the applicant meets the municipal requirements, the appropriateness of the location and premises where the licensed premises is to be located and whether use of the premises for the purposes or activities permitted by the license would tend to facilitate a public or private nuisance or create undesirable neighborhood problems such as disorderly patrons, unreasonably loud noise, litter, and excessive traffic and parking congestion. Probative evidence relating to these matters may be taken from the plan of operation submitted with the license application, if any, but shall not include the content of any music. Evidence regarding the fitness of the location of the premises to be maintained as the principal place of business, including but not limited to whether there is an overconcentration of businesses of the type for which the license is sought; whether the proposal is consistent with any pertinent neighborhood business or development plans, or the location's proximity to areas where children are typically present. The applicant's record in operating similarly licensed premises; and whether or not the applicant has been charged with or convicted of any felony, misdemeanor, municipal offense or other offense, the circumstances of which substantially relate to the activity to be permitted by the license being applied for or any other factor which reasonably relates to the public health, safety or welfare may also be considered. See attached police report or correspondence.

Notice for applicants with warrants or unpaid fines:

Proof of warrant satisfaction or payment of fines must be submitted at the hearing on the above date and time. Failure to comply with this requirement may result in a delay of the granting/denial of your application.

Failure to appear at this meeting may result in the denial of your license. Individual applicants must appear only in person or by an attorney. Corporate or Limited Liability applicants must appear only by the agent designated on the application or by an attorney. Partnership applicants must appear by a partner listed on the application or by an attorney. If you wish to do so and at your own expense, you may be accompanied by an attorney of your choosing to represent you at this hearing.

You will be given an opportunity to speak on behalf of the application and to respond and challenge any charges or reasons given for the denial. No petitions can be accepted by the committee, unless the people who signed the petition are present at the committee hearing and willing to testify. You may present witnesses under oath and you may also confront and cross-examine opposing witnesses under oath. If you have difficulty with the English language, you should bring an interpreter with you, at your expense, so that you can answer questions and participate in your hearing.

You may examine the application file at this office during regular business hours prior to the hearing date. Inquiries regarding this matter may be directed to the person whose signature appears below.

Limited parking for persons attending meetings in City Hall is available at reduced rates (5 hour limit) at the Milwaukee Center on the southwest corner of East Kilbourn and North Water Street. Parking tickets must be validated in the first floor information booth in City Hall.

PLEASE NOTE: Upon reasonable notice, efforts will be made to accommodate the needs of disabled individuals through sign language interpreters or other auxiliary aids. For additional information or to request this service, contact the Council Services Division ADA Coordinator at (414) 286-2998, Fax - (414) 286-3456, TDD - (414) 286-2025.

JIM OWCZARSKI, CITY CLERK

BY: _____

Jessica Celella

License Division Manager

If you have questions regarding this notice, please contact the License Division at (414) 286-2238.

200 E. Wells Street, Room 105, City Hall, Milwaukee, WI 53202. www.milwaukee.gov/license
Phone: (414) 286-2238 Fax: (414) 286-3057 Email Address: License@milwaukee.gov

MILWAUKEE POLICE DEPARTMENT LICENSING

CRIMINAL RECORD/ORDINANCE VIOLATION/INCIDENTS SYNOPSIS

DATE: 04/12/19
LICENSE TYPE: RST
NEW:
RENEWAL:

No. 291697
Application Date: 04/09/19

License Location: 3950 n. Holton Street #101DT
Business Name: Jay's Towing

Licensee/Applicant: ARIAS, Julio R
(Last Name, First Name, MI)
Date of Birth: 09/07/1987

Home Address: 2010 N. Holton Street
City: Milwaukee State: WI Zip Code: 53212
Home Phone: 414-628-0071

This report is written by Police Officer Corstan D. COURT, assigned to the License Investigation Unit, Days.

The Milwaukee Police Department's investigation regarding this application revealed the following:

1. On 07/13/13 the applicant was charged in Milwaukee County with Battery (Misdemeanor).

Charge: Disorderly Conduct
Finding: Guilty
Sentence: fine
Date: 04/11/14
Case: 2013CM003096

2. On 09/04/13 the applicant was cited in the City of Milwaukee at 2920 N. 4th Street (District #5) for Disorderly Conduct.

Charge: Disorderly Conduct
Finding: Guilty
Sentence: \$185.00 fine
Date: 10/23/13
Case: 13091021

3. On 05/27/14 the applicant was cited in the City of Milwaukee at 3045 N. 2nd Street for Disorderly Conduct and Vandalism.

Charge 1: Disorderly Conduct
2: Vandalism
Finding: Guilty
Sentence: \$568.00 fine
Date: 09/29/14
Case: 14042825/14042826

4. On 08/08/14 the applicant was charged in Milwaukee County with Possession of Firearm by Felon (Felony).

Charge: Possession of Firearm by Felon
Finding: Guilty
Sentence: 200 days House of Corrections, fine
Date: 10/06/16
Case: 2014CF003512

5. On 07/08/17 the applicant was cited in the City of Milwaukee at 2026 S. 29th Street for Sale/Discharge/Use of Fireworks.

Charge: Sale/Discharge/Use of Fireworks
Finding: **warrant issued for Failure to Appear for Arraignment**
Sentence:
Date:
Case: 17030918

6. On 09/15/17 the applicant was charged in Milwaukee County with Threat to Law Enforcement Officer and Battery or Threat to Judge, Prosecutor, or Law Enforcement Officer (Felonies).

Charge: Disorderly Conduct
Finding: Guilty
Sentence: 60 days House of Corrections
Date: 07/30/18
Case: 2017CF004294



Tuesday, June 18, 2019



Notice of Public Hearing

ARIAS, Julio R, Agent

Jay's Towing MKE LLC at 3950 N HOLTON St #101DT

Recycling, Salvaging, or Towing Premises License Application Requesting Non-Consensual Towing, Dealing, Storing, Transporting, Removing and/or Recycling Junk/Valuable Metal, and Dealing, Storing, and/or Transporting Salvaged Motor Vehicle Parts

Tuesday, June 25, 2019 at 2:30 PM

To whom it may concern:

The above application has been made by the above named applicant(s). This requires approval from the Licenses Committee and the Common Council of the City of Milwaukee. The hearing before the Licenses Committee will take place on 6/25/2019 at 2:30 PM, in Room 301-B, Third Floor, City Hall. If you wish, you may provide testimony at the hearing regarding the request; see below for further information. You are not required to attend the hearing. Once the Licenses Committee makes its recommendation, this recommendation is forwarded to the full Common Council for approval at its next regularly scheduled hearing. Please review the information below and if you have further questions regarding this process, please contact the License Division at (414) 286-2238.

Important details for those wishing to provide information for the Licenses Committee to consider when making its recommendation:

1. The license application is scheduled to be heard at the above time. Due to other hearings running longer than scheduled, you may have to wait some time to provide your testimony.
2. You must appear in person and testify as to matters that you have personally experienced or seen. (You cannot provide testimony for your neighbor, parent or anyone else; this is considered hearsay and cannot be considered by the committee.)
3. No letters or petitions can be accepted by the committee (unless the person who wrote the letter or the persons who signed the petition are present at the committee hearing and willing to testify).
4. Persons opposed to the license application are given the opportunity to testify first; supporters may testify after the opponents have finished.
5. When you are called to testify, you will be sworn in and asked to give your name, and address. (If your first and/or last names are uncommon please spell them.)
6. You may then provide testimony.
 - a. Include only information relating to the above license application.
 - b. Include only information you have personally witnessed or seen.
 - c. Provide concise and relevant information detailing how this business has affected or may affect the peaceful enjoyment of your neighborhood.
 - d. If by the time you have the opportunity to testify, the information you wish to share has already been provided to the committee, you may state that you agree with the previous testimony. Redundant or repetitive testimony will not assist the committee in making its recommendation.
7. After giving your testimony, the members of the Licenses Committee and the licensee may ask questions regarding the testimony you have given or other factors relating to the license application.
8. Business Competition is not a valid basis for denial or non-renewal of a license.

Please Note: If you have submitted an objection to the above application your objection cannot be considered by the committee unless you personally testify at the hearing.

OCCUPANT	MAIL ADDRESS	CITY, STATE ZIP
CURRENT OCCUPANT	3853 N RICHARDS ST	MILWAUKEE, WI 53212
CURRENT OCCUPANT	3838 N HOLTON ST	MILWAUKEE, WI 53212
CURRENT OCCUPANT	3865 N RICHARDS ST	MILWAUKEE, WI 53212
CURRENT OCCUPANT	3903 N RICHARDS ST	MILWAUKEE, WI 53212
CURRENT OCCUPANT	801 E CAPITOL DR 2	MILWAUKEE, WI 53212
CURRENT OCCUPANT	627 E CAPITOL DR	MILWAUKEE, WI 53212
CURRENT OCCUPANT	505 E CAPITOL DR	MILWAUKEE, WI 53212
CURRENT OCCUPANT	275 E CAPITOL DR	MILWAUKEE, WI 53212
CURRENT OCCUPANT	807 E CAPITOL DR	MILWAUKEE, WI 53212
CURRENT OCCUPANT	336 E CAPITOL DR	MILWAUKEE, WI 53212
CURRENT OCCUPANT	370 E CAPITOL DR	MILWAUKEE, WI 53212
CURRENT OCCUPANT	3760 N HOLTON ST	MILWAUKEE, WI 53212
CURRENT OCCUPANT	620 E VIENNA AVE	MILWAUKEE, WI 53212
CURRENT OCCUPANT	3837 N RICHARDS ST	MILWAUKEE, WI 53212
CURRENT OCCUPANT	3859 N RICHARDS ST	MILWAUKEE, WI 53212
CURRENT OCCUPANT	705 E CAPITOL DR	MILWAUKEE, WI 53212
CURRENT OCCUPANT	3907 N RICHARDS ST	MILWAUKEE, WI 53212
CURRENT OCCUPANT	821 E CAPITOL DR	MILWAUKEE, WI 53212
CURRENT OCCUPANT	378 E CAPITOL DR	MILWAUKEE, WI 53212
CURRENT OCCUPANT	3747 N BOOTH ST	MILWAUKEE, WI 53212
CURRENT OCCUPANT	3811 N HOLTON ST	MILWAUKEE, WI 53212
CURRENT OCCUPANT	3866 N FRATNEY ST	MILWAUKEE, WI 53212
CURRENT OCCUPANT	3950 N HOLTON ST	MILWAUKEE, WI 53212
CURRENT OCCUPANT	801 E CAPITOL DR 1	MILWAUKEE, WI 53212
CURRENT OCCUPANT	425 E CAPITOL DR	MILWAUKEE, WI 53212
CURRENT OCCUPANT	334 E CAPITOL DR	MILWAUKEE, WI 53212
CURRENT OCCUPANT	420 E CAPITOL DR	MILWAUKEE, WI 53212
CURRENT OCCUPANT	225 E CAPITOL DR	MILWAUKEE, WI 53212
CURRENT OCCUPANT	303 E VIENNA AVE	MILWAUKEE, WI 53212
CURRENT OCCUPANT	811 E VIENNA AVE	MILWAUKEE, WI 53212
CURRENT OCCUPANT	3830 N FRATNEY ST	MILWAUKEE, WI 53212
CURRENT OCCUPANT	3840 N FRATNEY ST	MILWAUKEE, WI 53212
CURRENT OCCUPANT	3879 N RICHARDS ST	MILWAUKEE, WI 53212
CURRENT OCCUPANT	3950 N HOLTON ST 1	MILWAUKEE, WI 53212
CURRENT OCCUPANT	3888 N FRATNEY ST	MILWAUKEE, WI 53212
CURRENT OCCUPANT	3901 N RICHARDS ST	MILWAUKEE, WI 53212
CURRENT OCCUPANT	3909 N RICHARDS ST	MILWAUKEE, WI 53212
CURRENT OCCUPANT	310 E CAPITOL DR	MILWAUKEE, WI 53212
CURRENT OCCUPANT	320 E CAPITOL DR	MILWAUKEE, WI 53212
CURRENT OCCUPANT	362 E CAPITOL DR 1	MILWAUKEE, WI 53212
CURRENT OCCUPANT	348 E CAPITOL DR	MILWAUKEE, WI 53212
CURRENT OCCUPANT	301 E VIENNA AVE	MILWAUKEE, WI 53212
CURRENT OCCUPANT	3850 N HOLTON ST	MILWAUKEE, WI 53212
CURRENT OCCUPANT	3830 N HOLTON ST	MILWAUKEE, WI 53212
CURRENT OCCUPANT	401 E CAPITOL DR	MILWAUKEE, WI 53212
CURRENT OCCUPANT	801 E CAPITOL DR 3	MILWAUKEE, WI 53212

CURRENT OCCUPANT	801 E CAPITOL DR	MILWAUKEE, WI 53212
CURRENT OCCUPANT	733 E CAPITOL DR	MILWAUKEE, WI 53212
CURRENT OCCUPANT	272 E CAPITOL DR	MILWAUKEE, WI 53212
CURRENT OCCUPANT	362 E CAPITOL DR 2	MILWAUKEE, WI 53212
CURRENT OCCUPANT	532 E CAPITOL DR 1	MILWAUKEE, WI 53212
CURRENT OCCUPANT	3744 N BOOTH ST	MILWAUKEE, WI 53212
CURRENT OCCUPANT	3775 N HOLTON ST	MILWAUKEE, WI 53212
CURRENT OCCUPANT	720 E CAPITOL DR	MILWAUKEE, WI 53212
CURRENT OCCUPANT	3950 N HOLTON ST 2	MILWAUKEE, WI 53212
CURRENT OCCUPANT	809 E CAPITOL DR	MILWAUKEE, WI 53212
CURRENT OCCUPANT	3736 N BOOTH ST	MILWAUKEE, WI 53212
CURRENT OCCUPANT	3872 N FRATNEY ST	MILWAUKEE, WI 53212
CURRENT OCCUPANT	709 E CAPITOL DR	MILWAUKEE, WI 53212
CURRENT OCCUPANT	3925 N RICHARDS ST	MILWAUKEE, WI 53212
CURRENT OCCUPANT	344 E CAPITOL DR	MILWAUKEE, WI 53212

Total Records: 61

Radius: 850.0 feet and Center of Circle: 3950 N Holton St



BUSINESS LICENSE PLAN OF OPERATION

ccl-busplan 3/15/18

Office of the City Clerk License Division
200 E. Wells St. Room 105, Milwaukee, WI 53202
(414) 286-2238 www.milwaukee.gov/license e-mail address: license@milwaukee.gov

1. Type of Business

Applying for: Extended Hours (12AM to 5AM) - If a food establishment, check all that apply: Delivery Drive Thru Dining Room
 Self Service Laundry Massage Establishment Filling Station
 Other (supplemental application for specific license also required)

Provide a detailed description of the type of business you plan on operating:

Auto Shop & towing

Do you have any experience operating this type of business? No Yes If yes, explain: 3 Year of towing

2. Business Operations

- a. Proposed Opening Date: 5-1-2019
- b. Is this premise under construction? No Yes If yes, list estimated completion date: _____
- c. Is this a franchise? No Yes
- d. Is this premises currently licensed? No Yes If yes, list type of license: _____
- e. Is the current licensee operating? No Yes If no, list date closed: _____
- f. Do you have future plans for other businesses, licenses or permits at this location? No Yes
If yes, explain: NO contain towing and Auto Shop
- g. Have you previously held an Extended Hours License in Milwaukee? No Yes
If yes, list address(es): _____
- h. Are other businesses operating in the same building? No Yes If yes, describe: ~~ABE~~ Various

3. Litter & Noise

- a. How are grounds kept clean? Sweep Pressure Wash Pick Up Litter Other: _____
- b. How often will grounds be cleaned? Daily Weekly As Needed Monthly Other: _____
- c. Grounds cleaned by: Licensee Building Owner Employees Hired Maintenance Other: we do it
- d. How are noise issues prevented and/or addressed? Security Manager approaches customer(s) Call Police
 Signs Posted Other: _____
- e. Will a sound amplification system be used? No Yes If yes, describe: _____

4. Smoking & Sanitation

- a. Are there designated outdoor smoking areas? No Yes If yes, describe: _____
- b. Number of Garbage Cans: Inside: 1 Locations: Back of Building
Outside: 7 Locations: front of office
- c. Is a crowd control barrier used? No Yes If yes, describe: _____
- d. How many restrooms are on the premises? 1
- e. Name of solid waste contractor: Advanced Disposal Waste Management Other: _____

5. Security

- a. Are there onsite parking spaces? No Yes If yes, how many? 10 and describe the parking security plan: we have number on the floor
- b. Is there a loading zone? No Yes If yes, describe the loading area security plan: _____
- c. Will you have security personnel on premise? No Yes If yes, how many? _____ and answer the following:
 What are their responsibilities? _____
 Is security equipment used? No Yes If yes, describe _____
 List their licensing, certification, or training credentials _____
- d. Will there be security cameras? No Yes If yes, how many? 6 and list locations: on Building and inside
- e. Will searches/identification checks be done upon entry? No Yes If yes, describe Pictures

6. Percentage of Sales (must total 100%)

Alcohol _____%	Food _____%	Secondhand Merchandise _____%	Precious Metals & Gems _____%
Entertainment _____%	Cigarettes _____%		
Pawnbroker Activity _____%	Salvaged Materials _____% (such as scrap metal)	Personal Services (such as tattoo, body piercing, salon, tailor, tanning, etc.) _____%	Other <u>100%</u> Describe: _____

7. Businesses/Licenses on the Premises (check all that apply):

Type 1

- Full Service Restaurant Cafe/Coffee Shop Deli or Fast Food Restaurant Private/Fraternal/Veterans Club
- Night Club Tavern Cocktail Lounge Teen Club
- Banquet Hall Sports Facility Bowling Alley
- Hotel/Motel : Number of Floors: _____ Rooming House: Number of Floors: _____
 Number of Rooms: _____ Number of Rooms: _____

Type 2

- Liquor Store Corner Store Supermarket Convenience Store
- Gas Station Amusement/Phonograph Distributor Recycling, Salvage or Towing
- Used Car Dealer Personal Service Establishment
(such as tattoo business, hair salon, tailor, etc.) Recording Studio

What other licenses/permits will you hold at this location? (check all that apply)

- Occupancy Permit Cigarette & Tobacco Gas Station Extended Hours Class "B" Tavern Weights & Measures
- Secondhand Dealer Precious Metal & Gem Other: _____

8. Legal Capacity (only if a Type 1 premises in #7 above)

Capacity _____ (Call the Milwaukee Development Center at 414-286-8211 if you have questions.)

9. Premises Description

a. Identify all area(s) of the premises that will be used in operating this business (include areas used only for storage):

1st Floor 2nd Floor Basement Storage Patio Beer Garden Sidewalk Café Deck Rooftop

Other: Describe: inside and outside parking spaces

b. Describe Location: Major Thoroughfare Secondary Street Other: _____

c. Nearest Major Cross Street: Holton St

d. Describe Building: Free Standing Building Strip Mall Other: _____

e. Describe Premises Structure: Single Story Multi-Story - # of Stories _____ Other: _____

f. Describe Surrounding Area: Commercial Residential Industrial Other: _____

g. Building Owner Name: 11010 Kevin Phone Number: 414 659-1234

Business Owner Address: 3950 N Holton St Milwaukee WI 53212

10. Hours of Operation & Customers

Will customers be entering the premises? No Yes

Day of the Week	Proposed Hours of Operation:		Estimated Number of Customers expected each day	Potential Age Range of Customers	Class B Tavern Applicant Only: Age Restriction (If none, write 'None')
	Open Time (include a.m. or p.m.)	Close Time (include a.m. or p.m.)			
Sunday	24		5	16-100	
Monday	24		5	16-100	
Tuesday	24		5	16-100	
Wednesday	24		5	16-100	
Thursday	24		5	16-100	
Friday	24		5	16-100	
Saturday	24		5	16-100	

An Extended Hours Establishment License is required for any convenience store, filling station, personal service establishment (such as tattoo, body piercing, salon, tailor, tanning, etc.), recording studio or restaurant which is open between the hours of 12:00 a.m. and 5:00 a.m.

Alcohol Establishments Class A: 8:00 am to 9:00 pm Sunday thru Saturday

Permitted Hours of Operation: Class B: 6:00 am to 2:00 am Sunday thru Thursday, 6:00 am to 2:30 am Friday & Saturday

Entertainment Outdoor Closing Hours: 10:00pm Sunday-Thursday; 12:00am Friday & Saturday; unless a different time, either earlier or later, is established by the Common Council in its approval of the licensee's plan of operation.

11. Signature(s)

Signature of Sole Proprietor, Partner, or 20% or more Shareholder

(If there are no 20% or more shareholders,
Corporate Officer-print name/title and sign)

Signature of additional partner or 20% or more shareholder

See Application Information for a complete list of all required application forms.



RECYCLING, SALVAGING OR TOWING PREMISES LICENSE SUPPLEMENTAL APPLICATION

cci-rstprem 2/23/18

Office of the City Clerk License Division
200 E. Wells St. Room 105, Milwaukee, WI 53202
(414) 286-2238 e-mail address: license@milwaukee.gov

Legal Entity Name: Jay's Towing MKE LLC
Business Address: 3950 N Holton
Do you currently hold any licenses in the City of Milwaukee? [X] No [] Yes

Has any person on the application ever had a license relating to the activities licensed in Milwaukee Code of Ordinances Chapter 93 denied, not renewed, suspended, or revoked? [X] No [] Yes
If yes, provide the circumstances and jurisdiction in which the event occurred...

Do you understand that you must follow all recordkeeping, reporting and operating regulations in MCO 93-43-49? [] No [X] Yes
Do you understand that all records and reports must be available to the police department upon request? [] No [X] Yes

Business Operations

Check all activities that apply:
[X] Non-Consensual Towing: Provide the address within the City of Milwaukee where vehicles will be towed: 3950 N Holton St mil wj 53212
Junk/Valuable Metal: [X] Dealing, Storing and/or Transporting [X] Removing and/or Recycling
Waste Tires: [] Dealing, Storing and/or Transporting [] Removing and/or Recycling
Salvaged Motor Vehicle Parts: [X] Dealing, Storing and/or Transporting [] Removing and/or Recycling

Do you have an additional yard(s) used for storage? [X] No [] Yes
If yes, provide the address(es) below and submit an additional \$50 per yard:

How many motor vehicles will be used in the business operations? 2 Provide information for each vehicle on page 2.

Required Signature(s)

Signature of Sole Proprietor, Partner, or 20% or more Shareholder
Additional partner or 20% or more shareholder

Table with 5 columns: Office Use Only, Initials, Filed, App#, YD#, Permit #s, Paid, MPD, DNS, LC, CC, Mayor's Signature, License #



CITY OF MILWAUKEE
OFFICE OF THE CITY CLERK

Tuesday, June 18, 2019

COMMITTEE MEETING NOTICE

AD 06

BROOKS, Vickie M, Agent
V & T LIQUORS, INC
916 W BURLEIGH ST

MILWAUKEE, WI 53206

You are requested to attend a hearing which is to be held in Room 301-B, Third Floor, City Hall on:

Tuesday, June 25, 2019 at 02:30 PM



Regarding: Your Class A Malt & Class A Liquor and Weights & Measures License Renewal Applications as agent for "V & T LIQUORS, INC" for "V & T WINE & LIQUOR" at 916 W BURLEIGH St.

There is a possibility that your application may be denied for one or more of the following reasons: The recommendation of the committee regarding the application shall be based on evidence presented at the hearing. Per MCO 85-4-4, unless otherwise specified in the code, probative evidence concerning non-renewal, suspension or revocation may include evidence of the following: failure of the applicant to meet municipal qualifications, pending charges against or the conviction of any felony, misdemeanor, municipal offense or other offense, the circumstances of which substantially relate to the circumstances of the particular licensed or permitted activity, by the applicant or by any employee or other agent of the applicant. If the activities of the applicant involve a licensed premises, whether the premises tends to facilitate a public or private nuisance or has been the source of congregations of persons which have resulted in any of the following: disturbance of the peace; illegal drug activity; public drunkenness; drinking in public; harassment of passers-by; gambling; prostitution; sale of stolen goods; public urination; theft; assaults; battery; acts of vandalism including graffiti, excessive littering, loitering, illegal parking, loud noise at times when the licensed premise is open for business; traffic violations; curfew violations; lewd conduct; display of materials harmful to minors, pursuant to s. 106-9.6; or any other factor which reasonably relates to the public health, safety and welfare, or failure to comply with the approved plan of operation. See attached police report or correspondence.

Notice for applicants with warrants or unpaid fines:

Proof of warrant satisfaction or payment of fines must be submitted at the hearing on the above date and time. Failure to comply with this requirement may result in a delay of the granting/denial of your application.

Failure to appear at this meeting may result in the denial of your license. Individual applicants must appear only in person or by an attorney. Corporate or Limited Liability applicants must appear only by the agent designated on the application or by an attorney. Partnership applicants must appear by a partner listed on the application or by an attorney. If you wish to do so and at your own expense, you may be accompanied by an attorney of your choosing to represent you at this hearing.

You will be given an opportunity to speak on behalf of the application and to respond and challenge any charges or reasons given for the denial. No petitions can be accepted by the committee, unless the people who signed the petition are present at the committee hearing and willing to testify. You may present witnesses under oath and you may also confront and cross-examine opposing witnesses under oath. If you have difficulty with the English language, you should bring an interpreter with you, at your expense, so that you can answer questions and participate in your hearing.

You may examine the application file at this office during regular business hours prior to the hearing date. Inquiries regarding this matter may be directed to the person whose signature appears below.

Limited parking for persons attending meetings in City Hall is available at reduced rates (5 hour limit) at the Milwaukee Center on the southwest corner of East Kilbourn and North Water Street. Parking tickets must be validated in the first floor information booth in City Hall.

PLEASE NOTE: Upon reasonable notice, efforts will be made to accommodate the needs of disabled individuals through sign language interpreters or other auxiliary aids. For additional information or to request this service, contact the Council Services Division ADA Coordinator at (414) 286-2998, Fax - (414) 286-3456, TDD - (414) 286-2025.

JIM OW CZARSKI, CITY CLERK

BY:

Jessica Celella
License Division Manager

If you have questions regarding this notice, please contact the License Division at (414) 286-2238.

200 E. Wells Street, Room 105, City Hall, Milwaukee, WI 53202. www.milwaukee.gov/license
Phone: (414) 286-2238 Fax: (414) 286-3057 Email Address: License@milwaukee.gov

MILWAUKEE POLICE DEPARTMENT
LICENSE INVESTIGATION UNIT

CRIMINAL RECORD/ORDINANCE VIOLATION/INCIDENTS
SYNOPSIS

DATE: 05/07/2019
LICENSE TYPE: ALQML
NEW:
RENEWAL: X

No. 293233
Application Date: 05/07/2019
Expiration Date:

License Location: 916 W Burleigh Street
Business Name: V & T Wine & Liquor

Aldermanic District: 06

Licensee/Applicant: Brooks, Vickie M
(Last Name, First Name, MI)
Date of Birth: 04/08/67

Male: Female:

Home Address: 3822 W Hope Street
City: Milwaukee
Home Phone: (414) 871-1898

State: WI Zip Code: 53216

This report is written by Police Officer David NOVAK, assigned to the License Investigation Unit, Days.

The Milwaukee Police Department's investigation regarding this application revealed the following:

1. On 08/12/07 at 9:24 pm, Milwaukee police were dispatched to an Armed Robbery at 2210 W Keefe Avenue. Officers spoke to the victim and investigation found the victim was robbed while exiting the V & T Liquor store. The victim stated two suspects ordered him into his vehicle at gun point and was made to drive the suspects to 2210 W Keefe where he was robbed of his property. Police did view surveillance video from the liquor store and spoke to the manager, Timothy Pernell, who stated he was working at the time of the robbery. No injuries were reported.

2. On 04/01/2014 a stolen credit card was used to purchase liquor at V&T Wine and Liquor (916 West Burleigh Street). The investigating officer spoke to the applicant on 04/05/2014 and 04/09/2014 in an attempt to obtain store video of the transaction. On both occasions, the applicant told the officer he needed to contact a third party to retrieve the video and the officer would be contacted when this happened. On 04/13/2014, the officer again contacted the applicant about retrieving the video and was told at that time that the video was only retained for a week and had been overwritten.

=====

3. On 08/30/2014 a 16 year old, working in conjunction with Milwaukee police, was able to purchase a Black and Mild cigar from the cashier at V and T Wine and Liquor (916 West Burleigh). The applicant was cited.

Charge: Sale of Cigarettes to Minor/Underage
Finding: Guilty
Sentence: \$181.00 fine
Date: 10/17/2014
Case: 14063949

- =====
4. On 12/12/2015 a 17 year old working in conjunction with the Milwaukee Police Department and WI WINS Tobacco initiative, was able to purchase a Swisher Sweets cigar for \$1.00 from the cashier at V&T Wine & Liquor, 916 W. Burleigh St. The clerk stated she didn't ask for ID because the juvenile looked old enough. The applicant was mailed a MARTS letter. As of 05/19/2016 the applicant had failed to enroll in MARTS. The applicant was cited for Sale of Cigarettes to Minor/Underage.

Charge: Sale of Cigarettes to Minor/Underage
Finding: Guilty
Sentence: Fined \$181.00
Date: 07/08/2016
Case: 16034079

5. On 10/21/2016 a 20 year old working in conjunction with the Milwaukee Police Department and D.F.C. Alcohol Compliance Initiative, was able to purchase a 16oz. can of Miller Lite from V&T Wine & Liquor, 916 W. Burleigh St. The clerk admitted the sale and apologized. The applicant was mailed a Respect 21 letter. As of 01/06/2017 the applicant had not enrolled in Respect 21 and was cited for Sale of Alcohol to Underaged Person.

Charge: Sale of Alcohol to Underaged Person
Finding: Dismissed
Sentence:
Date:
Case: 17003405

=====

Item #5 disposition added on 05/03/2018

=====

6. On 07/19/2018 a 19 year old working in conjunction with the Milwaukee Police Department and D.F.C. Alcohol Compliance initiative, was able to purchase 4 pack of Capricio Bubbly Sangria for \$9.99 from the clerk at V&T Liquor, 916 W. Burleigh St. The officer entered the business and identified the clerk based on the description provided. The clerk denied the sale. The manager came up and stated they would do better in the future and the officer explained the Respect 21 program. The manager stated he was familiar with the program because he had just completed it.

7. On 08/04/2018 a 17 year old working in conjunction with the Milwaukee Police Department and WI WINS Tobacco initiative, was able to purchase a 2 pack of Swisher Sweet Cigars from the clerk at V&T Liquor, 916 W. Burleigh St. The clerk did look at the ID but made the sale even though the ID showed the juvenile was 16. The clerk was identified and admitted the sale saying she made a mistake looking at the ID. The applicant was mailed a MARTS enrollment package. As of 12/10/2018 the applicant had not enrolled in MARTS and was issued a citation for the violation.

Charge: Sale of Cigarettes to Minor/Underage
Finding:
Sentence:
Date:
Citation: J980QWMLX3

Milwaukee Police Department

749 W. State Street Milwaukee, WI 53233

414-933-4444



Case #: 182000104

OtherEvent #: 18-LP-0159

Incident

916 W BURLEIGH ST Milwaukee, WISCONSIN 53206

Incident Date/Time:: 07/19/2018 15:47:00
CAD Number:: 182001745
District:: 5
Beat:: 530
Reporting Area:: 2498

Business Agent (1)

BROOKS, VICKIE MICHELLE

Person Involvement:: Agent
DOB:: 04/08/1967
Sex:: FEMALE
Race:: BLACK/AFRICAN AMERICAN
Phone 1 Number:: (414)-374-8540
Address:: 916 W BURLEIGH ST
City:: Milwaukee
State:: WISCONSIN
Zip Code:: 53206

Licensed Persons Involved (1)

BATEMAN, DENICE

Person Involvement:: Merchant
DOB:: 12/17/1956
Sex:: FEMALE
Race:: BLACK/AFRICAN AMERICAN
Address:: 2353 N 53RD ST
City:: MILWAUKEE
State:: WISCONSIN
Zip Code:: 53210

Narrative (1)

INITIAL INVESTIGATION

Brown, Penny A 014805

07/19/2018

This report is written by PO Penny MONREAL, assigned to the License Investigation Unit, Days.

On Thursday, July 19, 2018, I was assigned to work the D.F.C. Alcohol Compliance, which checks area vendors for age compliance alcohol purchases. Assisting in this assignment was: Ayanna M. DANIELS B/F 10/05/98 6428 N. Atwahl Dr. Milwaukee, WI 53209. DANIELS is 19 years old and not of legal age to purchase alcohol.

At approximately 3:47P, I observed DANIELS enter V & T Liquor, located at 916 W. Burleigh St. with

Milwaukee Police Department

749 W. State Street Milwaukee, WI 53233

414-933-4444



Case #:182000104

OtherEvent #: 18-LP-0159

nothing in her hands. At approximately 3:50P, I observed DANIELS exit the store carrying a bag. DANIELS then contacted me and advised me she was able to purchase a 4 pack of Capricio Bubbly Sangria for \$9.99 from the sole cashier in the store. DANIELS provided a description of a B/F with glasses, mid length wavy hair, wearing a blue and white button shirt. Upon entrance to the store I immediately identified based on the description. The cashier was identified by Wisconsin Driver's License as: Denice BATEMAN B/F 12/17/56 2353 N. 53rd St. Milwaukee, WI 53210. I advised BATEMAN of the reason for my investigation, however, BATEMAN stated "it wasn't me I just got here". I advised BATEMAN that she matched the description given exactly, however, she continued to deny the sale. I requested to see the surveillance cameras in an effort to prove or disprove BATEMAN's story, however, I received another call from DANIELS regarding another purchase and needed to leave. As I was explaining the Respect 21 to BATEMAN a B/M late 40's advised me he was the manager and provided me with a receipt for the sale and stated "if we were wrong, we were wrong, we just have to do better next time". I thanked him for his honesty and explained Respect 21, however, he stated he was aware as they had just completed the program.

Officer (1)

Reporting Officer:	Brown, Penny A (014805)	07/19/2018 17:32:00
Section: (Work Location):	27	
Approving Officer:	Raden, Chad M (010032)	07/20/2018 07:29:47

Milwaukee Police Department

749 W. State Street Milwaukee, WI 53233

414-933-4444



Case #:182160061

OtherEvent #: 18-LP-0218

Incident

916 W BURLEIGH ST Milwaukee, WISCONSIN 53206

Incident Date/Time:: 08/04/2018 10:49:00
CAD Number:: 182160926
District:: 5
Beat:: 530
Reporting Area:: 2498

Business Agent (1)

BROOKS, VICKIE MICHELLE

Person Involvement:: Agent
DOB:: 04/08/1967
Sex:: FEMALE
Race:: BLACK/AFRICAN AMERICAN
Phone 1 Number:: (414)-374-8540
Address:: 2841 N 55TH ST
City:: Milwaukee
State:: WISCONSIN
Zip Code:: 53210

Licensed Persons Involved (1)

BATEMAN, DENICE

Person Involvement:: Merchant
DOB:: 12/17/1956
Sex:: FEMALE
Race:: BLACK/AFRICAN AMERICAN
Address:: 2353 N 53RD ST
Apartment or Suite:: 7
City:: Milwaukee
State:: WISCONSIN
Zip Code:: 53210

Narrative (1)

INITIAL INVESTIGATION

Rueda, Denise A 013466

08/07/2018

This report is written by P.O. Denise Rueda assigned to the License Investigation Unit. On Saturday, August 4, 2018, I was assigned to work the Wisconsin WINS Youth Tobacco Initiative, checking area vendors for age compliance tobacco purchases. Assisting in this assignment was Kayla S McPike (B/F, 05/19/2002, of 4257 N 74th Street). McPike is 16 years of age which is not of legal age to purchase tobacco.

Milwaukee Police Department

749 W. State Street Milwaukee, WI 53233

414-933-4444



Case #:182160061

OtherEvent #: 18-LP-0218

At approximately 11:05am, MCPIKE entered V & T Wine & Liquor at 916 W Burleigh Street and purchased 1-2pk Swisher Sweet Cigarillo cigars. MCPIKE stated the cashier described as a B/F in her late 50's with short black hair wearing a light blue Brewer Jacket did ask for her ID and after looking at it sold the tobacco to her anyway. I entered the store and immediately identified the cashier based on the description given. The cashier identified herself as Denice BATEMAN, B/F, 12/17/56 of 2353 N 53rd Street. BATEMAN did admit to selling the Swisher Sweets to MCPIKE and stated that she made a mistake at looking at MCPIKE'S ID.

SINGH was advised that I would be sending out a letter to enroll in the M.A.R.T.S. Program.

Officer (1)

Reporting Officer:	Rueda, Denise A (013466)	08/07/2018 09:36:00
Section: (Work Location):	27	
Approving Officer:	Raden, Chad M (010032)	08/07/2018 10:14:11

Milwaukee Police Department



749 W. State Street Milwaukee, WI 53233

414-933-4444

Case #: 182160061

OtherEvent #: 18-LP-0646

Incident

916 W BURLEIGH ST Milwaukee, WISCONSIN 53206

Incident Date/Time:: 08/04/2018 10:49:00
CAD Number:: 182160926
District:: 5
Beat:: 530
Reporting Area:: 2498

Business Agent (1)

BROOKS, VICKIE MICHELLE

Person Involvement: (Must choose Agent
AGENT from drop down): Agent
DOB:: 04/08/1967
Sex:: FEMALE
Race:: BLACK/AFRICAN AMERICAN
Phone 1 Number:: (414)-374-8540
Address:: 2841 N 55TH ST
City:: Milwaukee
State:: WISCONSIN
Zip Code:: 53210

Licensed Premise Data (1)

V & T WINE & LIQUOR

Phone 1 Number:: (414)-374-8540
Address:: 916 W BURLEIGH ST
City:: Milwaukee
State:: WISCONSIN
Zip Code:: 53206
License Type:: Alcohol
Licensee Notification Was Made:: Yes
Licensee Notified Date/Time:: 08/04/2018 11:05:00
Business Was Cited For Violation:: No
Citation Number: (Additional Citations List in Narrative): J980QWMLX3
Violation/Ordinance Number:: 106-30-2-A
Licensee was cooperative: (If not explain in narrative): Yes
Licensee or Manager was on premises at time of violation/incident:: No

Narrative (1)

INITIAL INVESTIGATION

Rueda, Danise A 013486

12/17/2018

Milwaukee Police Department



749 W. State Street Milwaukee, WI 53233

414-933-4444

Case #: 182160061

OtherEvent #: 18-LP-0646

This report is written by P.O. Denise Rueda assigned to the License Investigation Unit. On Saturday, August 4, 2018, I was assigned to work the Wisconsin WINS Youth Tobacco Initiative, checking area vendors for age compliance tobacco purchases. Assisting in this assignment was Kayla S McPike (B/F, 05/19/2002, of 4257 N 74th Street). McPike is 16 years of age which is not of legal age to purchase tobacco.

At approximately 11:05am, MCPIKE entered V & T Wine & Liquor at 916 W Burleigh Street and purchased 1-2pk Swisher Sweet Cigarillo cigars. MCPIKE stated the cashier described as a B/F in her late 50's with short black hair wearing a light blue Brewer Jacket did ask for her ID and after looking at it sold the tobacco to her anyway. I entered the store and immediately identified the cashier based on the description given. The cashier identified herself as Denice BATEMAN, B/F, 12/17/56 of 2353 N 53rd Street. BATEMAN did admit to selling the Swisher Sweets to MCPIKE and stated that she made a mistake at looking at MCPIKE'S ID.

SINGH was advised that I would be sending out a letter to enroll in the M.A.R.T.S. Program.

AS OF DECEMBER 10, 2018 THE LISTED AGENT HAD NOT REGISTERED FOR THE M.A.R.T.S. PROGRAM, THEREFORE, A CITATION WAS ISSUED FOR THE INITIAL VIOLATION.

Officer (2)

Reporting Officer:	Rueda, Denise A (013466)	08/07/2018 09:36:00
Section: (Work Location):	27	
Approving Officer:	Raden, Chad M (010032)	12/18/2018 10:32:43
Section: (Work Location):	27	



Tuesday, June 18, 2019



Notice of Public Hearing

BROOKS, Vickie M, Agent
V & T WINE & LIQUOR at 916 W BURLEIGH St
Class A Malt & Class A Liquor and Weights & Measures License Renewal Applications

Tuesday, June 25, 2019 at 2:30 PM

To whom it may concern:

The above application has been made by the above named applicant(s). This requires approval from the Licenses Committee and the Common Council of the City of Milwaukee. The hearing before the Licenses Committee will take place on 6/25/2019 at 2:30 PM, in Room 301-B, Third Floor, City Hall. If you wish, you may provide testimony at the hearing regarding the request; see below for further information. You are not required to attend the hearing. Once the Licenses Committee makes its recommendation, this recommendation is forwarded to the full Common Council for approval at its next regularly scheduled hearing. Please review the information below and if you have further questions regarding this process, please contact the License Division at (414) 286-2238.

Important details for those wishing to provide information for the Licenses Committee to consider when making its recommendation:

1. The license application is scheduled to be heard at the above time. Due to other hearings running longer than scheduled, you may have to wait some time to provide your testimony.
2. You must appear in person and testify as to matters that you have personally experienced or seen. (You cannot provide testimony for your neighbor, parent or anyone else; this is considered hearsay and cannot be considered by the committee.)
3. No letters or petitions can be accepted by the committee (unless the person who wrote the letter or the persons who signed the petition are present at the committee hearing and willing to testify).
4. Persons opposed to the license application are given the opportunity to testify first; supporters may testify after the opponents have finished.
5. When you are called to testify, you will be sworn in and asked to give your name, and address. (If your first and/or last names are uncommon please spell them.)
6. You may then provide testimony.
 - a. Include only information relating to the above license application.
 - b. Include only information you have personally witnessed or seen.
 - c. Provide concise and relevant information detailing how this business has affected or may affect the peaceful enjoyment of your neighborhood.
 - d. If by the time you have the opportunity to testify, the information you wish to share has already been provided to the committee, you may state that you agree with the previous testimony. Redundant or repetitive testimony will not assist the committee in making its recommendation.
7. After giving your testimony, the members of the Licenses Committee and the licensee may ask questions regarding the testimony you have given or other factors relating to the license application.
8. Business Competition is not a valid basis for denial or non-renewal of a license.
Please Note: If you have submitted an objection to the above application your objection cannot be considered by the committee unless you personally testify at the hearing.

OCCUPANT	MAIL ADDRESS	CITY, STATE ZIP
CURRENT OCCUPANT	3122 N 9TH ST	MILWAUKEE, WI 53206
CURRENT OCCUPANT	3135 N 10TH ST	MILWAUKEE, WI 53206
CURRENT OCCUPANT	3139 N 10TH ST	MILWAUKEE, WI 53206
CURRENT OCCUPANT	3054 N 10TH ST	MILWAUKEE, WI 53206
CURRENT OCCUPANT	911 W BURLEIGH ST	MILWAUKEE, WI 53206
CURRENT OCCUPANT	3130A N 9TH ST	MILWAUKEE, WI 53206
CURRENT OCCUPANT	3105 N 9TH ST 2	MILWAUKEE, WI 53206
CURRENT OCCUPANT	3132 N 10TH ST	MILWAUKEE, WI 53206
CURRENT OCCUPANT	3134A N 9TH ST	MILWAUKEE, WI 53206
CURRENT OCCUPANT	3135 N 9TH ST	MILWAUKEE, WI 53206
CURRENT OCCUPANT	3053 N 9TH ST	MILWAUKEE, WI 53206
CURRENT OCCUPANT	3057 N 9TH ST	MILWAUKEE, WI 53206
CURRENT OCCUPANT	3065 N 9TH ST	MILWAUKEE, WI 53206
CURRENT OCCUPANT	913 W BURLEIGH ST	MILWAUKEE, WI 53206
CURRENT OCCUPANT	3114 N 9TH ST	MILWAUKEE, WI 53206
CURRENT OCCUPANT	902 W BURLEIGH ST	MILWAUKEE, WI 53206
CURRENT OCCUPANT	3133 N 9TH ST	MILWAUKEE, WI 53206
CURRENT OCCUPANT	3134 N 9TH ST	MILWAUKEE, WI 53206
CURRENT OCCUPANT	829 W BURLEIGH ST	MILWAUKEE, WI 53206
CURRENT OCCUPANT	1008 W BURLEIGH ST	MILWAUKEE, WI 53206
CURRENT OCCUPANT	1008 W BURLEIGH ST A	MILWAUKEE, WI 53206
CURRENT OCCUPANT	833 W BURLEIGH ST	MILWAUKEE, WI 53206
CURRENT OCCUPANT	917 W BURLEIGH ST	MILWAUKEE, WI 53206
CURRENT OCCUPANT	3112 N 9TH ST	MILWAUKEE, WI 53206
CURRENT OCCUPANT	3051 N 9TH ST	MILWAUKEE, WI 53206
CURRENT OCCUPANT	3120 N 9TH ST	MILWAUKEE, WI 53206
CURRENT OCCUPANT	3105 N 9TH ST 4	MILWAUKEE, WI 53206
CURRENT OCCUPANT	3105 N 9TH ST 3	MILWAUKEE, WI 53206
CURRENT OCCUPANT	3113 N 10TH ST	MILWAUKEE, WI 53206
CURRENT OCCUPANT	829A W BURLEIGH ST	MILWAUKEE, WI 53206
CURRENT OCCUPANT	3073 N 10TH ST	MILWAUKEE, WI 53206
CURRENT OCCUPANT	3130 N 9TH ST	MILWAUKEE, WI 53206
CURRENT OCCUPANT	3134 N 10TH ST	MILWAUKEE, WI 53206
CURRENT OCCUPANT	3139 N 9TH ST	MILWAUKEE, WI 53206
CURRENT OCCUPANT	3055 N 9TH ST	MILWAUKEE, WI 53206
CURRENT OCCUPANT	827A W BURLEIGH ST	MILWAUKEE, WI 53206

Total Records: 36

Radius: 250.0 feet and Center of Circle: 916 W Burleigh St

2018-2019 Plan of Operation for 916 W BURLEIGH ST

1. Litter & Security Plans	
How are the grounds kept clean? <input checked="" type="checkbox"/> Sweep <input type="checkbox"/> Pressure Wash <input checked="" type="checkbox"/> Pick Up Litter <input type="checkbox"/> Other:	
How often will grounds be cleaned? <input checked="" type="checkbox"/> Daily <input type="checkbox"/> Weekly <input type="checkbox"/> Other:	
Who cleans the grounds? <input checked="" type="checkbox"/> Licensee <input checked="" type="checkbox"/> Building Owner <input checked="" type="checkbox"/> Employees <input type="checkbox"/> Hired Maintenance <input type="checkbox"/> Other:	
How are noise issues prevented and/or addressed? <input type="checkbox"/> Security <input checked="" type="checkbox"/> Manager approaches customer(s) <input checked="" type="checkbox"/> Call Police <input type="checkbox"/> Signs Posted <input type="checkbox"/> Other:	
Are there designated outdoor smoking areas? <input checked="" type="checkbox"/> No <input type="checkbox"/> Yes If Yes, Describe:	
Number of garbage cans: Inside <u>2</u> Locations: <u>front and back of store</u> Outside <u>2</u> Locations: <u>behind door + bathroom</u>	
Is a crowd control barrier used? <input checked="" type="checkbox"/> No <input type="checkbox"/> Yes If Yes, Describe:	
Number of restrooms: <u>1</u>	Name of solid waste contractor: <u>Waste Management</u>
Are there parking spaces on the premises? <input checked="" type="checkbox"/> No <input type="checkbox"/> Yes If Yes, list number of spaces: _____ and describe security plans:	
Are there designated loading areas? <input type="checkbox"/> No <input checked="" type="checkbox"/> Yes If Yes, describe security plans: <u>Alley through the back door</u>	
Do you have security personnel on the premise? <input checked="" type="checkbox"/> No <input type="checkbox"/> Yes If Yes, how many? _____ AND What are their responsibilities? _____ What security equipment do they use? _____ List their licensing, certification or training credentials: _____	
Are there security cameras? <input type="checkbox"/> No <input checked="" type="checkbox"/> Yes If Yes, list all locations: <u>Side of building back, front outside inside</u>	
Are searches and/or identification checks conducted upon entry? <input checked="" type="checkbox"/> No <input type="checkbox"/> Yes If Yes, describe:	
2. Percentage of Sales (must total 100%)	
Alcohol <u>85</u> %	Food Sales <u>5</u> % Entertainment _____ % Other <u>10</u> % (Cigs)
3. Businesses On The Premises (choose all that apply):	
<input type="checkbox"/> Restaurant <input type="checkbox"/> Cafe/Coffee Shop <input type="checkbox"/> Cocktail Lounge <input type="checkbox"/> Convenience Store <input type="checkbox"/> Night Club <input checked="" type="checkbox"/> Liquor Store <input type="checkbox"/> Tavern <input type="checkbox"/> Sports Facility <input type="checkbox"/> Hotel <input type="checkbox"/> Banquet Hall <input type="checkbox"/> Supermarket <input type="checkbox"/> Private/Fraternal/Veterans' Club <input type="checkbox"/> Other:	
4. Hours of Operation and Age Restriction	
Are there any changes to the current hours of operation or age restriction? <input checked="" type="checkbox"/> No <input type="checkbox"/> Yes If Yes, Describe:	
Please Note: If you will be open earlier or later than the hours listed on your current license for even one event or holiday (for example, St. Patrick's Day, Brewers Opening Day, etc.) during the license period, this must be reported and printed on your license. Your hours of operation and age restriction are listed on your current license.	
5. Floor Plan and Capacity	
Are you requesting any changes to your capacity or floor plan*? <input checked="" type="checkbox"/> No <input type="checkbox"/> Yes If yes, describe: _____ and submit a new floor plan with this renewal application. A sample plan can be found online at www.milwaukee.gov/licenses under License Forms and Related Information.	
Alcohol/Food Establishments: A "Permanent Extension of Premises Application" is required if you are adding any square footage to the licensed premises.	
6. Sidewalk Dining: Fee:	
Are there any changes to the sidewalk dining site plan? <input checked="" type="checkbox"/> No <input type="checkbox"/> Yes If Yes, submit an updated site plan with this application.	
7. Food License: Fee:	8. Weights and Measures: W&M 3663 Fee: \$130.00
Your current food license includes the following food operations: Are there any changes to your food operations as listed above? <input checked="" type="checkbox"/> No <input type="checkbox"/> Yes, if Yes, explain _____	Number/Type of Devices: UPC SCANNERS = 3 OR LESS Are there any changes to the number or types of devices? <input checked="" type="checkbox"/> No <input type="checkbox"/> Yes If yes, contact our office for further instructions.



CITY OF MILWAUKEE
OFFICE OF THE CITY CLERK

Tuesday, June 18, 2019

COMMITTEE MEETING NOTICE

AD 06

WARREN G HARPER

2534 W HOPKINS St

MILWAUKEE, WI 53206

You are requested to attend a hearing which is to be held in Room 301-B, Third Floor, City Hall on:

Tuesday, June 25, 2019 at  3:30 PM

Regarding: Your Class B Tavern, Food Dealer, and Public Entertainment Premises License Renewal Applications for "WARREN'S LOUNGE" at 2534 W HOPKINS St.

There is a possibility that your application may be denied for one or more of the following reasons: The recommendation of the committee regarding the application shall be based on evidence presented at the hearing. Per MCO 85-4-4, unless otherwise specified in the code, probative evidence concerning non-renewal, suspension or revocation may include evidence of the following: failure of the applicant to meet municipal qualifications, pending charges against or the conviction of any felony, misdemeanor, municipal offense or other offense, the circumstances of which substantially relate to the circumstances of the particular licensed or permitted activity, by the applicant or by any employee or other agent of the applicant. If the activities of the applicant involve a licensed premises, whether the premises tends to facilitate a public or private nuisance or has been the source of congregations of persons which have resulted in any of the following: disturbance of the peace; illegal drug activity; public drunkenness; drinking in public; harassment of passers-by; gambling; prostitution; sale of stolen goods; public urination; theft; assaults; battery; acts of vandalism including graffiti, excessive littering, loitering, illegal parking, loud noise at times when the licensed premise is open for business; traffic violations; curfew violations; lewd conduct; display of materials harmful to minors, pursuant to s. 106-9.6; or any other factor which reasonably relates to the public health, safety and welfare, or failure to comply with the approved plan of operation. See attached police report or correspondence.

Notice for applicants with warrants or unpaid fines:

Proof of warrant satisfaction or payment of fines must be submitted at the hearing on the above date and time. Failure to comply with this requirement may result in a delay of the granting/denial of your application.

Failure to appear at this meeting may result in the denial of your license. Individual applicants must appear only in person or by an attorney. Corporate or Limited Liability applicants must appear only by the agent designated on the application or by an attorney. Partnership applicants must appear by a partner listed on the application or by an attorney. If you wish to do so and at your own expense, you may be accompanied by an attorney of your choosing to represent you at this hearing.

You will be given an opportunity to speak on behalf of the application and to respond and challenge any charges or reasons given for the denial. No petitions can be accepted by the committee, unless the people who signed the petition are present at the committee hearing and willing to testify. You may present witnesses under oath and you may also confront and cross-examine opposing witnesses under oath. If you have difficulty with the English language, you should bring an interpreter with you, at your expense, so that you can answer questions and participate in your hearing.

You may examine the application file at this office during regular business hours prior to the hearing date. Inquiries regarding this matter may be directed to the person whose signature appears below.

Limited parking for persons attending meetings in City Hall is available at reduced rates (5 hour limit) at the Milwaukee Center on the southwest corner of East Kilbourn and North Water Street. Parking tickets must be validated in the first floor information booth in City Hall.

PLEASE NOTE: Upon reasonable notice, efforts will be made to accommodate the needs of disabled individuals through sign language interpreters or other auxiliary aids. For additional information or to request this service, contact the Council Services Division ADA Coordinator at (414) 286-2998, Fax - (414) 286-3456, TDD - (414) 286-2025.

JIM OWCZARSKI, CITY CLERK

BY:

Jessica Celella
License Division Manager

If you have questions regarding this notice, please contact the License Division at (414) 286-2238.

200 E. Wells Street, Room 105, City Hall, Milwaukee, WI 53202. www.milwaukee.gov/license
Phone: (414) 286-2238 Fax: (414) 286-3057 Email Address: License@milwaukee.gov

**MILWAUKEE POLICE DEPARTMENT
LICENSE INVESTIGATION UNIT**

**CRIMINAL RECORD/ORDINANCE VIOLATION/INCIDENTS
SYNOPSIS**

DATE: 05/28/2019
LICENSE TYPE: BTAVN
NEW:
RENEWAL: X

No. 292769
Application Date: 04/29/2019
Expiration Date:

License Location: 2534 W Hopkins Street
Business Name: Warren's Lounge

Aldermanic District:06

Licensee/Applicant: Harper, Warren G
(Last Name, First Name, MI)
Date of Birth: 10/06/33

Male: **Female:**

Home Address: 3548 N 26th Street
City: Milwaukee
Home Phone: (414) 447-9351

State: Wi Zip Code: 53206

This report is written by Police Officer David NOVAK, assigned to the License Investigation Unit, Days.

The Milwaukee Police Department's investigation regarding this application revealed the following:

1. On 09/08/06 at 8:43 am, Milwaukee Police were dispatched to 2526 W Hopkins for a Hit and Run Accident. Investigation revealed that the owner of Warrens Lounge, Warren Harper, was backing out of the tavern parking lot after closing up the bar and struck the wall to the Sparkles Foods building located at 2526 W Hopkins. Warren never called police to report the accident. Further investigation revealed Warrens auto damage was consistent to the damage and paint transfer that was left on the building wall. When asked by police if Warren had to much to drink he answered, " I guess so.. you can say that." Warren received a citation for Duty Upon Striking Property and an accident report was filed.

- =====
2. On 06/30/2014 at 12:07am officers were dispatched to 2534 W. Hopkins to investigate a battery complaint. The investigation revealed that the victims was inside the bar drinking. She got into an argument with an unknown male patron. The argument escalated and the victim swung a bottle at the suspect who then hit the victim one time to the head with a closed fist. The suspect fled when the police were called. The victim was treated at St Mary's Hospital for bruising. The bartender was cooperative and gave a statement to the police with the suspects first name and description. There are no cameras in the bar. Milwaukee Police Department incident report #14-181-0007 was filed.
- =====

3. On 01/20/2016 Milwaukee police responded to a trouble with a subject complaint at 2534 West Hopkins Street (Warren's Lounge). The caller, who identified herself as an off duty Milwaukee police officer, stated she was involved in a verbal dispute with another patron while inside the business. The argument continued outside of the establishment and the caller was struck in the face. While investigating this incident, a vehicle traveling westbound on West Hopkins Street struck parked vehicles, including marked squad cars. This incident resulted in injuries to two police officers. The operator of the vehicle, Kenneth Taylor, was arrested for Operating While Intoxicated. Investigation revealed Taylor had been a patron of Warren's Lounge. Milwaukee police incident report #160200013 filed.

=====

4. On 05/23/2019 at 11:20pm officers were dispatched to a shooting a Warren's Lounge, 2534 W. Hopkins St. The investigation revealed the victim was inside the bar watching the Bucks game with his family. They noticed they were missing some credit cards and a cell phone from off the bar. The victim went outside to look for the items and got into an argument with a male subject. This person produced a firearm and shot the victim 8 times, then fled the scene. The victim was pronounced deceased on the scene. The applicant was contacted by phone. He stated he was out of the state on vacation but was cooperative with the Detectives regarding the recovery of video surveillance.

Milwaukee Police Department

749 W. State Street Milwaukee, WI 53233

414-933-4444



Case #: 191430160

OtherEvent #: 19-LP-0483

Incident

2534 W HOPKINS ST Milwaukee, WISCONSIN 53206

Incident Date/Time:: 05/23/2019 23:20:00
CAD Number:: 191432964
District:: 5
Beat:: 520
Reporting Area:: 2221

Business Agent (1)

HARPER, WARREN G

Person Involvement: (Must choose Agent
AGENT from drop down):
DOB:: 10/06/1933
Sex:: FEMALE
Race:: BLACK/AFRICAN AMERICAN
Phone 1 Number:: (414)-447-7876
Phone 1 Type:: Cell
Address:: 3548 N 26TH ST
City:: Milwaukee
State:: WISCONSIN
Zip Code:: 53206

Milwaukee Police Department

749 W. State Street Milwaukee, WI 53233

414-933-4444



Case #: 191430160

OtherEvent #: 19-LP-0483

Licensed Persons Involved (2)

ROGERS, SONYA YVETTE

Person Involvement:: Bartender
DOB:: 03/23/1967
Sex:: FEMALE
Race:: BLACK/AFRICAN AMERICAN
Phone 1 Number:: 414-808-6175
Phone 1 Type:: CELL PHONE
Address:: 2020 W ROOSEVELT DR
City:: Milwaukee
State:: WISCONSIN
Zip Code:: 53209

STORY, ADRIENNE RENITA

Person Involvement:: Bartender
DOB:: 11/18/1960
Sex:: FEMALE
Race:: BLACK/AFRICAN AMERICAN
Phone 1 Number:: 414-324-7920
Phone 1 Type:: CELL PHONE
Address:: 2852 N 40TH ST
Apartment or Suite:: A
City:: Milwaukee
State:: WISCONSIN
Zip Code:: 53210

Licensed Premise Data (1)

WARREN'S LOUNGE

Phone 1 Number:: (414)-442-1933
Phone 1 Type:: Main
Address:: 2534 W HOPKINS ST
City:: Milwaukee
State:: WISCONSIN
Zip Code:: 53206
License Type:: Alcohol
Licensee Notification Was Made:: Yes
Licensee Notified Date/Time:: 05/24/2019 01:52:00
Business Was Cited For Violation:: No
Licensee was cooperative: (If not explain in narrative): Yes
Licensee or Manager was on premises at time of violation/incident:: No

Milwaukee Police Department

749 W. State Street Milwaukee, WI 53233

414-933-4444



Case #: 191430160

OtherEvent #: 19-LP-0483

Narrative (1)

LICENSE PREMISE REPORT

Macrae, Russell J 022625

05/24/2019

This Report is written by PO Russell MACRAE assigned to District 5 - LATE POWER TAVERN CAR.

On 05/23/19 at approximately 11:20pm, Police responded to 2534 W Hopkins Street (WARREN'S LOUNGE) for a report of a shooting. As police arrived on-scene they located a (30yoa) B/M shooting victim who was shot. The victim was not breathing and did not have a pulse. Police began CPR and other life-saving measures until relieved by Milwaukee Fire Department. The victim ultimately succumbed to his injuries and was pronounced deceased.

According to CIB - Metro Investigation, the victim was at the bar with family for the Bucks game. During their stay at the bar, they noticed missing credit cards and a cell phone. The victim's wife began to get into a verbal argument inside the bar with another female patron. The victim's wife went to the rear of the bar to smoke outside. The victim left the front of the bar to look for the missing items. While outside, the victim became involved in a verbal argument with another male (Suspect). The suspect produced a firearm and shot the victim (8) times to the neck/chest, then fled the scene in a vehicle.

On 05/24/19 at 01:52am, I made contact with the tavern owner identified as Warren HARPER (B/M 10/06/33). I informed HARPER that there was a shooting incident at his tavern and that we would be filing a license-premise report regarding. HARPER stated that he was currently in Florida on vacation and was unable to come in person. CIB-METRO was in contact with HARPER as well who was providing assistance from Florida regarding possible video surveillance recovery. HARPER stated that he had (2) bartenders working tonight identified as Sonya ROGERS (B/F 03/23/67) and Adrienne STORY (B/F 11/18/60). HARPER stated that he does not have security for the tavern.

THIS INVESTIGATION IS ON-GOING

END OF REPORT

Officer (2)

Reporting Officer:	Macrae, Russell J (022625)	05/24/2019 01:49:00
Section: (Work Location):	54	
Approving Officer:	Raden, Chad M (010032)	05/28/2019 12:10:07
Section: (Work Location):	27	



Tuesday, June 18, 2019



Notice of Public Hearing

HARPER, Warren G
WARREN'S LOUNGE at 2534 W HOPKINS St
Class B Tavern, Food Dealer, and Public Entertainment Premises License Renewal Applications

Tuesday, June 25, 2019 at 2:30 PM

To whom it may concern:

The above application has been made by the above named applicant(s). This requires approval from the Licenses Committee and the Common Council of the City of Milwaukee. The hearing before the Licenses Committee will take place on 6/25/2019 at 2:30 PM, in Room 301-B, Third Floor, City Hall. If you wish, you may provide testimony at the hearing regarding the request; see below for further information. You are not required to attend the hearing. Once the Licenses Committee makes its recommendation, this recommendation is forwarded to the full Common Council for approval at its next regularly scheduled hearing. Please review the information below and if you have further questions regarding this process, please contact the License Division at (414) 286-2238.

Important details for those wishing to provide information for the Licenses Committee to consider when making its recommendation:

1. The license application is scheduled to be heard at the above time. Due to other hearings running longer than scheduled, you may have to wait some time to provide your testimony.
2. You must appear in person and testify as to matters that you have personally experienced or seen. (You cannot provide testimony for your neighbor, parent or anyone else; this is considered hearsay and cannot be considered by the committee.)
3. No letters or petitions can be accepted by the committee (unless the person who wrote the letter or the persons who signed the petition are present at the committee hearing and willing to testify).
4. Persons opposed to the license application are given the opportunity to testify first; supporters may testify after the opponents have finished.
5. When you are called to testify, you will be sworn in and asked to give your name, and address. (If your first and/or last names are uncommon please spell them.)
6. You may then provide testimony.
 - a. Include only information relating to the above license application.
 - b. Include only information you have personally witnessed or seen.
 - c. Provide concise and relevant information detailing how this business has affected or may affect the peaceful enjoyment of your neighborhood.
 - d. If by the time you have the opportunity to testify, the information you wish to share has already been provided to the committee, you may state that you agree with the previous testimony. Redundant or repetitive testimony will not assist the committee in making its recommendation.
7. After giving your testimony, the members of the Licenses Committee and the licensee may ask questions regarding the testimony you have given or other factors relating to the license application.
8. Business Competition is not a valid basis for denial or non-renewal of a license.
Please Note: If you have submitted an objection to the above application your objection cannot be considered by the committee unless you personally testify at the hearing.

OCCUPANT	MAIL ADDRESS	CITY, STATE ZIP
CURRENT OCCUPANT	2478 W KEEFE AVE	MILWAUKEE, WI 53206
CURRENT OCCUPANT	3517 N 25TH ST	MILWAUKEE, WI 53206
CURRENT OCCUPANT	3522 N 26TH ST	MILWAUKEE, WI 53206
CURRENT OCCUPANT	3524 N 25TH ST	MILWAUKEE, WI 53206
CURRENT OCCUPANT	3435 N 24TH PL	MILWAUKEE, WI 53206
CURRENT OCCUPANT	2480 W KEEFE AVE	MILWAUKEE, WI 53206
CURRENT OCCUPANT	3512A N 26TH ST	MILWAUKEE, WI 53206
CURRENT OCCUPANT	2518 W HOPKINS ST 2	MILWAUKEE, WI 53206
CURRENT OCCUPANT	2518 W HOPKINS ST 3	MILWAUKEE, WI 53206
CURRENT OCCUPANT	2522 W HOPKINS ST	MILWAUKEE, WI 53206
CURRENT OCCUPANT	2463 W KEEFE AVE	MILWAUKEE, WI 53206
CURRENT OCCUPANT	2467 W KEEFE AVE	MILWAUKEE, WI 53206
CURRENT OCCUPANT	2475 W KEEFE AVE	MILWAUKEE, WI 53206
CURRENT OCCUPANT	2479 W KEEFE AVE	MILWAUKEE, WI 53206
CURRENT OCCUPANT	2470 W KEEFE AVE	MILWAUKEE, WI 53206
CURRENT OCCUPANT	3516 N 26TH ST	MILWAUKEE, WI 53206
CURRENT OCCUPANT	3520 N 25TH ST	MILWAUKEE, WI 53206
CURRENT OCCUPANT	3441 N 24TH PL	MILWAUKEE, WI 53206
CURRENT OCCUPANT	2474 W KEEFE AVE	MILWAUKEE, WI 53206
CURRENT OCCUPANT	2479A W KEEFE AVE	MILWAUKEE, WI 53206
CURRENT OCCUPANT	3503 N 25TH ST	MILWAUKEE, WI 53206
CURRENT OCCUPANT	3501 N 25TH ST	MILWAUKEE, WI 53206
CURRENT OCCUPANT	3513 N 25TH ST	MILWAUKEE, WI 53206
CURRENT OCCUPANT	3516A N 26TH ST	MILWAUKEE, WI 53206
CURRENT OCCUPANT	2465 W KEEFE AVE	MILWAUKEE, WI 53206
CURRENT OCCUPANT	3509 N 25TH ST	MILWAUKEE, WI 53206
CURRENT OCCUPANT	3517A N 25TH ST	MILWAUKEE, WI 53206
CURRENT OCCUPANT	3521 N 25TH ST	MILWAUKEE, WI 53206
CURRENT OCCUPANT	2518 W HOPKINS ST 1	MILWAUKEE, WI 53206
CURRENT OCCUPANT	3439 N 24TH PL	MILWAUKEE, WI 53206
CURRENT OCCUPANT	2461 W KEEFE AVE	MILWAUKEE, WI 53206
CURRENT OCCUPANT	2469 W KEEFE AVE	MILWAUKEE, WI 53206
CURRENT OCCUPANT	2474A W KEEFE AVE	MILWAUKEE, WI 53206
CURRENT OCCUPANT	3512 N 26TH ST	MILWAUKEE, WI 53206
CURRENT OCCUPANT	3435A N 24TH PL	MILWAUKEE, WI 53206
CURRENT OCCUPANT	3520 N 26TH ST	MILWAUKEE, WI 53206
CURRENT OCCUPANT	2534 W HOPKINS ST	MILWAUKEE, WI 53206
CURRENT OCCUPANT	2459 W KEEFE AVE	MILWAUKEE, WI 53206
CURRENT OCCUPANT	2475A W KEEFE AVE	MILWAUKEE, WI 53206

Total Records: 39

Radius: 250.0 feet and Center of Circle: 2534 W Hopkins St

OCCUPANT	MAIL ADDRESS	CITY, STATE ZIP
CURRENT OCCUPANT	2478 W KEEFE AVE	MILWAUKEE, WI 53206
CURRENT OCCUPANT	3517 N 25TH ST	MILWAUKEE, WI 53206
CURRENT OCCUPANT	3522 N 26TH ST	MILWAUKEE, WI 53206
CURRENT OCCUPANT	3524 N 25TH ST	MILWAUKEE, WI 53206
CURRENT OCCUPANT	3435 N 24TH PL	MILWAUKEE, WI 53206
CURRENT OCCUPANT	2480 W KEEFE AVE	MILWAUKEE, WI 53206
CURRENT OCCUPANT	3512A N 26TH ST	MILWAUKEE, WI 53206
CURRENT OCCUPANT	2518 W HOPKINS ST 2	MILWAUKEE, WI 53206
CURRENT OCCUPANT	2518 W HOPKINS ST 3	MILWAUKEE, WI 53206
CURRENT OCCUPANT	2522 W HOPKINS ST	MILWAUKEE, WI 53206
CURRENT OCCUPANT	2463 W KEEFE AVE	MILWAUKEE, WI 53206
CURRENT OCCUPANT	2467 W KEEFE AVE	MILWAUKEE, WI 53206
CURRENT OCCUPANT	2475 W KEEFE AVE	MILWAUKEE, WI 53206
CURRENT OCCUPANT	2479 W KEEFE AVE	MILWAUKEE, WI 53206
CURRENT OCCUPANT	2470 W KEEFE AVE	MILWAUKEE, WI 53206
CURRENT OCCUPANT	3516 N 26TH ST	MILWAUKEE, WI 53206
CURRENT OCCUPANT	3520 N 25TH ST	MILWAUKEE, WI 53206
CURRENT OCCUPANT	3441 N 24TH PL	MILWAUKEE, WI 53206
CURRENT OCCUPANT	2474 W KEEFE AVE	MILWAUKEE, WI 53206
CURRENT OCCUPANT	2479A W KEEFE AVE	MILWAUKEE, WI 53206
CURRENT OCCUPANT	3503 N 25TH ST	MILWAUKEE, WI 53206
CURRENT OCCUPANT	3501 N 25TH ST	MILWAUKEE, WI 53206
CURRENT OCCUPANT	3513 N 25TH ST	MILWAUKEE, WI 53206
CURRENT OCCUPANT	3516A N 26TH ST	MILWAUKEE, WI 53206
CURRENT OCCUPANT	2465 W KEEFE AVE	MILWAUKEE, WI 53206
CURRENT OCCUPANT	3509 N 25TH ST	MILWAUKEE, WI 53206
CURRENT OCCUPANT	3517A N 25TH ST	MILWAUKEE, WI 53206
CURRENT OCCUPANT	3521 N 25TH ST	MILWAUKEE, WI 53206
CURRENT OCCUPANT	2518 W HOPKINS ST 1	MILWAUKEE, WI 53206
CURRENT OCCUPANT	3439 N 24TH PL	MILWAUKEE, WI 53206
CURRENT OCCUPANT	2461 W KEEFE AVE	MILWAUKEE, WI 53206
CURRENT OCCUPANT	2469 W KEEFE AVE	MILWAUKEE, WI 53206
CURRENT OCCUPANT	2474A W KEEFE AVE	MILWAUKEE, WI 53206
CURRENT OCCUPANT	3512 N 26TH ST	MILWAUKEE, WI 53206
CURRENT OCCUPANT	3435A N 24TH PL	MILWAUKEE, WI 53206
CURRENT OCCUPANT	3520 N 26TH ST	MILWAUKEE, WI 53206
CURRENT OCCUPANT	2534 W HOPKINS ST	MILWAUKEE, WI 53206
CURRENT OCCUPANT	2459 W KEEFE AVE	MILWAUKEE, WI 53206
CURRENT OCCUPANT	2475A W KEEFE AVE	MILWAUKEE, WI 53206

Total Records: 39

Radius: 250.0 feet and Center of Circle: 2534 W Hopkins St

2018-2019 Plan of Operation for 2534 W HOPKINS ST

1. Litter & Security Plans	
How are the grounds kept clean? <input type="checkbox"/> Sweep <input type="checkbox"/> Pressure Wash <input checked="" type="checkbox"/> Pick Up Litter <input type="checkbox"/> Other: LICENSE DIVISION	
How often will grounds be cleaned? <input checked="" type="checkbox"/> Daily <input type="checkbox"/> Weekly <input type="checkbox"/> Other:	
Who cleans the grounds? <input type="checkbox"/> Licensee <input type="checkbox"/> Building Owner <input checked="" type="checkbox"/> Employees <input type="checkbox"/> Hired Maintenance <input type="checkbox"/> Other: 29	
How are noise issues prevented and/or addressed? <input type="checkbox"/> Security <input checked="" type="checkbox"/> Manager approaches customer(s) <input type="checkbox"/> Call Police <input type="checkbox"/> Signs Posted <input type="checkbox"/> Other:	
Are there designated outdoor smoking areas? <input checked="" type="checkbox"/> No <input type="checkbox"/> Yes If Yes, Describe:	
Number of garbage cans: Inside <u>6</u> Locations: <u>3 under Bar 2 Kitchen 1 by Kitchen</u> Outside <u>2</u> Locations: <u>Parking Lot</u>	
Is a crowd control barrier used? <input checked="" type="checkbox"/> No <input type="checkbox"/> Yes If Yes, Describe:	
Number of restrooms: <u>3</u>	Name of solid waste contractor: <u>ADVANCE DIS POS</u>
Are there parking spaces on the premises? <input type="checkbox"/> No <input checked="" type="checkbox"/> Yes If Yes, list number of spaces: <u>13</u> and describe security plans: <u>BARTONder Control Customers</u>	
Are there designated loading areas? <input checked="" type="checkbox"/> No <input type="checkbox"/> Yes If Yes, describe security plans:	
Do you have security personnel on the premise? <input checked="" type="checkbox"/> No <input type="checkbox"/> Yes If Yes, how many? _____ AND What are their responsibilities? _____ What security equipment do they use? _____ List their licensing, certification or training credentials: _____	
Are there security cameras? <input type="checkbox"/> No <input checked="" type="checkbox"/> Yes If Yes, list all locations: <u>Entire Building</u>	
Are searches and/or identification checks conducted upon entry? <input checked="" type="checkbox"/> No <input type="checkbox"/> Yes If Yes, describe:	
2. Percentage of Sales (must total 100%)	
Alcohol <u>97</u> %	Food Sales <u>3</u> % Entertainment _____ % Other _____ %
3. Businesses On The Premises (choose all that apply):	
<input type="checkbox"/> Restaurant <input checked="" type="checkbox"/> Cafe/Coffee Shop <input type="checkbox"/> Cocktail Lounge <input type="checkbox"/> Convenience Store <input type="checkbox"/> Night Club <input type="checkbox"/> Liquor Store <input checked="" type="checkbox"/> Tavern <input type="checkbox"/> Sports Facility <input type="checkbox"/> Hotel <input type="checkbox"/> Banquet Hall <input type="checkbox"/> Supermarket <input type="checkbox"/> Private/Fraternal/Veterans' Club <input type="checkbox"/> Other:	
4. Hours of Operation and Age Restriction	
Are there any changes to the current hours of operation or age restriction? <input checked="" type="checkbox"/> No <input type="checkbox"/> Yes If Yes, Describe:	
Please Note: If you will be open earlier or later than the hours listed on your current license for even one event or holiday (for example, St. Patrick's Day, Brewers Opening Day, etc.) during the license period, this must be reported and printed on your license. Your hours of operation and age restriction are listed on your current license.	
5. Floor Plan and Capacity	
Are you requesting any changes to your capacity or floor plan*? <input checked="" type="checkbox"/> No <input type="checkbox"/> Yes If yes, describe: _____ and submit a new floor plan with this renewal application. A sample plan can be found online at www.milwaukee.gov/licenses under License Forms and Related Information.	
Alcohol/Food Establishments: A "Permanent Extension of Premises Application" is required if you are adding any square footage to the licensed premises.	
6. Sidewalk Dining: Fee:	
Are there any changes to the sidewalk dining site plan? <input type="checkbox"/> No <input type="checkbox"/> Yes If Yes, submit an updated site plan with this application.	
7. Food License: FREST 11384 Fee: \$525.00	8. Weights and Measures: Fee:
Your current food license includes the following food operations: DHS - MODERATE, Sales < \$20,000, Tavern Restaurant. Are there any changes to your food operations as listed above? <input checked="" type="checkbox"/> No <input type="checkbox"/> Yes, if Yes, explain _____	Number/Type of Devices: Are there any changes to the number or types of devices? <input type="checkbox"/> No <input type="checkbox"/> Yes If yes, contact our office for further instructions.

1. CURRENT APPROVED ENTERTAINMENT

The following types of entertainment have been approved for your current Public Entertainment Premises license:

Patrons Dancing, Disc Jockey, Amusement Machines 5, Internet Music

2. ADDING ENTERTAINMENT

If applicable, check any entertainment you wish to add: **ONLY CHECK ENTERTAINMENT TYPE(S) YOU ARE ADDING. YOUR CURRENT APPROVED ENTERTAINMENT IS LISTED ABOVE.**

- | | | | |
|---|--|--|---|
| <input type="checkbox"/> Instrumental Musicians | <input type="checkbox"/> Bands | <input type="checkbox"/> Battle of the Bands | <input type="checkbox"/> Comedy Acts |
| <input type="checkbox"/> Disc Jockey | <input type="checkbox"/> Magic Shows | <input type="checkbox"/> Poetry Readings | <input type="checkbox"/> Dancing by Performers |
| <input type="checkbox"/> Jukebox | <input type="checkbox"/> Wrestling | <input type="checkbox"/> Patron Contests | <input type="checkbox"/> Patrons Dancing |
| <input type="checkbox"/> Adult Entertainment/
Strippers/Erotic Dance | <input type="checkbox"/> Karaoke | <input type="checkbox"/> Bowling Alley
How many? _____ | <input type="checkbox"/> Pool Tables
How many? _____ |
| <input type="checkbox"/> Motion Pictures (movies by admission)
How many screens? _____ | <input type="checkbox"/> Amusement Machines
How many? _____ | <input type="checkbox"/> Concerts
Approx. # per year? _____ | <input type="checkbox"/> Theatrical Performances
Approx. # per year? _____ |

Other: _____

No entertainment changes can take place until approved by Common Council and a new license has been issued and posted on the premises.

3. REMOVING ENTERTAINMENT

If applicable, list any entertainment you wish to remove:

4. PROMOTERS/SOUND AMPLIFICATION

Will promoters ever be used for any of the entertainment? No Yes If Yes, Describe:

At any time will sound amplification be used? No Yes If Yes, Describe:

5. SIGNATURE

Warren G. Harper

I understand that after the license has been issued, a change to the plan of operation will require a written request to change and approval from the Common Council.

I agree to inform the City Clerk within 10 days of any substantial changes in the information supplied in this application.

I understand that I shall not willfully refuse to provide the services offered under this license, or add charges or require deposits not required of the general public because of race, color, sex, religion, national origin or ancestry, age, handicap, lawful source of income, marital status, sexual orientation, gender identity or expression, familial status or the fact that a person is now or has been a member of the military service, whether dressed in uniform or not; and shall not seek such information as a condition of employment, or penalize any employee or discriminate in the selection of personnel for training or promotion on the basis of such information.

I have knowledge of the City Ordinances currently regulating public entertainment, and understand that the license may be subject to suspension, non-renewal or revocation, if I violate any rule, law or regulation of the city of Milwaukee and State of Wisconsin.

Warren G. Harper

Signature of Sole Proprietor, a Partner, or if a Corporation or LLC, the Agent must sign



**CITY OF MILWAUKEE
OFFICE OF THE CITY CLERK**

Thursday, June 20, 2019

COMMITTEE MEETING NOTICE

AD 06

JULES, Lucile M, Agent
Curry Goat Corp
PO Box 1206
Milwaukee, WI 53201

You are requested to attend a hearing which is to be held in Room 301-B, Third Floor, City Hall on:

Tuesday, June 25, 2019 at 02:30 PM

Regarding: Your Public Entertainment Premises, Sidewalk Dining, Alcohol and Food Permanent Extension of Premises License Applications Adding Patio and Sidewalk Café, and requesting Instrumental Musicians, Disc Jockey, Jukebox, Bands, Battle of the Bands, Poetry Readings, Patron Contests, Comedy Acts, Dancing by Performers, Patron Dancing, Dance Lessons, Exercise Classes, 12 Motion Pictures, 36 Concerts, and 12 Theatrical Performances as agent for "Curry Goat Corp" for "Jewels Caribbean Restaurant" at 2230 N Martin L King Jr DR.

There is a possibility that your application may be denied for one or more of the following reasons: The recommendation of the committee regarding the application shall be based on evidence presented at the hearing. Per MCO 85-2.7-4, probative evidence concerning whether or not a new license should be granted may be presented on the following subjects: whether or not the applicant meets the municipal requirements, the appropriateness of the location and premises where the licensed premises is to be located and whether use of the premises for the purposes or activities permitted by the license would tend to facilitate a public or private nuisance or create undesirable neighborhood problems such as disorderly patrons, unreasonably loud noise, litter, and excessive traffic and parking congestion. Probative evidence relating to these matters may be taken from the plan of operation submitted with the license application, if any, but shall not include the content of any music. Evidence regarding the fitness of the location of the premises to be maintained as the principal place of business, including but not limited to whether there is an overconcentration of businesses of the type for which the license is sought; whether the proposal is consistent with any pertinent neighborhood business or development plans, or the location's proximity to areas where children are typically present. The applicant's record in operating similarly licensed premises; and whether or not the applicant has been charged with or convicted of any felony, misdemeanor, municipal offense or other offense, the circumstances of which substantially relate to the activity to be permitted by the license being applied for or any other factor which reasonably relates to the public health, safety or welfare may also be considered.

Notice for applicants with warrants or unpaid fines: Proof of warrant satisfaction or payment of fines must be submitted at the hearing on the above date and time. Failure to comply with this requirement may result in a delay of the granting/denial of your application.

Failure to appear at this meeting may result in the denial of your license. Individual applicants must appear only in person or by an attorney. Corporate or Limited Liability applicants must appear only by the agent designated on the application or by an attorney. Partnership applicants must appear by a partner listed on the application or by an attorney. If you wish to do so and at your own expense, you may be accompanied by an attorney of your choosing to represent you at this hearing.

You will be given an opportunity to speak on behalf of the application and to respond and challenge any charges or reasons given for the denial. No petitions can be accepted by the committee, unless the people who signed the petition are present at the committee hearing and willing to testify. You may present witnesses under oath and you may also confront and cross-examine opposing witnesses under oath. If you have difficulty with the English language, you should bring an interpreter with you, at your expense, so that you can answer questions and participate in your hearing.

You may examine the application file at this office during regular business hours prior to the hearing date. Inquiries regarding this matter may be directed to the person whose signature appears below.

Limited parking for persons attending meetings in City Hall is available at reduced rates (5 hour limit) at the Milwaukee Center on the southwest corner of East Kilbourn and North Water Street. Parking tickets must be validated in the first floor information booth in City Hall.

PLEASE NOTE: Upon reasonable notice, efforts will be made to accommodate the needs of disabled individuals through sign language interpreters or other auxiliary aids. For additional information or to request this service, contact the Council Services Division ADA Coordinator at (414) 286-2998, Fax - (414) 286-3456, TDD - (414) 286-2025.

JIM OWCZARSKI, CITY CLERK

BY: _____
Jessica Celella

License Division Manager

If you have questions regarding this notice, please contact the License Division at (414) 286-2238.
200 E. Wells Street, Room 105, City Hall, Milwaukee, WI 53202. www.milwaukee.gov/license
Phone: (414) 286-2238 Fax: (414) 286-3057 Email Address: License@milwaukee.gov



Thursday, June 20, 2019



Notice of Public Hearing

JULES, Lucile M, Agent

Jewels Caribbean Restaurant at 2230 N Martin L King Jr DR

Public Entertainment Premises, Sidewalk Dining, Alcohol and Food Permanent Extension of Premises License Applications Adding Patio and Sidewalk Café, and Requesting Instrumental Musicians, Disc Jockey, Jukebox, Bands, Battle of the Bands, Poetry Readings, Patron Contests, Comedy Acts, Dancing by Performers, Patron Dancing, Dance Lessons, Exercise Classes, 12 Motion Pictures, 36 Concerts, and 12 Theatrical Performances

Tuesday, June 25, 2019 at 2:30 PM

To whom it may concern:

The above application has been made by the above named applicant(s). This requires approval from the Licenses Committee and the Common Council of the City of Milwaukee. The hearing before the Licenses Committee will take place on 6/25/2019 at 2:30 PM, in Room 301-B, Third Floor, City Hall. If you wish, you may provide testimony at the hearing regarding the request; see below for further information. You are not required to attend the hearing. Once the Licenses Committee makes its recommendation, this recommendation is forwarded to the full Common Council for approval at its next regularly scheduled hearing. Please review the information below and if you have further questions regarding this process, please contact the License Division at (414) 286-2238.

Important details for those wishing to provide information for the Licenses Committee to consider when making its recommendation:

1. The license application is scheduled to be heard at the above time. Due to other hearings running longer than scheduled, you may have to wait some time to provide your testimony.
2. You must appear in person and testify as to matters that you have personally experienced or seen. (You cannot provide testimony for your neighbor, parent or anyone else; this is considered hearsay and cannot be considered by the committee.)
3. No letters or petitions can be accepted by the committee (unless the person who wrote the letter or the persons who signed the petition are present at the committee hearing and willing to testify).
4. Persons opposed to the license application are given the opportunity to testify first; supporters may testify after the opponents have finished.
5. When you are called to testify, you will be sworn in and asked to give your name, and address. (If your first and/or last names are uncommon please spell them.)
6. You may then provide testimony.
 - a. Include only information relating to the above license application.
 - b. Include only information you have personally witnessed or seen.
 - c. Provide concise and relevant information detailing how this business has affected or may affect the peaceful enjoyment of your neighborhood.
 - d. If by the time you have the opportunity to testify, the information you wish to share has already been provided to the committee, you may state that you agree with the previous testimony. Redundant or repetitive testimony will not assist the committee in making its recommendation.
7. After giving your testimony, the members of the Licenses Committee and the licensee may ask questions regarding the testimony you have given or other factors relating to the license application.
8. Business Competition is not a valid basis for denial or non-renewal of a license.

OCCUPANT	MAIL ADDRESS	CITY, STATE ZIP
CURRENT OCCUPANT	2104 N DR MARTIN LUTHER KING DR 107	MILWAUKEE, WI 53212
CURRENT OCCUPANT	2104 N DR MARTIN LUTHER KING DR 201	MILWAUKEE, WI 53212
CURRENT OCCUPANT	2104 N DR MARTIN LUTHER KING DR 206	MILWAUKEE, WI 53212
CURRENT OCCUPANT	2104 N DR MARTIN LUTHER KING DR 209	MILWAUKEE, WI 53212
CURRENT OCCUPANT	2104 N DR MARTIN LUTHER KING DR 304	MILWAUKEE, WI 53212
CURRENT OCCUPANT	2104 N DR MARTIN LUTHER KING DR 305	MILWAUKEE, WI 53212
CURRENT OCCUPANT	2104 N DR MARTIN LUTHER KING DR 309	MILWAUKEE, WI 53212
CURRENT OCCUPANT	2104 N DR MARTIN LUTHER KING DR 312	MILWAUKEE, WI 53212
CURRENT OCCUPANT	2121 N 2ND ST 106	MILWAUKEE, WI 53212
CURRENT OCCUPANT	2121 N 2ND ST 208	MILWAUKEE, WI 53212
CURRENT OCCUPANT	2121 N 2ND ST 223	MILWAUKEE, WI 53212
CURRENT OCCUPANT	2121 N 2ND ST 227	MILWAUKEE, WI 53212
CURRENT OCCUPANT	2121 N 2ND ST 320	MILWAUKEE, WI 53212
CURRENT OCCUPANT	2121 N 2ND ST 325	MILWAUKEE, WI 53212
CURRENT OCCUPANT	2123 N 2ND ST 119	MILWAUKEE, WI 53212
CURRENT OCCUPANT	2123 N 2ND ST 120	MILWAUKEE, WI 53212
CURRENT OCCUPANT	2218 N DR MARTIN LUTHER KING DR A11	MILWAUKEE, WI 53212
CURRENT OCCUPANT	2218 N DR MARTIN LUTHER KING DR A23	MILWAUKEE, WI 53212
CURRENT OCCUPANT	2218 N DR MARTIN LUTHER KING DR A32	MILWAUKEE, WI 53212
CURRENT OCCUPANT	2218 N DR MARTIN LUTHER KING DR A33	MILWAUKEE, WI 53212
CURRENT OCCUPANT	2218 N DR MARTIN LUTHER KING DR A36	MILWAUKEE, WI 53212
CURRENT OCCUPANT	2218 N DR MARTIN LUTHER KING DR A45	MILWAUKEE, WI 53212
CURRENT OCCUPANT	2200 N DR MARTIN LUTHER KING DR B32	MILWAUKEE, WI 53212
CURRENT OCCUPANT	2200 N DR MARTIN LUTHER KING DR B43	MILWAUKEE, WI 53212
CURRENT OCCUPANT	2200 N DR MARTIN LUTHER KING DR B54	MILWAUKEE, WI 53212
CURRENT OCCUPANT	2104 N DR MARTIN LUTHER KING DR 103	MILWAUKEE, WI 53212
CURRENT OCCUPANT	2104 N DR MARTIN LUTHER KING DR 109	MILWAUKEE, WI 53212
CURRENT OCCUPANT	2104 N DR MARTIN LUTHER KING DR 203	MILWAUKEE, WI 53212
CURRENT OCCUPANT	2104 N DR MARTIN LUTHER KING DR 219	MILWAUKEE, WI 53212
CURRENT OCCUPANT	2121 N 2ND ST 103	MILWAUKEE, WI 53212
CURRENT OCCUPANT	2121 N 2ND ST 108	MILWAUKEE, WI 53212
CURRENT OCCUPANT	2121 N 2ND ST 203	MILWAUKEE, WI 53212
CURRENT OCCUPANT	2121 N 2ND ST 209	MILWAUKEE, WI 53212
CURRENT OCCUPANT	2121 N 2ND ST 212	MILWAUKEE, WI 53212
CURRENT OCCUPANT	2121 N 2ND ST 215	MILWAUKEE, WI 53212
CURRENT OCCUPANT	2121 N 2ND ST 225	MILWAUKEE, WI 53212
CURRENT OCCUPANT	2121 N 2ND ST 228	MILWAUKEE, WI 53212
CURRENT OCCUPANT	2121 N 2ND ST 304	MILWAUKEE, WI 53212
CURRENT OCCUPANT	2121 N 2ND ST 311	MILWAUKEE, WI 53212
CURRENT OCCUPANT	2121 N 2ND ST 313	MILWAUKEE, WI 53212
CURRENT OCCUPANT	2121 N 2ND ST 317	MILWAUKEE, WI 53212
CURRENT OCCUPANT	2121 N 2ND ST 321	MILWAUKEE, WI 53212
CURRENT OCCUPANT	2121 N 2ND ST 322	MILWAUKEE, WI 53212
CURRENT OCCUPANT	2123 N 2ND ST 125	MILWAUKEE, WI 53212
CURRENT OCCUPANT	2218 N DR MARTIN LUTHER KING DR A31	MILWAUKEE, WI 53212
CURRENT OCCUPANT	2200 N DR MARTIN LUTHER KING DR B25	MILWAUKEE, WI 53212

CURRENT OCCUPANT	2200 N DR MARTIN LUTHER KING DR B35	MILWAUKEE, WI 53212
CURRENT OCCUPANT	211 W NORTH AVE 6	MILWAUKEE, WI 53212
CURRENT OCCUPANT	211 W NORTH AVE 7	MILWAUKEE, WI 53212
CURRENT OCCUPANT	2104 N DR MARTIN LUTHER KING DR 106	MILWAUKEE, WI 53212
CURRENT OCCUPANT	2104 N DR MARTIN LUTHER KING DR 112	MILWAUKEE, WI 53212
CURRENT OCCUPANT	2104 N DR MARTIN LUTHER KING DR 114	MILWAUKEE, WI 53212
CURRENT OCCUPANT	2104 N DR MARTIN LUTHER KING DR 212	MILWAUKEE, WI 53212
CURRENT OCCUPANT	2104 N DR MARTIN LUTHER KING DR 214	MILWAUKEE, WI 53212
CURRENT OCCUPANT	2104 N DR MARTIN LUTHER KING DR 302	MILWAUKEE, WI 53212
CURRENT OCCUPANT	2104 N DR MARTIN LUTHER KING DR 306	MILWAUKEE, WI 53212
CURRENT OCCUPANT	2121 N 2ND ST 101	MILWAUKEE, WI 53212
CURRENT OCCUPANT	2121 N 2ND ST 102	MILWAUKEE, WI 53212
CURRENT OCCUPANT	2121 N 2ND ST 112	MILWAUKEE, WI 53212
CURRENT OCCUPANT	2121 N 2ND ST 202	MILWAUKEE, WI 53212
CURRENT OCCUPANT	2121 N 2ND ST 210	MILWAUKEE, WI 53212
CURRENT OCCUPANT	2121 N 2ND ST 220	MILWAUKEE, WI 53212
CURRENT OCCUPANT	2121 N 2ND ST 221	MILWAUKEE, WI 53212
CURRENT OCCUPANT	2121 N 2ND ST 301	MILWAUKEE, WI 53212
CURRENT OCCUPANT	2121 N 2ND ST 312	MILWAUKEE, WI 53212
CURRENT OCCUPANT	2121 N 2ND ST 327	MILWAUKEE, WI 53212
CURRENT OCCUPANT	2123 N 2ND ST 121	MILWAUKEE, WI 53212
CURRENT OCCUPANT	2123 N 2ND ST 127	MILWAUKEE, WI 53212
CURRENT OCCUPANT	2218 N DR MARTIN LUTHER KING DR A21	MILWAUKEE, WI 53212
CURRENT OCCUPANT	2218 N DR MARTIN LUTHER KING DR A24	MILWAUKEE, WI 53212
CURRENT OCCUPANT	2200 N DR MARTIN LUTHER KING DR B33	MILWAUKEE, WI 53212
CURRENT OCCUPANT	2200 N DR MARTIN LUTHER KING DR B44	MILWAUKEE, WI 53212
CURRENT OCCUPANT	2104 N DR MARTIN LUTHER KING DR 104	MILWAUKEE, WI 53212
CURRENT OCCUPANT	2104 N DR MARTIN LUTHER KING DR 116	MILWAUKEE, WI 53212
CURRENT OCCUPANT	2104 N DR MARTIN LUTHER KING DR 217	MILWAUKEE, WI 53212
CURRENT OCCUPANT	2104 N DR MARTIN LUTHER KING DR 303	MILWAUKEE, WI 53212
CURRENT OCCUPANT	2104 N DR MARTIN LUTHER KING DR 307	MILWAUKEE, WI 53212
CURRENT OCCUPANT	2104 N DR MARTIN LUTHER KING DR 313	MILWAUKEE, WI 53212
CURRENT OCCUPANT	2121 N 2ND ST 107	MILWAUKEE, WI 53212
CURRENT OCCUPANT	2121 N 2ND ST 109	MILWAUKEE, WI 53212
CURRENT OCCUPANT	2121 N 2ND ST 110	MILWAUKEE, WI 53212
CURRENT OCCUPANT	2121 N 2ND ST 307	MILWAUKEE, WI 53212
CURRENT OCCUPANT	2121 N 2ND ST 316	MILWAUKEE, WI 53212
CURRENT OCCUPANT	2123 N 2ND ST 118	MILWAUKEE, WI 53212
CURRENT OCCUPANT	2123 N 2ND ST 122	MILWAUKEE, WI 53212
CURRENT OCCUPANT	2218 N DR MARTIN LUTHER KING DR A22	MILWAUKEE, WI 53212
CURRENT OCCUPANT	2218 N DR MARTIN LUTHER KING DR A35	MILWAUKEE, WI 53212
CURRENT OCCUPANT	2218 N DR MARTIN LUTHER KING DR A42	MILWAUKEE, WI 53212
CURRENT OCCUPANT	2200 N DR MARTIN LUTHER KING DR B45	MILWAUKEE, WI 53212
CURRENT OCCUPANT	2200 N DR MARTIN LUTHER KING DR B53	MILWAUKEE, WI 53212
CURRENT OCCUPANT	2104 N DR MARTIN LUTHER KING DR 101	MILWAUKEE, WI 53212
CURRENT OCCUPANT	2104 N DR MARTIN LUTHER KING DR 115	MILWAUKEE, WI 53212
CURRENT OCCUPANT	2104 N DR MARTIN LUTHER KING DR 210	MILWAUKEE, WI 53212

CURRENT OCCUPANT	2104 N DR MARTIN LUTHER KING DR 310	MILWAUKEE, WI 53212
CURRENT OCCUPANT	2121 N 2ND ST 201	MILWAUKEE, WI 53212
CURRENT OCCUPANT	2121 N 2ND ST 206	MILWAUKEE, WI 53212
CURRENT OCCUPANT	2121 N 2ND ST 303	MILWAUKEE, WI 53212
CURRENT OCCUPANT	2121 N 2ND ST 308	MILWAUKEE, WI 53212
CURRENT OCCUPANT	2123 N 2ND ST 117	MILWAUKEE, WI 53212
CURRENT OCCUPANT	2123 N 2ND ST 128	MILWAUKEE, WI 53212
CURRENT OCCUPANT	2218 N DR MARTIN LUTHER KING DR A26	MILWAUKEE, WI 53212
CURRENT OCCUPANT	2218 N DR MARTIN LUTHER KING DR A46	MILWAUKEE, WI 53212
CURRENT OCCUPANT	2200 N DR MARTIN LUTHER KING DR M2	MILWAUKEE, WI 53212
CURRENT OCCUPANT	2200 N DR MARTIN LUTHER KING DR B23	MILWAUKEE, WI 53212
CURRENT OCCUPANT	2200 N DR MARTIN LUTHER KING DR B34	MILWAUKEE, WI 53212
CURRENT OCCUPANT	2200 N DR MARTIN LUTHER KING DR B41	MILWAUKEE, WI 53212
CURRENT OCCUPANT	2200 N DR MARTIN LUTHER KING DR B42	MILWAUKEE, WI 53212
CURRENT OCCUPANT	211 W NORTH AVE 2	MILWAUKEE, WI 53212
CURRENT OCCUPANT	2104 N DR MARTIN LUTHER KING DR 102	MILWAUKEE, WI 53212
CURRENT OCCUPANT	2104 N DR MARTIN LUTHER KING DR 202	MILWAUKEE, WI 53212
CURRENT OCCUPANT	2104 N DR MARTIN LUTHER KING DR 213	MILWAUKEE, WI 53212
CURRENT OCCUPANT	2104 N DR MARTIN LUTHER KING DR 311	MILWAUKEE, WI 53212
CURRENT OCCUPANT	2104 N DR MARTIN LUTHER KING DR 316	MILWAUKEE, WI 53212
CURRENT OCCUPANT	2104 N DR MARTIN LUTHER KING DR 317	MILWAUKEE, WI 53212
CURRENT OCCUPANT	2121 N 2ND ST 213	MILWAUKEE, WI 53212
CURRENT OCCUPANT	2121 N 2ND ST 219	MILWAUKEE, WI 53212
CURRENT OCCUPANT	2121 N 2ND ST 310	MILWAUKEE, WI 53212
CURRENT OCCUPANT	2121 N 2ND ST 315	MILWAUKEE, WI 53212
CURRENT OCCUPANT	2121 N 2ND ST 319	MILWAUKEE, WI 53212
CURRENT OCCUPANT	2123 N 2ND ST 123	MILWAUKEE, WI 53212
CURRENT OCCUPANT	2218 N DR MARTIN LUTHER KING DR A34	MILWAUKEE, WI 53212
CURRENT OCCUPANT	2218 N DR MARTIN LUTHER KING DR A44	MILWAUKEE, WI 53212
CURRENT OCCUPANT	2200 N DR MARTIN LUTHER KING DR B21	MILWAUKEE, WI 53212
CURRENT OCCUPANT	2200 N DR MARTIN LUTHER KING DR B51	MILWAUKEE, WI 53212
CURRENT OCCUPANT	2200 N DR MARTIN LUTHER KING DR B52	MILWAUKEE, WI 53212
CURRENT OCCUPANT	211 W NORTH AVE 3	MILWAUKEE, WI 53212
CURRENT OCCUPANT	211 W NORTH AVE 4	MILWAUKEE, WI 53212
CURRENT OCCUPANT	2104 N DR MARTIN LUTHER KING DR 111	MILWAUKEE, WI 53212
CURRENT OCCUPANT	2104 N DR MARTIN LUTHER KING DR 113	MILWAUKEE, WI 53212
CURRENT OCCUPANT	2104 N DR MARTIN LUTHER KING DR 216	MILWAUKEE, WI 53212
CURRENT OCCUPANT	2104 N DR MARTIN LUTHER KING DR 314	MILWAUKEE, WI 53212
CURRENT OCCUPANT	2104 N DR MARTIN LUTHER KING DR 315	MILWAUKEE, WI 53212
CURRENT OCCUPANT	2121 N 2ND ST 104	MILWAUKEE, WI 53212
CURRENT OCCUPANT	2121 N 2ND ST 105	MILWAUKEE, WI 53212
CURRENT OCCUPANT	2121 N 2ND ST 204	MILWAUKEE, WI 53212
CURRENT OCCUPANT	2121 N 2ND ST 205	MILWAUKEE, WI 53212
CURRENT OCCUPANT	2121 N 2ND ST 211	MILWAUKEE, WI 53212
CURRENT OCCUPANT	2121 N 2ND ST 216	MILWAUKEE, WI 53212
CURRENT OCCUPANT	2121 N 2ND ST 224	MILWAUKEE, WI 53212
CURRENT OCCUPANT	2121 N 2ND ST 302	MILWAUKEE, WI 53212

CURRENT OCCUPANT	2121 N 2ND ST 306	MILWAUKEE, WI 53212
CURRENT OCCUPANT	2121 N 2ND ST 314	MILWAUKEE, WI 53212
CURRENT OCCUPANT	2123 N 2ND ST 126	MILWAUKEE, WI 53212
CURRENT OCCUPANT	2218 N DR MARTIN LUTHER KING DR A25	MILWAUKEE, WI 53212
CURRENT OCCUPANT	2218 N DR MARTIN LUTHER KING DR A41	MILWAUKEE, WI 53212
CURRENT OCCUPANT	2200 N DR MARTIN LUTHER KING DR M1	MILWAUKEE, WI 53212
CURRENT OCCUPANT	2200 N DR MARTIN LUTHER KING DR B22	MILWAUKEE, WI 53212
CURRENT OCCUPANT	211 W NORTH AVE 1	MILWAUKEE, WI 53212
CURRENT OCCUPANT	211 W NORTH AVE 5	MILWAUKEE, WI 53212
CURRENT OCCUPANT	211 W NORTH AVE 10	MILWAUKEE, WI 53212
CURRENT OCCUPANT	2104 N DR MARTIN LUTHER KING DR 105	MILWAUKEE, WI 53212
CURRENT OCCUPANT	2104 N DR MARTIN LUTHER KING DR 204	MILWAUKEE, WI 53212
CURRENT OCCUPANT	2104 N DR MARTIN LUTHER KING DR 205	MILWAUKEE, WI 53212
CURRENT OCCUPANT	2104 N DR MARTIN LUTHER KING DR 207	MILWAUKEE, WI 53212
CURRENT OCCUPANT	2104 N DR MARTIN LUTHER KING DR 211	MILWAUKEE, WI 53212
CURRENT OCCUPANT	2104 N DR MARTIN LUTHER KING DR 319	MILWAUKEE, WI 53212
CURRENT OCCUPANT	2121 N 2ND ST 207	MILWAUKEE, WI 53212
CURRENT OCCUPANT	2121 N 2ND ST 214	MILWAUKEE, WI 53212
CURRENT OCCUPANT	2121 N 2ND ST 217	MILWAUKEE, WI 53212
CURRENT OCCUPANT	2121 N 2ND ST 218	MILWAUKEE, WI 53212
CURRENT OCCUPANT	2121 N 2ND ST 222	MILWAUKEE, WI 53212
CURRENT OCCUPANT	2121 N 2ND ST 226	MILWAUKEE, WI 53212
CURRENT OCCUPANT	2121 N 2ND ST 305	MILWAUKEE, WI 53212
CURRENT OCCUPANT	2121 N 2ND ST 309	MILWAUKEE, WI 53212
CURRENT OCCUPANT	2121 N 2ND ST 318	MILWAUKEE, WI 53212
CURRENT OCCUPANT	2121 N 2ND ST 323	MILWAUKEE, WI 53212
CURRENT OCCUPANT	2121 N 2ND ST 324	MILWAUKEE, WI 53212
CURRENT OCCUPANT	2121 N 2ND ST 326	MILWAUKEE, WI 53212
CURRENT OCCUPANT	2121 N 2ND ST 328	MILWAUKEE, WI 53212
CURRENT OCCUPANT	2123 N 2ND ST 124	MILWAUKEE, WI 53212
CURRENT OCCUPANT	2218 N DR MARTIN LUTHER KING DR A43	MILWAUKEE, WI 53212
CURRENT OCCUPANT	2200 N DR MARTIN LUTHER KING DR B24	MILWAUKEE, WI 53212
CURRENT OCCUPANT	2200 N DR MARTIN LUTHER KING DR B31	MILWAUKEE, WI 53212
CURRENT OCCUPANT	2200 N DR MARTIN LUTHER KING DR B55	MILWAUKEE, WI 53212
CURRENT OCCUPANT	211 W NORTH AVE 8	MILWAUKEE, WI 53212
CURRENT OCCUPANT	211 W NORTH AVE 9	MILWAUKEE, WI 53212

Total Records: 176

Radius: 250.0 feet and Center of Circle: 2230 N Martin Luther King Jr Dr



BUSINESS LICENSE PLAN OF OPERATION

ccl-busplan 3/15/18

Office of the City Clerk License Division
200 E. Wells St. Room 105, Milwaukee, WI 53202
(414) 286-2238 www.milwaukee.gov/license e-mail address: license@milwaukee.gov

1. Type of Business

Applying for: Extended Hours (12AM to 5AM) - If a food establishment, check all that apply: Delivery Drive Thru Dining Room
 Self Service Laundry Massage Establishment Filling Station
 Other (supplemental application for specific license also required)

Provide a detailed description of the type of business you plan on operating:
Caribbean restaurant and bar

Do you have any experience operating this type of business? No Yes If yes, explain: We are already open

2. Business Operations

- a. Proposed Opening Date: We opened in December 2018
- b. Is this premise under construction? No Yes If yes, list estimated completion date: _____
- c. Is this a franchise? No Yes
- d. Is this premises currently licensed? No Yes If yes, list type of license: Food Dealer, Tavern Class B
- e. Is the current licensee operating? No Yes If no, list date closed: _____
- f. Do you have future plans for other businesses, licenses or permits at this location? No Yes
If yes, explain: Public Entertainment License
- g. Have you previously held an Extended Hours License in Milwaukee? No Yes
If yes, list address(es): _____
- h. Are other businesses operating in the same building? No Yes If yes, describe: _____

3. Litter & Noise

- a. How are grounds kept clean? Sweep Pressure Wash Pick Up Litter Other: _____
- b. How often will grounds be cleaned? Daily Weekly As Needed Monthly Other: _____
- c. Grounds cleaned by: Licensee Building Owner Employees Hired Maintenance Other: _____
- d. How are noise issues prevented and/or addressed? Security Manager approaches customer(s) Call Police
 Signs Posted Other: _____ Text
- e. Will a sound amplification system be used? No Yes If yes, describe: microphone and speakers

4. Smoking & Sanitation

- a. Are there designated outdoor smoking areas? No Yes If yes, describe: _____
- b. Number of Garbage Cans: Inside: 8 Locations: in kitchen, behind bar
Outside: 2 Locations: trash bins in locked corral
- c. Is a crowd control barrier used? No Yes If yes, describe: _____
- d. How many restrooms are on the premises? 8
- e. Name of solid waste contractor: Advanced Disposal Waste Management Other: ToGo Disposal

5. Security

- a. Are there onsite parking spaces? No Yes If yes, how many? 48 and describe the parking security plan: Trust and towing company patrolling lot several times a day
- b. Is there a loading zone? No Yes If yes, describe the loading area security plan: _____
- c. Will you have security personnel on premise? No Yes If yes, how many? 1 and answer the following:
 What are their responsibilities? prevent incidents, walk patrons to car late night
 Is security equipment used? No Yes If yes, describe _____
 List their licensing, certification, or training credentials U.S. Marine
- d. Will there be security cameras? No Yes If yes, how many? 6 and list locations: dining area, exit/entrance
- e. Will searches/identification checks be done upon entry? No Yes If yes, describe _____

6. Percentage of Sales (must total 100%)

Alcohol <u>40</u> %	Food <u>60</u> %	Secondhand Merchandise _____ %	Precious Metals & Gems _____ %
Entertainment _____ %	Cigarettes _____ %	Personal Services (such as tattoo, body piercing, salon, tailor, tanning, etc.) _____ %	Other _____ %
Pawnbroker Activity _____ %	Salvaged Materials _____ % (such as scrap metal)	Describe: _____	

7. Businesses/Licenses on the Premises (check all that apply):

Type 1

Full Service Restaurant Cafe/Coffee Shop Deli or Fast Food Restaurant Private/Fraternal/Veterans Club

Night Club Tavern Cocktail Lounge Teen Club

Banquet Hall Sports Facility Bowling Alley

Hotel/Motel : Number of Floors: _____ Rooming House: Number of Floors: _____
 Number of Rooms: _____ Number of Rooms: _____

Type 2

Liquor Store Corner Store Supermarket Convenience Store

Gas Station Amusement/Phonograph Distributor Recycling, Salvage or Towing

Used Car Dealer Personal Service Establishment
(such as tattoo business, hair salon, tailor, etc.) Recording Studio

What other licenses/permits will you hold at this location? (check all that apply)

- Occupancy Permit Cigarette & Tobacco Gas Station Extended Hours Class "B" Tavern Weights & Measures
- Secondhand Dealer Precious Metal & Gem Other: _____

8. Legal Capacity (only if a Type 1 premises in #7 above)

Capacity 320 (Call the Milwaukee Development Center at 414-286-8211 if you have questions.)

9. Premises Description

- a. Identify all area(s) of the premises that will be used in operating this business (include areas used only for storage):
 1st Floor 2nd Floor Basement Storage Patio Beer Garden Sidewalk Café Deck Rooftop
 Other: Describe: _____
- b. Describe Location: Major Thoroughfare Secondary Street Other: _____
- c. Nearest Major Cross Street: Dr. Martin Luther King Jr Dr and North Ave
- d. Describe Building: Free Standing Building Strip Mall Other: _____
- e. Describe Premises Structure: Single Story Multi-Story - # of Stories 2 Other: _____
- f. Describe Surrounding Area: Commercial Residential Industrial Other: _____
- g. Building Owner Name: Curry Goat Corp. Phone Number: 310-755-4683
 Business Owner Address: POBox 1206 Milwaukee WI 53201

10. Hours of Operation & Customers

Will customers be entering the premises? No Yes

Day of the Week	Proposed Hours of Operation:		Estimated Number of Customers expected each day	Potential Age Range of Customers	Class B Tavern Applicant Only: Age Restriction (If none, write 'None')
	Open Time (include a.m. or p.m.)	Close Time (include a.m. or p.m.)			
Sunday	10:00 a.m.	8:00 pm	100	25-60	21 y.o.
Monday	8:00a.m.	11:00 pm	100	25-60	21 y.o.
Tuesday	8:00a.m.	11:00 pm	100	25-60	21 y.o.
Wednesday	8:00a.m.	11:00 pm	100	25-60	21 y.o.
Thursday	8:00a.m.	1:30am	100	25-60	21 y.o.
Friday	8:00 a.m.	1:30am	200	25-60	21 y.o.
Saturday	8:00 a.m.	1:30am	200	25-60	21 y.o.

An Extended Hours Establishment License is required for any convenience store, filling station, personal service establishment (such as tattoo, body piercing, salon, tailor, tanning, etc.), recording studio or restaurant which is open between the hours of 12:00 a.m. and 5:00 a.m.

Alcohol Establishments Class A: 8:00 am to 9:00 pm Sunday thru Saturday
 Permitted Hours of Operation: Class B: 6:00 am to 2:00 am Sunday thru Thursday, 6:00 am to 2:30 am Friday & Saturday

Entertainment Outdoor Closing Hours: 10:00pm Sunday-Thursday; 12:00am Friday & Saturday; unless a different time, either earlier or later, is established by the Common Council in its approval of the licensee's plan of operation.

11. Signature(s)

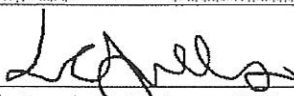
 Signature of Sole Proprietor, Partner, or 20% or more Shareholder
 (If there are no 20% or more shareholders,
 Corporate Officer—print name/title and sign)

 Signature of additional partner or 20% or more shareholder

See Application Information for a complete list of all required application forms.



ALCOHOL BEVERAGE & PUBLIC ENTERTAINMENT PREMISES SUPPLEMENTAL APPLICATION

Office of the City Clerk License Division
200 E. Wells St. Room 105, Milwaukee, WI 53202
(414) 286-2238 e-mail address: license@milwaukee.gov www.milwaukee.gov/license

Legal Entity Name: <u>Curry Goat Corp. d/b/a/ Jewels Caribbean Restaurant</u>
Premise Address: <u>2230 N. Dr Martin Luther King Jr Dr, Milwaukee, WI 53212</u>
Proximity of Premises to Church, School, Daycare Center or Hospital
Is the building within 300 feet of any church, school, daycare center or hospital? <input checked="" type="checkbox"/> No <input type="checkbox"/> Yes
"Service Bar Only" Designation
If applying for Class B or C license, are you applying for "Service Bar Only"? <input checked="" type="checkbox"/> No <input type="checkbox"/> Yes Service Bar Only means customers cannot sit at the bar. Alcohol is served to employees who serve patrons seated at tables. No stools, chairs or other articles of furniture shall be placed at the service bar for patrons to sit upon.
Business Information
a) Are you taking out this application for anyone that may not be eligible for a license? <input checked="" type="checkbox"/> No <input type="checkbox"/> Yes If yes, list their name and address: _____
b) Will the agent, a partner or the individual licensee be conducting the day-to-day operations of the business? <input type="checkbox"/> No <input checked="" type="checkbox"/> Yes If no, list the name and address of the person(s) who will: _____ _____
Class B Applicants: If the agent, a partner or the individual licensee will not be conducting the day-to-day operations of the business, the person(s) listed above must obtain a Class B Managers license.
c) Does anyone else have money invested or any other interest in this business? <input checked="" type="checkbox"/> No <input type="checkbox"/> Yes If yes, explain: _____
d) Have you made an agreement with anyone to repay any loan or any other payments based upon income from the business? <input checked="" type="checkbox"/> No <input type="checkbox"/> Yes If yes, list name and address: _____
Proof of Ownership, Lease, or Offer to Purchase (New & Transfer Applicants Only)
Submit proof of ownership, lease, or offer to purchase the building with this application. A lease or office to purchase must: a) Be in the same legal entity name as that apply for the license b) Reflect the same address as the premises address on this application c) Reflect current dates and d) Be signed by the lessor/seller and lessee/buyer
Property Information (New & Transfer Applicants Only)
a) Do you own or lease the building? <input type="checkbox"/> Own <input checked="" type="checkbox"/> Lease
b) Who owns the fixtures (for example, coolers, etc.)? <u>Curry Goat Corp</u>
c) Are you purchasing the stock and/or fixtures? <input checked="" type="checkbox"/> No <input type="checkbox"/> Yes If yes, amount paid \$ _____
d) Total amount paid for business \$ _____
e) Total amount paid for goodwill of the business \$ _____
Goodwill comprises the reputation and customer relationships of an existing business. If the price you pay for the business exceeds the fair market value of all of the rest of the assets of the business, the excess may be considered goodwill.
f) Have you made arrangements with the seller for payment of personal property taxes? <input checked="" type="checkbox"/> No <input type="checkbox"/> Yes

See Application Information for a list of all required application forms.

Lease Information (New & Transfer Applicants who are leasing the premises only)

- a) Date lease begins Feb 1, 2018 Ends Feb 1, 2024
- b) Monthly rental \$ 10,444.65
- c) Do you have an option to renew the lease? No Yes
- d) Does your lease allow for assignment to another party without the consent of the owner? No Yes
- e) For what length of time have you been guaranteed occupancy (number of years)? 6 years
- f) In addition to paying the monthly rental, will you have to pay anything additional to the owner of the building to guarantee performance of the lease? No Yes If yes, explain _____
- g) Does the present owner or occupancy object to the granting of your license? No Yes
If yes, explain _____

Change of Agent Applicants Only

Have there been any changes to the floor plan since the last application was submitted? No Yes
If no, a new floor plan is not required. If yes, submit a new floor plan and explain the change(s): _____

Signature

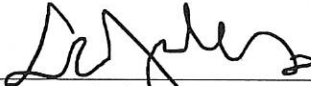

Signature of Sole Proprietor, Partner or 20% or More Shareholder
(If no 20% or more Shareholder, Corporate Officer - print name/title and sign)

Note: All information contained in this application is subject to approval by the Common Council.
Deviating from approved plan of operation will subject licensee to citations, and/or suspension or non-renewal of the license.
Contact the License Division for information on how to request changes.

New and transfer of premise applicants must submit the following:

- Proof of ownership, lease or offer to purchase the building
- Detailed floor plan
- If a restaurant, copy of the menu



PUBLIC ENTERTAINMENT PREMISES LICENSE SUPPLEMENTAL APPLICATION

Office of the City Clerk License Division
200 E. Wells St. Room 105, Milwaukee, WI 53202
(414) 286-2238 www.milwaukee.gov/license e-mail address: license@milwaukee.gov

PREMISES ADDRESS: 2230 N. Dr. Martin Luther King Jr Dr, Milwaukee, WI 53212

TYPES OF ENTERTAINMENT (CHECK ALL THAT APPLY)

- | | | | |
|--|---|---|--|
| <input checked="" type="checkbox"/> Instrumental Musicians | <input checked="" type="checkbox"/> Battle of the Bands | <input checked="" type="checkbox"/> Dancing by Performers | <input type="checkbox"/> Amusement Machines
How many? _____ |
| <input checked="" type="checkbox"/> Bands | <input checked="" type="checkbox"/> Comedy Acts | <input type="checkbox"/> Adult Entertainment/
Strippers/Erotic Dance | <input checked="" type="checkbox"/> Concerts
Approx. # per year? <u>36</u> |
| <input type="checkbox"/> Bowling Alley
How many? _____ | <input checked="" type="checkbox"/> Disc Jockey | <input type="checkbox"/> Wrestling | <input checked="" type="checkbox"/> Theatrical Performances
Approx. # per year? <u>12</u> |
| <input type="checkbox"/> Pool Tables
How many? _____ | <input type="checkbox"/> Magic Shows | <input checked="" type="checkbox"/> Patron Contests | <input checked="" type="checkbox"/> Jukebox |
| <input checked="" type="checkbox"/> Motion Pictures (movies by
admission) - How many? <u>12</u> | <input checked="" type="checkbox"/> Poetry Readings | <input checked="" type="checkbox"/> Patrons Dancing | <input checked="" type="checkbox"/> Karaoke |
| <input checked="" type="checkbox"/> Other: <u>exercise classes, dance lessons</u> | | | |

Entertainment Outdoor Closing Hours: 10:00pm Sunday-Thursday; 12:00am Friday & Saturday; unless a different time, either earlier or later, is established by the Common Council in its approval of the licensee's plan of operation.

PROMOTERS/SOUND AMPLIFICATION

Will promoters ever be used for any of the entertainment? No Yes If Yes, Describe: Promoters will inform the public about events via social media, flyers, print, tv, radio, etc

At any time will sound amplification be used? No Yes If Yes, Describe: Microphone and speakers

LEGAL CAPACITY OF PREMISES

320 (Call the Development Center at 414-286-8211 with questions.) Legal capacity determines the fee for your Public Entertainment Premises License. If you would like to request the license be approved with a lower capacity than that listed above, indicate the lower capacity here: 299. If approved, this lower capacity will print on your license and override the capacity listed on your Occupancy Permit.

ACKNOWLEDGEMENT/SIGNATURE

I understand that after the license has been issued, a change to the plan of operation will require a written request to change and approval from the Common Council. I agree to inform the City Clerk within 10 days of any substantial changes in the information supplied in this application. I understand that I shall not willfully refuse to provide the services offered under this license, or add charges or require deposits not required of the general public because of race, color, sex, religion, national origin or ancestry, age, handicap, lawful source of income, marital status, sexual orientation, gender identity or expression, familial status or the fact that a person is now or has been a member of the military service, whether dressed in uniform or not; and shall not seek such information as a condition of employment, or penalize any employee or discriminate in the selection of personnel for training or promotion on the basis of such information.

I have knowledge of the City Ordinances currently regulating public entertainment, and understand that the license may be subject to suspension, non-renewal or revocation, if I violate any rule, law or regulation of the city of Milwaukee and State of Wisconsin.

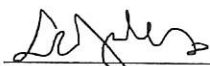

Signature of Sole Proprietor, Partner or 20% or More Shareholder
(If no 20% or more Shareholder, Corporate Officer - print name/title and sign)

Office Use Only:

Initials: _____ Filed: _____ App: _____

Only PEP? No Yes If Yes, Queue to MPD and Email Mgrs/Team Lead (must be heard w/in 60 days)



PERMANENT EXTENSION OF PREMISES APPLICATION FOOD AND ALCOHOL BEVERAGE ESTABLISHMENTS

OFFICE OF THE CITY CLERK LICENSE DIVISION
200 E. WELLS ST. ROOM 105, MILWAUKEE, WI 53202
(414) 286-2238 E-MAIL ADDRESS: LICENSE@MILWAUKEE.GOV

Section A	Date of Application: May 21, 2019	Aldermanic District: 6
	Licensee (Name of individual; partners, or agent, if Corp/LLC): agent - Lucile Jules	
	Corporation or LLC Name (if applicable): Curry Goat Corp.	Business Name: Jewels Caribbean Restaurant
	Business Address (include city,state,zip): 2230 N. Dr. Martin Luther King JR Dr, Milwaukee, WI 53212	
	(Optional) Mailing Address (include city,state,zip): P.O.Box 1206, Milwaukee, W 53201-1206	Business Telephone Number: 414-585-0678
Section B	This request is for the permanent extension of premises for a: <input checked="" type="checkbox"/> FOOD license <input checked="" type="checkbox"/> ALCOHOL license	
	The Current Premises Description is : <u>Interior of 2230 N. Dr. Martin Luther King Jr Dr</u>	
	Identify the specific area(s) for which the permanent extension of premises is requested. Check all that apply and list for each the relationship of the area to the premises (example: north side, front, etc.)	
	<input checked="" type="checkbox"/> Sidewalk café (public sidewalk) at the <u>western</u> side of the premises in front of the following street address(es) <u>2230 N. Dr. MLK</u> (area must be contiguous with licensed area and under the licensee's control) (An application for a Siding Dining Facility Permit must also be submitted with this application.) <input checked="" type="checkbox"/> Patio (concrete surface) at the <u>eastern</u> side of the premises <input type="checkbox"/> Beer garden (soil/grass surface) at the _____ side of the premises <input type="checkbox"/> Deck (attached to building) at the _____ side of the premises <input type="checkbox"/> Addition to the: <input type="checkbox"/> 1 st floor <input type="checkbox"/> 2 nd floor <input type="checkbox"/> 3 rd floor <input type="checkbox"/> Basement <input type="checkbox"/> Other: _____ at the _____ side of the premises <input type="checkbox"/> Other: Describe area(s): _____	
Does extension area have an additional street address? <input checked="" type="checkbox"/> No <input type="checkbox"/> Yes If yes, list address: _____		
List all type(s) of business(es) that will operate at this location? <input checked="" type="checkbox"/> Tavern <input checked="" type="checkbox"/> Restaurant <input type="checkbox"/> Other: Describe: _____		
Section C	 Signature of Sole Proprietor; a Partner; or if a Corporation or LLC, the Agent must sign	

Office Use Only:

Filed 6/17/19 Initials yo App #s: Food 295525 Alcohol 295524

Queue to:

- | | | |
|--|-----------------------------------|-------------------------------------|
| <input type="checkbox"/> DNS (all) | <input type="checkbox"/> Approved | <input type="checkbox"/> Hold _____ |
| <input type="checkbox"/> HD (all food) | <input type="checkbox"/> Approved | <input type="checkbox"/> Hold _____ |
| <input type="checkbox"/> CC Food Only (no alcohol) | <input type="checkbox"/> Approved | <input type="checkbox"/> Denied |

Email to:

- | | | | |
|--|-----------------------------------|-------------------------------------|---|
| <input type="checkbox"/> DPW (sidewalk cafes/parklets) | <input type="checkbox"/> Approved | <input type="checkbox"/> Hold _____ | <input type="checkbox"/> Sidewalk Dining Facility Permit Issued |
| New Licenses Issued: Food _____ | Initials _____ | Alcohol _____ | Initials _____ |



Sidewalk Dining Facility Supplemental Application

ccl-side1 2/21/18

Office of the City Clerk License Division
200 E. Wells St. Room 105, Milwaukee, WI 53202
(414) 286-2238 www.milwaukee.gov/license e-mail address: license@milwaukee.gov

Business Name: <u>Jewels Caribbean Restaurant</u>	Aldermanic District # <u>6</u>
Premises Address: <u>2230 N. Dr. Martin Luther King Jr Dr</u>	
Business Operations	
Check one: <input type="checkbox"/> I/we are also applying for Food/Alcohol license(s) at this time. <input checked="" type="checkbox"/> I/we currently hold Food/Alcohol license(s) AND <input checked="" type="checkbox"/> confirm that the Business Plan of Operation on file which was previously submitted with the Food and/or Alcohol application has not changed, except for the addition of this sidewalk dining facility. <input type="checkbox"/> have included a new Business Plan of Operation reflecting requested changes.	
Sidewalk Dining Facility will operate from: Start Date: <u>June 1, 2019</u> to End Date: <u>November 3, 2019</u> Will any food preparation be done outdoors? <input type="checkbox"/> No <input checked="" type="checkbox"/> Yes If yes, describe: <u>grill</u> Will any sidewalk dining facility improvements be physically attached to public structures? <input checked="" type="checkbox"/> No <input type="checkbox"/> Yes If yes, describe: _____	
Property Owner	
Check one: <input checked="" type="checkbox"/> Applicant owns the property <input type="checkbox"/> Property owner's information/signature provided below (REQUIRED): Name: _____ Phone # _____ Address: _____ Property Owner's Signature: _____	
Signature(s)	
<u></u> Signature of Sole Proprietor, Partner, or 20% or more Shareholder (If there are no 20% or more shareholders, Corporate Officer-print name/title and sign)	_____ Signature of additional partner or 20% or more shareholder

Office Use Only:

Initials _____ Filed _____ App # _____

Processing LS: Queue to: HD DNS CC Email To: DPW Primary LS

Also: holds is applying for: Food Alcohol Perm Ext

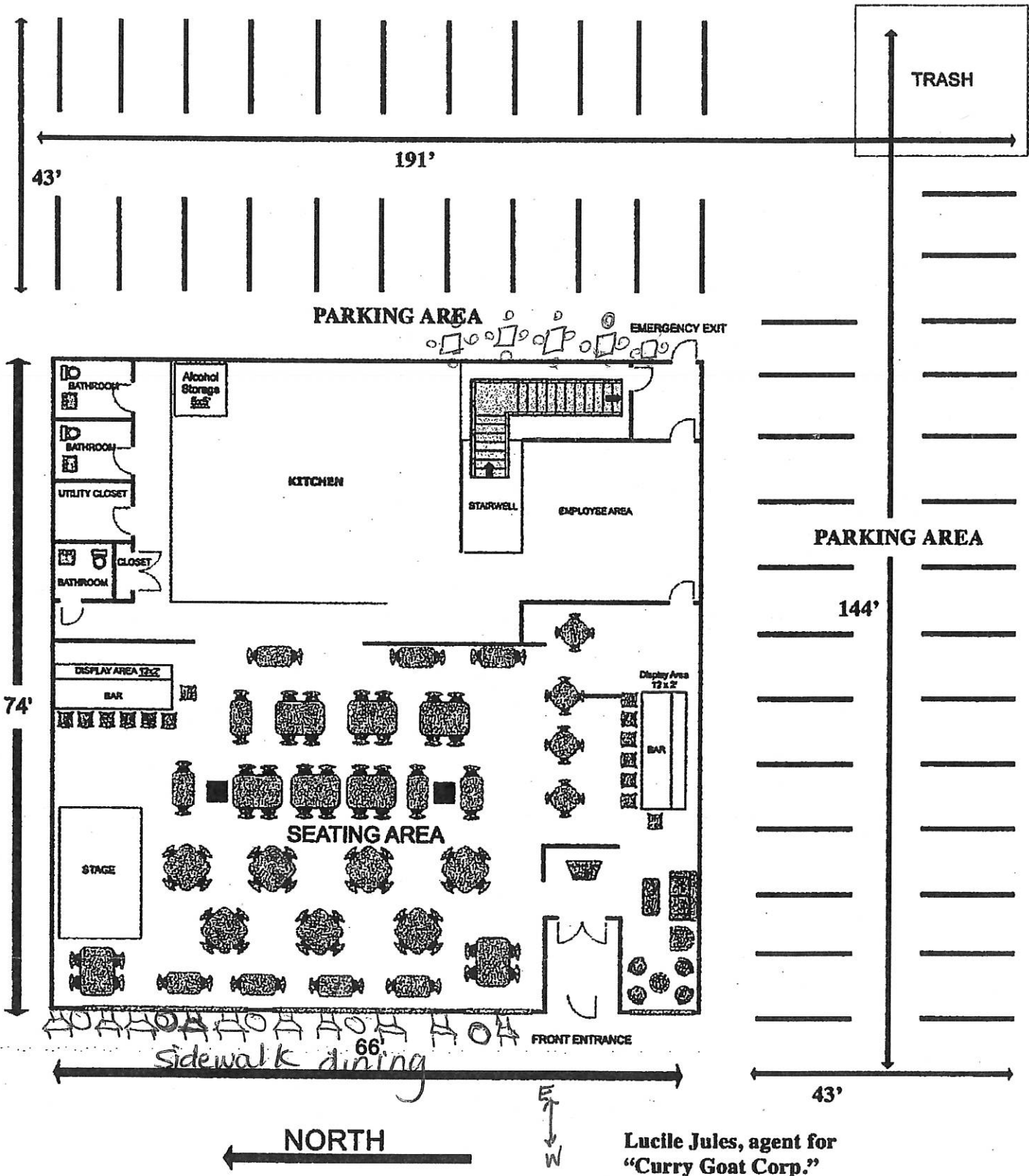

Martin Luther King Jr. Drive

Total Square Footage= 4,938 s.f.

Lucile Jules, agent for
 "Curry Goat Corp."
 "Jewels Caribbean Restaurant"
 2230 N. Martin Luther King Jr. Drive
 DATE: August 29, 2017
FIRST FLOOR

Jewels Caribbean Restaurant

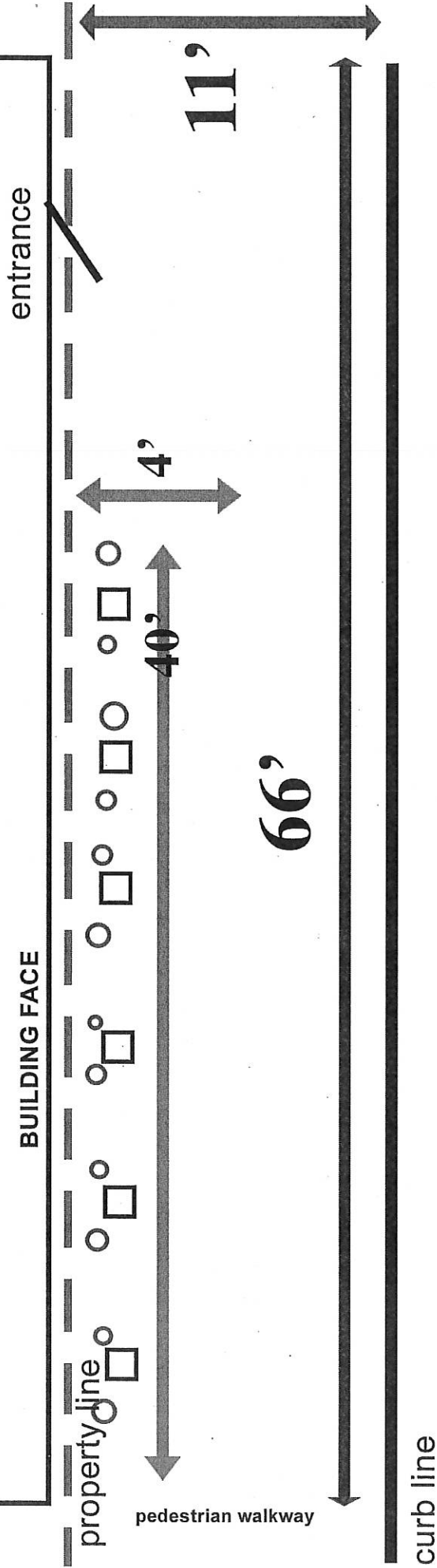

Lucile Jules, agent for
"Curry Goat Corp."
"Jewels Caribbean Restaurant"
2230 N. Martin Luther King Jr. Drive
DATE: May 21, 2019
FIRST FLOOR

Martin Luther King Jr. Drive

NORTH





CITY OF MILWAUKEE
OFFICE OF THE CITY CLERK

Tuesday, June 18, 2019

COMMITTEE MEETING NOTICE

AD 06

NAGRA, Gurinder S, Agent
Pueblo Foods & Liquor, Inc
2029-31 N HOLTON St

Milwaukee, WI 53212

You are requested to attend a hearing which is to be held in Room 301-B, Third Floor, City Hall on:

Tuesday, June 25, 2019 at 02:30 PM

Regarding: Your Class A Malt & Class A Liquor, Food Dealer, and Weigh  & Measures License Renewal Applications as agent for "Pueblo Foods & Liquor, Inc" for "Pueblo Foods & Liquor" at 2029-31 N HOLTON St.

There is a possibility that your application may be denied for one or more of the following reasons: The recommendation of the committee regarding the application shall be based on evidence presented at the hearing. Per MCO 85-4-4, unless otherwise specified in the code, probative evidence concerning non-renewal, suspension or revocation may include evidence of the following: failure of the applicant to meet municipal qualifications, pending charges against or the conviction of any felony, misdemeanor, municipal offense or other offense, the circumstances of which substantially relate to the circumstances of the particular licensed or permitted activity, by the applicant or by any employee or other agent of the applicant. If the activities of the applicant involve a licensed premises, whether the premises tends to facilitate a public or private nuisance or has been the source of congregations of persons which have resulted in any of the following: disturbance of the peace; illegal drug activity; public drunkenness; drinking in public; harassment of passers-by; gambling; prostitution; sale of stolen goods; public urination; theft; assaults; battery; acts of vandalism including graffiti, excessive littering, loitering, illegal parking, loud noise at times when the licensed premise is open for business; traffic violations; curfew violations; lewd conduct; display of materials harmful to minors, pursuant to s. 106-9.6; or any other factor which reasonably relates to the public health, safety and welfare, or failure to comply with the approved plan of operation. See attached police report or correspondence.

Notice for applicants with warrants or unpaid fines:

Proof of warrant satisfaction or payment of fines must be submitted at the hearing on the above date and time. Failure to comply with this requirement may result in a delay of the granting/denial of your application.

Failure to appear at this meeting may result in the denial of your license. Individual applicants must appear only in person or by an attorney. Corporate or Limited Liability applicants must appear only by the agent designated on the application or by an attorney. Partnership applicants must appear by a partner listed on the application or by an attorney. If you wish to do so and at your own expense, you may be accompanied by an attorney of your choosing to represent you at this hearing.

You will be given an opportunity to speak on behalf of the application and to respond and challenge any charges or reasons given for the denial. No petitions can be accepted by the committee, unless the people who signed the petition are present at the committee hearing and willing to testify. You may present witnesses under oath and you may also confront and cross-examine opposing witnesses under oath. If you have difficulty with the English language, you should bring an interpreter with you, at your expense, so that you can answer questions and participate in your hearing.

You may examine the application file at this office during regular business hours prior to the hearing date. Inquiries regarding this matter may be directed to the person whose signature appears below.

Limited parking for persons attending meetings in City Hall is available at reduced rates (5 hour limit) at the Milwaukee Center on the southwest corner of East Kilbourn and North Water Street. Parking tickets must be validated in the first floor information booth in City Hall.

PLEASE NOTE: Upon reasonable notice, efforts will be made to accommodate the needs of disabled individuals through sign language interpreters or other auxiliary aids. For additional information or to request this service, contact the Council Services Division ADA Coordinator at (414) 286-2998, Fax - (414) 286-3456, TDD - (414) 286-2025.

JIM OWCZARSKI, CITY CLERK

BY:

Jessica Celella

License Division Manager

If you have questions regarding this notice, please contact the License Division at (414) 286-2238.

200 E. Wells Street, Room 105, City Hall, Milwaukee, WI 53202. www.milwaukee.gov/license
Phone: (414) 286-2238 Fax: (414) 286-3057 Email Address: License@milwaukee.gov

MILWAUKEE POLICE DEPARTMENT LICENSING

CRIMINAL RECORD/ORDINANCE VIOLATION/INCIDENTS SYNOPSIS

DATE: 04/30/2019
LICENSE TYPE: BTAVN
NEW:
RENEWAL:

No. 292775
Application Date: 04/28/2019

License Location: 2029-31 N Holton Street
Business Name: Pueblo Foods & Liquor, Inc

Licensee/Applicant: Nagra, Gurinder S
(Last Name, First Name, MI)

Date of Birth: 07/30/70

Home Address: 3776 Cypress Lane
City: Milwaukee State: WI Zip Code: 53132
Home Phone: (414)

This report is written by Police Officer David NOVAK, assigned to the License Investigation Unit, Days.

The Milwaukee Police Department's investigation regarding this application revealed the following:

1. On 03/20/13, Milwaukee police conducted a License Premise Check at 2029-31 N Holton regarding a received complaint of the sale of bootleg liquor inside the establishment. Police spoke with the manager Kumar Karan who was able to provide police with invoices for all alcohol purchases and showed police around the business. No violations were observed.

=====

2. On 02/25/2014 the applicant was cited at 2667 North 5th Street in the city of Milwaukee for Responsible Person on Premises Required.

Charge:	Responsible Person on Premises Required
Finding:	Guilty
Sentence:	\$368.00 fine
Date:	04/17/2014
Case:	14018997

3. On 05/15/2014 the applicant was cited at 2029 North Holton Street in the city of Milwaukee for Building Code Violations.

Charge: Building Code Violations
Finding: Guilty
Sentence: \$280.00 fine
Date: 01/15/2015
Case: 14062301

4. On 07/19/2014 a 17 year old, working in conjunction with Milwaukee police, was able to purchase a 2 pack of Swisher Sweet brand cigars from the cashier, Margarita Molinar, at Pueblo Foods (2029 North Holton Street). The applicant was cited.

Charge: Sale of Cigarettes to Minor/Underage
Finding: Dismissed without Prejudice
Sentence:
Date: 12/29/2014
Case: 14054171

=====

5. On 01/26/2016 the applicant was cited in the City of Milwaukee at 4839 N. Green Bay Av for Building Code Violations.

Charge: Building Code Violations
Finding: Guilty
Sentence: Fined \$980.00
Date: 01/05/2017
Case: 16033149

6. On 06/16/2016 the applicant was cited in the City of Milwaukee at 4110 W. Martin Dr for Building Code Violations.

Charge: Building Code Violations
Finding: Guilty
Sentence: Fined \$280.00
Date: 01/17/2017
Case: 16051366

=====

7. On 08/02/2017 the applicant was cited in the City of Milwaukee at 4839 N. Green bay Av for

Charge: Building Code Violations
Finding: Guilty
Sentence: Fined \$330.00
Date: 01/25/2018
Case: 17074331

8. On 08/22/2017 the applicant was cited in the City of Milwaukee at 2667 N. 5th St for

Charge: Responsible Person on Premises Required
Finding: Guilty
Sentence: Fined \$190.00
Date: 02/22/2018
Case: 17042400

9. On 08/26/2017 the applicant was cited in the City of Milwaukee at 2677 N. 5th St for

Charge: Sale of Cigarettes to Minor/Underage
Finding: Guilty
Sentence: Fined \$280.00
Date: 06/27/2018
Case: 17051220

10. On 08/26/2017 the applicant was cited in the City of Milwaukee at 6811 N. Teutonia Av for

Charge: Sale of Cigarettes to Minor/Underage
Finding: Dismissed
Sentence:
Date: 06/27/2018
Case: 17051221

=====

Items #9 & 10 updated with disposition on 04/30/2019

11. On 06/21/2018 Simranjeet BENIPAL (50%hshareholder) was cited in the City of Milwaukee at 2483 W. Capitol Dr. for Responsible Person on Premise Required.

Charge: Responsible Person on Premise Required
Finding: Guilty
Sentence: Fined \$378.00
Date: 08/06/2018
Case: 18058687

12. On 09/08/2018 a 17 year old working in conjunction with the Milwaukee Police Department and WI WINS Tobacco initiative, was able to purchase a 2 pack of Swisher Sweet cigars from the clerk at Pueblo Foods, 2029 N. Holton St. The clerk was identified as Margarita MOLINAR, who stated she checked the ID but did the math wrong. The applicant was mailed a MARTS enrollment package.

13. On 12/03/2018 the applicant was cited in the City of Milwaukee at 3876 N. Port Washington St for Responsible Person on Premise Required.

Charge: Responsible Person on Premise Required
Finding: Guilty
Sentence: Fined \$189.00
Date: 04/11/2019
Case: 18085794

Milwaukee Police Department

749 W. State Street Milwaukee, WI 53233

414-933-4444



Case #: 182510055

OtherEvent #: 18-LP-0328

Incident

2029 N HOLTON ST Milwaukee, WISCONSIN 53212

Incident Date/Time:: 09/08/2018 08:50:00
CAD Number:: 182510738
District:: 5
Beat:: 540
Reporting Area:: 3754

Business Agent (1)

NAGRA, GURINDER S

Person Involvement: (Must choose Agent
AGENT from drop down):
DOB:: 07/30/1970
Sex:: MALE
Race:: WHITE
Phone 1 Number:: (414)-423-6485
Address:: 6980 S 35TH ST
City:: FRANKLIN
State:: WISCONSIN
Zip Code:: 53132

Licensed Persons Involved (1)

MOLINAR, MARGARITA NMI

Person Involvement:: Merchant
DOB:: 10/19/1977
Sex:: FEMALE
Race:: WHITE
Address:: 2637 N RICHARDS ST
City:: MILWAUKEE
State:: WISCONSIN
Zip Code:: 53212

License Premise Data (1)

Milwaukee Police Department

749 W. State Street Milwaukee, WI 53233

414-933-4444



Case #: 182510055

OtherEvent #: 18-LP-0328

Pueblo Foods & Liquor

Phone 1 Number:: (414)-372-7172
Address:: 2029 N HOLTON ST
City:: Milwaukee
State:: WISCONSIN
Zip Code:: 53212
License Type:: Alcohol
Licensee Notification Was Made:: Yes
Licensee Notified Date/Time:: 09/08/2018 09:00:00
Business Was Cited For Violation:: No
Licensee was cooperative: (If not explain in narrative): Yes
Licensee or Manager was on premises at time of violation/incident:: No

Narrative (1)

INITIAL INVESTIGATION

Brown, Penny A 014805

09/08/2018

This report is written by PO Penny BROWN assigned to the License Investigation Unit.

On Saturday, September 8, 2018, I was assigned to work the Wisconsin WINS Youth Tobacco Initiative, which checks area vendors for age compliant tobacco sales. Assisting in this assignment was: Tierra R. POLE B/F 11/8/00 of 5663 N. 96th St. Milwaukee, WI 53225. POLE is 17yoa and not of legal age to purchase tobacco.

At approximately 8:50A, POLE entered Pueblo Food & Liquor at 20029 N. Holton St., and purchased a 2 pack of regular Swisher Sweet Cigars from the cashier. POLE described the cashier as: H/F 30's wearing a black shirt. Upon entrance to the store, I immediately identified the cashier based on the description given. The cashier was identified as Margarita Molinar H/F 10/19/77. Molinar admitted to the sale and apologized, stating she did check ID, however, did not do the math. I advised Molinar I would be mailing out a Marts Enrollment packet to the registered agent.

Officer (2)

Milwaukee Police Department

749 W. State Street Milwaukee, WI 53233

414-933-4444



Case #: 182510055

OtherEvent #: 18-LP-0328

Reporting Officer:	Brown, Penny A (014805)	09/08/2018 12:40:00
Section: (Work Location):	27	
Approving Officer:	Raden, Chad M (010032)	09/10/2018 11:35:09
Section: (Work Location):	27	



Tuesday, June 18, 2019



Notice of Public Hearing

NAGRA, Gurinder S, Agent
Pueblo Foods & Liquor at 2029-31 N HOLTON St
Class A Malt & Class A Liquor, Food Dealer, and Weights & Measures License Renewal
Applications

Tuesday, June 25, 2019 at 2:30 PM

To whom it may concern:

The above application has been made by the above named applicant(s). This requires approval from the Licenses Committee and the Common Council of the City of Milwaukee. The hearing before the Licenses Committee will take place on 6/25/2019 at 2:30 PM, in Room 301-B, Third Floor, City Hall. If you wish, you may provide testimony at the hearing regarding the request; see below for further information. You are not required to attend the hearing. Once the Licenses Committee makes its recommendation, this recommendation is forwarded to the full Common Council for approval at its next regularly scheduled hearing. Please review the information below and if you have further questions regarding this process, please contact the License Division at (414) 286-2238.

Important details for those wishing to provide information for the Licenses Committee to consider when making its recommendation:

1. The license application is scheduled to be heard at the above time. Due to other hearings running longer than scheduled, you may have to wait some time to provide your testimony.
2. You must appear in person and testify as to matters that you have personally experienced or seen. (You cannot provide testimony for your neighbor, parent or anyone else; this is considered hearsay and cannot be considered by the committee.)
3. No letters or petitions can be accepted by the committee (unless the person who wrote the letter or the persons who signed the petition are present at the committee hearing and willing to testify).
4. Persons opposed to the license application are given the opportunity to testify first; supporters may testify after the opponents have finished.
5. When you are called to testify, you will be sworn in and asked to give your name, and address. (If your first and/or last names are uncommon please spell them.)
6. You may then provide testimony.
 - a. Include only information relating to the above license application.
 - b. Include only information you have personally witnessed or seen.
 - c. Provide concise and relevant information detailing how this business has affected or may affect the peaceful enjoyment of your neighborhood.
 - d. If by the time you have the opportunity to testify, the information you wish to share has already been provided to the committee, you may state that you agree with the previous testimony. Redundant or repetitive testimony will not assist the committee in making its recommendation.
7. After giving your testimony, the members of the Licenses Committee and the licensee may ask questions regarding the testimony you have given or other factors relating to the license application.
8. Business Competition is not a valid basis for denial or non-renewal of a license.
Please Note: If you have submitted an objection to the above application your objection cannot be considered by the committee unless you personally testify at the hearing.

OCCUPANT	MAIL ADDRESS	CITY, STATE ZIP
CURRENT OCCUPANT	2051A N BOOTH ST	MILWAUKEE, WI 53212
CURRENT OCCUPANT	2039A N BOOTH ST	MILWAUKEE, WI 53212
CURRENT OCCUPANT	2013 N BOOTH ST	MILWAUKEE, WI 53212
CURRENT OCCUPANT	456 E BROWN ST 206	MILWAUKEE, WI 53212
CURRENT OCCUPANT	456 E BROWN ST 208	MILWAUKEE, WI 53212
CURRENT OCCUPANT	456 E BROWN ST 305	MILWAUKEE, WI 53212
CURRENT OCCUPANT	456 E BROWN ST 315	MILWAUKEE, WI 53212
CURRENT OCCUPANT	456 E BROWN ST 402	MILWAUKEE, WI 53212
CURRENT OCCUPANT	2026 N HOLTON ST	MILWAUKEE, WI 53212
CURRENT OCCUPANT	2010 N HOLTON ST	MILWAUKEE, WI 53212
CURRENT OCCUPANT	2012 N BUFFUM ST	MILWAUKEE, WI 53212
CURRENT OCCUPANT	2006 N BUFFUM ST	MILWAUKEE, WI 53212
CURRENT OCCUPANT	2047 N BOOTH ST	MILWAUKEE, WI 53212
CURRENT OCCUPANT	456 E BROWN ST 207	MILWAUKEE, WI 53212
CURRENT OCCUPANT	456 E BROWN ST 212	MILWAUKEE, WI 53212
CURRENT OCCUPANT	456 E BROWN ST 214	MILWAUKEE, WI 53212
CURRENT OCCUPANT	456 E BROWN ST 313	MILWAUKEE, WI 53212
CURRENT OCCUPANT	456 E BROWN ST 404	MILWAUKEE, WI 53212
CURRENT OCCUPANT	456 E BROWN ST 407	MILWAUKEE, WI 53212
CURRENT OCCUPANT	456 E BROWN ST 410	MILWAUKEE, WI 53212
CURRENT OCCUPANT	456 E BROWN ST 104	MILWAUKEE, WI 53212
CURRENT OCCUPANT	2035 N HOLTON ST 5	MILWAUKEE, WI 53212
CURRENT OCCUPANT	2042 N HOLTON ST	MILWAUKEE, WI 53212
CURRENT OCCUPANT	2000 N HOLTON ST	MILWAUKEE, WI 53212
CURRENT OCCUPANT	2000 N HOLTON ST A	MILWAUKEE, WI 53212
CURRENT OCCUPANT	401 E LLOYD ST	MILWAUKEE, WI 53212
CURRENT OCCUPANT	2034 N BUFFUM ST	MILWAUKEE, WI 53212
CURRENT OCCUPANT	521 E LLOYD ST	MILWAUKEE, WI 53212
CURRENT OCCUPANT	2041 N BOOTH ST	MILWAUKEE, WI 53212
CURRENT OCCUPANT	2039 N BOOTH ST	MILWAUKEE, WI 53212
CURRENT OCCUPANT	2030A N BUFFUM ST	MILWAUKEE, WI 53212
CURRENT OCCUPANT	418 E LLOYD ST	MILWAUKEE, WI 53212
CURRENT OCCUPANT	421 E LLOYD ST	MILWAUKEE, WI 53212
CURRENT OCCUPANT	456 E BROWN ST 216	MILWAUKEE, WI 53212
CURRENT OCCUPANT	456 E BROWN ST 303	MILWAUKEE, WI 53212
CURRENT OCCUPANT	456 E BROWN ST 101	MILWAUKEE, WI 53212
CURRENT OCCUPANT	456 E BROWN ST 310	MILWAUKEE, WI 53212
CURRENT OCCUPANT	456 E BROWN ST 312	MILWAUKEE, WI 53212
CURRENT OCCUPANT	456 E BROWN ST 406	MILWAUKEE, WI 53212
CURRENT OCCUPANT	433 E LLOYD ST	MILWAUKEE, WI 53212
CURRENT OCCUPANT	2043 N HOLTON ST 1	MILWAUKEE, WI 53212
CURRENT OCCUPANT	2035 N HOLTON ST 1	MILWAUKEE, WI 53212
CURRENT OCCUPANT	2029 N HOLTON ST	MILWAUKEE, WI 53212
CURRENT OCCUPANT	2040 N HOLTON ST	MILWAUKEE, WI 53212
CURRENT OCCUPANT	2020 N HOLTON ST	MILWAUKEE, WI 53212
CURRENT OCCUPANT	2010A N HOLTON ST	MILWAUKEE, WI 53212

CURRENT OCCUPANT	2008A N HOLTON ST	MILWAUKEE, WI 53212
CURRENT OCCUPANT	2044B N BUFFUM ST	MILWAUKEE, WI 53212
CURRENT OCCUPANT	2039B N BOOTH ST	MILWAUKEE, WI 53212
CURRENT OCCUPANT	412 E LLOYD ST	MILWAUKEE, WI 53212
CURRENT OCCUPANT	456 E BROWN ST 308	MILWAUKEE, WI 53212
CURRENT OCCUPANT	456 E BROWN ST 309	MILWAUKEE, WI 53212
CURRENT OCCUPANT	456 E BROWN ST 405	MILWAUKEE, WI 53212
CURRENT OCCUPANT	456 E BROWN ST 408	MILWAUKEE, WI 53212
CURRENT OCCUPANT	456 E BROWN ST 411	MILWAUKEE, WI 53212
CURRENT OCCUPANT	456 E BROWN ST 413	MILWAUKEE, WI 53212
CURRENT OCCUPANT	456 E BROWN ST 202	MILWAUKEE, WI 53212
CURRENT OCCUPANT	2111 N HOLTON ST	MILWAUKEE, WI 53212
CURRENT OCCUPANT	434 E LLOYD ST	MILWAUKEE, WI 53212
CURRENT OCCUPANT	433 E LLOYD ST A	MILWAUKEE, WI 53212
CURRENT OCCUPANT	2043 N HOLTON ST 2	MILWAUKEE, WI 53212
CURRENT OCCUPANT	439 E LLOYD ST	MILWAUKEE, WI 53212
CURRENT OCCUPANT	2050 N HOLTON ST	MILWAUKEE, WI 53212
CURRENT OCCUPANT	2030 N HOLTON ST	MILWAUKEE, WI 53212
CURRENT OCCUPANT	2024 N HOLTON ST	MILWAUKEE, WI 53212
CURRENT OCCUPANT	2016 N HOLTON ST	MILWAUKEE, WI 53212
CURRENT OCCUPANT	1956A N HOLTON ST	MILWAUKEE, WI 53212
CURRENT OCCUPANT	1962A N HOLTON ST	MILWAUKEE, WI 53212
CURRENT OCCUPANT	408 E BROWN ST	MILWAUKEE, WI 53212
CURRENT OCCUPANT	2043 N BOOTH ST	MILWAUKEE, WI 53212
CURRENT OCCUPANT	2025 N BOOTH ST	MILWAUKEE, WI 53212
CURRENT OCCUPANT	421A E LLOYD ST	MILWAUKEE, WI 53212
CURRENT OCCUPANT	456 E BROWN ST 213	MILWAUKEE, WI 53212
CURRENT OCCUPANT	456 E BROWN ST 301	MILWAUKEE, WI 53212
CURRENT OCCUPANT	456 E BROWN ST 412	MILWAUKEE, WI 53212
CURRENT OCCUPANT	456 E BROWN ST 414	MILWAUKEE, WI 53212
CURRENT OCCUPANT	456 E BROWN ST 105	MILWAUKEE, WI 53212
CURRENT OCCUPANT	456 E BROWN ST 103	MILWAUKEE, WI 53212
CURRENT OCCUPANT	456 E BROWN ST 102	MILWAUKEE, WI 53212
CURRENT OCCUPANT	456 E BROWN ST 203	MILWAUKEE, WI 53212
CURRENT OCCUPANT	403 E LLOYD ST	MILWAUKEE, WI 53212
CURRENT OCCUPANT	2044 N BUFFUM ST	MILWAUKEE, WI 53212
CURRENT OCCUPANT	2010 N BUFFUM ST	MILWAUKEE, WI 53212
CURRENT OCCUPANT	405 E LLOYD ST	MILWAUKEE, WI 53212
CURRENT OCCUPANT	1956 N HOLTON ST	MILWAUKEE, WI 53212
CURRENT OCCUPANT	2031 N BOOTH ST	MILWAUKEE, WI 53212
CURRENT OCCUPANT	456 E BROWN ST 205	MILWAUKEE, WI 53212
CURRENT OCCUPANT	456 E BROWN ST 209	MILWAUKEE, WI 53212
CURRENT OCCUPANT	456 E BROWN ST 211	MILWAUKEE, WI 53212
CURRENT OCCUPANT	456 E BROWN ST 215	MILWAUKEE, WI 53212
CURRENT OCCUPANT	456 E BROWN ST 302	MILWAUKEE, WI 53212
CURRENT OCCUPANT	456 E BROWN ST 311	MILWAUKEE, WI 53212
CURRENT OCCUPANT	456 E BROWN ST 314	MILWAUKEE, WI 53212

CURRENT OCCUPANT	456 E BROWN ST 316	MILWAUKEE, WI 53212
CURRENT OCCUPANT	456 E BROWN ST 403	MILWAUKEE, WI 53212
CURRENT OCCUPANT	456 E BROWN ST 201	MILWAUKEE, WI 53212
CURRENT OCCUPANT	456 E BROWN ST 204	MILWAUKEE, WI 53212
CURRENT OCCUPANT	430 E LLOYD ST	MILWAUKEE, WI 53212
CURRENT OCCUPANT	428 E LLOYD ST	MILWAUKEE, WI 53212
CURRENT OCCUPANT	2043 N HOLTON ST 3	MILWAUKEE, WI 53212
CURRENT OCCUPANT	2035 N HOLTON ST 3	MILWAUKEE, WI 53212
CURRENT OCCUPANT	2035 N HOLTON ST 2	MILWAUKEE, WI 53212
CURRENT OCCUPANT	2035 N HOLTON ST 4	MILWAUKEE, WI 53212
CURRENT OCCUPANT	511 E LLOYD ST	MILWAUKEE, WI 53212
CURRENT OCCUPANT	2040A N HOLTON ST	MILWAUKEE, WI 53212
CURRENT OCCUPANT	2034A N BUFFUM ST	MILWAUKEE, WI 53212
CURRENT OCCUPANT	2014 N BUFFUM ST	MILWAUKEE, WI 53212
CURRENT OCCUPANT	519 E LLOYD ST	MILWAUKEE, WI 53212
CURRENT OCCUPANT	2047A N BOOTH ST	MILWAUKEE, WI 53212
CURRENT OCCUPANT	2019 N BOOTH ST	MILWAUKEE, WI 53212
CURRENT OCCUPANT	456 E BROWN ST 306	MILWAUKEE, WI 53212
CURRENT OCCUPANT	2043 N HOLTON ST 4	MILWAUKEE, WI 53212
CURRENT OCCUPANT	441 E LLOYD ST	MILWAUKEE, WI 53212
CURRENT OCCUPANT	2028A N HOLTON ST	MILWAUKEE, WI 53212
CURRENT OCCUPANT	2044A N BUFFUM ST	MILWAUKEE, WI 53212
CURRENT OCCUPANT	2030 N BUFFUM ST	MILWAUKEE, WI 53212
CURRENT OCCUPANT	2024 N BUFFUM ST	MILWAUKEE, WI 53212
CURRENT OCCUPANT	2024 N BUFFUM ST A	MILWAUKEE, WI 53212
CURRENT OCCUPANT	1962 N HOLTON ST	MILWAUKEE, WI 53212
CURRENT OCCUPANT	2051 N BOOTH ST	MILWAUKEE, WI 53212
CURRENT OCCUPANT	411 E LLOYD ST	MILWAUKEE, WI 53212
CURRENT OCCUPANT	424 E LLOYD ST	MILWAUKEE, WI 53212
CURRENT OCCUPANT	420 E LLOYD ST	MILWAUKEE, WI 53212
CURRENT OCCUPANT	456 E BROWN ST 210	MILWAUKEE, WI 53212
CURRENT OCCUPANT	456 E BROWN ST 304	MILWAUKEE, WI 53212
CURRENT OCCUPANT	456 E BROWN ST 401	MILWAUKEE, WI 53212
CURRENT OCCUPANT	456 E BROWN ST 409	MILWAUKEE, WI 53212
CURRENT OCCUPANT	456 E BROWN ST 415	MILWAUKEE, WI 53212
CURRENT OCCUPANT	456 E BROWN ST 416	MILWAUKEE, WI 53212
CURRENT OCCUPANT	456 E BROWN ST 307	MILWAUKEE, WI 53212
CURRENT OCCUPANT	434A E LLOYD ST	MILWAUKEE, WI 53212
CURRENT OCCUPANT	2047 N HOLTON ST	MILWAUKEE, WI 53212
CURRENT OCCUPANT	2028 N HOLTON ST	MILWAUKEE, WI 53212
CURRENT OCCUPANT	2006 N HOLTON ST	MILWAUKEE, WI 53212
CURRENT OCCUPANT	2004 N BUFFUM ST	MILWAUKEE, WI 53212

Total Records: 135

Radius: 250.0 feet and Center of Circle: 2029-31 N Holton St

2018-2019 Plan of Operation for 2029-31 N HOLTON ST

1. Litter & Security Plans			
How are the grounds kept clean? <input checked="" type="checkbox"/> Sweep <input type="checkbox"/> Pressure Wash <input checked="" type="checkbox"/> Pick Up Litter <input type="checkbox"/> Other:			
How often will grounds be cleaned? <input checked="" type="checkbox"/> Daily <input type="checkbox"/> Weekly <input type="checkbox"/> Other:			
Who cleans the grounds? <input checked="" type="checkbox"/> Licensee <input type="checkbox"/> Building Owner <input checked="" type="checkbox"/> Employees <input type="checkbox"/> Hired Maintenance <input type="checkbox"/> Other:			
How are noise issues prevented and/or addressed? <input type="checkbox"/> Security <input checked="" type="checkbox"/> Manager approaches customer(s) <input type="checkbox"/> Call Police <input checked="" type="checkbox"/> Signs Posted <input type="checkbox"/> Other:			
Are there designated outdoor smoking areas? <input checked="" type="checkbox"/> No <input type="checkbox"/> Yes If Yes, Describe:			
Number of garbage cans: Inside <u>6</u> Locations: <u>BY CASH REG. MEAT DEPT. DELI AREA RESTROOM</u> Outside <u>1</u> Locations: <u>BY FRONT DOOR OUTSIDE</u>			
Is a crowd control barrier used? <input checked="" type="checkbox"/> No <input type="checkbox"/> Yes If Yes, Describe:			
Number of restrooms: <u>2</u>		Name of solid waste contractor: <u>WASTE MANAGEMENT</u>	
Are there parking spaces on the premises? <input checked="" type="checkbox"/> No <input type="checkbox"/> Yes If Yes, list number of spaces: _____ and describe security plans:			
Are there designated loading areas? <input checked="" type="checkbox"/> No <input type="checkbox"/> Yes If Yes, describe security plans:			
Do you have security personnel on the premise? <input type="checkbox"/> No <input type="checkbox"/> Yes If Yes, how many? _____ AND What are their responsibilities? _____ What security equipment do they use? _____ List their licensing, certification or training credentials: _____			
Are there security cameras? <input type="checkbox"/> No <input checked="" type="checkbox"/> Yes If Yes, list all locations: <u>MONITORS INSIDE & STORE SURROUNDINGS</u>			
Are searches and/or identification checks conducted upon entry? <input checked="" type="checkbox"/> No <input type="checkbox"/> Yes If Yes, describe:			
2. Percentage of Sales (must total 100%)			
Alcohol <u>20</u> %	Food Sales <u>80</u> %	Entertainment <u>0</u> %	Other <u>0</u> %
3. Businesses On The Premises (choose all that apply):			
<input type="checkbox"/> Restaurant <input type="checkbox"/> Cafe/Coffee Shop <input type="checkbox"/> Cocktail Lounge <input type="checkbox"/> Convenience Store <input type="checkbox"/> Night Club <input type="checkbox"/> Liquor Store <input type="checkbox"/> Tavern <input type="checkbox"/> Sports Facility <input type="checkbox"/> Hotel <input type="checkbox"/> Banquet Hall <input checked="" type="checkbox"/> Supermarket <input type="checkbox"/> Private/Fraternal/Veterans' Club <input type="checkbox"/> Other:			
4. Hours of Operation and Age Restriction			
Are there any changes to the current hours of operation or age restriction? <input checked="" type="checkbox"/> No <input type="checkbox"/> Yes If Yes, Describe:			
Please Note: If you will be open earlier or later than the hours listed on your current license for even one event or holiday (for example, St. Patrick's Day, Brewers Opening Day, etc.) during the license period, this must be reported and printed on your license. Your hours of operation and age restriction are listed on your current license.			
5. Floor Plan and Capacity			
Are you requesting any changes to your capacity or floor plan*? <input checked="" type="checkbox"/> No <input type="checkbox"/> Yes If yes, describe: _____ and submit a new floor plan with this renewal application. A sample plan can be found online at www.milwaukee.gov/licenses under License Forms and Related Information.			
Alcohol/Food Establishments: A "Permanent Extension of Premises Application" is required if you are adding any square footage to the licensed premises.			
6. Sidewalk Dining: Fee:			
Are there any changes to the sidewalk dining site plan? <input checked="" type="checkbox"/> No <input type="checkbox"/> Yes If Yes, submit an updated site plan with this application.			
7. Food License: FOOD 9103 Fee: \$350.00		8. Weights and Measures: W&M 3920 Fee: \$405.00	
Your current food license includes the following food operations: Processing, Hazardous Foods, Sales < \$20,000, Convenience. Are there any changes to your food operations as listed above? <input checked="" type="checkbox"/> No <input type="checkbox"/> Yes, if Yes, explain _____		Number/Type of Devices: UPC Scanners = 3; Scales 0-300LBS = 5 Are there any changes to the number or types of devices? <input checked="" type="checkbox"/> No <input type="checkbox"/> Yes If yes, contact our office for further instructions.	

2017 JAN 31 11 18 AM CST

ALQML

CERTIFICATE OF COMPLETION



This certificate is awarded to

PUEBLO FOODS & LIQUOR, INC.

in recognition of completion of the Pivot Program with the
CITY OF MILWAUKEE

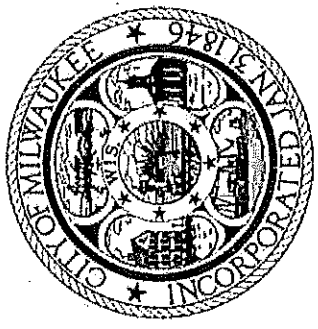

Jane R. Diefen
Signature

Jan. 30, 2017
Date

Joan Schumke
Signature

Jan. 30, 2017
Date

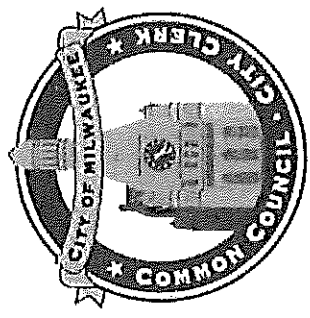



CITY OF MILWAUKEE
OFFICE OF THE CITY CLERK

Tuesday, June 18, 2019

COMMITTEE MEETING NOTICE

AD 06

TOOR, Davinder S, Agent
Toor Retail LLC
3565 N Teutonia Av

Milwaukee, WI 53206

You are requested to attend a hearing which is to be held in Room 301-B, Third Floor, City Hall on:

Tuesday, June 25, 2019 at 02:30 PM

Regarding: Your Class A Malt & Class A Liquor, Food Dealer, and Weigh & Measures License Renewal Applications as agent for "Toor Retail LLC" for "Jack's Beverage Center" at 3565-67 N Teutonia Av.

There is a possibility that your application may be denied for one or more of the following reasons: The recommendation of the committee regarding the application shall be based on evidence presented at the hearing. Per MCO 85-4-4, unless otherwise specified in the code, probative evidence concerning non-renewal, suspension or revocation may include evidence of the following: failure of the applicant to meet municipal qualifications, pending charges against or the conviction of any felony, misdemeanor, municipal offense or other offense, the circumstances of which substantially relate to the circumstances of the particular licensed or permitted activity, by the applicant or by any employee or other agent of the applicant. If the activities of the applicant involve a licensed premises, whether the premises tends to facilitate a public or private nuisance or has been the source of congregations of persons which have resulted in any of the following: disturbance of the peace; illegal drug activity; public drunkenness; drinking in public; harassment of passers-by; gambling; prostitution; sale of stolen goods; public urination; theft; assaults; battery; acts of vandalism including graffiti, excessive littering, loitering, illegal parking, loud noise at times when the licensed premise is open for business; traffic violations; curfew violations; lewd conduct; display of materials harmful to minors, pursuant to s. 106-9.6; or any other factor which reasonably relates to the public health, safety and welfare, or failure to comply with the approved plan of operation. See attached police report or correspondence.

Notice for applicants with warrants or unpaid fines:

Proof of warrant satisfaction or payment of fines must be submitted at the hearing on the above date and time. Failure to comply with this requirement may result in a delay of the granting/denial of your application.

Failure to appear at this meeting may result in the denial of your license. Individual applicants must appear only in person or by an attorney. Corporate or Limited Liability applicants must appear only by the agent designated on the application or by an attorney. Partnership applicants must appear by a partner listed on the application or by an attorney. If you wish to do so and at your own expense, you may be accompanied by an attorney of your choosing to represent you at this hearing.

You will be given an opportunity to speak on behalf of the application and to respond and challenge any charges or reasons given for the denial. No petitions can be accepted by the committee, unless the people who signed the petition are present at the committee hearing and willing to testify. You may present witnesses under oath and you may also confront and cross-examine opposing witnesses under oath. If you have difficulty with the English language, you should bring an interpreter with you, at your expense, so that you can answer questions and participate in your hearing.

You may examine the application file at this office during regular business hours prior to the hearing date. Inquiries regarding this matter may be directed to the person whose signature appears below.

Limited parking for persons attending meetings in City Hall is available at reduced rates (5 hour limit) at the Milwaukee Center on the southwest corner of East Kilbourn and North Water Street. Parking tickets must be validated in the first floor information booth in City Hall.

PLEASE NOTE: Upon reasonable notice, efforts will be made to accommodate the needs of disabled individuals through sign language interpreters or other auxiliary aids. For additional information or to request this service, contact the Council Services Division ADA Coordinator at (414) 286-2998, Fax - (414) 286-3456, TDD - (414) 286-2025.

JIM OWCZARSKI, CITY CLERK

BY: _____

Jessica Celella
License Division Manager

If you have questions regarding this notice, please contact the License Division at (414) 286-2238.

200 E. Wells Street, Room 105, City Hall, Milwaukee, WI 53202. www.milwaukee.gov/license
Phone: (414) 286-2238 Fax: (414) 286-3057 Email Address: License@milwaukee.gov

MILWAUKEE POLICE DEPARTMENT
LICENSE INVESTIGATION UNIT

CRIMINAL RECORD/ORDINANCE VIOLATION/INCIDENTS
SYNOPSIS

DATE: 05/20/2019

LICENSE TYPE: CLASS A MALT & LIQUOR

NEW:

RENEWAL: X

No. 293767

Application Date: 05/16/2019

Expiration Date:

License Location: 3565-67 N. Teutonia Ave.

Business Name: Toor Retail

Licensee/Applicant: Toor, Davinder S.

(Last Name, First Name, MI)

Date of Birth: 04/23/1983

Male:

Female:

Home Address: 10315 S. George Dr.

City: Oak Creek

State: WI

Zip Code: 53154

Home Phone: (414) 698-4896

This report is written by Police Officer David NOVAK, assigned to the License Investigation Unit, Days.

The Milwaukee Police Department's investigation regarding this application revealed the following:

1. On 06/08/2008 the applicant was cited in Kenosha County for Violate Public Swimming Pool Regulations.

Charge: Violate Public Swimming Pool Regulations

Finding: Guilty

Sentence: Fine

Date: 06/18/2008

Case: 2008FO000563

=====

2. On 07/19/2014 a 17 year old, working in conjunction with Milwaukee police, was able to purchase three Show brand cigars from the cashier at 3565 North Teutonia Avenue (Jack's Beverage Center). The applicant was cited.

Charge: Sale of Cigarettes to Minor/Underage

Finding: Guilty

Sentence: \$130.00 fine

Date: 10/28/2014

Case: 14054187

=====

3. On 10/08/2016 the applicant was cited in the City of Milwaukee at 5009 N. Hampton Av for

Charge: Sale of Cigarettes to Minor/Underage
Finding: Guilty
Sentence: Fined \$260.00
Date: 09/18/2017
Case: 17034918

=====

4. On 08/11/2018 a 17 year old working in conjunction with the Milwaukee Police Department and WI WINS Tobacco initiative, was able to purchase a Black & Mild cigar from the clerk at Jack's Beverage Center, 3565 N. Teutonia Av, who checked for ID but made the sale anyways. The cashier admitted the sale and apologized. The applicant was mailed MARTS enrollment package.
5. On 03/19/2019 officers conducted a licensed premise check at Jack's Beverage Center, 3565 N. Teutonia Av. The officers checked the licenses and found them to be current and the clerk was cooperative. No violations observed.

Milwaukee Police Department



749 W. State Street Milwaukee, WI 53233

414-933-4444

Case #:182230059

OtherEvent #: 18-LP-0238

Incident

3565 N TEUTONIA AV Milwaukee, WISCONSIN 53206

Incident Date/Time:: 08/11/2018 10:00:00
CAD Number:: 182230808
District:: 5
Beat:: 530
Reporting Area:: 2154

Business Agent (1)

TOOR, DAVINDER SINGH

Person Involvement:: Agent
DOB:: 04/23/1983
Sex:: MALE
Race:: ASIAN
Address:: 10315 S GEORGE DR
City:: OAK CREEK
State:: WISCONSIN
Zip Code:: 53154

Licensed Persons Involved (1)

ATWAL, GURSHARANJIT SINGH

Person Involvement:: Merchant
DOB:: 07/29/1982
Sex:: MALE
Race:: ASIAN
Address:: 5089 W HAMPTON AV
City:: Milwaukee
State:: WISCONSIN
Zip Code:: 53218

Narrative (1)

INITIAL INVESTIGATION

Brown, Penny A 014805

08/11/2018

This report is written by PO Penny MONREAL assigned to the License Investigation Unit.

On Saturday, August 11, 2018, I was assigned to work Wisconsin WINS Youth Tobacco Initiative, which checks area vendors for age compliant tobacco sales. Assisting in this assignment was: Tierra R. POLE B/F 11/8/00 5663 N. 95th St. Milwaukee 53225. POLE is 17 years old and not of legal age to purchase

Milwaukee Police Department

749 W. State Street Milwaukee, WI 53233

414-933-4444



Case #: 182230059

OtherEvent #: 18-LP-0238

tobacco.

At approximately 9:55A, POLE entered Jack's Beverage Center, located at 3565 N. Teutonia., and purchased a Black & Mild Jazz flavored Cigar from the cashier described as A/M 40's wearing a red T-Shirt, who checked her ID, but sold anyway. I entered the store and identified the cashier based on the description. The cashier was identified as: Gursharajit S. ATWAL A/M 07/27/82. ATWAL admitted to the sale and apologized. I explained I will be mailing out a MARTS enrollment packet to the agent.

Officer (1)

Reporting Officer:	Brown, Penny A (014805)	08/11/2018 12:44:00
Section: (Work Location):	27	
Approving Officer:	Raden, Chad M (010032)	08/13/2018 06:33:17

Milwaukee Police Department

749 W. State Street Milwaukee, WI 53233

414-933-4444



Case #:190780127

OtherEvent #: 19-LP-0281

Incident

3565 N TEUTONIA AV Milwaukee, WISCONSIN 53206

Incident Date/Time:: 03/19/2019 19:47:00
CAD Number:: 190782464
District:: 5
Beat:: 530
Reporting Area:: 2154

Business Agent (1)

TOOR, DAVINDER SINGH

Person Involvement: (Must choose Agent
AGENT from drop down): Agent
DOB:: 04/23/1983
Sex:: MALE
Race:: ASIAN
Phone 1 Number:: (414)-698-4896
Address:: 12033 W Wilbur Av
City:: Milwaukee
State:: WISCONSIN
Zip Code:: 53228

Licensed Persons Involved (1)

RANDHAWA, JAGAT J

Person Involvement:: Employee
DOB:: 09/14/1960
Sex:: MALE
Race:: WHITE
Phone 1 Number:: 414-405-7249
Phone 1 Type:: Cell
Address:: 6716 PARKEDGE CIR
City:: Franklin
State:: WISCONSIN
Zip Code:: 53132

Licensed Premise Data (1)

Jacks Beverage

Phone 1 Number:: (414)-698-4896
Phone 1 Type:: Home
Address:: 3551 N TEUTONIA AV
City:: Milwaukee
State:: WISCONSIN
Zip Code:: 53206
License Type:: Alcohol
Licensee Notification Was Made:: Yes
Licensee Notified Date/Time:: 03/19/2019 19:59:00
Business Was Cited For Violation:: No

Milwaukee Police Department

749 W. State Street Milwaukee, WI 53233

414-933-4444



Case #:190780127

OtherEvent #: 19-LP-0281

Licensee was cooperative: (if not Yes
explain in narrative):

Licensee or Manager was on No
premises at time of
violation/incident::

Narrative (1)

License Premise Report

Letteer, David J 016078

04/03/2019

This report is written by PO David LETTEER, assigned to the District 5 Tavern Squad(5468), with PO Russell Macrae.

On 03/19/19 at 7:47 p.m., we conducted a license premise check of Jack's Beverage, located at 3565 N. Teutonia Ave., which is a license premise in the city of Milwaukee.

Upon arrival, we met with the clerk Jagat RANDHAWA (w/m 09-14-60), who has a valid Class D License (02277628), which is set to expire on 12/31/19. He showed us the business Class A Liquor license (0199597), which is also valid and is set to expire on 07/30/19.

RANDHAWA was helpful with our questions about the business, but there were questions that he could not answer, just being an employee. RANDHAWA stated everything at the store was going well and that if we had further questions or answers to questions he could not answer regarding the business, the owner would be in the business in the morning and he could answer our questions.

End of report.

Officer (2)

Reporting Officer:	Letteer, David J (016078)	04/03/2019 00:32:00
Section: (Work Location):	54	
Approving Officer:	Ortiz, Jesus A (010989)	04/03/2019 08:31:28
Section: (Work Location):	53	



Tuesday, June 18, 2019



Notice of Public Hearing

TOOR, Davinder S, Agent
Jack's Beverage Center at 3565-67 N Teutonia Av
Class A Malt & Class A Liquor, Food Dealer, and Weights & Measures License Renewal
Applications

Tuesday, June 25, 2019 at 2:30 PM

To whom it may concern:

The above application has been made by the above named applicant(s). This requires approval from the Licenses Committee and the Common Council of the City of Milwaukee. The hearing before the Licenses Committee will take place on 6/25/2019 at 2:30 PM, in Room 301-B, Third Floor, City Hall. If you wish, you may provide testimony at the hearing regarding the request; see below for further information. You are not required to attend the hearing. Once the Licenses Committee makes its recommendation, this recommendation is forwarded to the full Common Council for approval at its next regularly scheduled hearing. Please review the information below and if you have further questions regarding this process, please contact the License Division at (414) 286-2238.

Important details for those wishing to provide information for the Licenses Committee to consider when making its recommendation:

1. The license application is scheduled to be heard at the above time. Due to other hearings running longer than scheduled, you may have to wait some time to provide your testimony.
2. You must appear in person and testify as to matters that you have personally experienced or seen. (You cannot provide testimony for your neighbor, parent or anyone else; this is considered hearsay and cannot be considered by the committee.)
3. No letters or petitions can be accepted by the committee (unless the person who wrote the letter or the persons who signed the petition are present at the committee hearing and willing to testify).
4. Persons opposed to the license application are given the opportunity to testify first; supporters may testify after the opponents have finished.
5. When you are called to testify, you will be sworn in and asked to give your name, and address. (If your first and/or last names are uncommon please spell them.)
6. You may then provide testimony.
 - a. Include only information relating to the above license application.
 - b. Include only information you have personally witnessed or seen.
 - c. Provide concise and relevant information detailing how this business has affected or may affect the peaceful enjoyment of your neighborhood.
 - d. If by the time you have the opportunity to testify, the information you wish to share has already been provided to the committee, you may state that you agree with the previous testimony. Redundant or repetitive testimony will not assist the committee in making its recommendation.
7. After giving your testimony, the members of the Licenses Committee and the licensee may ask questions regarding the testimony you have given or other factors relating to the license application.
8. Business Competition is not a valid basis for denial or non-renewal of a license.
Please Note: If you have submitted an objection to the above application your objection cannot be considered by the committee unless you personally testify at the hearing.

OCCUPANT	MAIL ADDRESS	CITY, STATE ZIP
CURRENT OCCUPANT	3556 N 19TH ST	MILWAUKEE, WI 53206
CURRENT OCCUPANT	1907 W FINN PL	MILWAUKEE, WI 53206
CURRENT OCCUPANT	1917 W FINN PL	MILWAUKEE, WI 53206
CURRENT OCCUPANT	3530A N 20TH ST	MILWAUKEE, WI 53206
CURRENT OCCUPANT	3520A N 20TH ST	MILWAUKEE, WI 53206
CURRENT OCCUPANT	1926A W KEEFE AVE	MILWAUKEE, WI 53206
CURRENT OCCUPANT	3544A N TEUTONIA AVE 3	MILWAUKEE, WI 53206
CURRENT OCCUPANT	3554 N 19TH ST	MILWAUKEE, WI 53206
CURRENT OCCUPANT	3572 N TEUTONIA AVE	MILWAUKEE, WI 53206
CURRENT OCCUPANT	1956 W FINN PL	MILWAUKEE, WI 53206
CURRENT OCCUPANT	3606A N 20TH ST	MILWAUKEE, WI 53206
CURRENT OCCUPANT	3617 N TEUTONIA AVE	MILWAUKEE, WI 53206
CURRENT OCCUPANT	3550A N 19TH ST	MILWAUKEE, WI 53206
CURRENT OCCUPANT	3544A N TEUTONIA AVE 2	MILWAUKEE, WI 53206
CURRENT OCCUPANT	3605 N 19TH ST	MILWAUKEE, WI 53206
CURRENT OCCUPANT	1947 W FINN PL	MILWAUKEE, WI 53206
CURRENT OCCUPANT	1954 W FINN PL	MILWAUKEE, WI 53206
CURRENT OCCUPANT	1964 W FINN PL	MILWAUKEE, WI 53206
CURRENT OCCUPANT	3621B N TEUTONIA AVE	MILWAUKEE, WI 53206
CURRENT OCCUPANT	3558 N 19TH ST	MILWAUKEE, WI 53206
CURRENT OCCUPANT	3560 N 19TH ST	MILWAUKEE, WI 53206
CURRENT OCCUPANT	3530 N 20TH ST	MILWAUKEE, WI 53206
CURRENT OCCUPANT	1958 W KEEFE AVE	MILWAUKEE, WI 53206
CURRENT OCCUPANT	1945 W FINN PL	MILWAUKEE, WI 53206
CURRENT OCCUPANT	1953 W FINN PL	MILWAUKEE, WI 53206
CURRENT OCCUPANT	3606 N 20TH ST	MILWAUKEE, WI 53206
CURRENT OCCUPANT	1932 W KEEFE AVE	MILWAUKEE, WI 53206
CURRENT OCCUPANT	1936 W KEEFE AVE	MILWAUKEE, WI 53206
CURRENT OCCUPANT	1941 W FINN PL	MILWAUKEE, WI 53206
CURRENT OCCUPANT	3566A N 19TH ST	MILWAUKEE, WI 53206
CURRENT OCCUPANT	1906 W FINN PL	MILWAUKEE, WI 53206
CURRENT OCCUPANT	1959 W FINN PL	MILWAUKEE, WI 53206
CURRENT OCCUPANT	3615 N TEUTONIA AVE	MILWAUKEE, WI 53206
CURRENT OCCUPANT	1926 W KEEFE AVE	MILWAUKEE, WI 53206
CURRENT OCCUPANT	3520 N 20TH ST	MILWAUKEE, WI 53206
CURRENT OCCUPANT	1954 W KEEFE AVE	MILWAUKEE, WI 53206
CURRENT OCCUPANT	1957 W FINN PL	MILWAUKEE, WI 53206
CURRENT OCCUPANT	1963A W FINN PL	MILWAUKEE, WI 53206
CURRENT OCCUPANT	3550 N 19TH ST	MILWAUKEE, WI 53206
CURRENT OCCUPANT	3566 N 19TH ST	MILWAUKEE, WI 53206
CURRENT OCCUPANT	1963 W FINN PL	MILWAUKEE, WI 53206
CURRENT OCCUPANT	3602 N 20TH ST	MILWAUKEE, WI 53206
CURRENT OCCUPANT	3544A N TEUTONIA AVE	MILWAUKEE, WI 53206
CURRENT OCCUPANT	3573 N 19TH ST	MILWAUKEE, WI 53206
CURRENT OCCUPANT	3577 N 19TH ST	MILWAUKEE, WI 53206
CURRENT OCCUPANT	3611A N TEUTONIA AVE	MILWAUKEE, WI 53206

CURRENT OCCUPANT	3512 N 20TH ST	MILWAUKEE, WI 53206
CURRENT OCCUPANT	3512A N 20TH ST	MILWAUKEE, WI 53206
CURRENT OCCUPANT	1965 W FINN PL	MILWAUKEE, WI 53206
CURRENT OCCUPANT	3621A N TEUTONIA AVE	MILWAUKEE, WI 53206

Total Records: 50

Radius: 250.0 feet and Center of Circle: 3565 N Teutonia Ave

2018-2019 Plan of Operation for 3565-67 N TEUTONIA AV

1. Litter & Security Plans

How are the grounds kept clean? Sweep Pressure Wash Pick Up Litter Other:

How often will grounds be cleaned? Daily Weekly Other: AS NEEDED

Who cleans the grounds? Licensee Building Owner Employees Hired Maintenance Other:

How are noise issues prevented and/or addressed? Security Manager approaches customer(s) Call Police Signs Posted Other:

Are there designated outdoor smoking areas? No Yes If Yes, Describe:

Number of garbage cans: Inside 3 Locations: By Entrance Door, By Check out, By cooler
 Outside 9 Locations: By Entrance, By Parking.

Is a crowd control barrier used? No Yes If Yes, Describe:

Number of restrooms: 3 Name of solid waste contractor: ADVANCE WASTE

Are there parking spaces on the premises? No Yes If Yes, list number of spaces: 10 and describe security plans: CAMERAS, LIGHTED.

Are there designated loading areas? No Yes If Yes, describe security plans: CAMERAS, LIGHTS, STEEL DOOR

Do you have security personnel on the premise? No Yes If Yes, how many? _____
 AND What are their responsibilities? _____
 What security equipment do they use? _____
 List their licensing, certification or training credentials: _____

Are there security cameras? No Yes If Yes, list all locations: 16 CAMERAS, BY CASHIER ENTRANCE, BACK ROOM PARKING

Are searches and/or identification checks conducted upon entry? No Yes If Yes, describe:

2. Percentage of Sales (must total 100%)

Alcohol 85 % Food Sales 5 % Entertainment _____ % Other 10 % TOBACCO

3. Businesses On The Premises (choose all that apply):

Restaurant Cafe/Coffee Shop Cocktail Lounge Convenience Store Night Club Liquor Store Tavern Sports Facility
 Hotel Banquet Hall Supermarket Private/Fraternal/Veterans' Club Other:

4. Hours of Operation and Age Restriction

Are there any changes to the current hours of operation or age restriction? No Yes If Yes, Describe:

Please Note: If you will be open earlier or later than the hours listed on your current license for even one event or holiday (for example, St. Patrick's Day, Brewers Opening Day, etc.) during the license period, this must be reported and printed on your license. Your hours of operation and age restriction are listed on your current license.

5. Floor Plan and Capacity

Are you requesting any changes to your capacity or floor plan*? No Yes If yes, describe: _____ and submit a new floor plan with this renewal application. A sample plan can be found online at www.milwaukee.gov/licenses under License Forms and Related Information.

Alcohol/Food Establishments: A "Permanent Extension of Premises Application" is required if you are adding any square footage to the licensed premises.

6. Sidewalk Dining: Fee:

Are there any changes to the sidewalk dining site plan? No Yes If Yes, submit an updated site plan with this application.

7. Food License: FOOD 9126 Fee: \$200.00

Your current food license includes the following food operations: No Processing, Hazardous Foods, Sales < \$20,000, Convenience. Are there any changes to your food operations as listed above? No Yes, if Yes, explain _____

8. Weights and Measures: W&M 3620 Fee: \$130.00

Number/Type of Devices:
 UPC Scanners = 3
 Are there any changes to the number or types of devices? No Yes If yes, contact our office for further instructions.

3565-67 N Teutonia Av.

CERTIFICATE OF COMPLETION



This certificate is awarded to

JACK'S BEVERAGE CENTER

in recognition of completion of the Pivot Program with the

CITY OF MILWAUKEE

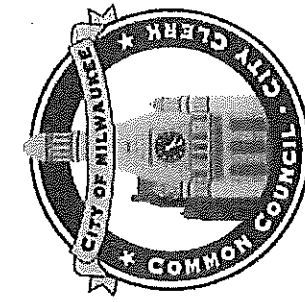

James R. O'Connell
James R. O'Connell, City Clerk

Oct. 15, 2018
Date

Jessica Celesia
Jessica Celesia, License Division Manager

Oct. 15, 2018
Date

