

FRIEBERT, FINERTY & ST. JOHN, S.C.

ATTORNEYS AT LAW

TWO PLAZA EAST - SUITE 1250

330 EAST KILBOURN AVENUE

MILWAUKEE, WISCONSIN 53202

ROBERT H. FRIEBERT
JOHN D. FINERTY
THOMAS W. ST. JOHN
WILLIAM B. GUIB
S. TODD FARRIS
TED A. WARPINSKI
BRIAN R. SMIGELSKI
MATTHEW W. O'NEILL
LAWRENCE J. GLUSMAN
MICHAEL S. MAISTELMAN
SHANNON A. ALLEN
JEREMY P. LEVINSON
BRIAN C. RANDALL
JENNIFER L. BOLGER

TELEPHONE
(414) 271-0130

TELECOPIER
(414) 272-8191

EMAIL
ffsj@ffsj.com

July 25, 2001

Via Messenger

Alderman Willie L. Hines, Jr.
17th Aldermanic District
City of Milwaukee
Room 205, City Hall
200 E. Wells Street
Milwaukee, WI 53202

RE: Common Council File No. 010249 ... Substitute resolution relative to the issuance of Airport Facility Revenue Bonds (Mitchell Field Maintenance Hangar Project) (Air Wisconsin Airlines Corporation Project)

Dear Alderman Hines:

Although I haven't seen the agenda for the Economic Development Committee for Monday, July 30, 2001, I understand that the above matter will come up in connection with a revenue bond proposal for Air Wisconsin's new hangar and aircraft maintenance facility at General Mitchell International Airport (GMIA).

For your background on this issue, I am enclosing a small color rendering of the building and the site plan for the parcel it will occupy.

The remarkable thing about this project is that construction can start almost immediately once the lease is signed with Milwaukee County and a reasonable assurance can be made that Industrial Revenue Bond financing is available through the City.

Ald. Willie J. Hines, Jr.
July 25, 2001
Page 2

The reason for this is that when the new Don Hutson center was built for the Green Bay Packers, the old practice facility which was relatively new at the time, was not demolished but was systematically disassembled and stored. The practice facility actually was based on a specification for a large aircraft hangar. Accordingly, the structural steel is currently stored in Columbus, Wisconsin and has or is about to be acquired by Air Wisconsin for shipment to Milwaukee. When site preparation is completed e.g., removal of the asphalt apron and the foundation from the original building is complete, the steel goes up.

If you make a statement and I can be of any help, I will put some bullet points together for you based on what I know - which is usually very little.

I am going to be sending a copy of this rendering and site plan to Ald. Pawlinski as the alderman for the district. There is, or at least perceived to be, a noise problem at the airport and that perception may bring some neighbors out to the meeting to complain. They were at the County Board's Committee meeting, but they were small in number. I can fill Jeff in on our responses on the noise issues.

If you have any immediate questions or comments, please call me at your convenience.

Thank you for your attention to this communication.

Very truly yours,

FRIEBERT, FINERTY & ST. JOHN, S.C.



John D. Finerty

JDF/kdr
Encl.

THE 'INSIDE' STORY . . .

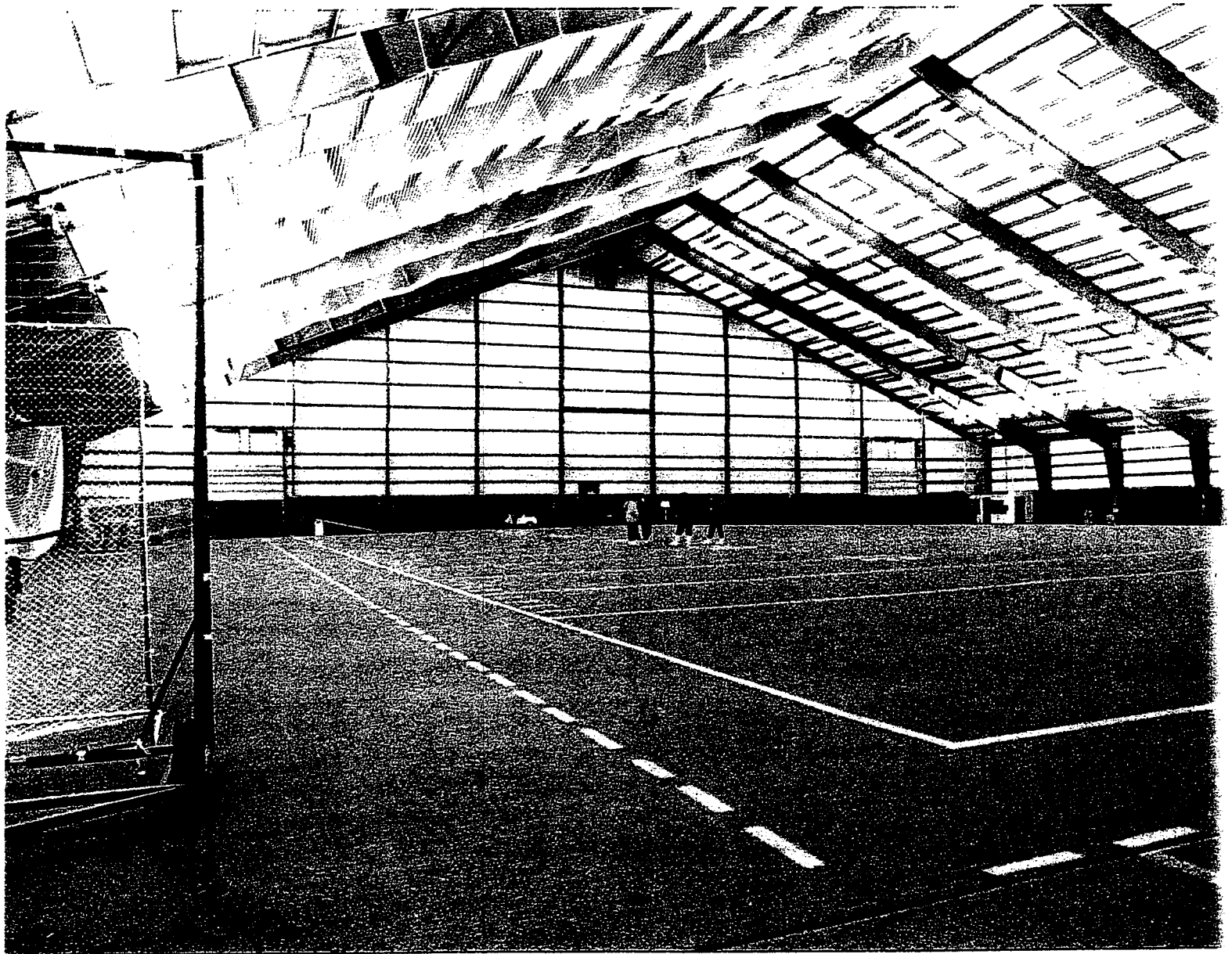

The Packers' all-metal practice building is 240 feet long, 230 feet wide and 65 feet high at the apex, sufficient to permit practice of punting and placekicking. Lighting is provided by sky lights and 1,500 watt, metal halide indirect lighting (76 fixtures).

A clear span, free-standing building, it is the only one of its kind in professional football (the Minnesota Vikings and Buffalo Bills have indoor practice facilities but they are air-supported structures). The Packers' building, which can be heated to over 65 degrees, is equipped with electric heating.

ONE OF A KIND . . .

The Packers' New Indoor Practice Facility



Head Coach Forrest Gregg describes the Packers' new indoor practice facility (pictured above) as "a real plus . . . It gives you good flexibility from a practice standpoint. It's a plus, too, because a guy can go in there and work out, do something, all year long. That's the big plus."

Linebacker Mike Douglass, commenting on the 55,000-square foot structure, calls it "the greatest thing the Packer organization ever has done for the players."

The building, completed in November of 1982, covers an 80-yard artificial turf strip on the Packers' practice fields, located a stone's throw east of Lambeau Field.

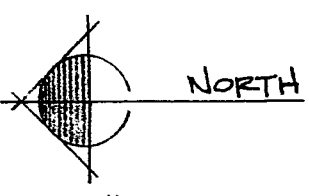
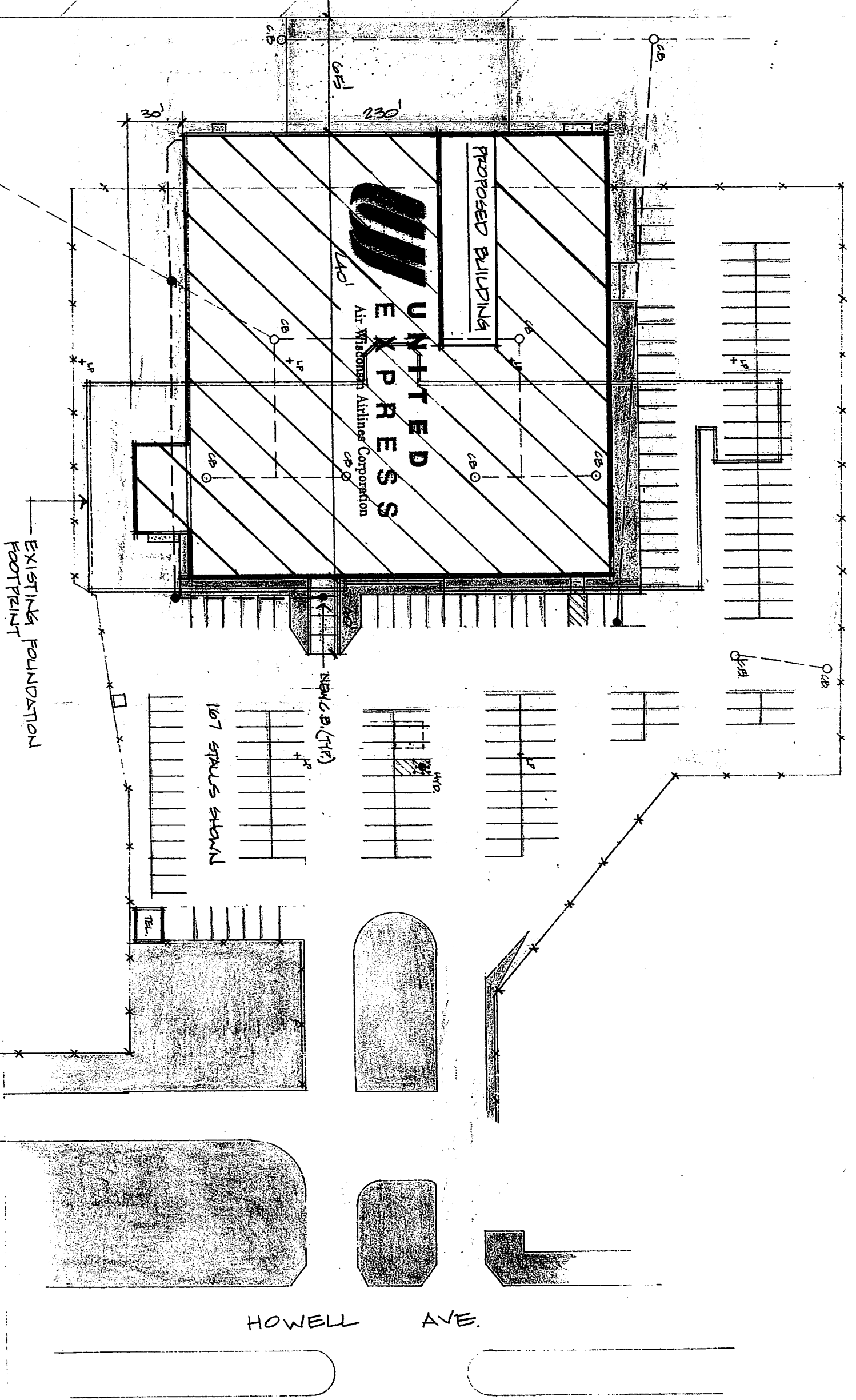

SITE PLAN
 SCALE: 1" = 60' 0"

HOWELL AVE.

**UNITED
EXPRESS**
Air Wisconsin Airlines Corporation

