



**CITY OF MILWAUKEE
OFFICE OF THE CITY CLERK**

Friday, September 18, 2020

COMMITTEE MEETING NOTICE

AD 01

NAVADIA, Prakash, Agent
Clark's Beer & Liquor Inc.
4728 W BURLEIGH St

Milwaukee, WI 53210

You are requested to attend a virtual hearing to be held on:

Tuesday, September 29, 2020 at 03:00 PM

Regarding: Your Class A Malt & Class A Liquor and Weights & Measures License Applications as agent for "Clark's Beer & Liquor Inc." for "Clark's Beer & Liquor" at 4770 N 18TH St.

This meeting will be held via GoToMeeting. Please see the enclosed best practices document for further instructions. The access code is <https://global.gotomeeting.com/join/945944877>. If you wish to call in, please call +1 (872) 240-3412 and use Access Code: 945-944-877.

There is a possibility that your application may be denied for one or more of the following reasons: The recommendation of the committee regarding the application shall be based on evidence presented at the hearing. Per MCO 85-2.7-4, probative evidence concerning whether or not a new license should be granted may be presented on the following subjects: whether or not the applicant meets the municipal requirements, the appropriateness of the location and premises where the licensed premises is to be located and whether use of the premises for the purposes or activities permitted by the license would tend to facilitate a public or private nuisance or create undesirable neighborhood problems such as disorderly patrons, unreasonably loud noise, litter, and excessive traffic and parking congestion. Probative evidence relating to these matters may be taken from the plan of operation submitted with the license application, if any, but shall not include the content of any music. Evidence regarding the fitness of the location of the premises to be maintained as the principal place of business, including but not limited to whether there is an overconcentration of businesses of the type for which the license is sought; whether the proposal is consistent with any pertinent neighborhood business or development plans, or the location's proximity to areas where children are typically present. The applicant's record in operating similarly licensed premises; and whether or not the applicant has been charged with or convicted of any felony, misdemeanor, municipal offense or other offense, the circumstances of which substantially relate to the activity to be permitted by the license being applied for or any other factor which reasonably relates to the public health, safety or welfare may also be considered. See attached police report or correspondence.

Notice for applicants with warrants or unpaid fines: Proof of warrant satisfaction or payment of fines must be submitted at the hearing on the above date and time. Failure to comply with this requirement may result in a delay of the granting/denial of your application.

Failure to attend this meeting may result in the denial of your license. Individual applicants and partnership applicants must attend or attend by an attorney. The agent or attorney for corporate or limited liability applicants must attend. If you wish to do so and at your own expense, you may be accompanied by an attorney of your choosing to represent you at this hearing.

You will be given an opportunity to speak on behalf of the application and to respond and challenge any charges or reasons given for the denial. No petitions can be accepted by the committee, unless the people who signed the petition attend the virtual hearing and are willing to testify. You may present witnesses under oath and you may also confront and cross-examine opposing witnesses under oath. If you have difficulty with the English language, you should request an interpreter attend the meeting with you, at your expense, so that you can answer questions and participate in your hearing.

PLEASE NOTE: Upon reasonable notice, efforts will be made to accommodate the needs of disabled individuals through sign language interpreters or other auxiliary aids. For additional information or to request this service, contact the Council Services Division ADA Coordinator at (414) 286-2998, Fax - (414) 286-3456, TDD - (414) 286-2025.

JIM OWCZARSKI, CITY CLERK

BY: _____

Jessica Celella
License Division Manager

If you have questions regarding this meeting, please contact the staff assistant, Molly Kuether-Steele at (414) 286-2775 or molly.kuether-steele@milwaukee.gov.

200 E. Wells Street, Room 105, City Hall, Milwaukee, WI 53202. www.milwaukee.gov/license
Phone: (414) 286-2238 Fax: (414) 286-3057 Email Address: License@milwaukee.gov



CITY OF MILWAUKEE
OFFICE OF THE CITY CLERK

Friday, September 18, 2020

COMMITTEE MEETING NOTICE

AD 01

NAVADIA, Prakash, Agent
Clark's Beer & Liquor Inc.
W135N7255 Lund Circle
#309
Menomonee Falls, WI 53051

You are requested to attend a virtual hearing to be held on:

Tuesday, September 29, 2020 at 03:00 PM

Regarding: Your Class A Malt & Class A Liquor and Weights & Measures License Applications as agent for "Clark's Beer & Liquor Inc." for "Clark's Beer & Liquor" at 4770 N 18TH St.

This meeting will be held via GoToMeeting. Please see the enclosed best practices document for further instructions. The access code is <https://global.gotomeeting.com/join/945944877>. If you wish to call in, please call +1 (872) 240-3412 and use Access Code: 945-944-877.

There is a possibility that your application may be denied for one or more of the following reasons: The recommendation of the committee regarding the application shall be based on evidence presented at the hearing. Per MCO 85-2.7-4, probative evidence concerning whether or not a new license should be granted may be presented on the following subjects: whether or not the applicant meets the municipal requirements, the appropriateness of the location and premises where the licensed premises is to be located and whether use of the premises for the purposes or activities permitted by the license would tend to facilitate a public or private nuisance or create undesirable neighborhood problems such as disorderly patrons, unreasonably loud noise, litter, and excessive traffic and parking congestion. Probative evidence relating to these matters may be taken from the plan of operation submitted with the license application, if any, but shall not include the content of any music. Evidence regarding the fitness of the location of the premises to be maintained as the principal place of business, including but not limited to whether there is an overconcentration of businesses of the type for which the license is sought; whether the proposal is consistent with any pertinent neighborhood business or development plans, or the location's proximity to areas where children are typically present. The applicant's record in operating similarly licensed premises; and whether or not the applicant has been charged with or convicted of any felony, misdemeanor, municipal offense or other offense, the circumstances of which substantially relate to the activity to be permitted by the license being applied for or any other factor which reasonably relates to the public health, safety or welfare may also be considered. See attached police report or correspondence.

Notice for applicants with warrants or unpaid fines:

Proof of warrant satisfaction or payment of fines must be submitted at the hearing on the above date and time. Failure to comply with this requirement may result in a delay of the granting/denial of your application.

Failure to attend this meeting may result in the denial of your license. Individual applicants and partnership applicants must attend or attend by an attorney. The agent or attorney for corporate or limited liability applicants must attend. If you wish to do so and at your own expense, you may be accompanied by an attorney of your choosing to represent you at this hearing.

You will be given an opportunity to speak on behalf of the application and to respond and challenge any charges or reasons given for the denial. No petitions can be accepted by the committee, unless the people who signed the petition attend the virtual hearing and are willing to testify. You may present witnesses under oath and you may also confront and cross-examine opposing witnesses under oath. If you have difficulty with the English language, you should request an interpreter attend the meeting with you, at your expense, so that you can answer questions and participate in your hearing.

PLEASE NOTE: Upon reasonable notice, efforts will be made to accommodate the needs of disabled individuals through sign language interpreters or other auxiliary aids. For additional information or to request this service, contact the Council Services Division ADA Coordinator at (414) 286-2998, Fax - (414) 286-3456, TDD - (414) 286-2025.

JIM OWCZARSKI, CITY CLERK

BY: _____

Jessica Celella
License Division Manager

If you have questions regarding this meeting, please contact the staff assistant, Molly Kuether-Steele at (414) 286-2775 or molly.kuether-steele@milwaukee.gov.

200 E. Wells Street, Room 105, City Hall, Milwaukee, WI 53202. www.milwaukee.gov/license
Phone: (414) 286-2238 Fax: (414) 286-3057 Email Address: License@milwaukee.gov

Date:03/25/20
Officer: Monreal

City of Milwaukee Police Department
90-5-1.5 Crime Prevention Survey
Convenience Store/Liquor Store Inspection

Name of Premise: Clark's Beer & Liquor
Address: 4770 N. 18th St.
Phone: 414-372-4880

Owner: Prakash, Navadia
Owner address: W135 N7255 Lund Cr. #309
City State Zip: M. Falls, WI 53051
Owner Phone: 262-527-4213
Owner email: navadiap@gmail.com

Manager: Same
Home Address:
City State Zip:
Phone:
Email:

Preferred contact: Same

Location currently open: YES NO

Projected open date:

Day's open: S M T W Th F SA ALL

Hours of Operation: Sun: 8A-9P 24 hours Y N
Mon: "
Tue: "
Wed: "
Thu: "
Fri: "
Sat: "

Premise Type: Liquor Store
Convenience Store
Other:

Licenses currently held:

- Alcohol: Yes No Class: #:
Tobacco: Yes No #:
Food: Yes No #:
Extended Hours: Yes No #:
Secondhand Dealer: Yes No Type: #:
Other: Yes No Type: #:
Other: Yes No Type: #:

Exterior Survey:

1. Is the area around the location clean? Yes No
2. What surrounds the location? (Check all the apply)
 - a. Park
 - b. School
 - c. Youth Center
 - d. Church
 - e. Tavern(s) If so, how many
 - f. Residential
 - g. Other businesses
 - h. Other:
3. Can you see from the outside of the location into the interior Yes No
4. Can you see the employees inside of the location from the outside Yes No
5. Are exterior windows free of signage Yes No
6. Is there a parking lot Yes No
7. Is the parking lot clean? Yes No
8. Is the parking lot well lit? Yes No
9. Are there areas where a person could conceal themselves Yes No
10. Is there exterior lighting? Yes No. Does it appears to be adequate Yes No
11. Exterior Payphone? Yes No
12. Are there No Loitering Signs posted? Yes No
13. Are there exterior security cameras Yes No How Many: 9
14. Are the address numbers prominently displayed and easy to see Yes No

Camera Survey:

15. Does this location have security cameras? Yes No
16. Are they in working order? Yes No
17. What format are the cameras?
 - a. Color Yes No
 - b. Digital Yes No
 - c. VCR Yes No
 - d. Recorded Yes No
18. How long is footage stored for later viewing: 45 days
19. Are there exterior cameras Yes No How many: 9
20. Are there interior cameras Yes No How many: 13
21. Do all employees know how to retrieve recorded digital images/footage? Yes No

Interior Survey:

22. Is the storeowner willing to be a standing complainant regarding loitering? Yes No
a. If yes have them fill out the standing complaint form and give them two of the commercial signs Yes No
23. Is the interior of the location neat and clean? Yes No
24. Does an interior camera face the entrance/exit? Yes No
25. Is there a lockable area that separates employees from customers? Yes No
26. Does the store sell single chore boy? Yes No
27. Does the store sell blunt wraps? Yes No
28. Does the store sell scales? Yes No
29. Does the store sell items that may be used as crack pipes? Yes No
a. Describe item
30. Does the store have an over abundance of sandwich baggies: Yes No
31. Does the owner understand that these items are often used for drug use? Yes No
32. Do the products in the store appear to be new and rotated often? Yes No
33. Are emergency and non-emergency numbers posted near the phone? Yes No
34. Does the owner know how to contact their police district directly? Yes No
a. Did you provide a district contact guide to the owner? Yes No

Complete this section if alcohol establishment is a convenience store:

(** Read full ordinance for all details "68-4.3 Convenience Food Stores")

All convenience food stores not exempted under sub. 3 shall:

1. Is the cash register located in a manner so that at the time of a sales transaction, the employee and customer are both visible from the sidewalk? Yes No **
2. Are the glass entrance and exit doors clear of any signs or advertisements with the exception of a sign which states that the cash register contains \$50 or less and that the safe is no accessible to employees? Yes No
3. Does the store maintain one of the following on the licensed premise:
 - a. A safe that was in use at the convenience food store on August 17, 1994? Yes No
 - b. A drop-safe or time release safe that weighs at least 500 pounds or which is attached to or set into the floor in a manner approved by the police department? Yes No
4. Is lighting provided for the store's parking area during all hours of darkness when employees or customers are on the premises at a minimum average of 2-foot candles per square foot, unless the store is not open for business after sunset and before sunrise? Yes No N/A
5. Are at least two high-resolution surveillance security cameras installed? Yes No
6. Are the security cameras in working order? Yes No
7. Does one camera show an overall view of the counter and register area? Yes No
8. Does one camera show a clear, identifiable, full frame image of the face of each person entering and leaving the store? Yes No
9. Are the camera views obstructed by fixtures or displays? Yes No
10. Is the recorded footage stored for at least 30 days? Yes No
11. Do all store employees know how to record footage from the camera system to media capable of being transferred to police custody? Yes No

12. Are customer entrances/exits made of glass or other transparent material? Yes No
a. Exception: A store that does not have such doors on August 17, 1994 shall not be required to install such doors until the holder of the store's food dealer license changes.
13. Has the owner and their employees attended the Robbery Prevention Training within 120 days of ownership or employment? Yes No
a. Contact Community Outreach and Education at 935-7836 for schedule.

Sub 3. Exemptions. The requirements of this section do not apply to a convenience food store that conforms to either of the following descriptions:

- a-1. The store is located in an enclosed shopping structure, enclosed commercial building or hospital. A convenience food store is not in an enclosed structure or building if a customer can enter it directly from the outside.
Does store conform to a-1 Yes No
- a-2. The store physically separates employees from customers with a solid partition that bars a person from entering the employee area from the customer area, has a secure lock on the employee side of any door between the employee area and the customer, and conducts all transaction through a service window or similar arrangement.
Does store conform to a-2 Yes No
- a. At the commissioner's discretion, a convenience store may be exempted from any or all of the regulations specified in sub 2.
Does this location hold an exemption from the commissioner regarding any of the requirements of Sub 2? Yes No

ADDITIONAL COMMENTS/RECOMMENDATIONS:

Advised agent to take some advertisements off windows for visibility.

Advised to add address to outside of building.



City Concentration Map

4770 N 18th St

Area : 21,862,585.6 ft²

Aug 4 2020 9:36:19 Central Daylight Time

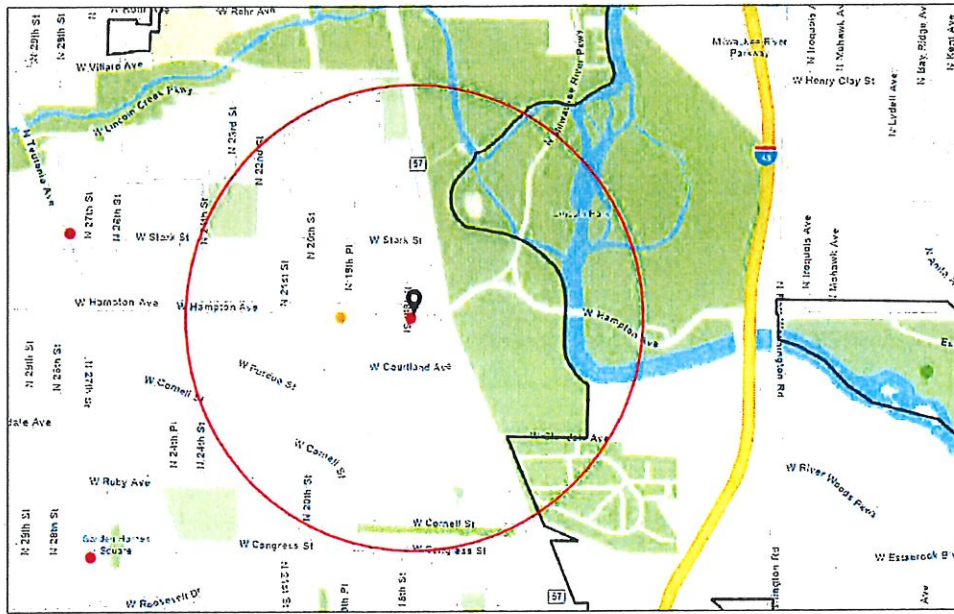

- Alcohol Licenses**
- Class A Fermented Malt Beverage
 - Class A Liquor and Malt
 - Class B Fermented Malt Beverage
 - Class C Wine Retailer
 - City Boundary

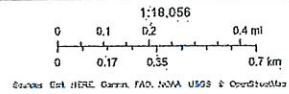

Summary

Name	Count	Area(ft²)	Length(mi)
Alcohol Licenses	2		

Alcohol Licenses

#	Legal Entity	Trade Name	Licensee	Address	License Type Name	Total Capacity	Expiration Date	Count
1	Colbert's Beer & Liquor	Colbert's Beer & Liquor	WILLIE G COLBERT, SP	4770 N 18th ST	Class A Malt & Class A Liquor License		6/29/2021, 7:00 PM	1
2	Multani Food Market LLC	Multani Food Market	Manpreet Singh, Agt	1951 W Hampton AV	Class A Fermented Malt Beverage Retailer's License		5/25/2021, 7:00 PM	1

Establishments within a 0.5 miles radius centered on area of interest.



Friday, September 18, 2020

Licenses Committee Notice of Hearing

COLBERT'S BEER AND LIQUOR MART LLC
11320 W Daphne St
Milwaukee, WI 53224

The Licenses Committee will consider the following license application:

Class A Malt & Class A Liquor and Weights & Measures License Applications
NAVADIA, Prakash, Agent
Clark's Beer & Liquor at 4770 N 18TH St

Date: 9/29/2020

Time: 03:00 PM

Location: The hearing before the Licenses Committee will take place virtually on Tuesday, September 29, 2020. This is a public hearing. Those wishing to view the proceeding are able to do so via the City Channel – Channel 25 on Spectrum Cable – or on the Internet at <http://city.milwaukee.gov/citychannel>. Those wishing to provide oral testimony will be asked to do so by phone or internet and are asked to contact the staff assistant, Molly Kuether-Steele at (414) 286-2775 or molly.kuether-steele@milwaukee.gov for necessary information. Please make such requests no later than one business day prior to the start of the meeting. You are not required to attend the hearing, but please see the information below if you would like to provide testimony.

Please note this application may be recommended for denial based on fitness of the location due to concentration of alcohol beverage outlets in the area. If the application is denied for this reason, no other application for an alcohol beverage license for this location shall be recommended for approval by the Licenses Committee within three years of the date of denial unless the applicant has demonstrated a change of circumstances since the prior denial.





Friday, September 18, 2020



Notice of Public Hearing

blank
notice

NAVADIA, Prakash, Agent
Clark's Beer & Liquor at 4770 N 18TH St
Class A Malt & Class A Liquor and Weights & Measures License Applications

Tuesday, September 29, 2020 at 3:00 PM

To whom it may concern:

The above application has been made by the above named applicant(s). This requires approval from the Licenses Committee and the Common Council of the City of Milwaukee. The hearing before the Licenses Committee will take place virtually on 9/29/2020 at 3:00 PM. This is a public hearing. Those wishing to view the proceeding are able to do so via the City Channel – Channel 25 on Spectrum Cable – or on the Internet at <http://city.milwaukee.gov/citychannel>. Those wishing to provide oral testimony will be asked to do so by phone or internet and are asked to contact the staff assistant, Molly Kuether-Steele at (414) 286-2775 or molly.kuether-steele@milwaukee.gov for necessary information. Please make such requests no later than one business day prior to the start of the meeting. You are not required to attend the hearing, but please see the information below if you would like to provide testimony. Once the Licenses Committee makes its recommendation, this recommendation is forwarded to the full Common Council for approval at its next regularly scheduled hearing.

Important details for those wishing to provide information for the Licenses Committee to consider when making its recommendation:

1. The license application is scheduled to be heard at the above time. Due to other hearings running longer than scheduled, you may have to wait some time to provide your testimony.
2. You must testify as to matters that you have personally experienced or seen. (You cannot provide testimony for your neighbor, parent or anyone else; this is considered hearsay and cannot be considered by the committee.)
3. No letters or petitions can be accepted by the committee (unless the person who wrote the letter or the persons who signed the petition are willing to testify).
4. Persons opposed to the license application are given the opportunity to testify first; supporters may testify after the opponents have finished.
5. When you are called to testify, you will be sworn in and asked to give your name, and address. (If your first and/or last names are uncommon please spell them.)
6. You may then provide testimony.
 - a. Include only information relating to the above license application.
 - b. Include only information you have personally witnessed or seen.
 - c. Provide concise and relevant information detailing how this business has affected or may affect the peaceful enjoyment of your neighborhood.
 - d. If by the time you have the opportunity to testify, the information you wish to share has already been provided to the committee, you may state that you agree with the previous testimony. Redundant or repetitive testimony will not assist the committee in making its recommendation.
7. After giving your testimony, the members of the Licenses Committee and the licensee may ask questions regarding the testimony you have given or other factors relating to the license application.
8. Business Competition is not a valid basis for denial or non-renewal of a license.

Please Note: If you have submitted an objection to the above application your objection cannot be considered by the committee unless you personally testify at the hearing.

OCCUPANT	MAIL ADDRESS	CITY, STATE ZIP
CURRENT OCCUPANT	4740 N PARKWAY AVE	MILWAUKEE, WI 53209
CURRENT OCCUPANT	1802A W HAMPTON AVE	MILWAUKEE, WI 53209
CURRENT OCCUPANT	4800 N 18TH ST 3	MILWAUKEE, WI 53209
CURRENT OCCUPANT	4752 N 19TH ST	MILWAUKEE, WI 53209
CURRENT OCCUPANT	4747 N 18TH ST	MILWAUKEE, WI 53209
CURRENT OCCUPANT	4754 N PARKWAY AVE	MILWAUKEE, WI 53209
CURRENT OCCUPANT	4752 N 18TH ST	MILWAUKEE, WI 53209
CURRENT OCCUPANT	1820 W HAMPTON AVE 5	MILWAUKEE, WI 53209
CURRENT OCCUPANT	1812 W HAMPTON AVE 1	MILWAUKEE, WI 53209
CURRENT OCCUPANT	4744 N PARKWAY AVE	MILWAUKEE, WI 53209
CURRENT OCCUPANT	4747 N GREEN BAY AVE	MILWAUKEE, WI 53209
CURRENT OCCUPANT	1820 W HAMPTON AVE 3	MILWAUKEE, WI 53209
CURRENT OCCUPANT	4800 N 18TH ST 1	MILWAUKEE, WI 53209
CURRENT OCCUPANT	4822 N 18TH ST	MILWAUKEE, WI 53209
CURRENT OCCUPANT	4744 N 19TH ST	MILWAUKEE, WI 53209
CURRENT OCCUPANT	4734 N PARKWAY AVE	MILWAUKEE, WI 53209
CURRENT OCCUPANT	4827 N GREEN BAY AVE	MILWAUKEE, WI 53209
CURRENT OCCUPANT	4800 N 18TH ST 4	MILWAUKEE, WI 53209
CURRENT OCCUPANT	4731 N 18TH ST	MILWAUKEE, WI 53209
CURRENT OCCUPANT	4750 N PARKWAY AVE	MILWAUKEE, WI 53209
CURRENT OCCUPANT	4743 N GREEN BAY AVE	MILWAUKEE, WI 53209
CURRENT OCCUPANT	4760 N 18TH ST	MILWAUKEE, WI 53209
CURRENT OCCUPANT	1729 W HAMPTON AVE	MILWAUKEE, WI 53209
CURRENT OCCUPANT	1820 W HAMPTON AVE 1	MILWAUKEE, WI 53209
CURRENT OCCUPANT	4800 N 18TH ST 2	MILWAUKEE, WI 53209
CURRENT OCCUPANT	1738 W HAMPTON AVE	MILWAUKEE, WI 53209
CURRENT OCCUPANT	1730 W HAMPTON AVE	MILWAUKEE, WI 53209
CURRENT OCCUPANT	4756 N 19TH ST	MILWAUKEE, WI 53209
CURRENT OCCUPANT	4751 N 18TH ST	MILWAUKEE, WI 53209
CURRENT OCCUPANT	1820 W HAMPTON AVE 6	MILWAUKEE, WI 53209
CURRENT OCCUPANT	1820 W HAMPTON AVE 2	MILWAUKEE, WI 53209
CURRENT OCCUPANT	1820 W HAMPTON AVE 7	MILWAUKEE, WI 53209
CURRENT OCCUPANT	1812 W HAMPTON AVE 2	MILWAUKEE, WI 53209
CURRENT OCCUPANT	1812 W HAMPTON AVE 4	MILWAUKEE, WI 53209
CURRENT OCCUPANT	4740 N 19TH ST	MILWAUKEE, WI 53209
CURRENT OCCUPANT	4735 N 18TH ST	MILWAUKEE, WI 53209
CURRENT OCCUPANT	1735A W HAMPTON AVE	MILWAUKEE, WI 53209
CURRENT OCCUPANT	1820 W HAMPTON AVE 4	MILWAUKEE, WI 53209
CURRENT OCCUPANT	1802 W HAMPTON AVE	MILWAUKEE, WI 53209
CURRENT OCCUPANT	1735 W HAMPTON AVE	MILWAUKEE, WI 53209
CURRENT OCCUPANT	1820 W HAMPTON AVE 8	MILWAUKEE, WI 53209
CURRENT OCCUPANT	1812 W HAMPTON AVE 3	MILWAUKEE, WI 53209
CURRENT OCCUPANT	4757 N 18TH ST	MILWAUKEE, WI 53209

blank

notice

Total Records: 43

Radius: 250.0 feet and Center of Circle: 4770 N 18th St



BUSINESS LICENSE PLAN OF OPERATION

ccf-busplan 3/15/18

Office of the City Clerk License Division
200 E. Wells St. Room 105, Milwaukee, WI 53202
(414) 286-2238 www.milwaukee.gov/license e-mail address: license@milwaukee.gov

1. Type of Business

Applying for: Extended Hours (12AM to 5AM) - If a food establishment, check all that apply: Delivery Drive Thru Dining Room
 Self Service Laundry Massage Establishment Filling Station
 Other (supplemental application for specific license also required)

Provide a detailed description of the type of business you plan on operating:

Liquor Store

Do you have any experience operating this type of business? No Yes If yes, explain: Have worked in this

2. Business Operations

Industry 10+ years and own LIQUOR STORE NOW.

- a. Proposed Opening Date: 3/15/2020
- b. Is this premise under construction? No Yes If yes, list estimated completion date: _____
- c. Is this a franchise? No Yes
- d. Is this premises currently licensed? No Yes If yes, list type of license: Cig & Tobacco, Weights & Measures
AM-LIQUOR LIC.
- e. Is the current licensee operating? No Yes If no, list date closed: _____
- f. Do you have future plans for other businesses, licenses or permits at this location? No Yes
If yes, explain: _____
- g. Have you previously held an Extended Hours License in Milwaukee? No Yes
If yes, list address(es): _____
- h. Are other businesses operating in the same building? No Yes If yes, describe: _____

3. Litter & Noise

- a. How are grounds kept clean? Sweep Pressure Wash Pick Up Litter Other: _____
- b. How often will grounds be cleaned? Daily Weekly As Needed Monthly Other: _____
- c. Grounds cleaned by: Licensee Building Owner Employees Hired Maintenance Other: _____
- d. How are noise issues prevented and/or addressed? Security Manager approaches customer(s) Call Police
 Signs Posted Other: _____
- e. Will a sound amplification system be used? No Yes If yes, describe: _____

4. Smoking & Sanitation

- a. Are there designated outdoor smoking areas? No Yes If yes, describe: _____
- b. Number of Garbage Cans: Inside: 2 Locations: behind register & by door + RESTROOM
Outside: 1 Locations: Outside on property
- c. Is a crowd control barrier used? No Yes If yes, describe: _____
- d. How many restrooms are on the premises? 1
- e. Name of solid waste contractor: Advanced Disposal Waste Management Other: _____

5. Security

- a. Are there onsite parking spaces? No Yes If yes, how many? 20 and describe the parking security plan: fenced and security camera
- b. Is there a loading zone? No Yes If yes, describe the loading area security plan: Cameras
- c. Will you have security personnel on premise? No Yes If yes, how many? _____ and answer the following:
 What are their responsibilities? _____
 Is security equipment used? No Yes If yes, describe Cameras & alarm systems & lighting
 List their licensing, certification, or training credentials _____
- d. Will there be security cameras? No Yes If yes, how many? 6 and list locations: Entry door
6 Inside
6 Outside
- e. Will searches/identification checks be done upon entry? No Yes If yes, describe _____

6. Percentage of Sales (must total 100%)

Alcohol <u>90</u> %	Food <u>5</u> %	Secondhand Merchandise <u>0</u> %	Precious Metals & Gems <u>0</u> %
Entertainment <u>0</u> %	Cigarettes <u>5</u> %	Personal Services (such as tattoo, body piercing, salon, tailor, tanning, etc.) <u>0</u> %	Other _____ % Describe: _____
Pawnbroker Activity <u>0</u> %	Salvaged Materials _____ % (such as scrap metal)		

7. Businesses/licenses on the Premises (check all that apply):

- Type 1
- Full Service Restaurant Cafe/Coffee Shop Deli or Fast Food Restaurant Private/Fraternal/Veterans Club
- Night Club Tavern Cocktail Lounge Teen Club
- Banquet Hall Sports Facility Bowling Alley
- Hotel/Motel: Number of Floors: _____ Number of Rooms: _____
 Rooming House: Number of Floors: _____ Number of Rooms: _____

- Type 2
- Liquor Store Corner Store Supermarket Convenience Store
- Gas Station Amusement/Phonograph Distributor Recycling, Salvage or Towing
- Used Car Dealer Personal Service Establishment (such as tattoo business, hair salon, tailor, etc.) Recording Studio

What other licenses/permits will you hold at this location? (check all that apply)

- Occupancy Permit Cigarette & Tobacco Gas Station Extended Hours Class "B" Tavern Weights & Measures
- Secondhand Dealer Precious Metal & Gem Other: Class A Liquor & melt

8. Legal Capacity (only if a Type 1 premises in #7 above)

Capacity _____ (Call the Milwaukee Development Center at 414-286-8211 if you have questions.)

9. Premises Description

- a. Identify all area(s) of the premises that will be used in operating this business (include areas used only for storage):
 1st Floor 2nd Floor Basement Storage Patio Beer Garden Sidewalk Café Deck Rooftop
 Other: Describe: 2nd floor storage only
- b. Describe Location: Major Thoroughfare Secondary Street Other: _____
- c. Nearest Major Cross Street: Hampton and 18th St
- d. Describe Building: Free Standing Building Strip Mall Other: _____
- e. Describe Premises Structure: Single Story Multi-Story - # of Stories: 2 Other: _____
- f. Describe Surrounding Area: Commercial Residential Industrial Other: _____
- g. Building Owner Name: Willie Colbert Phone Number: 414-397-6350
 Business Owner Address: 4770 N 18th Street Milwaukee

10. Hours of Operation & Customers

Will customers be entering the premises? No Yes

Day of the Week	Proposed Hours of Operation:		Estimated Number of Customers expected each day	Potential Age Range of Customers	Class B Tavern Applicant Only: Age Restriction (If none, write 'None')
	Open Time (include a.m. or p.m.)	Close Time (include a.m. or p.m.)			
Sunday	8 am	9 PM	250	21-99	
Monday	8 am	9 PM	250	21-99	
Tuesday	8 am	9 PM	250	21-99	
Wednesday	8 am	9 PM	250	21-99	
Thursday	8 am	9 PM	280	21-99	
Friday	8 am	9 PM	300	21-99	
Saturday	8 am	9 PM	300	21-99	

An Extended Hours Establishment License is required for any convenience store, filling station, personal service establishment (such as tattoo, body piercing, salon, tailor, tanning, etc.), recording studio or restaurant which is open between the hours of 12:00 a.m. and 5:00 a.m.

Alcohol Establishments
 Permitted Hours of Operation: Class A: 8:00 am to 9:00 pm Sunday thru Saturday
 Class B: 6:00 am to 2:00 am Sunday thru Thursday, 6:00 am to 2:30 am Friday & Saturday

Entertainment Outdoor Closing Hours: 10:00pm Sunday-Thursday; 12:00am Friday & Saturday; unless a different time, either earlier or later, is established by the Common Council in its approval of the licensee's plan of operation.

11. Signature(s)

Pravash Navroia
 Signature of Sole Proprietor, Partner, or 20% or more Shareholder
 (if there are no 20% or more shareholders,
 Corporate Officer-print name/title and sign)

 Signature of additional partner or 20% or more shareholder

See Application Information for a complete list of all required application forms.



**ALCOHOL BEVERAGE & PUBLIC ENTERTAINMENT PREMISES
SUPPLEMENTAL APPLICATION**

Office of the City Clerk License Division
200 E. Wells St. Room 105, Milwaukee, WI 53202
(414) 286-2238 e-mail address: license@milwaukee.gov www.milwaukee.gov/license

Legal Entity Name: <u>Clark's Beer & Liquor Inc</u>	
Premise Address: <u>4770 N 18th St, Milwaukee, WI 53209</u>	
Proximity of Premises to Church, School, Daycare Center or Hospital	
Is the building within 300 feet of any church, school, daycare center or hospital? <input checked="" type="checkbox"/> No <input type="checkbox"/> Yes	
"Service Bar Only" Designation	
If applying for Class B or C license, are you applying for "Service Bar Only"? <input checked="" type="checkbox"/> No <input type="checkbox"/> Yes Service Bar Only means customers cannot sit at the bar. Alcohol is served to employees who serve patrons seated at tables. No stools, chairs or other articles of furniture shall be placed at the service bar for patrons to sit upon.	
Business Information	
a) Are you taking out this application for anyone that may not be eligible for a license? <input checked="" type="checkbox"/> No <input type="checkbox"/> Yes If yes, list their name and address: _____	
b) Will the agent, a partner or the individual licensee be conducting the day-to-day operations of the business? <input type="checkbox"/> No <input checked="" type="checkbox"/> Yes If no, list the name and address of the person(s) who will: _____ _____ Class B Applicants: If the agent, a partner or the individual licensee will not be conducting the day-to-day operations of the business, the person(s) listed above must obtain a Class B Managers license.	
c) Does anyone else have money invested or any other interest in this business? <input checked="" type="checkbox"/> No <input type="checkbox"/> Yes If yes, explain: _____	
d) Have you made an agreement with anyone to repay any loan or any other payments based upon income from the business? <input checked="" type="checkbox"/> No <input type="checkbox"/> Yes If yes, list name and address: _____	
Proof of Ownership, Lease, or Offer to Purchase (New & Transfer Applicants Only)	
Submit proof of ownership, lease, or offer to purchase the building with this application. A lease or offer to purchase must: a) Be in the same legal entity name as that apply for the license b) Reflect the same address as the premises address on this application c) Reflect current dates and d) Be signed by the lessor/seller and lessee/buyer	
Property Information (New & Transfer Applicants Only)	
a) Do you own or lease the building? <input type="checkbox"/> Own <input checked="" type="checkbox"/> Lease	
b) Who owns the fixtures (for example, coolers, etc.)? <u>I OWN</u>	
c) Are you purchasing the stock and/or fixtures? <input type="checkbox"/> No <input checked="" type="checkbox"/> Yes If yes, amount paid \$ <u>0</u>	
d) Total amount paid for business \$ <u>0</u>	
e) Total amount paid for goodwill of the business \$ _____	
Goodwill comprises the reputation and customer relationships of an existing business. If the price you pay for the business exceeds the fair market value of all of the rest of the assets of the business, the excess may be considered goodwill.	
f) Have you made arrangements with the seller for payment of personal property taxes? <input type="checkbox"/> No <input checked="" type="checkbox"/> Yes	

See Application Information for a list of all required application forms.

Lease Information (New & Transfer Applicants who are leasing the premises only)

- a) Date lease begins _____ Ends _____
- b) Monthly rental \$ _____
- c) Do you have an option to renew the lease? No Yes
- d) Does your lease allow for assignment to another party without the consent of the owner? No Yes
- e) For what length of time have you been guaranteed occupancy (number of years)? _____
- f) In addition to paying the monthly rental, will you have to pay anything additional to the owner of the building to guarantee performance of the lease? No Yes If yes, explain _____
- g) Does the present owner or occupancy object to the granting of your license? No Yes
If yes, explain _____

Change of Agent Applicants Only

Have there been any changes to the floor plan since the last application was submitted? No Yes
If no, a new floor plan is not required. If yes, submit a new floor plan and explain the change(s): _____

Signature

Prakash Navadia
Signature of Sole Proprietor, Partner or 20% or More Shareholder
(If no 20% or more Shareholder, Corporate Officer - print name/title and sign)

Note: All information contained in this application is subject to approval by the Common Council.
Deviating from approved plan of operation will subject licensee to citations, and/or suspension or non-renewal of the license.
Contact the License Division for information on how to request changes.

New and transfer of premises applicants must submit the following:

- Proof of ownership, lease or offer to purchase the building
- Detailed floor plan
- If a restaurant, copy of the menu



**WEIGHTS & MEASURES LICENSE
SUPPLEMENTAL APPLICATION**

OFFICE OF THE CITY CLERK, LICENSE DIVISION
CITY HALL, 200 E. WELLS ST, ROOM 105, MILWAUKEE, WI 53202
(414) 286-2238 • license@milwaukee.gov • www.milwaukee.gov/license

Office Use Only:

App# _____

Filed _____

Initials _____

Paid _____

Lic # _____

Legal Entity Name: CLARY'S BEER & LIQUOR INC

Premise Address: 4770 N 18th St, Milwaukee, WI 53209

Device Type(s)

- Check all device types for which you need a license.
 - For each device type checked, indicate how many you have in the Number of Devices column (b).
 - Calculate the Total Fee Per Device Type by multiplying the Fee Per Device Type (a) by the Number of Devices (b).
 - Add all Total Fee Per Device Type amounts together and that will be your Total Fee Due.
- * Exception: The Scanner fee is not per device. Check the box for the appropriate range.
If you have 1-3 scanners, the total due is \$130. If you have 4 or more scanners, the total due is \$250.
Check the Number of Devices (b).

Device Type	License Period	Fee Per Device Type (a)	Number of Devices (b)	Total Fee Per Device Type (a x b)
Liquid Measuring Devices				
<input type="checkbox"/> Retail Petroleum Meters	12 months	\$60		
<input type="checkbox"/> 0 to 30 gallons per minute	24 months	\$60		
<input type="checkbox"/> 31 to 200 gallons per minute	24 months	\$250		
<input type="checkbox"/> Over 200 gallons per minute	24 months	\$250		
Scales				
<input type="checkbox"/> Measuring any weight amount	24 months	\$55		
Scanners				
		Fee for scanners is by range	Check how many scanners you have	
<input checked="" type="checkbox"/> Up to 3 scanners	24 months	\$130 total*	<input type="checkbox"/> 1 <input type="checkbox"/> 2 <input type="checkbox"/> 3	
<input checked="" type="checkbox"/> Four or more scanners	24 months	\$250 total*	<input type="checkbox"/> 4 <input type="checkbox"/> Other _____	
Other Devices				
<input type="checkbox"/> Length Measuring Device	24 months	\$60		
<input type="checkbox"/> Timing Device	24 months	\$30		

Total Fee Due 130.

Signature: _____

I hereby agree that I will comply with the applicable sections of the Wisconsin State Statutes, Administrative Code and the Milwaukee Code of Ordinances regarding the operation of weighing and measuring devices.

I understand that all devices must be operated within the specifications, tolerances and other technical requirements set forth in the National Institute of Standards and Technology Handbook 44. I understand that the license for which I am applying must be posted on the premises or in my vehicle prior to opening for business or operating the device.

I understand that these device licenses are not transferable (with the exception of scanners). If the device is replaced or needs to be resealed, I must apply for and receive a new license so that an inspection of the device can be performed prior to its use. I acknowledge that as a condition of being issued this license, I must allow the Health Department into the establishment to test the device to validate its specifications/tolerances. If my devices are found out of compliance, I may be charged inspection fees. I have read, understand, and will adhere to all the above acknowledgments.

Pravash Navroia
Signature of Sole Proprietor, Partner, or 20% or more Shareholder
(If there are no 20% or more shareholders, Corporate Officer-print name/title and sign)

Signature of additional partner or 20% or more shareholder

This form must be submitted with the Business License Application, Weights & Measures Plan of Operation, and appropriate fee. Forms can be obtained online at www.milwaukee.gov/licenses.

7-22-6-17-0053

PLAT OF SURVEY

PROPERTY AT HAMPTON AVE. (OWNER)
LEGAL DESCRIPTION LOTS 12, 13, AND 14, BLOCK L ADAMS, SUBD. NO 2, EXCEPTING
THE N. 22' THEREOF, IN THE NE 1/4 OF SEC. 6, T. 1 N., R. 22 E., CITY OF MILWAUKEE,
WISC.

3/11/2020

$26 \times 100 = 2600$

Prakash Navatia Agent
Clarus Beer & Liquor Inc
Clarus Beer & Liquor
4770 N 18th St
Milwaukee WI, 53209

coolers for soda and juices

Coolers for Beer & wine

office

Stair to upstairs

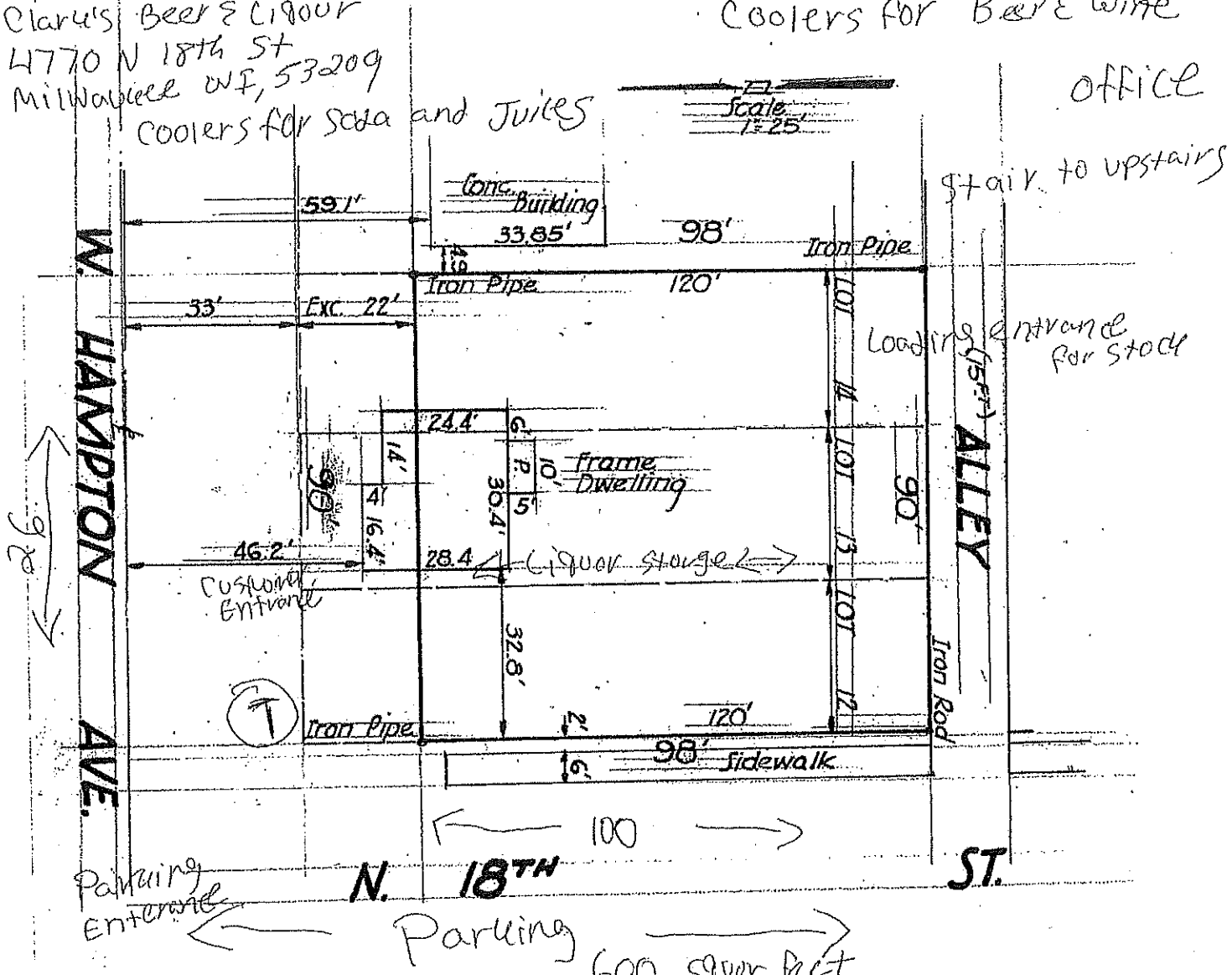

Parking Entrance

N. 18TH

ST.

Parking 600 square feet

Prepared for Riszew & Dickey Co.

State of Wisconsin, }
County of Milwaukee } ss.

I hereby certify that on the 26TH day of JULY 1951, I have surveyed the property described above according to the official records and that the above plat is a correct representation of the boundary lines and measurements of all buildings and other structures thereon.

Plat No. 51-466

Signed Milton N. Schmidt
Engineer and Surveyor

Garbage Dumpster

Office

Stair to upstairs

3/11/2020 600 square feet
Prakash Navadia
Clar's Beer & Liqueur Inc
Clar's Beer & Liqueur
4770 N 18th St
Milwaukee WI 53209

Clar's Beer & Liqueur
4770 N 18th St
Milwaukee, WI 53209

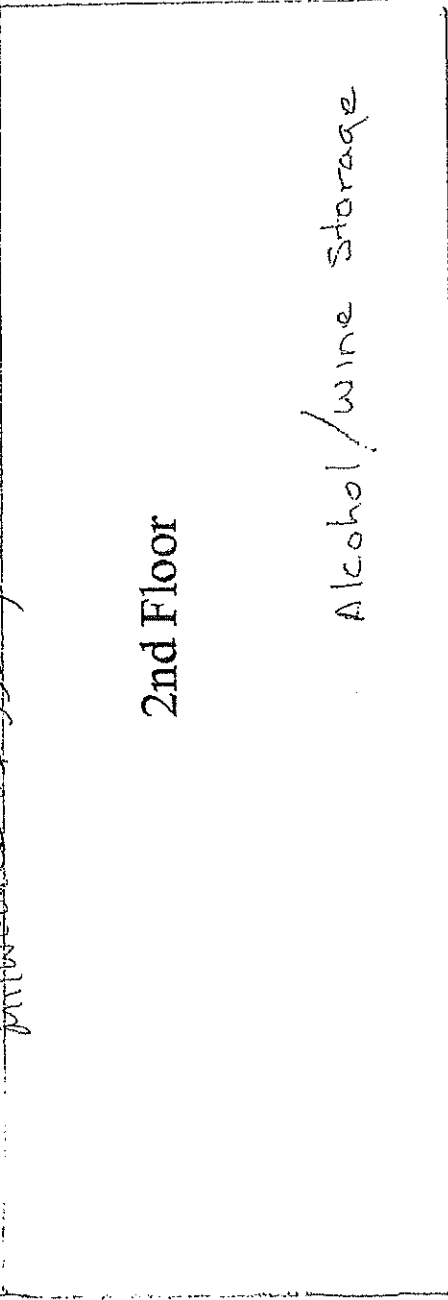

Building Remission
I
I
6W X 100-
26 X 80
2,600 sq ft
I
East
Hampton Avenue
I
West

North
Point <

I
East
Hampton Ave
West
I

Driveway
into

Col-

I
East
I
Alley

I
I
I
West

I
I

Driveway
18th st

I
I

Customer Parking Customer Parking Customer Parking Customer Parking

July 25, 2016

---North 18th ST---