

CITY OF MILWAUKEE WATER DISTRIBUTION FACILITY

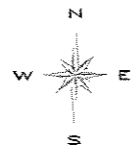

- LEGEND:**
- ⊕ STS BORING NUMBER AND LOCATION (SALT STORAGE DOME PROJECT, 1992)
 - ⊙ B1 BORING NUMBER AND LOCATION (PROJECT No. 1G-940878)
 - ⊙ P1 TERRAPROBE PENETRATION AND ABANDONED MONITORING WELL NUMBER AND LOCATION (PROJECT No. 1E-941228-1)
 - ⊙ MW1A MONITORING WELL NUMBER AND LOCATION
 - FENCE SEPARATING 6' BELOW GRADE DITCH WITH STONE RIP-RAP OVER GEOMEMBRANE COVER
 - ▲ BENCHMARK: SOUTHWEST CORNER OF SECONDARY CONTAINMENT WALL, "LUBECUBE" AST. ELEVATION = 100.00'
 - FORMER UTILITIES OR BUILDINGS

- CHEMICAL KEY:**
- 1-MN: 1-METHYLNAPHTHALENE
 - 2-MN: 2-METHYLNAPHTHALENE
 - 1,2,4-TMB: 1,2,4-TRIMETHYLBENZENE
 - 1,3,5-TMB: 1,3,5-TRIMETHYLBENZENE
 - ACP: ACENAPHTHYLENE
 - AN: ACENAPHTHENE
 - AT: ANTHRACENE
 - B: BENZENE
 - B(a): BENZO (a) ANTHRACENE
 - B(a)F: BENZO (a) FLUORANTHENE
 - B(a)P: BENZO (a) PYRENE
 - B(b): BENZO (b) FLUORANTHENE
 - B(g,h,i): BENZO (g,h,i) PERYLENE
 - B(k): BENZO (k) FLUORANTHENE
 - C: CHRYSENE
 - B(a)A: d1 BENZO (a,h) ANTHRACENE
 - E: ETHYLENENE
 - F: FLUORANTHENE
 - FL: FLUORENE
 - IP: INDENO (1,2,3-cd) PYRENE
 - IPBz: ISOPROPYLBENZENE
 - NapM: NAPHTHALENE
 - n-ButB: n-BUTYLBENZENE
 - n-PBz: n-PROPYLBENZENE
 - P: PYRENE
 - PA: PHENANTHRENE
 - PCA: TETRACHLOROETHANE
 - S: STYRENE
 - PCB: POLYCHLORINATED BIPHENYLS
 - T: TOLUENE
 - TCB: TRICHLOROETHENE
 - X: TOTAL XYLENES

- METALS KEY:**
- As: ARSENIC
 - Ba: BARIUM
 - Cr: CHROMIUM
 - Hg: MERCURY
 - Pb: LEAD
- ABBREVIATIONS:**
- DRO: DIESEL RANGE ORGANICS
 - GRO: GASOLINE RANGE ORGANICS
 - PAH: POLYNUCLEAR AROMATIC HYDROCARBONS
 - RCRA: RESOURCE CONSERVATION AND RECOVERY ACT
 - VOC: VOLATILE ORGANIC COMPOUNDS

NOTES:

GRO, DRO, PAH, AND RCRA METALS RESULTS EXPRESSED IN MILLIGRAMS PER KILOGRAM (mg/kg) EQUIVALENT TO PARTS PER MILLION (ppm)

VOC RESULTS EXPRESSED IN MICROGRAMS PER KILOGRAM (ug/kg) EQUIVALENT TO PARTS PER BILLION (ppb)

RESULTS INDICATED IN RED ARE ABOVE RESIDUAL CONTAMINANT LEVELS FOR SOIL SET FORTH IN TABLE 1 OF NR 729.09.

RESULTS INDICATED IN GREEN ARE ABOVE WDRR RESIDUAL CONTAMINANT LEVELS FOR A DIRECT CONTACT PATHWAY.

RESULTS INDICATED IN BLUE ARE ABOVE WDRR RESIDUAL CONTAMINANT LEVELS FOR PROTECTION OF GROUNDWATER.

LINCOLN CREEK

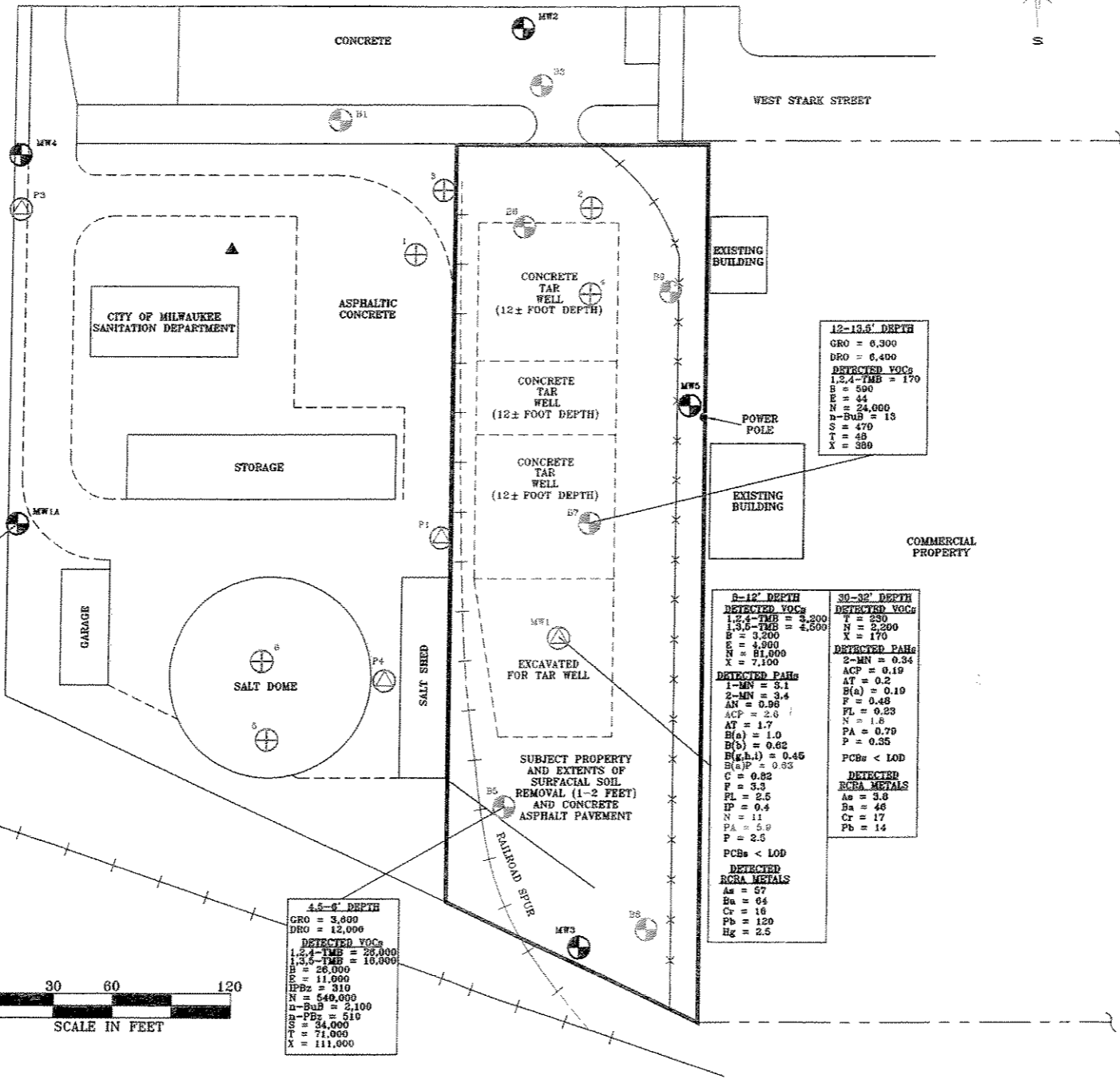

39.5'-41' DEPTH
 DETECTED VOCs
 T = 3.5
 PAHs < LOD
 PCBs < LOD
 DETECTED RCRA METALS
 As = 4.2
 Ba = 7.3
 Cr = 21
 Pb = 16

4.5'-6' DEPTH
 GRO = 3,600
 DRO = 12,000
 DETECTED VOCs
 1,2,4-TMB = 25,000
 1,3,5-TMB = 15,000
 B = 28,000
 E = 11,000
 IPBz = 310
 N = 549,000
 n-ButB = 2,100
 n-PBz = 510
 PCBs = 71,000
 X = 111,000

12-13.5' DEPTH
 GRO = 6,300
 DRO = 6,400
 DETECTED VOCs
 1,2,4-TMB = 170
 B = 590
 E = 44
 N = 24,000
 n-ButB = 13
 S = 470
 T = 49
 X = 380

6-12' DEPTH
 DETECTED VOCs
 1,2,4-TMB = 3,200
 1,3,5-TMB = 2,500
 B = 3,200
 E = 4,900
 N = 61,000
 X = 7,100
 DETECTED PAHs
 1-MN = 3.1
 2-MN = 3.4
 AN = 0.98
 ACP = 2.6
 AT = 1.7
 B(a) = 1.0
 B(b) = 0.62
 B(g,h,i) = 0.45
 B(k)P = 0.83
 C = 0.82
 F = 3.3
 FL = 2.5
 IP = 0.4
 N = 11
 PA = 5.9
 P = 2.5
 PCBs < LOD
 DETECTED RCRA METALS
 As = 57
 Ba = 64
 Cr = 16
 Pb = 120
 Hg = 2.5

30-32' DEPTH
 DETECTED VOCs
 T = 290
 N = 2,290
 X = 170
 DETECTED PAHs
 2-MN = 0.34
 ACP = 0.19
 AT = 0.2
 B(a) = 0.19
 F = 0.48
 FL = 0.23
 N = 1.6
 PA = 0.70
 P = 0.55
 PCBs < LOD
 DETECTED RCRA METALS
 As = 3.8
 Ba = 46
 Cr = 17
 Pb = 14

GILES ENGINEERING ASSOCIATES, INC.
 NO W22650 JOHNSON RD., WAUKESHA, WI, 53186
 (414)-544-0118

FIGURE 8
 SOIL ANALYTICAL RESULTS
 CAMERON YARD PROJECT
 231 WEST CAMERON AVENUE
 MILWAUKEE, WISCONSIN

DESIGNED	DRAWN	APPROVED	SCALE	DATE
SCT	DOC	X	1"=60'	3-89-98
PROJECT NO.: 1E-9710012		CAD NO.: E7100129		