

AMENDMENT NO. 3  
NORTH 7<sup>TH</sup> STREET-WEST GARFIELD  
AVENUE PROJECT AREA  
REDEVELOPMENT PLAN

Document Number

Name and Return Address  
Redevelopment Authority  
Attn: Janet Grau, Long Range Planning  
P.O. Box 324  
Milwaukee, WI 53201

Recording Area

Tax Key No.: See Attached **Exhibit "A"**.

**WITNESSETH**

Whereas, An Urban Renewal Plan for the North 7<sup>th</sup> Street-West Garfield Avenue Redevelopment Project Area was adopted by the Redevelopment Authority of the City of Milwaukee ("RACM") and by the Common Council of the City of Milwaukee ("Common Council") and was subsequently recorded with the Office of the Register of Deeds for Milwaukee County ("Register of Deeds") on June 30, 1983 as Document No. 5630275 ("Plan"); and

Whereas, Amendment No. 1 to the Plan was adopted by RACM and the Common Council and was recorded with the Register of Deeds on February 15, 1984 as Document No. 5693942; and

Whereas, Amendment No. 2 to the Plan, which established an African American Entertainment and Cultural District in an expanded project area, was adopted by RACM and the Common Council and was recorded with the Register of Deeds on June 14, 2005 as Document No. 09028109; and

Whereas, RACM and the Council desire to amend Amendment No. 2 to revise the procedures for removing properties from acquisition, to revise Map No. 3, "Proposed Land Use Plan" and to revise Map No. 4, "Acquisition Map and Schedule of Property Acquisitions", and Amendment No. 3 was approved by RACM on November 16, 2006 and by the Common Council on December 12, 2006; and

Whereas, The project area is legally described in **Exhibit "B"**;

Now, therefore, the Amendment No 2 is amended as follows:

- A. Under Section C, Subsection 3, add the following after Subsection i):
- "j) Automotive uses."
- B. Under Section D, Subsection 1, the existing subsection (c) is deleted and replaced with the following:
- "c. If identified for acquisition on Map No. 4 – Land Acquisition Plan, property later may be exclude from acquisition during the course of project execution upon approval by the Authority under the following conditions:"
- C. Under Section D, Subsection 1, Subsection c, add the following after Subsection 3):
- "4. The Authority determines the acquisition is no longer necessary to implement the objectives of the Plan."
- D. Under Section F, Procedures for Changes in the Approved Plan, Subsections 2 and 3 are deleted.
- E. Map 3, "Proposed Land Use Plan", is replaced with Revised Map 3, "Revised Proposed Land Use Plan" attached as **Exhibit "C"**.
- F. Map 4, "Acquisition Map and Schedule of Lands and Interests to be Acquired" is replaced with Revised Map 4, "Revised Acquisition Map and Revised Schedule of Lands and Interests to be Acquired" attached hereto as **Exhibit "D."**
- G. All other sections of Amendment No. 2 remain unchanged.

**Certificate of Recording Officer**  
**Amendment No. 3**  
**North 7<sup>th</sup> Street-West Garfield Avenue Redevelopment Plan**

I, Joel T. Brennan, Assistant Executive Director-Secretary of the Redevelopment Authority of the City of Milwaukee, do certify that the attached Redevelopment Plan Amendment No. 3 for the North 7<sup>th</sup> Street-West Garfield Avenue Project Area is a true and exact copy of the redevelopment plan amendment as adopted and approved for recorded by, respectively, the Redevelopment Authority of the City of Milwaukee on November 16, 2006, in Resolution Number \_\_\_\_\_, and by the Common Council of the City of Milwaukee on December 12, 2006 in Resolution Number \_\_\_\_\_, on file and of record, pursuant to Section 66.1333, Wisconsin Statutes.

In Testimony Whereof, for and on behalf of the Redevelopment Authority of the City of Milwaukee, I have hereunto sent my hand and caused the seal of said authority to be affixed this \_\_\_\_ day of December, 2006.

\_\_\_\_\_  
Joel T. Brennan  
Assistant Executive Director-Secretary  
Redevelopment Authority of the City of Milwaukee

STATE OF WISCONSIN     )  
                                  )SS  
COUNTY OF MILWAUKEE   )

Personally came before me this \_\_\_\_ day of December, 2006, Joel T. Brennan, who acknowledged himself to be the Assistant Executive Director-Secretary of the Redevelopment Authority of the City of Milwaukee, a Corporation, and that he, being authorized so to do, executed the foregoing instrument as such officer of said Redevelopment Authority, by its authority.

IN WITNESS WHEREOF, I have hereunto set my hand and official seal.

SEAL

\_\_\_\_\_  
Notary Public,  
  
Milwaukee County  
My commission \_\_\_\_\_

This document was drafted by the City of Milwaukee, Department of City Development.

**Exhibit "A"**  
Tax Key Numbers  
Amendment No. 3  
North 7<sup>th</sup>-West Garfield Avenue Project Area Redevelopment Plan

3230651000, 3230654000, 3230130100, 3230638000, 3230639100, 3230640000, 3230641000, 3230642000,  
3230643000, 3230644113, 3230646112, 3230647000, 3230648000, 3230649000, 3230650000, 3230651000,  
3230652000, 3230653000, 3230654000, 3230655000, 3230656000, 3230657000, 3230659110, 3230661100,  
3230663100, 3230664100, 3230668111, 3230669000, 3230670000, 3230671000, 3230672100, 3230673100,  
3230677100, 3230676000, 3221172100, 3221173000, 3230680100, 3230681000, 3230682000, 3230683000,  
3230684000, 3230685000, 3230686000, 3230687000, 3230688000, 3230690000, 3230691000, 3230692100,  
3230689110, 3221187000, 3221186000, 3221185000, 3221184000, 3221183000, 3221182000, 3221181000,  
3221180000, 3221179000, 3221178100, 3221176110, 3221215000, 3221216100, 3221189100, 3221214000,  
3221213000, 3221212100, 3221210000, 3221209000, 3221208000, 3221207100, 3221203000, 3221202000,  
3221201000, 3221200100, 3221198000, 3221197000, 3221196000, 3221195000, 3221194000, 3221193000,  
3221192100, 3221190100, 3221189200, 3221232000, 3221233000, 3520611200, 3520614110, 3520615000,  
3520618100, 3520619100, 3520593123, 3520597000, 3520598000, 3520599100, 3520601000, 3520602000,  
3520604000, 3520605000, 3520606100, 3520607000, 3520135100, 3520134000, 3520133000, 3520131000,  
3520130100, 3520132000, 3520110100, 3530231110, 3530232000, 3530234000, 3520109000, 3520108110,  
3520103100, 3520102000, 3530247000, 3530246000, 3530245000, 3530244000, 3530243000, 3530240100,  
3531232000, 3531231000, 3530219110, 3530221100, 3530224100, 3530225100, 3530226100, 3530228111,  
3530222100, 3530205000, 3530206000, 3530209000, 3530213000

**Exhibit "B"**  
Legal Description  
Amendment No 3  
North 7<sup>th</sup> Street-West Garfield Avenue Redevelopment Plan

The perimeter boundary of the project area is as follows:

Beginning at the intersection of the north line of West Meinecke and the west line of N. 7<sup>th</sup> Street;

Thence, east along the north line of West Meinecke to its intersection with the east line of N. 4<sup>th</sup> Street;

Thence, south along the east line of N. 4<sup>th</sup> Street to the north line of the east-west alley that is to the north of 324 North Avenue;

Thence, east along the north line of the east-west alley to its intersection with the east line of the north-south alley that is to the east of 324 North Avenue;

Thence, south along the east line of the north-south alley to its intersection with the south line of West Garfield Avenue;

Thence, west along the south line of West Garfield to its intersection with the east line of N. 8<sup>th</sup> Avenue;

Thence, north along the west line of 2225 N. 8<sup>th</sup> to its intersection with the north line of North Avenue;

Thence, east along the north line of North Avenue to its intersection with the west line of N. 7<sup>th</sup> Street;

Thence, north along the west line of N. 7<sup>th</sup> Street to its intersection with the north line of West Meinecke, the point of beginning.

Exhibit "C"

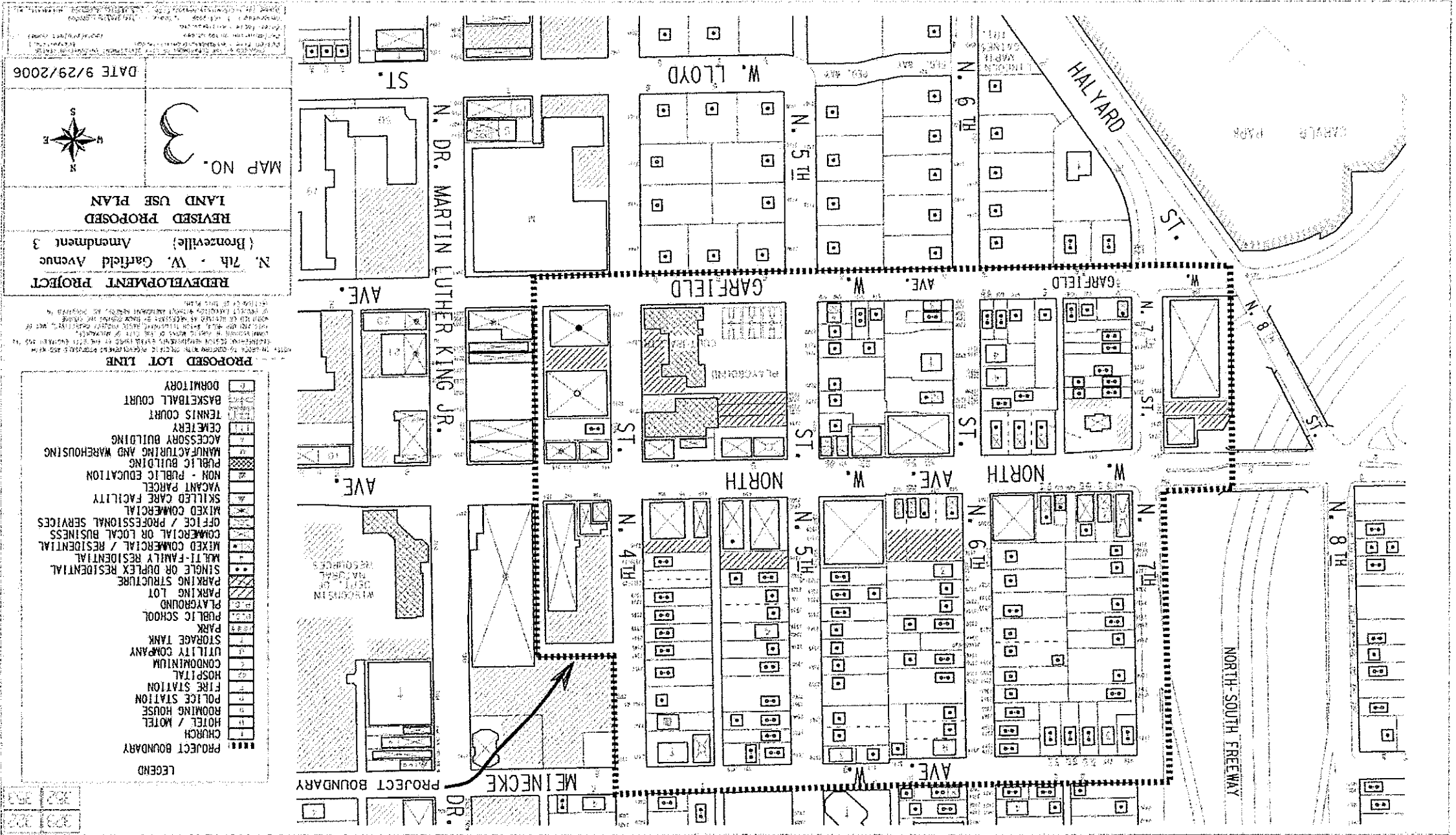

DATE 9/29/2006



MAP NO. 3

REDEVELOPMENT PROJECT  
 (Bronzeville) Amendment 3  
 N. 7th - W. Garfield Avenue  
 REVISIED PROPOSED  
 LAND USE PLAN

PROPOSED LOT LINE

- LEGEND
- PROJECT BOUNDARY
  - CHURCH
  - HOTEL / MOTEL
  - ROOMING HOUSE
  - POLICE STATION
  - FIRE STATION
  - HOSPITAL
  - CONDOMINIUM
  - UTILITY COMPANY
  - STORAGE TANK
  - PARK
  - PUBLIC SCHOOL
  - PLAYGROUND
  - PARKING LOT
  - PARKING STRUCTURE
  - SINGLE OR DUPLEX RESIDENTIAL
  - MULTI-FAMILY RESIDENTIAL
  - MIXED COMMERCIAL / RESIDENTIAL
  - COMMERCIAL OR LOCAL BUSINESS
  - OFFICE / PROFESSIONAL SERVICES
  - MIXED COMMERCIAL
  - SKILLED CARE FACILITY
  - VACANT PARCEL
  - NON - PUBLIC EDUCATION
  - PUBLIC BUILDING
  - MANUFACTURING AND WAREHOUSING
  - ACCESSORY BUILDING
  - CENETERY
  - TENNIS COURT
  - BASKETBALL COURT
  - DORMITORY

303 222  
 302 353

Exhibit "D"

REDEVELOPMENT PROJECT  
N. 7th - W. Garfield Avenue  
(Bronzeville)  
Amendment 3  
REVISED LAND ACQUISITION  
PLAN  
MAP NO. [ ]  
DATE 9/29/2006

- ACQUISITION MAP  
LAND ACQUISITION PLAN  
LEGEND
- 1 BLOCK NUMBERS
  - 2 PARCEL NUMBERS
  - PARCEL TO BE ACQUIRED
  - OWNER-OCCUPIED
  - BACK / CITY OWNED



327	328
329	330

**Map 4**  
**Schedule of Lands and Interests to be Acquired**

BLOCK	PARCEL	OWNER	OWNER MAILING ADDRESS	PARCEL ADDRESS	TAX KEY	INTEREST REQUIRED	BEFORE	AFTER	TAKING
							LOT AREA - SQUARE FEET		
1	1	RUTH A. SMITH	2370 N 7TH ST MILWAUKEE WI 53212	639 to 639 W MEINCKE AV	3230638000	NONE	3,864	3,864	0
1	2	PATSY J CUNNINGHAM	2484 W. LOCUST ST. MILWAUKEE, WI 53206	633 to 633 W MEINCKE AV	3230639100	NONE	5,040	5,040	0
1	3	DENNIS DEIDA	1178 DAHLIA DR. ROYAL PALM BEACH, FL 33411	627 to 629 W MEINCKE AV	3230640000	FEE	5,040	5,040	5,040
1	4	DENNIS DEIDA	1178 DAHLIA DR. ROYAL PALM BEACH, FL 33411	623 to 625 W MEINCKE AV	3230641000	FEE	5,040	5,040	5,040
1	5	JULIA E RILEY	617 W MEINCKE AV MILWAUKEE, WI 53212	617 to 619 W MEINCKE AV	3230642000	NONE	5,640	5,640	0
1	6	LEILA TURNER C/O MCKINLEY HILLS JR	4167 N 51ST BLVD MILWAUKEE WI 53216	2360 to 2362 N 7TH ST	3230643000	NONE	6,000	6,000	0
1	7	IRENE BRANTLEY	2354 N 7TH ST MILWAUKEE WI 53212	2354 to 2354 N 7TH ST	3230644113	NONE	12,000	12,000	0
1	8	IRENE BRANTLEY	2354 N 7TH ST MILWAUKEE WI 53212	2344 to 2344 N 7TH ST	3230646112	NONE	6,000	6,000	0
1	9	MARY L ALBRITTON POB 080041	MILWAUKEE WI 532083135	2338 to 2340 N 7TH ST	3230647000	NONE	6,000	6,000	0
1	10	JOHN HENRY BLANKS & MATTIE M	2332 N 7TH ST MILWAUKEE, WI 53212	2332 to 2332 N 7TH ST	3230648000	NONE	6,000	6,000	0
1	11	KENNETH C HENZLER	2801 N 54TH ST MILWAUKEE, WI 53210	2328 to 2328 N 7TH ST	3230649000	NONE	6,000	6,000	0
1	12	TAVIA L. HORTON	2322 N 7TH ST MILWAUKEE, WI 53212	2322 to 2322 N 7TH ST	3230650000	NONE	6,000	6,000	0
1	13	RICHARD F DREYER & DIANE	1518 S 7TH ST MILWAUKEE WI 53204	2316 to 2318 N 7TH ST	3230651000	NONE	6,000	6,000	0
1	14	LAMONT SMITH	642 W NORTH AV MILWAUKEE, WI 53212	642 to 642 W NORTH AV	3230652000	FEE	4,749	4,749	0
1	15	RALPH H FLEEGE %JBD INVEST AGENCY 233	3506 W NATIONAL AV MILWAUKEE, WI 53215	634 to 636 W NORTH AV	3230653000	NONE	4,830	4,830	0
1	16	FANNIE RYALS ELIZA SYKES	2766 N 13TH ST MILWAUKEE, WI 53206	628 to 630 W NORTH AV	3230654000	NONE	4,830	4,830	0
1	17	CITY OF MILW REDEV AUTH	809 N BROADWAY MILWAUKEE, WI 53202	626 to 626 W NORTH AV	3230655000	FEE	2,414	2,414	0
1	18	CITY OF MILW REDEV AUTH	809 N BROADWAY MILWAUKEE, WI 53202	622 to 622 W NORTH AV	3230656000	FEE	2,021	2,021	0
1	19	CITY OF MILW	809 N BROADWAY MILWAUKEE, WI 53202	616 to 618 W NORTH AV	3230657000	FEE	5,400	5,400	0

**Map 4**  
**Schedule of Lands and Interests to be Acquired**

BLOCK	PARCEL	OWNER	OWNER MAILING ADDRESS	PARCEL ADDRESS	TAX KEY	INTEREST	BEFORE	AFTER	TAKING
1	20	ANNIE LEE WALTON	2307 N 6TH ST MILWAUKEE, WI 53212	2307 to 2309 N 6TH ST	3230659110	FEE	11,500	0	11,500
1	21	BRENDA L BRANTLEY	2728 N 41ST ST MILWAUKEE WI 532102420	2317 to 2325 N 6TH ST	3230661100	FEE	9,876	0	9,876
1	22	CITY OF MILW	809 N BROADWAY MILWAUKEE WI 53202	2327 to 2327 N 6TH ST	3230663100	FEE	8,421	0	8,421
1	23	VERNON FISHER	2333 N 6TH ST MILWAUKEE, WI 53212	2333 to 2333 N 6TH ST	3230664100	NONE	9,900	9,900	0
1	24	ROSHANNA S. CLARK	2351 N 6TH ST MILWAUKEE, WI 53212	2351 to 2351 N 6TH ST	3230668111	NONE	18,150	18,150	0
1	25	CITY OF MILW HOUSING AUTH	809 N BROADWAY MILWAUKEE WI 53203	2355 to 2357 N 6TH ST	3230669000	NONE	6,651	6,651	0
1	26	CITY OF MILW HOUSING AUTH	809 N BROADWAY MILWAUKEE WI 53202	2361 to 2363 N 6TH ST	3230670000	NONE	6,487	6,487	0
1	27	CATHERINE GRIFFIN	2365 N 6TH ST MILWAUKEE, WI 53212	2365 to 2367 N 6TH ST	3230671000	NONE	4,000	4,000	0
1	28	NORRIS ADKINS & EVA ADKINS/LOUIS RUSSELL	2371 N 6TH ST MILWAUKEE WI 53212	2369 to 2371 N 6TH ST	3230672100	NONE	4,000	4,000	0
1	29	LINTON GILL & BEATRICE GILL	2377 N 6TH ST MILWAUKEE WI 53212	2377 to 2379 N 6TH ST	3230673100	NONE	4,000	4,000	0
2	1	WISCONSIN CORRECTIONAL FOUNDATION INC	230 W WELLS ST RM 500 MILWAUKEE WI 53203	2374 to 2374 N 6TH ST	3230677100	NONE	16,029	16,029	0
2	2	JAMEELA ALI	523 W. MEINCKE AVE. MILWAUKEE WI 53212	523 to 523 W MEINCKE AV	3230676000	NONE	2,960	2,960	0
2	3	ANNIE PEARL CLEVELAND	4132 N 26TH ST MILWAUKEE WI 532096618	513 to 513 W MEINCKE AV	3221172100	NONE	2,960	2,960	0
2	4	J W ARMSTEAD ETHEL ARMSTEAD	9337 N JOYCE AVE MILWAUKEE, WI 53224	2379 to 2379 N 5TH ST	3221173000	NONE	2,960	2,960	0
2	5	LEE E LOCKS	2354 N 6TH ST MILWAUKEE WI 53212	2354 to 2356 N 6TH ST	3230680100	NONE	13,600	13,600	0
2	6	ROBERT L ROBERSON	8681 N 63RD ST BROWN DEER, WI 53223	2348 to 2350 N 6TH ST	3230681000	NONE	6,800	6,800	0
2	7	CITY OF MILWAUKEE	809 N BROADWAY MILWAUKEE WI 53202	2344 to 2344 N 6TH ST	3230682000	NONE	3,830	3,830	0
2	8	ROBERSON, ELGIN & EVA M	8681 N 63RD ST BROWN DEER, WI 53223	2344 to 2344B N 6TH ST	3230683000	NONE	2,920	2,920	0
2	9	LAURI J WYNN	8157 W SCRANTON PL MILWAUKEE WI 53218	2338 to 2338 N 6TH ST	3230684000	NONE	6,800	6,800	0



**Map 4**  
Schedule of Lands and Interests to be Acquired

BLOCK	PARCEL	OWNER	OWNER MAILING ADDRESS	PARCEL ADDRESS	TAX KEY	INTEREST	BEFORE	AFTER	TAKING
2	10	CITY OF MILW	809 N BROADWAY MILWAUKEE, WI 53202	2332 to 2334 N 6TH ST	3230685000	NONE	6,696	6,696	0
2	11	ALBERT THOMPSON SYLVIA E THOMPSON	4876 N 50TH ST MILWAUKEE, WI 53218	2328 to 2328 N 6TH ST	3230686000	NONE	6,800	6,800	0
2	12	LONNIE P PATTERSON	1005 HYDE PARK DR MCKINNEY TX 75069	2322 to 2324 N 6TH ST	3230687000	NONE	6,800	6,800	0
2	13	CITY OF MILW REDEV AUTH	809 N BROADWAY MILWAUKEE, WI 53202	2316 to 2316 N 6TH ST	3230688000	FEE	4,990	4,990	0
2	14	CITY OF MILW REDEV AUTH	809 N BROADWAY MILWAUKEE, WI 53202	540 to 540 W NORTH AV	3230690000	FEE	3,384	3,384	0
2	15	CITY OF MILW REDEV AUTH	809 N BROADWAY MILWAUKEE, WI 53202	534 to 534 W NORTH AV	3230691000	FEE	1,829	1,829	0
2	16	CITY OF MILW REDEV AUTH	809 N BROADWAY MILWAUKEE, WI 53212	530 to 532 W NORTH AV	3230692100	FEE	4,493	4,493	0
2	17	CITY OF MILW REDEV AUTH	809 N BROADWAY MILWAUKEE, WI 53202	522 to 522 W NORTH AV	3230689110	FEE	17,068	17,068	0
2	18	SAMUEL J JOHNSON	2039 N 5TH ST MILWAUKEE WI 53212	2307 to 2309 N 5TH ST	3221187000	FEE	5,960	5,960	0
2	19	SAMUEL J JOHNSON	2039 N 5TH ST MILWAUKEE WI 53212	2313 to 2313 N 5TH ST	3221186000	FEE	5,960	5,960	0
2	20	SAMUEL J JOHNSON	2039 N 5TH ST MILWAUKEE WI 53212	2317 to 2319 N 5TH ST	3221185000	FEE	5,960	5,960	0
2	21	SAMUEL J JOHNSON	2039 N 5TH ST MILWAUKEE WI 53212	2323 to 2325 N 5TH ST	3221184000	NONE	5,960	5,960	0
2	22	SAMUEL J JOHNSON	2039 N 5TH ST MILWAUKEE WI 53212	2327 to 2329 N 5TH ST	3221183000	NONE	5,960	5,960	0
2	23	SAMUEL J JOHNSON	2039 N 5TH ST MILWAUKEE WI 53212	2335 to 2335 N 5TH ST	3221182000	NONE	5,920	5,920	0
2	24	NADINE V EATON	2341 N 5TH ST MILWAUKEE, WI 53212	2341 to 2341 N 5TH ST	3221181000	NONE	5,910	5,910	0
2	25	CITY OF MILW HOUSING AUTH	809 N BROADWAY MILWAUKEE WI 53202	2345 to 2345 N 5TH ST	3221180000	NONE	5,887	5,887	0
2	26	JOENETTE D KELLY-KIDD	P O BOX 12051 MILWAUKEE, WI 53212	2351 to 2351 N 5TH ST	3221179000	NONE	5,960	5,960	0
2	27	BETTYE J COLEMAN	2355 N 5TH ST MILWAUKEE WI 53212	2355 to 2355 N 5TH ST	3221178100	NONE	10,360	10,360	0
2	28	CITY OF MILWAUKEE C/O REAL ESTATE	809 N BROADWAY MILWAUKEE WI 53202	2367 to 2367 N 5TH ST	3221176110	NONE	13,222	13,222	0

**Map 4**  
**Schedule of Lands and Interests to be Acquired**

BLOCK	PARCEL	OWNER	OWNER MAILING ADDRESS	PARCEL ADDRESS	TAX KEY	REQUIRED INTEREST	BEFORE	AFTER	TAKING
							LOT AREA - SQUARE FEET		
3	1	NATHANIEL WOOD & JUANITA HW	2376 N 5TH ST MILWAUKEE, WI 532123132	2376 to 2376 N 5TH ST	3221215000	NONE	3,500	3,500	0
3	2	PATRICIA ANN BROWN	4424 WILSON DR #2 SHERWOOD WI 53211	429 to 431 W MEINCKE AV	3221216100	NONE	4,000	4,000	0
3	3	KING SOLOMON BAPTIST CHURCH	PO BOX 72099 MILWAUKEE WI 53212	2375 to 2375 N 4TH ST	3221189100	NONE	12,014	12,014	0
3	4	BRUCE L MARTIN	P O BOX 12372 %MARTIN DEVELOPMENT INC	2370 to 2370 N 5TH ST	3221214000	NONE	4,500	4,500	0
3	5	RICKIE E. LEE	2366 N 5TH ST MILWAUKEE WI 53212	2366 to 2366 N 5TH ST	3221213000	NONE	6,000	6,000	0
3	6	MYRTLE JOHNSON	2360 N 5TH ST MILWAUKEE WI 532123132	2360 to 2362 N 5TH ST	3221212100	NONE	12,000	12,000	0
3	7	GABRIEL L SHAW	3629 N 57TH ST MILWAUKEE, WI 53216	2350 to 2350 N 5TH ST	3221210000	NONE	6,000	6,000	0
3	8	CAMPBELL, LOUIS & RUTH	2344 N 5TH ST MILWAUKEE WI 53212	2344 to 2344 N 5TH ST	3221209000	NONE	6,000	6,000	0
3	9	NICHOLAS C. KALLAS	3007 W. ST. PAUL AVE. MILWAUKEE WI 53208	2338 to 2340 N 5TH ST	3221208000	NONE	6,000	6,000	0
3	10	CITY OF MILW REDEV AUTH	809 N BROADWAY MILW WI 53202	2326 to 2334 N 5TH ST	3221207100	FEE	12,014	0	12,014
3	11	ADELBEKE MIYODE	2322 N 5TH ST MILWAUKEE WI 53212	2322 to 2322 N 5TH ST	3221203000	NONE	6,000	6,000	0
3	12	SUNG & YOUNG LLC	430 W NORTH AVE. MILWAUKEE WI 53212	2318 to 2320 N 5TH ST	3221202000	NONE	6,000	6,000	0
3	13	SUNG & YOUNG LLC	430 W NORTH AVE. MILWAUKEE WI 53212	430 to 430 W NORTH AV	3221201000	NONE	18,000	18,000	0
3	14	BACHAN SINGH	4455 ACREVIEW CT BROOKFIELD WI 53005	408 to 418 W NORTH AV	3221200100	NONE	18,000	18,000	0
3	15	BACHAN SINGH	4455 ACRE VIEW CT BROOKFIELD WI 53005	2319 to 2321 N 4TH ST	3221198000	NONE	6,000	6,000	0
3	16	CITY OF MILW	809 N BROADWAY MILWAUKEE, WI 53202	2323 to 2325 N 4TH ST	3221197000	NONE	6,015	6,015	0
3	17	WILLIE P HILL	2801 N 41ST ST BELVELYN BROWN	2329 to 2331 N 4TH ST	3221196000	NONE	6,000	6,000	0
3	18	WILLIE P HILL	2351 N 4TH ST BELVELYN BROWN ET AL	2335 to 2335 N 4TH ST	3221195000	NONE	6,000	6,000	0

**Map 4**  
**Schedule of Lands and Interests to be Acquired**

BLOCK	PARCEL	OWNER	OWNER MAILING ADDRESS	PARCEL ADDRESS	TAX KEY	REQUIRED INTEREST	BEFORE	AFTER	LOT AREA - SQUARE FEET
		DOROTHY L JONES	2339 N 4TH ST MILWAUKEE WI 53212	2339 to 2341 N 4TH ST	3221194000	NONE	6,000	6,000	0
3	19	WILLIE P HILL	2345 N 4TH ST MILWAUKEE, WI 53212	2345 to 2347 N 4TH ST	3221193000	NONE	6,000	6,000	0
3	20	BELVERLYN BROWN	2801 N 41ST ST MILWAUKEE WI 53210	2351 to 2351 N 4TH ST	3221192100	NONE	9,000	9,000	0
3	21	C P & CARRIE & WILLIE BROWN	2361 N 4TH ST MILWAUKEE, WI 53212	2361 to 2363 N 4TH ST	3221190100	NONE	9,000	9,000	0
3	22	EUGENE J GORMAN	2367 N 4TH ST MILWAUKEE, WI 53212	2367 to 2367 N 4TH ST	3221189200	NONE	6,002	6,002	0
3	23	MILWAUKEE THEOLOGICAL INSTITUTE	5380 S 13TH ST MILWAUKEE WI 532213608	324 to 332 W NORTH AV	3221232000	NONE	42,000	42,000	0
4	4	MERCANTILE THRIFT STORES INC DBA VALUE VILLAGE	430 W NORTH AVE. MILWAUKEE WI 53212	338 to 338 W NORTH AV	3221233000	NONE	6,000	6,000	0
5	5	MILWAUKEE COUNTY REGISTER OF DEEDS	901 N 9TH ST MILWAUKEE, WI 53233	2243 to 2243 N 7TH ST	3520611200	FEE	2,819	2,819	0
5	2	MILWAUKEE COUNTY REGISTER OF DEEDS	901 N 9TH ST MILWAUKEE, WI 53233	2237 to 2237 N 7TH ST	3520614110	FEE	4,734	4,734	0
5	3	PMG HOLDINGS INC	N11 W24600 SILVERMAIL RD PEWAUKEE, WI 530725599	2233 to 2233 N 7TH ST	3520615000	FEE	4,950	4,950	0
5	4	CITY OF MILW REDEV AUTH	809 N BROADWAY MILWAUKEE, WI 53202	2225 to 2225 N 7TH ST	3520618100	FEE	12,450	12,450	0
5	5	CITY OF MILW REDEV AUTH	809 N BROADWAY MILWAUKEE, WI 53202	708 to 708 W GARFIELD AV	3520619100	FEE	22,451	22,451	0
6	6	J B PROPERTIES LTD PTRNSHP CO VICKY CHIN, ACCTG	1903 STANLEY GAULT PK LOUISVILLE, KY 40223	637 to 637 W NORTH AV	3520593123	NONE	34,409	34,409	0
6	2	PAUL M BACHOWSKI	2831 N 1ST ST MILWAUKEE, WI 53212000	2228 to 2228 N 7TH ST	3520597000	NONE	3,750	3,750	0
6	3	PAUL M BACHOWSKI	2831 N 1ST ST MILWAUKEE, WI 53212000	2224 to 2224 N 7TH ST	3520598000	NONE	3,750	3,750	0
6	4	LUCILLE JACKSON	2220 N 7TH ST MILWAUKEE, WI 53205	2220 to 2220 N 7TH ST	3520599100	NONE	7,500	7,500	0
6	5	CITY OF MILW REDEV AUTH	809 N BROADWAY ST MILWAUKEE WI 53202	2214 to 2214 N 7TH ST	3520601000	FEE	3,759	3,759	0
6	6	PAUL M BACHOWSKI	2831 N 1ST ST MILWAUKEE, WI 53212000	2208 to 2210 N 7TH ST	3520602000	NONE	3,900	3,900	0

**Map 4**  
Schedule of Lands and Interests to be Acquired

BLOCK	PARCEL	OWNER	OWNER MAILING ADDRESS	PARCEL ADDRESS	TAX KEY	REQUIRED INTEREST	BEFORE	AFTER	TAKING
6	7	J E D INVESTMENT CORP	3506 W NATIONAL AVE MILWAUKEE, WI 53215	634 to 642 W GARFIELD AV	3520604000	NONE	3,750	3,750	0
6	8	OLGA GELFAND	632 W GARFIELD MILWAUKEE WI 53212	632 to 632 W GARFIELD AV	3520605000	NONE	2,000	2,000	0
6	9	RALPH EDWARD & MARGARET L HOLTMAN HW	3281 N 46TH ST MILWAUKEE WI 53216	626 to 626 W GARFIELD AV	3520606100	NONE	5,350	5,350	0
6	10	DENISE R BOWENS	653 PRINCESS CR LITHIA SPRINGS GA 30122	616 to 616 W GARFIELD AV	3520607000	NONE	10,000	10,000	0
6	11	DAISY O ECHOLS	4136 N 13TH ST MILWAUKEE WI 53209	610 to 610 W GARFIELD AV	3520135100	NONE	6,000	6,000	0
6	12	LESLIE A KAISER/ANNEMARIE KAISER	606 W GARFIELD AVE MILWAUKEE WI 53212	606 to 606 W GARFIELD AV	3520134000	NONE	2,700	2,700	0
6	13	DELORES TOOLS	600 W GARFIELD AVE MILWAUKEE WI 53212	600 to 602 W GARFIELD AV	3520133000	NONE	2,700	2,700	0
6	15	CITY OF MILWAUKEE	809 N BROADWAY MILWAUKEE WI 53202	2223 to 2225 N 6TH ST	3520131000	NONE	6,014	6,014	0
6	16	PAUL M BACHOWSKI	2831 N 1ST ST MILWAUKEE, WI 53212000	2229 to 2233 N 6TH ST	3520130100	NONE	8,500	8,500	0
6	17	CITY OF MILWAUKEE C/O CITY REAL ESTATE	809 N BROADWAY MILWAUKEE WI 53202	2217 to 2219 N 6TH ST	3520132000	NONE	6,596	6,596	0
7	1	ROLLER ENTERPRISES LLC	525 W NORTH AV MILWAUKEE, WI 53212	521 to 535 W NORTH AV	3520110100	NONE	14,925	14,925	0
7	2	LOUIS CAMPBELL & RUTH HW	2344 N 5TH ST MILWAUKEE, WI 53212	517 to 519 W NORTH AV	3530231110	FEE	6,150	6,150	0
7	3	PAUL M BACHOWSKI	2831 N 1ST ST MILWAUKEE, WI 53212000	507 to 507 W NORTH AV	3530232000	NONE	1,850	1,850	0
7	4	A J WILSON	7870 N PT WASHINGTON CT FOX POINT WI 53217	501 to 503 W NORTH AV	3530234000	NONE	1,575	1,575	0
7	5	TRUMP THE CHURCH & KINGDOM OF GOD IN CHRIST	POB 12105 MILWAUKEE WI 53213111	2232 to 2234 N 6TH ST	3520109000	FEE	10,790	10,790	0
7	6	TRUMP THE CHURCH & KINGDOM OF GOD IN CHRIST	PO BOX 12105 MILWAUKEE WI 53212	2222 to 2222 N 6TH ST	3520108110	NONE	16,242	16,242	0
7	7	EMMA MURRY CHILD CARE CENTER	P.O. BOX 12105 MILWAUKEE WI 53212	2200 to 2202 N 6TH ST	3520103100	NONE	2,400	2,400	0
7	8	GLORIOUS MALONE	1415 W LARKSPUR LN RIVER HILLS, WI 53217	2204 to 2206 N 6TH ST	3520102000	NONE	2,600	2,600	0
7	9	SANDRA K WILLIAMS	518 W GARFIELD AV MILWAUKEE, WI 53212	518 to 518 W GARFIELD AV	3530247000	NONE	3,230	3,230	0