



**CITY OF MILWAUKEE
OFFICE OF THE CITY CLERK**

Thursday, February 02, 2017

COMMITTEE MEETING NOTICE

AD 06

ALKHATIB, Nizar Y, Agent
Midget Food LLC
2500 N Booth St

Milwaukee, WI 53212

You are requested to attend a hearing which is to be held in Room 301-B, Third Floor, City Hall on:

Tuesday, February 14, 2017 at 10:30 AM

Regarding: Your Class A Malt and Food Dealer License Applications as agent for "Midget Food LLC" for "Midget Food" at 2500 N Booth St.

There is a possibility that your application may be denied for one or more of the following reasons: The recommendation of the committee regarding the application shall be based on evidence presented at the hearing. Per MCO 85-2.7-4, probative evidence concerning whether or not a new license should be granted may be presented on the following subjects: whether or not the applicant meets the municipal requirements, the appropriateness of the location and premises where the licensed premises is to be located and whether use of the premises for the purposes or activities permitted by the license would tend to facilitate a public or private nuisance or create undesirable neighborhood problems such as disorderly patrons, unreasonably loud noise, litter, and excessive traffic and parking congestion. Probative evidence relating to these matters may be taken from the plan of operation submitted with the license application, if any, but shall not include the content of any music. Evidence regarding the fitness of the location of the premises to be maintained as the principal place of business, including but not limited to whether there is an overconcentration of businesses of the type for which the license is sought; whether the proposal is consistent with any pertinent neighborhood business or development plans, or the location's proximity to areas where children are typically present. The applicant's record in operating similarly licensed premises; and whether or not the applicant has been charged with or convicted of any felony, misdemeanor, municipal offense or other offense, the circumstances of which substantially relate to the activity to be permitted by the license being applied for or any other factor which reasonably relates to the public health, safety or welfare may also be considered. See attached police report or correspondence.

Notice for applicants with warrants or unpaid fines:

Proof of warrant satisfaction or payment of fines must be submitted at the hearing on the above date and time. Failure to comply with this requirement may result in a delay of the granting/denial of your application.

Failure to appear at this meeting may result in the denial of your license. Individual applicants must appear only in person or by an attorney. Corporate or Limited Liability applicants must appear only by the agent designated on the application or by an attorney. Partnership applicants must appear by a partner listed on the application or by an attorney. If you wish to do so and at your own expense, you may be accompanied by an attorney of your choosing to represent you at this hearing.

You will be given an opportunity to speak on behalf of the application and to respond and challenge any charges or reasons given for the denial. No petitions can be accepted by the committee, unless the people who signed the petition are present at the committee hearing and willing to testify. You may present witnesses under oath and you may also confront and cross-examine opposing witnesses under oath. If you have difficulty with the English language, you should bring an interpreter with you, at your expense, so that you can answer questions and participate in your hearing.

You may examine the application file at this office during regular business hours prior to the hearing date. Inquiries regarding this matter may be directed to the person whose signature appears below.

Limited parking for persons attending meetings in City Hall is available at reduced rates (5 hour limit) at the Milwaukee Center on the southwest corner of East Kilbourn and North Water Street. Parking tickets must be validated in the first floor information booth in City Hall.

PLEASE NOTE: Upon reasonable notice, efforts will be made to accommodate the needs of disabled individuals through sign language interpreters or other auxiliary aids. For additional information or to request this service, contact the Council Services Division ADA Coordinator at (414) 286-2998, Fax - (414) 286-3456, TDD - (414) 286-2025.

JIM OWCZARSKI, CITY CLERK

BY:

Jason Schunk

License Division Manager

If you have questions regarding this notice, please contact the License Division at (414) 286-2238.

200 E. Wells Street, Room 105, City Hall, Milwaukee, WI 53202. www.milwaukee.gov/license
Phone: (414) 286-2238 Fax: (414) 286-3057 Email Address: License@milwaukee.gov



**CITY OF MILWAUKEE
OFFICE OF THE CITY CLERK**

Thursday, February 02, 2017

COMMITTEE MEETING NOTICE

AD 06

ALKHATIB, Nizar Y, Agent
Midget Food LLC
1723 S 2nd St

Milwaukee, WI 53204

You are requested to attend a hearing which is to be held in Room 301-B, Third Floor, City Hall on:

Tuesday, February 14, 2017 at 10:30 AM

Regarding: Your Class A Malt and Food Dealer License Applications as agent for "Midget Food LLC" for "Midget Food" at 2500 N Booth St.

There is a possibility that your application may be denied for one or more of the following reasons: The recommendation of the committee regarding the application shall be based on evidence presented at the hearing. Per MCO 85-2.7-4, probative evidence concerning whether or not a new license should be granted may be presented on the following subjects: whether or not the applicant meets the municipal requirements, the appropriateness of the location and premises where the licensed premises is to be located and whether use of the premises for the purposes or activities permitted by the license would tend to facilitate a public or private nuisance or create undesirable neighborhood problems such as disorderly patrons, unreasonably loud noise, litter, and excessive traffic and parking congestion. Probative evidence relating to these matters may be taken from the plan of operation submitted with the license application, if any, but shall not include the content of any music. Evidence regarding the fitness of the location of the premises to be maintained as the principal place of business, including but not limited to whether there is an overconcentration of businesses of the type for which the license is sought; whether the proposal is consistent with any pertinent neighborhood business or development plans, or the location's proximity to areas where children are typically present. The applicant's record in operating similarly licensed premises, and whether or not the applicant has been charged with or convicted of any felony, misdemeanor, municipal offense or other offense, the circumstances of which substantially relate to the activity to be permitted by the license being applied for or any other factor which reasonably relates to the public health, safety or welfare may also be considered. See attached police report or correspondence.

Notice for applicants with warrants or unpaid fines:

Proof of warrant satisfaction or payment of fines must be submitted at the hearing on the above date and time. Failure to comply with this requirement may result in a delay of the granting/denial of your application.

Failure to appear at this meeting may result in the denial of your license. Individual applicants must appear only in person or by an attorney. Corporate or Limited Liability applicants must appear only by the agent designated on the application or by an attorney. Partnership applicants must appear by a partner listed on the application or by an attorney. If you wish to do so and at your own expense, you may be accompanied by an attorney of your choosing to represent you at this hearing.

You will be given an opportunity to speak on behalf of the application and to respond and challenge any charges or reasons given for the denial. No petitions can be accepted by the committee, unless the people who signed the petition are present at the committee hearing and willing to testify. You may present witnesses under oath and you may also confront and cross-examine opposing witnesses under oath. If you have difficulty with the English language, you should bring an interpreter with you, at your expense, so that you can answer questions and participate in your hearing.

You may examine the application file at this office during regular business hours prior to the hearing date. Inquiries regarding this matter may be directed to the person whose signature appears below.

Limited parking for persons attending meetings in City Hall is available at reduced rates (5 hour limit) at the Milwaukee Center on the southwest corner of East Kilbourn and North Water Street. Parking tickets must be validated in the first floor information booth in City Hall.

PLEASE NOTE: Upon reasonable notice, efforts will be made to accommodate the needs of disabled individuals through sign language interpreters or other auxiliary aids. For additional information or to request this service, contact the Council Services Division ADA Coordinator at (414) 286-2998, Fax - (414) 286-3456, TDD - (414) 286-2025.

JIM OWCZARSKI, CITY CLERK

BY:

Jason Schunk
License Division Manager

If you have questions regarding this notice, please contact the License Division at (414) 286-2238.

200 E. Wells Street, Room 105, City Hall, Milwaukee, WI 53202. www.milwaukee.gov/license
Phone: (414) 286-2238 Fax: (414) 286-3057 Email Address: License@milwaukee.gov

Date: 12/31/2016
Officer: P.O. Ciano

City of Milwaukee Police Department
90-5-1.5 Crime Prevention Survey
Convenience Store/Liquor Store Inspection

Name of Premise: Midget Foods LLC
Address: 2500 N Booth St
Phone: 414-264-7409

Owner:
Owner address:
City State Zip:
Owner Phone:
Owner email:

Manager: Alkhatib Y Nizar
Home Address: 1723 S 2nd St
City State Zip: Milwaukee, WI 53204
Phone: 414-745-2151
Email: nizdog2000@yahoo.com

Preferred contact: 414-264-7409

Location currently open: YES NO

Projected open date:

Day's open: S M T W Th F SA ALL

Hours of Operation: Sun: 9 am – 9 pm 24 hours Y N
Mon: “
Tue: “
Wed: “
Thu: “
Fri: “
Sat: “

Premise Type: Liquor Store
Convenience Store
Other:

Licenses currently held:

- Alcohol: Yes No Class: #:
Tobacco: Yes No #:
Food: Yes No #:
Extended Hours: Yes No #:
Secondhand Dealer: Yes No Type: #:
Other: Yes No Type: #:
Other: Yes No Type: #:

Who is your alcohol distributor?

Exterior Survey:

1. Is the area around the location clean? Yes No
2. What surrounds the location? (Check all the apply)
 - a. Park
 - b. School
 - c. Youth Center
 - d. Church
 - e. Tavern(s) If so, how many
 - f. Residential
 - g. Other businesses
 - h. Other:
3. Can you see from the outside of the location into the interior Yes No
4. Can you see the employees inside of the location from the outside Yes No
5. Are exterior windows free of signage Yes No
6. Is there a parking lot Yes No
7. Is the parking lot clean? Yes No
8. Is the parking lot well lit? Yes No
9. Are there areas where a person could conceal themselves Yes No
10. Is there exterior lighting? Yes No. Does it appears to be adequate Yes No
11. Exterior Payphone? Yes No
12. Are there No Loitering Signs posted? Yes No
13. Are there exterior security cameras Yes No How Many:
14. Are the address numbers prominently displayed and easy to see Yes No

Camera Survey:

15. Does this location have security cameras? Yes No
16. Are they in working order? Yes No
17. What format are the cameras?
 - a. Color Yes No
 - b. Digital Yes No
 - c. VCR Yes No
 - d. Recorded Yes No
18. How long is footage stored for later viewing: 30 days
19. Are there exterior cameras Yes No How many:
20. Are there interior cameras Yes No How many: 1

21. Do all employees know how to retrieve recorded digital images/footage? Yes No

Interior Survey:

22. Is the storeowner willing to be a standing complainant regarding loitering? Yes No
a. If yes have them fill out the standing complaint form and give them two of the commercial signs Yes No
23. Is the interior of the location neat and clean? Yes No
24. Does an interior camera face the entrance/exit? Yes No
25. Is there a lockable area that separates employees from customers? Yes No
26. Does the store sell single chore boy? Yes No
27. Does the store sell blunt wraps? Yes No
28. Does the store sell scales? Yes No
29. Does the store sell items that may be used as crack pipes? Yes No
a. Describe item N/A
30. Does the store have an over abundance of sandwich baggies: Yes No
31. Does the owner understand that these items are often used for drug use? Yes No
32. Do the products in the store appear to be new and rotated often? Yes No
33. Are emergency and non-emergency numbers posted near the phone? Yes No
34. Does the owner know how to contact their police district directly? Yes No
a. Did you provide a district contact guide to the owner? Yes No

Complete this section if alcohol establishment is a convenience store:

(** Read full ordinance for all details "68-55 Convenience Food Stores")

All convenience food stores not exempted under sub. 3 shall:

1. Is the cash register located in a manner so that at the time of a sales transaction, the employee and customer are both visible from the sidewalk? Yes No **
2. Are the glass entrance and exit doors clear of any signs or advertisements with the exception of a sign which states that the cash register contains \$50 or less and that the safe is no accessible to employees? Yes No
3. Does the store maintain one of the following on the licensed premise:
 - a. A safe that was in use at the convenience food store on August 17, 1994? Yes No
 - b. A drop-safe or time release safe that weighs at least 500 pounds or which is attached to or set into the floor in a manner approved by the police department? Yes No
4. Is lighting provided for the store's parking area during all hours of darkness when employees or customers are on the premises at a minimum average of 2-foot candles per square foot, unless the store is not open for business after sunset and before sunrise? Yes No N/A
5. Are at least two high-resolution surveillance security cameras installed? Yes No
6. Are the security cameras in working order? Yes No
7. Does one camera show an overall view of the counter and register area? Yes No
8. Does one camera show a clear, identifiable, full frame image of the face of each person entering and leaving the store? Yes No
9. Are the camera views obstructed by fixtures or displays? Yes No

10. Is the recorded footage stored for at least 30 days? Yes No
11. Do all store employees know how to record footage from the camera system to media capable of being transferred to police custody? Yes No
12. Are customer entrances/exits made of glass or other transparent material? Yes No
- a. Exception: A store that does not have such doors on August 17, 1994 shall not be required to install such doors until the holder of the store's food dealer license changes.
13. Has the owner and their employees attended the Robbery Prevention Training within 120 days of ownership or employment? Yes No
- a. Contact Community Outreach and Education at 935-7836 for schedule.

Sub 3. Exemptions. The requirements of this section do not apply to a convenience food store that conforms to either of the following descriptions:

- a-1. The store is located in an enclosed shopping structure, enclosed commercial building or hospital. A convenience food store is not in an enclosed structure or building if a customer can enter it directly from the outside.
Does store conform to a-1 Yes No
- a-2. The store physically separates employees from customers with a solid partition that bars a person from entering the employee area from the customer area, has a secure lock on the employee side of any door between the employee area and the customer, and conducts all transaction through a service window or similar arrangement.
Does store conform to a-2 Yes No
- a. At the commissioner's discretion, a convenience store may be exempted from any or all of the regulations specified in sub 2.
Does this location hold an exemption from the commissioner regarding any of the requirements of Sub 2? Yes No

ADDITIONAL COMMENTS/RECOMMENDATIONS:

Add additional security cameras

**MILWAUKEE POLICE DEPARTMENT
LICENSE INVESTIGATION UNIT**

**CRIMINAL RECORD/ORDINANCE VIOLATION/INCIDENTS
SYNOPSIS**

DATE: 04/14/2016

LICENSE TYPE: CLASS A LIQUOR MALT

NEW:

RENEWAL: X

No. 228430

Application Date: 04/14/2016

Expiration Date:

License Location: 2500 N. Booth Street

Aldermanic District: 03

Business Name: Midget Foods

Licensee/Applicant: KAUR, JASVIR

(Last Name, First Name, MI)

Date of Birth: 01/01/1959

Male:

Female: X

Home Address: 2040 w Jonathan Drive

City: Oak Creek

State: WI

Zip Code: 53154

Home Phone: (414) 771-5278

This report is written by Police Officer Gilbert Gwinn, assigned to the License Investigation Unit, Days.

The Milwaukee Police Department's investigation regarding this application revealed the following:

1. On 3-15-03, Police officers, with an underage police aide conducted a premises check at Rainbow Foods, 1433 W North Avenue. The applicant is the licensee at that premises. The police aide, who is under 21 years of age entered the store, and purchased a 12 pack of MGD Beer from the cashier. The cashier told officers he thought the guy he sold the beer to looked older than 21.

Citation issued to the cashier,

Charge: Sale to Underage person
Finding: guilty
Sentence: fined \$150.00
Date: 5-8-03
Case: 03059924
Citation: 58003864

2. On 10-29-03, police officers, with an underage police aide, conducted a premises check at Holton Liquor, 2305 N Holton Avenue. The applicant is the licensee of that premises. The police aide purchased a 6 pack of 16 oz. Budweiser beer from the cashier. This was witnessed by one of the officers. The cashier was unable to locate her Class D Bartender license.

Continued on page #2

The cashier was issued the following

Charge: 1. Sale to Underage
2. Class D license required
Finding: 1. Guilty 2. Dismissed
Sentence: fined \$125.00
Date: 2-20-04
Case: 01363664 01363665
Citation: 58328756 58328771

The licensee was issued the following

Charge: Licensee Responsibility
Finding: guilty
Sentence: fined \$100.00
Date: 6-10-04
Case: 03163663
Citation: 58328782

-
3. On 5-27-04, Police officers, accompanied by an underage police aide, conducted a premises check at Holton Liquor, 2305 N Holton Street. The police aide entered the premises and was asked for an ID. She gave the cashier her ID. The clerk looked at it for a long time, and then sold the police aide a 12 pack of "Milwaukee's Best Ice".

The licensee was issued the following,

Charge: Sale to Underage – licensee
Finding: guilty
Sentence: fined \$100.00
Date: 7-22-04
Case: 04072817
Citation: 58604022

The cashier was issued the following

Charge: Sale to Underage
Finding: guilty
Sentence: fined \$100.00
Date: 7-22-04
Case: 04072855
Citation: 58576140

4. On 07/19/2014 a 16 year old, working in conjunction with Milwaukee police, was able to purchase a Black and Mild brand cigar from the cashier, Gursharan Singh, at 2500 North Booth Street (Midget Foods). The applicant was cited.

Charge: Sale of Cigarettes to Minor/Underage
Finding: Guilty
Sentence: \$260.00 fine
Date: 09/05/2014
Case: 14054165

=====
Previous premise

Alcohol Concentration for 2500 N Booth St

City of Milwaukee, Wisconsin

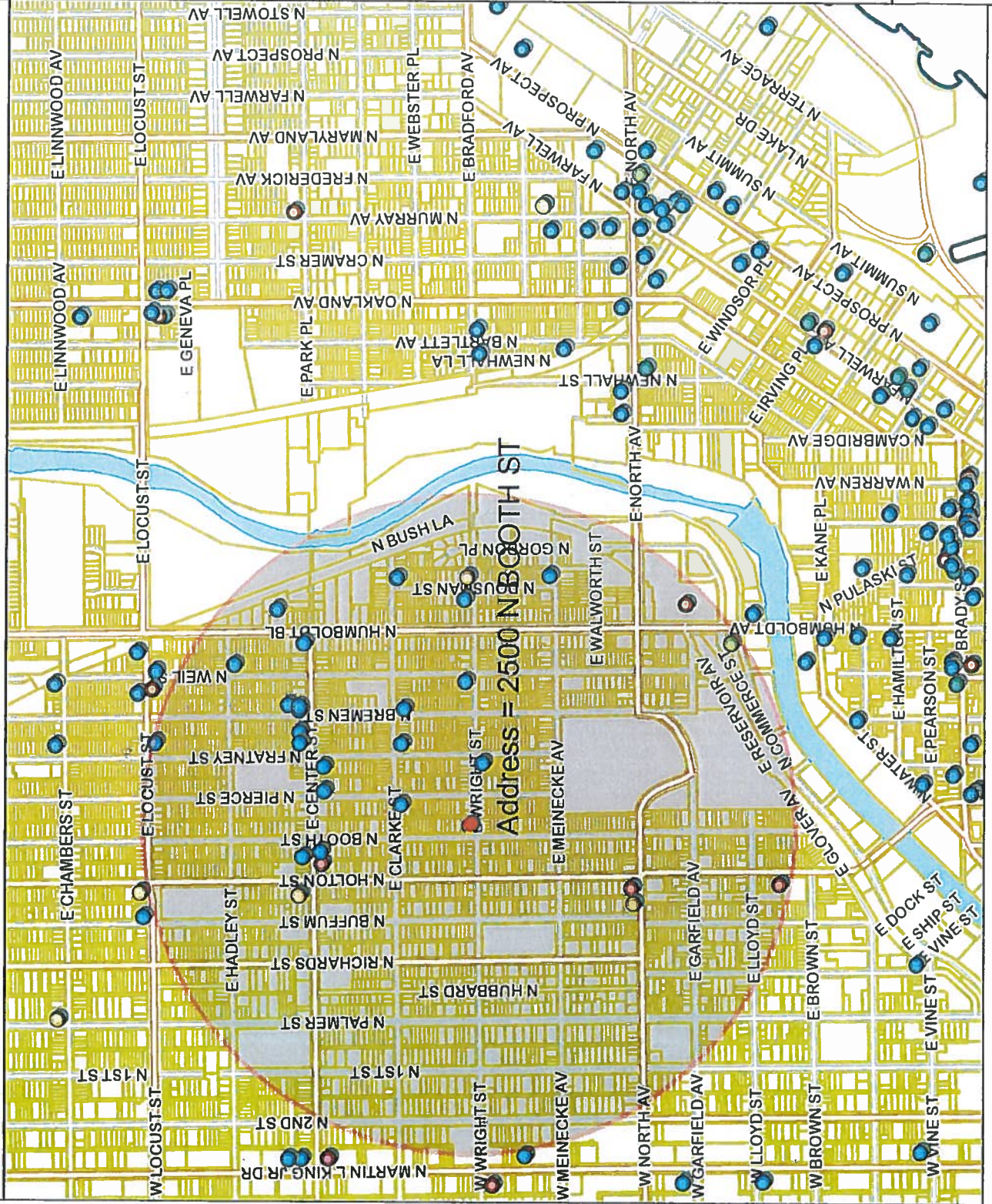

- Legend -

- City limits
- Parcels
- Freeways
- Freeways
- Exit ramps
- Entry ramps
- Ramps
- Major streets
- Streets
- Waterways
- Alcohol licenses
 - Class A intoxicating liquor
 - Class A fermented malt beverage
 - Class A liquor and malt
 - Class B fermented malt beverage
 - Class B tavern
 - Class C wine retailer

- Notes -

Alcohol establishments within a .5 mile radius centered on 2500 N Booth St on November 18, 2016



Department of Administration - ITMD



Map Scale: 1: 13,659

© City of Milwaukee, Wisconsin
 Map Milwaukee: Property Information
 11/18/2016
 Disclaimer

Licensed Alcohol Beverage Establishments within a .5 Mile Radius Centered on 2500 N Booth St, November 18, 2016													Total
License Summary													Total
Class A Fermented Malt Beverage Retailer's License													5
Class A Malt & Class A Liquor License													4
Class A Retailer's Intoxicating Liquor License													1
Class B Fermented Malt Beverage Retailer's License													1
Class B Tavern License													21
Class C Wine Retailer's License													1
Grand Total													33
Legal entity	Trade name	Licensee	License type name	Room capacity	Total capacity	Address	License type	Expiration date					
Bayan & G LLC	Sunny Days Food Mart	Mohammad A Alawneh, Agt	Class A Fermented Malt Beverage Retailer's License			2500 N DOUJSMAN ST	AMALT	1/9/2017					
KRAYEM, INC	QUICK STOP FOODS	MOHAMMAD EL-HASSAN, Agt	Class A Fermented Malt Beverage Retailer's License			416 E NORTH AV	AMALT	11/23/2016					
Loves Supermarket II LLC	Loves Supermarket	HARINDER S BRACHI, Agt	Class A Fermented Malt Beverage Retailer's License			418 E CENTER ST	AMALT	11/26/2017					
MIDGET FOODS	MIDGET FOODS	JASVIR KAUR, SP	Class A Fermented Malt Beverage Retailer's License			2500 N BOOTH ST	AMALT	6/30/2017					
Tabria LLC	Sunny Days Foods	MOHAMMAD EL-HASSAN, Agt	Class A Fermented Malt Beverage Retailer's License			2500 N DOUJSMAN ST	AMALT	7/26/2017					
Center Street Liquor Store Inc	Center Street Liquor Store	Charanjit Kaur, Agt	Class A Malt & Class A Liquor License			513 E Center St	ALQML	12/16/2016					
Holton Liquor & Food	Holton Liquor & Food	MOHAMMAD T NAZER, Agt	Class A Malt & Class A Liquor License			2301 N Holton St	ALQML	5/17/2017					
MEGA MARTS, LLC	PICK 'N SAVE #6882	Donald R Kosiboski, Agt	Class A Malt & Class A Liquor License			1100 E GARFIELD AV	ALQML	2/5/2017					
Pueblo Foods & Liquor, Inc	Pueblo Foods & Liquor	GURINDER S MAGRA, Agt	Class A Malt & Class A Liquor License			2029-31 N HOLTON ST	ALQML	7/23/2017					
MIDGET FOODS	MIDGET FOODS	JASVIR KAUR, SP	Class A Retailer's Intoxicating Liquor License			2500 N BOOTH ST	ALQR	6/30/2017					
Beau Chalet, LLC	Beefline Cafe	Michael G Allen, Agt	Class B Fermented Malt Beverage Retailer's License			2076 N COMMERCE ST	BBEER	9/3/2017					
Club 99	Club 99	GEORGE LORTIZ, SP	Class B Tavern License	54		2579 N Pierce St	BTAVN	3/2/2017					
Company Brewing LLC	Company Brewing	George D Bregar, Agt	Class B Tavern License	150		735 E Center St	BTAVN	2/26/2017					
Falcon Bowl	Falcon Bowl	R Lynn Okopinski, SP	Class B Tavern License	220		801 E Clarke St	BTAVN	6/30/2017					
Fly By Night LLC	High Dive	JASON R MC BRADY, Agt	Class B Tavern License			701 E Center St	BTAVN	7/21/2017					
FOUNDATION BAR, INC	THE FOUNDATION	CHARLES JORDAN, Agt	Class B Tavern License	80		2718 N BREMEN ST	BTAVN	5/8/2017					
FUEL CAFE, INC	FUEL CAFE	SCOTT M JOHNSON, Agt	Class B Tavern License	49		818 E CENTER ST	BTAVN	10/6/2017					
GEE WILLICKERS	GEE WILLICKERS	RANDY L LANGLOIS, SP	Class B Tavern License	25		2578 N DOUJSMAN ST	BTAVN	1/23/2017					
Heifess Lounge & Networking Cafe Inc	Heifess Lounge & Networking Cafe	MARCUS C SHAW, Agt	Class B Tavern License	49		906 E Center St	BTAVN	1/20/2017					
ILLUMINATI, LLC	BREMEN CAFE	DAVID A KOPP, Agt	Class B Tavern License	80		901 E CLARKE ST	BTAVN	12/10/2016					
KISMAVO, LLC	CLUB TIMBUKTU	YOUSSOUF KOMARA, Agt	Class B Tavern License	160		520 E CENTER ST	BTAVN	6/30/2017					
METRO ENTERPRISES, INC	QUARTERS	DANIEL FISCHER, Agt	Class B Tavern License	80		900 E CENTER ST	BTAVN	12/10/2016					
MONDO BROTHERS MARKET, LLC	Milwaukee Beer Bistro	RUSSELL R DAVIS, Agt	Class B Tavern License	198	West Dining Room	2730 N HUMBOLDT BL	BTAVN	2/9/2017					
NESSUN DORMA, LLC	NESSUN DORMA	DEAN M CANNISTRA, Agt	Class B Tavern License	47		2778 N WEIL ST	BTAVN	9/23/2017					
Riverwest Public House Cooperative	Riverwest Public House Cooperative	Shawn D Hutchens, Agt	Class B Tavern License	49		932 E WRIGHT ST	BTAVN	12/9/2016					
THE GIG	THE GIG	BARRY LEWIS, SP	Class B Tavern License	80		815 E LOCUST ST	BTAVN	2/28/2017					
THE MAD PLANET, INC	THE MAD PLANET	ROSEMARY S SLAGY, Agt	Class B Tavern License	100		1132 E WRIGHT ST	BTAVN	2/5/2017					
THE SQUIRREL CAGE	THE SQUIRREL CAGE	PATRICIA L ULIK, SP	Class B Tavern License	299		533 E CENTER ST	BTAVN	6/30/2017					
TWO PS IN A POD, INC	CENTRO CAFE	MARGARET M KARPFFINGER, Agt	Class B Tavern License	25		2402 N DOUJSMAN ST	BTAVN	6/30/2017					
UPTOWNER	UPTOWNER	STEPHEN A JOHNSON, SP	Class B Tavern License	40		808 E CENTER ST	BTAVN	9/30/2017					
Veggas Pub	Veggas Pub	Craig A Pape, SP	Class B Tavern License	99		1032 E CENTER ST	BTAVN	2/13/2017					
Beau Chalet, LLC	Beefline Cafe	Michael G Allen, Agt	Class C Wine Retailer's License			2479 N FRATNEY ST	BTAVN	4/8/2017					
						2076 N COMMERCE ST	CWINE	9/3/2017					



Thursday, February 02, 2017

Licenses Committee Notice of Hearing

Kenneth Kmet
PO Box 12683

Milwaukee, WI 53212

Date: 2/14/2017
Time: 10:30 AM
Location: Room 301-B, Third Floor, City Hall

The Licenses Committee will consider the following license application:

Class A Malt and Food Dealer License Applications
ALKHATIB, Nizar Y, Agent
Midget Food at 2500 N Booth St

Please note this application may be recommended for denial based on fitness of the location due to concentration of alcohol beverage outlets in the area. If the application is denied for this reason, no other application for an alcohol beverage license for this location shall be recommended for approval by the Licenses Committee within three years of the date of denial unless the applicant has demonstrated a change of circumstances since the prior denial.

If you have any questions, please call (414) 286-2238.





Thursday, February 02, 2017



Notice of Public Hearing

ALKHATIB, Nizar Y, Agent
Midget Food at 2500 N Booth St
Class A Malt and Food Dealer License Applications

Tuesday, February 14, 2017 at 10:30 AM

To whom it may concern:

The above application has been made by the above named applicant(s). This requires approval from the Licenses Committee and the Common Council of the City of Milwaukee. The hearing before the Licenses Committee will take place on 2/14/2017 at 10:30 AM, in Room 301-B, Third Floor, City Hall. If you wish, you may provide testimony at the hearing regarding the request; see below for further information. You are not required to attend the hearing. Once the Licenses Committee makes its recommendation, this recommendation is forwarded to the full Common Council for approval at its next regularly scheduled hearing. Please review the information below and if you have further questions regarding this process, please contact the License Division at (414) 286-2238.

Important details for those wishing to provide information for the Licenses Committee to consider when making its recommendation:

1. The license application is scheduled to be heard at the above time. Due to other hearings running longer than scheduled, you may have to wait some time to provide your testimony.
2. You must appear in person and testify as to matters that you have personally experienced or seen. (You cannot provide testimony for your neighbor, parent or anyone else; this is considered hearsay and cannot be considered by the committee.)
3. No letters or petitions can be accepted by the committee (unless the person who wrote the letter or the persons who signed the petition are present at the committee hearing and willing to testify).
4. Persons opposed to the license application are given the opportunity to testify first; supporters may testify after the opponents have finished.
5. When you are called to testify, you will be sworn in and asked to give your name, and address. (If your first and/or last names are uncommon please spell them.)
6. You may then provide testimony.
 - a. Include only information relating to the above license application.
 - b. Include only information you have personally witnessed or seen.
 - c. Provide concise and relevant information detailing how this business has affected or may affect the peaceful enjoyment of your neighborhood.
 - d. If by the time you have the opportunity to testify, the information you wish to share has already been provided to the committee, you may state that you agree with the previous testimony. Redundant or repetitive testimony will not assist the committee in making its recommendation.
7. After giving your testimony, the members of the Licenses Committee and the licensee may ask questions regarding the testimony you have given or other factors relating to the license application.
8. Business Competition is not a valid basis for denial or non-renewal of a license.
Please Note: If you have submitted an objection to the above application your objection cannot be considered by the committee unless you personally testify at the hearing.

OCCUPANT	MAIL ADDRESS	CITY AND ZIP CODE
CURRENT OCCUPANT	2510 N HOLTON ST	MILWAUKEE, WI 53212-2927
CURRENT OCCUPANT	530A E WRIGHT ST	MILWAUKEE, WI 53212-2939
CURRENT OCCUPANT	2510 N BOOTH ST A	MILWAUKEE, WI 53212-2907
CURRENT OCCUPANT	2524 N BOOTH ST	MILWAUKEE, WI 53212-2907
CURRENT OCCUPANT	2525 N BOOTH ST	MILWAUKEE, WI 53212-2906
CURRENT OCCUPANT	2526 N BOOTH ST	MILWAUKEE, WI 53212-2907
CURRENT OCCUPANT	508 E WRIGHT ST	MILWAUKEE, WI 53212-2939
CURRENT OCCUPANT	2471 N PIERCE ST	MILWAUKEE, WI 53212-2936
CURRENT OCCUPANT	701A E WRIGHT ST	MILWAUKEE, WI 53212-2942
CURRENT OCCUPANT	2461 N BOOTH ST	MILWAUKEE, WI 53212-2930
CURRENT OCCUPANT	2474 N BOOTH ST	MILWAUKEE, WI 53212-2931
CURRENT OCCUPANT	605 E WRIGHT ST	MILWAUKEE, WI 53212-2940
CURRENT OCCUPANT	2514 N HOLTON ST	MILWAUKEE, WI 53212-2927
CURRENT OCCUPANT	2524A N HOLTON ST	MILWAUKEE, WI 53212-2927
CURRENT OCCUPANT	530 E WRIGHT ST	MILWAUKEE, WI 53212-2939
CURRENT OCCUPANT	604 E WRIGHT ST	MILWAUKEE, WI 53212-2941
CURRENT OCCUPANT	2509 N PIERCE ST	MILWAUKEE, WI 53212-2952
CURRENT OCCUPANT	706A E WRIGHT ST	MILWAUKEE, WI 53212-2943
CURRENT OCCUPANT	2510 N BOOTH ST B	MILWAUKEE, WI 53212-2907
CURRENT OCCUPANT	2517 N BOOTH ST	MILWAUKEE, WI 53212-2906
CURRENT OCCUPANT	2520 N PIERCE ST	MILWAUKEE, WI 53212-2953
CURRENT OCCUPANT	2526A N BOOTH ST	MILWAUKEE, WI 53212-2907
CURRENT OCCUPANT	512 E WRIGHT ST	MILWAUKEE, WI 53212-2939
CURRENT OCCUPANT	2463B N BOOTH ST	MILWAUKEE, WI 53212-2930
CURRENT OCCUPANT	2463A N BOOTH ST	MILWAUKEE, WI 53212-2930
CURRENT OCCUPANT	2457 N BOOTH ST	MILWAUKEE, WI 53212-2930
CURRENT OCCUPANT	531 E WRIGHT ST	MILWAUKEE, WI 53212-2938
CURRENT OCCUPANT	2533 N PIERCE ST	MILWAUKEE, WI 53212-2952
CURRENT OCCUPANT	2522 N HOLTON ST	MILWAUKEE, WI 53212-2927
CURRENT OCCUPANT	2502 N BOOTH ST	MILWAUKEE, WI 53212-2907
CURRENT OCCUPANT	626 E WRIGHT ST	MILWAUKEE, WI 53212-2941
CURRENT OCCUPANT	700 E WRIGHT ST	MILWAUKEE, WI 53212-2943
CURRENT OCCUPANT	2510 N BOOTH ST	MILWAUKEE, WI 53212-2907
CURRENT OCCUPANT	2529 N PIERCE ST	MILWAUKEE, WI 53212-2952
CURRENT OCCUPANT	2467 N PIERCE ST	MILWAUKEE, WI 53212-2936
CURRENT OCCUPANT	2459A N PIERCE ST	MILWAUKEE, WI 53212-2936
CURRENT OCCUPANT	2463 N BOOTH ST	MILWAUKEE, WI 53212-2930
CURRENT OCCUPANT	615 E WRIGHT ST	MILWAUKEE, WI 53212-2940
CURRENT OCCUPANT	2516 N HOLTON ST	MILWAUKEE, WI 53212-2927
CURRENT OCCUPANT	2520 N HOLTON ST A	MILWAUKEE, WI 53212-2927
CURRENT OCCUPANT	604 E WRIGHT ST A	MILWAUKEE, WI 53212-2941
CURRENT OCCUPANT	2523 N BOOTH ST	MILWAUKEE, WI 53212-2906
CURRENT OCCUPANT	2468 N PIERCE ST	MILWAUKEE, WI 53212-2937
CURRENT OCCUPANT	2458A N BOOTH ST	MILWAUKEE, WI 53212-2931
CURRENT OCCUPANT	2454 N BOOTH ST	MILWAUKEE, WI 53212-2931
CURRENT OCCUPANT	605A E WRIGHT ST	MILWAUKEE, WI 53212-2940
CURRENT OCCUPANT	2535 N PIERCE ST	MILWAUKEE, WI 53212-2952
CURRENT OCCUPANT	2524 N HOLTON ST	MILWAUKEE, WI 53212-2927
CURRENT OCCUPANT	620A E WRIGHT ST	MILWAUKEE, WI 53212-2941
CURRENT OCCUPANT	2517A N PIERCE ST	MILWAUKEE, WI 53212-2952
CURRENT OCCUPANT	2517 N PIERCE ST	MILWAUKEE, WI 53212-2952
CURRENT OCCUPANT	513 E WRIGHT ST	MILWAUKEE, WI 53212-2938
CURRENT OCCUPANT	2462A N BOOTH ST	MILWAUKEE, WI 53212-2931
CURRENT OCCUPANT	621 E WRIGHT ST	MILWAUKEE, WI 53212-2940
CURRENT OCCUPANT	625A E WRIGHT ST	MILWAUKEE, WI 53212-2940

CURRENT OCCUPANT	2520 N HOLTON ST	MILWAUKEE, WI 53212-2927
CURRENT OCCUPANT	520 E WRIGHT ST	MILWAUKEE, WI 53212-2939
CURRENT OCCUPANT	620 E WRIGHT ST	MILWAUKEE, WI 53212-2941
CURRENT OCCUPANT	2509A N PIERCE ST	MILWAUKEE, WI 53212-2952
CURRENT OCCUPANT	2516 N BOOTH ST	MILWAUKEE, WI 53212-2907
CURRENT OCCUPANT	2522 N BOOTH ST	MILWAUKEE, WI 53212-2907
CURRENT OCCUPANT	2521 N PIERCE ST	MILWAUKEE, WI 53212-2952
CURRENT OCCUPANT	2525A N BOOTH ST	MILWAUKEE, WI 53212-2906
CURRENT OCCUPANT	2470A N HOLTON ST	MILWAUKEE, WI 53212-2935
CURRENT OCCUPANT	2467A N PIERCE ST	MILWAUKEE, WI 53212-2936
CURRENT OCCUPANT	2459 N PIERCE ST	MILWAUKEE, WI 53212-2936
CURRENT OCCUPANT	2455 N PIERCE ST	MILWAUKEE, WI 53212-2936
CURRENT OCCUPANT	2468B N PIERCE ST	MILWAUKEE, WI 53212-2937
CURRENT OCCUPANT	2468A N PIERCE ST	MILWAUKEE, WI 53212-2937
CURRENT OCCUPANT	2468C N PIERCE ST	MILWAUKEE, WI 53212-2937
CURRENT OCCUPANT	2466A N BOOTH ST	MILWAUKEE, WI 53212-2931
CURRENT OCCUPANT	2536 N BOOTH ST	MILWAUKEE, WI 53212-2907
CURRENT OCCUPANT	524 E WRIGHT ST	MILWAUKEE, WI 53212-2939
CURRENT OCCUPANT	524A E WRIGHT ST	MILWAUKEE, WI 53212-2939
CURRENT OCCUPANT	626A E WRIGHT ST	MILWAUKEE, WI 53212-2941
CURRENT OCCUPANT	2511 N PIERCE ST	MILWAUKEE, WI 53212-2952
CURRENT OCCUPANT	2519 N BOOTH ST	MILWAUKEE, WI 53212-2906
CURRENT OCCUPANT	2525 N PIERCE ST	MILWAUKEE, WI 53212-2952
CURRENT OCCUPANT	2470 N HOLTON ST	MILWAUKEE, WI 53212-2935
CURRENT OCCUPANT	701 E WRIGHT ST	MILWAUKEE, WI 53212-2942
CURRENT OCCUPANT	2472 N BOOTH ST	MILWAUKEE, WI 53212-2931
CURRENT OCCUPANT	2466 N BOOTH ST	MILWAUKEE, WI 53212-2931
CURRENT OCCUPANT	2462 N BOOTH ST	MILWAUKEE, WI 53212-2931
CURRENT OCCUPANT	2452 N BOOTH ST	MILWAUKEE, WI 53212-2931
CURRENT OCCUPANT	625 E WRIGHT ST	MILWAUKEE, WI 53212-2940
CURRENT OCCUPANT	2539 N PIERCE ST	MILWAUKEE, WI 53212-2952
CURRENT OCCUPANT	706 E WRIGHT ST	MILWAUKEE, WI 53212-2943
CURRENT OCCUPANT	2511 N BOOTH ST	MILWAUKEE, WI 53212-2906
CURRENT OCCUPANT	2517B N PIERCE ST	MILWAUKEE, WI 53212-2952
CURRENT OCCUPANT	2529A N BOOTH ST	MILWAUKEE, WI 53212-2906
CURRENT OCCUPANT	2529 N BOOTH ST	MILWAUKEE, WI 53212-2906
CURRENT OCCUPANT	513A E WRIGHT ST	MILWAUKEE, WI 53212-2938
CURRENT OCCUPANT	2463 N PIERCE ST	MILWAUKEE, WI 53212-2936
CURRENT OCCUPANT	633 E WRIGHT ST	MILWAUKEE, WI 53212-2940
CURRENT OCCUPANT	531A E WRIGHT ST	MILWAUKEE, WI 53212-2938
CURRENT OCCUPANT	2458 N BOOTH ST	MILWAUKEE, WI 53212-2931

Total Records: 97

Radius: 250.0 feet and Center of Circle: 2500 N Booth ST



BUSINESS LICENSE PLAN OF OPERATION

ccl-busplan 9/15/15

Office of the City Clerk License Division
200 E. Wells St. Room 105, Milwaukee, WI 53202
(414) 286-2238 www.milwaukee.gov/license e-mail address: license@milwaukee.gov

1. Type of Business

- Applying for: Extended Hours Establishment Filling Station Waste Tire Transporter Waste Tire Generator
 Self Service Laundry Rooming House: Number of Units: _____ Hotel/Motel: Number of Units: _____
 Massage Establishment Other (supplemental application for specific license also required)

Provide a detailed description of the type of business you plan on operating:

Grocery

Do you have any experience operating this type of business? No Yes If yes, explain: Worked in several stores

2. Business Operations

- a. Proposed Opening Date: 12/1/16
- b. Is this premise under construction? No Yes If yes, list estimated completion date: _____
- c. Is this a franchise? No Yes
- d. Is this premises currently licensed? No Yes If yes, list type of license: BEER, CIG, food, occupancy
- e. Is the current licensee operating? No Yes If no, list date closed: _____
- f. Do you have future plans for other businesses, licenses or permits at this location? No Yes
If yes, explain: _____
- g. Have you previously held an Extended Hours License in Milwaukee? No Yes
If yes, list address(es): _____
- h. Are other businesses operating in the same building? No Yes If yes, describe: _____

3. Litter & Noise

- a. How are grounds kept clean? Sweep Pressure Wash Pick Up Litter Hired Maintenance
 Building Owner Responsibility Garbage Cans Outside Other: _____
- b. How often will grounds be cleaned? Daily Weekly As Needed Monthly Other: _____
- c. Grounds cleaned by: Licensee Building Owner Employees Hired Maintenance Other: _____
- d. How are noise issues prevented and/or addressed? Security Manager approaches customer(s) Call Police
 Signs Posted Other: _____
- e. Will a sound amplification system be used? No Yes If yes, describe: _____

4. Smoking & Sanitation

- f. Are there designated outdoor smoking areas? No Yes If yes, describe: _____
- g. Number of Garbage Cans: Inside: 1 Locations: counter
Outside: 1 Locations: main entrance
- h. Is a crowd control barrier used? No Yes If yes, describe: _____
- i. Describe sanitation facilities (restrooms): employees only 1
Name of solid waste contractor: Advanced Disposal Waste Management Other: _____

5. Security

- a. Are there onsite parking spaces? No Yes If yes, how many? _____
Describe parking security plan: _____
- b. Is there a loading zone? No Yes If yes, describe loading area security plan _____
- c. Will you have security personnel on premise? No Yes If yes, how many? _____
What are their responsibilities? _____
Is security equipment used? No Yes If yes, describe _____
List their licensing, certification, or training credentials _____
Will there be security cameras? No Yes If yes, where? Inside and outside
Will searches/identification verification be conducted upon entry? No Yes If yes, describe _____

6. Percentage of Sales (must total 100%)

Alcohol <u>17</u> %	Food <u>83</u> %	Secondhand Merchandise _____ %	Precious Metals & Gems _____ %
Entertainment _____ %	Cigarettes _____ %	Personal Services (such as tattoo, body piercing, salon, tailor, tanning, etc.) _____ %	Other _____ % Describe: _____
Pawnbroker Activity _____ %	Salvaged Materials (such as scrap metal) _____ %		

7. Businesses/Licenses on the Premises (check all that apply):

Type 1

- Full Service Restaurant Cafe/Coffee Shop Deli or Fast Food Restaurant Private/Fraternal/Veterans Club
- Night Club Tavern Cocktail Lounge Teen Club
- Banquet Hall Sports Facility
- Hotel/Motel – Number of Rooms: _____ Rooming House – Number of Rooms: _____

Type 2

- Liquor Store Corner Store Supermarket Convenience Store
- Gas Station Amusement/Phonograph Distributor Auto Wrecker
- Used Car Dealer Used Auto Parts Personal Service Establishment (such as tattoo business, hair salon, tailor, etc.) Recording Studio

What other licenses/permits will you hold at this location? (check all that apply)

- Occupancy Permit Cigarette & Tobacco Gas Station Extended Hours Class "B" Tavern Weights & Measures
- Secondhand Dealer Precious Metal & Gem Other: _____

8. Legal Capacity (only if a Type 1 premises in #6 above)

Capacity _____ (Call the Milwaukee Development Center at 414-286-8211 if you have questions.)

9. Premises Description

d. Identify all area(s) of the premises that will be used in operating this business (include areas used only for storage):

1st Floor 2nd Floor Basement Storage Patio Beer Garden Sidewalk Café Deck Rooftop

Other: Describe: _____

e. Describe Location: Major Thoroughfare Secondary Street Other: _____

f. Nearest Major Cross Street: 1st Night

g. Describe Building: Free Standing Building Strip Mall Other: _____

h. Describe Premises Structure: Single Story Multi-Story - # of Stories _____ Other: _____

i. Describe Surrounding Area: Commercial Residential Industrial Other: _____

j. Building Owner Name: KEN KMET Phone Number: 914-975-0207

Business Owner Address: PO BOX 12683 MILW, WI, 53212

10. Hours of Operation & Customers

Will customers be entering the premises? No Yes

Day of the Week	Proposed Hours of Operation:		Estimated Number of Customers expected each day	Potential Age Range of Customers	Class B Applicants: Age Restriction (If none, write 'None')
	Open Time (include a.m. or p.m.)	Close Time (include a.m. or p.m.)			
Sunday	9 am	9 pm	40	-	
Monday	9	9	50	-	
Tuesday	9	9	50	-	
Wednesday	9	9	50	-	
Thursday	9	9	50	-	
Friday	9	9	50	-	
Saturday	9	9	50	-	

Extended Hours Establishment License is required for any convenience store, filling station, personal service establishment (such as tattoo, body piercing, salon, tailor, tanning, etc.), recording studio or restaurant which is open between the hours of 12 a.m. and 5 a.m.

Entertainment Indoor Closing Hours - If alcohol beverage establishment, same as alcohol license hours.
If non-alcohol establishment 1:00 am Sunday to Thursday; 1:30 am Friday and Saturday.

Entertainment Outdoor Closing Hours - 10:00 pm Sunday - Thursday; 12:00 am Friday and Saturday, unless otherwise approved by Common Council in licensee's plan of operation.

11. Signature(s)

Sole Proprietor, Partner, Agent, or 20% or more Shareholder

Signature of additional partner or 20% or more Shareholder

See Application Information for a list of all required application forms.



ALCOHOL BEVERAGE & PUBLIC ENTERTAINMENT PREMISES SUPPLEMENTAL PLAN OF OPERATION

Office of the City Clerk License Division
200 E. Wells St. Room 105, Milwaukee, WI 53202
(414) 286-2238 e-mail address: license@milwaukee.gov www.milwaukee.gov/license

Legal Entity Name: Midget Food LLC

Premise Address: 2500 N. Booth St

Proximity of Premises to Church, School, Daycare Center or Hospital

Is there at least 300 feet between the building and any church, school, daycare center or hospital? Yes No

"Service Bar Only" Designation

If applying for Class B or C license, are you applying for "Service Bar Only"? No Yes
Service Bar Only means customers cannot sit at the bar. Alcohol is served to patrons seated at tables. No stools, chairs or other articles of furniture shall be placed at the service bar for patrons to sit upon. N/A

Business Information

- a) Are you taking out this application for anyone that may not be eligible for a license? No Yes
If yes, list name and address: _____
 - b) Will the agent, a partner or the individual licensee be conducting the day-to-day operations of the business? No Yes
If no, list the name and address of the person(s) who will: _____
- Class B Applicants: If the agent, a partner or the individual licensee will not be conducting the day-to-day operations of the business, the person(s) listed above must obtain a Class B Managers license.
- c) Does anyone else have money invested or any other interest in this business? No Yes
If yes, explain: _____
 - d) Have you made an agreement with anyone to repay any loan or any other payments based upon income from the business?
 No Yes If yes, list name and address: _____

Proof of Ownership, Lease, or Offer to Purchase (new & transfer applicants only)

Submit proof of ownership, lease, or offer to purchase the building with this application.
A lease or offer to purchase must:

- a) Be in the same legal entity name as that apply for the license
- b) Reflect the same address as the premises address on this application
- c) Reflect current dates and
- d) Be signed by the lessor/seller and lessee/buyer

Property Information (new & transfer applicants only)

- a) Do you own or lease the building? Own Lease
 - b) Who owns the fixtures (for example, coolers, etc.)? I do
 - c) Are you purchasing the stock and/or fixtures? No Yes If yes, amount paid \$ 10,000
 - d) Total amount paid for business \$ 27,000
 - e) Total amount paid for goodwill of the business \$ 0
- Goodwill comprises the reputation and customer relationships of an existing business. If the price you pay for the business exceeds the fair market value of all of the rest of the assets of the business, the excess may be considered goodwill.
- f) Have you made arrangements with the seller for payment of personal property taxes? No Yes

See Application Information for a list of all required application forms.

Lease Information (new & transfer applicants who are leasing the premises only)

- a) Date lease begins 11/1/16 Ends 10/31/2021
- b) Monthly rental \$ 750
- c) Do you have an option to renew the lease? No Yes
- d) Does your lease allow for assignment to another party without the consent of the owner? No Yes
- e) For what length of time have you been guaranteed occupancy (number of years)? 10 YEARS
- f) In addition to paying the monthly rental, will you have to pay anything additional to the owner of the building to guarantee performance of the lease? No Yes If yes, explain _____
- g) Does the present owner or occupancy object to the granting of your license? No Yes
If yes, explain _____

Change of Agent Applicants Only

Have there been any changes to the floor plan since the last application was submitted? No Yes
If no, a new floor plan is not required. If yes, submit a new floor plan and explain the change(s): _____

Notarized Signatures of Applicants

SUBSCRIBED AND SWORN TO BEFORE ME

This 11th day of Nov, 2016

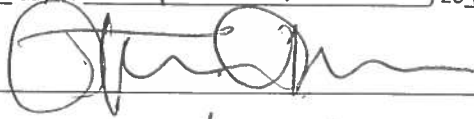

(Clerk/Notary Public)

My Commission Expires 10/15/17
*Notary Seal must be affixed.

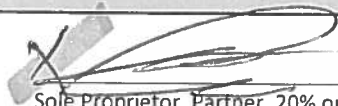
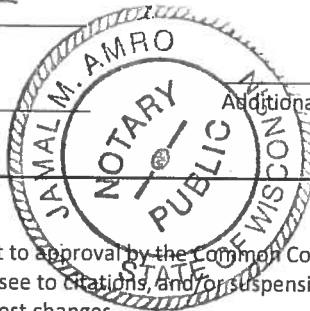

Sole Proprietor, Partner, 20% or more Shareholder, or Agent – only if there are no 20% or more shareholders

Additional partner or 20% or more shareholder

Note: All information contained in this application is subject to approval by the Common Council. Deviating from approved plan of operation will subject licensee to citations, and/or suspension or non-renewal of the license. Contact the License Division for information on how to request changes.

New and transfer of premise applicants must submit the following:

- Proof of ownership, lease or offer to purchase the building
- Detailed floor plan
- If a restaurant, copy of the menu



FOOD DEALER LICENSE PLAN OF OPERATION

ccl-foodplan 8/1/16

OFFICE OF THE CITY CLERK, LICENSE DIVISION
CITY HALL, 200 E. WELLS ST, ROOM 105, MILWAUKEE, WI 53202
(414) 286-2238 • license@milwaukee.gov • www.milwaukee.gov/license

Legal Entity Name: Midgcl Food LLC

Premises Address: 2500 N. Booth St Milwaukee 53212

SECTION 1 TYPE OF BUSINESS

Type of application (check one): taking over a currently operating business starting a new business
Anticipated opening date? 12/1/16

Check the type that best describes your business (check only one):

See Food Dealer License Information sheet for definitions.

- Restaurant
- Retail Establishment
 - If retail, will it be a convenience store? Yes No
(less than 5,000 sq ft of retail space, primary business is the sale of basic food items, and in addition sells household products)
- Community Food Program
- Bed & Breakfast
- Base for Food Peddler
- Base for Temporary/Seasonal Food Stand

In addition, will any wholesale business be done? Yes No

If yes, what percentage of the business will be wholesale? Less than 25% 25% or More (Contact DATCP)*

Will retail items be sold? No Yes If Yes, indicate percentage of food sales 5 %

Will restaurant items be sold? No* Yes If Yes, indicate percentage of food sales 20 %

* If you checked "25% or More" of the business will be wholesale and answered "No" to restaurant items being sold, do not continue completing this application. A City of Milwaukee License is not required. Contact DATCP only.

SECTION 2 FOOD PROCESSING

Will any food processing be done? No Yes

Processing is defined as assembling, grinding, cutting, mixing, baking, coating, stuffing, packing, bottling, grilling, canning, extracting, fermenting, distilling, pickling, freezing, drying, smoking, or packaging.

If Yes, check the types of food items:

- SNACKS & BEVERAGES
includes, but is not limited to, ice cream/soft serve, lemonade, snow cones, coffee, espresso, cappuccino, tea, fruit juice, smoothies, candy, dispensed soda, fruit cups, bakery, cookies, popcorn, kettle corn, cotton candy, funnel cakes, fritters, tortilla chips w/ cheese
- MEALS
includes, but is not limited to, chicken, ribs, sandwiches, roasted corn, baked potatoes, hot dogs, brats, tacos, nachos w/ cheese and meat, French fries, cooked or deep fried vegetables/fruit, cooked cheese curds, corn dogs, egg rolls, salads

SECTION 3 HAZARDOUS FOODS

Will any hazardous food be sold? No Yes

Hazardous foods require temperature control (includes dairy products such as milk, cheese, and ice cream, fish shellfish, meat, poultry)

If yes, list the types of food items: Frozen food

SECTION 4 SHARED KITCHEN

Will you be sharing kitchen space with another operator?

No If No, SKIP to Section 5

Yes If Yes, check one:

I will rent space from another operator ("Shared Kitchen Agreement" is required)

I will rent space to another operator (peddler/caterer)

SECTION 5 DETAILS OF OPERATION

Answer the following questions:

Will you have seating on site for dining? No Yes

Will you be doing any catering? No Yes

Will you be doing any delivery? No Yes

Will you have outdoor activities? No Yes

If Yes to outdoor activities, check all that apply: Bar Cooking/Grilling Dining

Will you have a drive thru window? No Yes

If Yes to drive thru, are hours different from inside? No Yes

If Yes, provide drive thru hours: _____

Will any scales or barcode scanners be used? No Yes

If Yes, a Weights & Measures application must be completed and a license obtained.

SECTION 6 ADDITIONAL SITES

Where will food be prepared and/or sold?

At a single site

At multiple sites (for example, a hotel with several dining rooms or bars) How many? _____

If multiple sites, attach a Food Dealer Additional Site Addendum (ccl-foodadd) for each additional site.

SECTION 7 CONSTRUCTION OR CHANGES

Are you planning any construction, remodeling or equipment changes?

No If No, SKIP to Section 6

Yes If Yes, check all that apply:

New construction of a building

Construction changes to an existing building

Renovation or remodeling

Equipment changes only (installation or replacement)

Provide a brief description of the changes: _____

Start date: _____

Name, Address & Phone Number of Architect: _____

Name, Address & Phone Number of Contractor: _____

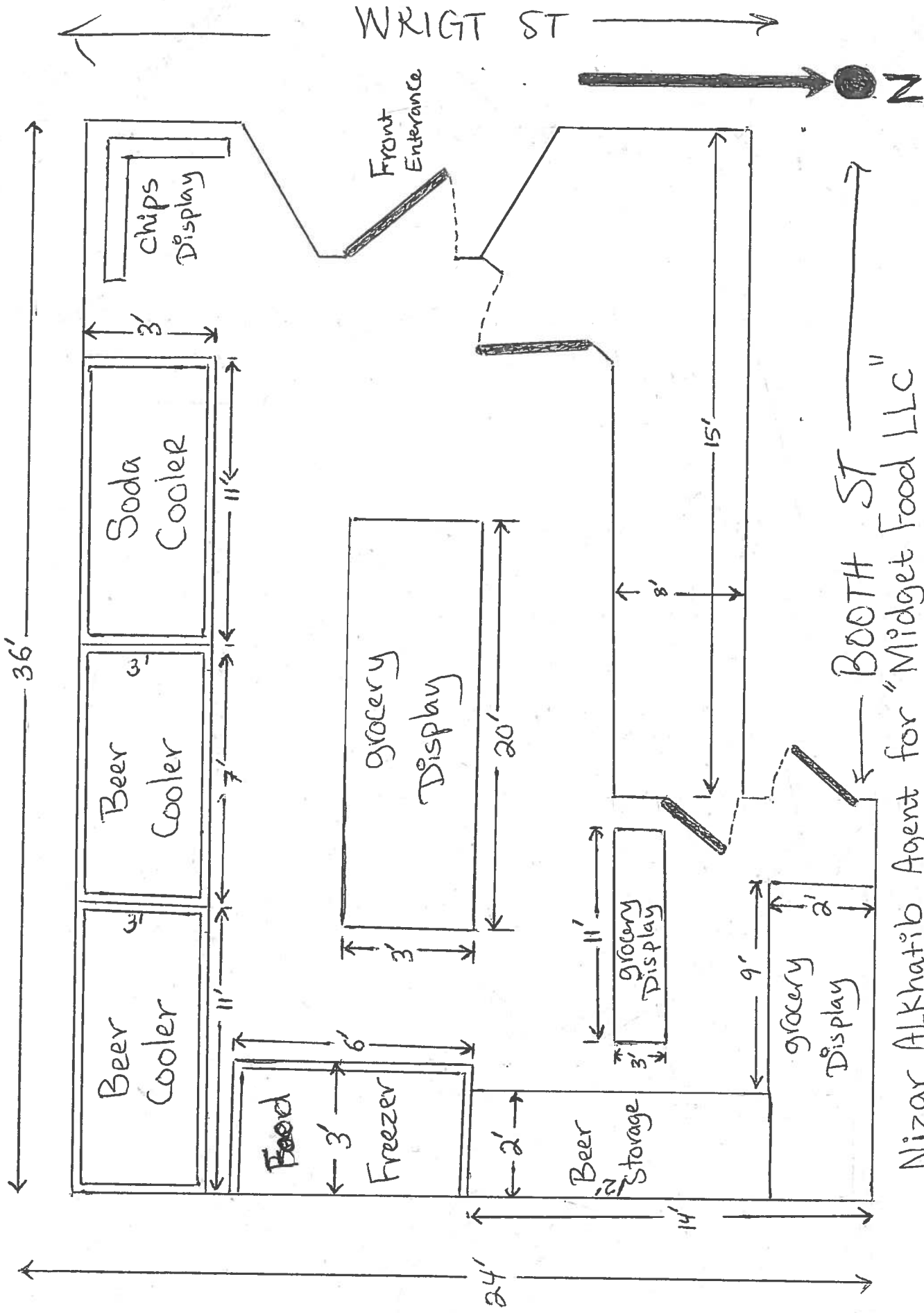

WRIGHT ST →



← BOOTH ST

Nizar Alkhatib Agent for "Midget Food LLC"
 2500 N Booth St. Milwaukee, WI 53212
 Date: November 18, 2016



**CITY OF MILWAUKEE
OFFICE OF THE CITY CLERK**

Thursday, February 02, 2017

COMMITTEE MEETING NOTICE

AD 06

BARNES, Garfield W, Agent
Eclectic Works LLC
8531 W Olive St

Milwaukee, WI 53222

You are requested to attend a hearing which is to be held in Room 301-B, Third Floor, City Hall on:

Tuesday, February 14, 2017 at 10:30 AM

Regarding: Your Class A Malt and Food Dealer License Applications as agent for "Eclectic Works LLC" for "Barnes Foods" at 3580 N Teutonia Av.

There is a possibility that your application may be denied  one or more of the following reasons: The recommendation of the committee regarding the application shall be based on evidence presented at the hearing. Per MCO 85-2.7-4, probative evidence concerning whether or not a new license should be granted may be presented on the following subjects: whether or not the applicant meets the municipal requirements, the appropriateness of the location and premises where the licensed premises is to be located and whether use of the premises for the purposes or activities permitted by the license would tend to facilitate a public or private nuisance or create undesirable neighborhood problems such as disorderly patrons, unreasonably loud noise, litter, and excessive traffic and parking congestion. Probative evidence relating to these matters may be taken from the plan of operation submitted with the license application, if any, but shall not include the content of any music. Evidence regarding the fitness of the location of the premises to be maintained as the principal place of business, including but not limited to whether there is an overconcentration of businesses of the type for which the license is sought; whether the proposal is consistent with any pertinent neighborhood business or development plans, or the location's proximity to areas where children are typically present. The applicant's record in operating similarly licensed premises; and whether or not the applicant has been charged with or convicted of any felony, misdemeanor, municipal offense or other offense, the circumstances of which substantially relate to the activity to be permitted by the license being applied for or any other factor which reasonably relates to the public health, safety or welfare may also be considered. See attached police report or correspondence.

Notice for applicants with warrants or unpaid fines:

Proof of warrant satisfaction or payment of fines must be submitted at the hearing on the above date and time. Failure to comply with this requirement may result in a delay of the granting/denial of your application.

Failure to appear at this meeting may result in the denial of your license. Individual applicants must appear only in person or by an attorney. Corporate or Limited Liability applicants must appear only by the agent designated on the application or by an attorney. Partnership applicants must appear by a partner listed on the application or by an attorney. If you wish to do so and at your own expense, you may be accompanied by an attorney of your choosing to represent you at this hearing.

You will be given an opportunity to speak on behalf of the application and to respond and challenge any charges or reasons given for the denial. No petitions can be accepted by the committee, unless the people who signed the petition are present at the committee hearing and willing to testify. You may present witnesses under oath and you may also confront and cross-examine opposing witnesses under oath. If you have difficulty with the English language, you should bring an interpreter with you, at your expense, so that you can answer questions and participate in your hearing.

You may examine the application file at this office during regular business hours prior to the hearing date. Inquiries regarding this matter may be directed to the person whose signature appears below.

Limited parking for persons attending meetings in City Hall is available at reduced rates (5 hour limit) at the Milwaukee Center on the southwest corner of East Kilbourn and North Water Street. Parking tickets must be validated in the first floor information booth in City Hall.

PLEASE NOTE: Upon reasonable notice, efforts will be made to accommodate the needs of disabled individuals through sign language interpreters or other auxiliary aids. For additional information or to request this service, contact the Council Services Division ADA Coordinator at (414) 286-2998, Fax - (414) 286-3456, TDD - (414) 286-2025.

JIM OWZARSKI, CITY CLERK

BY: _____



Jason Schunk
License Division Manager

If you have questions regarding this notice, please contact the License Division at (414) 286-2238.

200 E. Wells Street, Room 105, City Hall, Milwaukee, WI 53202. www.milwaukee.gov/license
Phone: (414) 286-2238 Fax: (414) 286-3057 Email Address: License@milwaukee.gov

Date: 11/29/16
Officer: P.O. C. Harris

City of Milwaukee Police Department
90-5-1.5 Crime Prevention Survey
Convenience Store/Liquor Store Inspection

Name of Premise: Barnes Foods
Address: 3580 N. Teutonia Ave., Milwaukee, WI
Phone: 414-839-8624

Owner: Robert N. Forney
Owner address: 3840 N. 36th St.
City State Zip: Milwaukee, WI 53216
Owner Phone: 414-469-5788
Owner email:

Manager: Garfield Barnes
Home Address: 8531 W. Olive St.
City State Zip: Milwaukee, WI 53222
Phone: 414-839-8624
Email: gfield414@gmail.com

Preferred contact: Mr. Barnes.

Location currently open: YES NO

Projected open date: January 2017

Day's open: S M T W Th F SA ALL

Hours of Operation: Sun: 8 am – 9 pm
Mon: 8 am – 9 pm
Tue: 8 am – 9 pm
Wed: 8 am – 9 pm
Thu: 8 am – 9 pm
Fri: 8 am – 9 pm
Sat: 8 am – 9 pm
24 hours Y N

Premise Type: Liquor Store
Convenience Store (beer only)
Other:

Licenses currently held: none at the time

- Alcohol: Yes No Class: #:
Tobacco: Yes No #:
Food: Yes No #:
Extended Hours: Yes No #:
Secondhand Dealer: Yes No Type: #:
Other: Yes No Type: #:
Other: Yes No Type: #:

Who is your alcohol distributor?

Exterior Survey:

1. Is the area around the location clean? Yes No
2. What surrounds the location? (Check all the apply)
 - a. Park
 - b. School
 - c. Youth Center
 - d. Church
 - e. Tavern(s) If so, how many
 - f. Residential
 - g. Other businesses
 - h. Other:
3. Can you see from the outside of the location into the interior Yes No
4. Can you see the employees inside of the location from the outside Yes No
5. Are exterior windows free of signage Yes No
6. Is there a parking lot Yes No
7. Is the parking lot clean? Yes No
8. Is the parking lot well lit? Yes No
9. Are there areas where a person could conceal themselves Yes No
10. Is there exterior lighting? Yes No. Does it appears to be adequate Yes No
11. Exterior Payphone? Yes No
12. Are there No Loitering Signs posted? Yes No
13. Are there exterior security cameras Yes No How Many: 6
14. Are the address numbers prominently displayed and easy to see Yes No

Camera Survey:

15. Does this location have security cameras? Yes No
16. Are they in working order? Yes No
17. What format are the cameras?
 - a. Color Yes No
 - b. Digital Yes No
 - c. VCR Yes No
 - d. Recorded Yes No
18. How long is footage stored for later viewing: 60 hours
19. Are there exterior cameras Yes No How many: 2
20. Are there interior cameras Yes No How many: 4
21. Do all employees know how to retrieve recorded digital images/footage? Yes No

Interior Survey:

22. Is the storeowner willing to be a standing complainant regarding loitering? Yes No
a. If yes have them fill out the standing complaint form and give them two of the commercial signs Yes No
23. Is the interior of the location neat and clean? Yes No
24. Does an interior camera face the entrance/exit? Yes No
25. Is there a lockable area that separates employees from customers? Yes No
26. Does the store sell single chore boy? Yes No
27. Does the store sell blunt wraps? Yes No
28. Does the store sell scales? Yes No
29. Does the store sell items that may be used as crack pipes? Yes No
a. Describe item N/A
30. Does the store have an over abundance of sandwich baggies: Yes No
31. Does the owner understand that these items are often used for drug use? Yes No
32. Do the products in the store appear to be new and rotated often? Yes No
33. Are emergency and non-emergency numbers posted near the phone? Yes No
34. Does the owner know how to contact their police district directly? Yes No
a. Did you provide a district contact guide to the owner? Yes No

Complete this section if alcohol establishment is a convenience store:

(** Read full ordinance for all details "68-55 Convenience Food Stores")

All convenience food stores not exempted under sub. 3 shall:

1. Is the cash register located in a manner so that at the time of a sales transaction, the employee and customer are both visible from the sidewalk? Yes No **
2. Are the glass entrance and exit doors clear of any signs or advertisements with the exception of a sign which states that the cash register contains \$50 or less and that the safe is no accessible to employees? Yes No
3. Does the store maintain one of the following on the licensed premise:
 - a. A safe that was in use at the convenience food store on August 17, 1994? Yes No
 - b. A drop-safe or time release safe that weighs at least 500 pounds or which is attached to or set into the floor in a manner approved by the police department? Yes No
4. Is lighting provided for the store's parking area during all hours of darkness when employees or customers are on the premises at a minimum average of 2-foot candles per square foot, unless the store is not open for business after sunset and before sunrise? Yes No N/A
5. Are at least two high-resolution surveillance security cameras installed? Yes No
6. Are the security cameras in working order? Yes No
7. Does one camera show an overall view of the counter and register area? Yes No
8. Does one camera show a clear, identifiable, full frame image of the face of each person entering and leaving the store? Yes No
9. Are the camera views obstructed by fixtures or displays? Yes No
10. Is the recorded footage stored for at least 30 days? Yes No
11. Do all store employees know how to record footage from the camera system to media capable of being transferred to police custody? Yes No

12. Are customer entrances/exits made of glass or other transparent material? Yes No
a. Exception: A store that does not have such doors on August 17, 1994 shall not be required to install such doors until the holder of the store's food dealer license changes.
13. Has the owner and their employees attended the Robbery Prevention Training within 120 days of ownership or employment? Yes No
a. Contact Community Outreach and Education at 935-7836 for schedule.

Sub 3. Exemptions. The requirements of this section do not apply to a convenience food store that conforms to either of the following descriptions:

- a-1. The store is located in an enclosed shopping structure, enclosed commercial building or hospital. A convenience food store is not in an enclosed structure or building if a customer can enter it directly from the outside.
Does store conform to a-1 Yes No
- a-2. The store physically separates employees from customers with a solid partition that bars a person from entering the employee area from the customer area, has a secure lock on the employee side of any door between the employee area and the customer, and conducts all transactions through a service window or similar arrangement.
Does store conform to a-2 Yes No
- a. At the commissioner's discretion, a convenience store may be exempted from any or all of the regulations specified in sub 2.
Does this location hold an exemption from the commissioner regarding any of the requirements of Sub 2? Yes No

ADDITIONAL COMMENTS/RECOMMENDATIONS:

Barnes stated that he will totally remodel the interior of the store, once he takes over. I recommended he upgrade the exterior lighting. I also recommended he remove the shelving systems that currently obstruct parts of the windows, for more exterior viewing. He stated once he opens he will have officers come back for a walk through.

MILWAUKEE POLICE DEPARTMENT LICENSING

CRIMINAL RECORD/ORDINANCE VIOLATION/INCIDENTS SYNOPSIS

DATE: 08/31/2016
LICENSE TYPE: AMALT
NEW:
RENEWAL:

No. 236657
Application Date: 08/30/2016

License Location: 3580 N Teutonia Av
Business Name: Eclectic Works LLC

Licensee/Applicant: BARNES, Garfield W
(Last Name, First Name, MI)

Date of Birth: 01/14/1977

Home Address: 8531 W Olive St
City: Milwaukee
Home Phone:

State: WI **Zip Code:** 53222

This report is written by Police Officer Gilbert Gwinn, assigned to the License Investigation Unit, Days.

The Milwaukee Police Department's investigation regarding this application revealed the following:

1. On 09/17/2007 the applicant's license was revoked for 7 months for Operating While Intoxicated.
2. On 12/26/2009 the applicant was charged in Milwaukee County with Carrying Concealed Weapon (Misdemeanor).

Charge: Carrying a Concealed Weapon
Finding: Guilty
Sentence: 3 months House of Corrections
Date: 05/11/2010
Case: 2009CM006292

3. On 10/22/2015 the applicant was cited at North 22nd Street and West Vienna Avenue in the city of Milwaukee for Keep Open Intoxicants in MV.

Charge: Keep Open Intoxicants in MV
Finding: Guilty
Sentence: \$75.00 fine
Date: 01/29/2016
Case: 15064659

CITY OF MILWAUKEE
LICENSE DIVISION
2016 SEP 22 P 1:03

REDACTED RECORD

September 16, 2016

Re: Possible liquor license for 3580 N Teutonia Avenue, Milwaukee, WI 53206

To whom it may concern:

This letter is intended as a written objection to the license committee considering a Class A Malt and/or Class A liquor license for the business located at 3580 N Teutonia Avenue, Milwaukee, WI 53206.

Our establishment, _____, has been serving the neighborhood since the 1960's and has maintained a liquor license in good standing since that time. During the years that our store has been in the neighborhood, we have been witness to many changes. One of these is the explosion on liquor stores / taverns in the area. It seems that each year, new liquor licenses are being issued in the neighborhood which is becoming over saturated with them.

In the one mile radius around the proposed new licensee, there are 37 existing licensees. In the 3 mile radius around the proposed new licensee, there are 195 licensees, as listed on the enclosed document. As one can see from the list, licensees are sometimes only next door or across the street from one another.

It is our opinion that the concentration of liquor licenses is too great and further licenses should not be issued in the neighborhood. There are likely areas of the city with lower concentrations of liquor licenses that would be better suited to the addition of a new vendor. With the concentration as high as it is in this neighborhood, after a certain point, each additional license granted creates a negative impact on the overall quality of life of the residents. Therefore, we ask that the license committee not issue the license in question.

Sincerely,

Legal Entity	Trade Name	Address	Distance
YOUNG'S BAR, INC	YOUNG'S BAR	3571 N TEUTONIA Av	0.0
Competition Sports Bar LLC	THA Competition Sports Bar	3621 N TEUTONIA Av	0.1
CATFISH LOUNGE, INC	CATFISH LOUNGE	3646 N TEUTONIA Av	0.1
Toor Retail LLC	Jack's Beverage Center	3565-67 N Teutonia Av	0.1
CETTERY M GARDNER, SP	SHANANIGANS	3751 N TEUTONIA Av	0.2
OCTAVIUS M SIMMONS, SP	Midnighter's Bar	3038 N Teutonia Av	0.2
ANI ALLIANCE, INC	EXPRESS LIQUOR	3833 N TEUTONIA Av	0.3
FAITH GROCERIES, INC	FAITH GROCERIES	3451 N 23RD St	0.4
MICHAEL TSIRLIN, SP	Empire Nightclub & Lounge	4126 N TEUTONIA Av	0.4
JOE F MALLETT, SP	MALLETT'S FOODS	3501 N 14TH St	0.4
GENINNE RICE, SP	Gee Gee's Lounge	3941 N TEUTONIA Av	0.4
LUTHER BROWN, SP	CASPAR'S LOUNGE	1300 W KEEFE Av	0.5
SHANAA GROCERY, INC	MR F FOODS	3246 N 15TH St	0.5
JAMES BANKS, SP	BIG MANS PLACE	1932 W CAPITOL DR	0.5
SANGHAS FOOD MART, INC	Sam's Food Mart	1901 W ATKINSON Av	0.6
Mark A Murray, SP	Murray's Bar	2474 W HOPKINS St	0.6
CHIDI P ONUKWUGHA, SP	ANGEL FOOD MARKET	3700 N 26TH St	0.6
WARREN G HARPER, SP	WARREN'S LOUNGE	2534 W HOPKINS St	0.7
B & S FOOD MARKET, INC	B & S FOOD MARKET	3299 N 12TH St	0.7
Freez Food Mart LLC	Freez Food Mart	2526 W Hopkins St	0.7
KHASRIA 3, INC	BIG JIM LIQUOR	2161 W HOPKINS St	0.7
PJS SUPERMARKET, LLC	PJS SUPERMARKET	3079 N 21ST St	0.7
DRAKE, INC	TEUTONIA WINE & LIQUOR	2232 W CAPITOL DR	0.8
Capitol Pantry, Inc	Capitol Pantry	2483 W Capitol DR	0.8
FAMILY SUPER SAVER, INC	FAMILY SUPERSAVER	2301 W HOPKINS St	0.8
ATKINSON BEER & LIQUOR MART, INC	ATKINSON BEER & LIQUOR MART, INC	1101 W ATKINSON Av	0.8
Harman Liquor LLC	Hopkins Liquor & Food Mart	1646 W Hopkins St	0.9
ADAMS FOOD LLC	BURLEIGH FOOD MART	1120 W BURLEIGH St	0.9
JESSICA P STEWART, SP	STEWART'S REST SPOT	1422 W ATKINSON Av	0.9
PATRICIA A PICKENS, SP	Rose's Place	2878 N 20th St	0.9
Y&A LLC	Mothers Food and Liquor	2438 W Hopkins St	1.0
North Side Meat Mart LLC	North Side Meat Mart	3004 N 12th St	1.0
SUNPRI CORP	CORNER LIQUOR	3500 N PORT WASHINGTON	1.0
Loves Supermarket II LLC	Loves Supermarket II LLC	2305 W Atkinson Av	1.0
Magic Holdings, LLC	Magic Foods	2879 N 16th St	1.0
V & T LIQUORS, INC	V & T WINE & LIQUOR	916 W BURLEIGH St	1.0
CHARNJIT KAUR, SP	STARK FOOD MARKET	1301 W ATKINSON Av	1.0
Sunny and Son Investments LLC	Value Food and Liquor	3160 N 27th St	1.1
JJ Food & Beer Inc	All Star Food	3100 N 27th St	1.2
HARMEET, LLC	MID CITY LIQUOR	1935 W CENTER St	1.2
Zaid 9 LLC	Locust Food Market	2902 N Mother Simpson WA	1.2
TIFFANY GIVENS, SP	Rookies Sports Lounge	2579 N Teutonia Av	1.3
HOT SPOT SUPERMARKET, LLC	HOT SPOT SUPERMARKET	2643 W ATKINSON Av	1.3
ALETA M PARKER, SP	ALETA'S LIQUOR	1525 W CENTER St	1.3
GOLDEN NORTHTOWN FOODS, INC	GOLDEN NORTHTOWN FOOD	4402 N 27TH St	1.3
Agnes D Boone, SP	Good Times	2978 N Mother Simpson WA	1.3
HENRY L WINCE, SP	HENRY'S LOUNGE	4411 N 27TH St	1.3
INDIAN LIQUOR LLC	JJ FOOD MART & LIQUOR	4173-75 N GREEN BAY Av	1.3
PAUL E SIMMONS, SP	Brother's II	3251 N 8th St	1.3
Abrar Musaitif, SP	Sunshine Food Market	103 E Keefe Av	1.3
FLORA B WATKINS, SP	WATKINS GROCERY	3806 N 4TH St	1.4

Alcohol Concentration for 3580 N Teutonia Av

City of Milwaukee, Wisconsin



- Legend -

- City limits
- Parcels
- Freeways**
- Freeways
- Exit ramps
- Entry ramps
- Ramps
- Major streets**
- Major streets
- Streets**
- Streets
- Waterways
- Alcohol licenses**
- Class A intoxicating liquor
- Class A fermented malt beverage
- Class A liquor and malt
- Class B fermented malt beverage
- Class B tavern
- Class C wine retailer



- Notes -

Licensed Alcohol Beverage Establishments within a .5 Mile Radius Centered on 3580 N Teutonia Av, 8/30/2016



Department of Administration - ITMD

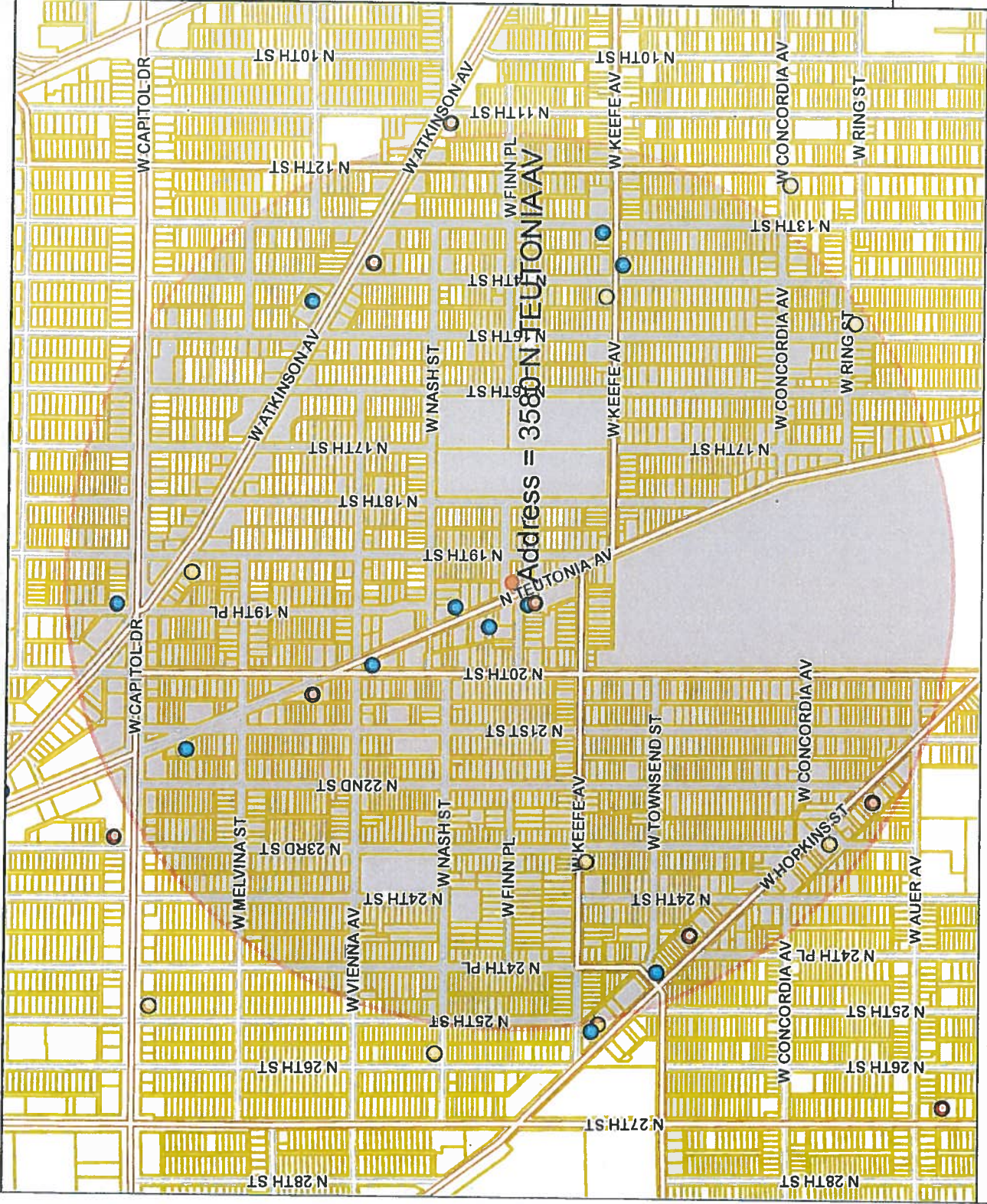

© City of Milwaukee, Wisconsin
 Map Milwaukee: Property Information
 Disclaimer
 8/30/2016

Map Scale: 1: 10,000
 833.3
 0
 416.67
 833.3 Feet

Licensed Alcohol Beverage Establishments within a .5 Mile Radius Centered on 3580 N Teutonia Av, 8/30/2016

License Summary	Total	Address	License type name	Total capacity	Expiration date
Class A Fermented Malt Beverage Retailer's License	5	3451 N 23RD ST	Class A Fermented Malt Beverage Retailer's License		4/11/2017
Class A Malt & Class A Liquor License	5	2301 W HOPKINS ST	Class A Fermented Malt Beverage Retailer's License		7/30/2017
Class B Tavern License	10	3501 N 14TH ST	Class A Fermented Malt Beverage Retailer's License		10/13/2016
Grand Total	20				
Legal entity	Licensee	Address	License type name	Total capacity	Expiration date
FAITH GROCERIES, INC	HARJINDER KHASRIA, Agt	3451 N 23RD ST	Class A Fermented Malt Beverage Retailer's License		4/11/2017
FAMILY SUPER SAVER, INC	ELHAM ABDUL RAHIM, Agt	2301 W HOPKINS ST	Class A Fermented Malt Beverage Retailer's License		7/30/2017
MALLETT'S FOODS	JOE F MALLET, SP	3501 N 14TH ST	Class A Fermented Malt Beverage Retailer's License		10/13/2016
SANGHAS FOOD MART, INC	TAJINDER SINGH, Agt	1901 W ATKINSON AV	Class A Fermented Malt Beverage Retailer's License		4/10/2017
SHANAA GROCERY, INC	BASSEL S HAMZA, Agt	3246 N 15TH ST	Class A Fermented Malt Beverage Retailer's License		12/16/2016
ANI ALLIANCE, INC	NAVPREET S MANHANI, Agt	3833 N TEUTONIA AV	Class A Malt & Class A Liquor License		12/15/2016
KHASRIA 3, INC	BHUPINDER SINGH, Agt	2161 W HOPKINS ST	Class A Malt & Class A Liquor License		1/19/2017
STARK FOOD MARKET	CHARNJIT KAUR, SP	1301 W ATKINSON AV	Class A Malt & Class A Liquor License		2/26/2017
Toor Retail LLC	Yasir A Ghani, Agt	3565-67 N Teutonia AV	Class A Malt & Class A Liquor License		7/23/2017
Y&A LLC	David S Toor, Agt	2438 W Hopkins ST	Class A Malt & Class A Liquor License		2/28/2017
BIG MANS PLACE	JAMES BANKS, SP	1932 W CAPITOL DR	Class B Tavern License	76	11/8/2016
Bungalow Restaurant, LLC	Demetrius T Jones, Agt	3466 N 14th ST	Class B Tavern License		6/11/2017
CASPARI'S LOUNGE	LUTHER BROWN, SP	1300 W KEEFE AV	Class B Tavern License	60	6/30/2017
CATFISH LOUNGE, INC	JAMIE N GLADNEY, Agt	3646 N TEUTONIA AV	Class B Tavern License	80	6/13/2017
Competition Sports Bar LLC	Isaiah F Walls, Agt	3621 N TEUTONIA AV	Class B Tavern License	80	12/6/2016
Gee Gee's Lounge	GENINNE RICE, SP	3941 N TEUTONIA AV	Class B Tavern License	80	2/7/2017
Murray's Bar	Mark A Murray, SP	2474 W HOPKINS ST	Class B Tavern License	75	5/20/2017
SHANANIGANS	CETTERY M GARDNER, SP	3751 N TEUTONIA AV	Class B Tavern License	70	9/24/2016
STEWART'S REST SPOT	JESSICA P STEWART, SP	1422 W ATKINSON AV	Class B Tavern License	25	10/11/2016
YOUNG'S BAR, INC	CHARLENE E GRAY, Agt	3571 N TEUTONIA AV	Class B Tavern License	50	6/14/2017



Thursday, February 02, 2017

Licenses Committee Notice of Hearing

Charlotte McNeeley
16625 Cherry Hill DR

Brookfield, WI 53005

Date: 2/14/2017
Time: 10:30 AM
Location: Room 301-B, Third Floor, City Hall

The Licenses Committee will consider the following license application:

Class A Malt and Food Dealer License Applications
BARNES, Garfield W, Agent
Barnes Foods at 3580 N Teutonia Av

Please note this application may be recommended for denial based on fitness of the location due to concentration of alcohol beverage outlets in the area. If the application is denied for this reason, no other application for an alcohol beverage license for this location shall be recommended for approval by the Licenses Committee within three years of the date of denial unless the applicant has demonstrated a change of circumstances since the prior denial.

If you have any questions, please call (414) 286-2238.





Thursday, February 02, 2017

Licenses Committee Notice of Hearing

Charlotte McNeeley
8531 W Olive St

Milwaukee, WI 53222

Date: 2/14/2017
Time: 10:30 AM
Location: Room 301-B, Third Floor, City Hall

The Licenses Committee will consider the following license application:

Class A Malt and Food Dealer License Applications
BARNES, Garfield W, Agent
Barnes Foods at 3580 N Teutonia Av

Please note this application may be recommended for denial based on fitness of the location due to concentration of alcohol beverage outlets in the area. If the application is denied for this reason, no other application for an alcohol beverage license for this location shall be recommended for approval by the Licenses Committee within three years of the date of denial unless the applicant has demonstrated a change of circumstances since the prior denial.

If you have any questions, please call (414) 286-2238.





Thursday, February 02, 2017



Notice of Public Hearing

BARNES, Garfield W, Agent
Barnes Foods at 3580 N Teutonia Av
Class A Malt and Food Dealer License Applications

Tuesday, February 14, 2017 at 10:30 AM

To whom it may concern:

The above application has been made by the above named applicant(s). This requires approval from the Licenses Committee and the Common Council of the City of Milwaukee. The hearing before the Licenses Committee will take place on 2/14/2017 at 10:30 AM, in Room 301-B, Third Floor, City Hall. If you wish, you may provide testimony at the hearing regarding the request; see below for further information. You are not required to attend the hearing. Once the Licenses Committee makes its recommendation, this recommendation is forwarded to the full Common Council for approval at its next regularly scheduled hearing. Please review the information below and if you have further questions regarding this process, please contact the License Division at (414) 286-2238.

Important details for those wishing to provide information for the Licenses Committee to consider when making its recommendation:

1. The license application is scheduled to be heard at the above time. Due to other hearings running longer than scheduled, you may have to wait some time to provide your testimony.
2. You must appear in person and testify as to matters that you have personally experienced or seen. (You cannot provide testimony for your neighbor, parent or anyone else; this is considered hearsay and cannot be considered by the committee.)
3. No letters or petitions can be accepted by the committee (unless the person who wrote the letter or the persons who signed the petition are present at the committee hearing and willing to testify).
4. Persons opposed to the license application are given the opportunity to testify first; supporters may testify after the opponents have finished.
5. When you are called to testify, you will be sworn in and asked to give your name, and address. (If your first and/or last names are uncommon please spell them.)
6. You may then provide testimony.
 - a. Include only information relating to the above license application.
 - b. Include only information you have personally witnessed or seen.
 - c. Provide concise and relevant information detailing how this business has affected or may affect the peaceful enjoyment of your neighborhood.
 - d. If by the time you have the opportunity to testify, the information you wish to share has already been provided to the committee, you may state that you agree with the previous testimony. Redundant or repetitive testimony will not assist the committee in making its recommendation.
7. After giving your testimony, the members of the Licenses Committee and the licensee may ask questions regarding the testimony you have given or other factors relating to the license application.
8. Business Competition is not a valid basis for denial or non-renewal of a license.
Please Note: If you have submitted an objection to the above application your objection cannot be considered by the committee unless you personally testify at the hearing.

OCCUPANT	MAIL ADDRESS	CITY AND ZIP CODE
CURRENT OCCUPANT	3586A N 19TH ST	MILWAUKEE, WI 53206-2309
CURRENT OCCUPANT	3625 N 19TH ST	MILWAUKEE, WI 53206-2312
CURRENT OCCUPANT	3617 N 19TH ST	MILWAUKEE, WI 53206-2312
CURRENT OCCUPANT	3556 N 19TH ST	MILWAUKEE, WI 53206-2309
CURRENT OCCUPANT	1945 W FINN PL	MILWAUKEE, WI 53206-2321
CURRENT OCCUPANT	1947 W FINN PL	MILWAUKEE, WI 53206-2321
CURRENT OCCUPANT	3572 N TEUTONIA AVE	MILWAUKEE, WI 53206-2328
CURRENT OCCUPANT	1956 W FINN PL	MILWAUKEE, WI 53206-2320
CURRENT OCCUPANT	1906 W FINN PL	MILWAUKEE, WI 53206-2318
CURRENT OCCUPANT	3608A N 19TH ST	MILWAUKEE, WI 53206-2311
CURRENT OCCUPANT	3608 N 19TH ST	MILWAUKEE, WI 53206-2311
CURRENT OCCUPANT	3617 N TEUTONIA AVE	MILWAUKEE, WI 53206-2331
CURRENT OCCUPANT	3621B N TEUTONIA AVE	MILWAUKEE, WI 53206-2331
CURRENT OCCUPANT	3621 N 19TH ST	MILWAUKEE, WI 53206-2312
CURRENT OCCUPANT	3544A N TEUTONIA AVE	MILWAUKEE, WI 53206-2328
CURRENT OCCUPANT	1954 W FINN PL	MILWAUKEE, WI 53206-2320
CURRENT OCCUPANT	3605 N 19TH ST	MILWAUKEE, WI 53206-2312
CURRENT OCCUPANT	3615 N TEUTONIA AVE	MILWAUKEE, WI 53206-2331
CURRENT OCCUPANT	3638 N TEUTONIA AVE	MILWAUKEE, WI 53206-2313
CURRENT OCCUPANT	3566 N 19TH ST	MILWAUKEE, WI 53206-2309
CURRENT OCCUPANT	3578 N 19TH ST	MILWAUKEE, WI 53206-2309
CURRENT OCCUPANT	3612 N 19TH ST	MILWAUKEE, WI 53206-2311
CURRENT OCCUPANT	3577 N 19TH ST	MILWAUKEE, WI 53206-2310
CURRENT OCCUPANT	3621A N TEUTONIA AVE	MILWAUKEE, WI 53206-2331
CURRENT OCCUPANT	3626 N TEUTONIA AVE	MILWAUKEE, WI 53206-2313
CURRENT OCCUPANT	3550 N 19TH ST	MILWAUKEE, WI 53206-2309
CURRENT OCCUPANT	3604 N 19TH ST	MILWAUKEE, WI 53206-2311
CURRENT OCCUPANT	3574A N TEUTONIA AVE	MILWAUKEE, WI 53206-2328
CURRENT OCCUPANT	3573 N 19TH ST	MILWAUKEE, WI 53206-2310
CURRENT OCCUPANT	3550A N 19TH ST	MILWAUKEE, WI 53206-2309
CURRENT OCCUPANT	3560 N 19TH ST	MILWAUKEE, WI 53206-2309
CURRENT OCCUPANT	3618 N 19TH ST	MILWAUKEE, WI 53206-2311
CURRENT OCCUPANT	1953 W FINN PL	MILWAUKEE, WI 53206-2321
CURRENT OCCUPANT	3574 N TEUTONIA AVE	MILWAUKEE, WI 53206-2328
CURRENT OCCUPANT	1907 W FINN PL	MILWAUKEE, WI 53206-2319
CURRENT OCCUPANT	3554 N 19TH ST	MILWAUKEE, WI 53206-2309
CURRENT OCCUPANT	3558 N 19TH ST	MILWAUKEE, WI 53206-2309
CURRENT OCCUPANT	3616 N 19TH ST	MILWAUKEE, WI 53206-2311
CURRENT OCCUPANT	3544 N TEUTONIA AVE	MILWAUKEE, WI 53206-2328
CURRENT OCCUPANT	3576 N TEUTONIA AVE	MILWAUKEE, WI 53206-2328
CURRENT OCCUPANT	3638A N TEUTONIA AVE	MILWAUKEE, WI 53206-2313

Total Records: 42

Radius: 250.0 feet and Center of Circle: 3580 N Teutonia AV



BUSINESS LICENSE PLAN OF OPERATION

ccl-busplan 5/24/16

Office of the City Clerk License Division
200 E. Wells St. Room 105, Milwaukee, WI 53202
(414) 286-2238 www.milwaukee.gov/license e-mail address: license@milwaukee.gov

1. Type of Business

Applying for: Extended Hours (12AM to 5AM) - If a food establishment, check all that apply: Delivery Drive Thru Dining Room
 Self Service Laundry Rooming House Hotel/Motel Massage Establishment Filling Station
 Other (supplemental application for specific license also required)

Provide a detailed description of the type of business you plan on operating:

Retail Store Convenience store

Do you have any experience operating this type of business? No Yes If yes, explain: Owned one before

2. Business Operations

- a. Proposed Opening Date: 8/15/2016
- b. Is this premise under construction? No Yes If yes, list estimated completion date: _____
- c. Is this a franchise? No Yes
- d. Is this premises currently licensed? No Yes If yes, list type of license: Food cleaners
- e. Is the current licensee operating? No Yes If no, list date closed: _____
- f. Do you have future plans for other businesses, licenses or permits at this location? No Yes
If yes, explain: _____
- g. Have you previously held an Extended Hours License in Milwaukee? No Yes
If yes, list address(es): _____
- h. Are other businesses operating in the same building? No Yes If yes, describe: _____

3. Litter & Noise

- a. How are grounds kept clean? Sweep Pressure Wash Pick Up Litter Other: _____
- b. How often will grounds be cleaned? Daily Weekly As Needed Monthly Other: _____
- c. Grounds cleaned by: Licensee Building Owner Employees Hired Maintenance Other: _____
- d. How are noise issues prevented and/or addressed? Security Manager approaches customer(s) Call Police
 Signs Posted Other: _____
- e. Will a sound amplification system be used? No Yes If yes, describe: _____

4. Smoking & Sanitation

- a. Are there designated outdoor smoking areas? No Yes If yes, describe: _____
- b. Number of Garbage Cans: Inside: 4 Locations: Inside of store
Outside: 4 Locations: Parking area beyond fence
- c. Is a crowd control barrier used? No Yes If yes, describe: _____
- d. How many restrooms are on the premises? 1
- e. Name of solid waste contractor: Advanced Disposal Waste Management Other: City of Milwaukee

5. Security

- a. Are there onsite parking spaces? No Yes If yes, indicate how many? 2 and describe the parking security plan: gated
- b. Is there a loading zone? No Yes If yes, describe the loading area security plan: _____
- c. Will you have security personnel on premise? No Yes If yes, how many? _____ and answer the following:
 What are their responsibilities? _____
 Is security equipment used? No Yes If yes, describe Cameras
 List their licensing, certification, or training credentials _____
- d. Will there be security cameras? No Yes If yes, where? inside and outside building
- e. Will searches/identification checks be done upon entry? No Yes If yes, describe will ask for ID before purchase of alcohol/beer

6. Percentage of Sales (must total 100%)

Alcohol <u>15</u> %	Food <u>70</u> %	Secondhand Merchandise _____ %	Precious Metals & Gems _____ %
Entertainment _____ %	Cigarettes <u>15</u> %	_____ %	_____ %
Pawnbroker Activity _____ %	Salvaged Materials _____ % (such as scrap metal)	Personal Services (such as tattoo, body piercing, salon, tailor, tanning, etc.) _____ %	Other _____ % Describe: _____

7. Businesses/Licenses on the Premises (check all that apply):

Type 1

- Full Service Restaurant Cafe/Coffee Shop Deli or Fast Food Restaurant Private/Fraternal/Veterans Club
- Night Club Tavern Cocktail Lounge Teen Club
- Banquet Hall Sports Facility Bowling Alley
- Hotel/Motel: Number of Floors: _____ Rooming House: Number of Floors: _____
 Number of Rooms: _____ Number of Rooms: _____

Type 2

- Liquor Store Corner Store Supermarket Convenience Store
- Gas Station Amusement/Phonograph Distributor Recycling, Salvage or Towing
- Used Car Dealer Personal Service Establishment
(such as tattoo business, hair salon, tailor, etc.) Recording Studio

What other licenses/permits will you hold at this location? (check all that apply)

- Occupancy Permit Cigarette & Tobacco Gas Station Extended Hours Class "B" Tavern Weights & Measures
- Secondhand Dealer Precious Metal & Gem Other: _____

8. Legal Capacity (only if a Type 1 premises in #7 above)

Capacity _____ (Call the Milwaukee Development Center at 414-286-8211 if you have questions.)

9. Premises Description

a. Identify all area(s) of the premises that will be used in operating this business (include areas used only for storage):

1st Floor 2nd Floor Basement Storage Patio Beer Garden Sidewalk Café Deck Rooftop

Other: Describe: _____

b. Describe Location: Major Thoroughfare Secondary Street Other: _____

c. Nearest Major Cross Street: FINN

d. Describe Building: Free Standing Building Strip Mall Other: _____

e. Describe Premises Structure: Single Story Multi-Story - # of Stories _____ Other: _____

f. Describe Surrounding Area: Commercial Residential Industrial Other: _____

g. Building Owner Name: Charlotte McNeely Phone Number: 414-350-4160

Business Owner Address: 8531 W. Olive St

10. Hours of Operation & Customers

Will customers be entering the premises? No Yes

Day of the Week	Proposed Hours of Operation:		Estimated Number of Customers expected each day	Potential Age Range of Customers	Class B Tavern Applicant Only: Age Restriction (If none, write 'None')
	Open Time (include a.m. or p.m.)	Close Time (include a.m. or p.m.)			
Sunday	10:00 AM	2:00 PM	50	0-100	None
Monday	9:00 AM	9:00 PM			
Tuesday	9:00 AM	9:00 PM			
Wednesday	9:00 AM	9:00 PM			
Thursday	9:00 AM	9:00 PM			
Friday	7:00 AM	9:00 PM			
Saturday	10:00 AM	9:00 PM			

Extended Hours Establishment License is required for any convenience store, filling station, personal service establishment (such as tattoo, body piercing, salon, tailor, tanning, etc.), recording studio or restaurant which is open between the hours of 12 a.m. and 5 a.m.

Entertainment Indoor Closing Hours : If alcohol beverage establishment, same as alcohol license hours.
If non-alcohol establishment 1:00 am Sunday to Thursday; 1:30 am Friday and Saturday.

Entertainment Outdoor Closing Hours : 10:00 pm Sunday – Thursday; 12:00 am Friday and Saturday, unless otherwise approved by Common Council in licensee's plan of operation.

11. Signature(s)

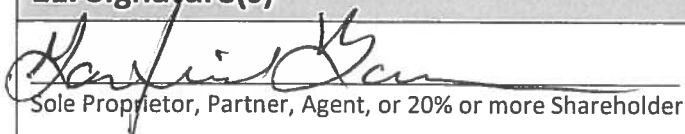
Sole Proprietor, Partner, Agent, or 20% or more Shareholder

Signature of additional partner or 20% or more Shareholder

See Application Information for a complete list of all required application forms.



ALCOHOL BEVERAGE & PUBLIC ENTERTAINMENT PREMISES SUPPLEMENTAL PLAN OF OPERATION

Office of the City Clerk License Division
200 E. Wells St. Room 105, Milwaukee, WI 53202
(414) 286-2238 e-mail address: license@milwaukee.gov www.milwaukee.gov/license

Legal Entity Name: Eclectic Works LLC

Premise Address: 3580 N. Teutonia Ave Milw. WI 53206

Proximity of Premises to Church, School, Daycare Center or Hospital

Is there at least 300 feet between the building and any church, school, daycare center or hospital? Yes No

"Service Bar Only" Designation

If applying for Class B or C license, are you applying for "Service Bar Only"? No Yes
Service Bar Only means customers cannot sit at the bar. Alcohol is served to patrons seated at tables. No stools, chairs or other articles of furniture shall be placed at the service bar for patrons to sit upon.

Business Information

- a) Are you taking out this application for anyone that may not be eligible for a license? No Yes
If yes, list name and address: _____
 - b) Will the agent, a partner or the individual licensee be conducting the day-to-day operations of the business? No Yes
If no, list the name and address of the person(s) who will: _____
- Class B Applicants: If the agent, a partner or the individual licensee will not be conducting the day-to-day operations of the business, the person(s) listed above must obtain a Class B Managers license.
- c) Does anyone else have money invested or any other interest in this business? No Yes
If yes, explain: _____
 - d) Have you made an agreement with anyone to repay any loan or any other payments based upon income from the business?
 No Yes If yes, list name and address: _____

Proof of Ownership, Lease, or Offer to Purchase (new & transfer applicants only)

Submit proof of ownership, lease, or offer to purchase the building with this application.
A lease or offer to purchase must:

- a) Be in the same legal entity name as that apply for the license
- b) Reflect the same address as the premises address on this application
- c) Reflect current dates and
- d) Be signed by the lessor/seller and lessee/buyer

Property Information (new & transfer applicants only)

- a) Do you own or lease the building? Own Lease
 - b) Who owns the fixtures (for example, coolers, etc.)? Eclectic Works LLC
 - c) Are you purchasing the stock and/or fixtures? No Yes If yes, amount paid \$ _____
 - d) Total amount paid for business \$ 0
 - e) Total amount paid for goodwill of the business \$ 0
- Goodwill comprises the reputation and customer relationships of an existing business. If the price you pay for the business exceeds the fair market value of all of the rest of the assets of the business, the excess may be considered goodwill.
- f) Have you made arrangements with the seller for payment of personal property taxes? No Yes

See Application Information for a list of all required application forms.

Lease Information (new & transfer applicants who are leasing the premises only)

- a) Date lease begins 1-3-2016 Ends 1-2021
- b) Monthly rental \$ 1400
- c) Do you have an option to renew the lease? No Yes
- d) Does your lease allow for assignment to another party without the consent of the owner? No Yes
- e) For what length of time have you been guaranteed occupancy (number of years)? 5 years
- f) In addition to paying the monthly rental, will you have to pay anything additional to the owner of the building to guarantee performance of the lease? No Yes If yes, explain utilities and upkeep of building
- g) Does the present owner or occupancy object to the granting of your license? No Yes
If yes, explain _____

Change of Agent Applicants Only

Have there been any changes to the floor plan since the last application was submitted? No Yes
If no, a new floor plan is not required. If yes, submit a new floor plan and explain the change(s): _____

Notarized Signatures of Applicants

SUBSCRIBED AND SWORN TO BEFORE ME
This 20 day of August

[Signature]
(Clerk/Notary Public)

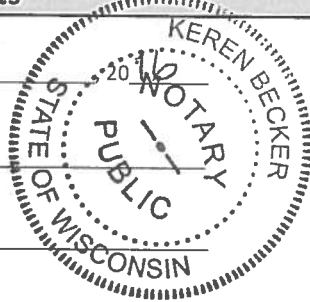

[Signature]
Sole Proprietor, Partner, 20% or more Shareholder, or
Agent – only if there are no 20% or more shareholders

My Commission Expires 10/1/13
*Notary Seal must be affixed.

Additional partner or 20% or more shareholder

Note: All information contained in this application is subject to approval by the Common Council.
Deviating from approved plan of operation will subject licensee to citations, and/or suspension or non-renewal of the license.
Contact the License Division for information on how to request changes.

New and transfer of premise applicants must submit the following:

- Proof of ownership, lease or offer to purchase the building
- Detailed floor plan
- If a restaurant, copy of the menu



FOOD DEALER LICENSE PLAN OF OPERATION

ccl-foodplan 2/22/16

OFFICE OF THE CITY CLERK, LICENSE DIVISION
CITY HALL, 200 E. WELLS ST, ROOM 105, MILWAUKEE, WI 53202
(414) 286-2238 • license@milwaukee.gov • www.milwaukee.gov/license

Legal Entity Name: Eclectic Works L.L.C

Premises Address: 3580 N. Teutonia Ave

SECTION 1

Type of application (check one): taking over a currently operating business starting a new business
Anticipated opening date? 8/15/2016

Check the type that best describes your business (check only one):

See Food Dealer License Information sheet for definitions.

- Restaurant
- Retail Establishment
 - If retail, will it be a convenience store? Yes No
 - (less than 5,000 sq ft of retail space, primary business is the sale of basic food items, and in addition sells household products)
- Community Food Program
- Bed & Breakfast
- Base for Food Peddler
- Base for Temporary/Seasonal Food Stand

In addition, will any wholesale business be done? Yes No

If yes, what percentage of the business will be wholesale? Less than 25% 25% or More (Contact DATCP)*

Will retail items be sold? No Yes If Yes, indicate percentage of food sales 80% 70%

Will restaurant items be sold? No* Yes If Yes, indicate percentage of food sales _____ %

* If you checked "25% or More" of the business will be wholesale and answered "No" to restaurant items being sold, do not continue completing this application. A City of Milwaukee License is not required. Contact DATCP only.

SECTION 2

Will you be sharing kitchen space with another operator?

- No If No, SKIP to Section 3
- Yes If Yes, check one:
 - I will rent space from another operator ("Shared Kitchen Agreement" is required)
 - I will rent space to another operator (peddler/caterer)

SECTION 3

Answer the following questions:

- Will you have seating on site for dining? No Yes
- Will you be doing any catering? No Yes
- Will you be doing any delivery? No Yes
- Will you have outdoor activities? No Yes
 - If Yes to outdoor activities, check all that apply: Bar Cooking/Grilling Dining
- Will you have a drive thru window? No Yes
 - If Yes to drive thru, are hours different from inside? No Yes
 - If Yes, provide drive thru hours: _____
- Will any scales or barcode scanners be used? No Yes
 - If Yes, a Weights & Measures application must be completed and a license obtained.

SECTION 4

Where will food be prepared and/or sold?

- At a single site
- At multiple sites (for example, a hotel with several dining rooms or bars) How many? _____
If multiple sites, attach a Food Dealer Additional Site Addendum (ccl-foodadd) for each additional site.

SECTION 5

Are you planning any construction, remodeling or equipment changes?

- No If No, SKIP to Section 6
- Yes If Yes, check all that apply:
 - New construction of a building
 - Construction changes to an existing building
 - Renovation or remodeling
 - Equipment changes only (installation or replacement)

Provide a brief description of the changes: _____

Start date: _____

Name, Address & Phone Number of Architect: _____

Name, Address & Phone Number of Contractor: _____

SECTION 6

Are you applying for an alcohol beverage license?

- No If No, SKIP to Section 7
- Yes If YES, if your food license is approved prior to the alcohol beverage license, when do you want the food license issued? Immediately At the same time as the alcohol license

SECTION 7

You must initial each item confirming your understanding:

- I understand the Health Department must conduct an inspection and advise the License Division of their approval before the license may be issued.
- I understand I must obtain an occupancy permit from the Department of Neighborhood Services and an inspection may be required. Neighborhood Services must advise the License Division of their approval before the license may be issued.
- I understand the district alderperson will review and either approve or deny my application. If denied, I may appeal and be scheduled to appear before the Licenses Committee. The Licenses Committee will then make a recommendation to the Common Council. The Common Council must grant the license before it may be issued.
- I understand proof of payment for all license fees must be on file in the License Division before the license may be issued.
- I understand the license must be issued and posted in my establishment prior to opening for business.
- I will not operate my food business until the license has been issued and posted in the establishment.

Signature of sole proprietor, partner, agent or 20% shareholder: Sanjiv Kumar

Signature of additional partner(s): _____

8-3-2016

Garthiel Barnes / Barnes Foods
Eclectic Works LLC
3580 N. Teutonia
Milwaukee, WI 53221

30086 Ft

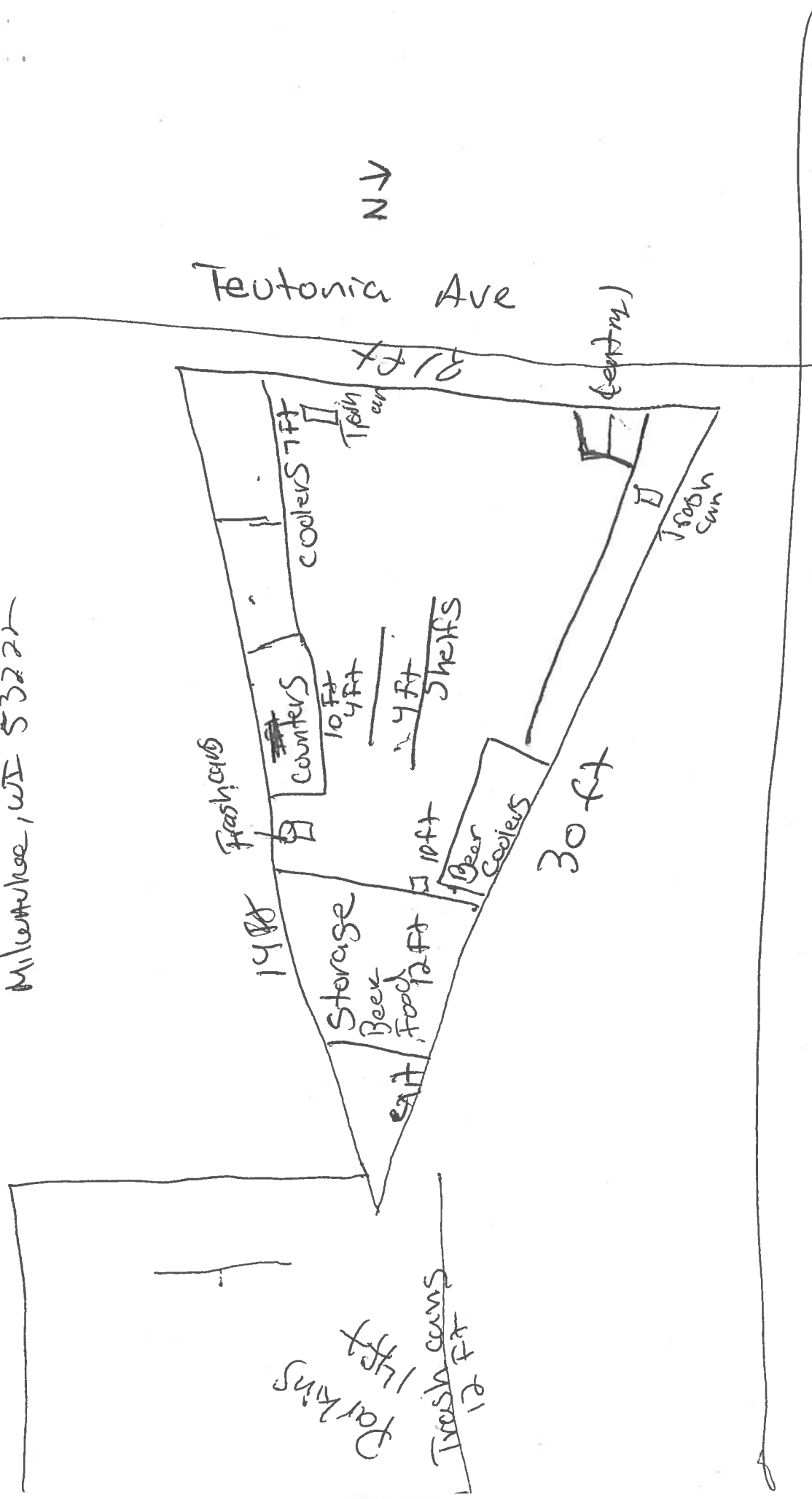

Fina st



**CITY OF MILWAUKEE
OFFICE OF THE CITY CLERK**

Friday, February 03, 2017

COMMITTEE MEETING NOTICE

AD 06

GEORGE L ORTIZ

2579 N Pierce St

Milwaukee, WI 53212

You are requested to attend a hearing which is to be held in Room 301-B, Third Floor, City Hall on:

Tuesday, February 14, 2017 at 10:30 AM

Regarding: Your Class B Tavern and Public Entertainment Premises License Renewal Applications for "Club 99" at 2579 N Pierce St.

There is a possibility that your application may be **denied** for one or more of the following reasons: The recommendation of the committee regarding the application shall be based on evidence presented at the hearing. Per MCO 85-4-4, unless otherwise specified in the code, probative evidence concerning non-renewal, suspension or revocation may include evidence of the following: failure of the applicant to meet municipal qualifications, pending charges against or the conviction of any felony, misdemeanor, municipal offense or other offense, the circumstances of which substantially relate to the circumstances of the particular licensed or permitted activity, by the applicant or by any employee or other agent of the applicant. If the activities of the applicant involve a licensed premises, whether the premises tends to facilitate a public or private nuisance or has been the source of congregations of persons which have resulted in any of the following: disturbance of the peace; illegal drug activity; public drunkenness; drinking in public; harassment of passers-by; gambling; prostitution; sale of stolen goods; public urination; theft; assaults; battery; acts of vandalism including graffiti, excessive littering, loitering, illegal parking, loud noise at times when the licensed premise is open for business; traffic violations; curfew violations; lewd conduct; display of materials harmful to minors, pursuant to s. 106-9.6; or any other factor which reasonably relates to the public health, safety and welfare, or failure to comply with the approved plan of operation. See attached police report or correspondence.

Notice for applicants with warrants or unpaid fines:

Proof of warrant satisfaction or payment of fines must be submitted at the hearing on the above date and time. Failure to comply with this requirement may result in a delay of the granting/denial of your application.

Failure to appear at this meeting may result in the denial of your license. Individual applicants must appear only in person or by an attorney. Corporate or Limited Liability applicants must appear only by the agent designated on the application or by an attorney. Partnership applicants must appear by a partner listed on the application or by an attorney. If you wish to do so and at your own expense, you may be accompanied by an attorney of your choosing to represent you at this hearing.

You will be given an opportunity to speak on behalf of the application and to respond and challenge any charges or reasons given for the denial. No petitions can be accepted by the committee, unless the people who signed the petition are present at the committee hearing and willing to testify. You may present witnesses under oath and you may also confront and cross-examine opposing witnesses under oath. If you have difficulty with the English language, you should bring an interpreter with you, at your expense, so that you can answer questions and participate in your hearing.

You may examine the application file at this office during regular business hours prior to the hearing date. Inquiries regarding this matter may be directed to the person whose signature appears below.

Limited parking for persons attending meetings in City Hall is available at reduced rates (5 hour limit) at the Milwaukee Center on the southwest corner of East Kilbourn and North Water Street. Parking tickets must be validated in the first floor information booth in City Hall.

PLEASE NOTE: Upon reasonable notice, efforts will be made to accommodate the needs of disabled individuals through sign language interpreters or other auxiliary aids. For additional information or to request this service, contact the Council Services Division ADA Coordinator at (414) 286-2998, Fax - (414) 286-3456, TDD - (414) 286-2025.

JIM OWZARSKI, CITY CLERK

BY:

Jason Schunk
License Division Manager

If you have questions regarding this notice, please contact the License Division at (414) 286-2238.

200 E. Wells Street, Room 105, City Hall, Milwaukee, WI 53202. www.milwaukee.gov/license
Phone: (414) 286-2238 Fax: (414) 286-3057 Email Address: License@milwaukee.gov

Cerella, Jessica

From: Coggs, Milele
Sent: Wednesday, February 01, 2017 4:11 PM
To: Cerella, Jessica
Subject: FW: Club 99

REDACTED RECORD

From:
Sent: Tuesday, August 30, 2016 4:36 PM
To: Coggs, Milele
Subject: Fwd: Club 99

Hi Alderwoman Coggs,

I received a voicemail from someone in your office today, and am thankful you are looking into this! I would rather not be named if you talk to the bar owner. We really try to be friendly with him and I'd much rather keep the peace than seem confrontational.

What I'd really, ideally love to instate is some sort of neighborhood bar rule that says people need to be respectful and indoors by 10pm, or something like that.

Please let me know if you think something like that might be doable.

Thank you.

From:
Sent: Friday, August 26, 2016 10:55 PM
To: Kovac, Nik
Cc:
Subject: Club 99

Hi Mr. Kovac,

I hope you're doing well. This email is a LONG time coming, and I really hope there's something you can do to help.

My husband and I own a duplex on
from Club 99, a bar.

in Riverwest. We live

The bar continuously plays loud music at night, and keeps all its doors open. We can literally hear the bass booming in our home -- windows rattling, etc. We have tenants above us who also hear the same things we do. The bar also has a problem with super loud people standing outside talking, yelling, screaming, throwing bottles around, at all hours of the night. There are also frequently cars parked outside blasting their radios and just being completely obnoxious.

We have a decent relationship with the bar owner, Willy.

we've even had to call the police a couple times. We HATE that we have to do this. We are constantly policing him, and it's just no way to live. We feel that he talks a good talk to us about how he's going to try to keep things quieter, but once his patrons are in the bar, he no longer has a backbone and lets them do whatever they want. He also parties right along with them, so tends to lose control over his patrons. We just can't keep calling him every single night asking him to quiet down. When we do call, he normally shuts the doors, which at least keeps the music from reaching our house. But there are always still people outside, bottles left on our lawns, etc. It's just very disrespectful and not representative of the rest of our neighborhood.

I'm wondering why there's not some kind of neighborhood bar rule in Riverwest. This might be Riverwest, but it's not Water Street. It's residential. I can recall going to bars in residential neighborhoods in Bay View -- and at 10pm everyone needs to be inside, all the doors are closed, etc. There are signs inside and outside the bars asking people to please be quiet and respectful of the neighbors. Why can't we do this?? It just seems ridiculous that there is this loud, bumping, ridiculous bar smack in the middle of a generally quiet neighborhood. We are just sick of being the "bad guys" and harping on the bar owner. We also feel that it puts us in danger when the bar is being loud and we have to go stand on our porch and tell people to quiet down. It's just not a safe situation for anyone. It's also sad that we can never even consider sitting on our porch on the weekends -- it's just too loud and crazy out there.

We love Riverwest and my husband has lived here for 20 years. We aren't asking for silence or even quiet --- just respect. We are constantly cleaning up trash, mowing our neighbors' lawns, and going above and beyond to make at least our little corner a nice place. We would really appreciate your help in figuring out what to do with Club 99 so that our neighborhood can be pleasant for everyone.

Thank you so so so so much.

The City of Milwaukee is subject to Wisconsin Statutes related to public records. Unless otherwise exempted from the public records law, senders and receivers of City of Milwaukee e-mail should presume that e-mail is

**MILWAUKEE POLICE DEPARTMENT
LICENSE INVESTIGATION UNIT**

**CRIMINAL RECORD/ORDINANCE VIOLATION/INCIDENTS
SYNOPSIS**

DATE: 01/18/2017
LICENSE TYPE: BTAVN
NEW:
RENEWAL: X

No. 245578
Application Date: 01/18/2017
Expiration Date:

License Location: 2579 N Pierce Street
Business Name: Club 99

Aldermanic District: 03

Licensee/Applicant: Ortiz, George L

(Last Name, First Name, MI)

Date of Birth: 03/20/1947

Male:

Female:

Home Address: 631 E Clarke Street

City: Milwaukee

State: WI

Zip Code: 53212

Home Phone: (414) 372-6623

This report is written by Police Officer Gilbert Gwinn, assigned to the License Investigation Unit, Days.

The Milwaukee Police Department's investigation regarding this application revealed the following:

1. On 10/24/07 at 1:00 am, Milwaukee Police received a tip from a citizen (who wanted to remain anonymous) that there was drug dealing going on inside the tavern Club 99. Investigation revealed a patron that was inside of the tavern was in possession of suspected cocaine. Officers interview this subject who stated he uses the cocaine for personal use and hangs out at the club because his father tends bar there. This suspect also stated that several other patrons in the bar sell cocaine. He was arrested and charged with POCS – Cocaine.

- =====
2. On 06/02/2009 at 1:15PM, a Milwaukee Police Department squad was sent to 409 E Burleigh St, regarding a battery complaint. The victim stated she was at "Club 99" tavern on 05/31/2009 between 10:00PM and 10:30PM when she got into an argument with a known suspect. The victim then went into the bathroom and upon returning to bar area was struck in the face causing her to fall to the ground. The victim went to St Mary's hospital and received several stitches to her lip. The licensee and his son were cooperative with the police during the investigation and provided a copy of the video footage.
- =====

3. On 05/21/2010 at 10:40am Milwaukee Police were dispatched to a burglary complaint at 2579 North Pierce Street (Club 99). Investigation revealed an entry had occurred at this location and Police Incident Report #101410041 was filed.
4. On 05/23/2010 at 12:00pm Milwaukee Police were dispatched to a burglary complaint at 2579 North Pierce Street (Club 99). Investigation revealed an entry had occurred at this location and Police Incident Report #101430108 was filed. The entry that occurred on 05/21/2010 (listed above) resulted in the door to the business being secured with a strap that had been bolted to a table. Entry was gained on 05/23/2010 by pulling on the door until that table broke.

=====

5. On 10/22/2015 the applicant was cited at 2648 North Holton Street in the city of Milwaukee for Building Code Violations.

Charge: Building Code Violations
Finding: Due for further proceedings 05/02/2017 8:30am branch 3
Sentence:
Date:
Case: 16055770

6. On 11/16/2015 the applicant was cited at 2330 North Weil Street in the city of Milwaukee for Building Code Violations.

Charge: Building Code Violations
Finding: Guilty
Sentence: \$600.00 fine
Date: 06/02/2016
Case: 16017215



Friday, February 03, 2017



Notice of Public Hearing

ORTIZ, George L
Club 99 at 2579 N Pierce St
Class B Tavern and Public Entertainment Premises License Renewal Applications

Tuesday, February 14, 2017 at 10:30 AM

To whom it may concern:

The above application has been made by the above named applicant(s). This requires approval from the Licenses Committee and the Common Council of the City of Milwaukee. The hearing before the Licenses Committee will take place on 2/14/2017 at 10:30 AM, in Room 301-B, Third Floor, City Hall. If you wish, you may provide testimony at the hearing regarding the request; see below for further information. You are not required to attend the hearing. Once the Licenses Committee makes its recommendation, this recommendation is forwarded to the full Common Council for approval at its next regularly scheduled hearing. Please review the information below and if you have further questions regarding this process, please contact the License Division at (414) 286-2238.

Important details for those wishing to provide information for the Licenses Committee to consider when making its recommendation:

1. The license application is scheduled to be heard at the above time. Due to other hearings running longer than scheduled, you may have to wait some time to provide your testimony.
2. You must appear in person and testify as to matters that you have personally experienced or seen. (You cannot provide testimony for your neighbor, parent or anyone else; this is considered hearsay and cannot be considered by the committee.)
3. No letters or petitions can be accepted by the committee (unless the person who wrote the letter or the persons who signed the petition are present at the committee hearing and willing to testify).
4. Persons opposed to the license application are given the opportunity to testify first; supporters may testify after the opponents have finished.
5. When you are called to testify, you will be sworn in and asked to give your name, and address. (If your first and/or last names are uncommon please spell them.)
6. You may then provide testimony.
 - a. Include only information relating to the above license application.
 - b. Include only information you have personally witnessed or seen.
 - c. Provide concise and relevant information detailing how this business has affected or may affect the peaceful enjoyment of your neighborhood.
 - d. If by the time you have the opportunity to testify, the information you wish to share has already been provided to the committee, you may state that you agree with the previous testimony. Redundant or repetitive testimony will not assist the committee in making its recommendation.
7. After giving your testimony, the members of the Licenses Committee and the licensee may ask questions regarding the testimony you have given or other factors relating to the license application.
8. Business Competition is not a valid basis for denial or non-renewal of a license.
Please Note: If you have submitted an objection to the above application your objection cannot be considered by the committee unless you personally testify at the hearing.

OCCUPANT	MAIL ADDRESS	CITY AND ZIP CODE
CURRENT OCCUPANT	721 E CLARKE ST	MILWAUKEE, WI 53212-2946
CURRENT OCCUPANT	720 E CLARKE ST	MILWAUKEE, WI 53212-2947
CURRENT OCCUPANT	727 E CLARKE ST	MILWAUKEE, WI 53212-2946
CURRENT OCCUPANT	2615 N PIERCE ST	MILWAUKEE, WI 53212-2954
CURRENT OCCUPANT	2617A N PIERCE ST	MILWAUKEE, WI 53212-2954
CURRENT OCCUPANT	2611 N PIERCE ST	MILWAUKEE, WI 53212-2954
CURRENT OCCUPANT	619 E CLARKE ST	MILWAUKEE, WI 53212-2924
CURRENT OCCUPANT	2607 N PIERCE ST	MILWAUKEE, WI 53212-2954
CURRENT OCCUPANT	2568 N PIERCE ST	MILWAUKEE, WI 53212-2953
CURRENT OCCUPANT	2558 N PIERCE ST	MILWAUKEE, WI 53212-2953
CURRENT OCCUPANT	2565A N FRATNEY ST	MILWAUKEE, WI 53212-2948
CURRENT OCCUPANT	2565 N FRATNEY ST	MILWAUKEE, WI 53212-2948
CURRENT OCCUPANT	2608 N BOOTH ST	MILWAUKEE, WI 53212-2909
CURRENT OCCUPANT	2602 N BOOTH ST 1	MILWAUKEE, WI 53212-2966
CURRENT OCCUPANT	2556 N BOOTH ST	MILWAUKEE, WI 53212-2907
CURRENT OCCUPANT	2623A N PIERCE ST	MILWAUKEE, WI 53212-2954
CURRENT OCCUPANT	621 E CLARKE ST	MILWAUKEE, WI 53212-2924
CURRENT OCCUPANT	2551 N PIERCE ST	MILWAUKEE, WI 53212-2952
CURRENT OCCUPANT	2612 N PIERCE ST	MILWAUKEE, WI 53212-2955
CURRENT OCCUPANT	2560 N PIERCE ST	MILWAUKEE, WI 53212-2953
CURRENT OCCUPANT	2552 N PIERCE ST	MILWAUKEE, WI 53212-2953
CURRENT OCCUPANT	2550 N BOOTH ST	MILWAUKEE, WI 53212-2907
CURRENT OCCUPANT	2618 N PIERCE ST	MILWAUKEE, WI 53212-2955
CURRENT OCCUPANT	2624 N PIERCE ST	MILWAUKEE, WI 53212-2955
CURRENT OCCUPANT	2557 N PIERCE ST	MILWAUKEE, WI 53212-2952
CURRENT OCCUPANT	2602 N BOOTH ST 4	MILWAUKEE, WI 53212-2966
CURRENT OCCUPANT	2578 N BOOTH ST	MILWAUKEE, WI 53212-2907
CURRENT OCCUPANT	2568 N BOOTH ST	MILWAUKEE, WI 53212-2907
CURRENT OCCUPANT	2570 N BOOTH ST	MILWAUKEE, WI 53212-2907
CURRENT OCCUPANT	2548 N BOOTH ST	MILWAUKEE, WI 53212-2907
CURRENT OCCUPANT	2540 N BOOTH ST	MILWAUKEE, WI 53212-2907
CURRENT OCCUPANT	618 E CLARKE ST	MILWAUKEE, WI 53212-2925
CURRENT OCCUPANT	2571 N PIERCE ST	MILWAUKEE, WI 53212-2952
CURRENT OCCUPANT	2561 N PIERCE ST	MILWAUKEE, WI 53212-2952
CURRENT OCCUPANT	2570 N PIERCE ST	MILWAUKEE, WI 53212-2953
CURRENT OCCUPANT	2546 N PIERCE ST	MILWAUKEE, WI 53212-2953
CURRENT OCCUPANT	712A E CLARKE ST	MILWAUKEE, WI 53212-2947
CURRENT OCCUPANT	2602 N BOOTH ST 2	MILWAUKEE, WI 53212-2966
CURRENT OCCUPANT	2576 N BOOTH ST	MILWAUKEE, WI 53212-2907
CURRENT OCCUPANT	722 E CLARKE ST	MILWAUKEE, WI 53212-2947
CURRENT OCCUPANT	727A E CLARKE ST	MILWAUKEE, WI 53212-2946
CURRENT OCCUPANT	2613 N PIERCE ST	MILWAUKEE, WI 53212-2954
CURRENT OCCUPANT	2601 N PIERCE ST	MILWAUKEE, WI 53212-2954
CURRENT OCCUPANT	631 E CLARKE ST	MILWAUKEE, WI 53212-2924
CURRENT OCCUPANT	2604 N PIERCE ST	MILWAUKEE, WI 53212-2955
CURRENT OCCUPANT	2564 N PIERCE ST	MILWAUKEE, WI 53212-2953
CURRENT OCCUPANT	2556 N PIERCE ST	MILWAUKEE, WI 53212-2953
CURRENT OCCUPANT	2546A N PIERCE ST	MILWAUKEE, WI 53212-2953
CURRENT OCCUPANT	2544A N PIERCE ST	MILWAUKEE, WI 53212-2953
CURRENT OCCUPANT	2571 N FRATNEY ST	MILWAUKEE, WI 53212-2948
CURRENT OCCUPANT	2561 N FRATNEY ST	MILWAUKEE, WI 53212-2948
CURRENT OCCUPANT	2550 N BOOTH ST A	MILWAUKEE, WI 53212-2907
CURRENT OCCUPANT	2552 N BOOTH ST	MILWAUKEE, WI 53212-2907
CURRENT OCCUPANT	2623B N PIERCE ST	MILWAUKEE, WI 53212-2954
CURRENT OCCUPANT	2623 N PIERCE ST	MILWAUKEE, WI 53212-2954

CURRENT OCCUPANT	2545A N PIERCE ST	MILWAUKEE, WI 53212-2952
CURRENT OCCUPANT	708 E CLARKE ST	MILWAUKEE, WI 53212-2947
CURRENT OCCUPANT	712 E CLARKE ST	MILWAUKEE, WI 53212-2947
CURRENT OCCUPANT	2618A N PIERCE ST	MILWAUKEE, WI 53212-2955
CURRENT OCCUPANT	716 E CLARKE ST	MILWAUKEE, WI 53212-2947
CURRENT OCCUPANT	2617B N PIERCE ST	MILWAUKEE, WI 53212-2954
CURRENT OCCUPANT	2617 N PIERCE ST	MILWAUKEE, WI 53212-2954
CURRENT OCCUPANT	2565 N PIERCE ST	MILWAUKEE, WI 53212-2952
CURRENT OCCUPANT	2555 N PIERCE ST	MILWAUKEE, WI 53212-2952
CURRENT OCCUPANT	2541 N PIERCE ST	MILWAUKEE, WI 53212-2952
CURRENT OCCUPANT	2576 N PIERCE ST	MILWAUKEE, WI 53212-2953
CURRENT OCCUPANT	2576A N PIERCE ST	MILWAUKEE, WI 53212-2953
CURRENT OCCUPANT	2554 N PIERCE ST	MILWAUKEE, WI 53212-2953
CURRENT OCCUPANT	2540 N PIERCE ST	MILWAUKEE, WI 53212-2953
CURRENT OCCUPANT	2602 N BOOTH ST 3	MILWAUKEE, WI 53212-2966
CURRENT OCCUPANT	2558 N BOOTH ST	MILWAUKEE, WI 53212-2907
CURRENT OCCUPANT	2556A N BOOTH ST	MILWAUKEE, WI 53212-2907
CURRENT OCCUPANT	2620 N BOOTH ST	MILWAUKEE, WI 53212-2909
CURRENT OCCUPANT	620 E CLARKE ST	MILWAUKEE, WI 53212-2925
CURRENT OCCUPANT	2545 N PIERCE ST	MILWAUKEE, WI 53212-2952
CURRENT OCCUPANT	2539 N PIERCE ST	MILWAUKEE, WI 53212-2952
CURRENT OCCUPANT	2605 N PIERCE ST	MILWAUKEE, WI 53212-2954
CURRENT OCCUPANT	2603 N PIERCE ST	MILWAUKEE, WI 53212-2954
CURRENT OCCUPANT	2604A N PIERCE ST	MILWAUKEE, WI 53212-2955
CURRENT OCCUPANT	2544 N PIERCE ST	MILWAUKEE, WI 53212-2953
CURRENT OCCUPANT	2571A N FRATNEY ST	MILWAUKEE, WI 53212-2948
CURRENT OCCUPANT	2606 N BOOTH ST	MILWAUKEE, WI 53212-2909
CURRENT OCCUPANT	2602 N BOOTH ST 5	MILWAUKEE, WI 53212-2966
CURRENT OCCUPANT	605 E CLARKE ST	MILWAUKEE, WI 53212-2924
CURRENT OCCUPANT	2566 N BOOTH ST	MILWAUKEE, WI 53212-2907
CURRENT OCCUPANT	2562 N BOOTH ST	MILWAUKEE, WI 53212-2907
CURRENT OCCUPANT	2546 N BOOTH ST	MILWAUKEE, WI 53212-2907

Total Records: 88

Radius: 250.0 feet and Center of Circle: 2579 N Pierce ST

2016-2017 Plan of Operation for 2579 N PIERCE ST

1. Litter & Security Plans			
How are the grounds kept clean? <input checked="" type="checkbox"/> Sweep <input checked="" type="checkbox"/> Pressure Wash <input checked="" type="checkbox"/> Pick Up Litter <input checked="" type="checkbox"/> Other: <u>Backpack Blower</u>			
How often will grounds be cleaned? <input checked="" type="checkbox"/> Daily <input type="checkbox"/> Weekly <input type="checkbox"/> Other:			
Who cleans the grounds? <input checked="" type="checkbox"/> Licensee <input checked="" type="checkbox"/> Building Owner <input checked="" type="checkbox"/> Employees <input type="checkbox"/> Hired Maintenance <input type="checkbox"/> Other:			
How are noise issues prevented and/or addressed? <input type="checkbox"/> Security <input checked="" type="checkbox"/> Manager approaches customer(s) <input checked="" type="checkbox"/> Call Police <input checked="" type="checkbox"/> Signs Posted <input type="checkbox"/> Other:			
Are there designated outdoor smoking areas? <input type="checkbox"/> No <input checked="" type="checkbox"/> Yes If Yes, Describe: <u>By side of Building</u>			
Number of garbage cans: Inside <u>2</u> Locations: <u>North side of Building corners of bar</u> Outside <u>2</u> Locations: <u>North side of Building</u>			
Is a crowd control barrier used? <input checked="" type="checkbox"/> No <input type="checkbox"/> Yes If Yes, Describe:			
Number of restrooms: <u>2</u>			
Name of solid waste contractor: <u>Waste Management</u>			
Are there parking spaces on the premises? <input checked="" type="checkbox"/> No <input type="checkbox"/> Yes If Yes, list number of spaces: _____ and describe security plans:			
Are there designated loading areas? <input checked="" type="checkbox"/> No <input type="checkbox"/> Yes If Yes, describe security plans:			
Do you have security personnel on the premise? <input checked="" type="checkbox"/> No <input type="checkbox"/> Yes If Yes, how many? _____ AND What are their responsibilities? _____ What security equipment do they use? _____ List their licensing, certification or training credentials: _____			
Are there security cameras? <input type="checkbox"/> No <input checked="" type="checkbox"/> Yes If Yes, list all locations: <u>2 inside & 2 outside</u>			
Are searches and/or identification checks conducted upon entry? <input type="checkbox"/> No <input type="checkbox"/> Yes If Yes, describe:			
2. Percentage of Sales (must total 100%)			
Alcohol <u>90</u> %	Food Sales _____ %	Entertainment <u>10</u> %	Other _____ %
3. Businesses On The Premises (choose all that apply):			
<input type="checkbox"/> Restaurant	<input type="checkbox"/> Cafe/Coffee Shop	<input type="checkbox"/> Cocktail Lounge	<input type="checkbox"/> Convenience Store <input type="checkbox"/> Other:
<input type="checkbox"/> Night Club	<input checked="" type="checkbox"/> Tavern	<input type="checkbox"/> Banquet Hall	<input type="checkbox"/> Sports Facility
<input type="checkbox"/> Liquor Store	<input type="checkbox"/> Hotel	<input type="checkbox"/> Supermarket	<input type="checkbox"/> Private/Fraternal/Veterans' Club
4. Hours of Operation and Age Restriction			
Are there any changes to the current hours of operation or age restriction? <input checked="" type="checkbox"/> No <input type="checkbox"/> Yes If Yes, Describe:			
Please Note: If you will be open earlier or later than the hours listed on your current license for even one event or holiday (for example, St. Patrick's Day, Brewers Opening Day, etc.) during the license period, this must be reported and printed on your license. Your hours of operation and age restriction are listed on your current license.			
5. Floor Plan and Capacity			
Are you requesting any changes to the floor plan or capacity? <input checked="" type="checkbox"/> No <input type="checkbox"/> Yes If Yes, Describe:			
If requesting changes to the floor plan, submit a new floor plan with this application. Changes in floor plan include changing the location of tables, games, etc. within your current licensed premises. If your changes include adding any additional areas or square footage to your premises, or any renovations to the building will be done, a Permanent Extension of Premises application must be filed.			
6. Sidewalk Dining (if renewing a current license)			
Are there any changes to the sidewalk dining site plan? <input checked="" type="checkbox"/> No <input type="checkbox"/> Yes If Yes, submit an updated site plan with this application.			

PUBLIC ENTERTAINMENT PREMISES RENEWAL SUPPLEMENTARY APPLICATION

1. CURRENT APPROVED ENTERTAINMENT

The following types of entertainment have been approved for your current Public Entertainment Premises license:

Jukebox, 1 Pool Table, 5 Amusement Machines

2. ADDING ENTERTAINMENT

If applicable, check any entertainment you wish to ADD:

- | | | | |
|---|--|--|---|
| <input type="checkbox"/> Instrumental Musicians | <input type="checkbox"/> Bands | <input type="checkbox"/> Battle of the Bands | <input type="checkbox"/> Comedy Acts |
| <input type="checkbox"/> Disc Jockey | <input type="checkbox"/> Magic Shows | <input type="checkbox"/> Poetry Readings | <input type="checkbox"/> Dancing by Performers |
| <input type="checkbox"/> Jukebox | <input type="checkbox"/> Wrestling | <input type="checkbox"/> Patron Contests | <input type="checkbox"/> Patrons Dancing |
| <input type="checkbox"/> Adult Entertainment/
Strippers/Erotic Dance | <input type="checkbox"/> Karaoke | <input type="checkbox"/> Bowling Alley | <input type="checkbox"/> Pool Tables |
| <input type="checkbox"/> Motion Pictures
How many screens? _____ | <input type="checkbox"/> Amusement Machines –
How many? _____ | <input type="checkbox"/> Concerts
Approx. # per year? _____ | <input type="checkbox"/> Theatrical Performances
Approx. # per year? _____ |
| <input type="checkbox"/> Other: _____ | | | |

No entertainment changes can take place until approved by Common Council and a new license has been issued and posted on the premises.

3. REMOVING ENTERTAINMENT

If applicable, list any entertainment you wish to remove:

4. PROMOTERS/SOUND AMPLIFICATION

Will promoters ever be used for any of the entertainment? No Yes If Yes, Describe:

At any time will sound amplification be used? No Yes If Yes, Describe:

5. NOTARIZED SIGNATURES

I understand that after the license has been issued, a change to the plan of operation will require a written request to change and approval from the Common Council.

I agree to inform the City Clerk within 10 days of any substantial changes in the information supplied in this application.

I understand that I shall not willfully refuse to provide the services offered under this license, or add charges or require deposits not required of the general public because of race, color, sex, religion, national origin or ancestry, age, handicap, lawful source of income, marital status, sexual orientation, gender identity or expression, familial status or the fact that a person is now or has been a member of the military service, whether dressed in uniform or not; and shall not seek such information as a condition of employment, or penalize any employee or discriminate in the selection of personnel for training or promotion on the basis of such information.

I have knowledge of the City Ordinances currently regulating public entertainment, and understand that the license may be subject to suspension, non-renewal or revocation, if I violate any rule, law or regulation of the City of Milwaukee and State of Wisconsin.

SUBSCRIBED AND SWORN TO BEFORE ME

This 12th day of January, 2017

(Clerk/Notary Public)

My Commission Expires permanent

*Notary Seal must be affixed.

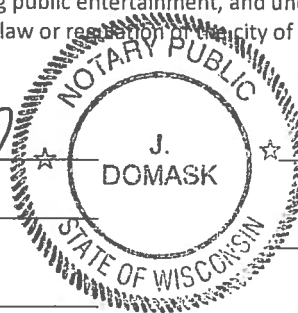

George L. Citi
Agent/20% or More Shareholder/Partner

Additional 20% or More Shareholder/Partner



**CITY OF MILWAUKEE
OFFICE OF THE CITY CLERK**

Thursday, February 02, 2017

COMMITTEE MEETING NOTICE

AD 06

ISAAC T RAGSDALE

3305 N MARTIN L KING JR DR

MILWAUKEE, WI 53212

You are requested to attend a hearing which is to be held in Room 301-B, Third Floor, City Hall on:

Tuesday, February 14, 2017 at 10:30 AM

Regarding: Your Class A Malt & Class A Liquor and Food Dealer License Renewal Applications for "GREEN RING II" at 3305 N MARTIN L KING JR DR.

There is a possibility that your application may be denied for one or more of the following reasons: The recommendation of the committee regarding the application shall be based on evidence presented at the hearing. Per MCO 85-4-4, unless otherwise specified in the code, probative evidence concerning non-renewal, suspension or revocation may include evidence of the following: failure of the applicant to meet municipal qualifications, pending charges against or the conviction of any felony, misdemeanor, municipal offense or other offense, the circumstances of which substantially relate to the circumstances of the particular licensed or permitted activity, by the applicant or by any employee or other agent of the applicant. If the activities of the applicant involve a licensed premises, whether the premises tends to facilitate a public or private nuisance or has been the source of congregations of persons which have resulted in any of the following: disturbance of the peace; illegal drug activity; public drunkenness; drinking in public; harassment of passers-by; gambling; prostitution; sale of stolen goods; public urination; theft; assaults; battery; acts of vandalism including graffiti, excessive littering, loitering, illegal parking, loud noise at times when the licensed premise is open for business; traffic violations; curfew violations; lewd conduct; display of materials harmful to minors, pursuant to s. 106-9.6; or any other factor which reasonably relates to the public health, safety and welfare, or failure to comply with the approved plan of operation. See attached police report or correspondence.

Notice for applicants with warrants or unpaid fines:

Proof of warrant satisfaction or payment of fines must be submitted at the hearing on the above date and time. Failure to comply with this requirement may result in a delay of the granting/denial of your application.

Failure to appear at this meeting may result in the denial of your license. Individual applicants must appear only in person or by an attorney. Corporate or Limited Liability applicants must appear only by the agent designated on the application or by an attorney. Partnership applicants must appear by a partner listed on the application or by an attorney. If you wish to do so and at your own expense, you may be accompanied by an attorney of your choosing to represent you at this hearing.

You will be given an opportunity to speak on behalf of the application and to respond and challenge any charges or reasons given for the denial. No petitions can be accepted by the committee, unless the people who signed the petition are present at the committee hearing and willing to testify. You may present witnesses under oath and you may also confront and cross-examine opposing witnesses under oath. If you have difficulty with the English language, you should bring an interpreter with you, at your expense, so that you can answer questions and participate in your hearing.

You may examine the application file at this office during regular business hours prior to the hearing date. Inquiries regarding this matter may be directed to the person whose signature appears below.

Limited parking for persons attending meetings in City Hall is available at reduced rates (5 hour limit) at the Milwaukee Center on the southwest corner of East Kilbourn and North Water Street. Parking tickets must be validated in the first floor information booth in City Hall.

PLEASE NOTE: Upon reasonable notice, efforts will be made to accommodate the needs of disabled individuals through sign language interpreters or other auxiliary aids. For additional information or to request this service, contact the Council Services Division ADA Coordinator at (414) 286-2998, Fax - (414) 286-3456, TDD - (414) 286-2025.

JIM OWCZARSKI, CITY CLERK

BY:

Jason Schunk
License Division Manager

If you have questions regarding this notice, please contact the License Division at (414) 286-2238.

200 E. Wells Street, Room 105, City Hall, Milwaukee, WI 53202. www.milwaukee.gov/license
Phone: (414) 286-2238 Fax: (414) 286-3057 Email Address: License@milwaukee.gov

**MILWAUKEE POLICE DEPARTMENT
LICENSE INVESTIGATION UNIT**

**CRIMINAL RECORD/ORDINANCE VIOLATION/INCIDENTS
SYNOPSIS**

DATE: 12/06/2016
LICENSE TYPE: ALQML
NEW:
RENEWAL: X

No. 243487
Application Date: 12/06/2016
Expiration Date:

License Location: 3305 N Dr Martin Luther King, Jr Dr
Business Name: Green Ring II

Aldermanic District: 06

Licensee/Applicant: Ragsdale, Isaac T
(Last Name, First Name, MI)
Date of Birth: 09/03/71

Male:

Female:

Home Address: 10410 S Kelly Dr
City: Oak Creek
Home Phone: (414) 762-5011

State: Wi **Zip Code: 53154**

This report is written by Police Officer Gilbert Gwinn, assigned to the License Investigation Unit, Days.

The Milwaukee Police Department's investigation regarding this application revealed the following:

1. On 06/10/07 at 8:38 am, Milwaukee Police were dispatched to 3305 N Dr MLK Drive for an Entry complaint. Investigation revealed the business was broken into by someone who smashed the window and gain entry. The business was ransacked and items were missing per the owner, Isaac Ragsdale. A report was filed.
2. On 08/31/07 at 9:30 pm, Milwaukee Police conducted a license premise check at 3305 N Dr MKL Drive. Investigation revealed several patrons inside the Green Ring were drinking the alcohol that they had purchased earlier from the Green Ring. The owner, Isaac Ragsdale, was also under the influence, as officers could smell a malt beverage on his breath as he talked with officers. His speech was also slurred. Ragsdale received a citation for Permit Person to Tend Bar W/O License.

Charge: Permit Person To Tend Bar W/O License
Finding: Guilty
Sentence: Fined \$356.00
Date: 10/22/07
Case: 07103624

=====

3. On 03/05/08 at 1:45 pm, Milwaukee police observed several subjects loitering in front of Green Ring II located at 3305 N MLK Drive. As police approached these subjects fled and ran into the Green Ring II store. Police proceeded inside and observed two open bottles of liquor, which were half full sitting on a counter in the rear of the store. Police also located another half full bottle behind some boxes near the front of the store. Officers attempted to speak with Isaac Ragsdale who refused to come from behind the counter. Ragsdale stated to police that he did not know what was going on. Police advised Ragsdale that subjects were not allowed to drink alcohol in the store with Ragsdale becoming uncooperative with police. Ragsdale stated he wasn't doing anything wrong and was tired of police messing with him.
4. On 03/07/08 at 3:30 pm, Milwaukee police along with an agent GeorgeAnn King conducted a license premise check at 3305 N MLK Drive. Agent King found the licensee, Isaac Ragsdale, did not have property receipts for purchases on alcohol and tobacco products. Agent King confiscated numerous alcohol and tobacco products. The applicant was issued a citation for Class A Retailer's Liquor License at 3305 N MLK Drive by Milwaukee police. A subject who found in the store to be in possession of marijuana was arrested and cited for same.

Charge: Class A Retailer's Liquor License
Finding: Guilty
Sentence: Fined \$356.00
Date: 04/28/08
Case: 08035419

5. On 03/08/08 at 4:37 pm, Milwaukee police were advised that the Green Ring II was shut down due to code violations and observed the business to be open and operating. Police spoke to Isaac Ragsdale who stated he had his heat fixed and that he could be open. Investigation revealed inspectors had not been out to inspect the property and officers advised Ragsdale he needed to close until inspectors approved the work done.

=====
Applicant currently has an outstanding traffic fine in the amount of \$83.80 that was due on 06/25/09. (09032215)
=====

- On 07/14/10, applicant was convicted of BAC in Milwaukee County. His license was suspended for 6 months.
 - On 07/23/10, applicant was convicted of OWI in Milwaukee County. His license was revoked for 9 months.
- =====

6. On 04/15/10 at 10:00 pm, Milwaukee police observed several individuals loitering in front of Green Ring II Liquors where signs were posted with "No Loitering". As officers conducted field interviews, they could smell freshly burned marijuana. Some of the subjects were found to be in possession of marijuana. Officers also observed several of these subjects drinking from bottles of beer. All of these subjects were issued Loitering-Drug related citations. Officers also observed the owner Isaac Ragsdale by his pick-up truck parked in front of the store. Police observed a 24 Oz can of "Four Maxed 10% alcohol malt beverage on his truck bumper. When asked why Ragsdale didn't ask the subjects to leave and not loiter in front of his business, Ragsdale just shook his head from side to side. Ragsdale was informed that he would be issued citations as well.

Charges: Disorderly Conduct
Loitering or Prowling
Finding: both were dismissed w/o prejudice
Date: 08/11/10
Case: 10057860
10057861

=====

7. On 02/19/11 at 9:40 pm, Milwaukee police were patrolling the area of 3300 N MLK Drive when police observed numerous individuals inside a closed business located at 3305 MLK Drive. Police attempted to enter the building but found the doors locked. Police announced themselves numerous times to which Isaac Ragsdale finally came to the front door and unlocked it. Police observed 13 individuals inside the business gathered around a television set, drinking beer and alcohol. Police advised Ragsdale that his class A license allowed only the sale of alcohol and that he needed a Class B license in order to serve and have patrons inside drinking. Ragsdale stated he understood and that it wouldn't happen again. Police escorted all patrons out and a report was filed.

- On 07/23/10, applicant was convicted of OWI in Racine County. His license was revoked for 9 months.
- **Applicant has a warrant with Oak Creek Police Department regarding a traffic offense. (P227058-6)**

=====

- The applicant no longer has the warrant with Oak Creek Police Department.

8. On 09/13/12 at 1:55pm, Milwaukee Police Officers along with agents from the Wisconsin Department of Revenue conducted a licensed premises check at 3305 N. Dr. M.L King Dr, Green Ring Liquor II. Officers observed numerous food items for sale on store shelves and behind the counter. It was later determined there was no valid food dealer license for this location. The owner Isaac Ragsdale was advised to removed the food items until he acquired the proper licensing. There was evidence of alcohol consumption on the premises. Multiple empty 50ml size bottles of alcoholic beverages were observed in the trashcan in front of the cashier counter along with (1) 750 ml empty liquor bottle. Officers also observed empty plastic cups with trivial amounts of an alcoholic beverage in them inside the trashcan. The state agents removed multiple boxes of tobacco products and bottles of liquor for tax regulation violations.

=====

9. On 09/13/2012 the applicant was cited in the City of Milwaukee at 3305 N. Martin L King Jr Dr for Building Code Violations.

Charge: Building Code Violations
Finding: Guilty
Sentence: Fined \$1,400.00 **ARREST WARRANT (FAILURE TO PAY JUDGMENT)**
Date: 10/02/2013
Case: 13077654

=====

10. THE APPLICANT CONTINUES TO HAVE A WARRANT FOR ITEM #7.

11. On 07/12/2015 the applicant was cited for Operating While Intoxicated (2nd). He was convicted on 08/20/2015 and his license was suspended for 1 year and he was sentenced to 45 days in the House of Correction.

12. On 11/25/2015 a 16 year old working in conjunction with the Milwaukee Police Department and Wisconsin WINS went to Green Ring II, 3305 N. Martin Luther King Jr. Dr. The juvenile was able to purchase a pack of two Swisher Sweet cigars. An officer entered the business and identified the clerk as Michael HARDISON who admitted to selling the tobacco. Green Ring II also sells alcohol. HARDISON was the only employee on the premises and does not have a Class D Operator license. The applicant was cited for Responsible Person on Premises Required.

Charge: Responsible Person on Premises Required
Finding: Guilty
Sentence: \$250.00 fine
Date: 01/12/2016
Case: 15072550

=====

Item #12 previously reported, disposition added 12/06/2016.

13. On 11/25/2015 a 16 year old, working in conjunction with Milwaukee police, was able to purchase a cigar from the cashier at 3305 N. Martin L. King Jr. Drive (Green Ring II). The applicant was given notice to enroll in the M.A.R.T.S. program. As of 01/29/2016, the agent had not enrolled in the M.A.R.T.S. program and a citation was issued.

Charge: Sale of Cigarettes to Minor
Finding: Due for pre-trial 12/14/2016 8:30am branch 2
Sentence:
Date:
Case: 16010059

14. On 01/09/2016 Milwaukee police responded to a subject with a gun complaint at 3305 N. Martin Luther King Jr. Drive (Green Ring II). The applicant denied calling police and stated he had not observed anyone with a gun. During this encounter, officers discovered marijuana in a clear plastic bag, crack cocaine in a clear plastic bag, and prescription drugs in a bottle with an unreadable name. Additionally, the applicant was taken into custody when officers discovered two handguns inside the business that had previously been reported stolen. Milwaukee police incident report #160090130 filed.

15. On 01/14/2016 Milwaukee police, along with the Department of Neighborhood Services, conducted follow-up regarding possible code violations at 3305 N. Martin Luther King Jr. Drive (Green Ring II). The inspector issued orders to correct for condition observed for; no heat, gasoline inside the building, illegal use of fuel fired equipment and blocked egress/exit. On 01/19/2016 the Department of Neighborhood Services returned and found the code violations had been corrected.

MILWAUKEE POLICE DEPARTMENT

REPORT OF INCIDENTS INVOLVING LICENSED PERSONS OR PREMISES

TO: Derrick HARRIS

Business Name: Green Ring II

Address of Licensed Premises: 3305 N. Martin L. King Jr. Dr.

District: 5

Business Phone: 414-372-8639

Type of License: Class A Malt and Liquor

Violation / Incident #

Date of Incident: 11/25/15

Licensee or Manager on premises at time of violation / incident? Yes No

Licensee cooperative? Yes No (if no, explain in narrative section)

Licensee Notified by Officer: P.O. Dean DRAJKOWSKI

Date:
11/25/15

Time: 1623

Licensee or Agent's Name: RAGSDALE, Isaac T.

Date of Birth: 09-03-71

Home Address: 10410 S. Kelly Dr.

Home Phone:

Co-Licensee Name:

Date of Birth:

Home Address:

Home Phone:

Class S License Number:

Bartender Name:

Date of Birth:

Home Address:

Home Phone:

Class D License Number:

Licensed Person / Public Pass. Vehicle, etc.:

Date of Birth:

Home Address:

Home Phone:

Class D License Number:

VIOLATION/INCIDENT - DESCRIBE FACTS AND CIRCUMSTANCES IN NARRATIVE SECTION

Name of Person Cited: RAGSDALE, Isaac T.

Date of Birth: 09-03-71

Citation Number: 48973511176

Violation & Ord. / Statue No.: 106-30-2-a Tob Minor

Court Date: 03/18/16

Name of Person Cited:

Date of Birth:

Citation Number:

Violation & Ord. / Statue No.:

Court Date:

Name of Person Cited:

Date of Birth:

Citation Number:

Violation & Ord. / Statue No.:

Court Date:

Name of Person Cited:

Date of Birth:

Citation Number:

Violation & Ord. / Statue No.:

Court Date:

Name of Person Cited:

Date of Birth:

Citation Number:

Violation & Ord. / Statue No.:

Court Date:

Investigating Officer: P.O. Dean DRAJKOWSKI

District / Bureau: 27

Date: 01/29/16

Commanding Officer

2-3-16
Date

DISPOSITION - FOR LICENSING ONLY

Citation No.	Case Number	Disposition	Judge	Date
			LICENSE INVESTIGATION UNIT	
		Received	<u>7-3-16</u>	
		Referred		
		By 		

PA-33E Narrative

This report was written by P.O. Dean DRAJKOWSKI assigned to the License Unit day shift.

On Wednesday, November 25, 2015, while assigned to Squad 2741, I was assigned to the Wisconsin WINS Youth Tobacco Initiative, which checks area vendors for age compliance tobacco purchases. I was working with Cleveland EASLEY, B/M, 03-27-99, who is 16 years old and not of legal age to purchase tobacco. A photo of EASLEY was taken at the beginning of the assignment for identification.

At about 4:23 pm, EASLEY entered Green Ring II liquor store located at 3305 N. Martin L. King Jr. Dr. and purchased a pack of two Swisher Sweets cigars for \$0.99 cents. EASLEY provided a description of the cashier that sold him the tobacco. I entered the store and identified the cashier as Michael L. HARDISON, B/M, 09-24-59. HARDISON admitted to selling tobacco to EASLEY and apologized. HARDISON stated he did not check his id. HARDISON did not have a valid Class D Operator's License to serve liquor.

The licensee for Green Ring II liquor store was Isaac T. RAGSDALE, B/M, 09-03-71. RAGSDALE was provided the notice to enroll in the Municipal Citation Diversion Program called "MARTS". RAGSDALE was also issued a citation for Responsible Person upon Licensed Premises.

As of January 29, 2016, the agent had not enrolled in the MARTS program, therefore a citation was issued for the violation.

MILWAUKEE POLICE DEPARTMENT

REPORT OF INCIDENTS INVOLVING LICENSED PERSONS OR PREMISES

TO: Thomas STIGLER, Captain of Police

ORIGINAL

Business Name: Green Ring II
Address of Licensed Premises: 3305 N Dr Martin Luther King Jr Dr
Business Phone: 414-372-8639 Type of License: CLASS A

District: 5

Violation / Incident # 160090130 Date of Incident: 1-9-16

Licensee or Manager on premises at time of violation / incident? Yes No

Licensee cooperative? Yes No (if no, explain in narrative section)

Licensee Notified by Officer: PO O'MALIA Date: 1-9-16 Time: 5:00 PM

Licensee or Agent's Name: Isaac T RAGSDALE Date of Birth: 9-3-72
Home Address: 10410 S Kelly Dr Oak Creek WI 53154 Home Phone: 414-855-6294

Co-Licensee Name: Date of Birth:
Home Address: Home Phone:
Class S License Number:

Bartender Name: Date of Birth:
Home Address: Home Phone:
Class D License Number:

Licensed Person / Public Pass. Vehicle, etc.: Date of Birth:
Home Address: Home Phone:
Class D License Number:

VIOLATION/INCIDENT - DESCRIBE FACTS AND CIRCUMSTANCES IN NARRATIVE SECTION

Name of Person Cited: Date of Birth:
Citation Number: Violation & Ord. / Statue No.: Court Date:

Name of Person Cited: Date of Birth:
Citation Number: Violation & Ord. / Statue No.: Court Date:

Name of Person Cited: Date of Birth:
Citation Number: Violation & Ord. / Statue No.: Court Date:

Name of Person Cited: Date of Birth:
Citation Number: Violation & Ord. / Statue No.: Court Date:

Name of Person Cited: Date of Birth:
Citation Number: Violation & Ord. / Statue No.: Court Date:

Investigating Officer: PO O'MALIA District / Bureau: 52P Date: 1-9-16

Capt. Thomas Stigler *1-11-16*
Commanding Officer Date

DISPOSITION - FOR LICENSING ONLY

Citation No.	Case Number	Disposition	Judge	Date
			LICENSE INVESTIGATION UNIT	
			Received <i>1-9-16</i>	
			Referred	
			By <i>[Signature]</i>	

PA-33E Narrative

This report is written by PO O'MALIA assigned to District Five Early Power Shift Squad 5252 with PO MILLER.

This report is being submitted for information purposes only. It should be noted that the occupancy license number for this establishment, Green Ring II, which is located at 3305 N Dr Martin Luther King Jr Dr, is 500124 issued on 12-14-03. The Class A license being displayed was number ALQML - 0198781 expired 3-3-15. The licensee stated that his Class A license was current and that he believed he had been displaying the current license. This establishment also had a food dealers license being displayed, number Food - 005988 which expires on 3-3-16. Citations regarding licensing were not issued.

On Saturday 1-9-16 PO MILLER and I responded to a Subject with Gun complaint at 3305 N Martin Luther King Jr Dr. Upon arrival I noted this address belonged to a brick building with the name Green Ring 2 convenience store located on the northwest corner of N Martin Luther King Jr Dr and W Concordia Av.

Upon entering the store I noticed a strong smell of fresh marijuana and several occupants standing around. PO MILLER ordered the group to keep their hands where we could see them while he and PO PAOLO (Squad 5251) patted the subjects down for guns before releasing them from the scene. I spoke to the clerk who was also the business owner and identified himself as Isaac T RAGSDALE (B/M 9-3-71). RAGSDALE stated that he did not call the Police and had not observed anyone in his store with a gun. I then asked RAGSDALE if he had any guns in the store. RAGSDALE stated that he had a pistol in a safe under the counter on a shelf. I then asked RAGSDALE if I could look at it and he told me that the safe was unlocked and just needed to be pulled open. In the safe was a silver over black colored Smith & Wesson SW9V 9mm semiautomatic pistol with a serial number of PBA8213. While on scene PO MILLER observed a holstered black colored Ruger Speed Six Shot revolver on top of a beverage cooler located behind the counter and brought it to my attention. I asked RAGSDALE why he had not told me about this gun when I asked before and he stated that the revolver was his, "Take home gun," and that he had forgotten it was there.

As I was speaking to RAGSDALE PO MILLER observed a abandoned black backpack sitting on the seat of a barber's chair. PO MILLER asked RAGSDALE who the bag belonged to but he stated that he did not know. PO MILLER looked inside of the back pack in search of identifying information linking the abandoned property to the owner and discovered a large plastic ziplock type bag containing a leafy green substance which was later tested by PO MAHNKE (Squad 5467) using a NARK II 05 field test and was found to be positive for THC with a weight of 36.40 grams. It should be noted that PO MAHNKE tested, identified, and inventoried all drugs recovered during this assignment. PO MILLER then noticed a clear plastic sandwich bag full of what later tested positive for THC in plain view located in an open side pocket of the black back pack testing positive for THC with a weight of 10.14 grams. In the small front pocket of the back pack was an orange prescription pill bottle containing 16 Cyclobenzaprine Hydrochloride pills, 5 Tramadol pills, and 1 Acetaminophen/Oxycodone pill. The name on the pill bottle was unreadable. PO MILLER again asked RAGSDALE who the bag belonged to and he stated that it belonged to, "Jamie," but that he did not know this subject's last name. RAGSDALE stated that Jamie worked as a barber inside of his store. PO MAHNKE placed the pills on MPD inventory number 16001102 and the marijuana on MPD inventory number 16001101. The pills were identified using the Drugs.com pill identifier.

PO PAOLO located a clear plastic container sealed with a blue plastic lid on top of the partition wall which separated the clerk's counter from the rest of the store. Inside of this container were 15 clear plastic bags containing a green leafy substance. PO MAHNKE also tested this substance using the NARK II 05 field test. The substance tested positive for THC with a total weight of 6.6 grams, and placed it on MPD inventory number 16001101 with the other marijuana.

While this was happening I observed a clear plastic bag sitting on the inside ledge (clerk's side) of the same partition containing an off white chunky substance which I believed to be crack-cocaine. I asked RAGSDALE how the bag had gotten to where it was resting and who it belonged to but he stated that he did not know. Once at District Five Police station this substance was tested by PO MAHNKE using a NARK II 07 field test, was positive for cocaine base with a total weight of 0.34 grams, and was placed on MPD inventory number 16001103.

After these items were located PO MILLER and I decided to check the gun serial numbers with the District Five Console Operator and found that both guns had been reported stolen. RAGSDALE was taken into custody when these firearms were discovered to have been reported stolen MPD IR# 153020006 (Ruger) and MPD IR# 042783085 (Smith & Wesson). The Smith & Wesson SW9V 9mm semiautomatic pistol with a serial number of PBA8213 was placed on MPD inventory number 16010088 by PO BOYAK (Squad 5467). This revolver was placed on MPD inventory number 16001087 by PO DILLMAN (Squad 5467).

PO MILLER called for a CST Officer and Squad 5221 (PO NEUBURG and PO FUERTE) responded. PO NEUBURG will write a supplemental report regarding his part of this investigation. Squad 5221 conveyed RAGSDALE to District Five Police Station where PO FUERTE assisted in the booking process.

PO MILLER also requested a working dog to respond to our location. Squad 758 (PO SMOKOVICH) responded and will write a supplemental report regarding his part of this investigation. It should be noted that SMOKOVICH's working dog did locate two clear plastic bags of leafy green substance in the front of the store in plain view on the floor, a single plastic bag of leafy green substance behind the partition in the area occupied RAGSDALE, and some loose leafy green substance in the rear room of the store. All of this later tested positive for THC by PO MAHNKE using a NARK II 05 field test and was placed on inventory 16001101.

While on scene I located a black jacket sitting on some empty crates next to a barber's clipper set about three feet from the barber's chair where the back pack was sitting. In the front left zippered breast pocket of the jacket I found a social security card with the name James T MOORE on it with the last four numbers of the social security number listed as 9283. I then checked B of I and found a James T MOORE (B/M 8-26-82) with the last four numbers of his social security number listed as 9382. It should be noted that the first five numbers of both social security numbers were the same. I passed this information along to PO MILLER while at District Five Police Station.

MILWAUKEE POLICE DEPARTMENT

REPORT OF INCIDENTS INVOLVING LICENSED PERSONS OR PREMISES

TO: Captain Thomas G. STIGLER

Business Name: Green Ring II

Address of Licensed Premises: 3305 N Martin L King Jr Drive

Business Phone: 855-6294

Type of License: Class A Malt Liquor

District: 5

Violation / Incident #

Date of Incident: 1/14/2016

Licensee or Manager on premises at time of violation / incident? Yes No

Licensee cooperative? Yes No (if no, explain in narrative section)

Licensee Notified by Officer: PO Michael WALKER

Date: 1/14/16

Time: 1:37 pm

Licensee or Agent's Name: Isaac T RAGSDALE

Home Address: 10410 S Kelly Drive Oak Creek, WI 53154

Date of Birth: 9/3/1971

Home Phone: 414-855-6294

Co-Licensee Name:

Home Address:

Class S License Number:

Date of Birth:

Home Phone:

Bartender Name:

Home Address:

Class D License Number:

Date of Birth:

Home Phone:

Licensed Person / Public Pass. Vehicle, etc.:

Home Address:

Class D License Number:

Date of Birth:

Home Phone:

VIOLATION/INCIDENT - DESCRIBE FACTS AND CIRCUMSTANCES IN NARRATIVE SECTION

Name of Person Cited:

Citation Number:

Violation & Ord. / Statute No.:

Date of Birth:

Court Date:

Name of Person Cited:

Citation Number:

Violation & Ord. / Statute No.:

Date of Birth:

Court Date:

Name of Person Cited:

Citation Number:

Violation & Ord. / Statute No.:

Date of Birth:

Court Date:

Name of Person Cited:

Citation Number:

Violation & Ord. / Statute No.:

Date of Birth:

Court Date:

Name of Person Cited:

Citation Number:

Violation & Ord. / Statute No.:

Date of Birth:

Court Date:

Investigating Officer: PO M. WALKER

District / Bureau: 52-1

Date: 1-21-16

LT. ALAN REPLEN

JANUARY 31ST 2016

Commanding Officer

Date

DISPOSITION - FOR LICENSING ONLY

Citation No.	Case Number	Disposition	Judge	Date
_____	_____	_____	_____	_____
_____	_____	_____	_____	_____
_____	_____	_____	_____	_____
_____	_____	_____	_____	_____
_____	_____	_____	_____	_____
_____	_____	_____	_____	_____

Received 2-4-16
 Referred _____
 By [Signature]

PA-33E Narrative

This report was written by PO Michael WALKER, assigned to District Five, Community Prosecution Unit.

On Thursday, January 14, 2016 squad 5264 (PO Chauncey HARRIS and myself) along with Department of Neighborhood Services (DNS) conducted follow-up regarding possible city code violations at the Green Ring II liquor store, located at 3305 N Martin Luther King Jr Drive.

The licensee Isaac T RAGSDALE was present during this walk-through. A kerosene-operated torpedo style space heater was being used to heat the main store area. RAGSDALE stated the heat was not working inside his store and he was using this space heater as the primary heat source. Additional code violations were observed and DNS informed RAGSDALE of these violations.

Inspector Theresa MORALES issued the following orders to correct for condition observed: emergency orders were issued relative to no heat, gasoline inside building, illegal use of fuel-fired equipment, and blocked egress/exits.

On 1/19/2016 DNS returned for follow-up, and found the code violations were corrected.



Thursday, February 02, 2017



Notice of Public Hearing

RAGSDALE, Isaac T
GREEN RING II at 3305 N MARTIN L KING JR DR
Class A Malt & Class A Liquor and Food Dealer License Renewal Applications

Tuesday, February 14, 2017 at 10:30 AM

To whom it may concern:

The above application has been made by the above named applicant(s). This requires approval from the Licenses Committee and the Common Council of the City of Milwaukee. The hearing before the Licenses Committee will take place on 2/14/2017 at 10:30 AM, in Room 301-B, Third Floor, City Hall. If you wish, you may provide testimony at the hearing regarding the request; see below for further information. You are not required to attend the hearing. Once the Licenses Committee makes its recommendation, this recommendation is forwarded to the full Common Council for approval at its next regularly scheduled hearing. Please review the information below and if you have further questions regarding this process, please contact the License Division at (414) 286-2238.

Important details for those wishing to provide information for the Licenses Committee to consider when making its recommendation:

1. The license application is scheduled to be heard at the above time. Due to other hearings running longer than scheduled, you may have to wait some time to provide your testimony.
2. You must appear in person and testify as to matters that you have personally experienced or seen. (You cannot provide testimony for your neighbor, parent or anyone else; this is considered hearsay and cannot be considered by the committee.)
3. No letters or petitions can be accepted by the committee (unless the person who wrote the letter or the persons who signed the petition are present at the committee hearing and willing to testify).
4. Persons opposed to the license application are given the opportunity to testify first; supporters may testify after the opponents have finished.
5. When you are called to testify, you will be sworn in and asked to give your name, and address. (If your first and/or last names are uncommon please spell them.)
6. You may then provide testimony.
 - a. Include only information relating to the above license application.
 - b. Include only information you have personally witnessed or seen.
 - c. Provide concise and relevant information detailing how this business has affected or may affect the peaceful enjoyment of your neighborhood.
 - d. If by the time you have the opportunity to testify, the information you wish to share has already been provided to the committee, you may state that you agree with the previous testimony. Redundant or repetitive testimony will not assist the committee in making its recommendation.
7. After giving your testimony, the members of the Licenses Committee and the licensee may ask questions regarding the testimony you have given or other factors relating to the license application.
8. Business Competition is not a valid basis for denial or non-renewal of a license.
Please Note: If you have submitted an objection to the above application your objection cannot be considered by the committee unless you personally testify at the hearing.

OCCUPANT	MAIL ADDRESS	CITY AND ZIP CODE
CURRENT OCCUPANT	535 W CONCORDIA AVE 209	MILWAUKEE, WI 53212-1959
CURRENT OCCUPANT	535 W CONCORDIA AVE 203	MILWAUKEE, WI 53212-1959
CURRENT OCCUPANT	535 W CONCORDIA AVE 212	MILWAUKEE, WI 53212-1959
CURRENT OCCUPANT	535 W CONCORDIA AVE 201	MILWAUKEE, WI 53212-1959
CURRENT OCCUPANT	535 W CONCORDIA AVE 218	MILWAUKEE, WI 53212-1900
CURRENT OCCUPANT	535 W CONCORDIA AVE 108	MILWAUKEE, WI 53212-1959
CURRENT OCCUPANT	535 W CONCORDIA AVE 204	MILWAUKEE, WI 53212-1959
CURRENT OCCUPANT	535 W CONCORDIA AVE 217	MILWAUKEE, WI 53212-1900
CURRENT OCCUPANT	535 W CONCORDIA AVE 113	MILWAUKEE, WI 53212-1959
CURRENT OCCUPANT	514 W CONCORDIA AVE	MILWAUKEE, WI 53212-1947
CURRENT OCCUPANT	535 W CONCORDIA AVE 302	MILWAUKEE, WI 53212-1900
CURRENT OCCUPANT	535 W CONCORDIA AVE 106	MILWAUKEE, WI 53212-1959
CURRENT OCCUPANT	535 W CONCORDIA AVE 211	MILWAUKEE, WI 53212-1959
CURRENT OCCUPANT	502 W CONCORDIA AVE	MILWAUKEE, WI 53212-1947
CURRENT OCCUPANT	535 W CONCORDIA AVE 202	MILWAUKEE, WI 53212-1959
CURRENT OCCUPANT	535 W CONCORDIA AVE 223	MILWAUKEE, WI 53212-1900
CURRENT OCCUPANT	535 W CONCORDIA AVE 111	MILWAUKEE, WI 53212-1959
CURRENT OCCUPANT	535 W CONCORDIA AVE 216	MILWAUKEE, WI 53212-1959
CURRENT OCCUPANT	535 W CONCORDIA AVE 213	MILWAUKEE, WI 53212-1959
CURRENT OCCUPANT	535 W CONCORDIA AVE 312	MILWAUKEE, WI 53212-1900
CURRENT OCCUPANT	536 W CONCORDIA AVE	MILWAUKEE, WI 53212-1947
CURRENT OCCUPANT	528 W CONCORDIA AVE	MILWAUKEE, WI 53212-1947
CURRENT OCCUPANT	510 W CONCORDIA AVE	MILWAUKEE, WI 53212-1947
CURRENT OCCUPANT	535 W CONCORDIA AVE 200	MILWAUKEE, WI 53212-1959
CURRENT OCCUPANT	535 W CONCORDIA AVE 316	MILWAUKEE, WI 53212-1900
CURRENT OCCUPANT	535 W CONCORDIA AVE 115	MILWAUKEE, WI 53212-1959
CURRENT OCCUPANT	535 W CONCORDIA AVE 310	MILWAUKEE, WI 53212-1900
CURRENT OCCUPANT	535 W CONCORDIA AVE 210	MILWAUKEE, WI 53212-1959
CURRENT OCCUPANT	535 W CONCORDIA AVE 221	MILWAUKEE, WI 53212-1900
CURRENT OCCUPANT	3309 N 4TH ST	MILWAUKEE, WI 53212-1432
CURRENT OCCUPANT	3338 N 5TH ST	MILWAUKEE, WI 53212-1437
CURRENT OCCUPANT	535 W CONCORDIA AVE 300	MILWAUKEE, WI 53212-1900
CURRENT OCCUPANT	535 W CONCORDIA AVE 206	MILWAUKEE, WI 53212-1959
CURRENT OCCUPANT	535 W CONCORDIA AVE 309	MILWAUKEE, WI 53212-1900
CURRENT OCCUPANT	535 W CONCORDIA AVE 323	MILWAUKEE, WI 53212-1900
CURRENT OCCUPANT	535 W CONCORDIA AVE 301	MILWAUKEE, WI 53212-1900
CURRENT OCCUPANT	535 W CONCORDIA AVE 105	MILWAUKEE, WI 53212-1959
CURRENT OCCUPANT	535 W CONCORDIA AVE 306	MILWAUKEE, WI 53212-1900
CURRENT OCCUPANT	535 W CONCORDIA AVE 110	MILWAUKEE, WI 53212-1959
CURRENT OCCUPANT	535 W CONCORDIA AVE 109	MILWAUKEE, WI 53212-1959
CURRENT OCCUPANT	535 W CONCORDIA AVE 319	MILWAUKEE, WI 53212-1900
CURRENT OCCUPANT	535 W CONCORDIA AVE 107	MILWAUKEE, WI 53212-1959
CURRENT OCCUPANT	535 W CONCORDIA AVE 112	MILWAUKEE, WI 53212-1959
CURRENT OCCUPANT	526 W CONCORDIA AVE	MILWAUKEE, WI 53212-1947
CURRENT OCCUPANT	516 W CONCORDIA AVE	MILWAUKEE, WI 53212-1947
CURRENT OCCUPANT	3305 N DR MARTIN LUTHER KING DR	MILWAUKEE, WI 53212-1455
CURRENT OCCUPANT	535 W CONCORDIA AVE 317	MILWAUKEE, WI 53212-1900
CURRENT OCCUPANT	535 W CONCORDIA AVE 102	MILWAUKEE, WI 53212-1959
CURRENT OCCUPANT	535 W CONCORDIA AVE 116	MILWAUKEE, WI 53212-1959
CURRENT OCCUPANT	535 W CONCORDIA AVE 314	MILWAUKEE, WI 53212-1900
CURRENT OCCUPANT	535 W CONCORDIA AVE 100	MILWAUKEE, WI 53212-1959
CURRENT OCCUPANT	535 W CONCORDIA AVE 101	MILWAUKEE, WI 53212-1959
CURRENT OCCUPANT	535 W CONCORDIA AVE 313	MILWAUKEE, WI 53212-1900
CURRENT OCCUPANT	535 W CONCORDIA AVE 304	MILWAUKEE, WI 53212-1900
CURRENT OCCUPANT	512 W CONCORDIA AVE	MILWAUKEE, WI 53212-1947

CURRENT OCCUPANT 410 W CONCORDIA AVE	MILWAUKEE, WI 53212-1945
CURRENT OCCUPANT 3315 N 4TH ST	MILWAUKEE, WI 53212-1432
CURRENT OCCUPANT 535 W CONCORDIA AVE 207	MILWAUKEE, WI 53212-1959
CURRENT OCCUPANT 535 W CONCORDIA AVE 305	MILWAUKEE, WI 53212-1900
CURRENT OCCUPANT 535 W CONCORDIA AVE 104	MILWAUKEE, WI 53212-1959
CURRENT OCCUPANT 535 W CONCORDIA AVE 214	MILWAUKEE, WI 53212-1959
CURRENT OCCUPANT 535 W CONCORDIA AVE 321	MILWAUKEE, WI 53212-1900
CURRENT OCCUPANT 535 W CONCORDIA AVE 308	MILWAUKEE, WI 53212-1900
CURRENT OCCUPANT 535 W CONCORDIA AVE 318	MILWAUKEE, WI 53212-1900
CURRENT OCCUPANT 535 W CONCORDIA AVE 208	MILWAUKEE, WI 53212-1959
CURRENT OCCUPANT 535 W CONCORDIA AVE 103	MILWAUKEE, WI 53212-1959
CURRENT OCCUPANT 3301 N 4TH ST	MILWAUKEE, WI 53212-1432
CURRENT OCCUPANT 3307 N 4TH ST	MILWAUKEE, WI 53212-1432
CURRENT OCCUPANT 3313 N 4TH ST	MILWAUKEE, WI 53212-1432
CURRENT OCCUPANT 3336 N 5TH ST	MILWAUKEE, WI 53212-1437
CURRENT OCCUPANT 3369 N DR MARTIN LUTHER KING DR	MILWAUKEE, WI 53212-1455
CURRENT OCCUPANT 535 W CONCORDIA AVE 117	MILWAUKEE, WI 53212-1959
CURRENT OCCUPANT 535 W CONCORDIA AVE 303	MILWAUKEE, WI 53212-1900
CURRENT OCCUPANT 535 W CONCORDIA AVE 307	MILWAUKEE, WI 53212-1900
CURRENT OCCUPANT 535 W CONCORDIA AVE 215	MILWAUKEE, WI 53212-1959
CURRENT OCCUPANT 535 W CONCORDIA AVE 315	MILWAUKEE, WI 53212-1900
CURRENT OCCUPANT 535 W CONCORDIA AVE 311	MILWAUKEE, WI 53212-1900
CURRENT OCCUPANT 535 W CONCORDIA AVE 205	MILWAUKEE, WI 53212-1959
CURRENT OCCUPANT 535 W CONCORDIA AVE 219	MILWAUKEE, WI 53212-1900
CURRENT OCCUPANT 535 W CONCORDIA AVE 114	MILWAUKEE, WI 53212-1959
CURRENT OCCUPANT 3276 N 5TH ST	MILWAUKEE, WI 53212-1951
CURRENT OCCUPANT 504 W CONCORDIA AVE	MILWAUKEE, WI 53212-1947

Total Records: 83

Radius: 250.0 feet and Center of Circle: 3305 N Martin L King Jr DR

2016-2017 Plan of Operation for 3305 N MARTIN L KING JR DR

1. Litter & Security Plans

How are the grounds kept clean? Sweep Pressure Wash Pick Up Litter Other:

How often will grounds be cleaned? Daily Weekly Other:

Who cleans the grounds? Licensee Building Owner Employees Hired Maintenance Other:

How are noise issues prevented and/or addressed? Security Manager approaches customer(s) Call Police Signs Posted
 Other: Employees

Are there designated outdoor smoking areas? No Yes If Yes, Describe:

Number of garbage cans: Inside 1 Locations: Back of the counter
 Outside 1 Locations: front

Is a crowd control barrier used? No Yes If Yes, Describe:

Number of restrooms: 1 Name of solid waste contractor: Toho

Are there parking spaces on the premises? No Yes If Yes, list number of spaces: _____ and describe security plans:

Are there designated loading areas? No Yes If Yes, describe security plans:

Do you have security personnel on the premise? No Yes If Yes, how many? _____

AND What are their responsibilities? _____

What security equipment do they use? _____

List their licensing, certification or training credentials: _____

Are there security cameras? No Yes If Yes, list all locations: front of store ; Side of store inside

Are searches and/or identification checks conducted upon entry? No Yes If Yes, describe:

2. Percentage of Sales (must total 100%)

Alcohol 50 % Food Sales 25 % Entertainment _____ % Other 25 %

3. Businesses On The Premises (choose all that apply):

Restaurant Cafe/Coffee Shop Cocktail Lounge Convenience Store Night Club Liquor Store Tavern Sports Facility
 Hotel Banquet Hall Supermarket Private/Fraternal/Veterans' Club Other:

4. Hours of Operation and Age Restriction

Are there any changes to the current hours of operation or age restriction? No Yes If Yes, Describe:

Please Note: If you will be open earlier or later than the hours listed on your current license for even one event or holiday (for example, St. Patrick's Day, Brewers Opening Day, etc.) during the license period, this must be reported and printed on your license.

Your hours of operation and age restriction are listed on your current license.

5. Floor Plan and Capacity

Are you requesting any changes to the floor plan or capacity? No Yes If Yes, Describe:

If requesting changes to the floor plan, submit a new floor plan with this application. Changes in floor plan include changing the location of tables, games, etc. within your current licensed premises. If your changes include adding any additional areas or square footage to your premises, or any renovations to the building will be done, a Permanent Extension of Premises application must be filed.

6. Sidewalk Dining (If renewing a current license – Renewal Fee : \$)

Are there any changes to the sidewalk dining site plan? No Yes If Yes, submit an updated site plan with this application.

7. Food Licenses (If renewing a current license – Renewal Fee : \$200)

Do you sell ONLY prepackaged foods? No Yes

If yes, do you sell ONLY non hazardous foods? No Yes (FROZEN PIZZA is a HAZARDOUS FOOD)

If you answered YES to both questions, YOU DO NOT NEED TO RENEW YOUR FOOD LICENSE.