



CITY OF MILWAUKEE
OFFICE OF THE CITY CLERK

Monday, November 14, 2022

COMMITTEE MEETING NOTICE

AD 02

SIDDIQUE, Mohammad S, Agent
Siddique, Inc
6060 N 77TH St
Milwaukee, WI 53218

You are requested to attend a hearing which is to be held in Room 301-B, Third Floor, City Hall or you may attend virtually using the link below. The hearing will be held at:

Tuesday, November 29, 2022 at 09:50 AM

The access code is <https://meet.goto.com/578608581>. If you wish to call in, please call [+1 \(224\) 501-3412](tel:+12245013412) and use Access Code: 578-608-581. Please see the enclosed best practices document for further instructions.

Regarding: Your Extended Hours Establishments, Filling Station, Food Dealer and Weights & Measures License Applications as agent for "Siddique, Inc" for "Star Fuel Center and Pantry" 5656 N 76TH St.

There is a possibility that your application may be denied for one or more of the following reasons: The recommendation of the committee regarding the application shall be based on evidence presented at the hearing. Per MCO 85-2.7-4, probative evidence concerning whether or not a new license should be granted may be presented on the following subjects: whether or not the applicant meets the municipal requirements, the appropriateness of the location and premises where the licensed premises is to be located and whether use of the premises for the purposes or activities permitted by the license would tend to facilitate a public or private nuisance or create undesirable neighborhood problems such as disorderly patrons, unreasonably loud noise, litter, and excessive traffic and parking congestion. Probative evidence relating to these matters may be taken from the plan of operation submitted with the license application, if any, but shall not include the content of any music. Evidence regarding the fitness of the location of the premises to be maintained as the principal place of business, including but not limited to whether there is an overconcentration of businesses of the type for which the license is sought; whether the proposal is consistent with any pertinent neighborhood business or development plans, or the location's proximity to areas where children are typically present. The applicant's record in operating similarly licensed premises; and whether or not the applicant has been charged with or convicted of any felony, misdemeanor, municipal offense or other offense, the circumstances of which substantially relate to the activity to be permitted by the license being applied for or any other factor which reasonably relates to the public health, safety or welfare may also be considered. See attached police report or correspondence.

Notice for applicants with warrants or unpaid fines:

Proof of warrant satisfaction or payment of fines must be submitted at the hearing on the above date and time. Failure to comply with this requirement may result in a delay of the granting/denial of your application.

Failure to appear at this meeting may result in the denial of your license. Individual applicants must appear only in person or by an attorney. Corporate or Limited Liability applicants must appear only by the agent designated on the application or by an attorney. Partnership applicants must appear by a partner listed on the application or by an attorney. If you wish to do so and at your own expense, you may be accompanied by an attorney of your choosing to represent you at this hearing.

You will be given an opportunity to speak on behalf of the application and to respond and challenge any charges or reasons given for the denial. No petitions can be accepted by the committee, unless the people who signed the petition are present at the committee hearing and willing to testify. You may present witnesses under oath and you may also confront and cross-examine opposing witnesses under oath. If you have difficulty with the English language, you should bring an interpreter with you, at your expense, so that you can answer questions and participate in your hearing.

You may examine the application file at this office during regular business hours prior to the hearing date. Inquiries regarding this matter may be directed to the person whose signature appears below.

Limited parking for persons attending meetings in City Hall is available at reduced rates (5 hour limit) at the Milwaukee Center on the southwest corner of East Kilbourn and North Water Street. Parking tickets must be validated in the first floor information booth in City Hall.

PLEASE NOTE: Upon reasonable notice, efforts will be made to accommodate the needs of disabled individuals through sign language interpreters or other auxiliary aids. For additional information or to request this service, contact the Council Services Division ADA Coordinator at (414) 286-2998, Fax - (414) 286-3456, TDD - (414) 286-2025.

JIM OWCZARSKI, CITY CLERK

BY: _____

Jim Cooney
License Division Manager

If you have questions regarding this notice, please contact the License Division at (414) 286-2238.

200 E. Wells Street, Room 105, City Hall, Milwaukee, WI 53202. www.milwaukee.gov/license
Phone: (414) 286-2238 Fax: (414) 286-3057 Email Address: License@milwaukee.gov



Monday, November 14, 2022



Notice of Public Hearing

Blank Notice

SIDDIQUE, Mohammad S, Agent
Star Fuel Center and Pantry at 5656 N 76TH St
Extended Hours Establishments, Filling Station, Food Dealer and Weights & Measures License
Applications

Tuesday, November 29, 2022 at 9:50 AM

To whom it may concern:

The above application has been made by the above named applicant(s). This requires approval from the Licenses Committee and the Common Council of the City of Milwaukee. The hearing before the Licenses Committee will take place on 11/29/2022 at 9:50 AM in Room 301-B, Third Floor, City Hall. This is a public hearing. Those wishing to view the proceeding are able to do so via the City Channel – Channel 25 on Spectrum Cable – or on the Internet at <http://city.milwaukee.gov/citychannel>. Those wishing to provide oral testimony via phone or internet are asked to contact the staff assistant, Yadira Melendez at (414) 286-2775 or stasst5@milwaukee.gov for necessary information. Please make such requests no later than one business day prior to the start of the meeting. You are not required to attend the hearing, but please see the information below if you would like to provide testimony. Once the Licenses Committee makes its recommendation, this recommendation is forwarded to the full Common Council for approval at its next regularly scheduled hearing.

Important details for those wishing to provide information for the Licenses Committee to consider when making its recommendation:

1. The license application is scheduled to be heard at the above time. Due to other hearings running longer than scheduled, you may have to wait some time to provide your testimony.
2. You must appear in person and testify as to matters that you have personally experienced or seen. (You cannot provide testimony for your neighbor, parent or anyone else; this is considered hearsay and cannot be considered by the committee.)
3. No letters or petitions can be accepted by the committee (unless the person who wrote the letter or the persons who signed the petition are present at the committee hearing and willing to testify).
4. Persons opposed to the license application are given the opportunity to testify first; supporters may testify after the opponents have finished.
5. When you are called to testify, you will be sworn in and asked to give your name, and address. (If your first and/or last names are uncommon please spell them.)
6. You may then provide testimony.
 - a. Include only information relating to the above license application.
 - b. Include only information you have personally witnessed or seen.
 - c. Provide concise and relevant information detailing how this business has affected or may affect the peaceful enjoyment of your neighborhood.
 - d. If by the time you have the opportunity to testify, the information you wish to share has already been provided to the committee, you may state that you agree with the previous testimony. Redundant or repetitive testimony will not assist the committee in making its recommendation.
7. After giving your testimony, the members of the Licenses Committee and the licensee may ask questions regarding the testimony you have given or other factors relating to the license application.
8. Business Competition is not a valid basis for denial or non-renewal of a license.
Please Note: If you have submitted an objection to the above application your objection cannot be considered by the committee unless you personally testify at the hearing.

OCCUPANT	MAIL ADDRESS	CITY STATE ZIP
CURRENT OCCUPANT	5645 N 74TH ST	MILWAUKEE, WI 53218-2247
CURRENT OCCUPANT	5702 N 75TH ST	MILWAUKEE, WI 53218-2233
CURRENT OCCUPANT	5702 N 76TH ST	MILWAUKEE, WI 53218-2252
CURRENT OCCUPANT	5703 N 76TH ST	MILWAUKEE, WI 53218-2253
CURRENT OCCUPANT	5708 N 76TH ST	MILWAUKEE, WI 53218-2252
CURRENT OCCUPANT	5709 N 76TH ST	MILWAUKEE, WI 53218-2253
CURRENT OCCUPANT	5711 N 76TH ST	MILWAUKEE, WI 53218-2253
CURRENT OCCUPANT	5712 N 76TH ST	MILWAUKEE, WI 53218-2252
CURRENT OCCUPANT	5715 N 75TH ST	MILWAUKEE, WI 53218-2234
CURRENT OCCUPANT	5715 N 76TH ST	MILWAUKEE, WI 53218-2253
CURRENT OCCUPANT	5717 N 76TH ST	MILWAUKEE, WI 53218-2253
CURRENT OCCUPANT	5718 N 75TH ST	MILWAUKEE, WI 53218-2233
CURRENT OCCUPANT	5718 N 76TH ST	MILWAUKEE, WI 53218-2252
CURRENT OCCUPANT	5719 N 75TH ST	MILWAUKEE, WI 53218-2234
CURRENT OCCUPANT	5720 N 76TH ST	MILWAUKEE, WI 53218-2252
CURRENT OCCUPANT	5722 N 75TH ST	MILWAUKEE, WI 53218-2233
CURRENT OCCUPANT	5723 N 76TH ST# 1	MILWAUKEE, WI 53218-2254
CURRENT OCCUPANT	5723 N 76TH ST# 2	MILWAUKEE, WI 53218-2254
CURRENT OCCUPANT	5723 N 76TH ST# 3	MILWAUKEE, WI 53218-2254
CURRENT OCCUPANT	5723 N 76TH ST# 4	MILWAUKEE, WI 53218-2254
CURRENT OCCUPANT	5724 N 76TH ST# 1	MILWAUKEE, WI 53218-2255
CURRENT OCCUPANT	5724 N 76TH ST# 2	MILWAUKEE, WI 53218-2255
CURRENT OCCUPANT	5724 N 76TH ST# 3	MILWAUKEE, WI 53218-2255
CURRENT OCCUPANT	5724 N 76TH ST# 4	MILWAUKEE, WI 53218-2255
CURRENT OCCUPANT	5725 N 75TH ST	MILWAUKEE, WI 53218-2234
CURRENT OCCUPANT	5729 N 75TH ST	MILWAUKEE, WI 53218-2234
CURRENT OCCUPANT	5733 N 75TH ST	MILWAUKEE, WI 53218-2234
CURRENT OCCUPANT	7453 W THURSTON CIR	MILWAUKEE, WI 53218-2266
CURRENT OCCUPANT	7457 W THURSTON AVE# 101	MILWAUKEE, WI 53218-2200
CURRENT OCCUPANT	7457 W THURSTON AVE# 102	MILWAUKEE, WI 53218-2200
CURRENT OCCUPANT	7457 W THURSTON AVE# 103	MILWAUKEE, WI 53218-2200
CURRENT OCCUPANT	7457 W THURSTON AVE# 104	MILWAUKEE, WI 53218-2200
CURRENT OCCUPANT	7457 W THURSTON AVE# 105	MILWAUKEE, WI 53218-2200
CURRENT OCCUPANT	7457 W THURSTON AVE# 106	MILWAUKEE, WI 53218-2200
CURRENT OCCUPANT	7457 W THURSTON AVE# 107	MILWAUKEE, WI 53218-2224
CURRENT OCCUPANT	7457 W THURSTON AVE# 108	MILWAUKEE, WI 53218-2224
CURRENT OCCUPANT	7457 W THURSTON AVE# 109	MILWAUKEE, WI 53218-2224
CURRENT OCCUPANT	7457 W THURSTON AVE# 110	MILWAUKEE, WI 53218-2224
CURRENT OCCUPANT	7457 W THURSTON AVE# 111	MILWAUKEE, WI 53218-2224
CURRENT OCCUPANT	7457 W THURSTON AVE# 112	MILWAUKEE, WI 53218-2224
CURRENT OCCUPANT	7463 W THURSTON CIR	MILWAUKEE, WI 53218-2266
CURRENT OCCUPANT	7469 W THURSTON CIR	MILWAUKEE, WI 53218-2266
CURRENT OCCUPANT	7501 W THURSTON AVE	MILWAUKEE, WI 53218-2264
CURRENT OCCUPANT	7502 W THURSTON AVE	MILWAUKEE, WI 53218-2263
CURRENT OCCUPANT	7503 W THURSTON AVE	MILWAUKEE, WI 53218-2264
CURRENT OCCUPANT	7503 W THURSTON CIR	MILWAUKEE, WI 53218-2270

CURRENT OCCUPANT	7505 W THURSTON AVE	MILWAUKEE, WI 53218-2264
CURRENT OCCUPANT	7510 W THURSTON AVE# 1	MILWAUKEE, WI 53218-2263
CURRENT OCCUPANT	7510 W THURSTON AVE# 2	MILWAUKEE, WI 53218-2263
CURRENT OCCUPANT	7510 W THURSTON AVE# 3	MILWAUKEE, WI 53218-2263

Blank Notice

Total Records: 50

Radius 250.0 feet and Center of Circle: 5656 n 76th St



BUSINESS LICENSE PLAN OF OPERATION

ccl-busplan 5/12/2020

Office of the City Clerk License Division
200 E. Wells St. Room 105, Milwaukee, WI 53202
(414) 286-2238 www.milwaukee.gov/license e-mail address: license@milwaukee.gov

1. Type of Business

Applying for: Extended Hours (12AM to 5AM) - If a food establishment, check all that apply: Delivery Drive Thru Dining Room
 Self Service Laundry Massage Establishment Filling Station
 Other (supplemental application for specific license also required)

Provide a detailed description of the type of business you plan on operating:
gas station, convenience store, tobacco and such. No Alcohol

Do you have any experience operating this type of business? No Yes If yes, explain: Operated this location from ^{Approx.} 1999 - ^{Approx.} 2007

2. Business Operations

- a. Proposed Opening Date: ASAP
- b. Is this premise under construction? No Yes If yes, list estimated completion date: _____
- c. Is this a franchise? No Yes
- d. Is this premises currently licensed? No Yes If yes, list type of license: Same as being applied for.
- e. Is the current licensee operating? No Yes If no, list date closed: _____
- f. Do you have future plans for other businesses, licenses or permits at this location? No Yes
If yes, explain: _____
- g. Have you previously held an Extended Hours License in Milwaukee? No Yes
If yes, list address(es): 5656 N 76th Street
- h. Are other businesses operating in the same building? No Yes If yes, describe: _____

3. Litter & Noise

- a. How are grounds kept clean? Sweep Pressure Wash Pick Up Litter Other: Keeping trash cans
- b. How often will grounds be cleaned? Daily Weekly As Needed Monthly Other: _____
- c. Grounds cleaned by: Licensee Building Owner Employees Hired Maintenance Other: _____
- d. How are noise issues prevented and/or addressed? Security Manager approaches customer(s) Call Police
 Signs Posted Other: Employees and owners patrol and approach, if needed
- e. Will a sound amplification system be used? No Yes If yes, describe: _____

4. Smoking & Sanitation

- a. Are there designated outdoor smoking areas? No Yes If yes, describe: _____
- b. Number of Garbage Cans: Inside: 2 Locations: 1 by entrance; 1 by register
Outside: 3 Locations: 1 by each gas pumping station
- c. Is a crowd control barrier used? No Yes If yes, describe: _____
- d. How many restrooms are on the premises? 1
- e. Name of solid waste contractor: Advanced Disposal Waste Management Other: Eagle Disposal

5. Security

- a. Are there onsite parking spaces? No Yes If yes, how many? 9 and describe the parking security plan: patrol by employees, managers, and owners.
- b. Is there a loading zone? No Yes If yes, describe the loading area security plan: _____
- c. Will you have security personnel on premise? No Yes If yes, how many? _____ and answer the following:
 What are their responsibilities? _____
 Is security equipment used? No Yes If yes, describe Camera System
 List their licensing, certification, or training credentials _____
- d. Will there be security cameras? No Yes If yes, how many? 12-16 and list locations: Entire premises is covered
- e. Will searches/identification checks be done upon entry? No Yes If yes, describe _____

6. Percentage of Sales (must total 100%)

Alcohol <u>0</u> %	Food <u>60</u> %	Secondhand Merchandise <u>0</u> %	Precious Metals & Gems <u>0</u> %
Entertainment <u>0</u> %	Cigarettes <u>20</u> %		
Pawnbroker Activity <u>0</u> %	Salvaged Materials <u>0</u> % (such as scrap metal)	Personal Services (such as tattoo, body piercing, salon, tailor, tanning, etc.) <u>0</u> %	Other <u>20</u> % Describe <u>gas</u>

7. Businesses/Licenses on the Premises (check all that apply):

Type 1

- Full Service Restaurant Cafe/Coffee Shop Deli or Fast Food Restaurant Private/Fraternal/Veterans Club
- Night Club Tavern Cocktail Lounge Teen Club
- Banquet Hall Sports Facility Bowling Alley
- Hotel/Motel: Number of Floors: _____ Rooming House: Number of Floors: _____
 Number of Rooms: _____ Number of Rooms: _____

Type 2

- Liquor Store Corner Store Supermarket Convenience Store
- Gas Station Amusement/Phonograph Distributor Recycling, Salvage or Towing
- Used Car Dealer Personal Service Establishment
(such as tattoo business, hair salon, tailor, etc.) Recording Studio

What other licenses/permits will you hold at this location? (check all that apply)

- Occupancy Permit Cigarette & Tobacco Gas Station Extended Hours Class "B" Tavern Weights & Measures
- Secondhand Dealer Precious Metal & Gem Other: _____

8. Legal Capacity (only if a Type 1 premises in #7 above)

Capacity _____ (Call the Milwaukee Development Center at 414-286-8211 if you have questions.)

9. Premises Description

a. Identify all area(s) of the premises that will be used in operating this business (include areas used only for storage):

1st Floor 2nd Floor Basement Storage Patio Beer Garden Sidewalk Café Deck Rooftop

Other: Describe: _____

b. Describe Location: Major Thoroughfare Secondary Street Other: _____

c. Nearest Major Cross Street: Silver Spring Drive and 76th Street

d. Describe Building: Free Standing Building Strip Mall Other: _____

e. Describe Premises Structure: Single Story Multi-Story - # of Stories _____ Other: _____

f. Describe Surrounding Area: Commercial Residential Industrial Other: MIX (Commercial/Residential)

g. Building Owner Name: Silver Spring Road Properties, Inc. Phone Number: (414) 305-6435

Building Owner Address: 6060 N 77th Street

10. Hours of Operation & Customers

Will customers be entering the premises? No Yes

Day of the Week	Proposed Hours of Operation:		Estimated Number of Customers expected each day	Potential Age Range of Customers	Class B Tavern Applicant Only: Age Restriction (If none, write 'None')
	Open Time (include a.m. or p.m.)	Close Time (include a.m. or p.m.)			
Sunday	5Am	2Am	350-800	0-120	None
Monday	↓	↓	↓	↓	↓
Tuesday	↓	↓	↓	↓	↓
Wednesday	↓	↓	↓	↓	↓
Thursday	↓	↓	↓	↓	↓
Friday	↓	↓	↓	↓	↓
Saturday	↓	↓	↓	↓	↓

An Extended Hours Establishment License is required for any convenience store, filling station, personal service establishment (such as tattoo, body piercing, salon, tailor, tanning, etc.), recording studio or restaurant which is open between the hours of 12:00 a.m. and 5:00 a.m.

Alcohol Establishments Permitted Hours of Operation: Class A: 8:00 am to 9:00 pm Sunday thru Saturday
Class B: 6:00 am to 2:00 am Sunday thru Thursday, 6:00 am to 2:30 am Friday & Saturday

Entertainment Outdoor Closing Hours: 10:00pm Sunday-Thursday; 12:00am Friday & Saturday; unless a different time, either earlier or later, is established by the Common Council in its approval of the licensee's plan of operation.

11. Signature(s)

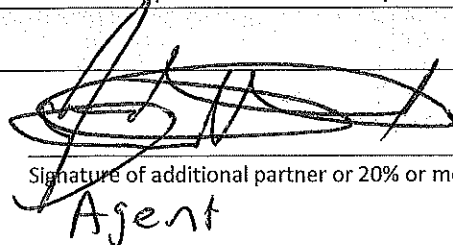

Signature of Sole Proprietor, Partner, or 20% or more Shareholder
(If there are no 20% or more shareholders,
Corporate Officer-print name/title and sign)

Agent

Signature of additional partner or 20% or more shareholder

See Application Information for a complete list of all required application forms.



FOOD DEALER LICENSE PLAN OF OPERATION

OFFICE OF THE CITY CLERK, LICENSE DIVISION
CITY HALL, 200 E. WELLS ST, ROOM 105, MILWAUKEE, WI 53202
(414) 286-2238 • license@milwaukee.gov • www.milwaukee.gov/license

Legal Entity Name:

Siddique, Inc.

Premises Address:

5656 N 76th Street

SECTION 1 TYPE OF BUSINESS

What will be the majority of your food sales? (check one)

Restaurant Items (meals):
MEALS include, but are not limited to, chicken, ribs, sandwiches, roasted corn, baked potatoes, hot dogs, brats, tacos, nachos w/ cheese and meat, French fries, cooked or deep fried vegetables/fruit, cooked cheese curds, corn dogs, egg rolls, salads.

Retail Items (snacks and beverages):
RETAIL items include, but are not limited to, ice cream/soft serve, lemonade, snow cones, coffee, espresso, cappuccino, tea, fruit juice, smoothies, candy, dispensed soda, fruit cups, bakery, cookies, kettle corn, cotton candy, funnel cakes, fritters, tortilla chips w/ cheese.

Will it be a convenience store? Yes No

A convenience store contains less than 5,000 square feet of retail space and has, as its primary business, the sale of basic food items and in addition, sells household products or is a filling station that sells basic food items and household products.

Bed & Breakfast

Micro Market

All Applicants: Submit a menu or a list of food items that will be sold.

Will any wholesale business be done? No Yes If yes, what percentage of food sales will be wholesale?

Less than 25%

25% or More AND:

Restaurant items (meals) will be sold – Complete this application and also contact DATCP.

NO restaurant items (meals) will be sold - Do NOT complete this application. Contact DATCP only.

SECTION 2 FOOD PROCESSING

Will any food processing be done? No Yes

Processing is defined as assembling, grinding, cutting, mixing, baking, coating, stuffing, packing, bottling, grilling, canning, extracting, fermenting, distilling, pickling, freezing, drying, smoking, or packaging.

SECTION 3 FOOD REQUIRING TEMPERATURE CONTROL

Will any food that requires temperature control be sold? No Yes

(includes dairy products such as milk, cheese, and ice cream, fish, shellfish, meat, poultry)

If yes, list the types of food items: *Milk, eggs, Cheese, frozen dinners and foods*

SECTION 4 DETAILS OF OPERATION

Will you have seating on site for dining? No Yes

Will you be doing any catering? No Yes

Will you be doing any delivery? No Yes

Will you have outdoor activities? No Yes - Check all that apply: Bar Cooking/Grilling Dining

Will you have a drive thru window? No Yes - Are hours different from inside? No Yes

If Yes, provide drive thru hours: _____

Will scales or barcode scanners be used? No Yes - You must also apply for a Weights & Measures License.

SECTION 5 ADDITIONAL SITES

Where will food be prepared and/or sold?

At a single site At multiple sites: How many? _____ (for example, a hotel with several dining rooms or bars)

If multiple sites, attach a Food Dealer Additional Site Addendum (ccl-foodadd) for each additional site.

SECTION 6 CONSTRUCTION OR CHANGES

Are you planning any construction, remodeling or equipment changes?

No If No, SKIP to Section 8

Yes If Yes, check all that apply: New construction of a building Renovation or remodeling

Construction changes to existing building Equipment changes only

Provide a brief description of the changes: _____

Start date: _____

Name, Address & Phone Number of Architect: _____

Name, Address & Phone Number of Contractor: _____

SECTION 7 ALCOHOL BEVERAGES

Are you applying for an alcohol beverage license?

No If No, SKIP to Section 8

Yes If YES, if your food license is approved prior to the alcohol license, when do you want the food license issued?

Immediately At the same time as the alcohol license

SECTION 8 ACKNOWLEDGEMENTS & SIGNATURE

You must initial each item confirming your understanding:

- I understand the Health Department must conduct an inspection and advise the License Division of their approval before the license may be issued.
- I understand I must obtain an occupancy permit from the Department of Neighborhood Services and an inspection may be required. Neighborhood Services must advise the License Division of their approval before the license may be issued.
- I understand the district alderperson will review and either support or object to my application. If he/she objects, I may appeal and be scheduled to appear before the Licenses Committee. The Licenses Committee will then make a recommendation to the Common Council. The Common Council must grant the license before it may be issued.
- I understand proof of payment for all license fees must be on file in the License Division before the license may be issued and the license must be issued and posted in my establishment prior to opening for business.
- I will not operate my food business until the license has been issued and posted in the establishment.

Signature of Sole Proprietor, Partner, or 20% Shareholder: _____

Signature of Additional Partner: _____



**FILLING STATION LICENSE AND
WEIGHTS & MEASURES (RETAIL PETROLEUM METERS)
LICENSE SUPPLEMENTAL APPLICATION**

OFFICE OF THE CITY CLERK, LICENSE DIVISION
CITY HALL, 200 E. WELLS ST, ROOM 105, MILWAUKEE, WI 53202
(414) 286-2238 • license@milwaukee.gov • www.milwaukee.gov/license

Legal Entity Name: Siddique, Inc.
Premise Address: 5656 N 76th Street;

Filling Station License Fee \$ 275

Weights & Measures License Fee
Number of Retail Petroleum Meters* 18 x \$60 per meter = \$ 1080

*For each nozzle, count the number of grades (not including midgrade if mixed in the pump), add the number of all grades together and that is your number of retail petroleum meters.

Will electronic scanners be used to determine/record the price of items? No Yes
Will scales be used to price items based on their weight? No Yes
If yes to either or both questions, a separate Weights & Measures License Application must be submitted for these devices.

Acknowledgements and Signature

I confirm that all information is true and correct. I understand any changes to the information in this application must be reported to the City Clerk License Division within 10 days. I have knowledge of the City of Milwaukee ordinances currently regulating the licenses applied for and understand that the licenses may be subject to suspension, non-renewal, or revocation if I violate these regulations.

[Signature]
Signature of Sole Proprietor, Partner, or 20% or more Shareholder
(If no 20% or more Shareholder, Corporate Officer must sign and provide title)

[Signature] Agent
Signature of Additional Partner or 20% or more Shareholder

- Submit this form with the following:
- Business License Application
 - Business Plan of Operation
 - Floor plan
 - License fees
- Forms can be obtained online at www.milwaukee.gov/licenses

Office Use Only:		
App# _____	Filed _____	Initials _____
Paid _____	MPD _____	CC _____
HD _____	DNS _____	Lic # _____

Application for Cigarette and Tobacco Products Retail License

Submit to municipal clerk.

MUNICIPAL USE ONLY

License Number
Period Covered
Date of Issuance

Applicant's Wisconsin 15-digit Sales Tax Account Number
456-0000185909

← This must be issued in the same Legal Name of the licensee below.

Legal Name (corporation, limited liability company, partnership or sole proprietorship) Siddique, Inc			Federal Employer Identification No. (FEIN) 39-1875519		
Trade or Business Name (if different than Legal Name) Star Fuel Center & Pantry			Telephone Number (414) 305-6435		
Business Address (License Location) 5656 N 76th Street		Business Located In <input checked="" type="checkbox"/> City <input type="checkbox"/> Village <input type="checkbox"/> Town of: Milwaukee		Business Telephone () - - - - -	
Municipality Milwaukee	State WI	Zip Code 53218	County Milwaukee		
Mailing Address (if different than Business Address) 6060 N 77th Street			Municipality Milwaukee		State Zip Code WI 53218

Organization (check one)

Sole Proprietor Wisconsin Corporation – Enter date incorporated: **02/04/1997**
 Partnership Out-of-State Corporation – Are you registered to do business in Wisconsin? Yes No
 Other (describe) _____

- Yes No 1. Does the applicant understand that they must purchase cigarettes only from distributors or jobbers who hold a permit with the Wisconsin Department of Revenue?
- Yes No 2. Does the applicant understand that they must obtain a Tobacco Products Distributor permit if purchasing untaxed tobacco products from an out-of-state company? (Tobacco Products Distributor permit is available from the Wisconsin Department of Revenue at 608-266-6701. See application form CTP-129, revenue.wi.gov/forms/excise/ctp-129.pdf.)
- Yes No 3. Does the applicant understand that they cannot purchase/exchange cigarettes or tobacco products from another retailer, including transferring existing stock to a new owner?
- Yes No 4. Does the applicant understand that they must provide employees with tobacco sales training approved by the Wisconsin Department of Health Services? (<https://witobaccocheck.org>)
- Yes No 5. Does the applicant understand that they may not sell, give or otherwise provide cigarettes/tobacco products and nicotine products to minors (including electronic cigarettes containing nicotine)?
- Yes No 6. Does the applicant understand that they may not sell single cigarettes?
- Yes No 7. Does the applicant understand that cigarette and tobacco products invoices must be kept on the licensed premises for two years from the date of the invoice and be available for inspection by the Wisconsin Department of Revenue/law enforcement and that failure to comply can result in criminal penalties, including loss of cigarettes/tobacco products?
- Yes No 8. Does the applicant understand that only cigarettes and roll-your-own (RYO) tobacco products listed on the Wisconsin Department of Justice's website labeled "Directory of Certified Tobacco Manufacturers and Brands" at www.doj.state.wi.us/dls/tobacco-directory may be sold in Wisconsin?

Cigarettes / Tobacco will be sold over counter through vending machine both

READ CAREFULLY BEFORE SIGNING: Under penalty provided by law, the applicant states that each of the above questions has been truthfully answered to the best of the knowledge of the applicant. Applicant agrees to operate this business according to law and that the rights and responsibilities conferred by the license(s), if granted, cannot be assigned to another.

Any lack of access to any portion of a licensed premises during inspection will be deemed a refusal to permit inspection. Such refusal is a misdemeanor and grounds for revocation of this license. Any person who knowingly provides materially false information on this application may be required to forfeit not more than \$1,000.

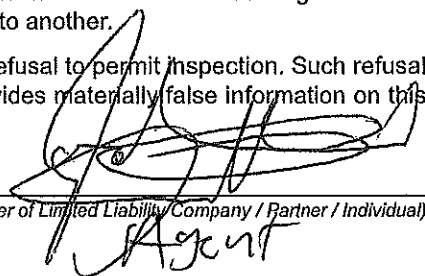

 (Officer of Corporation / Member / Manager of Limited Liability Company / Partner / Individual)

 Agent

Approx. 2,400 Sq. Ft.

~69'

Parking \$69/ea

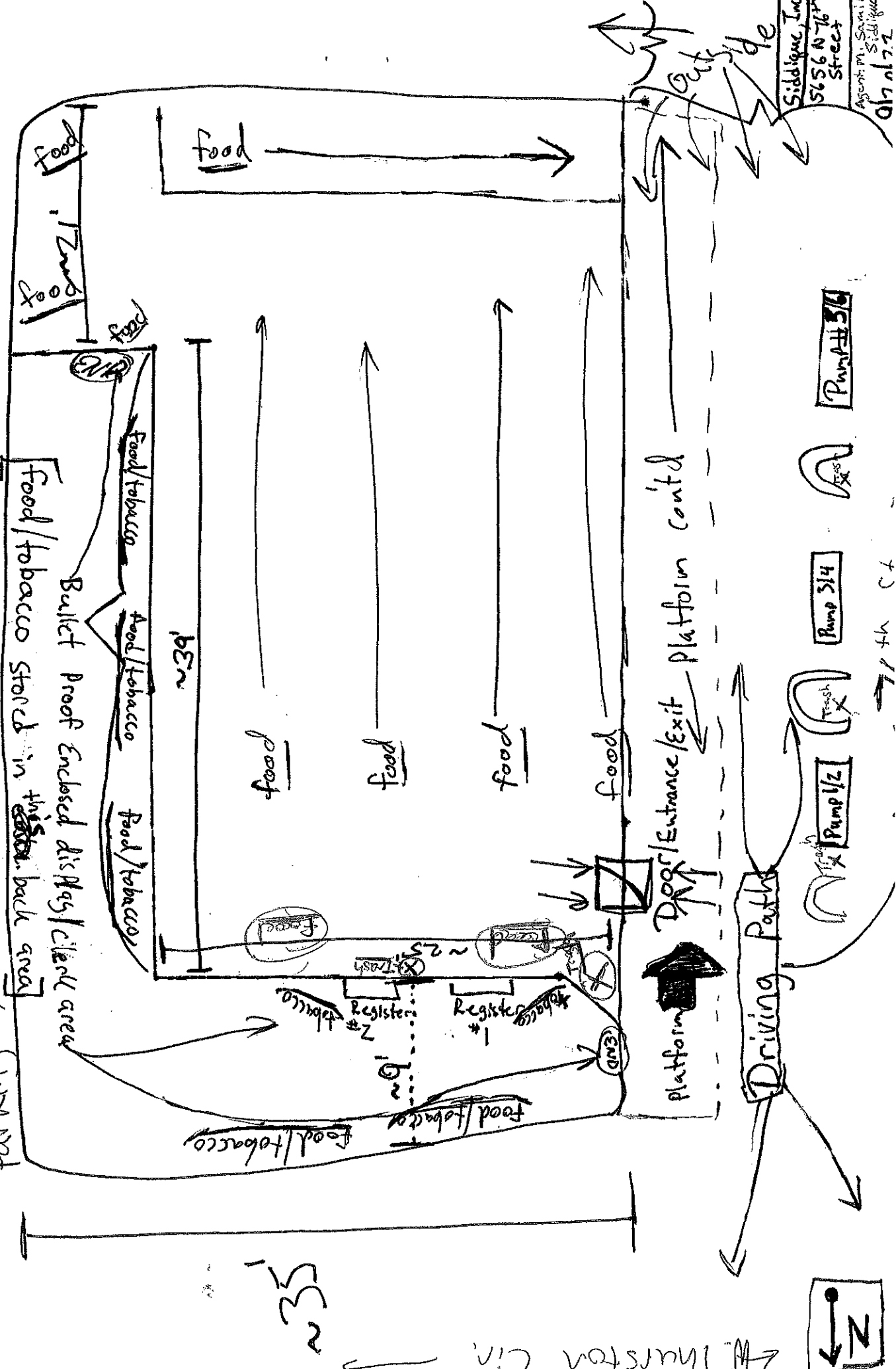

Siddique, Inc
5656 N 76th Street
Agents: M. Sami, Siddique
01/17/72



Thurston Cir

~35'

~35'

Food/tobacco stored in this back area

Bullet Proof Enclosed display/client area

Food/tobacco

Food

Food

Food

Food

food

food

food

food

Door/Entrance/Exit Platform cont'd

Platform

Driving Path

Pump 1/2

Pump 3/4

Pump 5/6

Pump #3/4

→ 1/17/72

Parking: ~ 3,695 sq. ft.

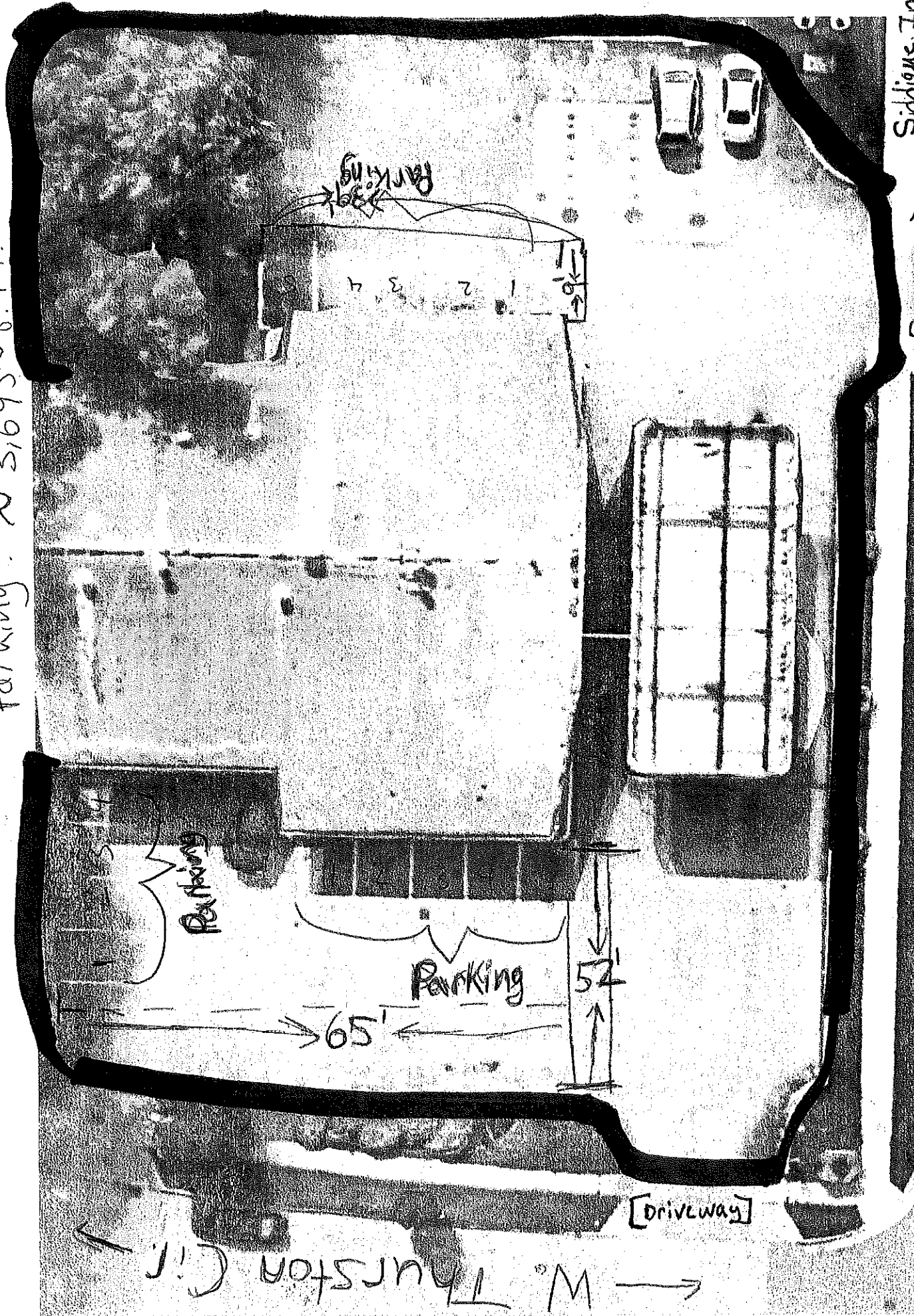

W. Thurston Cir. →

Siddique, Inc. 3656 N 76th St.

9/20/2022
Agent: M. Samir

[driveway]

→

No. 76th Street

←

↑