



**CITY OF MILWAUKEE
OFFICE OF THE CITY CLERK**

Wednesday, October 04, 2023

COMMITTEE MEETING NOTICE

AD 04

EITEL, Michael J, Agent
BBC 782 LLC
1401 E Kenmore Pl
Shorewood, WI 53211

You are requested to attend a hearing which is to be held in Room 301-B, Third Floor, City Hall or you may attend virtually using the link below.

Tuesday, October 17, 2023 at 11:05 AM

The access code is <https://meet.goto.com/428236653>. If you wish to call in: **+1 (571) 317-3122** and use Access Code: **428-236-653**. Please see the enclosed best practices document for further instructions.

Regarding: Your Class B Tavern, Public Entertainment Premises. Food Dealer and Sidewalk Dining License Applications Requesting Instrumental Musicians, Disc Jockey. Jukebox, Bands and 5 Amusement Machines as agent for "BBC 782 LLC" for "Barrel Burrito Eitel's" at 782 N JEFFERSON St.

There is a possibility that your application may be denied for one or more of the following reasons: The recommendation of the committee regarding the application shall be based on evidence presented at the hearing. Per MCO 85-2.7-4, probative evidence concerning whether or not a new license should be granted may be presented on the following subjects: whether or not the applicant meets the municipal requirements, the appropriateness of the location and premises where the licensed premises is to be located and whether use of the premises for the purposes or activities permitted by the license would tend to facilitate a public or private nuisance or create undesirable neighborhood problems such as disorderly patrons, unreasonably loud noise, litter, and excessive traffic and parking congestion. Probative evidence relating to these matters may be taken from the plan of operation submitted with the license application, if any, but shall not include the content of any music. Evidence regarding the fitness of the location of the premises to be maintained as the principal place of business, including but not limited to whether there is an overconcentration of businesses of the type for which the license is sought; whether the proposal is consistent with any pertinent neighborhood business or development plans, or the location's proximity to areas where children are typically present. The applicant's record in operating similarly licensed premises; and whether or not the applicant has been charged with or convicted of any felony, misdemeanor, municipal offense or other offense, the circumstances of which substantially relate to the activity to be permitted by the license being applied for or any other factor which reasonably relates to the public health, safety or welfare may also be considered. See attached police report or correspondence.

Notice for applicants with warrants or unpaid fines:

Proof of warrant satisfaction or payment of fines must be submitted at the hearing on the above date and time. Failure to comply with this requirement may result in a delay of the granting/denial of your application.

Failure to appear at this meeting may result in the denial of your license. Individual applicants must appear only in person or by an attorney. Corporate or Limited Liability applicants must appear only by the agent designated on the application or by an attorney. Partnership applicants must appear by a partner listed on the application or by an attorney. If you wish to do so and at your own expense, you may be accompanied by an attorney of your choosing to represent you at this hearing. You will be given an opportunity to speak on behalf of the application and to respond and challenge any charges or reasons given for the denial. No petitions can be accepted by the committee, unless the people who signed the petition are present at the committee hearing and willing to testify. You may present witnesses under oath and you may also confront and cross-examine opposing witnesses under oath. If you have difficulty with the English language, you should bring an interpreter with you, at your expense, so that you can answer questions and participate in your hearing.

You may examine the application file at this office during regular business hours prior to the hearing date. Inquiries regarding this matter may be directed to the person whose signature appears below.

Limited parking for persons attending meetings during normal business hours is available at reduced rates (5 hour limit) at the Milwaukee Center on the southwest corner of Kilbourn Avenue and Water Street. You must present a copy of the meeting notice to the parking cashier.

PLEASE NOTE: Upon reasonable notice, efforts will be made to accommodate the needs of disabled individuals through sign language interpreters or other auxiliary aids. For additional information or to request this service, contact the Council Services Division ADA Coordinator at (414) 286-2998, Fax - (414) 286-3456, TDD - (414) 286-2025.

JIM OWCZARSKI, CITY CLERK

BY: _____

Jim Cooney
License Division Manager

If you have questions regarding this notice, please contact the License Division at (414) 286-2238.

200 E. Wells Street, Room 105, City Hall, Milwaukee, WI 53202. www.milwaukee.gov/license
Phone: (414) 286-2238 Fax: (414) 286-3057 Email Address: License@milwaukee.gov

Date: 9/27/2023
Officer: PLUMLEY

City of Milwaukee Police Department
90-5-1.5 Crime Prevention Survey
Tavern Inspection

Name of Premise: Barrel Burrito Company
Address: 782 N Jefferson St
Phone:

Owner: Caravan Hospitality LLC
Owner address: 1668 N Warren
City State Zip: Milwaukee WI 53202
Owner Phone: (414) 350-7557
Owner email: uncledude@mac.com

Licensee/Agent: Michael J. EITEL
Home Address: 1401 E Kenmore PL
City State Zip: Shorewood WI 53211
Phone: (414) 350-7557
Email: uncledude@mac.com

Preferred contact: Phone

Location currently open: ☐ YES ☒ NO

Projected open date: 10/9/2023

Day's open: ☐S ☐M ☐T ☐W ☐Th ☐F ☐SA ☒ALL

Hours of Operation: Sun: 10A-2A ☐24 hours ☐Y ☒N
Mon: 10A-2A
Tue: 10A-2A
Wed: 10A-2A
Thu: 10A-2A
Fri: 10A-2:30A
Sat: 10A-2:30A

Premise Type: ☒Tavern/Bar
☒Restaurant
☐Other:

Licenses currently held:

Alcohol: ☒Yes ☐No Class: BTAVN #: 356622
Tobacco: ☒Yes ☐No #: 1031738

Food: ☒ Yes ☐ No #: 13824
Extended Hours: ☐ Yes ☒ No #:
Secondhand Dealer: ☐ Yes ☒ No Type: #:
Other: ☒ Yes ☐ No Type: PEP #: 8753
Other: ☒ Yes ☐ No Type: SD #: 1801

Exterior Survey:

1. Is the area around the location clean? ☐ Yes ☐ No
2. What surrounds the location? (Check all the apply)
 - a. ☐ Park
 - b. ☐ School
 - c. ☐ Youth Center
 - d. ☐ Church
 - e. ☐ Tavern(s) If so, how many
 - f. ☐ Residential
 - g. ☒ Other businesses
 - h. ☐ Other:
3. Can you see from the outside of the location into the interior ☒ Yes ☐ No
4. Can you see the employees inside of the location from the outside ☒ Yes ☐ No
5. Are exterior windows free of signage ☒ Yes ☐ No
6. Is there a parking lot ☐ Yes ☒ No
7. Is the parking lot clean? ☐ Yes ☐ No
8. Off-Street parking ☐ Yes ☒ No
9. Is the parking lot well lit? ☐ Yes ☐ No
10. Valet Parking ☐ Yes ☒ No
 - a. Will this lot have a guard? ☐ Yes ☐ No
 - b. Will this lot have cameras? ☐ Yes ☐ No
11. Are there areas where a person could conceal themselves ☐ Yes ☒ No
12. Is there exterior lighting? ☒ Yes ☐ No. Does it appears to be adequate ☒ Yes ☐ No
13. Exterior Payphone? ☐ Yes ☒ No
14. Are there No Loitering Signs posted? ☐ Yes ☒ No
15. Are there exterior security cameras ☐ Yes ☒ No How Many:
16. Are the address numbers prominently displayed and easy to see ☐ Yes ☐ No

Camera Survey:

17. Does this location have security cameras? ☐ Yes ☒ No
18. Are they in working order? ☐ Yes ☐ No
19. What format are the cameras?
 - a. Color ☐ Yes ☐ No
 - b. Digital ☐ Yes ☐ No
 - c. Recorded ☐ Yes ☐ No
20. How long is footage stored for later viewing:
21. Are there exterior cameras ☐ Yes ☐ No How many:
22. Are there interior cameras ☐ Yes ☐ No How many:
23. Do all employees know how to retrieve recorded digital images/footage? ☐ Yes ☐ No
24. Cameras located in parking lot ☐ Yes ☐ No How many

Interior Survey:

25. What is the planned capacity 149

26. What is the minimum number of employees That will be on premise 4
27. Is the storeowner willing to be a standing complainant regarding loitering? ☒ Yes ☐ No
- a. If yes have them fill out the standing complaint form and give them two of the commercial signs ☐ Yes ☒ No
28. Is the interior of the location neat and clean? ☒ Yes ☐ No
29. Does an interior camera face the entrance/exit? ☐ Yes ☒ No
30. Is there a lockable area that separates employees from customers? ☒ Yes ☐ No
31. Are emergency and non-emergency numbers posted near the phone? ☒ Yes ☐ No
32. Does the owner know how to contact their police district directly? ☒ Yes ☐ No
- a. Did you provide a district contact guide to the owner? ☒ Yes ☐ No

Security

33. How many security personnel are going to be employed: 1-2
34. How ill they be deployed: Interior 1-2 Exterior
35. What days will they be deployed ☒ Mon ☒ Tue ☒ Wed ☒ Thu ☒ Fri ☒ Sat ☒ Sun
36. Will the security be managed by business ☒ or contracted ☐
37. Will they be armed ☐ Yes ☒ No
38. What type of security measures to be used:
- ☐ Wandering/metal detector
 - ☐ ID Scanner
 - ☐ Dress Code
 - ☐ Cover Charge
 - ☐ Age restriction
 - ☐ Other

ADDITIONAL COMMENTS/RECOMMENDATIONS:

Will be adding 16 surveillance cameras to the establishment. There will be two door positions for security officers. The owner will be posting a "No Loitering" sign in the window of the establishment. The owner is willing to add more security for special events going on at the establishment.



Concentration Map 782 N JEFFERSON ST

Area of Interest (AOI) Information

Area : 21,862,586.1 ft²

Sep 19 2023 15:17:29 Central Daylight Time

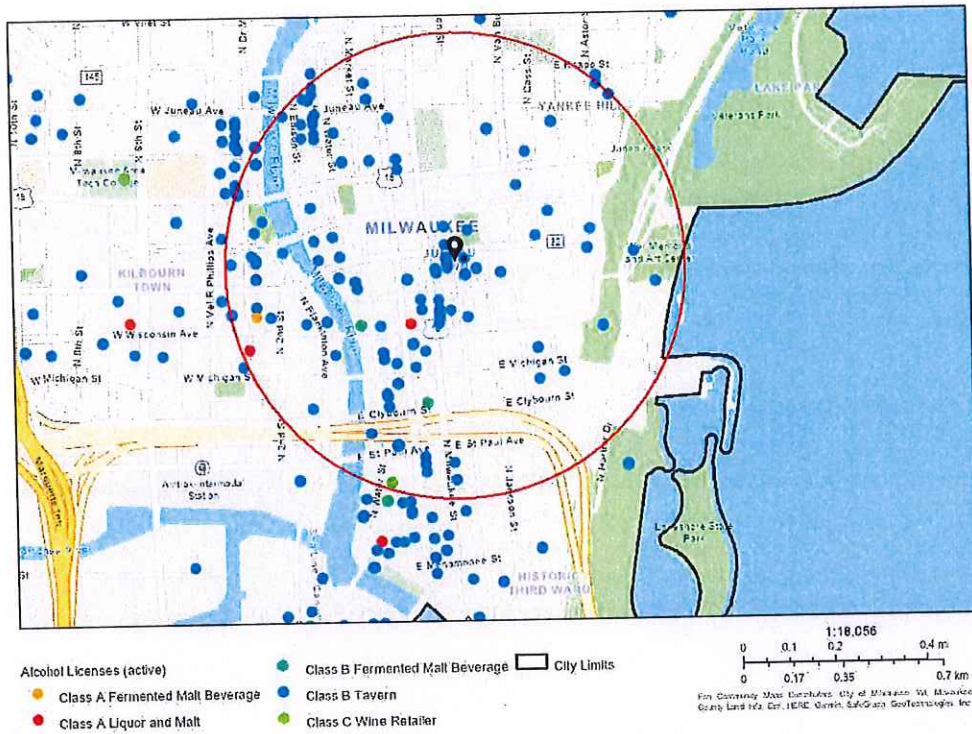

782 N JEFFERSON ST

Summary

Name	Count	Area(ft²)	Length(mi)
Alcohol Licenses	147		

Alcohol Licenses

#	Legal Entity	Trade Name	Licensee	Address	License Type Name	Total Capacity	Expiration Date	Count
1	ST. PAUL SEAFOOD, LLC	ST. PAUL FISH CO.	TIMOTHY G COLLINS, Agt	400 N WATER ST	Class B Tavern License		9/20/2023, 7:00 PM	1
2	TUDY-BART, LLC	BACCHUS-A BARTOLOTTA RESTAURANT	CHRISTIAN M DAMIANO, Agt	925 E WELLS ST	Class B Tavern License	200	9/21/2023, 7:00 PM	1
3	BRG 1000 Water Street, LLC	Rumpus Room - A Bartolotta Gastropub	CHRISTIAN M DAMIANO, Agt	1030 N Water ST	Class B Tavern License	254	9/21/2023, 7:00 PM	1
4	BRG 1000 Water St LLC	Room @ The Rumpus Room	CHRISTIAN M DAMIANO, Agt	1020 N Water ST	Class B Tavern License		9/21/2023, 7:00 PM	1
5	BRG 777 E Wisconsin LLC	Downtown Kitchen	CHRISTIAN M DAMIANO, Agt	777 E WISCONSIN AV	Class B Tavern License	483	9/21/2023, 7:00 PM	1
6	LUKE'S OF MILWAUKEE, LTD	RED ROCK SALOON MILWAUKEE	JEFFREY A KOVACOVICH, JR, Agt	1225 N WATER ST	Class B Tavern License	390	9/24/2023, 7:00 PM	1
7	WELLS-JEFFERSON CORPORATION	TAYLOR'S	DANIEL R TAYLOR, Agt	795 N JEFFERSON ST	Class B Tavern License	160	9/25/2023, 7:00 PM	1
8	THE WESTOWN ASSOCIATION OF MILWAUKEE, INC.	Westown Association	STACIE J CALLIES, Agt	310 W WISCONSIN AV	Class B Tavern License		9/25/2023, 7:00 PM	1
9	Artisan Ramen LLC	Artisan Ramen	Zoe F Gagliano, Agt	530 E Mason ST	Class B Tavern License	93	9/29/2023, 7:00 PM	1
10	Drury Hotels Company, LLC	Drury Plaza Hotel - Milwaukee Downtown	Chris Palid, Agt	700 N Water ST	Class B Tavern License		10/2/2023, 7:00 PM	1
11	REAL CHILI OF MILWAUKEE, INC	REAL CHILI	STEPHEN J KASTELIC, Agt	419 E WELLS ST	Class B Tavern License	80	10/2/2023, 7:00 PM	1
12	SINCERESWANA, LLC	SWINGIN DOOR EXCHANGE	MICHELLE M SINCERE, Agt	219 E MICHIGAN ST	Class B Tavern License	80	10/10/2023, 7:00 PM	1
13	BAR NONE MILWAUKEE, LLC	BAR NONE	AMY M BLADOW, Agt	1139 N WATER ST	Class B Tavern License	60	10/11/2023, 7:00 PM	1
14	BREW CITY BAR B Q, INC	TRINITY THREE IRISH PUBS	ROBERT C SCHMIDT, JR, Agt	125 E JUNEAU AV	Class B Tavern License	833	10/16/2023, 7:00 PM	1
15	ASCENT BAR MKE LLC	Ascent Bar	TIM B GOKHMAN, Agt	700 E KILBOURN AV	Class B Tavern License		10/17/2023, 7:00 PM	1
16	PTG Live Events LLC	Pabst Theater Group	RICHARD J RYAN, Agt	1119 N Marshall ST	Class B Tavern License		10/31/2023, 7:00 PM	1
17	BW HOLDINGS, LLC	WARD'S HOUSE OF PRIME	BRIAN J WARD, Agt	540 E MASON ST	Class B Tavern License	260	11/1/2023, 7:00 PM	1

18	MKE Events LLC	Red White and Blue	JACOB E DEHNE, Agt	1044 N MARTIN L KING JR DR	Class B Tavern License	824	11/5/2023, 6:00 PM	1
19	3rd Street Market LLC	3rd St Market Hall	Jaime A Jacobs-Schroeder, Agt	275 W Wisconsin AV 100	Class B Tavern License		11/9/2023, 6:00 PM	1
20	HDS 777, LLC	The Sofie	DAVID J SAFINA, Agt	777 N JEFFERSON ST	Class B Tavern License		11/20/2023, 6:00 PM	1
21	Dubbel Dutch, LLC	Dubbel Dutch Hotel	Kaelyn M Cervero, Agt	817-819 N MARSHALL ST	Class B Tavern License		11/21/2023, 6:00 PM	1
22	Integrated Plankinton Milwaukee LLC	Cambria Milwaukee Downtown	Christopher R Torres, Agt	503 N Plankinton AV	Class B Tavern License		11/21/2023, 6:00 PM	1
23	CALDERONE CLUB	CALDERONE CLUB	GIORGIO G FAZZARI, SP	842 N Martin L king Jr DR	Class B Tavern License	100	11/21/2023, 6:00 PM	1
24	JCTH, INC	CAFE AT THE PLAZA	BENJAMIN T CRICHTON, Agt	1007 N CASS ST	Class B Tavern License		11/23/2023, 6:00 PM	1
25	KEN ELLIOT'S, INC	SCOOTERS PUB / DUKES ON WATER	JAMES A BAADE, Agt	150-58 E JUNEAU AV	Class B Tavern License	400	11/24/2023, 6:00 PM	1
26	The Brownstone LLC	The Brownstone	COREY L SMITH, Agt	524 N Water ST	Class B Tavern License		11/27/2023, 6:00 PM	1
27	BOOBY JDK, LLC	McGillycuddy's Bar & Grill	ANDREW C DEUSTER, Agt	1133-37 N Water ST	Class B Tavern License	300	11/28/2023, 6:00 PM	1
28	Tourist Convenience LLC	Racks Full of Snacks	AHMED K YAFAI, Agt	240 W Wells ST	Class A Malt & Class A Liquor License		11/28/2023, 6:00 PM	1
29	OUZO CAFE	OUZO CAFE	NICKEY G PAPPAS, Agt	776 N MILWAUKEE ST	Class B Tavern License	40	11/29/2023, 6:00 PM	1
30	Pat's Rib Place 2, LLC	Pat's Rib Place 2	Tyodus D Hayes, Agt	400 N WATER ST	Class B Fermented Malt Beverage Retailer's License		12/11/2023, 6:00 PM	1
31	MKE Water Street LLC	ELMNT Lounge	HABIB MANJEE, Agt	618 N WATER ST	Class B Tavern License		12/17/2023, 6:00 PM	1
32	DEER CAMP, LLC	Deer Camp	Paul C Hackbarth, Agt	1023-1027 N Dr Martin L King Jr DR	Class B Tavern License		12/21/2023, 6:00 PM	1
33	THE KING AND I RESTAURANT, INC	THE KING AND I RESTAURANT	DEREK E PHOUNGPHO L, Agt	830 N Dr Martin L King Jr DR	Class B Tavern License	240	12/25/2023, 6:00 PM	1
34	Tua Pasta LLC	Tua Pasta	Alvaro Nino de Guzman Ramirez, Agt	100 E WISCONSIN AV LL101	Class B Fermented Malt Beverage Retailer's License		12/28/2023, 6:00 PM	1
35	Tua Pasta LLC	Tua Pasta	Alvaro Nino de Guzman Ramirez, Agt	100 E WISCONSIN AV LL101	Class C Wine Retailer's License		12/28/2023, 6:00 PM	1

36	Fazzari & Company, LLC	San Giorgio Pizzeria Napoletana	GIORGIO G FAZZARI, Agt	838 N Martin L King Jr DR	Class B Tavern License	99	1/1/2024, 6:00 PM	1
37	ALEM ETHIOPIAN RESTAURANT, LLC	ALEM ETHIOPIAN VILLAGE	MULU H HABTESILAS SIE, Agt	307 E WISCONSIN AV	Class B Tavern License	98	1/16/2024, 6:00 PM	1
38	Shake Shack Wisconsin LLC	Shake Shack	ARI B DOMNITZ, Agt	220 E Buffalo ST 110	Class B Fermented Malt Beverage Retailer's License		1/16/2024, 6:00 PM	1
39	Button Block Holdings LLC	Homewood Suites Hotel	Travis M Gitter, Agt	500 N Water ST	Class B Tavern License		1/16/2024, 6:00 PM	1
40	Shake Shack Wisconsin LLC	Shake Shack	ARI B DOMNITZ, Agt	220 E Buffalo ST 110	Class C Wine Retailer's License		1/16/2024, 6:00 PM	1
41	CHINA GOURMET, INC	CHINA GOURMET RESTAURANT	ROBERT C TSAO, Agt	117 E WELLS ST	Class B Tavern License	165	1/17/2024, 6:00 PM	1
42	APARTMENT 720, LLC	APARTMENT 720	Tony T Skoufis, Agt	720 N MILWAUKEE ST	Class B Tavern License	299	1/24/2024, 6:00 PM	1
43	Carnivoras Inc	Carnevor	Joseph McLean, Agt	718 N Milwaukee ST	Class B Tavern License	99	1/25/2024, 6:00 PM	1
44	Oak Barrel Public House LLC	Oak Barrel	ROBERT L WILTGEN, Agt	1033 N Martin L King Jr DR	Class B Tavern License		1/29/2024, 6:00 PM	1
45	MAC PARTNERS, LLC	Milwaukee Athletic Club - Roof Top	Thomas James McGinty, Agt	758 N BROADWAY	Class B Tavern License		2/5/2024, 6:00 PM	1
46	MAC PARTNERS, LLC	Milwaukee Athletic Club - 3rd Floor	Thomas James McGinty, Agt	758 N BROADWAY	Class B Tavern License		2/5/2024, 6:00 PM	1
47	GRANDVIEW MANAGEMENT, INC	ZILLI HOSPITALITY GROUP	ROBERT J ZILLI, Agt	910 E MICHIGAN ST	Class B Tavern License	450	2/6/2024, 6:00 PM	1
48	The Belmont Tavern, Inc	The Belmont Tavern	MICHAEL J VITUCCI, Agt	784 N Jefferson ST	Class B Tavern License	160	2/6/2024, 6:00 PM	1
49	Smoke Shack Mke, LLC	Smoke Shack	David J Marcus, Agt	332 N Milwaukee ST	Class B Tavern License	91	2/6/2024, 6:00 PM	1
50	Pourman's LLC	Pourman's	BENJAMIN A HEBL, Agt	1127 N Water ST	Class B Tavern License	80	2/7/2024, 6:00 PM	1
51	WOMANS CLUB OF WISCONSIN	WOMANS CLUB OF WISCONSIN	Patti L Muccio, Agt	813 E KILBOURN AV	Class B Tavern License	500	2/9/2024, 6:00 PM	1
52	STEE V GEE LLC	Sportclub Nomad	MICHAEL J EITEL, Agt	750 N Jefferson ST	Class B Tavern License	240	2/14/2024, 6:00 PM	1
53	3CP LLC	Third Coast Provisions	Andrew H Miller, Agt	724 N Milwaukee ST	Class B Tavern License		2/14/2024, 6:00 PM	1
54	Mojo MKE LLC	Mojo MKE	Todd M Wargula, Agt	134 E JUNEAU AV	Class B Tavern License	239	2/21/2024, 6:00 PM	1

55	Levy @ Milwaukee Symphony	Levy @ Milwaukee Symphony	Joshua J Langenohl, Agt	212 W WISCONSIN AV	Class B Tavern License		2/26/2024, 6:00 PM	1
56	MILWAUKEE WATERFRONT DELI, INC	MILWAUKEE WATERFRONT DELI	JEREMIAH D PANDL, Agt	761 N WATER ST	Class B Tavern License		2/26/2024, 6:00 PM	1
57	Ninja MKE Steak House, Inc	Ninja MKE Japanese Steak House	Lichai Chen, Agt	770-772 N MILWAUKEE ST	Class B Tavern License		2/26/2024, 6:00 PM	1
58	Milwaukee Art Museum, Inc	Milwaukee Art Museum	Christina M Gaskey, Agt	700 N Art Museum DR	Class B Tavern License	2,133	2/28/2024, 6:00 PM	1
59	THE WICKED HOP, LLC	THE WICKED HOP	MILES E O'NEIL, Agt	343-45 N BROADWAY	Class B Tavern License	160	2/29/2024, 6:00 PM	1
60	Who's Milwaukee LLC	Who's on Third, Milwaukee's Pub	ROBERT L WILTGEN, Agt	1003&1007 N Martin L King Jr DR	Class B Tavern License		3/2/2024, 6:00 PM	1
61	FLOUR POWER LLC	Flourchild	Andrew H Miller, Agt	722 N MILWAUKEE ST	Class B Tavern License		3/5/2024, 6:00 PM	1
62	International Exports LLC	The Safe House	Mark A Peterson, Agt	779 N Front ST	Class B Tavern License	248	3/8/2024, 6:00 PM	1
63	Foot Paw LLC	Amilinda	Gregory R Leon, Agt	315 E Wisconsin AV	Class B Tavern License		3/9/2024, 6:00 PM	1
64	Xankia LLC	Xankia	Vang Thao, Agt	222 W WELLS ST	Class B Tavern License		3/12/2024, 7:00 PM	1
65	ManCave Milwaukee, LLC	ManCave Milwaukee	Jeffrey L Taylor, Agt	706 N MILWAUKEE ST 106	Class B Tavern License		3/14/2024, 7:00 PM	1
66	Allure MKE LLC	Allure MKE	Tino K Bates, Agt	787-789 N Jefferson ST	Class B Tavern License		3/15/2024, 7:00 PM	1
67	Discourse Coffee, LLC	Discourse Coffee	Ryan S Castelaz, Agt	1020 N BROADWAY	Class B Tavern License	110	3/20/2024, 7:00 PM	1
68	Charro Latino, LLC	CARBON/LUC ID	Michael B Byers-Dent, Agt	725-729 N Milwaukee ST	Class B Tavern License	490	3/21/2024, 7:00 PM	1
69	SAZAMA'S FINE CATERING, INC	SAZAMA'S FINE CATERING	Stephanie L Sazama-Schneck, Agt	929 N WATER ST	Class B Tavern License		4/4/2024, 7:00 PM	1
70	M DE PALMA, LLC	MONICA'S ON ASTOR	MONICA J DE PALMA, Agt	1228 N ASTOR ST	Class B Tavern License	159	4/9/2024, 7:00 PM	1
71	Higbee's MKE LLC	BODEGA	PATSY SMITH-JAMES, Agt	628 N Water ST	Class B Tavern License	225	4/13/2024, 7:00 PM	1
72	Steakhouse Milwaukee LLC	Rare Steakhouse	Mark D Burish, Agt	833 E MICHIGAN ST	Class B Tavern License		4/16/2024, 7:00 PM	1
73	CSM Milwaukee Downtown LLC	Residence Inn - Milwaukee	Thys V Jones, Agt	101 W Wisconsin AV 3	Class B Tavern License		4/16/2024, 7:00 PM	1

74	BRUNCH MKE LLC	BRUNCH	Morgan K Schnabl, Agt	714 N MILWAUKEE ST	Class B Tavern License	160	4/17/2024, 7:00 PM	1
75	Jay Squared LLC	The Box	Jamie A Berger, Agt	311 E Wisconsin AV	Class B Tavern License	270	4/17/2024, 7:00 PM	1
76	East Town Association, Inc	East Town Association	Edgar L Sturkey, Agt	520 E WELLS ST	Class B Tavern License		4/17/2024, 7:00 PM	1
77	Benelux Third Ward, LLC	Cafe Benelux	ERIC G WAGNER, Agt	346 N Broadway	Class B Tavern License	455	5/1/2024, 7:00 PM	1
78	Kinn GH LL LLC	Kinn MKE Guesthouse	Michael Dietrich, Agt	600 N BROADWAY	Class B Tavern License	258	5/1/2024, 7:00 PM	1
79	LUPI & IRIS, LLC	Lupi & Iris/Andiamo	Michael D DeMichele, Agt	777 N VAN BUREN ST	Class B Tavern License		5/7/2024, 7:00 PM	1
80	LOWCOUNTRY MILWAUKEE INC	Lowcountry	Tyler E Mei, Agt	1114 N WATER ST	Class B Tavern License		5/7/2024, 7:00 PM	1
81	Tropic LLC	Tropic	HYACINTH E NEMBHARDT, Agt	518 N Water ST	Class B Tavern License	156	5/7/2024, 7:00 PM	1
82	LUPI & IRIS, LLC	Lupi & Iris/Andiamo	Michael D DeMichele, Agt	777 N VAN BUREN ST	Class A Malt & Class A Liquor License		5/7/2024, 7:00 PM	1
83	V & V PARTNERS, LLC	BENIHANA	SABAH M LIDDAWYEH, Agt	850 N PLANKINTON AV	Class B Tavern License	180	5/17/2024, 7:00 PM	1
84	Milwaukee School of Engineering	Milwaukee School of Engineering	Beth M Luedtke-Williams, Agt	1000 N BROADWAY	Class B Tavern License	480	5/18/2024, 7:00 PM	1
85	GRANDVIEW MANAGEMENT, INC	ZILLI LAKE & GARDENS	ROBERT J ZILLI, Agt	931 E WISCONSIN AV	Class B Tavern License	450	5/18/2024, 7:00 PM	1
86	Milwaukee School of Engineering	Milwaukee School of Engineering	Beth M Luedtke-Williams, Agt	1025 N BROADWAY	Class B Tavern License		5/18/2024, 7:00 PM	1
87	MILWAUKEE SCHOOL OF ENGINEERING	MILWAUKEE SCHOOL OF ENGINEERING	Beth M Luedtke-Williams, Agt	1120 N BROADWAY	Class B Tavern License	208	5/18/2024, 7:00 PM	1
88	1209 WATER ST, INC	BROTHERS BAR & GRILL	MARC R FORTNEY, Agt	1209-13 N WATER ST	Class B Tavern License	750	5/18/2024, 7:00 PM	1
89	Olive Tree LLC	Convenience +	Jamal T Shawar, Agt	308 E Wisconsin AV	Class A Malt & Class A Liquor License		5/19/2024, 7:00 PM	1
90	Giovanis Hospitality Family LLC	Safina's	DAVID J SAFINA, Agt	783-785 N Jefferson ST	Class B Tavern License		5/22/2024, 7:00 PM	1
91	JSWD Wisconsin Venture I LLC	The Westin Milwaukee	Jonathan M Lykins, Agt	550 N Van Buren ST	Class B Tavern License		5/22/2024, 7:00 PM	1
92	WESTTOWN ASSOCIATION OF MILW, INC	WESTTOWN ASSOCIATION	STACIE J CALLIES, Agt	950 N Dr Martin L King Jr DR	Class B Tavern License		5/22/2024, 7:00 PM	1

93	Cheese Mart, Inc	Wisconsin Cheese Mart	KENNETH J MC NULTY, Agt	215 W Highland AV	Class B Tavern License	133	5/22/2024, 7:00 PM	1
94	ZARLETTI, LLC	ZARLETTI	BRIAN C ZARLETTI, Agt	741 N MILWAUKEE ST 1	Class B Tavern License		5/23/2024, 7:00 PM	1
95	Wisconsin & Milwaukee Hotel, LLC	Milwaukee Marriott Downtown/Starbucks	Benjamin A Risseuw, Agt	323 E Wisconsin AV	Class B Tavern License	312	5/23/2024, 7:00 PM	1
96	PPH Properties I LLC	Silk Exotic Gentlemen's Club	SCOTT A KRAHN, Agt	730 N Martin L King Jr DR	Class B Tavern License	297	5/25/2024, 7:00 PM	1
97	12AM Management Group, LLC	Room Seven	Andre B Lewis, Agt	780 N Jefferson ST	Class B Tavern License	240	5/25/2024, 7:00 PM	1
98	Grandview Management Inc	Zilli Hospitality Group	ROBERT J ZILLI, Agt	910 N Martin L King Jr DR	Class B Tavern License		5/25/2024, 7:00 PM	1
99	HTWA MARKET PROJECT, LLC	MILWAUKEE PUBLIC MARKET	MICHAEL GARDNER, Agt	400 N WATER ST	Class B Tavern License	320	5/28/2024, 7:00 PM	1
100	Foltz Family Market, Inc	Foltz Family Market	Casey C Foltz, Agt	400 N WATER ST 6	Class B Tavern License		5/29/2024, 7:00 PM	1
101	NOBLE BEVERAGE MANAGEMENT, LLC	HYATT REGENCY MILWAUKEE	Joshua S Schoggins, Agt	333 W KILBOURN AV	Class B Tavern License	930	5/30/2024, 7:00 PM	1
102	RIVER HOUSE RESTAURANT, INC	VagaBond	ROBERT C SCHMIDT, JR, Agt	1122 N EDISON ST	Class B Tavern License	150	6/1/2024, 7:00 PM	1
103	GRAND CONVENIENT, LLC	GRAND CONVENIENT STORE	AHMED K YAFI, Agt	724 N Martin L King Jr DR	Class A Fermented Malt Beverage Retailer's License		6/13/2024, 7:00 PM	1
104	First MKD, LLC	Hilton Garden Inn	Sarah I Frost, Agt	611 N BROADWAY	Class B Tavern License		6/15/2024, 7:00 PM	1
105	COCKTAILS BY COUNTY, INC.	COCKTAILS BY COUNTY	DONALD G CHILDERS, Agt	250 E JUNEAU AV	Class B Tavern License	330	6/17/2024, 7:00 PM	1
106	CAPITAL GRILLE HOLDINGS, INC	THE CAPITAL GRILLE OF MILW #8027	Lindsey R FitzMaurice, Agt	310 W WISCONSIN AV 100	Class B Tavern License	200	6/18/2024, 7:00 PM	1
107	EDISON MKE LLC	The Edison	David J Marcus, Agt	322 N BROADWAY	Class B Tavern License		6/18/2024, 7:00 PM	1
108	MILWAUKEE SCHOOL OF ENGINEERING	MILWAUKEE SCHOOL OF ENGINEERING	Beth M Luedtke-Williams, Agt	1245 N BROADWAY	Class B Tavern License	2,759	6/19/2024, 7:00 PM	1
109	SORFCO, LTD	THE KNICK	ELIAS G CHEDID, Agt	1030 E JUNEAU AV	Class B Tavern License		6/27/2024, 7:00 PM	1
110	THE MILWAUKEE CLUB	THE MILWAUKEE CLUB	Molly J Schick, Agt	706 N JEFFERSON ST	Class B Tavern License	180	6/29/2024, 7:00 PM	1

111	THIEF WINE, LLC	THIEF WINE SHOP & BAR	PHILIP M BILODEAU, Agt	400 N WATER ST	Class B Tavern License	42	6/29/2024, 7:00 PM	1
112	ELSA'S ON THE PARK, LTD	ELSA'S ON THE PARK	KARL R KOPP, Agt	833 N JEFFERSON ST	Class B Tavern License	100	6/29/2024, 7:00 PM	1
113	THIS IS IT, INC	THIS IS IT	GEORGE R SCHNEIDER, Agt	418 E WELLS ST	Class B Tavern License	160	6/29/2024, 7:00 PM	1
114	WA Cheese & Sausage Shoppe, Inc	WA Cheese & Sausage Shoppe	Mark S Lutz, Agt	400 N WATER ST 24	Class B Tavern License		6/29/2024, 7:00 PM	1
115	MILWAUKEE COUNTY WAR MEMORIAL, INC	MILWAUKEE COUNTY WAR MEMORIAL CENTER	Laurieann Kildegaard, Agt	750 N LINCOLN MEMORIAL DR	Class B Tavern License	240	6/29/2024, 7:00 PM	1
116	MARCUS HOTELS HOSPITALITY, LLC	Saint Kate-The Arts Hotel	Mark A Peterson, Agt	139 E KILBOURN AV	Class B Tavern License		7/5/2024, 7:00 PM	1
117	PABST THEATER CONCESSIONS, LLC	THE PABST THEATER	Richard J Ryan, Agt	144 E WELLS ST	Class B Tavern License		7/5/2024, 7:00 PM	1
118	Fenix Milwaukee LLC	Rodizio Grill	Renan Utrera De Paula, Agt	777 N WATER ST	Class B Tavern License		7/5/2024, 7:00 PM	1
119	UNIVERSITY CLUB OF MILWAUKEE	UNIVERSITY CLUB OF MILWAUKEE	JOSEPH G CORAGGIO, Agt	924 E WELLS ST	Class B Tavern License	150	7/9/2024, 7:00 PM	1
120	MP On Wheels Catering Service	MP On Wheels Catering Service	DULCE M ALARCON, SP	400 N WATER ST	Class B Tavern License	320	7/11/2024, 7:00 PM	1
121	Bollywood Grill, LLC	Bollywood Grill	MANJIT SINGH, Agt	1028-30 N Jackson ST	Class B Tavern License		7/21/2024, 7:00 PM	1
122	Wild Rogues LLC	Elwood's Liquor & Tap	Nathan S Showers, Agt	1111 N Water ST	Class B Tavern License		7/25/2024, 7:00 PM	1
123	DOS BONITAS, LLC	CUBANITAS	MARTA C BIANCHINI, Agt	728 N MILWAUKEE ST	Class B Tavern License	50	7/25/2024, 7:00 PM	1
124	Art's Performing Center, LLC	Silk on Water	SCOTT A KRAHN, Agt	144 E Juneau AV	Class B Tavern License	80	7/25/2024, 7:00 PM	1
125	ARBED, LLC	MO'S IRISH PUB	JAMES A VASSALLO, Agt	142-44 W Wisconsin AV	Class B Tavern License	480	7/26/2024, 7:00 PM	1
126	RIVERWALK COMMONS LLC	Riverwalk Commons	PAUL H SCHWARTZ, Agt	423 N WATER ST	Class B Tavern License		7/28/2024, 7:00 PM	1
127	WALGREEN CO	WALGREENS #1200	Nicole R Davis, Agt	275 W WISCONSIN AV 1108	Class A Malt & Class A Liquor License		7/29/2024, 7:00 PM	1
128	BUCKLEY'S KISKEAM INN, LLC	Buckley's	MICHAEL V BUCKLEY, Agt	801-09 N CASS ST	Class B Tavern License	65	7/29/2024, 7:00 PM	1

129	MARCUS HOTELS HOSPITALITY, LLC	Pfister Hotel & Tower	Mark A Peterson, Agt	424 E WISCONSIN AV	Class B Tavern License	419	7/29/2024, 7:00 PM	1
130	PTG Live Events LLC	The Riverside	Richard J Ryan, Agt	116 W Wisconsin AV	Class B Tavern License	2,480	7/29/2024, 7:00 PM	1
131	NOBLE RIVERCENTE R MKE, LLC	Vault	Kaelyn M Cervero, Agt	111 E KILBOURN AV 210 Ste	Class B Tavern License	432	7/30/2024, 7:00 PM	1
132	TACO MIKES LLC	Taco Mikes LLC	Michael P Holz, Agt	1001 N MARTIN L KING JR DR	Class B Tavern License		8/11/2024, 7:00 PM	1
133	MAC PARTNERS, LLC	Milwaukee Athletic Club - 4th Floor	Thomas James McGinty, Agt	758 N BROADWAY	Class B Tavern License		8/15/2024, 7:00 PM	1
134	LC MKE LLC	The Lucky Clover Pub	JACOB E DEHNE, Agt	1048 N MARTIN L KING JR DR	Class B Tavern License		8/16/2024, 7:00 PM	1
135	INDULGE WINE ROOMS, LLC	INDULGE	MARC R BIANCHINI, Agt	708 N MILWAUKEE ST	Class B Tavern License	60	8/30/2024, 7:00 PM	1
136	MEGA MARTS, LLC	METRO MARKET #371	ANTHONY M KUCHINSKY, Agt	1123 N VAN BUREN ST	Class B Tavern License	65	8/30/2024, 7:00 PM	1
137	Hotel Metro Operator, LLC	Hotel Metro	Andrew R Cordes, Agt	411 E Mason ST	Class B Tavern License	150	8/30/2024, 7:00 PM	1
138	Central Standard LLC	Central Standard Craft Distillery	William P McQuillan, Agt	320 E Clybourn ST	Class B Fermented Malt Beverage Retailer's License		8/30/2024, 7:00 PM	1
139	Sirk Steak LLC	Mo's A Place for Steaks	JAMES A VASSALLO, Agt	720 N Plankinton AV	Class B Tavern License		9/2/2024, 7:00 PM	1
140	MILWAUKEE REPERTORY THEATER, INC	MILWAUKEE REPERTORY THEATER	Melissa N Vartanian-Mikaelian, Agt	108 E WELLS ST	Class B Tavern License		9/7/2024, 7:00 PM	1
141	Water Street Brewery Inc	Water Street Brewery	MATTHEW R SCHMIDT, Agt	1101 N WATER ST	Class B Tavern License	300	9/13/2024, 7:00 PM	1
142	THE HARP IRISH PUB, INC	THE HARP	ROBERT C SCHMIDT, JR, Agt	113 E JUNEAU AV	Class B Tavern License	325	9/14/2024, 7:00 PM	1
143	ST. PAUL SEAFOOD, LLC	ST. PAUL FISH CO.	TIMOTHY G COLLINS, Agt	400 N WATER ST	Class B Tavern License		9/20/2024, 7:00 PM	1
144	BRG 1000 Water Street, LLC	Rumpus Room - A Bartolotta Gastropub	CHRISTIAN M DAMIANO, Agt	1030 N Water ST	Class B Tavern License	254	9/21/2024, 7:00 PM	1
145	BARTOLOTTA CATERING - GRAIN EXCHANGE LLC	BARTOLOTTA CATERING - GRAIN EXCHANGE LLC	CHRISTIAN M DAMIANO, Agt	225 E MICHIGAN ST	Class B Tavern License	299	9/21/2024, 7:00 PM	1
146	TUDY-BART, LLC	BACCHUS-A BARTOLOTTA RESTAURANT	CHRISTIAN M DAMIANO, Agt	925 E WELLS ST	Class B Tavern License	200	9/21/2024, 7:00 PM	1

147	BRG 777 E Wisconsin LLC	Downtown Kitchen	CHRISTIAN M DAMIANO, Agt	777 E WISCONSIN AV	Class B Tavern License	483	9/21/2024, 7:00 PM	1
-----	----------------------------	---------------------	-----------------------------	--------------------------	------------------------------	-----	-----------------------	---

Establishments within a 0.5 miles radius centered on area of interest.



Wednesday, October 04, 2023



Notice of Public Hearing

Blank Notice

EITEL, Michael J, Agent

Barrel Burrito Co/Eitel's at 782 N JEFFERSON St

Class B Tavern, Public Entertainment Premises. Food Dealer and Sidewalk Dining License
Applications Requesting Instrumental Musicians, Disc Jockey. Jukebox, Bands and 5 Amusement
Machines

Tuesday, October 17, 2023 at 11:05 AM

To whom it may concern:

The above application has been made by the above named applicant(s). This requires approval from the Licenses Committee and the Common Council of the City of Milwaukee. The hearing before the Licenses Committee will take place on 10/17/2023 at 11:05 AM in Room 301-B, Third Floor, City Hall. This is a public hearing. Those wishing to view the proceeding are able to do so via the City Channel – Channel 25 on Spectrum Cable – or on the Internet at <http://city.milwaukee.gov/citychannel>. Those wishing to provide oral testimony via phone or internet are asked to contact the staff assistant, Yadira Melendez at (414) 286-2775 or stasst5@milwaukee.gov for necessary information. Please make such requests no later than one business day prior to the start of the meeting. You are not required to attend the hearing, but please see the information below if you would like to provide testimony. Once the Licenses Committee makes its recommendation, this recommendation is forwarded to the full Common Council for approval at its next regularly scheduled hearing.

Important details for those wishing to provide information for the Licenses Committee to consider when making its recommendation:

1. The license application is scheduled to be heard at the above time. Due to other hearings running longer than scheduled, you may have to wait some time to provide your testimony.
2. You must appear in person and testify as to matters that you have personally experienced or seen. (You cannot provide testimony for your neighbor, parent or anyone else; this is considered hearsay and cannot be considered by the committee.)
3. No letters or petitions can be accepted by the committee (unless the person who wrote the letter or the persons who signed the petition are present at the committee hearing and willing to testify).
4. Persons opposed to the license application are given the opportunity to testify first; supporters may testify after the opponents have finished.
5. When you are called to testify, you will be sworn in and asked to give your name, and address. (If your first and/or last names are uncommon please spell them.)
6. You may then provide testimony.
 - a. Include only information relating to the above license application.
 - b. Include only information you have personally witnessed or seen.
 - c. Provide concise and relevant information detailing how this business has affected or may affect the peaceful enjoyment of your neighborhood.
 - d. If by the time you have the opportunity to testify, the information you wish to share has already been provided to the committee, you may state that you agree with the previous testimony. Redundant or repetitive testimony will not assist the committee in making its recommendation.
7. After giving your testimony, the members of the Licenses Committee and the licensee may ask questions regarding the testimony you have given or other factors relating to the license application.
8. Business Competition is not a valid basis for denial or non-renewal of a license.
Please Note: If you have submitted an objection to the above application your objection cannot be considered by the committee unless you personally testify at the hearing.

OCCUPANT	MAIL ADDRESS	CITY STATE ZIP
CURRENT OCCUPANT	545 E WELLS ST# 1000	MILWAUKEE, WI 53202-3806
CURRENT OCCUPANT	545 E WELLS ST# 1001	MILWAUKEE, WI 53202-3806
CURRENT OCCUPANT	545 E WELLS ST# 1002	MILWAUKEE, WI 53202-3806
CURRENT OCCUPANT	545 E WELLS ST# 300	MILWAUKEE, WI 53202-3806
CURRENT OCCUPANT	545 E WELLS ST# 301	MILWAUKEE, WI 53202-3806
CURRENT OCCUPANT	545 E WELLS ST# 302	MILWAUKEE, WI 53202-3806
CURRENT OCCUPANT	545 E WELLS ST# 303	MILWAUKEE, WI 53202-3806
CURRENT OCCUPANT	545 E WELLS ST# 400	MILWAUKEE, WI 53202-3806
CURRENT OCCUPANT	545 E WELLS ST# 401	MILWAUKEE, WI 53202-3806
CURRENT OCCUPANT	545 E WELLS ST# 402	MILWAUKEE, WI 53202-3806
CURRENT OCCUPANT	545 E WELLS ST# 403	MILWAUKEE, WI 53202-3806
CURRENT OCCUPANT	545 E WELLS ST# 500	MILWAUKEE, WI 53202-3806
CURRENT OCCUPANT	545 E WELLS ST# 501	MILWAUKEE, WI 53202-3806
CURRENT OCCUPANT	545 E WELLS ST# 502	MILWAUKEE, WI 53202-3806
CURRENT OCCUPANT	545 E WELLS ST# 600	MILWAUKEE, WI 53202-3806
CURRENT OCCUPANT	545 E WELLS ST# 601	MILWAUKEE, WI 53202-3806
CURRENT OCCUPANT	545 E WELLS ST# 602	MILWAUKEE, WI 53202-3806
CURRENT OCCUPANT	545 E WELLS ST# 700	MILWAUKEE, WI 53202-3806
CURRENT OCCUPANT	545 E WELLS ST# 701	MILWAUKEE, WI 53202-3806
CURRENT OCCUPANT	545 E WELLS ST# 702	MILWAUKEE, WI 53202-3806
CURRENT OCCUPANT	545 E WELLS ST# 703	MILWAUKEE, WI 53202-3806
CURRENT OCCUPANT	545 E WELLS ST# 800	MILWAUKEE, WI 53202-3806
CURRENT OCCUPANT	545 E WELLS ST# 801	MILWAUKEE, WI 53202-3806
CURRENT OCCUPANT	545 E WELLS ST# 802	MILWAUKEE, WI 53202-3806
CURRENT OCCUPANT	545 E WELLS ST# 900	MILWAUKEE, WI 53202-3806
CURRENT OCCUPANT	545 E WELLS ST# 901	MILWAUKEE, WI 53202-3806
CURRENT OCCUPANT	545 E WELLS ST# 902	MILWAUKEE, WI 53202-3806
CURRENT OCCUPANT	769 N JEFFERSON ST# 201	MILWAUKEE, WI 53202-3722
CURRENT OCCUPANT	769 N JEFFERSON ST# 202	MILWAUKEE, WI 53202-3722
CURRENT OCCUPANT	769 N JEFFERSON ST# 301	MILWAUKEE, WI 53202-3730
CURRENT OCCUPANT	769 N JEFFERSON ST# 302	MILWAUKEE, WI 53202-3730
CURRENT OCCUPANT	773 N JEFFERSON ST# 1	MILWAUKEE, WI 53202-3707
CURRENT OCCUPANT	773 N JEFFERSON ST# 2	MILWAUKEE, WI 53202-3707
CURRENT OCCUPANT	773 N JEFFERSON ST# 3	MILWAUKEE, WI 53202-3707
CURRENT OCCUPANT	773 N JEFFERSON ST# 4	MILWAUKEE, WI 53202-3707
CURRENT OCCUPANT	773 N JEFFERSON ST# 5	MILWAUKEE, WI 53202-3707
CURRENT OCCUPANT	773 N JEFFERSON ST# 6	MILWAUKEE, WI 53202-3707
CURRENT OCCUPANT	777 N VAN BUREN ST# 1001	MILWAUKEE, WI 53202-3860
CURRENT OCCUPANT	777 N VAN BUREN ST# 1002	MILWAUKEE, WI 53202-3860
CURRENT OCCUPANT	777 N VAN BUREN ST# 1003	MILWAUKEE, WI 53202-3860
CURRENT OCCUPANT	777 N VAN BUREN ST# 1004	MILWAUKEE, WI 53202-3860
CURRENT OCCUPANT	777 N VAN BUREN ST# 1005	MILWAUKEE, WI 53202-3860
CURRENT OCCUPANT	777 N VAN BUREN ST# 1006	MILWAUKEE, WI 53202-3860
CURRENT OCCUPANT	777 N VAN BUREN ST# 1007	MILWAUKEE, WI 53202-3860
CURRENT OCCUPANT	777 N VAN BUREN ST# 1008	MILWAUKEE, WI 53202-3860
CURRENT OCCUPANT	777 N VAN BUREN ST# 1009	MILWAUKEE, WI 53202-3860

[illegible]

[illegible]

[illegible]

[illegible]

[illegible]

[illegible]

CURRENT OCCUPANT	777 N VAN BUREN ST# 3208	MILWAUKEE, WI 53202-3865
CURRENT OCCUPANT	777 N VAN BUREN ST# 3209	MILWAUKEE, WI 53202-3865
CURRENT OCCUPANT	777 N VAN BUREN ST# 3210	MILWAUKEE, WI 53202-3865
CURRENT OCCUPANT	777 N VAN BUREN ST# 3211	MILWAUKEE, WI 53202-3865
CURRENT OCCUPANT	777 N VAN BUREN ST# 3212	MILWAUKEE, WI 53202-3865
CURRENT OCCUPANT	777 N VAN BUREN ST# 3301	MILWAUKEE, WI 53202-3865
CURRENT OCCUPANT	777 N VAN BUREN ST# 3302	MILWAUKEE, WI 53202-3865
CURRENT OCCUPANT	777 N VAN BUREN ST# 3303	MILWAUKEE, WI 53202-3865
CURRENT OCCUPANT	777 N VAN BUREN ST# 3304	MILWAUKEE, WI 53202-3865
CURRENT OCCUPANT	777 N VAN BUREN ST# 3305	MILWAUKEE, WI 53202-3865
CURRENT OCCUPANT	777 N VAN BUREN ST# 3306	MILWAUKEE, WI 53202-3865
CURRENT OCCUPANT	777 N VAN BUREN ST# 3307	MILWAUKEE, WI 53202-3865
CURRENT OCCUPANT	777 N VAN BUREN ST# 3401	MILWAUKEE, WI 53202-3866
CURRENT OCCUPANT	777 N VAN BUREN ST# 3402	MILWAUKEE, WI 53202-3866
CURRENT OCCUPANT	777 N VAN BUREN ST# 3403	MILWAUKEE, WI 53202-3866
CURRENT OCCUPANT	777 N VAN BUREN ST# 3404	MILWAUKEE, WI 53202-3866
CURRENT OCCUPANT	777 N VAN BUREN ST# 3405	MILWAUKEE, WI 53202-3866
CURRENT OCCUPANT	777 N VAN BUREN ST# 3406	MILWAUKEE, WI 53202-3866
CURRENT OCCUPANT	777 N VAN BUREN ST# 3407	MILWAUKEE, WI 53202-3866
CURRENT OCCUPANT	780 N MILWAUKEE ST	MILWAUKEE, WI 53202-3705

Blank Notice

Total Records: 348

Radius 250.0 feet and Center of the Circle: 782 N Jefferson St



BUSINESS LICENSE PLAN OF OPERATION

ccl-busplan 5/12/2020

Office of the City Clerk License Division
200 E. Wells St. Room 105, Milwaukee, WI 53202
(414) 286-2238 www.milwaukee.gov/license e-mail address: license@milwaukee.gov

1. Type of Business

Applying for: ☐ Extended Hours (12AM to 5AM) - If a food establishment, check all that apply: ☐ Delivery ☐ Drive Thru ☐ Dining Room
☐ Self Service Laundry ☐ Massage Establishment ☐ Filling Station
☐ Other (supplemental application for specific license also required)

Provide a detailed description of the type of business you plan on operating:

Quick service restaurant, dining area, bar

Do you have any experience operating this type of business? ☐ No ☒ Yes If yes, explain: 28 years of running bars + restaurants

2. Business Operations

- a. Proposed Opening Date: 11/4/2023
- b. Is this premise under construction? ☒ No ☐ Yes If yes, list estimated completion date: _____
- c. Is this a franchise? ☒ No ☐ Yes
- d. Is this premises currently licensed? ☒ No ☐ Yes If yes, list type of license: _____
- e. Is the current licensee operating? ☐ No ☐ Yes If no, list date closed: _____
- f. Do you have future plans for other businesses, licenses or permits at this location? ☒ No ☐ Yes
If yes, explain: _____
- g. Have you previously held an Extended Hours License in Milwaukee? ☒ No ☐ Yes
If yes, list address(es): _____
- h. Are other businesses operating in the same building? ☒ No ☐ Yes If yes, describe: _____

3. Litter & Noise

- a. How are grounds kept clean? ☒ Sweep ☒ Pressure Wash ☒ Pick Up Litter ☐ Other: _____
- b. How often will grounds be cleaned? ☒ Daily ☐ Weekly ☐ As Needed ☐ Monthly ☐ Other: _____
- c. Grounds cleaned by: ☒ Licensee ☐ Building Owner ☒ Employees ☒ Hired Maintenance ☐ Other: _____
- d. How are noise issues prevented and/or addressed? ☒ Security ☒ Manager approaches customer(s) ☒ Call Police
☐ Signs Posted ☐ Other: _____
- e. Will a sound amplification system be used? ☐ No ☒ Yes If yes, describe: TV + Speakers

4. Smoking & Sanitation

- a. Are there designated outdoor smoking areas? ☒ No ☐ Yes If yes, describe: _____
- b. Number of Garbage Cans: Inside: 11 Locations: see site plan Bathrooms, Kitchen, bar
Outside: 1 Locations: behind building dining room
- c. Is a crowd control barrier used? ☒ No ☐ Yes If yes, describe: _____
- d. How many restrooms are on the premises? 2
- e. Name of solid waste contractor: ☐ Advanced Disposal ☒ Waste Management ☒ Other: _____

5. Security

- a. Are there onsite parking spaces? ☒ No ☐ Yes If yes, how many? _____ and describe the parking security plan: _____
- b. Is there a loading zone? ☒ No ☐ Yes If yes, describe the loading area security plan: _____
- c. Will you have security personnel on premise? ☐ No ☒ Yes If yes, how many? 1-2 and answer the following:
 What are their responsibilities? ID patrons, assist with customer relations
 Is security equipment used? ☐ No ☒ Yes If yes, describe security cameras
 List their licensing, certification, or training credentials _____
- d. Will there be security cameras? ☐ No ☒ Yes If yes, how many? 12 and list locations: kitchen, hallway, bar, counter, dining room, exit doors, patio
- e. Will searches/identification checks be done upon entry? ☐ No ☒ Yes If yes, describe must show ID to consume alcohol

6. Percentage of Sales (must total 100%)

Alcohol <u>40</u> %	Food <u>60</u> %	Secondhand Merchandise _____ %	Precious Metals & Gems _____ %
Entertainment _____ %	Cigarettes _____ %		
Pawnbroker Activity _____ %	Salvaged Materials _____ % (such as scrap metal)	Personal Services (such as tattoo, body piercing, salon, tailor, tanning, etc.) _____ %	Other _____ % Describe: _____

7. Businesses/Licenses on the Premises (check all that apply):

Type 1

- ☒ Full Service Restaurant ☐ Cafe/Coffee Shop ☒ Deli or Fast Food Restaurant ☐ Private/Fraternal/Veterans Club
- ☐ Night Club ☒ Tavern ☐ Cocktail Lounge ☐ Teen Club
- ☐ Banquet Hall ☐ Sports Facility ☐ Bowling Alley
- ☐ Hotel/Motel: Number of Floors: _____ Number of Rooms: _____
- ☐ Rooming House: Number of Floors: _____ Number of Rooms: _____

Type 2

- ☐ Liquor Store ☐ Corner Store ☐ Supermarket ☐ Convenience Store
- ☐ Gas Station ☐ Amusement/Phonograph Distributor ☐ Recycling, Salvage or Towing
- ☐ Used Car Dealer ☐ Personal Service Establishment (such as tattoo business, hair salon, tailor, etc.) ☐ Recording Studio

What other licenses/permits will you hold at this location? (check all that apply)

- ☒ Occupancy Permit ☐ Cigarette & Tobacco ☐ Gas Station ☐ Extended Hours ☒ Class "B" Tavern ☐ Weights & Measures
- ☐ Secondhand Dealer ☐ Precious Metal & Gem ☐ Other: _____

8. Legal Capacity (only if a Type 1 premises in #7 above)

Capacity 150 (Call the Milwaukee Development Center at 414-286-8211 if you have questions.)

9. Premises Description

a. Identify all area(s) of the premises that will be used in operating this business (include areas used only for storage):

☒ 1st Floor ☐ 2nd Floor ☐ Basement Storage ☐ Patio ☐ Beer Garden ☒ Sidewalk Café ☐ Deck ☐ Rooftop

☐ Other: Describe: _____

b. Describe Location: ☐ Major Thoroughfare ☒ Secondary Street ☐ Other: _____

c. Nearest Major Cross Street: WELLS ST

d. Describe Building: ☐ Free Standing Building ☐ Strip Mall ☐ Other: _____

e. Describe Premises Structure: ☒ Single Story ☐ Multi-Story - # of Stories _____ ☐ Other: _____

f. Describe Surrounding Area: ☒ Commercial ☐ Residential ☐ Industrial ☐ Other: _____

g. Building Owner Name: Washington Square Associates Phone Number: 414 224 5070 x 124

Building Owner Address: c/o Van Buren Management 788 N Jefferson St Suite 800 Milwaukee, WI 53203

10. Hours of Operation & Customers

Will customers be entering the premises? ☐ No ☒ Yes

Day of the Week	Proposed Hours of Operation:		Estimated Number of Customers expected each day	Potential Age Range of Customers	Class B Tavern Applicant Only: Age Restriction (If none, write 'None')
	Open Time (include a.m. or p.m.)	Close Time (include a.m. or p.m.)			
Sunday	10am	2am	250	0-100	None
Monday	11am	2am	250	"	"
Tuesday	11am	2am	250	"	"
Wednesday	11am	2am	250	"	"
Thursday	11am	2am	250	"	"
Friday	11am	2:30am	350	"	"
Saturday	10am	2:30am	350	"	"

An Extended Hours Establishment License is required for any convenience store, filling station, personal service establishment (such as tattoo, body piercing, salon, tailor, tanning, etc.), recording studio or restaurant which is open between the hours of 12:00 a.m. and 5:00 a.m.

Alcohol Establishments Class A: 8:00 am to 9:00 pm Sunday thru Saturday
Permitted Hours of Operation: Class B: 6:00 am to 2:00 am Sunday thru Thursday, 6:00 am to 2:30 am Friday & Saturday

Entertainment Outdoor Closing Hours: 10:00pm Sunday-Thursday; 12:00am Friday & Saturday; unless a different time, either earlier or later, is established by the Common Council in its approval of the licensee's plan of operation.

11. Signature(s)

MICHAEL EITEL, PRESIDENT

Signature of Sole Proprietor, Partner, or 20% or more Shareholder
(If there are no 20% or more shareholders,
Corporate Officer-print name/title and sign)

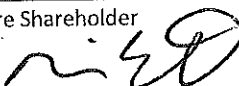

Signature of additional partner or 20% or more shareholder

See Application Information for a complete list of all required application forms.



ALCOHOL BEVERAGE & PUBLIC ENTERTAINMENT PREMISES SUPPLEMENTAL APPLICATION

Office of the City Clerk License Division
200 E. Wells St. Room 105, Milwaukee, WI 53202
(414) 286-2238 e-mail address: license@milwaukee.gov www.milwaukee.gov/license

Legal Entity Name:

BBC 782 LLC

Premise Address:

782 N JEFFERSON ST

Proximity of Premises to Church, School, Daycare Center or Hospital

Is the building within 300 feet of any church, school, daycare center or hospital?

☒ No ☐ Yes

"Service Bar Only" Designation

If applying for Class B or C license, are you applying for "Service Bar Only"?

☒ No ☐ Yes

Service Bar Only means customers cannot sit at the bar. Alcohol is served to employees who serve patrons seated at tables.
No stools, chairs or other articles of furniture shall be placed at the service bar for patrons to sit upon.

Business Information

a) Are you taking out this application for anyone that may not be eligible for a license? ☒ No ☐ Yes

If yes, list their name and address: _____

b) Will the agent, a partner or the individual licensee be conducting the day-to-day operations of the business? ☐ No ☒ Yes

If no, list the name and address of the person(s) who will: _____

Class B Applicants: If the agent, a partner or the individual licensee will not be conducting the day-to-day operations of the business, the person(s) listed above must obtain a Class B Managers license.

c) Does anyone else have money invested or any other interest in this business? ☒ No ☐ Yes

If yes, explain: _____

d) Have you made an agreement with anyone to repay any loan or any other payments based upon income from the business?

☒ No ☐ Yes If yes, list name and address: _____

Property Information (New & Transfer Applicants Only)

a) Do you own or lease the building?

☐ Own ☒ Lease

b) Who owns the fixtures (for example, coolers, etc.)?

Landlord

c) Are you purchasing the stock and/or fixtures?

☒ No ☐ Yes If yes, amount paid \$ _____

d) Total amount paid for business

\$ 0

e) Total amount paid for goodwill of the business

\$ 0

Goodwill comprises the reputation and customer relationships of an existing business. If the price you pay for the business exceeds the fair market value of all of the rest of the assets of the business, the excess may be considered goodwill.

f) Have you made arrangements with the seller for payment of personal property taxes? ☐ No ☐ Yes

Lease Information (New & Transfer Applicants who are leasing the premises only)

a) Date lease begins 8/29/2023 Ends 3/1/2031

b) Monthly rental \$9666.67

c) Do you have an option to renew the lease? ☐ No ☒ Yesd) Does your lease allow for assignment to another party without the consent of the owner? ☒ No ☐ Yes

e) For what length of time have you been guaranteed occupancy (number of years)? 7 years

Lease Information (Continued)

- f) In addition to paying the monthly rental, will you have to pay anything additional to the owner of the building to guarantee performance of the lease? ☐ No ☒ Yes If yes, explain Utilities, water, insurance
- g) Does the present owner or occupant object to the granting of your license? ☒ No ☐ Yes
If yes, explain _____

Change of Agent Applicants Only

Have there been any changes to the floor plan since the last application was submitted? ☐ No ☐ Yes
If no, a new floor plan is not required. If yes, submit a new floor plan and explain the change(s):

Signature

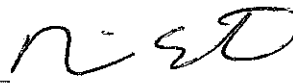
MICHAEL EITEL, President 

Signature of Sole Proprietor, Partner or 20% or More Shareholder
(If no 20% or more Shareholder, Corporate Officer - print name/title and sign)

Note: All information contained in this application is subject to approval by the Common Council.
Deviating from approved plan of operation will subject licensee to citations, and/or suspension or non-renewal of the license.
Contact the License Division for information on how to request changes.

New and transfer of premises applicants must submit the following:

- ☒ Detailed floor plan
☐ If a restaurant, copy of the menu

**FOOD DEALER LICENSE PLAN OF OPERATION**

OFFICE OF THE CITY CLERK, LICENSE DIVISION
CITY HALL, 200 E. WELLS ST, ROOM 105, MILWAUKEE, WI 53202
(414) 286-2238 • license@milwaukee.gov • www.milwaukee.gov/license

Legal Entity Name:

BBC 782 LLC

Premises Address:

782 N JEFFERSON ST, MILWAUKEE, WI 53202

SECTION 1**TYPE OF BUSINESS**

What will be the majority of your food sales? (check one)

☒ Restaurant Items (meals):

MEALS include, but are not limited to, chicken, ribs, sandwiches, roasted corn, baked potatoes, hot dogs, brats, tacos, nachos w/ cheese and meat, French fries, cooked or deep fried vegetables/fruit, cooked cheese curds, corn dogs, egg rolls, salads.

☐ Retail Items (snacks and beverages):

RETAIL items include, but are not limited to, ice cream/soft serve, lemonade, snow cones, coffee, espresso, cappuccino, tea, fruit juice, smoothies, candy, dispensed soda, fruit cups, bakery, cookies, kettle corn, cotton candy, funnel cakes, fritters, tortilla chips w/ cheese.

Will it be a convenience store? ☐ Yes ☐ No

A convenience store contains less than 5,000 square feet of retail space and has, as its primary business, the sale of basic food items and in addition, sells household products or is a filling station that sells basic food items and household products.

☐ Bed & Breakfast☐ Micro Market

All Applicants: Submit a menu or a list of food items that will be sold.

Will any wholesale business be done? ☒ No ☐ Yes If yes, what percentage of food sales will be wholesale?☐ Less than 25%☐ 25% or More AND:☐ Restaurant items (meals) will be sold – Complete this application and also contact DATCP.☐ NO restaurant items (meals) will be sold - Do NOT complete this application. Contact DATCP only.**SECTION 2****FOOD PROCESSING**Will any food processing be done? ☐ No ☒ Yes

Processing is defined as assembling, grinding, cutting, mixing, baking, coating, stuffing, packing, bottling, grilling, canning, extracting, fermenting, distilling, pickling, freezing, drying, smoking, or packaging.

SECTION 3**FOOD REQUIRING TEMPERATURE CONTROL**

Will any food that requires temperature control be sold? ☐ No ☒ Yes
(includes dairy products such as milk, cheese, and ice cream, fish, shellfish, meat, poultry)

If yes, list the types of food items: all of the above

SECTION 4 DETAILS OF OPERATION

- Will you have seating on site for dining? ☐ No ☒ Yes
- Will you be doing any catering? ☐ No ☒ Yes
- Will you be doing any delivery? ☒ No ☐ Yes
- Will you have outdoor activities? ☒ No ☐ Yes - Check all that apply: ☐ Bar ☐ Cooking/Grilling ☐ Dining
- Will you have a drive thru window? ☒ No ☐ Yes - Are hours different from inside? ☐ No ☐ Yes
- If Yes, provide drive thru hours: _____
- Will scales or barcode scanners be used? ☒ No ☐ Yes - You must also apply for a Weights & Measures License.

SECTION 5 ADDITIONAL SITES

Where will food be prepared and/or sold?

- ☒ At a single site ☐ At multiple sites: How many? _____ (for example, a hotel with several dining rooms or bars)

If multiple sites, attach a Food Dealer Additional Site Addendum (ccl-foodadd) for each additional site.

SECTION 6 CONSTRUCTION OR CHANGES

Are you planning any construction, remodeling or equipment changes?

- ☒ No If No, SKIP to Section 7
- ☐ Yes If Yes, check all that apply: ☐ New construction of a building ☐ Renovation or remodeling
- ☐ Construction changes to existing building ☐ Equipment changes only

Provide a brief description of the changes: _____

Start date: _____

Name, Address & Phone Number of Architect: _____

Name, Address & Phone Number of Contractor: _____

SECTION 7 ALCOHOL BEVERAGES

Are you applying for an alcohol beverage license?

- ☐ No If No, SKIP to Section 8
- ☒ Yes If YES, if your food license is approved prior to the alcohol license, when do you want the food license issued?
- ☒ Immediately ☐ At the same time as the alcohol license

SECTION 8 ACKNOWLEDGEMENTS & SIGNATURE

You must initial each item confirming your understanding:

- NE I understand the Health Department must conduct an inspection and advise the License Division of their approval before the license may be issued.
- NE I understand I must obtain an occupancy permit from the Department of Neighborhood Services and an inspection may be required. Neighborhood Services must advise the License Division of their approval before the license may be issued.
- NE I understand the district alderperson will review and either support or object to my application. If he/she objects, I may appeal and be scheduled to appear before the Licenses Committee. The Licenses Committee will then make a recommendation to the Common Council. The Common Council must grant the license before it may be issued.
- NE I understand proof of payment for all license fees must be on file in the License Division before the license may be issued and the license must be issued and posted in my establishment prior to opening for business.
- NE I will not operate my food business until the license has been issued and posted in the establishment.

Signature of Sole Proprietor, Partner, or 20% Shareholder: _____

Signature of Additional Partner: _____



PUBLIC ENTERTAINMENT PREMISES LICENSE SUPPLEMENTAL APPLICATION

Office of the City Clerk License Division
200 E. Wells St. Room 105, Milwaukee, WI 53202
(414) 286-2238 www.milwaukee.gov/license e-mail address: license@milwaukee.gov

PREMISES ADDRESS: 782 N JEFFERSON ST MILWAUKEE, WI 53202

TYPES OF ENTERTAINMENT (CHECK ALL THAT APPLY)

- | | | | |
|---|---|---|---|
| <input checked="" type="checkbox"/> Instrumental Musicians | <input type="checkbox"/> Battle of the Bands | <input type="checkbox"/> Dancing by Performers | <input checked="" type="checkbox"/> Amusement Machines
How many? <u>5</u> |
| <input checked="" type="checkbox"/> Bands | <input type="checkbox"/> Comedy Acts | <input type="checkbox"/> Adult Entertainment/
Strippers/Erotic Dance | <input type="checkbox"/> Concerts
Approx. # per year? _____ |
| <input type="checkbox"/> Bowling Alley
How many? _____ | <input checked="" type="checkbox"/> Disc Jockey | <input type="checkbox"/> Wrestling | <input type="checkbox"/> Theatrical Performances
Approx. # per year? _____ |
| <input type="checkbox"/> Pool Tables
How many? _____ | <input type="checkbox"/> Magic Shows | <input type="checkbox"/> Patron Contests | <input checked="" type="checkbox"/> Jukebox |
| <input type="checkbox"/> Motion Pictures (movies by
admission) - How many? _____ | <input type="checkbox"/> Poetry Readings | <input type="checkbox"/> Patrons Dancing | <input type="checkbox"/> Karaoke |
| <input type="checkbox"/> Other: _____ | | | |

Entertainment Outdoor Closing Hours: 10:00pm Sunday-Thursdays; 12:00am Friday & Saturday; unless a different time, either earlier or later, is established by the Common Council in its approval of the licensee's plan of operation.

PROMOTERS/SOUND AMPLIFICATION

Will promoters ever be used for any of the entertainment? ☒ No ☐ Yes If Yes, Describe: _____

At any time will sound amplification be used? ☐ No ☒ Yes If Yes, Describe: House PA for TV's + DJ's

LEGAL CAPACITY OF PREMISES

150 (Call the Development Center at 414-286-8211 with questions.) Legal capacity determines the fee for your Public Entertainment Premises License. If you would like to request the license be approved with a lower capacity than that listed above, indicate the lower capacity here: 149. If approved, this lower capacity will print on your license and override the capacity listed on your Occupancy Permit.

ACKNOWLEDGEMENT/SIGNATURE

I understand that after the license has been issued, a change to the plan of operation will require a written request to change and approval from the Common Council. I agree to inform the City Clerk within 10 days of any substantial changes in the information supplied in this application. I understand that I shall not willfully refuse to provide the services offered under this license, or add charges or require deposits not required of the general public because of race, color, sex, religion, national origin or ancestry, age, handicap, lawful source of income, marital status, sexual orientation, gender identity or expression, familial status or the fact that a person is now or has been a member of the military service, whether dressed in uniform or not; and shall not seek such information as a condition of employment, or penalize any employee or discriminate in the selection of personnel for training or promotion on the basis of such information.

I have knowledge of the City Ordinances currently regulating public entertainment, and understand that the license may be subject to suspension, non-renewal or revocation, if I violate any rule, law or regulation of the city of Milwaukee and State of Wisconsin.

MICHAEL EITEL President

[Signature]

Signature of Sole Proprietor, Partner or 20% or More Shareholder
(If no 20% or more Shareholder, Corporate Officer - print name/title and sign)

Office Use Only:

Initials: _____ Filed: _____ App: _____

Only PEP? ☐ No ☐ Yes If Yes, ☐ Queue to MPD and ☐ Email Mgrs/Team Lead (must be heard w/in 60 days)



Sidewalk Dining Facility Supplemental Application

ccl-side1 2/21/18

Office of the City Clerk License Division

200 E. Wells St. Room 105, Milwaukee, WI 53202

(414) 286-2238 www.milwaukee.gov/license e-mail address: license@milwaukee.gov

Business Name:

BBC 782 LLC

Aldermanic District #

41

Premises Address:

782 N JEFFERSON ST

MILWAUKEE WI 53202

Business Operations

Check one: ☒ I/we are also applying for Food/Alcohol license(s) at this time.

☐ I/we currently hold Food/Alcohol license(s) AND

☐ confirm that the Business Plan of Operation on file which was previously submitted with the Food and/or Alcohol application has not changed, except for the addition of this sidewalk dining facility.

☐ have included a new Business Plan of Operation reflecting requested changes.

Sidewalk Dining Facility will operate from: Start Date: 11/4/23 to End Date: _____

Will any food preparation be done outdoors? ☒ No ☐ Yes

If yes, describe: _____

Will any sidewalk dining facility improvements be physically attached to public structures? ☒ No ☐ Yes

If yes, describe: _____

Property Owner

Check one: ☐ Applicant owns the property

☒ Property owner's information/signature provided below (REQUIRED):

Name: WASHINGTON SQUARE ASSOCIATES IV Phone # 414 224 5070 x124

Address: 788 N JEFFERSON ST SUITE 800 MILWAUKEE WI 53202

Property Owner's Signature: BY: Van Buren Management, Inc., General Partner

BY: Daniel Lee, Vice President

Signature(s)

MICHAEL EITEL President

Signature of Sole Proprietor, Partner, or 20% or more Shareholder
(If there are no 20% or more shareholders,
Corporate Officer-print name/title and sign)

Signature of additional partner or 20% or more shareholder

Office Use Only:

Initials _____ Filed _____ App # _____

Processing LS: Queue to: ☐ HD ☐ DNS ☐ CC Email To: ☐ DPW ☐ Primary LS

Also: ☐ holds ☐ is applying for: ☐ Food ☐ Alcohol ☐ Perm Ext

Barrel Burrito Company To Go MENU

BURRITOS \$12 (WRAPPED OR BOWL)

STEAK
CHICKEN
BREAKFAST
MAHI MAHI
SHRIMP
BIRRIA
VEGGIE
GRINGO
KOREAN BBQ
VEGAN

NACHO PLATE \$11

TORTILLA SOUP \$7 BOWL

GUACAMOLE \$7

CHIPS AND SALSA \$4
SALSA ROJA
SALSA VERDE
CREMA HABANERO

Bar Menu

MAC N CHEESE \$9
 ADD TOPPING \$5
 (chili, pulled pork, pulled chicken, bacon jalapeno)
CARAVAN CHILI \$7
CHILI MAC \$12
SLIDERS (3) \$11
CHICKEN WINGS (6) \$12

ALLEY

SHARED LOADING
DOCK AND
DUMPSTERS

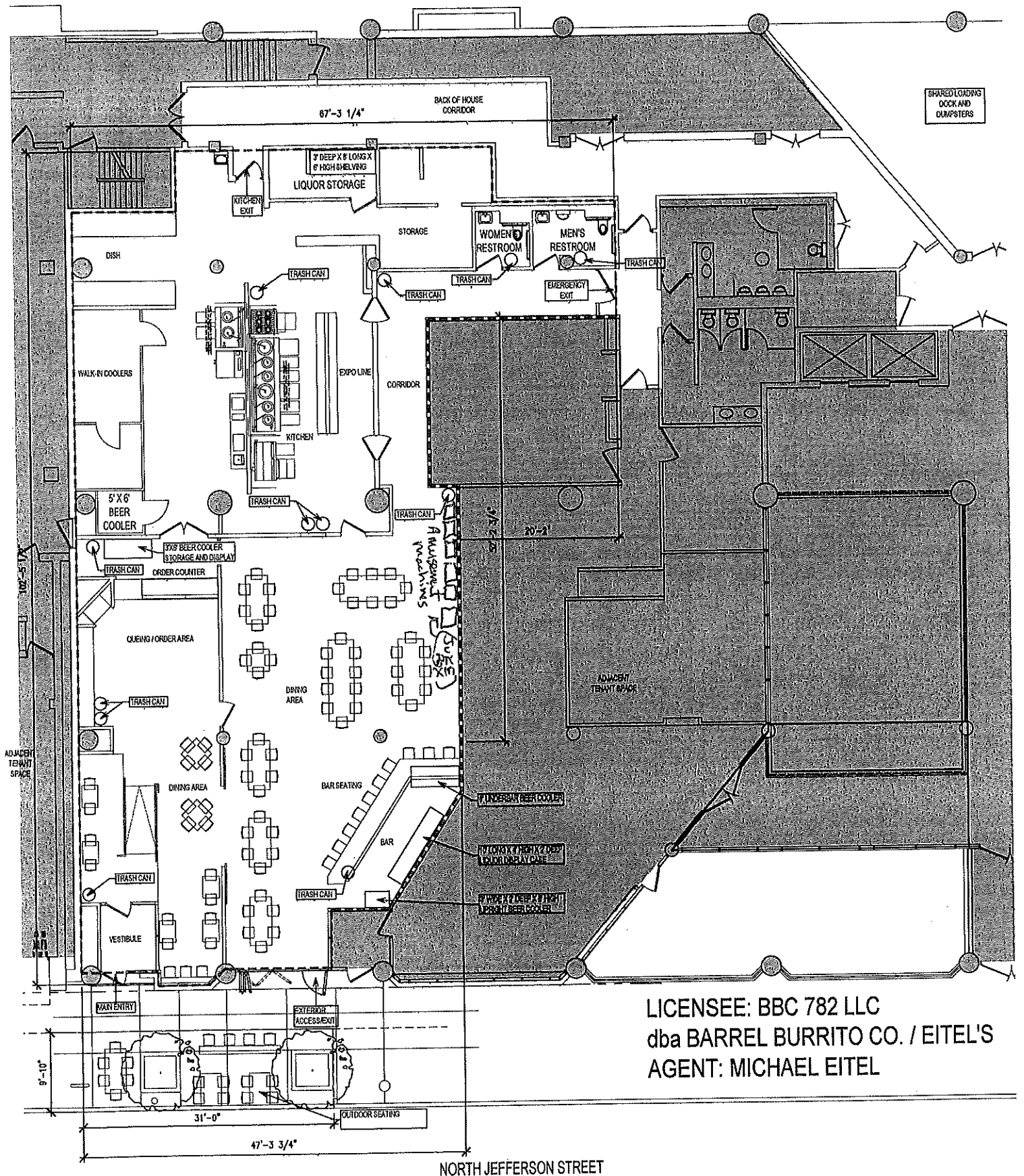

LICENSEE: BBC 782 LLC
dba BARREL BURRITO CO. / EITEL'S
AGENT: MICHAEL EITEL

NORTH JEFFERSON STREET

TENANT SPACE: 4,754 SF
INDOOR DINING: 1,875 SF
OUTDOOR SEATING AREA: 304 SF



LICENSING PLAN

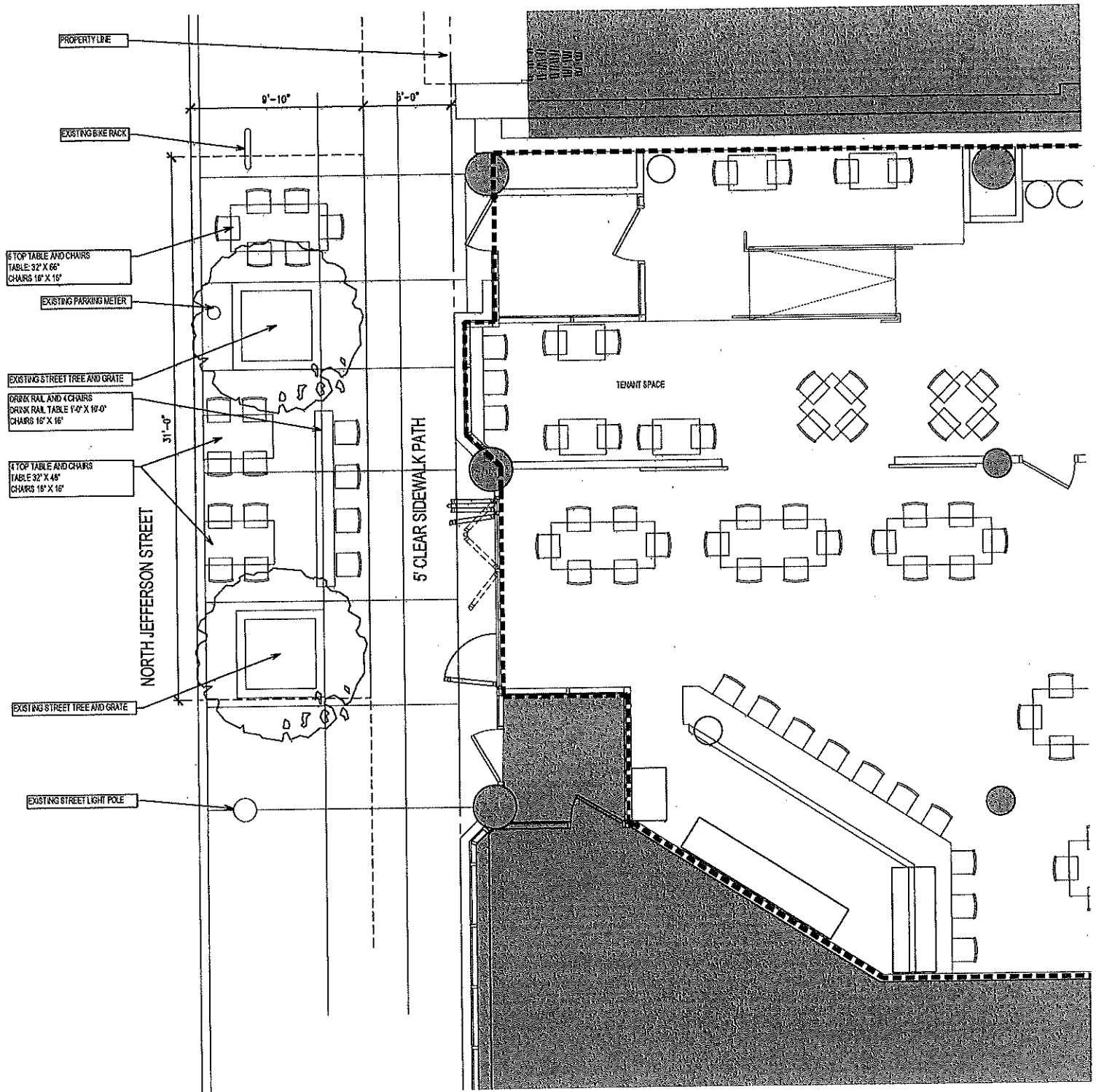

OUTDOOR SEATING AREA: 304 SF
INDOOR DINING: 1,875 SF

LICENSEE: BBC 782 LLC
dba BARREL BURRITO CO. / EITEL'S
AGENT: MICHAEL EITEL

SIDEWALK SEATING PLAN

782 N JEFFERSON STREET
#23144 | SEPTEMBER 15, 2023