



CITY OF MILWAUKEE
OFFICE OF THE CITY CLERK

Tuesday, July 02, 2024

COMMITTEE MEETING NOTICE

AD 15

ABOHADBA, Yasser, Agent
Brother Plus Grocery LLC
4020 W NORTH Av
Milwaukee, WI 53208

You are requested to attend a hearing which is to be held in Room 301-B, Third Floor, City Hall or you may attend virtually using the link below.

Friday, July 12, 2024 at 09:50 AM

The access code is https://meet.goto.com/584084517. Please see the enclosed best practices document for further instructions.

Regarding: Your Food Dealer License Application as agent for "Brother Plus Grocery LLC" for "Brother Plus Grocery" at 4020 W NORTH Av.

There is a possibility that your application may be denied for one or more of the following reasons: The recommendation of the committee regarding the application shall be based on evidence presented at the hearing. Per MCO 85-2.7-4, probative evidence concerning whether or not a new license should be granted may be presented on the following subjects: whether or not the applicant meets the municipal requirements, the appropriateness of the location and premises where the licensed premises is to be located and whether use of the premises for the purposes or activities permitted by the license would tend to facilitate a public or private nuisance or create undesirable neighborhood problems such as disorderly patrons, unreasonably loud noise, litter, and excessive traffic and parking congestion. Probative evidence relating to these matters may be taken from the plan of operation submitted with the license application, if any, but shall not include the content of any music. Evidence regarding the fitness of the location of the premises to be maintained as the principal place of business, including but not limited to whether there is an overconcentration of businesses of the type for which the license is sought; whether the proposal is consistent with any pertinent neighborhood business or development plans, or the location's proximity to areas where children are typically present. The applicant's record in operating similarly licensed premises; and whether or not the applicant has been charged with or convicted of any felony, misdemeanor, municipal offense or other offense, the circumstances of which substantially relate to the activity to be permitted by the license being applied for or any other factor which reasonably relates to the public health, safety or welfare may also be considered. See attached police report or correspondence.

Notice for applicants with warrants or unpaid fines: Proof of warrant satisfaction or payment of fines must be submitted at the hearing on the above date and time. Failure to comply with this requirement may result in a delay of the granting/denial of your application.

Failure to appear at this meeting may result in the denial of your license. Individual applicants must appear only in person or by an attorney. Corporate or Limited Liability applicants must appear only by the agent designated on the application or by an attorney. Partnership applicants must appear by a partner listed on the application or by an attorney. If you wish to do so and at your own expense, you may be accompanied by an attorney of your choosing to represent you at this hearing.

You will be given an opportunity to speak on behalf of the application and to respond and challenge any charges or reasons given for the denial. No petitions can be accepted by the committee, unless the people who signed the petition are present at the committee hearing and willing to testify. You may present witnesses under oath and you may also confront and cross-examine opposing witnesses under oath. If you have difficulty with the English language, you should bring an interpreter with you, at your expense, so that you can answer questions and participate in your hearing.

You may examine the application file at this office during regular business hours prior to the hearing date. Inquiries regarding this matter may be directed to the person whose signature appears below.

Limited parking for persons attending meetings during normal business hours is available at reduced rates (5 hour limit) at the Milwaukee Center on the southwest corner of Kilbourn Avenue and Water Street. You must present a copy of the meeting notice to the parking cashier.

PLEASE NOTE: Upon reasonable notice, efforts will be made to accommodate the needs of disabled individuals through sign language interpreters or other auxiliary aids. For additional information or to request this service, contact the Council Services Division ADA Coordinator at (414) 286-2998, Fax - (414) 286-3456, TDD - (414) 286-2025.

JIM OWCZARSKI, CITY CLERK

Handwritten signature of Jim Cooney

BY: Jim Cooney
License Division Manager

If you have questions regarding this notice, please contact the License Division at (414) 286-2238.

200 E. Wells Street, Room 105, City Hall, Milwaukee, WI 53202. www.milwaukee.gov/license
Phone: (414) 286-2238 Fax: (414) 286-3057 Email Address: License@milwaukee.gov



CITY OF MILWAUKEE  
OFFICE OF THE CITY CLERK

Tuesday, July 02, 2024

COMMITTEE MEETING NOTICE

AD 15

ABOHADBA, Yasser, Agent  
Brother Plus Grocery LLC  
3741 S 61<sup>ST</sup> ST #204  
Milwaukee, WI 53220

You are requested to attend a hearing which is to be held in Room 301-B, Third Floor, City Hall or you may attend virtually using the link below.

**Friday, July 12, 2024 at 09:50 AM**

The access code is <https://meet.goto.com/584084517>. Please see the enclosed best practices document for further instructions.

**Regarding:** Your Food Dealer License Application as agent for "Brother Plus Grocery LLC" for "Brother Plus Grocery" at 4020 W NORTH Av.

There is a possibility that your application may be denied for one or more of the following reasons: The recommendation of the committee regarding the application shall be based on evidence presented at the hearing. Per MCO 85-2.7-4, probative evidence concerning whether or not a new license should be granted may be presented on the following subjects: whether or not the applicant meets the municipal requirements, the appropriateness of the location and premises where the licensed premises is to be located and whether use of the premises for the purposes or activities permitted by the license would tend to facilitate a public or private nuisance or create undesirable neighborhood problems such as disorderly patrons, unreasonably loud noise, litter, and excessive traffic and parking congestion. Probative evidence relating to these matters may be taken from the plan of operation submitted with the license application, if any, but shall not include the content of any music. Evidence regarding the fitness of the location of the premises to be maintained as the principal place of business, including but not limited to whether there is an overconcentration of businesses of the type for which the license is sought; whether the proposal is consistent with any pertinent neighborhood business or development plans, or the location's proximity to areas where children are typically present. The applicant's record in operating similarly licensed premises; and whether or not the applicant has been charged with or convicted of any felony, misdemeanor, municipal offense or other offense, the circumstances of which substantially relate to the activity to be permitted by the license being applied for or any other factor which reasonably relates to the public health, safety or welfare may also be considered. See attached police report or correspondence.

**Notice for applicants with warrants or unpaid fines:**

Proof of warrant satisfaction or payment of fines must be submitted at the hearing on the above date and time. Failure to comply with this requirement may result in a delay of the granting/denial of your application.

Failure to appear at this meeting may result in the denial of your license. Individual applicants must appear only in person or by an attorney. Corporate or Limited Liability applicants must appear only by the agent designated on the application or by an attorney. Partnership applicants must appear by a partner listed on the application or by an attorney. If you wish to do so and at your own expense, you may be accompanied by an attorney of your choosing to represent you at this hearing.

You will be given an opportunity to speak on behalf of the application and to respond and challenge any charges or reasons given for the denial. No petitions can be accepted by the committee, unless the people who signed the petition are present at the committee hearing and willing to testify. You may present witnesses under oath and you may also confront and cross-examine opposing witnesses under oath. If you have difficulty with the English language, you should bring an interpreter with you, at your expense, so that you can answer questions and participate in your hearing.

You may examine the application file at this office during regular business hours prior to the hearing date. Inquiries regarding this matter may be directed to the person whose signature appears below.

Limited parking for persons attending meetings during normal business hours is available at reduced rates (5 hour limit) at the Milwaukee Center on the southwest corner of Kilbourn Avenue and Water Street. You must present a copy of the meeting notice to the parking cashier.

PLEASE NOTE: Upon reasonable notice, efforts will be made to accommodate the needs of disabled individuals through sign language interpreters or other auxiliary aids. For additional information or to request this service, contact the Council Services Division ADA Coordinator at (414) 286-2998, Fax - (414) 286-3456, TDD - (414) 286-2025.

JIM OWCZARSKI, CITY CLERK

BY: \_\_\_\_\_

Jim Cooney  
License Division Manager

**If you have questions regarding this notice, please contact the License Division at (414) 286-2238.**

200 E. Wells Street, Room 105, City Hall, Milwaukee, WI 53202. [www.milwaukee.gov/license](http://www.milwaukee.gov/license)  
Phone: (414) 286-2238 Fax: (414) 286-3057 Email Address: License@milwaukee.gov

# Brother Plus Grocery LLC

4020 W North Ave  
Milwaukee, WI 53208  
(414) 202-8989  
Yasserabohadba74@Gmail.com

April 25, 2024

Dear Office City Clerk License Division,

I am writing to appeal the Alderman's objection to approve my application for a Food Dealer Retail License at 4020 W North Ave Milwaukee, WI 53208.

Although there may be similar establishments near the proposed location, my hours of operation are different and the Food Dealer Retail License will help meet the needs of several long standing customers.

I am constantly reminded by numerous consumers of their appreciation of the "convenience of a one stop shop". Given the license, I am able to offer healthier food selections and accommodate reasonable demands for perishable items. I will also be able to provide a variety of food choices that aid in feeding families during the hours other establishments are not operating.

In light of the information provided, I ask that you reconsider our decision to grant Brother Plus Grocery LLC the Food Dealer Retail License. Thank you for your time and consideration.

Sincerely,

Yasser Abohadba  
Owner of Brother Plus Grocery LLC.

CITY OF MILWAUKEE  
LICENSE DIVISION  
APR 29 10 41 20



Office of the City Clerk  
**License Division**

**Jim Owczarski**  
City Clerk  
jowcza@milwaukee.gov

**Jim Cooney**  
License Division Manager  
jim.cooney@milwaukee.gov

April 18, 2024

ABOHADBA, Yasser  
Brother Plus Grocery LLC  
4020 W NORTH Av  
Milwaukee WI 53208

RE: Food Dealer Retail License Application for 4020 W NORTH Av  
**Immediate Response Required**

Dear ABOHADBA, Yasser:

The local alderperson who represents the district for your proposed business objects to your application for a Food Dealer Retail license at 4020 W NORTH Av .

Their objection is based on:

- Concentration of food establishments in the area.

You have the right to file an appeal to the objection. The appeal must be in writing and addressed to the Licenses Committee of the Common Council. Submit your written statement appealing the local alderperson's objection within 10 working days of the date of this letter to the License Division, City Hall, Room 105, 200 E. Wells Street, Milwaukee, WI 53202.

If you do not file an appeal, no further action will be taken regarding your application. Contact the License Division for information regarding a partial refund of any paid license fees.

Sincerely,

Tonja Richardson  
License Specialist II





# 4020 W. North Ave.

## Area of Interest (AOI) Information

Area : 21,862,585.81 ft<sup>2</sup>

Apr 18 2024 9:37:57 Central Daylight Time

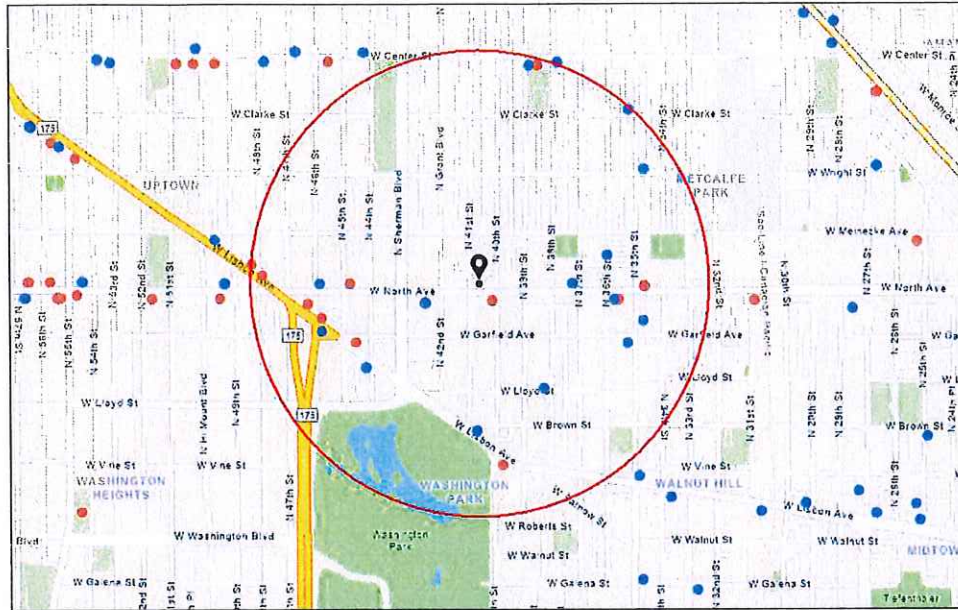

- Food Licenses (active)
- Food Dealer - Retail
- Food Dealer - Restaurant
- City Limits

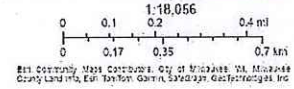

### Summary

Name	Count	Area(ft <sup>2</sup> )	Length(mi)
Food Licenses	29		

### Food Licenses

#	Legal Entity	Trade Name	Licensee	Address	License Type Name	Total Capacity	Expiration Date	Count
1	Cita & Papa's Place	Cita & Papa's Place	Scotty Goines, SP	3821 W Center ST	Food Dealer - Restaurant		4/19/2024, 7:00 PM	1
2	SHAN FOOD SALES INC	JUDY'S RED HOTS	Ali S Chattha, Agt	4806 W LISBON AV	Food Dealer - Restaurant		5/25/2024, 7:00 PM	1
3	Silver City BBQ & Fish	Silver City BBQ & Fish	Desmond O Wilson, SP	3521 W NORTH AV	Food Dealer - Restaurant		6/29/2024, 7:00 PM	1
4	BRIDGEMAN FOODS II, INC	WENDY'S RESTAURAN T #6	PAUL S THOMPSON, Agt	4601 W NORTH AV	Food Dealer - Restaurant		5/29/2024, 7:00 PM	1
5	Samir LLC	Dave's Beacon Service	Mohammed Khan, Agt	4527 W Lisbon AV	Food Dealer Retail		7/27/2024, 7:00 PM	1
6	Best Deal Food Mart LLC	Bill the Butcher	Latoya T James, Agt	3533 W NORTH AV	Food Dealer Retail		7/4/2024, 7:00 PM	1
7	PKK LLC	SKYWAY FOOD MART	Praneeth K Ponugoti, Agt	2601 N 35TH ST	Food Dealer Retail		8/12/2024, 7:00 PM	1
8	ADAM MINI MART, LLC	LLOYD FOOD	BALWINDER SINGH, Agt	2101 N 38TH ST	Food Dealer Retail		8/12/2024, 7:00 PM	1
9	BIG SHARKS FISH & CHICKEN LLC	BIG SHARKS FISH & CHICKEN	MAHER T AYAD, Agt	3420 W North AV	Food Dealer - Restaurant		10/4/2024, 7:00 PM	1
10	Lisbon Food & Beer, Inc	Lisbon Food & Beer	Ashwani Sharma, Agt	4401 W Lisbon AV	Food Dealer Retail		9/22/2024, 7:00 PM	1
11	NATURES NETER HERBS AND SUPPLEMENTS LLC	House of Vitali-tea	Kamar M Carter, Agt	4424 W NORTH AV	Food Dealer Retail		10/2/2024, 7:00 PM	1
12	Los Tres Paisas LLC	Los Tres Paisas	Ezequiel Vidal Hilario, Agt	3434 W NORTH AV	Food Dealer - Restaurant		10/9/2024, 7:00 PM	1
13	Original Kings of Chicken LLC	Original King of Chicken	Willie L Murphy, Agt	4424 W LISBON AV	Food Dealer - Restaurant		11/15/2024, 6:00 PM	1
14	Tricklebee Cafe, Inc.	Tricklebee Cafe	Christie E Melby-Gibbons, Agt	4424-4424A W NORTH AV	Food Dealer - Restaurant		11/20/2024, 6:00 PM	1
15	GURU FOOD, LLC	GURU FOOD	MAMTA SINGH, Agt	4028 W LISBON AV	Food Dealer Retail		10/18/2024, 7:00 PM	1
16	Uptown on North LLC	786 Pantry	Shamika Harris, Agt	4534 W NORTH AV	Food Dealer Retail		10/23/2024, 7:00 PM	1
17	Brothers Petrol Inc.	Brothers Petrol	Arshdeep s Sandhar, Agt	2175 N 35th ST	Food Dealer Retail		11/16/2024, 6:00 PM	1
18	Brew City Pizza	Dominos	John Theisen, Agt	4211 W NORTH AV	Food Dealer - Restaurant		11/20/2024, 6:00 PM	1
19	Seafood Island Market Inc	Seafood Island Market	Muhannad A Abughosh, Agt	3939 W LISBON AV	Food Dealer - Restaurant		6/7/2024, 7:00 PM	1
20	Fresh-Fast & Delicious LLC	Fresh, Fast & Delicious	Jermaine D Peterson, Agt	3821 W Center ST	Food Dealer - Restaurant		11/7/2024, 6:00 PM	1
21	RALPH'S COFFEE	RALPH'S COFFEE	RALPH E NEELY, SP	4538 W LISBON AV	Food Dealer - Restaurant		12/18/2024, 6:00 PM	1
22	PREMIER SPORTS LOUNGE, LLC	PREMIER SPORTS LOUNGE	Tabitha A Harris, Agt	4001 W NORTH AV	Food Dealer - Restaurant		12/16/2024, 6:00 PM	1

23	Harman Beer & Liquor Inc	Buy Rite	Krishna Teja Mummaneni, Agt	2500 N 35th ST	Food Dealer Retail		1/18/2025, 6:00 PM	1
24	Family Dollar Stores of Wisconsin LLC	Family Dollar #26245	Peter A Barnett, Agt	2214 N 35th ST	Food Dealer Retail		1/9/2025, 6:00 PM	1
25	Ruby J's Inc	Ruby J's Cafe	Eric R Brown, Agt	4734 W Lisbon AV	Food Dealer - Restaurant		1/8/2025, 6:00 PM	1
26	MEGA MARTS, LLC	PICK 'N SAVE #879	BEVERLY HUGHES, Agt	2355 N 35TH ST	Food Dealer Retail		1/17/2025, 6:00 PM	1
27	UP 31 PETRO MART INC	Up 31 Petro Mart	GURINDER S NAGRA, Agt	3708 W North AV	Food Dealer Retail		1/15/2025, 6:00 PM	1
28	QUICK FOOD MARKET	QUICK FOOD MARKET	BALJEET KAUR, Raghwi nder Singh	3833 W CENTER ST	Food Dealer Retail		1/20/2025, 6:00 PM	1
29	SK PANTRY INC.	BC Supermarket	Sanjeev Dhingra, Agt	4225 W NORTH AV	Food Dealer Retail		2/10/2025, 6:00 PM	1

Establishments within a 0.5 miles radius centered on area of interest.





Tuesday, July 02, 2024



# Notice of Public Hearing

Blank Notice

---

ABOHADBA, Yasser, Agent  
Brother Plus Grocery at 4020 W NORTH Av  
Food Dealer License Application

**Friday, July 12, 2024 at 9:50 AM**

To whom it may concern:

The above application has been made by the above named applicant(s). This requires approval from the Licenses Committee and the Common Council of the City of Milwaukee. The hearing before the Licenses Committee will take place on 7/12/2024 at 9:50 AM in Room 301-B, Third Floor, City Hall. This is a public hearing. Those wishing to view the proceeding are able to do so via the City Channel – Channel 25 on Spectrum Cable – or on the Internet at <http://city.milwaukee.gov/citychannel>. Those wishing to provide oral testimony via internet are asked to contact the staff assistant, Yadira Melendez at (414) 286-2775 or [stasst5@milwaukee.gov](mailto:stasst5@milwaukee.gov) for necessary information. Please make such requests no later than one business day prior to the start of the meeting. You are not required to attend the hearing, but please see the information below if you would like to provide testimony. Once the Licenses Committee makes its recommendation, this recommendation is forwarded to the full Common Council for approval at its next regularly scheduled hearing.

---

## **Important details for those wishing to provide information for the Licenses Committee to consider when making its recommendation:**

1. The license application is scheduled to be heard at the above time. Due to other hearings running longer than scheduled, you may have to wait some time to provide your testimony.
2. You must appear in person and testify as to matters that you have personally experienced or seen. (You cannot provide testimony for your neighbor, parent or anyone else; this is considered hearsay and cannot be considered by the committee.)
3. No letters or petitions can be accepted by the committee (unless the person who wrote the letter or the persons who signed the petition are present at the committee hearing and willing to testify).
4. Persons opposed to the license application are given the opportunity to testify first; supporters may testify after the opponents have finished.
5. When you are called to testify, you will be sworn in and asked to give your name, and address. (If your first and/or last names are uncommon please spell them.)
6. You may then provide testimony.
  - a. Include only information relating to the above license application.
  - b. Include only information you have personally witnessed or seen.
  - c. Provide concise and relevant information detailing how this business has affected or may affect the peaceful enjoyment of your neighborhood.
  - d. If by the time you have the opportunity to testify, the information you wish to share has already been provided to the committee, you may state that you agree with the previous testimony. Redundant or repetitive testimony will not assist the committee in making its recommendation.
7. After giving your testimony, the members of the Licenses Committee and the licensee may ask questions regarding the testimony you have given or other factors relating to the license application.
8. Business Competition is not a valid basis for denial or non-renewal of a license.  
**Please Note: If you have submitted an objection to the above application your objection cannot be considered by the committee unless you personally testify at the hearing.**

OCCUPANT	MAIL ADDRESS	CITY STATE ZIP
CURRENT OCCUPANT	2232 N 41ST ST	MILWAUKEE, WI 53208-1303
CURRENT OCCUPANT	2235 N 41ST ST	MILWAUKEE, WI 53208-1304
CURRENT OCCUPANT	2236 N 41ST ST	MILWAUKEE, WI 53208-1303
CURRENT OCCUPANT	2237 N 40TH ST	MILWAUKEE, WI 53208-1341
CURRENT OCCUPANT	2238 N 41ST ST	MILWAUKEE, WI 53208-1303
CURRENT OCCUPANT	2239 N 40TH ST	MILWAUKEE, WI 53208-1341
CURRENT OCCUPANT	2239 N 41ST ST	MILWAUKEE, WI 53208-1304
CURRENT OCCUPANT	2245 N 41ST ST	MILWAUKEE, WI 53208-1304
CURRENT OCCUPANT	2248 N 41ST ST	MILWAUKEE, WI 53208-1303
CURRENT OCCUPANT	2250 N 41ST ST	MILWAUKEE, WI 53208-1303
CURRENT OCCUPANT	2251 N 41ST ST	MILWAUKEE, WI 53208-1304
CURRENT OCCUPANT	2252 N 41ST ST	MILWAUKEE, WI 53208-1303
CURRENT OCCUPANT	2253 N 41ST ST	MILWAUKEE, WI 53208-1304
CURRENT OCCUPANT	2254 N 42ND ST	MILWAUKEE, WI 53208-1308
CURRENT OCCUPANT	2256 N 42ND ST	MILWAUKEE, WI 53208-1308
CURRENT OCCUPANT	2304 N GRANT BLVD	MILWAUKEE, WI 53210-2938
CURRENT OCCUPANT	2307 N 41ST ST	MILWAUKEE, WI 53210-2931
CURRENT OCCUPANT	2309 N 41ST ST	MILWAUKEE, WI 53210-2931
CURRENT OCCUPANT	2310 N GRANT BLVD	MILWAUKEE, WI 53210-2938
CURRENT OCCUPANT	2312 N 41ST ST	MILWAUKEE, WI 53210-2930
CURRENT OCCUPANT	2313 N 40TH ST	MILWAUKEE, WI 53210-3014
CURRENT OCCUPANT	2313 N 41ST ST	MILWAUKEE, WI 53210-2931
CURRENT OCCUPANT	2314 N 41ST ST	MILWAUKEE, WI 53210-2930
CURRENT OCCUPANT	2315 N 40TH ST	MILWAUKEE, WI 53210-3014
CURRENT OCCUPANT	2315 N 41ST ST	MILWAUKEE, WI 53210-2931
CURRENT OCCUPANT	2316 N GRANT BLVD	MILWAUKEE, WI 53210-2938
CURRENT OCCUPANT	2318 N 41ST ST	MILWAUKEE, WI 53210-2930
CURRENT OCCUPANT	2319 N 40TH ST	MILWAUKEE, WI 53210-3014
CURRENT OCCUPANT	2319 N 41ST ST	MILWAUKEE, WI 53210-2931
CURRENT OCCUPANT	2320 N 41ST ST	MILWAUKEE, WI 53210-2930
CURRENT OCCUPANT	2321 N 40TH ST	MILWAUKEE, WI 53210-3014
CURRENT OCCUPANT	2321 N 41ST ST	MILWAUKEE, WI 53210-2931
CURRENT OCCUPANT	2326 N 41ST ST	MILWAUKEE, WI 53210-2930
CURRENT OCCUPANT	2326 N GRANT BLVD	MILWAUKEE, WI 53210-2938
CURRENT OCCUPANT	2327 N GRANT BLVD	MILWAUKEE, WI 53210-2939
CURRENT OCCUPANT	2328 N GRANT BLVD	MILWAUKEE, WI 53210-2938
CURRENT OCCUPANT	2329 N 41ST ST	MILWAUKEE, WI 53210-2931
CURRENT OCCUPANT	2329 N GRANT BLVD	MILWAUKEE, WI 53210-2939
CURRENT OCCUPANT	2330 N 40TH ST	MILWAUKEE, WI 53210-3066
CURRENT OCCUPANT	2331 N 41ST ST	MILWAUKEE, WI 53210-2931
CURRENT OCCUPANT	2332 N 40TH ST	MILWAUKEE, WI 53210-3066
CURRENT OCCUPANT	2333 N 41ST ST	MILWAUKEE, WI 53210-2931
CURRENT OCCUPANT	2334 N GRANT BLVD	MILWAUKEE, WI 53210-2938
CURRENT OCCUPANT	2335 N 41ST ST	MILWAUKEE, WI 53210-2931
CURRENT OCCUPANT	2335 N GRANT BLVD	MILWAUKEE, WI 53210-2939
CURRENT OCCUPANT	2336 N 40TH ST	MILWAUKEE, WI 53210-3066

CURRENT OCCUPANT	2336 N GRANT BLVD	MILWAUKEE, WI 53210-2938
CURRENT OCCUPANT	2337 N 41ST ST	MILWAUKEE, WI 53210-2931
CURRENT OCCUPANT	2337 N GRANT BLVD	MILWAUKEE, WI 53210-2939
CURRENT OCCUPANT	2338 N 40TH ST	MILWAUKEE, WI 53210-3066
CURRENT OCCUPANT	2338 N GRANT BLVD	MILWAUKEE, WI 53210-2938
CURRENT OCCUPANT	2339 N 41ST ST	MILWAUKEE, WI 53210-2931
CURRENT OCCUPANT	2339 N GRANT BLVD	MILWAUKEE, WI 53210-2939
CURRENT OCCUPANT	2340 N GRANT BLVD	MILWAUKEE, WI 53210-2938
CURRENT OCCUPANT	2341 N 39TH ST	MILWAUKEE, WI 53210-3087
CURRENT OCCUPANT	2341 N GRANT BLVD	MILWAUKEE, WI 53210-2939
CURRENT OCCUPANT	2342 N 40TH ST	MILWAUKEE, WI 53210-3066
CURRENT OCCUPANT	2342 N GRANT BLVD	MILWAUKEE, WI 53210-2938
CURRENT OCCUPANT	2343 N 39TH ST	MILWAUKEE, WI 53210-3087
CURRENT OCCUPANT	2344 N 40TH ST	MILWAUKEE, WI 53210-3066
CURRENT OCCUPANT	2344 N GRANT BLVD	MILWAUKEE, WI 53210-2938
CURRENT OCCUPANT	2345 N 39TH ST	MILWAUKEE, WI 53210-3087
CURRENT OCCUPANT	2347 N 39TH ST	MILWAUKEE, WI 53210-3087
CURRENT OCCUPANT	2348 N 40TH ST	MILWAUKEE, WI 53210-3085
CURRENT OCCUPANT	2349 N 41ST ST	MILWAUKEE, WI 53210-2931
CURRENT OCCUPANT	2350 N 40TH ST	MILWAUKEE, WI 53210-3085
CURRENT OCCUPANT	2350 N GRANT BLVD	MILWAUKEE, WI 53210-2938
CURRENT OCCUPANT	2351 N 39TH ST	MILWAUKEE, WI 53210-3087
CURRENT OCCUPANT	2351 N GRANT BLVD	MILWAUKEE, WI 53210-2939
CURRENT OCCUPANT	2352 N GRANT BLVD	MILWAUKEE, WI 53210-2938
CURRENT OCCUPANT	2353 N 39TH ST	MILWAUKEE, WI 53210-3087
CURRENT OCCUPANT	2353 N GRANT BLVD	MILWAUKEE, WI 53210-2939
CURRENT OCCUPANT	2354 N 40TH ST	MILWAUKEE, WI 53210-3085
CURRENT OCCUPANT	2354 N 41ST ST	MILWAUKEE, WI 53210-2930
CURRENT OCCUPANT	2355 N 41ST ST	MILWAUKEE, WI 53210-2931
CURRENT OCCUPANT	2355 N GRANT BLVD	MILWAUKEE, WI 53210-2939
CURRENT OCCUPANT	2356 N 40TH ST	MILWAUKEE, WI 53210-3085
CURRENT OCCUPANT	2356 N 41ST ST	MILWAUKEE, WI 53210-2930
CURRENT OCCUPANT	2357 N 39TH ST	MILWAUKEE, WI 53210-3087
CURRENT OCCUPANT	2357 N 40TH ST	MILWAUKEE, WI 53210-3014
CURRENT OCCUPANT	2357 N 41ST ST	MILWAUKEE, WI 53210-2931
CURRENT OCCUPANT	2357 N GRANT BLVD	MILWAUKEE, WI 53210-2939
CURRENT OCCUPANT	2359 N 39TH ST	MILWAUKEE, WI 53210-3087
CURRENT OCCUPANT	2360 N 40TH ST	MILWAUKEE, WI 53210-3085
CURRENT OCCUPANT	2360 N GRANT BLVD	MILWAUKEE, WI 53210-2938
CURRENT OCCUPANT	2362 N 40TH ST	MILWAUKEE, WI 53210-3085
CURRENT OCCUPANT	2362 N 41ST ST	MILWAUKEE, WI 53210-2930
CURRENT OCCUPANT	2362 N GRANT BLVD	MILWAUKEE, WI 53210-2938
CURRENT OCCUPANT	2363 N 41ST ST	MILWAUKEE, WI 53210-2931
CURRENT OCCUPANT	2364 N 41ST ST	MILWAUKEE, WI 53210-2930
CURRENT OCCUPANT	2365 N 41ST ST	MILWAUKEE, WI 53210-2931
CURRENT OCCUPANT	2366 N 40TH ST	MILWAUKEE, WI 53210-3085
CURRENT OCCUPANT	2367 N 40TH ST	MILWAUKEE, WI 53210-3014

CURRENT OCCUPANT	2367 N GRANT BLVD	MILWAUKEE, WI 53210-2939
CURRENT OCCUPANT	2368 N 40TH ST	MILWAUKEE, WI 53210-3085
CURRENT OCCUPANT	2370 N GRANT BLVD	MILWAUKEE, WI 53210-2938
CURRENT OCCUPANT	3903 W MEINECKE AVE	MILWAUKEE, WI 53210-3090
CURRENT OCCUPANT	3905 W MEINECKE AVE	MILWAUKEE, WI 53210-3090
CURRENT OCCUPANT	3909 W MEINECKE AVE	MILWAUKEE, WI 53210-3090
CURRENT OCCUPANT	3911 W MEINECKE AVE	MILWAUKEE, WI 53210-3090
CURRENT OCCUPANT	3915 W MEINECKE AVE	MILWAUKEE, WI 53210-3090
CURRENT OCCUPANT	3917 W MEINECKE AVE	MILWAUKEE, WI 53210-3090
CURRENT OCCUPANT	3925 W MEINECKE AVE	MILWAUKEE, WI 53210-3089
CURRENT OCCUPANT	3927 W MEINECKE AVE	MILWAUKEE, WI 53210-3089
CURRENT OCCUPANT	3929 W MEINECKE AVE	MILWAUKEE, WI 53210-3089
CURRENT OCCUPANT	3931 W MEINECKE AVE	MILWAUKEE, WI 53210-3089
CURRENT OCCUPANT	3935 W MEINECKE AVE	MILWAUKEE, WI 53210-3089
CURRENT OCCUPANT	3937 W MEINECKE AVE	MILWAUKEE, WI 53210-3089
CURRENT OCCUPANT	4001 W NORTH AVE	MILWAUKEE, WI 53208-1318
CURRENT OCCUPANT	4007 W MEINECKE AVE	MILWAUKEE, WI 53210-3068
CURRENT OCCUPANT	4009 W MEINECKE AVE	MILWAUKEE, WI 53210-3068
CURRENT OCCUPANT	4025 W MEINECKE AVE	MILWAUKEE, WI 53210-3068
CURRENT OCCUPANT	4027 W MEINECKE AVE	MILWAUKEE, WI 53210-3068
CURRENT OCCUPANT	4107 W MEINECKE AVE	MILWAUKEE, WI 53210-2953
CURRENT OCCUPANT	4109 W MEINECKE AVE	MILWAUKEE, WI 53210-2953
CURRENT OCCUPANT	4117 W MEINECKE AVE	MILWAUKEE, WI 53210-2953
CURRENT OCCUPANT	4119 W NORTH AVE, 1	MILWAUKEE, WI 53208-1320
CURRENT OCCUPANT	4119 W NORTH AVE, 2	MILWAUKEE, WI 53208-1320
CURRENT OCCUPANT	4119 W NORTH AVE, 3	MILWAUKEE, WI 53208-1320
CURRENT OCCUPANT	4123 W MEINECKE AVE	MILWAUKEE, WI 53210-2953
CURRENT OCCUPANT	4124 W NORTH AVE	MILWAUKEE, WI 53208-1319
CURRENT OCCUPANT	4203 W MEINECKE AVE	MILWAUKEE, WI 53210-2929
CURRENT OCCUPANT	4205 W MEINECKE AVE	MILWAUKEE, WI 53210-2929
CURRENT OCCUPANT	4213 W MEINECKE AVE	MILWAUKEE, WI 53210-2929
CURRENT OCCUPANT	4215 W MEINECKE AVE	MILWAUKEE, WI 53210-2929
CURRENT OCCUPANT	4229 W MEINECKE AVE	MILWAUKEE, WI 53210-2929

Blank Notice

Total Records: 126

Radius 250 feet and Center of the Circle: 4020 W North Av



# BUSINESS LICENSE PLAN OF OPERATION

ccl-busplan 5/12/2020

Office of the City Clerk License Division  
200 E. Wells St. Room 105, Milwaukee, WI 53202  
(414) 286-2238 www.milwaukee.gov/license e-mail address: license@milwaukee.gov

## 1. Type of Business

Applying for:  Extended Hours (12AM to 5AM) - If a food establishment, check all that apply:  Delivery  Drive Thru  Dining Room  
 Self Service Laundry  Massage Establishment  Filling Station

Other (supplemental application for specific license also required) Grocery Store

Provide a detailed description of the type of business you plan on operating:

Grocery Store

Do you have any experience operating this type of business?  No  Yes If yes, explain:

## 2. Business Operations

a. Proposed Opening Date: 3/1/2018

b. Is this premise under construction?  No  Yes If yes, list estimated completion date: \_\_\_\_\_

c. Is this a franchise?  No  Yes

d. Is this premises currently licensed?  No  Yes If yes, list type of license: Occupancy License Tobacco

e. Is the current licensee operating?  No  Yes If no, list date closed: \_\_\_\_\_

f. Do you have future plans for other businesses, licenses or permits at this location?  No  Yes

If yes, explain: Food Dealer, Food Stamps, WIC

g. Have you previously held an Extended Hours License in Milwaukee?  No  Yes

If yes, list address(es): \_\_\_\_\_

h. Are other businesses operating in the same building?  No  Yes If yes, describe: \_\_\_\_\_

## 3. Litter & Noise

a. How are grounds kept clean?  Sweep  Pressure Wash  Pick Up Litter  Other: \_\_\_\_\_

b. How often will grounds be cleaned?  Daily  Weekly  As Needed  Monthly  Other: \_\_\_\_\_

c. Grounds cleaned by:  Licensee  Building Owner  Employees  Hired Maintenance  Other: \_\_\_\_\_

d. How are noise issues prevented and/or addressed?  Security  Manager approaches customer(s)  Call Police  
 Signs Posted  Other: \_\_\_\_\_

e. Will a sound amplification system be used?  No  Yes If yes, describe: \_\_\_\_\_

## 4. Smoking & Sanitation

a. Are there designated outdoor smoking areas?  No  Yes If yes, describe: \_\_\_\_\_

b. Number of Garbage Cans: Inside: 5 Locations: by cashier, office, Entrance (2), Restroom  
Outside: 2 Locations: by entrance, in parking lot

c. Is a crowd control barrier used?  No  Yes If yes, describe: \_\_\_\_\_

d. How many restrooms are on the premises? 2

e. Name of solid waste contractor:  Advanced Disposal  Waste Management  Other: \_\_\_\_\_

**5. Security**

- a. Are there onsite parking spaces?  No  Yes If yes, how many? 8 and describe the parking security plan: Camera Systems provided, in parking lot, Entrance & Exit well marked
- b. Is there a loading zone?  No  Yes If yes, describe the loading area security plan: \_\_\_\_\_
- c. Will you have security personnel on premise?  No  Yes If yes, how many? \_\_\_\_\_ and answer the following:  
 What are their responsibilities? \_\_\_\_\_  
 Is security equipment used?  No  Yes If yes, describe Camera system covering inside & outside all directions  
 List their licensing, certification, or training credentials N/A
- d. Will there be security cameras?  No  Yes If yes, how many? 32 and list locations: all directions inside and outside location and Parking Lot
- e. Will searches/identification checks be done upon entry?  No  Yes If yes, describe \_\_\_\_\_

**6. Percentage of Sales (must total 100%)**

Alcohol <u>0</u> %	Food <u>75</u> %	Secondhand Merchandise <u>0</u> %	Precious Metals & Gems <u>0</u> %
Entertainment <u>0</u> %	Cigarettes <u>25</u> %	Personal Services (such as tattoo, body piercing, salon, tailor, tanning, etc.) _____ %	Other <u>0</u> % Describe: _____
Pawnbroker Activity <u>0</u> %	Salvaged Materials (such as scrap metal) <u>0</u> %		

**7. Businesses/Licenses on the Premises (check all that apply):**

- Type 1**
- Full Service Restaurant     Cafe/Coffee Shop     Deli or Fast Food Restaurant     Private/Fraternal/Veterans Club
- Night Club     Tavern     Cocktail Lounge     Teen Club
- Banquet Hall     Sports Facility     Bowling Alley
- Hotel/Motel: Number of Floors: \_\_\_\_\_     Rooming House: Number of Floors: \_\_\_\_\_  
 Number of Rooms: \_\_\_\_\_    Number of Rooms: \_\_\_\_\_

- Type 2**
- Liquor Store     Corner Store     Supermarket     Convenience Store
- Gas Station     Amusement/Phonograph Distributor     Recycling, Salvage or Towing
- Used Car Dealer     Personal Service Establishment (such as tattoo business, hair salon, tailor, etc.)     Recording Studio

What other licenses/permits will you hold at this location? (check all that apply)

- Occupancy Permit     Cigarette & Tobacco     Gas Station     Extended Hours     Class "B" Tavern     Weights & Measures
- Secondhand Dealer     Precious Metal & Gem     Other: \_\_\_\_\_

**8. Legal Capacity (only if a Type 1 premises in #7 above)**

Capacity N/A (Call the Milwaukee Development Center at 414-286-8211 if you have questions.)

N/A

## 9. Premises Description

a. Identify all area(s) of the premises that will be used in operating this business (include areas used only for storage):

1<sup>st</sup> Floor  2<sup>nd</sup> Floor  Basement Storage  Patio  Beer Garden  Sidewalk Café  Deck  Rooftop

Other: Describe: \_\_\_\_\_

b. Describe Location:  Major Thoroughfare  Secondary Street  Other: \_\_\_\_\_

c. Nearest Major Cross Street: 40th North Ave

d. Describe Building:  Free Standing Building  Strip Mall  Other: \_\_\_\_\_

e. Describe Premises Structure:  Single Story  Multi-Story - # of Stories \_\_\_\_\_  Other: \_\_\_\_\_

f. Describe Surrounding Area:  Commercial  Residential  Industrial  Other: \_\_\_\_\_

g. Building Owner Name: JWH Investment Phone Number: (262) 305-4363

Building Owner Address: 4451 Honeywood Ct, Jackson, WI 53087

## 10. Hours of Operation & Customers

Will customers be entering the premises?  No  Yes

Day of the Week	Proposed Hours of Operation:		Estimated Number of Customers expected each day	Potential Age Range of Customers	Class B Tavern Applicant Only: Age Restriction (If none, write 'None')
	Open Time (include a.m. or p.m.)	Close Time (include a.m. or p.m.)			
Sunday	7:00am	12:00am	70	Adults	N/A
Monday	7 AM	12 AM	45	"	
Tuesday	7 AM	12 AM	50	"	
Wednesday	7 AM	12 AM	50	"	
Thursday	7 AM	12 AM	60	"	
Friday	7 AM	12 AM	70	"	
Saturday	7 AM	12 AM	80	"	

An Extended Hours Establishment License is required for any convenience store, filling station, personal service establishment (such as tattoo, body piercing, salon, tailor, tanning, etc.), recording studio or restaurant which is open between the hours of 12:00 a.m. and 5:00 a.m.

Alcohol Establishments Class A: 8:00 am to 9:00 pm Sunday thru Saturday  
 Permitted Hours of Operation: Class B: 6:00 am to 2:00 am Sunday thru Thursday, 6:00 am to 2:30 am Friday & Saturday

Entertainment Outdoor Closing Hours: 10:00pm Sunday-Thursday; 12:00am Friday & Saturday; unless a different time, either earlier or later, is established by the Common Council in its approval of the licensee's plan of operation.

## 11. Signature(s)

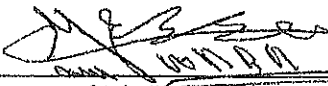
  
 Signature of Sole Proprietor, Partner, or 20% or more Shareholder  
 (If there are no 20% or more shareholders,  
 Corporate Officer-print name/title and sign)

\_\_\_\_\_  
 Signature of additional partner or 20% or more shareholder

See Application Information for a complete list of all required application forms.



# FOOD DEALER LICENSE PLAN OF OPERATION

OFFICE OF THE CITY CLERK, LICENSE DIVISION  
 CITY HALL, 200 E. WELLS ST, ROOM 105, MILWAUKEE, WI 53202  
 (414) 286-2238 • [license@milwaukee.gov](mailto:license@milwaukee.gov) • [www.milwaukee.gov/license](http://www.milwaukee.gov/license)

Legal Entity Name: Brother Plus Grocery LLC

Premises Address: 4020 W North Ave, Milwaukee, WI 53208

## SECTION 1 TYPE OF BUSINESS

What will be the majority of your food sales? (check one)

Restaurant Items (meals):  
 MEALS include, but are not limited to, chicken, ribs, sandwiches, roasted corn, baked potatoes, hot dogs, brats, tacos, nachos w/ cheese and meat, French fries, cooked or deep fried vegetables/fruit, cooked cheese curds, corn dogs, egg rolls, salads.

Retail Items (snacks and beverages):  
 RETAIL items include, but are not limited to, ice cream/soft serve, lemonade, snow cones, coffee, espresso, cappuccino, tea, fruit juice, smoothies, candy, dispensed soda, fruit cups, bakery, cookies, kettle corn, cotton candy, funnel cakes, fritters, tortilla chips w/ cheese.

Will it be a convenience store?  Yes  No

A convenience store contains less than 5,000 square feet of retail space and has, as its primary business, the sale of basic food items and in addition, sells household products or is a filling station that sells basic food items and household products.

- Bed & Breakfast
- Micro Market

All Applicants: Submit a menu or a list of food items that will be sold.

Will any wholesale business be done?  No  Yes If yes, what percentage of food sales will be wholesale?

Less than 25%

25% or More AND:

Restaurant Items (meals) will be sold – Complete this application and also contact DATCP.

NO restaurant items (meals) will be sold - Do NOT complete this application. Contact DATCP only.

## SECTION 2 FOOD PROCESSING

Will any food processing be done?  No  Yes

Processing is defined as assembling, grinding, cutting, mixing, baking, coating, stuffing, packing, bottling, grilling, canning, extracting, fermenting, distilling, pickling, freezing, drying, smoking, or packaging.

## SECTION 3 FOOD REQUIRING TEMPERATURE CONTROL

Will any food that requires temperature control be sold?  No  Yes  
 (Includes dairy products such as milk, cheese, and ice cream, fish, shellfish, meat, poultry)

If yes, list the types of food items: meat, cheese, Milk, fish



**SECTION 4 DETAILS OF OPERATION**

- Will you have seating on site for dining?  No  Yes
- Will you be doing any catering?  No  Yes
- Will you be doing any delivery?  No  Yes
- Will you have outdoor activities?  No  Yes - Check all that apply:  Bar  Cooking/Grilling  Dining
- Will you have a drive thru window?  No  Yes - Are hours different from inside?  No  Yes  
 If Yes, provide drive thru hours: \_\_\_\_\_
- Will scales or barcode scanners be used?  No  Yes - You must also apply for a Weights & Measures License.

**SECTION 5 ADDITIONAL SITES**

Where will food be prepared and/or sold?  
 At a single site  At multiple sites: How many? \_\_\_\_\_ (for example, a hotel with several dining rooms or bars)  
 If multiple sites, attach a Food Dealer Additional Site Addendum (ccl-foodadd) for each additional site.

**SECTION 6 CONSTRUCTION OR CHANGES**

Are you planning any construction, remodeling or equipment changes?  
 No If No, SKIP to Section 8  
 Yes If Yes, check all that apply:  New construction of a building  Renovation or remodeling  
 Construction changes to existing building  Equipment changes only

Provide a brief description of the changes: \_\_\_\_\_

Start date: \_\_\_\_\_

Name, Address & Phone Number of Architect: \_\_\_\_\_



Name, Address & Phone Number of Contractor: \_\_\_\_\_

**SECTION 7 ALCOHOL BEVERAGES**

Are you applying for an alcohol beverage license?  
 No If No, SKIP to Section 8  
 Yes If YES, if your food license is approved prior to the alcohol license, when do you want the food license issued?  
 Immediately  At the same time as the alcohol license

**SECTION 8 ACKNOWLEDGEMENTS & SIGNATURE**

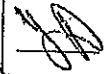
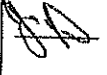
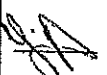
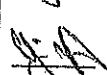
You must initial each item confirming your understanding:

-  I understand the Health Department must conduct an inspection and advise the License Division of their approval before the license may be issued.
-  I understand I must obtain an occupancy permit from the Department of Neighborhood Services and an inspection may be required. Neighborhood Services must advise the License Division of their approval before the license may be issued.
-  I understand the district alderperson will review and either support or object to my application. If he/she objects, I may appeal and be scheduled to appear before the Licenses Committee. The Licenses Committee will then make a recommendation to the Common Council. The Common Council must grant the license before it may be issued.
-  I understand proof of payment for all license fees must be on file in the License Division before the license may be issued and the license must be issued and posted in my establishment prior to opening for business.
-  I will not operate my food business until the license has been issued and posted in the establishment.

Signature of Sole Proprietor, Partner, or 20% Shareholder: 

Signature of Additional Partner: \_\_\_\_\_

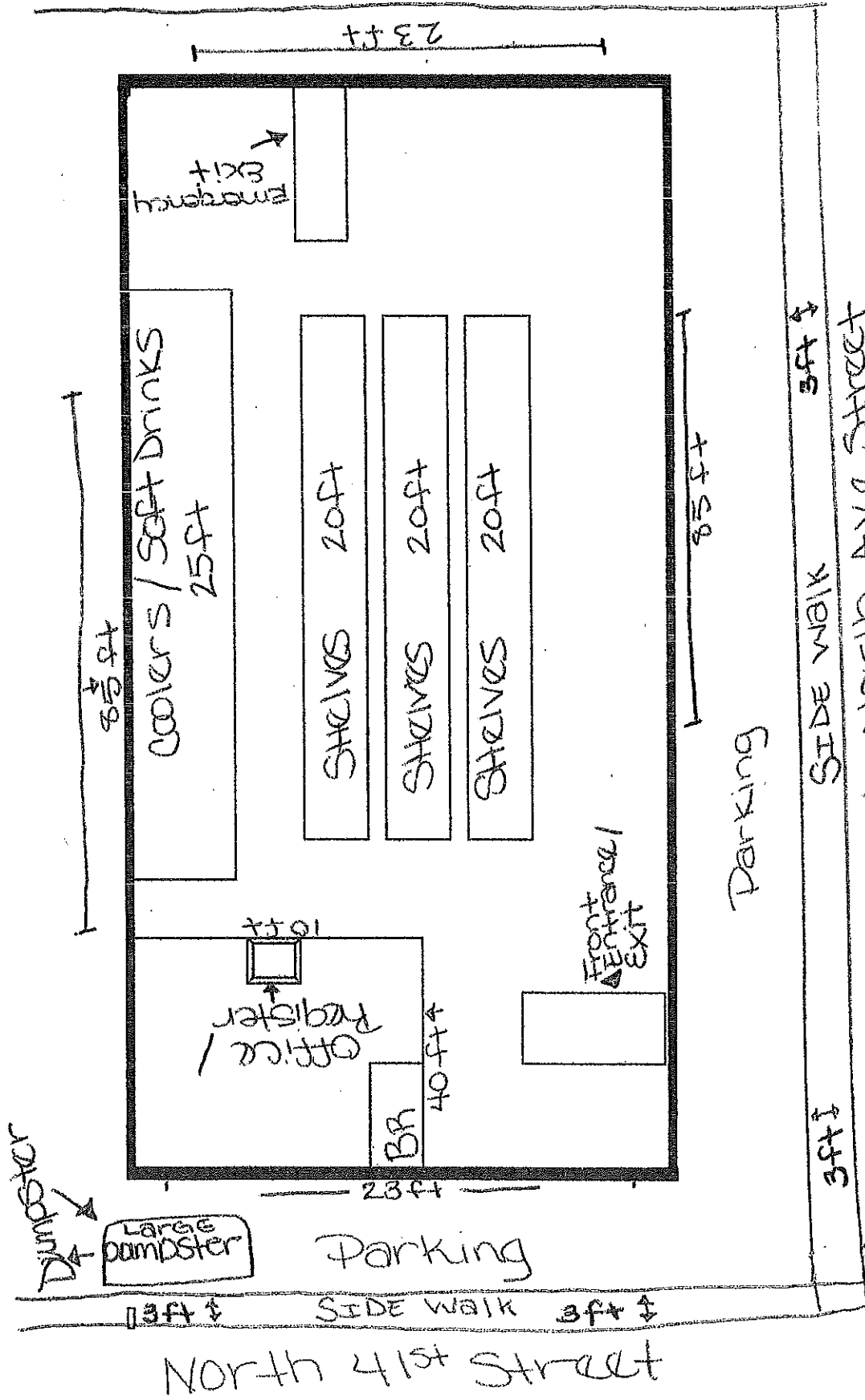

Total  
 Square  
 Footage = 1955 sqft

Brother Plus Grocery Inc  
 1020 W North Ave  
 Milwaukee, WI 53208  
 (414) 202-8989

Brother Plus Grocery LLC  
4020 W North Ave  
Milwaukee, WI 53208  
PH: (414) 202-8989

## **Brother Plus Grocery LLC**

### **Menu or List of Food Items that will be Sold**

#### **1. Bakery and Bread**

- Whole wheat bread, pita pockets, and English muffins
- Whole-grain flour tortillas

#### **2. Meat**

- Reduced-sodium lunchmeat (turkey, roast beef)
- Beef/Turkey bacon

#### **4. Oils, Sauces, Salad Dressings, and Condiments**

- Tomato sauce
- Mustard
- Barbecue sauce
- Salsa
- Extra virgin olive oil, canola oil, nonfat cooking spray
- Jarred capers and olives
- Hot pepper sauce
- Ketchup

Brother Plus Grocery LLC  
4020 W North Ave  
Milwaukee, WI 53208  
PH: (414) 202-8989

### **5. Cereals and Breakfast Foods**

- Whole-grain or multigrain cereals
- Steel-cut or instant oatmeal
- Whole-grain cereal bars

### **6. Soups and Canned Goods**

- Diced or whole peeled tomatoes
- Tuna or salmon packed in water
- Low-sodium soups and broths

### **7. Frozen Foods**

- Frozen vegetables: broccoli, spinach, peas, and carrots (no sauce)
- Frozen fruit: strawberries, raspberries, blueberries (without added sugar)
- Frozen shrimp
- Pre-portioned, low-fat ice cream or frozen yogurt
- Pizza
- Prepackaged dinner entre

### **8. Dairy, Cheese, and Eggs**

- Milk
- yogurt
- cottage cheese
- cheese or string cheese snacks
- Eggs or egg substitutes

### **9. Snacks and Crackers**

On Your List:

- crackers
- Dried fruit: apricots, figs, prunes, raisins, cranberries
- Nuts: almonds, cashews, walnuts, peanuts, pecans, pistachios
- Seeds: sunflower seeds
- Peanut butter, almond, or soy butter

Brother Plus Grocery LLC  
4020 W North Ave  
Milwaukee, WI 53208  
PH: (414) 202-8989

## **10. Produce**

- Fruit: bananas, apples, oranges, mangoes, strawberries, blueberries
- Vegetables: sweet potatoes, baby spinach, broccoli, carrot sticks

## **11. Drinks**

- Green and flavored teas
- orange juice
- Sparkling water
- Water
- Soda POP
- Ice Coffee
- Gatorade