



CITY OF MILWAUKEE
OFFICE OF THE CITY CLERK

Wednesday, October 27, 2021

COMMITTEE MEETING NOTICE

AD 14

MAHMOUD, Fahim N
4380 S 83rd St
MILWAUKEE, WI 53220

You are requested to attend a virtual hearing to be held on:

Tuesday, November 09, 2021 at 11:10 AM

Regarding: Your Class A Malt & Class A Liquor License Application for "FRANKS FOOD" at 2500 S 9TH St.

This meeting will be held via GoToMeeting. Please see the enclosed best practices document for further instructions. The access code is <https://global.gotomeeting.com/join/333235981>. If you wish to call in, please call [+1 \(872\) 240-3311](tel:+18722403311) and use Access Code: [333-235-981](tel:333235981)

There is a possibility that your application may be denied for one or more of the following reasons: The recommendation of the committee regarding the application shall be based on evidence presented at the hearing. Per MCO 85-2.7-4, probative evidence concerning whether or not a new license should be granted may be presented on the following subjects: whether or not the applicant meets the municipal requirements, the appropriateness of the location and premises where the licensed premises is to be located and whether use of the premises for the purposes or activities permitted by the license would tend to facilitate a public or private nuisance or create undesirable neighborhood problems such as disorderly patrons, unreasonably loud noise, litter, and excessive traffic and parking congestion. Probative evidence relating to these matters may be taken from the plan of operation submitted with the license application, if any, but shall not include the content of any music. Evidence regarding the fitness of the location of the premises to be maintained as the principal place of business, including but not limited to whether there is an overconcentration of businesses of the type for which the license is sought; whether the proposal is consistent with any pertinent neighborhood business or development plans, or the location's proximity to areas where children are typically present. The applicant's record in operating similarly licensed premises; and whether or not the applicant has been charged with or convicted of any felony, misdemeanor, municipal offense or other offense, the circumstances of which substantially relate to the activity to be permitted by the license being applied for or any other factor which reasonably relates to the public health, safety or welfare may also be considered. See attached police report or correspondence.

Notice for applicants with warrants or unpaid fines:

Proof of warrant satisfaction or payment of fines must be submitted at the hearing on the above date and time. Failure to comply with this requirement may result in a delay of the granting/denial of your application.

Failure to attend this meeting may result in the denial of your license. Individual applicants and partnership applicants must attend or attend by an attorney. The agent or attorney for corporate or limited liability applicants must attend. If you wish to do so and at your own expense, you may be accompanied by an attorney of your choosing to represent you at this hearing.

You will be given an opportunity to speak on behalf of the application and to respond and challenge any charges or reasons given for the denial. No petitions can be accepted by the committee, unless the people who signed the petition attend the virtual hearing and are willing to testify. You may present witnesses under oath and you may also confront and cross-examine opposing witnesses under oath. If you have difficulty with the English language, you should request an interpreter attend the meeting with you, at your expense, so that you can answer questions and participate in your hearing.

PLEASE NOTE: Upon reasonable notice, efforts will be made to accommodate the needs of disabled individuals through sign language interpreters or other auxiliary aids. For additional information or to request this service, contact the Council Services Division ADA Coordinator at (414) 286-2998, Fax - (414) 286-3456, TDD - (414) 286-2025.

JIM OWCZARSKI, CITY CLERK

BY: _____

Jim Cooney
License Division Manager

If you have questions regarding this meeting, please contact the staff assistant, Yadira Melendez at (414) 286-2775 or stas5@milwaukee.gov

Date:09/22/21
Officer: PO Kevin Vodicka

City of Milwaukee Police Department
90-5-1.5 Crime Prevention Survey
Convenience Store/Liquor Store Inspection

Name of Premise: Frank's Foods
Address: 2500 S 9th St
Phone: 414-384-8063

Owner: Fahim N MAHMOUD
Owner address: 4380 S 83rd St
City State Zip: Greenfield, WI 53220
Owner Phone: 414-334-0554
Owner email: FM.APARI54@gmail.com

Manager: same
Home Address:
City State Zip:
Phone:
Email:

Preferred contact: same

Location currently open: YES NO

Projected open date:

Day's open: S M T W Th F SA ALL

Hours of Operation: Sun: 9a-9p 24 hours Y N
Mon: 9a-9p
Tue: 9a-9p
Wed: 9a-9p
Thu: 9a-9p
Fri: 9a-9p
Sat: 9a-9p

Premise Type: Liquor Store
Convenience Store
Other: Beer

Licenses currently held:

- Alcohol: Yes No Class: #:
Tobacco: Yes No #:
Food: Yes No #:
Extended Hours: Yes No #:
Secondhand Dealer: Yes No Type: #:
Other: Yes No Type: #:
Other: Yes No Type: #:

Exterior Survey:

1. Is the area around the location clean? Yes No
2. What surrounds the location? (Check all the apply)
 - a. Park
 - b. School
 - c. Youth Center
 - d. Church
 - e. Tavern(s) If so, how many
 - f. Residential
 - g. Other businesses
 - h. Other:
3. Can you see from the outside of the location into the interior Yes No
4. Can you see the employees inside of the location from the outside Yes No
5. Are exterior windows free of signage Yes No
6. Is there a parking lot Yes No
7. Is the parking lot clean? Yes No
8. Is the parking lot well lit? Yes No
9. Are there areas where a person could conceal themselves Yes No
10. Is there exterior lighting? Yes No. Does it appears to be adequate Yes No
11. Exterior Payphone? Yes No
12. Are there No Loitering Signs posted? Yes No
13. Are there exterior security cameras Yes No How Many: 6
14. Are the address numbers prominently displayed and easy to see Yes No

Camera Survey:

15. Does this location have security cameras? Yes No
16. Are they in working order? Yes No
17. What format are the cameras?
 - a. Color Yes No
 - b. Digital Yes No
 - c. VCR Yes No
 - d. Recorded Yes No
18. How long is footage stored for later viewing: 7 days inside /30 days outside
19. Are there exterior cameras Yes No How many: 6
20. Are there interior cameras Yes No How many: 8
21. Do all employees know how to retrieve recorded digital images/footage? Yes No

Interior Survey:

22. Is the storeowner willing to be a standing complainant regarding loitering? Yes No
a. If yes have them fill out the standing complaint form and give them two of the commercial signs Yes No
23. Is the interior of the location neat and clean? Yes No
24. Does an interior camera face the entrance/exit? Yes No
25. Is there a lockable area that separates employees from customers? Yes No
26. Does the store sell single chore boy? Yes No
27. Does the store sell blunt wraps? Yes No
28. Does the store sell scales? Yes No
29. Does the store sell items that may be used as crack pipes? Yes No
a. Describe item Tire gauges
30. Does the store have an over abundance of sandwich baggies: Yes No
31. Does the owner understand that these items are often used for drug use? Yes No
32. Do the products in the store appear to be new and rotated often? Yes No
33. Are emergency and non-emergency numbers posted near the phone? Yes No
34. Does the owner know how to contact their police district directly? Yes No
a. Did you provide a district contact guide to the owner? Yes No

Complete this section if alcohol establishment is a convenience store:

(* Read full ordinance for all details "68-4.3 Convenience Food Stores")

All convenience food stores not exempted under sub. 3 shall:

1. Is the cash register located in a manner so that at the time of a sales transaction, the employee and customer are both visible from the sidewalk? Yes No **
2. Are the glass entrance and exit doors clear of any signs or advertisements with the exception of a sign which states that the cash register contains \$50 or less and that the safe is no accessible to employees? Yes No
3. Does the store maintain one of the following on the licensed premise:
 - a. A safe that was in use at the convenience food store on August 17, 1994? Yes No
 - b. A drop-safe or time release safe that weighs at least 500 pounds or which is attached to or set into the floor in a manner approved by the police department? Yes No
4. Is lighting provided for the store's parking area during all hours of darkness when employees or customers are on the premises at a minimum average of 2-foot candles per square foot, unless the store is not open for business after sunset and before sunrise? Yes No N/A
5. Are at least two high-resolution surveillance security cameras installed? Yes No
6. Are the security cameras in working order? Yes No
7. Does one camera show an overall view of the counter and register area? Yes No
8. Does one camera show a clear, identifiable, full frame image of the face of each person entering and leaving the store? Yes No
9. Are the camera views obstructed by fixtures or displays? Yes No
10. Is the recorded footage stored for at least 30 days? Yes No
11. Do all store employees know how to record footage from the camera system to media capable of being transferred to police custody? Yes No

12. Are customer entrances/exits made of glass or other transparent material? Yes No
a. Exception: A store that does not have such doors on August 17, 1994 shall not be required to install such doors until the holder of the store's food dealer license changes.
13. Has the owner and their employees attended the Robbery Prevention Training within 120 days of ownership or employment? Yes No
a. Contact Community Outreach and Education at 935-7836 for schedule.

Sub 3. Exemptions. The requirements of this section do not apply to a convenience food store that conforms to either of the following descriptions:

- a-1. The store is located in an enclosed shopping structure, enclosed commercial building or hospital. A convenience food store is not in an enclosed structure or building if a customer can enter it directly from the outside.
Does store conform to a-1 Yes No
- a-2. The store physically separates employees from customers with a solid partition that bars a person from entering the employee area from the customer area, has a secure lock on the employee side of any door between the employee area and the customer, and conducts all transaction through a service window or similar arrangement.
Does store conform to a-2 Yes No
- a. At the commissioner's discretion, a convenience store may be exempted from any or all of the regulations specified in sub 2.
Does this location hold an exemption from the commissioner regarding any of the requirements of Sub 2? Yes No

ADDITIONAL COMMENTS/RECOMMENDATIONS:

Beer Capital and Beechwood are current distributors



Concentration Map 2500 S 9TH ST

Area of Interest (AOI) Information

Area : 21,862,585.55 ft²

Sep 7 2021 11:30:16 Central Daylight Time

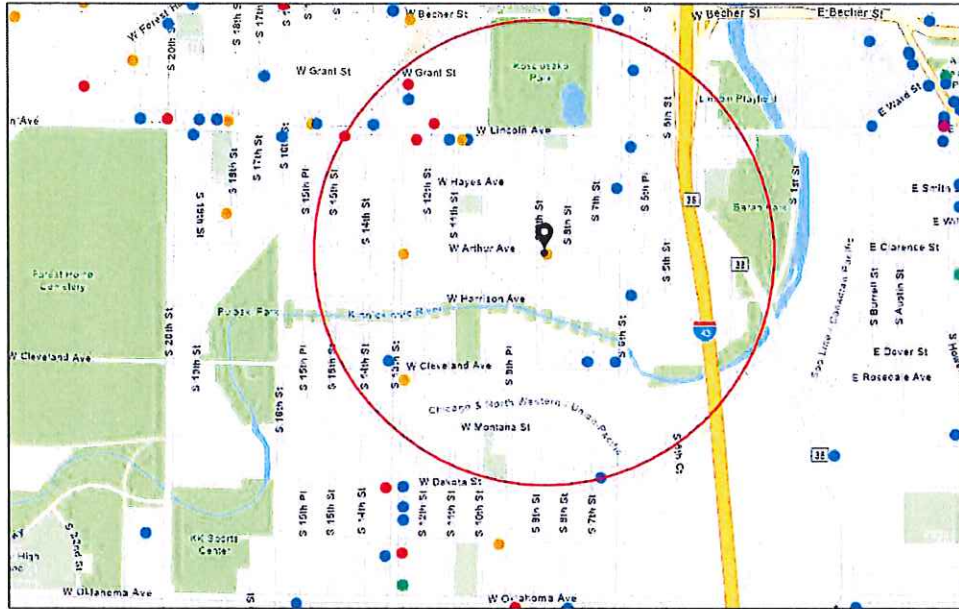

- | | | |
|-----------------------------------|-----------------------------------|-------------------------|
| ● Class A Intoxicating Liquor | ● Class A Liquor and Malt | ● Class C Wine Retailer |
| ● Class A Fermented Malt Beverage | ● Class B Fermented Malt Beverage | ▭ City Limits |
| ● Class B Tavern | | |

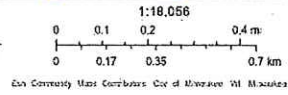

2500 S 9TH ST

Summary

| Name | Count | Area(ft ²) | Length(mi) |
|------------------|-------|------------------------|------------|
| Alcohol Licenses | 20 | | |

Alcohol Licenses

| # | Legal Entity | Trade Name | Licensee | Address | License Type Name | Total Capacity | Expiration Date | Count |
|----|------------------------------|-------------------------|--------------------------------|---------------------|--|----------------|---------------------|-------|
| 1 | FRANKS FOOD | FRANKS FOOD | FAHIM N MAHMOUD, SP | 2500 S 9TH ST | Class A Fermented Malt Beverage Retailer's License | | 9/20/2021, 7:00 PM | 1 |
| 2 | A & J POLISH DELI, INC | A & J POLISH DELI | JADWIGA T ROZAK, Agt | 1215 W LINCOLN AV | Class A Malt & Class A Liquor License | | 10/9/2021, 7:00 PM | 1 |
| 3 | BROWNS PLACE, LLC | BROWNS PLACE | JO ANN BROWN, Agt | 2874 S 7TH ST | Class B Tavern License | 25 | 10/8/2021, 7:00 PM | 1 |
| 4 | Singh's Corner Grocery Inc | South Star Food | BALJINDER SINGH, Agt | 2714 S 13th ST | Class A Fermented Malt Beverage Retailer's License | | 10/31/2021, 7:00 PM | 1 |
| 5 | Huckski's LLC | Money Pit & Bar Grill | Lanette Huck, Agt | 2691 S 7th ST | Class B Tavern License | | 10/18/2021, 7:00 PM | 1 |
| 6 | La Pasadita Bar LLC | La Pasadita Bar | Luis Lopez-Gonzalez, Agt | 2691 S 6th ST | Class B Tavern License | 99 | 11/10/2021, 6:00 PM | 1 |
| 7 | MESA GARIBALDI, LLC | FIESTA GARIBALDI | VALDEMAR ESCOBAR, Agt | 821-23 W LINCOLN AV | Class B Tavern License | | 12/11/2021, 6:00 PM | 1 |
| 8 | La Salsita Restaurant LLC | La Salsita Restaurant | Nicolas Santa Cruz-Ruedas, Agt | 1105 W Lincoln AV | Class B Tavern License | | 1/17/2022, 6:00 PM | 1 |
| 9 | La Casa del Chivolin, LLC | La Casa del Chivolin | Luis Alvarez, Agt | 2423 S 6TH ST | Class B Tavern License | | 2/7/2022, 6:00 PM | 1 |
| 10 | 3 HERMANOS, INC | 3 Hermanos Club | RAMON OROZCO, Agt | 1332 W LINCOLN AV | Class B Tavern License | 163 | 2/19/2022, 6:00 PM | 1 |
| 11 | Mi Super Foods, & Liquor Inc | Mi Super Foods & Liquor | Gurinder S Nagra, Agt | 2200 S 13th ST | Class A Malt & Class A Liquor License | | 2/7/2022, 6:00 PM | 1 |
| 12 | REYNA'S BAR | REYNA'S BAR | MANUEL G RODRIGUEZ, SP | 2566 S 6TH ST | Class B Tavern License | 80 | 3/21/2022, 7:00 PM | 1 |
| 13 | Beer Town LLC | Beer Town | PARAMJIT KAUR, Agt | 1029 W Lincoln AV | Class A Fermented Malt Beverage Retailer's License | | 4/2/2022, 7:00 PM | 1 |
| 14 | El Sunami II, LLC | Sunami | Ociel Escobar Luvianos, Agt | 2222 S 13TH ST | Class B Tavern License | 49 | 4/19/2022, 7:00 PM | 1 |
| 15 | Channa Sales Inc | Arthur Mini Mart | Baljeet S Channa, Agt | 2500 S 13TH ST | Class A Fermented Malt Beverage Retailer's License | | 6/12/2022, 7:00 PM | 1 |
| 16 | EL LUCERO LIQUOR, INC | EL LUCERO LIQUOR | HANIN K ABDELRAHIM, Agt | 1132-A W LINCOLN AV | Class A Malt & Class A Liquor License | | 6/13/2022, 7:00 PM | 1 |
| 17 | KOTHALA, LLC | SOUTHSIDE BEER & LIQUOR | JASBIR S PANU, Agt | 1434 W WINDLAKE AV | Class A Malt & Class A Liquor License | | 6/13/2022, 7:00 PM | 1 |

| | | | | | | | | |
|----|--------------------------|------------------------|-------------------------|----------------|------------------------|----|--------------------|---|
| 18 | CEDAR INN | CEDAR INN | JOANNE M HUMSIK, SP | 2178 S 6TH ST | Class B Tavern License | 25 | 6/29/2022, 7:00 PM | 1 |
| 19 | EL SALVADOR RESTAURANT | EL SALVADOR RESTAURANT | DAVID A ARIAS, SP | 2316 S 6TH ST | Class B Tavern License | 50 | 7/4/2022, 7:00 PM | 1 |
| 20 | Taqueria La Sierrita LLC | Taqueria La Sierrita | Miguel Leon Santos, Agt | 2689 S 13th ST | Class B Tavern License | 64 | 7/22/2022, 7:00 PM | 1 |

Establishments within a 0.5 miles radius centered on area of interest.

| OCCUPANT | MAIL ADDRESS | CITY STATE ZIP |
|------------------|------------------|--------------------------|
| CURRENT OCCUPANT | 2466 S 9TH ST | MILWAUKEE, WI 53215-3210 |
| CURRENT OCCUPANT | 2466A S 9TH ST | MILWAUKEE, WI 53215-3210 |
| CURRENT OCCUPANT | 2466B S 9TH ST | MILWAUKEE, WI 53215-3210 |
| CURRENT OCCUPANT | 2467 S 8TH ST | MILWAUKEE, WI 53215-3230 |
| CURRENT OCCUPANT | 2467 S 9TH ST | MILWAUKEE, WI 53215-3209 |
| CURRENT OCCUPANT | 2467A S 9TH ST | MILWAUKEE, WI 53215-3209 |
| CURRENT OCCUPANT | 2470 S 9TH ST | MILWAUKEE, WI 53215-3210 |
| CURRENT OCCUPANT | 2470A S 9TH ST | MILWAUKEE, WI 53215-3210 |
| CURRENT OCCUPANT | 2470B S 9TH ST | MILWAUKEE, WI 53215-3210 |
| CURRENT OCCUPANT | 2471 S 8TH ST | MILWAUKEE, WI 53215-3230 |
| CURRENT OCCUPANT | 2471 S 9TH ST | MILWAUKEE, WI 53215-3209 |
| CURRENT OCCUPANT | 2471 S 9TH ST, A | MILWAUKEE, WI 53215-3209 |
| CURRENT OCCUPANT | 2471A S 8TH ST | MILWAUKEE, WI 53215-3230 |
| CURRENT OCCUPANT | 2474 S 9TH ST | MILWAUKEE, WI 53215-3210 |
| CURRENT OCCUPANT | 2474A S 9TH ST | MILWAUKEE, WI 53215-3210 |
| CURRENT OCCUPANT | 2475 S 8TH ST | MILWAUKEE, WI 53215-3230 |
| CURRENT OCCUPANT | 2475 S 9TH ST | MILWAUKEE, WI 53215-3209 |
| CURRENT OCCUPANT | 2477 S 8TH ST | MILWAUKEE, WI 53215-3230 |
| CURRENT OCCUPANT | 2477 S 9TH ST | MILWAUKEE, WI 53215-3209 |
| CURRENT OCCUPANT | 2478 S 9TH ST | MILWAUKEE, WI 53215-3210 |
| CURRENT OCCUPANT | 2478A S 9TH ST | MILWAUKEE, WI 53215-3210 |
| CURRENT OCCUPANT | 2480 S 8TH ST | MILWAUKEE, WI 53215-3231 |
| CURRENT OCCUPANT | 2480 S 9TH PL | MILWAUKEE, WI 53215-3214 |
| CURRENT OCCUPANT | 2480A S 8TH ST | MILWAUKEE, WI 53215-3231 |
| CURRENT OCCUPANT | 2482 S 9TH ST | MILWAUKEE, WI 53215-3210 |
| CURRENT OCCUPANT | 2482A S 9TH ST | MILWAUKEE, WI 53215-3210 |
| CURRENT OCCUPANT | 2483 S 8TH ST | MILWAUKEE, WI 53215-3230 |
| CURRENT OCCUPANT | 2483 S 9TH ST | MILWAUKEE, WI 53215-3209 |
| CURRENT OCCUPANT | 2483A S 8TH ST | MILWAUKEE, WI 53215-3230 |
| CURRENT OCCUPANT | 2484 S 8TH ST | MILWAUKEE, WI 53215-3231 |
| CURRENT OCCUPANT | 2484 S 9TH ST, 1 | MILWAUKEE, WI 53215-3257 |
| CURRENT OCCUPANT | 2484 S 9TH ST, 2 | MILWAUKEE, WI 53215-3257 |
| CURRENT OCCUPANT | 2484 S 9TH ST, 4 | MILWAUKEE, WI 53215-3257 |
| CURRENT OCCUPANT | 2484 S 9TH ST, 5 | MILWAUKEE, WI 53215-3257 |
| CURRENT OCCUPANT | 2484 S 9TH ST, 6 | MILWAUKEE, WI 53215-3257 |
| CURRENT OCCUPANT | 2484 S 9TH ST, 7 | MILWAUKEE, WI 53215-3257 |
| CURRENT OCCUPANT | 2484 S 9TH ST, 8 | MILWAUKEE, WI 53215-3257 |
| CURRENT OCCUPANT | 2485 S 8TH ST | MILWAUKEE, WI 53215-3230 |
| CURRENT OCCUPANT | 2485 S 9TH ST | MILWAUKEE, WI 53215-3209 |
| CURRENT OCCUPANT | 2485A S 9TH ST | MILWAUKEE, WI 53215-3209 |
| CURRENT OCCUPANT | 2486 S 9TH PL | MILWAUKEE, WI 53215-3214 |
| CURRENT OCCUPANT | 2486A S 9TH PL | MILWAUKEE, WI 53215-3214 |
| CURRENT OCCUPANT | 2487 S 8TH ST | MILWAUKEE, WI 53215-3230 |
| CURRENT OCCUPANT | 2488 S 8TH ST | MILWAUKEE, WI 53215-3231 |
| CURRENT OCCUPANT | 2489 S 9TH ST | MILWAUKEE, WI 53215-3209 |
| CURRENT OCCUPANT | 2490 S 9TH PL | MILWAUKEE, WI 53215-3214 |

| | | |
|------------------|------------------|--------------------------|
| CURRENT OCCUPANT | 2490A S 9TH PL | MILWAUKEE, WI 53215-3214 |
| CURRENT OCCUPANT | 2491 S 8TH ST | MILWAUKEE, WI 53215-3230 |
| CURRENT OCCUPANT | 2491 S 9TH ST | MILWAUKEE, WI 53215-3209 |
| CURRENT OCCUPANT | 2500 S 8TH ST | MILWAUKEE, WI 53215-3410 |
| CURRENT OCCUPANT | 2500A S 8TH ST | MILWAUKEE, WI 53215-3410 |
| CURRENT OCCUPANT | 2501 S 9TH ST | MILWAUKEE, WI 53215-3421 |
| CURRENT OCCUPANT | 2502 S 8TH ST | MILWAUKEE, WI 53215-3410 |
| CURRENT OCCUPANT | 2502A S 8TH ST | MILWAUKEE, WI 53215-3410 |
| CURRENT OCCUPANT | 2503 S 8TH ST | MILWAUKEE, WI 53215-3409 |
| CURRENT OCCUPANT | 2503 S 9TH ST | MILWAUKEE, WI 53215-3421 |
| CURRENT OCCUPANT | 2505 S 8TH ST | MILWAUKEE, WI 53215-3409 |
| CURRENT OCCUPANT | 2505 S 9TH ST | MILWAUKEE, WI 53215-3421 |
| CURRENT OCCUPANT | 2506 S 8TH ST | MILWAUKEE, WI 53215-3410 |
| CURRENT OCCUPANT | 2506A S 8TH ST | MILWAUKEE, WI 53215-3410 |
| CURRENT OCCUPANT | 2506A S 9TH PL | MILWAUKEE, WI 53215-3426 |
| CURRENT OCCUPANT | 2506B S 9TH PL | MILWAUKEE, WI 53215-3426 |
| CURRENT OCCUPANT | 2506C S 9TH PL | MILWAUKEE, WI 53215-3426 |
| CURRENT OCCUPANT | 2509 S 9TH ST | MILWAUKEE, WI 53215-3421 |
| CURRENT OCCUPANT | 2509A S 9TH ST | MILWAUKEE, WI 53215-3421 |
| CURRENT OCCUPANT | 2510 S 8TH ST | MILWAUKEE, WI 53215-3410 |
| CURRENT OCCUPANT | 2510 S 9TH ST | MILWAUKEE, WI 53215-3422 |
| CURRENT OCCUPANT | 2510A S 8TH ST | MILWAUKEE, WI 53215-3410 |
| CURRENT OCCUPANT | 2510A S 9TH ST | MILWAUKEE, WI 53215-3422 |
| CURRENT OCCUPANT | 2511 S 8TH ST | MILWAUKEE, WI 53215-3409 |
| CURRENT OCCUPANT | 2512 S 9TH PL | MILWAUKEE, WI 53215-3426 |
| CURRENT OCCUPANT | 2512 S 9TH ST | MILWAUKEE, WI 53215-3422 |
| CURRENT OCCUPANT | 2512A S 9TH ST | MILWAUKEE, WI 53215-3422 |
| CURRENT OCCUPANT | 2513 S 9TH ST | MILWAUKEE, WI 53215-3421 |
| CURRENT OCCUPANT | 2514 S 8TH ST | MILWAUKEE, WI 53215-3410 |
| CURRENT OCCUPANT | 2515 S 8TH ST | MILWAUKEE, WI 53215-3409 |
| CURRENT OCCUPANT | 2516 S 8TH ST | MILWAUKEE, WI 53215-3410 |
| CURRENT OCCUPANT | 2517 S 8TH ST | MILWAUKEE, WI 53215-3409 |
| CURRENT OCCUPANT | 2517 S 9TH ST | MILWAUKEE, WI 53215-3421 |
| CURRENT OCCUPANT | 2517A S 9TH ST | MILWAUKEE, WI 53215-3421 |
| CURRENT OCCUPANT | 2518 S 9TH PL | MILWAUKEE, WI 53215-3426 |
| CURRENT OCCUPANT | 2518 S 9TH ST | MILWAUKEE, WI 53215-3422 |
| CURRENT OCCUPANT | 2518A S 9TH PL | MILWAUKEE, WI 53215-3426 |
| CURRENT OCCUPANT | 2518A S 9TH ST | MILWAUKEE, WI 53215-3422 |
| CURRENT OCCUPANT | 2519 S 8TH ST | MILWAUKEE, WI 53215-3409 |
| CURRENT OCCUPANT | 2520 S 8TH ST | MILWAUKEE, WI 53215-3410 |
| CURRENT OCCUPANT | 2520A S 8TH ST | MILWAUKEE, WI 53215-3410 |
| CURRENT OCCUPANT | 2521 S 8TH ST, 1 | MILWAUKEE, WI 53215-3449 |
| CURRENT OCCUPANT | 2521 S 8TH ST, 2 | MILWAUKEE, WI 53215-3449 |
| CURRENT OCCUPANT | 2521 S 8TH ST, 3 | MILWAUKEE, WI 53215-3449 |
| CURRENT OCCUPANT | 2521 S 8TH ST, 4 | MILWAUKEE, WI 53215-3449 |
| CURRENT OCCUPANT | 2521 S 9TH ST | MILWAUKEE, WI 53215-3421 |
| CURRENT OCCUPANT | 2522 S 9TH PL | MILWAUKEE, WI 53215-3426 |

| | | |
|------------------|----------------------|--------------------------|
| CURRENT OCCUPANT | 2522A S 9TH PL | MILWAUKEE, WI 53215-3426 |
| CURRENT OCCUPANT | 2523 S 9TH ST | MILWAUKEE, WI 53215-3421 |
| CURRENT OCCUPANT | 2524 S 8TH ST | MILWAUKEE, WI 53215-3410 |
| CURRENT OCCUPANT | 2524 S 9TH PL | MILWAUKEE, WI 53215-3426 |
| CURRENT OCCUPANT | 2524A S 9TH PL | MILWAUKEE, WI 53215-3426 |
| CURRENT OCCUPANT | 2525 S 9TH ST | MILWAUKEE, WI 53215-3421 |
| CURRENT OCCUPANT | 2526 S 8TH ST | MILWAUKEE, WI 53215-3410 |
| CURRENT OCCUPANT | 2526 S 9TH ST | MILWAUKEE, WI 53215-3422 |
| CURRENT OCCUPANT | 2526A S 8TH ST | MILWAUKEE, WI 53215-3410 |
| CURRENT OCCUPANT | 2526A S 9TH ST | MILWAUKEE, WI 53215-3422 |
| CURRENT OCCUPANT | 2527 S 8TH ST | MILWAUKEE, WI 53215-3409 |
| CURRENT OCCUPANT | 2527A S 8TH ST | MILWAUKEE, WI 53215-3409 |
| CURRENT OCCUPANT | 2527B S 8TH ST | MILWAUKEE, WI 53215-3409 |
| CURRENT OCCUPANT | 2529 S 8TH ST | MILWAUKEE, WI 53215-3409 |
| CURRENT OCCUPANT | 2529 S 9TH ST | MILWAUKEE, WI 53215-3421 |
| CURRENT OCCUPANT | 2529A S 9TH ST | MILWAUKEE, WI 53215-3421 |
| CURRENT OCCUPANT | 2530 S 9TH ST | MILWAUKEE, WI 53215-3422 |
| CURRENT OCCUPANT | 2530A S 9TH ST | MILWAUKEE, WI 53215-3422 |
| CURRENT OCCUPANT | 2532 S 9TH ST | MILWAUKEE, WI 53215-3422 |
| CURRENT OCCUPANT | 2533 S 9TH ST | MILWAUKEE, WI 53215-3421 |
| CURRENT OCCUPANT | 2535 S 8TH ST | MILWAUKEE, WI 53215-3409 |
| CURRENT OCCUPANT | 2535A S 8TH ST | MILWAUKEE, WI 53215-3409 |
| CURRENT OCCUPANT | 2537 S 9TH ST | MILWAUKEE, WI 53215-3421 |
| CURRENT OCCUPANT | 2538 S 9TH ST | MILWAUKEE, WI 53215-3422 |
| CURRENT OCCUPANT | 2538A S 9TH ST | MILWAUKEE, WI 53215-3422 |
| CURRENT OCCUPANT | 2539 S 8TH ST | MILWAUKEE, WI 53215-3409 |
| CURRENT OCCUPANT | 2539A S 8TH ST | MILWAUKEE, WI 53215-3409 |
| CURRENT OCCUPANT | 2540 S 9TH ST | MILWAUKEE, WI 53215-3422 |
| CURRENT OCCUPANT | 2541 S 9TH ST | MILWAUKEE, WI 53215-3421 |
| CURRENT OCCUPANT | 2543 S 8TH ST | MILWAUKEE, WI 53215-3409 |
| CURRENT OCCUPANT | 2543A S 8TH ST | MILWAUKEE, WI 53215-3409 |
| CURRENT OCCUPANT | 822 W ARTHUR AVE, 10 | MILWAUKEE, WI 53215-3237 |
| CURRENT OCCUPANT | 822 W ARTHUR AVE, 11 | MILWAUKEE, WI 53215-3237 |
| CURRENT OCCUPANT | 822 W ARTHUR AVE, 9 | MILWAUKEE, WI 53215-3237 |
| CURRENT OCCUPANT | 824 W ARTHUR AVE | MILWAUKEE, WI 53215-3237 |
| CURRENT OCCUPANT | 826 W ARTHUR AVE | MILWAUKEE, WI 53215-3237 |
| CURRENT OCCUPANT | 829 W ARTHUR AVE | MILWAUKEE, WI 53215-3236 |
| CURRENT OCCUPANT | 830 W ARTHUR AVE | MILWAUKEE, WI 53215-3237 |
| CURRENT OCCUPANT | 903 W ARTHUR AVE | MILWAUKEE, WI 53215-3242 |
| CURRENT OCCUPANT | 927 W ARTHUR AVE | MILWAUKEE, WI 53215-3242 |

Blank Notice

Total Records: 133

Radius: 250.0 feet and Center of Circle: 2500 S 9th St



Wednesday, October 27, 2021



Notice of Public Hearing

Blank Notice

MAHMOUD, Fahim N
FRANKS FOOD at 2500 S 9TH St.
Class A Malt & Class A Liquor License Application

Tuesday, November 09, 2021 at 11:10 AM

To whom it may concern:

The above application has been made by the above named applicant(s). This requires approval from the Licenses Committee and the Common Council of the City of Milwaukee. The hearing before the Licenses Committee will take place virtually on 11/09/2021 at 11:10 AM. This is a public hearing. Those wishing to view the proceeding are able to do so via the City Channel – Channel 25 on Spectrum Cable – or on the Internet at <http://city.milwaukee.gov/citychannel>. Those wishing to provide oral testimony will be asked to do so by phone or internet and are asked to contact the staff assistant, Yadira Melendez at (414) 286-2775 or stasst5@milwaukee.gov for necessary information. Please make such requests no later than one business day prior to the start of the meeting. You are not required to attend the hearing, but please see the information below if you would like to provide testimony. Once the Licenses Committee makes its recommendation, this recommendation is forwarded to the full Common Council for approval at its next regularly scheduled hearing.

Important details for those wishing to provide information for the Licenses Committee to consider when making its recommendation:

1. The license application is scheduled to be heard at the above time. Due to other hearings running longer than scheduled, you may have to wait some time to provide your testimony.
2. You must testify as to matters that you have personally experienced or seen. (You cannot provide testimony for your neighbor, parent or anyone else; this is considered hearsay and cannot be considered by the committee.)
3. No letters or petitions can be accepted by the committee (unless the person who wrote the letter or the persons who signed the petition are willing to testify).
4. Persons opposed to the license application are given the opportunity to testify first; supporters may testify after the opponents have finished.
5. When you are called to testify, you will be sworn in and asked to give your name, and address. (If your first and/or last names are uncommon please spell them.)
6. You may then provide testimony.
 - a. Include only information relating to the above license application.
 - b. Include only information you have personally witnessed or seen.
 - c. Provide concise and relevant information detailing how this business has affected or may affect the peaceful enjoyment of your neighborhood.
 - d. If by the time you have the opportunity to testify, the information you wish to share has already been provided to the committee, you may state that you agree with the previous testimony. Redundant or repetitive testimony will not assist the committee in making its recommendation.
7. After giving your testimony, the members of the Licenses Committee and the licensee may ask questions regarding the testimony you have given or other factors relating to the license application.
8. Business Competition is not a valid basis for denial or non-renewal of a license.

Please Note: If you have submitted an objection to the above application your objection cannot be considered by the committee unless you personally testify at the hearing.



BUSINESS LICENSE PLAN OF OPERATION

ccl-busplan 5/12/2020

Office of the City Clerk License Division
200 E. Wells St. Room 105, Milwaukee, WI 53202
(414) 286-2238 www.milwaukee.gov/license e-mail address: license@milwaukee.gov

1. Type of Business

Applying for: Extended Hours (12AM to 5AM) - If a food establishment, check all that apply: Delivery Drive Thru Dining Room
 Self Service Laundry Massage Establishment Filling Station
 Other (supplemental application for specific license also required)

NONE Class A Liquor

Provide a detailed description of the type of business you plan on operating:

grocery store Selling Beer & Alcohol

Do you have any experience operating this type of business? No Yes If yes, explain:

worked in store before

2. Business Operations

- a. Proposed Opening Date: Now open
- b. Is this premise under construction? No Yes If yes, list estimated completion date: _____
- c. Is this a franchise? No Yes
- d. Is this premises currently licensed? No Yes If yes, list type of license: Food, Beer, WIC, Foodstamp
- e. Is the current licensee operating? No Yes If no, list date closed: _____
- f. Do you have future plans for other businesses, licenses or permits at this location? No Yes
If yes, explain: _____
- g. Have you previously held an Extended Hours License in Milwaukee? No Yes
If yes, list address(es): _____
- h. Are other businesses operating in the same building? No Yes If yes, describe: _____

3. Litter & Noise

- a. How are grounds kept clean? Sweep Pressure Wash Pick Up Litter Other: _____
- b. How often will grounds be cleaned? Daily Weekly As Needed Monthly Other: _____
- c. Grounds cleaned by: Licensee Building Owner Employees Hired Maintenance Other: _____
- d. How are noise issues prevented and/or addressed? Security Manager approaches customer(s) Call Police
 Signs Posted Other: _____
- e. Will a sound amplification system be used? No Yes If yes, describe: _____

4. Smoking & Sanitation

- a. Are there designated outdoor smoking areas? No Yes If yes, describe: _____
- b. Number of Garbage Cans: Inside: 1 Locations: by cashier
Outside: 1 Locations: dumpster outside
- c. Is a crowd control barrier used? No Yes If yes, describe: _____
- d. How many restrooms are on the premises? 1
- e. Name of solid waste contractor: Advanced Disposal Waste Management Other: _____

5. Security

- a. Are there onsite parking spaces? No Yes If yes, how many? _____ and describe the parking security plan: _____
- b. Is there a loading zone? No Yes If yes, describe the loading area security plan: _____
- c. Will you have security personnel on premise? No Yes If yes, how many? _____ and answer the following:
 What are their responsibilities? _____
 Is security equipment used? No Yes If yes, describe _____
 List their licensing, certification, or training credentials _____
- d. Will there be security cameras? No Yes If yes, how many? 86 and list locations: 8" inside Store By cash register, Coolers, shelves, Front, & outside by front door & side door overlooking St.
- e. Will searches/identification checks be done upon entry? No Yes If yes, describe _____

6. Percentage of Sales (must total 100%)

| | | | |
|--------------------------------|--|--|---|
| Alcohol <u>25</u> % | Food <u>55</u> % | Secondhand Merchandise <u>0</u> % | Precious Metals & Gems <u>0</u> % |
| Entertainment <u>0</u> % | Cigarettes <u>10</u> % | | |
| Pawnbroker Activity <u>0</u> % | Salvaged Materials <u>0</u> % (such as scrap metal) | Personal Services (such as tattoo, body piercing, salon, tailor, tanning, etc.) <u>0</u> % | Other <u>10</u> % Describe: <u>household goods</u> |

7. Businesses/Licenses on the Premises (check all that apply):

Type 1

- Full Service Restaurant NO Cafe/Coffee Shop NO Deli or Fast Food Restaurant NO Private/Fraternal/Veterans Club NO
- Night Club NO Tavern NO Cocktail Lounge NO Teen Club NO
- Banquet Hall NO Sports Facility NO Bowling Alley NO
- Hotel/Motel: Number of Floors: _____ Rooming House: Number of Floors: _____
NO Number of Rooms: _____ NO Number of Rooms: _____

Type 2

- Liquor Store Corner Store Supermarket Convenience Store
- Gas Station Amusement/Phonograph Distributor Recycling, Salvage or Towing
- Used Car Dealer Personal Service Establishment (such as tattoo business, hair salon, tailor, etc.) Recording Studio

What other licenses/permits will you hold at this location? (check all that apply)

- Occupancy Permit Cigarette & Tobacco Gas Station Extended Hours Class "B" Tavern Weights & Measures
- Secondhand Dealer Precious Metal & Gem Other: Food License

8. Legal Capacity (only if a Type 1 premises in #7 above)

Capacity _____ (Call the Milwaukee Development Center at 414-286-8211 if you have questions.)

9. Premises Description

a. Identify all area(s) of the premises that will be used in operating this business (include areas used only for storage):

1st Floor 2nd Floor Basement Storage Patio Beer Garden Sidewalk Café Deck Rooftop

Other: Describe: _____

b. Describe Location: Major Thoroughfare Secondary Street Other: _____

c. Nearest Major Cross Street: 9th Street + Arthur Ave

d. Describe Building: Free Standing Building Strip Mall Other: _____

e. Describe Premises Structure: Single Story Multi-Story - # of Stories 2 Other: _____

f. Describe Surrounding Area: Commercial Residential Industrial Other: _____

g. Building Owner Name: Fahim Mahmoud Phone Number: 414-334-0554

Building Owner Address: 2500 S. 9th St. Milwaukee 53215

10. Hours of Operation & Customers

Will customers be entering the premises? No Yes

| Day of the Week | Proposed Hours of Operation: | | Estimated Number of Customers expected each day | Potential Age Range of Customers | Class B Tavern Applicant Only: Age Restriction (If none, write 'None') |
|-----------------|----------------------------------|-----------------------------------|---|----------------------------------|--|
| | Open Time (include a.m. or p.m.) | Close Time (include a.m. or p.m.) | | | |
| Sunday | 9:00am | 9:00 pm | 100 | 10 to 70 | none |
| Monday | 9:00am | 9:00 pm | 100 | 10 to 70 | none |
| Tuesday | 9:00am | 9:00 pm | 100 | 10 to 70 | none |
| Wednesday | 9:00am | 9:00 pm | 100 | 10 to 70 | none |
| Thursday | 9:00am | 9:00 pm | 100 | 10 to 70 | none |
| Friday | 9:00am | 9:00 pm | 100 | 10 to 70 | none |
| Saturday | 9:00am | 9:00 pm | 100 | 10 to 70 | none |

An Extended Hours Establishment License is required for any convenience store, filling station, personal service establishment (such as tattoo, body piercing, salon, tailor, tanning, etc.), recording studio or restaurant which is open between the hours of 12:00 a.m. and 5:00 a.m.

Alcohol Establishments Class A: 8:00 am to 9:00 pm Sunday thru Saturday
 Permitted Hours of Operation: Class B: 6:00 am to 2:00 am Sunday thru Thursday, 6:00 am to 2:30 am Friday & Saturday

Entertainment Outdoor Closing Hours: 10:00pm Sunday-Thursday; 12:00am Friday & Saturday; unless a different time, either earlier or later, is established by the Common Council in its approval of the licensee's plan of operation.

11. Signature(s)

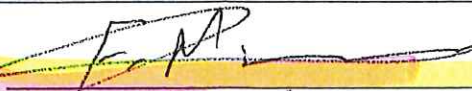
 Signature of Sole Proprietor, Partner, or 20% or more Shareholder
 (If there are no 20% or more shareholders,
 Corporate Officer-print name/title and sign)

 Signature of additional partner or 20% or more shareholder

See Application Information for a complete list of all required application forms.



ALCOHOL BEVERAGE & PUBLIC ENTERTAINMENT PREMISES SUPPLEMENTAL APPLICATION

Office of the City Clerk License Division
200 E. Wells St. Room 105, Milwaukee, WI 53202
(414) 286-2238 e-mail address: license@milwaukee.gov www.milwaukee.gov/license

Legal Entity Name: Fahim Mahmoud

Premise Address: 2500 S. 9th Street, Milwaukee 53215

Proximity of Premises to Church, School, Daycare Center or Hospital

If the building within 300 feet of any church, school, daycare center or hospital? No Yes

"Service Bar Only" Designation

If applying for Class B or C license, are you applying for "Service Bar Only"? No Yes

Service Bar Only means customers cannot sit at the bar. Alcohol is served to employees who serve patrons seated at tables. No stools, chairs or other articles of furniture shall be placed at the service bar for patrons to sit upon.

Business Information

a) Are you taking out this application for anyone that may not be eligible for a license? No Yes

If yes, list their name and address: _____

b) Will the agent, a partner or the individual licensee be conducting the day-to-day operations of the business? No Yes

If no, list the name and address of the person(s) who will: _____

Class B Applicants: If the agent, a partner or the individual licensee will not be conducting the day-to-day operations of the business, the person(s) listed above must obtain a Class B Managers license.

c) Does anyone else have money invested or any other interest in this business? No Yes

If yes, explain: _____

d) Have you made an agreement with anyone to repay any loan or any other payments based upon income from the business?

No Yes If yes, list name and address: _____

Property Information (New & Transfer Applicants Only)

a) Do you own or lease the building? Own Lease

b) Who owns the fixtures (for example, coolers, etc.)? present owner

c) Are you purchasing the stock and/or fixtures? No Yes If yes, amount paid \$ _____

d) Total amount paid for business \$ 30,000

e) Total amount paid for goodwill of the business \$ NO

Goodwill comprises the reputation and customer relationships of an existing business. If the price you pay for the business exceeds the fair market value of all of the rest of the assets of the business, the excess may be considered goodwill.

f) Have you made arrangements with the seller for payment of personal property taxes? No Yes

Lease Information (New & Transfer Applicants who are leasing the premises only)

a) Date lease begins _____ Ends _____

b) Monthly rental \$ _____

c) Do you have an option to renew the lease? No Yes

d) Does your lease allow for assignment to another party without the consent of the owner? No Yes

e) For what length of time have you been guaranteed occupancy (number of years)? _____

Lease Information (Continued)

- f) In addition to paying the monthly rental, will you have to pay anything additional to the owner of the building to guarantee performance of the lease? No Yes If yes, explain_____
- g) Does the present owner or occupancy object to the granting of your license? No Yes
If yes, explain_____

Change of Agent Applicants Only

Have there been any changes to the floor plan since the last application was submitted? No Yes
If no, a new floor plan is not required. If yes, submit a new floor plan and explain the change(s):

Signature



Signature of Sole Proprietor, Partner or 20% or More Shareholder
(If no 20% or more Shareholder, Corporate Officer - print name/title and sign)

Note: All information contained in this application is subject to approval by the Common Council.
Deviating from approved plan of operation will subject licensee to citations, and/or suspension or non-renewal of the license.
Contact the License Division for information on how to request changes.

New and transfer of premises applicants must submit the following:

- Detailed floor plan
- If a restaurant, copy of the menu

dumpster

BACK

Fahim N. Mahmood

Frank Foods

2500 S. 9th St, MIL, WI 53215

9-7-21

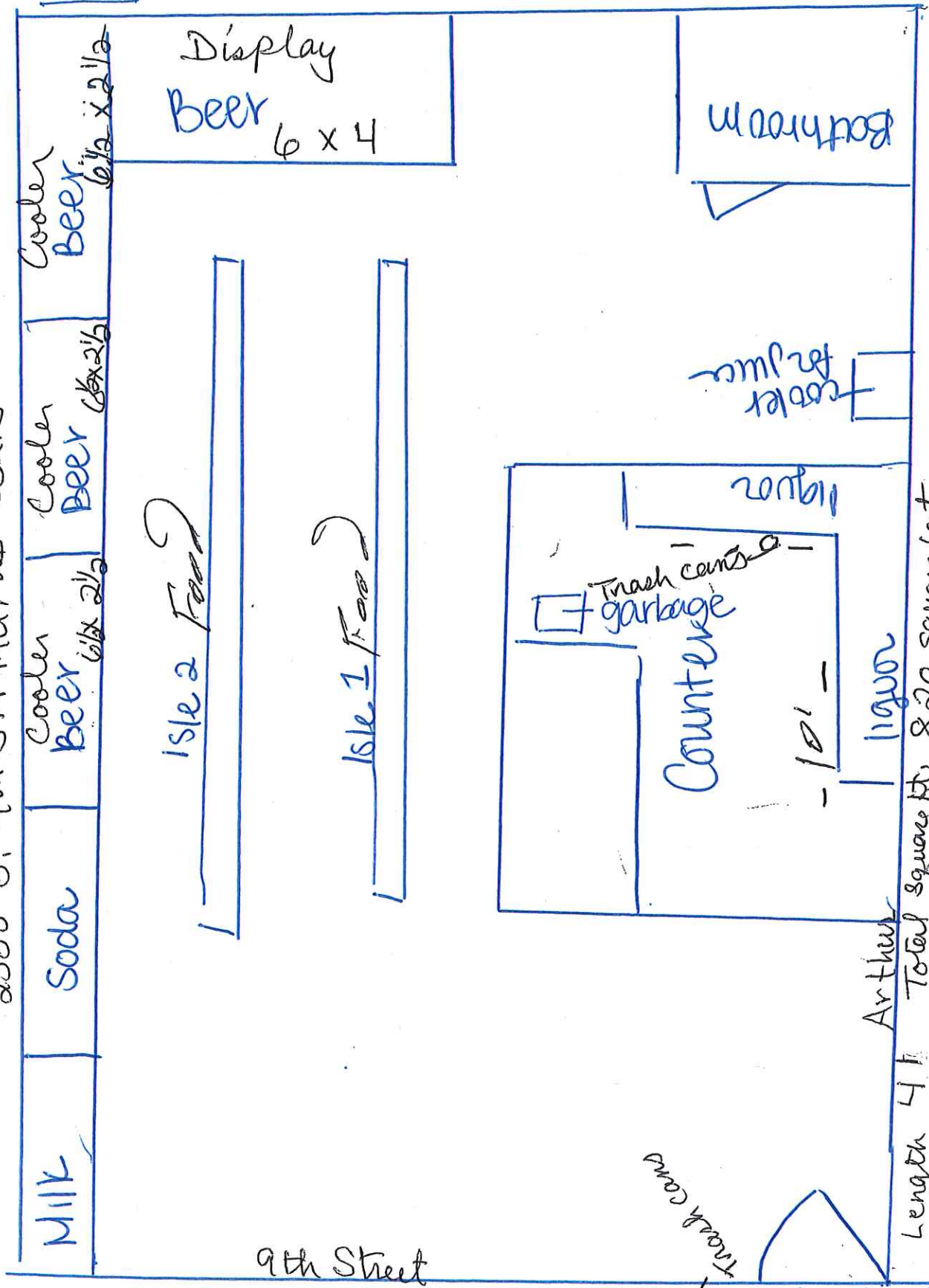

Length 41
width 20

Total square ft, 820 square feet

Arthur

FRONT

No parking (street parking)