



CITY OF MILWAUKEE
OFFICE OF THE CITY CLERK

Thursday, September 30, 2021

COMMITTEE MEETING NOTICE

AD 09

Pamela D Perrin
6514 W HUSTIS St
Milwaukee, WI 53223

You are requested to attend a virtual hearing to be held on:

Tuesday, October 19, 2021 at 09:30 AM

Regarding: Your Class B Tavern, Food Dealer, and Public Entertainment Premises License Applications Requesting Jukebox, 12 Bowling Lanes, 1 Pool Table, 5 Amusement Machines, and Patrons Dancing for "Coconut Bowl" at 4707 W MILL Rd. 

This meeting will be held via GoToMeeting. Please see the enclosed best practices document for further instructions. The access code is <https://global.gotomeeting.com/join/636199461>. If you wish to call in, please call +1 (872) 240-3212 and use Access Code: 636-199-461.

There is a possibility that your application may be denied for one or more of the following reasons: The recommendation of the committee regarding the application shall be based on evidence presented at the hearing. Per MCO 85-2.7-4, probative evidence concerning whether or not a new license should be granted may be presented on the following subjects: whether or not the applicant meets the municipal requirements, the appropriateness of the location and premises where the licensed premises is to be located and whether use of the premises for the purposes or activities permitted by the license would tend to facilitate a public or private nuisance or create undesirable neighborhood problems such as disorderly patrons, unreasonably loud noise, litter, and excessive traffic and parking congestion. Probative evidence relating to these matters may be taken from the plan of operation submitted with the license application, if any, but shall not include the content of any music. Evidence regarding the fitness of the location of the premises to be maintained as the principal place of business, including but not limited to whether there is an overconcentration of businesses of the type for which the license is sought; whether the proposal is consistent with any pertinent neighborhood business or development plans, or the location's proximity to areas where children are typically present. The applicant's record in operating similarly licensed premises; and whether or not the applicant has been charged with or convicted of any felony, misdemeanor, municipal offense or other offense, the circumstances of which substantially relate to the activity to be permitted by the license being applied for or any other factor which reasonably relates to the public health, safety or welfare may also be considered. See attached police report or correspondence. An application for a Public Entertainment Premises license seeking amusement machines may be denied on the basis of the potential illegality of the machines for which the license is sought.

Notice for applicants with warrants or unpaid fines:

Proof of warrant satisfaction or payment of fines must be submitted at the hearing on the above date and time. Failure to comply with this requirement may result in a delay of the granting/denial of your application.

Failure to attend this meeting may result in the denial of your license. Individual applicants and partnership applicants must attend or attend by an attorney. The agent or attorney for corporate or limited liability applicants must attend. If you wish to do so and at your own expense, you may be accompanied by an attorney of your choosing to represent you at this hearing.

You will be given an opportunity to speak on behalf of the application and to respond and challenge any charges or reasons given for the denial. No petitions can be accepted by the committee, unless the people who signed the petition attend the virtual hearing and are willing to testify. You may present witnesses under oath and you may also confront and cross-examine opposing witnesses under oath. If you have difficulty with the English language, you should request an interpreter attend the meeting with you, at your expense, so that you can answer questions and participate in your hearing.

PLEASE NOTE: Upon reasonable notice, efforts will be made to accommodate the needs of disabled individuals through sign language interpreters or other auxiliary aids. For additional information or to request this service, contact the Council Services Division ADA Coordinator at (414) 286-2998, Fax - (414) 286-3456, TDD - (414) 286-2025.

JIM OWCZARSKI, CITY CLERK



BY: _____

Jim Cooney

License Division Manager

If you have questions regarding this meeting, please contact the staff assistant, Yadira Melendez at (414) 286-2775 or stasst5@milwaukee.gov.

200 E. Wells Street, Room 105, City Hall, Milwaukee, WI 53202. www.milwaukee.gov/license
Phone: (414) 286-2238 Fax: (414) 286-3057 Email Address: License@milwaukee.gov

Date: 07/23/21
Officer: T. Geniesse

City of Milwaukee Police Department
90-5-1.5 Crime Prevention Survey
Tavern Inspection

Name of Premise: Coconut Bowl
Address: 4707 W. Mill Rd
Phone: N/A

Owner: Pamela D Perrin B/F 08/18/1979 DL# P650-6647-9798-01 exp 08/18/22
Owner address: 6514 W Hustis St
City State Zip: Milwaukee, WI 53225
Owner Phone: 262-880-5925
Owner email: 1pamelah@gmail.com

Licensee/Agent: Pamela D Perrin
Home Address: 6514 W Hustis St
City State Zip: Milwaukee, WI 53225
Phone: 262-880-5925
Email: 1pamelah@gmail.com

Preferred contact: Pamela Perrin

Location currently open: YES NO

Projected open date: Aug. 1st, 2021

Day's open: S M T W Th F SA ALL

Hours of Operation: Sun: 10a-11p 24 hours Y N
Mon: 10a-12a
Tue: 10a-12a
Wed: 10a-12a
Thu: 9a-12a
Fri: 10a-230a
Sat: 10a-230a

Premise Type: Tavern/Bar
 Restaurant
 Other: Bowling Alley

Licenses currently held: None

Alcohol: Yes No Class: #:
 Tobacco: Yes No #:
 Food: Yes No #:
 Extended Hours: Yes No #:
 Secondhand Dealer: Yes No Type: #:
 Other: Yes No Type: #:
 Other: Yes No Type: #:

Applying for: Class B, Public Entertainment and Food

Exterior Survey:

1. Is the area around the location clean? Yes No
2. What surrounds the location? (Check all the apply)
 - a. Park
 - b. School
 - c. Youth Center
 - d. Church
 - e. Tavern(s) If so, how many
 - f. Residential
 - g. Other businesses
 - h. Other:
3. Can you see from the outside of the location into the interior Yes No
4. Can you see the employees inside of the location from the outside Yes No
5. Are exterior windows free of signage Yes No
6. Is there a parking lot Yes No
7. Is the parking lot clean? Yes No
8. Off-Street parking Yes No
9. Is the parking lot well lit? Yes No
10. Valet Parking Yes No
 - a. Will this lot have a guard? Yes No
 - b. Will this lot have cameras? Yes No
11. Are there areas where a person could conceal themselves Yes No
12. Is there exterior lighting? Yes No. Does it appears to be adequate Yes No
13. Exterior Payphone? Yes No
14. Are there No Loitering Signs posted? Yes No But will place one on each side of the building
15. Are there exterior security cameras Yes No How Many: 4
16. Are the address numbers prominently displayed and easy to see Yes No

Camera Survey:

17. Does this location have security cameras? Yes No
18. Are they in working order? Yes No
19. What format are the cameras?
 - a. Color Yes No
 - b. Digital Yes No
 - c. Recorded Yes No
20. How long is footage stored for later viewing: 30 days
21. Are there exterior cameras Yes No How many: 4

22. Are there interior cameras Yes No How many: 5
 23. Do all employees know how to retrieve recorded digital images/footage? Yes No
 24. Cameras located in parking lot Yes No How many 4

Interior Survey:

25. What is the planned capacity 200
 26. What is the minimum number of employees That will be on premise 3
 27. Is the storeowner willing to be a standing complainant regarding loitering? Yes No
 a. If yes have them fill out the standing complaint form and give them two of the commercial signs Yes No
 28. Is the interior of the location neat and clean? Yes No
 29. Does an interior camera face the entrance/exit? Yes No
 30. Is there a lockable area that separates employees from customers? Yes No
 31. Are emergency and non-emergency numbers posted near the phone? Yes No But will once they are open
 32. Does the owner know how to contact their police district directly? Yes No
 a. Did you provide a district contact guide to the owner? Yes No

Security

33. How many security personnel are going to be employed: 1-3
 34. How ill they be deployed: Interior 1 Exterior 2
 35. What days will they be deployed MonTueWedThuFriSatSun
 36. Will the security be managed by business or contracted
 37. Will they be armed Yes No Unknown at this time
 38. What type of security measures to be used:
Wanding/metal detector
ID Scanner
Dress Code
Cover Charge
Age restriction
Other

Will post "No Firearms" allowed signs

ADDITIONAL COMMENTS/RECOMMENDATIONS:

No loitering signs, update cameras, fix lightening in parking lot



Concentration Map 4707 W Mill Rd

Area of Interest (AOI) Information

Area : 21,862,585.72 ft²

Jul 14 2021 13:05:12 Central Daylight Time

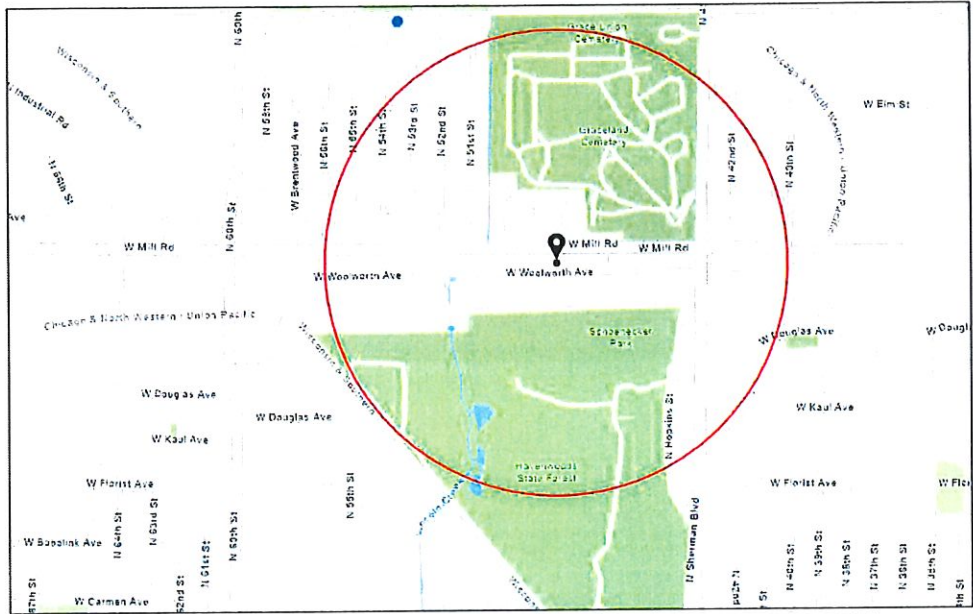

Alcohol Licenses City Limits
● Class B Tavern

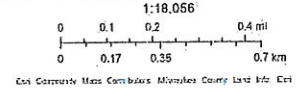

4707 W Mill RD

Summary

Name	Count	Area(ft ²)	Length(mi)
Alcohol Licenses	0		

Establishments within a 0.5 miles radius centered on area of interest.

Tuesday, September 14, 2021

REDACTED RECORD

City Clerk – License Division

City Hall Room 105
200 E. Wells Street
Milwaukee, WI 53202

To whom it may concern,

I am writing as a member of the [REDACTED] business community. It is my understanding that the bowling alley located at 4707 N. Mill Road, formally known as the Court Lanes North has a prospective buyer. I know that there is a deep concern within the neighborhood about having an establishment that might be serving alcohol until the typical bar time of 2:00 AM. This is a neighborhood that is struggling to keep its streets safe. While bowling in of itself may be a very wholesome activity, the associated bar activity will likely not be. For this reason, I agree with neighbors who would like to see the bar activity limited to an earlier closing time.

In addition, I would ask the following questions;

1. What if any, improvements would a new owner make to the property?
2. What if any, sort of security would they be providing?
3. How might they place to be not only a good neighbor, but an asset to the business community?

The [REDACTED] block watch is fighting hard for their neighborhood. I share in their concerns. I sincerely hope that any new owner of this bowling alley will have an appreciation for the issues that concern them.

Sincerely,



Thursday, September 30, 2021

Licenses Committee Notice of Hearing

J M SUTTON
6665 N RANGE LINE Rd
GLENDALE, WI 53209

The Licenses Committee will consider the following license application:

Class B Tavern, Food Dealer, and Public Entertainment Premises License
Applications Requesting Jukebox, 12 Bowling Lanes, 1 Pool Table, 5 Amusement
Machines, and Patrons Dancing
Pamela D Perrin
Coconut Bowl at 4707 W MILL Rd

Date: 10/19/2021

Time: 09:30 AM

Location: The hearing before the Licenses Committee will take place virtually on Tuesday, October 19, 2021. This is a public hearing. Those wishing to view the proceeding are able to do so via the City Channel – Channel 25 on Spectrum Cable – or on the Internet at <http://city.milwaukee.gov/citychannel>. Those wishing to provide oral testimony will be asked to do so by phone or internet and are asked to contact the staff assistant, Yadira Melendez at (414) 286-2775 or stasst5@milwaukee.gov for necessary information. Please make such requests no later than one business day prior to the start of the meeting. You are not required to attend the hearing, but please see the information below if you would like to provide testimony

Please note this application may be recommended for denial based on fitness of the location due to concentration of alcohol beverage outlets in the area. If the application is denied for this reason, no other application for an alcohol beverage license for this location shall be recommended for approval by the Licenses Committee within three years of the date of denial unless the applicant has demonstrated a change of circumstances since the prior denial.



Thursday, September 30, 2021



Notice of Public Hearing

blank
notice

PERRIN, Pamela D

Coconut Bowl at 4707 W MILL Rd

Class B Tavern, Food Dealer, and Public Entertainment Premises License Applications
Requesting Jukebox, 12 Bowling Lanes, 1 Pool Table, 5 Amusement Machines, and Patrons
Dancing

Tuesday, October 19, 2021 at 9:30 AM

To whom it may concern:

The above application has been made by the above named applicant(s). This requires approval from the Licenses Committee and the Common Council of the City of Milwaukee. The hearing before the Licenses Committee will take place virtually on 10/19/2021 at 9:30 AM. This is a public hearing. Those wishing to view the proceeding are able to do so via the City Channel – Channel 25 on Spectrum Cable – or on the Internet at <http://city.milwaukee.gov/citychannel>. Those wishing to provide oral testimony will be asked to do so by phone or internet and are asked to contact the staff assistant, Yadira Melendez at (414) 286-2775 or stasst5@milwaukee.gov for necessary information. Please make such requests no later than one business day prior to the start of the meeting. You are not required to attend the hearing, but please see the information below if you would like to provide testimony. Once the Licenses Committee makes its recommendation, this recommendation is forwarded to the full Common Council for approval at its next regularly scheduled hearing.

Important details for those wishing to provide information for the Licenses Committee to consider when making its recommendation:

1. The license application is scheduled to be heard at the above time. Due to other hearings running longer than scheduled, you may have to wait some time to provide your testimony.
2. You must testify as to matters that you have personally experienced or seen. (You cannot provide testimony for your neighbor, parent or anyone else; this is considered hearsay and cannot be considered by the committee.)
3. No letters or petitions can be accepted by the committee (unless the person who wrote the letter or the persons who signed the petition are willing to testify).
4. Persons opposed to the license application are given the opportunity to testify first; supporters may testify after the opponents have finished.
5. When you are called to testify, you will be sworn in and asked to give your name, and address. (If your first and/or last names are uncommon please spell them.)
Please Note: If you have submitted an objection to the above application your objection cannot be considered by the committee unless you personally testify at the hearing.
6. You may then provide testimony.
 - a. Include only information relating to the above license application.
 - b. Include only information you have personally witnessed or seen.
 - c. Provide concise and relevant information detailing how this business has affected or may affect the peaceful enjoyment of your neighborhood.
 - d. If by the time you have the opportunity to testify, the information you wish to share has already been provided to the committee, you may state that you agree with the previous testimony. Redundant or repetitive testimony will not assist the committee in making its recommendation.
7. After giving your testimony, the members of the Licenses Committee and the licensee may ask questions regarding the testimony you have given or other factors relating to the license application.
8. Business Competition is not a valid basis for denial or non-renewal of a license.

OCCUPANT	MAIL ADDRESS	CITY STATE ZIP
CURRENT OCCUPANT	4560 W MILL RD	MILWAUKEE, WI 53218-1401
CURRENT OCCUPANT	4562 W MILL RD	MILWAUKEE, WI 53218-1401
CURRENT OCCUPANT	4580 W MILL RD	MILWAUKEE, WI 53218-1401
CURRENT OCCUPANT	4582 W MILL RD	MILWAUKEE, WI 53218-1401
CURRENT OCCUPANT	4600 W MILL RD	MILWAUKEE, WI 53218-1402
CURRENT OCCUPANT	4602 W MILL RD	MILWAUKEE, WI 53218-1402
CURRENT OCCUPANT	4614 W MILL RD	MILWAUKEE, WI 53218-1402
CURRENT OCCUPANT	4616 W MILL RD	MILWAUKEE, WI 53218-1402
CURRENT OCCUPANT	4621 W MILL RD	MILWAUKEE, WI 53218-1403
CURRENT OCCUPANT	4621 W MILL RD, A	MILWAUKEE, WI 53218-1403
CURRENT OCCUPANT	4622 W MILL RD	MILWAUKEE, WI 53218-1402
CURRENT OCCUPANT	4624 W MILL RD	MILWAUKEE, WI 53218-1402
CURRENT OCCUPANT	4625 W MILL RD	MILWAUKEE, WI 53218-1403
CURRENT OCCUPANT	4630 W MILL RD	MILWAUKEE, WI 53218-1402
CURRENT OCCUPANT	4632 W BRENTWOOD CT	MILWAUKEE, WI 53223-6029
CURRENT OCCUPANT	4632 W MILL RD	MILWAUKEE, WI 53218-1402
CURRENT OCCUPANT	4633 W BRENTWOOD CT	MILWAUKEE, WI 53223-6029
CURRENT OCCUPANT	4639 W BRENTWOOD CT	MILWAUKEE, WI 53223-6029
CURRENT OCCUPANT	4640 W BRENTWOOD CT	MILWAUKEE, WI 53223-6029
CURRENT OCCUPANT	4644 W BRENTWOOD CT	MILWAUKEE, WI 53223-6029
CURRENT OCCUPANT	4647 W BRENTWOOD CT	MILWAUKEE, WI 53223-6029
CURRENT OCCUPANT	4652 W BRENTWOOD CT	MILWAUKEE, WI 53223-6029
CURRENT OCCUPANT	4660 W BRENTWOOD CT	MILWAUKEE, WI 53223-6029
CURRENT OCCUPANT	4700 W BRENTWOOD AVE	MILWAUKEE, WI 53223-6024
CURRENT OCCUPANT	4701 W BRENTWOOD AVE	MILWAUKEE, WI 53223-6023
CURRENT OCCUPANT	4706 W BRENTWOOD AVE	MILWAUKEE, WI 53223-6024
CURRENT OCCUPANT	4706 W MILL RD	MILWAUKEE, WI 53218-1404
CURRENT OCCUPANT	4707 W MILL RD	MILWAUKEE, WI 53218-1405
CURRENT OCCUPANT	4708 W MILL RD	MILWAUKEE, WI 53218-1404
CURRENT OCCUPANT	4714 W BRENTWOOD AVE	MILWAUKEE, WI 53223-6024
CURRENT OCCUPANT	4714 W MILL RD	MILWAUKEE, WI 53218-1404
CURRENT OCCUPANT	4720 W BRENTWOOD AVE	MILWAUKEE, WI 53223-6024
CURRENT OCCUPANT	4722 W MILL RD	MILWAUKEE, WI 53218-1404
CURRENT OCCUPANT	4723 W BRENTWOOD AVE	MILWAUKEE, WI 53223-6023
CURRENT OCCUPANT	4726 W BRENTWOOD AVE	MILWAUKEE, WI 53223-6024
CURRENT OCCUPANT	4734 W BRENTWOOD AVE	MILWAUKEE, WI 53223-6024
CURRENT OCCUPANT	4800 W BRENTWOOD AVE	MILWAUKEE, WI 53223-6026
CURRENT OCCUPANT	4801 W BRENTWOOD AVE	MILWAUKEE, WI 53223-6025
CURRENT OCCUPANT	4802 W MILL RD	MILWAUKEE, WI 53218-1406
CURRENT OCCUPANT	4808 W BRENTWOOD AVE	MILWAUKEE, WI 53223-6026
CURRENT OCCUPANT	4808 W MILL RD	MILWAUKEE, WI 53218-1406
CURRENT OCCUPANT	4810 W MILL RD	MILWAUKEE, WI 53218-1406
CURRENT OCCUPANT	4811 W MILL RD	MILWAUKEE, WI 53218-1407
CURRENT OCCUPANT	4816 W BRENTWOOD AVE	MILWAUKEE, WI 53223-6026
CURRENT OCCUPANT	4817 W MILL RD	MILWAUKEE, WI 53218-1407
CURRENT OCCUPANT	4820 W MILL RD	MILWAUKEE, WI 53218-1406

CURRENT OCCUPANT	4822 W BRENTWOOD AVE	MILWAUKEE, WI 53223-6026
CURRENT OCCUPANT	4823 W BRENTWOOD AVE	MILWAUKEE, WI 53223-6025
CURRENT OCCUPANT	4901 W MILL RD	MILWAUKEE, WI 53218-1409
CURRENT OCCUPANT	4911 W MILL RD	MILWAUKEE, WI 53218-1409
CURRENT OCCUPANT	5011 W MILL RD	MILWAUKEE, WI 53218-1410
CURRENT OCCUPANT	6400 N 49TH ST	MILWAUKEE, WI 53223-6005
CURRENT OCCUPANT	6400 N 51ST ST	MILWAUKEE, WI 53223-6008
CURRENT OCCUPANT	6401 N 51ST ST	MILWAUKEE, WI 53223-6007
CURRENT OCCUPANT	6403 N 49TH ST	MILWAUKEE, WI 53223-6004
CURRENT OCCUPANT	6403 N 51ST ST	MILWAUKEE, WI 53223-6007
CURRENT OCCUPANT	6407 N 51ST ST	MILWAUKEE, WI 53223-6007
CURRENT OCCUPANT	6408 N 49TH ST	MILWAUKEE, WI 53223-6005
CURRENT OCCUPANT	6409 N 47TH ST	MILWAUKEE, WI 53223-6001
CURRENT OCCUPANT	6409 N 51ST ST	MILWAUKEE, WI 53223-6007
CURRENT OCCUPANT	6411 N 49TH ST	MILWAUKEE, WI 53223-6004
CURRENT OCCUPANT	6414 N 49TH ST	MILWAUKEE, WI 53223-6005
CURRENT OCCUPANT	6417 N 49TH ST	MILWAUKEE, WI 53223-6004
CURRENT OCCUPANT	6418 N 51ST ST	MILWAUKEE, WI 53223-6008
CURRENT OCCUPANT	6420 N 49TH ST	MILWAUKEE, WI 53223-6005
CURRENT OCCUPANT	6423 N 47TH ST	MILWAUKEE, WI 53223-6001
CURRENT OCCUPANT	6423 N 49TH ST	MILWAUKEE, WI 53223-6004
CURRENT OCCUPANT	6426 N 51ST ST	MILWAUKEE, WI 53223-6008
CURRENT OCCUPANT	6427 N 48TH CT	MILWAUKEE, WI 53223-6003
CURRENT OCCUPANT	6428 N 47TH ST	MILWAUKEE, WI 53223-6002
CURRENT OCCUPANT	6428 N 49TH ST	MILWAUKEE, WI 53223-6005
CURRENT OCCUPANT	6429 N 47TH ST	MILWAUKEE, WI 53223-6001
CURRENT OCCUPANT	6430 N 48TH CT	MILWAUKEE, WI 53223-6003
CURRENT OCCUPANT	6432 N 51ST ST	MILWAUKEE, WI 53223-6008
CURRENT OCCUPANT	6433 N 48TH CT	MILWAUKEE, WI 53223-6003
CURRENT OCCUPANT	6434 N 47TH ST	MILWAUKEE, WI 53223-6002
CURRENT OCCUPANT	6434 N 49TH ST	MILWAUKEE, WI 53223-6005
CURRENT OCCUPANT	6436 N 48TH CT	MILWAUKEE, WI 53223-6003
CURRENT OCCUPANT	6437 N 47TH ST	MILWAUKEE, WI 53223-6001
CURRENT OCCUPANT	6437 N 49TH ST	MILWAUKEE, WI 53223-6004
CURRENT OCCUPANT	6440 N 51ST ST	MILWAUKEE, WI 53223-6008
CURRENT OCCUPANT	6441 N 48TH CT	MILWAUKEE, WI 53223-6003
CURRENT OCCUPANT	6441 N 49TH ST	MILWAUKEE, WI 53223-6004
CURRENT OCCUPANT	6442 N 48TH CT	MILWAUKEE, WI 53223-6003
CURRENT OCCUPANT	6442 N 49TH ST	MILWAUKEE, WI 53223-6005
CURRENT OCCUPANT	6443 N 47TH ST	MILWAUKEE, WI 53223-6001
CURRENT OCCUPANT	6445 N 49TH ST	MILWAUKEE, WI 53223-6004
CURRENT OCCUPANT	6446 N 47TH ST	MILWAUKEE, WI 53223-6002
CURRENT OCCUPANT	6448 N 51ST ST	MILWAUKEE, WI 53223-6008
CURRENT OCCUPANT	6451 N 49TH ST	MILWAUKEE, WI 53223-6004
CURRENT OCCUPANT	6454 N 51ST ST	MILWAUKEE, WI 53223-6008
CURRENT OCCUPANT	6460 N 51ST ST	MILWAUKEE, WI 53223-6008
CURRENT OCCUPANT	6466 N 51ST ST	MILWAUKEE, WI 53223-6008

CURRENT OCCUPANT	6500 N 49TH CT	MILWAUKEE, WI 53223-6006
CURRENT OCCUPANT	6505 N 43RD ST	MILWAUKEE, WI 53209-3014
CURRENT OCCUPANT	6515 N 49TH CT	MILWAUKEE, WI 53223-6006
CURRENT OCCUPANT	6520 N 49TH CT	MILWAUKEE, WI 53223-6006
CURRENT OCCUPANT	6523 N 49TH CT	MILWAUKEE, WI 53223-6006
CURRENT OCCUPANT	6529 N 49TH CT	MILWAUKEE, WI 53223-6006
CURRENT OCCUPANT	6530 N 49TH CT	MILWAUKEE, WI 53223-6006
CURRENT OCCUPANT	6538 N 49TH CT	MILWAUKEE, WI 53223-6006
blank	notice	

Total Records: 101

Radius: 950.0 feet and Center of Circle: 4707 W Mill Rd



BUSINESS LICENSE PLAN OF OPERATION

ccl-busplan 5/12/2020

Office of the City Clerk License Division
200 E. Wells St. Room 105, Milwaukee, WI 53202
(414) 286-2238 www.milwaukee.gov/license e-mail address: license@milwaukee.gov

1. Type of Business

Applying for: Extended Hours (12AM to 5AM) - If a food establishment, check all that apply: Delivery Drive Thru Dining Room
 Self Service Laundry Massage Establishment Filling Station
 Other (supplemental application for specific license also required)

Provide a detailed description of the type of business you plan on operating:

Bowling Alley w/ bar & food service; banquet hall rentals

Do you have any experience operating this type of business? No Yes If yes, explain:

2. Business Operations

- a. Proposed Opening Date: 8/15/2021
- b. Is this premise under construction? No Yes If yes, list estimated completion date: _____
- c. Is this a franchise? No Yes
- d. Is this premises currently licensed? No Yes If yes, list type of license: Class B, Public Entertainment, Food
- e. Is the current licensee operating? No Yes If no, list date closed: 3/2020(?)
- f. Do you have future plans for other businesses, licenses or permits at this location? No Yes
If yes, explain: _____
- g. Have you previously held an Extended Hours License in Milwaukee? No Yes
If yes, list address(es): _____
- h. Are other businesses operating in the same building? No Yes If yes, describe: _____

3. Litter & Noise

- a. How are grounds kept clean? Sweep Pressure Wash Pick Up Litter Other: _____
- b. How often will grounds be cleaned? Daily Weekly As Needed Monthly Other: _____
- c. Grounds cleaned by: Licensee Building Owner Employees Hired Maintenance Other: _____
- d. How are noise issues prevented and/or addressed? Security Manager approaches customer(s) Call Police
 Signs Posted Other: _____
- e. Will a sound amplification system be used? No Yes If yes, describe: Bowling P.A & digital jukebox

4. Smoking & Sanitation

- a. Are there designated outdoor smoking areas? No Yes If yes, describe: to be assigned
- b. Number of Garbage Cans: Inside: 8-9 Locations: Each of 4 restrooms, bar, kitchen, hall, sitting area
Outside: 4 Locations: All four corners of building
- c. Is a crowd control barrier used? No Yes If yes, describe: _____
- d. How many restrooms are on the premises? 4
- e. Name of solid waste contractor: Advanced Disposal Waste Management Other: _____

5. Security

- a. Are there onsite parking spaces? No Yes If yes, how many? 44 and describe the parking security plan: Security detail to monitor perimeter
- b. Is there a loading zone? No Yes If yes, describe the loading area security plan: _____
- c. Will you have security personnel on premise? No Yes If yes, how many? 2 and answer the following:
 What are their responsibilities? Monitor outdoor premises & have presence indoors - descending/ascending
 Is security equipment used? No Yes If yes, describe _____
 List their licensing, certification, or training credentials _____
- d. Will there be security cameras? No Yes If yes, how many? 10 and list locations: 6 inside
4 - outside premises
- e. Will searches/identification checks be done upon entry? No Yes If yes, describe 10 check, when events in lower level.
proper carding of individuals for bar

6. Percentage of Sales (must total 100%)

Alcohol <u>30</u> %	Food <u>30</u> %	Secondhand Merchandise _____ %	Precious Metals & Gems _____ %
Entertainment <u>40</u> %	Cigarettes _____ %	Personal Services (such as tattoo, body piercing, salon, tailor, tanning, etc.) _____ %	Other _____ %
Pawnbroker Activity _____ %	Salvaged Materials _____ % (such as scrap metal)		Describe: _____

7. Businesses/Licenses on the Premises (check all that apply):

Type 1

- Full Service Restaurant Cafe/Coffee Shop Deli or Fast Food Restaurant Private/Fraternal/Veterans Club
- Night Club Tavern Cocktail Lounge Teen Club
- Banquet Hall Sports Facility Bowling Alley
- Hotel/Motel: Number of Floors: _____ Rooming House: Number of Floors: _____
 Number of Rooms: _____ Number of Rooms: _____

Type 2

- Liquor Store Corner Store Supermarket Convenience Store
- Gas Station Amusement/Phonograph Distributor Recycling, Salvage or Towing
- Used Car Dealer Personal Service Establishment
 (such as tattoo business, hair salon, tailor, etc.) Recording Studio

What other licenses/permits will you hold at this location? (check all that apply)

- Occupancy Permit Cigarette & Tobacco Gas Station Extended Hours Class "B" Tavern Weights & Measures
- Secondhand Dealer Precious Metal & Gem Other: Public Entertainment (Bowling Alley), Food Dealer

8. Legal Capacity (only if a Type 1 premises in #7 above)

Capacity 275 (Call the Milwaukee Development Center at 414-286-8211 if you have questions.)

9. Premises Description

a. Identify all area(s) of the premises that will be used in operating this business (include areas used only for storage):

1st Floor 2nd Floor Basement Storage Patio Beer Garden Sidewalk Café Deck Rooftop

Other: Describe: Banquet Hall - lower level

b. Describe Location: Major Thoroughfare Secondary Street Other: _____

c. Nearest Major Cross Street: Sherman Rd

d. Describe Building: Free Standing Building Strip Mall Other: _____

e. Describe Premises Structure: Single Story Multi-Story - # of Stories 3 Other: _____

f. Describe Surrounding Area: Commercial Residential Industrial Other: _____

g. Building Owner Name: J.M. Sutton & Selma L. Phone Number: 414-353-7116

Building Owner Address: 6665 N. Range Line Rd Glendale, WI 53009

10. Hours of Operation & Customers

Will customers be entering the premises? No Yes

Day of the Week	Proposed Hours of Operation:		Estimated Number of Customers expected each day	Potential Age Range of Customers	Class B Tavern Applicant Only: Age Restriction (If none, write 'None')
	Open Time (include a.m. or p.m.)	Close Time (include a.m. or p.m.)			
Sunday	10 ⁰⁰ A.M	11 ⁰⁰ P.M	50+	0-100	
Monday	10 ⁰⁰ A.M	12:00 A.M	"	"	
Tuesday	10 ⁰⁰ A.M	12:00 A.M	"	"	
Wednesday	10 ⁰⁰ A.M	12:00 A.M	"	"	
Thursday	9 ⁰⁰ A.M	12:00 A.M	"	"	
Friday	10 ⁰⁰ A.M	2:30 A.M	"	"	
Saturday	10 ⁰⁰ A.M	2:30 A.M	"	"	

An Extended Hours Establishment License is required for any convenience store, filling station, personal service establishment (such as tattoo, body piercing, salon, tailor, tanning, etc.), recording studio or restaurant which is open between the hours of 12:00 a.m. and 5:00 a.m.

Alcohol Establishments Class A: 8:00 am to 9:00 pm Sunday thru Saturday
Permitted Hours of Operation: Class B: 6:00 am to 2:00 am Sunday thru Thursday, 6:00 am to 2:30 am Friday & Saturday

Entertainment Outdoor Closing Hours: 10:00pm Sunday-Thursday; 12:00am Friday & Saturday; unless a different time, either earlier or later, is established by the Common Council in its approval of the licensee's plan of operation.

11. Signature(s)

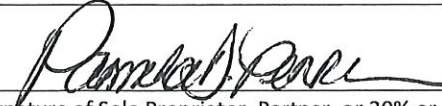

Signature of Sole Proprietor, Partner, or 20% or more Shareholder
(If there are no 20% or more shareholders,
Corporate Officer—print name/title and sign)

Signature of additional partner or 20% or more shareholder

See Application Information for a complete list of all required application forms.



ALCOHOL BEVERAGE & PUBLIC ENTERTAINMENT PREMISES SUPPLEMENTAL APPLICATION

Office of the City Clerk License Division
200 E. Wells St. Room 105, Milwaukee, WI 53202
(414) 286-2238 e-mail address: license@milwaukee.gov www.milwaukee.gov/license

Legal Entity Name: Parole Perrin

Premise Address: 4707 W. Mill Rd Milwaukee, WI 53218

Proximity of Premises to Church, School, Daycare Center or Hospital

Is the building within 300 feet of any church, school, daycare center or hospital? No Yes

"Service Bar Only" Designation

If applying for Class B or C license, are you applying for "Service Bar Only"? No Yes
Service Bar Only means customers cannot sit at the bar. Alcohol is served to employees who serve patrons seated at tables. No stools, chairs or other articles of furniture shall be placed at the service bar for patrons to sit upon.

Business Information

a) Are you taking out this application for anyone that may not be eligible for a license? No Yes
If yes, list their name and address: _____

b) Will the agent, a partner or the individual licensee be conducting the day-to-day operations of the business? No Yes
If no, list the name and address of the person(s) who will: _____

Class B Applicants: If the agent, a partner or the individual licensee will not be conducting the day-to-day operations of the business, the person(s) listed above must obtain a Class B Managers license.

c) Does anyone else have money invested or any other interest in this business? No Yes
If yes, explain: _____

d) Have you made an agreement with anyone to repay any loan or any other payments based upon income from the business? No Yes
If yes, list name and address: _____

Property Information (New & Transfer Applicants Only)

a) Do you own or lease the building? Own Lease *lease to own

b) Who owns the fixtures (for example, coolers, etc.)? Applicant responsible

c) Are you purchasing the stock and/or fixtures? No Yes If yes, amount paid \$ (incl w/building)

d) Total amount paid for business \$ 325,000.00

e) Total amount paid for goodwill of the business \$ 0.00

Goodwill comprises the reputation and customer relationships of an existing business. If the price you pay for the business exceeds the fair market value of all of the rest of the assets of the business, the excess may be considered goodwill.

f) Have you made arrangements with the seller for payment of personal property taxes? No Yes

Lease Information (New & Transfer Applicants who are leasing the premises only)

a) Date lease begins 7-1-21 Ends _____

b) Monthly rental \$ 2000.00

c) Do you have an option to renew the lease? No Yes *option to purchase

d) Does your lease allow for assignment to another party without the consent of the owner? No Yes

e) For what length of time have you been guaranteed occupancy (number of years)? 2 years

Lease Information (Continued)

- f) In addition to paying the monthly rental, will you have to pay anything additional to the owner of the building to guarantee performance of the lease? No Yes If yes, explain _____
- g) Does the present owner or occupancy object to the granting of your license? No Yes
If yes, explain _____

Change of Agent Applicants Only

Have there been any changes to the floor plan since the last application was submitted? No Yes
If no, a new floor plan is not required. If yes, submit a new floor plan and explain the change(s):

Signature



Signature of Sole Proprietor, Partner or 20% or More Shareholder
(If no 20% or more Shareholder, Corporate Officer - print name/title and sign)

Note: All information contained in this application is subject to approval by the Common Council.
Deviating from approved plan of operation will subject licensee to citations, and/or suspension or non-renewal of the license.
Contact the License Division for information on how to request changes.

New and transfer of premises applicants must submit the following:

- Detailed floor plan
- If a restaurant, copy of the menu



FOOD DEALER LICENSE PLAN OF OPERATION

OFFICE OF THE CITY CLERK, LICENSE DIVISION
 CITY HALL, 200 E. WELLS ST, ROOM 105, MILWAUKEE, WI 53202
 (414) 286-2238 • license@milwaukee.gov • www.milwaukee.gov/license

Legal Entity Name:	<i>Pamela Perrin</i>
Premises Address:	<i>4707 W. Mill Rd. Milwaukee, WI 53228</i>
SECTION 1 TYPE OF BUSINESS	
<p>What will be the majority of your food sales? (check one)</p> <p><input checked="" type="checkbox"/> Restaurant Items (meals): MEALS include, but are not limited to, chicken, ribs, sandwiches, roasted corn, baked potatoes, hot dogs, brats, tacos, nachos w/ cheese and meat, French fries, cooked or deep fried vegetables/fruit, cooked cheese curds, corn dogs, egg rolls, salads.</p> <p><i>PO</i> <input checked="" type="checkbox"/> Retail Items (snacks and beverages): RETAIL items include, but are not limited to, ice cream/soft serve, lemonade, snow cones, coffee, espresso, cappuccino, tea, fruit juice, smoothies, candy, dispensed soda, fruit cups, bakery, cookies, kettle corn, cotton candy, funnel cakes, fritters, tortilla chips w/ cheese.</p> <p>Will it be a convenience store? <input type="checkbox"/> Yes <input checked="" type="checkbox"/> No A convenience store contains less than 5,000 square feet of retail space and has, as its primary business, the sale of basic food items and in addition, sells household products or is a filling station that sells basic food items and household products.</p> <p><input type="checkbox"/> Bed & Breakfast <input type="checkbox"/> Micro Market</p> <p>All Applicants: Submit a menu or a list of food items that will be sold.</p>	
<p>Will any wholesale business be done? <input checked="" type="checkbox"/> No <input type="checkbox"/> Yes If yes, what percentage of food sales will be wholesale?</p> <p><input type="checkbox"/> Less than 25%</p> <p><input type="checkbox"/> 25% or More AND: <input type="checkbox"/> Restaurant items (meals) will be sold – Complete this application and also contact DATCP. <input type="checkbox"/> NO restaurant items (meals) will be sold - Do NOT complete this application. Contact DATCP only.</p>	
SECTION 2 FOOD PROCESSING	
<p>Will any food processing be done? <input type="checkbox"/> No <input checked="" type="checkbox"/> Yes</p> <p>Processing is defined as assembling, grinding, cutting, mixing, baking, coating, stuffing, packing, bottling, grilling, canning, extracting, fermenting, distilling, pickling, freezing, drying, smoking, or packaging.</p>	
SECTION 3 FOOD REQUIRING TEMPERATURE CONTROL	
<p>Will any food that requires temperature control be sold? <input type="checkbox"/> No <input checked="" type="checkbox"/> Yes (includes dairy products such as milk, cheese, and ice cream, fish, shellfish, meat, poultry)</p> <p>If yes, list the types of food items: <i>Chicken, desserts, tacos, etc</i></p>	

SECTION 4 DETAILS OF OPERATION

Will you have seating on site for dining? No Yes
 Will you be doing any catering? No Yes
 Will you be doing any delivery? No Yes
 Will you have outdoor activities? No Yes - Check all that apply: Bar Cooking/Grilling Dining
 Will you have a drive thru window? No Yes - Are hours different from inside? No Yes
 If Yes, provide drive thru hours: _____
 Will scales or barcode scanners be used? No Yes - You must also apply for a Weights & Measures License.

SECTION 5 ADDITIONAL SITES

Where will food be prepared and/or sold?
 At a single site At multiple sites: How many? _____ (for example, a hotel with several dining rooms or bars)
 If multiple sites, attach a Food Dealer Additional Site Addendum (ccl-foodadd) for each additional site.

SECTION 6 CONSTRUCTION OR CHANGES

Are you planning any construction, remodeling or equipment changes?
 No If No, SKIP to Section 8
 Yes If Yes, check all that apply: New construction of a building Renovation or remodeling
 Construction changes to existing building Equipment changes only
 Provide a brief description of the changes: _____
 Start date: _____
 Name, Address & Phone Number of Architect: _____

 Name, Address & Phone Number of Contractor: _____

SECTION 7 ALCOHOL BEVERAGES

Are you applying for an alcohol beverage license?
 No If No, SKIP to Section 8
 Yes If YES, if your food license is approved prior to the alcohol license, when do you want the food license issued?
 Immediately At the same time as the alcohol license

SECTION 8 ACKNOWLEDGEMENTS & SIGNATURE

You must initial each item confirming your understanding:

PP I understand the Health Department must conduct an inspection and advise the License Division of their approval before the license may be issued.

PP I understand I must obtain an occupancy permit from the Department of Neighborhood Services and an inspection may be required. Neighborhood Services must advise the License Division of their approval before the license may be issued.

PP I understand the district alderperson will review and either support or object to my application. If he/she objects, I may appeal and be scheduled to appear before the Licenses Committee. The Licenses Committee will then make a recommendation to the Common Council. The Common Council must grant the license before it may be issued.

PP I understand proof of payment for all license fees must be on file in the License Division before the license may be issued and the license must be issued and posted in my establishment prior to opening for business.

PP I will not operate my food business until the license has been issued and posted in the establishment.

Signature of Sole Proprietor, Partner, or 20% Shareholder: *[Signature]*

Signature of Additional Partner: _____



PUBLIC ENTERTAINMENT PREMISES LICENSE SUPPLEMENTAL APPLICATION

Office of the City Clerk License Division
200 E. Wells St. Room 105, Milwaukee, WI 53202
(414) 286-2238 www.milwaukee.gov/license e-mail address: license@milwaukee.gov

PREMISES ADDRESS: 4707 W. MILL RD MILWAUKEE, WI 53218

TYPES OF ENTERTAINMENT (CHECK ALL THAT APPLY)

- | | | | |
|---|--|---|---|
| <input type="checkbox"/> Instrumental Musicians | <input type="checkbox"/> Battle of the Bands | <input type="checkbox"/> Dancing by Performers | <input checked="" type="checkbox"/> Amusement Machines
How many? <u>5</u> |
| <input type="checkbox"/> Bands | <input type="checkbox"/> Comedy Acts | <input type="checkbox"/> Adult Entertainment/
Strippers/Erotic Dance | <input type="checkbox"/> Concerts
Approx. # per year? _____ |
| <input checked="" type="checkbox"/> Bowling Alley
How many? <u>12 lanes</u> | <input type="checkbox"/> Disc Jockey | <input type="checkbox"/> Wrestling | <input type="checkbox"/> Theatrical Performances
Approx. # per year? _____ |
| <input checked="" type="checkbox"/> Pool Tables
How many? <u>1</u> | <input type="checkbox"/> Magic Shows | <input type="checkbox"/> Patron Contests | <input checked="" type="checkbox"/> Jukebox |
| <input type="checkbox"/> Motion Pictures (movies by
admission) - How many? _____ | <input type="checkbox"/> Poetry Readings | <input checked="" type="checkbox"/> Patrons Dancing | <input type="checkbox"/> Karaoke |
| <input checked="" type="checkbox"/> Other: <u>Dancing in Hall (lower level) - patrons dancing</u> | | | |

Entertainment Outdoor Closing Hours: 10:00pm Sunday-Thursday; 12:00am Friday & Saturday; unless a different time, either earlier or later, is established by the Common Council in its approval of the licensee's plan of operation.

PROMOTERS/SOUND AMPLIFICATION

Will promoters ever be used for any of the entertainment? No Yes If Yes, Describe:

At any time will sound amplification be used? No Yes If Yes, Describe: Bowling P.A. System digital music box

LEGAL CAPACITY OF PREMISES

275 (Call the Development Center at 414-286-8211 with questions.) Legal capacity determines the fee for your Public Entertainment Premises License. If you would like to request the license be approved with a lower capacity than that listed above, indicate the lower capacity here: _____. If approved, this lower capacity will print on your license and override the capacity listed on your Occupancy Permit.

ACKNOWLEDGEMENT/SIGNATURE

I understand that after the license has been issued, a change to the plan of operation will require a written request to change and approval from the Common Council. I agree to inform the City Clerk within 10 days of any substantial changes in the information supplied in this application. I understand that I shall not willfully refuse to provide the services offered under this license, or add charges or require deposits not required of the general public because of race, color, sex, religion, national origin or ancestry, age, handicap, lawful source of income, marital status, sexual orientation, gender identity or expression, familial status or the fact that a person is now or has been a member of the military service, whether dressed in uniform or not; and shall not seek such information as a condition of employment, or penalize any employee or discriminate in the selection of personnel for training or promotion on the basis of such information.

I have knowledge of the City Ordinances currently regulating public entertainment, and understand that the license may be subject to suspension, non-renewal or revocation, if I violate any rule, law or regulation of the city of Milwaukee and State of Wisconsin.

[Signature]
Signature of Sole Proprietor, Partner or 20% or More Shareholder
(If no 20% or more Shareholder, Corporate Officer - print name/title and sign)

Office Use Only:

Initials: _____ Filed: _____ App: _____

Only PEP? No Yes If Yes, Queue to MPD and Email Mgrs/Team Lead (must be heard w/in 60 days)

Menu Items

Chicken Wings

Chicken Tenders

Buffalo Wings

French Fries

Mozzarella Sticks

Nachos

Hot Dogs

Jerk Chicken

Egg Rolls

Tacos

Quesadillas

Cheesecake

Popcorn

Dispensed Soda / Lemonade

MILL ROAD

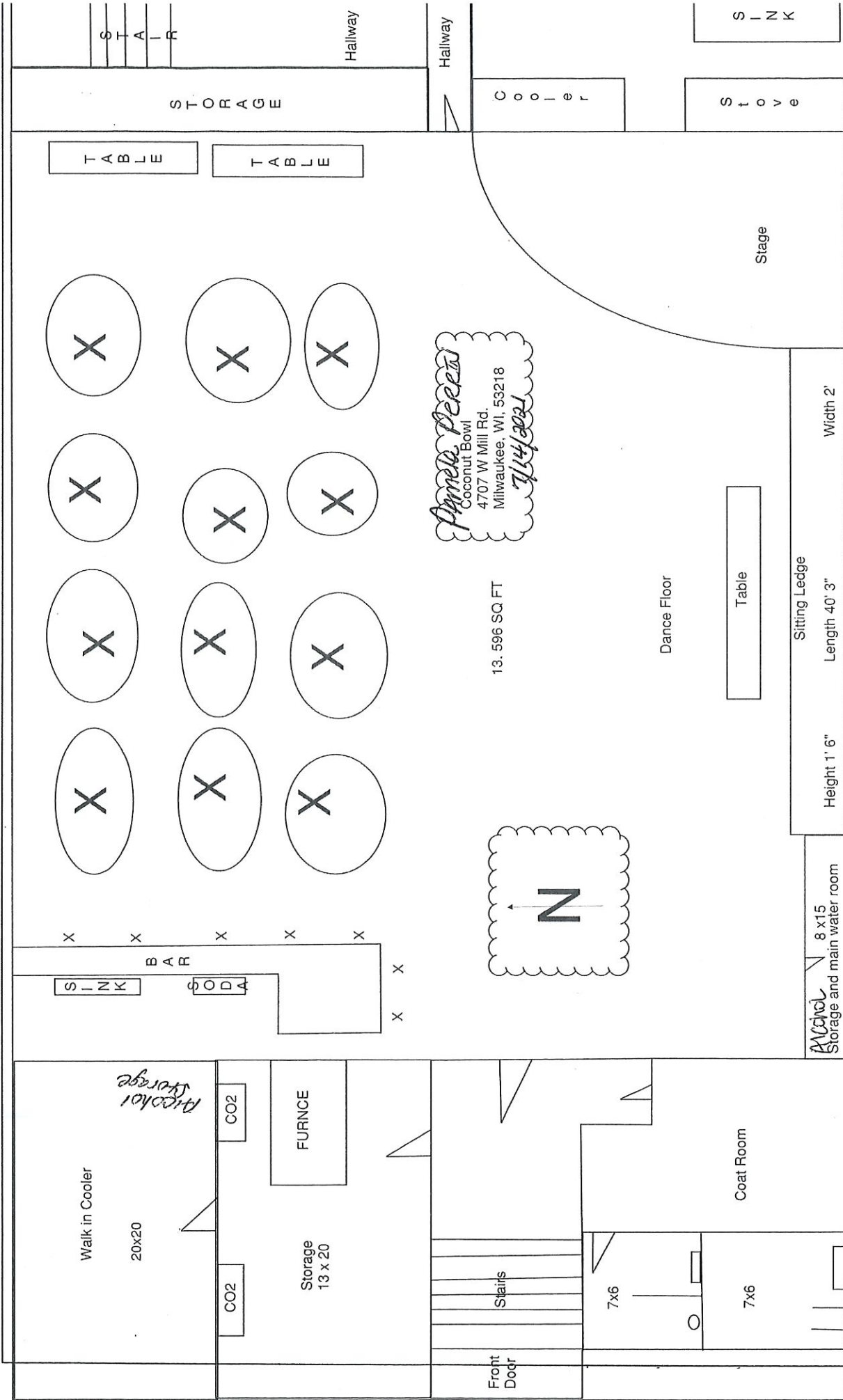

REVISIONS	
NO.	DATE

BASEMENT

