



CITY OF MILWAUKEE  
OFFICE OF THE CITY CLERK

Wednesday, October 05, 2016

COMMITTEE MEETING NOTICE

AD 12

RABINDER S KHAHRA

1831 W NATIONAL Av

MILWAUKEE, WI 53204

You are requested to attend a hearing which is to be held in Room 301-B, Third Floor, City Hall on:

**Tuesday, October 18, 2016 at 10:15 AM**

**Regarding:** Your Extended Hours Establishments and Food Dealer Renewal Applications for "NATIONAL QUICK MART" at 1831 W NATIONAL Av. 

There is a possibility that your application may be denied for one or more of the following reasons: The recommendation of the committee regarding the application shall be based on evidence presented at the hearing. Per MCO 85-4-4, unless otherwise specified in the code, probative evidence concerning non-renewal, suspension or revocation may include evidence of the following: failure of the applicant to meet municipal qualifications, pending charges against or the conviction of any felony, misdemeanor, municipal offense or other offense, the circumstances of which substantially relate to the circumstances of the particular licensed or permitted activity, by the applicant or by any employee or other agent of the applicant. If the activities of the applicant involve a licensed premises, whether the premises tends to facilitate a public or private nuisance or has been the source of congregations of persons which have resulted in any of the following: disturbance of the peace; illegal drug activity; public drunkenness; drinking in public; harassment of passers-by; gambling; prostitution; sale of stolen goods; public urination; theft; assaults; battery; acts of vandalism including graffiti, excessive littering, loitering, illegal parking, loud noise at times when the licensed premise is open for business; traffic violations; curfew violations; lewd conduct; display of materials harmful to minors, pursuant to s. 106-9.6; or any other factor which reasonably relates to the public health, safety and welfare, or failure to comply with the approved plan of operation. See attached police report or correspondence.

**Notice for applicants with warrants or unpaid fines:**

Proof of warrant satisfaction or payment of fines must be submitted at the hearing on the above date and time. Failure to comply with this requirement may result in a delay of the granting/denial of your application.

Failure to appear at this meeting may result in the denial of your license. Individual applicants must appear only in person or by an attorney. Corporate or Limited Liability applicants must appear only by the agent designated on the application or by an attorney. Partnership applicants must appear by a partner listed on the application or by an attorney. If you wish to do so and at your own expense, you may be accompanied by an attorney of your choosing to represent you at this hearing.

You will be given an opportunity to speak on behalf of the application and to respond and challenge any charges or reasons given for the denial. No petitions can be accepted by the committee, unless the people who signed the petition are present at the committee hearing and willing to testify. You may present witnesses under oath and you may also confront and cross-examine opposing witnesses under oath. If you have difficulty with the English language, you should bring an interpreter with you, at your expense, so that you can answer questions and participate in your hearing.

You may examine the application file at this office during regular business hours prior to the hearing date. Inquiries regarding this matter may be directed to the person whose signature appears below.

Limited parking for persons attending meetings in City Hall is available at reduced rates (5 hour limit) at the Milwaukee Center on the southwest corner of East Kilbourn and North Water Street. Parking tickets must be validated in the first floor information booth in City Hall.

PLEASE NOTE: Upon reasonable notice, efforts will be made to accommodate the needs of disabled individuals through sign language interpreters or other auxiliary aids. For additional information or to request this service, contact the Council Services Division ADA Coordinator at (414) 286-2998, Fax - (414) 286-3456, TDD - (414) 286-2025.

JIM OWCZARSKI, CITY CLERK

BY: \_\_\_\_\_



Jason Schunk  
License Division Manager

**If you have questions regarding this notice, please contact the License Division at (414) 286-2238.**

200 E. Wells Street, Room 105, City Hall, Milwaukee, WI 53202. [www.milwaukee.gov/license](http://www.milwaukee.gov/license)  
Phone: (414) 286-2238 Fax: (414) 286-3057 Email Address: [License@milwaukee.gov](mailto:License@milwaukee.gov)

MILWAUKEE POLICE DEPARTMENT  
LICENSE INVESTIGATION UNIT

CRIMINAL RECORD/ORDINANCE VIOLATION/INCIDENTS  
SYNOPSIS

DATE: 09/01/16  
LICENSE TYPE: 24 HOURS  
NEW:  
RENEWAL: X

No. 236779  
Application Date:  
Expiration Date:

License Location: 1831 W National Av  
Business Name: National Quick Mart

Aldermanic District:

Licensee/Applicant: Khahra, Rabinder S  
(Last Name, First Name, MI)  
Date of Birth: 12/05/1959

Home Address: N38W7588 Greystone Ct  
City: Cedarburg State: WI Zip Code: 53012  
Home Phone: (262) 375 – 1006

This report is written by Police Officer KUKOWSKI, assigned to the License Investigation Unit, Days.

The Milwaukee Police Department's investigation regarding this application revealed the following convictions:

- 08/24/2005 Filling Station Security Camera Required Milwaukee Municipal Court
- 09/01/2005 B & Z Violations Milwaukee Municipal Court
- On 12/03/2011 at 4:40pm the applicant was cited at 5904 W. Hampton Ave. in the city of Milwaukee for Sale of Cigarettes to Minor/Underage.

Charge: Sale of Cigarettes to Minor/Underage  
Finding: **Guilty**  
Sentence: Fined \$70.00  
Date: 03/02/12  
Case: 12000981

Incident # 3 previously reported, disposition now added on 02/07/13.

- On 12/05/15, Milwaukee police were working the Wisconsin WINS Tobacco Initiative and had an underage student enter 1831 W National Avenue in attempts to purchase tobacco products. The student purchased a 2 pack Cigarillo without being asked for ID. The clerk was identified as Azeen Mohammed and Mohammed was advised that an enrollment letter for the M.A.R.T.S program would be mailed to the agent.

# MILWAUKEE POLICE DEPARTMENT

## REPORT OF INCIDENTS INVOLVING LICENSED PERSONS OR PREMISES

TO: Derrick HARRIS

Business Name: National Quick Mart  
Address of Licensed Premises: 1831 W. National Ave  
Business Phone:

District: 2

Type of License: Extended Hours

Violation /  Incident #

Date of Incident: 12/05/2015

Licensee or Manager on premises at time of violation / incident?  Yes  No

Licensee cooperative?  Yes  No (if no, explain in narrative section)

Licensee Notified by Officer: P.O. Jennifer PHILLIPS

Date: 12/05/2015

Time: 11:15am

Licensee or Agent's Name: Rabinder S. KHAHRA  
Home Address: N38 W 7588 Greystone Ct Cedarburg Wi 53012

Date of Birth: 15/05/1959  
Home Phone: 414-322-1015

Co-Licensee Name:  
Home Address:  
Class S License Number:

Date of Birth:  
Home Phone:

Bartender Name:  
Home Address:  
Class D License Number:

Date of Birth:  
Home Phone:

Licensed Person / Public Pass. Vehicle, etc.:  
Home Address:  
Class D License Number:

Date of Birth:  
Home Phone:

### VIOLATION/INCIDENT - DESCRIBE FACTS AND CIRCUMSTANCES IN NARRATIVE SECTION

Name of Person Cited:  
Citation Number:

Violation & Ord. / Statue No.:

Date of Birth:  
Court Date:

Name of Person Cited:  
Citation Number:

Violation & Ord. / Statue No.:

Date of Birth:  
Court Date:

Name of Person Cited:  
Citation Number:

Violation & Ord. / Statue No.:

Date of Birth:  
Court Date:

Name of Person Cited:  
Citation Number:

Violation & Ord. / Statue No.:

Date of Birth:  
Court Date:

Name of Person Cited:  
Citation Number:

Violation & Ord. / Statue No.:

Date of Birth:  
Court Date:

Investigating Officer: P.O. Jennifer Phillips

District / Bureau: Central Bk

Date: 12/05/2015

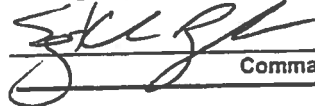

Commanding Officer

12-09-15

Date

### DISPOSITION - FOR LICENSING ONLY

Citation No.	Case Number	Disposition	Judge	Date
		LICENSE INVESTIGATION UNIT		
		Issued 12-09-15		
		Referred		

By 

PA-33E Narrative

This report was written by P.O. Jennifer Phillips, assigned to Central Booking, Late Shift.

On Saturday, December 5, 2015, I was assigned to the Wisconsin Wins Tobacco Initiative, which checks area vendors for age compliance tobacco purchases. Assisting in this assignment was Timothy WILKINS B/M 9/01/98 of 35256 W Sarnow St Milwaukee, WI 53208. WILKINS is 17 years old and not of legal age to purchase tobacco. A photo of WILKINS was taken at the beginning of the assignment for identification.

At approximately 11:15am, WILKINS entered National Quick Mart at 1831 W. National Ave and purchased a 2 pack Cigarillo. WILKINS provided a description of the cashier that sold her the tobacco. I entered the store and spoke with the cashier that matched the description. The subject was identified as Azeen MOHAMMED. MOHAMMED admitted he sold WILKINS tobacco. MOHAMMED was advised an enrollment letter for the M.A.R.T.S. program would be mailed to the agent.



Wednesday, October 05, 2016



# Notice of Public Hearing

---

KHAHRA, Rabinder S  
NATIONAL QUICK MART at 1831 W NATIONAL Av  
Extended Hours Establishments and Food Dealer Renewal Applications

**Tuesday, October 18, 2016 at 10:15 AM**

To whom it may concern:

The above application has been made by the above named applicant(s). This requires approval from the Licenses Committee and the Common Council of the City of Milwaukee. The hearing before the Licenses Committee will take place on 10/18/2016 at 10:15 AM, in Room 301-B, Third Floor, City Hall. If you wish, you may provide testimony at the hearing regarding the request; see below for further information. You are not required to attend the hearing. Once the Licenses Committee makes its recommendation, this recommendation is forwarded to the full Common Council for approval at its next regularly scheduled hearing. Please review the information below and if you have further questions regarding this process, please contact the License Division at (414) 286-2238.

---

## Important details for those wishing to provide information for the Licenses Committee to consider when making its recommendation:

1. The license application is scheduled to be heard at the above time. Due to other hearings running longer than scheduled, you may have to wait some time to provide your testimony.
2. You must appear in person and testify as to matters that you have personally experienced or seen. (You cannot provide testimony for your neighbor, parent or anyone else; this is considered hearsay and cannot be considered by the committee.)
3. No letters or petitions can be accepted by the committee (unless the person who wrote the letter or the persons who signed the petition are present at the committee hearing and willing to testify).
4. Persons opposed to the license application are given the opportunity to testify first; supporters may testify after the opponents have finished.
5. When you are called to testify, you will be sworn in and asked to give your name, and address. (If your first and/or last names are uncommon please spell them.)
6. You may then provide testimony.
  - a. Include only information relating to the above license application.
  - b. Include only information you have personally witnessed or seen.
  - c. Provide concise and relevant information detailing how this business has affected or may affect the peaceful enjoyment of your neighborhood.
  - d. If by the time you have the opportunity to testify, the information you wish to share has already been provided to the committee, you may state that you agree with the previous testimony. Redundant or repetitive testimony will not assist the committee in making its recommendation.
7. After giving your testimony, the members of the Licenses Committee and the licensee may ask questions regarding the testimony you have given or other factors relating to the license application.
8. Business Competition is not a valid basis for denial or non-renewal of a license.  
**Please Note: If you have submitted an objection to the above application your objection cannot be considered by the committee unless you personally testify at the hearing.**

OCCUPANT	MAIL ADDRESS	CITY AND ZIP CODE
CURRENT OCCUPANT	824 S 20TH ST	MILWAUKEE, WI 53204-1143
CURRENT OCCUPANT	808 S 18TH ST	MILWAUKEE, WI 53204-1125
CURRENT OCCUPANT	814 S 18TH ST	MILWAUKEE, WI 53204-1125
CURRENT OCCUPANT	828 S 18TH ST	MILWAUKEE, WI 53204-1125
CURRENT OCCUPANT	834 S 18TH ST	MILWAUKEE, WI 53204-1125
CURRENT OCCUPANT	912 S 19TH ST	MILWAUKEE, WI 53204-1167
CURRENT OCCUPANT	911A S 18TH ST	MILWAUKEE, WI 53204-1128
CURRENT OCCUPANT	903 S 18TH ST	MILWAUKEE, WI 53204-1128
CURRENT OCCUPANT	911 S 18TH ST	MILWAUKEE, WI 53204-1128
CURRENT OCCUPANT	904 S 19TH ST	MILWAUKEE, WI 53204-1167
CURRENT OCCUPANT	827 S 18TH ST C	MILWAUKEE, WI 53204-4106
CURRENT OCCUPANT	829 S 19TH ST 6	MILWAUKEE, WI 53204-1100
CURRENT OCCUPANT	821 S 18TH ST	MILWAUKEE, WI 53204-1126
CURRENT OCCUPANT	816 S 18TH ST	MILWAUKEE, WI 53204-1125
CURRENT OCCUPANT	915 S 18TH ST A	MILWAUKEE, WI 53204-1128
CURRENT OCCUPANT	827 S 18TH ST A	MILWAUKEE, WI 53204-4106
CURRENT OCCUPANT	900 S 20TH ST	MILWAUKEE, WI 53204-1145
CURRENT OCCUPANT	813 S 18TH ST A	MILWAUKEE, WI 53204-4104
CURRENT OCCUPANT	820A S 18TH ST	MILWAUKEE, WI 53204-1125
CURRENT OCCUPANT	909 S 18TH ST	MILWAUKEE, WI 53204-1128
CURRENT OCCUPANT	909A S 18TH ST	MILWAUKEE, WI 53204-1128
CURRENT OCCUPANT	836 S 19TH ST	MILWAUKEE, WI 53204-1165
CURRENT OCCUPANT	827 S 18TH ST D	MILWAUKEE, WI 53204-4106
CURRENT OCCUPANT	907 S 19TH ST	MILWAUKEE, WI 53204-1168
CURRENT OCCUPANT	829 S 19TH ST 3	MILWAUKEE, WI 53204-1100
CURRENT OCCUPANT	822 S 20TH ST	MILWAUKEE, WI 53204-1143
CURRENT OCCUPANT	813 S 18TH ST B	MILWAUKEE, WI 53204-4104
CURRENT OCCUPANT	802 S 18TH ST	MILWAUKEE, WI 53204-1125
CURRENT OCCUPANT	903A S 18TH ST	MILWAUKEE, WI 53204-1128
CURRENT OCCUPANT	829 S 19TH ST 5	MILWAUKEE, WI 53204-1100
CURRENT OCCUPANT	829 S 19TH ST 4	MILWAUKEE, WI 53204-1100
CURRENT OCCUPANT	818 S 20TH ST	MILWAUKEE, WI 53204-1143
CURRENT OCCUPANT	813 S 18TH ST D	MILWAUKEE, WI 53204-4104
CURRENT OCCUPANT	906 S 19TH ST	MILWAUKEE, WI 53204-1167
CURRENT OCCUPANT	905 S 18TH ST	MILWAUKEE, WI 53204-1128
CURRENT OCCUPANT	913 S 19TH ST	MILWAUKEE, WI 53204-1168
CURRENT OCCUPANT	829 S 19TH ST 2	MILWAUKEE, WI 53204-1100
CURRENT OCCUPANT	813 S 18TH ST C	MILWAUKEE, WI 53204-4104
CURRENT OCCUPANT	823 S 18TH ST	MILWAUKEE, WI 53204-1126
CURRENT OCCUPANT	915 S 18TH ST	MILWAUKEE, WI 53204-1128
CURRENT OCCUPANT	908 S 19TH ST	MILWAUKEE, WI 53204-1167
CURRENT OCCUPANT	902 S 19TH ST	MILWAUKEE, WI 53204-1167
CURRENT OCCUPANT	834 S 19TH ST	MILWAUKEE, WI 53204-1165
CURRENT OCCUPANT	833 S 18TH ST	MILWAUKEE, WI 53204-1126
CURRENT OCCUPANT	835 S 18TH ST	MILWAUKEE, WI 53204-1126
CURRENT OCCUPANT	822 S 19TH ST	MILWAUKEE, WI 53204-1165
CURRENT OCCUPANT	827 S 18TH ST B	MILWAUKEE, WI 53204-4106
CURRENT OCCUPANT	907A S 19TH ST	MILWAUKEE, WI 53204-1168
CURRENT OCCUPANT	829 S 19TH ST 1	MILWAUKEE, WI 53204-1100
CURRENT OCCUPANT	828 S 20TH ST	MILWAUKEE, WI 53204-1143
CURRENT OCCUPANT	830 S 20TH ST	MILWAUKEE, WI 53204-1143
CURRENT OCCUPANT	820 S 20TH ST	MILWAUKEE, WI 53204-1143
CURRENT OCCUPANT	821 S 19TH ST	MILWAUKEE, WI 53204-1166
CURRENT OCCUPANT	820 S 18TH ST	MILWAUKEE, WI 53204-1125
CURRENT OCCUPANT	824 S 18TH ST	MILWAUKEE, WI 53204-1125

---

**Total Records: 56**

**Radius: 250.0 feet and Center of Circle: 1831 W National AV**



**EXTENDED HOURS ESTABLISHMENT  
RENEWAL LICENSE SUPPLEMENTAL  
APPLICATION & PLAN OF OPERATION**

Office of the City Clerk License Division  
200 E. Wells St. Room 105, Milwaukee, WI 53202  
(414) 286-2238 email address: [license@milwaukee.gov](mailto:license@milwaukee.gov) [www.milwaukee.gov/license](http://www.milwaukee.gov/license)

Current License # **24HRS 197897**  
Legal Name: **NATIONAL QUICK MART**  
Premises Address: **1831 W NATIONAL AV**

**Business Operations**

**RESTAURANTS ONLY:**

Legal Occupancy Limit/Capacity ▶ \_\_\_\_\_

**RESTAURANTS & PERSONAL SERVICE ESTABLISHMENTS ONLY:**

Number of Off-Street Parking Places ▶ \_\_\_\_\_

Are there any changes to the current hours of operation or number of customers expected each day?

NO IF NO, SKIP THIS SECTION

YES IF YES, DESCRIBE: \_\_\_\_\_

Check here if the proposed change to hours should be applied to a Food License.

Your current hours of operation are listed on your current license.

**Litter & Noise**

Are there any changes to your Litter/Noise plan?  NO IF NO, SKIP THIS SECTION

YES IF YES, ANSWER QUESTIONS BELOW

What are your plans to keep the grounds clean?  Sweep  Pressure Wash  Pick Up Litter  Hired Maintenance  
 Building Owner's Responsibility  Garbage Cans Outside  Other \_\_\_\_\_

How often will the grounds be cleaned?  Daily  Weekly  As Needed  Monthly  Other \_\_\_\_\_

Who will keep the grounds clean?  Licensee  Building Owner  Employees  Hired Maintenance  Other \_\_\_\_\_

How are noise issues prevented/addressed?  Security  Manager approaches customer(s)  Call police  Signs posted   
Other \_\_\_\_\_

**Signature**

SIGNATURE of individual, partner, agent or 20% or more shareholder: *D. K. Huber*







**CITY OF MILWAUKEE  
OFFICE OF THE CITY CLERK**

Wednesday, October 05, 2016

**COMMITTEE MEETING NOTICE**

AD 12

PLACENCIA VERA, Ramiro, Agent  
El Botanero LLC  
2875 S 33rd St

Milwaukee, WI 53215

You are requested to attend a hearing which is to be held in Room 301-B, Third Floor, City Hall on:

**Tuesday, October 18, 2016 at 10:15 AM**

**Regarding:** Your Class B Tavern and Public Entertainment Pr  License Applications Requesting Bands, Disc Jockey, Karaoke, and Patrons Dancing as agent for "El Botanero LLC" for "El Botanero" at 1428 W Lincoln Av.

There is a possibility that your application may be denied for one or more of the following reasons: The recommendation of the committee regarding the application shall be based on evidence presented at the hearing. Per MCO 85-2.7-4, probative evidence concerning whether or not a new license should be granted may be presented on the following subjects: whether or not the applicant meets the municipal requirements, the appropriateness of the location and premises where the licensed premises is to be located and whether use of the premises for the purposes or activities permitted by the license would tend to facilitate a public or private nuisance or create undesirable neighborhood problems such as disorderly patrons, unreasonably loud noise, litter, and excessive traffic and parking congestion. Probative evidence relating to these matters may be taken from the plan of operation submitted with the license application, if any, but shall not include the content of any music. Evidence regarding the fitness of the location of the premises to be maintained as the principal place of business, including but not limited to whether there is an overconcentration of businesses of the type for which the license is sought; whether the proposal is consistent with any pertinent neighborhood business or development plans, or the location's proximity to areas where children are typically present. The applicant's record in operating similarly licensed premises; and whether or not the applicant has been charged with or convicted of any felony, misdemeanor, municipal offense or other offense, the circumstances of which substantially relate to the activity to be permitted by the license being applied for or any other factor which reasonably relates to the public health, safety or welfare may also be considered. See attached police report or correspondence.

**Notice for applicants with warrants or unpaid fines:**

**Proof of warrant satisfaction or payment of fines must be submitted at the hearing on the above date and time. Failure to comply with this requirement may result in a delay of the granting/denial of your application.**

Failure to appear at this meeting may result in the denial of your license. Individual applicants must appear only in person or by an attorney. Corporate or Limited Liability applicants must appear only by the agent designated on the application or by an attorney. Partnership applicants must appear by a partner listed on the application or by an attorney. If you wish to do so and at your own expense, you may be accompanied by an attorney of your choosing to represent you at this hearing.

You will be given an opportunity to speak on behalf of the application and to respond and challenge any charges or reasons given for the denial. No petitions can be accepted by the committee, unless the people who signed the petition are present at the committee hearing and willing to testify. You may present witnesses under oath and you may also confront and cross-examine opposing witnesses under oath. If you have difficulty with the English language, you should bring an interpreter with you, at your expense, so that you can answer questions and participate in your hearing.

You may examine the application file at this office during regular business hours prior to the hearing date. Inquiries regarding this matter may be directed to the person whose signature appears below.

Limited parking for persons attending meetings in City Hall is available at reduced rates (5 hour limit) at the Milwaukee Center on the southwest corner of East Kilbourn and North Water Street. Parking tickets must be validated in the first floor information booth in City Hall.

PLEASE NOTE: Upon reasonable notice, efforts will be made to accommodate the needs of disabled individuals through sign language interpreters or other auxiliary aids. For additional information or to request this service, contact the Council Services Division ADA Coordinator at (414) 286-2998, Fax - (414) 286-3456, TDD - (414) 286-2025.

JIM OWCZARSKI, CITY CLERK

BY:   
\_\_\_\_\_  
Jason Schunk  
License Division Manager

**If you have questions regarding this notice, please contact the License Division at (414) 286-2238.**

200 E. Wells Street, Room 105, City Hall, Milwaukee, WI 53202. [www.milwaukee.gov/license](http://www.milwaukee.gov/license)  
Phone: (414) 286-2238 Fax: (414) 286-3057 Email Address: [License@milwaukee.gov](mailto:License@milwaukee.gov)

Date:09/24/16  
Officer: Efrain Cornejo

City of Milwaukee Police Department  
90-5-1.5 Crime Prevention Survey  
Tavern Inspection

Name of Premise: El Botanero  
Address: 1428 W Lincoln Av  
Phone: (414) 808-0689

Owner: El Botanero LLC  
Owner address: 2875 S 33<sup>rd</sup> St  
City State Zip: Milwaukee, WI 53215  
Owner Phone: (414) 841-5614  
Owner email:

Licensee/Agent: Ramiro Plascencia-Vera  
Home Address: 2875 S 33rd St  
City State Zip: Milwaukee, WI 53215  
Phone: (414) 841-5614  
Email:

Preferred contact: Ramiro Plascencia-Vera

Location currently open:  YES  NO

Projected open date: October 2016

Day's open: S M T W Th F SA ALL

Hours of Operation: Sun: 7AM-2AM  
Mon: 7AM-2AM  
Tue: 7AM-2AM  
Wed: 7AM-2AM  
Thu: 7AM-2AM  
Fri: 7AM-2AM  
Sat: 7AM-2AM  
24 hours Y N

Premise Type: Tavern/Bar  
Restaurant  
Other:

Licenses currently held:

- Alcohol:  Yes  No Class: #:  
Tobacco:  Yes  No #:  
Food:  Yes  No #:  
Other:  Yes  No Type: #:  
Other:  Yes  No Type: #:

**Exterior Survey:**

1. Is the area around the location clean?  Yes  No
2. What surrounds the location? (Check all the apply)
  - a.  Park
  - b.  School
  - c.  Youth Center
  - d.  Church
  - e.  Tavern(s) If so, how many<sup>3</sup>
  - f.  Residential
  - g.  Other businesses
  - h.  Other:
3. Can you see from the outside of the location into the interior  Yes  No
4. Can you see the employees inside of the location from the outside  Yes  No
5. Are exterior windows free of signage  Yes  No
6. Street parking  Yes  No
7. Is there a parking lot  Yes  No
8. Is the parking lot clean?  Yes  No
9. Is the parking lot well lit?  Yes  No
10. Valet Parking  Yes  No
  - a. Will this lot have a guard?  Yes  No
  - b. Will this lot have cameras?  Yes  No
11. Are there areas where a person could conceal themselves  Yes  No
12. Is there exterior lighting?  Yes  No. Does it appears to be adequate  Yes  No
13. Exterior Payphone?  Yes  No
14. Are there No Loitering Signs posted?  Yes  No
15. Are there exterior security cameras  Yes  No How Many:
16. Are the address numbers prominently displayed and easy to see  Yes  No

**Camera Survey:**

17. Does this location have security cameras?  Yes  No
18. Are they in working order?  Yes  No
19. What format are the cameras?
  - a. Color  Yes  No
  - b. Digital  Yes  No
  - c. VCR  Yes  No
  - d. Recorded  Yes  No
20. How long is footage stored for later viewing:
21. Are there exterior cameras  Yes  No How many:
22. Are there interior cameras  Yes  No How many:

23. Do all employees know how to retrieve recorded digital images/footage?  Yes  No  
 24. Cameras located in parking lot  Yes  No How many

**Interior Survey:**

25. What is the planned/posted capacity 99  
 26. What is the minimum number of employees that will be on premise 4  
 27. Is the storeowner willing to be a standing complainant regarding loitering?  Yes  No  
     a. If yes have them fill out the standing complaint form and give them two of the commercial signs  Yes  No  
 28. Is the interior of the location neat and clean?  Yes  No  
 29. Does an interior camera face the entrance/exit?  Yes  No  
 30. Are emergency and non-emergency numbers posted near the phone?  Yes  No  
 31. Does the owner know how to contact their police district directly?  Yes  No  
     a. Did you provide a district contact guide to the owner?  Yes  No

**Security**

32. How many security personnel are going to be employed: 0  
 33. How will they be deployed: Interior Exterior  
 34. What days will they be deployed  Mon  Tue  Wed  Thu  Fri  Sat  Sun  
 35. Will the security be managed by business  or contracted   
 36. Will they be armed  Yes  No  
 37. What type of security measures will be used:  
      Wanding/metal detector  
      ID Scanner  
      Dress Code  
      Cover Charge  
      Age restriction  
      Other  
 38. When at capacity, how will the overflow crowd be managed? Applicant stated he would have customers wait outside until he has room for capacity.  
 39. Will a guard monitor the overflow crowd at all times?  Yes  No

**ADDITIONAL COMMENTS/RECOMMENDATIONS:**

Applicant stated he applied for a Public Entertainment Public Premise because he has a hall in the second floor that he wants to rent out. He stated he plans on running a restaurant on the main level with a banquet hall in the second level. Applicant stated he has a four camera surveillance system but he has not installed it yet.

# Alcohol License Concentration for 1428 W Lincoln Ave

City of Milwaukee, Wisconsin

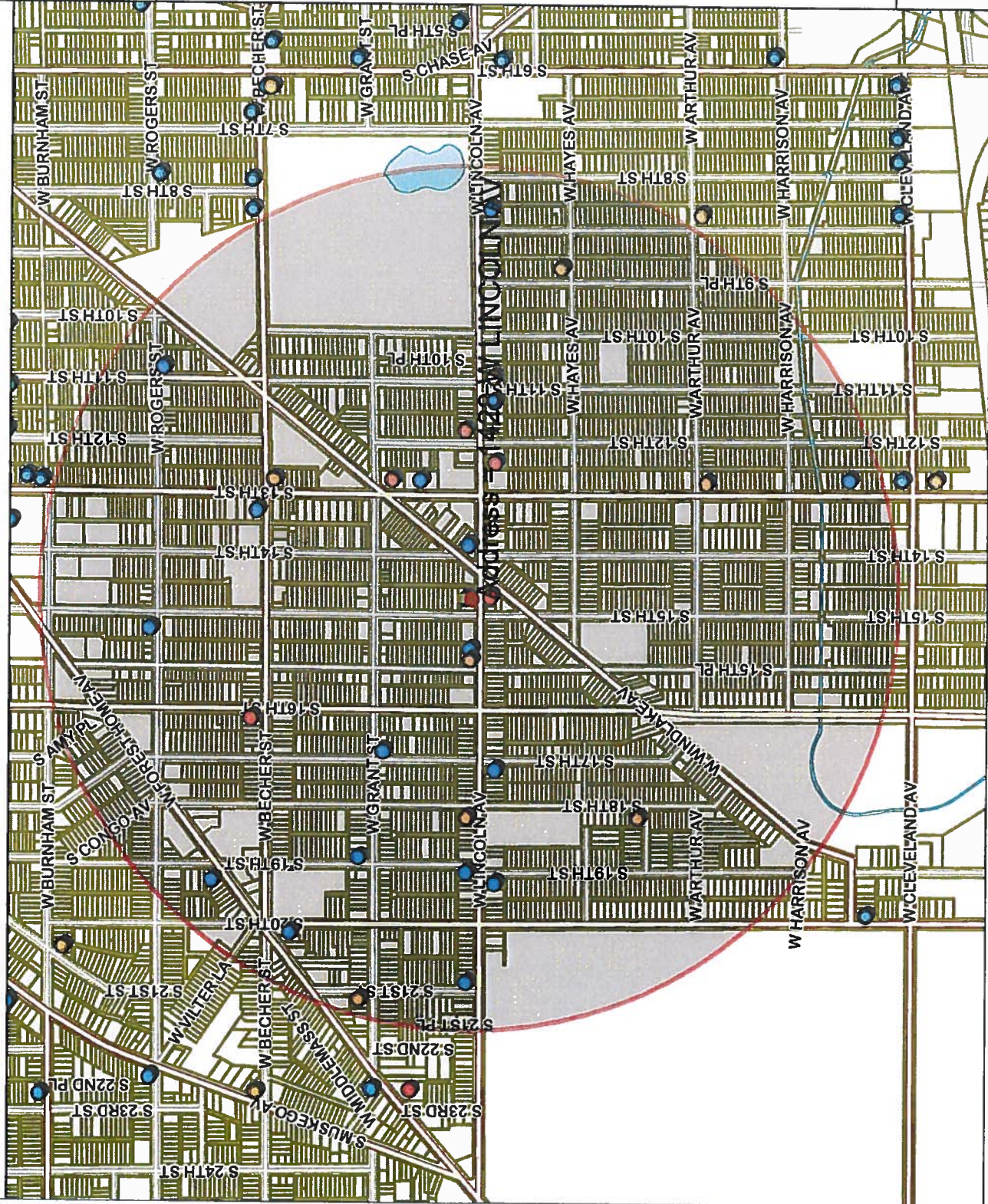

## - Legend -

- City limits
- Parcels
- Freeways
- Exit ramps
- Entry ramps
- Major streets
- Streets
- Waterways
- Alcohol licenses
  - Class A intoxicating liquor
  - Class A fermented malt beverage
  - Class A liquor and malt
  - Class B fermented malt beverage
  - Class B tavern
  - Class C wine retailer

## - Notes -

Licensed Alcohol Establishments Within a .5 Mile Radius Centered on 1428 W Lincoln Ave on 08/02/2016



Department of Administration - ITMD



Map Scale: 1: 10,396

Disclaimer  
8/2/2016

© City of Milwaukee, Wisconsin  
Map Milwaukee: Property Information

Licensed Alcohol Establishments Within a .5 Mile Radius Centered on 1428 W Lincoln Ave on 08/02/2016

Legal entity	Trade name	Licensee	Address	License type name	Total capacity	Room capacity	Expiration date
ABDELAL, LLC	GRANT MARKET	SAED F ABDELAL, Agt	2100 W GRANT ST	Class A Fermented Malt Beverage Retailer's License			5/14/2017
Amatitan Groceries LLC	Amatitan Groceries	Byron F Gudiel, Agt	2366 S 9th PL	Class A Fermented Malt Beverage Retailer's License			7/21/2017
Baba Narak, Inc	Los Amigos	Jatinder S Dhaliwal, Agt	2100 S 13TH ST	Class A Fermented Malt Beverage Retailer's License			7/21/2017
Beer Town LLC	Beer Town	PARAMJIT KAUR, Agt	1029 W Lincoln AV	Class A Fermented Malt Beverage Retailer's License			4/3/2017
Lincoln Express, Inc.	Express Pantry	PETTY BABBER, Agt	1804 W Lincoln AV	Class A Fermented Malt Beverage Retailer's License			5/4/2017
PG MINI MARKET	PG MINI MARKET	KARAMVIR K DHALIWAL, Agt	2500 S 13TH ST	Class A Fermented Malt Beverage Retailer's License			7/6/2017
ROMANS FOODS	ROMANS FOODS	NEDAL K ASSAD, SP	2441 S 18TH ST	Class A Fermented Malt Beverage Retailer's License			5/15/2017
YASMINE FOODS, LLC	LINCOLN SUPERMARKET	LOAI A ATARI, Agt	1534 W LINCOLN AV	Class A Fermented Malt Beverage Retailer's License			12/11/2016
A & J POLISH DELI, INC	A & J POLISH DELI	JADWIGA T ROZAK, Agt	1215 W LINCOLN AV	Class A Malt & Class A Liquor License			10/10/2016
BEER CAPITAL	BEER CAPITAL	PARAMJIT SINGH, SP	1600 W BECHER ST	Class A Malt & Class A Liquor License			9/25/2016
EL LUCERO LIQUOR, INC	EL LUCERO LIQUOR	HANIN K ABDELRAHIM, Agt	1132-A W LINCOLN AV	Class A Malt & Class A Liquor License			6/6/2017
KOTHALA, LLC	SOUTHSIDE BEER & LIQUOR	JASBIR S PANU, Agt	1434 W WINDLAKE AV	Class A Malt & Class A Liquor License			6/14/2017
VILLARREAL LLC	MI SUPER MERCADO	CARMEN VILLARREAL, Agt	2200 S 13TH ST	Class A Malt & Class A Liquor License			12/11/2016
3 HERMANOS, INC	3 Hermanos Club	RAMON OROZCO, Agt	1332 W LINCOLN AV	Class B Tavern License	163		6/30/2017
ANNA'S TAP	ANNA'S TAP	SAMANTHA L RITCHIE, SP	1838 W GRANT ST	Class B Tavern License	25		2/13/2017
Davez Barz, LLC	The Last Drop	DAVID NUNEZ-CRUZ, Agt	1979 S 15TH ST	Class B Tavern License			11/4/2016
Divino Pancho's LLC	Divino Pancho's	Adriana Castelan, Agt	1701 W Lincoln AV	Class B Tavern License	99		8/25/2016
El Carmiante LLC	El Escape Night Club	Jose Alberto Lopez, Agt	1900 W LINCOLN AV	Class B Tavern License			7/28/2017
HOLLER HOUSE	HOLLER HOUSE	TODD C STUCKERT, SP	2042 W LINCOLN AV	Class B Tavern License	50		6/30/2017
Irene's Catering Service, Inc	Irene's Catering Service, Inc	Thomas E Rewolinski, Agt	1901 W Lincoln AV	Class B Tavern License		60 1st floor 70 beer garden	10/19/2016
J J BROTHERS	J J BROTHERS	JORGE L DIAZ, SP	2644 S 13TH ST	Class B Tavern License	130		1/21/2017
LA GUADALUPANA	LA GUADALUPANA	ANA M RAZO, SP	1520 W LINCOLN AV	Class B Tavern License	99		10/6/2016
MESA GARIBALDI, LLC	FIESTA GARIBALDI	VALDEMAR ESCOBAR, Agt	821-23 W LINCOLN AV	Class B Tavern License			12/12/2016
NEON LIGHTS	NEON LIGHTS	CHUE H XIONG, SP	1904 W FOREST HOME AV	Class B Tavern License	50		12/9/2016
PRIMOS PLACE	PRIMOS PLACE	ENRIQUE TERRONES, SP	1631 W GRANT ST	Class B Tavern License	62		3/7/2017
PROMOCIONES MEXICAS LLC	EL GRANT TEOCALI	PALOMA NAVA, Agt	2011 W FOREST HOME AV	Class B Tavern License	282		5/4/2017
Restaurant Bar La Nibera LLC	Restaurant Bar La Nibera	Juan J Sanchez, Agt	1428 W Lincoln AV	Class B Tavern License	99		11/23/2016
RICHIE'S PUB	RICHIE'S PUB	ELISA MALDONADO, Agt	2000 S 11TH ST	Class B Tavern License	25		7/26/2017
SHORTY'S CATERING, INC	SHORTY'S CATERING & RESTAURANT	ANGEL GUTIERREZ GARNICA, SP	2075-79 S 13TH ST	Class B Tavern License	156	Restaurant = 49, Hall = 107	9/21/2016
TAQUERIA EL JALAPENO	TAQUERIA EL JALAPENO	FRANCISCO MONTENEGRO, Agt	2222 S 13TH ST	Class B Tavern License	80		1/16/2017
TAQUERIA LA SALSA, LLC	TAQUERIA LA SALSA		1105 W LINCOLN AV	Class B Tavern License			11/25/2016
						Grand Total = 31	
						Total	



Wednesday, October 05, 2016

## Licenses Committee Notice of Hearing

Angel Gutierrez  
Josefina Gutierrez  
2431 S 9TH St

Milwaukee, WI 53215

Date: 10/18/2016  
Time: 10:15 AM  
Location: Room 301-B, Third Floor, City Hall

The Licenses Committee will consider the following license application:

Class B Tavern and Public Entertainment Premises License Applications  
Requesting Bands, Disc Jockey, Karaoke, and Patrons Dancing  
PLACENCIA VERA, Ramiro, Agent  
El Botanero at 1428 W Lincoln Av

Please note this application may be recommended for denial based on fitness of the location due to concentration of alcohol beverage outlets in the area. If the application is denied for this reason, no other application for an alcohol beverage license for this location shall be recommended for approval by the Licenses Committee within three years of the date of denial unless the applicant has demonstrated a change of circumstances since the prior denial.

If you have any questions, please call (414) 286-2238.







Wednesday, October 05, 2016



# Notice of Public Hearing

---

PLACENCIA VERA, Ramiro, Agent  
El Botanero at 1428 W Lincoln Av

Class B Tavern and Public Entertainment Premises License Applications Requesting Bands, Disc Jockey, Karaoke, and Patrons Dancing

**Tuesday, October 18, 2016 at 10:15 AM**

To whom it may concern:

The above application has been made by the above named applicant(s). This requires approval from the Licenses Committee and the Common Council of the City of Milwaukee. The hearing before the Licenses Committee will take place on 10/18/2016 at 10:15 AM, in Room 301-B, Third Floor, City Hall. If you wish, you may provide testimony at the hearing regarding the request; see below for further information. You are not required to attend the hearing. Once the Licenses Committee makes its recommendation, this recommendation is forwarded to the full Common Council for approval at its next regularly scheduled hearing. Please review the information below and if you have further questions regarding this process, please contact the License Division at (414) 286-2238.

---

## Important details for those wishing to provide information for the Licenses Committee to consider when making its recommendation:

1. The license application is scheduled to be heard at the above time. Due to other hearings running longer than scheduled, you may have to wait some time to provide your testimony.
2. You must appear in person and testify as to matters that you have personally experienced or seen. (You cannot provide testimony for your neighbor, parent or anyone else; this is considered hearsay and cannot be considered by the committee.)
3. No letters or petitions can be accepted by the committee (unless the person who wrote the letter or the persons who signed the petition are present at the committee hearing and willing to testify).
4. Persons opposed to the license application are given the opportunity to testify first; supporters may testify after the opponents have finished.
5. When you are called to testify, you will be sworn in and asked to give your name, and address. (If your first and/or last names are uncommon please spell them.)
6. You may then provide testimony.
  - a. Include only information relating to the above license application.
  - b. Include only information you have personally witnessed or seen.
  - c. Provide concise and relevant information detailing how this business has affected or may affect the peaceful enjoyment of your neighborhood.
  - d. If by the time you have the opportunity to testify, the information you wish to share has already been provided to the committee, you may state that you agree with the previous testimony. Redundant or repetitive testimony will not assist the committee in making its recommendation.
7. After giving your testimony, the members of the Licenses Committee and the licensee may ask questions regarding the testimony you have given or other factors relating to the license application.
8. Business Competition is not a valid basis for denial or non-renewal of a license.  
**Please Note: If you have submitted an objection to the above application your objection cannot be considered by the committee unless you personally testify at the hearing.**

OCCUPANT	MAIL ADDRESS	CITY AND ZIP CODE
CURRENT OCCUPANT	1432A W WINDLAKE AVE	MILWAUKEE, WI 53215-3149
CURRENT OCCUPANT	1420 W LINCOLN AVE 2	MILWAUKEE, WI 53215-3161
CURRENT OCCUPANT	2257 S 14TH ST	MILWAUKEE, WI 53215-2717
CURRENT OCCUPANT	2240 S 15TH ST	MILWAUKEE, WI 53215-2702
CURRENT OCCUPANT	2241A S 15TH ST	MILWAUKEE, WI 53215-2701
CURRENT OCCUPANT	1324 W LINCOLN AVE	MILWAUKEE, WI 53215-3127
CURRENT OCCUPANT	1447 W WINDLAKE AVE	MILWAUKEE, WI 53215-3148
CURRENT OCCUPANT	2310 S 15TH ST	MILWAUKEE, WI 53215-3131
CURRENT OCCUPANT	2241 S 15TH ST	MILWAUKEE, WI 53215-2701
CURRENT OCCUPANT	1403 W LINCOLN AVE 202	MILWAUKEE, WI 53215-3101
CURRENT OCCUPANT	2237 S 15TH ST	MILWAUKEE, WI 53215-2701
CURRENT OCCUPANT	1438A W LINCOLN AVE	MILWAUKEE, WI 53215-3144
CURRENT OCCUPANT	1420 W LINCOLN AVE 3	MILWAUKEE, WI 53215-3161
CURRENT OCCUPANT	2263 S 14TH ST A	MILWAUKEE, WI 53215-2717
CURRENT OCCUPANT	2259 S 14TH ST	MILWAUKEE, WI 53215-2717
CURRENT OCCUPANT	2255 S 15TH ST	MILWAUKEE, WI 53215-2701
CURRENT OCCUPANT	2255 S 14TH ST	MILWAUKEE, WI 53215-2717
CURRENT OCCUPANT	2238 S 15TH ST	MILWAUKEE, WI 53215-2702
CURRENT OCCUPANT	1455A W WINDLAKE AVE	MILWAUKEE, WI 53215-3148
CURRENT OCCUPANT	1441 W WINDLAKE AVE	MILWAUKEE, WI 53215-3148
CURRENT OCCUPANT	2321 S 15TH ST	MILWAUKEE, WI 53215-3130
CURRENT OCCUPANT	1435 W WINDLAKE AVE	MILWAUKEE, WI 53215-3148
CURRENT OCCUPANT	1444A W WINDLAKE AVE	MILWAUKEE, WI 53215-3149
CURRENT OCCUPANT	2237A S 14TH ST	MILWAUKEE, WI 53215-2717
CURRENT OCCUPANT	2235 S 15TH ST	MILWAUKEE, WI 53215-2701
CURRENT OCCUPANT	2234 S 15TH ST	MILWAUKEE, WI 53215-2702
CURRENT OCCUPANT	1434 W LINCOLN AVE	MILWAUKEE, WI 53215-3144
CURRENT OCCUPANT	2250 S 15TH ST	MILWAUKEE, WI 53215-2702
CURRENT OCCUPANT	2251A S 14TH ST	MILWAUKEE, WI 53215-2717
CURRENT OCCUPANT	2245 S 15TH ST	MILWAUKEE, WI 53215-2701
CURRENT OCCUPANT	1443A W WINDLAKE AVE	MILWAUKEE, WI 53215-3148
CURRENT OCCUPANT	1439A W WINDLAKE AVE	MILWAUKEE, WI 53215-3148
CURRENT OCCUPANT	1403 W LINCOLN AVE 201	MILWAUKEE, WI 53215-3101
CURRENT OCCUPANT	1515 W LINCOLN AVE	MILWAUKEE, WI 53215-2635
CURRENT OCCUPANT	2310A S 15TH ST	MILWAUKEE, WI 53215-3131
CURRENT OCCUPANT	2230 S 15TH ST	MILWAUKEE, WI 53215-2702
CURRENT OCCUPANT	2303 S 15TH ST	MILWAUKEE, WI 53215-3130
CURRENT OCCUPANT	1434A W LINCOLN AVE	MILWAUKEE, WI 53215-3144
CURRENT OCCUPANT	2259 S 15TH ST	MILWAUKEE, WI 53215-2701
CURRENT OCCUPANT	2256 S 15TH ST	MILWAUKEE, WI 53215-2702
CURRENT OCCUPANT	2251 S 14TH ST	MILWAUKEE, WI 53215-2717
CURRENT OCCUPANT	2248 S 15TH ST A	MILWAUKEE, WI 53215-2702
CURRENT OCCUPANT	2248 S 15TH ST B	MILWAUKEE, WI 53215-2702
CURRENT OCCUPANT	2244 S 15TH ST	MILWAUKEE, WI 53215-2702
CURRENT OCCUPANT	1435A W WINDLAKE AVE	MILWAUKEE, WI 53215-3148
CURRENT OCCUPANT	1401 W LINCOLN AVE	MILWAUKEE, WI 53215-3101
CURRENT OCCUPANT	2308 S 15TH ST	MILWAUKEE, WI 53215-3131
CURRENT OCCUPANT	2235 S 14TH ST	MILWAUKEE, WI 53215-2717
CURRENT OCCUPANT	2231 S 14TH ST	MILWAUKEE, WI 53215-2717
CURRENT OCCUPANT	1420 W LINCOLN AVE 4	MILWAUKEE, WI 53215-3161
CURRENT OCCUPANT	1414 W LINCOLN AVE	MILWAUKEE, WI 53215-3144
CURRENT OCCUPANT	1414 W LINCOLN AVE A	MILWAUKEE, WI 53215-3144
CURRENT OCCUPANT	2263 S 14TH ST	MILWAUKEE, WI 53215-2717
CURRENT OCCUPANT	2261 S 15TH ST	MILWAUKEE, WI 53215-2701
CURRENT OCCUPANT	2252 S 15TH ST	MILWAUKEE, WI 53215-2702

CURRENT OCCUPANT	2248 S 15TH ST	MILWAUKEE, WI 53215-2702
CURRENT OCCUPANT	1455 W WINDLAKE AVE	MILWAUKEE, WI 53215-3148
CURRENT OCCUPANT	1443B W WINDLAKE AVE	MILWAUKEE, WI 53215-3148
CURRENT OCCUPANT	1438 W LINCOLN AVE	MILWAUKEE, WI 53215-3144
CURRENT OCCUPANT	2263 S 15TH ST	MILWAUKEE, WI 53215-2701
CURRENT OCCUPANT	2260 S 15TH ST	MILWAUKEE, WI 53215-2702
CURRENT OCCUPANT	2254 S 15TH ST	MILWAUKEE, WI 53215-2702
CURRENT OCCUPANT	2253 S 15TH ST	MILWAUKEE, WI 53215-2701
CURRENT OCCUPANT	2249 S 15TH ST	MILWAUKEE, WI 53215-2701
CURRENT OCCUPANT	1443 W WINDLAKE AVE	MILWAUKEE, WI 53215-3148
CURRENT OCCUPANT	2311 S 14TH ST	MILWAUKEE, WI 53215-3116
CURRENT OCCUPANT	1505 W LINCOLN AVE	MILWAUKEE, WI 53215-2635
CURRENT OCCUPANT	2237 S 14TH ST	MILWAUKEE, WI 53215-2717
CURRENT OCCUPANT	2313 S 15TH ST	MILWAUKEE, WI 53215-3130
CURRENT OCCUPANT	2306 S 15TH ST	MILWAUKEE, WI 53215-3131
CURRENT OCCUPANT	1420 W LINCOLN AVE 1	MILWAUKEE, WI 53215-3161
CURRENT OCCUPANT	2247 S 15TH ST	MILWAUKEE, WI 53215-2701
CURRENT OCCUPANT	2245 S 14TH ST	MILWAUKEE, WI 53215-2717
CURRENT OCCUPANT	2243 S 15TH ST	MILWAUKEE, WI 53215-2701
CURRENT OCCUPANT	2243 S 14TH ST	MILWAUKEE, WI 53215-2717
CURRENT OCCUPANT	2242 S 15TH ST	MILWAUKEE, WI 53215-2702
CURRENT OCCUPANT	1451A W WINDLAKE AVE	MILWAUKEE, WI 53215-3148
CURRENT OCCUPANT	1451 W WINDLAKE AVE	MILWAUKEE, WI 53215-3148
CURRENT OCCUPANT	1439 W WINDLAKE AVE	MILWAUKEE, WI 53215-3148
CURRENT OCCUPANT	1507A W LINCOLN AVE	MILWAUKEE, WI 53215-2635
CURRENT OCCUPANT	1444 W WINDLAKE AVE	MILWAUKEE, WI 53215-3149

**Total Records: 82**

**Radius: 250.0 feet and Center of Circle: 1428 W Lincoln AV**



# BUSINESS LICENSE PLAN OF OPERATION

ccl-busplan 5/24/16

Office of the City Clerk License Division  
200 E. Wells St. Room 105, Milwaukee, WI 53202  
(414) 286-2238 www.milwaukee.gov/license e-mail address: [license@milwaukee.gov](mailto:license@milwaukee.gov)

## 1. Type of Business

Applying for:  Extended Hours (12AM to 5AM) - If a food establishment, check all that apply:  Delivery  Drive Thru  Dining Room  
 Self Service Laundry  Rooming House  Hotel/Motel  Massage Establishment  Filling Station  
 Other (supplemental application for specific license also required)

Provide a detailed description of the type of business you plan on operating:

Restaurant and Catering

Do you have any experience operating this type of business?  No  Yes If yes, explain:

## 2. Business Operations

- a. Proposed Opening Date: 9/1/16
- b. Is this premise under construction?  No  Yes If yes, list estimated completion date: \_\_\_\_\_
- c. Is this a franchise?  No  Yes
- d. Is this premises currently licensed?  No  Yes If yes, list type of license: Class B
- e. Is the current licensee operating?  No  Yes If no, list date closed: \_\_\_\_\_
- f. Do you have future plans for other businesses, licenses or permits at this location?  No  Yes  
If yes, explain: \_\_\_\_\_
- g. Have you previously held an Extended Hours License in Milwaukee?  No  Yes  
If yes, list address(es): \_\_\_\_\_
- h. Are other businesses operating in the same building?  No  Yes If yes, describe: \_\_\_\_\_

## 3. Litter & Noise

- a. How are grounds kept clean?  Sweep  Pressure Wash  Pick Up Litter  Other: \_\_\_\_\_
- b. How often will grounds be cleaned?  Daily  Weekly  As Needed  Monthly  Other: \_\_\_\_\_
- c. Grounds cleaned by:  Licensee  Building Owner  Employees  Hired Maintenance  Other: \_\_\_\_\_
- d. How are noise issues prevented and/or addressed?  Security  Manager approaches customer(s)  Call Police  
 Signs Posted  Other: \_\_\_\_\_
- e. Will a sound amplification system be used?  No  Yes If yes, describe: \_\_\_\_\_

## 4. Smoking & Sanitation

- a. Are there designated outdoor smoking areas?  No  Yes If yes, describe: \_\_\_\_\_
- b. Number of Garbage Cans: Inside: 6 Locations: Bar, Bathrooms, Kitchen  
Outside: 2 Locations: Rear of Building
- c. Is a crowd control barrier used?  No  Yes If yes, describe: \_\_\_\_\_
- d. How many restrooms are on the premises? 4
- e. Name of solid waste contractor:  Advanced Disposal  Waste Management  Other: Waste management or Eagle Disposal T.B. Contracted.

## 5. Security

- a. Are there onsite parking spaces?  No  Yes If yes, indicate how many? \_\_\_\_\_ and describe the parking security plan: \_\_\_\_\_
- b. Is there a loading zone?  No  Yes If yes, describe the loading area security plan: \_\_\_\_\_
- c. Will you have security personnel on premise?  No  Yes If yes, how many? \_\_\_\_\_ and answer the following:  
 What are their responsibilities? \_\_\_\_\_  
 Is security equipment used?  No  Yes If yes, describe \_\_\_\_\_  
 List their licensing, certification, or training credentials \_\_\_\_\_
- d. Will there be security cameras?  No  Yes If yes, where? \_\_\_\_\_
- e. Will searches/identification checks be done upon entry?  No  Yes If yes, describe \_\_\_\_\_

## 6. Percentage of Sales (must total 100%)

Alcohol <u>30</u> %	Food <u>70</u> %	Secondhand Merchandise	Precious Metals & Gems
Entertainment <u>0</u> %	Cigarettes <u>0</u> %	<u>0</u> %	<u>0</u> %
Pawnbroker Activity <u>0</u> %	Salvaged Materials <u>0</u> % (such as scrap metal)	Personal Services (such as tattoo, body piercing, salon, tailor, tanning, etc.) <u>0</u> %	Other <u>0</u> % Describe: _____

## 7. Businesses/Licenses on the Premises (check all that apply):

### Type 1

- Full Service Restaurant  Cafe/Coffee Shop  Deli or Fast Food Restaurant  Private/Fraternal/Veterans Club
- Night Club  Tavern  Cocktail Lounge  Teen Club
- Banquet Hall  Sports Facility  Bowling Alley
- Hotel/Motel : Number of Floors: \_\_\_\_\_ Number of Rooms: \_\_\_\_\_  
 Rooming House: Number of Floors: \_\_\_\_\_ Number of Rooms: \_\_\_\_\_

### Type 2

- Liquor Store  Corner Store  Supermarket  Convenience Store
- Gas Station  Amusement/Phonograph Distributor  Recycling, Salvage or Towing
- Used Car Dealer  Personal Service Establishment (such as tattoo business, hair salon, tailor, etc.)  Recording Studio

What other licenses/permits will you hold at this location? (check all that apply)

- Occupancy Permit  Cigarette & Tobacco  Gas Station  Extended Hours  Class "B" Tavern  Weights & Measures
- Secondhand Dealer  Precious Metal & Gem  Other: \_\_\_\_\_

## 8. Legal Capacity (only if a Type 1 premises in #7 above)

Capacity \_\_\_\_\_ (Call the Milwaukee Development Center at 414-286-8211 if you have questions.)

## 9. Premises Description

- a. Identify all area(s) of the premises that will be used in operating this business (include areas used only for storage):  
 1<sup>st</sup> Floor  2<sup>nd</sup> Floor  Basement Storage  Patio  Beer Garden  Sidewalk Café  Deck  Rooftop  
 Other: Describe: \_\_\_\_\_
- b. Describe Location:  Major Thoroughfare  Secondary Street  Other: \_\_\_\_\_
- c. Nearest Major Cross Street: Lincoln Ave
- d. Describe Building:  Free Standing Building  Strip Mall  Other: \_\_\_\_\_
- e. Describe Premises Structure:  Single Story  Multi-Story - # of Stories 2  Other: \_\_\_\_\_
- f. Describe Surrounding Area:  Commercial  Residential  Industrial  Other: \_\_\_\_\_
- g. Building Owner Name: Angel & Josefina Gutierrez Phone Number: 414-793-2153  
 Business Owner Address: 2431 S 9th St - Milwaukee WI 53215

## 10. Hours of Operation & Customers

Will customers be entering the premises?  No  Yes

Day of the Week	Proposed Hours of Operation:		Estimated Number of Customers expected each day	Potential Age Range of Customers	Class B Tavern Applicant Only: Age Restriction (If none, write 'None')
	Open Time (include a.m. or p.m.)	Close Time (include a.m. or p.m.)			
Sunday	7:00am	2:00 am	30	1-100	
Monday	7:00am	2:00 am	20	1-100	
Tuesday	7:00am	2:00 am	20	1-100	N
Wednesday	7:00am	2:00 am	30	1-100	0
Thursday	7:00am	2:00 am	30	1-100	Y
Friday	7:00am	2:00 am	40	1-100	E
Saturday	7:00am	2:00 am	50	1-100	

Extended Hours Establishment License is required for any convenience store, filling station, personal service establishment (such as tattoo, body piercing, salon, tailor, tanning, etc.), recording studio or restaurant which is open between the hours of 12 a.m. and 5 a.m.

Entertainment Indoor Closing Hours: If alcohol beverage establishment, same as alcohol license hours.  
 If non-alcohol establishment 1:00 am Sunday to Thursday; 1:30 am Friday and Saturday.

Entertainment Outdoor Closing Hours: 10:00 pm Sunday – Thursday; 12:00 am Friday and Saturday,  
 unless otherwise approved by Common Council in licensee's plan of operation.

## 11. Signature(s)

\_\_\_\_\_  
 Sole Proprietor, Partner, Agent, or 20% or more Shareholder

\_\_\_\_\_  
 Signature of additional partner or 20% or more Shareholder

See Application Information for a complete list of all required application forms.



## ALCOHOL BEVERAGE & PUBLIC ENTERTAINMENT PREMISES SUPPLEMENTAL PLAN OF OPERATION

Office of the City Clerk License Division  
200 E. Wells St. Room 105, Milwaukee, WI 53202  
(414) 286-2238 e-mail address: license@milwaukee.gov www.milwaukee.gov/license

Legal Entity Name: EL Botanero LLC

Premise Address: 1428 W Lincoln Ave - Milwaukee WI 53215

### Proximity of Premises to Church, School, Daycare Center or Hospital

Is there at least 300 feet between the building and any church, school, daycare center or hospital?  Yes  No

### "Service Bar Only" Designation

If applying for Class B or C license, are you applying for "Service Bar Only"?  No  Yes  
Service Bar Only means customers cannot sit at the bar. Alcohol is served to patrons seated at tables. No stools, chairs or other articles of furniture shall be placed at the service bar for patrons to sit upon.

### Business Information

a) Are you taking out this application for anyone that may not be eligible for a license?  No  Yes  
If yes, list name and address: \_\_\_\_\_

b) Will the agent, a partner or the individual licensee be conducting the day-to-day operations of the business?  No  Yes  
If no, list the name and address of the person(s) who will: \_\_\_\_\_

Class B Applicants: If the agent, a partner or the individual licensee will not be conducting the day-to-day operations of the business, the person(s) listed above must obtain a Class B Managers license.

c) Does anyone else have money invested or any other interest in this business?  No  Yes  
If yes, explain: \_\_\_\_\_

d) Have you made an agreement with anyone to repay any loan or any other payments based upon income from the business?  
 No  Yes If yes, list name and address: \_\_\_\_\_

### Proof of Ownership, Lease, or Offer to Purchase (new & transfer applicants only)

Submit proof of ownership, lease, or offer to purchase the building with this application.  
A lease or offer to purchase must:

- Be in the same legal entity name as that apply for the license
- Reflect the same address as the premises address on this application
- Reflect current dates and
- Be signed by the lessor/seller and lessee/buyer

### Property Information (new & transfer applicants only)

a) Do you own or lease the building?  Own  Lease

b) Who owns the fixtures (for example, coolers, etc.)? Landlord

c) Are you purchasing the stock and/or fixtures?  No  Yes If yes, amount paid \$ \_\_\_\_\_

d) Total amount paid for business \$ 0

e) Total amount paid for goodwill of the business \$ 0

Goodwill comprises the reputation and customer relationships of an existing business. If the price you pay for the business exceeds the fair market value of all of the rest of the assets of the business, the excess may be considered goodwill.

f) Have you made arrangements with the seller for payment of personal property taxes?  No  Yes

See Application Information for a list of all required application forms.

**Lease Information (new & transfer applicants who are leasing the premises only)**

- a) Date lease begins 01/08/16 Ends 7/3/17
- b) Monthly rental \$ 3000
- c) Do you have an option to renew the lease?  No  Yes
- d) Does your lease allow for assignment to another party without the consent of the owner?  No  Yes
- e) For what length of time have you been guaranteed occupancy (number of years)? 1 with option of renewal
- f) In addition to paying the monthly rental, will you have to pay anything additional to the owner of the building to guarantee performance of the lease?  No  Yes If yes, explain \_\_\_\_\_
- g) Does the present owner or occupancy object to the granting of your license?  No  Yes  
If yes, explain \_\_\_\_\_

**Change of Agent Applicants Only**

Have there been any changes to the floor plan since the last application was submitted?  No  Yes  
If no, a new floor plan is not required. If yes, submit a new floor plan and explain the change(s): \_\_\_\_\_

**Notarized Signatures of Applicants**

SUBSCRIBED AND SWORN TO BEFORE ME

This 29 day of July

(Clerk/Notary Public)

My Commission Expires 11/17/11

\*Notary Seal must be affixed.

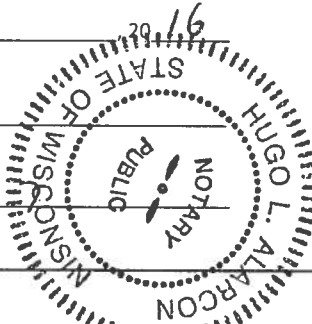

[Signature]  
Sole Proprietor, Partner, 20% or more Shareholder, or Agent – only if there are no 20% or more shareholders

[Signature]  
Additional partner or 20% or more shareholder

Note: All information contained in this application is subject to approval by the Common Council. Deviating from approved plan of operation will subject licensee to citations, and/or suspension or non-renewal of the license. Contact the License Division for information on how to request changes.

**New and transfer of premise applicants must submit the following:**

- Proof of ownership, lease or offer to purchase the building
- Detailed floor plan
- If a restaurant, copy of the menu





# PUBLIC ENTERTAINMENT PREMISES LICENSE SUPPLEMENTAL APPLICATION

Office of the City Clerk License Division  
200 E. Wells St. Room 105, Milwaukee, WI 53202  
(414) 286-2238 [www.milwaukee.gov/license](http://www.milwaukee.gov/license) e-mail address: [license@milwaukee.gov](mailto:license@milwaukee.gov)

## TYPES OF ENTERTAINMENT (CHECK ALL THAT APPLY)

<input type="checkbox"/> Instrumental Musicians	<input checked="" type="checkbox"/> Bands	<input type="checkbox"/> Battle of the Bands	<input type="checkbox"/> Comedy Acts
<input checked="" type="checkbox"/> Disc Jockey	<input type="checkbox"/> Magic Shows	<input type="checkbox"/> Poetry Readings	<input type="checkbox"/> Dancing by Performers
<input type="checkbox"/> Jukebox	<input type="checkbox"/> Wrestling	<input type="checkbox"/> Patron Contests	<input checked="" type="checkbox"/> Patrons Dancing
<input type="checkbox"/> Adult Entertainment/ Strippers/Erotic Dance	<input checked="" type="checkbox"/> Karaoke	<input type="checkbox"/> Bowling Alley	<input type="checkbox"/> Pool Tables
<input type="checkbox"/> Motion Pictures	<input type="checkbox"/> Amusement Machines –	How many? _____	How many? _____
How many? _____	How many? _____	<input type="checkbox"/> Concerts	<input type="checkbox"/> Theatrical Performances
<input type="checkbox"/> Other: _____		Approx. # per year? _____	Approx. # per year? _____

Entertainment Indoor Hours: Alcohol beverage establishment: same as alcohol license hours.  
Non-alcohol establishment: 10:30am to 1:00am Sun to Thurs; 1:30am Fri-Sat  
Entertainment Outdoor Closing Hours: 10:00pm Sunday-Thursdays; 12:00am Friday & Saturday; unless otherwise approved by Common Council.

## PROMOTERS/SOUND AMPLIFICATION

Will promoters ever be used for any of the entertainment?  No  Yes If Yes, Describe: \_\_\_\_\_

At any time will sound amplification be used?  No  Yes If Yes, Describe: \_\_\_\_\_

## LEGAL CAPACITY OF PREMISES

99 (Call the Development Center at 414-286-8211 with questions.) Legal capacity determines the fee for your Public Entertainment Premises License. If you would like to request the license be approved with a lower capacity than that listed above, indicate the lower capacity here: \_\_\_\_\_. If approved, this lower capacity will print on your license and override the capacity listed on your Occupancy Permit.

## NOTARIZED SIGNATURES

I understand that after the license has been issued, a change to the plan of operation will require a written request to change and approval from the Common Council.

I agree to inform the City Clerk within 10 days of any substantial change in the information supplied in this application.

I understand that I shall not willfully refuse to provide the services offered under this license, or add charges or require deposits not required of the general public because of race, color, sex, religion, national origin or ancestry, age, handicap, lawful source of income, marital status, sexual orientation, gender identity or expression, familial status or the fact that a person is now or has been a member of the military service, whether dressed in uniform or not; and shall not seek such information as a condition of employment, or penalize any employee or discriminate in the selection of personnel for training or promotion on the basis of such information.

I have knowledge of the City Ordinances currently regulating public entertainment, and understand that the license may be subject to suspension, non-renewal or revocation, if I violate any rule, law or regulation of the city of Milwaukee and State of Wisconsin.

SUBSCRIBED AND SWORN TO BEFORE ME

This 2<sup>nd</sup> day of August, 2016

  
\_\_\_\_\_  
(Clerk/Notary Public)  
My Commission Expires MARCH 27, 2019  
\*Notary Seal must be affixed.

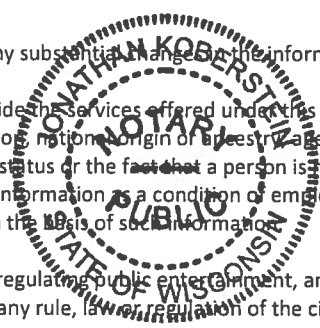

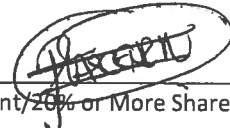
  
\_\_\_\_\_  
Agent/20% or More Shareholder/Partner

\_\_\_\_\_  
Additional 20% or More Shareholder/Partner

Office Use Only: Initials: \_\_\_\_\_ Filed: \_\_\_\_\_ App: \_\_\_\_\_

Check if only PEP (must be heard w/in 60 days) Granted \_\_\_\_\_ License # \_\_\_\_\_

Date 7/29/16

EL Botanero LLC

1428 W Lincoln Ave. Milwaukee WI 53215

First Floor

87

Agent: Ramiro Palencia Vera

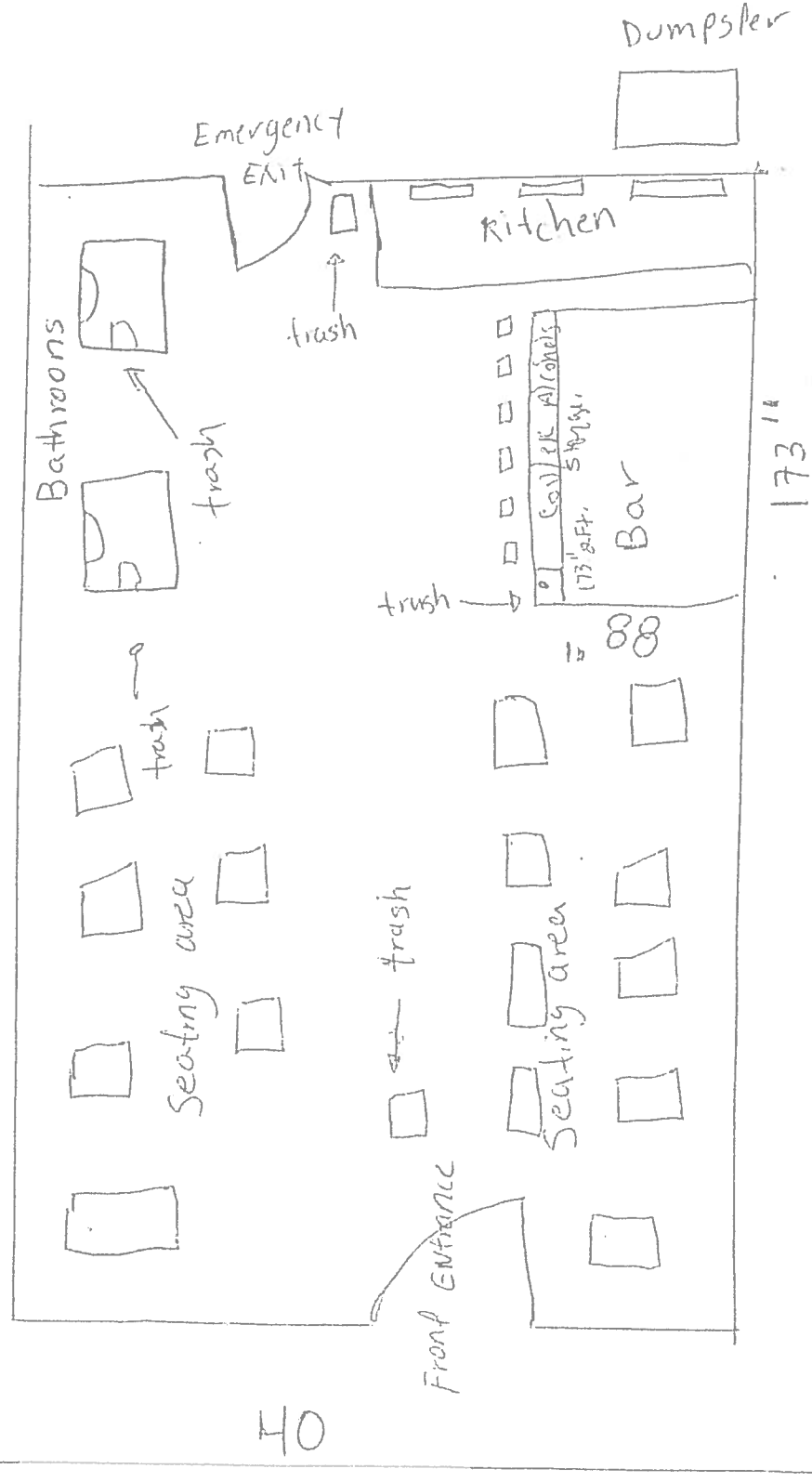

Lincoln ave



total square footage = 2200'

Date 7/29/16

EL Botanero LLC

1428 W Lincoln Ave Milwaukee WI 53215  
Agent: Ramiro Placencia Vera

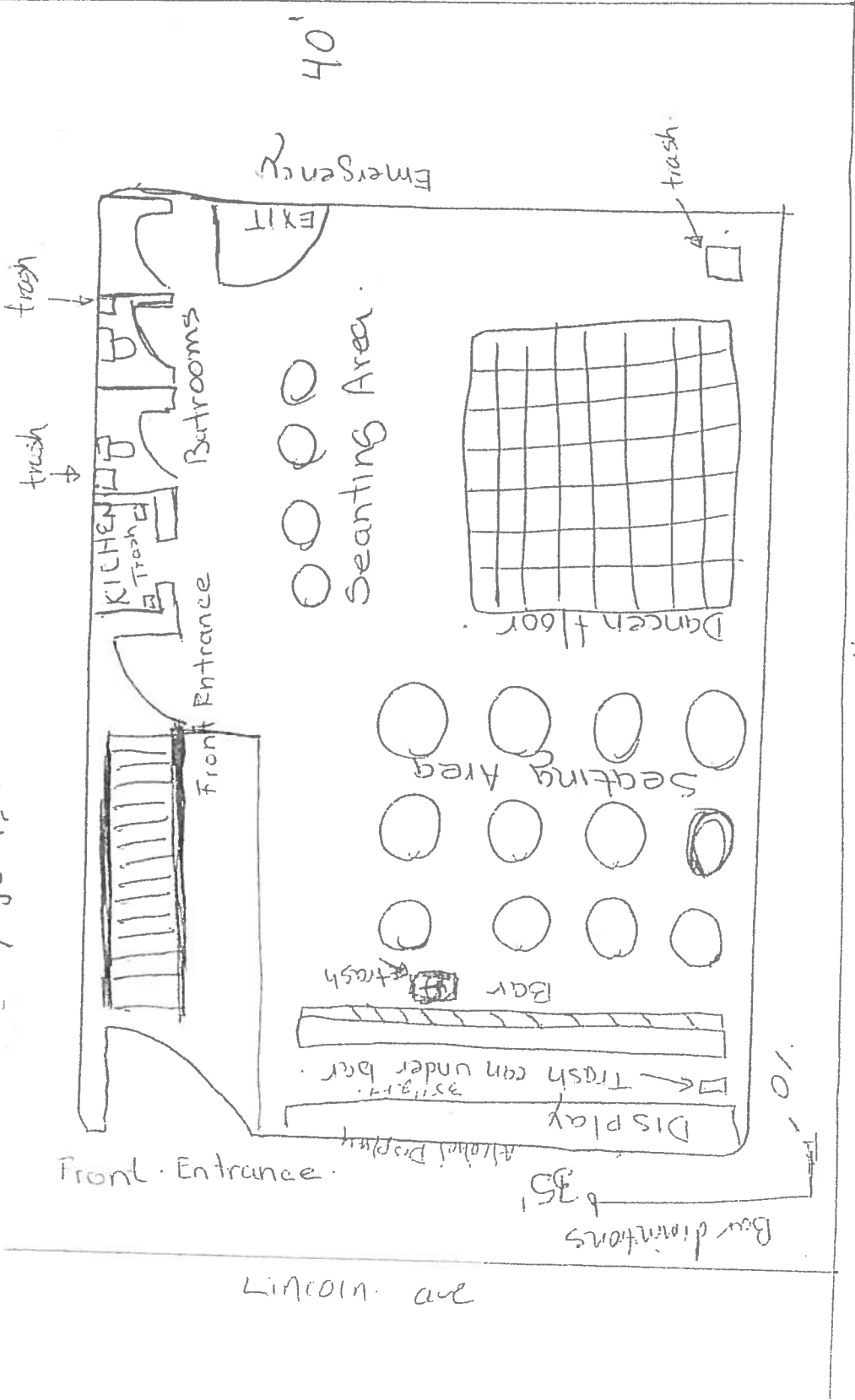

second floor

total square footage = 3280'

Date 7/29/16

Basement

EL Botanero LLC  
1428 W Lincoln Ave  
Milwaukee WI 53215

Agent: Ramiro Pecesera Vera

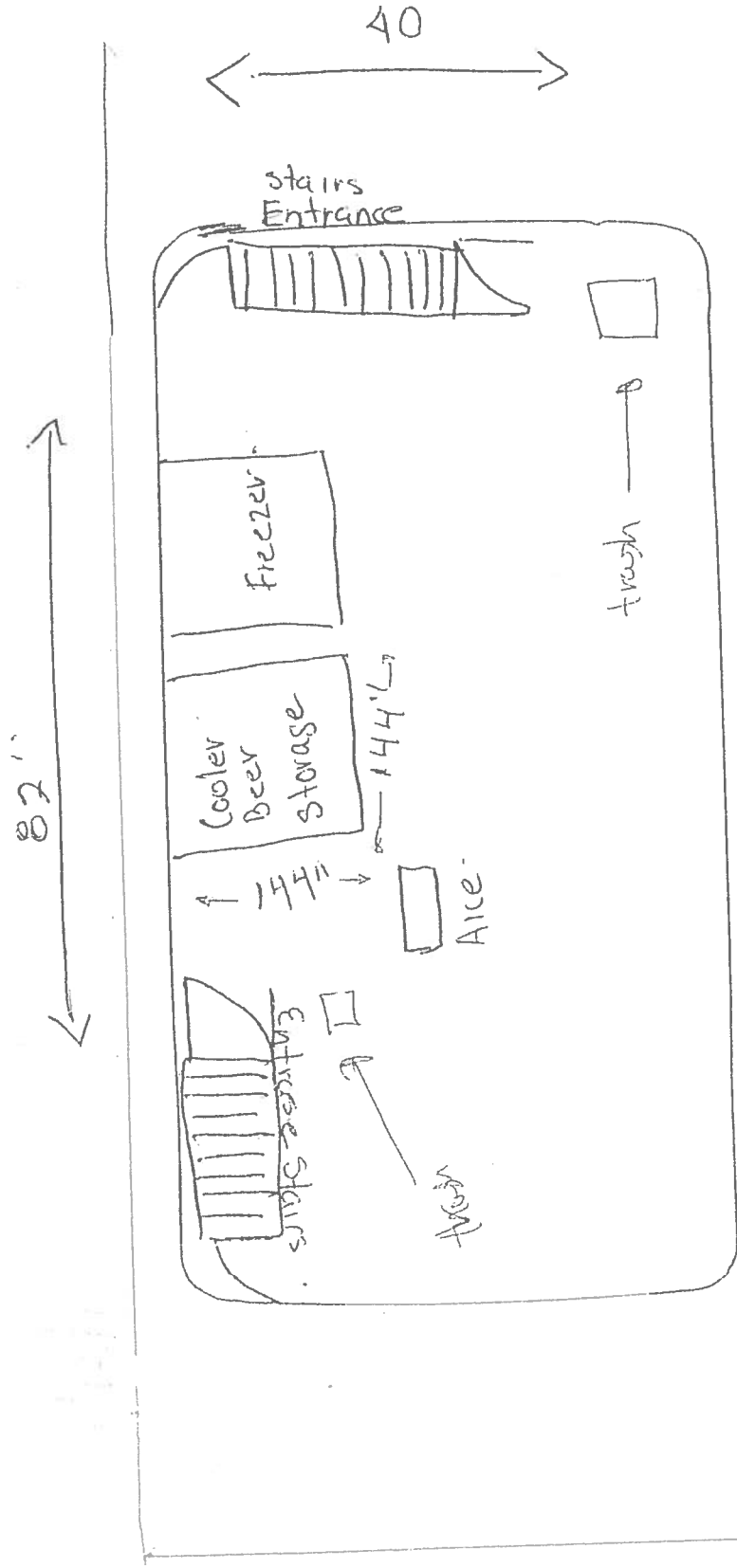

total square  
footage =  
3280'

Av. Lincoln 1428



**CITY OF MILWAUKEE  
OFFICE OF THE CITY CLERK**

Wednesday, October 05, 2016

**COMMITTEE MEETING NOTICE**

AD 12

SANCHEZ, Martin, Agent  
Sanchez Welding and Rim Repair LLC  
1662 S 13TH St

Milwaukee, WI 53204

You are requested to attend a hearing which is to be held in Room 301-B, Third Floor, City Hall on:

**Tuesday, October 18, 2016 at 10:15 AM**

**Regarding:** Your Recycling, Salvaging, or Towing Premises Application as agent for "Sanchez Welding and Rim Repair LLC" for "Sanchez Welding and Rim Repair" at 1662 S 13TH St.

There is a possibility that your application may be denied for one or more of the following reasons: The recommendation of the committee regarding the application shall be based on evidence presented at the hearing. Per MCO 85-2.7-4, probative evidence concerning whether or not a new license should be granted may be presented on the following subjects: whether or not the applicant meets the municipal requirements, the appropriateness of the location and premises where the licensed premises is to be located and whether use of the premises for the purposes or activities permitted by the license would tend to facilitate a public or private nuisance or create undesirable neighborhood problems such as disorderly patrons, unreasonably loud noise, litter, and excessive traffic and parking congestion. Probative evidence relating to these matters may be taken from the plan of operation submitted with the license application, if any, but shall not include the content of any music. Evidence regarding the fitness of the location of the premises to be maintained as the principal place of business, including but not limited to whether there is an overconcentration of businesses of the type for which the license is sought; whether the proposal is consistent with any pertinent neighborhood business or development plans, or the location's proximity to areas where children are typically present. The applicant's record in operating similarly licensed premises; and whether or not the applicant has been charged with or convicted of any felony, misdemeanor, municipal offense or other offense, the circumstances of which substantially relate to the activity to be permitted by the license being applied for or any other factor which reasonably relates to the public health, safety or welfare may also be considered. See attached police report or correspondence.

**Notice for applicants with warrants or unpaid fines:**

Proof of warrant satisfaction or payment of fines must be submitted at the hearing on the above date and time. Failure to comply with this requirement may result in a delay of the granting/denial of your application.

Failure to appear at this meeting may result in the denial of your license. Individual applicants must appear only in person or by an attorney. Corporate or Limited Liability applicants must appear only by the agent designated on the application or by an attorney. Partnership applicants must appear by a partner listed on the application or by an attorney. If you wish to do so and at your own expense, you may be accompanied by an attorney of your choosing to represent you at this hearing.

You will be given an opportunity to speak on behalf of the application and to respond and challenge any charges or reasons given for the denial. No petitions can be accepted by the committee, unless the people who signed the petition are present at the committee hearing and willing to testify. You may present witnesses under oath and you may also confront and cross-examine opposing witnesses under oath. If you have difficulty with the English language, you should bring an interpreter with you, at your expense, so that you can answer questions and participate in your hearing.

You may examine the application file at this office during regular business hours prior to the hearing date. Inquiries regarding this matter may be directed to the person whose signature appears below.

Limited parking for persons attending meetings in City Hall is available at reduced rates (5 hour limit) at the Milwaukee Center on the southwest corner of East Kilbourn and North Water Street. Parking tickets must be validated in the first floor information booth in City Hall.

PLEASE NOTE: Upon reasonable notice, efforts will be made to accommodate the needs of disabled individuals through sign language interpreters or other auxiliary aids. For additional information or to request this service, contact the Council Services Division ADA Coordinator at (414) 286-2998, Fax - (414) 286-3456, TDD - (414) 286-2025.

**JIM OWCZARSKI, CITY CLERK**

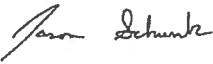
BY:   
\_\_\_\_\_  
Jason Schunk  
License Division Manager

**If you have questions regarding this notice, please contact the License Division at (414) 286-2238.**

200 E. Wells Street, Room 105, City Hall, Milwaukee, WI 53202. [www.milwaukee.gov/license](http://www.milwaukee.gov/license)  
Phone: (414) 286-2238 Fax: (414) 286-3057 Email Address: [License@milwaukee.gov](mailto:License@milwaukee.gov)



**CITY OF MILWAUKEE  
OFFICE OF THE CITY CLERK**

Wednesday, October 05, 2016

**COMMITTEE MEETING NOTICE**

AD 12

SANCHEZ, Martin, Agent  
Sanchez Welding and Rim Repair LLC  
3624 W Grant St

Milwaukee, WI 53215

You are requested to attend a hearing which is to be held in Room 301-B, Third Floor, City Hall on:

**Tuesday, October 18, 2016 at 10:15 AM**

**Regarding:** Your Recycling, Salvaging, or Towing Premises Application as agent for "Sanchez Welding and Rim Repair LLC" for "Sanchez Welding and Rim Repair" at 1662 S 13TH St.

There is a possibility that your application may be denied for one or more of the following reasons: The recommendation of the committee regarding the application shall be based on evidence presented at the hearing. Per MCO 85-2.7-4, probative evidence concerning whether or not a new license should be granted may be presented on the following subjects: whether or not the applicant meets the municipal requirements, the appropriateness of the location and premises where the licensed premises is to be located and whether use of the premises for the purposes or activities permitted by the license would tend to facilitate a public or private nuisance or create undesirable neighborhood problems such as disorderly patrons, unreasonably loud noise, litter, and excessive traffic and parking congestion. Probative evidence relating to these matters may be taken from the plan of operation submitted with the license application, if any, but shall not include the content of any music. Evidence regarding the fitness of the location of the premises to be maintained as the principal place of business, including but not limited to whether there is an overconcentration of businesses of the type for which the license is sought; whether the proposal is consistent with any pertinent neighborhood business or development plans, or the location's proximity to areas where children are typically present. The applicant's record in operating similarly licensed premises; and whether or not the applicant has been charged with or convicted of any felony, misdemeanor, municipal offense or other offense, the circumstances of which substantially relate to the activity to be permitted by the license being applied for or any other factor which reasonably relates to the public health, safety or welfare may also be considered. See attached police report or correspondence.

**Notice for applicants with warrants or unpaid fines:**

Proof of warrant satisfaction or payment of fines must be submitted at the hearing on the above date and time. Failure to comply with this requirement may result in a delay of the granting/denial of your application.

Failure to appear at this meeting may result in the denial of your license. Individual applicants must appear only in person or by an attorney. Corporate or Limited Liability applicants must appear only by the agent designated on the application or by an attorney. Partnership applicants must appear by a partner listed on the application or by an attorney. If you wish to do so and at your own expense, you may be accompanied by an attorney of your choosing to represent you at this hearing.

You will be given an opportunity to speak on behalf of the application and to respond and challenge any charges or reasons given for the denial. No petitions can be accepted by the committee, unless the people who signed the petition are present at the committee hearing and willing to testify. You may present witnesses under oath and you may also confront and cross-examine opposing witnesses under oath. If you have difficulty with the English language, you should bring an interpreter with you, at your expense, so that you can answer questions and participate in your hearing.

You may examine the application file at this office during regular business hours prior to the hearing date. Inquiries regarding this matter may be directed to the person whose signature appears below.

Limited parking for persons attending meetings in City Hall is available at reduced rates (5 hour limit) at the Milwaukee Center on the southwest corner of East Kilbourn and North Water Street. Parking tickets must be validated in the first floor information booth in City Hall.

PLEASE NOTE: Upon reasonable notice, efforts will be made to accommodate the needs of disabled individuals through sign language interpreters or other auxiliary aids. For additional information or to request this service, contact the Council Services Division ADA Coordinator at (414) 286-2998, Fax - (414) 286-3456, TDD - (414) 286-2025.

JIM OWCZARSKI, CITY CLERK

BY:

Jason Schunk  
License Division Manager

**If you have questions regarding this notice, please contact the License Division at (414) 286-2238.**

200 E. Wells Street, Room 105, City Hall, Milwaukee, WI 53202. [www.milwaukee.gov/license](http://www.milwaukee.gov/license)  
Phone: (414) 286-2238 Fax: (414) 286-3057 Email Address: [License@milwaukee.gov](mailto:License@milwaukee.gov)

# MILWAUKEE POLICE DEPARTMENT

## LICENSING

### CRIMINAL RECORD/ORDINANCE VIOLATION/INCIDENTS SYNOPSIS

**DATE:** 09/01/2016  
**LICENSE TYPE:** RST  
**NEW:**   
**RENEWAL:**

**No. 236739**  
**Application Date:** 08/31/2016

**License Location:** 1662 S 13<sup>th</sup> St  
**Business Name:** Sanchez Welding and Rim Repair LLC

**Licensee/Applicant:** SANCHEZ, Martin  
(Last Name, First Name, MI)  
**Date of Birth:** 04/07/1964

**Home Address:** 3624 W Grant St  
**City:** Milwaukee **State:** WI **Zip Code:** 53215  
**Home Phone:**

This report is written by Police Officer David Novak, assigned to the License Investigation Unit, Days.

The Milwaukee Police Department's investigation regarding this application revealed the following:

1. On 02/23/2015 the applicant was cited in the City of Milwaukee at 1662 S 13<sup>th</sup> St for Building Code Violations.

**Charge:** Building Code Violations  
**Finding:** Guilty  
**Sentence:** Fined \$280.00  
**Date:** 08/06/2015  
**Case:** 15021561



Wednesday, October 05, 2016



# Notice of Public Hearing

---

SANCHEZ, Martin, Agent  
Sanchez Welding and Rim Repair at 1662 S 13TH St  
Recycling, Salvaging, or Towing Premises Application

**Tuesday, October 18, 2016 at 10:15 AM**

To whom it may concern:

The above application has been made by the above named applicant(s). This requires approval from the Licenses Committee and the Common Council of the City of Milwaukee. The hearing before the Licenses Committee will take place on 10/18/2016 at 10:15 AM, in Room 301-B, Third Floor, City Hall. If you wish, you may provide testimony at the hearing regarding the request; see below for further information. You are not required to attend the hearing. Once the Licenses Committee makes its recommendation, this recommendation is forwarded to the full Common Council for approval at its next regularly scheduled hearing. Please review the information below and if you have further questions regarding this process, please contact the License Division at (414) 286-2238.

---

## Important details for those wishing to provide information for the Licenses Committee to consider when making its recommendation:

1. The license application is scheduled to be heard at the above time. Due to other hearings running longer than scheduled, you may have to wait some time to provide your testimony.
2. You must appear in person and testify as to matters that you have personally experienced or seen. (You cannot provide testimony for your neighbor, parent or anyone else; this is considered hearsay and cannot be considered by the committee.)
3. No letters or petitions can be accepted by the committee (unless the person who wrote the letter or the persons who signed the petition are present at the committee hearing and willing to testify).
4. Persons opposed to the license application are given the opportunity to testify first; supporters may testify after the opponents have finished.
5. When you are called to testify, you will be sworn in and asked to give your name, and address. (If your first and/or last names are uncommon please spell them.)
6. You may then provide testimony.
  - a. Include only information relating to the above license application.
  - b. Include only information you have personally witnessed or seen.
  - c. Provide concise and relevant information detailing how this business has affected or may affect the peaceful enjoyment of your neighborhood.
  - d. If by the time you have the opportunity to testify, the information you wish to share has already been provided to the committee, you may state that you agree with the previous testimony. Redundant or repetitive testimony will not assist the committee in making its recommendation.
7. After giving your testimony, the members of the Licenses Committee and the licensee may ask questions regarding the testimony you have given or other factors relating to the license application.
8. Business Competition is not a valid basis for denial or non-renewal of a license.  
**Please Note: If you have submitted an objection to the above application your objection cannot be considered by the committee unless you personally testify at the hearing.**



OCCUPANT	MAIL ADDRESS	CITY AND ZIP CODE
CURRENT OCCUPANT	1628 S 13TH ST	MILWAUKEE, WI 53204-3205
CURRENT OCCUPANT	1627 S 12TH ST	MILWAUKEE, WI 53204-3332
CURRENT OCCUPANT	1627A S 12TH ST	MILWAUKEE, WI 53204-3332
CURRENT OCCUPANT	1218 W HISTORIC MITCHELL ST A	MILWAUKEE, WI 53204-3329
CURRENT OCCUPANT	1642 S 13TH ST	MILWAUKEE, WI 53204-3205
CURRENT OCCUPANT	1638 S 13TH ST	MILWAUKEE, WI 53204-3205
CURRENT OCCUPANT	1638A S 13TH ST	MILWAUKEE, WI 53204-3205
CURRENT OCCUPANT	1631 S 12TH ST	MILWAUKEE, WI 53204-3332
CURRENT OCCUPANT	1206 W HISTORIC MITCHELL ST 208	MILWAUKEE, WI 53204-3347
CURRENT OCCUPANT	1642A S 13TH ST	MILWAUKEE, WI 53204-3205
CURRENT OCCUPANT	1643 S 12TH ST	MILWAUKEE, WI 53204-3332
CURRENT OCCUPANT	1639A S 12TH ST	MILWAUKEE, WI 53204-3332
CURRENT OCCUPANT	1635 S 12TH ST	MILWAUKEE, WI 53204-3332
CURRENT OCCUPANT	1633 S 12TH ST	MILWAUKEE, WI 53204-3332
CURRENT OCCUPANT	1628A S 13TH ST	MILWAUKEE, WI 53204-3205
CURRENT OCCUPANT	1206 W HISTORIC MITCHELL ST 206	MILWAUKEE, WI 53204-3347
CURRENT OCCUPANT	1206 W HISTORIC MITCHELL ST 217	MILWAUKEE, WI 53204-3347
CURRENT OCCUPANT	1645 S 12TH ST	MILWAUKEE, WI 53204-3332
CURRENT OCCUPANT	1630 S 13TH ST	MILWAUKEE, WI 53204-3205
CURRENT OCCUPANT	1640 S 12TH ST	MILWAUKEE, WI 53204-3331
CURRENT OCCUPANT	1640A S 12TH ST	MILWAUKEE, WI 53204-3331
CURRENT OCCUPANT	1206 W HISTORIC MITCHELL ST 220	MILWAUKEE, WI 53204-3347
CURRENT OCCUPANT	1644 S 13TH ST	MILWAUKEE, WI 53204-3205
CURRENT OCCUPANT	1635A S 12TH ST	MILWAUKEE, WI 53204-3332
CURRENT OCCUPANT	1630 S 13TH ST A	MILWAUKEE, WI 53204-3205
CURRENT OCCUPANT	1224 W HISTORIC MITCHELL ST	MILWAUKEE, WI 53204-3329
CURRENT OCCUPANT	1218 W HISTORIC MITCHELL ST	MILWAUKEE, WI 53204-3329
CURRENT OCCUPANT	1206 W HISTORIC MITCHELL ST 203	MILWAUKEE, WI 53204-3347
CURRENT OCCUPANT	1206 W HISTORIC MITCHELL ST 204	MILWAUKEE, WI 53204-3347
CURRENT OCCUPANT	1206 W HISTORIC MITCHELL ST 218	MILWAUKEE, WI 53204-3347
CURRENT OCCUPANT	1206 W HISTORIC MITCHELL ST 221	MILWAUKEE, WI 53204-3347
CURRENT OCCUPANT	1206 W HISTORIC MITCHELL ST 205	MILWAUKEE, WI 53204-3347
CURRENT OCCUPANT	1639 S 12TH ST	MILWAUKEE, WI 53204-3332
CURRENT OCCUPANT	1634 S 13TH ST	MILWAUKEE, WI 53204-3205

**Total Records: 35**

**Radius: 250.0 feet and Center of Circle: 1662 S 13th ST**



# BUSINESS LICENSE PLAN OF OPERATION

ccl-busplan 5/24/16

Office of the City Clerk License Division  
200 E. Wells St. Room 105, Milwaukee, WI 53202  
(414) 286-2238 www.milwaukee.gov/license e-mail address: [license@milwaukee.gov](mailto:license@milwaukee.gov)

## 1. Type of Business

Applying for:  Extended Hours (12AM to 5AM) - If a food establishment, check all that apply:  Delivery  Drive Thru  Dining Room  
 Self Service Laundry  Rooming House  Hotel/Motel  Massage Establishment  Filling Station  
 Other (supplemental application for specific license also required)

Provide a detailed description of the type of business you plan on operating:

Repair rims and metal fabrication Hours: Mon - Sat 11:00 AM - 7:00 PM

Do you have any experience operating this type of business?  No  Yes If yes, explain: Welder experience

## 2. Business Operations

- a. Proposed Opening Date: Jan 2016
- b. Is this premise under construction?  No  Yes If yes, list estimated completion date: \_\_\_\_\_
- c. Is this a franchise?  No  Yes
- d. Is this premises currently licensed?  No  Yes If yes, list type of license: \_\_\_\_\_
- e. Is the current licensee operating?  No  Yes If no, list date closed: \_\_\_\_\_
- f. Do you have future plans for other businesses, licenses or permits at this location?  No  Yes  
If yes, explain: \_\_\_\_\_
- g. Have you previously held an Extended Hours License in Milwaukee?  No  Yes  
If yes, list address(es): \_\_\_\_\_
- h. Are other businesses operating in the same building?  No  Yes If yes, describe: \_\_\_\_\_

## 3. Litter & Noise

- a. How are grounds kept clean?  Sweep  Pressure Wash  Pick Up Litter  Other: \_\_\_\_\_
- b. How often will grounds be cleaned?  Daily  Weekly  As Needed  Monthly  Other: \_\_\_\_\_
- c. Grounds cleaned by:  Licensee  Building Owner  Employees  Hired Maintenance  Other: \_\_\_\_\_
- d. How are noise issues prevented and/or addressed?  Security  Manager approaches customer(s)  Call Police  
 Signs Posted  Other: N/A
- e. Will a sound amplification system be used?  No  Yes If yes, describe: \_\_\_\_\_

## 4. Smoking & Sanitation

- a. Are there designated outdoor smoking areas?  No  Yes If yes, describe: \_\_\_\_\_
- b. Number of Garbage Cans: Inside: 1 Locations: In the center of the Shop  
Outside: 1 Locations: In the left corner of the entrance
- c. Is a crowd control barrier used?  No  Yes If yes, describe: \_\_\_\_\_
- d. How many restrooms are on the premises? 1
- e. Name of solid waste contractor:  Advanced Disposal  Waste Management  Other: \_\_\_\_\_

## 5. Security

- a. Are there onsite parking spaces?  No  Yes If yes, indicate how many? \_\_\_\_\_ and describe the parking security plan: \_\_\_\_\_
- b. Is there a loading zone?  No  Yes If yes, describe the loading area security plan: \_\_\_\_\_
- c. Will you have security personnel on premise?  No  Yes If yes, how many? \_\_\_\_\_ and answer the following:  
 What are their responsibilities? \_\_\_\_\_  
 Is security equipment used?  No  Yes If yes, describe \_\_\_\_\_  
 List their licensing, certification, or training credentials \_\_\_\_\_
- d. Will there be security cameras?  No  Yes If yes, where? Entrance, In front & back of the shop (8)
- e. Will searches/identification checks be done upon entry?  No  Yes If yes, describe \_\_\_\_\_

## 6. Percentage of Sales (must total 100%)

Alcohol _____%	Food _____%	Secondhand Merchandise <u>10</u> %	Precious Metals & Gems _____%
Entertainment _____%	Cigarettes _____%	Personal Services (such as tattoo, body piercing, salon, tailor, tanning, etc.) _____%	Other <u>90</u> % Describe: <u>Welding Services</u>
Pawnbroker Activity _____%	Salvaged Materials _____% (such as scrap metal)		

## 7. Businesses/Licenses on the Premises (check all that apply):

### Type 1

- Full Service Restaurant       Cafe/Coffee Shop       Deli or Fast Food Restaurant       Private/Fraternal/Veterans Club
- Night Club       Tavern       Cocktail Lounge       Teen Club
- Banquet Hall       Sports Facility       Bowling Alley
- Hotel/Motel : Number of Floors: \_\_\_\_\_       Rooming House: Number of Floors: \_\_\_\_\_  
 Number of Rooms: \_\_\_\_\_      Number of Rooms: \_\_\_\_\_

### Type 2

- Liquor Store       Corner Store       Supermarket       Convenience Store
- Gas Station       Amusement/Phonograph Distributor       Recycling, Salvage or Towing
- Used Car Dealer       Personal Service Establishment  
(such as tattoo business, hair salon, tailor, etc.)       Recording Studio

What other licenses/permits will you hold at this location? (check all that apply)

- Occupancy Permit     Cigarette & Tobacco     Gas Station     Extended Hours     Class "B" Tavern     Weights & Measures
- Secondhand Dealer     Precious Metal & Gem     Other: \_\_\_\_\_

## 8. Legal Capacity (only if a Type 1 premises in #7 above)

Capacity \_\_\_\_\_ (Call the Milwaukee Development Center at 414-286-8211 if you have questions.)

## 9. Premises Description

a. Identify all area(s) of the premises that will be used in operating this business (include areas used only for storage):

1<sup>st</sup> Floor  2<sup>nd</sup> Floor  Basement Storage  Patio  Beer Garden  Sidewalk Café  Deck  Rooftop

Other: Describe: \_\_\_\_\_

b. Describe Location:  Major Thoroughfare  Secondary Street  Other: \_\_\_\_\_

c. Nearest Major Cross Street: 13<sup>th</sup> Street

d. Describe Building:  Free Standing Building  Strip Mall  Other: \_\_\_\_\_

e. Describe Premises Structure:  Single Story  Multi-Story - # of Stories 2  Other: \_\_\_\_\_

f. Describe Surrounding Area:  Commercial  Residential  Industrial  Other: \_\_\_\_\_

g. Building Owner Name: Martin Sanchez Phone Number: 414-241-6827

Business Owner Address: 3624 W Grant Street, Milwaukee WI 53215

## 10. Hours of Operation & Customers

Will customers be entering the premises?  No  Yes

Day of the Week	Proposed Hours of Operation:		Estimated Number of Customers expected each day	Potential Age Range of Customers	Class B Tavern Applicant Only: Age Restriction (If none, write 'None')
	Open Time (include a.m. or p.m.)	Close Time (include a.m. or p.m.)			
Sunday					
Monday	11:00 AM	7:00 PM	10	30 years	
Tuesday	11:00 AM	7:00 PM	↑ ↓	↑ ↓	
Wednesday	11:00 AM	7:00 PM			
Thursday	11:00 AM	7:00 PM			
Friday	11:00 AM	7:00 PM			
Saturday	11:00 AM	7:00 PM			

Extended Hours Establishment License is required for any convenience store, filling station, personal service establishment (such as tattoo, body piercing, salon, tailor, tanning, etc.), recording studio or restaurant which is open between the hours of 12 a.m. and 5 a.m.

Entertainment Indoor Closing Hours : If alcohol beverage establishment, same as alcohol license hours.  
If non-alcohol establishment 1:00 am Sunday to Thursday; 1:30 am Friday and Saturday.

Entertainment Outdoor Closing Hours : 10:00 pm Sunday – Thursday; 12:00 am Friday and Saturday,  
unless otherwise approved by Common Council in licensee's plan of operation.

## 11. Signature(s)

Martin Sanchez  
Sole Proprietor, Partner, Agent, or 20% or more Shareholder

\_\_\_\_\_  
Signature of additional partner or 20% or more Shareholder

See Application Information for a complete list of all required application forms.



RECYCLING, SALVAGING OR TOWING PREMISES LICENSE SUPPLEMENTAL APPLICATION

ccl-rstprem 12/11/15

Office of the City Clerk License Division
200 E. Wells St. Room 105, Milwaukee, WI 53202
(414) 286-2238 e-mail address: license@milwaukee.gov

Legal Entity Name: SAUTER WELDING and Rim Repair LLC

Business Address: 1662 S 13th St. Milw WI 53204

Do you currently hold any licenses in the City of Milwaukee? [ ] No [ ] Yes If yes, list:

Has any person on the application ever had a license relating to the activities licensed in Milwaukee Code of Ordinances Chapter 93 denied, not renewed, suspended, or revoked? [X] No [ ] Yes

If yes, provide the circumstances and jurisdiction in which the event occurred (including a record of any actions from the State Department of Transportation and Financial Institutions relating to suspensions, revocations, forfeitures and warnings imposed by these departments relating to the operation of any automotive sales business by the applicant):

Do you understand that you must follow all recordkeeping, reporting and operating regulations in MCO 93-43-49? [ ] No [X] Yes
Do you understand that all records and reports must be available to the police department upon request? [ ] No [X] Yes

Business Operations

Check all activities that apply:

Non-Consensual Towing: Provide the address within the City of Milwaukee where vehicles will be towed:

Junk/Valuable Metal: [ ] Dealing, Storing and/or Transporting [ ] Removing and/or Recycling

Waste Tires: [X] Dealing, Storing and/or Transporting [X] Removing and/or Recycling

Salvaged Motor Vehicle Parts: [X] Dealing, Storing and/or Transporting [X] Removing and/or Recycling (including tires/batteries)

Do you have an additional yard(s) used for storage? [X] No [ ] Yes
If yes, provide the address(es) below and submit an additional \$50 per yard:

How many motor vehicles will be used in the business operations? 1 Provide information for each vehicle on page 2.

Required Signature(s)

Martin Sanchez
Sole Proprietor, Partner, 20% or more Shareholder, or the Agent - only if there are no 20% or more shareholders

Signature of additional partner or 20% or more shareholder

Table with 5 columns: Office Use Only, Initials, Filed, App#, YD#, Permit #s, Paid, MPD, DNS, LC, CC, Mayor's Signature, License #

### Recycling, Salvaging or Towing - Vehicle Information

(attach additional pages as needed)

Vehicle Make: <i>Chevy</i>	Model: <i>Colorado</i>	Year: <i>2004</i>	Plate #: <i>JM1747</i>
VIN #: <i>JT6CC5146548150429</i>		US DOT # or WI DOT operating authority:	Assigned Permit #: <i>2187</i>
Vehicle Make:	Model:	Year:	Plate #:
VIN #:		US DOT # or WI DOT operating authority:	Assigned Permit #:
Vehicle Make:	Model:	Year:	Plate #:
VIN #:		US DOT # or WI DOT operating authority:	Assigned Permit #:
Vehicle Make:	Model:	Year:	Plate #:
VIN #:		US DOT # or WI DOT operating authority:	Assigned Permit #:
Vehicle Make:	Model:	Year:	Plate #:
VIN #:		US DOT # or WI DOT operating authority:	Assigned Permit #:
Vehicle Make:	Model:	Year:	Plate #:
VIN #:		US DOT # or WI DOT operating authority:	Assigned Permit #:
Vehicle Make:	Model:	Year:	Plate #:
VIN #:		US DOT # or WI DOT operating authority:	Assigned Permit #:
Vehicle Make:	Model:	Year:	Plate #:
VIN #:		US DOT # or WI DOT operating authority:	Assigned Permit #:
Vehicle Make:	Model:	Year:	Plate #:
VIN #:		US DOT # or WI DOT operating authority:	Assigned Permit #:



**CITY OF MILWAUKEE  
OFFICE OF THE CITY CLERK**

Wednesday, October 05, 2016

**COMMITTEE MEETING NOTICE**

AD 12

TURNER-VERGARA, Kimberly, Agent  
Mahij LLC  
111 E Seeboth St #414

Milwaukee, WI 53204

You are requested to attend a hearing which is to be held in Room 301-B, Third Floor, City Hall on:

**Tuesday, October 18, 2016 at 10:15 AM**

**Regarding:** Your Class B Tavern, Food Dealer, and Public Entertainment Premises License Applications Requesting Bands, Disc Jockey, Instrumental Musicians,  Contests, Patrons Dancing, and 4 Concerts as agent for "Mahij LLC" for "Michai's Quiet Storm Smooth Jazz Lounge" at 161 S 1ST St.

There is a possibility that your application may be denied for one or more of the following reasons: The recommendation of the committee regarding the application shall be based on evidence presented at the hearing. Per MCO 85-2.7-4, probative evidence concerning whether or not a new license should be granted may be presented on the following subjects: whether or not the applicant meets the municipal requirements, the appropriateness of the location and premises where the licensed premises is to be located and whether use of the premises for the purposes or activities permitted by the license would tend to facilitate a public or private nuisance or create undesirable neighborhood problems such as disorderly patrons, unreasonably loud noise, litter, and excessive traffic and parking congestion. Probative evidence relating to these matters may be taken from the plan of operation submitted with the license application, if any, but shall not include the content of any music. Evidence regarding the fitness of the location of the premises to be maintained as the principal place of business, including but not limited to whether there is an overconcentration of businesses of the type for which the license is sought; whether the proposal is consistent with any pertinent neighborhood business or development plans, or the location's proximity to areas where children are typically present. The applicant's record in operating similarly licensed premises; and whether or not the applicant has been charged with or convicted of any felony, misdemeanor, municipal offense or other offense, the circumstances of which substantially relate to the activity to be permitted by the license being applied for or any other factor which reasonably relates to the public health, safety or welfare may also be considered. See attached police report or correspondence.

**Notice for applicants with warrants or unpaid fines:**

**Proof of warrant satisfaction or payment of fines must be submitted at the hearing on the above date and time. Failure to comply with this requirement may result in a delay of the granting/denial of your application.**

Failure to appear at this meeting may result in the denial of your license. Individual applicants must appear only in person or by an attorney. Corporate or Limited Liability applicants must appear only by the agent designated on the application or by an attorney. Partnership applicants must appear by a partner listed on the application or by an attorney. If you wish to do so and at your own expense, you may be accompanied by an attorney of your choosing to represent you at this hearing.

You will be given an opportunity to speak on behalf of the application and to respond and challenge any charges or reasons given for the denial. No petitions can be accepted by the committee, unless the people who signed the petition are present at the committee hearing and willing to testify. You may present witnesses under oath and you may also confront and cross-examine opposing witnesses under oath. If you have difficulty with the English language, you should bring an interpreter with you, at your expense, so that you can answer questions and participate in your hearing.

You may examine the application file at this office during regular business hours prior to the hearing date. Inquiries regarding this matter may be directed to the person whose signature appears below.

Limited parking for persons attending meetings in City Hall is available at reduced rates (5 hour limit) at the Milwaukee Center on the southwest corner of East Kilbourn and North Water Street. Parking tickets must be validated in the first floor information booth in City Hall.

PLEASE NOTE: Upon reasonable notice, efforts will be made to accommodate the needs of disabled individuals through sign language interpreters or other auxiliary aids. For additional information or to request this service, contact the Council Services Division ADA Coordinator at (414) 286-2998, Fax - (414) 286-3456, TDD - (414) 286-2025.

JIM OWZARSKI, CITY CLERK

BY: \_\_\_\_\_

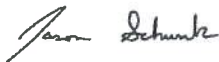

Jason Schunk  
License Division Manager

**If you have questions regarding this notice, please contact the License Division at (414) 286-2238.**

Date:08/12/16  
Officer: J. Alba

City of Milwaukee Police Department  
90-5-1.5 Crime Prevention Survey  
Tavern Inspection

Name of Premise: Michai Quiet Smooth Jazz Lounge  
Address: 161 S. 1<sup>st</sup> St.  
Phone: 414-915-8004

Owner: Kimberly M. Turner- Vergara B/F 07/27/70  
Owner address: 111 E. Seeboth St. #414  
City State Zip: Milwaukee, WI. 53204  
Owner Phone: 414-915-8004  
Owner email:

Licensee/Agent: Owner  
Home Address:  
City State Zip:  
Phone:  
Email:

Preferred contact: Owner

Location currently open:  YES  NO

Projected open date: 11/15/16

Day's open: S M T W Th F SA ALL

Hours of Operation: Sun: 8am-11pm 24 hours Y N  
Mon: Closed  
Tue: 5pm-11pm  
Wed: 5pm-11pm  
Thu: 5pm-11pm  
Fri: 5pm-2:30am  
Sat: 5pm-2:30am

Premise Type: Tavern/Bar  
Restaurant  
Other: rental hall



Licenses currently held:

- Alcohol:  Yes  No Class: #:  
Tobacco:  Yes  No #:  
Food:  Yes  No #:  
Other:  Yes  No Type: #:  
Other:  Yes  No Type: #:

**Exterior Survey:**

1. Is the area around the location clean?  Yes  No
2. What surrounds the location? (Check all the apply)
  - a.  Park
  - b.  School
  - c.  Youth Center
  - d.  Church
  - e.  Tavern(s) If so, how many
  - f.  Residential
  - g.  Other businesses
  - h.  Other:
3. Can you see from the outside of the location into the interior  Yes  No
4. Can you see the employees inside of the location from the outside  Yes  No
5. Are exterior windows free of signage  Yes  No
6. Street parking  Yes  No
7. Is there a parking lot  Yes  No
8. Is the parking lot clean?  Yes  No
9. Is the parking lot well lit?  Yes  No
10. Valet Parking  Yes  No
  - a. Will this lot have a guard?  Yes  No
  - b. Will this lot have cameras?  Yes  No
11. Are there areas where a person could conceal themselves  Yes  No
12. Is there exterior lighting?  Yes  No. Does it appears to be adequate  Yes  No
13. Exterior Payphone?  Yes  No
14. Are there No Loitering Signs posted?  Yes  No
15. Are there exterior security cameras  Yes  No How Many: 2 planned
16. Are the address numbers prominently displayed and easy to see  Yes  No

**Camera Survey:**

17. Does this location have security cameras?  Yes  No
18. Are they in working order?  Yes  No
19. What format are the cameras?
  - a. Color  Yes  No
  - b. Digital  Yes  No
  - c. VCR  Yes  No
  - d. Recorded  Yes  No
20. How long is footage stored for later viewing: 30 days
21. Are there exterior cameras  Yes  No How many: 2 planned
22. Are there interior cameras  Yes  No How many: 2 planned

23. Do all employees know how to retrieve recorded digital images/footage?  Yes  No  
 24. Cameras located in parking lot  Yes  No How many N/A

**Interior Survey:**

25. What is the planned/posted capacity 150, 2150 Sqr. Ft.  
 26. What is the minimum number of employees that will be on premise 3  
 27. Is the storeowner willing to be a standing complainant regarding loitering?  Yes  No  
 a. If yes have them fill out the standing complaint form and give them two of the commercial signs  Yes  No  
 28. Is the interior of the location neat and clean?  Yes  No  
 29. Does an interior camera face the entrance/exit?  Yes  No  
 30. Are emergency and non-emergency numbers posted near the phone?  Yes  No  
 31. Does the owner know how to contact their police district directly?  Yes  No  
 a. Did you provide a district contact guide to the owner?  Yes  No

**Security**

32. How many security personnel are going to be employed: 0  
 33. How will they be deployed: Interior Exterior  
 34. What days will they be deployed  Mon  Tue  Wed  Thu  Fri  Sat  Sun  
 35. Will the security be managed by business  or contracted   
 36. Will they be armed  Yes  No  
 37. What type of security measures will be used:  
 Wanding/metal detector  
 ID Scanner  
 Dress Code  
 Cover Charge  
 Age restriction  
 Other ID at service by trained staff  
 38. When at capacity, how will the overflow crowd be managed?  
 39. Will a guard monitor the overflow crowd at all times?  Yes  No

**ADDITIONAL COMMENTS/RECOMMENDATIONS:**

- Applicant has never held liquor license.
- Upscale live jazz lounge planned for target aged 30yoa clientele.
- Application for top shelf liquor, wine and beer. No beer taps planned.
- Live music planned for Thu., Fri., Sat. nights.
- \$4K planned in renovation of existing space.

# Alcohol License Concentration for 161 S 1st St

City of Milwaukee, Wisconsin

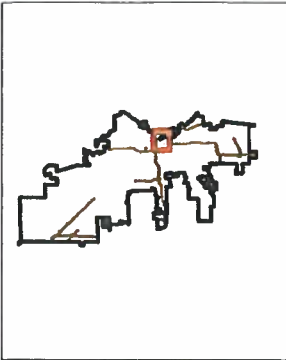

## - Legend -

- City limits
- Parcels
- Freeways
- Exit ramps
- Entry ramps
- Ramps
- Major streets
- Streets
- Waterways
- Alcohol licenses
  - Class A intoxicating liquor
  - Class A fermented malt beverage
  - Class A liquor and malt
  - Class B fermented malt beverage
  - Class B tavern
  - Class C wine retailer



## - Notes -

Licensed Alcohol Establishments Within a .5 Mile Radius Centered on 161 S 1st St on 08/04/16



Department of Administration - ITMD

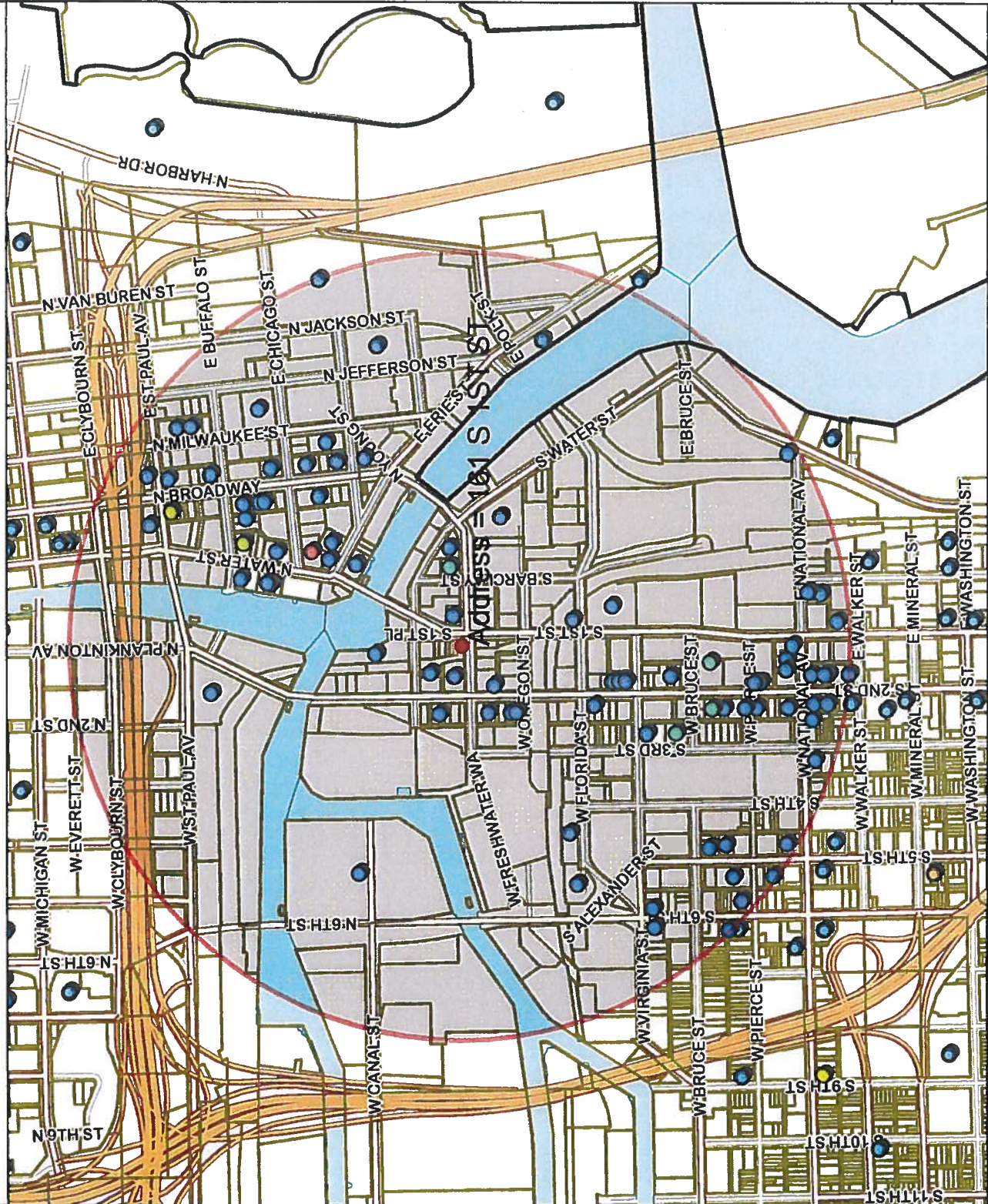

Map Scale: 1: 11,463

Licensed Alcohol Establishments Within a .5 Mile Radius Centered on 161 S 1st St on 08/04/2016

Legal entity	Trade name	Licensee	Address	License type name	Total capacity	Room capacity	Expiration date
Bhatia Corp	Fine Vineyard	VARINDER P BHATIA, Agt	601 S 1st St	Class A Malt & Class A Liquor License			2/9/2017
CIRCLE K LLC	CIRCLE K PANTRY	ZIAD W KALID, Agt	130 N WATER ST	Class A Malt & Class A Liquor License			12/10/2016
Central Standard LLC	Central Standard Craft Distillery	William P McQuillan, Agt	613 S 2ND ST 609	Class B Fermented Malt Beverage Retailer's License			3/3/2017
Clutch Corp	Anodyne Coffee Roasting Co.	Matthew J McClutchy, Agt	224 W Bruce St	Class B Fermented Malt Beverage Retailer's License			10/1/2016
Collective Coffee Roasters, Inc	Collective Coffee Roasters, Inc	William D Sisker, Agt	225 E ST PAUL AV	Class B Fermented Malt Beverage Retailer's License	49		4/1/2017
Girl Corporation	Stone Creek Coffee	Eric A Resch, Agt	158 S Barclay St	Class B Fermented Malt Beverage Retailer's License			7/22/2017
JING'S CORPORATION	JING'S	NICK W WANG, Agt	207 E BUFFALO ST 168	Class B Fermented Malt Beverage Retailer's License	45		7/30/2017
KARAMPELAS INVESTMENTS INC	GYRO PALACE	NICK A KARAMPELAS, Agt	602 S 2ND ST	Class B Fermented Malt Beverage Retailer's License	75		5/8/2017
126 Seeboth, LLC	Wine Mania On The River	Debra A Bertrand, Agt	106 W Seeboth ST 103	Class B Tavern License	124		7/5/2017
223 N Broadway LLC	Onesto	JOSEPH J SORGE, JR, Agt	221-223 N Broadway	Class B Tavern License	288		7/17/2017
700 CLUB, LLC	SABBATIC	JAY K STAMATES, Agt	700 S 2ND ST	Class B Tavern License	80		12/30/2016
AP, LLC	AP Bar & Kitchen	PEGGY J MAGISTER, Agt	814 S 2nd St	Class B Tavern License			7/22/2017
Ashley's Que LLC	Ashley's Que	Darnell D Ashley, Agt	124 W NATIONAL AV	Class B Tavern License	455		8/13/2016
Benelux Third Ward, LLC	Cafe Benelux	ERIC G WAGNER, Agt	346 N Broadway	Class B Tavern License			5/1/2017
Black Tuna LLC	Lucky Ginger	Souklay Savanongsa, Agt	221 N Water St	Class B Tavern License	48	48 Interior	10/13/2016
Caminobar LLC	Caminobar	CASEY A RATAZAK, Agt	434 S 2nd St	Class B Tavern License			3/28/2017
Camp Bar Inc	Camp Bar	Paul C Hackbarth, Agt	525 E Menomonee St	Class B Tavern License	128		7/15/2016
CARNAL LLC	CLUB CHARLIES	CRAIG M BLOOMFIELD, Agt	320 E MENOMONEE ST	Class B Tavern License	160		7/15/2016
CENTANNI, LLC	Gouda's Italian Deli and Bugey's, A Back Alley Saloon	Joseph McLean, Agt	218 N WATER ST	Class B Tavern License	359		12/17/2016
Champion Productions, LLC	Kana Mojito Club	ANGEL M VELAZQUEZ, Agt	626 S 5TH ST	Class B Tavern License	198		3/1/2017
CIEUTO UNDO, LLC	CIEUTO UNDO	RODRIGO R LOPEZ, Agt	733-39 S 2ND ST	Class B Tavern License			7/30/2017
COLGAN, LLC	THE IRISH PUB	REBECCA GOLDBERGER, Agt	124 N WATER ST	Class B Tavern License	210	160 1st floor and patio	12/13/2016
CONPROV, INC	COMEDY SPORTZ	Jason Manske, Agt	420 S 1ST ST	Class B Tavern License	320		6/30/2017
COOPER'S PLACE, INC	COOPER'S PLACE	THOMAS A MILLER, Agt	539 W VIRGINIA ST	Class B Tavern License	144		3/19/2017
Oak	Oak	SEAN A PUSS, Agt	231 E BUFFALO ST	Class B Tavern License	170		11/12/2016
COQUETTE CAFE, INC	COQUETTE CAFE	NICHOLAS A BURKI, Agt	316 N MILWAUKEE ST	Class B Tavern License	150		2/6/2017
Cuvee Champagne LLC	Cuvee	KRIS H GORSKI, Agt	177 N BROADWAY	Class B Tavern License	244		5/23/2017
DW Pub, LLC	Drink Wisconsin Pub	Laura Marie Van Heijningen, Agt	135 E National AV	Class B Tavern License	88		4/20/2017
ECNS Inc	Engine Co No 3	AUGUSTO P SANDRONI, JR, Agt	217 W National AV	Class B Tavern License			2/1/2017
El Chelo LLC	El Chelo	Ruben Abaniti, Agt	625 S 6TH ST	Class B Tavern License	106		5/12/2017
El Fanoir Bar, LLC	El Fanoir Bar	BEVERLYN GONZALEZ DEL TORO, Agt	819 S 2ND ST	Class B Tavern License			11/2/2016
FLUID, INC	FLUID	WILLIAM M WARDLOW, Agt	330 E ST PAUL AV	Class B Tavern License	320		6/13/2017
GROOM FOR MEN, INC	Groom for Men / Groom Lounge	Terril J DeBoode, Agt	138 N Broadway	Class B Tavern License	320		5/29/2017
HTWA - Catalano Square	HTWA - Catalano Square	MICHAEL GARDNER, Agt	400 N WATER ST	Class B Tavern License	156		1/17/2017
HTWA MARKET PROJECT, LLC	MILWAUKEE PUBLIC MARKET	MICHAEL GARDNER, Agt	158 N Broadway	Class B Tavern License	550		7/29/2017
Indulgence Wine Rooms LLC	Indulgence Wine Rooms	MARC R BIANCHINI, Agt	211 S 2nd St	Class B Tavern License	99		6/22/2017
Indulgence Chocolaters LLC	Indulgence Chocolaters	Julie A Waterman, Agt	500 W FLORIDA ST	Class B Tavern License	99		6/16/2017
Iron Horse Milwaukee, LLC	The Iron Horse Hotel	THOMAS J DYON, Agt	931 E CHICAGO ST	Class B Tavern License			4/11/2017
ITALIAN CONFERENCE CENTER INC	ITALIAN CONFERENCE CENTER	LAURIE J BIESCI, Agt	623 S 2nd St	Class B Tavern License			6/30/2017
JD Commercial LLC	Picture Pizza Pub	Joshua D Taylor, Agt	605 W Virginia St	Class B Tavern License			6/23/2017
Juto, LLC	Juto	Tua Thao, Agt	310 E Chicago St	Class B Tavern License			6/16/2017
Kimpton Hotel & Restaurant Group LLC	Journeyman Hotel	Kyle A Strigent, Agt	231 S 2nd St	Class B Tavern License			9/5/2017
Konsak Enterprises, LLC	Zaks Cafe	Douglas R Konzak, Agt	354 E NATIONAL AV	Class B Tavern License	160	80 first floor 1st floor and basement storage-480 2nd floor tavern and show lounge-200 Portion of lower level restaurant-90	
KRUZ, LLC	KRUZ	SERGE PELLICELLI, Agt		Class B Tavern License			
LA CAGE ENTERPRISES, LLC	LA CAGE	MICHAEL J JOST, Agt	801 S 2ND ST	Class B Tavern License	815		12/17/2016
LA FUENTE LTD	LA FUENTE RESTAURANT	JOSE G ZARATE, Agt	625-31 S 5TH ST	Class B Tavern License	579		5/24/2017
LA MERENDA, INC	LA MERENDA	AUGUSTO P SANDRONI, JR, Agt	125 E NATIONAL AV	Class B Tavern License	146		11/13/2016
LA PERLA, LLC	LA PERLA RESTAURANT	JOANNE A ANTON, Agt	730-34 S 5TH ST	Class B Tavern License	117		10/17/2016
Levy Restaurants at Harley Davidson	Levy Restaurants at Harley Davidson	Dave Kash, Agt	401 W CANAL ST	Class B Tavern License	690	250 - Restaurant, 440 - Special Events Room	5/19/2017
LOLA'S, LLC	WALKERS PINT	ELIZABETH A BOENNING, Agt	818 S 2ND ST	Class B Tavern License	150	93 inside, 57 out with 1 portable restroom	6/28/2017
LOUNGING AROUND, INC	Yme Nightclub	SAMER L ASAD, Agt	715-17 S 5TH ST	Class B Tavern License	320	2nd floor = 80; 1st floor = 240	4/8/2017
MC ZAR'S, LLC	O'Yehli's Bar & Grill	Linda M Sackett, Agt	338 S 1ST ST	Class B Tavern License	150		6/5/2017
Memento LLC	Bavette	Karen E Bell, Agt	330 E Menomonee St	Class B Tavern License			5/20/2017
Merriment Social LLC	Merriment Social	Andrew H Miller, Agt	240 E Pilsburgh AV	Class B Tavern License			7/17/2017
Moroi Restaurant LLC	Moroi Restaurant	Jonathan S Manyo, Agt	430 S 2nd St	Class B Tavern License	49		8/12/2017
Movida LLC	Movida	Aaron R Gersonde, Agt	524 S 2ND ST	Class B Tavern License	320		6/30/2017
MP On Wheels	MP On Wheels Catering Service	DULCE M ALARCON, SP	400 N WATER ST	Class B Tavern License		42	6/11/2017
MP On Wheels Family Market LLC	Nehring's Family Market	ANNE C FINCH-NEHRING, Agt	400 N Water ST 6	Class B Tavern License			9/19/2016
Next Act Theatre, Inc.	Next Act Theatre	David A Caccarini, Agt	255 S Water St	Class B Tavern License			7/5/2017
Noble Provisions, LLC	The Noble	DAVID G KRESSIN, Agt	704 S 2nd St	Class B Tavern License	50		

Total

Grand Total = 101

Pritzlaff Redevelopment, LLC	Pritzlaff	325-33 N Plankinton AV	Class B Tavern License	915 325 N Plankinton - 315, 333 N Plankinton - 600	5/21/2017
Pritzlaff Redevelopment, LLC	Kendall G Breunig, Agt	143 W St Paul AV	Class B Tavern License		5/21/2017
RCW LLC	Stuart E Rudolph, Agt	408 W FLORIDA ST 102	Class B Tavern License		5/16/2017
RELO CORPORATION	RIVERFRONT PIZZERIA BAR AND GRILL	509 E ERIE ST	Class B Tavern License	300	9/5/2017
ROJUI, INC	GINGER	235 S 2ND ST	Class B Tavern License	150	7/30/2016
Romp LLC	Kasana	241 N BROADWAY 1	Class B Tavern License		11/06/2016
S&S Hospitality Concepts, LLC	Black Sheep	216 S 2nd ST	Class B Tavern License	240	4/9/2017
Sa?z Catering Inc	Sa?z Second: A Sa?z's Hospitality Group Property	838 S 2nd ST	Class B Tavern License		4/12/2017
Sa?z of Milwaukee Inc.	Stack'D Burger Bar	170 S 1st ST	Class B Tavern License		3/31/2017
SCREAMING TUNA RESTAURANT, LLC	SCREAMING TUNA	106 W SEEBOTH ST 102	Class B Tavern License	174	6/14/2017
SHAKERS, INC	SHAKERS CIGAR BAR & WORLD CAFE	422 S 2ND ST	Class B Tavern License	144	10/13/2016
Smoke Shack LLC	Smoke Shack	332 N Milwaukee ST	Class B Tavern License	91, Interior capacity = 91, Beer Garden capacity = 75	2/7/2017
Splash Studio Inc	Splash Studio	184 N Broadway	Class B Tavern License	150	2/27/2017
ST. PAULI SEAFOOD, LLC	ST. PAULI FISH CO.	400 N WATER ST	Class B Tavern License		6/23/2017
STERN'S, INC	STERN'S	800 S 2ND ST	Class B Tavern License	160	11/22/2016
STRAIGHT/AHEAD, INC	CAROLINE'S	401 S 2ND ST	Class B Tavern License	136	2/7/2017
SURG Waterfront, LLC	SURG On The Water	102 N WATER ST	Class B Tavern License	290	3/22/2017
Sway Guild LLC	Klik Laurija	606-608 S 5TH ST	Class B Tavern License	330	9/1/2016
Swig MKE, LLC	Swig	217 N BROADWAY	Class B Tavern License	100	2/7/2017
The Chef's Table LLC	The Chef's Table	500 S 3rd ST	Class B Tavern License		9/23/2016
The Flow DJ's Entertainment LLC	VIP Lounge	828 S 1st ST	Class B Tavern License	300	9/23/2016
The Hudson Business Lounge LLC	The Hudson Business Lounge	310 E Buffalo ST	Class B Tavern License		10/14/2016
The Red Arrow Bar, LLC	Little Whiskey Bar	309 W National AV	Class B Tavern License	49	4/6/2017
THE SALOON, LTD	JUST ART'S SALOON	181 S 2ND ST	Class B Tavern License	70	6/30/2017
The Seaboth LLC	The Seaboth	131 W Seeboth ST	Class B Tavern License		12/3/2016
THE TRIPLE BELT CORPORATION	D.L.X.	739 S 1st ST	Class B Tavern License	180	10/22/2016
THE V BAR, LLC	The Tin Willow	703 S 2ND ST	Class B Tavern License	49	4/16/2017
THE WICKED HOP, LLC	THE WICKED HOP	343-45 N BROADWAY	Class B Tavern License	160	3/1/2017
THIEF WINE, LLC	THIEF WINE SHOP & BAR	400 N WATER ST	Class B Tavern License	42	6/30/2017
TRESSLER THIRD WARD, LLC	Hinterland Erie Street Gastropub	222 E ERIE ST 100	Class B Tavern License	300	4/16/2017
Two Nephews One Uncle, LLC	Lucky Joe's Tiki Room	196 S 2nd ST	Class B Tavern License	80	8/4/2016
Var Gallery & Studios LLC	Var Gallery & Studios	643 S 2nd ST	Class B Tavern License		12/1/2016
VINO THIRD WARD, LLC	VINO 100 MILWAUKEE THIRD WARD	302C N WATER ST	Class B Tavern License	41	11/2/2016
Woorl Corp	Water Buffalo	249 N WATER ST	Class B Tavern License	240	2/7/2017
Wunderjak Enterprises, LLC	Kanpai	408 E Chicago ST	Class B Tavern License	99	9/4/2017
ZAD'S, INC	Fat Daddy's	120 W National AV	Class B Tavern License	270 92 - First floor, 178 - Beer Garden	4/10/2017
ZARLETTI, LLC	ZAD'S	436-38 S 2ND ST	Class B Tavern License	160	2/13/2017
Clutch Corp	RUSTIC	224 N WATER ST	Class B Tavern License	160	5/24/2017
Collectivo Coffee Roasters, Inc	Anodyne Coffee Roasting Co.	224 W Bruce ST	Class C Wine Retailer's License		10/1/2016
Giri Corporation	Collectivo Coffee Roasters, Inc	William D Suley, Agt	Class C Wine Retailer's License		4/1/2017
JING'S CORPORATION	JING'S	158 S Barclay ST	Class C Wine Retailer's License		7/22/2017
		207 E BUFFALO ST 168	Class C Wine Retailer's License	45	7/30/2017



Wednesday, October 05, 2016

## Licenses Committee Notice of Hearing

161 First LLC  
Capital Properties  
600 N BROADWAY  
STE 110  
Milwaukee, WI 53202

Date: 10/18/2016  
Time: 10:15 AM  
Location: Room 301-B, Third Floor, City Hall

The Licenses Committee will consider the following license application:

Class B Tavern, Food Dealer, and Public Entertainment Premises License  
Applications Requesting Bands, Disc Jockey, Instrumental Musicians, Patron  
Contests, Patrons Dancing, and 4 Concerts  
TURNER-VERGARA, Kimberly, Agent  
Michai's Quiet Storm Smooth Jazz Lounge at 161 S 1ST St

Please note this application may be recommended for denial based on fitness of the location due to concentration of alcohol beverage outlets in the area. If the application is denied for this reason, no other application for an alcohol beverage license for this location shall be recommended for approval by the Licenses Committee within three years of the date of denial unless the applicant has demonstrated a change of circumstances since the prior denial.

If you have any questions, please call (414) 286-2238.





Wednesday, October 05, 2016

## Licenses Committee Notice of Hearing

South 1st LLC  
Capital Properties  
161 S 1st St  
Milwaukee, WI 53204

Date: 10/18/2016  
Time: 10:15 AM  
Location: Room 301-B, Third Floor, City Hall

The Licenses Committee will consider the following license application:

Class B Tavern, Food Dealer, and Public Entertainment Premises License  
Applications Requesting Bands, Disc Jockey, Instrumental Musicians, Patron  
Contests, Patrons Dancing, and 4 Concerts  
TURNER-VERGARA, Kimberly, Agent  
Michai's Quiet Storm Smooth Jazz Lounge at 161 S 1ST St

Please note this application may be recommended for denial based on fitness of the location due to concentration of alcohol beverage outlets in the area. If the application is denied for this reason, no other application for an alcohol beverage license for this location shall be recommended for approval by the Licenses Committee within three years of the date of denial unless the applicant has demonstrated a change of circumstances since the prior denial.

If you have any questions, please call (414) 286-2238.





Wednesday, October 05, 2016



# Notice of Public Hearing

---

TURNER-VERGARA, Kimberly, Agent  
Michai's Quiet Storm Smooth Jazz Lounge at 161 S 1ST St  
Class B Tavern, Food Dealer, and Public Entertainment Premises License Applications  
Requesting Bands, Disc Jockey, Instrumental Musicians, Patron Contests, Patrons Dancing, and 4  
Concerts

**Tuesday, October 18, 2016 at 10:15 AM**

To whom it may concern:

The above application has been made by the above named applicant(s). This requires approval from the Licenses Committee and the Common Council of the City of Milwaukee. The hearing before the Licenses Committee will take place on 10/18/2016 at 10:15 AM, in Room 301-B, Third Floor, City Hall. If you wish, you may provide testimony at the hearing regarding the request; see below for further information. You are not required to attend the hearing. Once the Licenses Committee makes its recommendation, this recommendation is forwarded to the full Common Council for approval at its next regularly scheduled hearing. Please review the information below and if you have further questions regarding this process, please contact the License Division at (414) 286-2238.

---

## Important details for those wishing to provide information for the Licenses Committee to consider when making its recommendation:

1. The license application is scheduled to be heard at the above time. Due to other hearings running longer than scheduled, you may have to wait some time to provide your testimony.
2. You must appear in person and testify as to matters that you have personally experienced or seen. (You cannot provide testimony for your neighbor, parent or anyone else; this is considered hearsay and cannot be considered by the committee.)
3. No letters or petitions can be accepted by the committee (unless the person who wrote the letter or the persons who signed the petition are present at the committee hearing and willing to testify).
4. Persons opposed to the license application are given the opportunity to testify first; supporters may testify after the opponents have finished.
5. When you are called to testify, you will be sworn in and asked to give your name, and address. (If your first and/or last names are uncommon please spell them.)
6. You may then provide testimony.
  - a. Include only information relating to the above license application.
  - b. Include only information you have personally witnessed or seen.
  - c. Provide concise and relevant information detailing how this business has affected or may affect the peaceful enjoyment of your neighborhood.
  - d. If by the time you have the opportunity to testify, the information you wish to share has already been provided to the committee, you may state that you agree with the previous testimony. Redundant or repetitive testimony will not assist the committee in making its recommendation.
7. After giving your testimony, the members of the Licenses Committee and the licensee may ask questions regarding the testimony you have given or other factors relating to the license application.
8. Business Competition is not a valid basis for denial or non-renewal of a license.  
**Please Note: If you have submitted an objection to the above application your objection cannot be considered by the committee unless you personally testify at the hearing.**



OCCUPANT	MAIL ADDRESS	CITY AND ZIP CODE
CURRENT OCCUPANT	133 W PITTSBURGH AVE 401	MILWAUKEE, WI 53204-1464
CURRENT OCCUPANT	228 S 1ST ST B1	MILWAUKEE, WI 53204-1474
CURRENT OCCUPANT	131 W SEEBOTH ST	MILWAUKEE, WI 53204-1445
CURRENT OCCUPANT	133 W PITTSBURGH AVE 303	MILWAUKEE, WI 53204-1461
CURRENT OCCUPANT	133 W PITTSBURGH AVE 402	MILWAUKEE, WI 53204-1462
CURRENT OCCUPANT	133 W PITTSBURGH AVE 301	MILWAUKEE, WI 53204-1461
CURRENT OCCUPANT	133 W PITTSBURGH AVE 310	MILWAUKEE, WI 53204-1464
CURRENT OCCUPANT	133 W PITTSBURGH AVE 205	MILWAUKEE, WI 53204-1462
CURRENT OCCUPANT	133 W PITTSBURGH AVE 410	MILWAUKEE, WI 53204-1461
CURRENT OCCUPANT	133 W PITTSBURGH AVE 305	MILWAUKEE, WI 53204-1465
CURRENT OCCUPANT	133 W PITTSBURGH AVE 503	MILWAUKEE, WI 53204-1464
CURRENT OCCUPANT	133 W PITTSBURGH AVE 307	MILWAUKEE, WI 53204-1465
CURRENT OCCUPANT	133 W PITTSBURGH AVE 501	MILWAUKEE, WI 53204-1470
CURRENT OCCUPANT	133 W PITTSBURGH AVE 502	MILWAUKEE, WI 53204-1471
CURRENT OCCUPANT	133 W PITTSBURGH AVE 507	MILWAUKEE, WI 53204-1471
CURRENT OCCUPANT	133 W PITTSBURGH AVE 504	MILWAUKEE, WI 53204-1463
CURRENT OCCUPANT	133 W PITTSBURGH AVE B2	MILWAUKEE, WI 53204-1464
CURRENT OCCUPANT	133 W PITTSBURGH AVE 404	MILWAUKEE, WI 53204-1462
CURRENT OCCUPANT	133 W PITTSBURGH AVE 405	MILWAUKEE, WI 53204-1465
CURRENT OCCUPANT	133 W PITTSBURGH AVE 409	MILWAUKEE, WI 53204-1463
CURRENT OCCUPANT	133 W PITTSBURGH AVE B1	MILWAUKEE, WI 53204-1461
CURRENT OCCUPANT	133 W PITTSBURGH AVE 202A	MILWAUKEE, WI 53204-1470
CURRENT OCCUPANT	133 W PITTSBURGH AVE 309	MILWAUKEE, WI 53204-1464
CURRENT OCCUPANT	133 W PITTSBURGH AVE 205C	MILWAUKEE, WI 53204-1462
CURRENT OCCUPANT	228 S 1ST ST B3	MILWAUKEE, WI 53204-1474
CURRENT OCCUPANT	133 W PITTSBURGH AVE 304	MILWAUKEE, WI 53204-1465
CURRENT OCCUPANT	133 W PITTSBURGH AVE 202	MILWAUKEE, WI 53204-1471
CURRENT OCCUPANT	133 W PITTSBURGH AVE 302	MILWAUKEE, WI 53204-1470
CURRENT OCCUPANT	133 W PITTSBURGH AVE 505	MILWAUKEE, WI 53204-1464
CURRENT OCCUPANT	133 W PITTSBURGH AVE 406	MILWAUKEE, WI 53204-1463
CURRENT OCCUPANT	133 W PITTSBURGH AVE 206	MILWAUKEE, WI 53204-1461
CURRENT OCCUPANT	133 W PITTSBURGH AVE 306	MILWAUKEE, WI 53204-1465
CURRENT OCCUPANT	133 W PITTSBURGH AVE 403	MILWAUKEE, WI 53204-1465
CURRENT OCCUPANT	133 W PITTSBURGH AVE 407	MILWAUKEE, WI 53204-1461
CURRENT OCCUPANT	133 W PITTSBURGH AVE 308	MILWAUKEE, WI 53204-1464
CURRENT OCCUPANT	133 W PITTSBURGH AVE 506	MILWAUKEE, WI 53204-1471

**Total Records: 37**  
**Radius: 250.0 feet and Center of Circle: 161 S 1st ST**



# BUSINESS LICENSE PLAN OF OPERATION

ccl-busplan 5/24/16

Office of the City Clerk License Division  
200 E. Wells St. Room 105, Milwaukee, WI 53202  
(414) 286-2238 www.milwaukee.gov/license e-mail address: [license@milwaukee.gov](mailto:license@milwaukee.gov)

## 1. Type of Business

Applying for:  Extended Hours (12AM to 5AM) - If a food establishment, check all that apply:  Delivery  Drive Thru  Dining Room  
 Self Service Laundry  Rooming House  Hotel/Motel  Massage Establishment  Filling Station  
 Other (supplemental application for specific license also required)

Provide a detailed description of the type of business you plan on operating:

CLASS B DANCE TAPERS

Do you have any experience operating this type of business?  No  Yes If yes, explain:

## 2. Business Operations

- a. Proposed Opening Date: 11-20-16
- b. Is this premise under construction?  No  Yes If yes, list estimated completion date: \_\_\_\_\_
- c. Is this a franchise?  No  Yes
- d. Is this premises currently licensed?  No  Yes If yes, list type of license: \_\_\_\_\_
- e. Is the current licensee operating?  No  Yes If no, list date closed: \_\_\_\_\_
- f. Do you have future plans for other businesses, licenses or permits at this location?  No  Yes  
If yes, explain: Renovations to main floor-stage
- g. Have you previously held an Extended Hours License in Milwaukee?  No  Yes  
If yes, list address(es): \_\_\_\_\_
- h. Are other businesses operating in the same building?  No  Yes If yes, describe: Architect and Law Firm

## 3. Litter & Noise

- a. How are grounds kept clean?  Sweep  Pressure Wash  Pick Up Litter  Other: \_\_\_\_\_
- b. How often will grounds be cleaned?  Daily  Weekly  As Needed  Monthly  Other: \_\_\_\_\_
- c. Grounds cleaned by:  Licensee  Building Owner  Employees  Hired Maintenance  Other: \_\_\_\_\_
- d. How are noise issues prevented and/or addressed?  Security  Manager approaches customer(s)  Call Police  
 Signs Posted  Other: \_\_\_\_\_
- e. Will a sound amplification system be used?  No  Yes If yes, describe: MICROPHONE

## 4. Smoking & Sanitation

- a. Are there designated outdoor smoking areas?  No  Yes If yes, describe: \_\_\_\_\_
- b. Number of Garbage Cans: Inside: 4 Locations: (2) Storage Room (2) Under BAR  
Outside: 2 Locations: Behind Building Near PARKING Lot
- c. Is a crowd control barrier used?  No  Yes If yes, describe: \_\_\_\_\_
- d. How many restrooms are on the premises? 2
- e. Name of solid waste contractor:  Advanced Disposal  Waste Management  Other: \_\_\_\_\_



## 9. Premises Description

- a. Identify all area(s) of the premises that will be used in operating this business (include areas used only for storage):  
 1<sup>st</sup> Floor  2<sup>nd</sup> Floor  Basement Storage  Patio  Beer Garden  Sidewalk Café  Deck  Rooftop  
 Other: Describe: \_\_\_\_\_
- b. Describe Location:  Major Thoroughfare  Secondary Street  Other: \_\_\_\_\_
- c. Nearest Major Cross Street: Water Street and Pittsburgh
- d. Describe Building:  Free Standing Building  Strip Mall  Other: \_\_\_\_\_
- e. Describe Premises Structure:  Single Story  Multi-Story - # of Stories \_\_\_\_\_  Other: \_\_\_\_\_
- f. Describe Surrounding Area:  Commercial  Residential  Industrial  Other: \_\_\_\_\_
- g. Building Owner Name: South 1st LLC Phone Number: 297-3707  
 Business Owner Address: 111 South 1st Street

## 10. Hours of Operation & Customers

Will customers be entering the premises?  No  Yes

Day of the Week	Proposed Hours of Operation:		Estimated Number of Customers expected each day	Potential Age Range of Customers	Class B Tavern Applicant Only: Age Restriction (If none, write 'None')
	Open Time (include a.m. or p.m.)	Close Time (include a.m. or p.m.)			
Sunday	10 AM	1 PM	150	30↑	NONE
Monday					
Tuesday	5 PM	11 PM	150	30↑	NONE
Wednesday	5 PM	11 PM	150	30↑	NONE
Thursday	5 PM	2 AM	300	30↑	↓
Friday	5 PM	2 AM	300	30↑	
Saturday	5 PM	2 AM	300	30↑	

Extended Hours Establishment License is required for any convenience store, filling station, personal service establishment (such as tattoo, body piercing, salon, tailor, tanning, etc.), recording studio or restaurant which is open between the hours of 12 a.m. and 5 a.m.

Entertainment Indoor Closing Hours : If alcohol beverage establishment, same as alcohol license hours.  
 If non-alcohol establishment 1:00 am Sunday to Thursday; 1:30 am Friday and Saturday.

Entertainment Outdoor Closing Hours : 10:00 pm Sunday – Thursday; 12:00 am Friday and Saturday,  
 unless otherwise approved by Common Council in licensee's plan of operation.

## 11. Signature(s)

Kimberly Ann... [Signature]  
 Sole Proprietor, Partner, Agent, or 20% or more Shareholder

\_\_\_\_\_  
 Signature of additional partner or 20% or more Shareholder

See Application Information for a complete list of all required application forms.



**ALCOHOL BEVERAGE & PUBLIC ENTERTAINMENT PREMISES  
SUPPLEMENTAL PLAN OF OPERATION**

Office of the City Clerk License Division  
200 E. Wells St. Room 105, Milwaukee, WI 53202  
(414) 286-2238 e-mail address: license@milwaukee.gov www.milwaukee.gov/license

Legal Entity Name: Mahig LLC

Premise Address: 1101 South 1st Street

**Proximity of Premises to Church, School, Daycare Center or Hospital**

Is there at least 300 feet between the building and any church, school, daycare center or hospital?  Yes  No

**"Service Bar Only" Designation**

If applying for Class B or C license, are you applying for "Service Bar Only"?  No  Yes

Service Bar Only means customers cannot sit at the bar. Alcohol is served to patrons seated at tables. No stools, chairs or other articles of furniture shall be placed at the service bar for patrons to sit upon.

**Business Information**

a) Are you taking out this application for anyone that may not be eligible for a license?  No  Yes

If yes, list name and address: \_\_\_\_\_

b) Will the agent, a partner or the individual licensee be conducting the day-to-day operations of the business?  No  Yes

If no, list the name and address of the person(s) who will: \_\_\_\_\_

Class B Applicants: If the agent, a partner or the individual licensee will not be conducting the day-to-day operations of the business, the person(s) listed above must obtain a Class B Managers license.

c) Does anyone else have money invested or any other interest in this business?  No  Yes

If yes, explain: \_\_\_\_\_

d) Have you made an agreement with anyone to repay any loan or any other payments based upon income from the business?  
 No  Yes If yes, list name and address: Education's Credit Union

**Proof of Ownership, Lease, or Offer to Purchase (new & transfer applicants only)**

Submit proof of ownership, lease, or offer to purchase the building with this application.

A lease or offer to purchase must:

- a) Be in the same legal entity name as that apply for the license
- b) Reflect the same address as the premises address on this application
- c) Reflect current dates and
- d) Be signed by the lessor/seller and lessee/buyer

**Property Information (new & transfer applicants only)**

a) Do you own or lease the building?  Own  Lease

b) Who owns the fixtures (for example, coolers, etc.)? Building Owner - South 1101 First LLC

c) Are you purchasing the stock and/or fixtures?  No  Yes If yes, amount paid \$ \_\_\_\_\_

d) Total amount paid for business \$ 0

e) Total amount paid for goodwill of the business \$ 0

Goodwill comprises the reputation and customer relationships of an existing business. If the price you pay for the business exceeds the fair market value of all of the rest of the assets of the business, the excess may be considered goodwill.

f) Have you made arrangements with the seller for payment of personal property taxes?  No  Yes

**Lease Information (new & transfer applicants who are leasing the premises only)**

- a) Date lease begins \_\_\_\_\_ Ends \_\_\_\_\_
- b) Monthly rental \$ 4000.00
- c) Do you have an option to renew the lease?  No  Yes
- d) Does your lease allow for assignment to another party without the consent of the owner?  No  Yes
- e) For what length of time have you been guaranteed occupancy (number of years)? 3
- f) In addition to paying the monthly rental, will you have to pay anything additional to the owner of the building to guarantee performance of the lease?  No  Yes If yes, explain \_\_\_\_\_
- g) Does the present owner or occupancy object to the granting of your license?  No  Yes  
If yes, explain \_\_\_\_\_

**Change of Agent Applicants Only**

Have there been any changes to the floor plan since the last application was submitted?  No  Yes  
If no, a new floor plan is not required. If yes, submit a new floor plan and explain the change(s): \_\_\_\_\_

**Notarized Signatures of Applicants**

SUBSCRIBED AND SWORN TO BEFORE ME  
This 24th day of August, 2016  
[Signature]  
(Clerk/Notary Public)  
My Commission Expires in roman  
\*Notary Seal must be affixed.

[Signature]  
Sole Proprietor, Partner, 20% or more Shareholder, or  
Agent – only if there are no 20% or more shareholders  
  
\_\_\_\_\_  
Additional partner or 20% or more shareholder

Note: All information contained in this application is subject to approval by the Common Council.  
Deviating from approved plan of operation will subject licensee to citations, and/or suspension or non-renewal of the license.  
Contact the License Division for information on how to request changes.

**New and transfer of premise applicants must submit the following:**

- Proof of ownership, lease or offer to purchase the building
- Detailed floor plan
- If a restaurant, copy of the menu



## PUBLIC ENTERTAINMENT PREMISES LICENSE SUPPLEMENTAL APPLICATION

*Office of the City Clerk License Division*  
200 E. Wells St. Room 105, Milwaukee, WI 53202  
(414) 286-2238 [www.milwaukee.gov/license](http://www.milwaukee.gov/license) e-mail address: [license@milwaukee.gov](mailto:license@milwaukee.gov)

### TYPES OF ENTERTAINMENT (CHECK ALL THAT APPLY)

<input checked="" type="checkbox"/> Instrumental Musicians	<input checked="" type="checkbox"/> Bands	<input type="checkbox"/> Battle of the Bands	<input type="checkbox"/> Comedy Acts
<input checked="" type="checkbox"/> Disc Jockey	<input type="checkbox"/> Magic Shows	<input type="checkbox"/> Poetry Readings	<input type="checkbox"/> Dancing by Performers
<input type="checkbox"/> Jukebox	<input type="checkbox"/> Wrestling	<input checked="" type="checkbox"/> Patron Contests	<input checked="" type="checkbox"/> Patrons Dancing
<input type="checkbox"/> Adult Entertainment/ Strippers/Erotic Dance	<input type="checkbox"/> Karaoke	<input type="checkbox"/> Bowling Alley	<input type="checkbox"/> Pool Tables
<input type="checkbox"/> Motion Pictures	<input type="checkbox"/> Amusement Machines –	<input checked="" type="checkbox"/> Concerts	<input type="checkbox"/> Theatrical Performances
How many? _____	How many? _____	Approx. # per year? <u>4</u>	Approx. # per year? _____
<input type="checkbox"/> Other: _____			

Entertainment Indoor Hours: Alcohol beverage establishment: same as alcohol license hours.  
Non-alcohol establishment: 10:30am to 1:00am Sun to Thurs; 1:30am Fri-Sat

Entertainment Outdoor Closing Hours: 10:00pm Sunday-Thurs; 12:00am Friday & Saturday; unless otherwise approved by Common Council.

### PROMOTERS/SOUND AMPLIFICATION

Will promoters ever be used for any of the entertainment?  No  Yes If Yes, Describe: \_\_\_\_\_

At any time will sound amplification be used?  No  Yes If Yes, Describe: Microphone.

### LEGAL CAPACITY OF PREMISES

\_\_\_\_\_ (Call the Development Center at 414-286-8211 with questions.) Legal capacity determines the fee for your Public Entertainment Premises License. If you would like to request the license be approved with a lower capacity than that listed above, indicate the lower capacity here: \_\_\_\_\_. If approved, this lower capacity will print on your license and override the capacity listed on your Occupancy Permit.

### NOTARIZED SIGNATURES

I understand that after the license has been issued, a change to the plan of operation will require a written request to change and approval from the Common Council.

I agree to inform the City Clerk within 10 days of any substantial changes in the information supplied in this application.

I understand that I shall not willfully refuse to provide the services offered under this license, or add charges or require deposits not required of the general public because of race, color, sex, religion, national origin or ancestry, age, handicap, lawful source of income, marital status, sexual orientation, gender identity or expression, familial status or the fact that a person is now or has been a member of the military service, whether dressed in uniform or not; and shall not seek such information as a condition of employment, or penalize any employee or discriminate in the selection of personnel for training or promotion on the basis of such information.

I have knowledge of the City Ordinances currently regulating public entertainment, and understand that the license may be subject to suspension, non-renewal or revocation, if I violate any rule, law or regulation of the city of Milwaukee and State of Wisconsin.

### SUBSCRIBED AND SWORN TO BEFORE ME

This 4<sup>th</sup> day of August, 2016

[Signature]  
(Clerk/Notary Public)

My Commission Expires is permanent

\*Notary Seal must be affixed.

[Signature]  
Agent/20% or More Shareholder/Partner

\_\_\_\_\_  
Additional 20% or More Shareholder/Partner

Office Use Only: Initials: \_\_\_\_\_ Filed: \_\_\_\_\_ App: \_\_\_\_\_

Check if only PEP (must be heard w/in 60 days) Granted \_\_\_\_\_ License # \_\_\_\_\_



# FOOD DEALER LICENSE PLAN OF OPERATION

ccl-foodplan 2/22/16

OFFICE OF THE CITY CLERK, LICENSE DIVISION  
CITY HALL, 200 E. WELLS ST, ROOM 105, MILWAUKEE, WI 53202  
(414) 286-2238 • [license@milwaukee.gov](mailto:license@milwaukee.gov) • [www.milwaukee.gov/license](http://www.milwaukee.gov/license)

FREST  
234999

Legal Entity Name:	Mahij LLC		
Premises Address:	161 South 1 Street Milwaukee Wi 53204		
<b>SECTION 1</b>			
Type of application (check one):	<input type="checkbox"/> taking over a currently operating business <input checked="" type="checkbox"/> starting a new business		
Anticipated opening date?	11-20-16		
Check the type that best describes your business (check only one): See Food Dealer License Information sheet for definitions.			
<input checked="" type="checkbox"/> Restaurant	<input type="checkbox"/> Community Food Program <input type="checkbox"/> Bed & Breakfast <input type="checkbox"/> Base for Food Peddler <input type="checkbox"/> Base for Temporary/Seasonal Food Stand		
<input type="checkbox"/> Retail Establishment	<input type="checkbox"/> Yes <input type="checkbox"/> No (less than 5,000 sq ft of retail space, primary business is the sale of basic food items, and in addition sells household products)		
In addition, will any wholesale business be done?	<input type="checkbox"/> Yes <input checked="" type="checkbox"/> No		
If yes, what percentage of the business will be wholesale?	<input type="checkbox"/> Less than 25% <input type="checkbox"/> 25% or More (Contact DATCP)*		
Will retail items be sold?	<input checked="" type="checkbox"/> No <input type="checkbox"/> Yes    If Yes, indicate percentage of food sales _____ %		
Will restaurant items be sold?	<input type="checkbox"/> No* <input checked="" type="checkbox"/> Yes    If Yes, indicate percentage of food sales <u>100</u> %		
* If you checked "25% or More" of the business will be wholesale and answered "No" to restaurant items being sold, do not continue completing this application. A City of Milwaukee License is not required. Contact DATCP only.			
<b>SECTION 2</b>			
Will you be sharing kitchen space with another operator?			
<input checked="" type="checkbox"/> No	If No, SKIP to Section 3		
<input type="checkbox"/> Yes	If Yes, check one:		
<input type="checkbox"/> I will rent space from another operator	("Shared Kitchen Agreement" is required)		
<input type="checkbox"/> I will rent space to another operator (peddler/caterer)			
<b>SECTION 3</b>			
Answer the following questions:			
Will you have seating on site for dining?	<input type="checkbox"/> No	<input checked="" type="checkbox"/> Yes	
Will you be doing any catering?	<input checked="" type="checkbox"/> No	<input type="checkbox"/> Yes	
Will you be doing any delivery?	<input checked="" type="checkbox"/> No	<input type="checkbox"/> Yes	
Will you have outdoor activities?	<input type="checkbox"/> No	<input checked="" type="checkbox"/> Yes	
If Yes to outdoor activities, check all that apply:	<input checked="" type="checkbox"/> Bar	<input type="checkbox"/> Cooking/Grilling	<input checked="" type="checkbox"/> Dining
Will you have a drive thru window?	<input checked="" type="checkbox"/> No	<input type="checkbox"/> Yes	
If Yes to drive thru, are hours different from inside?	<input type="checkbox"/> No	<input type="checkbox"/> Yes	
If Yes, provide drive thru hours:	_____		
Will any scales or barcode scanners be used?	<input checked="" type="checkbox"/> No	<input type="checkbox"/> Yes	
If Yes, a Weights & Measures application must be completed and a license obtained.			



**SECTION 4**

Where will food be prepared and/or sold?

- At a single site
- At multiple sites (for example, a hotel with several dining rooms or bars) How many? \_\_\_\_\_  
 If multiple sites, attach a Food Dealer Additional Site Addendum (ccl-foodadd) for each additional site.

**SECTION 5**

Are you planning any construction, remodeling or equipment changes?

- No If No, SKIP to Section 6
- Yes If Yes, check all that apply:
- New construction of a building
  - Construction changes to an existing building
  - Renovation or remodeling
  - Equipment changes only (installation or replacement)

Provide a brief description of the changes: Compliance regarding walls, shelves and storage

Start date: Contingent on approval of food and liquor license.

Name, Address & Phone Number of Architect: Kelly Denk 161 South 1st Street  
414-292-3707

Name, Address & Phone Number of Contractor: G Construction 3221 N Silver Ceder Rd Oconomowoc  
WI 53066 Gary Ligman 262-510-6017

**SECTION 6**

Are you applying for an alcohol beverage license?

- No If No, SKIP to Section 7
- Yes If YES, if your food license is approved prior to the alcohol beverage license, when do you want the food license issued?  Immediately  At the same time as the alcohol license

**SECTION 7**

You must initial each item confirming your understanding:

- ktv I understand the Health Department must conduct an inspection and advise the License Division of their approval before the license may be issued.
- ktv I understand I must obtain an occupancy permit from the Department of Neighborhood Services and an inspection may be required. Neighborhood Services must advise the License Division of their approval before the license may be issued.
- ktv I understand the district alderperson will review and either approve or deny my application. If denied, I may appeal and be scheduled to appear before the Licenses Committee. The Licenses Committee will then make a recommendation to the Common Council. The Common Council must grant the license before it may be issued.
- ktv I understand proof of payment for all license fees must be on file in the License Division before the license may be issued.
- ktv I understand the license must be issued and posted in my establishment prior to opening for business.
- ktv I will not operate my food business until the license has been issued and posted in the establishment.

Signature of sole proprietor, partner, agent or 20% shareholder: Kimberly Turner-Vergara

Signature of additional partner(s): \_\_\_\_\_

