

S.W. 1/4 SEC. 32, T.7N., R.22E.

432

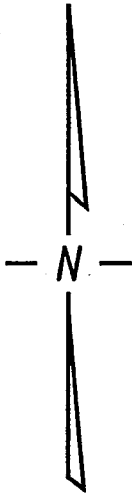

W. Pierce St. (R.O.W. VARIES)

1/4 SEC. LINE

← 15.10 M. 13.91 M. →

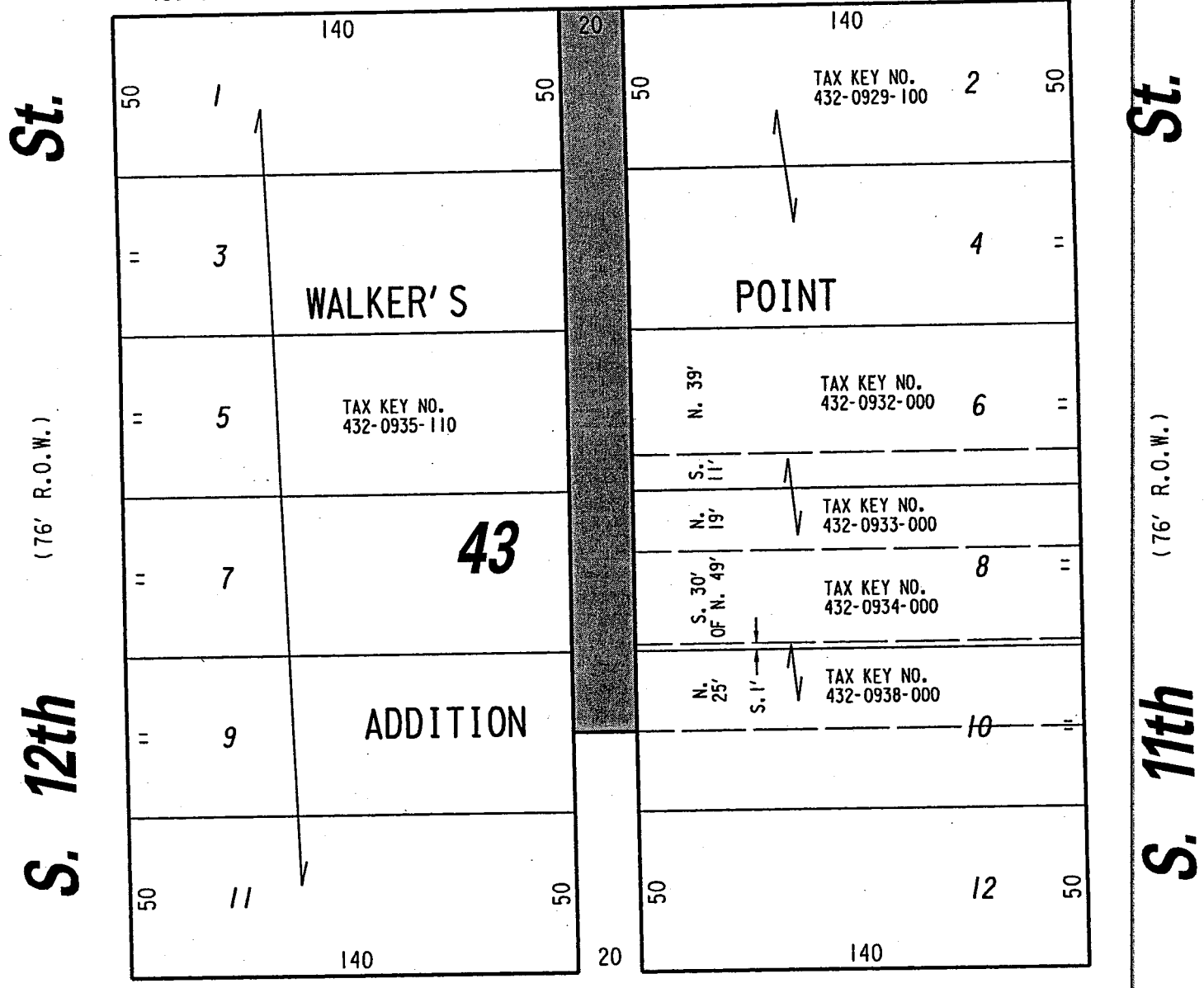

W. National Ave. (76' R.O.W.)

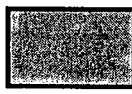
 PORTION OF PUBLIC ALLEY PROPOSED TO BE VACATED

EXHIBIT "A"
FILE NO. 021555
INFRASTRUCTURE SERVICES DIVISION

MILWAUKEE, WISCONSIN

ASSIGNED TO: W.E. FUCHS CH'K'D. BY: M.C. WILLIAMS
DRAWN BY: W.E.F. DATE: MARCH 5, 2003
PROJECT/GRANT NO.: WK52337173 SCALE: 1" = 50'
APPROVED BY:

Marcia Lindholm
CENTRAL DRAFTING & RECORDS MANAGER
[Signature]
CITY ENGINEER