

W. MEINECKE ST.

N. 25TH

EXHIBIT "B"

N. 24TH PL.

AVE.

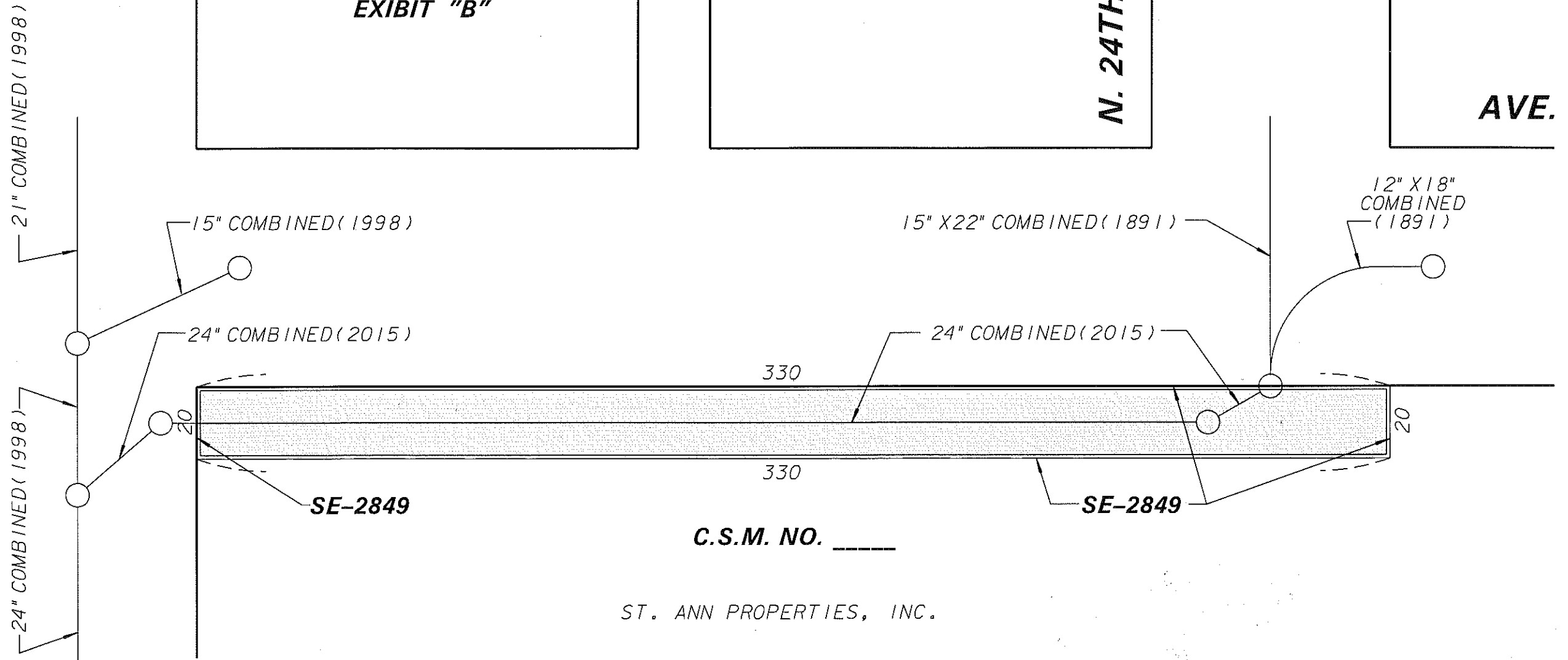

ENVIRONMENTAL ENGINEERING SECTION			
INFRASTRUCTURE SERVICES DIVISION			
DEPARTMENT OF PUBLIC WORKS			
MILWAUKEE, WISCONSIN			
PLAN OF SEWER EASEMENT			
AREA IN	S.W.1/4 SEC.18, T.7 N., R.22 E.		
S/S W. MEINECKE AVE. FROM VACATED N. 24TH PL.			
TO N. 25TH ST.			
SCALE 1"= 40'	ATLAS PAGE NO. 325	EASE. NO.	SE 2849
DRAWN BY JAWISE	CH'KD. BY SB	W.O. NO.	
APPROVED	DATE		
APPROVED	FILE NO. 198-7-18		