



CITY OF MILWAUKEE
OFFICE OF THE CITY CLERK

Tuesday, November 15, 2022

COMMITTEE MEETING NOTICE

AD 04

Kimberly M Clark

5361 N 26th St
Milwaukee, WI 53209

You are requested to attend a hearing which is to be held in Room 301-B, Third Floor, City Hall or you may attend virtually using the link below. The hearing will be held at:

Tuesday, November 29, 2022 at 11:10 AM

The access code is <https://meet.goto.com/578608581>. If you wish to call in, please call [+1 \(224\) 501-3412](tel:+12245013412) and use Access Code: 578-608-581. Please see the enclosed best practices document for further instructions.

Regarding: Your Waiver Request of the Time Limit to Receive a License for Food Dealer and Food Peddler License Applications for "Grilled Cheese" at 925 N 27th St.

There is a possibility that your application may be denied for one or more of the following reasons: The recommendation of the committee regarding the application shall be based on evidence presented at the hearing. Per MCO 85-2.7-4, probative evidence concerning whether or not a new license should be granted may be presented on the following subjects: whether or not the applicant meets the municipal requirements, the appropriateness of the location and premises where the licensed premises is to be located and whether use of the premises for the purposes or activities permitted by the license would tend to facilitate a public or private nuisance or create undesirable neighborhood problems such as disorderly patrons, unreasonably loud noise, litter, and excessive traffic and parking congestion. Probative evidence relating to these matters may be taken from the plan of operation submitted with the license application, if any, but shall not include the content of any music. Evidence regarding the fitness of the location of the premises to be maintained as the principal place of business, including but not limited to whether there is an overconcentration of businesses of the type for which the license is sought; whether the proposal is consistent with any pertinent neighborhood business or development plans, or the location's proximity to areas where children are typically present. The applicant's record in operating similarly licensed premises; and whether or not the applicant has been charged with or convicted of any felony, misdemeanor, municipal offense or other offense, the circumstances of which substantially relate to the activity to be permitted by the license being applied for or any other factor which reasonably relates to the public health, safety or welfare may also be considered. See attached police report or correspondence.

Notice for applicants with warrants or unpaid fines:

Proof of warrant satisfaction or payment of fines must be submitted at the hearing on the above date and time. Failure to comply with this requirement may result in a delay of the granting/denial of your application.

Failure to appear at this meeting may result in the denial of your license. Individual applicants must appear only in person or by an attorney. Corporate or Limited Liability applicants must appear only by the agent designated on the application or by an attorney. Partnership applicants must appear by a partner listed on the application or by an attorney. If you wish to do so and at your own expense, you may be accompanied by an attorney of your choosing to represent you at this hearing.

You will be given an opportunity to speak on behalf of the application and to respond and challenge any charges or reasons given for the denial. No petitions can be accepted by the committee, unless the people who signed the petition are present at the committee hearing and willing to testify. You may present witnesses under oath and you may also confront and cross-examine opposing witnesses under oath. If you have difficulty with the English language, you should bring an interpreter with you, at your expense, so that you can answer questions and participate in your hearing.

You may examine the application file at this office during regular business hours prior to the hearing date. Inquiries regarding this matter may be directed to the person whose signature appears below.

Limited parking for persons attending meetings in City Hall is available at reduced rates (5 hour limit) at the Milwaukee Center on the southwest corner of East Kilbourn and North Water Street. Parking tickets must be validated in the first floor information booth in City Hall.

PLEASE NOTE: Upon reasonable notice, efforts will be made to accommodate the needs of disabled individuals through sign language interpreters or other auxiliary aids. For additional information or to request this service, contact the Council Services Division ADA Coordinator at (414) 286-2998, Fax - (414) 286-3456, TDD - (414) 286-2025.

JIM OWCZARSKI, CITY CLERK

BY: _____

Jim Cooney
License Division Manager

If you have questions regarding this notice, please contact the License Division at (414) 286-2238.

200 E. Wells Street, Room 105, City Hall, Milwaukee, WI 53202. www.milwaukee.gov/license
Phone: (414) 286-2238 Fax: (414) 286-3057 Email Address: License@milwaukee.gov



Tuesday, November 15, 2022



Notice of Public Hearing

Blank Notice

CLARK, Kimberly M
Grilled Cheese at 925 N 27th St

Waiver Request of the Time Limit to Receive a License for Food Dealer and Food Peddler License Applications

Tuesday, November 29, 2022 at 11:10 AM

To whom it may concern:

The above application has been made by the above named applicant(s). This requires approval from the Licenses Committee and the Common Council of the City of Milwaukee. The hearing before the Licenses Committee will take place on 11/29/2022 at 11:10 AM in Room 301-B, Third Floor, City Hall. This is a public hearing. Those wishing to view the proceeding are able to do so via the City Channel – Channel 25 on Spectrum Cable – or on the Internet at <http://city.milwaukee.gov/citychannel>. Those wishing to provide oral testimony via phone or internet are asked to contact the staff assistant, Yadira Melendez at (414) 286-2775 or stasst5@milwaukee.gov for necessary information. Please make such requests no later than one business day prior to the start of the meeting. You are not required to attend the hearing, but please see the information below if you would like to provide testimony. Once the Licenses Committee makes its recommendation, this recommendation is forwarded to the full Common Council for approval at its next regularly scheduled hearing.

Important details for those wishing to provide information for the Licenses Committee to consider when making its recommendation:

1. The license application is scheduled to be heard at the above time. Due to other hearings running longer than scheduled, you may have to wait some time to provide your testimony.
2. You must appear in person and testify as to matters that you have personally experienced or seen. (You cannot provide testimony for your neighbor, parent or anyone else; this is considered hearsay and cannot be considered by the committee.)
3. No letters or petitions can be accepted by the committee (unless the person who wrote the letter or the persons who signed the petition are present at the committee hearing and willing to testify).
4. Persons opposed to the license application are given the opportunity to testify first; supporters may testify after the opponents have finished.
5. When you are called to testify, you will be sworn in and asked to give your name, and address. (If your first and/or last names are uncommon please spell them.)
6. You may then provide testimony.
 - a. Include only information relating to the above license application.
 - b. Include only information you have personally witnessed or seen.
 - c. Provide concise and relevant information detailing how this business has affected or may affect the peaceful enjoyment of your neighborhood.
 - d. If by the time you have the opportunity to testify, the information you wish to share has already been provided to the committee, you may state that you agree with the previous testimony. Redundant or repetitive testimony will not assist the committee in making its recommendation.
7. After giving your testimony, the members of the Licenses Committee and the licensee may ask questions regarding the testimony you have given or other factors relating to the license application.
8. Business Competition is not a valid basis for denial or non-renewal of a license.

Please Note: If you have submitted an objection to the above application your objection cannot be considered by the committee unless you personally testify at the hearing.

OCCUPANT	MAIL ADDRESS	CITY STATE ZIP
CURRENT OCCUPANT	2715 W STATE ST	MILWAUKEE, WI 53208-3549
CURRENT OCCUPANT	2723 W STATE ST	MILWAUKEE, WI 53208-3549
CURRENT OCCUPANT	2725 W KILBOURN AVE# 101	MILWAUKEE, WI 53208-3519
CURRENT OCCUPANT	2725 W KILBOURN AVE# 102	MILWAUKEE, WI 53208-3519
CURRENT OCCUPANT	2725 W KILBOURN AVE# 201	MILWAUKEE, WI 53208-3519
CURRENT OCCUPANT	2725 W KILBOURN AVE# 202	MILWAUKEE, WI 53208-3519
CURRENT OCCUPANT	2725 W KILBOURN AVE# 301	MILWAUKEE, WI 53208-3519
CURRENT OCCUPANT	2725 W KILBOURN AVE# 302	MILWAUKEE, WI 53208-3519
CURRENT OCCUPANT	2732 W KILBOURN AVE	MILWAUKEE, WI 53208-3518
CURRENT OCCUPANT	2733 W KILBOURN AVE# 103	MILWAUKEE, WI 53208-3521
CURRENT OCCUPANT	2733 W KILBOURN AVE# 104	MILWAUKEE, WI 53208-3521
CURRENT OCCUPANT	2733 W KILBOURN AVE# 203	MILWAUKEE, WI 53208-3521
CURRENT OCCUPANT	2733 W KILBOURN AVE# 204	MILWAUKEE, WI 53208-3521
CURRENT OCCUPANT	2733 W KILBOURN AVE# 303	MILWAUKEE, WI 53208-3521
CURRENT OCCUPANT	2733 W KILBOURN AVE# 304	MILWAUKEE, WI 53208-3521
CURRENT OCCUPANT	2734 W KILBOURN AVE	MILWAUKEE, WI 53208-3518
CURRENT OCCUPANT	2735 W STATE ST	MILWAUKEE, WI 53208-3549
CURRENT OCCUPANT	2743 W STATE ST	MILWAUKEE, WI 53208-3549
CURRENT OCCUPANT	846 N 28TH ST# 105	MILWAUKEE, WI 53208-3517
CURRENT OCCUPANT	846 N 28TH ST# 106	MILWAUKEE, WI 53208-3517
CURRENT OCCUPANT	846 N 28TH ST# 205	MILWAUKEE, WI 53208-3517
CURRENT OCCUPANT	846 N 28TH ST# 206	MILWAUKEE, WI 53208-3517
CURRENT OCCUPANT	846 N 28TH ST# 305	MILWAUKEE, WI 53208-3517
CURRENT OCCUPANT	846 N 28TH ST# 306	MILWAUKEE, WI 53208-3517
CURRENT OCCUPANT	912 N 28TH ST	MILWAUKEE, WI 53208-3545
CURRENT OCCUPANT	914 N 28TH ST	MILWAUKEE, WI 53208-3545
CURRENT OCCUPANT	915 N 28TH ST	MILWAUKEE, WI 53208-3546
CURRENT OCCUPANT	920 N 28TH ST# 101	MILWAUKEE, WI 53208-3545
CURRENT OCCUPANT	920 N 28TH ST# 102	MILWAUKEE, WI 53208-3545
CURRENT OCCUPANT	920 N 28TH ST# 103	MILWAUKEE, WI 53208-3545
CURRENT OCCUPANT	920 N 28TH ST# 104	MILWAUKEE, WI 53208-3545
CURRENT OCCUPANT	920 N 28TH ST# 105	MILWAUKEE, WI 53208-3545
CURRENT OCCUPANT	920 N 28TH ST# 106	MILWAUKEE, WI 53208-3545
CURRENT OCCUPANT	920 N 28TH ST# 107	MILWAUKEE, WI 53208-3545
CURRENT OCCUPANT	920 N 28TH ST# 108	MILWAUKEE, WI 53208-3545
CURRENT OCCUPANT	920 N 28TH ST# 109	MILWAUKEE, WI 53208-3545
CURRENT OCCUPANT	920 N 28TH ST# 201	MILWAUKEE, WI 53208-3545
CURRENT OCCUPANT	920 N 28TH ST# 202	MILWAUKEE, WI 53208-3545
CURRENT OCCUPANT	920 N 28TH ST# 203	MILWAUKEE, WI 53208-3545
CURRENT OCCUPANT	920 N 28TH ST# 204	MILWAUKEE, WI 53208-3545
CURRENT OCCUPANT	920 N 28TH ST# 205	MILWAUKEE, WI 53208-3545
CURRENT OCCUPANT	920 N 28TH ST# 206	MILWAUKEE, WI 53208-3545
CURRENT OCCUPANT	920 N 28TH ST# 207	MILWAUKEE, WI 53208-3545
CURRENT OCCUPANT	920 N 28TH ST# 208	MILWAUKEE, WI 53208-3545
CURRENT OCCUPANT	920 N 28TH ST# 209	MILWAUKEE, WI 53208-3545
CURRENT OCCUPANT	920 N 28TH ST# 301	MILWAUKEE, WI 53208-3545

CURRENT OCCUPANT	920 N 28TH ST# 302	MILWAUKEE, WI 53208-3545
CURRENT OCCUPANT	920 N 28TH ST# 303	MILWAUKEE, WI 53208-3545
CURRENT OCCUPANT	920 N 28TH ST# 304	MILWAUKEE, WI 53208-3545
CURRENT OCCUPANT	920 N 28TH ST# 305	MILWAUKEE, WI 53208-3545
CURRENT OCCUPANT	920 N 28TH ST# 306	MILWAUKEE, WI 53208-3545
CURRENT OCCUPANT	920 N 28TH ST# 307	MILWAUKEE, WI 53208-3545
CURRENT OCCUPANT	920 N 28TH ST# 308	MILWAUKEE, WI 53208-3545
CURRENT OCCUPANT	920 N 28TH ST# 309	MILWAUKEE, WI 53208-3545
CURRENT OCCUPANT	923 N 27TH ST	MILWAUKEE, WI 53208-3537
CURRENT OCCUPANT	956 N 27TH ST	MILWAUKEE, WI 53208-3536
CURRENT OCCUPANT	958 N 27TH ST# 101	MILWAUKEE, WI 53208-3500
CURRENT OCCUPANT	958 N 27TH ST# 102	MILWAUKEE, WI 53208-3500
CURRENT OCCUPANT	958 N 27TH ST# 201	MILWAUKEE, WI 53208-3500

Blank Notice

Total Records: 59

Radius 250.0 feet and Center for the Circle: 925 N 27th St



WAIVER REQUEST OF THE TIME LIMIT TO RECEIVE A LICENSE OR PERMIT APPLICATION

OFFICE OF THE CITY CLERK, LICENSE DIVISION
CITY HALL, 200 E. WELLS ST, ROOM 105, MILWAUKEE, WI 53202
(414) 286-2238 license@milwaukee.gov www.milwaukee.gov/license

33 0089
330090

Re Q MPD 10/06/22
10/07/22 NO ITEMS
Not Approved.

SECTION 1 BUSINESS INFORMATION	
Date of Application: <u>Oct 6th 2022</u>	Aldermanic District: <u>#4</u>
Applicant (Name of individual, partners, or agent): <u>Kimberly Clark</u>	
Legal Entity Name (If Applicable): <u>Grilled Cheese</u>	Trade Name: <u>Grilled Cheese</u>
Premises Address: <u>925 N. 27 St. Milwaukee, WI</u>	Mailing Address: <u>5361 N. 26th Street. Milwaukee, WI</u>
Business Phone: <u>414 501-6063</u>	Business Email: <u>MilwaukeeGrilled 53209</u>
SECTION 2 DESCRIPTION OF UNUSUAL CIRCUMSTANCES	
Describe the circumstances that prevented the issuance of the license or permit within the one year period and what steps you are taking to obtain the license or permit. <u>I was out-of-state tending to family matters. I have just passed the inspection today and have all most of my Application Requirements completed. I have only now to pay \$30.5 fee and wait for processing and invoice for from inspections Dept. Please grant me 30 days to obtain funds and allow time for processing.</u>	
SECTION 3 CHANGES	
Are there any changes to the Plan of Operation?	Yes <input type="checkbox"/> No <input checked="" type="checkbox"/>
Are there any changes to the legal entity or ownership?	Yes <input type="checkbox"/> No <input checked="" type="checkbox"/>
Are there any changes to the floor plan or premises description?	Yes <input type="checkbox"/> No <input checked="" type="checkbox"/>
Are there any other changes since the initial application was submitted?	Yes <input type="checkbox"/> No <input checked="" type="checkbox"/>
If you answered yes to any of these questions contact our office for additional forms.	
SECTION 4 ACKNOWLEDGMENTS & SIGNATURE	
By signature below, the undersigned understands and agrees to the following: I. That the undersigned is responsible for awareness of all federal laws, state laws, and City of Milwaukee Ordinances that govern the administration of the license(s) applied for; and that violation thereof may be grounds for suspension, non-renewal, or revocation of the license(s). II. That the undersigned shall not refuse to provide services pursuant to the license(s) on the basis of race, sex, religion, handicap, sexual orientation, gender identity or expression, military service, lawful source of income, or any other class protected by federal or state law. III. That the filing of this application does not entitle the undersigned to the license(s) applied for; and that the granting and renewal of the license(s) is subject to approval by the Milwaukee Common Council. IV. That any license(s) issued by the City of Milwaukee are subject to a renewal hearing; and that failure of the undersigned to attend said hearing may, by itself, be grounds for non-renewal. V. That the information contained in this application is true and correct, and that City Clerk must be informed of any changes to the information herein within ten (10) business days.	
 Signature of Individual, Partner, or Agent	

LC - 11-29-22
11/2/22 11/29 11:10



FOOD DEALER LICENSE APPLICATION FOR SHARED KITCHEN USERS

OFFICE OF THE CITY CLERK, LICENSE DIVISION
CITY HALL, 200 E. WELLS ST, ROOM 105, MILWAUKEE, WI 53202
(414) 286-2238 • license@milwaukee.gov • www.milwaukee.gov/license

Legal Entity Name (Individual, Partnership, Corp or LLC): Kimberly Clark

Business Name: Grilled Cheese

Premises (Shared Kitchen) Address: 925 N. 27th Street, Milwaukee, WI 53208

BUSINESS OPERATIONS

Base for Mobile Vendor (Peddler) Base for Temporary Event Caterer Other: _____

FOOD PROCESSING

What type of food items will be sold?

- Restaurant Items (meals):**
MEALS include, but are not limited to, chicken, ribs, sandwiches, roasted corn, baked potatoes, hot dogs, brats, tacos, nachos w/ cheese and meat, French fries, cooked or deep fried vegetables/fruit, cooked cheese curds, corn dogs, egg rolls, salads.
What percent of food items will be meals? 100 %
- Retail Items (snacks and beverages):**
RETAIL Items include, but are not limited to, ice cream/soft serve, lemonade, snow cones, coffee, espresso, cappuccino, tea, fruit juice, smoothies, candy, dispensed soda, fruit cups, bakery, cookies, kettle corn, cotton candy, funnel cakes, fritters, tortilla chips w/ cheese.
What percent of food items will be retail? _____ %

All Applicants: Submit a menu or a list of food items sold.

Will any food processing be done at the shared kitchen? No Yes
Processing is defined as assembling, grinding, cutting, mixing, baking, coating, stuffing, packing, bottling, grilling, canning, extracting, fermenting, distilling, pickling, freezing, drying, smoking, or packaging.

Will any food that requires temperature control be sold? No Yes
(includes dairy products such as milk, cheese, and ice cream, fish, shellfish, meat, poultry)

If yes, list the types of food items: Cheese, MEAT

PLAN OF OPERATION

- a. How are grounds kept clean? Sweep Pressure Wash Pick Up Litter Other: _____
- b. How often will grounds be cleaned? Daily Weekly As Needed Monthly Other: _____
- c. Grounds cleaned by: Licensee Building Owner Employees Hired Maintenance Other: _____
- d. How are noise issues prevented and/or addressed? Security Call Police Signs Posted Other: _____
- e. Will a sound amplification system be used? No Yes If yes, describe: _____
- f. Number of Garbage Cans: Inside: 3 Locations: inside kitchen
Outside: 1 Locations: outside by entrance
- g. Name of solid waste contractor: Advanced Disposal Waste Management Other: _____
- h. Is there a loading zone? No Yes
- i. Are there security cameras? No Yes If yes, how many? _____ and list locations: _____

PREMISES DESCRIPTION

- a. Are other businesses operating in the same building? No Yes If Yes, Describe: _____
- b. Identify all area(s) of the premises that will be used in operating this business (include areas used only for storage):
 1st Floor 2nd Floor Basement Storage Other: Describe: _____
- c. Describe Location: Major Thoroughfare Secondary Street Other: _____
- d. Nearest Major Cross Street: 27th & State Street
- e. Describe Building: Free Standing Building Strip Mall Other: _____
- f. Describe Premises Structure: Single Story Multi-Story - # of Stories _____ Other: _____
- g. Describe Surrounding Area: Commercial Residential Industrial Other: _____
- h. Building Owner Name: Gary Lieske Phone Number: 414-930-9122
 Building Owner Address: _____

SHARED KITCHEN AGREEMENT

SERVICES/FACILITIES (check all that will be used at the shared kitchen):

- Dry food storage
- Restroom facilities
- Chemical storage
- Garbage / recycling disposal
- Waste water tank disposal facilities
- Handwashing facilities
- Equipment / utensil storage
- Facilities to prepare or package food
- Potable water connection
- Waste water tank disposal facilities w/ grease trap
- Refrigeration / frozen food storage
- Warewashing facilities (3 compartment sink)
- Utilities: electrical connection
- Peddlers: overnight parking

HOURS OF OPERATION AT THE SHARED KITCHEN

DAY OF WEEK	Start Time (include am / pm)	End Time (include am / pm)
Sunday	8 AM	9:30 AM
Monday	8 AM	9:30 AM
Tuesday	8 AM	9:30 AM
Wednesday	8 AM	9:30 AM
Thursday	8 AM	9:30 AM
Friday	8 AM	9:30 AM
Saturday	8 AM	9:30 AM

I, the shared kitchen user, will utilize the services/facilities at this kitchen during the days/times indicated above. I will notify the City Clerk's Office (License Division) prior to discontinuing use of the kitchen. I will maintain an updated schedule of use of the kitchen with the City Clerk's Office (License Division) and keep a written log of the dates/times I am actually at the kitchen. (Peddlers: I will report to the facility at least once each operating day for cleaning and servicing.)

Print Name(s): Kimberly Clark
 Sole Proprietor, Partners or 20% or More Shareholder
 Signature(s): [Signature]

Date: 10/12/21

FOR COMPLETION BY THE SHARED KITCHEN OWNER

Kitchen Owner's Business Name:

I, the shared kitchen owner, acknowledge I have entered into an agreement with the user to utilize the services/facilities at this kitchen and agree to provide the user access to the kitchen on the days/times indicated above. I will maintain a written log of the dates/times the user is actually at the facility. I will promptly notify the City Clerk's Office (License Division) if this agreement is terminated or if the user fails to use the kitchen on the days/times they have indicated. I acknowledge that as the primary operator of the kitchen I am responsible for the maintenance and sanitation of the kitchen, and as such, I acknowledge I am responsible for maintaining the services/facilities being provided to the user in compliance with the Wisconsin Food Code.

Print Name: Randy Torrence
 Signature: [Signature]

Date: 10/12/21



FOOD PEDDLER PLAN OF OPERATION

OFFICE OF THE CITY CLERK, LICENSE DIVISION

CITY HALL, 200 E. WELLS ST, ROOM 105, MILWAUKEE, WI 53202

(414) 286-2238 ▪ license@milwaukee.gov ▪ www.milwaukee.gov/license

Legal Entity: Kimberly Clark

Premises Address: 925 N. 27th Street Milwaukee, WI 53209

1. Mobile Unit Description

Mobile Unit Type: Motorized Vehicle - Includes a peddler truck, vehicle, or trailer that must be pulled by a motorized vehicle
 Pushed, Pedaled, or Pulled Vehicle – does not require a motorized vehicle to move from site to site
 Carried Container

Provide the following information:

Color Brown Length 8 ft Width 6 ft Height 8 ft
 Make Karavan Model Trailer Year 2020
 License Plate Number (if applicable) _____ VIN (if applicable) _____

2. Food Operations

What type of food items will be sold?

Restaurant Items (meals):
 MEALS include, but are not limited to, chicken, ribs, sandwiches, roasted corn, baked potatoes, hot dogs, brats, tacos, nachos w/ cheese and meat, French fries, cooked or deep fried vegetables/fruit, cooked cheese curds, corn dogs, egg rolls, salads.

Retail Items (snacks and beverages):
 RETAIL items include, but are not limited to, ice cream/soft serve, lemonade, snow cones, coffee, espresso, cappuccino, tea, fruit juice, smoothies, candy, dispensed soda, fruit cups, bakery, cookies, kettle corn, cotton candy, funnel cakes, fritters, tortilla chips w/ cheese.

All Applicants: Submit a menu or a list of food items sold.

Will food processing be done on the mobile unit? No Yes

Processing includes assembling, grinding, cutting, mixing, baking, coating, stuffing, packing, bottling, grilling, canning, extracting, fermenting, distilling, pickling, freezing, drying, smoking, or packaging

Will food that requires temperature control be sold? No Yes Foods requiring temperature control include dairy products such as milk, cheese, and ice cream, fish, shellfish, meat, poultry

If yes, list the food items: Cheese, Meat

Do you intend to sell ice cream, popsicles, or other frozen confections? No Yes
 If yes, you must also obtain an Ice Cream Peddler License. Submit your Ice Cream Peddler License Application with this application. If anyone else will be operating the mobile unit, they must also obtain an Ice Cream Peddler License.

3. Service Base

Food peddlers must obtain a Food Dealer License for their service base. If you do not have a base, you must obtain a variance from the Health Dept.
 Check one:
 I will obtain a food dealer license for my service base located in the City of Milwaukee.
 I will obtain a food dealer license for my service base located outside the city of Milwaukee in another WI municipality. I will submit copies of the base license and health inspection report completed within the previous 12 month period to the License Division.
 I will contact the City of Milwaukee Health Department to apply for a variance.

4. Affirmation of Understanding – License Needed to Operate & Requirements

Read and initial each item confirming your understanding:

KC Health Department inspection and approval is required before my license may be issued.
KC A license must be issued for my service base or a variance obtained before my Food Peddler License may be issued.
KC The license must be issued and posted on the mobile unit prior to operating
KC A current Food Peddler Itinerary must be on file with the License Division and at the service base.
KC I must keep a written log of all days I am at the service base, including the time I arrive and leave.

 Signature of Sole Proprietor, Partner, or 20% or more Shareholder

 Signature of Additional Partner

FOOD PEDDLER ITINERARY

Business Name: Grilled Cheese

List all Vending Location Addresses	Check the Location Type	List the Days of the Week at this Location	Start Time (include am/pm)	End Time (include am/pm)
<u>5829 W. Villard Milwaukee, WI 53218</u>	<input type="checkbox"/> Public Way <input type="checkbox"/> Event <input checked="" type="checkbox"/> Private Property <input type="checkbox"/> Seasonal Market	<u>Monday - Saturday</u>	<u>10AM</u>	<u>7pm</u>
	<input type="checkbox"/> Public Way <input type="checkbox"/> Event <input type="checkbox"/> Private Property <input type="checkbox"/> Seasonal Market			
	<input type="checkbox"/> Public Way <input type="checkbox"/> Event <input type="checkbox"/> Private Property <input type="checkbox"/> Seasonal Market			
	<input type="checkbox"/> Public Way <input type="checkbox"/> Event <input type="checkbox"/> Private Property <input type="checkbox"/> Seasonal Market			
	<input type="checkbox"/> Public Way <input type="checkbox"/> Event <input type="checkbox"/> Private Property <input type="checkbox"/> Seasonal Market			
	<input type="checkbox"/> Public Way <input type="checkbox"/> Event <input type="checkbox"/> Private Property <input type="checkbox"/> Seasonal Market			
	<input type="checkbox"/> Public Way <input type="checkbox"/> Event <input type="checkbox"/> Private Property <input type="checkbox"/> Seasonal Market			
	<input type="checkbox"/> Public Way <input type="checkbox"/> Event <input type="checkbox"/> Private Property <input type="checkbox"/> Seasonal Market			
	<input type="checkbox"/> Public Way <input type="checkbox"/> Event <input type="checkbox"/> Private Property <input type="checkbox"/> Seasonal Market			
	<input type="checkbox"/> Public Way <input type="checkbox"/> Event <input type="checkbox"/> Private Property <input type="checkbox"/> Seasonal Market			
	<input type="checkbox"/> Public Way <input type="checkbox"/> Event <input type="checkbox"/> Private Property <input type="checkbox"/> Seasonal Market			
	<input type="checkbox"/> Public Way <input type="checkbox"/> Event <input type="checkbox"/> Private Property <input type="checkbox"/> Seasonal Market			

SIGNATURE(S)

I understand that any changes I wish to make must be reported to the City Clerk (License Division) on an updated Itinerary form before any changes can be implemented. I will keep a copy of my current Itinerary on my mobile until and at my service base all times.

I understand that failure to maintain a current itinerary with the City Clerk (License Division) may result in progressive enforcement action including citation and permit suspension and/or revocation.

[Signature]
Sole Proprietor, Partner, or 20% or more Shareholder

Additional Partner

GRILLED CHEESE

MENU ITEMS

1. chipotle chicken
grilled cheese

2. Mac & Cheese
Grilled Cheese

3. Cheesesteak
Grilled Cheese

4. Spinach &
Artichoke Grilled
Cheese

5. Roast Beef &
Smoked Gouda
Grilled Cheese

6. Four Cheese
Gourmet Grilled
Cheese

7. Canned Drinks

INGREDIENT LIST

Bread

Tomato

Red Onion

Bell pepper

Spinach

Avocado

Artichoke (jarred)

Sliced Chicken

Sliced roast beef

Sliced bacon

Sliced sirloin Steak

Mozzarella cheese

Cheddar cheese

Gouda cheese

Provolone cheese

Parmesan cheese

Monterey Jack cheese

Butter

Sage

Kosher Salt

Black pepper

Mayo

Garlic powder

Crushed red pepper

Pre-packaged Mac and
cheese

total square foot: 11600ft²
 Kimberly Clark Agent for
 "Grilled Cheese"
 925 N. 27th Street
 Milwaukee, WI 53208
 Date:

40' x 40'
 Parking Area

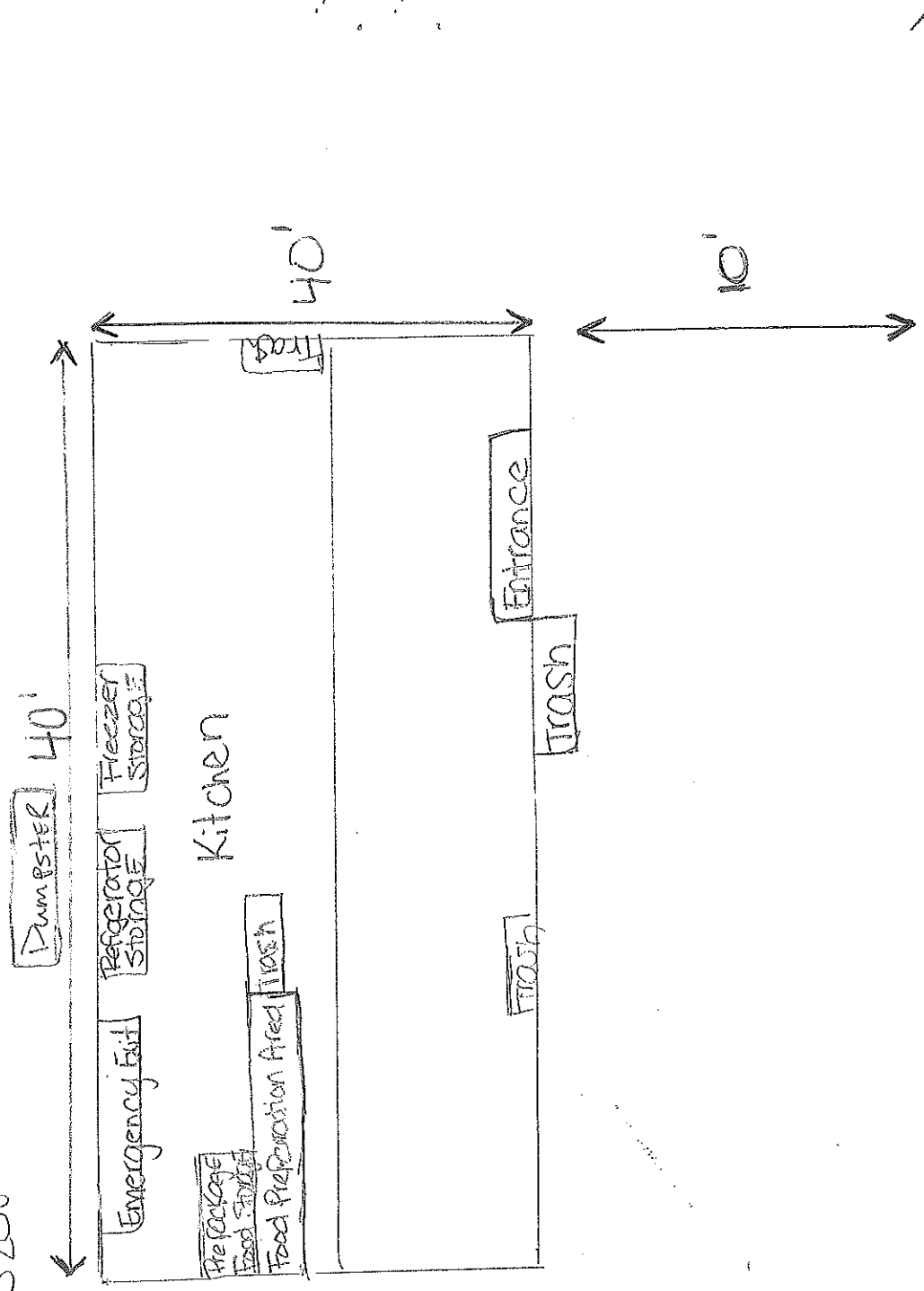

W. Killbourn Ave

100'

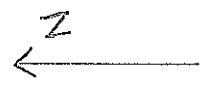

N 27th St. 200'