



CITY OF MILWAUKEE  
OFFICE OF THE CITY CLERK

Wednesday, January 14, 2026

COMMITTEE MEETING NOTICE

AD 04

SAINI, Singh G, Agent  
THE CONROY LLC  
PO BOX 2147  
BROOKFIELD, WI 53045

You are requested to attend a hearing which is to be held in Room 301-B, Third Floor, City Hall or you may attend virtually using the link below.

**Tuesday, January 27, 2026 at 01:00 PM**

The access code is <https://meet.goto.com/673613197>. Please see the enclosed best practices document for further instructions.

**Regarding:** Your Class B Tavern, Public Entertainment Premises, Food Dealer and Sidewalk Dining Licenses Application Requesting Instrumental Musicians, Disc Jockey and Bands as agent for "THE CONROY LLC" for "THE CONROY" at 725 N MILWAUKEE St. 

There is a possibility that your application may be denied for one or more of the following reasons: The recommendation of the committee regarding the application shall be based on evidence presented at the hearing. Per MCO 85-2.7-4, probative evidence concerning whether or not a new license should be granted may be presented on the following subjects: whether or not the applicant meets the municipal requirements, the appropriateness of the location and premises where the licensed premises is to be located and whether use of the premises for the purposes or activities permitted by the license would tend to facilitate a public or private nuisance or create undesirable neighborhood problems such as disorderly patrons, unreasonably loud noise, litter, and excessive traffic and parking congestion. Probative evidence relating to these matters may be taken from the plan of operation submitted with the license application, if any, but shall not include the content of any music. Evidence regarding the fitness of the location of the premises to be maintained as the principal place of business, including but not limited to whether there is an overconcentration of businesses of the type for which the license is sought; whether the proposal is consistent with any pertinent neighborhood business or development plans, or the location's proximity to areas where children are typically present. The applicant's record in operating similarly licensed premises; and whether or not the applicant has been charged with or convicted of any felony, misdemeanor, municipal offense or other offense, the circumstances of which substantially relate to the activity to be permitted by the license being applied for or any other factor which reasonably relates to the public health, safety or welfare may also be considered. See attached police report or correspondence.

**Notice for applicants with warrants or unpaid fines:**

**Proof of warrant satisfaction or payment of fines must be submitted at the hearing on the above date and time. Failure to comply with this requirement may result in a delay of the granting/denial of your application.**

Failure to appear at this meeting may result in the denial of your license. Individual applicants must appear only in person or by an attorney. Corporate or Limited Liability applicants must appear only by the agent designated on the application or by an attorney. Partnership applicants must appear by a partner listed on the application or by an attorney. If you wish to do so and at your own expense, you may be accompanied by an attorney of your choosing to represent you at this hearing.

You will be given an opportunity to speak on behalf of the application and to respond and challenge any charges or reasons given for the denial. No petitions can be accepted by the committee, unless the people who signed the petition are present at the committee hearing and willing to testify. You may present witnesses under oath and you may also confront and cross-examine opposing witnesses under oath. If you have difficulty with the English language, you should bring an interpreter with you, at your expense, so that you can answer questions and participate in your hearing.

You may examine the application file at this office during regular business hours prior to the hearing date. Inquiries regarding this matter may be directed to the person whose signature appears below.

Limited parking for persons attending meetings during normal business hours is available at reduced rates (5 hour limit) at the Milwaukee Center on the southwest corner of Kilbourn Avenue and Water Street. You must present a copy of the meeting notice to the parking cashier.

PLEASE NOTE: Upon reasonable notice, efforts will be made to accommodate the needs of disabled individuals through sign language interpreters or other auxiliary aids. For additional information or to request this service, contact the Council Services Division ADA Coordinator at (414) 286-2998, Fax - (414) 286-3456, TDD - (414) 286-2025.

JIM OWCZARSKI, CITY CLERK

BY: \_\_\_\_\_

Jim Cooney  
License Division Manager

**If you have questions regarding this notice, please contact the License Division at (414) 286-2238.**

200 E. Wells Street, Room 105, City Hall, Milwaukee, WI 53202. [www.milwaukee.gov/license](http://www.milwaukee.gov/license)  
Phone: (414) 286-2238 Fax: (414) 286-3057 Email Address: [License@milwaukee.gov](mailto:License@milwaukee.gov)





**CITY OF MILWAUKEE  
OFFICE OF THE CITY CLERK**

Wednesday, January 14, 2026

**COMMITTEE MEETING NOTICE**

AD 04

SAINI, Singh G, Agent  
THE CONROY LLC  
19475 SUMMERHILL LN  
BROOKFIELD, WI 53045

You are requested to attend a hearing which is to be held in Room 301-B, Third Floor, City Hall or you may attend virtually using the link below.

**Tuesday, January 27, 2026 at 01:00 PM**

The access code is <https://meet.goto.com/673613197>. Please see the enclosed best practices document for further instructions.

**Regarding:** Your Class B Tavern, Public Entertainment Premises, Food Dealer and Sidewalk Dining Licenses Application Requesting Instrumental Musicians, Disc Jockey and Bands as agent for "THE CONROY LLC" for "THE CONROY" at 725 N MILWAUKEE St.

There is a possibility that your application may be denied for one or more of the following reasons: The recommendation of the committee regarding the application shall be based on evidence presented at the hearing. Per MCO 85-2.7-4, probative evidence concerning whether or not a new license should be granted may be presented on the following subjects: whether or not the applicant meets the municipal requirements, the appropriateness of the location and premises where the licensed premises is to be located and whether use of the premises for the purposes or activities permitted by the license would tend to facilitate a public or private nuisance or create undesirable neighborhood problems such as disorderly patrons, unreasonably loud noise, litter, and excessive traffic and parking congestion. Probative evidence relating to these matters may be taken from the plan of operation submitted with the license application, if any, but shall not include the content of any music. Evidence regarding the fitness of the location of the premises to be maintained as the principal place of business, including but not limited to whether there is an overconcentration of businesses of the type for which the license is sought; whether the proposal is consistent with any pertinent neighborhood business or development plans, or the location's proximity to areas where children are typically present. The applicant's record in operating similarly licensed premises; and whether or not the applicant has been charged with or convicted of any felony, misdemeanor, municipal offense or other offense, the circumstances of which substantially relate to the activity to be permitted by the license being applied for or any other factor which reasonably relates to the public health, safety or welfare may also be considered. See attached police report or correspondence.

**Notice for applicants with  
warrants or unpaid fines:**

**Proof of warrant satisfaction or payment of fines must be submitted at the hearing on the above date and time. Failure to comply with this requirement may result in a delay of the granting/denial of your application.**

Failure to appear at this meeting may result in the denial of your license. Individual applicants must appear only in person or by an attorney. Corporate or Limited Liability applicants must appear only by the agent designated on the application or by an attorney. Partnership applicants must appear by a partner listed on the application or by an attorney. If you wish to do so and at your own expense, you may be accompanied by an attorney of your choosing to represent you at this hearing.

You will be given an opportunity to speak on behalf of the application and to respond and challenge any charges or reasons given for the denial. No petitions can be accepted by the committee, unless the people who signed the petition are present at the committee hearing and willing to testify. You may present witnesses under oath and you may also confront and cross-examine opposing witnesses under oath. If you have difficulty with the English language, you should bring an interpreter with you, at your expense, so that you can answer questions and participate in your hearing.

You may examine the application file at this office during regular business hours prior to the hearing date. Inquiries regarding this matter may be directed to the person whose signature appears below.

Limited parking for persons attending meetings during normal business hours is available at reduced rates (5 hour limit) at the Milwaukee Center on the southwest corner of Kilbourn Avenue and Water Street. You must present a copy of the meeting notice to the parking cashier.

PLEASE NOTE: Upon reasonable notice, efforts will be made to accommodate the needs of disabled individuals through sign language interpreters or other auxiliary aids. For additional information or to request this service, contact the Council Services Division ADA Coordinator at (414) 286-2998, Fax - (414) 286-3456, TDD - (414) 286-2025.

**JIM OWCZARSKI, CITY CLERK**

BY: \_\_\_\_\_

**Jim Cooney  
License Division Manager**

**If you have questions regarding this notice, please contact the License Division at (414) 286-2238.**

200 E. Wells Street, Room 105, City Hall, Milwaukee, WI 53202. [www.milwaukee.gov/license](http://www.milwaukee.gov/license)  
Phone: (414) 286-2238 Fax: (414) 286-3057 Email Address: [License@milwaukee.gov](mailto:License@milwaukee.gov)

Date: 01/06/2026

Officer: Monreal

**City of Milwaukee Police Department**

**90-5-1.5 Crime Prevention Survey**

Name of Premise: The Conroy  
Address: 725 N Milwaukee  
Phone: 414-763-7770

Owner: Saini G Singh  
Address: 19475 Summerhill La  
Address2: Brookfield, WI 53045  
Phone: 262-347-8789  
Email: theconroymke.com

Licensee/Agent: Saini, Singh G  
Address: 19475 Summerhill La  
Address 2: Brookfield, WI 53045  
Phone:  
Email:

Preferred Contact: Same

Location Currently Open: ☐ Yes ☐ No

Projected Open Date:

Days Open: ☐ S ☐ M ☐ T ☐ W ☐ TH ☐ F ☐ SA ☒ ALL

Hours: Sun: 7A-2A 24hrs ☐ Y ☒ N  
Mon: "  
Tues: "  
Wed: "  
Thur: "  
Fri: 7A-2:30A  
Sat: 7A-2:30A

Premise Type: ☐ Tavern/Bar  
☒ Restaurant  
☐ Other:

License Currently Held:

- ☒ Alcohol
- ☐ Tobacco
- ☒ Food
- ☐ Extended Hours
- ☐ Other:

**Exterior Survey:**

1. Is the area around the location neat and clean ☒ Y ☐ N
2. What surrounds the location:
  - a. ☐ Park
  - b. ☐ School
  - c. ☐ Youth Center
  - d. ☒ Tavern
  - e. ☒ Residential
  - f. ☒ Other Businesses
3. Can you see interior of business from outside ☒ Y ☐ N
4. Can you see employees from outside ☒ Y ☐ N
5. Are exterior windows free of signage ☒ Y ☐ N
6. Parking lot? ☐ Y ☒ N Well Lit ☐ Y ☐ N
7. Valet Parking ☒ Y ☐ N
  - a. Guard ☐ Y ☐ N
  - b. Cameras ☐ Y ☐ N How many?
8. Areas where a person could conceal themselves ☐ Y ☒ N
9. Exterior Lighting ☒ Y ☐ N Adequate ☒ Y ☐ N
10. No Loitering signs Posted ☐ Y ☒ N
11. Address easy to see ☒ Y ☐ N

**Camera Survey:**

15. Do they have security cameras: ☒ Y ☐ N
  - a. color ☒
  - b. digital ☒
  - c. recorded ☒
16. How long is video stored: 2 weeks
17. Exterior Cameras ☒ Y ☐ N How many: 6

18. Interior Cameras ☒Y ☐N How many: 30  
19. Does a camera face entrance/exit ☒Y ☐N  
20. Do all employees know how to retrieve video ☒Y ☐N

### **Interior Survey**

21. Planned Capacity: 190  
22. Minimum number of employees on Premise: 4  
23. Willing to be a complainant regarding Loitering ☒Y ☐N  
24. Interior neat and clean ☒Y ☐N  
25. Emergency/Non-Emergency Numbers near phone ☒Y ☐N  
26. Owner knows how to contact District Directly ☒Y ☐N

### **Security**

27. How many security personnel will be deployed:  
Interior: Exterior:  
28. Days deployed: ☐S ☐M ☐T ☐W ☐TH ☐F ☐SA  
29. Managed by business ☐ or contracted ☐  
30. Armed ☐Y ☐N  
31. Types of security measures:  
☐Wanding/metal detector  
☐ID Scanner  
☐Dress Code  
☐Cover Charge  
☐Age Restriction  
☐Checking ID's

### **Additional comments/recommendations:**

Security is hired only for Private Events. Agent will speak to tech personnel regarding video storage for 30 days in lieu of 2 weeks

## Area of Interest (AOI) Information

Area : 21,862,585.72 ft<sup>2</sup>

Dec 10 2025 15:43:00 Central Standard Time

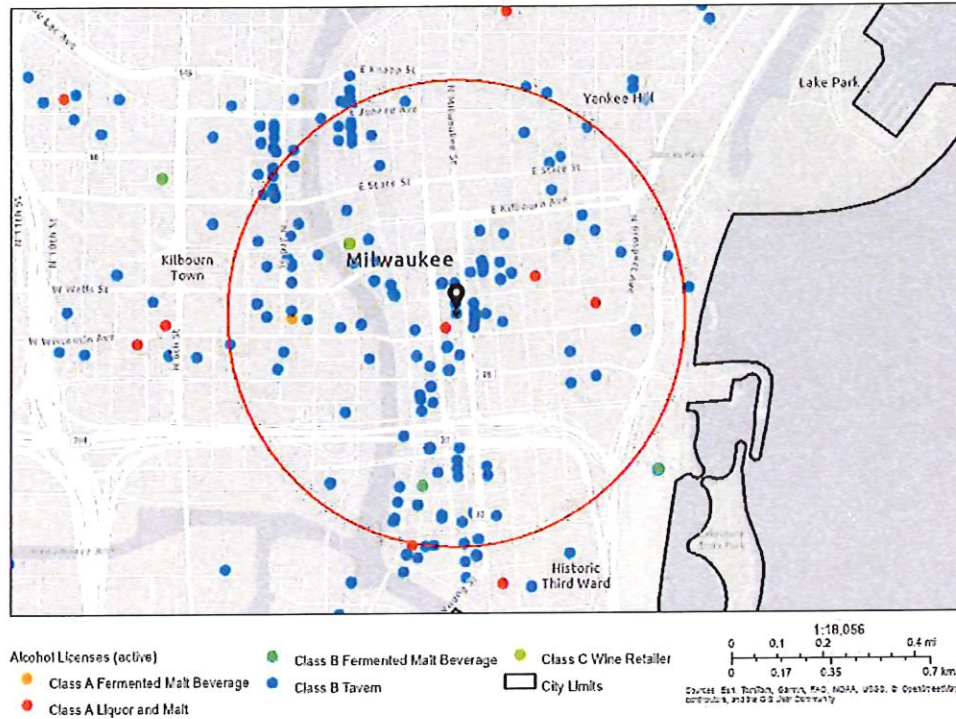

Summary

Name	Count	Area(ft²)	Length(mi)
Alcohol Licenses	162		

Alcohol Licenses



#	Legal Entity	Trade Name	Licensee	Address	License Type Name	Total Capacity	Expiration Date	Count
1	DEER CAMP, LLC	Deer Camp	Paul C Hackbarth, Agt	1023-1027 N Dr Martin L King Jr DR	Class B Tavern License		12/21/2025, 6:00 PM	1
2	FOURBIRDS LLC	THE SOCIETY	Tyler T Curran, Agt	910 N MARTIN L KING JR DR	Class B Tavern License		1/29/2026, 6:00 PM	1
3	THE KING AND I RESTAURANT, INC	THE KING AND I RESTAURANT	DEREK E PHOUNGPOL, Agt	830 N Dr Martin L King Jr DR	Class B Tavern License	240	12/25/2025, 6:00 PM	1
4	Fazzari & Company, LLC	San Giorgio Pizzeria Napoletana	GIORGIO G FAZZARI, Agt	838 N Martin L King Jr DR	Class B Tavern License	99	1/15/2026, 6:00 PM	1
5	CHINA GOURMET, INC	CHINA GOURMET RESTAURANT	ROBERT C TSAO, Agt	117 E WELLS ST	Class B Tavern License	165	1/17/2026, 6:00 PM	1
6	Carnivoras Inc	Carnevor	Joseph McLean, Agt	718 N Milwaukee ST	Class B Tavern License	99	1/25/2026, 6:00 PM	1
7	DAA SMOKEHOUSE MKE LLC	David Alan Alan's Smokehouse & Saloon MKE	David A O'Bryan, Agt	400 N WATER ST	Class B Tavern License		12/28/2025, 6:00 PM	1
8	OUZO CAFE	OUZO CAFE	NICKEY G PAPPAS, Agt	776 N MILWAUKEE ST	Class B Tavern License	40	1/4/2026, 6:00 PM	1
9	GRANDVIEW MANAGEMENT, INC	ZILLI HOSPITALITY GROUP	ROBERT J ZILLI, Agt	910 E MICHIGAN ST	Class B Tavern License	450	2/6/2026, 6:00 PM	1
10	APARTMENT 720, LLC	APARTMENT 720	Tony T Skoufis, Agt	720 N MILWAUKEE ST	Class B Tavern License	299	1/24/2026, 6:00 PM	1
11	ALEM ETHIOPIAN RESTAURANT, LLC	ALEM ETHIOPIAN VILLAGE	MULU H HABTESILASSIE, Agt	307 E WISCONSIN AV	Class B Tavern License	98	1/25/2026, 6:00 PM	1
12	Oak Barrel Public House LLC	Oak Barrel	ROBERT L WILTGEN, Agt	1033 N MARTIN L KING JR DR	Class B Tavern License		1/29/2026, 6:00 PM	1
13	EDISON MKE LLC	The Edison	David J Marcus, Agt	322 N BROADWAY	Class B Tavern License		2/25/2026, 6:00 PM	1
14	Onesto MKE, LLC	Onesto	David J Marcus, Agt	221-223 N Broadway	Class B Tavern License	288	2/6/2026, 6:00 PM	1
15	Blue Bat Kitchen MKE, LLC	Blue Bat Kitchen	David J Marcus, Agt	249 N WATER ST	Class B Tavern License	240	2/6/2026, 6:00 PM	1
16	Smoke Shack Mke, LLC	Smoke Shack	David J Marcus, Agt	332 N Milwaukee ST	Class B Tavern License	91	2/6/2026, 6:00 PM	1
17	THE WICKED HOP, LLC	THE WICKED HOP	MILES E O'NEIL, Agt	343-45 N BROADWAY	Class B Tavern License	160	2/28/2026, 6:00 PM	1
18	ANDY ZXL, INC.	FUSION POKE	Yulin Zheng, Agt	329 N BROADWAY	Class B Tavern License		2/27/2026, 6:00 PM	1



19	MILWAUKEE WATERFRONT DELI, INC	MILWAUKEE WATERFRONT DELI	JEREMIAH D PANDL, Agt	761 N WATER ST	Class B Tavern License		2/26/2026, 6:00 PM	1
20	STEE V GEE LLC	Sportclub Nomad	MICHAEL J EITEL, Agt	750 N Jefferson ST	Class B Tavern License	240	2/14/2026, 6:00 PM	1
21	KANO SUSHI LLC	AWI SUSHI	Cheraty D Par, Agt	755 N WATER ST	Class B Fermented Malt Beverage Retailer's License		3/17/2026, 7:00 PM	1
22	MCR Milwaukee Tenant LLC	Courtyard by Marriott Milwaukee Downtown	Jennifer A Jaseck, Agt	300 W Michigan ST	Class B Tavern License		4/3/2026, 7:00 PM	1
23	ManCave Milwaukee, LLC	ManCave Milwaukee	Jeffrey L Taylor, Agt	706 N MILWAUKEE ST	Class B Tavern License		3/14/2026, 7:00 PM	1
24	HANOBOLIC LLC	SINABRO	Jongsoo Kim, Agt	316 N MILWAUKEE ST 102	Class B Tavern License		3/9/2026, 7:00 PM	1
25	KANO SUSHI LLC	AWI SUSHI	Cheraty D Par, Agt	755 N WATER ST	Class C Wine Retailer's License		3/17/2026, 7:00 PM	1
26	Mediterranean Kuzina LLC	Mediterranean Cuisine	Ender Erk, Agt	753 N WATER ST	Class B Tavern License		3/2/2026, 6:00 PM	1
27	Sevenbirds LLC	The Rivulet	Tyler T Curran, Agt	309 N WATER ST 110	Class B Tavern License	318	3/4/2026, 6:00 PM	1
28	PRITZLAFF EVENTS, LLC	LAS GARDENIAS	RICHARD J KERHIN, Agt	305 N PLANKINTON AV 102	Class B Tavern License		3/5/2026, 6:00 PM	1
29	Foot Paw LLC	Amilinda	Gregory R Leon, Agt	315 E Wisconsin AV	Class B Tavern License		3/13/2026, 7:00 PM	1
30	International Exports LLC	The Safe House	LaMarvon J Jackson, Agt	779 N Front ST	Class B Tavern License	248	3/19/2026, 7:00 PM	1
31	GROOM FOR MEN, INC	Groom for Men / Groom Lounge	Terri J DeJoode, Agt	330 E ST PAUL AV	Class B Tavern License		3/24/2026, 7:00 PM	1
32	MAC PARTNERS, LLC	Milwaukee Athletic Club - Roof Top	Thomas James McGinty, Agt	758 N BROADWAY	Class B Tavern License		3/31/2026, 7:00 PM	1
33	Who's Milwaukee LLC	Who's on Third, Milwaukee's Pub	ROBERT L WILTGEN, Agt	1003&1007 N Martin L King Jr DR	Class B Tavern License		3/31/2026, 7:00 PM	1
34	3CP LLC	Third Coast Provisions	Andrew H Miller, Agt	724 N Milwaukee ST	Class B Tavern License		3/31/2026, 7:00 PM	1
35	Jay Squared LLC	The Box	Jaime D Levine, Agt	311 E Wisconsin AV	Class B Tavern License	270	4/17/2026, 7:00 PM	1
36	TACO MIKES HOLDINGS LLC	Taco Mikes LLC	Cornelius McClendon, Agt	1001 N MARTIN L KING JR DR	Class B Tavern License		2/19/2026, 6:00 PM	1

37	Valentine Coffee Roasters Third Ward LLC	Valentine Coffee	ROBBIN V KASHEVARO F, Agt	189 N Milwaukee ST	Class B Tavern License		4/16/2026, 7:00 PM	1
38	Shake Shack Wisconsin LLC	Shake Shack	Jonathon V Maurice, Agt	220 E Buffalo ST 110	Class C Wine Retailer's License		4/8/2026, 7:00 PM	1
39	Shake Shack Wisconsin LLC	Shake Shack	Jonathon V Maurice, Agt	220 E Buffalo ST 110	Class B Fermented Malt Beverage Retailer's License		4/8/2026, 7:00 PM	1
40	FLOUR POWER LLC	Flourchild	Andrew H Miller, Agt	722 N MILWAUKEE ST	Class B Tavern License		3/31/2026, 7:00 PM	1
41	WOMANS CLUB OF WISCONSIN	WOMANS CLUB OF WISCONSIN	Patti L Muccio, Agt	813 E KILBOURN AV	Class B Tavern License	500	3/31/2026, 7:00 PM	1
42	JSWD Commerce LLC	SpringHill Suites by Marriott Milwaukee Downtown	Benjamin A Risseuw, Agt	744 N VEL R PHILLIPS AV	Class B Tavern License	95	2/9/2026, 6:00 PM	1
43	CSM Milwaukee Downtown LLC	Residence Inn - Milwaukee	Gregory J Fugate, Agt	101 W Wisconsin AV 3	Class B Tavern License		4/16/2026, 7:00 PM	1
44	Higbee's MKE LLC	BODEGA	PATSY SMITH-JAMES, Agt	628 N Water ST	Class B Tavern License	225	4/15/2026, 7:00 PM	1
45	LUPI & IRIS, LLC	Lupi & Iris/Andiamo	Daria J Aitken-Siegel, Agt	777 N VAN BUREN ST	Class B Tavern License		5/7/2026, 7:00 PM	1
46	Stone and Brick LLC	Saffron	Fatima K Kumar, Agt	223 N Water ST 100	Class B Tavern License		5/16/2026, 7:00 PM	1
47	Benelux Third Ward, LLC	Cafe Benelux	ERIC G WAGNER, Agt	346 N Broadway	Class B Tavern License	455	5/1/2026, 7:00 PM	1
48	BRUNCH MKE LLC	BRUNCH	Morgan K Schnabl, Agt	714 N MILWAUKEE ST	Class B Tavern License	160	4/20/2026, 7:00 PM	1
49	Memento LLC	Bavette La Boucherie	Karen E Bell, Agt	217 N BROADWAY	Class B Tavern License		4/25/2026, 7:00 PM	1
50	ELEVATE MKE LLC	ELEVATE MKE	Tino K Bates, Agt	1131 N WATER ST	Class B Tavern License		5/1/2026, 7:00 PM	1
51	COPPER ON KING LLC	COPPER	PETER R MARSHALL, Agt	1019 N Martin L King Jr DR	Class B Tavern License		4/28/2026, 7:00 PM	1
52	KTY LLC	Beer District	Khader M Yafai, Agt	240 W WELLS ST	Class A Malt & Class A Liquor License		5/19/2026, 7:00 PM	1
53	PTM VENTURES LLC	State Street Pizza Pub	Andrew P Fish, Agt	322 W STATE ST	Class B Tavern License		5/18/2026, 7:00 PM	1
54	Wisconsin & Milwaukee Hotel, LLC	Milwaukee Marriott Downtown/Starbucks	Benjamin A Risseuw, Agt	323 E Wisconsin AV	Class B Tavern License	312	5/23/2026, 7:00 PM	1

55	Allure MKE LLC	Allure MKE	Tino K Bates, Agt	787-789 N Jefferson ST	Class B Tavern License		5/13/2026, 7:00 PM	1
56	RIVER HOUSE RESTAURANT, INC	VagaBond	MATTHEW R SCHMIDT, Agt	1122 N EDISON ST	Class B Tavern License	150	6/9/2026, 7:00 PM	1
57	Cheese Mart, Inc	Wisconsin Cheese Mart	KENNETH J MC NULTY, Agt	215 W Highland AV	Class B Tavern License	133	5/22/2026, 7:00 PM	1
58	Xankia LLC	Xankia	Vang Thao, Agt	222 W WELLS ST	Class B Tavern License		5/11/2026, 7:00 PM	1
59	Olive Tree LLC	Convenience +	Jamal T Shawar, Agt	308 E Wisconsin AV	Class A Malt & Class A Liquor License		5/19/2026, 7:00 PM	1
60	Foltz Family Market, Inc	Foltz Family Market	Casey C Foltz, Agt	400 N WATER ST 6	Class B Tavern License		5/29/2026, 7:00 PM	1
61	LUPI & IRIS, LLC	Lupi & Iris/Andiamo	Daria J Aitken-Siegel, Agt	777 N VAN BUREN ST	Class A Malt & Class A Liquor License		5/11/2026, 7:00 PM	1
62	GRANDVIEW MANAGEMENT, INC	ZILLI LAKE & GARDENS	ROBERT J ZILLI, Agt	931 E WISCONSIN AV	Class B Tavern License	450	5/18/2026, 7:00 PM	1
63	WESTTOWN ASSOCIATION OF MILW, INC	WESTTOWN ASSOCIATION	STACIE J CALLIES, Agt	950 N Dr Martin L King Jr DR	Class B Tavern License		5/22/2026, 7:00 PM	1
64	ZARLETTI, LLC	ZARLETTI	BRIAN C ZARLETTI, Agt	741 N MILWAUKEE ST 1	Class B Tavern License		5/23/2026, 7:00 PM	1
65	Tropic LLC	Tropic	HYACINTH E NEMBHARDT, Agt	518 N Water ST	Class B Tavern License	156	5/21/2026, 7:00 PM	1
66	12AM Management Group, LLC	Room Seven	Andre B Lewis, Agt	780 N Jefferson ST	Class B Tavern License	240	5/25/2026, 7:00 PM	1
67	Giovannis Hospitality Family LLC	Safina's	DAVID J SAFINA, Agt	783-785 N Jefferson ST	Class B Tavern License		5/25/2026, 7:00 PM	1
68	Steakhouse Milwaukee LLC	Rare Steakhouse	Mark D Burish, Agt	833 E MICHIGAN ST	Class B Tavern License		5/19/2026, 7:00 PM	1
69	GRAND CONVENIENT, LLC	GRAND CONVENIENT STORE	AHMED K YAFAI, Agt	724 N Martin L King Jr DR	Class A Fermented Malt Beverage Retailer's License		6/13/2026, 7:00 PM	1
70	CAPITAL GRILLE HOLDINGS, INC	THE CAPITAL GRILLE OF MILW #8027	Lindsey R FitzMaurice, Agt	310 W WISCONSIN AV 100	Class B Tavern License	200	6/18/2026, 7:00 PM	1
71	Pritzlaff Events LLC	Pritzlaff / Aperitivo	Kendall G Breunig, Agt	311-315 N Plankinton AV	Class B Tavern License	915	6/18/2026, 7:00 PM	1
72	JSWD Wisconsin Venture I LLC	The Westin Milwaukee	Benjamin A Risseuw, Agt	550 N Van Buren ST	Class B Tavern License		6/9/2026, 7:00 PM	1



73	WA Cheese & Sausage Shoppe, Inc	WA Cheese & Sausage Shoppe	Mark S Lutz, Agt	400 N WATER ST 24	Class B Tavern License		6/29/2026, 7:00 PM	1
74	Kimpton Hotel & Restaurant Group LLC	Journeyman Hotel	Kathleen M Neufeld, Agt	310 E Chicago ST	Class B Tavern License		6/15/2026, 7:00 PM	1
75	GILL HOSPITALITY GROUP LLC	BENIHANA	Navdeep S Gill, Agt	850 N PLANKINTON AV	Class B Tavern License		6/1/2026, 7:00 PM	1
76	HTWA MARKET PROJECT, LLC	MILWAUKEE PUBLIC MARKET	PAUL H SCHWARTZ, Agt	400 N WATER ST	Class B Tavern License	320	6/1/2026, 7:00 PM	1
77	Button Block Holdings LLC	Homewood Suites Hotel	Austin D Moore, Agt	500 N Water ST	Class B Tavern License		6/1/2026, 7:00 PM	1
78	Soche, LLC	City Social Bar and Grill and The LYNQ	COREY L SMITH, Agt	530 N WATER ST	Class B Tavern License		6/1/2026, 7:00 PM	1
79	HB Milwaukee Inc	Old German Beer Hall	HANS WEISSGERBER, III, Agt	1009 N MARTIN L KING JR DR	Class B Tavern License	120	6/16/2026, 7:00 PM	1
80	ELSA'S ON THE PARK, LTD	ELSA'S ON THE PARK	Christopher A Collins, Agt	833 N JEFFERSON ST	Class B Tavern License	100	6/30/2026, 7:00 PM	1
81	MAJOR GOOLSBY'S, INC	MAJOR GOOLSBY'S	PATRICK J MURPHY, Agt	340 W KILBOURN AV	Class B Tavern License	400	7/5/2026, 7:00 PM	1
82	THIEF WINE, LLC	THIEF WINE SHOP & BAR	PHILIP M BILODEAU, Agt	400 N WATER ST	Class B Tavern License	42	6/29/2026, 7:00 PM	1
83	MARCUS HOTELS HOSPITALITY, LLC	Saint Kate-The Arts Hotel	LaMarvon J Jackson, Agt	139 E KILBOURN AV	Class B Tavern License		7/5/2026, 7:00 PM	1
84	The Loft on Broadway, LLC	The Loft on Broadway	MEI LYN NELSON, Agt	177 N BROADWAY 3rd Floor	Class B Tavern License		7/13/2026, 7:00 PM	1
85	GRANDVIEW MANAGEMENT, INC.	Zilli Hospitality Group	ROBERT J ZILLI, Agt	325-333 N PLANKINTON AV	Class B Tavern License		7/5/2026, 7:00 PM	1
86	TUPELO HONEY HOSPITALITY CORPORATION	Tupelo Honey Southern Kitchen & Bar	Sarah A Reinhardt, Agt	511 N BROADWAY	Class B Tavern License		7/11/2026, 7:00 PM	1
87	East Town Association, Inc	East Town Association	Edgar L Sturkey, Agt	520 E WELLS ST	Class B Tavern License		7/3/2026, 7:00 PM	1
88	MILWAUKEE COUNTY WAR MEMORIAL, INC	MILWAUKEE COUNTY WAR MEMORIAL CENTER	Laurieann Kildegaard, Agt	750 N LINCOLN MEMORIAL DR	Class B Tavern License	240	6/29/2026, 7:00 PM	1
89	Fenix Milwaukee LLC	Rodizio Grill	Renan Utrera De Paula, Agt	777 N WATER ST	Class B Tavern License		7/5/2026, 7:00 PM	1
90	THE MILWAUKEE CLUB	THE MILWAUKEE CLUB	Molly J Schick, Agt	706 N JEFFERSON ST	Class B Tavern License	180	6/29/2026, 7:00 PM	1

91	Foy's LLC	Foy's	MICHAEL G FOY, Agt	784 N JEFFERSON ST	Class B Tavern License		6/30/2026, 7:00 PM	1
92	INDULGE CATERING COMPANY LLC	INDULGE CATERING COMPANY	Valentina J Bianchini, Agt	212 W WISCONSIN AV	Class B Tavern License		7/13/2026, 7:00 PM	1
93	JING'S CORPORATION	JING'S	JING WANG, Agt	207 E BUFFALO ST 168	Class B Fermented Malt Beverage Retailer's License	45	7/29/2026, 7:00 PM	1
94	Wild Rogues LLC	Elwood's Liquor & Tap	Nathan S Showers, Agt	1111 N Water ST	Class B Tavern License		7/25/2026, 7:00 PM	1
95	ARBED, LLC	MO'S IRISH PUB	JAMES A VASSALLO, Agt	142-44 W Wisconsin AV	Class B Tavern License	480	7/26/2026, 7:00 PM	1
96	PPH Properties I LLC	Silk Exotic Gentlemen's Club	SCOTT A KRAHN, Agt	730 N Martin L King Jr DR	Class B Tavern License	297	7/13/2026, 7:00 PM	1
97	MP On Wheels Catering Service	MP On Wheels Catering Service	DULCE M ALARCON, SP	400 N WATER ST	Class B Tavern License	320	8/3/2026, 7:00 PM	1
98	Pourman's LLC	Pourman's	BENJAMIN A HEBL, Agt	1127 N Water ST	Class B Tavern License	80	2/25/2026, 6:00 PM	1
99	BUCKLEY'S KISKEAM INN, LLC	Buckley's	MICHAEL V BUCKLEY, Agt	801-09 N CASS ST	Class B Tavern License	65	7/29/2026, 7:00 PM	1
100	JING'S CORPORATION	JING'S	JING WANG, Agt	207 E BUFFALO ST 168	Class C Wine Retailer's License	45	7/29/2026, 7:00 PM	1
101	PTG Live Events LLC	The Riverside	Richard J Ryan, Agt	116 W Wisconsin AV	Class B Tavern License	2,480	7/29/2026, 7:00 PM	1
102	MARCUS HOTELS HOSPITALITY, LLC	Pfister Hotel & Tower	LaMarvon J Jackson, Agt	424 E WISCONSIN AV	Class B Tavern License	419	7/29/2026, 7:00 PM	1
103	DOS BONITAS, LLC	CUBANITAS	MARTA C BIANCHINI, Agt	728 N MILWAUKEE ST	Class B Tavern License	50	7/25/2026, 7:00 PM	1
104	Commerce Building Restaurant LLC	Doc's Commerce Smokehouse	Aimee Brashier, Agt	754 N VEL R PHILLIPS AV	Class B Tavern License		7/13/2026, 7:00 PM	1
105	Bollywood Grill, LLC	Bollywood Grill	MANJIT SINGH, Agt	1028-30 N Jackson ST	Class B Tavern License		7/21/2026, 7:00 PM	1
106	Benson's Catering MKE LLC	Milwaukee Athletic Club	David J Marcus, Agt	758 N BROADWAY	Class B Tavern License		7/15/2026, 7:00 PM	1
107	MEGA MARTS, LLC	METRO MARKET #371	Michael Taylan, Agt	1123 N VAN BUREN ST	Class B Tavern License	65	8/30/2026, 7:00 PM	1
108	Kinn GH LL LLC	Kinn MKE Guesthouse	Charles Bailey, Agt	600 N BROADWAY	Class B Tavern License	258	6/9/2026, 7:00 PM	1

109	First MKD, LLC	Hilton Garden Inn	Kristopher J Anton, Agt	611 N BROADWAY	Class B Tavern License		7/29/2026, 7:00 PM	1
110	INDULGE WINE ROOMS, LLC	INDULGE	MARC R BIANCHINI, Agt	708 N MILWAUKEE ST	Class B Tavern License	60	8/30/2026, 7:00 PM	1
111	Sirk Steak LLC	Mo's A Place for Steaks	JAMES A VASSALLO, Agt	720 N Plankinton AV	Class B Tavern License		9/2/2026, 7:00 PM	1
112	RIVERWALK COMMONS LLC	Riverwalk Commons	PAUL H SCHWARTZ, Agt	423 N WATER ST	Class B Tavern License		9/1/2026, 7:00 PM	1
113	NOBLE BEVERAGE MANAGEMENT, LLC	HYATT REGENCY MILWAUKEE	John W Vaughn, Agt	333 W KILBOURN AV	Class B Tavern License	930	8/9/2026, 7:00 PM	1
114	WELLS-JEFFERSON CORPORATION	TAYLOR'S	DANIEL R TAYLOR, Agt	795 N JEFFERSON ST	Class B Tavern License	160	9/25/2026, 7:00 PM	1
115	Satori Restaurant LLC	Thai-namite Thai Bistro and Sushi Bar	KHEMANONG KONGSIN, Agt	400 N WATER ST	Class B Tavern License		9/25/2026, 7:00 PM	1
116	MILWAUKEE REPERTORY THEATER, INC	MILWAUKEE REPERTORY THEATER	Donald D Parsons, Agt	108 E WELLS ST	Class B Tavern License		9/7/2026, 7:00 PM	1
117	BRG 777 E Wisconsin LLC	Downtown Kitchen	CHRISTIAN M DAMIANO, Agt	777 E WISCONSIN AV	Class B Tavern License	483	9/21/2026, 7:00 PM	1
118	TUDY-BART, LLC	BACCHUS-A BARTOLOTTA RESTAURANT	CHRISTIAN M DAMIANO, Agt	925 E WELLS ST	Class B Tavern License	200	9/21/2026, 7:00 PM	1
119	Hotel Metro Operator, LLC	Hotel Metro	JOHN M CUNNINGHAM, Agt	411 E Mason ST	Class B Tavern License	150	8/31/2026, 7:00 PM	1
120	Picture Dis LLC	The Lower Level Lounge	STERLING O ODOM, Agt	207 E BUFFALO ST LL	Class B Tavern License		9/19/2026, 7:00 PM	1
121	EQUAL PARTS LLC	AGENCY COCKTAIL LOUNGE	Ryan S Castelaz, Agt	819 N MARSHALL ST	Class B Tavern License		8/31/2026, 7:00 PM	1
122	BRG 1000 Water Street, LLC	Rumpus Room - A Bartolotta Gastropub	CHRISTIAN M DAMIANO, Agt	1030 N Water ST	Class B Tavern License	254	9/21/2026, 7:00 PM	1
123	THE WESTOWN ASSOCIATION OF MILWAUKEE, INC.	Westown Association	STACIE J CALLIES, Agt	310 W WISCONSIN AV	Class B Tavern License		9/25/2026, 7:00 PM	1
124	ST. PAUL SEAFOOD, LLC	ST. PAUL FISH CO.	TIMOTHY G COLLINS, Agt	400 N WATER ST	Class B Tavern License		9/20/2026, 7:00 PM	1
125	MILWAUKEE BRAT HOUSE, LLC	MILWAUKEE BRAT HOUSE	SCOTT A SCHAEFER, Agt	1013 N Martin L King Jr DR	Class B Tavern License	191	9/14/2026, 7:00 PM	1



126	BARTOLOTTA CATERING - GRAIN EXCHANGE LLC	BARTOLOTTA CATERING - GRAIN EXCHANGE LLC	CHRISTIAN M DAMIANO, Agt	225 E MICHIGAN ST	Class B Tavern License	299	9/21/2026, 7:00 PM	1
127	Water Street Brewery Inc	Water Street Brewery	MATTHEW R SCHMIDT, Agt	1101 N WATER ST	Class B Tavern License	300	9/13/2026, 7:00 PM	1
128	PABST THEATER CONCESSIONS, LLC	THE PABST THEATER	Richard J Ryan, Agt	144 E WELLS ST	Class B Tavern License		7/5/2026, 7:00 PM	1
129	Black Tuna LLC	Lucky Ginger	Soukvilay Sayavongsa, Agt	221 N Water ST	Class B Tavern License		9/13/2026, 7:00 PM	1
130	MARCUS HOTELS HOSPITALITY, LLC	UPPER BAR	LaMarvon J Jackson, Agt	111 E Kilbourn AV 210	Class B Tavern License		9/21/2026, 7:00 PM	1
131	OVG Hospitality	OVG Hospitality	Maxxwel A Rodriguez, Agt	929 N WATER ST	Class B Tavern License		9/23/2026, 7:00 PM	1
132	SINCERESWAN, LLC	SWINGIN DOOR EXCHANGE	MICHELLE M SINCERE, Agt	219 E MICHIGAN ST	Class B Tavern License	80	10/10/2026, 7:00 PM	1
133	Sweet Diner LLC	Sweet Diner	George S Prassas, Agt	239 E Chicago ST 103	Class B Tavern License		10/13/2026, 7:00 PM	1
134	MARSHA'S COCKTAILS BY COUNTY LLC	GRACE CENTER	Marsha A Scharles-Horcos, Agt	250 E JUNEAU AV	Class B Tavern License		10/7/2026, 7:00 PM	1
135	Drury Hotels Company, LLC	Drury Plaza Hotel - Milwaukee Downtown	Chris Palid, Agt	700 N Water ST	Class B Tavern License		10/2/2026, 7:00 PM	1
136	LC MKE LLC	The Lucky Clover Pub	JACOB E DEHNE, Agt	1048 N MARTIN L KING JR DR	Class B Tavern License		8/19/2026, 7:00 PM	1
137	BENSON'S CATERING MKE LLC	Milwaukee Athletic Club	David J Marcus, Agt	758 N BROADWAY - 4th Floor	Class B Tavern License		10/7/2026, 7:00 PM	1
138	YOUR OFFICE, LLC	YOUR OFFICE	MICHAEL R SORGE, Agt	763 N MILWAUKEE ST	Class B Tavern License		10/8/2026, 7:00 PM	1
139	BREW CITY BAR B Q, INC	TRINITY THREE IRISH PUBS	MATTHEW R SCHMIDT, Agt	125 E JUNEAU AV	Class B Tavern License	833	10/16/2026, 7:00 PM	1
140	HAR FATEH, INC.	Turmeric Indian Cafe & Bar	Paramjit Kaur, Agt	1014 N Van Buren ST	Class B Tavern License		10/28/2026, 7:00 PM	1
141	BW HOLDINGS, LLC	WARD'S HOUSE OF PRIME	BRIAN J WARD, Agt	540 E MASON ST	Class B Tavern License	260	11/1/2026, 6:00 PM	1
142	JCTH, INC	CAFE AT THE PLAZA	BENJAMIN T CRICHTON, Agt	1007 N CASS ST	Class B Tavern License		11/23/2026, 6:00 PM	1
143	CDWI ASSOCIATES LLC	Cambria Milwaukee Downtown	Angenika R White, Agt	503 N PLANKINTON AV	Class B Tavern License		10/12/2026, 7:00 PM	1

144	Woori Corp	Kanpai	Jongsoo Kim, Agt	408 E Chicago ST	Class B Tavern License	99	10/20/2026, 7:00 PM	1
145	THE WOLF LLC	The Wolf on Broadway	Matthew A Schaefer, Agt	600 N BROADWAY	Class B Tavern License		10/18/2026, 7:00 PM	1
146	LOWCOUNTRY MILWAUKEE INC	Lowcountry	Mindy Am Bongxay, Agt	1114 N WATER ST	Class B Tavern License		9/15/2026, 7:00 PM	1
147	Good Land LLC	Draft & Co.	Nathaniel A Davauer, Agt	401 W WISCONSIN AV	Class B Tavern License		7/8/2026, 7:00 PM	1
148	Noble Catering MKE LLC	Noble Catering & Events	Kaelyn M Cervero, Agt	219 N MILWAUKEE ST	Class B Tavern License		10/12/2026, 7:00 PM	1
149	PTG Live Events LLC	Pabst Theater Group	RICHARD J RYAN, Agt	1119 N Marshall ST	Class B Tavern License		10/31/2026, 7:00 PM	1
150	COMPASS GROUP USA, INC.	EUREST NORTHWEST ERN MUTUAL	Maureen L Malone, Agt	805 E MASON ST	Class A Malt & Class A Liquor License		11/5/2026, 6:00 PM	1
151	3rd Street Market LLC	3rd St Market Hall	Eric T Kaye, Agt	275 W WISCONSIN AV 100	Class B Tavern License		11/9/2026, 6:00 PM	1
152	Artisan Ramen LLC	Artisan Ramen	Yufeng Qiu, Agt	530 E Mason ST	Class B Tavern License	93	11/4/2026, 6:00 PM	1
153	CALDERONE CLUB	CALDERONE CLUB	GIORGIO G FAZZARI, SP	842 N MARTIN L KING JR DR	Class B Tavern License	100	11/21/2026, 6:00 PM	1
154	ASCENT BAR MKE LLC	Ascent Bar	TIM B GOKHMAN, Agt	700 E KILBOURN AV	Class B Tavern License		11/19/2026, 6:00 PM	1
155	HDS 777, LLC	The Sofie	DAVID J SAFINA, Agt	777 N JEFFERSON ST	Class B Tavern License		11/20/2026, 6:00 PM	1
156	BOOBY JDK, LLC	McGillycuddy's Bar & Grill	ANDREW C DEUSTER, Agt	1133-37 N Water ST	Class B Tavern License	300	11/28/2026, 6:00 PM	1
157	Charro Latino, LLC	THE CONROY/Parlay	Singh G Saini, Agt	725-729 N Milwaukee ST	Class B Tavern License	490	4/2/2026, 7:00 PM	1
158	BBC 782 LLC	Barrel Burrito Co	MICHAEL J EITEL, Agt	782 N JEFFERSON ST	Class B Tavern License		12/1/2026, 6:00 PM	1
159	MKE Events LLC	Red White and Blue	JACOB E DEHNE, Agt	1044 N MARTIN L KING JR DR	Class B Tavern License	824	11/23/2026, 6:00 PM	1
160	REAL CHILI OF MILWAUKEE, INC	REAL CHILI	STEPHEN J KASTELIC, Agt	419 E WELLS ST	Class B Tavern License	80	11/27/2026, 6:00 PM	1
161	MARCUS HOTELS HOSPITALITY, LLC	River Center Market	LaMarvon J Jackson, Agt	111 E KILBOURN AV 120	Class B Fermented Malt Beverage Retailer's License		12/7/2026, 6:00 PM	1

162	MARCUS HOTELS HOSPITALITY, LLC	River Center Market	LaMarvon J Jackson, Agt	111 E KILBOURN AV 120	Class C Wine Retailer's License		12/7/2026, 6:00 PM	1
-----	---	------------------------	----------------------------	-----------------------------	---------------------------------------	--	-----------------------	---

Establishments within a 0.5 miles radius centered on area of interest.





Wednesday, January 14, 2026



# Notice of Public Hearing

Blank Notice

---

SAINI, Singh G, Agent  
The Conroy at 725 N MILWAUKEE St  
Class B Tavern, Public Entertainment Premises, Food Dealer and Sidewalk Dining Licenses  
Application Requesting Instrumental Musicians, Disc Jockey and Bands

**Tuesday, January 27, 2026 at 1:00 PM**

To whom it may concern:

The above application has been made by the above named applicant(s). This requires approval from the Licenses Committee and the Common Council of the City of Milwaukee. The hearing before the Licenses Committee will take place on 1/27/2026 at 1:00 PM in Room 301-B; Third Floor, City Hall. This is a public hearing. Those wishing to view the proceeding are able to do so via the City Channel – Channel 25 on Spectrum Cable – or on the Internet at <http://city.milwaukee.gov/citychannel>. Those wishing to provide oral testimony via internet are asked to contact the staff assistant, Yadira Melendez at (414) 286-2775 or [stasst5@milwaukee.gov](mailto:stasst5@milwaukee.gov) for necessary information. Please make such requests no later than one business day prior to the start of the meeting. You are not required to attend the hearing, but please see the information below if you would like to provide testimony. Once the Licenses Committee makes its recommendation, this recommendation is forwarded to the full Common Council for approval at its next regularly scheduled hearing.

---

## **Important details for those wishing to provide information for the Licenses Committee to consider when making its recommendation:**

1. The license application is scheduled to be heard at the above time. Due to other hearings running longer than scheduled, you may have to wait some time to provide your testimony.
2. You must appear in person and testify as to matters that you have personally experienced or seen. (You cannot provide testimony for your neighbor, parent or anyone else; this is considered hearsay and cannot be considered by the committee.)
3. No letters or petitions can be accepted by the committee (unless the person who wrote the letter or the persons who signed the petition are present at the committee hearing and willing to testify).
4. Persons opposed to the license application are given the opportunity to testify first; supporters may testify after the opponents have finished.
5. When you are called to testify, you will be sworn in and asked to give your name, and address. (If your first and/or last names are uncommon please spell them.)
6. You may then provide testimony.
  - a. Include only information relating to the above license application.
  - b. Include only information you have personally witnessed or seen.
  - c. Provide concise and relevant information detailing how this business has affected or may affect the peaceful enjoyment of your neighborhood.
  - d. If by the time you have the opportunity to testify, the information you wish to share has already been provided to the committee, you may state that you agree with the previous testimony. Redundant or repetitive testimony will not assist the committee in making its recommendation.
7. After giving your testimony, the members of the Licenses Committee and the licensee may ask questions regarding the testimony you have given or other factors relating to the license application.
8. Business Competition is not a valid basis for denial or non-renewal of a license.  
**Please Note: If you have submitted an objection to the above application your objection cannot be considered by the committee unless you personally testify at the hearing.**

[illegible]

[illegible]

CURRENT OCCUPANT	758 N BROADWAY# 905	MILWAUKEE, WI 53202-3654
CURRENT OCCUPANT	758 N BROADWAY# 906	MILWAUKEE, WI 53202-4012
CURRENT OCCUPANT	758 N BROADWAY# 907	MILWAUKEE, WI 53202-4012
CURRENT OCCUPANT	758 N BROADWAY# 908	MILWAUKEE, WI 53202-4012
CURRENT OCCUPANT	758 N BROADWAY# 909	MILWAUKEE, WI 53202-4012
CURRENT OCCUPANT	758 N BROADWAY# 910	MILWAUKEE, WI 53202-3654
CURRENT OCCUPANT	758 N BROADWAY# 911	MILWAUKEE, WI 53202-4013

Blank Notice

Total Records: 100

Radius 250 feet and Center of the Circle: 725 N Milwaukee St



## BUSINESS LICENSE PLAN OF OPERATION

ccl-busplan 5/12/2020

Office of the City Clerk License Division  
200 E. Wells St. Room 105, Milwaukee, WI 53202  
(414) 286-2238 www.milwaukee.gov/license e-mail address: [license@milwaukee.gov](mailto:license@milwaukee.gov)

### 1. Type of Business

Applying for: ☐ Extended Hours (12AM to 5AM) - If a food establishment, check all that apply: ☐ Delivery ☐ Drive Thru ☐ Dining Room  
☐ Self Service Laundry ☐ Massage Establishment ☐ Filling Station  
☒ Other (supplemental application for specific license also required)

Provide a detailed description of the type of business you plan on operating:

FULL SERVICE RESTAURANT

Do you have any experience operating this type of business? ☐ No ☒ Yes If yes, explain: SEPARATING CURRENT LICENSE

### 2. Business Operations

- a. Proposed Opening Date: DEC 2025
- b. Is this premise under construction? ☒ No ☐ Yes If yes, list estimated completion date: \_\_\_\_\_
- c. Is this a franchise? ☒ No ☐ Yes
- d. Is this premises currently licensed? ☐ No ☒ Yes If yes, list type of license: \_\_\_\_\_  
CLASS B, FOOD DEALER, FUSION ENTERTAINMENT, SIDEWALK, LOADING ZONE
- e. Is the current licensee operating? ☐ No ☒ Yes If no, list date closed: \_\_\_\_\_
- f. Do you have future plans for other businesses, licenses or permits at this location? ☒ No ☐ Yes  
If yes, explain: \_\_\_\_\_
- g. Have you previously held an Extended Hours License in Milwaukee? ☒ No ☐ Yes  
If yes, list address(es): \_\_\_\_\_
- h. Are other businesses operating in the same building? ☒ No ☐ Yes If yes, describe: \_\_\_\_\_

### 3. Litter & Noise

- a. How are grounds kept clean? ☒ Sweep ☒ Pressure Wash ☒ Pick Up Litter ☐ Other: \_\_\_\_\_
- b. How often will grounds be cleaned? ☒ Daily ☐ Weekly ☐ As Needed ☐ Monthly ☐ Other: \_\_\_\_\_
- c. Grounds cleaned by: ☒ Licensee ☒ Building Owner ☒ Employees ☒ Hired Maintenance ☐ Other: \_\_\_\_\_
- d. How are noise issues prevented and/or addressed? ☐ Security ☒ Manager approaches customer(s) ☐ Call Police  
☐ Signs Posted ☐ Other: \_\_\_\_\_
- e. Will a sound amplification system be used? ☒ No ☐ Yes If yes, describe: \_\_\_\_\_

### 4. Smoking & Sanitation

- a. Are there designated outdoor smoking areas? ☒ No ☐ Yes If yes, describe: \_\_\_\_\_
- b. Number of Garbage Cans: Inside: 10 Locations: THROUGHOUT PREMISES  
Outside: 0 Locations: \_\_\_\_\_
- c. Is a crowd control barrier used? ☒ No ☐ Yes If yes, describe: \_\_\_\_\_
- d. How many restrooms are on the premises? 3
- e. Name of solid waste contractor: ☐ Advanced Disposal ☒ Waste Management ☒ Other: \_\_\_\_\_

## 5. Security

- a. Are there onsite parking spaces? ☒ No ☐ Yes If yes, how many? \_\_\_\_\_ and describe the parking security plan: \_\_\_\_\_
- b. Is there a loading zone? ☒ No ☐ Yes If yes, describe the loading area security plan: \_\_\_\_\_
- c. Will you have licensed security on premise? ☒ No ☐ Yes If yes, how many? \_\_\_\_\_ and answer the following:  
What are their responsibilities? \_\_\_\_\_  
Describe equipment used \_\_\_\_\_  
List their License Number (s) \_\_\_\_\_
- d. Will there be security cameras? ☐ No ☒ Yes If yes, how many? 16; THROUGHOUT INTERIOR AND EXTERIOR and list locations: \_\_\_\_\_
- e. Will searches/identification checks be done upon entry? ☒ No ☐ Yes If yes, describe \_\_\_\_\_

## 6. Percentage of Sales (must total 100%)

Alcohol <u>30</u> %	Food <u>70</u> % Cigarettes, Electronic Vape Devices, Tobacco Products _____ %	Secondhand Merchandise _____ %	Precious Metals & Gems _____ %
Entertainment _____ %	Pawnbroker Activity _____ %	Salvaged Materials _____ % (such as scrap metal)	Personal Services (such as tattoo, body piercing, salon, tailor, tanning, etc.) _____ %
			Other _____ % Describe: _____

## 7. Businesses/Licenses on the Premises (check all that apply):

### Type 1

- ☒ Full Service Restaurant ☐ Cafe/Coffee Shop ☐ Deli or Fast Food Restaurant ☐ Private/Fraternal/Veterans Club
- ☐ Night Club ☐ Tavern ☒ Cocktail Lounge ☐ Teen Club
- ☐ Banquet Hall ☐ Sports Facility ☐ Bowling Alley
- ☐ Hotel/Motel: Number of Floors: \_\_\_\_\_ Number of Rooms: \_\_\_\_\_
- ☐ Rooming House: Number of Floors: \_\_\_\_\_ Number of Rooms: \_\_\_\_\_

### Type 2

- ☐ Liquor Store ☐ Corner Store ☐ Supermarket ☐ Convenience Store
- ☐ Gas Station ☐ Amusement/Phonograph Distributor ☐ Recycling, Salvage or Towing
- ☐ Used Car Dealer ☐ Personal Service Establishment  
(such as tattoo business, hair salon, tailor, etc.) ☐ Recording Studio

What other licenses/permits will you hold at this location? (check all that apply)

- ☒ Occupancy Permit ☐ Cigarette, Tobacco, Electronic Vape Products ☐ Gas Station ☐ Extended Hours ☒ Class "B" Tavern ☐ Weights & Measures
- ☐ Secondhand Dealer ☐ Precious Metal & Gem ☒ Other: FOOD DEALER, SIDEWALK DINING, LOADING ZONE

## 8. Legal Capacity (only if a Type 1 premises in #7 above)

Capacity 190 (Call the Milwaukee Development Center at 414-286-8211 if you have questions.)



## 9. Premises Description

- a. Identify all area(s) of the premises that will be used in operating this business (include areas used only for storage):  
☒ 1<sup>st</sup> Floor ☐ 2<sup>nd</sup> Floor ☐ Basement Storage ☐ Patio ☐ Beer Garden ☐ Sidewalk Café ☐ Deck ☐ Rooftop  
☐ Other: Describe: Mezzanine
- b. Describe Location: ☐ Major Thoroughfare ☒ Secondary Street ☐ Other: MILWAUKEE ST
- c. Nearest Major Cross Street: WISCONSIN AVE
- d. Describe Building: ☒ Free Standing Building ☐ Strip Mall ☐ Other: \_\_\_\_\_
- e. Describe Premises Structure: ☐ Single Story ☒ Multi-Story - # of Stories 3.5 ☐ Other: \_\_\_\_\_
- f. Describe Surrounding Area: ☒ Commercial ☒ Residential ☐ Industrial ☐ Other: \_\_\_\_\_
- g. Building Owner Name: BELL SUPER LLC Phone Number: 414-687-5136  
Building Owner Address: PO BOX 2147, BROOKFIELD, WI 53008

## 10. Hours of Operation & Customers

Will customers be entering the premises? ☐ No ☒ Yes

Day of the Week	Proposed Hours of Operation:		Estimated Number of Customers expected each day	Potential Age Range of Customers	Class B Tavern Applicant Only: Age Restriction (If none, write 'None')
	Open Time (include a.m. or p.m.)	Close Time (include a.m. or p.m.)			
Sunday	7:00 AM	2:00 AM	80	24-60	NONE
Monday	7:00 AM	2:00 AM	80	24-60	NONE
Tuesday	7:00 AM	2:00 AM	80	24-60	NONE
Wednesday	7:00 AM	2:00 AM	80	24-60	NONE
Thursday	7:00 AM	2:00 AM	80	24-60	NONE
Friday	7:00 AM	2:30 AM	150	24-60	NONE
Saturday	7:00 AM	2:30 AM	150	24-60	NONE

An Extended Hours Establishment License is required for any convenience store, filling station, personal service establishment (such as tattoo, body piercing, salon, tailor, tanning, etc.), recording studio or restaurant which is open between the hours of 12:00 a.m. and 5:00 a.m.

Alcohol Establishments Class A: 8:00 am to 9:00 pm Sunday thru Saturday  
Permitted Hours of Operation: Class B: 6:00 am to 2:00 am Sunday thru Thursday, 6:00 am to 2:30 am Friday & Saturday

Entertainment Outdoor Closing Hours: 10:00pm Sunday-Thursday; 12:00am Friday & Saturday; unless a different time, either earlier or later, is established by the Common Council in its approval of the licensee's plan of operation.

## 11. Signature(s)

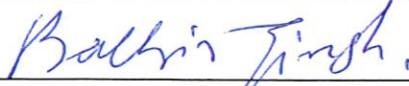
  
Signature of Sole Proprietor, Partner, or 20% or more Shareholder  
(If there are no 20% or more shareholders,  
Corporate Officer-print name/title and sign)

\_\_\_\_\_  
Signature of additional partner or 20% or more shareholder

See Application Information for a complete list of all required application forms.





# ALCOHOL BEVERAGE & PUBLIC ENTERTAINMENT PREMISES SUPPLEMENTAL APPLICATION

Office of the City Clerk License Division  
200 E. Wells St. Room 105, Milwaukee, WI 53202  
(414) 286-2238 e-mail address: [license@milwaukee.gov](mailto:license@milwaukee.gov) [www.milwaukee.gov/license](http://www.milwaukee.gov/license)

Legal Entity Name: THE CONROY LLC

Premise Address: 725 N MILWAUKEE ST, MILWAUKEE, WI 53202

## Proximity of Premises to Church, School, Daycare Center or Hospital

Is the building within 300 feet of any church, school, daycare center or hospital? ☒ No ☐ Yes

## "Service Bar Only" Designation

If applying for Class B or C license, are you applying for "Service Bar Only"? ☒ No ☐ Yes

Service Bar Only means customers cannot sit at the bar. Alcohol is served to employees who serve patrons seated at tables. No stools, chairs or other articles of furniture shall be placed at the service bar for patrons to sit upon.

## Business Information

a) Are you taking out this application for anyone that may not be eligible for a license? ☒ No ☐ Yes

If yes, list their name and address: \_\_\_\_\_

b) Will the agent, a partner or the individual licensee be conducting the day-to-day operations of the business? ☐ No ☒ Yes

If no, list the name and address of the person(s) who will: \_\_\_\_\_

Class B Applicants: If the agent, a partner or the individual licensee will not be conducting the day-to-day operations of the business, the person(s) listed above must obtain a Class B Managers license.

c) Does anyone else have money invested or any other interest in this business? ☒ No ☐ Yes

If yes, explain: \_\_\_\_\_

d) Have you made an agreement with anyone to repay any loan or any other payments based upon income from the business?

☒ No ☐ Yes If yes, list name and address: \_\_\_\_\_

## Property Information (New & Transfer Applicants Only)

a) Do you own or lease the building? ☒ Own ☐ Lease

b) Who owns the fixtures (for example, coolers, etc.)? THE CONROY LLC

c) Are you purchasing the stock and/or fixtures? ☒ No ☐ Yes If yes, amount paid \$ \_\_\_\_\_

d) Total amount paid for business \$N/A

e) Total amount paid for goodwill of the business \$N/A

Goodwill comprises the reputation and customer relationships of an existing business. If the price you pay for the business exceeds the fair market value of all of the rest of the assets of the business, the excess may be considered goodwill.

## Lease Information (New & Transfer Applicants who are leasing the premises only)

a) Date lease begins \_\_\_\_\_ Ends \_\_\_\_\_

b) Monthly rental \$ \_\_\_\_\_

c) Do you have an option to renew the lease? ☐ No ☐ Yes

d) Does your lease allow for assignment to another party without the consent of the owner? ☐ No ☐ Yes

e) For what length of time have you been guaranteed occupancy (number of years)? \_\_\_\_\_

### Lease Information (Continued)

- f) In addition to paying the monthly rental, will you have to pay anything additional to the owner of the building to guarantee performance of the lease? ☐ No ☐ Yes If yes, explain \_\_\_\_\_
- g) Does the present owner or occupant object to the granting of your license? ☐ No ☐ Yes  
If yes, explain \_\_\_\_\_

### Change of Agent Applicants Only

Have there been any changes to the floor plan since the last application was submitted? ☐ No ☒ Yes  
If no, a new floor plan is not required. If yes, submit a new floor plan and explain the change(s):  
SEPARATING LICENSES/PREMISES \_\_\_\_\_

### Signature



\_\_\_\_\_  
Signature of Sole Proprietor, Partner or 20% or More Shareholder  
(If no 20% or more Shareholder, Corporate Officer - print name/title and sign)

Note: All information contained in this application is subject to approval by the Common Council.  
Deviating from approved plan of operation will subject licensee to citations, and/or suspension or non-renewal of the license.  
Contact the License Division for information on how to request changes.

### New and transfer of premises applicants must submit the following:

- ☐ Detailed floor plan  
☐ If a restaurant, copy of the menu



**FOOD DEALER LICENSE PLAN OF OPERATION**

OFFICE OF THE CITY CLERK, LICENSE DIVISION  
CITY HALL, 200 E. WELLS ST, ROOM 105, MILWAUKEE, WI 53202  
(414) 286-2238 • [license@milwaukee.gov](mailto:license@milwaukee.gov) • [www.milwaukee.gov/license](http://www.milwaukee.gov/license)

Legal Entity Name: **THE CONROY LLC**

Premises Address: **725 N MILWAUKEE ST, MILWAUKEE, WI 53202**

**SECTION 1 TYPE OF BUSINESS**

What will be the majority of your food sales? (check one)

☒ Restaurant Items (meals):

MEALS include, but are not limited to, chicken, ribs, sandwiches, roasted corn, baked potatoes, hot dogs, brats, tacos, nachos w/ cheese and meat, French fries, cooked or deep fried vegetables/fruit, cooked cheese curds, corn dogs, egg rolls, salads.

☐ Retail Items (snacks and beverages):

RETAIL items include, but are not limited to, ice cream/soft serve, lemonade, snow cones, coffee, espresso, cappuccino, tea, fruit juice, smoothies, candy, dispensed soda, fruit cups, bakery, cookies, kettle corn, cotton candy, funnel cakes, fritters, tortilla chips w/ cheese.

Will it be a convenience store? ☐ Yes ☐ No

A convenience store contains less than 7,500 square feet of retail space and has, as its primary business, the sale of basic food items and in addition, sells household products or is a filling station that sells basic food items and household products.

☐ Bed & Breakfast

☐ Micro Market

All Applicants: Submit a menu or a list of food items that will be sold.

Will any wholesale business be done? ☒ No ☐ Yes If yes, what percentage of food sales will be wholesale?

☐ Less than 25%

☐ 25% or More AND:

☐ Restaurant items (meals) will be sold – Complete this application and also contact DATCP.

☐ NO restaurant items (meals) will be sold - Do NOT complete this application. Contact DATCP only.

**SECTION 2 FOOD PROCESSING**

Will any food processing be done? ☐ No ☒ Yes

Processing is defined as assembling, grinding, cutting, mixing, baking, coating, stuffing, packing, bottling, grilling, canning, extracting, fermenting, distilling, pickling, freezing, drying, smoking, or packaging.

**SECTION 3 FOOD REQUIRING TEMPERATURE CONTROL**

Will any food that requires temperature control be sold? ☐ No ☒ Yes  
(includes dairy products such as milk, cheese, and ice cream, fish, shellfish, meat, poultry)

If yes, list the types of food items: **MILK, CHEESE, ICE CREAM, FISH, SHELLFISH, MEAT, POULTRY**

**SECTION 4 DETAILS OF OPERATION**

- Will you have seating on site for dining? ☐ No ☒ Yes
- Will you be doing any catering? ☐ No ☒ Yes
- Will you be doing any delivery? ☒ No ☐ Yes
- Will you have outdoor activities? ☐ No ☒ Yes - Check all that apply: ☐ Bar ☐ Cooking/Grilling ☒ Dining
- Will you have a drive thru window? ☒ No ☐ Yes - Are hours different from inside? ☐ No ☐ Yes
- If Yes, provide drive thru hours: \_\_\_\_\_
- Will scales or barcode scanners be used? ☒ No ☐ Yes - You must also apply for a Weights & Measures License.

**SECTION 5 ADDITIONAL SITES**

Where will food be prepared and/or sold?

☒ At a single site ☐ At multiple sites: How many? \_\_\_\_\_ (for example, a hotel with several dining rooms or bars)

If multiple sites, attach a Food Dealer Additional Site Addendum (ccl-foodadd) for each additional site.

**SECTION 6 CONSTRUCTION OR CHANGES**

Are you planning any construction, remodeling or equipment changes?

☒ No If No, SKIP to Section 7

☐ Yes If Yes, check all that apply: ☐ New construction of a building ☐ Renovation or remodeling  
☐ Construction changes to existing building ☐ Equipment changes only

Provide a brief description of the changes: \_\_\_\_\_

Start date: \_\_\_\_\_

Name, Address & Phone Number of Architect: \_\_\_\_\_

Name, Address & Phone Number of Contractor: \_\_\_\_\_

**SECTION 7 ALCOHOL BEVERAGES**

Are you applying for an alcohol beverage license?

☐ No If No, SKIP to Section 8

☒ Yes If YES, if your food license is approved prior to the alcohol license, when do you want the food license issued?

☐ Immediately ☒ At the same time as the alcohol license

**SECTION 8 ACKNOWLEDGEMENTS & SIGNATURE**

You must initial each item confirming your understanding:

B.S.

I understand the Health Department must conduct an inspection and advise the License Division of their approval before the license may be issued.

B.S.

I understand I must obtain an occupancy permit from the Department of Neighborhood Services and an inspection may be required. Neighborhood Services must advise the License Division of their approval before the license may be issued.

B.S.

I understand the district alderperson will review and either support or object to my application. If he/she objects, I may appeal and be scheduled to appear before the Licenses Committee. The Licenses Committee will then make a recommendation to the Common Council. The Common Council must grant the license before it may be issued.

B.S.

I understand proof of payment for all license fees must be on file in the License Division before the license may be issued and the license must be issued and posted in my establishment prior to opening for business.

B.S.

I will not operate my food business until the license has been issued and posted in the establishment.

Signature of Sole Proprietor, Partner, or 20% Shareholder: \_\_\_\_\_

Signature of Additional Partner: \_\_\_\_\_





# PUBLIC ENTERTAINMENT PREMISES LICENSE SUPPLEMENTAL APPLICATION

Office of the City Clerk License Division  
200 E. Wells St. Room 105, Milwaukee, WI 53202  
(414) 286-2238 [www.milwaukee.gov/license](http://www.milwaukee.gov/license) e-mail address: [license@milwaukee.gov](mailto:license@milwaukee.gov)

**PREMISES ADDRESS:** 725 N MILWAUKEE, MILWAUKEE, WI 53202

## TYPES OF ENTERTAINMENT (CHECK ALL THAT APPLY)

- |   |   |   |   |
|---|---|---|---|
| <input checked="" type="checkbox"/> Instrumental Musicians                          | <input type="checkbox"/> Battle of the Bands    | <input type="checkbox"/> Dancing by Performers                          | <input type="checkbox"/> Amusement Machines<br>How many? _____                |
| <input checked="" type="checkbox"/> Bands   | <input type="checkbox"/> Comedy Acts            | <input type="checkbox"/> Adult Entertainment/<br>Strippers/Erotic Dance | <input type="checkbox"/> Concerts<br>Approx. # per year? _____                |
| <input type="checkbox"/> Bowling Alley<br>How many? _____                           | <input checked="" type="checkbox"/> Disc Jockey | <input type="checkbox"/> Wrestling                                      | <input type="checkbox"/> Theatrical Performances<br>Approx. # per year? _____ |
| <input type="checkbox"/> Pool Tables<br>How many? _____                             | <input type="checkbox"/> Magic Shows            | <input type="checkbox"/> Patron Contests                                | <input type="checkbox"/> Jukebox  |
| <input type="checkbox"/> Motion Pictures (movies by<br>admission) - How many? _____ | <input type="checkbox"/> Poetry Readings        | <input type="checkbox"/> Patrons Dancing                                | <input type="checkbox"/> Karaoke  |
| <input type="checkbox"/> Hookah Service   | <input type="checkbox"/> Other: _____           |   |   |

*Entertainment Outdoor Closing Hours: 10:00pm Sunday-Thursdays; 12:00am Friday & Saturday; unless a different time, either earlier or later, is established by the Common Council in its approval of the licensee's plan of operation.*

## PROMOTERS/SOUND AMPLIFICATION

Will promoters ever be used for any of the entertainment? ☒ No ☐ Yes If Yes, Describe:

At any time will sound amplification be used? ☒ No ☐ Yes If Yes, Describe:

## LEGAL CAPACITY OF PREMISES

190 (Call the Development Center at 414-286-8211 with questions.) Legal capacity determines the fee for your Public Entertainment Premises License. If you would like to request the license be approved with a lower capacity than that listed above, indicate the lower capacity here: \_\_\_\_\_. If approved, this lower capacity will print on your license and override the capacity listed on your Occupancy Permit.

## ACKNOWLEDGEMENT/SIGNATURE

I understand that after the license has been issued, a change to the plan of operation will require a written request to change and approval from the Common Council. I agree to inform the City Clerk within 10 days of any substantial changes in the information supplied in this application. I understand that I shall not willfully refuse to provide the services offered under this license, or add charges or require deposits not required of the general public because of race, color, sex, religion, national origin or ancestry, age, handicap, lawful source of income, marital status, sexual orientation, gender identity or expression, familial status or the fact that a person is now or has been a member of the military service, whether dressed in uniform or not; and shall not seek such information as a condition of employment, or penalize any employee or discriminate in the selection of personnel for training or promotion on the basis of such information.

I have knowledge of the City Ordinances currently regulating public entertainment, and understand that the license may be subject to suspension, non-renewal or revocation, if I violate any rule, law or regulation of the city of Milwaukee and State of Wisconsin.

*Balbir Singh*

Signature of Sole Proprietor, Partner or 20% or More Shareholder  
(If no 20% or more Shareholder, Corporate Officer - print name/title and sign)

## Office Use Only:

Initials: \_\_\_\_\_ Filed: \_\_\_\_\_ App: \_\_\_\_\_

Only PEP? ☐ No ☐ Yes If Yes, ☐ Queue to MPD and ☐ Email Mgrs/Team Lead (must be heard w/in 60 days)





## Sidewalk Dining Facility Supplemental Application

ccl-sdinfo 12/10/2024

Office of the City Clerk License Division

200 E. Wells St. Room 105, Milwaukee, WI 53202

(414) 286-2238 [www.milwaukee.gov/license](http://www.milwaukee.gov/license) e-mail address: [license@milwaukee.gov](mailto:license@milwaukee.gov)

Business Name: <b>THE CONROY</b>	Aldermanic District # <b>4</b>
Premises Address: <b>725 N MILWAUKEE ST, MILWAUKEE, WI 53202</b>	
<b>Business Operations</b>	
Check one: <input checked="" type="checkbox"/> I/we are also applying for Food/Alcohol license(s) at this time. <input type="checkbox"/> I/we currently hold Food/Alcohol license(s) AND .... <input type="checkbox"/> confirm that the Business Plan of Operation on file which was previously submitted with the Food and/or Alcohol application has not changed, except for the addition of this sidewalk dining facility. <input type="checkbox"/> have included a new Business Plan of Operation reflecting requested changes.	
Sidewalk Dining Facility will operate from: Start Date: <b>APRIL 2026</b> to End Date: <b>OCTOBER 2026</b>	
Will any food preparation be done outdoors? <input checked="" type="checkbox"/> No <input type="checkbox"/> Yes If yes, describe: _____	
Will any sidewalk dining facility improvements be physically attached to public structures? <input checked="" type="checkbox"/> No <input type="checkbox"/> Yes If yes, describe: _____	
<b>Property Owner</b>	
Check one: <input type="checkbox"/> Applicant owns the property <input checked="" type="checkbox"/> Property owner's information/signature provided below (REQUIRED): Name: <b>BELL SUPER LLC</b> Phone # <b>414-687-5136</b> Address: <b>PO BOX 2147, BROOKFIELD, WI 53008</b> Property Owner's Signature: <u><i>Bellio Enol</i></u>	
<b>Signature(s)</b>	
<u><i>Bellio Enol</i></u> Signature of Sole Proprietor, Partner, or 20% or more Shareholder (If there are no 20% or more shareholders, Corporate Officer-print name/title and sign)	_____ Signature of additional partner or 20% or more shareholder

### Office Use Only:

Initials \_\_\_\_\_ Filed \_\_\_\_\_ App # \_\_\_\_\_

Processing LS: Queue to: ☐ HD ☐ DNS ☐ CC Email To: ☐ DPW ☐ Primary LS

Also: ☐ holds ☐ is applying for: ☐ Food ☐ Alcohol ☐ Perm Ext

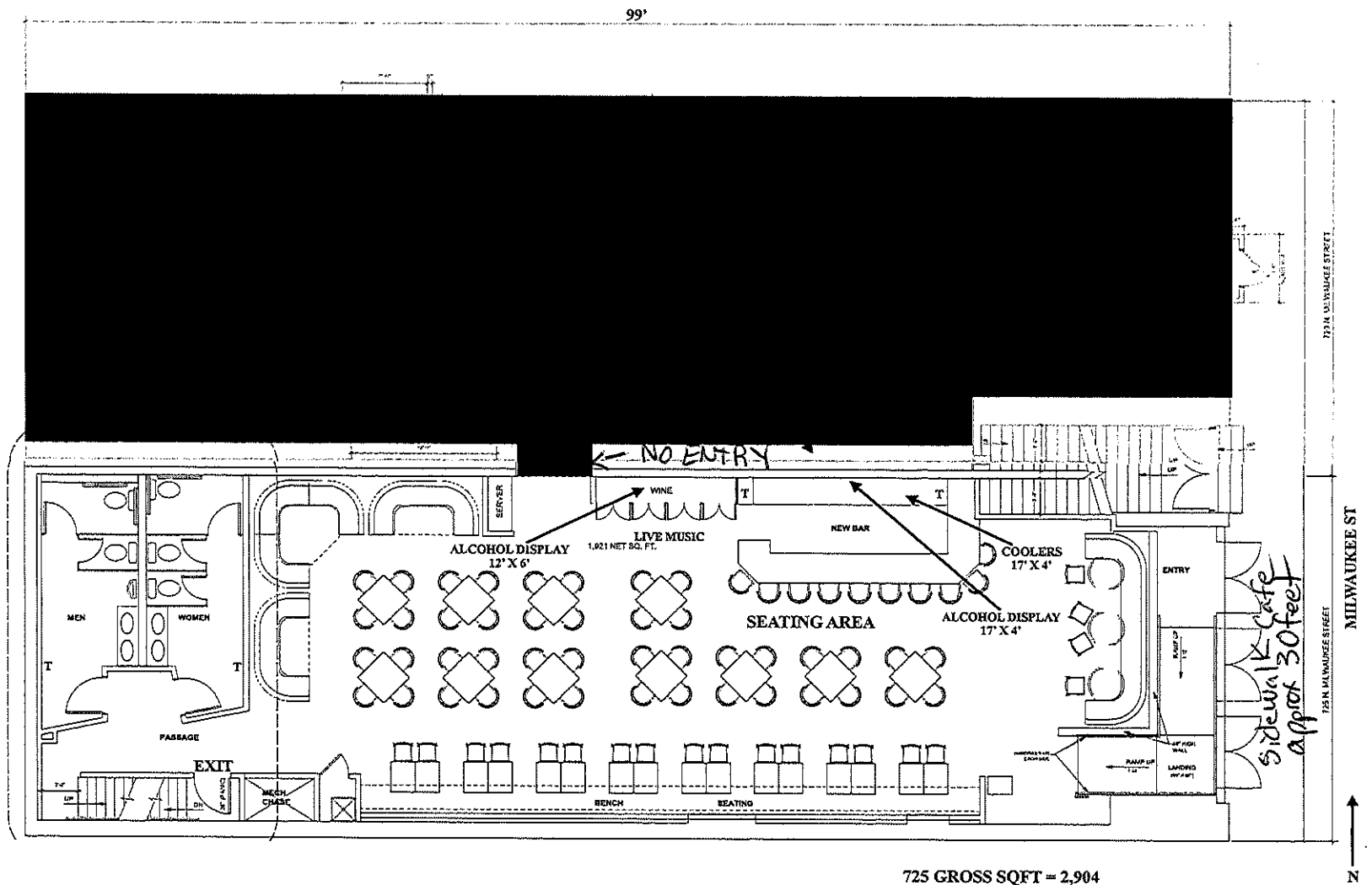

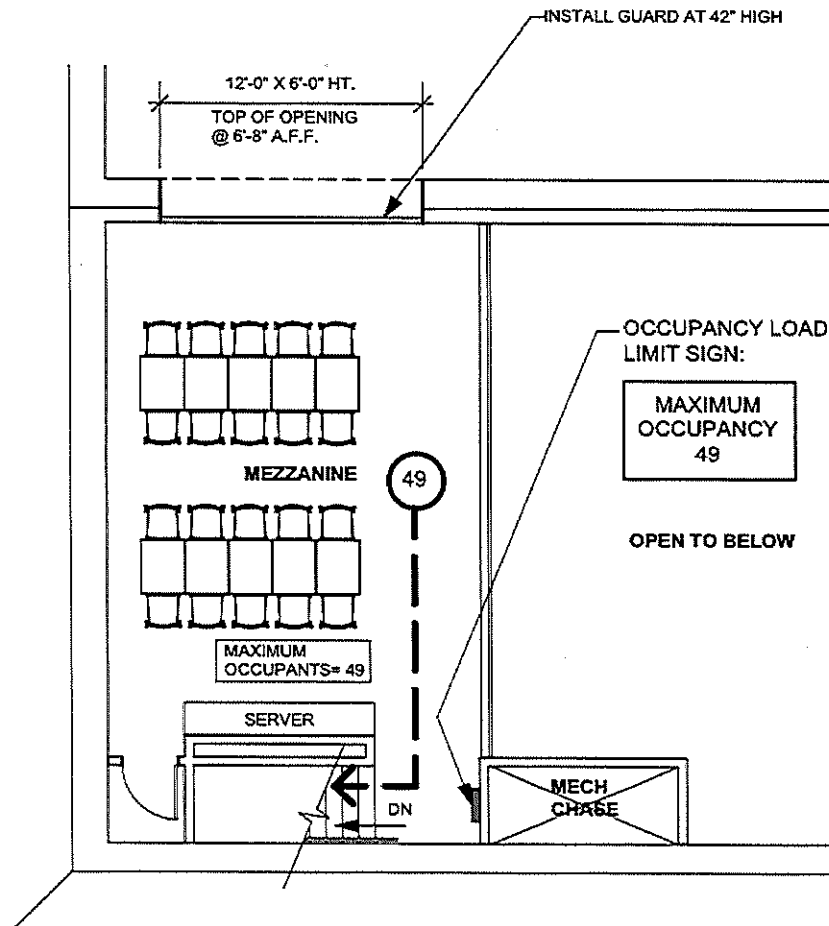

Saini, Singh, G. Agent for the Conroy LLC  
 "The Conroy"  
 725 N Milwaukee St, Milwaukee, WI, 53202  
 Mezzanine 12/10/25

--- EMERGENCY EGRESS  
PATH

# 4 MEZZANINE EMERGENCY EGRESS PLAN

SCALE: 1/8" = 1'-0"



105'

ALLEY

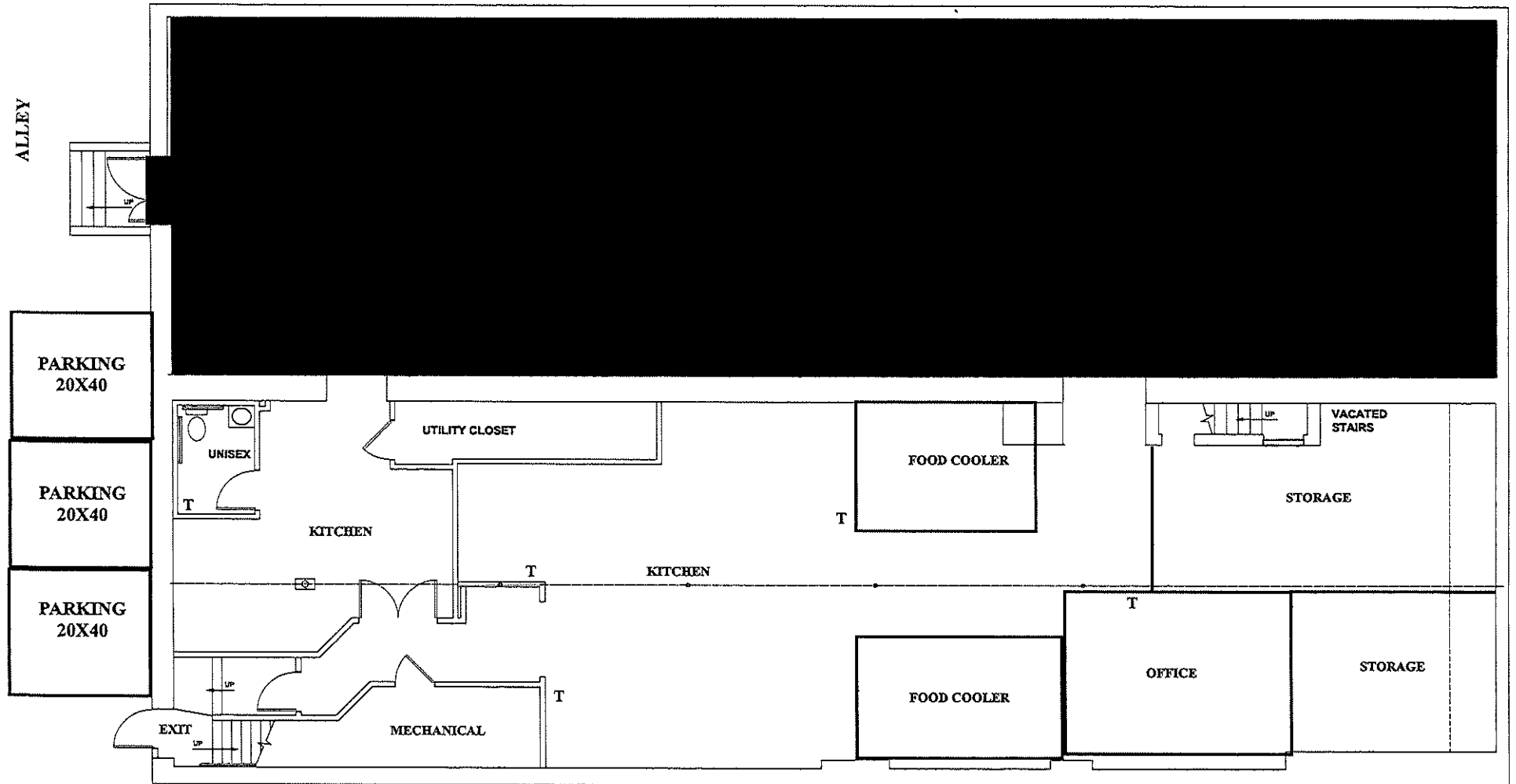

MILWAUKEE ST

61'

BASEMENT SQFT = 3,000

T = TRASH

SAINI, SINGH G AGENT FOR THE CONROY LLC  
"THE CONROY"  
725 N MILWAUKEE ST, MILWAUKEE, WI 53202  
BASEMENT  
11/6/2025



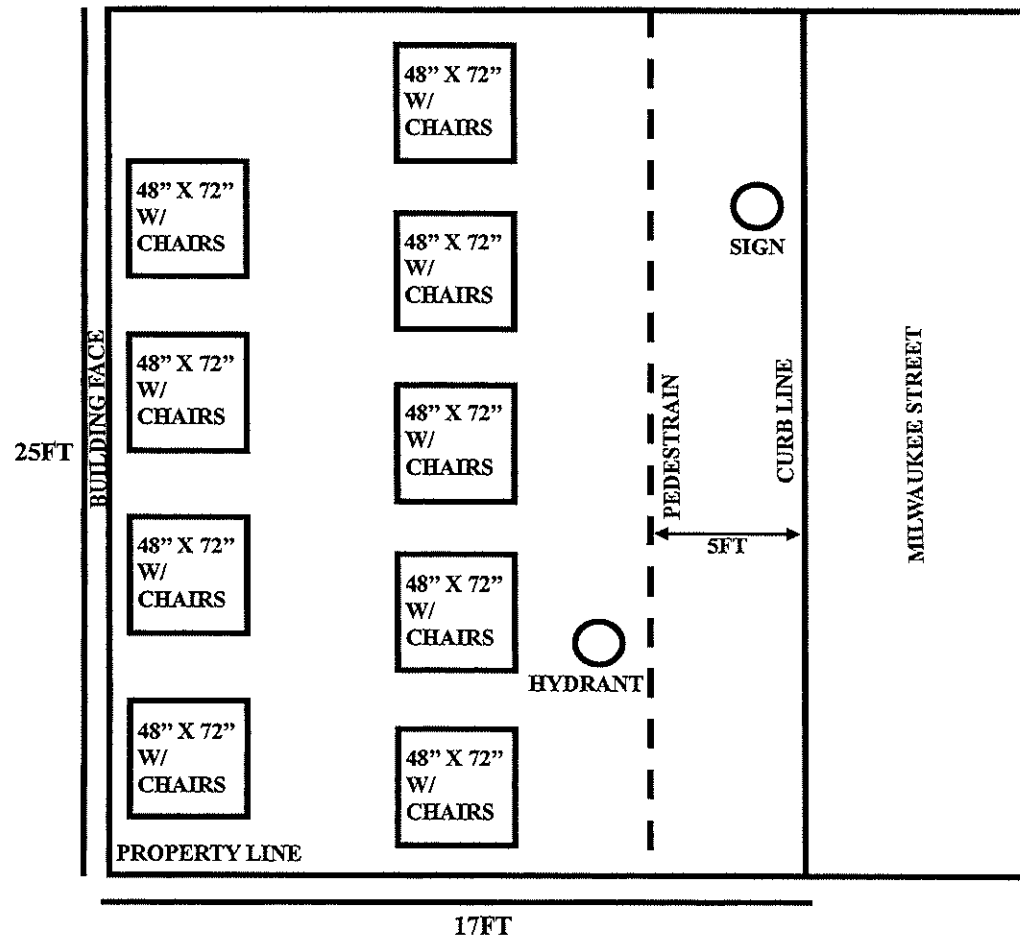

425 SQFT

SAINI, SINGH G AGENT FOR THE CONROY LLC  
"THE CONROY"  
725 N MILWAUKEE ST, MILWAUKEE, WI 53202  
414-763-7770  
11/6/2025

# THE CONROY

## WHITE WINE

### SPARKLING & CHAMPAGNE

RISATA, MOSCATO, PIEDMONT, ITALY NV 10 | 45

RISATA, PROSECCO, VENETO, ITALY NV 10 | 45

CAMPO VIEJO, CAVA, SPAIN NV 8 | 36

VEUVE CLICQUOT, BRUT, FRANCE NV 35 | 150

### ROSÉ & WHITE BLEND

WHISPERING ANGEL, ROSÉ, PROVENCE, FRANCE 2024 14 | 63

LA FÊTE DU BLANC, BLANC DE BLANCS, PROVENCE,  
FRANCE NV 15 | 68

### SAUVIGNON BLANC

CLOUDY BAY, MARLBOROUGH, NEW ZEALAND 2022 14 | 63

DAOU, PASO ROBLES, CALIFORNIA 2022 13 | 60

### PINOT GRIS

YEALANDS, MARLBOROUGH, NEW ZEALAND 2024 12 | 54

### CHARDONNAY

DAOU, PASO ROBLES, CALIFORNIA 2022 12 | 54

DUCKHORN, NAPA VALLEY, CALIFORNIA 2022 16 | 72

FLOWERS, SONOMA, CALIFORNIA 2022 20 | 90

## RED WINE

### PINOT NOIR

CHERRY PIE, CARNEROS, CALIFORNIA 2021 20 | 90

SEA SUN, CALIFORNIA 2021 12 | 54

### RED BLEND

CAYMUS THE WALKING FOOL, SUISUN VALLEY,  
CALIFORNIA 2022 16 | 72

JUSTIN ISOSCELES, PASO ROBLES, CALIFORNIA 2019 40 | 180

THE PAIRING, SANTA BARBARA, CALIFORNIA 2018 13 | 60

### MERLOT

DAOU SEQUENTIS, PASO ROBLES, CALIFORNIA 2021 20 | 90

### ZINFANDEL

TRENTADUE LA STORIA, SONOMA, CALIFORNIA 2021 15 | 67

### CABERNET

CAYMUS, NAPA VALLEY, CALIFORNIA 2022 32 | 144

CHARLES KRUG, NAPA VALLEY, CALIFORNIA 2022 24 | 108

## SIGNATURE COCKTAILS

### GOLDEN HOUR 16

CITRUS HONEY VODKA . LIMONCELLO  
ORANGE LIQUEUR

### MARILYN MONROE 18

VANILLA VODKA . PASSION FRUIT . LIME

### SEASONAL MULE

ASK SERVER/BARTENDER

### ROYAL BLOOM 16

EMPRESS GIN . RASPBERRY . STRAWBERRY  
EGG WHITE . ROSEWATER MIST

### DESERT ROSE 16

BLANCO TEQUILA . PRICKLY PEAR  
ORANGE LIQUEUR . LIME

### SUNDOWN 16

REPOSADO TEQUILA . BLOOD ORANGE  
GRAPEFRUIT . LIME

### OSAKA WHISPER 19

TOKI WHISKY . LYCHEE . LEMON

### QUIET FIRE 18

GLENFIDDICH 12 . AMARO . APEROL . LEMON

### VELVET LIME 16

COCONUT RUM . VODKA . LIME

### MOCKTAILS

MOST SIGNATURE COCKTAILS  
AVAILABLE SPIRIT-FREE

## CLASSIC COCKTAILS

### OLD FASHIONED 15

MAKER'S MARK . BITTERS

### MANHATTAN 16

LIMOUSIN RYE . SWEET VERMOUTH . BITTERS

### SIDECAR 17

VSOP COGNAC . ORANGE LIQUEUR . LEMON

### ESPRESSO MARTINI 15

VANILLA VODKA . COFFEE LIQUEUR . ESPRESSO

### FRENCH 75 18

BARREL-AGED GIN . LEMON . SPARKLING WINE

### SAZERAC 18

SAZERAC RYE . PEYCHAUD'S BITTERS . ABSINTHE



## BUBBLES & BUMPS

ONLY AT THE BAR | TUESDAY - FRIDAY | 4:30 PM - 6:30 PM

### CAVIAR

#### BUMP\* 8 | FLIGHT\* 24

POTATO CHIP . CRÈME FRAÎCHE . CHIVES  
CUCUMBER . BOURSIN . MICROGREENS  
NAAN BREAD . DILL CREAM CHEESE

### SPARKLING & CHAMPAGNE

RISATA, PROSECCO, VENETO, ITALY NV 8 | 40

CAMPO VIEJO, BRUT, CAVA, SPAIN, NV 7 | 30

VEUVE CLICQUOT, BRUT, FRANCE NV 32 | 143

### TO SIP

HOUSE SELECT RED 8

HOUSE SELECT WHITE 8

HALF PRICE CLASSIC COCKTAILS

HALF PRICE SIGNATURE COCKTAILS

### BITES

#### DRY AGED MEATBALLS 14

TOMATO SUGO . BASIL . PARMESAN

#### WAGYU BURGER\* 15

AMERICAN CHEESE . LETTUCE . TOMATO . CHILI AIOLI

#### CHIPS & DIP 6

HOUSEMADE POTATO CHIPS . ONION CREAM

#### PARMESAN TRUFFLE FRIES 8

## VINTAGE & VOGUE

THURSDAY | 5 PM - 9 PM

#### RESERVE CABERNET 20

CAYMUS, NAPA VALLEY, CALIFORNIA 2022

#### RESERVE CHARDONNAY 20

ROMBAUER, CARNEROS, CALIFORNIA 2022

#### SELECT RESERVE BOTTLES HALF PRICE

ASK SERVER/BARTENDER

## RESERVE CHAMPAGNE

### BOTTLE SERVICE

PERRIER JOUËT, BRUT, FRANCE 2015 422

DOM PÉRIGNON, BRUT, FRANCE 2013 620

VEUVE CLICQUOT, ROSÉ, FRANCE NV 165

VEUVE CLICQUOT, BRUT, FRANCE NV 150

MOËT & CHANDON, ROSÉ, FRANCE NV 136

### ACCOMPANIMENTS

PARMESAN TRUFFLE FRIES 14 CHARRED BROCCOLINI 14

GARLIC POTATO PURÉE 11 LOBSTER MAC & CHEESE 26

ROASTED WILD MUSHROOMS 14

### DESSERTS

#### CRÈME BRÛLÉE 12

VANILLA BEAN . CARAMELIZED SUGAR . BERRIES

#### CHEESECAKE 12

SEASONAL PREPARATION

#### FLOURLESS CHOCOLATE CAKE 12

DARK CHOCOLATE . ESPRESSO . CRÈME ANGLAISE

#### TIRAMISU 12

ESPRESSO . MASCARPONE . COCOA

## CAVIAR FLIGHT

#### HACKLEBACK\* 30 | ROYAL OSETRA\* 60

+ RISATA, PROSECCO 10 | + VEUVE CLICQUOT, BRUT 35

POTATO CHIP . CRÈME FRAÎCHE . CHIVES

CUCUMBER . BOURSIN . MICROGREENS

NAAN BREAD . DILL CREAM CHEESE

## FOR THE TABLE

### ROASTED SEAFOOD PLATTER MKT

LOBSTER TAILS . SHRIMP . SCALLOPS . MUSSELS

CHILI-GARLIC BUTTER

## STARTERS

#### WAGYU CARPACCIO\* 26

LEMON CAPER AIOLI . CHIVES . SOURDOUGH

+ ROYAL OSETRA 30

#### BEET & GOAT CHEESE SALAD 16

BABY SPINACH . CITRUS VINAIGRETTE . WALNUTS

#### CAESAR SALAD\* 14

ROMAINE HEARTS . BLACK GARLIC DRESSING

PARMESAN CRISP

#### BURRATA & CHARRED TOMATOES 16

AGED BALSAMIC . PISTACHIO . SOURDOUGH

#### CALAMARI FRITTI 18

MARINARA . LEMON AIOLI . PARSLEY

#### DRY AGED MEATBALLS 19

TOMATO SUGO . BASIL . PARMESAN

#### SAFFRON MUSSELS 19

COCONUT-SAFFRON BROTH . CHILI . SOURDOUGH

#### CHILI SHRIMP 25

CALABRIAN CHILI . BUTTER . LEMON

## JAPANESE WAGYU

#### A5 MIYAZAKI\* 56

2 OZ . WASABI CHANTILLY . SEL GRIS

+ ROYAL OSETRA 30

## ENTRÉES

#### FILET MIGNON\* 60

8 OZ . RED WINE DEMI-GLACE . GARLIC POTATO PURÉE

+ SCALLOPS 25 | + SHRIMP 20 | + LOBSTER TAIL 36

#### RIBEYE AU POIVRE\* 72

16 OZ . SLICED . BRANDY PEPPERCORN . TRUFFLE FRIES

+ SCALLOPS 25 | + SHRIMP 20 | + LOBSTER TAIL 36

#### CRISPY SALMON\* 40

MAPLE GLAZE . BUTTERNUT SQUASH PURÉE . PISTACHIO

#### ROASTED CHICKEN BREAST 32

WILD MUSHROOM JUS . GARLIC POTATO PURÉE . SHALLOTS

#### SEARED SCALLOPS\* 46

PARMESAN RISOTTO . LEMON BUTTER . HERB GREMOLATA

#### PINK PEPPERCORN BUCATINI 26

PARMESAN CREAM . CHIVES . WHITE WINE

+ CHICKEN BREAST 10 | + SHRIMP 20

#### SPICY RIGATONI 26

CALABRIAN CHILI . TOMATO CREAM . PARMESAN

+ CHICKEN BREAST 10 | + MEATBALLS 19 | + SHRIMP 20

#### WAGYU BURGER\* 20

AMERICAN CHEESE . LETTUCE . TOMATO . CHILI AIOLI . FRIES

\*CONSUMING RAW OR UNDERCOOKED MEATS, POULTRY, SEAFOOD, SHELLFISH, OR EGGS MAY INCREASE YOUR RISK OF FOODBORNE ILLNESS. PLEASE ALERT YOUR SERVER IF YOU HAVE ANY FOOD ALLERGIES OR DIETARY RESTRICTIONS. PRICES AND MENU SUBJECT TO CHANGE. 20% SERVICE CHARGE ADDED TO PARTIES OF 5 OR MORE.