



CITY OF MILWAUKEE
OFFICE OF THE CITY CLERK

Tuesday, May 05, 2026

COMMITTEE MEETING NOTICE

AD 06

QADAN, Amer S, Agent
QADAN CITY LLC
510 W VINE ST
MILWAUKEE, WI 53212

You are requested to attend a hearing which is to be held in Room 301-B, Third Floor, City Hall or you may attend virtually using the link below.

Tuesday, May 19, 2026 at 01:05 PM

The access code is <https://meet.goto.com/219052765>. Please see the enclosed best practices document for further instructions.

Regarding: Your Class A Fermented Malt, Food Dealer and Weights & Measures Licenses Application as agent for "QADAN CITY LLC" for "PENNY SAVER" at 510 W VINE St.

There is a possibility that your application may be denied for one or more of the following reasons: The recommendation of the committee regarding the application shall be based on evidence presented at the hearing. Per MCO 85-2.7-4, probative evidence concerning whether or not a new license should be granted may be presented on the following subjects: whether or not the applicant meets the municipal requirements, the appropriateness of the location and premises where the licensed premises is to be located and whether use of the premises for the purposes or activities permitted by the license would tend to facilitate a public or private nuisance or create undesirable neighborhood problems such as disorderly patrons, unreasonably loud noise, litter, and excessive traffic and parking congestion. Probative evidence relating to these matters may be taken from the plan of operation submitted with the license application, if any, but shall not include the content of any music. Evidence regarding the fitness of the location of the premises to be maintained as the principal place of business, including but not limited to whether there is an overconcentration of businesses of the type for which the license is sought; whether the proposal is consistent with any pertinent neighborhood business or development plans, or the location's proximity to areas where children are typically present. The applicant's record in operating similarly licensed premises; and whether or not the applicant has been charged with or convicted of any felony, misdemeanor, municipal offense or other offense, the circumstances of which substantially relate to the activity to be permitted by the license being applied for or any other factor which reasonably relates to the public health, safety or welfare may also be considered. See attached police report or correspondence.

Notice for applicants with warrants or unpaid fines:

Proof of warrant satisfaction or payment of fines must be submitted at the hearing on the above date and time. Failure to comply with this requirement may result in a delay of the granting/denial of your application.

Failure to appear at this meeting may result in the denial of your license. Individual applicants must appear only in person or by an attorney. Corporate or Limited Liability applicants must appear only by the agent designated on the application or by an attorney. Partnership applicants must appear by a partner listed on the application or by an attorney. If you wish to do so and at your own expense, you may be accompanied by an attorney of your choosing to represent you at this hearing.

You will be given an opportunity to speak on behalf of the application and to respond and challenge any charges or reasons given for the denial. No petitions can be accepted by the committee, unless the people who signed the petition are present at the committee hearing and willing to testify. You may present witnesses under oath and you may also confront and cross-examine opposing witnesses under oath. If you have difficulty with the English language, you should bring an interpreter with you, at your expense, so that you can answer questions and participate in your hearing.

You may examine the application file at this office during regular business hours prior to the hearing date. Inquiries regarding this matter may be directed to the person whose signature appears below.

Limited parking for persons attending meetings during normal business hours is available at reduced rates (5 hour limit) at the Milwaukee Center on the southwest corner of Kilbourn Avenue and Water Street. You must present a copy of the meeting notice to the parking cashier.

PLEASE NOTE: Upon reasonable notice, efforts will be made to accommodate the needs of disabled individuals through sign language interpreters or other auxiliary aids. For additional information or to request this service, contact the Council Services Division ADA Coordinator at (414) 286-2998, Fax - (414) 286-3456, TDD - (414) 286-2025.

JIM OWCZARSKI, CITY CLERK

BY: _____

Jim Cooney
License Division Manager

If you have questions regarding this notice, please contact the License Division at (414) 286-2238.

200 E. Wells Street, Room 105, City Hall, Milwaukee, WI 53202. www.milwaukee.gov/license
Phone: (414) 286-2238 Fax: (414) 286-3057 Email Address: License@milwaukee.gov



CITY OF MILWAUKEE
OFFICE OF THE CITY CLERK

Tuesday, May 05, 2026

COMMITTEE MEETING NOTICE

AD 06

QADAN, Amer S, Agent
QADAN CITY LLC
3509 W LAYTON AV
GREENFIELD, WI 53221

You are requested to attend a hearing which is to be held in Room 301-B, Third Floor, City Hall or you may attend virtually using the link below.

Tuesday, May 19, 2026 at 01:05 PM

The access code is <https://meet.goto.com/219052765>. Please see the enclosed best practices document for further instructions.

Regarding: Your Class A Fermented Malt, Food Dealer and Weights & Measures Licenses Application as agent for "QADAN CITY LLC" for "PENNY SAVER" at 510 W VINE St.

There is a possibility that your application may be denied for one or more of the following reasons: The recommendation of the committee regarding the application shall be based on evidence presented at the hearing. Per MCO 85-2.7-4, probative evidence concerning whether or not a new license should be granted may be presented on the following subjects: whether or not the applicant meets the municipal requirements, the appropriateness of the location and premises where the licensed premises is to be located and whether use of the premises for the purposes or activities permitted by the license would tend to facilitate a public or private nuisance or create undesirable neighborhood problems such as disorderly patrons, unreasonably loud noise, litter, and excessive traffic and parking congestion. Probative evidence relating to these matters may be taken from the plan of operation submitted with the license application, if any, but shall not include the content of any music. Evidence regarding the fitness of the location of the premises to be maintained as the principal place of business, including but not limited to whether there is an overconcentration of businesses of the type for which the license is sought; whether the proposal is consistent with any pertinent neighborhood business or development plans, or the location's proximity to areas where children are typically present. The applicant's record in operating similarly licensed premises; and whether or not the applicant has been charged with or convicted of any felony, misdemeanor, municipal offense or other offense, the circumstances of which substantially relate to the activity to be permitted by the license being applied for or any other factor which reasonably relates to the public health, safety or welfare may also be considered. See attached police report or correspondence.

Notice for applicants with warrants or unpaid fines: Proof of warrant satisfaction or payment of fines must be submitted at the hearing on the above date and time. Failure to comply with this requirement may result in a delay of the granting/denial of your application.

Failure to appear at this meeting may result in the denial of your license. Individual applicants must appear only in person or by an attorney. Corporate or Limited Liability applicants must appear only by the agent designated on the application or by an attorney. Partnership applicants must appear by a partner listed on the application or by an attorney. If you wish to do so and at your own expense, you may be accompanied by an attorney of your choosing to represent you at this hearing.

You will be given an opportunity to speak on behalf of the application and to respond and challenge any charges or reasons given for the denial. No petitions can be accepted by the committee, unless the people who signed the petition are present at the committee hearing and willing to testify. You may present witnesses under oath and you may also confront and cross-examine opposing witnesses under oath. If you have difficulty with the English language, you should bring an interpreter with you, at your expense, so that you can answer questions and participate in your hearing.

You may examine the application file at this office during regular business hours prior to the hearing date. Inquiries regarding this matter may be directed to the person whose signature appears below.

Limited parking for persons attending meetings during normal business hours is available at reduced rates (5 hour limit) at the Milwaukee Center on the southwest corner of Kilbourn Avenue and Water Street. You must present a copy of the meeting notice to the parking cashier.

PLEASE NOTE: Upon reasonable notice, efforts will be made to accommodate the needs of disabled individuals through sign language interpreters or other auxiliary aids. For additional information or to request this service, contact the Council Services Division ADA Coordinator at (414) 286-2998, Fax - (414) 286-3456, TDD - (414) 286-2025.

JIM OWCZARSKI, CITY CLERK

BY: _____
Jim Cooney
License Division Manager

If you have questions regarding this notice, please contact the License Division at (414) 286-2238.

200 E. Wells Street, Room 105, City Hall, Milwaukee, WI 53202. www.milwaukee.gov/license
Phone: (414) 286-2238 Fax: (414) 286-3057 Email Address: License@milwaukee.gov

MILWAUKEE POLICE DEPARTMENT LICENSING

CRIMINAL RECORD/ORDINANCE VIOLATION/INCIDENTS SYNOPSIS

DATE: 02/28/26

LICENSE TYPE: AMALT

NEW:

RENEWAL:

No. 390651

Application Date:

License Location: 510 W Vine St

Business Name: Penny Saver

Licensee/Applicant: AZAAM, Nayef M
(Last Name, First Name, MI)

Date of Birth: 05/02/1990

Home Address: 3653 W College Av #51

City: Greenfield

State: WI Zip Code: 53221

Home Phone:

This report is written by Police Officer MONREAL, assigned to the License Investigation Unit, Days.

The Milwaukee Police Department's investigation regarding this application revealed the following:

1. On 11/13/2019 at 3:32am officers were dispatched to a hold up alarm. The officers checked the business and found no signs of entry. The officers contacted the manager, who stated the alarm has been malfunctioning lately.

=====

2. On 05/12/23 at 6:32p.m., Milwaukee Police were dispatched to a Gambling complaint at 510 W. Vine St. On arrival officers observed several subjects standing outside of the location standing in a semi-circle with money laying on the ground. One of the subjects was arrested for gambling and drug possession charges. The agent was not on scene; however, the officers interviewed the cashier regarding the violation. The cashier was not cooperative with the police and did not understand why the officers were there because the gambling outside had nothing to do with the store. The cashier further stated to the officer they would no longer call the police for issues at the store because it will make the store look bad and they didn't want to put the license at risk by calling the police. It should be noted the officer felt the cashier was nervous during the investigation and it appeared they did not want customers to hear them speaking with the officer.

3. On 05/22/23 at 12:28p.m., Milwaukee Police conducted a License Premise Check at 510 W. Vine St. This was in regard to complaints of loitering and possible drug dealing in the area. On arrival officers observed several occupied vehicles parked in front, however, a few of them did enter the store and came out with purchases. The officers spoke to the employee and advised them of the reason for the check. The employee stated they had been calling for loitering calls, however the police rarely showed up due to the priority of the call. The employee was encouraged to continue to call for police service. The employee did fill out a standing loitering complaint form and posted a provided no loitering sign.

=====

4. On 10/12/25 at 1:23p.m., Milwaukee Police spoke to the business regarding loitering. The officer advised the employee the owner should contact them to set up a meeting with the Alderperson and MPD, prior to the expiration of the License. The employee stated they do their best to combat loitering, however, it is not their responsibility once people move off their property.

=====

Item 4 added as PREVIOUS PREMISE

Date: 02/28/2026
Officer: P.O Nelson

City of Milwaukee Police Department
90-5-1.5 Crime Prevention Survey
Convenience Store/Liquor Store Inspection

Name of Premise: Penny Saver
Address: 510 W Vine Street

Phone: 414-241-4556
Owner: Amer Qadan
Owner address: 3509 W Layton Avenue
City State Zip: Milwaukee Wisconsin 53221
Owner Phone: 414-241-4556
Owner email: amer_qadan@yahoo.com

Manager: Khaled Qaadan
Home Address: 5618 S 29th St.
City State Zip: Milwaukee, WI 53221
Phone: 217-637-0802
Email: Khaledqaadan@yahoo.com

Preferred contact: Amer Qadan / 414-241-4556

Location currently open: YES NO

Projected open date: December

Day's open: S M T W Th F SA ALL

Hours of Operation: Sun: 9:00AM to 9:00PM 24 hours Y N
Mon: 9:00AM to 9:00PM
Tue: 9:00AM to 9:00PM
Wed: 9:00AM to 9:00PM
Thu: 9:00AM to 9:00PM
Fri: 9:00AM to 9:00PM
Sat: 9:00AM to 9:00PM

Premise Type: Liquor Store
Convenience Store
Other: Beer

Licenses currently held:

- Alcohol: Yes No Class: #:
Tobacco: Yes No #:
Food: Yes No #:
Extended Hours: Yes No #:
Secondhand Dealer: Yes No Type: #:
Other: Yes No Type: #:
Other: Yes No Type: #:

Exterior Survey:

1. Is the area around the location clean? Yes No
2. What surrounds the location? (Check all the apply)
 - a. Park
 - b. School
 - c. Youth Center
 - d. Church
 - e. Tavern(s) If so, how many
 - f. Residential
 - g. Other businesses
 - h. Other:
3. Can you see from the outside of the location into the interior Yes No
4. Can you see the employees inside of the location from the outside Yes No
5. Are exterior windows free of signage Yes No
6. Is there a parking lot Yes No
7. Is the parking lot clean? Yes No
8. Is the parking lot well lit? Yes No
9. Are there areas where a person could conceal themselves Yes No
10. Is there exterior lighting? Yes No. Does it appears to be adequate Yes No
(UNSURE OF LIGHTING, CEPTED PERFORMED IN DAY TIME)
11. Exterior Payphone? Yes No
12. Are there No Loitering Signs posted? Yes No
13. Are there exterior security cameras Yes No How Many: 3
14. Are the address numbers prominently displayed and easy to see Yes No

Camera Survey:

15. Does this location have security cameras? Yes No
16. Are they in working order? Yes No
17. What format are the cameras?
 - a. Color Yes No
 - b. Digital Yes No
 - c. VCR Yes No
 - d. Recorded Yes No
18. How long is footage stored for later viewing: 30 days or more
19. Are there exterior cameras Yes No How many: 3
20. Are there interior cameras Yes No How many: 7 (2 MORE TO BE ADDED)
21. Do all employees know how to retrieve recorded digital images/footage? Yes No

Interior Survey:

22. Is the storeowner willing to be a standing complainant regarding loitering? Yes No
a. If yes have them fill out the standing complaint form and give them two of the commercial signs Yes No
23. Is the interior of the location neat and clean? Yes No
24. Does an interior camera face the entrance/exit? Yes No
25. Is there a lockable area that separates employees from customers? Yes No
26. Does the store sell single chore boy? Yes No
27. Does the store sell blunt wraps? Yes No
28. Does the store sell scales? Yes No
29. Does the store sell items that may be used as crack pipes? Yes No
a. Describe item
30. Does the store have an over abundance of sandwich baggies: Yes No
31. Does the owner understand that these items are often used for drug use? Yes No
32. Do the products in the store appear to be new and rotated often? Yes No
33. Are emergency and non-emergency numbers posted near the phone? Yes No
34. Does the owner know how to contact their police district directly? Yes No
a. Did you provide a district contact guide to the owner? Yes No

Complete this section if alcohol establishment is a convenience store:

(** Read full ordinance for all details "68-4.3 Convenience Food Stores")

All convenience food stores not exempted under sub. 3 shall:

1. Is the cash register located in a manner so that at the time of a sales transaction, the employee and customer are both visible from the sidewalk? Yes No ** (SIGNAGE IN THE WINDOW/GLASS DOOR)
2. Are the glass entrance and exit doors clear of any signs or advertisements with the exception of a sign which states that the cash register contains \$50 or less and that the safe is no accessible to employees? Yes No
3. Does the store maintain one of the following on the licensed premise:
 - a. A safe that was in use at the convenience food store on August 17, 1994? Yes No
 - b. A drop-safe or time release safe that weighs at least 500 pounds or which is attached to or set into the floor in a manner approved by the police department? Yes No
4. Is lighting provided for the store's parking area during all hours of darkness when employees or customers are on the premises at a minimum average of 2-foot candles per square foot, unless the store is not open for business after sunset and before sunrise? Yes No N/A
5. Are at least two high-resolution surveillance security cameras installed? Yes No
6. Are the security cameras in working order? Yes No
7. Does one camera show an overall view of the counter and register area? Yes No
8. Does one camera show a clear, identifiable, full frame image of the face of each person entering and leaving the store? Yes No
9. Are the camera views obstructed by fixtures or displays? Yes No
10. Is the recorded footage stored for at least 30 days? Yes No

11. Do all store employees know how to record footage from the camera system to media capable of being transferred to police custody? Yes No
12. Are customer entrances/exits made of glass or other transparent material? Yes No
 a. Exception: A store that does not have such doors on August 17, 1994 shall not be required to install such doors until the holder of the store's food dealer license changes.
13. Has the owner and their employees attended the Robbery Prevention Training within 120 days of ownership or employment? Yes No
 a. Contact Community Outreach and Education at 935-7836 for schedule.

Sub 3. Exemptions. The requirements of this section do not apply to a convenience food store that conforms to either of the following descriptions:

- a-1. The store is located in an enclosed shopping structure, enclosed commercial building or hospital. A convenience food store is not in an enclosed structure or building if a customer can enter it directly from the outside.
 Does store conform to a-1 Yes No
- a-2. The store physically separates employees from customers with a solid partition that bars a person from entering the employee area from the customer area, has a secure lock on the employee side of any door between the employee area and the customer, and conducts all transaction through a service window or similar arrangement.
 Does store conform to a-2 Yes No
- a. At the commissioner's discretion, a convenience store may be exempted from any or all of the regulations specified in sub 2.
 Does this location hold an exemption from the commissioner regarding any of the requirements of Sub 2? Yes No

ADDITIONAL COMMENTS/RECOMMENDATIONS:

- Recommended to attend local block watch meeting
- Attend District 5 Crime and Safety meeting
- The kitchen area has a place where a person could conceal themselves, however the owner stated he will be installing more cameras.
- Recommended to install fusus

 **City of Milwaukee** Concentration Map - 510 W VINE ST

Area of Interest (AOI) Information

Area : 21,862,585.72 ft²

Feb 24 2026 15:10:12 Central Standard Time

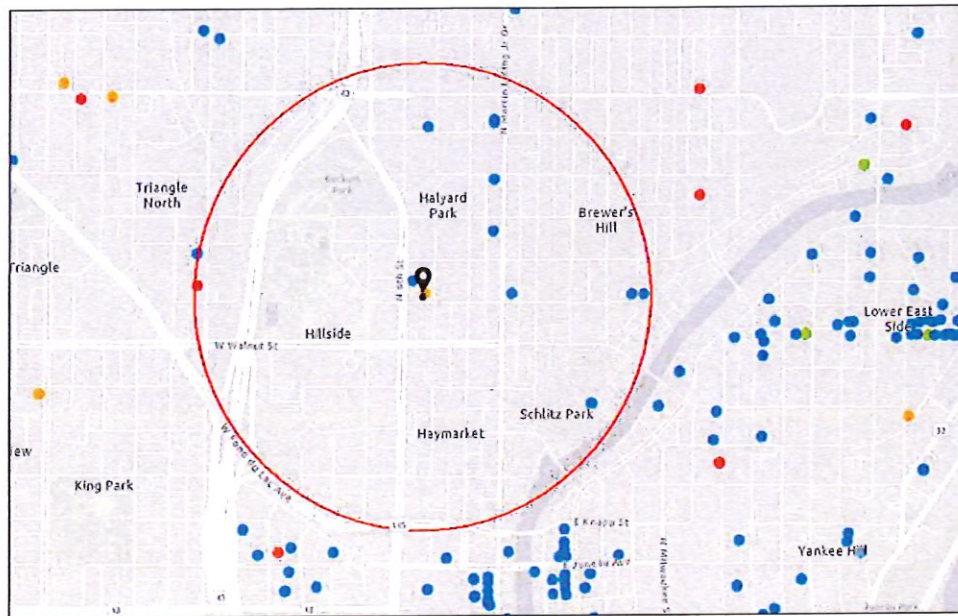

Alcohol Licenses (active)	Class B Fermented Malt Beverage	Class C Wine Retailer	<p>1:18,056 0 0.1 0.2 0.4 mi 0 0.17 0.35 0.7 km SOURCE: Esri, DeLorme, GeoEye, (RC), NAIP, IGN, USDA, © GeoEye/Geo</p>
Class A Fermented Malt Beverage	Class B Tavern	City Limits	
Class A Liquor and Malt			

Summary

Name	Count	Area(ft ²)	Length(mi)
Alcohol Licenses	13		

Alcohol Licenses

#	Legal Entity	Trade Name	Licensee	Address	License Type Name	Total Capacity	Expiration Date	Count
1	Niche Book Bar LLC	Niche Book Bar	Cetonia P Weston-Roy, Agt	1937 N Martin L King Jr DR	Class B Tavern License	40	4/6/2026, 7:00 PM	1
2	PRIMETIME EVENTS LLC	The Tap Yard-Schlitz Park/The Tap Yard-Milwaukee	Nicholas E Marking, Agt	1555 N RIVERCENTE R DR	Class B Fermented Malt Beverage Retailer's License		5/11/2026, 7:00 PM	1
3	Wisconsin Liquor & Food, Inc	ABC Beer & Liquor Depot II	NAVDIP KAUR, Agt	1819 N 12th ST	Class A Malt & Class A Liquor License		5/17/2026, 7:00 PM	1
4	Pepperpot on MLK, LLC	Pepperpot on MLK	Dwight A Jackson, Agt	2215 N MARTIN L KING JR DR	Class B Tavern License		6/1/2026, 7:00 PM	1
5	PRIMETIME EVENTS LLC	The Tap Yard-Schlitz Park/The Tap Yard-Milwaukee	Nicholas E Marking, Agt	1555 N RIVERCENTE R DR	Class B Tavern License		7/29/2026, 7:00 PM	1
6	Mai Bar LLC	Mai Bar	Kevin D Perkins, Agt	1840 N 6th ST	Class B Tavern License		7/29/2026, 7:00 PM	1
7	KISMET ACTIVATIONS LLC	Summer of '85	Julie Lukas, Agt	2213 N MARTIN L KING JR DR	Class B Tavern License		8/25/2026, 7:00 PM	1
8	MLK Dream MKE, LLC	Dream Lounge Social	Amy R Tucker, Agt	1806 N MARTIN L KING JR DR	Class B Tavern License		9/15/2026, 7:00 PM	1
9	AVLI MILWAUKEE LLC	AVLI INSPIRED GREEK	Robert E Case, Agt	1818 N HUBBARD ST	Class B Tavern License		10/12/2026, 7:00 PM	1
10	CURRIE & SONS LLC	Jewel's 502	Nicole L Robbins, Agt	502 W GARFIELD AV	Class B Tavern License		10/19/2026, 7:00 PM	1
11	Penny Saver, LLC	Penny Saver	Nayef M Azzam, Agt	510 W VINE ST	Class A Fermented Malt Beverage Retailer's License		11/20/2026, 6:00 PM	1
12	BRONZEVILLE KITCHEN & LOUNGE LLC	BRONZEVILLE KITCHEN & LOUNGE	Shana M Green, Agt	2053 N MARTIN L KING JR DR	Class B Tavern License		1/14/2027, 6:00 PM	1
13	Uncle Wolfie's Breakfast Tavern LLC	Uncle Wolfie's Breakfast Tavern	Matthew A Schaefer, Agt	234 E Vine ST	Class B Tavern License		1/19/2027, 6:00 PM	1

Establishments within a 0.5 miles radius centered on area of interest.



Tuesday, May 05, 2026



Notice of Public Hearing

Blank Notice

QADAN, Amer S, Agent
Penny Saver at 510 W VINE St
Class A Fermented Malt, Food Dealer and Weights & Measures Licenses Application

Tuesday, May 19, 2026 at 1:05 PM

To whom it may concern:

The above application has been made by the above named applicant(s). This requires approval from the Licenses Committee and the Common Council of the City of Milwaukee. The hearing before the Licenses Committee will take place on 5/19/2026 at 1:05 PM in Room 301-B, Third Floor, City Hall. This is a public hearing. Those wishing to view the proceeding are able to do so via the City Channel – Channel 25 on Spectrum Cable – or on the Internet at <http://city.milwaukee.gov/citychannel>. Those wishing to provide oral testimony via internet are asked to contact the staff assistant, Yadira Melendez at (414) 286-2775 or stasst5@milwaukee.gov for necessary information. Please make such requests no later than one business day prior to the start of the meeting. You are not required to attend the hearing, but please see the information below if you would like to provide testimony. Once the Licenses Committee makes its recommendation, this recommendation is forwarded to the full Common Council for approval at its next regularly scheduled hearing.

Important details for those wishing to provide information for the Licenses Committee to consider when making its recommendation:

1. The license application is scheduled to be heard at the above time. Due to other hearings running longer than scheduled, you may have to wait some time to provide your testimony.
2. You must appear in person and testify as to matters that you have personally experienced or seen. (You cannot provide testimony for your neighbor, parent or anyone else; this is considered hearsay and cannot be considered by the committee.)
3. No letters or petitions can be accepted by the committee (unless the person who wrote the letter or the persons who signed the petition are present at the committee hearing and willing to testify).
4. Persons opposed to the license application are given the opportunity to testify first; supporters may testify after the opponents have finished.
5. When you are called to testify, you will be sworn in and asked to give your name, and address. (If your first and/or last names are uncommon please spell them.)
6. You may then provide testimony.
 - a. Include only information relating to the above license application.
 - b. Include only information you have personally witnessed or seen.
 - c. Provide concise and relevant information detailing how this business has affected or may affect the peaceful enjoyment of your neighborhood.
 - d. If by the time you have the opportunity to testify, the information you wish to share has already been provided to the committee, you may state that you agree with the previous testimony. Redundant or repetitive testimony will not assist the committee in making its recommendation.
7. After giving your testimony, the members of the Licenses Committee and the licensee may ask questions regarding the testimony you have given or other factors relating to the license application.
8. Business Competition is not a valid basis for denial or non-renewal of a license.
Please Note: If you have submitted an objection to the above application your objection cannot be considered by the committee unless you personally testify at the hearing.

CURRENT OCCUPANT	506 W WALNUT ST# 313	MILWAUKEE, WI 53212-1204
CURRENT OCCUPANT	506 W WALNUT ST# 314	MILWAUKEE, WI 53212-1204
CURRENT OCCUPANT	506 W WALNUT ST# 402	MILWAUKEE, WI 53212-1204
CURRENT OCCUPANT	506 W WALNUT ST# 403	MILWAUKEE, WI 53212-1204
CURRENT OCCUPANT	506 W WALNUT ST# 404	MILWAUKEE, WI 53212-1204
CURRENT OCCUPANT	506 W WALNUT ST# 405	MILWAUKEE, WI 53212-1204
CURRENT OCCUPANT	506 W WALNUT ST# 406	MILWAUKEE, WI 53212-1204
CURRENT OCCUPANT	506 W WALNUT ST# 407	MILWAUKEE, WI 53212-1204
CURRENT OCCUPANT	506 W WALNUT ST# 408	MILWAUKEE, WI 53212-1204
CURRENT OCCUPANT	506 W WALNUT ST# 409	MILWAUKEE, WI 53212-1204
CURRENT OCCUPANT	506 W WALNUT ST# 410	MILWAUKEE, WI 53212-1204
CURRENT OCCUPANT	506 W WALNUT ST# 411	MILWAUKEE, WI 53212-1204
CURRENT OCCUPANT	506 W WALNUT ST# 412	MILWAUKEE, WI 53212-1204
CURRENT OCCUPANT	506 W WALNUT ST# 413	MILWAUKEE, WI 53212-1204
CURRENT OCCUPANT	506 W WALNUT ST# 414	MILWAUKEE, WI 53212-1204
CURRENT OCCUPANT	510A W VINE ST	MILWAUKEE, WI 53212-3637
CURRENT OCCUPANT	511 W RESERVOIR AVE	MILWAUKEE, WI 53212-3634
CURRENT OCCUPANT	513 W RESERVOIR AVE	MILWAUKEE, WI 53212-3634
CURRENT OCCUPANT	515 W RESERVOIR AVE	MILWAUKEE, WI 53212-3634
CURRENT OCCUPANT	516 W VINE ST	MILWAUKEE, WI 53212-3637
CURRENT OCCUPANT	518 W VINE ST	MILWAUKEE, WI 53212-3637
CURRENT OCCUPANT	518A W VINE ST	MILWAUKEE, WI 53212-3637

Blank Notice

Total Records: 115

Radius 250 feet and Center of the Circle: 510 W Vine St



BUSINESS LICENSE PLAN OF OPERATION

ccl-busplan 5/12/2020

Office of the City Clerk License Division
200 E. Wells St. Room 105, Milwaukee, WI 53202
(414) 286-2238 www.milwaukee.gov/license e-mail address: license@milwaukee.gov

1. Type of Business

- Applying for: Extended Hours (12AM to 5AM) - If a food establishment, check all that apply: Delivery Drive Thru Dining Room
 Self Service Laundry Massage Establishment Filling Station
 Other (supplemental application for specific license also required)

Provide a detailed description of the type of business you plan on operating:

Grocery Store

Do you have any experience operating this type of business? No Yes If yes, explain: 1 own multiple stores

2. Business Operations

- a. Proposed Opening Date: 2/15/2026
b. Is this premise under construction? No Yes If yes, list estimated completion date: _____
c. Is this a franchise? No Yes
d. Is this premises currently licensed? No Yes If yes, list type of license: Food license
e. Is the current licensee operating? No Yes If no, list date closed: _____
f. Do you have future plans for other businesses, licenses or permits at this location? No Yes
If yes, explain: _____
g. Have you previously held an Extended Hours License in Milwaukee? No Yes
If yes, list address(es): _____
h. Are other businesses operating in the same building? No Yes If yes, describe: _____

3. Litter & Noise

- a. How are grounds kept clean? Sweep Pressure Wash Pick Up Litter Other: _____
b. How often will grounds be cleaned? Daily Weekly As Needed Monthly Other: _____
c. Grounds cleaned by: Licensee Building Owner Employees Hired Maintenance Other: _____
d. How are noise issues prevented and/or addressed? Security Manager approaches customer(s) Call Police
 Signs Posted Other: _____
e. Will a sound amplification system be used? No Yes If yes, describe: _____

4. Smoking & Sanitation

- a. Are there designated outdoor smoking areas? No Yes If yes, describe: _____
b. Number of Garbage Cans: Inside: 2 Locations: By cash Register and 1 in the Restroom
Outside: 1 Locations: By the entrance
c. Is a crowd control barrier used? No Yes If yes, describe: _____
d. How many restrooms are on the premises? 1
e. Name of solid waste contractor: Advanced Disposal Waste Management Other: _____

5. Security

- a. Are there onsite parking spaces? No Yes If yes, how many? _____ and describe the parking security plan: _____
- b. Is there a loading zone? No Yes If yes, describe the loading area security plan: _____
- c. Will you have licensed security on premise? No Yes If yes, how many? _____ and answer the following:
 What are their responsibilities? _____
 Describe equipment used _____
 List their License Number (s) _____
- d. Will there be security cameras? No Yes If yes, how many? 12 and list locations: 3 outside By the entrance & 9 inside the premises between the aisles and by the Cash Register
- e. Will searches/identification checks be done upon entry? No Yes If yes, describe _____

6. Percentage of Sales (must total 100%)

Alcohol <u>22</u> %	Food <u>54</u> % Cigarettes, Electronic Vape Devices, Tobacco Products	Secondhand Merchandise <u>7</u> %	Precious Metals & Gems <u>7</u> %
Entertainment _____ %	Tobacco Products <u>5</u> %	Personal Services (such as tattoo, body piercing, salon, tailor, tanning, etc.) _____ %	Household Products Other <u>19</u> %
Pawnbroker Activity <u>7</u> %	Salvaged Materials (such as scrap metal) _____ %		Describe: _____

7. Businesses/Licenses on the Premises (check all that apply):

Type 1

- Full Service Restaurant Cafe/Coffee Shop Deli or Fast Food Restaurant Private/Fraternal/Veterans Club
- Night Club Tavern Cocktail Lounge Teen Club
- Banquet Hall Sports Facility Bowling Alley
- Hotel/Motel: Number of Floors: _____ Number of Rooms: _____
 Rooming House: Number of Floors: _____ Number of Rooms: _____

Type 2

- Liquor Store Corner Store Supermarket Convenience Store
- Gas Station Amusement/Phonograph Distributor Recycling, Salvage or Towing
- Used Car Dealer Personal Service Establishment (such as tattoo business, hair salon, tailor, etc.) Recording Studio

What other licenses/permits will you hold at this location? (check all that apply)

- Occupancy Permit Cigarette, Tobacco, Electronic Vape Products Gas Station Extended Hours Class "B" Tavern Weights & Measures
- Secondhand Dealer Precious Metal & Gem Other: Food

8. Legal Capacity (only if a Type 1 premises in #7 above)

Capacity _____ (Call the Milwaukee Development Center at 414-286-8211 if you have questions.)

9. Premises Description

a. Identify all area(s) of the premises that will be used in operating this business (include areas used only for storage):
 1st Floor 2nd Floor Basement Storage Patio Beer Garden Sidewalk Café Deck Rooftop

Other: Describe: _____

b. Describe Location: Major Thoroughfare Secondary Street Other: _____

c. Nearest Major Cross Street: W Vine St.

d. Describe Building: Free Standing Building Strip Mall Other: _____

e. Describe Premises Structure: Single Story Multi-Story - # of Stories _____ Other: _____

f. Describe Surrounding Area: Commercial Residential Industrial Other: _____

g. Building Owner Name: Suhair Abdullah Phone Number: (414) 305 9687

Building Owner Address: 2020 W Layton Ave. Milwaukee, WI 53221

10. Hours of Operation & Customers

Will customers be entering the premises? No Yes

Day of the Week	Proposed Hours of Operation:		Estimated Number of Customers expected each day	Potential Age Range of Customers	Class B Tavern Applicant Only: Age Restriction (If none, write 'None')
	Open Time (include a.m. or p.m.)	Close Time (Include a.m. or p.m.)			
Sunday	9:00 am	9:00 pm	100-150	+15	
Monday	9:00 am	9:00 pm	75-125	+15	
Tuesday	9:00 am	9:00 pm	75-125	+15	
Wednesday	9:00 am	9:00 pm	75-125	+15	
Thursday	9:00 am	9:00 pm	75-125	+15	
Friday	9:00 am	9:00 pm	100-150	+15	
Saturday	9:00 am	9:00 pm	100-150	+15	

An Extended Hours Establishment License is required for any convenience store, filling station, personal service establishment (such as tattoo, body piercing, salon, tailor, tanning, etc.), recording studio or restaurant which is open between the hours of 12:00 a.m. and 5:00 a.m.

Alcohol Establishments: Class A: 8:00 am to 9:00 pm Sunday thru Saturday
 Permitted Hours of Operation: Class B: 6:00 am to 2:00 am Sunday thru Thursday, 6:00 am to 2:30 am Friday & Saturday

Entertainment Outdoor Closing Hours: 10:00pm Sunday-Thursday; 12:00am Friday & Saturday; unless a different time, either earlier or later, is established by the Common Council in its approval of the licensee's plan of operation.

11. Signature(s)

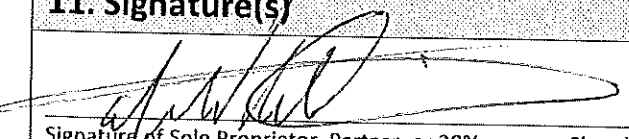
 Signature of Sole Proprietor, Partner, or 20% or more Shareholder
 (If there are no 20% or more shareholders,
 Corporate Officer-print name/title and sign)

 Signature of additional partner or 20% or more shareholder

See Application Information for a complete list of all required application forms.



ALCOHOL BEVERAGE & PUBLIC ENTERTAINMENT PREMISES SUPPLEMENTAL APPLICATION

Office of the City Clerk License Division
200 E. Wells St. Room 105, Milwaukee, WI 53202
(414) 286-2238 e-mail address: license@milwaukee.gov www.milwaukee.gov/license

Legal Entity Name: Madam City LLC

Premise Address: 510 W Vine St, Milwaukee, WI 53212

Proximity of Premises to Church, School, Daycare Center or Hospital

Is the building within 300 feet of any church, school, daycare center or hospital? No Yes

"Service Bar Only" Designation

If applying for Class B or C license, are you applying for "Service Bar Only"? No Yes
Service Bar Only means customers cannot sit at the bar. Alcohol is served to employees who serve patrons seated at tables. No stools, chairs or other articles of furniture shall be placed at the service bar for patrons to sit upon.

Business Information

a) Are you taking out this application for anyone that may not be eligible for a license? No Yes
If yes, list their name and address: _____

b) Will the agent, a partner or the individual licensee be conducting the day-to-day operations of the business? No Yes
If no, list the name and address of the person(s) who will: _____

Class B Applicants: If the agent, a partner or the individual licensee will not be conducting the day-to-day operations of the business, the person(s) listed above must obtain a Class B Managers license.

c) Does anyone else have money invested or any other interest in this business? No Yes
If yes, explain: _____

d) Have you made an agreement with anyone to repay any loan or any other payments based upon income from the business? No Yes If yes, list name and address: _____

Property Information (New & Transfer Applicants Only)

a) Do you own or lease the building? Own Lease

b) Who owns the fixtures (for example, coolers, etc.)? Tenant/Leasee

c) Are you purchasing the stock and/or fixtures? No Yes If yes, amount paid \$ _____

d) Total amount paid for business \$ 15,000

e) Total amount paid for goodwill of the business \$ 10,000

Goodwill comprises the reputation and customer relationships of an existing business. If the price you pay for the business exceeds the fair market value of all of the rest of the assets of the business, the excess may be considered goodwill.

Form Continues on next page →

Lease Information (New & Transfer Applicants who are leasing the premises only)

- a) Date lease begins 2/10/2026 Ends 2/09/2029
- b) Monthly rental \$2500
- c) Do you have an option to renew the lease? No Yes
- d) Does your lease allow for assignment to another party without the consent of the owner? No Yes
- e) For what length of time have you been guaranteed occupancy (number of years)? Continued
- f) In addition to paying the monthly rental, will you have to pay anything additional to the owner of the building to guarantee performance of the lease? No Yes If yes, explain _____
- g) Does the present owner or occupancy object to the granting of your license? No Yes
If yes, explain _____

Change of Agent Applicants Only

- Have there been any changes to the floor plan since the last application was submitted? No Yes
If no, a new floor plan is not required. If yes, submit a new floor plan and explain the change(s): _____

Responsible Beverage Server Training

- a) Within the last 2 years have you held a bartender's license in the state of Wisconsin? No Yes
- b) Within the last 2 years have you held a Class "A" or Class "B" alcohol beverage license, or a Class "B" manager's license in the state of Wisconsin? No Yes
- c) Within the last 2 years have you completed a Responsible Beverage Server Training Course in the state of Wisconsin? No Yes

If you answered no to all the above questions, proof of course completion must be provided by submitting your course certificate to the License Division.

For Course enrollment information, contact MATC at (414) 297-8370 or for similar approved courses see "Training" on the Wisconsin Department of Revenue's Website (<https://www.revenue.wi.gov/Pages/Training/alcSellerServer.aspx>)

I understand that a license will not be issued without a copy of the course certificate or proof of the license held within the last two years being submitted to the License Division.

Amye Qadan

Print Name of Individual/Partner/Agent

[Signature]

Signature of Individual/Partner/Agent

Signature

[Signature]
Signature of Sole Proprietor, Partner or 20% or More Shareholder
(If no 20% or more Shareholder, Corporate Officer - print name/title and sign)

Note: All information contained in this application is subject to approval by the Common Council.
Deviating from approved plan of operation will subject licensee to citations, and/or suspension or non-renewal of the license.
Contact the License Division for information on how to request changes.

New and transfer of premises applicants must submit the following:

- Detailed floor plan
- If a restaurant, copy of the menu



FOOD DEALER LICENSE PLAN OF OPERATION

ccl-foodplan 1/1/2026

OFFICE OF THE CITY CLERK, LICENSE DIVISION
CITY HALL, 200 E. WELLS ST, ROOM 105, MILWAUKEE, WI 53202
(414) 286-2238 • license@milwaukee.gov • www.milwaukee.gov/license

Legal Entity Name:

Clacku Certy LLC

Premises Address:

510 W Vine St. Milwaukee, WI 53212

SECTION 1 TYPE OF BUSINESS

What will be the majority of your food sales? (check one)

Restaurant Items (meals):

MEALS include, but are not limited to, chicken, ribs, sandwiches, roasted corn, baked potatoes, hot dogs, brats, tacos, nachos w/ cheese and meat, French fries, cooked or deep fried vegetables/fruit, cooked cheese curds, corn dogs, egg rolls, salads.

Retail Items (snacks and beverages):

RETAIL items include, but are not limited to, ice cream/soft serve, lemonade, snow cones, coffee, espresso, cappuccino, tea, fruit juice, smoothies, candy, dispensed soda, fruit cups, bakery, cookies, kettle corn, cotton candy, funnel cakes, fritters, tortilla chips w/ cheese.

Will it be a convenience store? Yes No

A convenience store contains less than 7,500 square feet of retail space and has, as its primary business, the sale of basic food items and in addition, sells household products or is a filling station that sells basic food items and household products.

Bed & Breakfast

Micro Market

All Applicants: Submit a menu or a list of food items that will be sold.

Will any wholesale business be done? No Yes If yes, what percentage of food sales will be wholesale?

Less than 25%

25% or More AND:

Restaurant items (meals) will be sold – Complete this application and also contact DATCP.

NO restaurant items (meals) will be sold - Do NOT complete this application. Contact DATCP only.

SECTION 2 FOOD PROCESSING

Will any food processing be done? No Yes

Processing is defined as assembling, grinding, cutting, mixing, baking, coating, stuffing, packing, bottling, grilling, canning, extracting, fermenting, distilling, pickling, freezing, drying, smoking, or packaging.

SECTION 3 FOOD REQUIRING TEMPERATURE CONTROL

Will any food that requires temperature control be sold? No Yes
(includes dairy products such as milk, cheese, and ice cream, fish, shellfish, meat, poultry)

If yes, list the types of food items:

Meat - egg - milk - chicken - cheese

SECTION 4 DETAILS OF OPERATION

- Will you have seating on site for dining? No Yes
- Will you be doing any catering? No Yes
- Will you be doing any delivery? No Yes
- Will you have outdoor activities? No Yes - Check all that apply: Bar Cooking/Grilling Dining
- Will you have a drive thru window? No Yes - Are hours different from inside? No Yes
 If Yes, provide drive thru hours: _____
- Will scales or barcode scanners be used? No Yes - You must also apply for a Weights & Measures License.

SECTION 5 ADDITIONAL SITES

- Where will food be prepared and/or sold?
 At a single site At multiple sites: How many? _____ (for example, a hotel with several dining rooms or bars)
 If multiple sites, attach a Food Dealer Additional Site Addendum (ccl-foodadd) for each additional site.

SECTION 6 CONSTRUCTION OR CHANGES

- Are you planning any construction, remodeling or equipment changes?
 No If No, SKIP to Section 8
 Yes If Yes, check all that apply: New construction of a building Renovation or remodeling
 Construction changes to existing building Equipment changes only
- Provide a brief description of the changes: _____
- Start date: _____
- Name, Address & Phone Number of Architect: _____

- Name, Address & Phone Number of Contractor: _____

SECTION 7 ALCOHOL BEVERAGES

- Are you applying for an alcohol beverage license?
 No If No, SKIP to Section 9
 Yes If YES, if your food license is approved prior to the alcohol license, when do you want the food license issued?
 Immediately At the same time as the alcohol license

SECTION 8 ACKNOWLEDGEMENTS & SIGNATURE

You must initial each item confirming your understanding:

- AG I understand the Health Department must conduct an inspection and advise the License Division of their approval before the license may be issued.
- AG I understand I must obtain an occupancy permit from the Department of Neighborhood Services and an inspection may be required. Neighborhood Services must advise the License Division of their approval before the license may be issued.
- AG I understand the district alderperson will review and either support or object to my application. If he/she objects, I may appeal and be scheduled to appear before the Licenses Committee. The Licenses Committee will then make a recommendation to the Common Council. The Common Council must grant the license before it may be issued.
- AG I understand proof of payment for all license fees must be on file in the License Division before the license may be issued and the license must be issued and posted in my establishment prior to opening for business.
- AG I will not operate my food business until the license has been issued and posted in the establishment.

Signature of Sole Proprietor, Partner, or 20% Shareholder: 

Signature of Additional Partner: _____



**WEIGHTS & MEASURES LICENSE
SUPPLEMENTAL APPLICATION**

OFFICE OF THE CITY CLERK, LICENSE DIVISION
CITY HALL, 200 E. WELLS ST, ROOM 105, MILWAUKEE, WI 53202
(414) 286-2238 • license@milwaukee.gov • www.milwaukee.gov/license

Office Use Only:

App# _____
Filed _____
Initials _____
Paid _____
Lic # _____

Legal Entity Name: Wadaw City LLC

Premise Address: 310 W Vine St - Milwaukee WI 53212

Device Type(s)

- Check all device types for which you need a license.
- For each device type checked, indicate how many you have in the Number of Devices column (b).
- Calculate the Total Fee Per Device Type by multiplying the Fee Per Device Type (a) by the Number of Devices (b).
- Add all Total Fee Per Device Type amounts together and that will be your Total Fee Due.
- * **Exception:** The Scanner fee is not per device. Check the box for the appropriate range.
If you have 1-3 scanners, the total due is \$130. If you have 4 or more scanners, the total due is \$250.
Check the Number of Devices (b).

Device Type	License Period	Fee Per Device Type (a)	Number of Devices (b)	Total Fee Per Device Type (a x b)
Liquid Measuring Devices				
<input type="checkbox"/> Retail Petroleum Meters	12 months	\$60		
<input type="checkbox"/> 0 to 30 gallons per minute	24 months	\$60		
<input type="checkbox"/> 31 to 200 gallons per minute	24 months	\$250		
<input type="checkbox"/> Over 200 gallons per minute	24 months	\$250		
Scales				
<input checked="" type="checkbox"/> Measuring any weight amount	24 months	\$55		
Scanners				
		Fee for scanners by range	Check how many scanners you have	
<input type="checkbox"/> Up to 3 scanners	24 months	\$130 total*	<input type="checkbox"/> 1 <input type="checkbox"/> 2 <input type="checkbox"/> 3	
<input type="checkbox"/> Four or more scanners	24 months	\$250 total*	<input type="checkbox"/> 4 <input type="checkbox"/> Other _____	
Other Devices				
<input type="checkbox"/> Length Measuring Device	24 months	\$60		
<input type="checkbox"/> Timing Device	24 months	\$30		

Total Fee Due 55.00

Signature

I hereby agree that I will comply with the applicable sections of the Wisconsin State Statutes, Administrative Code and the Milwaukee Code of Ordinances regarding the operation of weighing and measuring devices.

I understand that all devices must be operated within the specifications, tolerances and other technical requirements set forth in the National Institute of Standards and Technology Handbook 44. I understand that the license for which I am applying must be posted on the premises or in my vehicle prior to opening for business or operating the device.

I understand that these device licenses are not transferable (with the exception of scanners). If the device is replaced or needs to be resealed, I must apply for and receive a new license so that an inspection of the device can be performed prior to its use.

I acknowledge that as a condition of being issued this license, I must allow the Health Department into the establishment to test the device to validate its specifications/tolerances. If my devices are found out of compliance, I may be charged inspection fees.

I have read, understand, and will adhere to all the above acknowledgments.

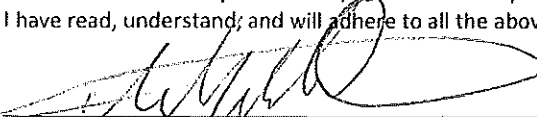
Signature of Sole Proprietor, Partner, or 20% or more Shareholder
(If there are no 20% or more shareholders,
Corporate Officer-print name/title and sign)

Signature of additional partner or 20% or more shareholder

This form must be submitted with the Business License Application, Weights & Measures Plan of Operation, and appropriate fee. Forms can be obtained online at www.milwaukee.gov/licenses.



WEIGHTS & MEASURES PLAN OF OPERATION

ccl-wmplan 1/9/18

Office of the City Clerk License Division
200 E. Wells St. Room 105, Milwaukee, WI 53202
(414) 286-2238 www.milwaukee.gov/license license@milwaukee.gov

Legal Entity Name: Quadam City LLC

Premise Address: 510 W Vine St. Milwaukee, WI 53212

Type of Business

Provide a brief description of the establishment/business:

Grocery Store

Other licenses may be required depending on the type of business you are operating.

Food / Tobacco / Weight and Measures

Litter & Noise

- a. How are grounds kept clean? Sweep Pressure Wash Pick Up Litter Other: _____
- b. How often will grounds be cleaned? Daily Weekly As Needed Monthly Other: _____
- c. Grounds cleaned by: Licensee Building Owner Employees Hired Maintenance Other: _____
- d. How are noise issues prevented and/or addressed? Security Manager approaches customer(s) Call Police
 Signs Posted Other: _____

Signature

Signature of Sole Proprietor, Partner, or 20% or more Shareholder
(If there are no 20% or more shareholders,
Corporate Officer-print name/title and sign)

Signature of additional partner or 20% or more shareholder

This form must be submitted with the Business License Application, Weights & Measures License Supplemental Application, and appropriate fee. Forms can be obtained online at www.milwaukee.gov/licenses.

- ① Front Door
- ② Windows
- ③ To Door cooler
- ④ Shelving
- ⑤ Doors
- ⑥ Grease
- ⑦ Cash Register
- ⑧ ATM
- ⑨ Map sink
- ⑩ Hand sink
- ⑪ Compartment sink
- ⑫ Worktop/meat sliced
- ⑬ Trays/cans
- ⑭ Deli cooler

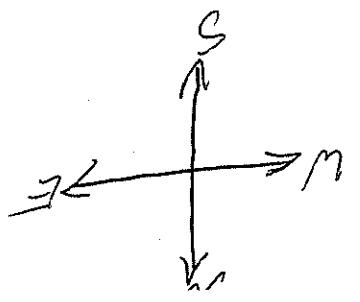
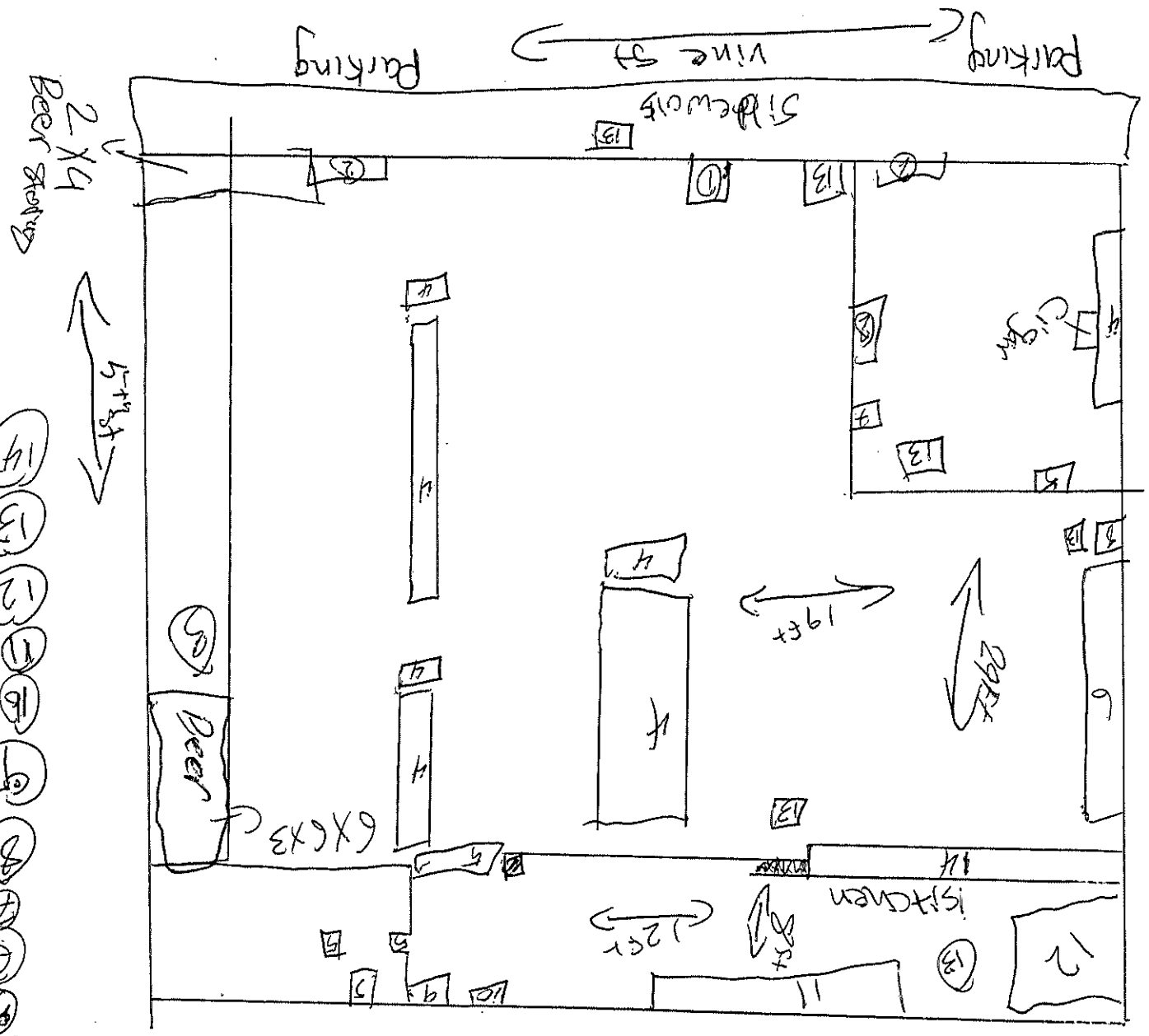

WADAN CITY LLC
 DBA Penny Saver
 570 W Vine St
 Milwaukee, WI 53212
 19ft Amer's Garden

$$\begin{array}{r}
 2711 \times 19ft = 5511ft \\
 12ft \times 8ft = 96ft \\
 \hline
 6477ft
 \end{array}$$

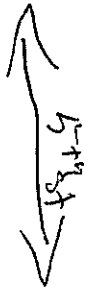
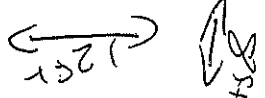
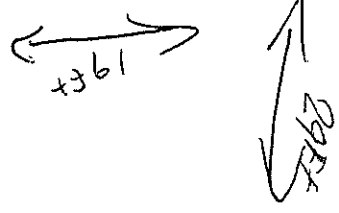

2 X 4
 Beer Storage

Parking
 Vine St

Silbeuols

Cigar

Kitchen

Beer

6 X 6 X 3

6

12

6477ft

$$\begin{array}{r}
 5511ft \\
 96ft \\
 \hline
 6477ft
 \end{array}$$