



PETITION FOR A SPECIAL PRIVILEGE cci-246 (12/13)

SP 2656

CCF _____

- New application \$250.00 Fee
- Amendment to add items to Special Privilege # 2352 (\$125.00 Fee)
- Amendment to remove items from Special Privilege # _____ (No fee)
- Amendment for change of ownership for Special Privilege # _____ (No fee)

- File petition with the Department of Public Works, Attention: Special Privileges, 841 North Broadway, Room 919, Milwaukee, WI 53202.
- Fee must be submitted with petition. Checks should be made payable to the City of Milwaukee.
- Questions? Call 414-286-2454

To the Honorable, The Common Council of the City of Milwaukee:

The Licensee BreakWater Condominium Association, Inc
(Name of Individual, Partners, Corporation or LLC)

being the owners of the following property known by street address as 1313 N Franklin Pl, 53202
(Street Address and Zip Code)

in the 3rd Aldermanic District respectfully petition the Common Council of the City of Milwaukee according to the provisions of Section 66.0425 of the Wisconsin Statutes, that the following privilege be granted:

Description of Special Privilege: amending CCF 070902 for addition of planter edging

Of which a plan or sketch is herewith submitted. Petitioner agrees to comply with all laws and all ordinances of the City of Milwaukee, to abide by any order or resolution of the Common Council affecting this privilege, to be primarily liable for damages to person or property by reason of the granting of such privilege, pay annual compensation as provided by law in the sum to be fixed by the proper city officers, and to file and keep current throughout the existence of the privilege, a certificate of insurance indicating applicant holds a public liability policy in at least the sums of \$25,000.00/\$50,000.00 bodily injury, and \$10,000.00 property damage, insuring the city against any liability that might arise by reason of the privilege.

Petitioner further agrees to remove said privilege whenever public necessity so requires when so ordered upon resolution adopted by the Common Council or other legislative body.

Should this special privilege be discontinued for any reason whatsoever, petitioner agrees to remove all construction work executed pursuant to this special privilege, to restore to its former condition and to the approval of the Commissioner of Public Works, any curb, pavement, or other public improvement which was removed, changed or disturbed by reason of the granting of this special privilege. Petitioner further agrees not to contest the validity of Section 66.0425 of the Wisconsin Statutes, or the legality of this special privilege in any way.

Name (Please Print): Ronald English
(Individual, Partner, or Agent if corporation or LLC as shown above)

Signature: 
(Individual, Partner, or Agent if corporation or LLC)

Corporation or LLC Name: BreakWater Condominium Association
(If applicable, as shown above)

Mailing Address (If different than property address above): _____

(OVER)

City: _____ State: _____ Zip: _____

Telephone: _____ E-Mail: _____

Architect/Engineer/Contractor (If Applicable)

Name: LANDWORKS LANDSCAPE, INC. / CHRIS MIRACLE
LANDSCAPE ARCHITECT

Address: N69 W25195 INDIAN GRASS LANE

City: SUSSEX State: WI Zip: 53089

Telephone: 414) 349-5921 E-Mail: cmiracle@landworkswisconsin.com

IMPORTANT NOTICE FOR CUSTOMERS PAYING BY CHECK

When you provide a check as payment, you authorize us either to use information from your check to make a one-time electronic fund transfer from your account or to process the payment as a check transaction.

E. KNAAP ST.

SIDEWALK

End of Phase 1 Scope

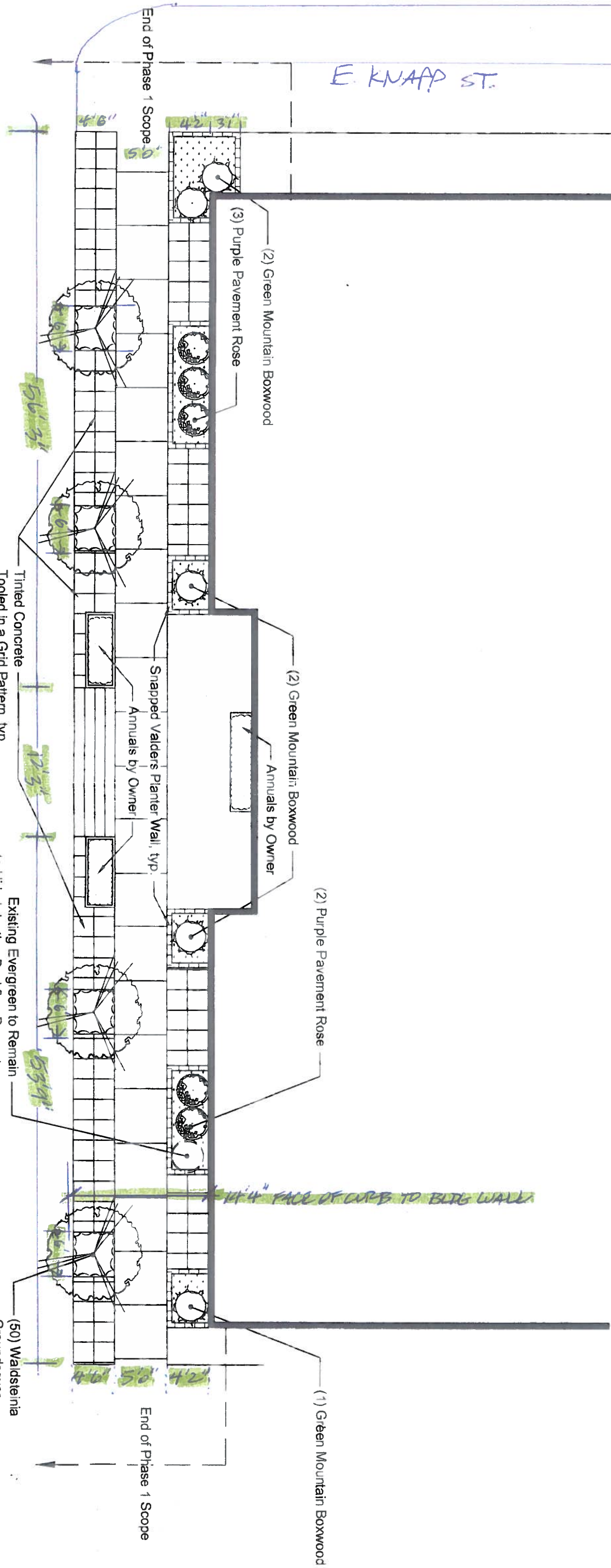

(3) Purple Pavement Rose
(2) Green Mountain Boxwood

(2) Green Mountain Boxwood
Annuals by Owner

(2) Purple Pavement Rose

(1) Green Mountain Boxwood

Snapped Valders Planter Wall, typ.
Annuals by Owner

Tinted Concrete
Tooled in a Grid Pattern, typ.

Existing Evergreen to Remain
to Hide Irrigation Backflow Preventer

(50) Waldsteinia
Groundcover
Under Each Tree in Boulevard, typ.

N. FRANKLIN PLACE

BREAKWATER CONDOMINIUMS



North →

Scale: 1" = 10'-0"

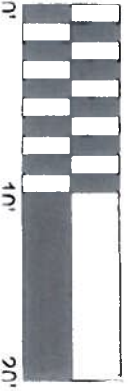

Chris Miracle
PLA, ASLA
Landscape Architect
cmmiracle@landworkswisconsin.com
p 262.820.2501 e 414.349.5921
N69 W25195 Indiangrass Lane
Sussex, WI 53089

1313 N. FRANKLIN PL.
MILWAUKEE, WI