



CITY OF MILWAUKEE
OFFICE OF THE CITY CLERK

Tuesday, January 11, 2022

COMMITTEE MEETING NOTICE

AD 15

PETERSON, Courtney L, Agent
Family First 5 LLC
3220 N Buffum St
Milwaukee, WI 53212

You are requested to attend a virtual hearing to be held on:

Tuesday, January 25, 2022 at 10:10 AM

Regarding: Your Food Dealer and Weights & Measures License Applications as agent for "Family First 5 LLC" for "Courtney Peterson" at 2801 N 20th

This meeting will be held via GoToMeeting. Please see the enclosed best practices document for further instructions. The access code is <https://global.gotomeeting.com/join/522275661>. If you wish to call in, please call **+1 (872) 240-3311** and use Access Code: **522-275-661**

There is a possibility that your application may be denied for one or more of the following reasons: The recommendation of the committee regarding the application shall be based on evidence presented at the hearing. Per MCO 85-2.7-4, probative evidence concerning whether or not a new license should be granted may be presented on the following subjects: whether or not the applicant meets the municipal requirements, the appropriateness of the location and premises where the licensed premises is to be located and whether use of the premises for the purposes or activities permitted by the license would tend to facilitate a public or private nuisance or create undesirable neighborhood problems such as disorderly patrons, unreasonably loud noise, litter, and excessive traffic and parking congestion. Probative evidence relating to these matters may be taken from the plan of operation submitted with the license application, if any, but shall not include the content of any music. Evidence regarding the fitness of the location of the premises to be maintained as the principal place of business, including but not limited to whether there is an overconcentration of businesses of the type for which the license is sought; whether the proposal is consistent with any pertinent neighborhood business or development plans, or the location's proximity to areas where children are typically present. The applicant's record in operating similarly licensed premises; and whether or not the applicant has been charged with or convicted of any felony, misdemeanor, municipal offense or other offense, the circumstances of which substantially relate to the activity to be permitted by the license being applied for or any other factor which reasonably relates to the public health, safety or welfare may also be considered. See attached police report or correspondence.

Notice for applicants with warrants or unpaid fines:

Proof of warrant satisfaction or payment of fines must be submitted at the hearing on the above date and time. Failure to comply with this requirement may result in a delay of the granting/denial of your application.

Failure to attend this meeting may result in the denial of your license. Individual applicants and partnership applicants must attend or attend by an attorney. The agent or attorney for corporate or limited liability applicants must attend. If you wish to do so and at your own expense, you may be accompanied by an attorney of your choosing to represent you at this hearing.

You will be given an opportunity to speak on behalf of the application and to respond and challenge any charges or reasons given for the denial. No petitions can be accepted by the committee, unless the people who signed the petition attend the virtual hearing and are willing to testify. You may present witnesses under oath and you may also confront and cross-examine opposing witnesses under oath. If you have difficulty with the English language, you should request an interpreter attend the meeting with you, at your expense, so that you can answer questions and participate in your hearing.

PLEASE NOTE: Upon reasonable notice, efforts will be made to accommodate the needs of disabled individuals through sign language interpreters or other auxiliary aids. For additional information or to request this service, contact the Council Services Division ADA Coordinator at (414) 286-2998, Fax - (414) 286-3456, TDD - (414) 286-2025.

JIM OWCZARSKI, CITY CLERK

BY: _____

Jim Cooney
License Division Manager

If you have questions regarding this meeting, please contact the staff assistant, Yadira Melendez at (414) 286-2775 or stas5@milwaukee.gov

Courtney L. Peterson
3220 North Buffum st.
Milwaukee, WI 53212
(WORK): 414-810-4442
(CELL): 414-514-7953
(EMAIL): courtney.p322@gmail.com

RE: JIM COONEY

Licenses Committee of the Common Council
Licenses Division City Hall Room 105
200 East Wells
Milwaukee, WI 53202

Dear Mr. Cooney, my name is Ms. Courtney Peterson and I hope you are doing well. I am writing to appeal the objection to grant my food dealer/retail license application for 2801 N. 20th street. The objection letter states that there is an "over concentration" of similar establishments in the area. I have done some extended research of my own and found only a few, food dealer/retail stores in the vicinity—with the exception of one Family Dollar. Enclosed is a copy of the names and addresses for all the similar establishments in the area including the Family Dollar which is only blocks away in walking distance.

2801 N. 20th has been a known convenience store since the 1980's. Even with different owners, this property is known in the neighborhood for this type of business. Families have depended on this location for its' convenience. This community needs a **BLACK OWNED AND OPERATED** business that is accessible to individuals in the proximity. I aim to service and cater to the specific needs of the neighborhood as well as the families looking to utilize our convenient resources.

I am asking that my request for licensing be re-visited and for the Common Council to overturn the decision to object to my application that was made by my alderman—granting me a license to operate a food dealer/retail store at 2801 N. 20th street. Based on factual evidence I am positive that if granted the license and opportunity to operate, 2801 will not clutter similar establishments. It will only add to a community that is on the uprise.

As I conclude this letter, I would like to thank you for your time. I am a dedicated individual with a vision for the African American Community. My vision can only add to the developmental flourishing that is well needed in the 53206 community. I have dedicated hours of hard work to bring this vision alive and I am optimistic that once reevaluated you will see and understand my vision as well.

Sincerely,

Courtney L. Peterson

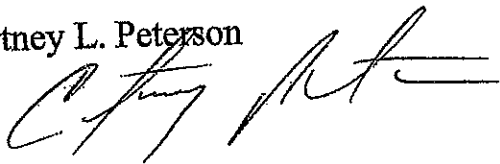
A handwritten signature in black ink, appearing to read 'Courtney L. Peterson', written in a cursive style.

Hide Details	Food Dealer Retail	Lucky Sam Food Mart	2401 N 21st St Milwaukee, WI 53206	active	07/13/2022
---------------------	--------------------	---------------------	---------------------------------------	--------	------------

Issue Date: 07/12/2021
 License Code: FOOD
 Aldermanic District: 15
 Police District: 3
 Food District: 8
 Legal Entity: Lucky Sam Food Mart Inc
 Licensee: Sukhdev Singh, Agent
 Premise Description: First Floor
 Specialty: Convenience, Food Store, Hazardous Foods, Processing, Sales \$20,001 - \$200,000
 Phone Number: (414)236-2862

Hours of Operation

Is Open?	Day	Open	Close	Expected Customers	Age Restriction
True	Sun	8:00AM	9:00PM	200	
True	Mon	8:00AM	9:00PM	200	
True	Tue	8:00AM	9:00PM	200	
True	Wed	8:00AM	9:00PM	200	
True	Thu	8:00AM	9:00PM	200	
True	Fri	8:00AM	9:00PM	200	
True	Sat	8:00AM	9:00PM	200	

Attachments

Attachment type	File Name
Application	2021_05_19_12_51_28.pdf

Hide Details	Food Dealer Retail	Magic Foods	2879 N 16th St Milwaukee, WI 53206	active	07/27/2022
---------------------	--------------------	-------------	---------------------------------------	--------	------------

Issue Date: 01/19/2021
 License Code: FOOD
 Aldermanic District: 15
 Police District: 5
 Food District: 4
 Legal Entity: Lama LLC
 Licensee: BELAL N ATARI, Agent
 Premise Description: 1st Floor
 Specialty: Convenience, Hazardous Foods, Processing, Sales \$20,001 - \$200,000
 Phone Number: (414)449-5499

Hours of Operation

Is Open?	Day	Open	Close	Expected Customers	Age Restriction
True	Sun	8:00AM	9:00PM	100	
True	Mon	8:00AM	9:00PM	100	
True	Tue	8:00AM	9:00PM	100	
True	Wed	8:00AM	9:00PM	100	
True	Thu	8:00AM	9:00PM	100	
True	Fri	8:00AM	9:00PM	100	
True	Sat	8:00AM	9:00PM	100	

Attachments

Attachment type	File Name
Application	scan0900.pdf

Show Details	Food Dealer Retail	PAYLESS FOOD	1841 N 27TH St MILWAUKEE, WI 53208	active	11/15/2022
Show Details	Food Dealer Retail	PICK 'N SAVE #879	2355 N 35TH St MILWAUKEE, WI 53210	Active (Renewal Pending)	01/18/2022
Show Details	Food Dealer Retail	Pantry 2514	2514 N 27th St Milwaukee, WI 53210	Active (Renewal Pending)	01/06/2022
Show Details	Food Dealer Retail	Pantry 81	2812 W FOND DU LAC Av Milwaukee, WI 53210	Active (Renewal Pending)	01/07/2022
Show Details	Food Dealer Retail	QUICK FOOD MARKET	3833 W CENTER St MILWAUKEE, WI 53210	Active (Renewal Pending)	12/27/2021
Show Details	Food Dealer Retail	RV Food Mart	1556 N 33RD St Milwaukee, WI 53208	active	03/22/2022
Show Details	Food Dealer Retail	SKYWAY FOOD MART	2601 N 35TH St MILWAUKEE, WI 53210	active	03/23/2022
Show Details	Food Dealer Retail	STOP N SHOP	2905 W FOND DU LAC Av MILWAUKEE, WI 53210	active	04/05/2022
Show Details	Food Dealer Retail	SUPERIOR FOOD & LIQUOR	1535 W NORTH Av MILWAUKEE, WI 53205	Active (Renewal Pending)	01/17/2022
Show Details	Food Dealer Retail	Save A Lot #8033	2322 W Oak St Milwaukee, WI 53206	active	03/22/2022

Issue Date: 07/12/2021
 License Code: FOOD
 Aldermanic District: 15
 Police District: 5
 Food District: 4
 Legal Entity: Magic Holdings, LLC
 Licensee: Balkar Singh, Agent
 Premise Description: First Floor & Basement Storage
 Specialty: Convenience, Hazardous Foods, Processing, Sales \$200,001 - \$2,000,000
 Phone Number: (414)265-3910

Hours of Operation

Is Open?	Day	Open	Close	Expected Customers	Age Restriction
True	Sun	8:00AM	9:00PM	150	
True	Mon	8:00AM	9:00PM	150	
True	Tue	8:00AM	9:00PM	150	
True	Wed	8:00AM	9:00PM	150	
True	Thu	8:00AM	9:00PM	150	
True	Fri	8:00AM	9:00PM	150	
True	Sat	8:00AM	9:00PM	150	

Attachments

Attachment type	File Name
Application	2879 N 16th St Magic Foods.pdf

<u>Show Details</u>					
<u>Show Details</u>	Food Dealer Retail	Mobil Gas Station	4950 W Lisbon Av Milwaukee, WI 53210	Active (Renewal Pending)	01/31/2022
<u>Show Details</u>	Food Dealer Retail	New Rainbow Foods	1433 W North Av Milwaukee, WI 53205	Active (Renewal Pending)	01/18/2022
<u>Show Details</u>	Food Dealer Retail	Omar Food	2803 N 35TH St Milwaukee, WI 53210	active	06/08/2022
<u>Hide Details</u>	Food Dealer Retail	One Stop Mart	2709 N 28th St Milwaukee, WI 53210	active	02/08/2022

Issue Date: 10/27/2021
 License Code: FOOD
 Aldermanic District: 15
 Police District: 3
 Food District: 8
 Legal Entity: Horizon Food Inc
 Licensee: Jamai J Sood, Agent
 Premise Description: First Floor
 Specialty: Convenience, Hazardous Foods, Processing, Sales \$20,001 - \$200,000
 Phone Number: (414)263-1633

Hours of Operation

Is Open?	Day	Open	Close	Expected Customers	Age Restriction
True	Sun	9:00AM	9:00PM	300	
True	Mon	9:00AM	9:00PM	300	
True	Tue	9:00AM	9:00PM	300	
True	Wed	9:00AM	9:00PM	300	
True	Thu	9:00AM	9:00PM	300	
True	Fri	9:00AM	9:00PM	300	
True	Sat	9:00AM	9:00PM	300	

Attachments

Attachment type	File Name
Application	2021_08_04_11_07_45.pdf

Show Details	Food Dealer Retail	FAST STOP FOOD MARKET	3611 W VLIET St MILWAUKEE, WI 53208	active	06/03/2022
Show Details	Food Dealer Retail	FOND DU LAC SMOKE SHOP	2910 W FOND DU LAC Av MILWAUKEE, WI 53210	active	05/21/2022
Show Details	Food Dealer Retail	Family Dollar #25469	2510 W North Av Milwaukee, WI 53205	active	09/07/2022
Hide Details	Food Dealer Retail	Family Dollar #31784	2117 W Center St Milwaukee, WI 53206	active	05/24/2022

Issue Date: 05/27/2021
 License Code: FOOD
 Aldermanic District: 15
 Police District: 3
 Food District: 0
 Legal Entity: Family Dollar Stores of Wisconsin LLC
 Licensee: Peter A Barnett, Agent
 Premise Description: First Floor
 Specialty: Convenience, Hazardous Foods, No Processing, Sales \$200,001 - \$2,000,000
 Phone Number: (757)321-5000

Hours of Operation

Is Open?	Day	Open	Close	Expected Customers	Age Restriction
True	Sun	9:00AM	8:00PM	300	
True	Mon	9:00AM	9:00PM	400	
True	Tue	9:00AM	9:00PM	400	
True	Wed	9:00AM	9:00PM	400	
True	Thu	9:00AM	9:00PM	400	
True	Fri	9:00AM	9:00PM	500	
True	Sat	9:00AM	9:00PM	500	

Attachments

Attachment type	File Name
Application	31784tobar21.pdf

Show Details	Food Dealer Retail	Business Name	Address	Status	Expiration Date
Show Details	Food Dealer Retail	GALST FOODS	1622 W NORTH Av MILWAUKEE, WI 53205	active	05/26/2022
Show Details	Food Dealer Retail	GURU FOOD	4028 W LISBON Av MILWAUKEE, WI 53208	active	09/22/2022
Show Details	Food Dealer Retail	Gigs Petro Pantry	2306 W FOND DU LAC Av Milwaukee, WI 53206	active	07/15/2022
Show Details	Food Dealer Retail	HAYAT PHARMACY	1919 W North Av Milwaukee, WI 53205	Active (Renewal Pending)	01/14/2022
Show Details	Food Dealer Retail	Hannawi Meat & Deli	4737 W CENTER St Milwaukee, WI 53210	active	02/14/2022
Show Details	Food Dealer Retail	JP Foods	2309 N 49th St Milwaukee, WI 53210	active	12/11/2022
Show Details	Food Dealer Retail	JP Foods	2309 N 49th St Milwaukee, WI 53210	Active (Renewal Pending)	12/11/2021
Show Details	Food Dealer Retail	LISBON GAS & FOOD	3033 W LISBON Av MILWAUKEE, WI 53208	Active (Renewal Pending)	01/31/2022
Show Details	Food Dealer Retail	LLOYD FOOD	2101 N 38TH St MILWAUKEE, WI 53208	active	07/06/2022
Show Details	Food Dealer Retail	Lisbon BP	2624 W Lisbon Av Milwaukee, WI 53205	Active (Renewal Pending)	01/31/2022
Show Details	Food Dealer Retail	Lisbon Food & Beer	4401 W Lisbon Av Milwaukee, WI 53208	active	09/23/2022



City of Milwaukee License Search

Search by Aldermanic District

Select a criteria to search by

Search by Aldermanic District ▼

District 15 ▼ **Select a Aldermanic District**

Submit

XML File with report data ▼

Export

421 Results for "Aldermanic District 15"

	License Title	Trade Name	Address	Type	Expiration Date
Show Details	Food Dealer Retail	BC Supermarket	4225 W North Av Milwaukee, WI 53208	active	04/08/2022
Show Details	Food Dealer Retail	BROWN STREET FOODS	2485 W BROWN St MILWAUKEE, WI 53205	active	04/13/2022
Show Details	Food Dealer Retail	Brothers Petrol	2175 N 35th St Milwaukee, WI 53208	Active (Renewal Pending)	11/17/2021
Show Details	Food Dealer Retail	Brothers Petrol	2175 N 35th St Milwaukee, WI 53208	active	11/17/2022
Hide Details	Food Dealer Retail	CENTER PETRO MART	1341 W CENTER St MILWAUKEE, WI 53206	Active (Renewal Pending)	12/18/2021

Issue Date: 11/24/2020
 License Code: FOOD
 Aldermanic District: 15
 Police District: 3
 Food District: 8
Legal Entity: 1341 CENTER ST INC
 Licensee: HARJINDER SINGH, Agent
 Specialty: Convenience - Gas Station, Hazardous Foods, Processing, Sales \$20,001 - \$200,000
 Phone Number: (414)699-7243

Hours of Operation

Is Open?	Day	Open	Close	Expected Customers	Age Restriction
True	Sun	12:00AM	12:00AM	250	
True	Mon	12:00AM	12:00AM	250	
True	Tue	12:00AM	12:00AM	250	
True	Wed	12:00AM	12:00AM	250	
True	Thu	12:00AM	12:00AM	250	
True	Fri	12:00AM	12:00AM	250	
True	Sat	12:00AM	12:00AM	250	

Attachments

Attachment type	File Name
Application	License Renewal - 1341 Center St Inc.pdf

Show Details	Food Dealer Retail	CHAHAL CITGO	3308 W VLIET St MILWAUKEE, WI 53208	active	11/11/2022
Show Details	Food Dealer Retail	COMMUNITY FOODS	2800 N 27TH St MILWAUKEE, WI 53210	active	09/26/2022
Show Details	Food Dealer Retail	Citgo Gas Station	3708 W North Av Milwaukee, WI 53208	active	01/31/2022
Show Details	Food Dealer Retail	Clark on Center	905 W Center St Milwaukee, WI 53206	active	09/21/2022
Show Details	Food Dealer Retail	Dave's Gas	4527 W LISBON Av Milwaukee, WI 53208	Active (Renewal Pending)	01/18/2022
Show Details	Food Dealer Retail	Dream Foods	3731-3733 W CENTER St Milwaukee, WI 53210	active	06/05/2022
Hide Details	Food Dealer Retail	Eagle Foods	1401 W Center St Milwaukee, WI 53206	active	10/11/2022



Tuesday, January 11, 2022



Notice of Public Hearing

Blank Notice

PETERSON, Courtney L
Courtney Peterson at 2801 N 20th St.
Food Dealer and Weights & Measures License Applications

Tuesday, January 25, 2022 at 10:10 AM

To whom it may concern:

The above application has been made by the above named applicant(s). This requires approval from the Licenses Committee and the Common Council of the City of Milwaukee. The hearing before the Licenses Committee will take place virtually on 01/25/2022 at 10:10 AM. This is a public hearing. Those wishing to view the proceeding are able to do so via the City Channel – Channel 25 on Spectrum Cable – or on the Internet at <http://city.milwaukee.gov/citychannel>. Those wishing to provide oral testimony will be asked to do so by phone or internet and are asked to contact the staff assistant, Yadira Melendez at (414) 286-2775 or stasst5@milwaukee.gov for necessary information. Please make such requests no later than one business day prior to the start of the meeting. You are not required to attend the hearing, but please see the information below if you would like to provide testimony. Once the Licenses Committee makes its recommendation, this recommendation is forwarded to the full Common Council for approval at its next regularly scheduled hearing.

Important details for those wishing to provide information for the Licenses Committee to consider when making its recommendation:

1. The license application is scheduled to be heard at the above time. Due to other hearings running longer than scheduled, you may have to wait some time to provide your testimony.
2. You must testify as to matters that you have personally experienced or seen. (You cannot provide testimony for your neighbor, parent or anyone else; this is considered hearsay and cannot be considered by the committee.)
3. No letters or petitions can be accepted by the committee (unless the person who wrote the letter or the persons who signed the petition are willing to testify).
4. Persons opposed to the license application are given the opportunity to testify first; supporters may testify after the opponents have finished.
5. When you are called to testify, you will be sworn in and asked to give your name, and address. (If your first and/or last names are uncommon please spell them.)
6. You may then provide testimony.
 - a. Include only information relating to the above license application.
 - b. Include only information you have personally witnessed or seen.
 - c. Provide concise and relevant information detailing how this business has affected or may affect the peaceful enjoyment of your neighborhood.
 - d. If by the time you have the opportunity to testify, the information you wish to share has already been provided to the committee, you may state that you agree with the previous testimony. Redundant or repetitive testimony will not assist the committee in making its recommendation.
7. After giving your testimony, the members of the Licenses Committee and the licensee may ask questions regarding the testimony you have given or other factors relating to the license application.
8. Business Competition is not a valid basis for denial or non-renewal of a license.

Please Note: If you have submitted an objection to the above application your objection cannot be considered by the committee unless you personally testify at the hearing.

OCCUPANT	MAIL ADDRESS	CITY STATE ZIP
CURRENT OCCUPANT	2021 W HADLEY ST	MILWAUKEE, WI 53206-1617
CURRENT OCCUPANT	2025 W HADLEY ST	MILWAUKEE, WI 53206-1617
CURRENT OCCUPANT	2032 W HADLEY ST	MILWAUKEE, WI 53206-1618
CURRENT OCCUPANT	2753 N 20TH ST	MILWAUKEE, WI 53206-1603
CURRENT OCCUPANT	2754 N 21ST ST	MILWAUKEE, WI 53206-1606
CURRENT OCCUPANT	2757 N 20TH ST	MILWAUKEE, WI 53206-1603
CURRENT OCCUPANT	2763 N 19TH ST	MILWAUKEE, WI 53206-2141
CURRENT OCCUPANT	2763 N 20TH ST	MILWAUKEE, WI 53206-1603
CURRENT OCCUPANT	2764 N 21ST ST	MILWAUKEE, WI 53206-1606
CURRENT OCCUPANT	2765 N 19TH ST	MILWAUKEE, WI 53206-2141
CURRENT OCCUPANT	2768 N 21ST ST	MILWAUKEE, WI 53206-1606
CURRENT OCCUPANT	2769 N 20TH ST	MILWAUKEE, WI 53206-1603
CURRENT OCCUPANT	2770 N 20TH ST	MILWAUKEE, WI 53206-1602
CURRENT OCCUPANT	2776 N 19TH ST	MILWAUKEE, WI 53206-2140
CURRENT OCCUPANT	2777 N 20TH ST	MILWAUKEE, WI 53206-1603
CURRENT OCCUPANT	2778 N 19TH ST	MILWAUKEE, WI 53206-2140
CURRENT OCCUPANT	2801 N 21ST ST	MILWAUKEE, WI 53206-1608
CURRENT OCCUPANT	2805 N 21ST ST	MILWAUKEE, WI 53206-1608
CURRENT OCCUPANT	2807 N 20TH ST	MILWAUKEE, WI 53206-1605
CURRENT OCCUPANT	2808 N 19TH ST	MILWAUKEE, WI 53206-2142
CURRENT OCCUPANT	2809 N 21ST ST	MILWAUKEE, WI 53206-1608
CURRENT OCCUPANT	2810 N 20TH ST	MILWAUKEE, WI 53206-1604
CURRENT OCCUPANT	2811 N 19TH ST	MILWAUKEE, WI 53206-2143
CURRENT OCCUPANT	2811 N 20TH LN	MILWAUKEE, WI 53206-1601
CURRENT OCCUPANT	2813 N 20TH LN	MILWAUKEE, WI 53206-1601
CURRENT OCCUPANT	2813 N 21ST ST	MILWAUKEE, WI 53206-1608
CURRENT OCCUPANT	2813A N 20TH LN	MILWAUKEE, WI 53206-1601
CURRENT OCCUPANT	2813A N 21ST ST	MILWAUKEE, WI 53206-1608
CURRENT OCCUPANT	2815 N 20TH ST	MILWAUKEE, WI 53206-1605
CURRENT OCCUPANT	2816 N 19TH ST	MILWAUKEE, WI 53206-2142
CURRENT OCCUPANT	2817 N 20TH ST	MILWAUKEE, WI 53206-1605
CURRENT OCCUPANT	2817 N 21ST ST	MILWAUKEE, WI 53206-1608
CURRENT OCCUPANT	2825 N 19TH ST	MILWAUKEE, WI 53206-2143
CURRENT OCCUPANT	2825 N 21ST ST	MILWAUKEE, WI 53206-1608
CURRENT OCCUPANT	2825A N 19TH ST	MILWAUKEE, WI 53206-2143
CURRENT OCCUPANT	2831 N 20TH ST	MILWAUKEE, WI 53206-1605
CURRENT OCCUPANT	2833 N 19TH ST	MILWAUKEE, WI 53206-2143
CURRENT OCCUPANT	2835 N 19TH ST	MILWAUKEE, WI 53206-2143
CURRENT OCCUPANT	2835 N 20TH ST	MILWAUKEE, WI 53206-1605

Blank Notice

Radius 250.0 feet and Center of Circle: 2801 N 20th St

#328464

ADIS

ccl-amend 9/10/18



APPLICATION AMENDMENT

Office of the City Clerk License Division
200 E. Wells Street, Room 105, Milwaukee, WI 53202 (414) 286-2238

Date: 10/22/2021

To the License Division of the City of Milwaukee:

I, Courtney Peterson, wish to amend my answer(s) on the application for a

(full legal name)

Convenience Store license at 2801 N 20th St

(type of license)

(premises address, if applicable)

by adding or amending the following information (complete only those sections being amended):

1. Answer to Question(s) # _____ should be: _____
2. Agent should be (full legal name): _____ Also complete 3, 4, 5 & 6
3. Date of birth should be: _____
4. Home address should be (include city/state/zip): _____
5. Phone number should be (include area code): _____
6. Driver's License Number/State ID Number should be: _____
7. Corporation/LLC name should be (full legal name): Family First 5 LLC
8. Business name should be: _____
9. Premises address should be (include city/state/zip): _____
10. Business phone number should be (include area code): _____
11. Mailing address should be (include city/state/zip): _____
12. Email address should be: _____
13. Recycling/Salvaging/Towing: Location where vehicle will be parked should be (include city/state/zip): _____
14. Class B Tavern: Age Distinction should be: _____
15. Other: _____

(Check with the License Division before submitting "Other" amendments using this form.)

Signature of Licensee (Individual, Partner, or Agent of Corp/LLC)

Office Use Only: Application #: _____ Date: _____ Initials: _____ To LC: _____
LC Email: MPD NS HD Initials: _____



BUSINESS LICENSE PLAN OF OPERATION

ccl-busplan 5/12/2020

Office of the City Clerk License Division
200 E. Wells St. Room 105, Milwaukee, WI 53202
(414) 286-2238 www.milwaukee.gov/license e-mail address: license@milwaukee.gov

1. Type of Business

Applying for: Extended Hours (12AM to 5AM) - If a food establishment, check all that apply: Delivery Drive Thru Dining Room
 Self Service Laundry Massage Establishment Filling Station
 Other (supplemental application for specific license also required)

Provide a detailed description of the type of business you plan on operating:

Convenience store / restaurant carry-out

Do you have any experience operating this type of business? No Yes If yes, explain: *Helped my brother start his restaurant in 2016*

2. Business Operations

- a. Proposed Opening Date: *1-1-21*
- b. Is this premise under construction? No Yes If yes, list estimated completion date: _____
- c. Is this a franchise? No Yes
- d. Is this premises currently licensed? No Yes If yes, list type of license: _____
- e. Is the current licensee operating? No Yes If no, list date closed: _____
- f. Do you have future plans for other businesses, licenses or permits at this location? No Yes
If yes, explain: _____
- g. Have you previously held an Extended Hours License in Milwaukee? No Yes
If yes, list address(es): _____
- h. Are other businesses operating in the same building? No Yes If yes, describe: _____

3. Litter & Noise

- a. How are grounds kept clean? Sweep Pressure Wash Pick Up Litter Other: _____
- b. How often will grounds be cleaned? Daily Weekly As Needed Monthly Other: _____
- c. Grounds cleaned by: Licensee Building Owner Employees Hired Maintenance Other: _____
- d. How are noise issues prevented and/or addressed? Security Manager approaches customer(s) Call Police
 Signs Posted Other: _____
- e. Will a sound amplification system be used? No Yes If yes, describe: _____

4. Smoking & Sanitation

- a. Are there designated outdoor smoking areas? No Yes If yes, describe: *Back of Store Outside.*
- b. Number of Garbage Cans: Inside: *4* Locations: *1 restroom, 2 kitchen, 1 behind register*
Outside: *1* Locations: *SIDE OF BUILDING*
- c. Is a crowd control barrier used? No Yes If yes, describe: _____
- d. How many restrooms are on the premises? *1*
- e. Name of solid waste contractor: Advanced Disposal Waste Management Other: *TOGO Disposable*

5. Security

- a. Are there onsite parking spaces? No Yes If yes, how many? _____ and describe the parking security plan: _____
- b. Is there a loading zone? No Yes If yes, describe the loading area security plan: _____
- c. Will you have security personnel on premise? No Yes If yes, how many? _____ and answer the following:
 What are their responsibilities? _____
 Is security equipment used? No Yes If yes, describe _____
 List their licensing, certification, or training credentials _____
- d. Will there be security cameras? No Yes If yes, how many? 3 and list locations: 1 Front Door
1 rear door 1 OUTSIDE OF BUILDING
- e. Will searches/identification checks be done upon entry? No Yes If yes, describe _____

6. Percentage of Sales (must total 100%)

Alcohol _____%	Food <u>65</u> %	Secondhand Merchandise _____%	Precious Metals & Gems _____%
Entertainment _____%	Cigarettes <u>35</u> %		
Pawnbroker Activity _____%	Salvaged Materials _____% (such as scrap metal)	Personal Services (such as tattoo, body piercing, salon, tailor, tanning, etc.) _____%	Other _____% Describe: _____

7. Businesses/Licenses on the Premises (check all that apply):

Type 1

- Full Service Restaurant Cafe/Coffee Shop Deli or Fast Food Restaurant Private/Fraternal/Veterans Club
- Night Club Tavern Cocktail Lounge Teen Club
- Banquet Hall Sports Facility Bowling Alley
- Hotel/Motel : Number of Floors: _____ Number of Rooms: _____
 Rooming House: Number of Floors: _____ Number of Rooms: _____

Type 2

- Liquor Store Corner Store Supermarket Convenience Store
- Gas Station Amusement/Phonograph Distributor Recycling, Salvage or Towing
- Used Car Dealer Personal Service Establishment (such as tattoo business, hair salon, tailor, etc.) Recording Studio

What other licenses/permits will you hold at this location? (check all that apply)

- Occupancy Permit Cigarette & Tobacco Gas Station Extended Hours Class "B" Tavern Weights & Measures
- Secondhand Dealer Precious Metal & Gem Other: _____

8. Legal Capacity (only if a Type 1 premises in #7 above)

Capacity 20 (Call the Milwaukee Development Center at 414-286-8211 if you have questions.)

9. Premises Description

a. Identify all area(s) of the premises that will be used in operating this business (include areas used only for storage):

1st Floor 2nd Floor Basement Storage Patio Beer Garden Sidewalk Café Deck Rooftop

Other: Describe: _____

b. Describe Location: Major Thoroughfare Secondary Street Other: _____

c. Nearest Major Cross Street: n 20th St. w Hadley St.

d. Describe Building: Free Standing Building Strip Mall Other: _____

e. Describe Premises Structure: Single Story Multi-Story - # of Stories 2 Other: _____

f. Describe Surrounding Area: Commercial Residential Industrial Other: _____

g. Building Owner Name: antonio Lewis Phone Number: 414 397-4623

Building Owner Address: 2710 n Grant Blvd.

10. Hours of Operation & Customers

Will customers be entering the premises? No Yes

Day of the Week	Proposed Hours of Operation:		Estimated Number of Customers expected each day	Potential Age Range of Customers	Class B Tavern Applicant Only: Age Restriction (If none, write 'None')
	Open Time (include a.m. or p.m.)	Close Time (include a.m. or p.m.)			
Sunday	8am	8 pm	150	12+ up	
Monday	7am	10 pm	100	12+ up	
Tuesday	7am	10 pm	100	12+ up	
Wednesday	7am	10 pm	100	12+ up	
Thursday	7am	10 pm	100	12+ up	
Friday	7am	10 pm	100	12+ up	
Saturday	7am	10 pm	150	12+ up	

An Extended Hours Establishment License is required for any convenience store, filling station, personal service establishment (such as tattoo, body piercing, salon, tailor, tanning, etc.), recording studio or restaurant which is open between the hours of 12:00 a.m. and 5:00 a.m.

Alcohol Establishments Class A: 8:00 am to 9:00 pm Sunday thru Saturday
Permitted Hours of Operation: Class B: 6:00 am to 2:00 am Sunday thru Thursday, 6:00 am to 2:30 am Friday & Saturday

Entertainment Outdoor Closing Hours: 10:00pm Sunday-Thursday; 12:00am Friday & Saturday; unless a different time, either earlier or later, is established by the Common Council in its approval of the licensee's plan of operation.

11. Signature(s)

Signature of Sole Proprietor, Partner, or 20% or more Shareholder
(If there are no 20% or more shareholders, Corporate Officer-print name/title and sign)

Signature of additional partner or 20% or more shareholder

See Application Information for a complete list of all required application forms.



FOOD DEALER LICENSE PLAN OF OPERATION

ccl-foodplan 2/28/19

OFFICE OF THE CITY CLERK, LICENSE DIVISION
CITY HALL, 200 E. WELLS ST, ROOM 105, MILWAUKEE, WI 53202
(414) 286-2238 • license@milwaukee.gov • www.milwaukee.gov/license

Legal Entity Name: Courtney Peterson

Premises Address: 2801 n 20th st Milwaukee, WI 53206

SECTION 1 TYPE OF BUSINESS

What will be the majority of your food sales? (check one)

Restaurant Items (meals):
MEALS include, but are not limited to, chicken, ribs, sandwiches, roasted corn, baked potatoes, hot dogs, brats, tacos, nachos w/ cheese and meat, French fries, cooked or deep fried vegetables/fruit, cooked cheese curds, corn dogs, egg rolls, salads.

Retail Items (snacks and beverages):
RETAIL items include, but are not limited to, ice cream/soft serve, lemonade, snow cones, coffee, espresso, cappuccino, tea, fruit juice, smoothies, candy, dispensed soda, fruit cups, bakery, cookies, kettle corn, cotton candy, funnel cakes, fritters, tortilla chips w/ cheese.

Will it be a convenience store? Yes No
A convenience store contains less than 5,000 square feet of retail space and has, as its primary business, the sale of basic food items and in addition, sells household products or is a filling station that sells basic food items and household products.

Bed & Breakfast
 Micro Market

All Applicants: Submit a menu or a list of food items that will be sold.

Will any wholesale business be done? No Yes If yes, what percentage of food sales will be wholesale?

Less than 25%

25% or More AND:
 Restaurant items (meals) will be sold – Complete this application and also contact DATCP.
 NO restaurant items (meals) will be sold - Do NOT complete this application. Contact DATCP only.

SECTION 2 FOOD PROCESSING

Will any food processing be done? No Yes

Processing is defined as assembling, grinding, cutting, mixing, baking, coating, stuffing, packing, bottling, grilling, canning, extracting, fermenting, distilling, pickling, freezing, drying, smoking, or packaging.

SECTION 3 FOOD REQUIRING TEMPERATURE CONTROL

Will any food that requires temperature control be sold? No Yes
(includes dairy products such as milk, cheese, and ice cream, fish, shellfish, meat, poultry)

If yes, list the types of food items: milk, cheese, ice cream, meat poultry

SECTION 4 DETAILS OF OPERATION

Will you have seating on site for dining? No Yes
 Will you be doing any catering? No Yes
 Will you be doing any delivery? No Yes
 Will you have outdoor activities? No Yes - Check all that apply: Bar Cooking/Grilling Dining
 Will you have a drive thru window? No Yes - Are hours different from inside? No Yes
 If Yes, provide drive thru hours: _____
 Will scales or barcode scanners be used? No Yes - You must also apply for a Weights & Measures License.

SECTION 5 ADDITIONAL SITES

Where will food be prepared and/or sold?
 At a single site At multiple sites: How many? _____ (for example, a hotel with several dining rooms or bars)
 If multiple sites, attach a Food Dealer Additional Site Addendum (ccl-foodadd) for each additional site.

SECTION 6 CONSTRUCTION OR CHANGES

Are you planning any construction, remodeling or equipment changes?
 No If No, SKIP to Section 8
 Yes If Yes, check all that apply: New construction of a building Renovation or remodeling
 Construction changes to existing building Equipment changes only
 Provide a brief description of the changes: _____
 Start date: _____
 Name, Address & Phone Number of Architect: _____

 Name, Address & Phone Number of Contractor: _____

SECTION 7 ALCOHOL BEVERAGES

Are you applying for an alcohol beverage license?
 No If No, SKIP to Section 8
 Yes If YES, if your food license is approved prior to the alcohol license, when do you want the food license issued?
 Immediately At the same time as the alcohol license

SECTION 8 ACKNOWLEDGEMENTS & SIGNATURE

You must initial each item confirming your understanding:

CP I understand the Health Department must conduct an inspection and advise the License Division of their approval before the license may be issued.
CP I understand I must obtain an occupancy permit from the Department of Neighborhood Services and an inspection may be required. Neighborhood Services must advise the License Division of their approval before the license may be issued.
CP I understand the district alderperson will review and either support or object to my application. If he/she objects, I may appeal and be scheduled to appear before the Licenses Committee. The Licenses Committee will then make a recommendation to the Common Council. The Common Council must grant the license before it may be issued.
CP I understand proof of payment for all license fees must be on file in the License Division before the license may be issued and the license must be issued and posted in my establishment prior to opening for business.
CP I will not operate my food business until the license has been issued and posted in the establishment.

Signature of Sole Proprietor, Partner, or 20% Shareholder: [Signature]

Signature of Additional Partner: _____



WEIGHTS & MEASURES LICENSE SUPPLEMENTAL APPLICATION

OFFICE OF THE CITY CLERK, LICENSE DIVISION
CITY HALL, 200 E. WELLS ST, ROOM 105, MILWAUKEE, WI 53202
(414) 286-2238 • license@milwaukee.gov • www.milwaukee.gov/license

Office Use Only:

App# _____
Filed _____
Initials _____
Paid _____
Lic # _____

Legal Entity Name:

Courtney L. Peterson

Premise Address:

2801 n 20th Milwaukee, WI 53206

Device Type(s)

- Check all device types for which you need a license.
 - For each device type checked, indicate how many you have in the Number of Devices column (b).
 - Calculate the Total Fee Per Device Type by multiplying the Fee Per Device Type (a) by the Number of Devices (b).
 - Add all Total Fee Per Device Type amounts together and that will be your Total Fee Due.
- * **Exception:** The Scanner fee is not per device. Check the box for the appropriate range.
If you have 1-3 scanners, the total due is \$130. If you have 4 or more scanners, the total due is \$250.
Check the Number of Devices (b).

Device Type	License Period	Fee Per Device Type (a)	Number of Devices (b)	Total Fee Per Device Type (a x b)
Liquid Measuring Devices				
<input type="checkbox"/> Retail Petroleum Meters	12 months	\$60		
<input type="checkbox"/> 0 to 30 gallons per minute	24 months	\$60		
<input type="checkbox"/> 31 to 200 gallons per minute	24 months	\$250		
<input type="checkbox"/> Over 200 gallons per minute	24 months	\$250		
Scales				
<input type="checkbox"/> Measuring any weight amount	24 months	\$55		
Scanners				
		Fee for scanners is by range	Check how many scanners you have	
<input type="checkbox"/> Up to 3 scanners	24 months	\$130 total*	<input type="checkbox"/> 1 <input type="checkbox"/> 2 <input type="checkbox"/> 3	
<input type="checkbox"/> Four or more scanners	24 months	\$250 total*	<input type="checkbox"/> 4 <input type="checkbox"/> Other__	
Other Devices				
<input type="checkbox"/> Length Measuring Device	24 months	\$60		
<input type="checkbox"/> Timing Device	24 months	\$30		

Total Fee Due 55.00

Signature

I hereby agree that I will comply with the applicable sections of the Wisconsin State Statutes, Administrative Code and the Milwaukee Code of Ordinances regarding the operation of weighing and measuring devices.

I understand that all devices must be operated within the specifications, tolerances and other technical requirements set forth in the National Institute of Standards and Technology Handbook 44. I understand that the license for which I am applying must be posted on the premises or in my vehicle prior to opening for business or operating the device.

I understand that these device licenses are not transferable (with the exception of scanners). If the device is replaced or needs to be resealed, I must apply for and receive a new license so that an inspection of the device can be performed prior to its use.

I acknowledge that as a condition of being issued this license, I must allow the Health Department into the establishment to test the device to validate its specifications/tolerances. If my devices are found out of compliance, I may be charged inspection fees.

I have read, understand, and will adhere to all the above acknowledgments.

X [Signature]
Signature of Sole Proprietor, Partner, or 20% or more Shareholder
(If there are no 20% or more shareholders,
Corporate Officer-print name/title and sign)

Signature of additional partner or 20% or more shareholder

This form must be submitted with the Business License Application, Weights & Measures Plan of Operation, and appropriate fee.
Forms can be obtained online at www.milwaukee.gov/licenses.



WEIGHTS & MEASURES PLAN OF OPERATION

ccl-wmpln 1/9/18

Office of the City Clerk License Division
200 E. Wells St. Room 105, Milwaukee, WI 53202
(414) 286-2238 www.milwaukee.gov/license license@milwaukee.gov

Legal Entity Name: Courtney L. Peterson

Premise Address: 2801 N. 20th St. Milwaukee, WI, 53206

Type of Business

Provide a brief description of the establishment/business: Retail Store
We will focus on everyday - essential needs

Other licenses may be required depending on the type of business you are operating.

Litter & Noise

- a. How are grounds kept clean? Sweep Pressure Wash Pick Up Litter Other: _____
- b. How often will grounds be cleaned? Daily Weekly As Needed Monthly Other: _____
- c. Grounds cleaned by: Licensee Building Owner Employees Hired Maintenance Other: _____
- d. How are noise issues prevented and/or addressed? Security Manager approaches customer(s) Call Police
 Signs Posted Other: _____

Signature

X [Signature]
Signature of Sole Proprietor, Partner, or 20% or more Shareholder
(If there are no 20% or more shareholders,
Corporate Officer-print name/title and sign)

Signature of additional partner or 20% or more shareholder

This form must be submitted with the Business License Application, Weights & Measures License Supplemental Application, and appropriate fee. Forms can be obtained online at www.milwaukee.gov/licenses.

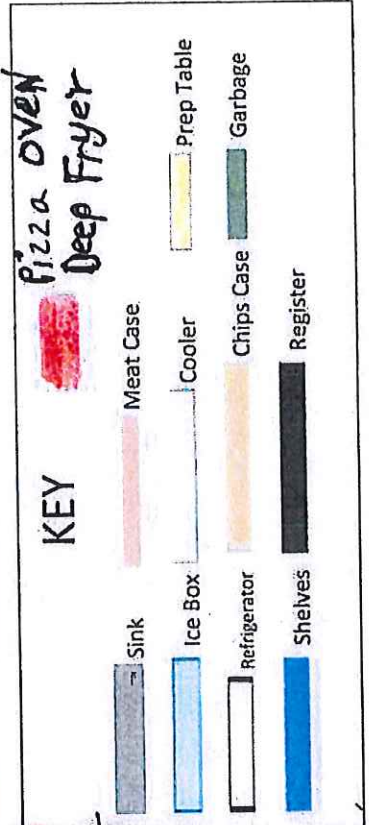
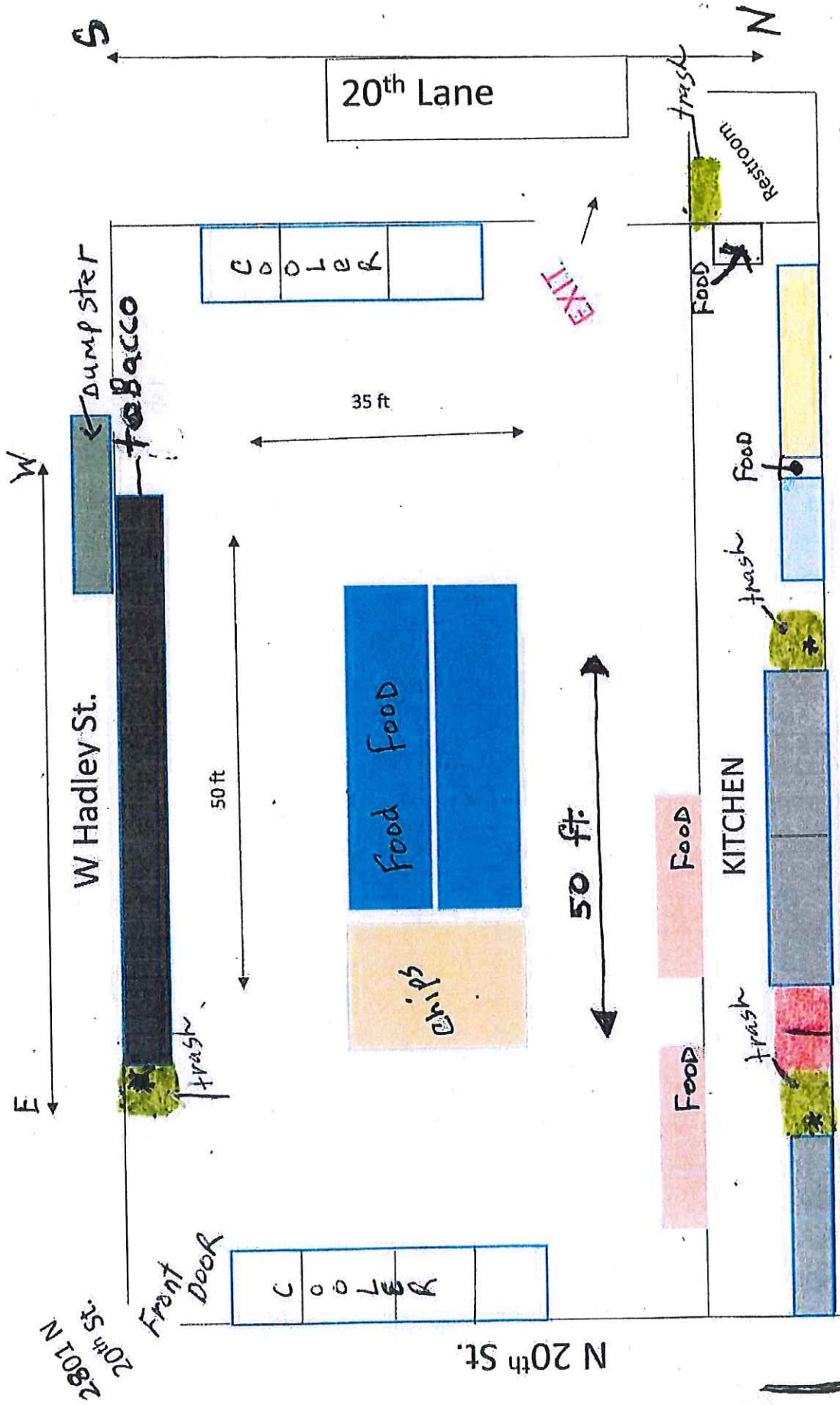

FRONT Man's
Corner Market

2374 sq ft. = total
Sq. Ft.
Courtney Peterson
Sole Proprietor
2801 n. 20th st.

11/10/2020