

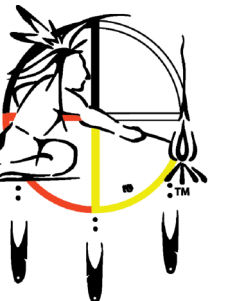

Quorum Architects, Inc.
 3112 West Highland Boulevard
 Milwaukee, Wisconsin 53208
 Phone: 414.265.9265
 Fax: 414.265.9465
 www.quorumarchitects.com



**FOREST COUNTY
 POTAWATOMI**

**PRELIMINARY
 NOT FOR
 CONSTRUCTION**
 QUORUM ARCHITECTS, INC.

**WGEMA CAMPUS
 GENERAL PLANNED DEVELOPMENT**

3215 W. State Street
 Milwaukee, Wisconsin 53208

Revisions:
 12/01/2021
 12/29/2021
 01/10/2022

Sheet Name:
**PROPOSED BUILDING AND
 PARKING SITE PLAN**

Date: **01/10/2022**

Drawn By: CLR/CGH

Project No.: 15014.02

Sheet No.

GPD-5

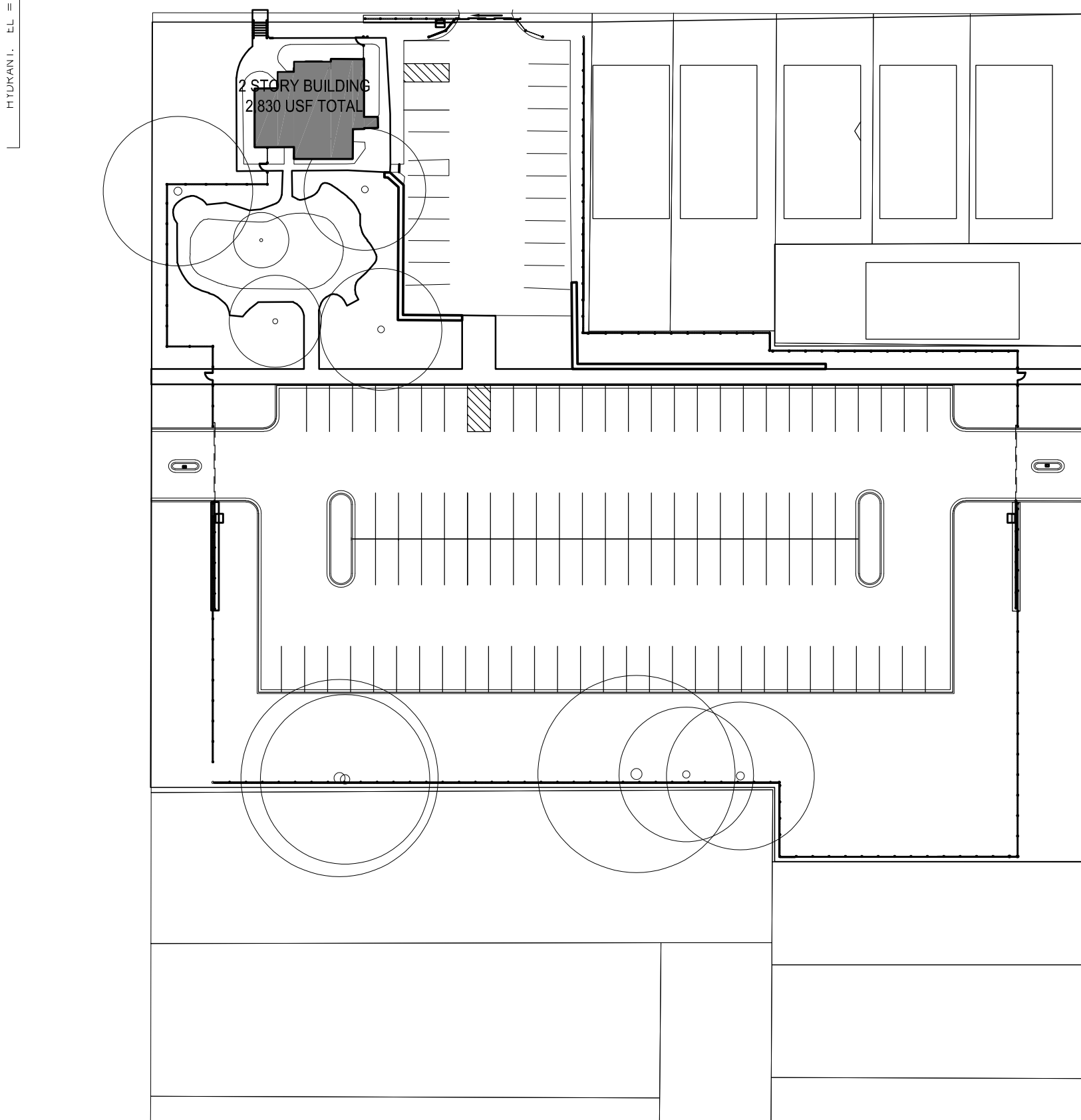
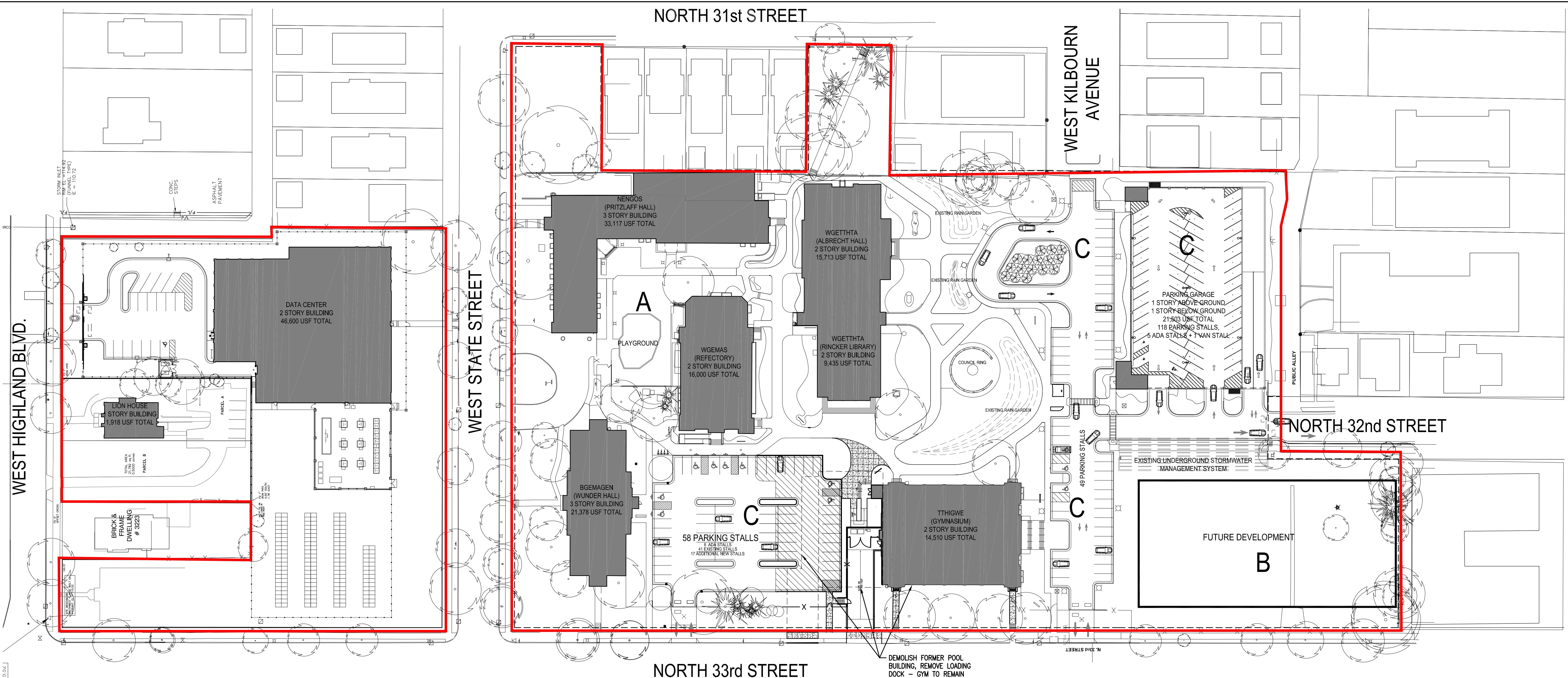

1 PROPOSED BUILDING AND PARKING SITE PLAN
 SCALE: 1" = 50'-0"

APPROVED USES	
A.	HISTORIC REDEVELOPMENT ZONE
B.	FUTURE DEVELOPMENT ZONE
C.	PARKING ZONE

GPD BOUNDARY

AREA / SITE AFFECTED BY
 DPD DEVELOPMENT

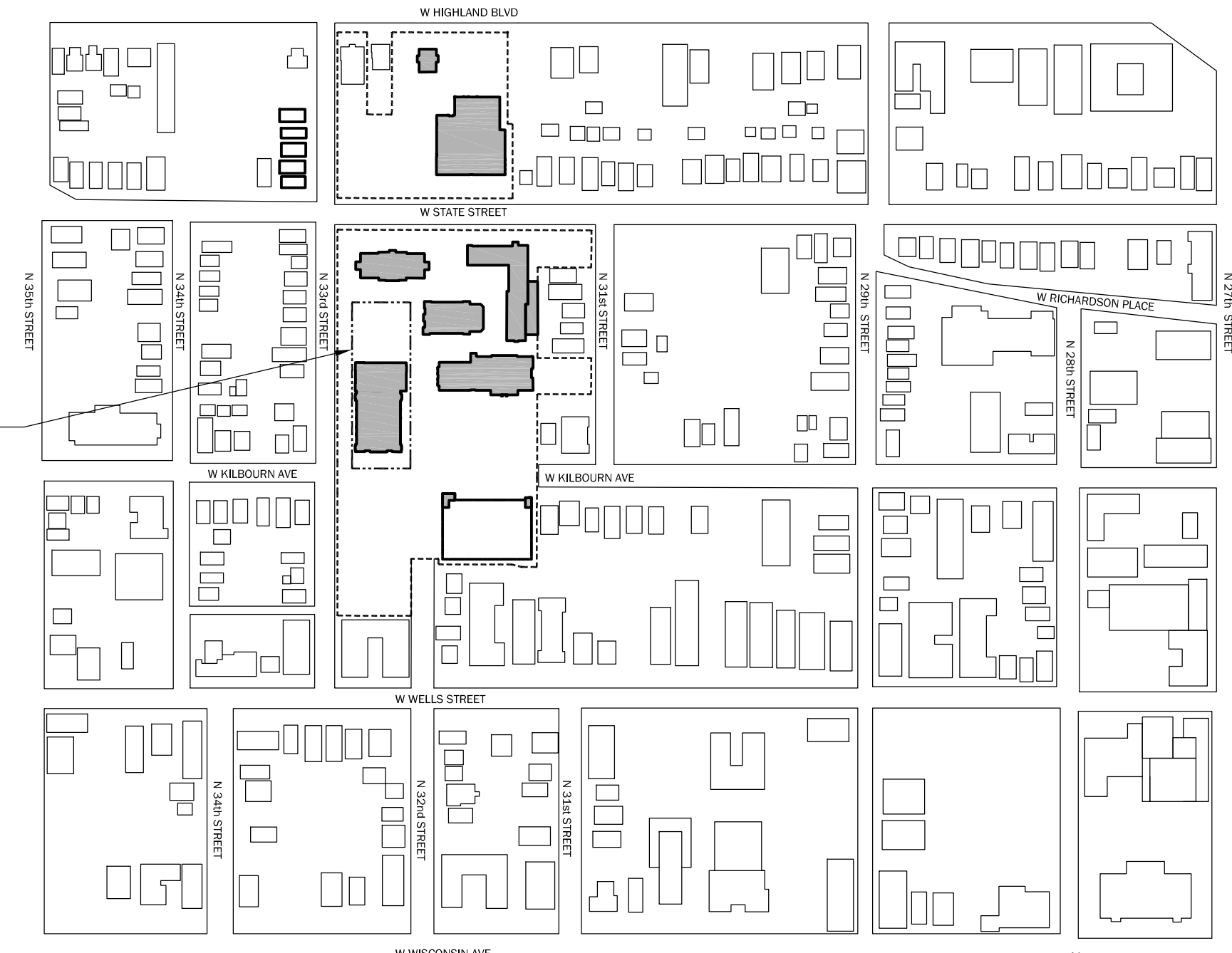

1 FIGURE GROUND MAP
 SCALE: 1" = 300'-0"

GPD BOUNDARY
 DPD BOUNDARY

Jan 10, 2022 - 5:31pm
 C:\15 Projects\15014-00 Wgema Campus\GPD - 2021-12-01\15014-00_GPD_5_Proposed Site Plan.dwg