



CITY OF MILWAUKEE  
OFFICE OF THE CITY CLERK

Thursday, November 01, 2018

COMMITTEE MEETING NOTICE

AD 07

DHINDSA, Amandeep K, Agent  
Indertip Corp  
8175 S 77th St

Franklin, WI 53132

You are requested to attend a hearing which is to be held in Room 301-B, Third Floor, City Hall on:

**Wednesday, November 14, 2018 at 10:00 AM**

**Regarding:** Your Class A Malt & Class A Liquor License Application as a [redacted] for "Indertip Corp" for "Vienna Mini Mart" at 3801 N 39th St.

There is a possibility that your application may be denied for one or more of the following reasons: The recommendation of the committee regarding the application shall be based on evidence presented at the hearing. Per MCO 85-2.7-4, probative evidence concerning whether or not a new license should be granted may be presented on the following subjects: whether or not the applicant meets the municipal requirements, the appropriateness of the location and premises where the licensed premises is to be located and whether use of the premises for the purposes or activities permitted by the license would tend to facilitate a public or private nuisance or create undesirable neighborhood problems such as disorderly patrons, unreasonably loud noise, litter, and excessive traffic and parking congestion. Probative evidence relating to these matters may be taken from the plan of operation submitted with the license application, if any, but shall not include the content of any music. Evidence regarding the fitness of the location of the premises to be maintained as the principal place of business, including but not limited to whether there is an overconcentration of businesses of the type for which the license is sought; whether the proposal is consistent with any pertinent neighborhood business or development plans, or the location's proximity to areas where children are typically present. The applicant's record in operating similarly licensed premises; and whether or not the applicant has been charged with or convicted of any felony, misdemeanor, municipal offense or other offense, the circumstances of which substantially relate to the activity to be permitted by the license being applied for or any other factor which reasonably relates to the public health, safety or welfare may also be considered. See attached police report or correspondence.

**Notice for applicants with warrants or unpaid fines:**

Proof of warrant satisfaction or payment of fines must be submitted at the hearing on the above date and time. Failure to comply with this requirement may result in a delay of the granting/denial of your application.

Failure to appear at this meeting may result in the denial of your license. Individual applicants must appear only in person or by an attorney. Corporate or Limited Liability applicants must appear only by the agent designated on the application or by an attorney. Partnership applicants must appear by a partner listed on the application or by an attorney. If you wish to do so and at your own expense, you may be accompanied by an attorney of your choosing to represent you at this hearing.

You will be given an opportunity to speak on behalf of the application and to respond and challenge any charges or reasons given for the denial. No petitions can be accepted by the committee, unless the people who signed the petition are present at the committee hearing and willing to testify. You may present witnesses under oath and you may also confront and cross-examine opposing witnesses under oath. If you have difficulty with the English language, you should bring an interpreter with you, at your expense, so that you can answer questions and participate in your hearing.

You may examine the application file at this office during regular business hours prior to the hearing date. Inquiries regarding this matter may be directed to the person whose signature appears below.

Limited parking for persons attending meetings in City Hall is available at reduced rates (5 hour limit) at the Milwaukee Center on the southwest corner of East Kilbourn and North Water Street. Parking tickets must be validated in the first floor information booth in City Hall.

PLEASE NOTE: Upon reasonable notice, efforts will be made to accommodate the needs of disabled individuals through sign language interpreters or other auxiliary aids. For additional information or to request this service, contact the Council Services Division ADA Coordinator at (414) 286-2998, Fax - (414) 286-3456, TDD - (414) 286-2025.

JIM OWCZARSKI, CITY CLERK

BY: \_\_\_\_\_

Jessica Ceella

License Division Manager

If you have questions regarding this notice, please contact the License Division at (414) 286-2238.

200 E. Wells Street, Room 105, City Hall, Milwaukee, WI 53202. [www.milwaukee.gov/license](http://www.milwaukee.gov/license)  
Phone: (414) 286-2238 Fax: (414) 286-3057 Email Address: [License@milwaukee.gov](mailto:License@milwaukee.gov)

**Moon Siefert, Linda**

---

**To:** Cooney, Jim  
**Subject:** RE: Objection to Liquor license .

**REDACTED RECORD**

---

**From:** .  
**Sent:** Wednesday, October 24, 2018 7:05 PM  
**To:** License  
**Subject:** Objection to Liquor license

We have lived on 39th street in the same block as the Vienna Mini Mart for 11 years. We have witnessed a variety of conditions on the block as a result of the store's presence. The street and yards are often littered with food wrappers, beer cans and black grocery bags. It is not unusual to see people loitering outside of the store or cars double parked to go into the store. It is our opinion that adding the sale of liquor to the mix would possibly exacerbate the negative situations and draw more traffic, litter and possible unsavory and or violent behavior in the area. We therefore object to the issuance of the Class A Liquor and Class A Malt license to Vienna Mini Mart.

Sincerely,

# MILWAUKEE POLICE DEPARTMENT LICENSING

## CRIMINAL RECORD/ORDINANCE VIOLATION/INCIDENTS SYNOPSIS

**DATE:** 10/24/2018  
**LICENSE TYPE:** ALQML  
**NEW:**   
**RENEWAL:**

**No. 283747**  
**Application Date:** 10/17/2018

**License Location:** 3801 N. 39<sup>th</sup> Street  
**Business Name:** Indertip

**Licensee/Applicant:** Dhindsa, Amandeep K  
(Last Name, First Name, MI)

**Date of Birth:** 05/12/1969

**Home Address:** 8175 S. 77<sup>th</sup> Street  
**City:** Franklin **State:** WI **Zip Code:** 53132  
**Home Phone:** 414-702-5812

This report is written by Police Officer David NOVAK, assigned to the License Investigation Unit, Days.

The Milwaukee Police Department's investigation regarding this application revealed the following:

1. On 06/23/2017 Milwaukee police conducted a licensed premise check at 3500 N. Port Washington (Corner Liquor). Officers discovered that the sole employee on the scene did not possess a Class D Operator's license and issued the 50% shareholder a citation.

**Charge:** Responsible Person on Premises Required  
**Finding:** Guilty  
**Sentence:** \$250.00 fine  
**Date:** 09/06/2017  
**Case:** 17029221

2. On 01/19/2018 the 50% shareholder was cited in the City of Milwaukee at 3500 N. Port Washington Rd for Responsible Person on Premises Required.

**Charge:** Responsible Person on Premises Required  
**Finding:** Guilty  
**Sentence:** Fined \$220.00  
**Date:** 04/25/2018  
**Case:** 18021144

# Alcohol License Concentration for 3801 N 39th St

City of Milwaukee, Wisconsin

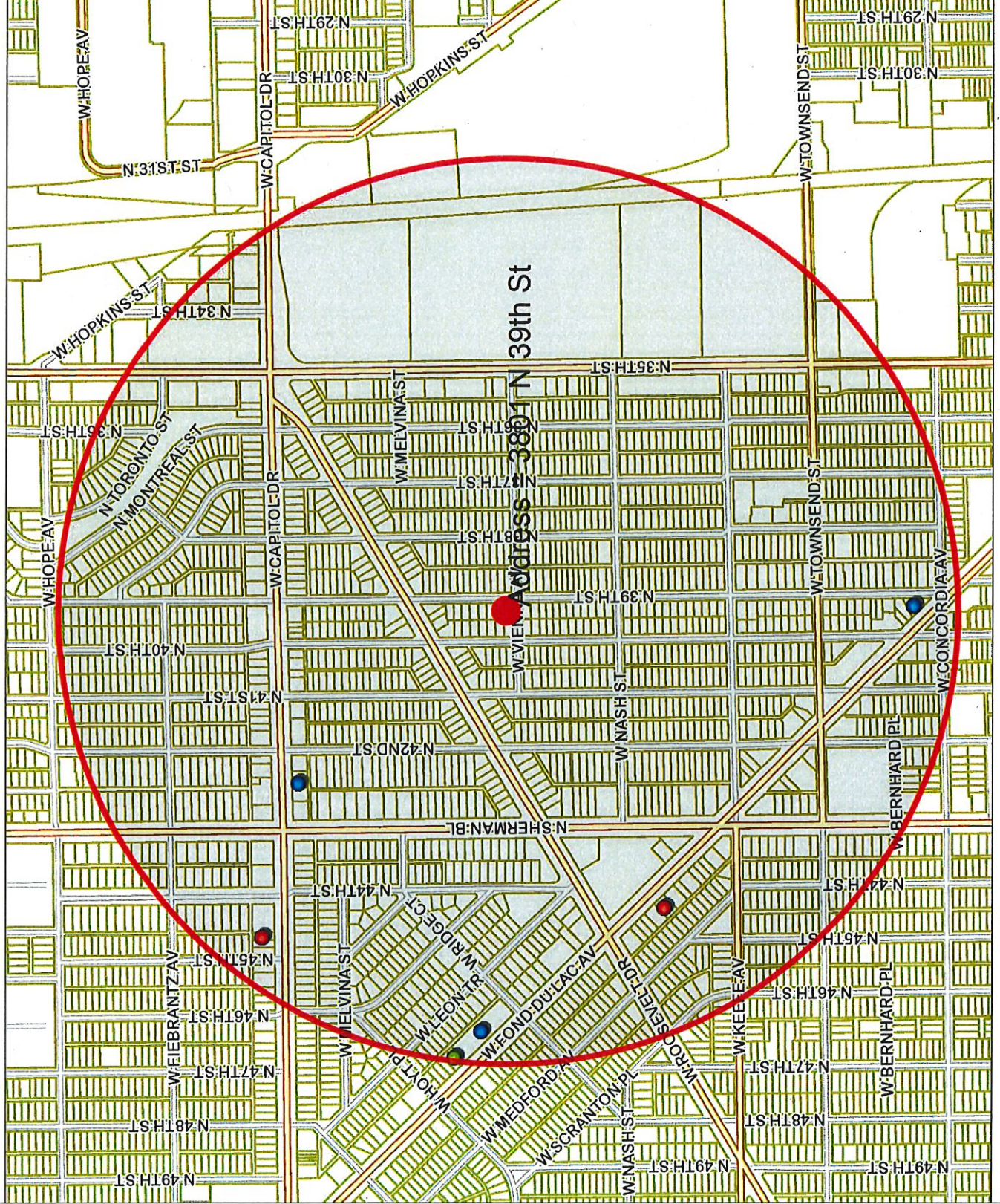

Map Scale: 1: 10,000

833.3 0 416.67 833.3 Feet

© City of Milwaukee, Wisconsin  
 Map Milwaukee: Property Information  
 Disclaimer  
 10/22/2018



## - Legend -

- Street names 10,000
- City limits
- Freeways 15,000
- Freeways
- Exit ramps
- Entry ramps
- Ramps
- Major streets 10,000
- Streets 10,000
- Waterways
- Milwaukee Parcels
- Alcohol licenses
  - Class A intoxicating liquor
  - Class A fermented malt beverage
  - Class A liquor and malt
  - Class B fermented malt beverage
  - Class B tavern
  - Class C wine retailer



## - Notes -

Licensed alcohol beverage establishments within a half mile radius centered on 3801 N 39th st, October 22, 2018



Department of Administration - ITMD

Licensed Alcohol Beverage Establishments Within a Half Mile Radius Centered on 3801 N 39th ST on October 22, 2018						
License Summary						
					Total	
Class A Fermented Malt Beverage Retailer's License						1
Class A Malt & Class A Liquor License						2
Class B Tavern License						3
Class C Wine Retailer's License						1
Legal entity	Trade name	License type name	Total capacity	Address	Expiration date	
Indertip Corp	Vienna Mini Mart	Class A Fermented Malt Beverage Retailer's License		3801 N 39th ST	1/13/2019	
DN Group LLC	Best Buy Liquor	Class A Malt & Class A Liquor License		4426 W Capitol DR	10/23/2019	
PARMSAT, INC	NORTHEM BEVERAGE II	Class A Malt & Class A Liquor License		4409 W FOND DU LAC AV	3/3/2019	
IN AETERNUM, INC	GENE BAR & GRILL	Class B Tavern License	120	3910 W FOND DU LAC AV	6/1/2019	
JLJones LLC	Mir J's Lounge	Class B Tavern License		4610 W FOND DU LAC AV F	1/20/2019	
M & J LOUNGE, INC	M & J CAP TAP	Class B Tavern License	47	4221 W CAPITOL DR	10/9/2019	
Elation Wine & Dessert Bar, LLC	Elation Wine & Dessert Bar	Class C Wine Retailer's License		4706-08 W Fond du Lac AV	5/2/2019	



Thursday, November 01, 2018

## Licenses Committee Notice of Hearing

Tipinder LLC  
8175 S 77th St  
Franklin, WI 53132

Date: 11/14/2018  
Time: 10:00 AM  
Location: Room 301-B, Third Floor, City Hall

The Licenses Committee will consider the following license application:

Class A Malt & Class A Liquor License Application  
DHINDSA, Amandeep K, Agent  
Vienna Mini Mart at 3801 N 39th St

Please note this application may be recommended for denial based on fitness of the location due to concentration of alcohol beverage outlets in the area. If the application is denied for this reason, no other application for an alcohol beverage license for this location shall be recommended for approval by the Licenses Committee within three years of the date of denial unless the applicant has demonstrated a change of circumstances since the prior denial.

If you have any questions, please call (414) 286-2238.





Thursday, November 01, 2018



# Notice of Public Hearing

---

DHINDSA, Amandeep K, Agent  
Vienna Mini Mart at 3801 N 39th St  
Class A Malt & Class A Liquor License Application

**Wednesday, November 14, 2018 at 10:00 AM**

To whom it may concern:

The above application has been made by the above named applicant(s). This requires approval from the Licenses Committee and the Common Council of the City of Milwaukee. The hearing before the Licenses Committee will take place on 11/14/2018 at 10:00 AM, in Room 301-B, Third Floor, City Hall. If you wish, you may provide testimony at the hearing regarding the request; see below for further information. You are not required to attend the hearing. Once the Licenses Committee makes its recommendation, this recommendation is forwarded to the full Common Council for approval at its next regularly scheduled hearing. Please review the information below and if you have further questions regarding this process, please contact the License Division at (414) 286-2238.

---

## Important details for those wishing to provide information for the Licenses Committee to consider when making its recommendation:

1. The license application is scheduled to be heard at the above time. Due to other hearings running longer than scheduled, you may have to wait some time to provide your testimony.
2. You must appear in person and testify as to matters that you have personally experienced or seen. (You cannot provide testimony for your neighbor, parent or anyone else; this is considered hearsay and cannot be considered by the committee.)
3. No letters or petitions can be accepted by the committee (unless the person who wrote the letter or the persons who signed the petition are present at the committee hearing and willing to testify).
4. Persons opposed to the license application are given the opportunity to testify first; supporters may testify after the opponents have finished.
5. When you are called to testify, you will be sworn in and asked to give your name, and address. (If your first and/or last names are uncommon please spell them.)
6. You may then provide testimony.
  - a. Include only information relating to the above license application.
  - b. Include only information you have personally witnessed or seen.
  - c. Provide concise and relevant information detailing how this business has affected or may affect the peaceful enjoyment of your neighborhood.
  - d. If by the time you have the opportunity to testify, the information you wish to share has already been provided to the committee, you may state that you agree with the previous testimony. Redundant or repetitive testimony will not assist the committee in making its recommendation.
7. After giving your testimony, the members of the Licenses Committee and the licensee may ask questions regarding the testimony you have given or other factors relating to the license application.
8. Business Competition is not a valid basis for denial or non-renewal of a license.  
**Please Note: If you have submitted an objection to the above application your objection cannot be considered by the committee unless you personally testify at the hearing.**

OCCUPANT	MAIL ADDRESS	CITY, STATE ZIP
CURRENT OCCUPANT	3824 N 40TH ST	MILWAUKEE, WI 53216
CURRENT OCCUPANT	3816 N 40TH ST	MILWAUKEE, WI 53216
CURRENT OCCUPANT	3758A N 40TH ST	MILWAUKEE, WI 53216
CURRENT OCCUPANT	3749 N 39TH ST	MILWAUKEE, WI 53216
CURRENT OCCUPANT	3807 N 38TH ST	MILWAUKEE, WI 53216
CURRENT OCCUPANT	3753 N 40TH ST	MILWAUKEE, WI 53216
CURRENT OCCUPANT	3837 N 39TH ST	MILWAUKEE, WI 53216
CURRENT OCCUPANT	3834A N 39TH ST	MILWAUKEE, WI 53216
CURRENT OCCUPANT	3806 N 39TH ST	MILWAUKEE, WI 53216
CURRENT OCCUPANT	3823 N 38TH ST	MILWAUKEE, WI 53216
CURRENT OCCUPANT	3825 N 38TH ST	MILWAUKEE, WI 53216
CURRENT OCCUPANT	3803 N 38TH ST	MILWAUKEE, WI 53216
CURRENT OCCUPANT	3769 N 38TH ST	MILWAUKEE, WI 53216
CURRENT OCCUPANT	3801 N 40TH ST	MILWAUKEE, WI 53216
CURRENT OCCUPANT	3815A N 40TH ST	MILWAUKEE, WI 53216
CURRENT OCCUPANT	3830 N 40TH ST	MILWAUKEE, WI 53216
CURRENT OCCUPANT	3766A N 40TH ST	MILWAUKEE, WI 53216
CURRENT OCCUPANT	3821 N 39TH ST	MILWAUKEE, WI 53216
CURRENT OCCUPANT	3823 N 39TH ST	MILWAUKEE, WI 53216
CURRENT OCCUPANT	3805 N 39TH ST	MILWAUKEE, WI 53216
CURRENT OCCUPANT	3828 N 39TH ST	MILWAUKEE, WI 53216
CURRENT OCCUPANT	3750 N 39TH ST	MILWAUKEE, WI 53216
CURRENT OCCUPANT	3744 N 39TH ST	MILWAUKEE, WI 53216
CURRENT OCCUPANT	3809 N 40TH ST	MILWAUKEE, WI 53216
CURRENT OCCUPANT	3836 N 40TH ST	MILWAUKEE, WI 53216
CURRENT OCCUPANT	3831A N 39TH ST	MILWAUKEE, WI 53216
CURRENT OCCUPANT	3809 N 39TH ST	MILWAUKEE, WI 53216
CURRENT OCCUPANT	3745 N 39TH ST	MILWAUKEE, WI 53216
CURRENT OCCUPANT	3838 N 39TH ST	MILWAUKEE, WI 53216
CURRENT OCCUPANT	3809 N 38TH ST	MILWAUKEE, WI 53216
CURRENT OCCUPANT	3755 N 40TH ST	MILWAUKEE, WI 53216
CURRENT OCCUPANT	3831 N 39TH ST	MILWAUKEE, WI 53216
CURRENT OCCUPANT	3808 N 39TH ST	MILWAUKEE, WI 53216
CURRENT OCCUPANT	3768 N 39TH ST	MILWAUKEE, WI 53216
CURRENT OCCUPANT	3821 N 40TH ST	MILWAUKEE, WI 53216
CURRENT OCCUPANT	3810 N 40TH ST	MILWAUKEE, WI 53216
CURRENT OCCUPANT	3748 N 40TH ST	MILWAUKEE, WI 53216
CURRENT OCCUPANT	3843 N 39TH ST	MILWAUKEE, WI 53216
CURRENT OCCUPANT	3803 N 39TH ST 2	MILWAUKEE, WI 53216
CURRENT OCCUPANT	3803 N 39TH ST 1	MILWAUKEE, WI 53216
CURRENT OCCUPANT	3834 N 39TH ST	MILWAUKEE, WI 53216
CURRENT OCCUPANT	3822 N 39TH ST	MILWAUKEE, WI 53216
CURRENT OCCUPANT	3818 N 39TH ST	MILWAUKEE, WI 53216
CURRENT OCCUPANT	3830 W VIENNA AVE	MILWAUKEE, WI 53216
CURRENT OCCUPANT	3819 N 38TH ST	MILWAUKEE, WI 53216
CURRENT OCCUPANT	3815 N 38TH ST	MILWAUKEE, WI 53216



CURRENT OCCUPANT	3759 N 40TH ST	MILWAUKEE, WI 53216
CURRENT OCCUPANT	3769 N 40TH ST	MILWAUKEE, WI 53216
CURRENT OCCUPANT	3815 N 40TH ST	MILWAUKEE, WI 53216
CURRENT OCCUPANT	3825 N 40TH ST	MILWAUKEE, WI 53216
CURRENT OCCUPANT	3842 N 40TH ST	MILWAUKEE, WI 53216
CURRENT OCCUPANT	3800 N 40TH ST	MILWAUKEE, WI 53216
CURRENT OCCUPANT	3766 N 40TH ST	MILWAUKEE, WI 53216
CURRENT OCCUPANT	3754 N 40TH ST	MILWAUKEE, WI 53216
CURRENT OCCUPANT	3744 N 40TH ST	MILWAUKEE, WI 53216
CURRENT OCCUPANT	3817 N 39TH ST	MILWAUKEE, WI 53216
CURRENT OCCUPANT	3811 N 39TH ST	MILWAUKEE, WI 53216
CURRENT OCCUPANT	3761 N 39TH ST	MILWAUKEE, WI 53216
CURRENT OCCUPANT	3763 N 38TH ST	MILWAUKEE, WI 53216
CURRENT OCCUPANT	3819 N 40TH ST	MILWAUKEE, WI 53216
CURRENT OCCUPANT	3758 N 40TH ST	MILWAUKEE, WI 53216
CURRENT OCCUPANT	3769 N 39TH ST	MILWAUKEE, WI 53216
CURRENT OCCUPANT	3755 N 39TH ST	MILWAUKEE, WI 53216
CURRENT OCCUPANT	3812 N 39TH ST	MILWAUKEE, WI 53216
CURRENT OCCUPANT	3762 N 39TH ST	MILWAUKEE, WI 53216
CURRENT OCCUPANT	3756 N 39TH ST	MILWAUKEE, WI 53216
CURRENT OCCUPANT	3746 N 39TH ST	MILWAUKEE, WI 53216
CURRENT OCCUPANT	3765 N 40TH ST	MILWAUKEE, WI 53216

Total Records: 68

Radius: 250.0 feet and Center of Circle: 3801 N 39th St



# BUSINESS LICENSE PLAN OF OPERATION

ccl-busplan 3/15/18

Office of the City Clerk License Division  
200 E. Wells St. Room 105, Milwaukee, WI 53202  
(414) 286-2238 www.milwaukee.gov/license e-mail address: license@milwaukee.gov

## 1. Type of Business

- Applying for:  Extended Hours (12AM to 5AM) - If a food establishment, check all that apply:  Delivery  Drive Thru  Dining Room  
 Self Service Laundry  Massage Establishment  Filling Station  
 Other (supplemental application for specific license also required)

Provide a detailed description of the type of business you plan on operating:

BEER, GROCERY, CIGARETTE STORE  
Do you have any experience operating this type of business?  No  Yes If yes, explain: HAS OPERATED TWO LIQUOR STORES FOR 10 YRS

## 2. Business Operations

- a. Proposed Opening Date: 1-15-2020
- b. Is this premise under construction?  No  Yes If yes, list estimated completion date: \_\_\_\_\_
- c. Is this a franchise?  No  Yes
- d. Is this premises currently licensed?  No  Yes If yes, list type of license: FOOD, BEER, CIGARETTE LICENSE
- e. Is the current licensee operating?  No  Yes If no, list date closed: \_\_\_\_\_
- f. Do you have future plans for other businesses, licenses or permits at this location?  No  Yes  
If yes, explain: \_\_\_\_\_
- g. Have you previously held an Extended Hours License in Milwaukee?  No  Yes  
If yes, list address(es): \_\_\_\_\_
- h. Are other businesses operating in the same building?  No  Yes If yes, describe: \_\_\_\_\_

## 3. Litter & Noise

- a. How are grounds kept clean?  Sweep  Pressure Wash  Pick Up Litter  Other: \_\_\_\_\_
- b. How often will grounds be cleaned?  Daily  Weekly  As Needed  Monthly  Other: \_\_\_\_\_
- c. Grounds cleaned by:  Licensee  Building Owner  Employees  Hired Maintenance  Other: \_\_\_\_\_
- d. How are noise issues prevented and/or addressed?  Security  Manager approaches customer(s)  Call Police  
 Signs Posted  Other: \_\_\_\_\_
- e. Will a sound amplification system be used?  No  Yes If yes, describe: \_\_\_\_\_

## 4. Smoking & Sanitation

- a. Are there designated outdoor smoking areas?  No  Yes If yes, describe: \_\_\_\_\_
- b. Number of Garbage Cans: Inside: 3 Locations: BY COUNTER, FRONT DOOR, BEER COOLER  
Outside: 2 Locations: FRONT DOOR, SIDE OF BUILDING
- c. Is a crowd control barrier used?  No  Yes If yes, describe: \_\_\_\_\_
- d. How many restrooms are on the premises? ONE
- e. Name of solid waste contractor:  Advanced Disposal  Waste Management  Other: EDGE DISPOSAL

### 5. Security

- a. Are there onsite parking spaces?  No  Yes If yes, how many? \_\_\_\_\_ and describe the parking security plan: \_\_\_\_\_
- b. Is there a loading zone?  No  Yes If yes, describe the loading area security plan: \_\_\_\_\_
- c. Will you have security personnel on premise?  No  Yes If yes, how many? \_\_\_\_\_ and answer the following:  
 What are their responsibilities? \_\_\_\_\_  
 Is security equipment used?  No  Yes If yes, describe 7 CAMERAS OUTSIDE  
 List their licensing, certification, or training credentials CORNERSTONE SECURITY
- d. Will there be security cameras?  No  Yes If yes, how many? 16 and list locations: FRONT, OUTSIDE, BEER COOLERS, BEHIND COUNTER, BASEMENT
- e. Will searches/identification checks be done upon entry?  No  Yes If yes, describe \_\_\_\_\_

### 6. Percentage of Sales (must total 100%)

Alcohol <u>25</u> %	Food <u>80</u> %	Secondhand Merchandise <u>0</u> %	Precious Metals & Gems <u>0</u> %
Entertainment <u>0</u> %	Cigarettes <u>25</u> %	Personal Services (such as tattoo, body piercing, salon, tailor, tanning, etc.) _____ %	Other _____ % Describe: _____
Pawnbroker Activity _____ %	Salvaged Materials _____ % (such as scrap metal)		

### 7. Businesses/Licenses on the Premises (check all that apply):

**Type 1**

Full Service Restaurant     Cafe/Coffee Shop     Deli or Fast Food Restaurant     Private/Fraternal/Veterans Club

Night Club     Tavern     Cocktail Lounge     Teen Club

Banquet Hall     Sports Facility     Bowling Alley

Hotel/Motel : Number of Floors: \_\_\_\_\_     Rooming House: Number of Floors: \_\_\_\_\_  
 Number of Rooms: \_\_\_\_\_    Number of Rooms: \_\_\_\_\_

**Type 2**

Liquor Store     Corner Store     Supermarket     Convenience Store

Gas Station     Amusement/Phonograph Distributor     Recycling, Salvage or Towing

Used Car Dealer     Personal Service Establishment (such as tattoo business, hair salon, tailor, etc.)     Recording Studio

What other licenses/permits will you hold at this location? (check all that apply)

Occupancy Permit     Cigarette & Tobacco     Gas Station     Extended Hours     Class "B" Tavern     Weights & Measures

Secondhand Dealer     Precious Metal & Gem     Other: EIT

### 8. Legal Capacity (only if a Type 1 premises in #7 above)

Capacity \_\_\_\_\_ (Call the Milwaukee Development Center at 414-286-8211 if you have questions.)

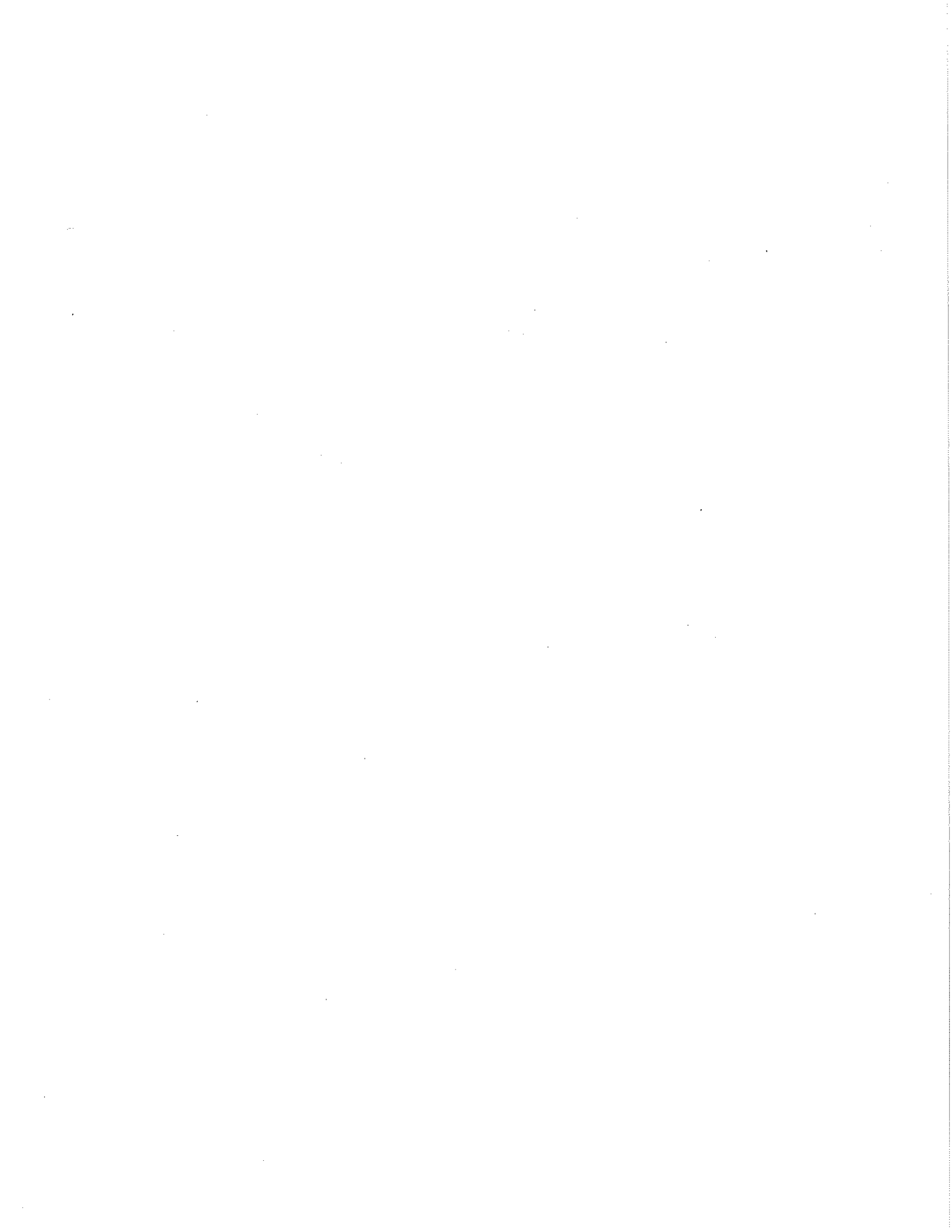

## 9. Premises Description

a. Identify all area(s) of the premises that will be used in operating this business (include areas used only for storage):

1<sup>st</sup> Floor  2<sup>nd</sup> Floor  Basement Storage  Patio  Beer Garden  Sidewalk Café  Deck  Rooftop

Other: Describe: \_\_\_\_\_

b. Describe Location:  Major Thoroughfare  Secondary Street  Other: \_\_\_\_\_

c. Nearest Major Cross Street: VIENNA STREET

d. Describe Building:  Free Standing Building  Strip Mall  Other: \_\_\_\_\_

e. Describe Premises Structure:  Single Story  Multi-Story - # of Stories \_\_\_\_\_  Other: \_\_\_\_\_

f. Describe Surrounding Area:  Commercial  Residential  Industrial  Other: \_\_\_\_\_

g. Building Owner Name: INDERTIP DHINDSA Phone Number: 414 795 8101

Business Owner Address: TIPINDER LLC  
8175 S 77th St FRANKLIN WI 53132

## 10. Hours of Operation & Customers

Will customers be entering the premises?  No  Yes

Day of the Week	Proposed Hours of Operation:		Estimated Number of Customers expected each day	Potential Age Range of Customers	Class B Tavern Applicant Only: Age Restriction (If none, write 'None')
	Open Time (include a.m. or p.m.)	Close Time (include a.m. or p.m.)			
Sunday	8 AM	9 PM	200	15-70	
Monday	8 AM	9 PM	225	15-70	
Tuesday	8 AM	9 PM	225	15-70	
Wednesday	8 AM	9 PM	175	15-70	
Thursday	8 AM	9 PM	200	15-70	
Friday	8 AM	9 PM	260	15-70	
Saturday	8 AM	9 PM	260	15-70	

An Extended Hours Establishment License is required for any convenience store, filling station, personal service establishment (such as tattoo, body piercing, salon, tailor, tanning, etc.), recording studio or restaurant which is open between the hours of 12:00 a.m. and 5:00 a.m.

Alcohol Establishments Class A: 8:00 am to 9:00 pm Sunday thru Saturday

Permitted Hours of Operation: Class B: 6:00 am to 2:00 am Sunday thru Thursday, 6:00 am to 2:30 am Friday & Saturday

Entertainment Outdoor Closing Hours: 10:00pm Sunday-Thursday; 12:00am Friday & Saturday; unless a different time, either earlier or later, is established by the Common Council in its approval of the licensee's plan of operation.

## 11. Signature(s)

Indertip Dhindsa  
Signature of Sole Proprietor, Partner, or 20% or more Shareholder  
(If there are no 20% or more shareholders,  
Corporate Officer-print name/title and sign)

Amanda K Dhindsa  
Signature of additional partner or 20% or more shareholder

See Application Information for a complete list of all required application forms.



# ALCOHOL BEVERAGE & PUBLIC ENTERTAINMENT PREMISES SUPPLEMENTAL APPLICATION

Office of the City Clerk License Division  
200 E. Wells St. Room 105, Milwaukee, WI 53202  
(414) 286-2238 e-mail address: license@milwaukee.gov [www.milwaukee.gov/license](http://www.milwaukee.gov/license)

Legal Entity Name: <u>INDERTIP CORP</u>	
Premise Address: <u>3801 N 39th ST MILWAUKEE</u>	
<u>WI-53216</u>	
<b>Proximity of Premises to Church, School, Daycare Center or Hospital</b>	
Is the building within 300 feet of any church, school, daycare center or hospital? <input type="checkbox"/> No <input checked="" type="checkbox"/> Yes	
<b>"Service Bar Only" Designation</b>	
If applying for Class B or C license, are you applying for "Service Bar Only"? <input type="checkbox"/> No <input type="checkbox"/> Yes	
Service Bar Only means customers cannot sit at the bar. Alcohol is served to employees who serve patrons seated at tables. No stools, chairs or other articles of furniture shall be placed at the service bar for patrons to sit upon.	
<b>Business Information</b>	
a) Are you taking out this application for anyone that may not be eligible for a license? <input checked="" type="checkbox"/> No <input type="checkbox"/> Yes	
If yes, list their name and address: _____	
b) Will the agent, a partner or the individual licensee be conducting the day-to-day operations of the business? <input type="checkbox"/> No <input checked="" type="checkbox"/> Yes	
If no, list the name and address of the person(s) who will: _____	
Class B Applicants: If the agent, a partner or the individual licensee will not be conducting the day-to-day operations of the business, the person(s) listed above must obtain a Class B Managers license.	
c) Does anyone else have money invested or any other interest in this business? <input checked="" type="checkbox"/> No <input type="checkbox"/> Yes	
If yes, explain: _____	
d) Have you made an agreement with anyone to repay any loan or any other payments based upon income from the business? <input checked="" type="checkbox"/> No <input type="checkbox"/> Yes	
If yes, list name and address: _____	
<b>Proof of Ownership, Lease, or Offer to Purchase (New &amp; Transfer Applicants Only)</b>	
Submit proof of ownership, lease, or offer to purchase the building with this application.	
A lease or offer to purchase must:	
a) Be in the same legal entity name as that apply for the license <u>YES</u>	
b) Reflect the same address as the premises address on this application <u>YES</u>	
c) Reflect current dates and	
d) Be signed by the lessor/seller and lessee/buyer	
<b>Property Information (New &amp; Transfer Applicants Only)</b>	
a) Do you own or lease the building?	<input checked="" type="checkbox"/> Own <input type="checkbox"/> Lease <u>ASSOCIATE ENTITY TIPINDER LLC</u>
b) Who owns the fixtures (for example, coolers, etc.)?	<u>INDERTIP</u>
c) Are you purchasing the stock and/or fixtures?	<input checked="" type="checkbox"/> No <input type="checkbox"/> Yes If yes, amount paid \$ _____
d) Total amount paid for business	\$ <u>0</u>
e) Total amount paid for goodwill of the business	\$ <u>0</u>
Goodwill comprises the reputation and customer relationships of an existing business. If the price you pay for the business exceeds the fair market value of all of the rest of the assets of the business, the excess may be considered goodwill.	
f) Have you made arrangements with the seller for payment of personal property taxes?	<input checked="" type="checkbox"/> No <input type="checkbox"/> Yes

See Application Information for a list of all required application forms.

### Lease Information (New & Transfer Applicants who are leasing the premises only)

- a) Date lease begins 10/1/18 Ends 9/30/2023
- b) Monthly rental \$ 1200
- c) Do you have an option to renew the lease?  No  Yes
- d) Does your lease allow for assignment to another party without the consent of the owner?  No  Yes
- e) For what length of time have you been guaranteed occupancy (number of years)? 15 YEARS
- f) In addition to paying the monthly rental, will you have to pay anything additional to the owner of the building to guarantee performance of the lease?  No  Yes If yes, explain \_\_\_\_\_
- g) Does the present owner or occupancy object to the granting of your license?  No  Yes  
If yes, explain \_\_\_\_\_

### Change of Agent Applicants Only

- Have there been any changes to the floor plan since the last application was submitted?  No  Yes  
If no, a new floor plan is not required. If yes, submit a new floor plan and explain the change(s): \_\_\_\_\_

### Signature

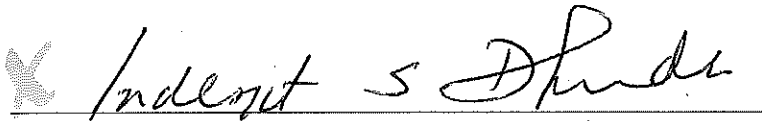
  
Signature of Sole Proprietor, Partner or 20% or More Shareholder  
(If no 20% or more Shareholder, Corporate Officer - print name/title and sign)

Note: All information contained in this application is subject to approval by the Common Council.  
Deviating from approved plan of operation will subject licensee to citations, and/or suspension or non-renewal of the license.  
Contact the License Division for information on how to request changes.

### New and transfer of premise applicants must submit the following:

- Proof of ownership, lease or offer to purchase the building
- Detailed floor plan
- If a restaurant, copy of the menu

# BASEMENT Floor Plan

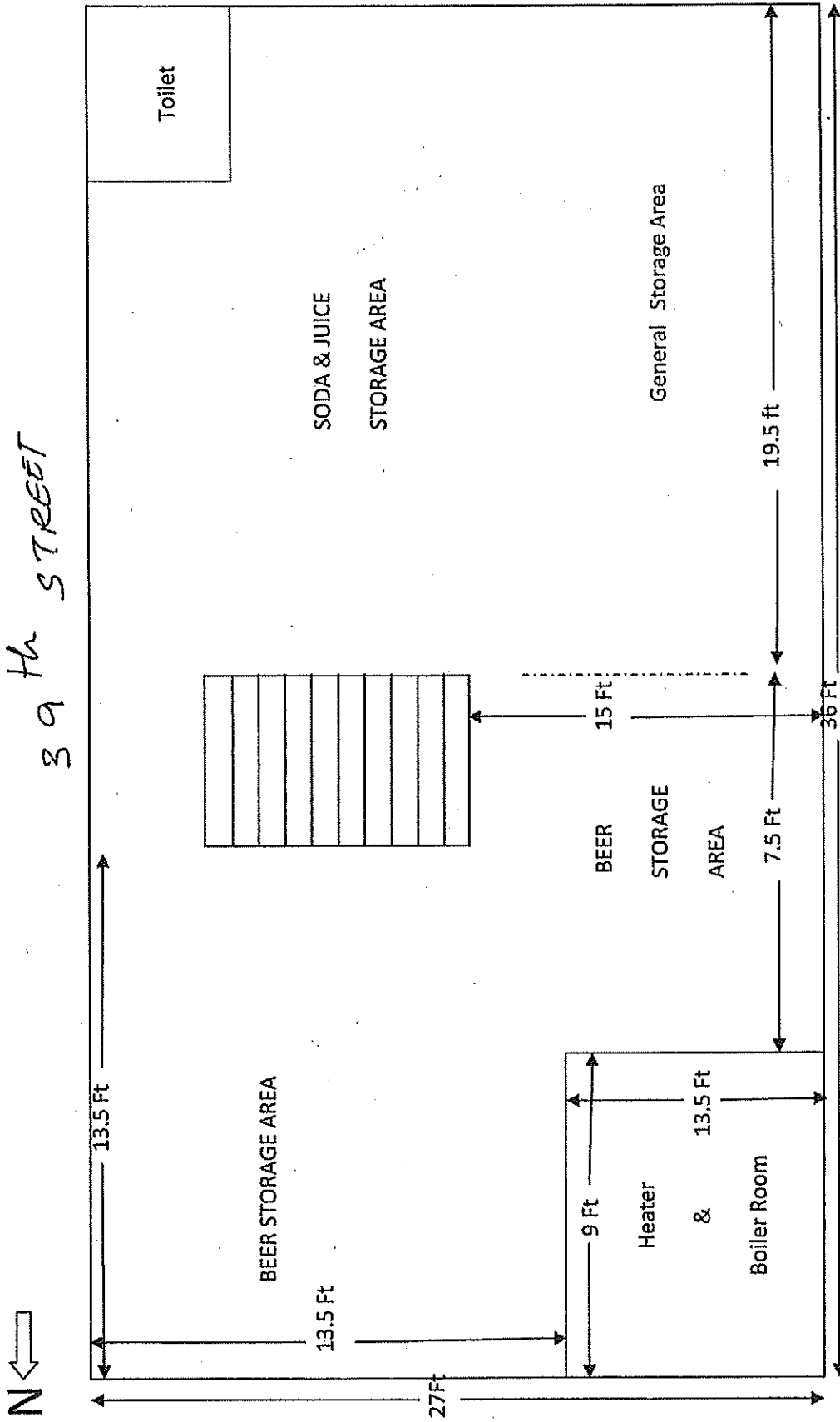

TOTAL SQUARE FOOTAGE = 975 Sq Ft

DATE: 10-17-18

IndechIP Corp  
 Vienna Mini Mart - 3801 N 39th St, Milwaukee, WI - 53216

T. [Signature]

Indrajit S. Dhinesa Agere



RESIDENTIAL

SOUTH

VIENNA ST

38 FEET

RACK

FROZEN FOOD  
14 FEET

COUNTER ENTRANCE

COUNTER ENTRANCE

garbage can

ENTRANCE

Steps

RACK  
garbage can

garbage can

ALCOHOL DISPLAY COUNTER

WEST

40 FEET

1 FOOT

RESIDENTIAL

GROCERY STAND  
18 FEET

FROZEN FOOD

GROCERY STAND  
18 FEET

COOLER  
6 FEET

garbage can

EMERGENCY EXIT

24 FEET

BEER COOLER

NORTH

38 FEET

RESIDENTIAL

10/17/18  
WIZ 53216  
M/WAUCES  
3801 N. 39TH ST  
VIENNA MINI MARKET  
dba  
ANDERTON CORP

39th STREET EAST