



CITY OF MILWAUKEE
OFFICE OF THE CITY CLERK

Wednesday, September 14, 2022

COMMITTEE MEETING NOTICE

AD 09

EUELL-MOSLEY, Annette, Agent
MEGA MARTS, LLC
PO BOX 305103
Nashville, TN 37230

You are requested to attend a hearing which is to be held in Room 301-B, Third Floor, City Hall on:

Tuesday, September 27, 2022 at 10:05 AM

Regarding: Your Permanent Extension of Premise Application for Alcohol Relocating the 2 Pick Up Parking Spots to the North of Entrances as agent for "MEGA MARTS, LLC" for "PICK 'N SAVE #418" at 7401 W GOOD HOPE Rd.

There is a possibility that your application may be denied for one or more of the following reasons: you do not meet the statutory and municipal requirements; the fitness and appropriateness of the location to be licensed and whether the location will create undesirable neighborhood problems (such as disorderly congregations of people, excessive litter, unreasonable noise, and traffic and parking problems), whether or not there is an over-concentration of alcohol beverage establishments in the neighborhood; whether or not you have been charged with or convicted of any felony, misdemeanor, municipal offense or other offense, the circumstances of which substantially relate to the licensed activity; and any other factors which reasonably relate to the public health, safety and welfare. See attached police report and/or written correspondence regarding this application. Please be advised the public will be able to provide information to the committee in person or in writing. The committee will receive and consider evidence regarding the above mentioned criteria.

Notice for applicants with warrants or unpaid fines:

Proof of warrant satisfaction or payment of fines must be submitted at the hearing on the above date and time. Failure to comply with this requirement may result in a delay of the granting/denial of your application.

Failure to appear at this meeting may result in the denial of your license. Individual applicants must appear only in person or by an attorney. Corporate or Limited Liability applicants must appear only by the agent designated on the application or by an attorney. Partnership applicants must appear by a partner listed on the application or by an attorney. If you wish to do so and at your own expense, you may be accompanied by an attorney of your choosing to represent you at this hearing.

You will be given an opportunity to speak on behalf of the application and to respond and challenge any charges or reasons given for the denial. No petitions can be accepted by the committee, unless the people who signed the petition are present at the committee hearing and willing to testify. You may present witnesses under oath and you may also confront and cross-examine opposing witnesses under oath. If you have difficulty with the English language, you should bring an interpreter with you, at your expense, so that you can answer questions and participate in your hearing.

You may examine the application file at this office during regular business hours prior to the hearing date. Inquiries regarding this matter may be directed to the person whose signature appears below.

Limited parking for persons attending meetings in City Hall is available at reduced rates (5 hour limit) at the Milwaukee Center on the southwest corner of East Kilbourn and North Water Street. Parking tickets must be validated in the first floor information booth in City Hall.

PLEASE NOTE: Upon reasonable notice, efforts will be made to accommodate the needs of disabled individuals through sign language interpreters or other auxiliary aids. For additional information or to request this service, contact the Council Services Division ADA Coordinator at (414) 286-2998, Fax - (414) 286-3456, TDD - (414) 286-2025.

JIM OWCZARSKI, CITY CLERK

BY: _____

Jim Cooney
License Division Manager

If you have questions regarding this notice, please contact the License Division at (414) 286-2238.

200 E. Wells Street, Room 105, City Hall, Milwaukee, WI 53202. www.milwaukee.gov/license
Phone: (414) 286-2238 Fax: (414) 286-3057 Email Address: License@milwaukee.gov



Wednesday, September 14, 2022



Notice of Public Hearing

Blank Notice

EUELL-MOSLEY, Annette

PICK 'N SAVE #418 at 7401 W GOOD HOPE Rd.

Permanent Extension of Premise Application for Alcohol Relocating the 2 Pick Up Parking Spots to the North of Entrances

Tuesday, September 27, 2022 at 10:05 AM

To whom it may concern:

The above application has been made by the above named applicant(s). This requires approval from the Licenses Committee and the Common Council of the City of Milwaukee. The hearing before the Licenses Committee will take place virtually on 09/27/2022 at 10:05 AM. This is a public hearing. Those wishing to view the proceeding are able to do so via the City Channel – Channel 25 on Spectrum Cable – or on the Internet at <http://city.milwaukee.gov/citychannel>. Those wishing to provide oral testimony will be asked to do so by phone or internet and are asked to contact the staff assistant, Yadira Melendez at (414) 286-2775 or stasst5@milwaukee.gov for necessary information. Please make such requests no later than one business day prior to the start of the meeting. You are not required to attend the hearing, but please see the information below if you would like to provide testimony. Once the Licenses Committee makes its recommendation, this recommendation is forwarded to the full Common Council for approval at its next regularly scheduled hearing.

Important details for those wishing to provide information for the Licenses Committee to consider when making its recommendation:

1. The license application is scheduled to be heard at the above time. Due to other hearings running longer than scheduled, you may have to wait some time to provide your testimony.
2. You must testify as to matters that you have personally experienced or seen. (You cannot provide testimony for your neighbor, parent or anyone else; this is considered hearsay and cannot be considered by the committee.)
3. No letters or petitions can be accepted by the committee (unless the person who wrote the letter or the persons who signed the petition are willing to testify).
4. Persons opposed to the license application are given the opportunity to testify first; supporters may testify after the opponents have finished.
5. When you are called to testify, you will be sworn in and asked to give your name, and address. (If your first and/or last names are uncommon please spell them.)
6. You may then provide testimony.
 - a. Include only information relating to the above license application.
 - b. Include only information you have personally witnessed or seen.
 - c. Provide concise and relevant information detailing how this business has affected or may affect the peaceful enjoyment of your neighborhood.
 - d. If by the time you have the opportunity to testify, the information you wish to share has already been provided to the committee, you may state that you agree with the previous testimony. Redundant or repetitive testimony will not assist the committee in making its recommendation.
7. After giving your testimony, the members of the Licenses Committee and the licensee may ask questions regarding the testimony you have given or other factors relating to the license application.
8. Business Competition is not a valid basis for denial or non-renewal of a license.

Please Note: If you have submitted an objection to the above application your objection cannot be considered by the committee unless you personally testify at the hearing.

CURRENT OCCUPANT	7717 W GOOD HOPE RD, 420	MILWAUKEE, WI 53223-4517
CURRENT OCCUPANT	7717 W GOOD HOPE RD, 421	MILWAUKEE, WI 53223-4517
CURRENT OCCUPANT	7717 W GOOD HOPE RD, 422	MILWAUKEE, WI 53223-4517
CURRENT OCCUPANT	7717 W GOOD HOPE RD, 501	MILWAUKEE, WI 53223-4519
CURRENT OCCUPANT	7717 W GOOD HOPE RD, 504	MILWAUKEE, WI 53223-4519
CURRENT OCCUPANT	7717 W GOOD HOPE RD, 505	MILWAUKEE, WI 53223-4519
CURRENT OCCUPANT	7717 W GOOD HOPE RD, 506	MILWAUKEE, WI 53223-4519
CURRENT OCCUPANT	7717 W GOOD HOPE RD, 507	MILWAUKEE, WI 53223-4519
CURRENT OCCUPANT	7717 W GOOD HOPE RD, 508	MILWAUKEE, WI 53223-4519
CURRENT OCCUPANT	7717 W GOOD HOPE RD, 509	MILWAUKEE, WI 53223-4519
CURRENT OCCUPANT	7717 W GOOD HOPE RD, 510	MILWAUKEE, WI 53223-4519
CURRENT OCCUPANT	7717 W GOOD HOPE RD, 511	MILWAUKEE, WI 53223-4519
CURRENT OCCUPANT	7717 W GOOD HOPE RD, 512	MILWAUKEE, WI 53223-4519
CURRENT OCCUPANT	7717 W GOOD HOPE RD, 513	MILWAUKEE, WI 53223-4519
CURRENT OCCUPANT	7717 W GOOD HOPE RD, 515	MILWAUKEE, WI 53223-4519
CURRENT OCCUPANT	7717 W GOOD HOPE RD, 516	MILWAUKEE, WI 53223-4519
CURRENT OCCUPANT	7717 W GOOD HOPE RD, 517	MILWAUKEE, WI 53223-4519
CURRENT OCCUPANT	7717 W GOOD HOPE RD, 518	MILWAUKEE, WI 53223-4519
CURRENT OCCUPANT	7717 W GOOD HOPE RD, 519	MILWAUKEE, WI 53223-4519
CURRENT OCCUPANT	7717 W GOOD HOPE RD, 520	MILWAUKEE, WI 53223-4519
CURRENT OCCUPANT	7717 W GOOD HOPE RD, 521	MILWAUKEE, WI 53223-4519
CURRENT OCCUPANT	7717 W GOOD HOPE RD, 522	MILWAUKEE, WI 53223-4519

Blank Notice

Total Records: 68

Radius 500.0 feet and Center of Circle: 7401 W Good Hope Rd



**PERMANENT EXTENSION OF PREMISES APPLICATION
FOOD AND ALCOHOL BEVERAGE ESTABLISHMENTS**

OFFICE OF THE CITY CLERK LICENSE DIVISION
200 E. WELLS ST. ROOM 105, MILWAUKEE, WI 53202
(414) 286-2238 E-MAIL ADDRESS: LICENSE@MILWAUKEE.GOV

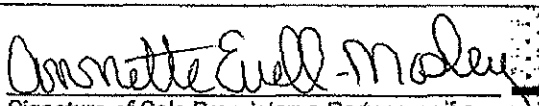
Section A	Date of Application:	Aldermanic District:
	Licensee (Name of individual; partners, or agent, if Corp/LLC): Annette Euell-Mosley	
	Corporation or LLC Name (if applicable): Mega Marts, LLC	Business Name: Pick 'n Save #418
	Business Address (include city, state, zip): 7401 W Good Hope Rd	
	(Optional) Mailing Address (include city, state, zip): Milwaukee, WI 53223	Business Telephone Number: 414-358-0011
Section B	This request is for the permanent extension of premises for a: <input type="checkbox"/> FOOD license <input checked="" type="checkbox"/> ALCOHOL license	
	The Current Premises Description is: <u>First Floor, North Grocery Delivery Parking Spaces</u>	
	Identify the specific area(s) for which the permanent extension of premises is requested. Check all that apply and list for each the relationship of the area to the premises (example: north side, front, etc.)	
	<input type="checkbox"/> Sidewalk café (public sidewalk) at the _____ side of the premises in front of the following street address(es) _____ (area must be contiguous with licensed area and under the licensee's control) (An application for a Siding Dining Facility Permit must also be submitted with this application.)	
	<input type="checkbox"/> Patio (concrete surface) at the _____ side of the premises	
Section C	<input type="checkbox"/> Beer garden (soil/grass surface) at the _____ side of the premises	
	<input type="checkbox"/> Deck (attached to building) at the _____ side of the premises	
	<input type="checkbox"/> Addition to the: <input type="checkbox"/> 1 st floor <input type="checkbox"/> 2 nd floor <input type="checkbox"/> 3 rd floor <input type="checkbox"/> Basement <input type="checkbox"/> Other: _____ at the _____ side of the premises	
	<input checked="" type="checkbox"/> Other: Describe area(s): <u>moving the 2 pick up spots to new location see attached.</u>	
	Does extension area have an additional street address? <input checked="" type="checkbox"/> No <input type="checkbox"/> Yes If yes, list address: _____	
List all type(s) of business(es) that will operate at this location? <input type="checkbox"/> Tavern <input type="checkbox"/> Restaurant <input checked="" type="checkbox"/> Other: Describe: <u>Grocery Store</u>		
 Signature of Sole Proprietor, a Partner, or if a Corporation or LLC, the Agent must sign		

Office Use Only:

Filed 8/15/2022 Initials ON App #: Food _____ Alcohol PERMEXT 3409109

Queue to:

<input type="checkbox"/> DNS (all)	<input type="checkbox"/> Approved	<input type="checkbox"/> Hold
<input type="checkbox"/> HD (all food)	<input type="checkbox"/> Approved	<input type="checkbox"/> Hold
<input type="checkbox"/> CC Food Only (no alcohol)	<input type="checkbox"/> Approved	<input type="checkbox"/> Denied

Email to:

<input type="checkbox"/> DPW (sidewalk cafes/parklets)	<input type="checkbox"/> Approved	<input type="checkbox"/> Hold	<input type="checkbox"/> Sidewalk Dining Facility Permit Issued
--	-----------------------------------	-------------------------------	---

New Licenses Issued: Food _____ Initials _____ Alcohol _____ Initials _____

CITY OF MILWAUKEE
LICENSE DIVISION

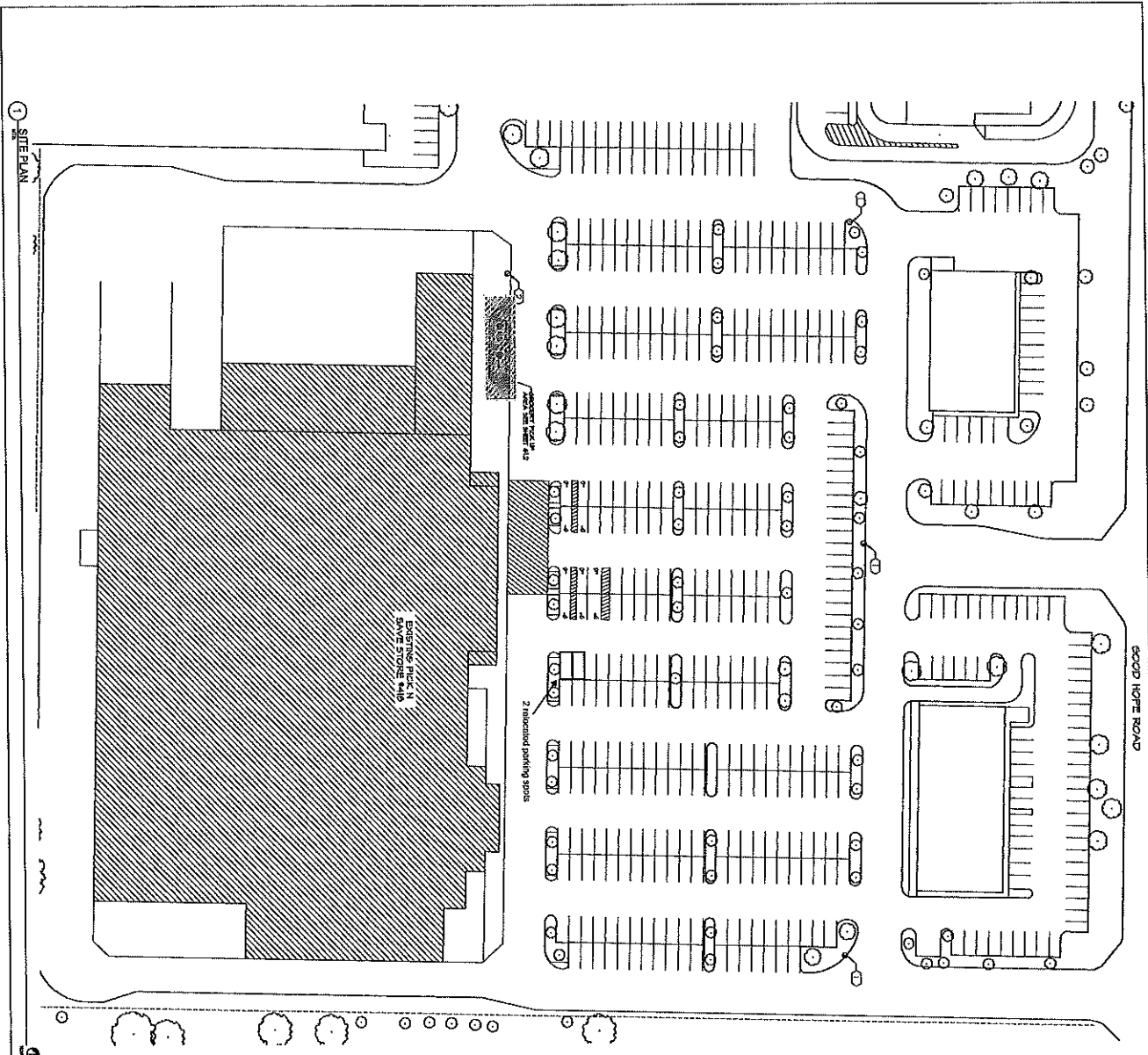

picture of spots

- PARTIAL SITE PLAN GENERAL NOTES:**
1. VERIFY AND CORRECT DATE OF CHANGE TO THIS PLAN TO BE SCHEDULED FOR CONSTRUCTION.
 2. ALL CONSTRUCTION SHALL BE IN ACCORDANCE WITH ALL APPLICABLE ORDINANCES.
 3. ALL CONSTRUCTION SHALL BE IN ACCORDANCE WITH ALL APPLICABLE STATE AND LOCAL CODES & REGULATIONS.
 4. ALL UTILITIES SHALL BE PROTECTED AND DEEPENED FOR THE PROPOSED DRIVEWAY AND DRIVEWAY.
 5. ALL UTILITIES SHALL BE PROTECTED AND DEEPENED FOR THE PROPOSED DRIVEWAY AND DRIVEWAY.
 6. ALL UTILITIES SHALL BE PROTECTED AND DEEPENED FOR THE PROPOSED DRIVEWAY AND DRIVEWAY.
 7. ALL UTILITIES SHALL BE PROTECTED AND DEEPENED FOR THE PROPOSED DRIVEWAY AND DRIVEWAY.
 8. ALL UTILITIES SHALL BE PROTECTED AND DEEPENED FOR THE PROPOSED DRIVEWAY AND DRIVEWAY.
 9. ALL UTILITIES SHALL BE PROTECTED AND DEEPENED FOR THE PROPOSED DRIVEWAY AND DRIVEWAY.
 10. ALL UTILITIES SHALL BE PROTECTED AND DEEPENED FOR THE PROPOSED DRIVEWAY AND DRIVEWAY.
- KEYNOTES:**
1. SHALL CHECK ALL UTILITIES TO BE PROTECTED AND DEEPENED FOR THE PROPOSED DRIVEWAY AND DRIVEWAY.
 2. SHALL CHECK ALL UTILITIES TO BE PROTECTED AND DEEPENED FOR THE PROPOSED DRIVEWAY AND DRIVEWAY.
 3. SHALL CHECK ALL UTILITIES TO BE PROTECTED AND DEEPENED FOR THE PROPOSED DRIVEWAY AND DRIVEWAY.
- NOTES:**
1. ALL CONSTRUCTION SHALL BE IN ACCORDANCE WITH ALL APPLICABLE ORDINANCES.
 2. ALL CONSTRUCTION SHALL BE IN ACCORDANCE WITH ALL APPLICABLE STATE AND LOCAL CODES & REGULATIONS.

<p>G1.1</p>	<p>GROCERY PICK UP SITE PLAN PICK N SAVE 418 7401 GOOD HOPE ROAD MILWAUKEE, WI 53223</p>	 REGIONAL OFFICE FACILITY ENGINEER 1000 N. MILWAUKEE AVENUE MILWAUKEE, WI 53233	<p>ROUNDY'S.</p> <p>ROUNDY'S SUPERMARKETS, INC. DIVISION - THE KROGER CO. 275 EAST BRIDGEMAN MILWAUKEE, WI 53212</p>	<p>API ARCHITECTS</p> <p>2475 PLYMOUTH AVENUE WATKINS ESTABLISHMENT, L. 40112 WATKINS, WI 53091</p>
--------------------	---	---	--	--

Agent: Annette Euell Mosley

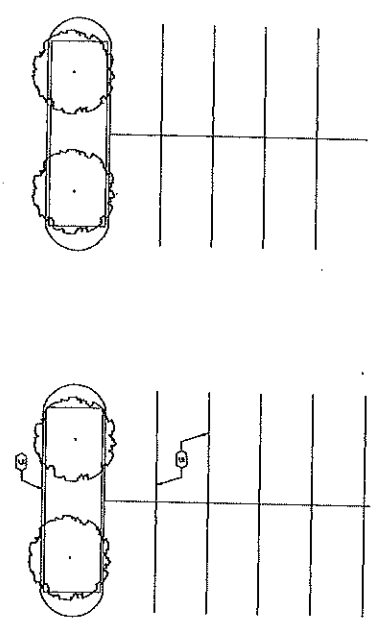

① PARTIAL SITE PLAN
SCALE: 1/8" = 1'-0"

<p>GENERAL NOTES:</p> <ol style="list-style-type: none"> 1. ALL DIMENSIONS ARE TO FACE UNLESS OTHERWISE NOTED. 2. ALL DIMENSIONS ARE TO FACE UNLESS OTHERWISE NOTED. 3. ALL DIMENSIONS ARE TO FACE UNLESS OTHERWISE NOTED. 4. ALL DIMENSIONS ARE TO FACE UNLESS OTHERWISE NOTED. 5. ALL DIMENSIONS ARE TO FACE UNLESS OTHERWISE NOTED. 6. ALL DIMENSIONS ARE TO FACE UNLESS OTHERWISE NOTED. 7. ALL DIMENSIONS ARE TO FACE UNLESS OTHERWISE NOTED. 8. ALL DIMENSIONS ARE TO FACE UNLESS OTHERWISE NOTED. 9. ALL DIMENSIONS ARE TO FACE UNLESS OTHERWISE NOTED. 10. ALL DIMENSIONS ARE TO FACE UNLESS OTHERWISE NOTED. 	<p>GENERAL NOTES:</p> <ol style="list-style-type: none"> 1. ALL DIMENSIONS ARE TO FACE UNLESS OTHERWISE NOTED. 2. ALL DIMENSIONS ARE TO FACE UNLESS OTHERWISE NOTED. 3. ALL DIMENSIONS ARE TO FACE UNLESS OTHERWISE NOTED. 4. ALL DIMENSIONS ARE TO FACE UNLESS OTHERWISE NOTED. 5. ALL DIMENSIONS ARE TO FACE UNLESS OTHERWISE NOTED. 6. ALL DIMENSIONS ARE TO FACE UNLESS OTHERWISE NOTED. 7. ALL DIMENSIONS ARE TO FACE UNLESS OTHERWISE NOTED. 8. ALL DIMENSIONS ARE TO FACE UNLESS OTHERWISE NOTED. 9. ALL DIMENSIONS ARE TO FACE UNLESS OTHERWISE NOTED. 10. ALL DIMENSIONS ARE TO FACE UNLESS OTHERWISE NOTED.
<p>GENERAL NOTES:</p> <ol style="list-style-type: none"> 1. ALL DIMENSIONS ARE TO FACE UNLESS OTHERWISE NOTED. 2. ALL DIMENSIONS ARE TO FACE UNLESS OTHERWISE NOTED. 3. ALL DIMENSIONS ARE TO FACE UNLESS OTHERWISE NOTED. 4. ALL DIMENSIONS ARE TO FACE UNLESS OTHERWISE NOTED. 5. ALL DIMENSIONS ARE TO FACE UNLESS OTHERWISE NOTED. 6. ALL DIMENSIONS ARE TO FACE UNLESS OTHERWISE NOTED. 7. ALL DIMENSIONS ARE TO FACE UNLESS OTHERWISE NOTED. 8. ALL DIMENSIONS ARE TO FACE UNLESS OTHERWISE NOTED. 9. ALL DIMENSIONS ARE TO FACE UNLESS OTHERWISE NOTED. 10. ALL DIMENSIONS ARE TO FACE UNLESS OTHERWISE NOTED. 	<p>GENERAL NOTES:</p> <ol style="list-style-type: none"> 1. ALL DIMENSIONS ARE TO FACE UNLESS OTHERWISE NOTED. 2. ALL DIMENSIONS ARE TO FACE UNLESS OTHERWISE NOTED. 3. ALL DIMENSIONS ARE TO FACE UNLESS OTHERWISE NOTED. 4. ALL DIMENSIONS ARE TO FACE UNLESS OTHERWISE NOTED. 5. ALL DIMENSIONS ARE TO FACE UNLESS OTHERWISE NOTED. 6. ALL DIMENSIONS ARE TO FACE UNLESS OTHERWISE NOTED. 7. ALL DIMENSIONS ARE TO FACE UNLESS OTHERWISE NOTED. 8. ALL DIMENSIONS ARE TO FACE UNLESS OTHERWISE NOTED. 9. ALL DIMENSIONS ARE TO FACE UNLESS OTHERWISE NOTED. 10. ALL DIMENSIONS ARE TO FACE UNLESS OTHERWISE NOTED.

② CHECK IN-LANE GRAPHIC TYPE

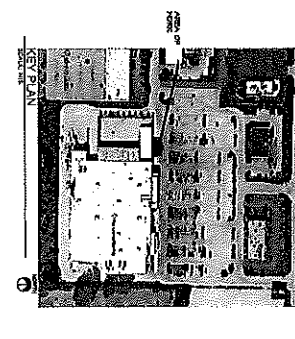
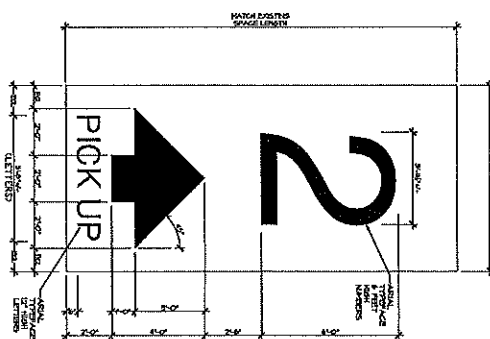

PARTIAL SITE PLAN GENERAL NOTES:

1. ALL DIMENSIONS ARE TO FACE UNLESS OTHERWISE NOTED.
2. ALL DIMENSIONS ARE TO FACE UNLESS OTHERWISE NOTED.
3. ALL DIMENSIONS ARE TO FACE UNLESS OTHERWISE NOTED.
4. ALL DIMENSIONS ARE TO FACE UNLESS OTHERWISE NOTED.
5. ALL DIMENSIONS ARE TO FACE UNLESS OTHERWISE NOTED.
6. ALL DIMENSIONS ARE TO FACE UNLESS OTHERWISE NOTED.
7. ALL DIMENSIONS ARE TO FACE UNLESS OTHERWISE NOTED.
8. ALL DIMENSIONS ARE TO FACE UNLESS OTHERWISE NOTED.
9. ALL DIMENSIONS ARE TO FACE UNLESS OTHERWISE NOTED.
10. ALL DIMENSIONS ARE TO FACE UNLESS OTHERWISE NOTED.

SITE PLAN NOTES:

1. ALL DIMENSIONS ARE TO FACE UNLESS OTHERWISE NOTED.
2. ALL DIMENSIONS ARE TO FACE UNLESS OTHERWISE NOTED.
3. ALL DIMENSIONS ARE TO FACE UNLESS OTHERWISE NOTED.
4. ALL DIMENSIONS ARE TO FACE UNLESS OTHERWISE NOTED.
5. ALL DIMENSIONS ARE TO FACE UNLESS OTHERWISE NOTED.
6. ALL DIMENSIONS ARE TO FACE UNLESS OTHERWISE NOTED.
7. ALL DIMENSIONS ARE TO FACE UNLESS OTHERWISE NOTED.
8. ALL DIMENSIONS ARE TO FACE UNLESS OTHERWISE NOTED.
9. ALL DIMENSIONS ARE TO FACE UNLESS OTHERWISE NOTED.
10. ALL DIMENSIONS ARE TO FACE UNLESS OTHERWISE NOTED.

<p>G1.2</p>	<p>GROCERY PICK UP SITE PLAN PICK N SAVE 418 7401 GOOD HOPE ROAD MILWAUKEE, WI 53223</p>	<p>GENERAL OFFICE FACILITY ENGINEERING</p>	<p>ROUNDY'S. ROUNDY'S SUPERMARKETS, INC. DIVISION - THE KROGER CO. 27 EAST WISCONSIN MILWAUKEE, WI 53201</p>	<p>API ARCHITECTS 1000 W. WISCONSIN AVENUE MILWAUKEE, WI 53233 414.224.4400</p>	<p>DATE: 10/15/10 SCALE: 1/8" = 1'-0"</p>
--------------------	---	---	---	--	--

Agent: Annett Euell Mosley