

**CERTIFIED SURVEY MAP NO.**

**BEING A REDIVISION OF PART OF LOT 6, ALL OF LOTS 7, 8, 9, 10, AND 11, BLOCK 7, SCHMITT'S SUBDIVISION AND LOTS 6 AND 7, BLOCK 7, GARFIELD HEIGHTS, BEING A PART OF THE SOUTHEAST 1/4 OF THE NORTHEAST 1/4 OF SECTION 24, TOWNSHIP 7 NORTH, RANGE 21 EAST, IN THE CITY OF MILWAUKEE, COUNTY OF MILWAUKEE, STATE OF WISCONSIN.**

- - DENOTES 1.315" O.D. IRON PIPE, WEIGHING 1.13 LBS PER LINEAL FOOT, 18" IN LENGTH - SET
- PK - SET PK NAIL AT CORNER

BEARINGS AREA REFERENCED TO AND COMPATIBLE WITH THE EAST LINE OF THE NE 1/4 OF SEC. 24-7-21. ASSUMED BEARING N00°46'08"W.

NORTHEAST CORNER OF THE NORTHEAST 1/4 OF SECTION 24-7-21  
CONC. MON W/BRASS CAP

ALL DIMENSIONS ARE MEASURED AND COMPUTED TO THE NEAREST ONE HUNDREDTH OF A FOOT.

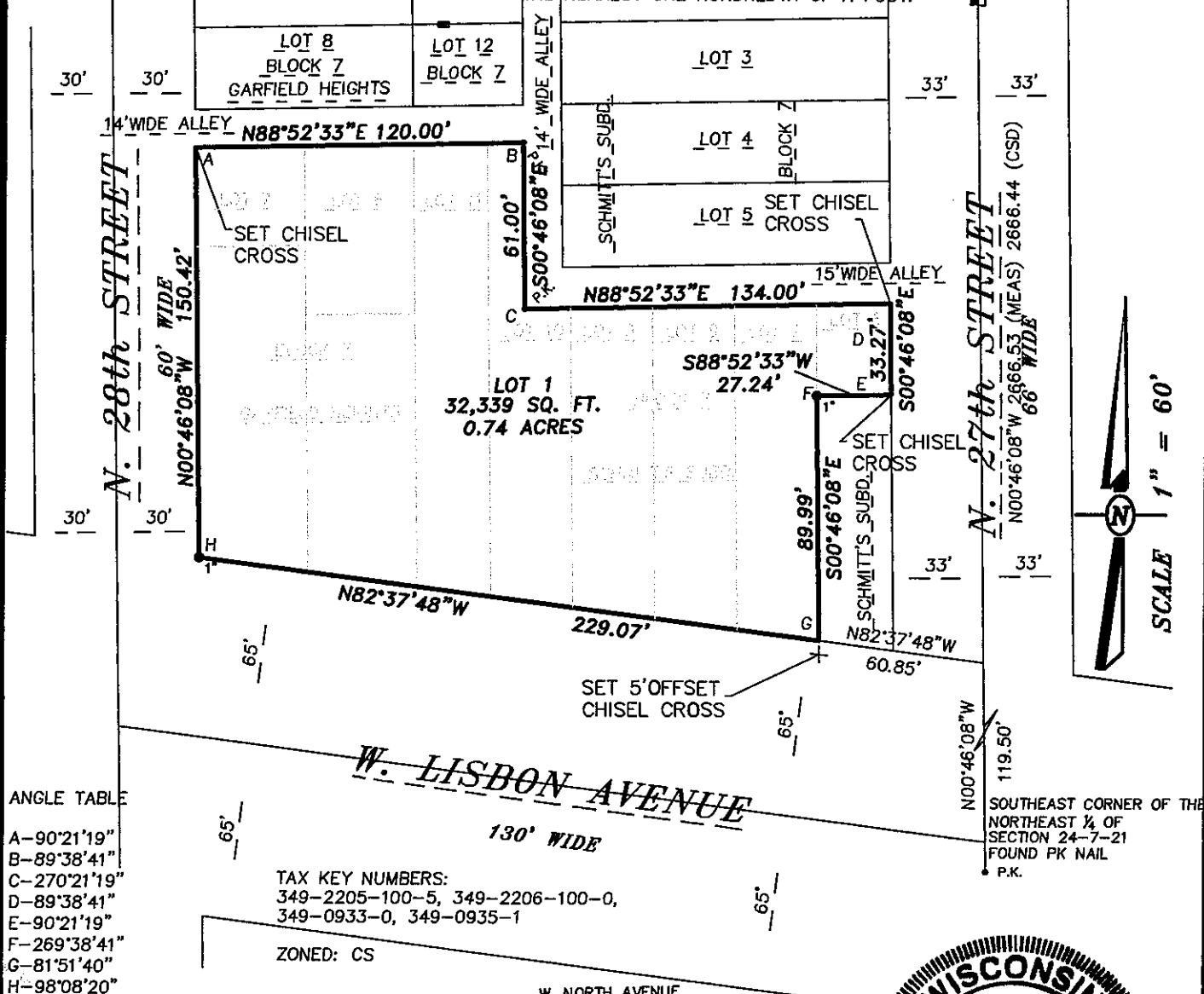

**McClure**  
Engineering Associates, Inc.  
5417 North 118th Court, Milwaukee, WI 53225  
(414) 616-4880 PROJECT NO.: 08-13-10-005  
(414) 616-4885 (FAX)  
DRAWING: TALAND PROJECTS\10005\DWG\10005E1.DWG

**GRAPHIC SCALE**

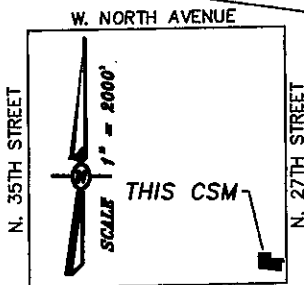
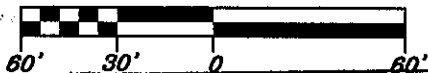

VICINITY MAP  
NE 1/4 SEC. 24-7-21

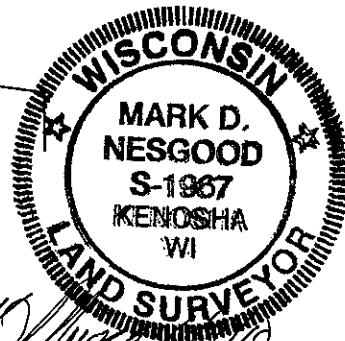

WISCONSIN REGISTERED LAND SURVEYOR  
MARK D. NESGOOD, RLS

DCD  
STAMP

INFRASTRUCTURE SERVICES DIVISION	
MARIA CORNELL 9/1/10 CENTRAL DRAFTING & RECORDS MANAGER	
MARTIN GUNDS 8/31/10 ENGR. IN CHARGE	ENVIRON. ENGR.
CORRECT	
JEFFREY PALANCA 9/1/10 CITY ENGINEER	
APPROVED	

## CERTIFIED SURVEY MAP NO. \_\_\_\_\_

BEING A REDIVISION OF PART OF LOT 6, ALL OF LOTS 7, 8, 9, 10, AND 11,  
 BLOCK 7, SCHMITT'S SUBDIVISION AND LOTS 6 AND 7, BLOCK 7,  
 GARFIELD HEIGHTS, BEING A PART OF THE SOUTHEAST ¼ OF THE  
 NORTHEAST ¼ OF SECTION 24, TOWNSHIP 7 NORTH, RANGE 21 EAST, IN THE  
 CITY OF MILWAUKEE, COUNTY OF MILWAUKEE, STATE OF WISCONSIN.

**SURVEYOR'S CERTIFICATE**

STATE OF WISCONSIN) SS  
 MILWAUKEE COUNTY)

I, Mark D. Nesgood, Registered Land Surveyor, do hereby certify that I have surveyed, divided and mapped a Redivision of part of Lot 6, all of lots 7, 8, 9, 10, and 11, Block 7, Schmitt's Subdivision and Lots 6 and 7, Block 7, Garfield Heights, being a part of the Southeast ¼ of the Northeast ¼ of Section 24, Township 7 North, Range 21 East, in the City of Milwaukee, County of Milwaukee, State of Wisconsin, bounded and described as follows:

Commencing at the Southeast corner of the Northeast ¼ of said Section; thence N00°46'08"W along the East line of the Northeast ¼ of said Section 119.50 feet to a point on the Northerly right-of-way line of W. Lisbon Avenue extended; thence N82°37'48"W along the Northerly right-of-way line of said Avenue extended 60.85 feet to the point of beginning; thence continuing N82°37'48"W along the Northerly right-of-way line of said Avenue 229.07 feet to a point on the East right-of-way line of N. 28<sup>th</sup> Street; thence N00°46'08"W along the East right-of-way line of said Street 150.42 feet to a point on South line of a public alley; thence N88°52'33"E along said South line of said public alley 120.00 feet; thence S00°46'08"E along the West line of said public alley 61.00 feet; thence N88°52'33"E along the South line of said public alley 134.00 feet to a point on the West right-of-way line of N. 27<sup>th</sup> Street; thence S00°46'08"E along the West right-of-way line of said Street 33.27 feet; thence S88°52'33"W 27.24 feet; thence S00°46'08"E 89.99 feet to the point of beginning.

Containing 0.74 acres of land more or less.

That I have made such survey, land division and map by the direction of the Lisbon Terrace, LLC, owner of said land.

That such map is a correct representation of the exterior boundaries of the land surveyed and the land division thereof made.

That I have fully complied with the provisions of Chapter 236 of the Wisconsin Statutes and Chapter 119 of the Milwaukee Code of Ordinances in surveying, dividing and mapping the same.

Dated this 3rd<sup>th</sup> day of June, 2010.

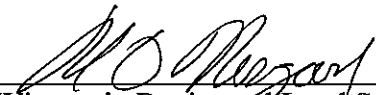

  
 Wisconsin Registered Land Surveyor  
 Mark D. Nesgood S-1967

## CERTIFIED SURVEY MAP NO. \_\_\_\_\_

BEING A REDIVISION OF PART OF LOT 6, ALL OF LOTS 7, 8, 9, 10, AND 11,  
BLOCK 7, SCHMITT'S SUBDIVISION AND LOTS 6 AND 7, BLOCK 7,  
GARFIELD HEIGHTS, BEING A PART OF THE SOUTHEAST ¼ OF THE  
NORTHEAST ¼ OF SECTION 24, TOWNSHIP 7 NORTH, RANGE 21 EAST, IN THE  
CITY OF MILWAUKEE, COUNTY OF MILWAUKEE, STATE OF WISCONSIN.

**CORPORATE OWNER'S CERTIFICATE**

Lisbon Terrace, LLC, a corporation duly organized and existing under and by virtue of the laws of the State of Wisconsin, as owner, certifies that said corporation caused the land described on this map to be surveyed, divided, and mapped as represented on this map in accordance with the requirements of Chapter 119 of the Milwaukee Code of Ordinances.

In consideration of the approval of the map by the Common Council and in accordance with Chapter 119 of the Milwaukee Code, the undersigned agrees:

That all utility lines to provide electrical power and telephone services and cable television or communications systems lines or cables to all lots in the certified survey map shall be installed underground in easements provided therefore, where feasible.

This agreement shall be binding on the undersigned and assigns.

In Witness Whereof, the Lisbon Terrace, LLC has caused these presents to be signed by Louie A. Lange III, its President, at Milwaukee, Wisconsin, this ~~15th~~ day of ~~July~~, 2010.

IN THE PRESENCE OF:

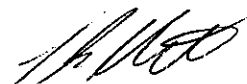
  
\_\_\_\_\_  
Witness

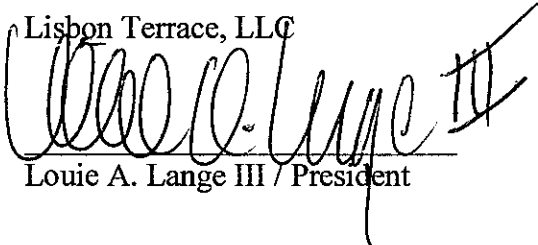
Lisbon Terrace, LLC  
  
\_\_\_\_\_  
Louie A. Lange III / President

\_\_\_\_\_  
Witness

STATE OF WISCONSIN) ss  
MILWAUKEE COUNTY)

PERSONALLY came before me this ~~15th~~ day of ~~July~~, 2010, Louie A. Lange III its President of the above named corporation, to me known to be the person who executed the foregoing instrument, and to me known to be the President of the corporation, and acknowledged that he executed the foregoing instrument as such officer's as the deed of the corporation, by its authority.

  
\_\_\_\_\_  
Notary Public, State of Wisconsin  
My commission expires 4/17/2011

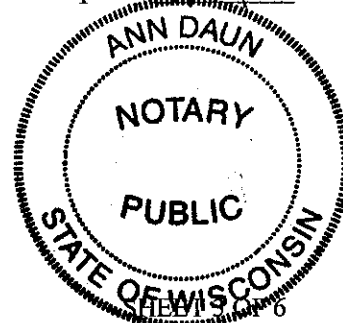

THIS INSTRUMENT WAS DRAFTED BY MARK D. NESGOOD, R.L.S.

CERTIFIED SURVEY MAP NO. \_\_\_\_\_

BEING A REDIVISION OF PART OF LOT 6, ALL OF LOTS 7, 8, 9, 10, AND 11,  
BLOCK 7, SCHMITT'S SUBDIVISION AND LOTS 6 AND 7, BLOCK 7,  
GARFIELD HEIGHTS, BEING A PART OF THE SOUTHEAST ¼ OF THE  
NORTHEAST ¼ OF SECTION 24, TOWNSHIP 7 NORTH, RANGE 21 EAST, IN THE  
CITY OF MILWAUKEE, COUNTY OF MILWAUKEE, STATE OF WISCONSIN.

**CONSENT OF CORPORATE MORTGAGEE**

IFF, an Illinois not-for-profit Corporation, mortgagee of the above described land, does hereby consent to the surveying, dividing dedicating and mapping of the land described on this map, and does hereby consent to the foregoing owner's certificate.

IFF, an Illinois not-for-profit corporation

*Lucy E. Tuck*  
Lucy E. Tuck /Vice President of Lending

STATE OF Illinois )  
Cook COUNTY) SS

Personally came before me this 27 day of July, 2010, Lucy E. Tuck of the above named Corporation, to be known to be the person who executed the foregoing instrument, and to me known to be such Vice President of Lending of said Corporation, and acknowledged that she executed the foregoing instrument as such officer as the deed of said corporation, by its authority.

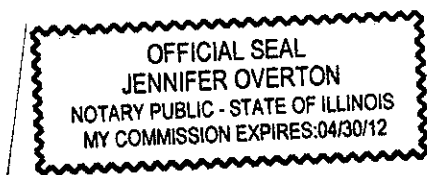

*Jennifer Overton*  
Notary Public, State of Illinois  
My Commission expires April 30, 2012

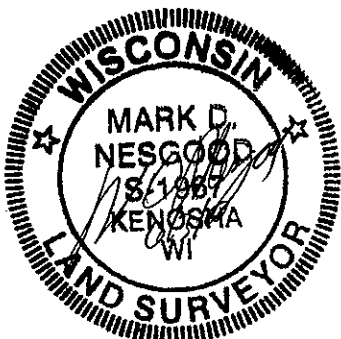

CERTIFIED SURVEY MAP NO. \_\_\_\_\_

BEING A REDIVISION OF PART OF LOT 6, ALL OF LOTS 7, 8, 9, 10, AND 11,  
BLOCK 7, SCHMITT'S SUBDIVISION AND LOTS 6 AND 7, BLOCK 7,  
GARFIELD HEIGHTS, BEING A PART OF THE SOUTHEAST ¼ OF THE  
NORTHEAST ¼ OF SECTION 24, TOWNSHIP 7 NORTH, RANGE 21 EAST, IN THE  
CITY OF MILWAUKEE, COUNTY OF MILWAUKEE, STATE OF WISCONSIN.

CONSENT

Wisconsin Housing and Economic Development Authority, does hereby consent to the  
surveying, dividing dedicating and mapping of the land described on this map, and does  
hereby consent to the foregoing owner's certificate.

Wisconsin Housing and Economic  
Development Authority

Timothy J. Radelet  
Timothy J. Radelet / General Counsel

STATE OF WISCONSIN)  
DANE COUNTY) SS

Personally came before me this 13<sup>th</sup> day of August, 2010, Timothy J.  
Radelet of the above named Corporation, to be known to be the person who executed the  
foregoing instrument, and to me known to be such General Counsel of said Corporation,  
and acknowledged that he executed the foregoing instrument as such officer as the deed  
of said corporation, by its authority.



Patrina White  
Notary Public, State of Wisconsin  
My Commission expires March 10, 2013



CERTIFIED SURVEY MAP NO. \_\_\_\_\_

BEING A REDIVISION OF PART OF LOT 6, ALL OF LOTS 7, 8, 9, 10, AND 11,  
BLOCK 7, SCHMITT'S SUBDIVISION AND LOTS 6 AND 7, BLOCK 7,  
GARFIELD HEIGHTS, BEING A PART OF THE SOUTHEAST ¼ OF THE  
NORTHEAST ¼ OF SECTION 24, TOWNSHIP 7 NORTH, RANGE 21 EAST, IN THE  
CITY OF MILWAUKEE, COUNTY OF MILWAUKEE, STATE OF WISCONSIN.

**CERTIFICATE OF CITY TREASURER**

STATE OF WISCONSIN)  
MILWAUKEE COUNTY)

I, WAYNE F. WHITTOW, being the duly elected, qualified and acting City Treasurer of the City of Milwaukee, do hereby certify that in accordance with the records in the Office of the City Treasurer of the City of Milwaukee, there are no unpaid taxes or unpaid special assessments on the land included in this Certified Survey Map.

Dated this 8<sup>th</sup> day of September, 2010.

Wayne F. Whittow  
WAYNE F. WHITTOW, City Treasurer

**COMMON COUNCIL CERTIFICATE OF APPROVAL**

I HEREBY certify that this Certified Survey Map was approved under Resolution File No. 100601 adopted by the Common Council of the City of Milwaukee on this 21<sup>st</sup> day of September, 2010.

Ronald D. Leonhardt  
RONALD D. LEONHARDT, City Clerk

Tom Barrett  
Tom Barrett, Mayor

