



CITY OF MILWAUKEE
OFFICE OF THE CITY CLERK

Thursday, August 27, 2020

COMMITTEE MEETING NOTICE

AD 08

Catherine Haefke

2042 W Lincoln Av

Milwaukee, WI 53215

You are requested to attend a virtual hearing to be held on:

Tuesday, September 08, 2020 at 10:10 AM

Regarding: Your Class B Tavern and Public Entertainment  License Applications Requesting Jukebox and 2 Bowling Alleys for "Holler House" at 2042 W Lincoln Av.

This meeting will be held via GoToMeeting. Please see the enclosed best practices document for further instructions. The access code is <https://global.gotomeeting.com/join/530391517>. If you wish to call in, please call +1 (872) 240-3412 and use Access Code: 530-391-517.

There is a possibility that your application may be denied for one or more of the following reasons: The recommendation of the committee regarding the application shall be based on evidence presented at the hearing. Per MCO 85-2.7-4, probative evidence concerning whether or not a new license should be granted may be presented on the following subjects: whether or not the applicant meets the municipal requirements, the appropriateness of the location and premises where the licensed premises is to be located and whether use of the premises for the purposes or activities permitted by the license would tend to facilitate a public or private nuisance or create undesirable neighborhood problems such as disorderly patrons, unreasonably loud noise, litter, and excessive traffic and parking congestion. Probative evidence relating to these matters may be taken from the plan of operation submitted with the license application, if any, but shall not include the content of any music. Evidence regarding the fitness of the location of the premises to be maintained as the principal place of business, including but not limited to whether there is an overconcentration of businesses of the type for which the license is sought; whether the proposal is consistent with any pertinent neighborhood business or development plans, or the location's proximity to areas where children are typically present. The applicant's record in operating similarly licensed premises; and whether or not the applicant has been charged with or convicted of any felony, misdemeanor, municipal offense or other offense, the circumstances of which substantially relate to the activity to be permitted by the license being applied for or any other factor which reasonably relates to the public health, safety or welfare may also be considered. See attached police report or correspondence.

Notice for applicants with warrants or unpaid fines:

Proof of warrant satisfaction or payment of fines must be submitted at the hearing on the above date and time. Failure to comply with this requirement may result in a delay of the granting/denial of your application.

Failure to attend this meeting may result in the denial of your license. Individual applicants and partnership applicants must attend or attend by an attorney. The agent or attorney for corporate or limited liability applicants must attend. If you wish to do so and at your own expense, you may be accompanied by an attorney of your choosing to represent you at this hearing.

You will be given an opportunity to speak on behalf of the application and to respond and challenge any charges or reasons given for the denial. No petitions can be accepted by the committee, unless the people who signed the petition attend the virtual hearing and are willing to testify. You may present witnesses under oath and you may also confront and cross-examine opposing witnesses under oath. If you have difficulty with the English language, you should request an interpreter attend the meeting with you, at your expense, so that you can answer questions and participate in your hearing.

PLEASE NOTE: Upon reasonable notice, efforts will be made to accommodate the needs of disabled individuals through sign language interpreters or other auxiliary aids. For additional information or to request this service, contact the Council Services Division ADA Coordinator at (414) 286-2998, Fax - (414) 286-3456, TDD - (414) 286-2025.

JIM OWCZARSKI, CITY CLERK

BY: _____

Jessica Celella
License Division Manager

If you have questions regarding this meeting, please contact the staff assistant, Molly Kuether-Steele at (414) 286-2775 or molly.kuether-steele@milwaukee.gov.

200 E. Wells Street, Room 105, City Hall, Milwaukee, WI 53202. www.milwaukee.gov/license
Phone: (414) 286-2238 Fax: (414) 286-3057 Email Address: License@milwaukee.gov



**CITY OF MILWAUKEE
OFFICE OF THE CITY CLERK**

Thursday, August 27, 2020

COMMITTEE MEETING NOTICE

AD 08

Catherine Haefke
8442 S Fountain Ct
Franklin, WI 53132

You are requested to attend a virtual hearing to be held on:

Tuesday, September 08, 2020 at 10:10 AM

Regarding: Your Class B Tavern and Public Entertainment Premises License Applications Requesting Jukebox and 2 Bowling Alleys for "Holler House" at 2042 W Lincoln Av.

This meeting will be held via GoToMeeting. Please see the enclosed best practices document for further instructions. The access code is <https://global.gotomeeting.com/join/530391517>. If you wish to call in, please call **+1 (872) 240-3412** and use Access Code: 530-391-517.

There is a possibility that your application may be denied for one or more of the following reasons: The recommendation of the committee regarding the application shall be based on evidence presented at the hearing. Per MCO 85-2.7-4, probative evidence concerning whether or not a new license should be granted may be presented on the following subjects: whether or not the applicant meets the municipal requirements, the appropriateness of the location and premises where the licensed premises is to be located and whether use of the premises for the purposes or activities permitted by the license would tend to facilitate a public or private nuisance or create undesirable neighborhood problems such as disorderly patrons, unreasonably loud noise, litter, and excessive traffic and parking congestion. Probative evidence relating to these matters may be taken from the plan of operation submitted with the license application, if any, but shall not include the content of any music. Evidence regarding the fitness of the location of the premises to be maintained as the principal place of business, including but not limited to whether there is an overconcentration of businesses of the type for which the license is sought; whether the proposal is consistent with any pertinent neighborhood business or development plans, or the location's proximity to areas where children are typically present. The applicant's record in operating similarly licensed premises; and whether or not the applicant has been charged with or convicted of any felony, misdemeanor, municipal offense or other offense, the circumstances of which substantially relate to the activity to be permitted by the license being applied for or any other factor which reasonably relates to the public health, safety or welfare may also be considered. See attached police report or correspondence.

Notice for applicants with warrants or unpaid fines: Proof of warrant satisfaction or payment of fines must be submitted at the hearing on the above date and time. Failure to comply with this requirement may result in a delay of the granting/denial of your application.

Failure to attend this meeting may result in the denial of your license. Individual applicants and partnership applicants must attend or attend by an attorney. The agent or attorney for corporate or limited liability applicants must attend. If you wish to do so and at your own expense, you may be accompanied by an attorney of your choosing to represent you at this hearing.

You will be given an opportunity to speak on behalf of the application and to respond and challenge any charges or reasons given for the denial. No petitions can be accepted by the committee, unless the people who signed the petition attend the virtual hearing and are willing to testify. You may present witnesses under oath and you may also confront and cross-examine opposing witnesses under oath. If you have difficulty with the English language, you should request an interpreter attend the meeting with you, at your expense, so that you can answer questions and participate in your hearing.

PLEASE NOTE: Upon reasonable notice, efforts will be made to accommodate the needs of disabled individuals through sign language interpreters or other auxiliary aids. For additional information or to request this service, contact the Council Services Division ADA Coordinator at (414) 286-2998, Fax - (414) 286-3456, TDD - (414) 286-2025.

JIM OWCZARSKI, CITY CLERK

BY: _____

Jessica Celella
License Division Manager

If you have questions regarding this meeting, please contact the staff assistant, Molly Kuether-Steele at (414) 286-2775 or molly.kuether-steele@milwaukee.gov.

200 E. Wells Street, Room 105, City Hall, Milwaukee, WI 53202. www.milwaukee.gov/license
Phone: (414) 286-2238 Fax: (414) 286-3057 Email Address: License@milwaukee.gov

Date: 07/09/20
Officer: Xavier Benitez

City of Milwaukee Police Department
90-5-1.5 Crime Prevention Survey
Tavern Inspection

Name of Premise: Holler House
Address: 2042 W. Lincoln Av
Phone: 414 647-9284

Owner:
Owner address:
City State Zip:
Owner Phone:
Owner email:

Licensee/Agent: Catherine M. Haefke
Home Address: 8442 S. Fountain Ct.
City State Zip: Franklin WI 53132
Phone: 262 442-2517
Email: cathy20935@aol.com

Preferred contact: by phone

Location currently open: YES NO

Projected open date: late July

Day's open: S M T W Th F SA ALL

Hours of Operation: Sun: 12pm-9pm 24 hours Y N
Mon: 12pm-11pm
Tue: 12pm-2am
Wed: 12pm-2am
Thu: 12pm-2am
Fri: 12pm-2:30am
Sat: 12pm-2:30am

Premise Type: Tavern/Bar
Restaurant
Other:

Licenses currently held:

- Alcohol: Yes No Class: #:
- Tobacco: Yes No #:
- Food: Yes No #:
- Extended Hours: Yes No #:
- Secondhand Dealer: Yes No Type: #:
- Other: Yes No Type: #:
- Other: Yes No Type: #:

Exterior Survey:

1. Is the area around the location clean? Yes No
2. What surrounds the location? (Check all the apply)
 - a. Park
 - b. School
 - c. Youth Center
 - d. Church
 - e. Tavern(s) If so, how many
 - f. Residential
 - g. Other businesses
 - h. Other:
3. Can you see from the outside of the location into the interior Yes No
4. Can you see the employees inside of the location from the outside Yes No
5. Are exterior windows free of signage Yes No
6. Is there a parking lot Yes No
7. Is the parking lot clean? Yes No
8. Off-Street parking Yes No
9. Is the parking lot well lit? Yes No
10. Valet Parking Yes No
 - a. Will this lot have a guard? Yes No
 - b. Will this lot have cameras? Yes No
11. Are there areas where a person could conceal themselves Yes No
12. Is there exterior lighting? Yes No. Does it appears to be adequate Yes No
13. Exterior Payphone? Yes No
14. Are there No Loitering Signs posted? Yes No
15. Are there exterior security cameras Yes No How Many:
16. Are the address numbers prominently displayed and easy to see Yes No

Camera Survey:

17. Does this location have security cameras? Yes No
18. Are they in working order? Yes No
19. What format are the cameras?
 - a. Color Yes No
 - b. Digital Yes No
 - c. Recorded Yes No
20. How long is footage stored for later viewing:
21. Are there exterior cameras Yes No How many:
22. Are there interior cameras Yes No How many:
23. Do all employees know how to retrieve recorded digital images/footage? Yes No

24. Cameras located in parking lot Yes No How many

Interior Survey:

- 25. What is the planned capacity 50
- 26. What is the minimum number of employees That will be on premise 2
- 27. Is the storeowner willing to be a standing complainant regarding loitering? Yes No
 - a. If yes have them fill out the standing complaint form and give them two of the commercial signs Yes No
- 28. Is the interior of the location neat and clean? Yes No
- 29. Does an interior camera face the entrance/exit? Yes No
- 30. Is there a lockable area that separates employees from customers? Yes No
- 31. Are emergency and non-emergency numbers posted near the phone? Yes No
- 32. Does the owner know how to contact their police district directly? Yes No
 - a. Did you provide a district contact guide to the owner? Yes No

Security

- 33. How many security personnel are going to be employed: N/A
- 34. How ill they be deployed: Interior Exterior
- 35. What days will they be deployed MonTueWedThuFriSatSun
- 36. Will the security be managed by business or contracted
- 37. Will they be armed Yes No
- 38. What type of security measures to be used:
 - Wanding/metal detector
 - ID Scanner
 - Dress Code
 - Cover Charge
 - Age restriction
 - Other

ADDITIONAL COMMENTS/RECOMMENDATIONS:

The location does not currently have a camera system. The listed agent expressed interest in having a camera system installed at a later date. The agent was given recommendations on some cameras placements. The agent was also recommended on the camera system to have color, digital, and 30 day storage capabilities.

MILWAUKEE POLICE DEPARTMENT LICENSING

CRIMINAL RECORD/ORDINANCE VIOLATION/INCIDENTS SYNOPSIS

DATE: 05/02/2019

LICENSE TYPE: Class B Tavern

NEW:

RENEWAL:

No. 293022

Application Date: 05/01/2019

License Location: 2042 W Lincoln Av

Business Name: Holler House

Licensee/Applicant: STUCKERT, Todd C
(Last Name, First Name, MI)

Date of Birth: 02/03/1951

Home Address: 6493 Whitnall Forge Rd

City: Franklin

State: WI Zip Code: 53132

Home Phone:

This report is written by Police Officer David NOVAK, assigned to the License Investigation Unit, Days.

The Milwaukee Police Department's investigation regarding this application revealed the following:

1. On 11/25/2015 officers conducted a license premises check on Holler House at 2042 W. Lincoln Av. They observed no violations and the staff was highly cooperative.

=====

2. On 03/18/2017 officers responded to Holler House, 2042 W. Lincoln Av, for a Theft complaint. The bartender stated he allowed two juveniles in to use the bathroom. One of the subjects came out of the bathroom and approached the bar. The bartender told the subject to get out and the subject grabbed money from the bar and fled on foot.

=====

PREVIOUS PREMISE



Concentration Map

2042 W Lincoln AV

Area : 21,862,585.64 ft²

Jun 10 2020 15:46:14 Central Daylight Time

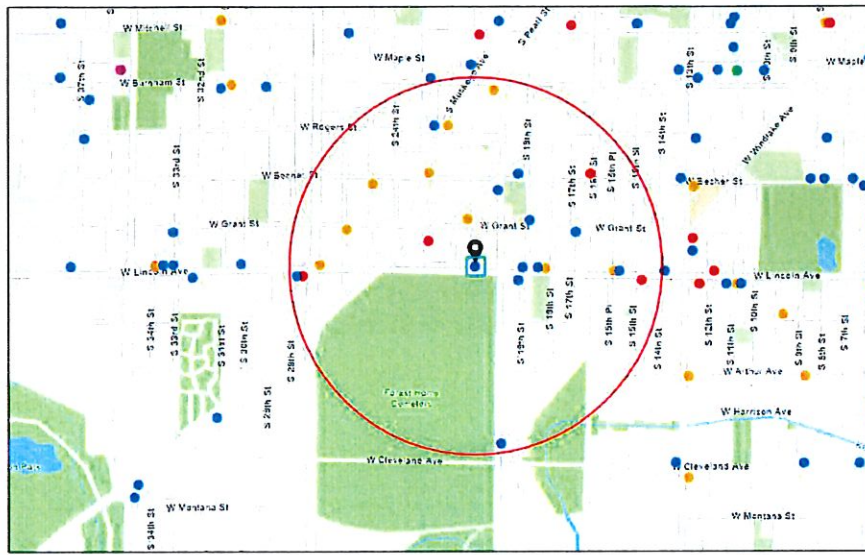

- Alcohol Licenses
- Class A Intoxicating Liquor
 - Class A Fermented Malt Beverage
 - Class A Liquor and Malt
 - Class B Fermented Malt Beverage
 - Class B Tavern

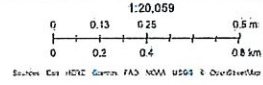

Summary

Name	Count	Area(ft ²)	Length(mi)
Alcohol Licenses	25		

Alcohol Licenses

#	Legal Entity	Trade Name	Licensee	Address	License Type Name	Total Capacity	Expiration Date	Count
1	Irene's Catering Service, Inc	Irene's Catering Service, Inc	Thomas E Rewolinski, Agt	1901 W Lincoln AV	Class B Tavern License		10/18/2020, 7:00 PM	1
2	Treder KMK Inc	Supermarket La Veracruzana	ERIC J TREDER, Agt	2539 W Grant ST	Class A Fermented Malt Beverage Retailer's License		3/1/2021, 6:00 PM	1
3	PRIMOS PLACE	PRIMOS PLACE	ENRIQUE TERRONES, SP	1631 W GRANT ST	Class B Tavern License	161	3/6/2021, 6:00 PM	1
4	OLD TOWN SERBIAN GOURMET RESTAURANT, LLC	OLD TOWN SERBIAN GOURMET RESTAURANT	NATALIA A RADICEVICH, Agt	518-522 W LINCOLN AV	Class B Tavern License	200	9/22/2020, 7:00 PM	1
5	Forest Home Ave Chicken Palace LLC	Chicken Palace - Forest Home/ Chicken Palace Forest Home Food Truck	Rosa Isela Real Perez, Agt	1937 W Forest Home AV	Class B Tavern License	71	8/19/2020, 7:00 PM	1
6	Farida, LLC	South Ave Foods	Thaher M Qatoum, Agt	2108 S 25TH ST	Class A Fermented Malt Beverage Retailer's License		5/5/2021, 7:00 PM	1
7	Starlite Beer & Food, Inc.	Starlite Food	GURMUKH SINGH, Agt	2013 W Burnham ST	Class A Fermented Malt Beverage Retailer's License		4/20/2021, 7:00 PM	1
8	ABDELAL, LLC	GRANT MARKET	SAED F ABDELAL, Agt	2100 W GRANT ST	Class A Fermented Malt Beverage Retailer's License		5/13/2021, 7:00 PM	1
9	Lincoln Express, Inc.	Express Pantry	PETTY BABBBER, Agt	1804 W Lincoln AV	Class A Fermented Malt Beverage Retailer's License		5/3/2021, 7:00 PM	1
10	CITIZEN, INC	LINCOLN AVENUE FOOD & LIQUOR	INTISAR HASAN, Agt	2717 W LINCOLN AV	Class A Malt & Class A Liquor License		5/14/2021, 7:00 PM	1
11	ANNA'S TAP	ANNA'S TAP	SAMANTHA L RITCHIE, SP	1838 W GRANT ST	Class B Tavern License	25	6/29/2020, 7:00 PM	1
12	Paul's Liquor LLC	Paul's Liquor	AGIAPAL SINGH, Agt	1600 W Becher ST	Class A Malt & Class A Liquor License		11/27/2020, 6:00 PM	1
13	Tabasco Bar	Tabasco Bar	Jose De Dios-Sosa, Agt	1900 W LINCOLN AV	Class B Tavern License		11/18/2020, 6:00 PM	1
14	Aarvind Food Mart, LLC	Lucky Food & Beer	LAKHWINDER KAUR, Agt	2638 W Lincoln AV	Class A Fermented Malt Beverage Retailer's License		12/16/2020, 6:00 PM	1

15	YASMINE FOODS, LLC	LINCOLN SUPERMARKET	LOAI A ATARI, Agt	1534 W LINCOLN AV	Class A Fermented Malt Beverage Retailer's License		12/10/2020, 6:00 PM	1
16	PROMOCIONES MEXICAS LLC	EL GRAN TEOCALLI	PALOMA NAVA, Agt	2011 W FOREST HOME AV	Class B Tavern License	282	5/12/2021, 7:00 PM	1
17	Punjab Food LLC	J&C El Centenario Market	Rita M Bhatti, Agt	2082 S Muskego AV	Class A Fermented Malt Beverage Retailer's License		4/19/2021, 7:00 PM	1
18	HOLLER HOUSE	HOLLER HOUSE	TODD C STUCKERT, SP	2042 W LINCOLN AV	Class B Tavern License	50	6/29/2020, 7:00 PM	1
19	LA ARRACHERA	LA ARRACHERA	MARINA VARA DE ARANA, SP	1988 S MUSKEGO AV	Class A Fermented Malt Beverage Retailer's License		7/16/2020, 7:00 PM	1
20	KOTHALA, LLC	SOUTHSIDE BEER & LIQUOR	JASBIR S PANU, Agt	1434 W WINDLAKE AV	Class A Malt & Class A Liquor License		6/13/2021, 7:00 PM	1
21	Seven Star Liquor LLC	Seven Star Liquor	JASJEET SINGH, Agt	2223 W Forest Home AV	Class A Malt & Class A Liquor License		7/25/2020, 7:00 PM	1
22	LA GUADALUPANA	LA GUADALUPANA	ANA M RAZO, SP	1520 W LINCOLN AV	Class B Tavern License	99	1/19/2021, 6:00 PM	1
23	PSR PETRO MART, LLC	JASSI'S PLACE	Martha Rojas, Agt	1933 W WINDLAKE AV	Class B Tavern License	51	7/31/2020, 7:00 PM	1
24	LA PICA #3, LLC	LA PICA CARR 3 BAR & HALL	WILLIAM RIVERA, Agt	3427-31 W LINCOLN AV	Class B Tavern License	162	7/28/2020, 7:00 PM	1
25	La Hamaca Bar LLC	La Hamaca Bar	Luis Lopez-Gonzalez, Agt	1993 S MUSKEGO AV	Class B Tavern License		9/28/2020, 7:00 PM	1

Establishments within a 0.5 miles radius centered on area of interest.



Thursday, August 27, 2020

Licenses Committee Notice of Hearing

MARCELLA SKOWRONSKI IRR FAMILY TRUST D11/20/2018
6493 WHITNALL EDGE Rd
Franklin, WI 53132

The Licenses Committee will consider the following license application:

Class B Tavern and Public Entertainment Premises License Applications
Requesting Jukebox and 2 Bowling Alleys
Catherine Haefke
Holler House at 2042 W Lincoln Av

Date: 9/8/2020

Time: 10:10 AM

Location: The hearing before the Licenses Committee will take place virtually on Tuesday, September 8, 2020. This is a public hearing. Those wishing to view the proceeding are able to do so via the City Channel – Channel 25 on Spectrum Cable – or on the Internet at <http://city.milwaukee.gov/citychannel>. Those wishing to provide oral testimony will be asked to do so by phone or internet and are asked to contact the staff assistant, Molly Kuether-Steele at (414) 286-2775 or molly.kuether-steele@milwaukee.gov for necessary information. Please make such requests no later than one business day prior to the start of the meeting. You are not required to attend the hearing, but please see the information below if you would like to provide testimony.

Please note this application may be recommended for denial based on fitness of the location due to concentration of alcohol beverage outlets in the area. If the application is denied for this reason, no other application for an alcohol beverage license for this location shall be recommended for approval by the Licenses Committee within three years of the date of denial unless the applicant has demonstrated a change of circumstances since the prior denial.





Thursday, August 27, 2020



Notice of Public Hearing

blank
notice

HAEFKE, Catherine
Holler House at 2042 W Lincoln Av
Class B Tavern and Public Entertainment Premises License Applications Requesting Jukebox and
2 Bowling Alleys

Tuesday, September 08, 2020 at 10:10 AM

To whom it may concern:

The above application has been made by the above named applicant(s). This requires approval from the Licenses Committee and the Common Council of the City of Milwaukee. The hearing before the Licenses Committee will take place virtually on 9/8/2020 at 10:10 AM. This is a public hearing. Those wishing to view the proceeding are able to do so via the City Channel – Channel 25 on Spectrum Cable – or on the Internet at <http://city.milwaukee.gov/citychannel>. Those wishing to provide oral testimony will be asked to do so by phone or internet and are asked to contact the staff assistant, Molly Kuether-Steele at (414) 286-2775 or molly.kuether-steele@milwaukee.gov for necessary information. Please make such requests no later than one business day prior to the start of the meeting. You are not required to attend the hearing, but please see the information below if you would like to provide testimony. Once the Licenses Committee makes its recommendation, this recommendation is forwarded to the full Common Council for approval at its next regularly scheduled hearing.

Important details for those wishing to provide information for the Licenses Committee to consider when making its recommendation:

1. The license application is scheduled to be heard at the above time. Due to other hearings running longer than scheduled, you may have to wait some time to provide your testimony.
2. You must testify as to matters that you have personally experienced or seen. (You cannot provide testimony for your neighbor, parent or anyone else; this is considered hearsay and cannot be considered by the committee.)
3. No letters or petitions can be accepted by the committee (unless the person who wrote the letter or the persons who signed the petition are willing to testify).
4. Persons opposed to the license application are given the opportunity to testify first; supporters may testify after the opponents have finished.
5. When you are called to testify, you will be sworn in and asked to give your name, and address. (If your first and/or last names are uncommon please spell them.)
6. You may then provide testimony.
 - a. Include only information relating to the above license application.
 - b. Include only information you have personally witnessed or seen.
 - c. Provide concise and relevant information detailing how this business has affected or may affect the peaceful enjoyment of your neighborhood.
 - d. If by the time you have the opportunity to testify, the information you wish to share has already been provided to the committee, you may state that you agree with the previous testimony. Redundant or repetitive testimony will not assist the committee in making its recommendation.
7. After giving your testimony, the members of the Licenses Committee and the licensee may ask questions regarding the testimony you have given or other factors relating to the license application.
8. Business Competition is not a valid basis for denial or non-renewal of a license.

Please Note: If you have submitted an objection to the above application your objection cannot be considered by the committee unless you personally testify at the hearing.

OCCUPANT	MAIL ADDRESS	CITY, STATE ZIP
CURRENT OCCUPANT	2272 S 21ST ST	MILWAUKEE, WI 53215
CURRENT OCCUPANT	2014 W LINCOLN AVE	MILWAUKEE, WI 53215
CURRENT OCCUPANT	2247 S 21ST ST	MILWAUKEE, WI 53215
CURRENT OCCUPANT	2247 S 20TH ST	MILWAUKEE, WI 53215
CURRENT OCCUPANT	2245 S 20TH ST	MILWAUKEE, WI 53215
CURRENT OCCUPANT	2257 S 20TH ST	MILWAUKEE, WI 53215
CURRENT OCCUPANT	2038 W LINCOLN AVE	MILWAUKEE, WI 53215
CURRENT OCCUPANT	2030 W LINCOLN AVE	MILWAUKEE, WI 53215
CURRENT OCCUPANT	2026 W LINCOLN AVE	MILWAUKEE, WI 53215
CURRENT OCCUPANT	2013A W LINCOLN AVE	MILWAUKEE, WI 53215
CURRENT OCCUPANT	2010 W LINCOLN AVE	MILWAUKEE, WI 53215
CURRENT OCCUPANT	2232 S 21ST ST	MILWAUKEE, WI 53215
CURRENT OCCUPANT	2251A S 21ST ST	MILWAUKEE, WI 53215
CURRENT OCCUPANT	2257A S 21ST ST	MILWAUKEE, WI 53215
CURRENT OCCUPANT	2100 W LINCOLN AVE 2	MILWAUKEE, WI 53215
CURRENT OCCUPANT	2028 W LINCOLN AVE	MILWAUKEE, WI 53215
CURRENT OCCUPANT	2228 S 21ST ST	MILWAUKEE, WI 53215
CURRENT OCCUPANT	2110 W LINCOLN AVE	MILWAUKEE, WI 53215
CURRENT OCCUPANT	2257 S 21ST ST	MILWAUKEE, WI 53215
CURRENT OCCUPANT	2246 S 21ST ST	MILWAUKEE, WI 53215
CURRENT OCCUPANT	2259 S 20TH ST	MILWAUKEE, WI 53215
CURRENT OCCUPANT	2233 S 21ST ST	MILWAUKEE, WI 53215
CURRENT OCCUPANT	2024 W LINCOLN AVE	MILWAUKEE, WI 53215
CURRENT OCCUPANT	2012 W LINCOLN AVE	MILWAUKEE, WI 53215
CURRENT OCCUPANT	2241 S 21ST ST	MILWAUKEE, WI 53215
CURRENT OCCUPANT	2247A S 21ST ST	MILWAUKEE, WI 53215
CURRENT OCCUPANT	2239 S 21ST ST	MILWAUKEE, WI 53215
CURRENT OCCUPANT	2112 W LINCOLN AVE	MILWAUKEE, WI 53215
CURRENT OCCUPANT	2248 S 21ST ST	MILWAUKEE, WI 53215
CURRENT OCCUPANT	2248 S 21ST ST A	MILWAUKEE, WI 53215
CURRENT OCCUPANT	2252 S 21ST ST	MILWAUKEE, WI 53215
CURRENT OCCUPANT	2254 S 21ST ST	MILWAUKEE, WI 53215
CURRENT OCCUPANT	2258A S 21ST ST	MILWAUKEE, WI 53215
CURRENT OCCUPANT	2258 S 21ST ST	MILWAUKEE, WI 53215
CURRENT OCCUPANT	2237 S 20TH ST	MILWAUKEE, WI 53215
CURRENT OCCUPANT	2020 W LINCOLN AVE	MILWAUKEE, WI 53215
CURRENT OCCUPANT	2022 W LINCOLN AVE	MILWAUKEE, WI 53215
CURRENT OCCUPANT	2100 W LINCOLN AVE 1	MILWAUKEE, WI 53215
CURRENT OCCUPANT	2036 W LINCOLN AVE	MILWAUKEE, WI 53215
CURRENT OCCUPANT	2011 W LINCOLN AVE	MILWAUKEE, WI 53215
CURRENT OCCUPANT	2251 S 21ST ST	MILWAUKEE, WI 53215
CURRENT OCCUPANT	2104 W LINCOLN AVE	MILWAUKEE, WI 53215
CURRENT OCCUPANT	2100 W LINCOLN AVE 3	MILWAUKEE, WI 53215
CURRENT OCCUPANT	2252A S 21ST ST	MILWAUKEE, WI 53215
CURRENT OCCUPANT	2241 S 20TH ST	MILWAUKEE, WI 53215
CURRENT OCCUPANT	2253 S 20TH ST	MILWAUKEE, WI 53215

CURRENT OCCUPANT	2261 S 20TH ST	MILWAUKEE, WI 53215
CURRENT OCCUPANT	2034 W LINCOLN AVE	MILWAUKEE, WI 53215
CURRENT OCCUPANT	2022A W LINCOLN AVE	MILWAUKEE, WI 53215
CURRENT OCCUPANT	2013 W LINCOLN AVE	MILWAUKEE, WI 53215
CURRENT OCCUPANT	2009 W LINCOLN AVE	MILWAUKEE, WI 53215
CURRENT OCCUPANT	2008 W LINCOLN AVE	MILWAUKEE, WI 53215
CURRENT OCCUPANT	2004 W LINCOLN AVE	MILWAUKEE, WI 53215
CURRENT OCCUPANT	2234 S 21ST ST	MILWAUKEE, WI 53215
CURRENT OCCUPANT	2118 W LINCOLN AVE	MILWAUKEE, WI 53215
CURRENT OCCUPANT	2244 S 21ST ST	MILWAUKEE, WI 53215
CURRENT OCCUPANT	2240 S 21ST ST	MILWAUKEE, WI 53215
CURRENT OCCUPANT	2260 S 21ST ST	MILWAUKEE, WI 53215
CURRENT OCCUPANT	2237A S 20TH ST	MILWAUKEE, WI 53215
CURRENT OCCUPANT	2235 S 21ST ST	MILWAUKEE, WI 53215
CURRENT OCCUPANT	2272A S 21ST ST	MILWAUKEE, WI 53215
CURRENT OCCUPANT	2040 W LINCOLN AVE	MILWAUKEE, WI 53215
CURRENT OCCUPANT	2032 W LINCOLN AVE	MILWAUKEE, WI 53215
CURRENT OCCUPANT	2016 W LINCOLN AVE	MILWAUKEE, WI 53215
CURRENT OCCUPANT	2018 W LINCOLN AVE	MILWAUKEE, WI 53215
CURRENT OCCUPANT	2006 W LINCOLN AVE	MILWAUKEE, WI 53215
CURRENT OCCUPANT	2237 S 21ST ST	MILWAUKEE, WI 53215
CURRENT OCCUPANT	2104A W LINCOLN AVE	MILWAUKEE, WI 53215
CURRENT OCCUPANT	2243 S 20TH ST	MILWAUKEE, WI 53215
CURRENT OCCUPANT	2263 S 20TH ST	MILWAUKEE, WI 53215

blank

notice

Total Records: 70

Radius: 250.0 feet and Center of Circle: 2042 W Lincoln Ave



BUSINESS LICENSE PLAN OF OPERATION

ccl-busplan 3/15/18

Office of the City Clerk License Division
200 E. Wells St. Room 105, Milwaukee, WI 53202
(414) 286-2238 www.milwaukee.gov/license e-mail address: license@milwaukee.gov

1. Type of Business

Applying for: Extended Hours (12AM to 5AM) - If a food establishment, check all that apply: Delivery Drive Thru Dining Room
 Self Service Laundry Massage Establishment Filling Station
 Other (supplemental application for specific license also required) Class B Tavern License

Provide a detailed description of the type of business you plan on operating:

Neighborhood Tavern and two-lane bowling alley.

Do you have any experience operating this type of business? No Yes If yes, explain: It's been in my family for 112 years.

2. Business Operations

- a. Proposed Opening Date: 6-1-20
- b. Is this premise under construction? No Yes If yes, list estimated completion date: _____
- c. Is this a franchise? No Yes
- d. Is this premises currently licensed? No Yes If yes, list type of license: _____
- e. Is the current licensee operating? No Yes If no, list date closed: _____
- f. Do you have future plans for other businesses, licenses or permits at this location? No Yes
If yes, explain: _____
- g. Have you previously held an Extended Hours License in Milwaukee? No Yes
If yes, list address(es): _____
- h. Are other businesses operating in the same building? No Yes If yes, describe: _____

3. Litter & Noise

- a. How are grounds kept clean? Sweep Pressure Wash Pick Up Litter Other: _____
- b. How often will grounds be cleaned? Daily Weekly As Needed Monthly Other: _____
- c. Grounds cleaned by: Licensee Building Owner Employees Hired Maintenance Other: _____
- d. How are noise issues prevented and/or addressed? Security Manager approaches customer(s) Call Police
 Signs Posted Other: _____
- e. Will a sound amplification system be used? No Yes If yes, describe: _____

4. Smoking & Sanitation

- a. Are there designated outdoor smoking areas? No Yes If yes, describe: _____
- b. Number of Garbage Cans: Inside: 3 Locations: 2 in tavern, 1 in bowling alley
Outside: 6 Locations: 1 dumpster 5 recycle cans
- c. Is a crowd control barrier used? No Yes If yes, describe: _____
- d. How many restrooms are on the premises? 2
- e. Name of solid waste contractor: Advanced Disposal Waste Management Other: City of Milwaukee

5. Security

- a. Are there onsite parking spaces? No Yes If yes, how many? _____ and describe the parking security plan: _____
- b. Is there a loading zone? No Yes If yes, describe the loading area security plan: _____
- c. Will you have security personnel on premise? No Yes If yes, how many? _____ and answer the following:
What are their responsibilities? _____
Is security equipment used? No Yes If yes, describe _____
List their licensing, certification, or training credentials _____
- d. Will there be security cameras? No Yes If yes, how many? _____ and list locations: _____
- e. Will searches/identification checks be done upon entry? No Yes If yes, describe For legal age

6. Percentage of Sales (must total 100%)

Alcohol <u>80</u> %	Food _____ %	Secondhand Merchandise _____ %	Precious Metals & Gems _____ %
Entertainment _____ %	Cigarettes _____ %		
Pawnbroker Activity _____ %	Salvaged Materials _____ % (such as scrap metal)	Personal Services (such as tattoo, body piercing, salon, tailor, tanning, etc.) _____ %	Other <u>20</u> % Describe: <u>Bowling</u>

7. Businesses/Licenses on the Premises (check all that apply):

Type 1

- Full Service Restaurant Cafe/Coffee Shop Deli or Fast Food Restaurant Private/Fraternal/Veterans Club
- Night Club Tavern Cocktail Lounge Teen Club
- Banquet Hall Sports Facility Bowling Alley
- Hotel/Motel : Number of Floors: _____ Number of Rooms: _____
 Rooming House: Number of Floors: _____ Number of Rooms: _____

Type 2

- Liquor Store Corner Store Supermarket Convenience Store
- Gas Station Amusement/Phonograph Distributor Recycling, Salvage or Towing
- Used Car Dealer Personal Service Establishment
(such as tattoo business, hair salon, tailor, etc.) Recording Studio

What other licenses/permits will you hold at this location? (check all that apply)

- Occupancy Permit Cigarette & Tobacco Gas Station Extended Hours Class "B" Tavern Weights & Measures
- Secondhand Dealer Precious Metal & Gem Other: _____

8. Legal Capacity (only if a Type 1 premises in #7 above)

Capacity 25 (Call the Milwaukee Development Center at 414-286-8211 if you have questions.)

9. Premises Description

a. Identify all area(s) of the premises that will be used in operating this business (include areas used only for storage):

1st Floor 2nd Floor Basement Storage Patio Beer Garden Sidewalk Café Deck Rooftop

Other: Describe: _____

b. Describe Location: Major Thoroughfare Secondary Street Other: _____

c. Nearest Major Cross Street: Forest Home Ave.

d. Describe Building: Free Standing Building Strip Mall Other: _____

e. Describe Premises Structure: Single Story Multi-Story - # of Stories 2 Other: _____

f. Describe Surrounding Area: Commercial Residential Industrial Other: _____

g. Building Owner Name: Skowronski Family Trust Phone Number: 262-442-2517

Business Owner Address: 2047 W Lincoln Ave Milwaukee, WI 53132

10. Hours of Operation & Customers

Will customers be entering the premises? No Yes

Day of the Week	Proposed Hours of Operation:		Estimated Number of Customers expected each day	Potential Age Range of Customers	Class B Tavern Applicant Only: Age Restriction (If none, write 'None')
	Open Time (include a.m. or p.m.)	Close Time (include a.m. or p.m.)			
Sunday	12:00 p.m.	9:00 p.m.	20	21-90	
Monday	12:00 p.m.	11:00 p.m.	10	21-90	
Tuesday	12:00 p.m.	2:00 a.m.	20	21-90	
Wednesday	12:00 p.m.	2:00 a.m.	20	21-90	
Thursday	12:00 p.m.	2:00 a.m.	20	21-90	
Friday	12:00 p.m.	2:00 a.m.	20	21-90	
Saturday	12:00 p.m.	2:00 a.m.	20	21-90	

An Extended Hours Establishment License is required for any convenience store, filling station, personal service establishment (such as tattoo, body piercing, salon, tailor, tanning, etc.), recording studio or restaurant which is open between the hours of 12:00 a.m. and 5:00 a.m.

Alcohol Establishments Permitted Hours of Operation: Class A: 8:00 am to 9:00 pm Sunday thru Saturday
Class B: 6:00 am to 2:00 am Sunday thru Thursday, 6:00 am to 2:30 am Friday & Saturday

Entertainment Outdoor Closing Hours: 10:00pm Sunday-Thursday; 12:00am Friday & Saturday; unless a different time, either earlier or later, is established by the Common Council in its approval of the licensee's plan of operation.

11. Signature(s)

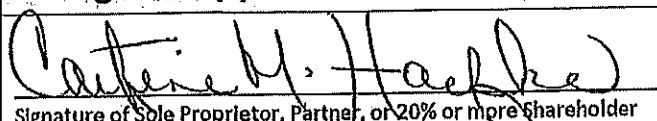
Signature of Sole Proprietor, Partner, or 20% or more Shareholder
(If there are no 20% or more shareholders, Corporate Officer-print name/title and sign)

Signature of additional partner or 20% or more shareholder

See Application Information for a complete list of all required application forms.



ALCOHOL BEVERAGE & PUBLIC ENTERTAINMENT PREMISES SUPPLEMENTAL APPLICATION

Office of the City Clerk License Division
200 E. Wells St. Room 105, Milwaukee, WI 53202
(414) 286-2238 e-mail address: license@milwaukee.gov www.milwaukee.gov/license

Legal Entity Name: Catherine M. Haefke

Premise Address: 2042 W. Lincoln Ave. Milwaukee, WI 53215

Proximity of Premises to Church, School, Daycare Center or Hospital

Is the building within 300 feet of any church, school, daycare center or hospital? No Yes

"Service Bar Only" Designation

If applying for Class B or C license, are you applying for "Service Bar Only"? No Yes

Service Bar Only means customers cannot sit at the bar. Alcohol is served to employees who serve patrons seated at tables. No stools, chairs or other articles of furniture shall be placed at the service bar for patrons to sit upon.

Business Information

a) Are you taking out this application for anyone that may not be eligible for a license? No Yes

If yes, list their name and address: _____

b) Will the agent, a partner or the individual licensee be conducting the day-to-day operations of the business? No Yes

If no, list the name and address of the person(s) who will: _____

Class B Applicants: If the agent, a partner or the individual licensee will not be conducting the day-to-day operations of the business, the person(s) listed above must obtain a Class B Managers license.

c) Does anyone else have money invested or any other interest in this business? No Yes

If yes, explain: _____

d) Have you made an agreement with anyone to repay any loan or any other payments based upon income from the business?

No Yes If yes, list name and address: _____

Property Information (New & Transfer Applicants Only)

a) Do you own or lease the building? Own Lease

b) Who owns the fixtures (for example, coolers, etc.)? My family

c) Are you purchasing the stock and/or fixtures? No Yes If yes, amount paid \$ _____

d) Total amount paid for business \$ 0

e) Total amount paid for goodwill of the business \$ 0

Goodwill comprises the reputation and customer relationships of an existing business. If the price you pay for the business exceeds the fair market value of all of the rest of the assets of the business, the excess may be considered goodwill.

f) Have you made arrangements with the seller for payment of personal property taxes? No Yes

Lease Information (New & Transfer Applicants who are leasing the premises only)

a) Date lease begins _____ Ends _____

b) Monthly rental \$ _____

c) Do you have an option to renew the lease? No Yes

d) Does your lease allow for assignment to another party without the consent of the owner? No Yes

e) For what length of time have you been guaranteed occupancy (number of years)? _____

Lease Information (Continued)

- f) In addition to paying the monthly rental, will you have to pay anything additional to the owner of the building to guarantee performance of the lease? No Yes If yes, explain _____
- g) Does the present owner or occupancy object to the granting of your license? No Yes
If yes, explain _____

Change of Agent Applicants Only

Have there been any changes to the floor plan since the last application was submitted? No Yes
If no, a new floor plan is not required. If yes, submit a new floor plan and explain the change(s): _____

Signature

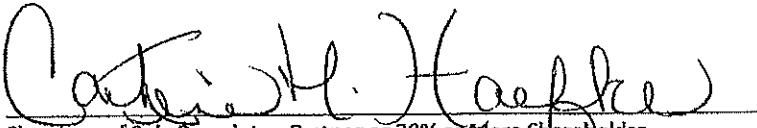

Signature of Sole Proprietor, Partner or 20% or More Shareholder
(If no 20% or more Shareholder, Corporate Officer - print name/title and sign)

Note: All information contained in this application is subject to approval by the Common Council.
Deviating from approved plan of operation will subject licensee to citations, and/or suspension or non-renewal of the license.
Contact the License Division for information on how to request changes.

New and transfer of premises applicants must submit the following:

- Detailed floor plan
 If a restaurant, copy of the menu



PUBLIC ENTERTAINMENT PREMISES LICENSE SUPPLEMENTAL APPLICATION

Office of the City Clerk License Division
200 E. Wells St. Room 105, Milwaukee, WI 53202
(414) 286-2238 www.milwaukee.gov/license e-mail address: license@milwaukee.gov

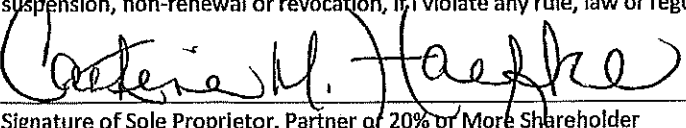
PREMISES ADDRESS:			
TYPES OF ENTERTAINMENT (CHECK ALL THAT APPLY)			
<input type="checkbox"/> Instrumental Musicians	<input type="checkbox"/> Battle of the Bands	<input type="checkbox"/> Dancing by Performers	<input type="checkbox"/> Amusement Machines How many? _____
<input type="checkbox"/> Bands	<input type="checkbox"/> Comedy Acts	<input type="checkbox"/> Adult Entertainment/ Strippers/Erotic Dance	<input type="checkbox"/> Concerts Approx. # per year? _____
<input checked="" type="checkbox"/> Bowling Alley How many? <u>2</u>	<input type="checkbox"/> Disc Jockey	<input type="checkbox"/> Wrestling	<input type="checkbox"/> Theatrical Performances Approx. # per year? _____
<input type="checkbox"/> Pool Tables How many? _____	<input type="checkbox"/> Magic Shows	<input type="checkbox"/> Patron Contests	<input checked="" type="checkbox"/> Jukebox
<input type="checkbox"/> Motion Pictures (movies by admission) - How many? _____	<input type="checkbox"/> Poetry Readings	<input type="checkbox"/> Patrons Dancing	<input type="checkbox"/> Karaoke
<input type="checkbox"/> Other: _____			
<i>Entertainment Outdoor Closing Hours: 10:00pm Sunday-Thursdays; 12:00am Friday & Saturday; unless a different time, either earlier or later, is established by the Common Council in its approval of the licensee's plan of operation.</i>			
PROMOTERS/SOUND AMPLIFICATION			
Will promoters ever be used for any of the entertainment? <input checked="" type="checkbox"/> No <input type="checkbox"/> Yes If Yes, Describe:			
At any time will sound amplification be used? <input checked="" type="checkbox"/> No <input type="checkbox"/> Yes If Yes, Describe:			
LEGAL CAPACITY OF PREMISES			
_____ (Call the Development Center at 414-286-8211 with questions.) Legal capacity determines the fee for your Public Entertainment Premises License. If you would like to request the license be approved with a lower capacity than that listed above, indicate the lower capacity here: _____. If approved, this lower capacity will print on your license and override the capacity listed on your Occupancy Permit.			
ACKNOWLEDGEMENT/SIGNATURE			
I understand that after the license has been issued, a change to the plan of operation will require a written request to change and approval from the Common Council. I agree to inform the City Clerk within 10 days of any substantial changes in the information supplied in this application. I understand that I shall not willfully refuse to provide the services offered under this license, or add charges or require deposits not required of the general public because of race, color, sex, religion, national origin or ancestry, age, handicap, lawful source of income, marital status, sexual orientation, gender identity or expression, familial status or the fact that a person is now or has been a member of the military service, whether dressed in uniform or not; and shall not seek such information as a condition of employment, or penalize any employee or discriminate in the selection of personnel for training or promotion on the basis of such information.			
I have knowledge of the City Ordinances currently regulating public entertainment, and understand that the license may be subject to suspension, non-renewal or revocation, if I violate any rule, law or regulation of the city of Milwaukee and State of Wisconsin.			
 _____ Signature of Sole Proprietor, Partner or 20% or More Shareholder (If no 20% or more Shareholder, Corporate Officer - print name/title and sign)			

Office Use Only:

Initials: _____ Filed: _____ App: _____

Only PEP? No Yes If Yes, Queue to MPD and Email Mgrs/Team Lead (must be heard w/in 60 days)

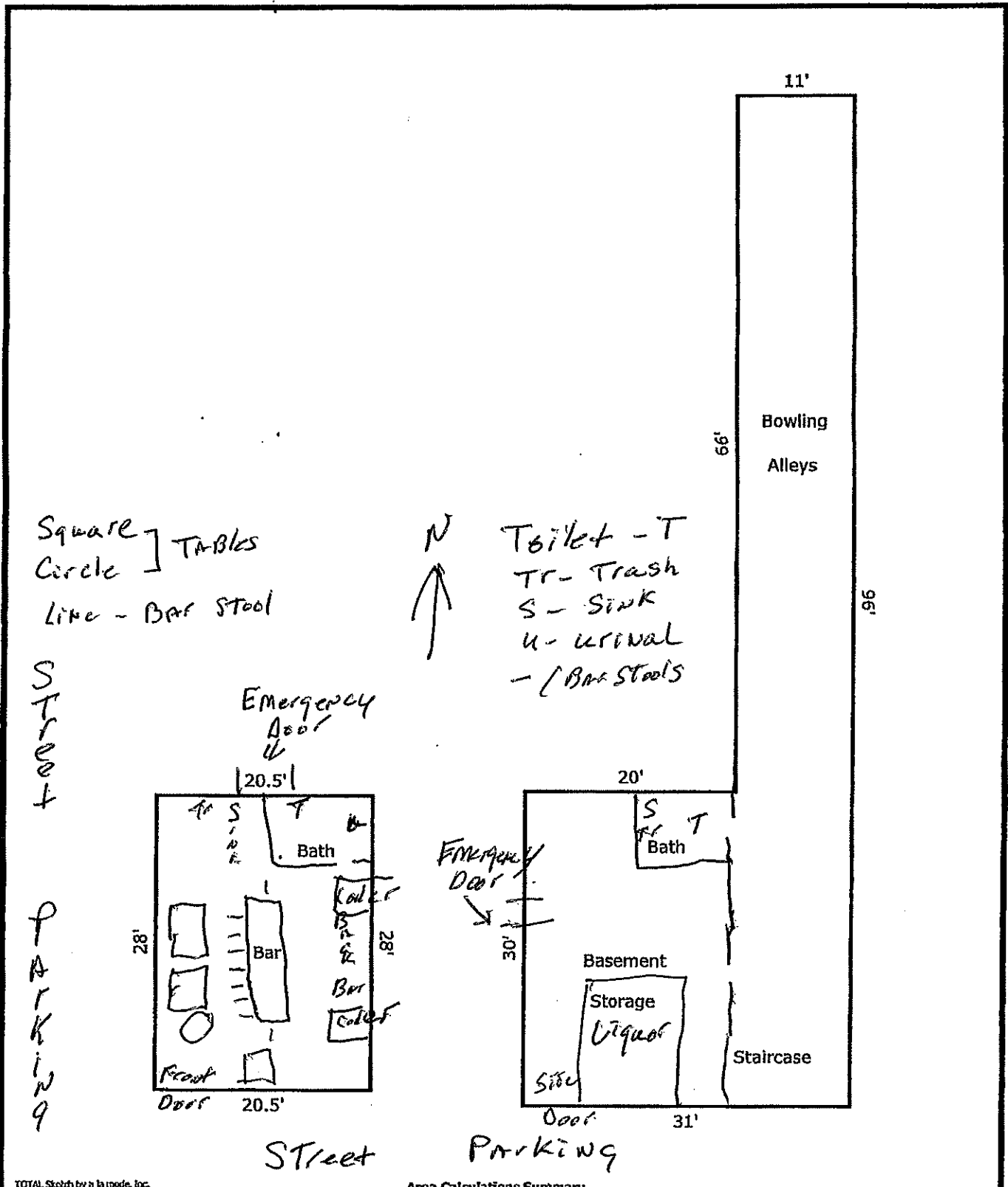

TOTAL Sketch by a la mode, Inc.

Area Calculations Summary

	Area	Calculation Details
Living Area		
First floor	574 Sq ft	28 × 20.5 = 574
Total Living Area (Rounded):	574 Sq ft	
Non-living Area		
Basement	1656 Sq ft	31 × 30 = 930 66 × 11 = 726