



**CITY OF MILWAUKEE  
OFFICE OF THE CITY CLERK**

Wednesday, June 30, 2021

**COMMITTEE MEETING NOTICE**

AD 04

ALBANO, Michael J, Agent  
Angelos Pizza, LLC  
12638 W Euclid Av

New Berlin, WI 53157

You are requested to attend a virtual hearing to be held on:

**Tuesday, July 13, 2021 at 10:25 AM**

**Regarding:** Your Class B Beer and Temporary Food Dealer License Applications as agent for "Angelos Pizza, LLC" for "Angelos Pizza" at 200 N Harbor DR #Area L.

This meeting will be held via GoToMeeting. Please see the enclosed best practices document for further instructions. The access code is <https://global.gotomeeting.com/join/175284253>. If you wish to call in, please call +1 (571) 317-3122 and use Access Code: 175-284-253.

There is a possibility that your application may be denied for one or more of the following reasons: The recommendation of the committee regarding the application shall be based on evidence presented at the hearing. Per MCO 85-2.7-4, probative evidence concerning whether or not a new license should be granted may be presented on the following subjects: whether or not the applicant meets the municipal requirements, the appropriateness of the location and premises where the licensed premises is to be located and whether use of the premises for the purposes or activities permitted by the license would tend to facilitate a public or private nuisance or create undesirable neighborhood problems such as disorderly patrons, unreasonably loud noise, litter, and excessive traffic and parking congestion. Probative evidence relating to these matters may be taken from the plan of operation submitted with the license application, if any, but shall not include the content of any music. Evidence regarding the fitness of the location of the premises to be maintained as the principal place of business, including but not limited to whether there is an overconcentration of businesses of the type for which the license is sought; whether the proposal is consistent with any pertinent neighborhood business or development plans, or the location's proximity to areas where children are typically present. The applicant's record in operating similarly licensed premises; and whether or not the applicant has been charged with or convicted of any felony, misdemeanor, municipal offense or other offense, the circumstances of which substantially relate to the activity to be permitted by the license being applied for or any other factor which reasonably relates to the public health, safety or welfare may also be considered. See attached police report or correspondence.

**Notice for applicants with warrants or unpaid fines:** Proof of warrant satisfaction or payment of fines must be submitted at the hearing on the above date and time. Failure to comply with this requirement may result in a delay of the granting/denial of your application.

Failure to attend this meeting may result in the denial of your license. Individual applicants and partnership applicants must attend or attend by an attorney. The agent or attorney for corporate or limited liability applicants must attend. If you wish to do so and at your own expense, you may be accompanied by an attorney of your choosing to represent you at this hearing.

You will be given an opportunity to speak on behalf of the application and to respond and challenge any charges or reasons given for the denial. No petitions can be accepted by the committee, unless the people who signed the petition attend the virtual hearing and are willing to testify. You may present witnesses under oath and you may also confront and cross-examine opposing witnesses under oath. If you have difficulty with the English language, you should request an interpreter attend the meeting with you, at your expense, so that you can answer questions and participate in your hearing.

PLEASE NOTE: Upon reasonable notice, efforts will be made to accommodate the needs of disabled individuals through sign language interpreters or other auxiliary aids. For additional information or to request this service, contact the Council Services Division ADA Coordinator at (414) 286-2998, Fax - (414) 286-3456, TDD - (414) 286-2025.

JIM OWCZARSKI, CITY CLERK

BY: \_\_\_\_\_

Jim Cooney  
License Division Manager

If you have questions regarding this meeting, please contact the staff assistant, Molly Kuether-Steele at (414) 286-2775 or [molly.kuether-steele@milwaukee.gov](mailto:molly.kuether-steele@milwaukee.gov).

200 E. Wells Street, Room 105, City Hall, Milwaukee, WI 53202. [www.milwaukee.gov/license](http://www.milwaukee.gov/license)  
Phone: (414) 286-2238 Fax: (414) 286-3057 Email Address: [License@milwaukee.gov](mailto:License@milwaukee.gov)

# MILWAUKEE POLICE DEPARTMENT LICENSING

## CRIMINAL RECORD/ORDINANCE VIOLATION/INCIDENTS SYNOPSIS

DATE: 06/17/21  
LICENSE TYPE: Class B Tavern  
NEW:   
RENEWAL:

No. 325554  
Application Date: 06/16/21

License Location: 200 N Harbor Dr #L  
Business Name: Angelos Pizza

Licensee/Applicant: ALBANO, Michael J  
(Last Name, First Name, MI)  
Date of Birth: 06/26/1972

Home Address: 4868 S 23<sup>rd</sup> St  
City: Milwaukee State: WI Zip Code: 53221  
Home Phone:

This report is written by Police Officer Monreal, assigned to the License Investigation Unit, Days.

The Milwaukee Police Department's investigation regarding this application revealed the following:

1. On 08/17/2017 the applicant was cited for Operating while Intoxicated. He was convicted on 10/18/2017 and his license was revoked for 6 months.
2. On 08/28/2017 the applicant was charged in Milwaukee County with Operate Firearm while Intoxicated (Misdemeanor) (2 counts).

Charge 1: Operate Firearm while Intoxicated  
2: Operate Firearm while Intoxicated  
Finding 1: Guilty  
2: Dismissed but read in  
Sentence: 12 months' probation  
Date: 12/05/2017  
Case: 2017CM003018

Date: 06/17/21  
Officer: Monreal

City of Milwaukee Police Department  
90-5-1.5 Crime Prevention Survey  
Tavern Inspection

Name of Premise: Angelo's Pizza  
Address: 200 N. Harbor Dr.  
Phone: 414-507-9592

Owner: Albano, Michael J  
Owner address: 4868 S. 23<sup>rd</sup> St.  
City State Zip: Milwaukee, WI 53221  
Owner Phone: 414-507-9592  
Owner email: malbano55@gmail.com

Licensee/Agent: Same  
Home Address:  
City State Zip:  
Phone:  
Email:

Preferred contact: Same

Location currently open:  YES  NO

Projected open date: 09/21

Day's open: S M T W Th F SA ALL

Hours of Operation: Sun: 24 hours Y N

Mon:

Tue:

Thu: 12P-12A

Fri: 12P-12A

Sat: 12P-12A

Wed: "

Premise Type: Tavern/Bar  
Restaurant  
Other:

Licenses currently held:  
Alcohol: Yes No Class: #:

- Tobacco:  Yes  No #:  
 Food:  Yes  No #:  
 Extended Hours:  Yes  No #:  
 Secondhand Dealer:  Yes  No Type: #:  
 Other:  Yes  No Type: #:  
 Other:  Yes  No Type: #:

**Exterior Survey:**

1. Is the area around the location clean?  Yes  No
2. What surrounds the location? (Check all the apply)
  - a.  Park
  - b.  School
  - c.  Youth Center
  - d.  Church
  - e.  Tavern(s) If so, how many
  - f.  Residential
  - g.  Other businesses
  - h.  Other:
3. Can you see from the outside of the location into the interior  Yes  No
4. Can you see the employees inside of the location from the outside  Yes  No
5. Are exterior windows free of signage  Yes  No
6. Is there a parking lot  Yes  No
7. Is the parking lot clean?  Yes  No
8. Off-Street parking  Yes  No
9. Is the parking lot well lit?  Yes  No
10. Valet Parking  Yes  No
  - a. Will this lot have a guard?  Yes  No
  - b. Will this lot have cameras?  Yes  No
11. Are there areas where a person could conceal themselves  Yes  No
12. Is there exterior lighting?  Yes  No. Does it appears to be adequate  Yes  No
13. Exterior Payphone?  Yes  No
14. Are there No Loitering Signs posted?  Yes  No
15. Are there exterior security cameras  Yes  No How Many: Full MWF Grounds
16. Are the address numbers prominently displayed and easy to see  Yes  No

**Camera Survey:**

17. Does this location have security cameras?  Yes  No
18. Are they in working order?  Yes  No
19. What format are the cameras?
  - a. Color  Yes  No
  - b. Digital  Yes  No
  - c. Recorded  Yes  No
20. How long is footage stored for later viewing: 30 Days
21. Are there exterior cameras  Yes  No How many: Full MWF Grounds
22. Are there interior cameras  Yes  No How many:
23. Do all employees know how to retrieve recorded digital images/footage?  Yes  No
24. Cameras located in parking lot  Yes  No How many Full MWF Grounds

**Interior Survey:**

- 25. What is the planned capacity 2000+
- 26. What is the minimum number of employees That will be on premise 1
- 27. Is the storeowner willing to be a standing complainant regarding loitering? Yes No
  - a. If yes have them fill out the standing complaint form and give them two of the commercial signs Yes No
- 28. Is the interior of the location neat and clean? Yes No
- 29. Does an interior camera face the entrance/exit? Yes No
- 30. Is there a lockable area that separates employees from customers? Yes No
- 31. Are emergency and non-emergency numbers posted near the phone? Yes No
- 32. Does the owner know how to contact their police district directly? Yes No
  - a. Did you provide a district contact guide to the owner? Yes No

**Security**

- 33. How many security personnel are going to be employed: 50+
- 34. How ill they be deployed: Interior Exterior50+
- 35. What days will they be deployed MonTueWedThuFriSatSun
- 36. Will the security be managed by business or contracted
- 37. Will they be armed Yes No
- 38. What type of security measures to be used:
  - Wanding/metal detector
  - ID Scanner
  - Dress Code
  - Cover Charge
  - Age restriction
  - Other

**ADDITIONAL COMMENTS/RECOMMENDATIONS:**

All security cameras and security personnel are contracted and monitored by Milwaukee World Festival Grounds and Security.



# BUSINESS LICENSE PLAN OF OPERATION

ccl-busplan 5/12/2020

Office of the City Clerk License Division  
200 E. Wells St. Room 105, Milwaukee, WI 53202  
(414) 286-2238 www.milwaukee.gov/license e-mail address: license@milwaukee.gov

## 1. Type of Business

Applying for:  Extended Hours (12AM to 5AM) - If a food establishment, check all that apply:  Delivery  Drive Thru  Dining Room  
 Self Service Laundry  Massage Establishment  Filling Station  
 Other (supplemental application for specific license also required)

Provide a detailed description of the type of business you plan on operating:

ANGEL'S PIZZA SELLS, PIZZA, SANDWICHES, APPETIZERS AND BEVERAGES AT SUMMERFEST

Do you have any experience operating this type of business?  No  Yes If yes, explain: BEEN AT SUMMERFEST FOR LAST 16 YEA

## 2. Business Operations

- a. Proposed Opening Date: SEPT 2<sup>ND</sup> 2021
- b. Is this premise under construction?  No  Yes If yes, list estimated completion date: \_\_\_\_\_
- c. Is this a franchise?  No  Yes
- d. Is this premises currently licensed?  No  Yes If yes, list type of license: TEMPORARY FOOD DEALER'S LICENSE
- e. Is the current licensee operating?  No  Yes If no, list date closed: ONLY OPERATES DURING SUMMERFEST
- f. Do you have future plans for other businesses, licenses or permits at this location?  No  Yes  
If yes, explain: \_\_\_\_\_
- g. Have you previously held an Extended Hours License in Milwaukee?  No  Yes  
If yes, list address(es): \_\_\_\_\_
- h. Are other businesses operating in the same building?  No  Yes If yes, describe: \_\_\_\_\_

## 3. Litter & Noise

- a. How are grounds kept clean?  Sweep  Pressure Wash  Pick Up Litter  Other: \_\_\_\_\_
- b. How often will grounds be cleaned?  Daily  Weekly  As Needed  Monthly  Other: \_\_\_\_\_
- c. Grounds cleaned by:  Licensee  Building Owner  Employees  Hired Maintenance  Other: \_\_\_\_\_
- d. How are noise issues prevented and/or addressed?  Security  Manager approaches customer(s)  Call Police  
 Signs Posted  Other: \_\_\_\_\_
- e. Will a sound amplification system be used?  No  Yes If yes, describe: \_\_\_\_\_

## 4. Smoking & Sanitation

- a. Are there designated outdoor smoking areas?  No  Yes If yes, describe: \_\_\_\_\_
- b. Number of Garbage Cans: Inside: 8 Locations: \_\_\_\_\_  
Outside: TBD Locations: UNDER MILWAUKEE WORLD FESTIVAL CONTROL
- c. Is a crowd control barrier used?  No  Yes If yes, describe: DEPENDS ON CROWD UNDER MWF CONTROL
- d. How many restrooms are on the premises? MANY
- e. Name of solid waste contractor:  Advanced Disposal  Waste Management  Other: NOT SURE MWF CONTRACT!

### 5. Security

- a. Are there onsite parking spaces?  No  Yes If yes, how many? \_\_\_\_\_ and describe the parking security plan: \_\_\_\_\_
- b. Is there a loading zone?  No  Yes If yes, describe the loading area security plan: \_\_\_\_\_
- c. Will you have security personnel on premise?  No  Yes If yes, how many? \_\_\_\_\_ and answer the following:  
 What are their responsibilities? \_\_\_\_\_  
 Is security equipment used?  No  Yes If yes, describe ALL SECURITY IS RUN  
 List their licensing, certification, or training credentials BY MILWAUKEE WORLD FESTIVALS
- d. Will there be security cameras?  No  Yes If yes, how many? NOT SURE and list locations: \_\_\_\_\_  
RUN BY MWF
- e. Will searches/identification checks be done upon entry?  No  Yes If yes, describe METAL DETECTION AND BIF SEARCH

### 6. Percentage of Sales (must total 100%)

Alcohol <u>15</u> %	Food <u>85</u> %	Secondhand Merchandise _____ %	Precious Metals & Gems _____ %
Entertainment <u>NA</u> %	Cigarettes _____ %	Personal Services (such as tattoo, body piercing, salon, tailor, tanning, etc.) _____ %	Other _____ % Describe: _____
Pawnbroker Activity _____ %	Salvaged Materials _____ % (such as scrap metal)		

### 7. Businesses/Licenses on the Premises (check all that apply):

#### Type 1

- Full Service Restaurant     Cafe/Coffee Shop     Deli or Fast Food Restaurant     Private/Fraternal/Veterans Club
- Night Club     Tavern     Cocktail Lounge     Teen Club
- Banquet Hall     Sports Facility     Bowling Alley
- Hotel/Motel: Number of Floors: \_\_\_\_\_     Rooming House: Number of Floors: \_\_\_\_\_  
 Number of Rooms: \_\_\_\_\_    Number of Rooms: \_\_\_\_\_

#### Type 2

- Liquor Store     Corner Store     Supermarket     Convenience Store
- Gas Station     Amusement/Phonograph Distributor     Recycling, Salvage or Towing
- Used Car Dealer     Personal Service Establishment  
 (such as tattoo business, hair salon, tailor, etc.)     Recording Studio

What other licenses/permits will you hold at this location? (check all that apply)

- Occupancy Permit     Cigarette & Tobacco     Gas Station     Extended Hours     Class "B" Tavern     Weights & Measures
- Secondhand Dealer     Precious Metal & Gem     Other: \_\_\_\_\_

### 8. Legal Capacity (only if a Type 1 premises in #7 above)

Capacity \_\_\_\_\_ (Call the Milwaukee Development Center at 414-286-8211 if you have questions.)

### 9. Premises Description

- a. Identify all area(s) of the premises that will be used in operating this business (include areas used only for storage):  
 1<sup>st</sup> Floor  2<sup>nd</sup> Floor  Basement Storage  Patio  Beer Garden  Sidewalk Café  Deck  Rooftop  
 Other: Describe: AREAL BUILDING #32 BX10 OUTSIDE COOLER
- b. Describe Location:  Major Thoroughfare  Secondary Street  Other: \_\_\_\_\_
- c. Nearest Major Cross Street: \_\_\_\_\_
- d. Describe Building:  Free Standing Building  Strip Mall  Other: \_\_\_\_\_
- e. Describe Premises Structure:  Single Story  Multi-Story - # of Stories \_\_\_\_\_  Other: \_\_\_\_\_
- f. Describe Surrounding Area:  Commercial  Residential  Industrial  Other: FESTIVAL
- g. Building Owner Name: MILWAUKEE WORLD FESTIVAL Phone Number: 414-273-2680  
 Building Owner Address: 200 N HARBOR DRIVE MILWAUKEE WI, 53202

### 10. Hours of Operation & Customers

Will customers be entering the premises?  No  Yes

Day of the Week	Proposed Hours of Operation:		Estimated Number of Customers expected each day	Potential Age Range of Customers	Class B Tavern Applicant Only: Age Restriction (If none, write 'None')
	Open Time (include a.m. or p.m.)	Close Time (include a.m. or p.m.)			
Sunday	<u>closed</u>	<u>closed</u>			
Monday	↓	↓			
Tuesday	↓	↓			
Wednesday	↓	↓			
Thursday	<u>12:00 pm</u>	<u>12 AM</u>	<u>0-2000</u>	<u>0-100</u>	
Friday	<u>12:00 pm</u>	<u>12 AM</u>	↓	↓	
Saturday	<u>12:00 pm</u>	<u>12 A.M</u>	↓	↓	

An Extended Hours Establishment License is required for any convenience store, filling station, personal service establishment (such as tattoo, body piercing, salon, tailor, tanning, etc.), recording studio or restaurant which is open between the hours of 12:00 a.m. and 5:00 a.m.

Alcohol Establishments Class A: 8:00 am to 9:00 pm Sunday thru Saturday  
 Permitted Hours of Operation: Class B: 6:00 am to 2:00 am Sunday thru Thursday, 6:00 am to 2:30 am Friday & Saturday  
 Entertainment Outdoor Closing Hours: 10:00pm Sunday-Thursday; 12:00am Friday & Saturday; unless a different time, either earlier or later, is established by the Common Council in its approval of the licensee's plan of operation.

### 11. Signature(s)

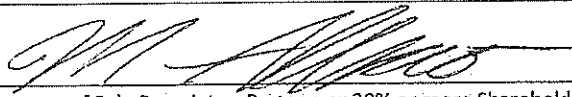
  
 Signature of Sole Proprietor, Partner, or 20% or more Shareholder  
 (If there are no 20% or more shareholders, Corporate Officer-print name/title and sign)

\_\_\_\_\_  
 Signature of additional partner or 20% or more shareholder

See Application Information for a complete list of all required application forms.





# ALCOHOL BEVERAGE & PUBLIC ENTERTAINMENT PREMISES SUPPLEMENTAL APPLICATION

Office of the City Clerk License Division  
200 E. Wells St. Room 105, Milwaukee, WI 53202  
(414) 286-2238 e-mail address: license@milwaukee.gov www.milwaukee.gov/license

Legal Entity Name:	Angelo's Pizza LLC
Premise Address:	200 N HARBOR DRIVE MILWAUKEE WI. 53202
<b>Proximity of Premises to Church, School, Daycare Center or Hospital</b>	
Is the building within 300 feet of any church, school, daycare center or hospital?	<input checked="" type="checkbox"/> No <input type="checkbox"/> Yes
<b>"Service Bar Only" Designation</b>	
If applying for Class B or C license, are you applying for "Service Bar Only"?	<input type="checkbox"/> No <input checked="" type="checkbox"/> Yes
Service Bar Only means customers cannot sit at the bar. Alcohol is served to employees who serve patrons seated at tables. No stools, chairs or other articles of furniture shall be placed at the service bar for patrons to sit upon.	
<b>Business Information</b>	
a) Are you taking out this application for anyone that may not be eligible for a license?	<input checked="" type="checkbox"/> No <input type="checkbox"/> Yes
If yes, list their name and address: _____	
b) Will the agent, a partner or the individual licensee be conducting the day-to-day operations of the business?	<input type="checkbox"/> No <input checked="" type="checkbox"/> Yes
If no, list the name and address of the person(s) who will: _____	
Class B Applicants: If the agent, a partner or the individual licensee will not be conducting the day-to-day operations of the business, the person(s) listed above must obtain a Class B Managers license.	
c) Does anyone else have money invested or any other interest in this business?	<input checked="" type="checkbox"/> No <input type="checkbox"/> Yes
If yes, explain: _____	
d) Have you made an agreement with anyone to repay any loan or any other payments based upon income from the business?	<input checked="" type="checkbox"/> No <input type="checkbox"/> Yes
If yes, list name and address: _____	
<b>Property Information (New &amp; Transfer Applicants Only)</b>	
a) Do you own or lease the building?	<input type="checkbox"/> Own <input checked="" type="checkbox"/> Lease
b) Who owns the fixtures (for example, coolers, etc.)?	MILWAUKEE WORLD FESTIVALS
c) Are you purchasing the stock and/or fixtures?	<input checked="" type="checkbox"/> No <input type="checkbox"/> Yes If yes, amount paid \$ _____
d) Total amount paid for business	\$ COMMISSION BASED
e) Total amount paid for goodwill of the business	\$ _____
Goodwill comprises the reputation and customer relationships of an existing business. If the price you pay for the business exceeds the fair market value of all of the rest of the assets of the business, the excess may be considered goodwill.	
f) Have you made arrangements with the seller for payment of personal property taxes?	<input checked="" type="checkbox"/> No <input type="checkbox"/> Yes
<b>Lease Information (New &amp; Transfer Applicants who are leasing the premises only)</b>	
a) Date lease begins	SEPT 2 2021 Ends SEPT 19, 2021
b) Monthly rental	\$ COMMISSION BASED
c) Do you have an option to renew the lease?	<input type="checkbox"/> No <input checked="" type="checkbox"/> Yes
d) Does your lease allow for assignment to another party without the consent of the owner?	<input checked="" type="checkbox"/> No <input type="checkbox"/> Yes
e) For what length of time have you been guaranteed occupancy (number of years)?	1-2 YEAR CONTRACTS

**Lease Information (Continued)**

- f) In addition to paying the monthly rental, will you have to pay anything additional to the owner of the building to guarantee performance of the lease?  No  Yes If yes, explain \_\_\_\_\_
- g) Does the present owner or occupancy object to the granting of your license?  No  Yes  
If yes, explain \_\_\_\_\_

**Change of Agent Applicants Only**

Have there been any changes to the floor plan since the last application was submitted?  No  Yes  
If no, a new floor plan is not required. If yes, submit a new floor plan and explain the change(s):  
\_\_\_\_\_

**Signature**

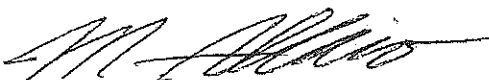

Signature of Sole Proprietor, Partner or 20% or More Shareholder  
(if no 20% or more Shareholder, Corporate Officer - print name/title and sign)

Note: All information contained in this application is subject to approval by the Common Council.  
Deviating from approved plan of operation will subject licensee to citations, and/or suspension or non-renewal of the license.  
Contact the License Division for information on how to request changes.

**New and transfer of premises applicants must submit the following:**

- Detailed floor plan
- If a restaurant, copy of the menu



March 8, 2021

City Clerk – License Division  
200 E Wells Street, Room 105  
Milwaukee, WI 53202

To Whom It May Concern:

Milwaukee World Festival, Inc. leases the land at 100 N. Harbor Drive from the City of Milwaukee. Milwaukee World Festival, Inc. is the sole member of MWF, LLC. As such Milwaukee World Festival, Inc. authorizes MWF, LLC to occupy and use 100 N. Harbor Drive.

MWF, LLC authorizes the following entities to occupy and use the areas designated on the enclosed map.

ANGELOS PIZZA LLC	Area L
BELAIR CANTINA, INC	Area C
BELAIR CANTINA, INC	Area N
BOTANAS, LLC	Area R
MADER'S GERMAN RESTAURANT, INC	Area Q
MAJOR GOOLSBY'S, INC	Area J
SAZ'S FESTIVAL, LLC	Area P
THE CHAR-GRILL, INC	Area K
VENICE CLUB FESTIVALS, INC	Area M

Sincerely,

*Susan D. Landry, VP/CFO*

Susan D. Landry  
VP / CFO

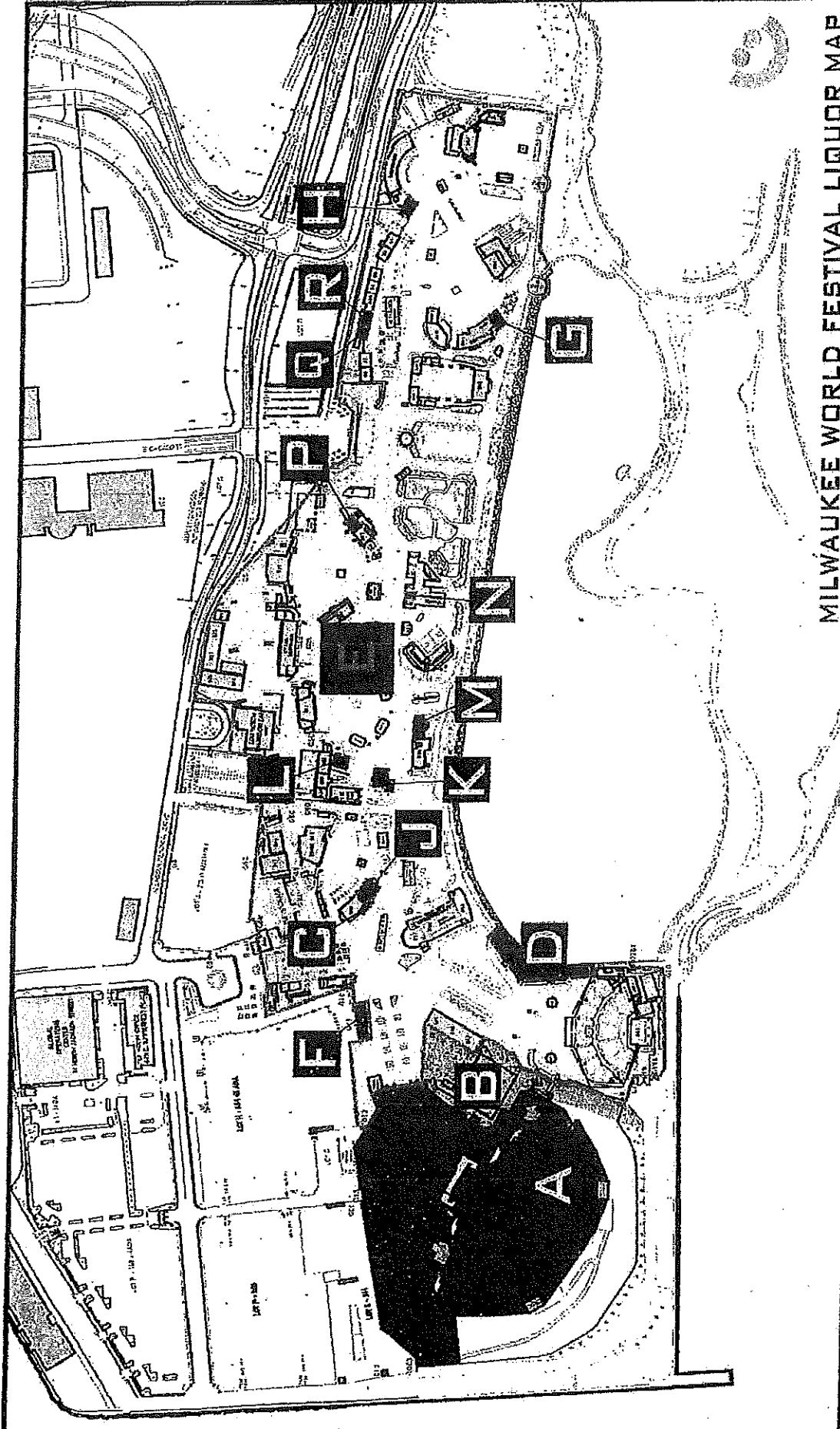

MILWAUKEE WORLD FESTIVAL LIQUOR MAP

<b>A</b>	MWLF, LLC 100 N. HARBOR DRIVE	<b>E</b>	MWLF, LLC EXTENSION	<b>J</b>	MAJOR BOOLSBY'S, INC.	<b>N</b>	BELAIR CANTINA, INC
<b>B</b>	JOJO'S MARTINI BAR LLC	<b>F</b>	SAZ'S FESTIVALS, LLC	<b>K</b>	THE CHAR-GRILL INC.	<b>P</b>	SAZ'S FESTIVAL, LLC
<b>C</b>	BELAIR CANTINA, INC	<b>G</b>	SAZ'S FESTIVALS, LLC	<b>L</b>	ANGELOS PIZZA LLC	<b>Q</b>	MADER'S GERMAN RESTAURANT, INC.
<b>D</b>	SAZ'S FESTIVALS, LLC	<b>H</b>	MADER'S GERMAN RESTAURANT, INC.	<b>M</b>	VENICE CLUB FESTIVALS, INC	<b>R</b>	BOTANAS, LLC



Revisions: 1/15/03

Scale: NTS  
Drawn by: JLS

# MILWAUKEE WORLD FESTIVAL, INC.

200 N. HARBOR DRIVE MILWAUKEE, WI 53202 PHONE: 414-273-2680



## Angelo's PIZZA LLC

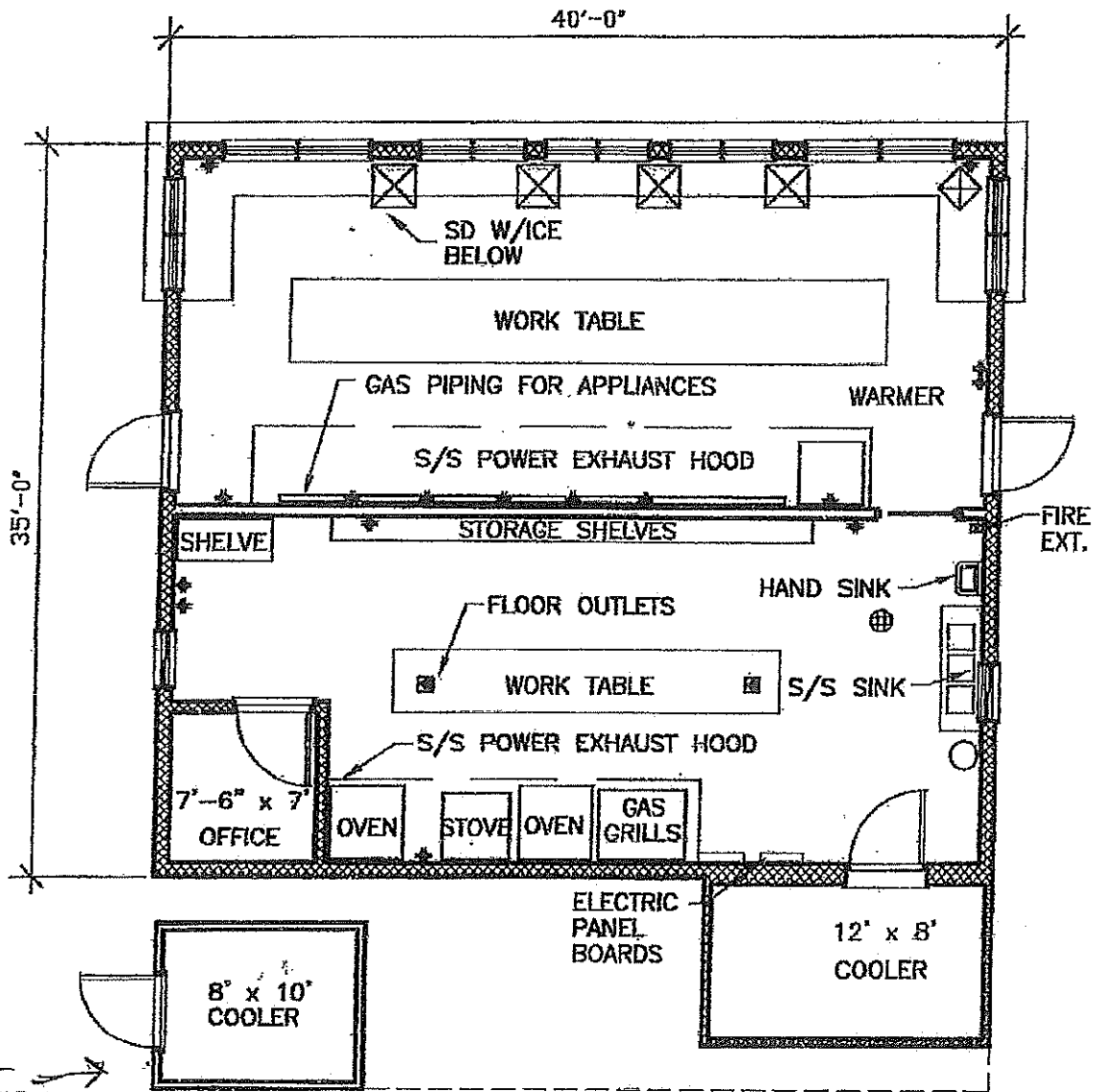

NOTE: EXHAUST HOOD INCLUDE FIRE SUPPRESSION SYSTEM



APPROXIMATE SQ. FOOTAGE: 1,400

CONSTRUCTION NOTES: WOOD FRAME

# BUILDING # 32

DRAWN BY: RJS/WDD/IPK

C.A.: N/A

REV. 05/17/12

SCALE: 1/8" = 1'-0"

PAGE # 59

ADDENDUM TO 2021

AGREEMENT BETWEEN MILWAUKEE WORLD FESTIVAL, INC.

AND ANGELOS PIZZA LLC dba ANGELO'S

, VENDOR

*\*Please include "extra" menu items on this list for POS programming purposes (i.e. extra onions @ \$.50).*

MENU ITEM	PORTION/DESCRIPTION	PRICE	DIET-FRIENDLY? List all that apply. GF, VG, VT
Cheese Pizza - 1/4	1/4 of a 14" pizza	\$6.75	Vegetarian
Cheese Pizza - Whole	14" Whole pizza	\$22.50	Vegetarian
Cheese & Sausage - 1/4	1/4 of a 14" pizza	\$7.25	
Cheese & Sausage - Whole	14" Whole pizza	\$23.25	
Cheese & Pepperoni - 1/4	1/4 of a 14" pizza	\$7.25	
Cheese & Pepperoni - Whole	14" Whole pizza	\$23.25	
Cheese, Spinach, Fresh Tomato & Garlic - 1/4	1/4 of a 14" pizza	\$7.50	Vegetarian
Cheese, Spinach, Fresh Tomato & Garlic - Whole	14" Whole pizza	\$24.25	Vegetarian
Chicago-Style Stuffed Pizza	Cheese, Sausage, Pepperoni, Fresh Tomato, Fresh Garlic w/ Romano Cheese Crust		
	1/6 of a 14" pizza	\$8.75	
	14" Whole pizza	\$33.25	
Lasagna Stick Marinara	Three (3) - 4oz. Lasagna sticks. Served with 3oz. cup of Marinara	\$7.00	
Italian Beef	6oz Italian Beef, Provolone Cheese, Giardiniera	\$8.75	
Potato Chip Parmesan	6oz. fresh potato chips w/ cheese & spices	\$5.50	Vegetarian
Side of Marinara Sauce	Total weight = 3oz.	\$0.50	
Side of Jalapeños	3.25oz. cup of Jalapeño peppers	\$0.50	
Miller Lite	16oz Can	\$8.00	
Leinenkugel's Summer Shandy	16oz Can	\$9.25	
Blue Moon	16oz Can	\$9.25	
ALL BEVERAGES EXCEPT FROZEN DRINKS, SPECIALTY COFFEE DRINKS AND SMOOTHIES	THROWBACK THURSDAY: NOON - 6:00PM	50% OFF	
	SUNDAY FUNDAY: 4:00PM - 6:00PM	50% OFF	
Potato Chip Parmesan	CHILDREN'S DAY: NOON - 3:00PM	\$3.00	
Cheese Pizza	CHILDREN'S DAY: NOON - 3:00PM	\$3.50	

ADDENDUM TO 2021 AGREEMENT BETWEEN MILWAUKEE WORLD FESTIVAL, INC. AND ANGELOS PIZZA LLC dba ANGELO'S, VENDOR

Please click/check the box for all that apply:

Fountain Beverages (Bag-In-Box):

Most dispensers can accommodate 6 - 8 flavors.

- Cup Size(s): [x] 16 oz. Cup \$4.25, [x] 32 oz. Souvenir Cup \$5.75, [ ] 44 oz. Cup \$6.75

- Choose Flavor(s): [x] Pepsi, [x] Diet Pepsi, [x] Mountain Dew, [ ] Unsweetened Iced Tea, [x] Mist TWST, [ ] Lipton 1/2 and 1/2 Half iced tea & half lemonade

Bottled Beverages - 20 oz. at \$4.75 per bottle

- Choose Flavor(s): [x] Pepsi, [x] Sierra Mist, [x] Lipton Green Tea, [x] Diet Pepsi, [x] Mountain Dew, [ ] Lipton Lemonade, [x] Lipton Diet Green Tea

Aquafina 20 oz. at \$4.75 per bottle (Aquafina)

Bubly Sparkling Water - 16 oz. at \$4.00 per can

- Choose Flavor(s): [x] Lime, [x] Blackberry, [x] Cherry

Red Bull Energy - 8.3oz. can at \$4.75 per can

- Choose Flavor(s): [x] Original, [x] Sugarfree, [x] Yellow Edition (Tropical)

Other Beverage - \$2.25 per beverage

- Choose Flavor(s): [ ] Coffee (8 oz. cup), [ ] Hot Tea (8 oz. cup), [ ] Hot Chocolate (8 oz. cup)

Other Beverage - \$1.75 per beverage

- [ ] Milk (1/2 pint)

Children's Day: Noon - 3:00PM = 16oz. Fountain Soda + 20oz. Bottled Soda/Water are \$3.75ea.

Throwback Thursday: Noon - 6:00PM = All Beverages (except frozen drinks, specialty coffee drinks and smoothies) are 50% Off

Sunday Funday: 4:00PM - 6:00PM = All Beverages (except frozen drinks, specialty coffee drinks and smoothies) are 50% Off

MILWAUKEE WORLD FESTIVAL, INC.

ANGELOS PIZZA LLC dba ANGELO'S

By: \_\_\_\_\_

By: \_\_\_\_\_

Julie A. Clemins
Food & Hospitality Operations Manager

Title: \_\_\_\_\_

Date: \_\_\_\_\_

Date: \_\_\_\_\_