



Certificate of Appropriateness—Amended

Milwaukee Historic Preservation Commission/200 E. Wells Street/Milwaukee, WI 53202/phone 414-286-5712/fax 414-286-3004

Property	2655 N. LAKE DR.	North Point North HD
Description of work	Build cedar fence in rear and side yard per attached materials. Sections facing Lake Drive will have the square lattice top. Other areas will be plain “universal design.”	
Date issued	7/16/2018	PTS ID 114573 COA: rear/side fence

In accordance with the provisions of Section 320-21 (11) and (12) of the Milwaukee Code of Ordinances, the Milwaukee Historic Preservation Commission has issued a certificate of appropriateness for the work listed above. The work was found to be consistent with preservation guidelines. The following conditions apply to this certificate of appropriateness:

All wood must be smooth and equivalent to #1 grade cedar or better when used in rear and side yards. Sections of fence forward of or in line with the primary building's front setback must be clear grain. Wood fences must be painted or stained with an opaque stain upon completion.

All work must be done in a craftsman-like manner, and must be completed within one year of the date this certificate was issued. Staff must approve any changes or additions to this certificate before work begins. Work that is not completed in accordance with this certificate may be subject to correction orders or citations. If you require technical assistance, please contact Historic Preservation staff as follows: Phone: (414) 286-5712 E-mail: hpc@milwaukee.gov.

If permits are required, you are responsible for obtaining them from the Milwaukee Development Center. If you have questions about permit requirements, please consult the Development Center's web site, www.milwaukee.gov/build, or call (414) 286-8210.

City of Milwaukee Historic Preservation Staff

Copies to: Development Center, Ald. Nik Kovac, Contractor

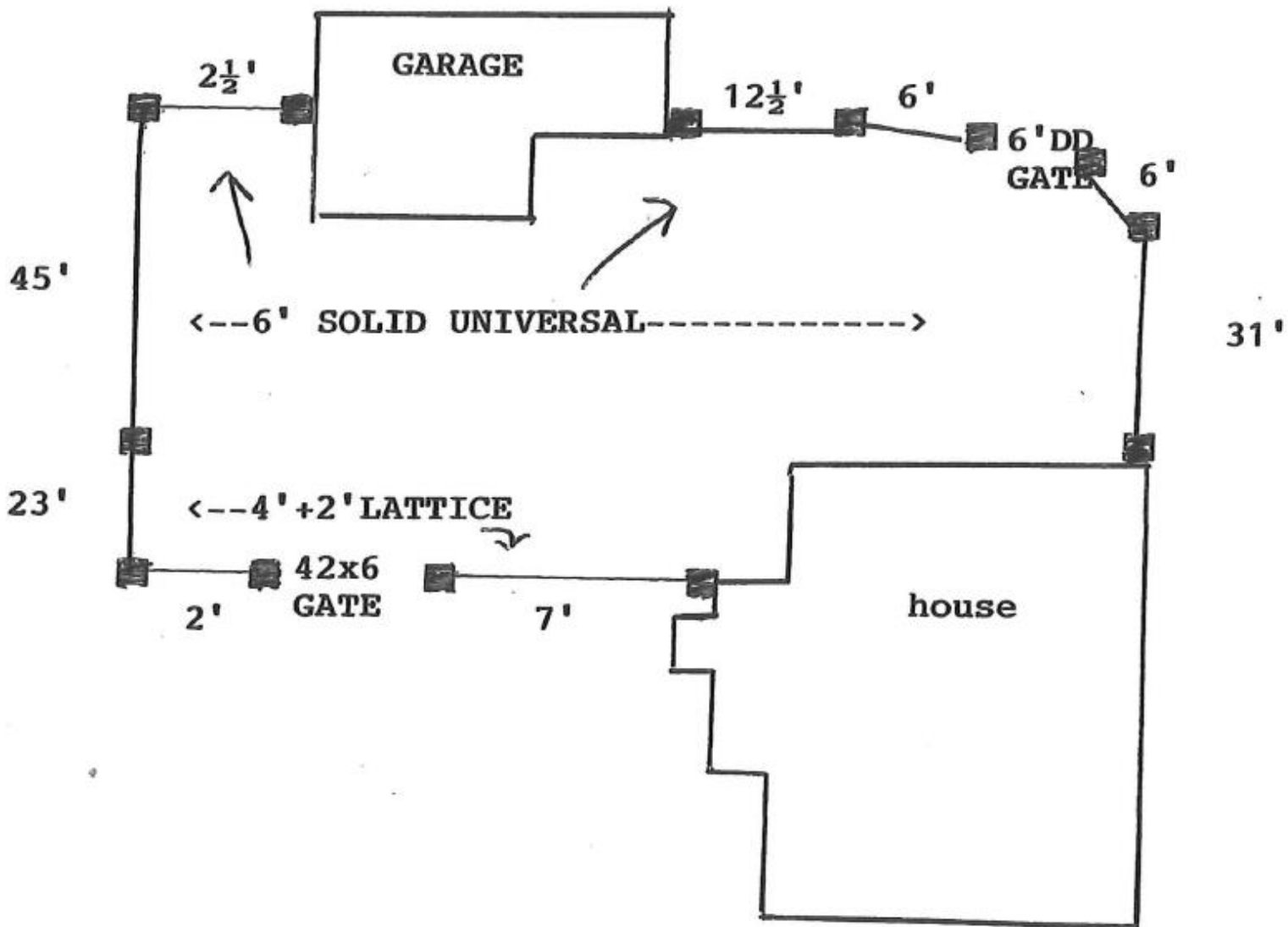

Site plan, north is at right

UNIVERSAL DESIGN



Approved fence styles; must be painted or stained with an opaque stain upon completion

UNIVERSAL WITH SQUARE LATTICE



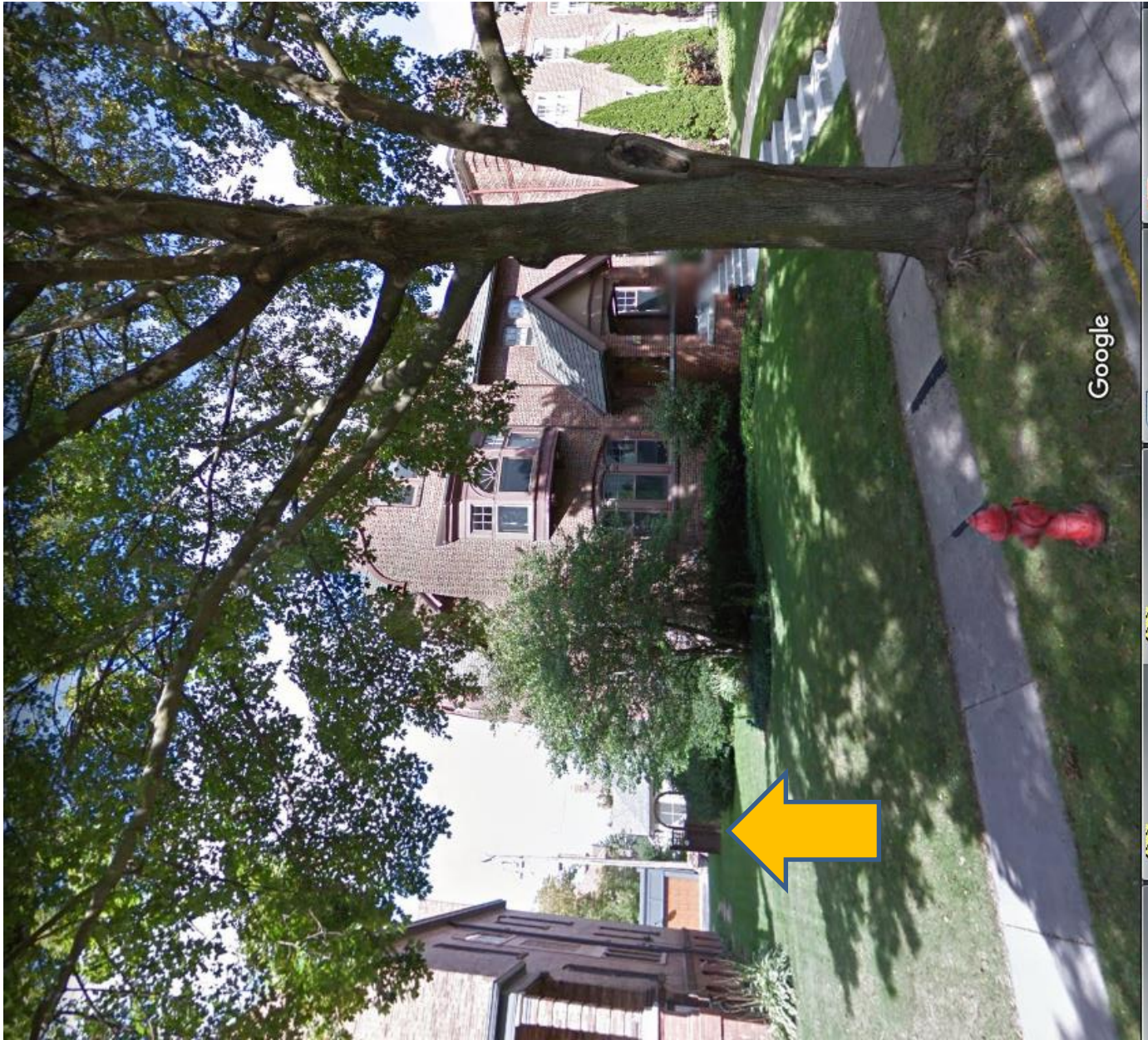

Existing conditions and existing fence. New fence will go in a similar location.