



<b><u>Primary Info</u></b>			
AHI Number	99997		
Historic Name			
Other Name			
Property Address	731 N 25TH ST		
County	Milwaukee	Municipality	Milwaukee
Civil Town		Unincorporated Community	
Parcel		PLSS (T-R-D-S-Q-QQ)	
Style	Contemporary	Wall Material	Brick
Historic Use	apartment/condominium	Structural System	Steel Frame
Year Built	1964	Year Demolished	
Structural Additions			
Architects	Richard Blake & Assoc.		
<b><u>Other Info</u></b>			
Survey Year	1984		
Tax Credit Project Number			
Tax Credit Case Number (legacy)			
WHS Project Number			
Bibliographic Reference			
Additional Comments			
<b><u>Other Eligibility Evaluation</u></b>			
Individual Eligibility Evaluation	Not Eligible		
Proposed Historic District			
Contributing			
Evaluation Date			
Eligibility Comments			





<b><u>Primary Info</u></b>			
<b>AHI Number</b>	112175		
<b>Historic Name</b>			
<b>Other Name</b>			
<b>Property Address</b>	734 N 26TH ST		
<b>County</b>	Milwaukee	<b>Municipality</b>	Milwaukee
<b>Civil Town</b>		<b>Unincorporated Community</b>	
<b>Parcel</b>		<b>PLSS (T-R-D-S-Q-QQ)</b>	
<b>Style</b>	Prairie School	<b>Wall Material</b>	Brick
<b>Historic Use</b>	social recreational/fraternal hall	<b>Structural System</b>	Balloon Frame
<b>Year Built</b>	1912	<b>Year Demolished</b>	
<b>Structural Additions</b>			
<b>Architects</b>	Leiser & Holst		

<b><u>Other Info</u></b>	
<b>Survey Year</b>	1984
<b>Tax Credit Project Number</b>	
<b>Tax Credit Case Number (legacy)</b>	
<b>WHS Project Number</b>	
<b>Bibliographic Reference</b>	
<b>Additional Comments</b>	

<b><u>Other Eligibility Evaluation</u></b>	
<b>Individual Eligibility Evaluation</b>	Not Eligible
<b>Proposed Historic District</b>	
<b>Contributing</b>	
<b>Evaluation Date</b>	
<b>Eligibility Comments</b>	



[◀ Previous Record](#)
[\[ Back to Search Results \]](#)
[Next Record ▶](#)
[Primary Info](#)
[National Register](#)
[Other Info](#)
[Map](#)
[Images](#)
[Documents](#)
 [Print](#)

**[#112266]**

Historic Name:

**Baebenroth's Pharmacy**

Other Name:

**Boris Tower Drugs**

Created By:

Created On: 10/14/2011

Updated By: Leah Penzkover

Updated On: 12/16/2024

#### Location Information

**County** Milwaukee

**Municipality** Milwaukee

**Civil Town**

**Unincorporated Community**

**Property Address** 760 N 27TH ST (A.K.A. 2639 W WELLS ST)

**Parcel**

**Public Land Survey System**

Township	Range	Direction	Section	QSection	QQSection

#### Property Characteristics

**Style** Commercial Vernacular

**Wall Material** Brick

**Historic Use** large retail building

**Structural System**

**Year Built** 1916

**Is Demolished** No

**Year Demolished**

**More Buildings On Site**

**Additions**

**Architect** Clare C. Hosmer



<b>Primary Info</b>			
AHI Number	111759		
Historic Name			
Other Name			
Property Address	805-811 N 22ND ST		
County	Milwaukee	Municipality	Milwaukee
Civil Town		Unincorporated Community	
Parcel		PLSS (T-R-D-S-Q-QQ)	
Style	Neoclassical/Beaux Arts	Wall Material	Brick
Historic Use	apartment/condominium	Structural System	
Year Built	1904	Year Demolished	
Structural Additions			
Architects	Hood & Tullgren		
<b>Other Info</b>			
Survey Year	1984		
Tax Credit Project Number			
Tax Credit Case Number (legacy)			
WHS Project Number			
Bibliographic Reference			
Additional Comments	Wenzel & Strachota were the masons.		
<b>Other Eligibility Evaluation</b>			
Individual Eligibility Evaluation	Not Eligible		
Proposed Historic District			
Contributing			
Evaluation Date			
Eligibility Comments			





<b><u>Primary Info</u></b>			
<b>AHI Number</b>	111816		
<b>Historic Name</b>			
<b>Other Name</b>			
<b>Property Address</b>	807 N 23RD ST		
<b>County</b>	Milwaukee	<b>Municipality</b>	Milwaukee
<b>Civil Town</b>		<b>Unincorporated Community</b>	
<b>Parcel</b>		<b>PLSS (T-R-D-S-Q-QQ)</b>	
<b>Style</b>	Queen Anne	<b>Wall Material</b>	Clapboard
<b>Historic Use</b>	house	<b>Structural System</b>	Balloon Frame
<b>Year Built</b>	1884	<b>Year Demolished</b>	
<b>Structural Additions</b>	1916		
<b>Architects</b>			
<b><u>Other Info</u></b>			
<b>Survey Year</b>	1984		
<b>Tax Credit Project Number</b>			
<b>Tax Credit Case Number (legacy)</b>			
<b>WHS Project Number</b>			
<b>Bibliographic Reference</b>	Tax Program. Building Permit Records. Sanborn Insurance Maps, 1888 & 1894.		
<b>Additional Comments</b>	Photo codes are 4-22/16 and 4-22/17.  Large 19th century frame house type with Picturesque plan. The front porch dates from 1916; other additions and alterations were made to the dwelling as well. No original building permit is on file.		
<b><u>Other Eligibility Evaluation</u></b>			
<b>Individual Eligibility Evaluation</b>	Not Eligible		
<b>Proposed Historic District</b>			
<b>Contributing</b>			
<b>Evaluation Date</b>			
<b>Eligibility Comments</b>			





<b><u>Primary Info</u></b>			
<b>AHI Number</b>	111817		
<b>Historic Name</b>	Melvin A. Hoyt House		
<b>Other Name</b>			
<b>Property Address</b>	813 N 23RD ST		
<b>County</b>	Milwaukee	<b>Municipality</b>	Milwaukee
<b>Civil Town</b>		<b>Unincorporated Community</b>	
<b>Parcel</b>		<b>PLSS (T-R-D-S-Q-QQ)</b>	
<b>Style</b>	Queen Anne	<b>Wall Material</b>	Clapboard
<b>Historic Use</b>	house	<b>Structural System</b>	Balloon Frame
<b>Year Built</b>	1902	<b>Year Demolished</b>	
<b>Structural Additions</b>			
<b>Architects</b>	Leenhouts & Guthrie		
<b><u>Other Info</u></b>			
<b>Survey Year</b>	1984		
<b>Tax Credit Project Number</b>			
<b>Tax Credit Case Number (legacy)</b>			
<b>WHS Project Number</b>			
<b>Bibliographic Reference</b>	A. Building Permit. B. Milwaukee City Directories, 1902-1925.		
<b>Additional Comments</b>	<p>Photo codes are 4-22/14 and 4-22/15.</p> <p>Large early 20th century frame residence with integrity of form. C. Schoknecht was the builder.</p> <p>Melvin Hoyt resided in this house from 1902 to the 1920's. He was president of the News Publishing Company, publishers of the "Milwaukee Daily News."</p>		
<b><u>Other Eligibility Evaluation</u></b>			
<b>Individual Eligibility Evaluation</b>	Not Eligible		
<b>Proposed Historic District</b>			
<b>Contributing</b>			
<b>Evaluation Date</b>			
<b>Eligibility Comments</b>			





<b><u>Primary Info</u></b>			
AHI Number	111818		
Historic Name			
Other Name			
Property Address	819 N 23RD ST		
County	Milwaukee	Municipality	Milwaukee
Civil Town		Unincorporated Community	
Parcel		PLSS (T-R-D-S-Q-QQ)	
Style	Gabled Ell	Wall Material	Aluminum/Vinyl Siding
Historic Use	house	Structural System	Balloon Frame
Year Built		Year Demolished	
Structural Additions			
Architects			
<b><u>Other Info</u></b>			
Survey Year	1984		
Tax Credit Project Number			
Tax Credit Case Number (legacy)			
WHS Project Number			
Bibliographic Reference			
Additional Comments			
<b><u>Other Eligibility Evaluation</u></b>			
Individual Eligibility Evaluation	Not Eligible		
Proposed Historic District			
Contributing			
Evaluation Date			
Eligibility Comments			





<b><u>Primary Info</u></b>			
AHI Number	111956		
Historic Name			
Other Name			
Property Address	820 N 24TH ST		
County	Milwaukee	Municipality	Milwaukee
Civil Town		Unincorporated Community	
Parcel		PLSS (T-R-D-S-Q-QQ)	
Style	Queen Anne	Wall Material	Asphalt
Historic Use	house	Structural System	
Year Built		Year Demolished	
Structural Additions			
Architects			

<b><u>Other Info</u></b>	
Survey Year	1984
Tax Credit Project Number	
Tax Credit Case Number (legacy)	
WHS Project Number	
Bibliographic Reference	
Additional Comments	

<b><u>Other Eligibility Evaluation</u></b>	
Individual Eligibility Evaluation	Not Eligible
Proposed Historic District	
Contributing	
Evaluation Date	
Eligibility Comments	





<b><u>Primary Info</u></b>			
AHI Number	112275		
Historic Name			
Other Name			
Property Address	820-826 N 27TH ST		
County	Milwaukee	Municipality	Milwaukee
Civil Town		Unincorporated Community	
Parcel		PLSS (T-R-D-S-Q-QQ)	
Style	Spanish/Mediterranean Styles	Wall Material	Brick
Historic Use	large retail building	Structural System	Steel Frame
Year Built	1925	Year Demolished	
Structural Additions			
Architects	George Zagel & Bro.		
<b><u>Other Info</u></b>			
Survey Year	1984		
Tax Credit Project Number			
Tax Credit Case Number (legacy)			
WHS Project Number			
Bibliographic Reference			
Additional Comments			
<b><u>National Register Info</u></b>			
National Register Reference #	16000767	National / State Register Listing Name	27th and Wells Commercial Historic District
State Register Listing Date	8/19/2016	Multiple Property Name	
National Register Listing Date	11/8/2016		
<b><u>Other Eligibility Evaluation</u></b>			
Individual Eligibility Evaluation			
Proposed Historic District			
Contributing	Contributing		
Evaluation Date			
Eligibility Comments			





Primary Info			
AHI Number	111957		
Historic Name	James J. Anderson House		
Other Name			
Property Address	822 N 24TH ST		
County	Milwaukee	Municipality	Milwaukee
Civil Town		Unincorporated Community	
Parcel		PLSS (T-R-D-S-Q-QQ)	
Style	Queen Anne	Wall Material	Asbestos
Historic Use	house	Structural System	
Year Built	1891	Year Demolished	
Structural Additions			
Architects	Jacob Jacobi		

Other Info	
Survey Year	1984
Tax Credit Project Number	
Tax Credit Case Number (legacy)	
WHS Project Number	
Bibliographic Reference	
Additional Comments	William Leipold was the builder.

Other Eligibility Evaluation	
Individual Eligibility Evaluation	Not Eligible
Proposed Historic District	
Contributing	
Evaluation Date	
Eligibility Comments	





<b>Primary Info</b>			
AHI Number	112101		
Historic Name			
Other Name			
Property Address	822 N 25TH ST		
County	Milwaukee	Municipality	Milwaukee
Civil Town		Unincorporated Community	
Parcel		PLSS (T-R-D-S-Q-QQ)	
Style	Contemporary	Wall Material	Brick
Historic Use	apartment/condominium	Structural System	
Year Built	1959	Year Demolished	
Structural Additions			
Architects	Harry Schmitt		
<b>Other Info</b>			
Survey Year	1984		
Tax Credit Project Number			
Tax Credit Case Number (legacy)			
WHS Project Number			
Bibliographic Reference			
Additional Comments	Standard Construction Co. was the builder.		
<b>Other Eligibility Evaluation</b>			
Individual Eligibility Evaluation	Not Eligible		
Proposed Historic District			
Contributing			
Evaluation Date			
Eligibility Comments			

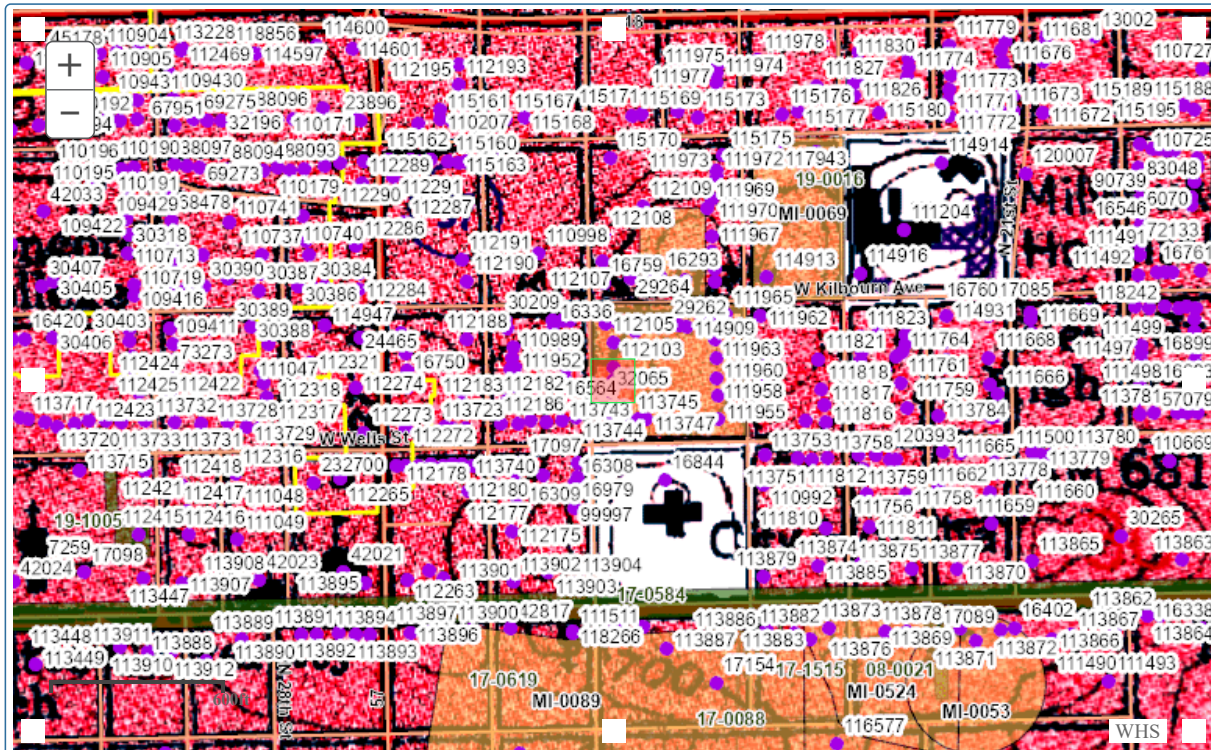



<b>Primary Info</b>			
AHI Number	111958		
Historic Name			
Other Name			
Property Address	823 N 24TH ST		
County	Milwaukee	Municipality	Milwaukee
Civil Town		Unincorporated Community	
Parcel		PLSS (T-R-D-S-Q-QQ)	
Style	Contemporary	Wall Material	Brick
Historic Use	apartment/condominium	Structural System	
Year Built	1966	Year Demolished	
Structural Additions			
Architects	M. B. Coleman		
<b>Other Info</b>			
Survey Year	1984		
Tax Credit Project Number			
Tax Credit Case Number (legacy)			
WHS Project Number	18-1082		
Bibliographic Reference			
Additional Comments	Wellston Corp. was the builder.		
<b>Other Eligibility Evaluation</b>			
Individual Eligibility Evaluation	Not Eligible		
Proposed Historic District			
Contributing			
Evaluation Date			
Eligibility Comments			





<b><u>Primary Info</u></b>			
AHI Number	107836		
Historic Name			
Other Name			
Property Address	830 N 23RD ST		
County	Milwaukee	Municipality	Milwaukee
Civil Town		Unincorporated Community	
Parcel		PLSS (T-R-D-S-Q-QQ)	
Style	Gabled Ell	Wall Material	Clapboard
Historic Use	house	Structural System	Balloon Frame
Year Built		Year Demolished	
Structural Additions			
Architects			
<b><u>Other Info</u></b>			
Survey Year	1984		
Tax Credit Project Number			
Tax Credit Case Number (legacy)			
WHS Project Number			
Bibliographic Reference			
Additional Comments			
<b><u>Other Eligibility Evaluation</u></b>			
Individual Eligibility Evaluation	Not Eligible		
Proposed Historic District			
Contributing			
Evaluation Date			
Eligibility Comments			





<b><u>Primary Info</u></b>			
AHI Number	111959		
Historic Name			
Other Name			
Property Address	830 N 24TH ST		
County	Milwaukee	Municipality	Milwaukee
Civil Town		Unincorporated Community	
Parcel		PLSS (T-R-D-S-Q-QQ)	
Style	Queen Anne	Wall Material	Asbestos
Historic Use	house	Structural System	
Year Built		Year Demolished	
Structural Additions			
Architects			

<b><u>Other Info</u></b>	
Survey Year	1984
Tax Credit Project Number	
Tax Credit Case Number (legacy)	
WHS Project Number	
Bibliographic Reference	
Additional Comments	

<b><u>Other Eligibility Evaluation</u></b>	
Individual Eligibility Evaluation	Not Eligible
Proposed Historic District	
Contributing	
Evaluation Date	
Eligibility Comments	





<b>Primary Info</b>			
AHI Number	112103		
Historic Name			
Other Name			
Property Address	832 N 25TH ST		
County	Milwaukee	Municipality	Milwaukee
Civil Town		Unincorporated Community	
Parcel		PLSS (T-R-D-S-Q-QQ)	
Style	Contemporary	Wall Material	Brick
Historic Use	apartment/condominium	Structural System	Steel Frame
Year Built	1961	Year Demolished	
Structural Additions			
Architects			

<b>Other Info</b>	
Survey Year	1984
Tax Credit Project Number	
Tax Credit Case Number (legacy)	
WHS Project Number	
Bibliographic Reference	
Additional Comments	

<b>Other Eligibility Evaluation</b>	
Individual Eligibility Evaluation	Not Eligible
Proposed Historic District	
Contributing	
Evaluation Date	
Eligibility Comments	





<b><u>Primary Info</u></b>			
<b>AHI Number</b>	111960		
<b>Historic Name</b>			
<b>Other Name</b>			
<b>Property Address</b>	833 N 24TH ST		
<b>County</b>	Milwaukee	<b>Municipality</b>	Milwaukee
<b>Civil Town</b>		<b>Unincorporated Community</b>	
<b>Parcel</b>		<b>PLSS (T-R-D-S-Q-QQ)</b>	
<b>Style</b>	Contemporary	<b>Wall Material</b>	Brick
<b>Historic Use</b>	apartment/condominium	<b>Structural System</b>	
<b>Year Built</b>	1966	<b>Year Demolished</b>	
<b>Structural Additions</b>			
<b>Architects</b>	M. B. Coleman		
<b><u>Other Info</u></b>			
<b>Survey Year</b>	1984		
<b>Tax Credit Project Number</b>			
<b>Tax Credit Case Number (legacy)</b>			
<b>WHS Project Number</b>	18-1082		
<b>Bibliographic Reference</b>			
<b>Additional Comments</b>	Wellston Co. was the builder.		
<b><u>Other Eligibility Evaluation</u></b>			
<b>Individual Eligibility Evaluation</b>	Not Eligible		
<b>Proposed Historic District</b>			
<b>Contributing</b>			
<b>Evaluation Date</b>			
<b>Eligibility Comments</b>			





<b><u>Primary Info</u></b>			
AHI Number	111820		
Historic Name			
Other Name			
Property Address	834 N 23RD ST		
County	Milwaukee	Municipality	Milwaukee
Civil Town		Unincorporated Community	
Parcel		PLSS (T-R-D-S-Q-QQ)	
Style	Gabled Ell	Wall Material	Clapboard
Historic Use	house	Structural System	Balloon Frame
Year Built		Year Demolished	
Structural Additions			
Architects			

<b><u>Other Info</u></b>	
Survey Year	1984
Tax Credit Project Number	
Tax Credit Case Number (legacy)	
WHS Project Number	
Bibliographic Reference	
Additional Comments	

<b><u>Other Eligibility Evaluation</u></b>	
Individual Eligibility Evaluation	Not Eligible
Proposed Historic District	
Contributing	
Evaluation Date	
Eligibility Comments	





<b><u>Primary Info</u></b>			
AHI Number	111961		
Historic Name	Frank Starkweather House		
Other Name			
Property Address	836 N 24TH ST		
County	Milwaukee	Municipality	Milwaukee
Civil Town		Unincorporated Community	
Parcel		PLSS (T-R-D-S-Q-QQ)	
Style	Arts and Crafts	Wall Material	Brick
Historic Use	house	Structural System	
Year Built	1901	Year Demolished	
Structural Additions			
Architects	Ferry & Clas		
<b><u>Other Info</u></b>			
Survey Year	1984		
Tax Credit Project Number			
Tax Credit Case Number (legacy)			
WHS Project Number			
Bibliographic Reference			
Additional Comments	John Langenbuger was the builder and Paul Riesen was the mason.		
<b><u>Other Eligibility Evaluation</u></b>			
Individual Eligibility Evaluation	Not Eligible		
Proposed Historic District			
Contributing			
Evaluation Date			
Eligibility Comments			





<b><u>Primary Info</u></b>			
AHI Number	111822		
Historic Name			
Other Name			
Property Address	838 N 23RD ST		
County	Milwaukee	Municipality	Milwaukee
Civil Town		Unincorporated Community	
Parcel		PLSS (T-R-D-S-Q-QQ)	
Style	Gabled Ell	Wall Material	Clapboard
Historic Use	house	Structural System	Balloon Frame
Year Built		Year Demolished	
Structural Additions			
Architects			
<b><u>Other Info</u></b>			
Survey Year	1984		
Tax Credit Project Number			
Tax Credit Case Number (legacy)			
WHS Project Number			
Bibliographic Reference			
Additional Comments			
<b><u>Other Eligibility Evaluation</u></b>			
Individual Eligibility Evaluation	Not Eligible		
Proposed Historic District			
Contributing			
Evaluation Date			
Eligibility Comments			





<b><u>Primary Info</u></b>			
AHI Number	111823		
Historic Name			
Other Name			
Property Address	842-844 N 23RD ST		
County	Milwaukee	Municipality	Milwaukee
Civil Town		Unincorporated Community	
Parcel		PLSS (T-R-D-S-Q-QQ)	
Style	Front Gabled	Wall Material	Stucco
Historic Use	duplex/two-flat	Structural System	Balloon Frame
Year Built		Year Demolished	
Structural Additions			
Architects			

<b><u>Other Info</u></b>	
Survey Year	1984
Tax Credit Project Number	
Tax Credit Case Number (legacy)	
WHS Project Number	
Bibliographic Reference	
Additional Comments	

<b><u>Other Eligibility Evaluation</u></b>	
Individual Eligibility Evaluation	Not Eligible
Proposed Historic District	
Contributing	
Evaluation Date	
Eligibility Comments	





<b>Primary Info</b>			
AHI Number	112105		
Historic Name			
Other Name			
Property Address	842 N 25TH ST		
County	Milwaukee	Municipality	Milwaukee
Civil Town		Unincorporated Community	
Parcel		PLSS (T-R-D-S-Q-QQ)	
Style	Queen Anne	Wall Material	Clapboard
Historic Use	duplex/two-flat	Structural System	Balloon Frame
Year Built		Year Demolished	
Structural Additions			
Architects			
<b>Other Info</b>			
Survey Year	1984		
Tax Credit Project Number			
Tax Credit Case Number (legacy)			
WHS Project Number			
Bibliographic Reference			
Additional Comments			
<b>Other Eligibility Evaluation</b>			
Individual Eligibility Evaluation	Not Eligible		
Proposed Historic District			
Contributing			
Evaluation Date			
Eligibility Comments			





<b>Primary Info</b>			
AHI Number	111963		
Historic Name			
Other Name			
Property Address	843 N 24TH ST		
County	Milwaukee	Municipality	Milwaukee
Civil Town		Unincorporated Community	
Parcel		PLSS (T-R-D-S-Q-QQ)	
Style	Spanish/Mediterranean Styles	Wall Material	Brick
Historic Use	apartment/condominium	Structural System	
Year Built	1928	Year Demolished	
Structural Additions			
Architects	Keymar & Nack Designers		
<b>Other Info</b>			
Survey Year	1984		
Tax Credit Project Number			
Tax Credit Case Number (legacy)			
WHS Project Number			
Bibliographic Reference			
Additional Comments	Rando Corp. was the builder.		
<b>Other Eligibility Evaluation</b>			
Individual Eligibility Evaluation	Not Eligible		
Proposed Historic District			
Contributing			
Evaluation Date			
Eligibility Comments			





<b><u>Primary Info</u></b>			
AHI Number	111964		
Historic Name			
Other Name			
Property Address	849 N 24TH ST		
County	Milwaukee	Municipality	Milwaukee
Civil Town		Unincorporated Community	
Parcel		PLSS (T-R-D-S-Q-QQ)	
Style	Gabled Ell	Wall Material	Asbestos
Historic Use	house	Structural System	
Year Built		Year Demolished	
Structural Additions			
Architects			

<b><u>Other Info</u></b>	
Survey Year	1984
Tax Credit Project Number	
Tax Credit Case Number (legacy)	
WHS Project Number	
Bibliographic Reference	
Additional Comments	

<b><u>Other Eligibility Evaluation</u></b>	
Individual Eligibility Evaluation	Not Eligible
Proposed Historic District	
Contributing	
Evaluation Date	
Eligibility Comments	

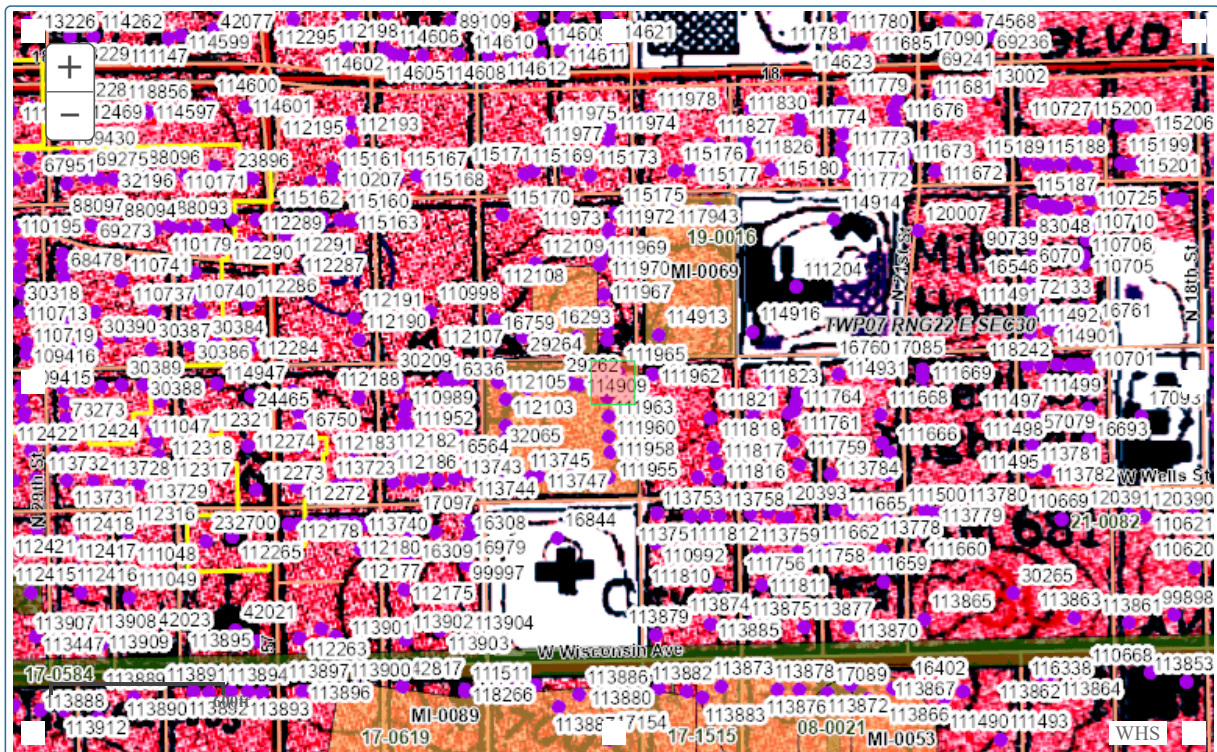



<b><u>Primary Info</u></b>			
AHI Number	111965		
Historic Name			
Other Name			
Property Address	855 N 24TH ST		
County	Milwaukee	Municipality	Milwaukee
Civil Town		Unincorporated Community	
Parcel		PLSS (T-R-D-S-Q-QQ)	
Style	Gabled Ell	Wall Material	Asbestos
Historic Use	house	Structural System	
Year Built		Year Demolished	
Structural Additions			
Architects			
<b><u>Other Info</u></b>			
Survey Year	1984		
Tax Credit Project Number			
Tax Credit Case Number (legacy)			
WHS Project Number			
Bibliographic Reference			
Additional Comments			
<b><u>Other Eligibility Evaluation</u></b>			
Individual Eligibility Evaluation	Not Eligible		
Proposed Historic District			
Contributing			
Evaluation Date			
Eligibility Comments			

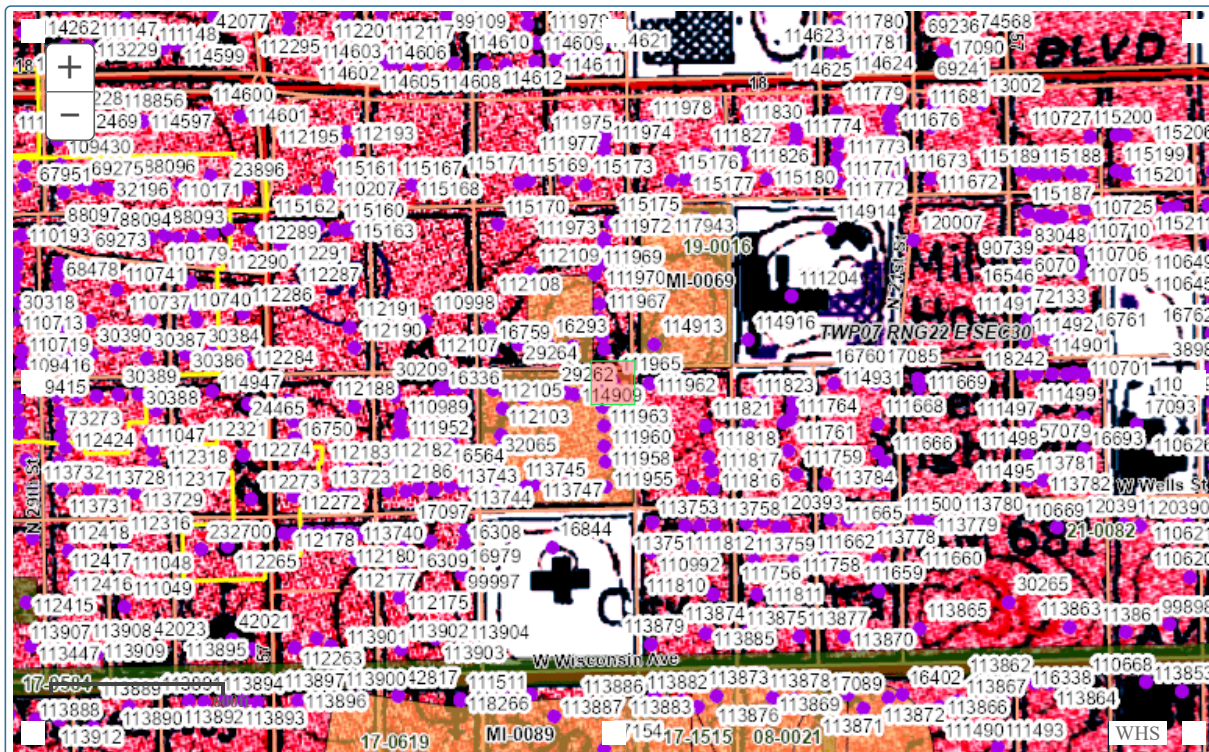



<b>Primary Info</b>			
AHI Number	112107		
Historic Name			
Other Name			
Property Address	910 N 25TH ST		
County	Milwaukee	Municipality	Milwaukee
Civil Town		Unincorporated Community	
Parcel		PLSS (T-R-D-S-Q-QQ)	
Style	Gabled Ell	Wall Material	Clapboard
Historic Use	house	Structural System	Balloon Frame
Year Built	1905	Year Demolished	
Structural Additions			
Architects	H. Messmer & Son		
<b>Other Info</b>			
Survey Year	1984		
Tax Credit Project Number			
Tax Credit Case Number (legacy)			
WHS Project Number			
Bibliographic Reference			
Additional Comments	J. H. Steuerwald was the buider.		
<b>Other Eligibility Evaluation</b>			
Individual Eligibility Evaluation	Not Eligible		
Proposed Historic District			
Contributing			
Evaluation Date			
Eligibility Comments			





<b>Primary Info</b>			
AHI Number	111966		
Historic Name	Stanley Mienic (Melnic)		
Other Name			
Property Address	911 N 24TH ST		
County	Milwaukee	Municipality	Milwaukee
Civil Town		Unincorporated Community	
Parcel		PLSS (T-R-D-S-Q-QQ)	
Style	Contemporary	Wall Material	Brick
Historic Use	apartment/condominium	Structural System	
Year Built	1963	Year Demolished	
Structural Additions			
Architects	Don E. Forbes		
<b>Other Info</b>			
Survey Year	1984		
Tax Credit Project Number			
Tax Credit Case Number (legacy)			
WHS Project Number			
Bibliographic Reference			
Additional Comments	Circle Construction Co. was the builder.		
<b>Other Eligibility Evaluation</b>			
Individual Eligibility Evaluation	Not Eligible		
Proposed Historic District			
Contributing			
Evaluation Date			
Eligibility Comments			

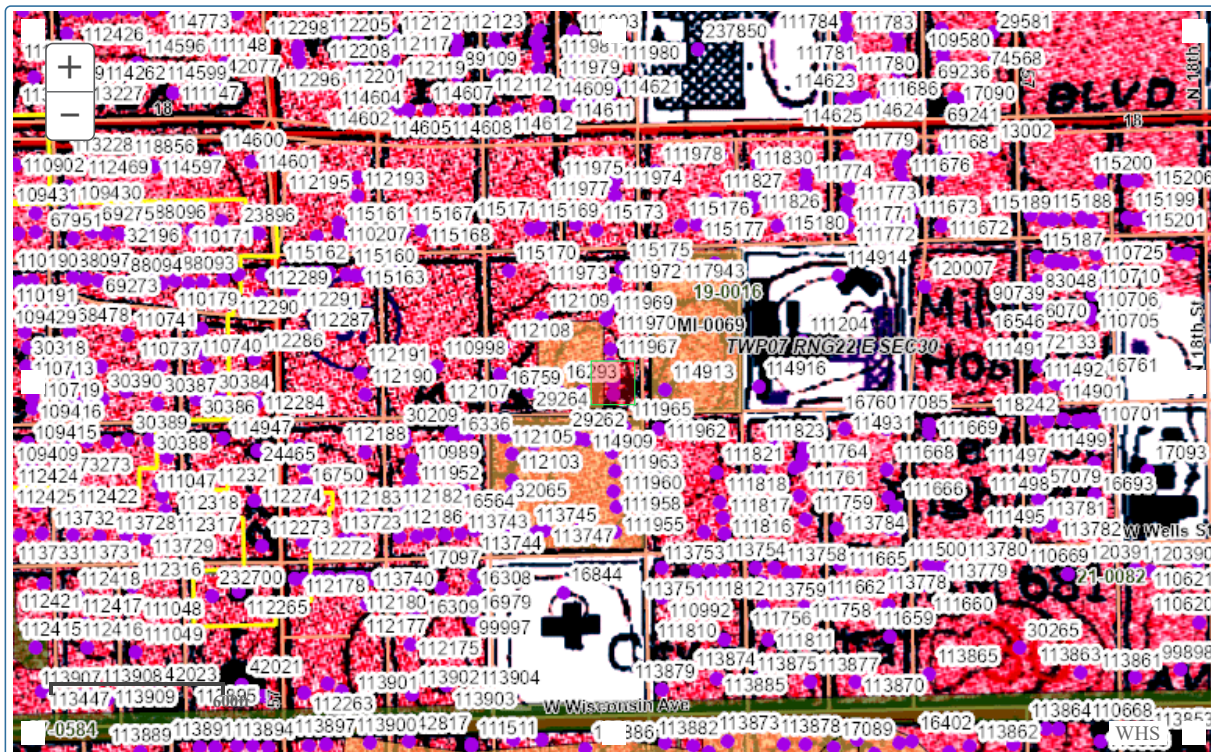



<b><u>Primary Info</u></b>			
AHI Number	111967		
Historic Name			
Other Name			
Property Address	915 N 24TH ST		
County	Milwaukee	Municipality	Milwaukee
Civil Town		Unincorporated Community	
Parcel		PLSS (T-R-D-S-Q-QQ)	
Style	Prairie School	Wall Material	Brick
Historic Use	apartment/condominium	Structural System	
Year Built	1924	Year Demolished	
Structural Additions			
Architects			

<b><u>Other Info</u></b>	
Survey Year	1984
Tax Credit Project Number	
Tax Credit Case Number (legacy)	
WHS Project Number	
Bibliographic Reference	
Additional Comments	West Side Apartment Co. was the builder.

<b><u>Other Eligibility Evaluation</u></b>	
Individual Eligibility Evaluation	Not Eligible
Proposed Historic District	
Contributing	
Evaluation Date	
Eligibility Comments	





<b><u>Primary Info</u></b>			
AHI Number	110998		
Historic Name	Wisconsin Telephone Co.		
Other Name			
Property Address	918 N 26TH ST		
County	Milwaukee	Municipality	Milwaukee
Civil Town		Unincorporated Community	
Parcel		PLSS (T-R-D-S-Q-QQ)	
Style	Art Deco	Wall Material	Brick
Historic Use	telephone/telegraph building	Structural System	Steel Frame
Year Built	1929	Year Demolished	
Structural Additions			
Architects	Eschweiler and Eschweiler		
<b><u>Other Info</u></b>			
Survey Year	1984		
Tax Credit Project Number			
Tax Credit Case Number (legacy)			
WHS Project Number			
Bibliographic Reference	Wisconsin Architectural Archives. Inscription.		
Additional Comments	The full photo codes for 10-32 are 10-32/25 and 10-32/26.  There is no main building permit.		
<b><u>Other Eligibility Evaluation</u></b>			
Individual Eligibility Evaluation	Not Eligible		
Proposed Historic District			
Contributing			
Evaluation Date			
Eligibility Comments			





<b>Primary Info</b>			
AHI Number	111968		
Historic Name			
Other Name			
Property Address	925-933 N 24TH ST		
County	Milwaukee	Municipality	Milwaukee
Civil Town		Unincorporated Community	
Parcel		PLSS (T-R-D-S-Q-QQ)	
Style	Italianate	Wall Material	Aluminum/Vinyl Siding
Historic Use	house	Structural System	
Year Built	1892	Year Demolished	
Structural Additions			
Architects	C. F. Ringer		

<b>Other Info</b>	
Survey Year	1984
Tax Credit Project Number	
Tax Credit Case Number (legacy)	
WHS Project Number	
Bibliographic Reference	1940 Federal census.
Additional Comments	Thebes was the builder in 1892. J. C. Martin was associated with this building in 1892. Numerous lodgers lived here in 1940.

<b>Other Eligibility Evaluation</b>	
Individual Eligibility Evaluation	Not Eligible
Proposed Historic District	
Contributing	
Evaluation Date	
Eligibility Comments	

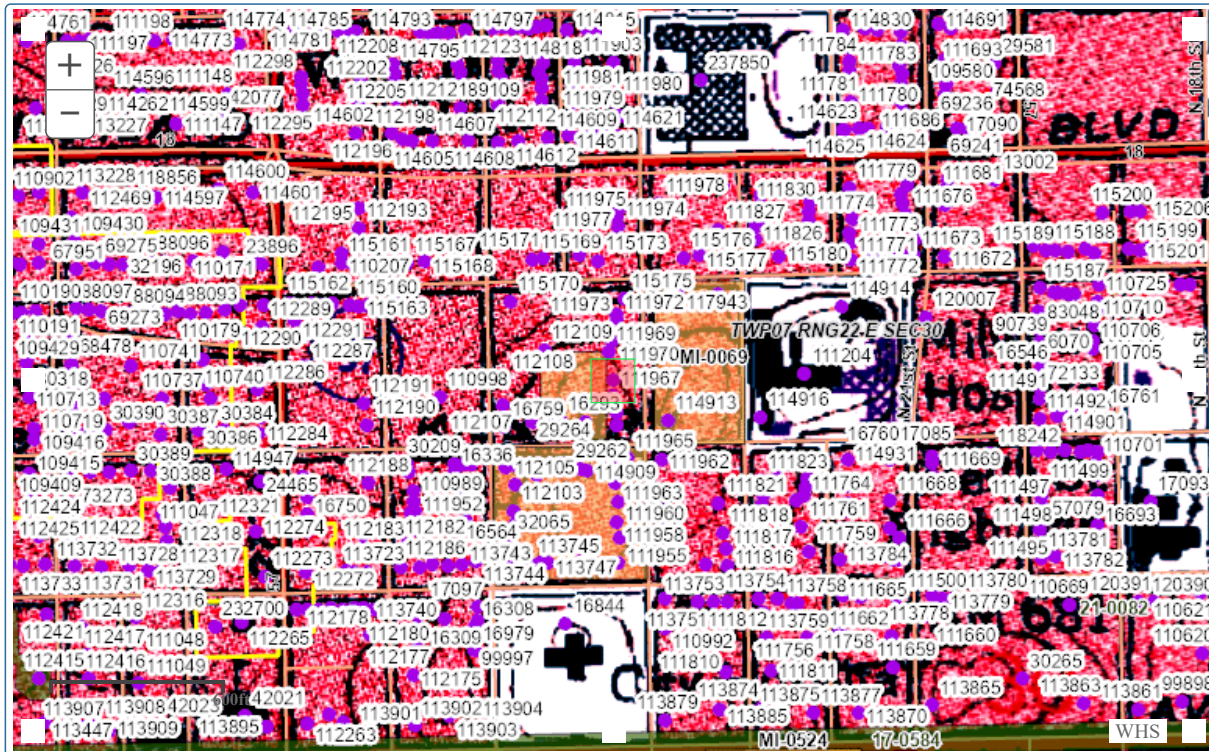



<b>Primary Info</b>			
AHI Number	112109		
Historic Name			
Other Name			
Property Address	936-940- 944 N 25TH ST		
County	Milwaukee	Municipality	Milwaukee
Civil Town		Unincorporated Community	
Parcel		PLSS (T-R-D-S-Q-QQ)	
Style	Spanish/Mediterranean Styles	Wall Material	Brick
Historic Use	apartment/condominium	Structural System	
Year Built	1925	Year Demolished	0
Structural Additions			
Architects			
<b>Other Info</b>			
Survey Year	1984		
Tax Credit Project Number			
Tax Credit Case Number (legacy)			
WHS Project Number			
Bibliographic Reference	Tax Program.		
Additional Comments	Photo codes are 10-33/12, 10-33/13, and 10-33/14.		
	This structure is an excellent example of apartment buildings as constructed during the 1920s. It is in original condition with a design influenced with Mission Revival elements.		
	Demolished prior to 2010		
<b>Other Eligibility Evaluation</b>			
Individual Eligibility Evaluation	Potentially Eligible		
Proposed Historic District			
Contributing			
Evaluation Date			
Eligibility Comments			





<b><u>Primary Info</u></b>			
AHI Number	111969		
Historic Name			
Other Name			
Property Address	939 N 24TH ST		
County	Milwaukee	Municipality	Milwaukee
Civil Town		Unincorporated Community	
Parcel		PLSS (T-R-D-S-Q-QQ)	
Style	Early Gothic Revival	Wall Material	Aluminum/Vinyl Siding
Historic Use	house	Structural System	
Year Built		Year Demolished	
Structural Additions			
Architects			
<b><u>Other Info</u></b>			
Survey Year	1984		
Tax Credit Project Number			
Tax Credit Case Number (legacy)			
WHS Project Number			
Bibliographic Reference	1940 Federal census.		
Additional Comments	Several families lived here in 1940.		
<b><u>Other Eligibility Evaluation</u></b>			
Individual Eligibility Evaluation	Not Eligible		
Proposed Historic District			
Contributing			
Evaluation Date			
Eligibility Comments			





<b><u>Primary Info</u></b>			
AHI Number	111970		
Historic Name	W. Davelaar House		
Other Name			
Property Address	943 N 24TH ST		
County	Milwaukee	Municipality	Milwaukee
Civil Town		Unincorporated Community	
Parcel		PLSS (T-R-D-S-Q-QQ)	
Style	Front Gabled	Wall Material	Brick
Historic Use	house	Structural System	
Year Built	1892	Year Demolished	
Structural Additions			
Architects	William Davelaar		

<b><u>Other Info</u></b>	
Survey Year	1984
Tax Credit Project Number	
Tax Credit Case Number (legacy)	
WHS Project Number	
Bibliographic Reference	
Additional Comments	

<b><u>Other Eligibility Evaluation</u></b>	
Individual Eligibility Evaluation	Not Eligible
Proposed Historic District	
Contributing	
Evaluation Date	
Eligibility Comments	





<b><u>Primary Info</u></b>			
AHI Number	111971		
Historic Name			
Other Name			
Property Address	947 N 24TH ST		
County	Milwaukee	Municipality	Milwaukee
Civil Town		Unincorporated Community	
Parcel		PLSS (T-R-D-S-Q-QQ)	
Style	Early Gothic Revival	Wall Material	Aluminum/Vinyl Siding
Historic Use	house	Structural System	
Year Built		Year Demolished	
Structural Additions			
Architects			
<b><u>Other Info</u></b>			
Survey Year	1984		
Tax Credit Project Number			
Tax Credit Case Number (legacy)			
WHS Project Number			
Bibliographic Reference			
Additional Comments			
<b><u>Other Eligibility Evaluation</u></b>			
Individual Eligibility Evaluation	Not Eligible		
Proposed Historic District			
Contributing			
Evaluation Date			
Eligibility Comments			





<b>Primary Info</b>			
AHI Number	113756		
Historic Name			
Other Name			
Property Address	2224-26 W WELLS ST		
County	Milwaukee	Municipality	Milwaukee
Civil Town		Unincorporated Community	
Parcel		PLSS (T-R-D-S-Q-QQ)	
Style	Spanish/Mediterranean Styles	Wall Material	Brick
Historic Use	tavern/bar	Structural System	
Year Built	1929	Year Demolished	
Structural Additions			
Architects			

<b>Other Info</b>	
Survey Year	1983
Tax Credit Project Number	
Tax Credit Case Number (legacy)	
WHS Project Number	
Bibliographic Reference	
Additional Comments	

<b>Other Eligibility Evaluation</b>	
Individual Eligibility Evaluation	Not Eligible
Proposed Historic District	
Contributing	
Evaluation Date	
Eligibility Comments	





<b>Primary Info</b>			
AHI Number	111487		
Historic Name			
Other Name			
Property Address	2402-2414 W WELLS ST		
County	Milwaukee	Municipality	Milwaukee
Civil Town		Unincorporated Community	
Parcel		PLSS (T-R-D-S-Q-QQ)	
Style	Neoclassical/Beaux Arts	Wall Material	Brick
Historic Use	apartment/condominium	Structural System	
Year Built	1909	Year Demolished	
Structural Additions			
Architects			

<b>Other Info</b>	
Survey Year	1984
Tax Credit Project Number	
Tax Credit Case Number (legacy)	
WHS Project Number	18-1082
Bibliographic Reference	
Additional Comments	Lynde Bradley (8/19/1878-2/8/1942), founder and president of the Allen-Bradley Co., lived here in 1921. John Hunholz was the builder.

<b>Other Eligibility Evaluation</b>	
Individual Eligibility Evaluation	Not Eligible
Proposed Historic District	
Contributing	
Evaluation Date	
Eligibility Comments	





<b><u>Primary Info</u></b>			
AHI Number	114911		
Historic Name	Wm. Jamison		
Other Name			
Property Address	2409 W KILBOURN AVE		
County	Milwaukee	Municipality	Milwaukee
Civil Town		Unincorporated Community	
Parcel		PLSS (T-R-D-S-Q-QQ)	
Style	Queen Anne	Wall Material	Asphalt
Historic Use	house	Structural System	
Year Built	1902	Year Demolished	
Structural Additions			
Architects			
<b><u>Other Info</u></b>			
Survey Year	1983		
Tax Credit Project Number			
Tax Credit Case Number (legacy)			
WHS Project Number			
Bibliographic Reference			
Additional Comments	Andrew Tophoover was the builder.		
<b><u>Other Eligibility Evaluation</u></b>			
Individual Eligibility Evaluation	Not Eligible		
Proposed Historic District			
Contributing			
Evaluation Date			
Eligibility Comments			





<b>Primary Info</b>			
AHI Number	115174		
Historic Name	P. F. Priebe		
Other Name			
Property Address	2411-19 W STATE ST		
County	Milwaukee	Municipality	Milwaukee
Civil Town		Unincorporated Community	
Parcel		PLSS (T-R-D-S-Q-QQ)	
Style	Twentieth Century Commercial	Wall Material	Brick
Historic Use	tavern/bar	Structural System	
Year Built	1925	Year Demolished	
Structural Additions			
Architects			

<b>Other Info</b>	
Survey Year	1983
Tax Credit Project Number	
Tax Credit Case Number (legacy)	
WHS Project Number	
Bibliographic Reference	
Additional Comments	

<b>Other Eligibility Evaluation</b>	
Individual Eligibility Evaluation	Not Eligible
Proposed Historic District	
Contributing	
Evaluation Date	
Eligibility Comments	





<b>Primary Info</b>			
AHI Number	114910		
Historic Name			
Other Name			
Property Address	2413-17 W KILBOURN AVE		
County	Milwaukee	Municipality	Milwaukee
Civil Town		Unincorporated Community	
Parcel		PLSS (T-R-D-S-Q-QQ)	
Style	Queen Anne	Wall Material	Clapboard
Historic Use	duplex/two-flat	Structural System	
Year Built		Year Demolished	
Structural Additions			
Architects			

<b>Other Info</b>	
Survey Year	1983
Tax Credit Project Number	
Tax Credit Case Number (legacy)	
WHS Project Number	
Bibliographic Reference	
Additional Comments	

<b>Other Eligibility Evaluation</b>	
Individual Eligibility Evaluation	Not Eligible
Proposed Historic District	
Contributing	
Evaluation Date	
Eligibility Comments	

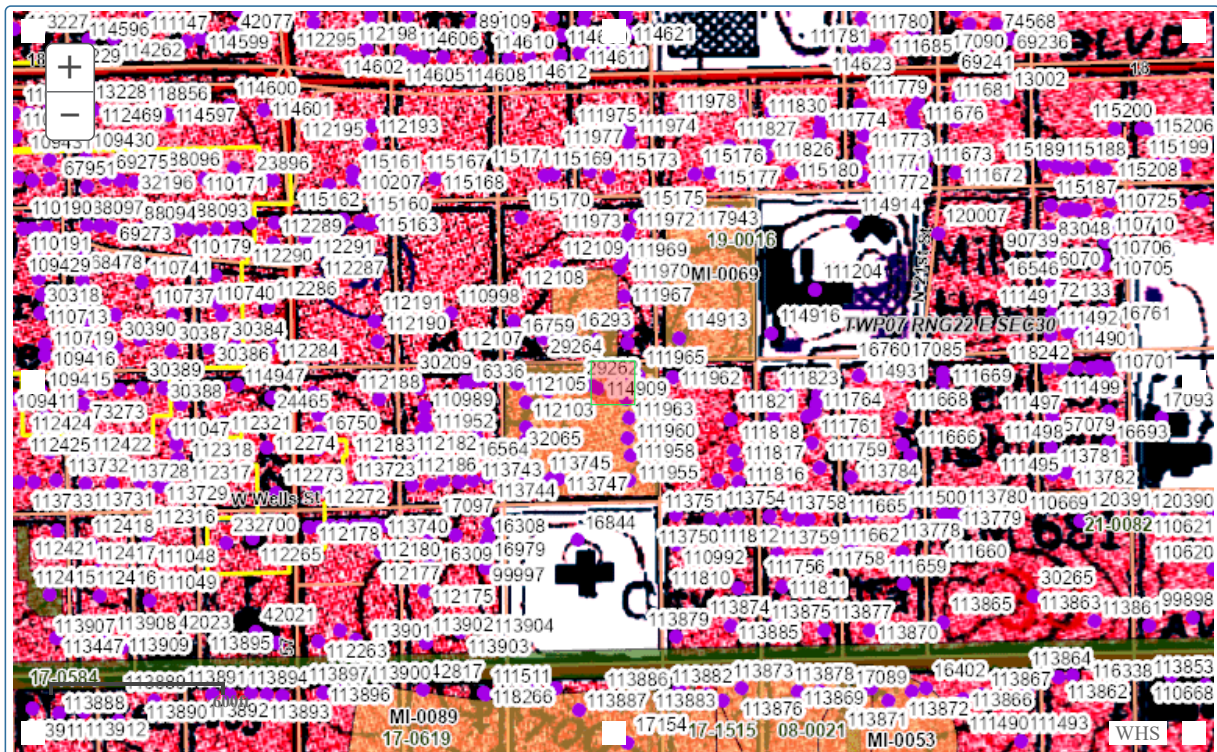



<b>Primary Info</b>			
AHI Number	111203		
Historic Name	Patrick J. Geraghty Residence		
Other Name			
Property Address	2422-2424 W KILBOURN		
County	Milwaukee	Municipality	Milwaukee
Civil Town		Unincorporated Community	
Parcel		PLSS (T-R-D-S-Q-QQ)	
Style	Queen Anne	Wall Material	Asphalt
Historic Use	duplex/two-flat	Structural System	
Year Built	1889	Year Demolished	
Structural Additions			
Architects	C.F. Rugee		
<b>Other Info</b>			
Survey Year	1984		
Tax Credit Project Number			
Tax Credit Case Number (legacy)			
WHS Project Number			
Bibliographic Reference	Milwaukee Sentinel 4/28/1889, 12/2. 1940 Federal census.		
Additional Comments	A 'site file' exists for this property. It contains additional information such as correspondence, newspaper clippings, or historical information. It is a public record and may be viewed in person at the Wisconsin Historical Society, State Historic Preservation Office. Builders were Kamerling and Ketelle. Several families lived here in 1940.		
<b>Other Eligibility Evaluation</b>			
Individual Eligibility Evaluation	Not Eligible		
Proposed Historic District			
Contributing			
Evaluation Date			
Eligibility Comments	Not eligible, REC, 8/2/2018		





<b>Primary Info</b>			
AHI Number	114909		
Historic Name			
Other Name			
Property Address	2423 W KILBOURN AVE		
County	Milwaukee	Municipality	Milwaukee
Civil Town		Unincorporated Community	
Parcel		PLSS (T-R-D-S-Q-QQ)	
Style	Gabled Ell	Wall Material	Asphalt
Historic Use	house	Structural System	
Year Built		Year Demolished	
Structural Additions			
Architects			

<b>Other Info</b>	
Survey Year	1983
Tax Credit Project Number	
Tax Credit Case Number (legacy)	
WHS Project Number	
Bibliographic Reference	
Additional Comments	

<b>Other Eligibility Evaluation</b>	
Individual Eligibility Evaluation	Not Eligible
Proposed Historic District	
Contributing	
Evaluation Date	
Eligibility Comments	





<b>Primary Info</b>			
AHI Number	113748		
Historic Name			
Other Name			
Property Address	2424-34 W WELLS ST		
County	Milwaukee	Municipality	Milwaukee
Civil Town		Unincorporated Community	
Parcel		PLSS (T-R-D-S-Q-QQ)	
Style	Contemporary	Wall Material	Brick
Historic Use	apartment/condominium	Structural System	Steel Frame
Year Built	1965	Year Demolished	
Structural Additions			
Architects			

<b>Other Info</b>	
Survey Year	1983
Tax Credit Project Number	
Tax Credit Case Number (legacy)	
WHS Project Number	
Bibliographic Reference	
Additional Comments	Emerald Builders were the builders.

<b>Other Eligibility Evaluation</b>	
Individual Eligibility Evaluation	Not Eligible
Proposed Historic District	
Contributing	
Evaluation Date	
Eligibility Comments	

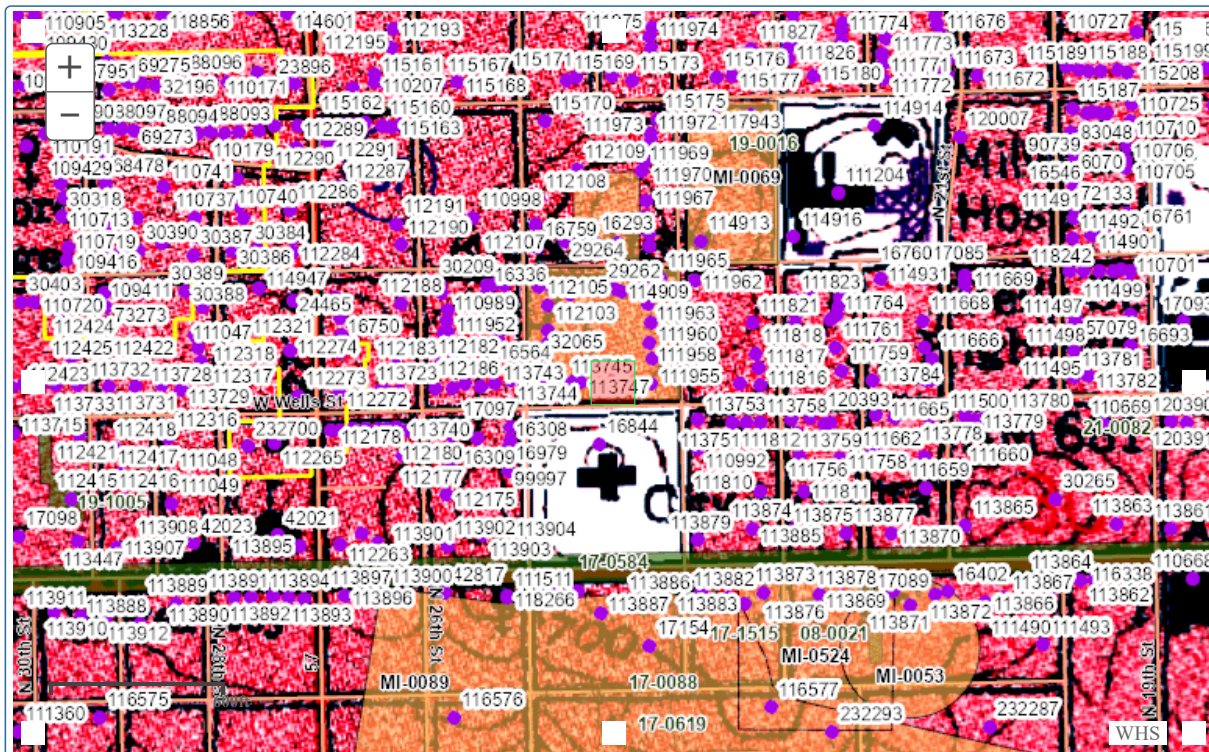



<u>Primary Info</u>			
AHI Number	16844		
Historic Name	Milwaukee County Dispensary and Emergency Hospital		
Other Name	COUNTY EMERGENCY HOSPITAL		
Property Address	2430 W WISCONSIN AVE		
County	Milwaukee	Municipality	Milwaukee
Civil Town		Unincorporated Community	
Parcel		PLSS (T-R-D-S-Q-QQ)	
Style	Neoclassical/Beaux Arts	Wall Material	Brick
Historic Use	hospital/medical clinic	Structural System	
Year Built	1929	Year Demolished	
Structural Additions			
Architects	(Armstrong & De Gelleke, NYC, Assoc. Arch.), Van Ryn & DeGelleke		

<u>Other Info</u>	
Survey Year	1984
Tax Credit Project Number	
Tax Credit Case Number (legacy)	
WHS Project Number	
Bibliographic Reference	
Additional Comments	<p>This structure is a good example of Neo-Classical designed semi-public buildings.</p> <p>A 'site file' exists for this property. It contains additional information such as correspondence, newspaper clippings, or historical information. It is a public record and may be viewed in person at the State Historical Society, Division of Historic Preservation.</p> <p>Specifications are in the site file.</p>

<u>National Register Info</u>			
National Register Reference #	85000639	National / State Register Listing Name	Milwaukee County Dispensary and Emergency Hospital
State Register Listing Date	1/1/1989	Multiple Property Name	
National Register Listing Date	3/21/1985		

<u>Other Eligibility Evaluation</u>	
Individual Eligibility Evaluation	
Proposed Historic District	
Contributing	
Evaluation Date	
Eligibility Comments	

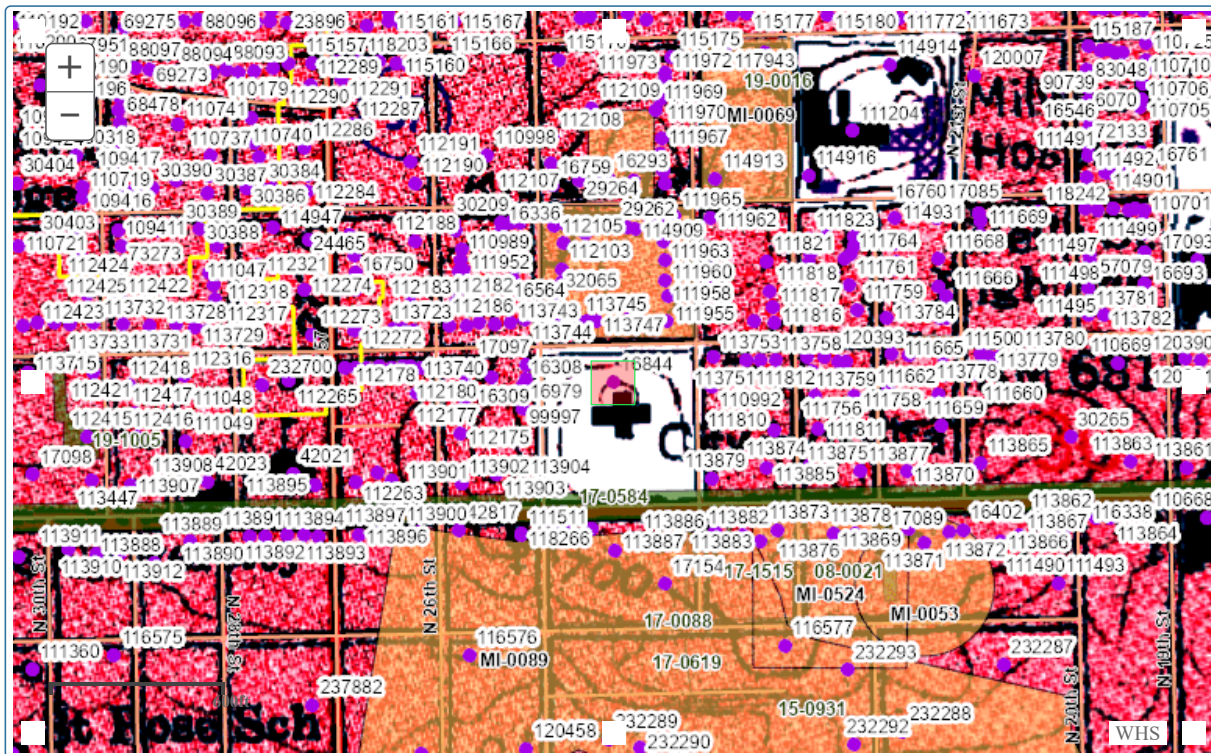



<b>Primary Info</b>			
AHI Number	16293		
Historic Name	Dorothea and Joseph B. Kalvelage House		
Other Name			
Property Address	2432 W KILBOURN AVE		
County	Milwaukee	Municipality	Milwaukee
Civil Town		Unincorporated Community	
Parcel		PLSS (T-R-D-S-Q-QQ)	
Style	German Renaissance Revival	Wall Material	Brick
Historic Use	house	Structural System	
Year Built	1896	Year Demolished	
Structural Additions			
Architects	OTTO STRACK		

<b>Other Info</b>	
Survey Year	1984
Tax Credit Project Number	
Tax Credit Case Number (legacy)	
WHS Project Number	
Bibliographic Reference	MILWAUKEE ETHNIC HOUSES TOUR, CITY OF MILWAUKEE DEPARTMENT OF DEVELOPMENT, 1994. Zimmermann, H. Russell, "Past in Our Present", Milwaukee Journal 5/28/1967. Tax program. Building permit. Buildings of Wisconsin manuscript.
Additional Comments	<p>A 'site file' exists for this property. It contains additional information such as correspondence, newspaper clippings, or historical information. It is a public record and may be viewed in person at the Wisconsin Historical Society, State Historic Preservation Office.</p> <p>German Baroque Revival. THE ARCHED WINDOW IN THE GABLE HAS BEEN FILLED WITH GLASS BLOCK. IRONWORK WAS PRODUCED BY CYRIL COLNIK. DURING THE 1920S THE HOUSE WAS OCCUPIED BY THE KU KLUX KLAN. IT LATER BECAME THE ROGER WILLIAMS HOSPITAL AND THEN A ROOMING HOUSE. IT IS NOW ONCE AGAIN A SINGLE FAMILY DWELLING.</p> <p>Mason was G.E. Stuewe. Builder was John Langen Berger.</p> <p>Of the facade's many striking features, the most impressive are the eight life-size terracotta male half-figures—called atlantes after the titan Atlas of Greek mythology—resembling similar ones at Dresden's early eighteenth-century Zwinger Palace. They guard the front porch, glaring at passers-by. But they are not the only faces watching. Winged heads peer from scrolled keystones in the arches of the front porch, a headdressed woman leans from the molding above each second-story window; a kingly bust with flowing beard and drooping mustache crowns the arched window on the third story; and pressed-tin lions stake out the corners of the roof. Craftsman Cyril Colnik created the lacy wrought ironwork trimming the porch roof, terrace, and balcony.</p> <p>Ornate decoration continues inside the thirty-room mansion. In the dark central entrance hall, extensive carving decorates the divided wooden staircase, with floral and scroll motifs, women, and watchful lions. Baroque carved woodwork highlights the first-story rooms. Even some of the ceilings consist of oak panels and beams.</p> <p>Joseph Kalvelage was an executive in a plumbing-fixture firm (which may explain why his house has seven bathrooms). He and his wife Dorothea hired one of Milwaukee's leading German-immigrant architects, Otto Strack, to design their mansion. At this time many wealthy German Milwaukeeans left established German neighborhoods, such as Brewers' Hill, and moved into opulent mansions elsewhere in the city. Captain Frederick Pabst built his famous German Renaissance Revival mansion on Grand (now West Wisconsin) Avenue in 1892. The Kalvelages, Harnischfegers, and others emulated Pabst, moving to the west side and embracing German Renaissance Revival architecture for their new residences. Unlike Pabst's neighborhood, the Kalvelages' neighborhood remained middle class.</p>

National Register Info			
National Register Reference #	78000118	National / State Register Listing Name	Kalvelage, Joseph B., House
State Register Listing Date	1/1/1989	Multiple Property Name	
National Register Listing Date	5/23/1978		

<b>Other Eligibility Evaluation</b>	
Individual Eligibility Evaluation	

Proposed Historic District	
Contributing	
Evaluation Date	
Eligibility Comments	





<b><u>Primary Info</u></b>			
AHI Number	29262		
Historic Name			
Other Name			
Property Address	2433 W KILBOURN		
County	Milwaukee	Municipality	Milwaukee
Civil Town		Unincorporated Community	
Parcel		PLSS (T-R-D-S-Q-QQ)	
Style	Queen Anne	Wall Material	Clapboard
Historic Use	house	Structural System	
Year Built		Year Demolished	
Structural Additions			
Architects			
<b><u>Other Info</u></b>			
Survey Year	1984		
Tax Credit Project Number			
Tax Credit Case Number (legacy)			
WHS Project Number			
Bibliographic Reference	Wright's Milwaukee (Milwaukee County, WI) City Directory. St. Paul: Wright Directory, 1950 Print. Jones, Patrick D. The Selma of the North: Civil Rights Insurgency in Milwaukee. Cambridge, MA: Harvard UP, 2009. Print. pg. 21.		
Additional Comments	Walter E. Wetzel owned the Metropolitan Club which hosted black entertainers in the midst of Jim Crow laws. He lived here in 1950.  With white hostility pressing in on all sides, the African-American population in Milwaukee worked on creating an encouraging and vibrant community within the confines of segregation. By the 1940s, black owned businesses like barber shops, shopkeepers, and law offices led to the emergence of a modest sized middle class, and paved the way for nightclubs and entertainment. Like most segregated cities in America, a string of safe and acceptable locations for African-American performers began to materialize in Milwaukee, Wisconsin. Black entertainers like Billie Holliday, Duke Ellington, and Louis Armstrong passed through on this route, known as the Chitlin Circuit; a network of clubs and venues around the Midwest, the South, and the East Coast. During the heydays of jazz, passing entertainers could be seen and heard playing at inner core clubs like the Metropole, the Flame, and Moon Glow.		
<b><u>Other Eligibility Evaluation</u></b>			
Individual Eligibility Evaluation	Not Eligible		
Proposed Historic District			
Contributing			
Evaluation Date			
Eligibility Comments			





<b><u>Primary Info</u></b>			
<b>AHI Number</b>	114936		
<b>Historic Name</b>	J.P. Zetteler		
<b>Other Name</b>			
<b>Property Address</b>	2437 W KILBOURN AVE		
<b>County</b>	Milwaukee	<b>Municipality</b>	Milwaukee
<b>Civil Town</b>		<b>Unincorporated Community</b>	
<b>Parcel</b>		<b>PLSS (T-R-D-S-Q-QQ)</b>	
<b>Style</b>	Queen Anne	<b>Wall Material</b>	Asphalt
<b>Historic Use</b>	house	<b>Structural System</b>	
<b>Year Built</b>	1905	<b>Year Demolished</b>	
<b>Structural Additions</b>			
<b>Architects</b>	Wm. Van Rhienen		
<b><u>Other Info</u></b>			
<b>Survey Year</b>	1983		
<b>Tax Credit Project Number</b>			
<b>Tax Credit Case Number (legacy)</b>			
<b>WHS Project Number</b>			
<b>Bibliographic Reference</b>			
<b>Additional Comments</b>			
<b><u>Other Eligibility Evaluation</u></b>			
<b>Individual Eligibility Evaluation</b>	Not Eligible		
<b>Proposed Historic District</b>			
<b>Contributing</b>			
<b>Evaluation Date</b>			
<b>Eligibility Comments</b>			





<b><u>Primary Info</u></b>			
<b>AHI Number</b>	114935		
<b>Historic Name</b>	F. Downer		
<b>Other Name</b>			
<b>Property Address</b>	2441 W KILBOURN AVE		
<b>County</b>	Milwaukee	<b>Municipality</b>	Milwaukee
<b>Civil Town</b>		<b>Unincorporated Community</b>	
<b>Parcel</b>		<b>PLSS (T-R-D-S-Q-QQ)</b>	
<b>Style</b>	Queen Anne	<b>Wall Material</b>	Asphalt
<b>Historic Use</b>	house	<b>Structural System</b>	
<b>Year Built</b>	1892	<b>Year Demolished</b>	
<b>Structural Additions</b>			
<b>Architects</b>	Wm. Davelaar		

<b><u>Other Info</u></b>	
<b>Survey Year</b>	1983
<b>Tax Credit Project Number</b>	
<b>Tax Credit Case Number (legacy)</b>	
<b>WHS Project Number</b>	
<b>Bibliographic Reference</b>	
<b>Additional Comments</b>	McCann Bros. was the builder.

<b><u>Other Eligibility Evaluation</u></b>	
<b>Individual Eligibility Evaluation</b>	Not Eligible
<b>Proposed Historic District</b>	
<b>Contributing</b>	
<b>Evaluation Date</b>	
<b>Eligibility Comments</b>	





<b><u>Primary Info</u></b>			
AHI Number	114934		
Historic Name			
Other Name			
Property Address	2447-47A W KILBOURN AVE		
County	Milwaukee	Municipality	Milwaukee
Civil Town		Unincorporated Community	
Parcel		PLSS (T-R-D-S-Q-QQ)	
Style	Queen Anne	Wall Material	Clapboard
Historic Use	house	Structural System	
Year Built	1911	Year Demolished	
Structural Additions			
Architects	Pieland		

<b><u>Other Info</u></b>	
Survey Year	1983
Tax Credit Project Number	
Tax Credit Case Number (legacy)	
WHS Project Number	
Bibliographic Reference	
Additional Comments	Riesen was the builder.

<b><u>Other Eligibility Evaluation</u></b>	
Individual Eligibility Evaluation	Not Eligible
Proposed Historic District	
Contributing	
Evaluation Date	
Eligibility Comments	





<b>Primary Info</b>			
AHI Number	29264		
Historic Name			
Other Name			
Property Address	2448 W KILBOURN		
County	Milwaukee	Municipality	Milwaukee
Civil Town		Unincorporated Community	
Parcel		PLSS (T-R-D-S-Q-QQ)	
Style	Contemporary	Wall Material	Brick
Historic Use	apartment/condominium	Structural System	
Year Built	1961	Year Demolished	
Structural Additions			
Architects	AL. M. RUTTENBERG		

<b>Other Info</b>	
Survey Year	1984
Tax Credit Project Number	
Tax Credit Case Number (legacy)	
WHS Project Number	
Bibliographic Reference	
Additional Comments	BUILDER WAS ART. WAY BLDG. INC.

<b>Other Eligibility Evaluation</b>	
Individual Eligibility Evaluation	Not Eligible
Proposed Historic District	
Contributing	
Evaluation Date	
Eligibility Comments	





<b><u>Primary Info</u></b>			
AHI Number	114933		
Historic Name			
Other Name			
Property Address	2449-51 W KILBOURN AVE		
County	Milwaukee	Municipality	Milwaukee
Civil Town		Unincorporated Community	
Parcel		PLSS (T-R-D-S-Q-QQ)	
Style	Queen Anne	Wall Material	Clapboard
Historic Use	duplex/two-flat	Structural System	
Year Built		Year Demolished	
Structural Additions			
Architects			
<b><u>Other Info</u></b>			
Survey Year	1983		
Tax Credit Project Number			
Tax Credit Case Number (legacy)			
WHS Project Number			
Bibliographic Reference			
Additional Comments			
<b><u>Other Eligibility Evaluation</u></b>			
Individual Eligibility Evaluation	Not Eligible		
Proposed Historic District			
Contributing			
Evaluation Date			
Eligibility Comments			

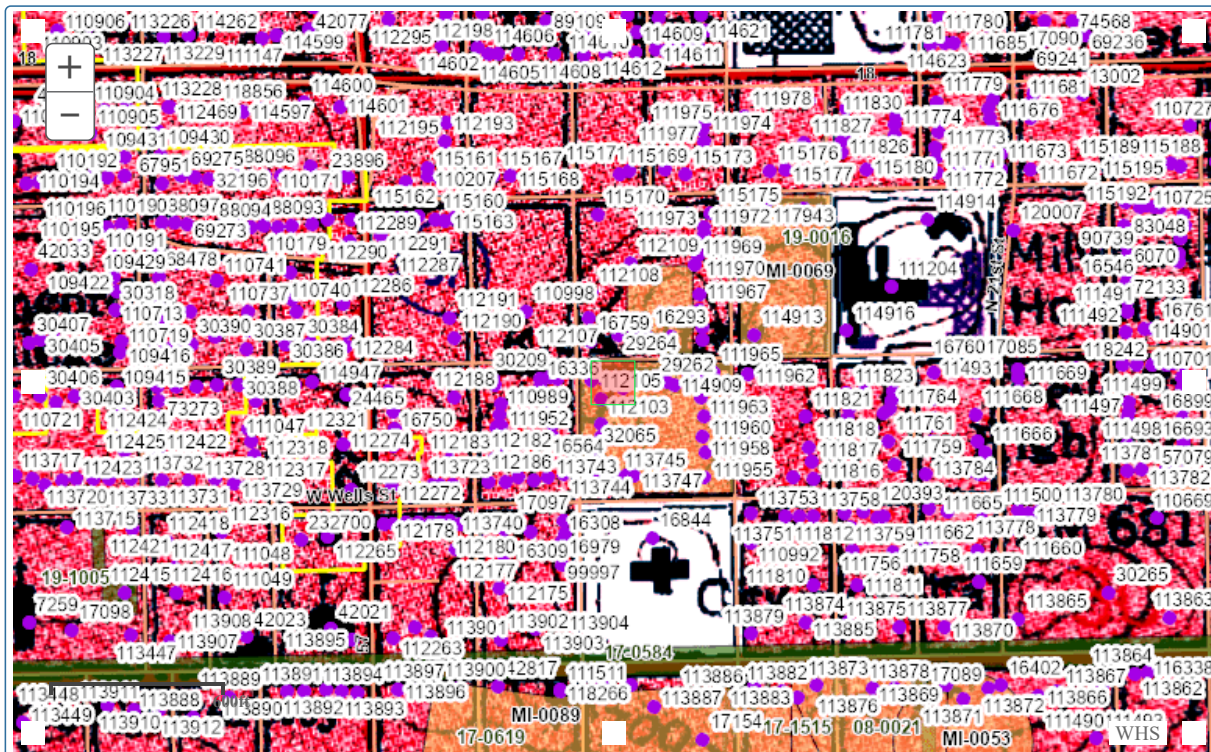



<b>Primary Info</b>			
AHI Number	16759		
Historic Name			
Other Name			
Property Address	2460 W KILBOURN AVE		
County	Milwaukee	Municipality	Milwaukee
Civil Town		Unincorporated Community	
Parcel		PLSS (T-R-D-S-Q-QQ)	
Style	Arts and Crafts	Wall Material	Stucco
Historic Use	house	Structural System	
Year Built	1920	Year Demolished	
Structural Additions			
Architects			

<b>Other Info</b>	
Survey Year	1984
Tax Credit Project Number	
Tax Credit Case Number (legacy)	
WHS Project Number	
Bibliographic Reference	Tax program.
Additional Comments	

<b>Other Eligibility Evaluation</b>	
Individual Eligibility Evaluation	Not Eligible
Proposed Historic District	
Contributing	
Evaluation Date	
Eligibility Comments	





<b><u>Primary Info</u></b>			
AHI Number	114939		
Historic Name	A. J. Stoltz		
Other Name			
Property Address	2463 W KILBOURN AVE		
County	Milwaukee	Municipality	Milwaukee
Civil Town		Unincorporated Community	
Parcel		PLSS (T-R-D-S-Q-QQ)	
Style	Other Vernacular	Wall Material	Asphalt
Historic Use	house	Structural System	
Year Built	1905	Year Demolished	
Structural Additions			
Architects	O.C. Uehling		
<b><u>Other Info</u></b>			
Survey Year	1983		
Tax Credit Project Number			
Tax Credit Case Number (legacy)			
WHS Project Number			
Bibliographic Reference			
Additional Comments	A. Schmitt & Co. was the mason. R. Riesen was the builder.		
<b><u>Other Eligibility Evaluation</u></b>			
Individual Eligibility Evaluation	Not Eligible		
Proposed Historic District			
Contributing			
Evaluation Date			
Eligibility Comments			





<u>Primary Info</u>			
AHI Number	113904		
Historic Name	Standard/American Oil Co.		
Other Name	Citgo		
Property Address	2502 W WISCONSIN AVE		
County	Milwaukee	Municipality	Milwaukee
Civil Town		Unincorporated Community	
Parcel		PLSS (T-R-D-S-Q-QQ)	
Style	Commercial Vernacular	Wall Material	Brick
Historic Use	gas station/service station	Structural System	
Year Built	1950	Year Demolished	
Structural Additions	1971		
Architects			

<u>Other Info</u>	
Survey Year	2004, 2014
Tax Credit Project Number	
Tax Credit Case Number (legacy)	
WHS Project Number	
Bibliographic Reference	.
Additional Comments	Previously surveyed in 1983 with map code 100/34. Map name was 389.

<u>Other Eligibility Evaluation</u>	
Individual Eligibility Evaluation	Not Eligible
Proposed Historic District	
Contributing	
Evaluation Date	
Eligibility Comments	





<b>Primary Info</b>			
AHI Number	113744		
Historic Name			
Other Name			
Property Address	2504 W WELLS ST		
County	Milwaukee	Municipality	Milwaukee
Civil Town		Unincorporated Community	
Parcel		PLSS (T-R-D-S-Q-QQ)	
Style	Contemporary	Wall Material	Brick
Historic Use	apartment/condominium	Structural System	Steel Frame
Year Built	1961	Year Demolished	
Structural Additions			
Architects			

<b>Other Info</b>	
Survey Year	1983
Tax Credit Project Number	
Tax Credit Case Number (legacy)	
WHS Project Number	
Bibliographic Reference	
Additional Comments	Wellston Co. was the builder.

<b>Other Eligibility Evaluation</b>	
Individual Eligibility Evaluation	Not Eligible
Proposed Historic District	
Contributing	
Evaluation Date	
Eligibility Comments	

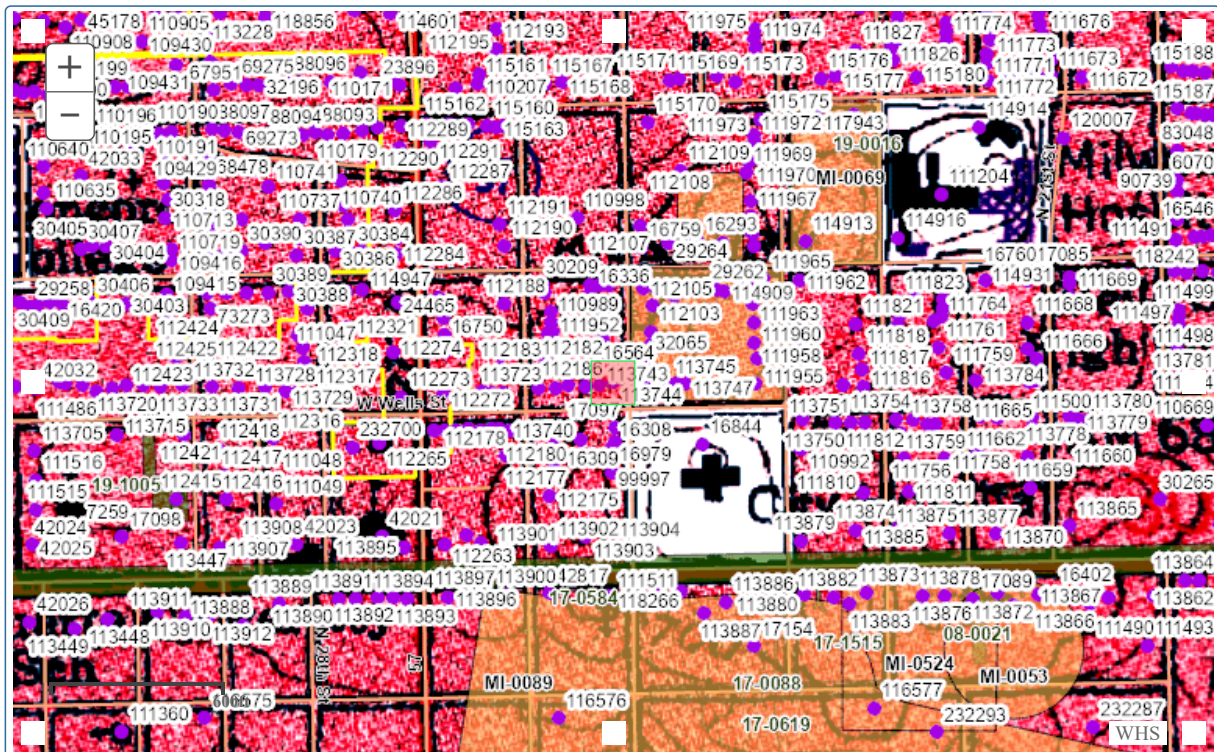



<u>Primary Info</u>			
<b>AHI Number</b>	113903		
<b>Historic Name</b>	Arthur G. Wolff Apartments		
<b>Other Name</b>			
<b>Property Address</b>	2518 W WISCONSIN AVE		
<b>County</b>	Milwaukee	<b>Municipality</b>	Milwaukee
<b>Civil Town</b>		<b>Unincorporated Community</b>	
<b>Parcel</b>		<b>PLSS (T-R-D-S-Q-QQ)</b>	
<b>Style</b>	Art Deco	<b>Wall Material</b>	Brick
<b>Historic Use</b>	apartment/condominium	<b>Structural System</b>	
<b>Year Built</b>	1931	<b>Year Demolished</b>	
<b>Structural Additions</b>			
<b>Architects</b>	Bruce Uthus		

<u>Other Info</u>	
<b>Survey Year</b>	1983, 2014
<b>Tax Credit Project Number</b>	
<b>Tax Credit Case Number (legacy)</b>	
<b>WHS Project Number</b>	15-1199
<b>Bibliographic Reference</b>	
<b>Additional Comments</b>	<p>A 'site file' exists for this property. It contains additional information such as correspondence, newspaper clippings, or historical information. It is a public record and may be viewed in person at the Wisconsin Historical Society, State Historic Preservation Office.</p> <p>2014- "The Arthur G. Wolff Apartment building is a four-story Art Deco apartment building constructed in 1931 and designed by Bruce Uthus. It is a four-story building with an L-plan and clad in brick. It has a flat roof with decorative terra cotta tiles and coping. The main entrance is centered on a wing at the northeast corner of the building, and set back from the street by a series of concrete steps and a sidewalk. It has a substantial masonry door surround with a zig-zag pattern carved into it. It retains the original wood and glass door with a rectangular transom and sidelights. Above the door, on each story, is a grouping of three windows: a three-over-one, double hung sash wood window flanked by two-over-one, double-hung sash. At the corners and between some windows are terra cotta panels with similar zig-zag patterns to what is found on the door surround. Windows on the facade are primarily three-over-one, double hung, wood sash."</p> <p>-"W Wisconsin Ave, 20th St-35th St", WisDOT #2190-00-00, Prepared by Mead &amp; Hunt, Inc. (2014).</p>

<u>Other Eligibility Evaluation</u>	
<b>Individual Eligibility Evaluation</b>	Not Eligible
<b>Proposed Historic District</b>	
<b>Contributing</b>	
<b>Evaluation Date</b>	1/6/2016
<b>Eligibility Comments</b>	Determined not eligible on 1/6/2016.





<b>Primary Info</b>			
AHI Number	113739		
Historic Name			
Other Name			
Property Address	2522 W WELLS ST		
County	Milwaukee	Municipality	Milwaukee
Civil Town		Unincorporated Community	
Parcel		PLSS (T-R-D-S-Q-QQ)	
Style	Contemporary	Wall Material	Stone - Unspecified
Historic Use	apartment/condominium	Structural System	Steel Frame
Year Built	1962	Year Demolished	
Structural Additions			
Architects			
<b>Other Info</b>			
Survey Year	1983		
Tax Credit Project Number			
Tax Credit Case Number (legacy)			
WHS Project Number			
Bibliographic Reference			
Additional Comments	Wellston Co. was the builder.		
<b>Other Eligibility Evaluation</b>			
Individual Eligibility Evaluation	Not Eligible		
Proposed Historic District			
Contributing			
Evaluation Date			
Eligibility Comments			

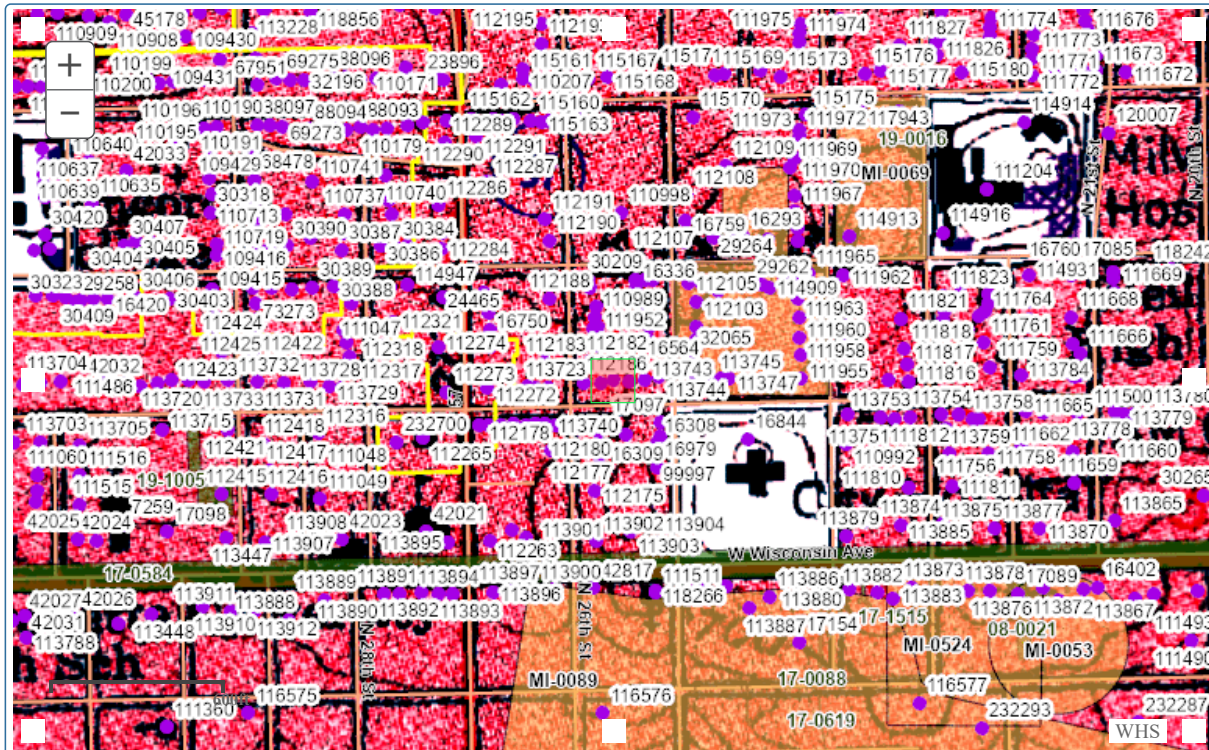



<b>Primary Info</b>			
AHI Number	113738		
Historic Name			
Other Name			
Property Address	2528 W WELLS ST		
County	Milwaukee	Municipality	Milwaukee
Civil Town		Unincorporated Community	
Parcel		PLSS (T-R-D-S-Q-QQ)	
Style	Contemporary	Wall Material	Brick
Historic Use	apartment/condominium	Structural System	Steel Frame
Year Built		Year Demolished	
Structural Additions			
Architects	A. C. Eschweiler		
<b>Other Info</b>			
Survey Year	1983		
Tax Credit Project Number			
Tax Credit Case Number (legacy)			
WHS Project Number			
Bibliographic Reference			
Additional Comments			
<b>Other Eligibility Evaluation</b>			
Individual Eligibility Evaluation	Not Eligible		
Proposed Historic District			
Contributing			
Evaluation Date			
Eligibility Comments			

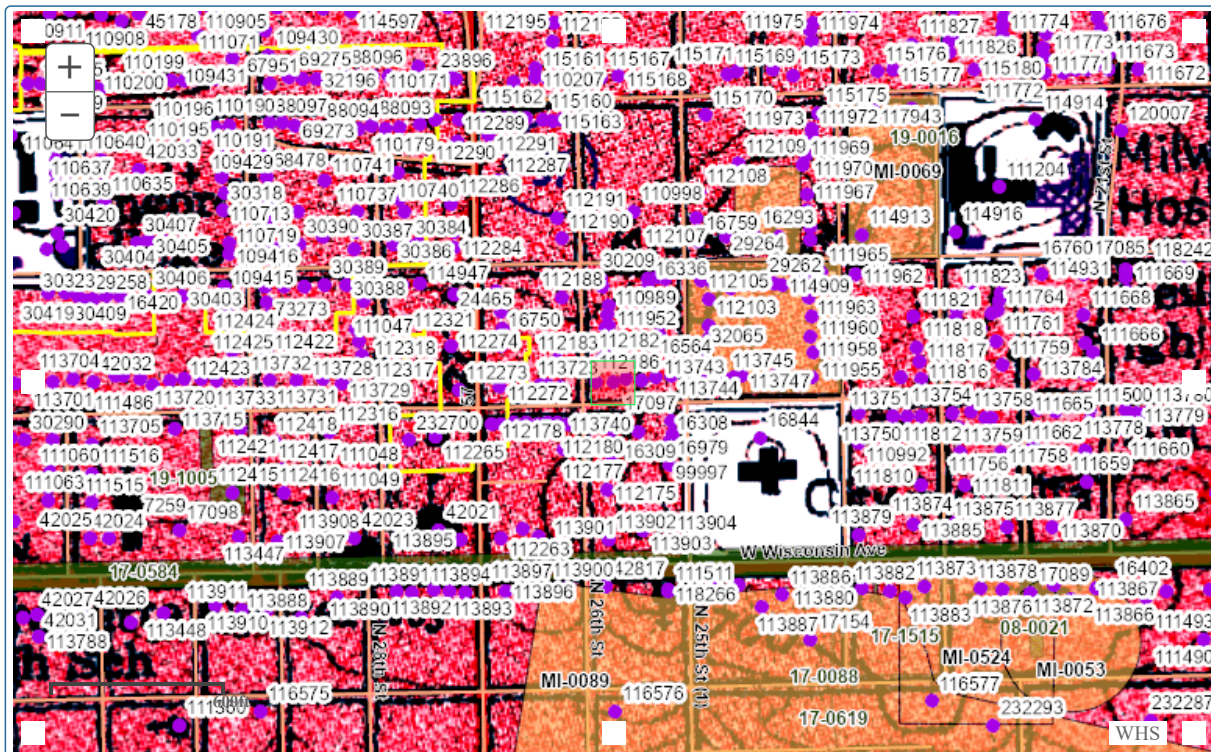



<b>Primary Info</b>			
AHI Number	113902		
Historic Name	G. Winner Residence		
Other Name	Choi's Taekwondo / Golden Chicken / Avenue Foods		
Property Address	2532-34 W WISCONSIN AVE		
County	Milwaukee	Municipality	Milwaukee
Civil Town		Unincorporated Community	
Parcel		PLSS (T-R-D-S-Q-QQ)	
Style	German Renaissance Revival	Wall Material	Brick
Historic Use	house	Structural System	
Year Built	1897	Year Demolished	
Structural Additions	1952		
Architects	Crane & Barkhausen, Schneider & Schaefer		
<b>Other Info</b>			
Survey Year	1983		
Tax Credit Project Number			
Tax Credit Case Number (legacy)			
WHS Project Number			
Bibliographic Reference	Inscription.		
Additional Comments	A. Kroening & Son is the builder. 2014 - Not resurveyed, lack of initial		
<b>Other Eligibility Evaluation</b>			
Individual Eligibility Evaluation	Not Eligible		
Proposed Historic District			
Contributing			
Evaluation Date			
Eligibility Comments			





<b>Primary Info</b>			
AHI Number	115166		
Historic Name	Herman Weise (Weiss?)		
Other Name	State Beer & Liquor		
Property Address	2537 W STATE ST		
County	Milwaukee	Municipality	Milwaukee
Civil Town		Unincorporated Community	
Parcel		PLSS (T-R-D-S-Q-QQ)	
Style	Queen Anne	Wall Material	Asphalt
Historic Use	large retail building	Structural System	
Year Built	1893	Year Demolished	
Structural Additions			
Architects	Edw. Kiesslich		
<b>Other Info</b>			
Survey Year	1983		
Tax Credit Project Number			
Tax Credit Case Number (legacy)			
WHS Project Number			
Bibliographic Reference	Permit.		
Additional Comments	This structure is representative of late 19th century commercial buildings.		
<b>Other Eligibility Evaluation</b>			
Individual Eligibility Evaluation	Not Eligible		
Proposed Historic District			
Contributing			
Evaluation Date			
Eligibility Comments			





<b>Primary Info</b>			
AHI Number	112272		
Historic Name	West Point Apartments		
Other Name			
Property Address	800-810 N 27TH ST/2632 W WELLS ST		
County	Milwaukee	Municipality	Milwaukee
Civil Town		Unincorporated Community	
Parcel		PLSS (T-R-D-S-Q-QQ)	
Style	English Revival Styles	Wall Material	Brick
Historic Use	apartment/condominium	Structural System	
Year Built	1916	Year Demolished	
Structural Additions			
Architects			

<b>Other Info</b>	
Survey Year	1984
Tax Credit Project Number	
Tax Credit Case Number (legacy)	
WHS Project Number	
Bibliographic Reference	
Additional Comments	

<b>National Register Info</b>			
National Register Reference #	16000767	National / State Register Listing Name	27th and Wells Commercial Historic District
State Register Listing Date	8/19/2016	Multiple Property Name	
National Register Listing Date	11/8/2016		

<b>Other Eligibility Evaluation</b>	
Individual Eligibility Evaluation	
Proposed Historic District	
Contributing	Contributing
Evaluation Date	
Eligibility Comments	

